

Bill of Materials Listing

TransArctic Canada Inc.

10/7/2021
Page 1 of 1

Product Number	Date	Description	Uof M	Weight	Yield	
Line	Qty	Component Prod#	Rev#	Bin	Unit	
KMC96664	10/17/2016	2 Mt Kit, ISL13, T3RE TM55/65, 24V, '13+			1654.94	0
10	1	BEL32210			each	
20	1	BMC83053			each	
30	1	BMC83054			each	
40	1	BMC83058			each	
50	1	BMC83074			each	
60	1	BMC83107			each	
70	1	BMC83109			each	
80	1	BMC83113			each	
90	1	BMC83116			each	
100	1	BMC83120			each	
110	1	BMC83122			each	
120	1	BMC90009			each	
130	2	CLP04000			each	
140	1	HOA04083			each	
150	1	KCB65502			each	
160	1	PUA05012			each	
170	1	PUL80074			each	
180	1	PUL89323			each	
190	1	SCD46012			each	
200	1	SCD48012			each	
210	2	SLV17012			each	
220	1	TUS04093			each	
230	1	KBC96664			each	

WILL REQUIRE TMP00002 (TEMPLATE).

Bill of Materials Listing

TransArctic Canada Inc.

10/6/2021
Page 1 of 1

Product Number	Date	Description	Uof M	Weight	Yield		
Line	Qty	Component Prod#	Rev#	Description	Bin	Unit	
KBC96664	10/17/2016	0	0	Bag Kit, Fasteners, KMC96664		2.97	0
10	4	BTC08035		Bolt, Hex, 8 x 1.25 x 35mm, 10.9, Plt,FT		each	
20	2	BTC10035		Bolt, Hex, 10 x 1.5 x 35mm, 10.9, Plt,FT		each	
30	5	BTC12040		Bolt, Hex, 12 x 1.75 x 40mm, 10.9,Plt,FT		each	
40	2	BTC12050		Bolt, Hex, 12 x 1.75 x 50mm, 10.9,Plt		each	
50	2	BTC12100		Bolt, Hex, 12 x 1.75 x 100mm, 10.9, Plt		each	
60	6	BTQ08126		Bolt, Hex, 1/2-20unf, 1.25", 8, Plt		each	
70	2	NTA10000		Nut, Hex, 10 x 1.5, 8.8, Plt		each	
80	9	NTA12000		Nut, Hex, 12 x 1.75, 8.8, Plt		each	
90	3	SCP03075		Screw, PH, PD, SDT, #10-16 x .75, ST,Plt		each	
100	4	WFA08000		Washer, Flat, 8mm, 8.8, Plt		each	
110	4	WFA10000		Washer, Flat, 10mm, 8.8, Plt		each	
120	16	WFA12000		Washer, Flat, 12mm, 8.8, Plt		each	
130	6	WFQ08000		Washer, Flat, 1/2", 8, Plt		each	
140	4	WLA08000		Washer, Lock, 8mm, 8.8, Plt		each	
150	2	WLA10000		Washer, Lock, 10mm, 8.8, Plt		each	
160	9	WLA12000		Washer, Lock, 12mm, 8.8, Plt		each	
170	6	WLQ08000		Washer, Lock, 1/2", 8, Plt		each	

Bill of Materials Listing

TransArctic Canada Inc.

2/8/2022
Page 1 of 1

Product Number	Date	Description		Uof M	Weight	Yield	
Line	Qty	Component Prod#	Rev#	Description	Bin	Unit	
KCB65502	10/13/16	0		Kit, Compressor, D/S, 24v, TM-65/55, '16		668.52	0
10	2	BMN80008	1	Vibration Isolator, Bar, 16.50 x 2 x 1.50		each	
20	1	BMN80025	0	Bkt, Back, PL, Slide, IC, RE300		each	
30	1	BMZ00043	3	Bkt, Main, Base PI, '13		each	
40	1	KAC65502	3	Kit, Alternator, TM-65, Driver Side, '13		each	
50	1	KBT65501	0	Kit, Platform, P/S, TM-55/65, '16		each	
60	1	KBC65502	0	Bag Kit, Fasteners, KCB65502		each	

Bill of Materials Listing

TransArctic Canada Inc.

10/6/2021
Page 1 of 1

Product Number	Date	Description		Uof M	Weight	Yield	
Line	Qty	Component	Prod#	Rev#	Bin	Unit	
KBC65502	10/31/2016	0	Bag Kit, Fasteners, KCB65502			1.14	0
10	1	BTP08653				each	
20	3	BTQ08101				each	
30	2	BTQ08126				each	
40	1	CSF08076				each	
50	5	WFQ08000				each	
60	6	WLQ08000				each	

Bill of Materials Listing

TransArctic Canada Inc.

2/8/2022
Page 1 of 1

Product Number	Date	Description		Uof M	Weight	Yield	
Line	Qty	Component Prod#	Rev#	Description	Bin	Unit	
KAC65502	08/11/16	3		Kit, Alternator, TM-65, Driver Side, '13		31.53	0
5	1	PAC12110		Pack, Carton, 12" x 11" x 5", 51 ECT		each	
10	2	BEL11040		Belt, A gr, 1040mm (41")		each	
20	1	BMC96663		1 Bkt, Main, Alt, Weldmt,ISL,TM-65/55,'13		each	
40	2	BMT10011		0 Bkt, Tenr, Block, Offset, 3mm		each	
50	1	PUL03321		1 Pulley, ALT, Idler, 3.25"d, 2A		each	
55	1	KBA84064		0 Bag Kit, ALT Shim, KC84064, KAC65501/02		each	
60	1	TRD08080		Threaded, Rod, 1/2-13unc x 8", 5, Plt		each	
70	1	KBA65502		0 Bag Kit, Fasteners, KAC65502			

NOTE:

1) Use KBA84064 "Shim bag kit", as required, to align the Alternator correctly.

Bill of Materials Listing

TransArctic Canada Inc.

10/6/2021
Page 1 of 1

Product Number	Date	Description			Uof M	Weight	Yield		
Line	Qty	Component	Prod#	Rev#	Description	Bin	Unit		
KBA65502	8/10/2016	0	Bag Kit, Fasteners, KAC65502					1.52	0
10	4	BTC12035			Bolt, Hex, 12 x 1.75 x 35mm, 10.9,Plt,FT		each		
20	1	BTQ08150			Bolt, Hex, 1/2-13unc, 1.5", 8, Plt		each		
30	1	BTQ08200			Bolt, Hex, 1/2-13unc, 2.0", 8, Plt		each		
40	1	BTQ08653			Bolt, Hex, 1/2-13unc, 6.5", 8, Plt		each		
50	6	NTQ08000			Nut, Hex, 1/2-13unc, 8, Plt		each		
60	4	WFA12000			Washer, Flat, 12mm, 8.8, Plt		each		
70	4	WFQ08000			Washer, Flat, 1/2", 8, Plt		each		
80	4	WLA12000			Washer, Lock, 12mm, 8.8, Plt		each		
90	5	WLQ08000			Washer, Lock, 1/2", 8, Plt		each		

Bill of Materials Listing

TransArctic Canada Inc.

2/4/2022
Page 1 of 1

Product Number	Date	Description			Uof M	Weight	Yield		
Line	Qty	Component	Prod#	Rev#	Description	Bin	Unit		
KBA84064	10/19/21	0			Bag Kit, ALT Shim, KC84064, KAC65501/02			0.09	0
10	1	SCD03613		0	Spacer, Col, Drl, 3.56mm x 25.4o x12.7i	Alley	each		
20	2	WFA14000			Washer, Flat, 14mm, 8.8, Plt		each		
30	2	WFQ08000			Washer, Flat, 1/2", 8, Plt		each		

NOTE:

1) Use (1) SCD03613, (2) WFA14000, (2) WFQ08000, in any arrg'mt/qtys as required to align the Alternator correctly.

Bill of Materials Listing

TransArctic Canada Inc.

10/6/2021
Page 1 of 1

Product Number	Date	Description		Uof M	Weight	Yield	
Line	Qty	Component Prod#	Rev#	Description	Bin	Unit	
KBT65501	8/10/2016	0		Kit, Platform, P/S, TM-55/65, '16		179.69	0
5	1	PAC15110		Pack, Carton, 15" x 11" x 10", 51 ECT		each	
10	1	BMN80031		0 Bkt, Main, Slide, Assy, 05K, IC, RE300		each	
20	1	BMZ00056		0 Bkt, Comp, FRT, Z, TM-65/55, '13		each	
30	1	BMZ00057		0 Bkt, Comp, Rear, Z, TM-65/55, '13		each	
40	1	KBZ65501		0 Bag Kit, Fasteners, KBT65501		each	

Bill of Materials Listing

TransArctic Canada Inc.

10/6/2021
Page 1 of 1

Product Number	Date			Description	Uof M	Weight	Yield	
Line	Qty	Component	Prod#	Rev#	Description	Bin	Unit	
KBZ65501			8/10/2016	0	Bag Kit, Fasteners, KBT65501		0.69	0
10	4	BTC12035			Bolt, Hex, 12 x 1.75 x 35mm, 10.9,Plt,FT		each	
20	4	NTP07000			Nut, Hex, 7/16-14unc, 5, Plt		each	
30	4	WFA12000			Washer, Flat, 12mm, 8.8, Plt		each	
40	4	WFN07000			Washer, Flat, 7/16", 2, Plt		each	
50	4	WLA12000			Washer, Lock, 12mm, 8.8, Plt		each	
60	4	WLQ07000			Washer, Lock, 7/16", 8, Plt		each	

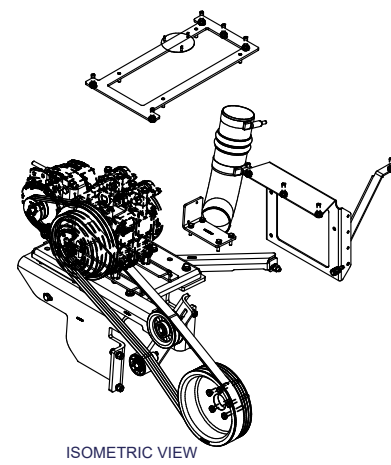
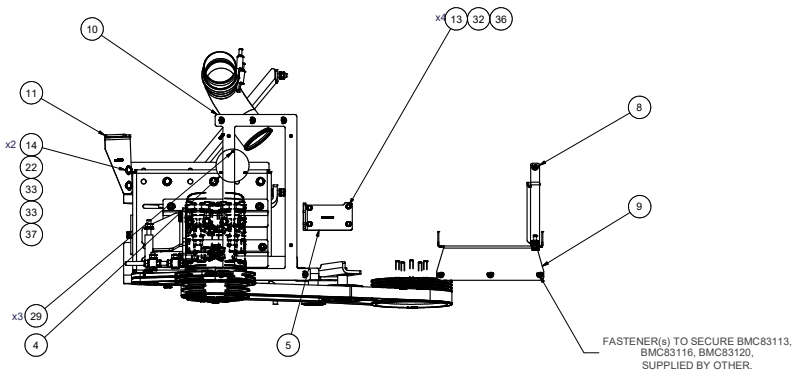

NOTE:
SHOWING TRANSARCTIC
COMPRESSOR PART#
CMV33844 (550cc)
CMV38844 (635cc)
AS REFERENCE.

NOTE:
SHOWING ALTERNATOR
AS REFERENCE.

NOTE:
RE-USE (5) EXISTING OEM BOLTS.
TORQUE TO: 50-55 FT-LB PLAIN & DRY
(HEXBOLT CAPSCREW M10 x 1.5 x 90mm)
TIGHTEN IN TWO STEPS IN A CRIS-CROSS
TIGHTENING SEQUENCE PATTERN.

NOTE:
INSTALL PULLEY WITH
DEEP OFFSET TOWARD SPACER.

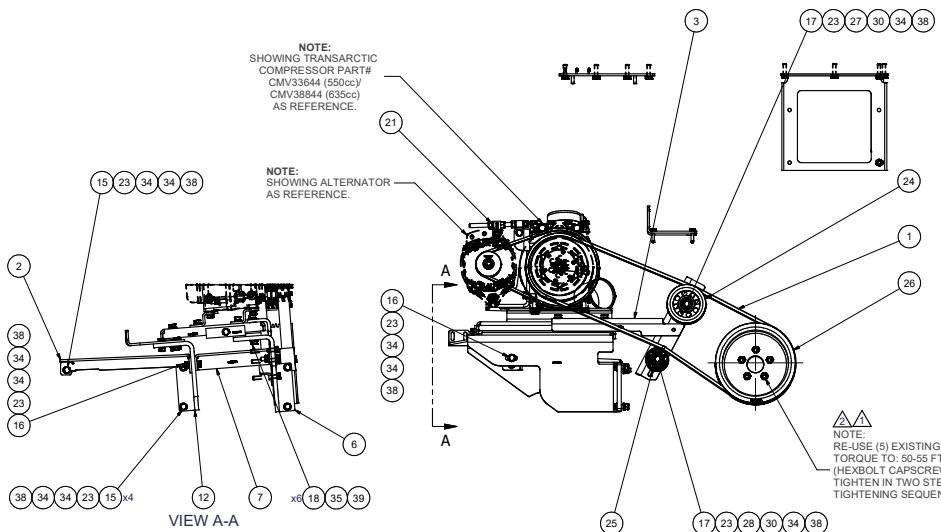

39	6	EACH	WLO08000	WASHER, LOCK, 1/2", 8, PLT
38	9	EACH	WLA12000	WASHER, LOCK, 12mm, 8.8, PLT
37	2	EACH	WLA10000	WASHER, LOCK, 10mm, 8.8, PLT
36	4	EACH	WLA08000	WASHER, LOCK, 8mm, 8.8, PLT
35	6	EACH	WFO08000	WASHER, FLAT, 1/2", 8, PLT
34	16	EACH	WFA12000	WASHER, FLAT, 12mm, 8.8, PLT
33	4	EACH	WFA10000	WASHER, FLAT, 10mm, 8.8, PLT
32	4	EACH	WFA08000	WASHER, FLAT, 8mm, 8.8, PLT
31	1	EACH	TUS04093	TUBE, STL, EXH, 4"o.d., 90 deg ELB, 8 x 8
30	2	EACH	SLV17012	SLEEVE, PULLEY, 16.90 x 22.23 mm x12.191
29	3	EACH	SCP03075	SCREW, PH, SDT, #10-16 x .75, ST, PLT
28	1	EACH	SCD48012	SPACER, COL, DRL, 48mm x 31.80 x 12.01
27	1	EACH	SCD46012	SPACER, COL, DRL, 46mm x 31.80 x 12.01
26	1	EACH	PULB9323	PULLEY, CRANK, ADD-ON, ISL, 28/3V, '13
25	1	EACH	PULB0074	PULLEY, IDLER, BACKSIDE, P8, 74D, 46.27W
24	1	EACH	PUA05012	PULLEY, ASSY, IDLER, B/BX gr, 5" STL, PLT
23	9	EACH	NTA12000	NUT, HEX, 12 x 1.75, 8.8, PLT
22	2	EACH	NTA10000	NUT, HEX, 10 x 1.5, 8.8, PLT
21	1	EACH	KCB65502	KIT, COMPRESSOR, D/S, 24V, TM-65/55, '16
20	1	EACH	HOA04083	HOSE, FLEX, CAC, 4.0d x 8.0, 3 RING
19	2	EACH	CLP04000	CLAMP, T BOLT, SPRING, 4", CAC
18	6	EACH	BTQ8126	BOLT, HEX, 1/2-20UNF x 1.25, 8, PLT
17	2	EACH	BTCL1200	BOLT, HEX, 12 x 1.75 x 100mm, 10.9, PLT
16	2	EACH	BTCL2050	BOLT, HEX, 12 x 1.75 x 50mm, 10.9, PLT
15	5	EACH	BTCL2040	BOLT, HEX, 12 x 1.75 x 40mm, 10.9, PLT
14	2	EACH	BTCL0035	BOLT, HEX, 10 x 1.5 x 35mm, 10.9, PLT
13	4	EACH	BTCL0835	BOLT, HEX, 8 x 1.25 x 35mm, 10.9, PLT
12	1	EACH	BMC90009	BKT, MAIN, RR SUPPORT, CNG, T3RE, '13
11	1	EACH	BMC83122	BKT, EXHAUST, ADAPTER, T3RE, '13
10	1	EACH	BMC83120	BKT, WELDMT, SUP, A.F HOUSING, T3RE, '13
9	1	EACH	BMC83116	BKT, SUPPORT, PDU PANEL, T3RE, '13
8	1	EACH	BMC83113	BKT, BRACE RR/RS, PDU PANEL, T3RE, '13
7	1	EACH	BMC83109	BKT, MAIN, LATERAL BRACE, T3RE, '13
6	1	EACH	BMC83107	BKT, MAIN, FRT SUPPORT, T3RE, '13
5	1	EACH	BMC83074	BKT, RELAY, ISC, D3RE, 2010
4	1	EACH	BMC83058	BKT, COVER, LIGHT PL, MFDI, RE300
3	1	EACH	BMC83054	BKT, MAIN, IDLER, WELDMT, RE300
2	1	EACH	BMC83053	BKT, DIAG, BRACE RR, MFDI, RE300
1	1	EACH	BEL32210	BELT, BANDED B Gr, 2210mm (87")

TRANSARCTIC INC.

REV: ECN DESCRIPTION DATE BY: James Stewart 10/17/2016
 2 CORRECTED TORQUE SPEC NOTE 10/30/2021 JRR CHECKED
 1 ADDED TO TORQUE SPEC NOTE 10/30/2014 JRR
 0 RELEASED TO PRODUCTION 10/17/2016 JRR

APPROVED: Dale Mason 10/17/2016

DRAWING UNIT OF MEASURE: MM (INCH) SCALE: 1:8

THIRD ANGLE PROJECTION

UNSPECIFIED TOLERANCES: ALL DIMS TO FACE UNLESS OTHERWISE SPECIFIED
 ONE DECIMAL PLACE (X1) .10 INCH
 TWO DECIMAL PLACE (X2) .02 INCH
 THREE DECIMAL PLACE (X3) .01 INCH
 FRACTIONAL (X1/8) 1/8 INCH

DWG NO: KMC96664
 TITLE: MT KIT, ISL13, T3RE TM-65/55, 1/2"24V '13+
 SHEET 1 OF 1

NOTES:
 1) USE SERVICABLE THREADLOCKER ON ALL FASTENERS TO ENGINE COMPONENTS AND TORQUE ALL BOLTS TO S.A.E. SPECIFICATIONS.
 2) SEE "TRANSARCTIC A/C COMPRESSOR MOUNT INSTALLATION DISCLAIMER".

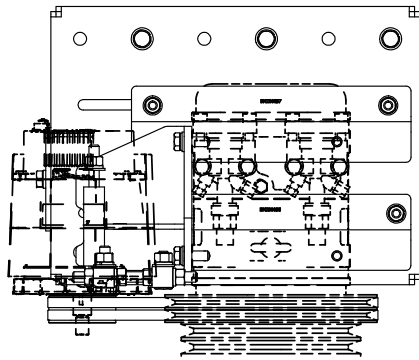

NOTE:
SHOWING ALTERNATOR
AS REFERENCE.

NOTE:
SHOWING COMPRESSOR
VALVE# T21485BY
AS REFERENCE.

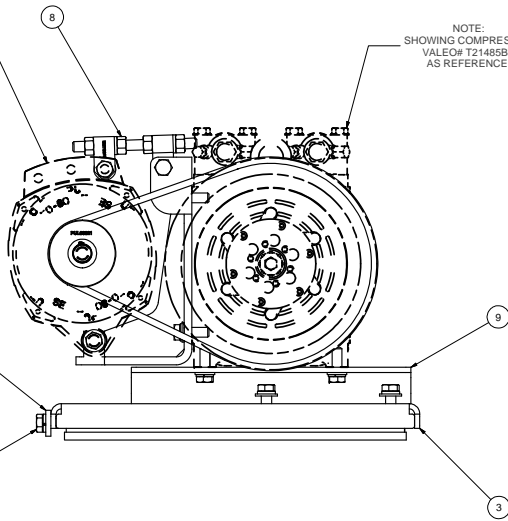

TOP VIEW

PARTS REMOVED FOR
CLARITY.

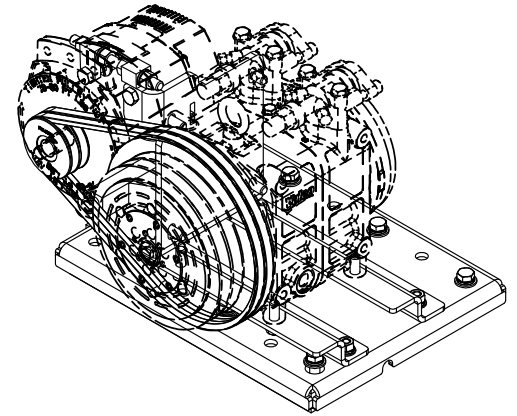
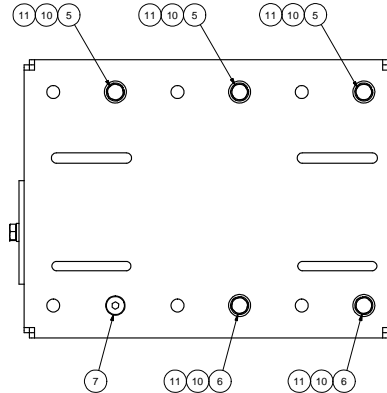

ISOMETRIC VIEW

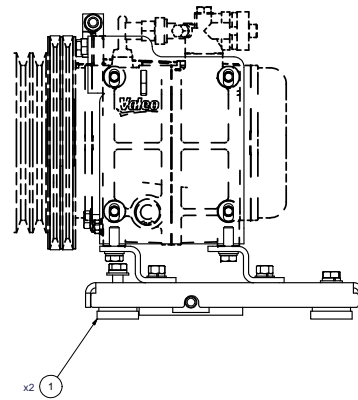

NOTES:

- 1) USE SERVICABLE THREADLOCKER ON ALL FASTENERS TO ENGINE COMPONENTS AND TORQUE **ALL** BOLTS TO S.A.E. SPECIFICATIONS.
- 2) SEE "TRANSARCTIC A/C COMPRESSOR MOUNT INSTALLATION DISCLAIMER".
- 3) WEIGHT: 68.75LBS.

ITEM	QTY	U/M	PART NUMBER	DESCRIPTION
11	6	EACH	WLO08000	WASHER, LOCK, 1/2", 8, PLT
10	5	EACH	WF008000	WASHER, FLAT, 1/2", 8, PLT
9	1	EACH	KBT65501	KIT, PLATFORM, P/S, TM-55/65, '16
8	1	EACH	KAC65502	KIT, ALTERNATOR, TM-65, DRIVER SIDE, '13
7	1	EACH	CSF08076	CAPSCREW, FH, 1/2-20UNF x .75", ALLOY, PLT
6	2	EACH	BTQ08126	BOLT, HEX, 1/2-20UNF x 1.25, 8, PLT
5	3	EACH	BTQ08101	BOLT, HEX, 1/2-20UNF x 1.00, 8, PLT
4	1	EACH	BTQ08653	BOLT, HEX, 1/2-13UNC x 6.50, 5, PLT, FT
3	1	EACH	BMZ00043	BKT, MAIN, BASE PL, '13
2	1	EACH	BMN80025	BKT, BACK, PL, SLIDE, IC, RE300
1	2	EACH	BMN80008	VIBRATION ISOLATOR, BAR, 1x.50 x 2 x 1.50

TRANSARCTIC INC.

DATE: 10/13/2016	BY: JRS	DESCRIPTION: RELEASED TO PRODUCTION	DATE: 10/13/2016	BY: Val_Jakowlew	TITLE: KIT, COMPRESSOR, D/S, 24V, TM-65/55, '16
DATE: 10/13/2016	BY: James Stewart	DESCRIPTION: APPROVED	DATE: 10/13/2016	BY: Dale Mason	DESCRIPTION: APPROVED
UNSPECIFIED TOLERANCES:		ALL DIMS	THIRD ANGLE PROJECTION		
ONE DECIMAL PLACE (X.0)	FRONT	FRONT	DRAWING UNIT OF MEASURE: MM (INCH)		
TWO DECIMAL PLACES (X.00)	FRONT	FRONT	SCALE: 1:3		
THREE DECIMAL PLACES (X.000)	FRONT	FRONT	DWG NO: KCB65502		
FRACTIONAL (1/16")	FRONT	FRONT	REV: 0		
SHEET 1 OF 1			SHEET 1 OF 1		

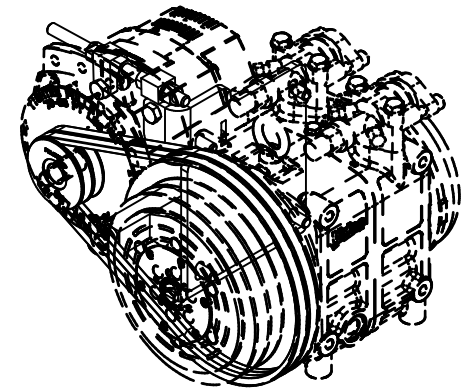
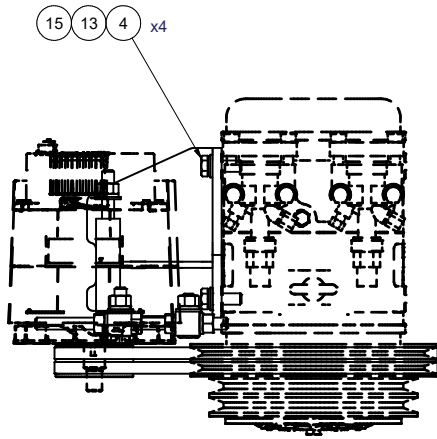

ISOMETRIC VIEW

NOTE:
SHOWING TRANSARCTIC
COMPRESSOR PART#
CMV33644 (550cc)/
CMV38844 (635cc)
AS REFERENCE.

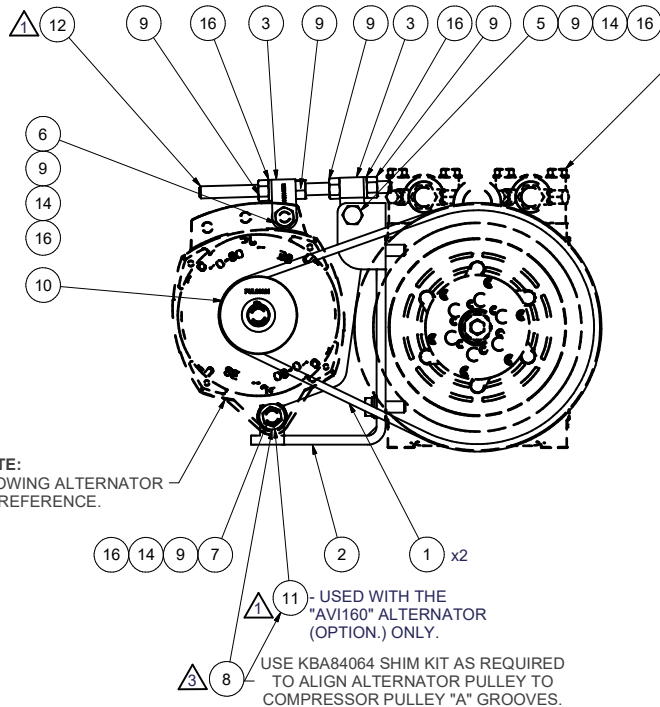

NOTE:
SHOWING ALTERNATOR
AS REFERENCE.

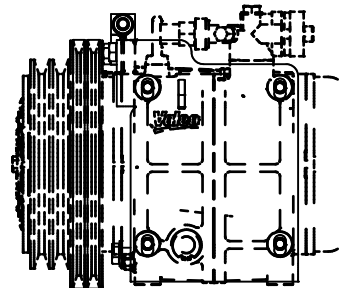

NOTES:

- 1) USE SERVICABLE THREADLOCKER ON ALL FASTENERS TO ENGINE COMPONENTS AND TORQUE **ALL** BOLTS TO S.A.E. SPECIFICATIONS.
- 2) SEE "TRANSARCTIC A/C COMPRESSOR MOUNT INSTALLATION DISCLAIMER".
- 3) WEIGHT: 18.11 LB

16	5	EACH	WLQ08000	WASHER, LOCK, 1/2", 8, PLT
15	4	EACH	WLA12000	WASHER, LOCK, 12mm, 8.8, PLT
14	4	EACH	WFO08000	WASHER, FLAT, 1/2", 8, PLT
13	4	EACH	WFA12000	WASHER, FLAT, 12mm, 8.8, PLT
12	1	EACH	TRD08080	THREADED, ROD, 1/2-13UNC x 8", 5 PLT
11	1	EACH	SCD05513	SPACER, COL, DRL, 5.51mm x 25.4o x 12.7i
10	1	EACH	PUL03321	PULLEY, ALT, IDLER, 3.25"o, 2A
9	7	EACH	NTQ08000	NUT, HEX, 1/2-13UNC, 8, PLT
8	1	EACH	KBA84064	BAG KIT, ALT SHIM, KC84064, KAC65501/02
7	1	EACH	BTQ08653	BOLT, HEX, 1/2-13UNC x 6.50, 8, PLT
6	1	EACH	BTQ08200	BOLT, HEX, 1/2-13UNC x 2.00, 8, PLT
5	1	EACH	BTQ08150	BOLT, HEX, 1/2-13UNC x 1.50, 8, PLT
4	4	EACH	BTC12035	BOLT, HEX, 12 x 1.75 x 35mm, 10.9, PLT
3	2	EACH	BMT10011	BKT, TENR, BLOCK, OFFSET, 3mm
2	1	EACH	BMC96663	BKT, MAIN, ALT, WELDM'T, ISL, TM-65/55, '13
1	2	EACH	BEL11118	BELT, A gr, 1040mm (41")
ITEM	QTY	U/M	PART NUMBER	DESCRIPTION

BILL OF MATERIALS

DRAWN	vjakowlew	10/04/16
CHECKED	Jose Rodriguez	10/04/16
QA	James Stewart	10/4/2016
MFG	James Stewart	10/04/16
APPROVED	Dale Mason	10/04/16

TRANSARCTIC INC.

TITLE
KIT, ALTERNATOR, TM-65, DRIVER SIDE, '13

SIZE	C	DWG NO	KAC65502	REV	3
SCALE	1:4	SHEET	1	OF	1

3	ADDED KBA84064 SHIM BAG KIT.	02/03/2022	VALJ	
2	WAS KBA96663 FASTENER BAG KIT.	10/11/2021	JRR	
1	WAS TRD08060 ADDED SCD05513	05/11/2021	VALJ	
0	RELEASED TO PRODUCTION.	10/4/2016	JRR	
REV:	ECN:	DESCRIPTION:	DATE:	BY:
THIS DRAWING CONTAINS PROPRIETARY CONFIDENTIAL INFORMATION OWNED BY TRANSARCTIC CANADA INC. THE DOCUMENT AND THE INFORMATION IN IT ARE NOT TO BE USED, DISCLOSED OR REPRODUCED WITHOUT EXPRESS WRITTEN PERMISSION OF THE COMPANY.				
UNSPECIFIED TOLERANCES: [ALT. DIM.]				
ONE DECIMAL PLACE (X)	MM	(INCH)		
TWO DECIMAL PLACE (XX)	.25	(.010)		
THREE DECIMAL PLACE (XXX)	.10	(.005)		
FRACTIONAL +/- .002"	ANGULAR +/- .50°			
THIRD ANGLE PROJECTION				
DRAWING UNIT OF MEASURE: MM (INCH)				

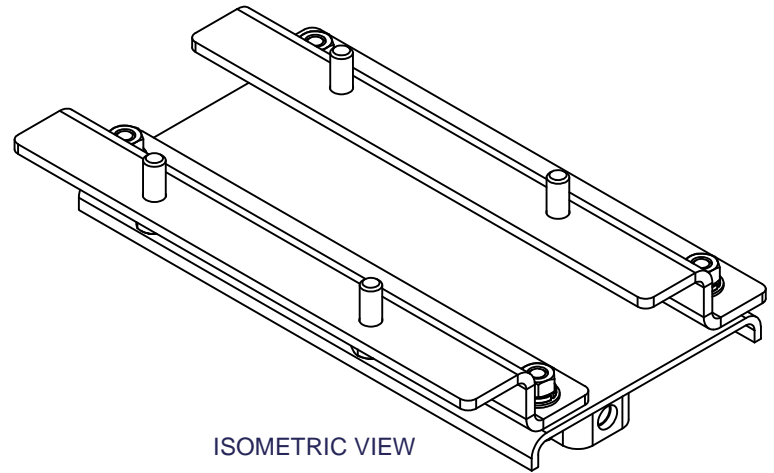
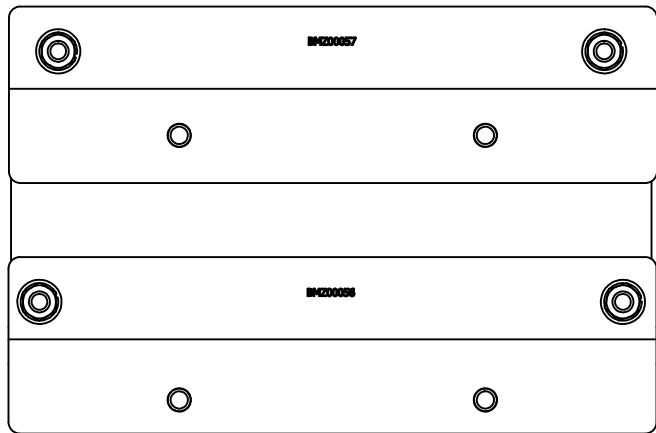

ISOMETRIC VIEW

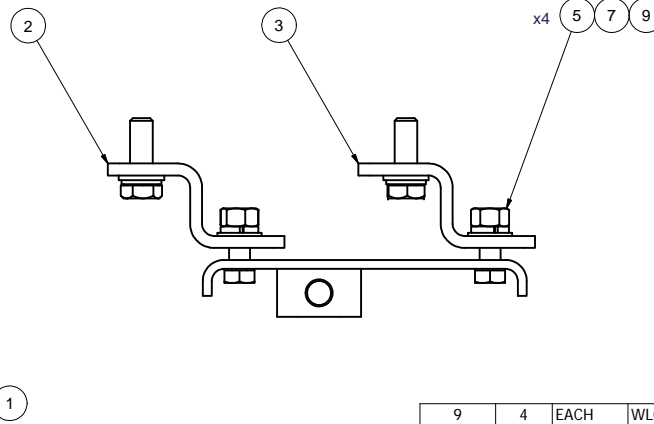
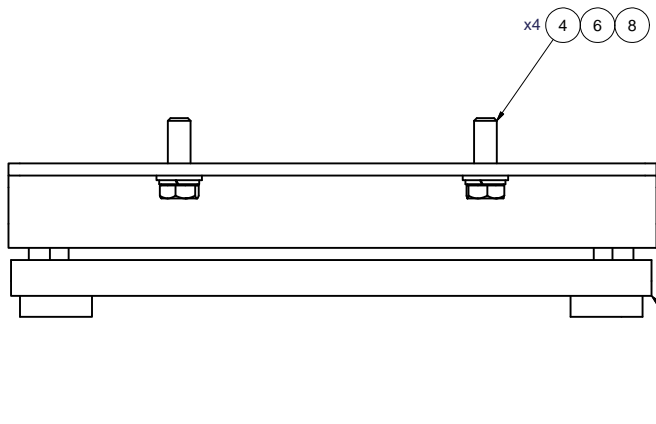

ITEM	QTY	U/M	PART NUMBER	DESCRIPTION
9	4	EACH	WLQ07000	WASHER, LOCK, 7/16", 8, PLT
8	4	EACH	WLA12000	WASHER, LOCK, 12mm, 8.8, PLT
7	4	EACH	WFO07000	WASHER, FLAT, 7/16", 2, PLT
6	4	EACH	WFA12000	WASHER, FLAT, 12mm, 8.8, PLT
5	4	EACH	NTP07000	NUT, HEX, 7/16-14UNC, 5, PLT
4	4	EACH	BTC12035	BOLT, HEX, 12 x 1.75 x 35mm, 10.9, PLT
3	1	EACH	BMZ00057	BKT, COMP, REAR, Z, TM-65/55, '13
2	1	EACH	BMZ00056	BKT, COMP, FRT, Z, TM-65/55, '13
1	1	EACH	BMN80031	BKT, MAIN, SLIDE, ASSY, 05K, IC, RE300



NOTES:

- 1) USE SERVICABLE THREADLOCKER ON ALL FASTENERS TO ENGINE COMPONENTS AND TORQUE **ALL** BOLTS TO S.A.E. SPECIFICATIONS.
- 2) SEE "TRANSARCTIC A/C COMPRESSOR MOUNT INSTALLATION DISCLAIMER".
- 3) WEIGHT: 16.47 LBS.

0	-	RELEASED TO PRODUCTION	8/8/2016	JRR
REV	ECN	DESCRIPTION	DATE	BY
THIS DRAWING CONTAINS PROPRIETARY CONFIDENTIAL INFORMATION OWNED BY TRANSARCTIC CANADA INC. THE DOCUMENT AND THE INFORMATION IN IT ARE NOT TO BE USED, DISCLOSED OR REPRODUCED WITHOUT EXPRESS WRITTEN PERMISSION OF THE COMPANY.				
UNSPECIFIED TOLERANCES: (ALT. DIM.)				
ONE DECIMAL PLACE (.X)	MM	(.020)	(.001)	
TWO DECIMAL PLACE (.XX)	MM	.25	[.010]	
THREE DECIMAL PLACE (.XXX)	MM	.10	[.005]	
FRACTIONAL +/- 1/32"	ANGULAR	+/- .50°		
 THIRD ANGLE PROJECTION				

DRAWN	8/8/2016
Jrodriguez	
CHECKED	8/8/2016
Val Jakowlew	
QA	
James Stewart	8/8/2016
MFG	
James Stewart	8/8/2016
APPROVED	
Dale Mason	8/8/2016
DRAWING UNIT OF MEASURE:	MM [INCH]

TITLE		REV	
KIT, PLATFORM, P/S, TM-55/65, '16		0	
SIZE	DWG NO		
C	KBT65501		
SCALE	1:2	SHEET 1 OF 1	

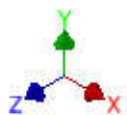
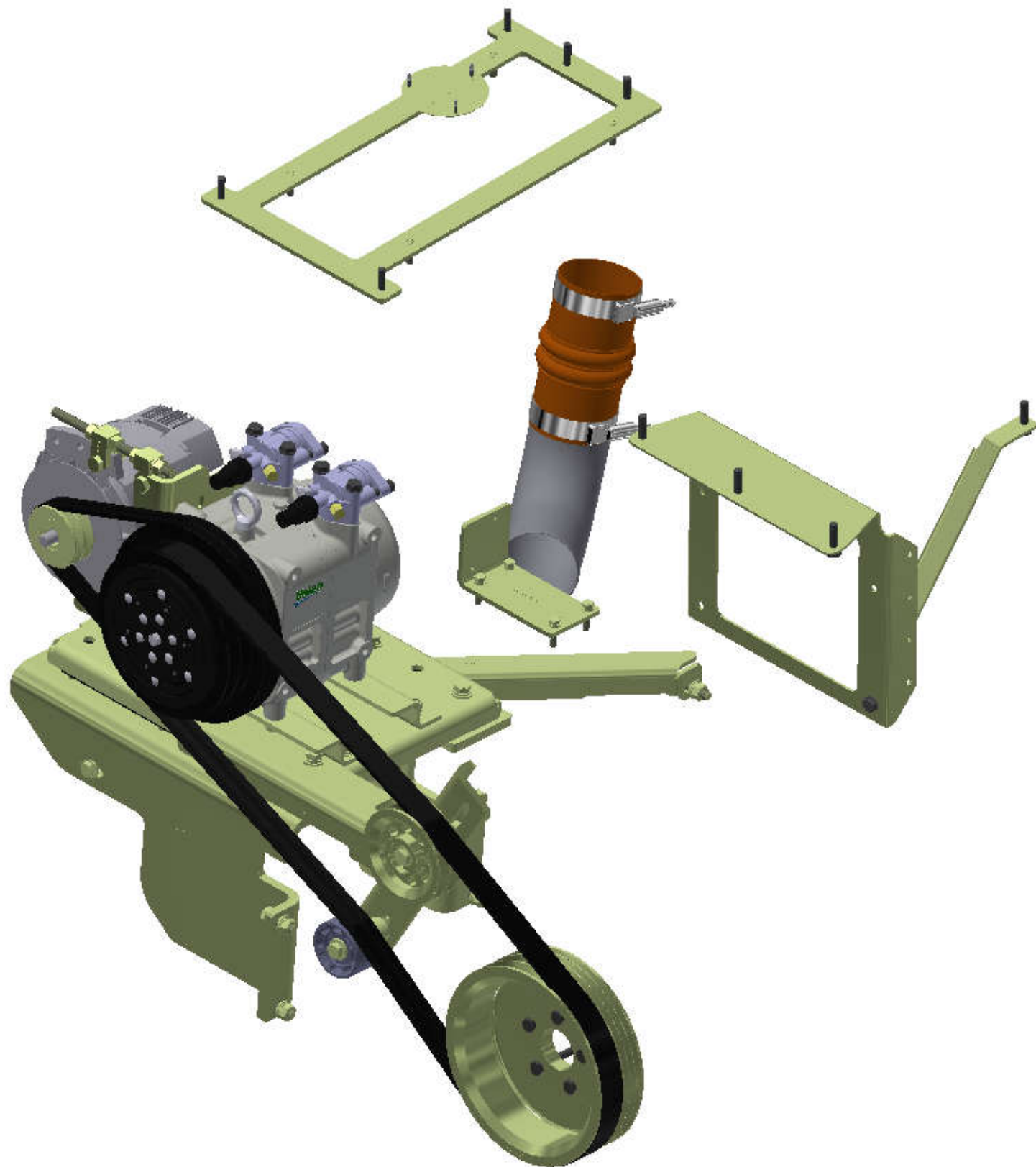

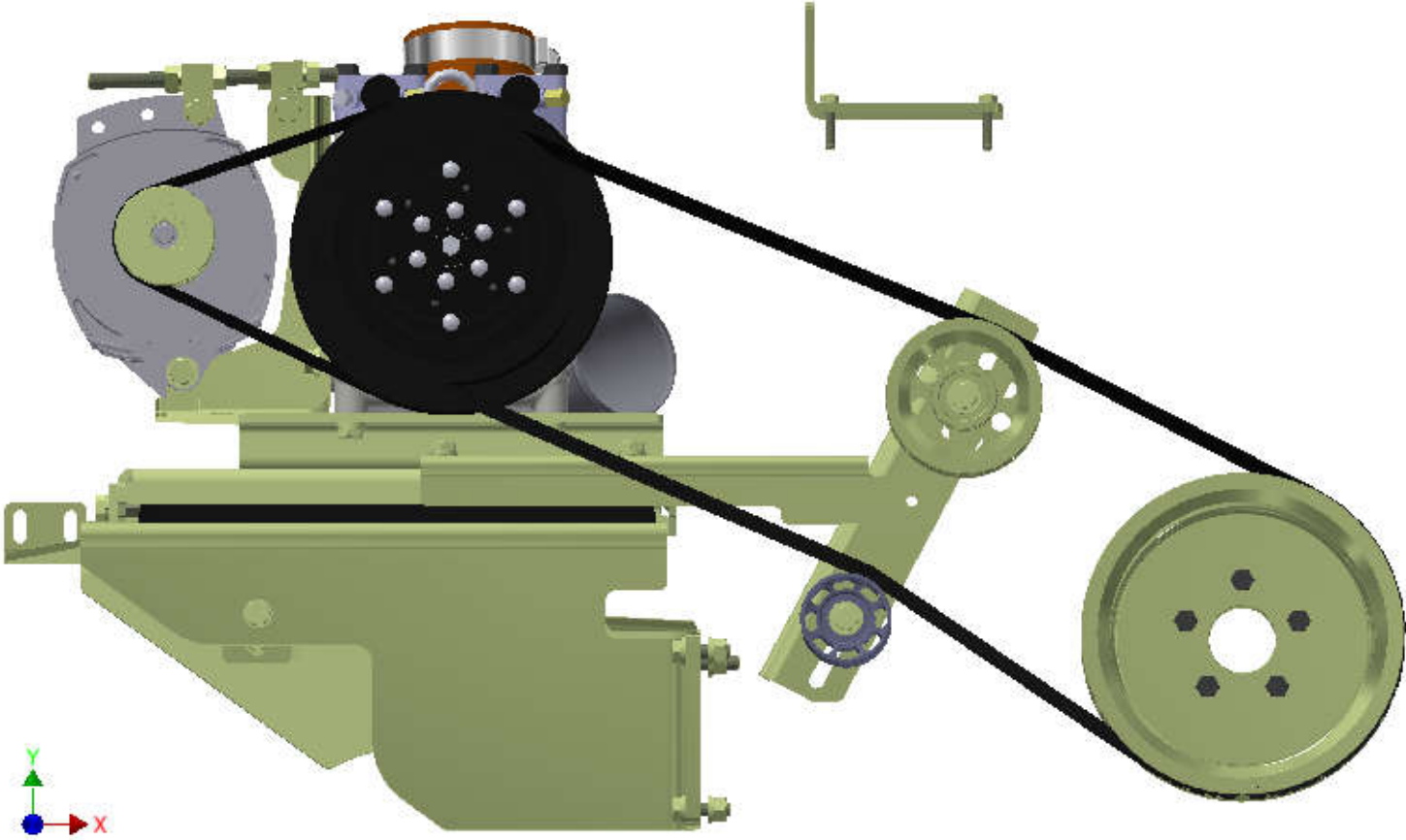
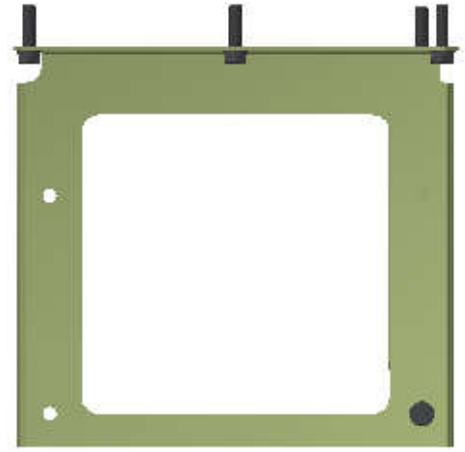

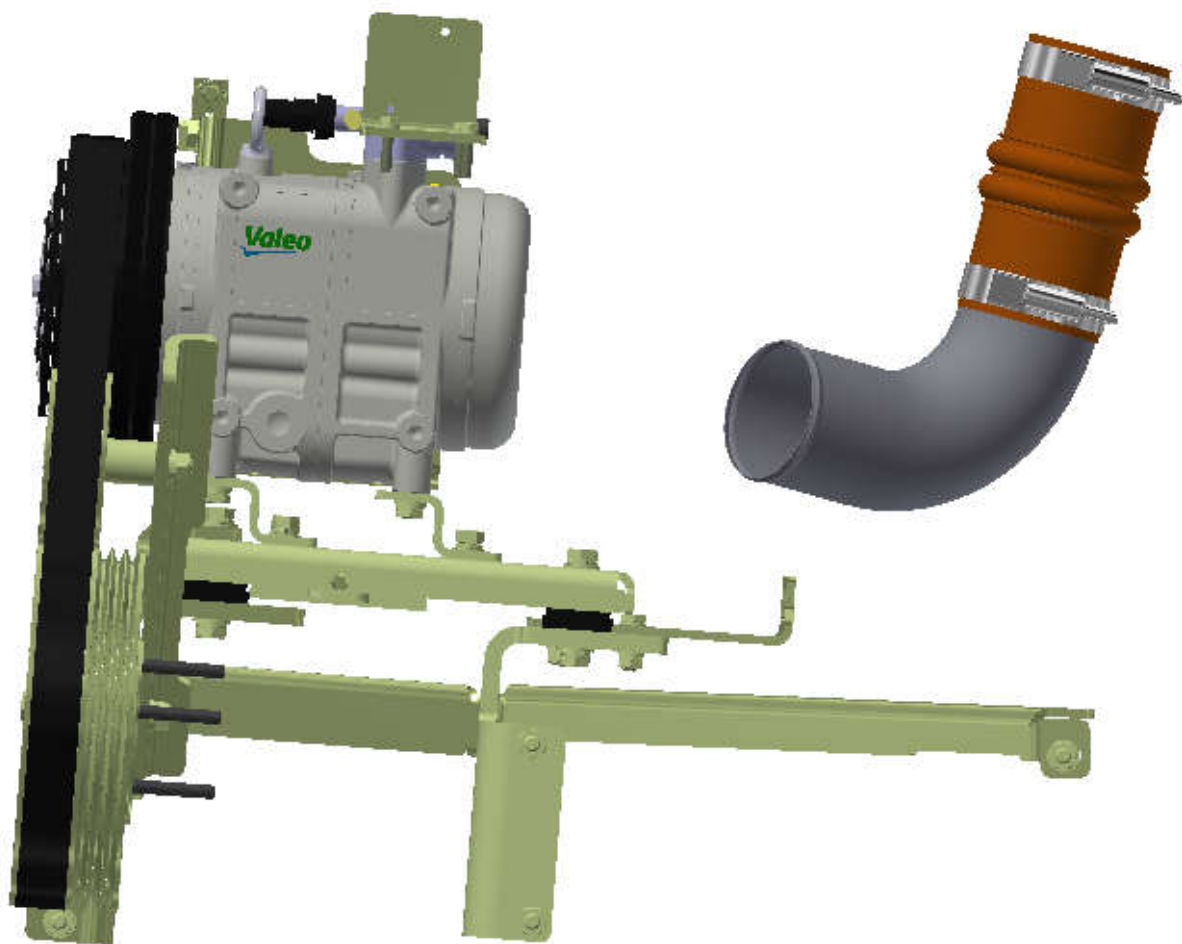
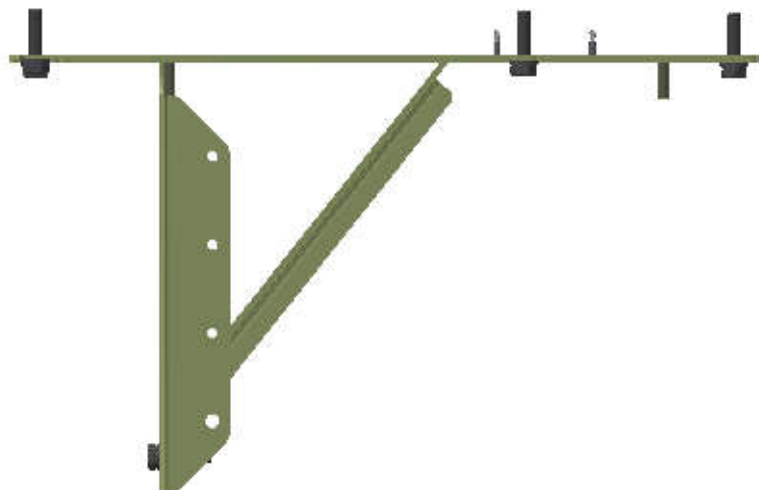

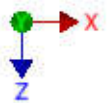
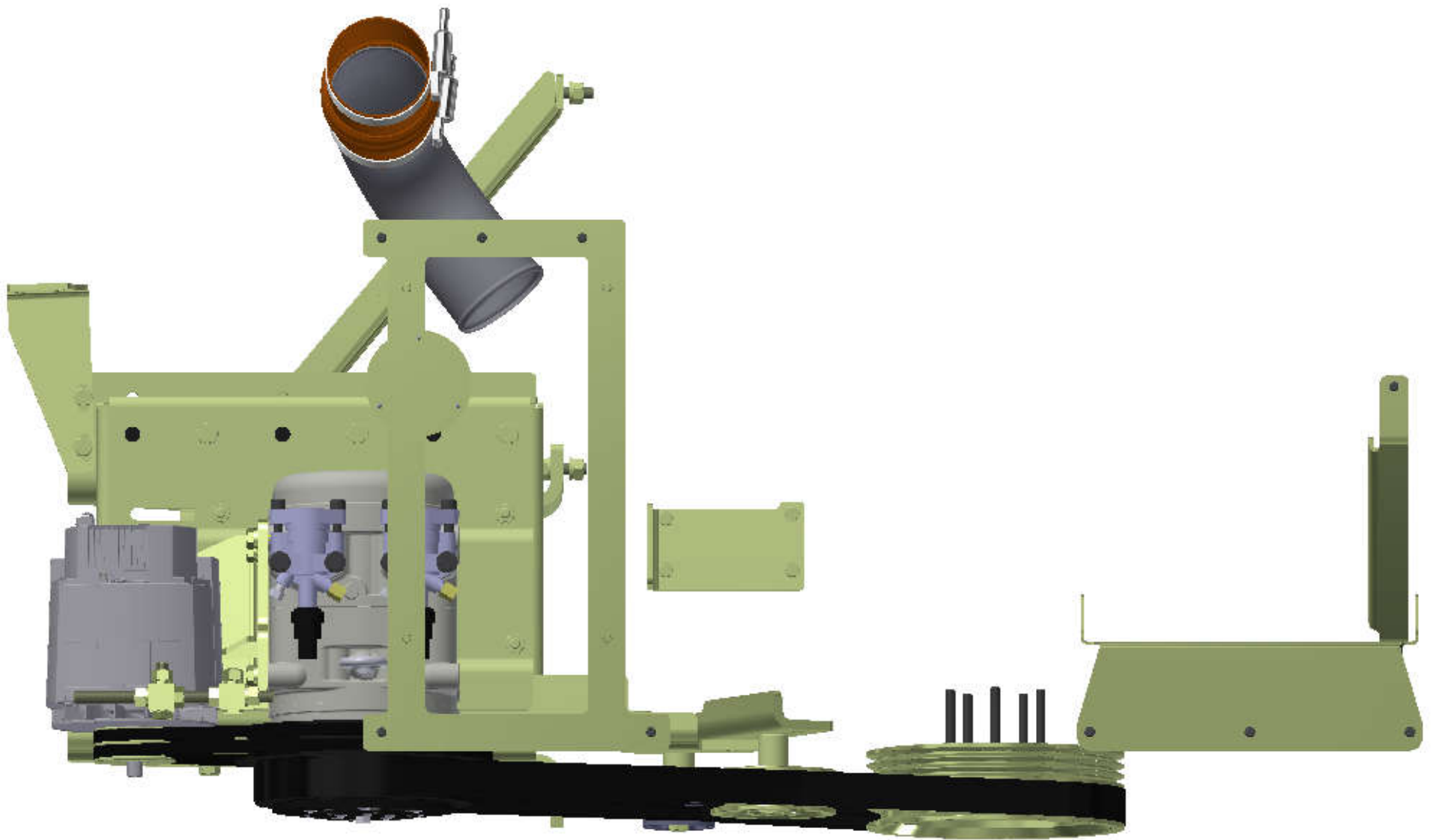

TransArctic A/C Compressor Mount Installation Disclaimer

All compressor mounts should be installed by qualified and trained personnel using proper tools and equipment in safe working conditions following industry standard guidelines for motor vehicle service and repair.

The installer of any compressor mount purchased from TransArctic must undertake all responsibility of issues arising from that compressor bracket being installed on any vehicle. As well as insure that a **proper and sufficient ground** is established between the compressors' clutches and the vehicle's engine. Mount functionality, operation and durability can all be compromised by an incompetent installation.

Due to the many different situations, parameters and application criteria, which are beyond the compressor mount manufacturer's control, TransArctic does not warrant design, durability, or operational functionality of any compressor mount improperly installed by another party.

With no implied guarantees it is the mount installer's strict responsibility to determine safety and functionality, of the compressor mount, at the time of installation.

Please contact TransArctic with any issue arising from installation so we may better improve the product. If you have any reservations about the compressor mount integrity contact TransArctic immediately at 1-877-COLD-AIR.

Mark OEM tensioner location

Install Kit

Check for Interferences

Check to ensure that the proper OEM tensioner orientation is maintained

Run engine with A/C system engaged for at least 10 minutes to run in belt

Check OEM tensioner orientation and adjust as required

Responsabilidad limitada de TransArctic en la instalación del soporte del compresor

Todos los soportes de los compresores deben ser instalados por personas calificadas y entrenadas, usando para ello los equipos y herramientas necesarios para esta labor en buenas condiciones y según las normas y guías para el servicio y/o reparación de motores de vehículos.

El instalador de los soportes comprados en TransArctic asume toda la responsabilidad de cualquier problema que surga en el soporte del compresor al vehículo; de igual manera es responsable que el cable a tierra sea conectado entre el embrague del compresor y el motor del vehículo.

Se advierte que el buen funcionamiento y la durabilidad del soporte pueden ser comprometidos por defectos en su instalación.

Debido a las diversas situaciones que se puedan presentar fuera del control del fabricante, TransArctic no garantiza el diseño, la durabilidad o el correcto funcionamiento de cualquier equipo inapropiadamente instalado por terceros.

Esta sobreentendido que el Instalador del montaje del compresor es estrictamente responsable de la seguridad y funcionamiento del equipo en el momento de la instalación.

Si tuviera algún problema o duda acerca de la instalación del soporte del compresor pongase en contacto inmediatamente con TransArctic al teléfono 1-877-COLD-AIR de modo que podamos mejorar nuestro producto.

Note la ubicación del medidor de tensión OEM

Instale el equipo

Controlar si hay interferencias.

Asegure que el medidor de tensión mantenga la orientación justa.

Encienda el motor por lo menos 10 minutos con el sistema A/C enganchado para que la correa corra

Controle la orientación justa del medidor de tensión y ajuste a las condiciones requeridas del fabricante