

Bill of Materials Listing

TransArctic Canada Inc.

11/25/2011
Page 1 of 1

Product Number	Description	Date	Weight	Uof M	Yield
Line Component Prod# Description	Bin	Unit	Qty		
KMC64161	Mt Kit, ISB, BBRE, O5G, 2B, 8" Cr, '07	12/5/2007	218.96		0
5 BEL32592	Belt, Banded B, 2591mm (102") (RBX99-2)	each	1		
10 KBB64161	Mt Kit, Base, Transit, BBRE, '07	each	1		
20 KGT84161	Mt Kit, Transit, O5G, '07	each	1		
30 KPC64161	Kit, Pulley, ISB, A3RE, '07	each	1		
40 KAC64161	Alt. Kit, 24V, ISB, BBRE, '07	each	1		

Bill of Materials Listing

TransArctic Canada Inc.

11/24/2011
Page 1 of 1

Product Number	Description	Date	Weight	Uof M	Yield
Line Component Prod#	Description	Bin Unit	Qty		
KBB64161	Mt Kit, Base, Transit, BBRE, '07	8/31/2007	159.41		0
20 BMC83019	Bkt, Gusset, Bumper, ISC, BBRE, '07	each	1		
30 BMC83020	Bkt, Dampner, ISC, BBRE, '07	each	1		
40 BMC83021	Bkt, Comp, Frt, ISC, BBRE, '07	each	1		
50 BMC83022	Bkt, Comp, Rear, ISC, BBRE, '07	each	1		
60 BMC83023	Bkt, Gusset, Idler, ISC, BBRE, '07	each	1		
70 BMC83043	Bkt, Main, Idler, ISB, BBRE, '07	each	1		
80 BMC83026	Bkt, Sprt, Bump, Rear, ISC, BBRE, '07	each	1		
90 BMC83027	Bkt, Sprt, Bump, Side, ISC, BBRE, '07	each	1		
100 BMC83028	Bkt, Tray, ISC, BBRE, '07	each	1		
110 BMC83029	Bkt, Shift, Tank, Weldmt, ISC, BBRE, '07	each	1		
115 BMC83031	Bkt, Slide, Block, Idler, BBRE	each	1		
120 BMN80008	Vibration Isolator, Bar,16.50 x 2 x 1.50	each	2		
130 BMN80009	Bkt, Main, Base Pl, IC, RE300	each	1		
160 BMN80025	Bkt, Back, PL, Slide, IC, RE300	each	1		
170 PUA06001	Pulley, Assy, Idler, B/S, 6", Stl, Plt	each	1		
180 PUA05012	Pulley, Assy, Idler,B/BX gr,5", STL,Plt	each	1		
220 SCD32812	Spacer, Step, Drl,32.8mm x 50.8o x 12.3i	each	1		
225 SPC19010	Spacer, Col, Drl, 19mm x 28.58o x 10.32i	each	2		
240 SCD48012	Spacer, Col, Drl,48 mm x 34.9o x 12.3i	each	1		
250 SLV17012	Sleeve, Pulley, 16.9o x 22.23mm x 12.32i	each	2		
280 KBT84161	Bag Kit, Fasteners, KBB84161	each	1		

Bill of Materials Listing

TransArctic Canada Inc.

11/9/2011
Page 1 of 1

Product Number		Description	Bin	Date	Weight	Uof M	Yield
Line	Component Prod#	Description		Unit	Qty		
KBT84161		Bag Kit, Fasteners, KBB84161		8/29/2007	5.37		0
10	BTC08020	Bolt, Hex, 8 x 1.25 x 20mm, 10.9, Plt		each	2		
20	BTC08035	Bolt, Hex, 8 x 1.25 x 35mm, 10.9, Plt,FT		each	1		
50	BTC12040	Bolt, Hex, 12 x 1.75 x 40mm, 10.9,Plt,FT		each	10		
60	BTC12050	Bolt, Hex, 12 x 1.75 x 50mm, 10.9,Plt		each	1		
70	BTC12060	Bolt, Hex, 12 x 1.75 x 60mm, 10.9,Plt,FT		each	1		
100	BTC12100	Bolt, Hex, 12 x 1.75 x 100mm, 10.9, Plt		each	2		
105	BTP08653	Bolt, Hex, 1/2-13unc, 6.5", 5, Plt, FT		each	1		
115	BTQ06200	Bolt, Hex, 3/8-16unc, 2.0", 8, Plt		each	2		
120	BTQ08126	Bolt, Hex, 1/2-20unf, 1.25", 8, Plt		each	12		
135	BTQ08200	Bolt, Hex, 1/2-13unc, 2.0", 8, Plt		each	3		
160	CSF06075	Capscrew, FH, 3/8-16 x .75", Alloy, Plt		each	2		
170	NTA08000	Nut, Hex, 8 x 1.25, 8.8, Plt		each	3		
190	NTA12000	Nut, Hex, 12 x 1.75, 8.8, Plt		each	13		
200	NTP06000	Nut, Hex, 3/8-16unc, 5, Plt		each	2		
230	WFA08000	Washer, Flat, 8mm, 8.8, Plt		each	4		
250	WFA12000	Washer, Flat, 12mm, 8.8, Plt		each	24		
270	WFQ08000	Washer, Flat, 1/2", 8, Plt		each	15		
280	WLA08000	Washer, Lock, 8mm, 8.8, Plt		each	3		
300	WLA12000	Washer, Lock, 12mm, 8.8, Plt		each	14		
330	WLQ08000	Washer, Lock, 1/2", 8, Plt		each	13		

Bill of Materials Listing

TransArctic Canada Inc.

11/23/2011
Page 1 of 1

Product Number	Description	Date	Weight	Uof M	Yield
Line Component Prod# Description	Bin	Unit	Qty		
KGT84161	Mt Kit, Transit, O5G, '07	10/19/2007	10.76		0
10 BMN80010	Bkt, Main, Slide, Assy, O5G, IC, RE300	each	1		
20 BMN80024	Bkt, Comp, FRT, Z, IC, RE300	each	1		
30 SCD29213	Spacer, Col, Drl, 29.21mm x 25.4o x 12.7i	each	2		
40 BTQ06150	Bolt, Hex, 3/8-16unc, 1.50", 8, Plt	each	2		
50 NTP07000	Nut, Hex, 7/16-14unc, 5, Plt	each	4		
60 WFN06000	Washer, Flat, 3/8", 2, Plt	each	2		
70 WLP07000	Washer, Lock, 7/16", 5, Plt	each	4		
80 WLP06000	Washer, Lock, 3/8", 5, Plt	each	2		

Bill of Materials Listing

TransArctic Canada Inc.

11/25/2011

Page 1 of 1

Product Number		Description	Bin	Date	Weight	Uof M	Yield
Line	Component Prod#	Description		Unit	Qty		
KPC64161		Kit, Pulley, ISB, A3RE, '07		5/13/2008	14.32		0
10	PUL67222	Pulley, Crank, ADD-ON, ISB,6.7L,2B/X,'07		each	1		
20	CSS12090	Capscrew, SH, 12 x 1.25 x 90mm, 12.9,BLK		each	6		
30	WFS12002	Washer, Flat, Hdn, 12mm, Stl, BLK		each	6		

Bill of Materials Listing

TransArctic Canada Inc.

11/25/2011
Page 1 of 1

Product Number	Description	Date	Weight	Uof M	Yield
Line Component Prod# Description	Bin	Unit	Qty		
KAC64161	Alt. Kit, 24V, ISB, BBRE, '07	4/21/2008	33.17		0
10 BEL81104	Belt, 8gr, 1104mm (43.5") (5080435)	each	1		
20 BMC67016	Bkt, Main, ALT, Weldm't, ISB, 08	each	1		
30 BMC67030	Bkt, Tenr Arm, ALT	each	1		
40 PUL80064	Pulley,ALT,Frontside,P8,63.5d (3972808)	each	1		
50 PUL80076	Pulley, Idler, Backside, P8, 76d (89062)	each	1		
60 PUL83008	Pulley, Fan, Add-on, Cum, ISC, 8.3, 8gr	each	1		
70 SCD09010	Spacer, Col, Drl, 9mm x 25.4o x10.32i	each	1		
80 SLV17010	Sleeve, Pulley, 16.9o x 22.23mm x 10.32i	each	1		
90 TEN00002	Tenr, Spring, Un-Direct, 90d, 3/8 x 4.5"/3.5"	each	1		
100 PNS04012	Pin, Spring, 1/4" d x 3/4" lg, ST, PLT	each	1		
110 KBA64161	Bag Kit, Fasteners, KAC64161	each	1		

TEN00002 to be set-up as CW rotation @ 4.5" CTL base to CTL pulley.

Bill of Materials Listing

TransArctic Canada Inc.

11/25/2011
Page 1 of 1

Product Number	Description	Date	Weight	Uof M	Yield
Line Component Prod#	Description	Bin Unit	Qty		
KBA64161	Bag Kit, Fasteners, KAC64161		4/21/2008	1.53	0
10	BTC10055	Bolt, Hex, 10 x 1.5 x 55mm, 10.9, Plt,FT	each	1	
20	BTC10100	Bolt, Hex, 10 x 1.5 x 100mm, 10.9,Plt,FT	each	3	
30	BTC10030	Bolt, Hex, 10 x 1.5 x 30mm, 10.9, Plt	each	1	
40	CSF06250	Capscrew, FH, 3/8-16 x 2.5", Alloy, Plt	each	1	
50	BTQ08653	Bolt, Hex, 1/2-13unc, 6.5", 8, Plt	each	1	
60	BTQ08150	Bolt, Hex, 1/2-13unc, 1.5", 8, Plt	each	2	
70	NTA10000	Nut, Hex, 10 x 1.5, 8.8, Plt	each	1	
80	NTP08000	Nut, Hex, 1/2-13unc, 5, Plt	each	1	
90	WFA10000	Washer, Flat, 10mm, 8.8, Plt	each	5	
100	WFQ08000	Washer, Flat, 1/2", 8, Plt	each	4	
110	WLA10000	Washer, Lock, 10mm, 8.8, Plt	each	5	
120	WLQ08000	Washer, Lock, 1/2", 8, Plt	each	3	

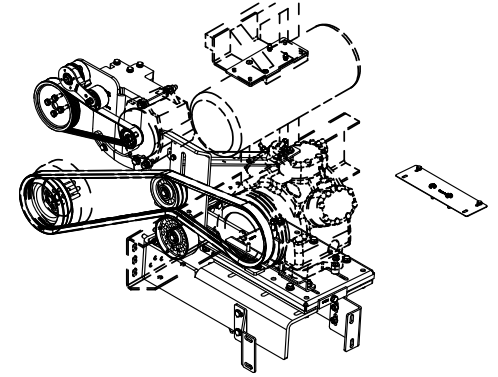
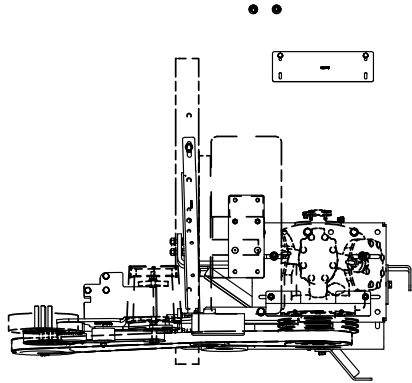

ISOMETRIC VIEW

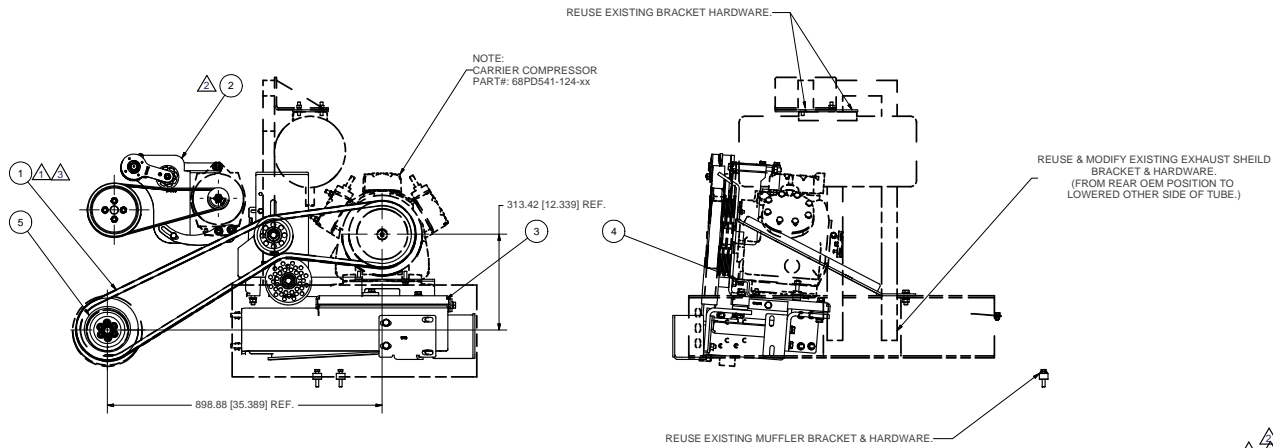

NOTES:
 1) USE SERVICABLE THREADLOCKER ON ALL FASTENERS TO ENGINE COMPONENTS AND TORQUE ALL BOLTS TO S.A.E. SPECIFICATIONS.
 2) SEE "TRANSARCTIC A/C COMPRESSOR MOUNT INSTALLATION DISCLAIMER".

ITEM	QTY	U/M	PART NUMBER	DESCRIPTION
5	1	EACH	KPC64161	KIT, PULLEY, ISB, BBRE, 07
4	1	EACH	KG784161	MT KIT, TRANSIT, O5G, 07
3	1	EACH	KGB64161	MT KIT, BASE, TRANSIT, BBRE, 07
2	1	EACH	KAC64161	ALT. KIT, 24V, ISB, BBRE, 07
1	1	EACH	BEL32592	BELT, BANDED B, 2591MM (102") (RBX99-2)

Parts List

DRAWN	Jose Rodriguez	10/22/2008	TRANSARCTIC INC.
CHECKED	Vaj Jakowlew	10/22/2008	
DATE:	James Stewart	10/22/2008	
BY:	Ron Ingram	10/22/2008	
APPROVED	Dale Mason	10/22/2008	MT KIT, ISB, BBRE, O5G, 2B, 8" CRANK, 07

THIS DRAWING CONTAINS PROPRIETARY CONFIDENTIAL INFORMATION OWNED BY TRANSARCTIC CANADA INC. THE DOCUMENT AND THE INFORMATION IN IT ARE NOT TO BE USED, DISCLOSED OR REPRODUCED WITHOUT EXPRESS WRITTEN PERMISSION OF THE COMPANY.

UNSPECIFIED TOLERANCES:	ALL DIM.	MM
ONE DECIMAL PLACE (X1)	±0.10	FRACTIONAL
TWO DECIMAL PLACE (X2)	±0.02	ANGULAR
THREE DECIMAL PLACE (X3)	±0.002	

THIRD ANGLE PROJECTION

DRAWING UNIT OF MEASURE	MM (INCH)
SCALE	1:1
SHEET	1 OF 1

3	REVISED KBB4161 WAS BEL22091	11/30/2011	VJL
2	REVISED P/N# KAC64161	11/06/04	JRR
1	ADDED P/N# BEL2592	07/12/08	JRR
0	RELEASED TO PRODUCTION	10/20/08	JRR

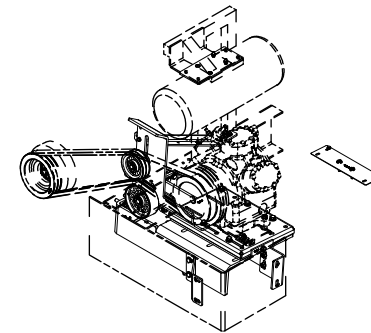
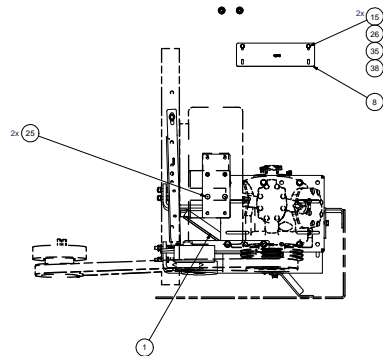

ISOMETRIC VIEW

- NOTES:
- 1) USE SERVICABLE THREADLOCKER ON ALL FASTENERS TO ENGINE COMPONENTS AND TORQUE ALL BOLTS TO S.A.E. SPECIFICATION.
 - 2) SEE "TRANSARCTIC A/C COMPRESSOR MOUNT INSTALLATION DISCLAIMER".
 - 3) WEIGHT: 155.00 LB

ITEM	QTY	UOM	PART NUMBER	DESCRIPTION
40	13	EACH	WLO08000	WASHER, LOCK, 1/2", 8, PLT
39	14	EACH	WLA12000	WASHER, LOCK, 12mm, 8, 8, PLT
38	3	EACH	WLO08000	WASHER, LOCK, 8mm, 8, 8, PLT
37	15	EACH	WFO08000	WASHER, FLAT, 1/2", 8, PLT
36	20	EACH	WFA12000	WASHER, FLAT, 12mm, 8, 8, PLT
35	4	EACH	WFO08000	WASHER, FLAT, 8mm, 8, 8, PLT
34	2	EACH	SPL19010	SPACER, COL, DBL, 19.05mm x 25.4 x 10.57
33	2	EACH	SLV17012	SLEEVE, PULLEY, 16.9 x 22.23 mm x 12.19
32	1	EACH	SCD48012	SPACER, COL, DBL, 48mm x 31.8mm x 12.0
31	1	EACH	SCD12812	SPACER, COL, DBL, 32.8mm x 50.8 x 12.3
30	1	EACH	PLA06001	PULLEY, ASSY, IDLER, B/S, 6", STL, PLT
29	1	EACH	PLA05012	PULLEY, ASSY, IDLER, B/BK, 6", 5" STL, PLT
28	2	EACH	WTP06000	NUT, HEX, 3/8-16UNC, 5, PLT
27	13	EACH	NTA12000	NUT, HEX, 1/2 x 1.75, 8, 8, PLT
26	3	EACH	NTA08000	NUT, HEX, 8 x 1.25, 8, 8, PLT
25	2	EACH	CSF06015	CARBIDE, FH, 3/8 x 1.5 x .75, 9, PLT
24	3	EACH	BTQ08200	BOLT, HEX, 1/2-13UNC x 2.00, 8, PLT
23	12	EACH	BTQ08126	BOLT, HEX, 1/2-20UNC x 1.25, 8, PLT
22	2	EACH	BTQ06000	BOLT, HEX, 3/8-16UNC, 1.00, 8, PLT
21	1	EACH	BTQ08653	BOLT, HEX, 1/2-13UNC x 6.50, 5, PLT, FT
20	2	EACH	BTQ12100	BOLT, HEX, 1/2 x 1.75 x 100mm, 10.9, PLT
19	1	EACH	BTQ12040	BOLT, HEX, 12 x 1.75 x 40mm, 10.9, PLT
18	1	EACH	BTQ12050	BOLT, HEX, 12 x 1.75 x 50mm, 10.9, PLT
17	10	EACH	BTQ12040	BOLT, HEX, 12 x 1.75 x 40mm, 10.9, PLT
16	1	EACH	BTQ08015	BOLT, HEX, 8 x 1.25 x 35mm, 10.9, PLT
15	2	EACH	BTQ08020	BOLT, HEX, 8 x 1.25 x 20mm, 10.9, PLT
14	1	EACH	BMN80025	BKT, BACK, PL, SLIDE, IC, RE 300
13	1	EACH	BMN80009	BKT, MAIN, BACK, PL, IC, HE 300
12	2	EACH	BMN80008	VIBRATION ISOLATOR, BAR, 16.50 x 2 x 1.50
11	1	EACH	BMC83043	BKT, MAIN, IDLER, ISB, BBRE, '07
10	1	EACH	BMC83031	BKT, SLIDE, BLOCK, IDLER, BBRE, '07
9	1	EACH	BMC83029	BKT, SHIFT, TANK, WELDMT, ISC, BBRE, '07
8	1	EACH	BMC83028	BKT, TRAY, ISC, BBRE, '07
7	1	EACH	BMC83027	BKT, SPRAY, BUMP, SIDE, ISC, BBRE, '07
6	1	EACH	BMC83026	BKT, SPRAY, BUMP, REAR, ISC, BBRE, '07
5	1	EACH	BMC83023	BKT, GUSSET, IDLER, ISC, BBRE, '07
4	1	EACH	BMC83022	BKT, COMP, REAR, ISC, BBRE, '07
3	1	EACH	BMC83021	BKT, COMP, FRT, ISC, BBRE, '07
2	1	EACH	BMC83020	BKT, DAMPNER, ISC, BBRE, '07
1	1	EACH	BMC83019	BKT, GUSSET, BUMPER, ISC, BBRE, '07

REV	DATE	DESCRIPTION	BY	CHK
1	3/17/2009	ISSUE FOR PRODUCTION	DA	DA
2	3/17/2009	REVISED TO ADD PARTS	DA	DA
3	3/17/2009	REVISED TO ADD PARTS	DA	DA
4	3/17/2009	REVISED TO ADD PARTS	DA	DA
5	3/17/2009	REVISED TO ADD PARTS	DA	DA
6	3/17/2009	REVISED TO ADD PARTS	DA	DA
7	3/17/2009	REVISED TO ADD PARTS	DA	DA
8	3/17/2009	REVISED TO ADD PARTS	DA	DA
9	3/17/2009	REVISED TO ADD PARTS	DA	DA
10	3/17/2009	REVISED TO ADD PARTS	DA	DA
11	3/17/2009	REVISED TO ADD PARTS	DA	DA
12	3/17/2009	REVISED TO ADD PARTS	DA	DA
13	3/17/2009	REVISED TO ADD PARTS	DA	DA
14	3/17/2009	REVISED TO ADD PARTS	DA	DA
15	3/17/2009	REVISED TO ADD PARTS	DA	DA
16	3/17/2009	REVISED TO ADD PARTS	DA	DA
17	3/17/2009	REVISED TO ADD PARTS	DA	DA
18	3/17/2009	REVISED TO ADD PARTS	DA	DA
19	3/17/2009	REVISED TO ADD PARTS	DA	DA
20	3/17/2009	REVISED TO ADD PARTS	DA	DA
21	3/17/2009	REVISED TO ADD PARTS	DA	DA
22	3/17/2009	REVISED TO ADD PARTS	DA	DA
23	3/17/2009	REVISED TO ADD PARTS	DA	DA
24	3/17/2009	REVISED TO ADD PARTS	DA	DA
25	3/17/2009	REVISED TO ADD PARTS	DA	DA
26	3/17/2009	REVISED TO ADD PARTS	DA	DA
27	3/17/2009	REVISED TO ADD PARTS	DA	DA
28	3/17/2009	REVISED TO ADD PARTS	DA	DA
29	3/17/2009	REVISED TO ADD PARTS	DA	DA
30	3/17/2009	REVISED TO ADD PARTS	DA	DA
31	3/17/2009	REVISED TO ADD PARTS	DA	DA
32	3/17/2009	REVISED TO ADD PARTS	DA	DA
33	3/17/2009	REVISED TO ADD PARTS	DA	DA
34	3/17/2009	REVISED TO ADD PARTS	DA	DA
35	3/17/2009	REVISED TO ADD PARTS	DA	DA
36	3/17/2009	REVISED TO ADD PARTS	DA	DA
37	3/17/2009	REVISED TO ADD PARTS	DA	DA
38	3/17/2009	REVISED TO ADD PARTS	DA	DA
39	3/17/2009	REVISED TO ADD PARTS	DA	DA
40	3/17/2009	REVISED TO ADD PARTS	DA	DA

REV	DATE	DESCRIPTION	BY	CHK
1	3/17/2009	ISSUE FOR PRODUCTION	DA	DA
2	3/17/2009	REVISED TO ADD PARTS	DA	DA
3	3/17/2009	REVISED TO ADD PARTS	DA	DA
4	3/17/2009	REVISED TO ADD PARTS	DA	DA
5	3/17/2009	REVISED TO ADD PARTS	DA	DA
6	3/17/2009	REVISED TO ADD PARTS	DA	DA
7	3/17/2009	REVISED TO ADD PARTS	DA	DA
8	3/17/2009	REVISED TO ADD PARTS	DA	DA
9	3/17/2009	REVISED TO ADD PARTS	DA	DA
10	3/17/2009	REVISED TO ADD PARTS	DA	DA
11	3/17/2009	REVISED TO ADD PARTS	DA	DA
12	3/17/2009	REVISED TO ADD PARTS	DA	DA
13	3/17/2009	REVISED TO ADD PARTS	DA	DA
14	3/17/2009	REVISED TO ADD PARTS	DA	DA
15	3/17/2009	REVISED TO ADD PARTS	DA	DA
16	3/17/2009	REVISED TO ADD PARTS	DA	DA
17	3/17/2009	REVISED TO ADD PARTS	DA	DA
18	3/17/2009	REVISED TO ADD PARTS	DA	DA
19	3/17/2009	REVISED TO ADD PARTS	DA	DA
20	3/17/2009	REVISED TO ADD PARTS	DA	DA
21	3/17/2009	REVISED TO ADD PARTS	DA	DA
22	3/17/2009	REVISED TO ADD PARTS	DA	DA
23	3/17/2009	REVISED TO ADD PARTS	DA	DA
24	3/17/2009	REVISED TO ADD PARTS	DA	DA
25	3/17/2009	REVISED TO ADD PARTS	DA	DA
26	3/17/2009	REVISED TO ADD PARTS	DA	DA
27	3/17/2009	REVISED TO ADD PARTS	DA	DA
28	3/17/2009	REVISED TO ADD PARTS	DA	DA
29	3/17/2009	REVISED TO ADD PARTS	DA	DA
30	3/17/2009	REVISED TO ADD PARTS	DA	DA
31	3/17/2009	REVISED TO ADD PARTS	DA	DA
32	3/17/2009	REVISED TO ADD PARTS	DA	DA
33	3/17/2009	REVISED TO ADD PARTS	DA	DA
34	3/17/2009	REVISED TO ADD PARTS	DA	DA
35	3/17/2009	REVISED TO ADD PARTS	DA	DA
36	3/17/2009	REVISED TO ADD PARTS	DA	DA
37	3/17/2009	REVISED TO ADD PARTS	DA	DA
38	3/17/2009	REVISED TO ADD PARTS	DA	DA
39	3/17/2009	REVISED TO ADD PARTS	DA	DA
40	3/17/2009	REVISED TO ADD PARTS	DA	DA

REV	DATE	DESCRIPTION	BY	CHK
1	3/17/2009	ISSUE FOR PRODUCTION	DA	DA
2	3/17/2009	REVISED TO ADD PARTS	DA	DA
3	3/17/2009	REVISED TO ADD PARTS	DA	DA
4	3/17/2009	REVISED TO ADD PARTS	DA	DA
5	3/17/2009	REVISED TO ADD PARTS	DA	DA
6	3/17/2009	REVISED TO ADD PARTS	DA	DA
7	3/17/2009	REVISED TO ADD PARTS	DA	DA
8	3/17/2009	REVISED TO ADD PARTS	DA	DA
9	3/17/2009	REVISED TO ADD PARTS	DA	DA
10	3/17/2009	REVISED TO ADD PARTS	DA	DA
11	3/17/2009	REVISED TO ADD PARTS	DA	DA
12	3/17/2009	REVISED TO ADD PARTS	DA	DA
13	3/17/2009	REVISED TO ADD PARTS	DA	DA
14	3/17/2009	REVISED TO ADD PARTS	DA	DA
15	3/17/2009	REVISED TO ADD PARTS	DA	DA
16	3/17/2009	REVISED TO ADD PARTS	DA	DA
17	3/17/2009	REVISED TO ADD PARTS	DA	DA
18	3/17/2009	REVISED TO ADD PARTS	DA	DA
19	3/17/2009	REVISED TO ADD PARTS	DA	DA
20	3/17/2009	REVISED TO ADD PARTS	DA	DA
21	3/17/2009	REVISED TO ADD PARTS	DA	DA
22	3/17/2009	REVISED TO ADD PARTS	DA	DA
23	3/17/2009	REVISED TO ADD PARTS	DA	DA
24	3/17/2009	REVISED TO ADD PARTS	DA	DA
25	3/17/2009	REVISED TO ADD PARTS	DA	DA
26	3/17/2009	REVISED TO ADD PARTS	DA	DA
27	3/17/2009	REVISED TO ADD PARTS	DA	DA
28	3/17/2009	REVISED TO ADD PARTS	DA	DA
29	3/17/2009	REVISED TO ADD PARTS	DA	DA
30	3/17/2009	REVISED TO ADD PARTS	DA	DA
31	3/17/2009	REVISED TO ADD PARTS	DA	DA
32	3/17/2009	REVISED TO ADD PARTS	DA	DA
33	3/17/2009	REVISED TO ADD PARTS	DA	DA
34	3/17/2009	REVISED TO ADD PARTS	DA	DA
35	3/17/2009	REVISED TO ADD PARTS	DA	DA
36	3/17/2009	REVISED TO ADD PARTS	DA	DA
37	3/17/2009	REVISED TO ADD PARTS	DA	DA
38	3/17/2009	REVISED TO ADD PARTS	DA	DA
39	3/17/2009	REVISED TO ADD PARTS	DA	DA
40	3/17/2009	REVISED TO ADD PARTS	DA	DA

REV	DATE	DESCRIPTION	BY	CHK
1	3/17/2009	ISSUE FOR PRODUCTION	DA	DA
2	3/17/2009	REVISED TO ADD PARTS	DA	DA
3	3/17/2009	REVISED TO ADD PARTS	DA	DA
4	3/17/2009	REVISED TO ADD PARTS	DA	DA
5	3/17/2009	REVISED TO ADD PARTS	DA	DA
6	3/17/2009	REVISED TO ADD PARTS	DA	DA
7	3/17/2009	REVISED TO ADD PARTS	DA	DA
8	3/17/2009	REVISED TO ADD PARTS	DA	DA
9	3/17/2009	REVISED TO ADD PARTS	DA	DA
10	3/17/2009	REVISED TO ADD PARTS	DA	DA
11	3/17/2009	REVISED TO ADD PARTS	DA	DA
12	3/17/2009	REVISED TO ADD PARTS	DA	DA
13	3/17/2009	REVISED TO ADD PARTS	DA	DA
14	3/17/2009	REVISED TO ADD PARTS	DA	DA
15	3/17/2009	REVISED TO ADD PARTS	DA	DA
16	3/17/2009	REVISED TO ADD PARTS	DA	DA
17	3/17/2009	REVISED TO ADD PARTS	DA	DA
18	3/17/2009	REVISED TO ADD PARTS	DA	DA
19	3/17/2009	REVISED TO ADD PARTS	DA	DA
20	3/17/2009	REVISED TO ADD PARTS	DA	DA
21	3/17/2009	REVISED TO ADD PARTS	DA	DA
22	3/17/2009	REVISED TO ADD PARTS	DA	DA
23	3/17/2009	REVISED TO ADD PARTS	DA	DA
24	3/17/2009	REVISED TO ADD PARTS	DA	DA
25	3/17/2009	REVISED TO ADD PARTS	DA	DA
26	3/17/2009	REVISED TO ADD PARTS	DA	DA
27	3/17/2009	REVISED TO ADD PARTS	DA	DA
28	3/17/2009	REVISED TO ADD PARTS	DA	DA
29	3/17/2009	REVISED TO ADD PARTS	DA	DA
30	3/17/2009	REVISED TO ADD PARTS	DA	DA
31	3/17/2009	REVISED TO ADD PARTS	DA	DA
32	3/17/2009	REVISED TO ADD PARTS	DA	DA
33	3/17/2009	REVISED TO ADD PARTS	DA	DA
34	3/17/2009	REVISED TO ADD PARTS	DA	DA
35	3/17/2009	REVISED TO ADD PARTS	DA	DA
36	3/17/2009	REVISED TO ADD PARTS	DA	DA
37	3/17/2009	REVISED TO ADD PARTS	DA	DA
38	3/17/2009	REVISED TO ADD PARTS	DA	DA
39	3/17/2009	REVISED TO ADD PARTS	DA	DA
40	3/17/2009	REVISED TO ADD PARTS	DA	DA

REV	DATE	DESCRIPTION	BY	CHK
1	3/17/2009	ISSUE FOR PRODUCTION	DA	DA
2	3/17/2009	REVISED TO ADD PARTS	DA	DA
3</				

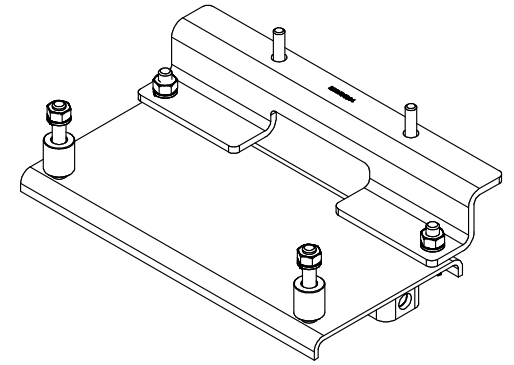
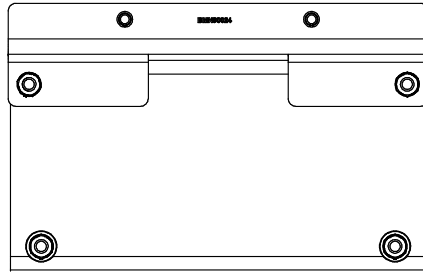

ISOMETRIC VIEW

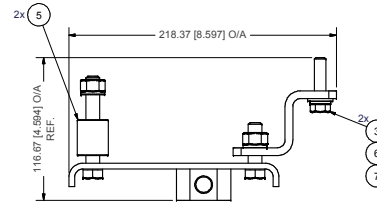
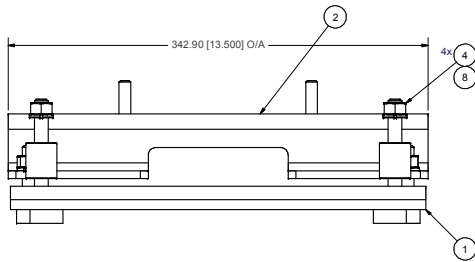

- NOTES:
- 1) USE SERVICABLE THREADLOCKER ON ALL FASTENERS TO ENGINE COMPONENTS AND TORQUE ALL BOLTS TO S.A.E. SPECIFICATIONS.
 - 2) SEE "TRANSARCTIC A/C COMPRESSOR MOUNT INSTALLATION DISCLAIMER".
 - 3) WEIGHT: 10.67 LB

ITEM	QTY	U/M	PART NUMBER	DESCRIPTION
8	4	EACH	WLP07000	WASHER, LOCK, 7/16", 5, PLT
7	2	EACH	WLP06000	WASHER, LOCK, 3/8", 5, PLT
6	2	EACH	WFN06000	WASHER, FLAT, 3/8", 2, PLT
5	2	EACH	SCD29213	SPACER, COL, DRL, 29.21mm x 25.4o x 12.7l
4	4	EACH	NTP07000	NUT, HEX, 7/16-14UNC, 5, PLT
3	2	EACH	BTQ06150	BOLT, HEX, 3/8-18UNC, 1.50", 8, PLT
2	1	EACH	BMN80024	BKT, COMP, FRT, Z, IC, RE300
1	1	EACH	BMN80010	BKT, MAIN, SLIDE, ASSY, IC, RE300

Parts List

DRAWN	Jose Rodriguez	10/21/2008	TRANSARCTIC INC.
CHECKED	Val Jakowlew	10/21/2008	

RELEASED TO PRODUCTION	10/20/2008	BRK		
REV	ECN	DESCRIPTION	DATE	BY
		1) G	10/21/2008	James Stewart
		2) G	10/21/2008	Ron Ingram
		APPROVED	10/21/2008	Dale Mason

TITLE		MT, KIT, TRANSIT, O5G, '07	
SIZE	D	DWG NO	KGT84161
DRAWING UNIT OF MEASURE	MM (INCH)	SCALE	1 : 2
SHEET	1	OF	1

UNSPECIFIED TOLERANCES: (ALL DIM)
 DIM DECIMAL PLACE (10) .0125
 DIM FRACTIONAL PLACE (1/32) .0156
 DIM FRACTIONAL (1/32) .0156



THIRD ANGLE PROJECTION

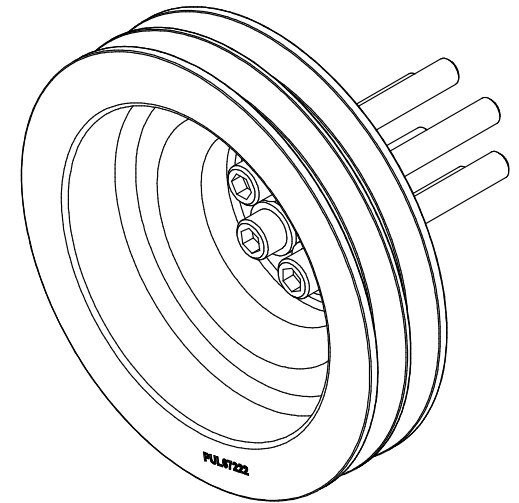
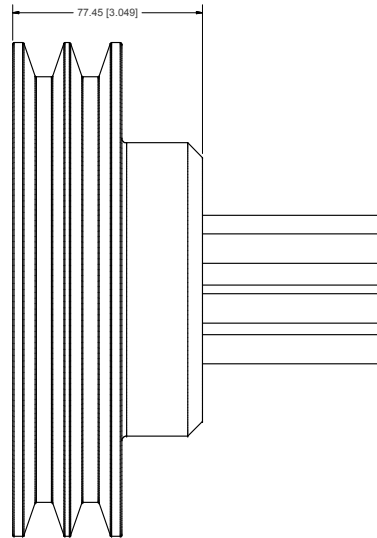
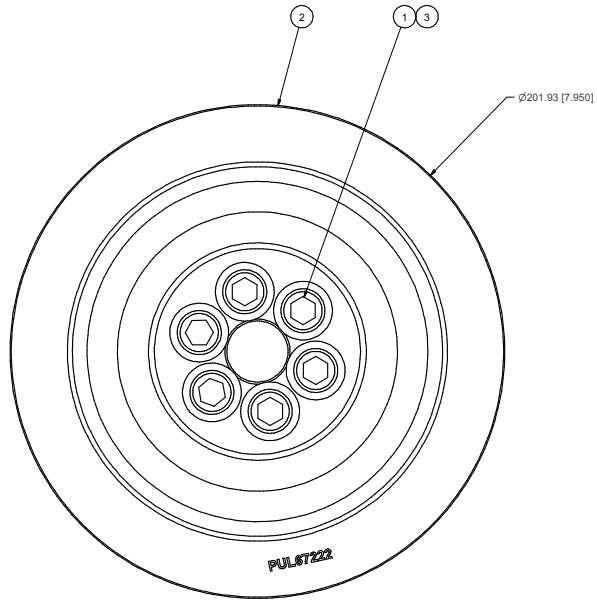
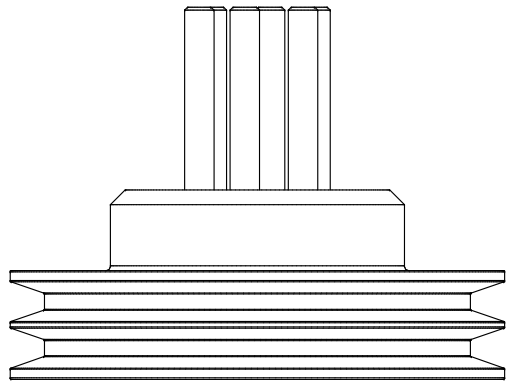

ISOMETRIC VIEW

NOTES:

- 1) USE SERVICABLE THREADLOCKER ON ALL FASTENERS TO ENGINE COMPONENTS AND TORQUE **ALL** BOLTS TO S.A.E. SPECIFICATIONS.
- 2) SEE "TRANSARC TIC A/C COMPRESSOR MOUNT INSTALLATION DISCLAIMER".
- 3) WEIGHT: 13.24 LB

ITEM	QTY	U/M	PART NUMBER	DESCRIPTION
3	6	EACH	WFS12002	WASHER, FLAT, HDN, 12mm, STL, BLK
2	1	EACH	PUL67222	PULLEY, CRANK, ADD-ON, ISB, 6.7L, 2B/X, '07
1	6	EACH	CSS12090	CAPSCREW, SH, 12 x 1.25 x 90mm, 12.9, PLT

BILL OF MATERIALS

DRAWN	Jose Rodriguez	10/21/2008	TITLE
CHECKED	James Stewart	10/21/2008	DATE
BY	James Stewart	10/21/2008	DATE
DATE	10/21/2008	DATE	DATE
DATE	10/21/2008	DATE	DATE
DATE	10/21/2008	DATE	DATE



KIT, PULLEY, ISB, BBRE, '07

UNSPECIFIED TOLERANCES:	(ALL DIM)	GROUP	THIRD ANGLE PROJECTION	DWG NO	REV
ONE DECIMAL PLACE (10)	AS SHOWN	AS SHOWN	THIRD ANGLE PROJECTION	KPC64161	0
TWO DECIMAL PLACE (20)	AS SHOWN	AS SHOWN	THIRD ANGLE PROJECTION		
FRACTIONAL (1/32)	AS SHOWN	AS SHOWN	THIRD ANGLE PROJECTION		
DRAWING UNIT OF MEASURE	MM (INCH)	SCALE	1:1	SHEET	1 OF 1

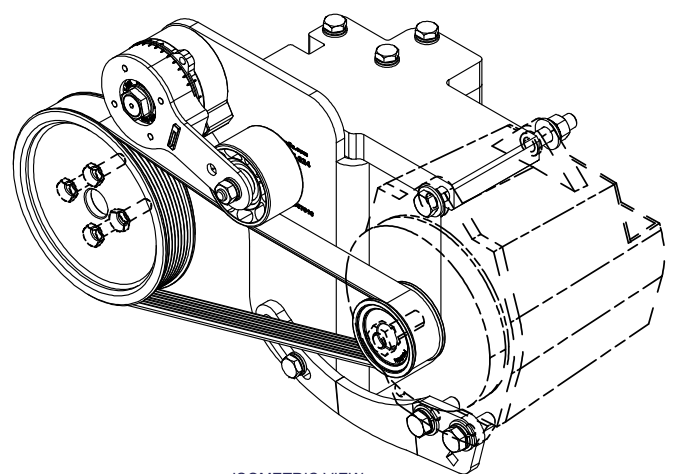
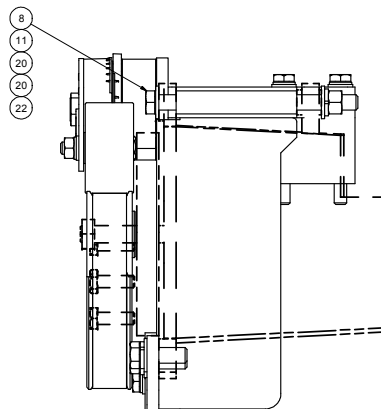
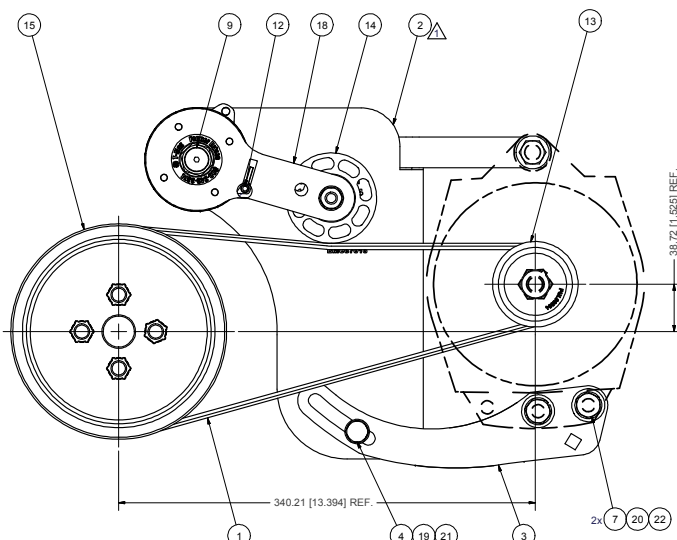
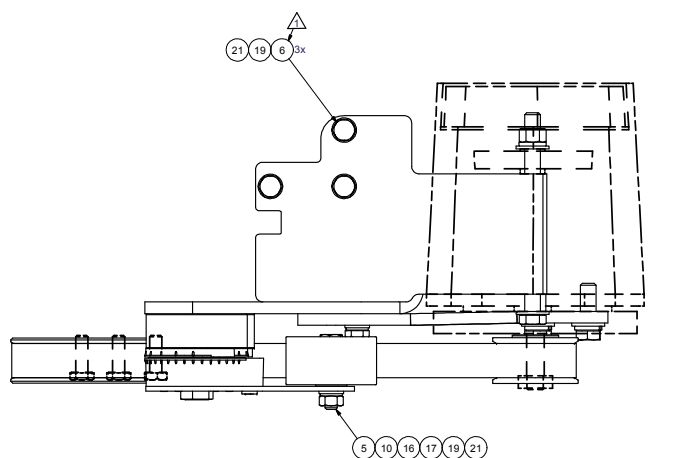

ISOMETRIC VIEW

- NOTES:
- 1) USE SERVICABLE THREADLOCKER ON ALL FASTENERS TO ENGINE COMPONENTS AND TORQUE ALL BOLTS TO S.A.E. SPECIFICATIONS.
 - 2) SEE "TRANSARGTIC A/C COMPRESSOR MOUNT INSTALLATION DISCLAIMER".
 - 3) WEIGHT: 13.00 LB

ITEM	QTY	U/M	PART NUMBER	DESCRIPTION
22	3	EACH	WLQ08000	WASHER, LOCK, 1/2", 8, PLT
21	5	EACH	WLA10000	WASHER, LOCK, 10mm, 8.8, PLT
20	4	EACH	WFO08000	WASHER, FLAT, 1/2", 8, PLT
19	5	EACH	WFA10000	WASHER, FLAT, 10mm, 8.8, PLT
18	1	EACH	TEN00002	TENR. SPRING, UN-DIRECT, 90D, 3/8 X 3.5"
17	1	EACH	SLV17010	SLEEVE, PULLEY, 16.9x x 22.23mm x 10.32l
16	1	EACH	SCD09010	SPACER, COL, DR_L, 9mm x 25.4x 10.32l
15	1	EACH	PUL83008	PULLEY, FAN, ADD-ON, CUM, ISC, 8.3, 8gr
14	1	EACH	PUL80076	PULLEY, IDLER, BACKSIDE, P8, 76D, 39W
13	1	EACH	PUL80064	PULLEY, ALT, FRONTSIDE, P8, 63.5d (3972808)
12	1	EACH	PNV04012	PIN, SPRING, 1/4" D x 3/4" L
11	1	EACH	NTP08000	NUT, HEX, 1/2-13UNC, 5, PLT
10	1	EACH	NTA10000	NUT, HEX, 10 x 1.5, 8.8, PLT
9	1	EACH	CSF06250	CAPSCREW, FH, 3/8-16 x 2.5", 9, PLT
8	1	EACH	BTQ08653	BOLT, HEX, 1/2-13UNC x 6.50, 8, PLT
7	2	EACH	BTQ08150	BOLT, HEX, 1/2-13UNC x 1.50, 8, PLT
6	3	EACH	BTC10100	BOLT, HEX, 10 x 1.5 x 100mm, 10.9, PLT
5	1	EACH	BTC10055	BOLT, HEX, 10 x 1.5 x 55mm, 10.9, PLT
4	1	EACH	BTC10030	BOLT, HEX, 10 x 1.5 x 30mm, 10.9, PLT
3	1	EACH	BMC67030	BKT, TENR, ARM, ALT
2	1	EACH	BMC67016	Bkt, Main, ALT, Weldmt, ISB, 08
1	1	EACH	BEL81104	Belt, 8gr, 1104mm (43.5") (S080435)

BILL OF MATERIALS					
DRAWN	Jose Rodriguez	10/1/2008	TRANSARGTIC INC.		
CHECKED	Val Jakowlew	10/1/2008			
REV	ECN	DESCRIPTION	DATE	BY	TITLE
1		REVISED BMC67016 WAS BTC10042	10/1/2008	JRK	
0		RELEASED FOR PRODUCTION	10/1/2008	JRK	
1		REVISED	10/1/2008	JRK	
1		DESCRIPTION	DATE	BY	TITLE
1		Alt. Kit, 24V, ISB, BBRE, '07	10/1/2008	Ron Ingram	
1		DESCRIPTION	DATE	BY	TITLE
1		Alt. Kit, 24V, ISB, BBRE, '07	10/1/2008	Dale Mason	

UNSPECIFIED TOLERANCES:	(ALL DIM)	GROUP
ONE DECIMAL PLACE (10)	25	FORM
TWO DECIMAL PLACE (100)	50	FORM
FRACTIONAL (1/32)	50	FORM
FRACTIONAL (1/64)	50	FORM



DRAWING UNIT OF MEASURE: MM (INCH) SCALE: 1:2 DWG NO: KAC64161 SHEET 1 OF 1

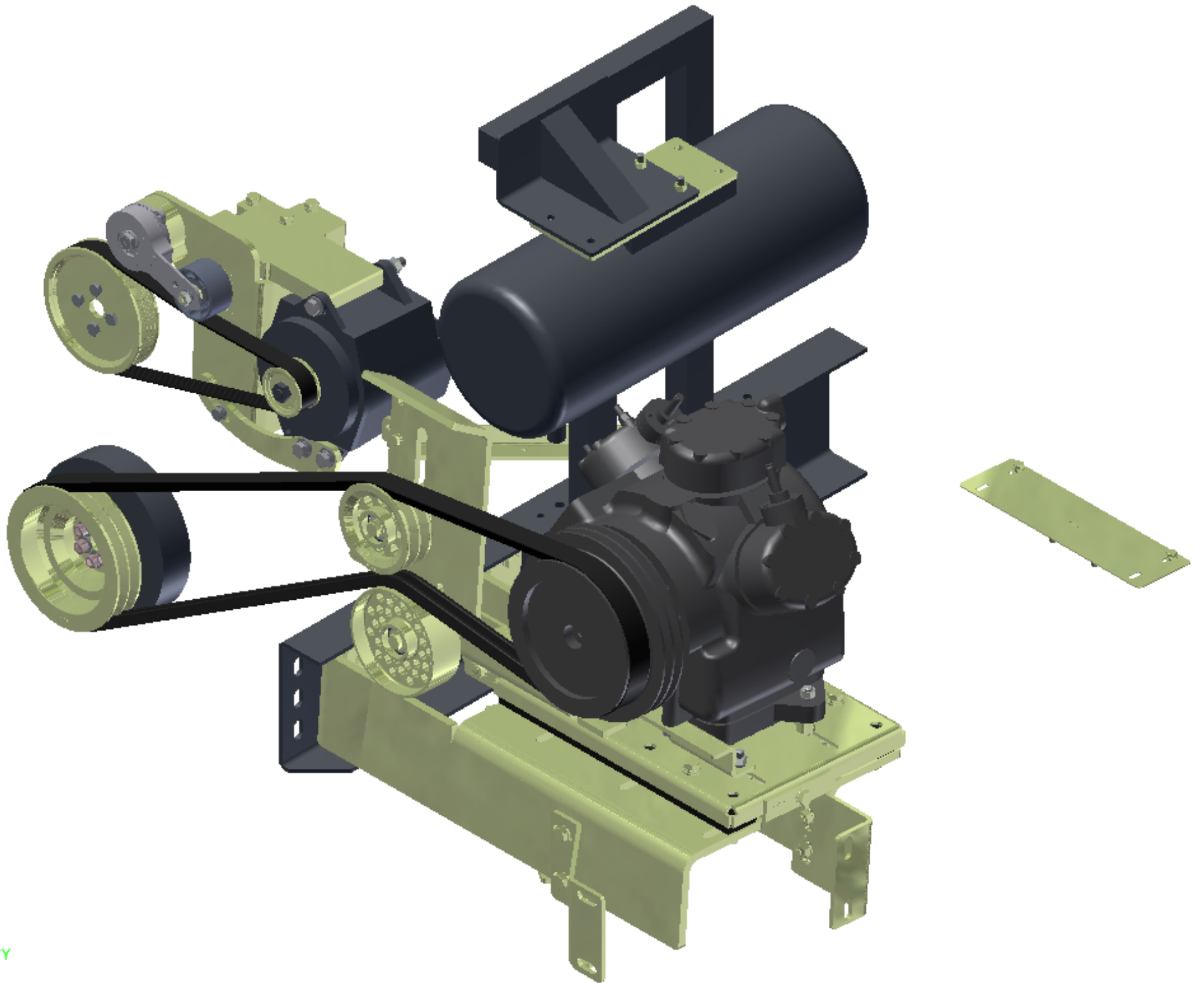

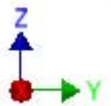
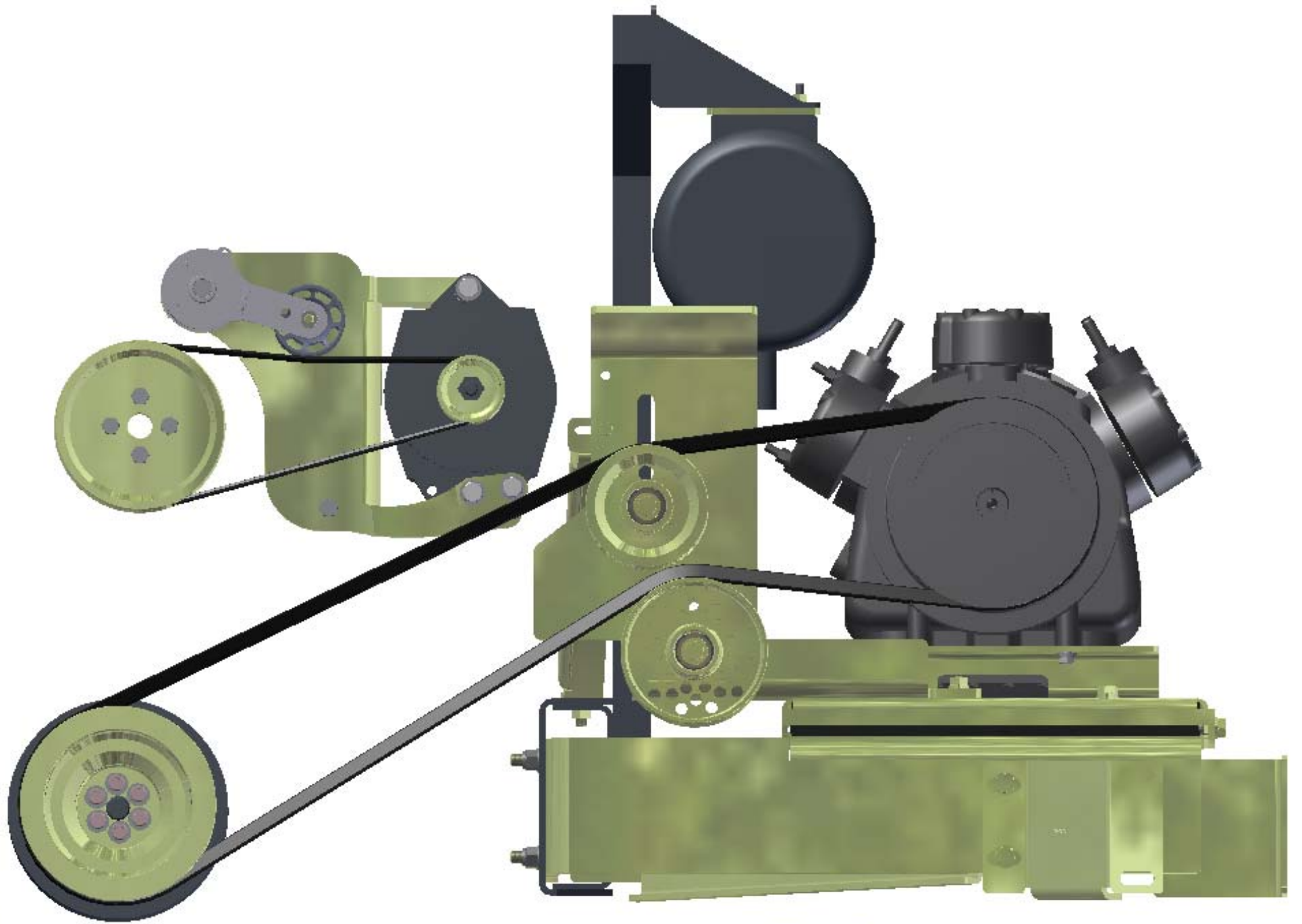

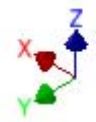
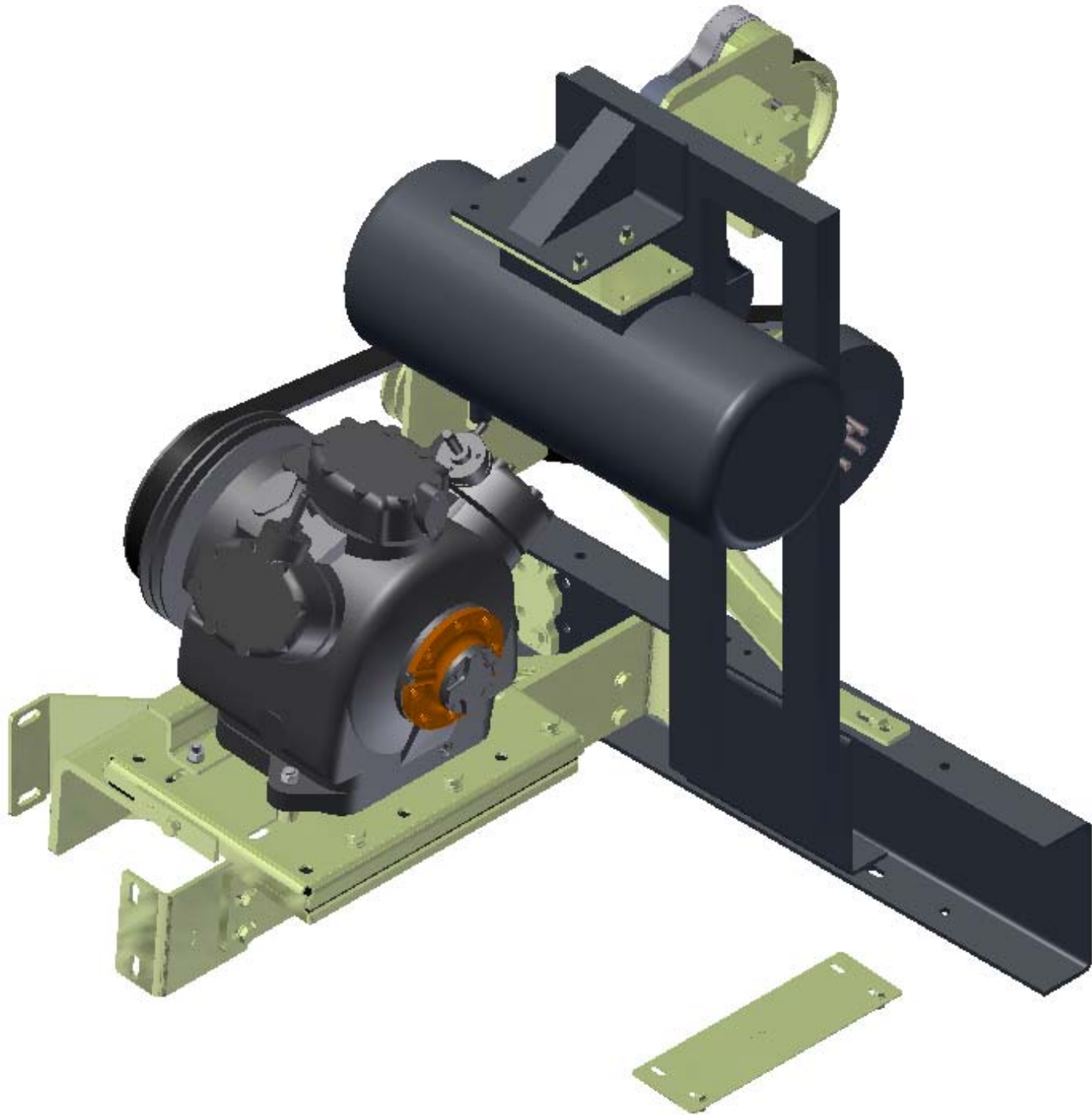

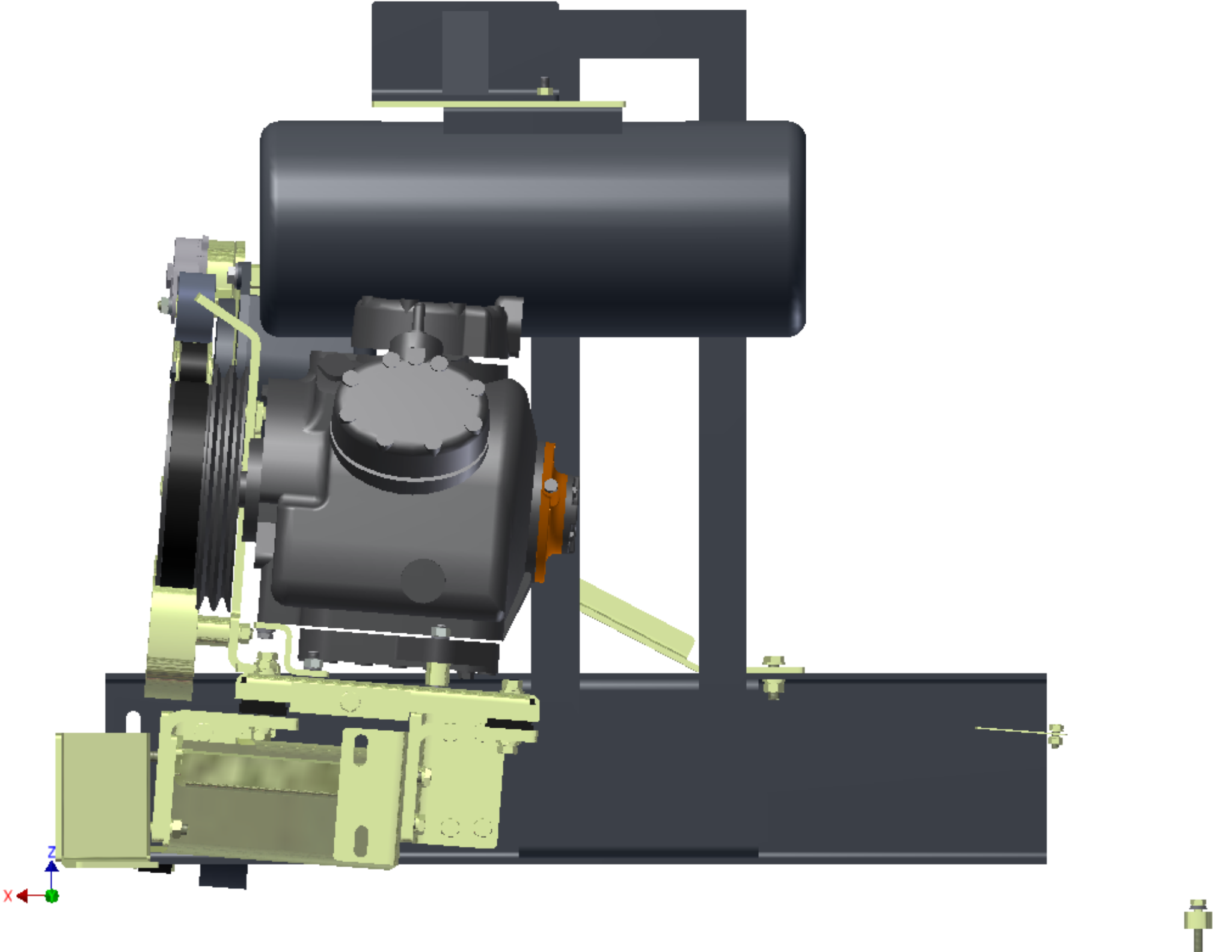

TransArctic A/C Compressor Mount Installation Disclaimer

All compressor mounts should be installed by qualified and trained personnel using proper tools and equipment in safe working conditions following industry standard guidelines for motor vehicle service and repair.

The installer of any compressor mount purchased from TransArctic must undertake all responsibility of issues arising from that compressor bracket being installed on any vehicle. As well as insure that a **proper and sufficient ground** is established between the compressors' clutches and the vehicle's engine. Mount functionality, operation and durability can all be compromised by an incompetent installation.

Due to the many different situations, parameters and application criteria, which are beyond the compressor mount manufacturer's control, TransArctic does not warrant design, durability, or operational functionality of any compressor mount improperly installed by another party.

With no implied guarantees it is the mount installer's strict responsibility to determine safety and functionality, of the compressor mount, at the time of installation.

Please contact TransArctic with any issue arising from installation so we may better improve the product. If you have any reservations about the compressor mount integrity contact TransArctic immediately at 1-877-COLD-AIR.

Mark OEM tensioner location

Install Kit

Check for Interferences

Check to ensure that the proper OEM tensioner orientation is maintained

Run engine with A/C system engaged for at least 10 minutes to run in belt

Check OEM tensioner orientation and adjust as required

Responsabilidad limitada de TransArctic en la instalación del soporte del compresor

Todos los soportes de los compresores deben ser instalados por personas calificadas y entrenadas, usando para ello los equipos y herramientas necesarios para esta labor en buenas condiciones y según las normas y guías para el servicio y/o reparación de motores de vehículos.

El instalador de los soportes comprados en TransArctic asume toda la responsabilidad de cualquier problema que surja en el soporte del compresor al vehículo; de igual manera es responsable que el cable a tierra sea conectado entre el embrague del compresor y el motor del vehículo.

Se advierte que el buen funcionamiento y la durabilidad del soporte pueden ser comprometidos por defectos en su instalación.

Debido a las diversas situaciones que se puedan presentar fuera del control del fabricante, TransArctic no garantiza el diseño, la durabilidad o el correcto funcionamiento de cualquier equipo inapropiadamente instalado por terceros.

Esta sobreentendido que el Instalador del montaje del compresor es estrictamente responsable de la seguridad y funcionamiento del equipo en el momento de la instalación.

Si tuviera algún problema o duda acerca de la instalación del soporte del compresor pongase en contacto inmediatamente con TransArctic al teléfono 1-877-COLD-AIR de modo que podamos mejorar nuestro producto.

Note la ubicación del medidor de tensión OEM

Instale el equipo

Controlar si hay interferencias.

Asegurese que el medidor de tensión mantenga la orientación justa.

Encienda el motor por lo menos 10 minutos con el sistema A/C enganchado para que la correa corra

Controle la orientación justa del medidor de tensión y ajuste a las condiciones requeridas del fabricante