

Bill of Materials Listing

TransArctic Canada Inc.

11/10/2020
Page 1 of 1

Product Number	Date	Description			Uof M	Weight	Yield		
Line	Qty	Component	Prod#	Rev#	Description	Bin	Unit		
KMC66597	4/25/2017			0	Mt Kit, ISB, HDX, TM-55/65, '20			1093.13	0
5	1	PAC39131			Pack, Carton, 39" x 13" x 16.25", 51 BC		each		
10	1	BEL32286			Belt, Banded B gr,2286mm (90")		each		
20	1	BMC90017			2 Bkt, Found'n, TH HDX, 4xFC/ 4K40, '16		each		
30	1	BMC90022			0 Bkt, Main, Idler, Weldm't, ISL, HDX, '16		each		
35	1	BMZ00074			0 Bkt, Adapter, P/S, 4xFC To TM-55/65		each		
40	1	BMZ01059			0 Bkt, Slide, Block, TH, HDX, '12		each		
50	1	KBB00002			0 Kit, PS, Platform, Transit, ADM, '20		each		
60	1	KPC64094			0 Kit, Pulley, 2B, ISB, 2013		each		
70	1	PUA05001			0 Pulley, Assy, Idler, B/S, 5", Stl, Plt		each		
80	1	PUA05012			0 Pulley, Assy, Idler,B/BX gr,5", STL,Plt		each		
90	1	SCD16012			1 Spacer, Col, Drl,16 mm x 34.9o x 12.3i		each		
100	1	SCD21912			0 Spacer, Col, Drl,21.9mm x 25.4o x 12.3i		each		
110	2	SLV17012			0 Sleeve, Pulley, 16.9o x 22.23mm x 12.32i		each		
120	1	KBC96597			0 Bag Kit, Fasteners, KMC96597 & KMC96697		each		

Bill of Materials Listing

TransArctic Canada Inc.

6/2/2020
Page 1 of 1

Product Number		Description	Rev#	Date	Weight	Uof M	Yield
Line	Component Prod#	Description	Bin	Unit	Qty		
KBC96597		Bag Kit, Fasteners, KMC96597 & KMC96697	0	7/14/2016	2.96		0
10	BTC10045	Bolt, Hex, 10 x 1.5 x 45mm, 10.9, Plt,FT		each	3		
20	BTC12080	Bolt, Hex, 12 x 1.75 x 80mm, 10.9,Plt,FT		each	2		
30	BTQ06175	Bolt, Hex, 3/8-16unc, 1.75", 8, Plt		each	8		
40	BTQ08200	Bolt, Hex, 1/2-13unc, 2.0", 8, Plt		each	3		
45	CSF08150	Capscrew, FH, 1/2-13 x 1.50", Alloy, Plt		each	1		
47	CSF12036	Capscrew, FH, 12 x 1.75 x 35mm, 10.9,Plt		each	4		
50	NTA10000	Nut, Hex, 10 x 1.5, 8.8, Plt		each	3		
60	NTA12000	Nut, Hex, 12 x 1.75, 8.8, Plt		each	2		
70	NTQ06000	Nut, Hex, 3/8-16unc, 8, Plt		each	8		
80	NTQ08000	Nut, Hex, 1/2-13unc, 8, Plt		each	4		
90	WFA10002	Washer, Flat, 10mm, Hvy, 8.8, Plt		each	6		
100	WFA12002	Washer, Flat, 12mm, Hvy, 8.8, Plt		each	2		
110	WFQ08000	Washer, Flat, 1/2", 8, Plt		each	7		
120	WFS06002	Washer, Flat, 3/8", L9, Plt		each	16		
130	WLA10000	Washer, Lock, 10mm, 8.8, Plt		each	3		
140	WLA12000	Washer, Lock, 12mm, 8.8, Plt		each	2		
150	WLQ06000	Washer, Lock, 3/8", 8, Plt		each	8		
160	WLQ08000	Washer, Lock, 1/2", 8, Plt		each	4		

Bill of Materials Listing

TransArctic Canada Inc.

6/3/2020
Page 1 of 1

Product Number		Description	Rev#	Date	Weight	Uof M	Yield
Line	Component Prod#	Description	Bin	Unit	Qty		
KBB00002		Kit, PS, Platform, Transit, ADM, '20	0	6/20/2012	75.91		0
10	BMZ01034	Bkt, Spring, Support Arm, ADM, '12		each	1		
20	BMZ01035	Bkt, Main, Pivot, Ass'y, ADM Transit, '12		each	1		
30	BMZ01037	Bkt, Fork, Knuckle-Joint, Adm, '12		each	1		
40	BMZ01038	Bkt, Main, Base Pl, ADM, '12		each	1		
50	BMZ01040	Bkt, Ass'y, THRD Rod, Isolator, ADM, '12		each	1		
60	BMZ01041	Shaft Key, 5/16" SQ x .540" Long		each	2		
70	BMZ01042	Vibration Isolator, Bar, 9.63 x 2 x 1.50		each	2		
80	BMZ01044	Bkt, Cradle, Pivot, Adm Transit, '12		each	1		
90	BMZ01047	Bkt, Bar, Slide Nut, ADJ, Trans ADM, '12		each	2		
110	PIS01010	Shaft, Stl, Grease, ADM Transit, '12		each	1		
120	SPR00002	Spring, Comp, R/H, 110 x 50 x 8.4, Red		each	1		
130	WFS16001	Washer, Flat, Dbl Step, 17mm, 50mm, Plt		each	1		
140	WFS27001	Washer, Flat, Dbl Step, 27mm, 63.5, Plt		each	1		
150	KBB00025	Bag Kit, Fasteners, KBB00001		each	1		
160	KBB00026	Bag Kit, Fasteners, Assembly, KBB00001		each	1		

NOTE:

Use Blue "Loctite" on the (4) fasteners to fasten BMZ01034 in place. 1/2 -13 UNC grd. 8 bolts, c/w
 L'whrs torque... used on the PIS01010 Shaft = 45 FT*LBS.
 (/VTS@ JAN-25-2019)

Bill of Materials Listing

TransArctic Canada Inc.

6/3/2020
Page 1 of 1

Product Number		Description	Rev#	Date	Weight	Uof M	Yield
Line	Component Prod#	Description	Bin	Unit	Qty		
KBB00025		Bag Kit, Fasteners, KBB00001/2	5	8/1/2012	1.61		0
10	BTQ08126	Bolt, Hex, 1/2-20unf, 1.25", 8, Plt		each	6		
20	BTQ08150	Bolt, Hex, 1/2-13unc, 1.5", 8, Plt		each	1		
30	BTQ10351	Bolt, Hex, 5/8-18unf, 3.5", 8. PLT		each	1		
50	NTQ08000	Nut, Hex, 1/2-13unc, 8, Plt		each	1		
60	NTQ10000	Nut, Hex, 5/8-11unc, 8, Plt		each	2		
65	NTQ10001	Nut, Hex, 5/8-18unf, 8, Plt		each	1		
100	WFQ08000	Washer, Flat, 1/2", 8, Plt		each	8		
110	WFQ10000	Washer, Flat, 5/8", 8, Plt		each	2		
120	WLQ08000	Washer, Lock, 1/2", 8, Plt		each	7		
130	WLQ10000	Washer, Lock, 5/8", 8, Plt		each	2		

Bill of Materials Listing

TransArctic Canada Inc.

6/3/2020
Page 1 of 1

Product Number		Description	Rev#	Date	Weight	Uof M	Yield
Line	Component Prod#	Description	Bin	Unit	Qty		
KBB00026		Bag Kit, Fasteners, Assembly, KBB00001/2	4	8/1/2012	2.48		0
5	BTQ08101	Bolt, Hex, 1/2-20unf, 1.00", 8, Plt		each	6		
15	BTQ08100	Bolt, Hex, 1/2-13unc, 1.00", 8, Plt		each	1		
20	BTQ08150	Bolt, Hex, 1/2-13unc, 1.5", 8, Plt		each	8		
70	WFS08001	Washer, Flat, 1/2", 8, USS, Plt		each	2		
100	WFQ08000	Washer, Flat, 1/2", 8, Plt		each	6		
120	WLQ08000	Washer, Lock, 1/2", 8, Plt		each	16		
130	NTQ08000	Nut, Hex, 1/2-13unc, 8, Plt		each	4		
140	BTM08100	Bolt, 1/2-13 x 1.0" w/ Grease Nipple FTG		each	1		

Bill of Materials Listing

TransArctic Canada Inc.

11/10/2020

Page 1 of 1

Product Number		Date	Description		Uof M	Weight	Yield	
Line	Qty	Component Prod#	Rev#	Description	Bin	Unit		
KPC64094		5/13/2008	0	Kit, Pulley, 2B, ISB, 2013			14.32	0
10	1	PUL67222	0	Pulley, Crank, ADD-ON, ISB,6.7L,2B/X,'07		each		
20	6	CSS12090		Capscrew, SH, 12 x 1.25 x 90mm, 12.9,BLK		each		
30	6	WFS12002	0	Washer, Flat, Hdn, 12mm, Stl, BLK		each		

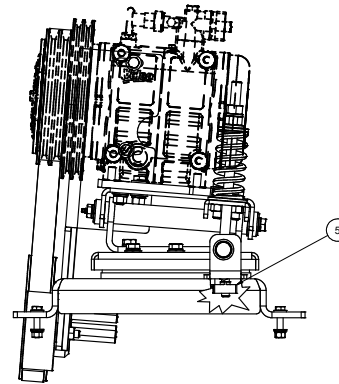
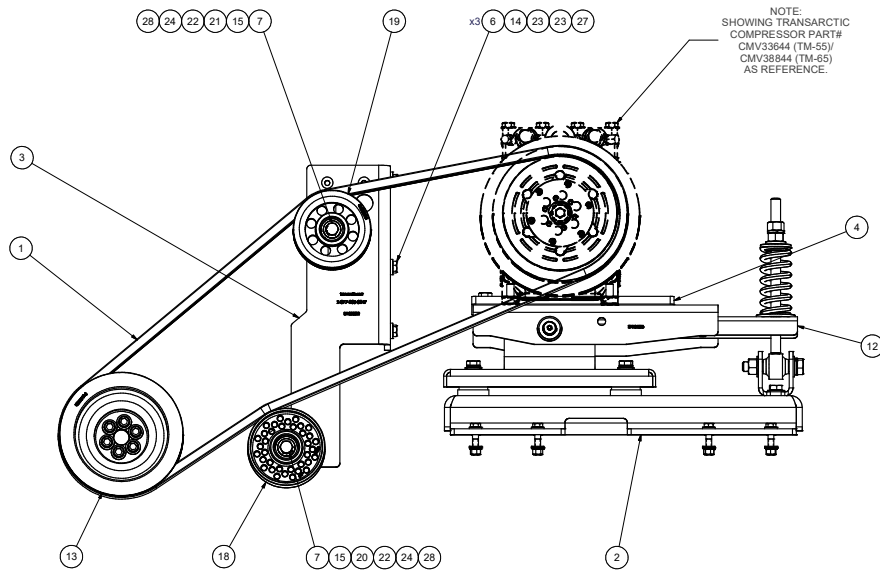
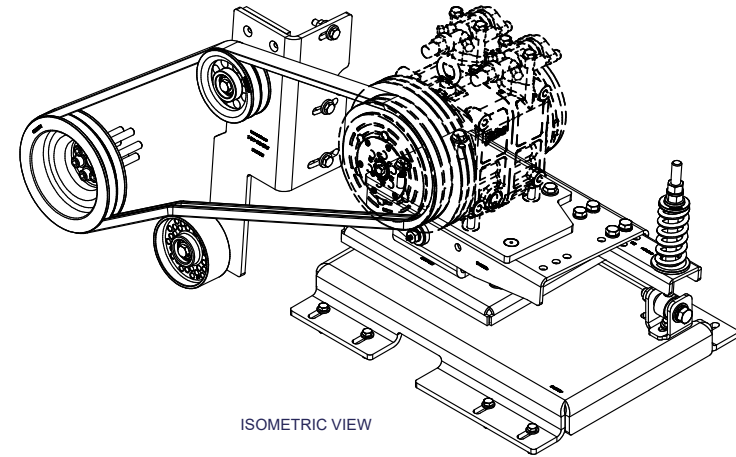
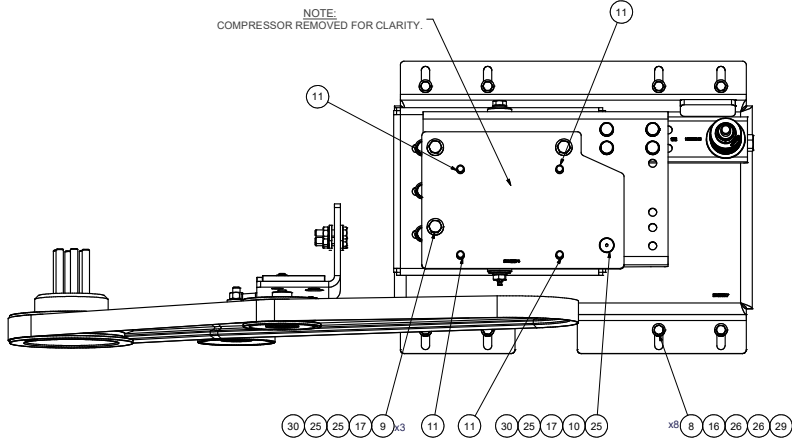

- NOTES:
- 1) USE SERVICABLE THREADLOCKER ON ALL FASTENERS TO ENGINE COMPONENTS AND TORQUE ALL BOLTS TO S.A.E. SPECIFICATIONS.
 - 2) SEE "TRANSARCTIC A/C COMPRESSOR MOUNT INSTALLATION DISCLAIMER".

QTY	U/M	PART NUMBER	DESCRIPTION
30	4	EACH	WLQ08000 WASHER, LOCK, 1/2", 8, PLT
29	8	EACH	WLO06000 WASHER, LOCK, 3/8", 8, PLT
28	2	EACH	WLA12000 WASHER, LOCK, 12mm, 8.8, PLT
27	3	EACH	WLA10000 WASHER, LOCK, 10mm, 8.8, PLT
26	16	EACH	WFS06002 WASHER, FLAT, 3/8", L9, PLT
25	7	EACH	WFO08000 WASHER, FLAT, 1/2", 8, PLT
24	2	EACH	WFA12002 WASHER, FLAT, 12mm, HVY, 8.8, PLT
23	6	EACH	WFA10002 WASHER, FLAT, 10mm, HVY, 8.8, PLT
22	2	EACH	SLV17012 SLEEVE, PULLEY, 16.90 x 22.23 mm x12.19l
21	1	EACH	SCD21912 SPACER, COL, DRL, 21.9mm x 31.80 x12.3l
20	1	EACH	SCD16012 SPACER, COL, DRL, 16 mm x 31.80 x 12.0l
19	1	EACH	PUA05012 PULLEY, ASSY, IDLER, B/BX gr, 5" STL, PLT
18	1	EACH	PUA05001 PULLEY, ASSY, IDLER, B/S, 5", STL, PLT
17	4	EACH	NTQ08000 NUT, HEX, 1/2-13UNC, 8, PLT
16	8	EACH	NTQ06000 NUT, HEX, 3/8-16UNC, 8, PLT
15	2	EACH	NTA12000 NUT, HEX, 12 x 1.75, 8.8, PLT
14	3	EACH	NTA10000 NUT, HEX, 10 x 1.5, 8.8, PLT
13	1	EACH	KPC64094 KIT, PULLEY, 2B, ISB, 2013
12	1	EACH	KBB00002 MT KIT, PS, PLATFORM, TRANSIT, ADM, '20
11	4	EACH	CSF12036 CAPSCREW, FH, 12 x 1.75 x 35mm, 10.9, PLT
10	1	EACH	CSF08150 CAPSCREW, FH, 1/2-13 x 1.5", ALLOY, PLT
9	3	EACH	BTQ06200 BOLT, HEX, 1/2-13UNC x 2.00, 8, PLT
8	8	EACH	BTQ06175 BOLT, HEX, 3/8-16UNC, 1.75", 8, PLT
7	2	EACH	BTC12080 BOLT, HEX, 12 x 1.75 x 80mm, 10.9, PLT, FT
6	3	EACH	BTC10045 BOLT, HEX, 10 x 1.5 x 45mm, 10.9, PLT
5	1	EACH	BMZ01059 BKT, SLIDE, BLOCK, TH, HDX, '13
4	1	EACH	BMZ00074 BKT, PL, TM-55/65, HDX, INTERFACE, '50"
3	1	EACH	BMC90022 BKT, MAIN, IDLER, WELDMT, ISL, HDX, '16
2	1	EACH	BMC90017 BKT, FOUND'N, HDX, 4x4C, '16
1	1	EACH	BEL32286 BELT, BANDED B GR, 2286mm (90")

DRAWN		11/9/2020		BILL OF MATERIALS	
jrodriguez		CHECKED		TRANSARCTIC INC.	
V.Jakowlew		11/9/2020			
REV		DESCRIPTION		TITLE	
0	RELEASED TO PRODUCTION	11/9/2020	JRR	MT KIT, ISB, HDX, TM-55/65, '20	
1	James Stewart	11/9/2020	APPROVED	MFG	
2	Dale Mason	11/9/2020	APPROVED	SIZE	
UNSPECIFIED TOLERANCES:		ALL DIMS		DWG NO	
ONE DECIMAL PLACE (X0.1)	FR	FR	FR	KMC66597	
TWO DECIMAL PLACE (X0.05)	FR	FR	FR	REV	
THREE DECIMAL PLACE (X0.025)	FR	FR	FR	0	
FRACTIONAL (X1/16)	FR	FR	FR	SCALE	
THIRD ANGLE PROJECTION		DRAWING UNIT OF MEASURE		1:4	
		MM (INCH)		SHEET 1 OF 1	

8 7 6 5 4 3 2 1

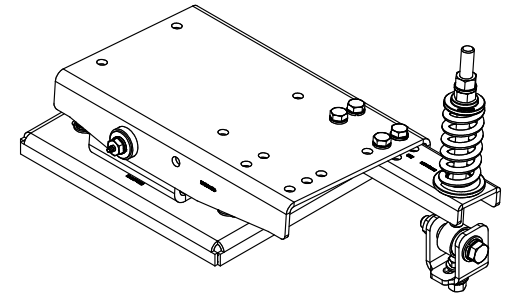
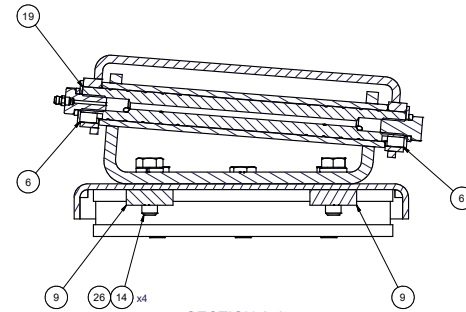
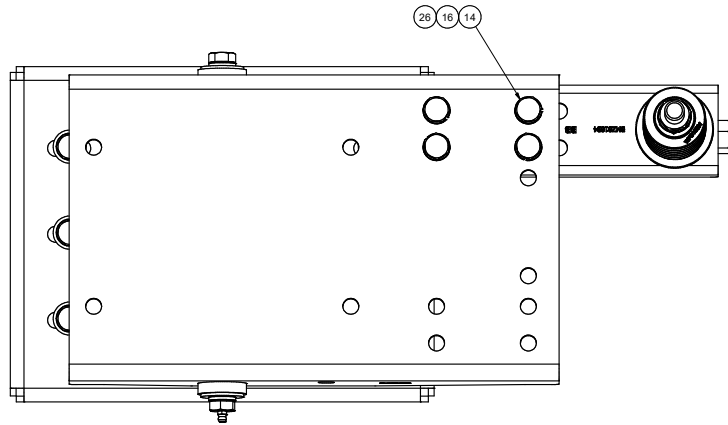

ISOMETRIC VIEW
SCALE 1/3

SECTION A-A

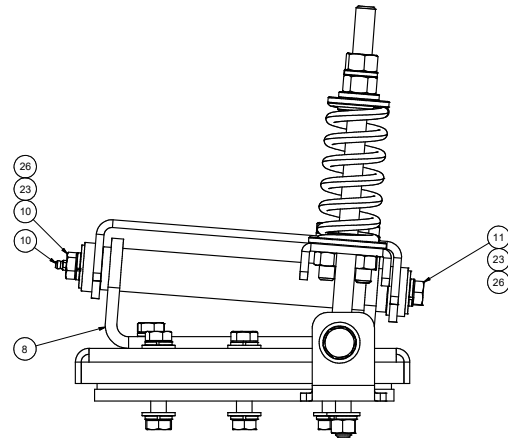
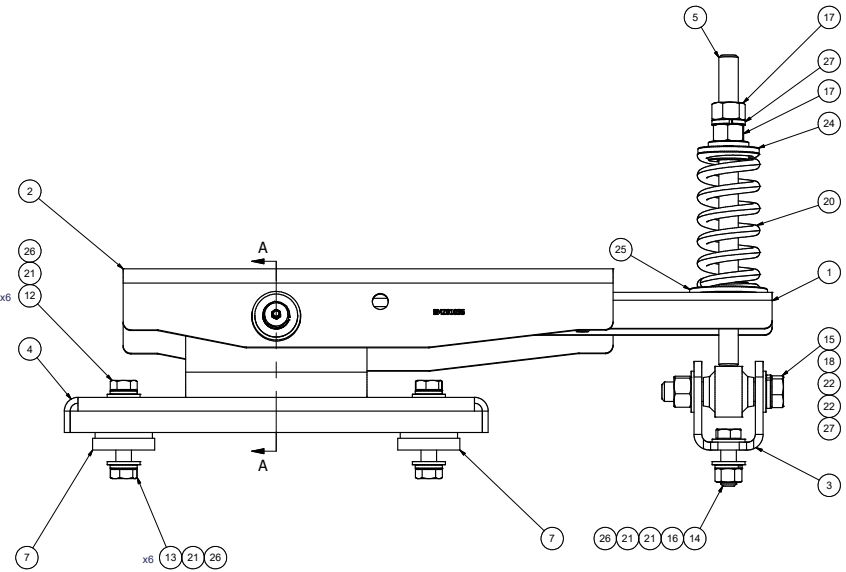

27	2	EACH	WLO10000	WASHER, LOCK, 5/8", 8, PLT
26	23	EACH	WLO08000	WASHER, LOCK, 1/2", 8, PLT
25	1	EACH	WFS27001	WASHER, FLAT, DBL STEP, 28mm, 63.5, PLT
24	1	EACH	WFS16001	WASHER, FLAT, DBL STEP, 16mm, 50mm, PLT
23	2	EACH	WFS08001	WASHER, FLAT, 1/2", 8, USS, PLT
22	2	EACH	WFO10000	WASHER, FLAT, 5/8", 8, PLT
21	14	EACH	WFO08000	WASHER, FLAT, 1/2", 8, PLT
20	1	EACH	SPR00002	SPRING, COMP, R/H, 110 x 50 x 8.4, RED
19	1	EACH	PTSO1010	SHAFT, STL, GREASE, ADM TRANSIT, '12
18	1	EACH	NTQ10001	NUT, HEX, 5/8-18UNC, 8, PLT
17	2	EACH	NTQ10000	NUT, HEX, 5/8-11UNC, 8, PLT
16	5	EACH	NTQ08000	NUT, HEX, 1/2-13UNC, 8, PLT
15	1	EACH	BTQ10351	BOLT, HEX, 5/8-18UNC x 3.50, 8, PLT
14	9	EACH	BTQ08150	BOLT, HEX, 1/2-20UNC x 1.25, 8, PLT
13	6	EACH	BTQ08126	BOLT, HEX, 1/2-20UNC x 1.00, 8, PLT
12	6	EACH	BTQ08101	BOLT, HEX, 1/2-20UNC x 1.00, 8, PLT
11	1	EACH	BTQ08100	BOLT, HEX, 1/2-13UNC x 1.00, 8, PLT
10	1	EACH	BTM08100	BOLT, 1/2-13 x 1.0" w/ GREASE NIPPLE FTG
9	2	EACH	BMZ01047	BKT, BAR, SLIDE NUT, ADJ, TRANS ADM, '12
8	1	EACH	BMZ01044	BKT, ASSY, CRADLE PIVOT, ADM TRANSIT, '12
7	2	EACH	BMZ01042	VIBRATION ISOLATOR, BAR, 9.63 x 2 x 1.50
6	2	EACH	BMZ01041	Shaft Key, 5/16" SQ x .540" Long
5	1	EACH	BMZ01040	BKT, ASSY, THRD ROD, ISOLATOR, ADM, '12
4	1	EACH	BMZ01038	BKT, MAIN, BASE PL, ADM, '12
3	1	EACH	BMZ01037	BKT, FORK, KNUCKLE-JOINT, ADM, '12
2	1	EACH	BMZ01035	BKT, MAIN, PIVOT, ASSY, ADM TRANSIT, '12
1	1	EACH	BMZ01034	BKT, SPRING, SUPPORT ARM, ADM, '12
ITEM	QTY	U/M	PART NUMBER	DESCRIPTION

REV	ECN	DESCRIPTION	DATE	BY
0		RELEASED TO PRODUCTION	6/12/2020	JRR
1			6/12/2020	Val Jakowlew
2			6/12/2020	James Stewart
3			6/12/2020	Ron Ingram
4			6/12/2020	Dale Mason

DRAWN: jrodriguez 6/12/2020
 CHECKED: Val Jakowlew 6/12/2020
 APPROVED: Dale Mason 6/12/2020

TRANSARCTIC INC.
 TITLE: MT KIT, PS, PLATFORM, TRANSIT, ADM, '20
 DWG NO: KBB00002
 SCALE: 1:2
 SHEET 1 OF 1

NOTES:
 1) USE SERVICABLE THREADLOCKER ON ALL FASTENERS TO ENGINE COMPONENTS AND TORQUE ALL BOLTS TO S.A.E. SPECIFICATIONS.
 2) SEE "TRANSARCTIC A/C COMPRESSOR MOUNT INSTALLATION DISCLAIMER".

UNSPECIFIED TOLERANCES: ALL DIMS IN INCHES
 ONE DECIMAL PLACE (.X) .005
 TWO DECIMAL PLACES (.XX) .0025
 THREE DECIMAL PLACES (.XXX) .0015
 FRACTIONAL IN INCHES: AS SHOWN



DRAWING UNIT OF MEASURE: MM (INCH)

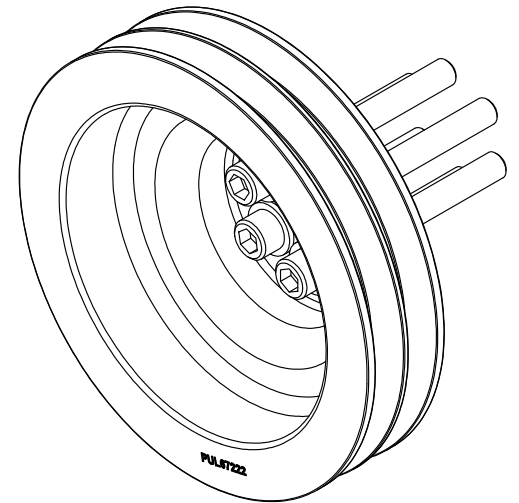
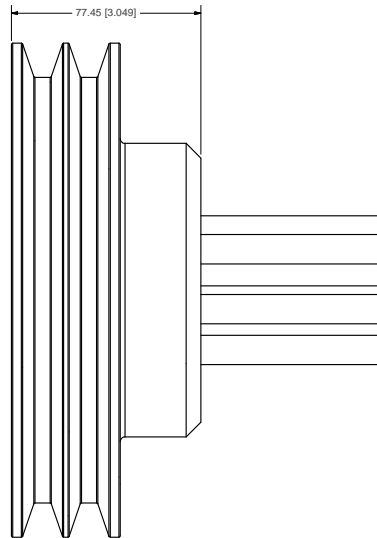
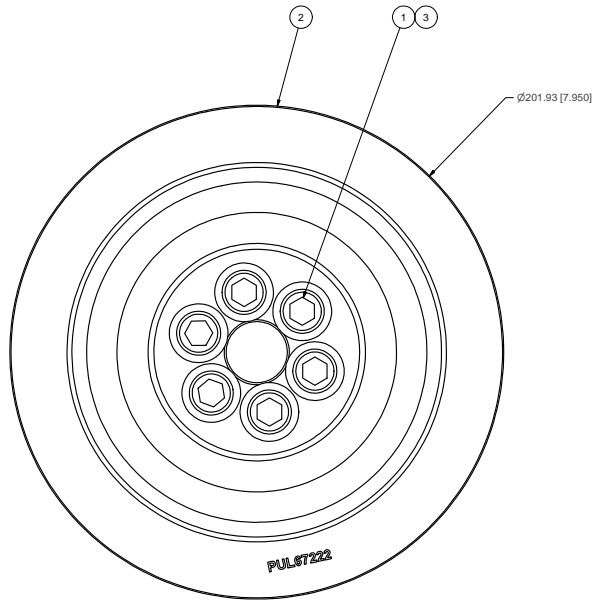
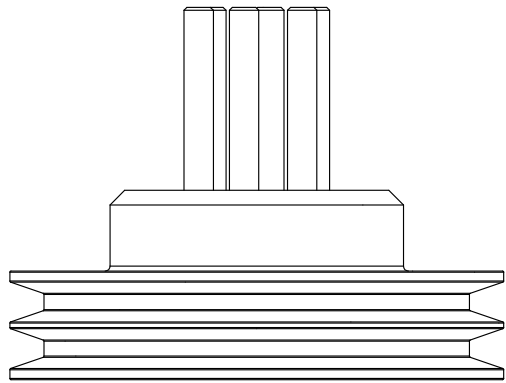

ISOMETRIC VIEW

- NOTES:**
- 1) USE SERVICABLE THREADLOCKER ON ALL FASTENERS TO ENGINE COMPONENTS AND TORQUE **ALL BOLTS** TO S.A.E. SPECIFICATIONS.
 - 2) SEE "TRANSARCTIC A/C COMPRESSOR MOUNT INSTALLATION DISCLAIMER".
 - 3) WEIGHT: 13.24 LB

ITEM	QTY	U/M	PART NUMBER	DESCRIPTION
3	6	EACH	WFS12002	WASHER, FLAT, HDN, 12mm, STL, BLK
2	1	EACH	PUL67222	PULLEY, CRANK, ADD-ON, ISB, 5.7L, 2B/1X '07
1	6	EACH	CSS12090	CAPSCREW, SH, 12 x 1.25 x 90mm, 12.9, FLT

TRANSARCTIC INC.

U	RELEASED TO PRODUCTION	11/6/2013	JRR	
REV	ECN	DESCRIPTION	DATE	BY
				James Stewart
				Ron Ingram
				Date Mason

THIS DRAWING CONTAINS PROPRIETARY CONFIDENTIAL INFORMATION OWNED BY TRANSARCTIC CANADA INC. THE DOCUMENT AND THE INFORMATION IN IT ARE NOT TO BE USED, DISCLOSED OR REPRODUCED WITHOUT EXPRESS WRITTEN PERMISSION OF THE COMPANY.

UNSPECIFIED TOLERANCES:			
ONE DECIMAL PLACE	(±)	0.1	(MM)
TWO DECIMAL PLACE	(±)	0.05	(MM)
THREE DECIMAL PLACE	(±)	0.025	(MM)
FRACTIONAL (1/32")	(±)	0.005	(INCH)
FRACTIONAL (1/64")	(±)	0.0025	(INCH)

DRAWN	Jose Rodriguez	11/6/2013	
CHECKED	Val Jakowlew	11/6/2013	
APPROVED	Ron Ingram	11/6/2013	
DATE	Date Mason	11/6/2013	
TITLE		KIT, PULLEY, 2B, ISB, 2013	
SIZE	D	DWG NO	KPC64094
SCALE	1:1	SHEET	1 OF 1



DRAWING UNIT OF MEASURE: MM (INCH)

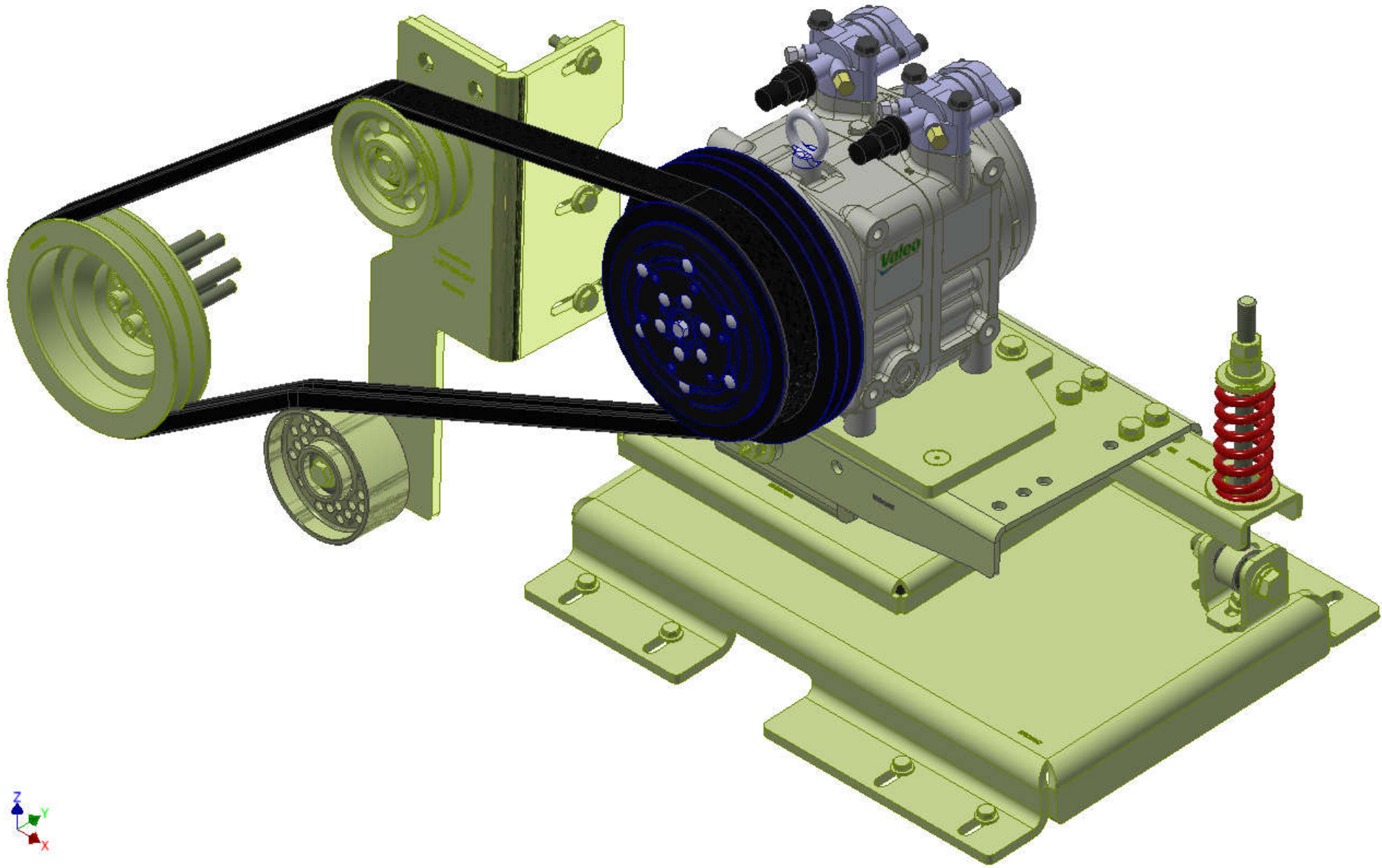

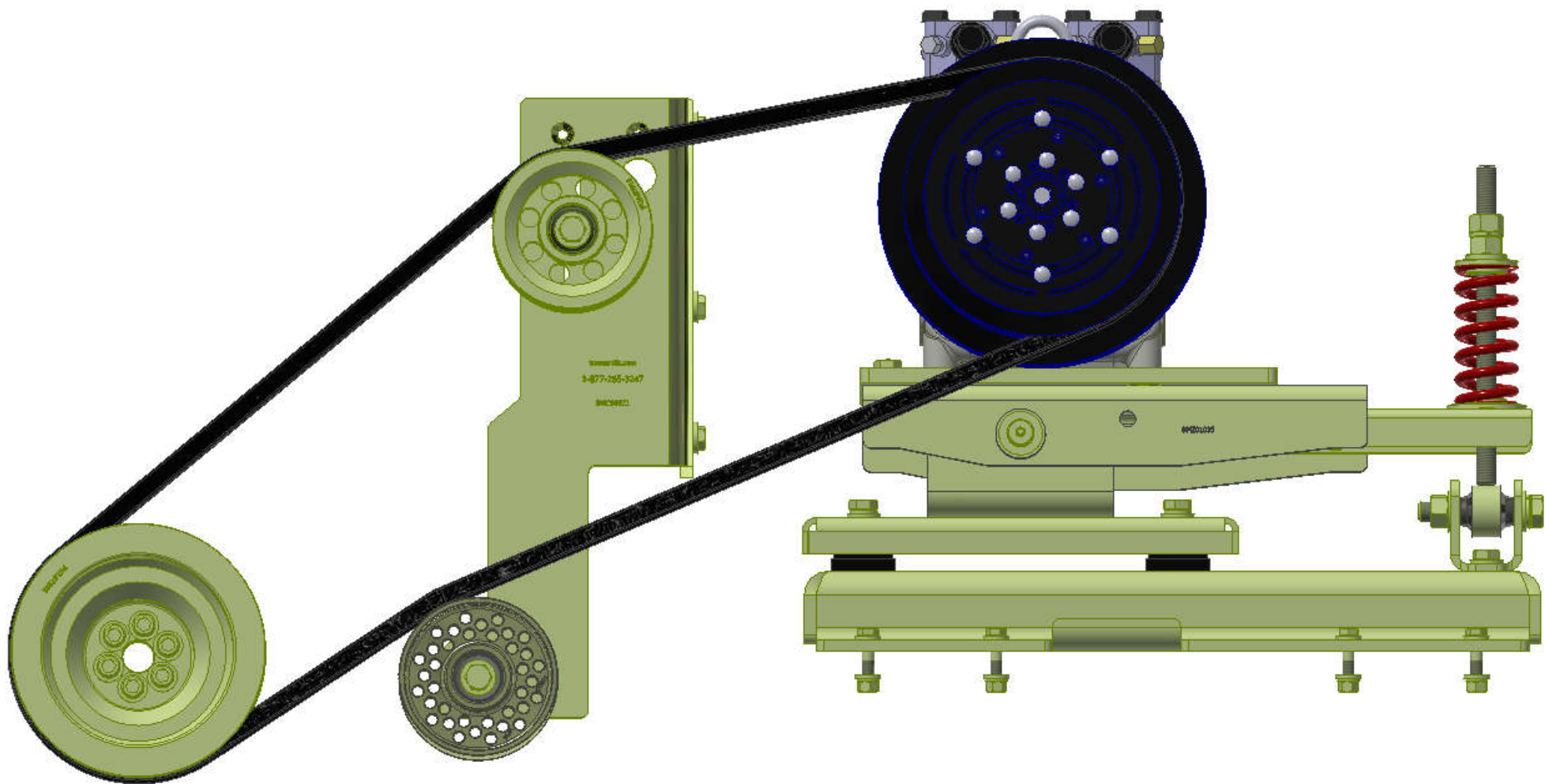

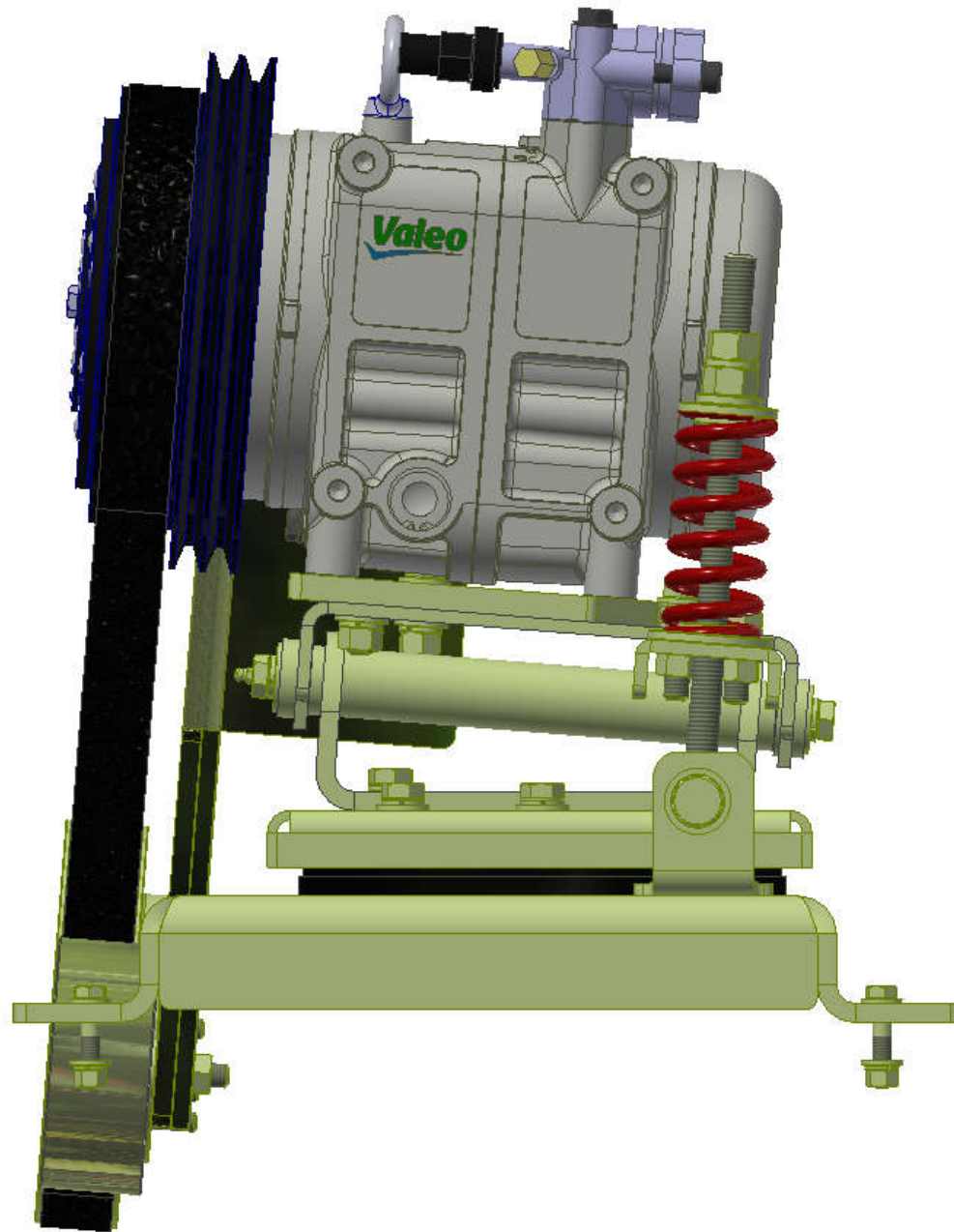

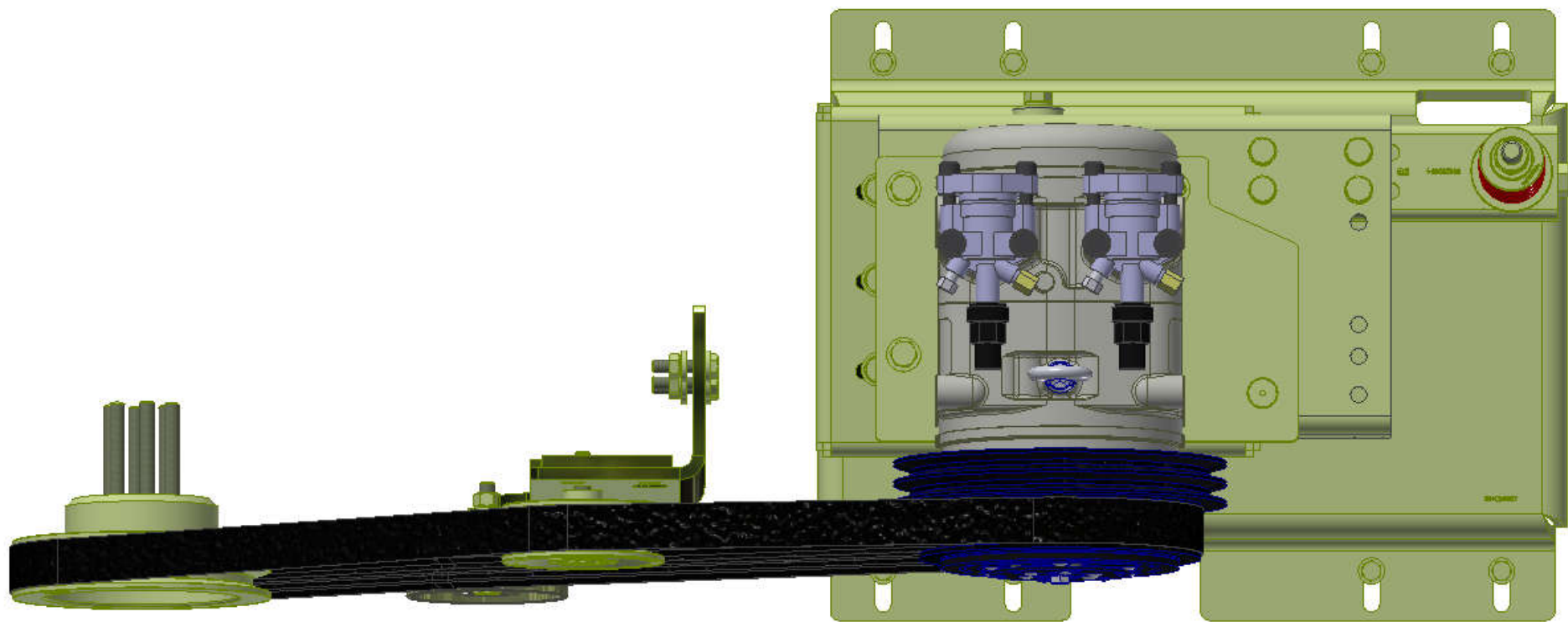

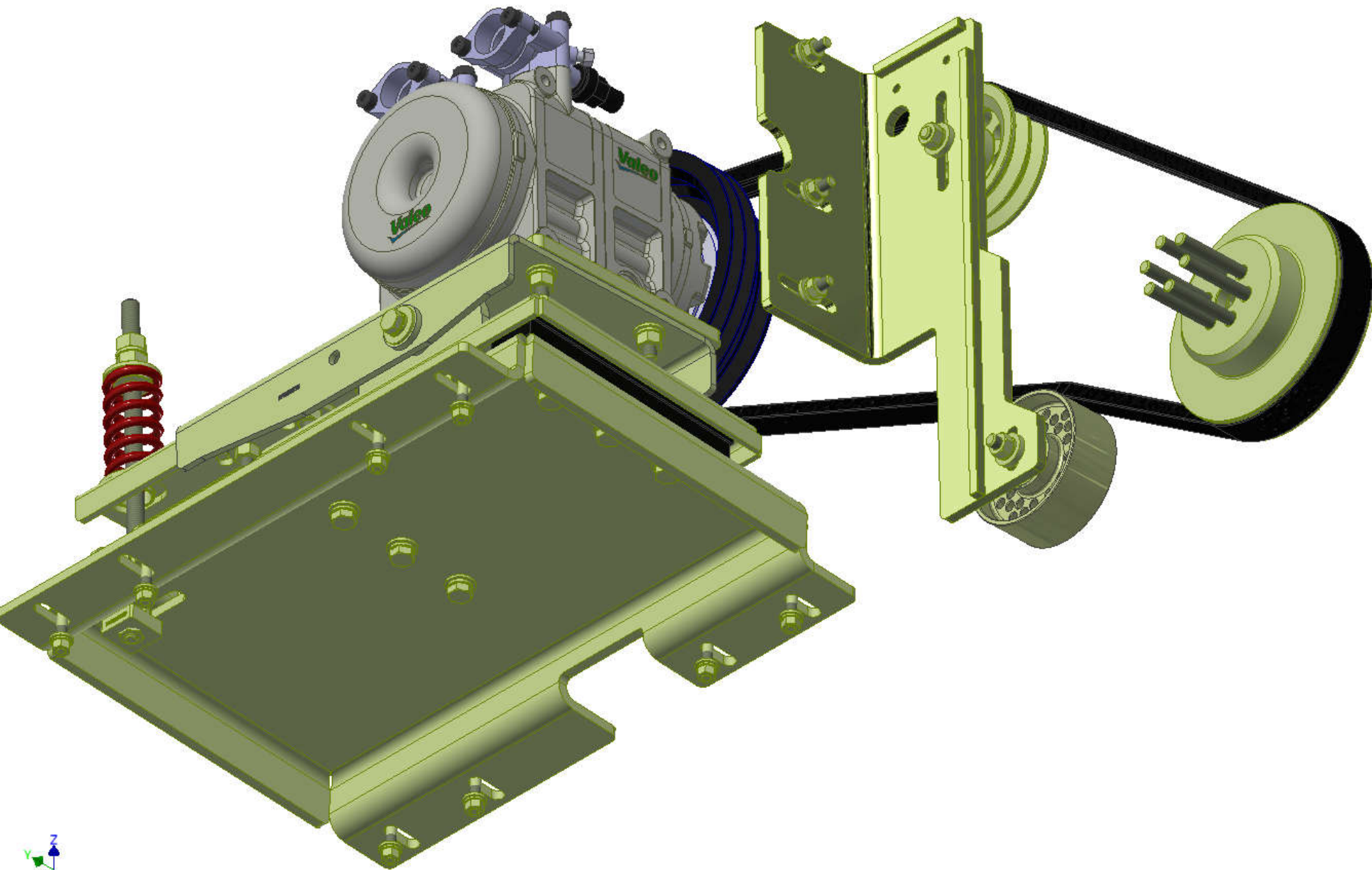

TransArctic A/C Compressor Mount Installation Disclaimer

All compressor mounts should be installed by qualified and trained personnel using proper tools and equipment in safe working conditions following industry standard guidelines for motor vehicle service and repair.

The installer of any compressor mount purchased from TransArctic must undertake all responsibility of issues arising from that compressor bracket being installed on any vehicle. As well as insure that a **proper and sufficient ground** is established between the compressors' clutches and the vehicle's engine. Mount functionality, operation and durability can all be compromised by an incompetent installation.

Due to the many different situations, parameters and application criteria, which are beyond the compressor mount manufacturer's control, TransArctic does not warrant design, durability, or operational functionality of any compressor mount improperly installed by another party.

With no implied guarantees it is the mount installer's strict responsibility to determine safety and functionality, of the compressor mount, at the time of installation.

Please contact TransArctic with any issue arising from installation so we may better improve the product. If you have any reservations about the compressor mount integrity contact TransArctic immediately at 1-877-COLD-AIR.

Mark OEM tensioner location

Install Kit

Check for Interferences

Check to ensure that the proper OEM tensioner orientation is maintained

Run engine with A/C system engaged for at least 10 minutes to run in belt

Check OEM tensioner orientation and adjust as required

Responsabilidad limitada de TransArctic en la instalación del soporte del compresor

Todos los soportes de los compresores deben ser instalados por personas calificadas y entrenadas, usando para ello los equipos y herramientas necesarios para esta labor en buenas condiciones y según las normas y guías para el servicio y/o reparación de motores de vehículos.

El instalador de los soportes comprados en TransArctic asume toda la responsabilidad de cualquier problema que surga en el soporte del compresor al vehículo; de igual manera es responsable que el cable a tierra sea conectado entre el embrague del compresor y el motor del vehículo.

Se advierte que el buen funcionamiento y la durabilidad del soporte pueden ser comprometidos por defectos en su instalación.

Debido a las diversas situaciones que se puedan presentar fuera del control del fabricante, TransArctic no garantiza el diseño, la durabilidad o el correcto funcionamiento de cualquier equipo inapropiadamente instalado por terceros.

Esta sobreentendido que el Instalador del montaje del compresor es estrictamente responsable de la seguridad y funcionamiento del equipo en el momento de la instalación.

Si tuviera algún problema o duda acerca de la instalación del soporte del compresor pongase en contacto inmediatamente con TransArctic al teléfono 1-877-COLD-AIR de modo que podamos mejorar nuestro producto.

Note la ubicación del medidor de tensión OEM

Instale el equipo

Controlar si hay interferencias.

Asegurese que el medidor de tensión mantenga la orientación justa.

Encienda el motor por lo menos 10 minutos con el sistema A/C enganchado para que la correa corra

Controle la orientación justa del medidor de tensión y ajuste a las condiciones requeridas del fabricante