

Bill of Materials Listing

TransArctic Canada Inc.

6/4/2020
Page 1 of 1

Product Number		Description	Rev#	Date	Weight	Uof M	Yield
Line	Component Prod#	Description	Bin	Unit	Qty		
KMC92698		Mt Kit, ISL-D, HDX ER, 2 TM-21, '19	0	10/2/2019	167.94		0
10	BEL21905	Belt, B gr, 1905mm (75") (BX72)		each	1		
13	BEL82134	Belt, 8gr, 2134mm (84")		each	1		
20	BMC67022	Bkt, Upper, Weldmt, D/S, ISB, TM-21		each	1		
23	BMC90007	Bkt, Cradle, ISL, R/H, TM-21,87mm,90/ccw		each	1		
25	BMC90008	Bkt, Cradle, ISL, L/H, TM-21,92mm,90/ccw		each	1		
30	BMC90030	Bkt, Support, Side Post, HDX, '19		each	1		
40	BMC90031	Bkt, Weldm't, Tensioner, HDX, '19		each	1		
50	BMC90034	Bkt, PI, Jack Screw, HDX, '19		each	1		
60	BMC90037	Bkt, Lower, Cradle, Weldm't, TM-21, '19		each	1		
70	BMT10011	Bkt, Tenr, Block, Offset, 3mm		each	1		
80	BMT10012	Bkt, Block, Jack Screw, Threaded		each	1		
90	KPC89012	Kit, Pulley, ISL, 8.9L, B/X,'13		each	1		
100	PUA20077	Pulley, Assy, Idler, SB, 3"d , STL		each	2		
110	SCD06410	Spacer, Col, Drl, 6.35mm x 25.4o x10.32i		each	1		
120	SCD37510	Spacer, Col, Drl, 37 mm x 25.4o x 12.3i		each	2		
130	SLV17110	Sleeve, Pulley,S,16.9o x 22.23mm x 10.3i	Alley	each	2		
140	KBC92698	Bag Kit, Fasteners, KMC92698/42698		each	1		

Bill of Materials Listing

TransArctic Canada Inc.

6/4/2020
Page 1 of 1

Product Number		Description	Rev#	Date	Weight	Uof M	Yield
Line	Component Prod#	Description	Bin	Unit	Qty		
KBC92698		Bag Kit, Fasteners, KMC92698/42698		10/10/2019	2.97		0
5	BTC08035	Bolt, Hex, 8 x 1.25 x 35mm, 10.9, Plt,FT		each	2		
10	BTC08100	Bolt, Hex, 8 x 1.25 x 100mm, 10.9, Plt		each	6		
20	BTC08120	Bolt, Hex, 8 x 1.25 x 120mm, 10.9, Plt		each	2		
30	BTC10040	Bolt, Hex, 10 x 1.5 x 40mm, 10.9, Plt,FT		each	2		
40	BTC10080	Bolt, Hex, 10 x 1.5 x 80mm, 10.9, Plt,FT		each	2		
50	BTC10130	Bolt, Hex, 10 x 1.5 x 130mm, 10.9, Plt		each	1		
60	BTQ08125	Bolt, Hex, 1/2-13unc, 1.25", 8, Plt		each	1		
65	BTQ08150	Bolt, Hex, 1/2-13unc, 1.5", 8, Plt		each	1		
70	BTQ08200	Bolt, Hex, 1/2-13unc, 2.0", 8, Plt		each	2		
80	BTS08080	Bolt, Hex, Weldm't, 1/2-13 UNC x 8"		each	1		
90	CSF10031	Capscrew, FH, 10 x 1.5 x 30mm, 10.9,Plt		each	1		
100	CSF10036	Capscrew, FH, 10 x 1.5 x 35mm, 10.9,Plt		each	1		
110	NTA10000	Nut, Hex, 10 x 1.5, 8.8, Plt		each	6		
120	NTQ08000	Nut, Hex, 1/2-13unc, 8, Plt		each	4		
130	WFA08000	Washer, Flat, 8mm, 8.8, Plt		each	10		
140	WFA10000	Washer, Flat, 10mm, 8.8, Plt		each	7		
150	WFA10002	Washer, Flat, 10mm, Hvy, 8.8, Plt		each	4		
160	WFAQ08000	Washer, Flat, 1/2", 8, Plt		each	8		
170	WLA08000	Washer, Lock, 8mm, 8.8, Plt		each	10		
180	WLA10000	Washer, Lock, 10mm, 8.8, Plt		each	7		
190	WLQ08000	Washer, Lock, 1/2", 8, Plt		each	5		

Bill of Materials Listing

TransArctic Canada Inc.

6/4/2020
Page 1 of 1

Product Number	Description	Rev#	Date	Weight	Uof M	Yield
Line	Component Prod#	Description	Bin	Unit	Qty	
KPC89012		Kit, Pulley, ISL, 8.9L, B/X,'13	0	10/15/2013	21.13	0
10	PUL89012	Pulley, Crank,ISL,8.9L, B/X,10.625",19 '		each	1	
20	BTC10070	Bolt, Hex, 10 x 1.5 x 70mm, 10.9, Plt		each	5	
30	WFA10000	Washer, Flat, 10mm, 8.8, Plt		each	5	

8 7 6 5 4 3 2 1

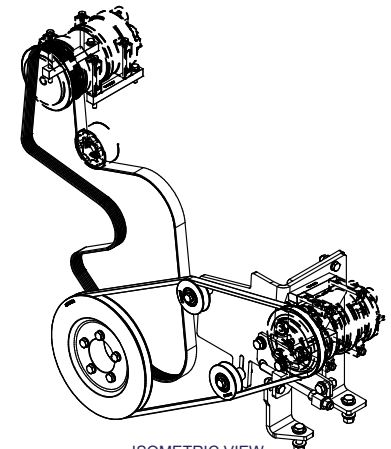
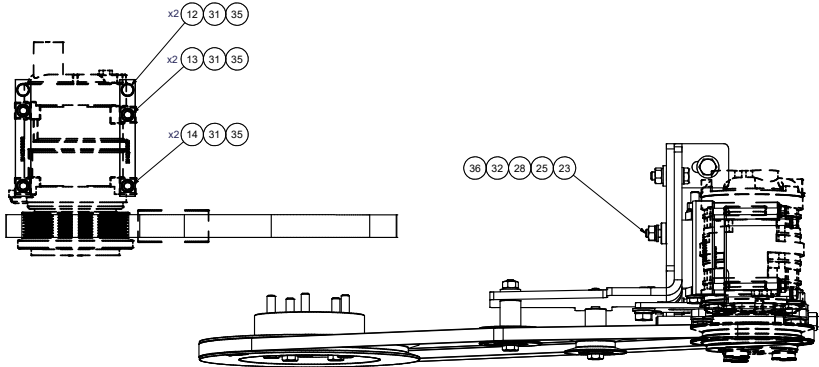

ISOMETRIC VIEW
SCALE: 1/5

NOTE:
SHOWING TRANSARCTIC
COMPRESSOR PART#
CMS13181 (TM-21)
AS REFERENCE.

NOTE:
SHOWING TRANSARCTIC
COMPRESSOR PART#
CMV13112 (TM-21)
AS REFERENCE.

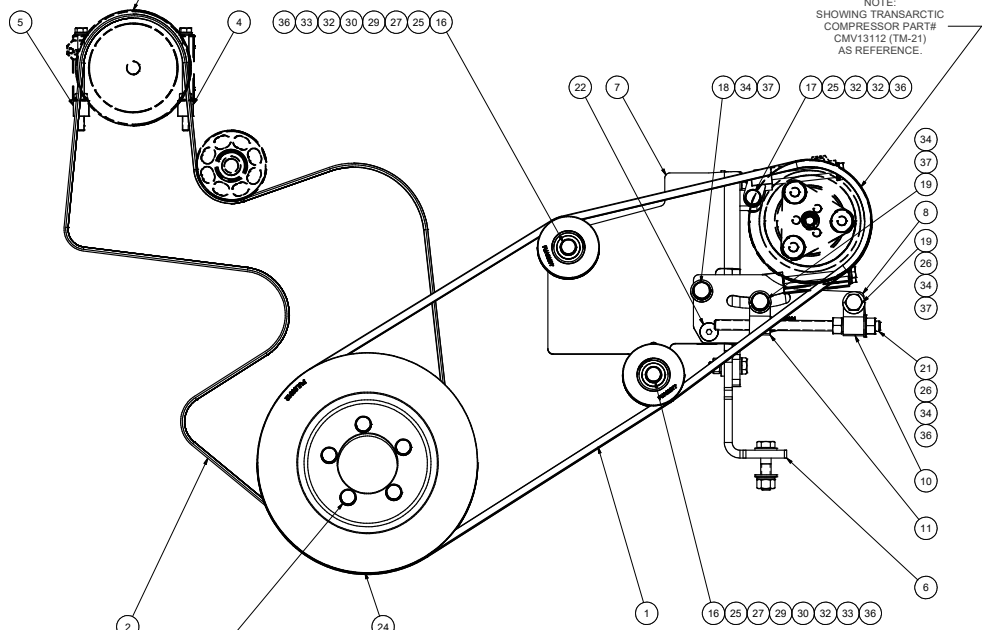

NOTE:
TORQUE TO: .48 FT LB PLAIN & LUBRICATED W/ CLEAN ENGINE OIL (15W-40)
(HEXBOLT CAPSCREW M10 x 1.5 x 50mm)
TIGHTEN IN TWO STEPS IN A CRIS-CROSS TIGHTENING SEQUENCE PATTERN.

NOTES:
1) USE SERVICEABLE THREADLOCKER ON ALL FASTENERS TO ENGINE COMPONENTS AND
TORQUE **ALL** BOLTS TO S.A.E. SPECIFICATIONS.
2) SEE "TRANSARCTIC A/C COMPRESSOR MOUNT INSTALLATION DISCLAIMER".

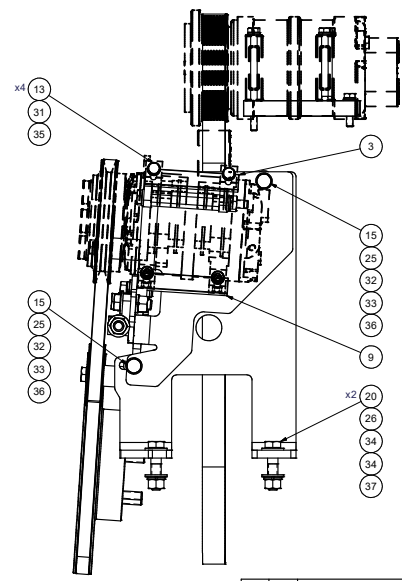

37	5	EACH	WLQ08000	WASHER, LOCK, 1/2", 8, PLT
36	7	EACH	WLA10000	WASHER, LOCK, 10mm, 8.8, PLT
35	10	EACH	WLA08000	WASHER, LOCK, 8mm, 8.8, PLT
34	8	EACH	WFO08000	WASHER, FLAT, 1/2", 8, PLT
33	4	EACH	WFA10002	WASHER, FLAT, 10mm, HVY, 8.8, PLT
32	7	EACH	WFA10000	WASHER, FLAT, 10mm, 8.8, PLT
31	10	EACH	WFA08000	WASHER, FLAT, 8mm, 8.8, PLT
30	2	EACH	SLV17110	SLEEVE, PULLEY, 5, 16.90 x 22.23mm x 10.31
29	2	EACH	SCD37510	SPACER, COL, DRL, 37.5mm x 25.40 x 10.31
28	1	EACH	SCD06410	SPACER, COL, DRL, 6.35mm x 25.40 x 10.321
27	2	EACH	PUA20077	PULLEY, ASSY, IDLER, 5B, 3"D, STL
26	4	EACH	NTQ08000	NUT, HEX, 1/2-13UNC, 8, PLT
25	6	EACH	NTA10000	NUT, HEX, 10 x 1.5, 8.8, PLT
24	1	EACH	KPC99012	KIT, PULLEY, ISL, 8.5L, B/X, '19
23	1	EACH	CSF10036	CAPSCREW, FH, 10 x 1.5 x 35mm, 10.9, PLT
22	1	EACH	CSF10031	CAPSCREW, FH, 10 x 1.5 x 30mm, 10.9, PLT
21	1	EACH	BTS08080	BOLT, HEX, WELDMT, 1/2-13UNC x 8"
20	2	EACH	BTQ08200	BOLT, HEX, 1/2-13UNC x 2.00, 8, PLT
19	2	EACH	BTQ08150	BOLT, HEX, 1/2-13UNC x 1.50, 8, PLT
18	1	EACH	BTQ08125	BOLT, HEX, 1/2-13UNC x 1.25, 8, PLT
17	1	EACH	BTCT01130	BOLT, HEX, 10 x 1.5 x 130mm, 10.9, PLT
16	2	EACH	BTCT00080	BOLT, HEX, 10 x 1.5 x 80mm, 10.9, PLT
15	2	EACH	BTCT00040	BOLT, HEX, 10 x 1.5 x 40mm, 10.9, PLT
14	2	EACH	BTCT08120	BOLT, HEX, 8 x 1.25 x 120mm, 10.9, PLT
13	6	EACH	BTCT08100	BOLT, HEX, 8 x 1.25 x 100mm, 10.9, PLT
12	2	EACH	BTCT08035	BOLT, HEX, 8 x 1.25 x 35mm, 10.9, PLT
11	1	EACH	BMT10012	BKT, BLOCK, JACK SCREW, THREADED
10	1	EACH	BMT10011	BKT, TENR, BLOCK, OFFSET, 3mm
9	1	EACH	BMC90037	BKT, LOWER, CRADLE, WELDMT, TM-21
8	1	EACH	BMC90034	BKT, PL, JACK SCREW, HDX, '19
7	1	EACH	BMC90031	BKT, WELDMT, MAIN, TENSIONER, HDX, '19
6	1	EACH	BMC90030	BKT, SUPPORT, SIDE POST, HDX, '19
5	1	EACH	BMC90008	Bkt, Cradle, ISL, L/H, TM-21, 92mm, 90/ccw
4	1	EACH	BMC90007	Bkt, Cradle, ISL, R/H, TM-21, 87mm, 90/ccw
3	1	EACH	BMC67022	BKT, UPPER, WELDMT, D/S, ISB, TM-21
2	1	EACH	BEL82134_KMC92698	BELT, 8GR, 2134mm (84") (5080840)
1	1	EACH	BEL21905	BELT, B, GR, 1905mm (75") (BX72)

ITEM		QTY	U/M	PART NUMBER	DESCRIPTION
BILL OF MATERIALS					
DRAWN: jrodriguez 9/27/2019					
CHECKED: Jose Rodriguez 9/27/2019					
DATE: 9/11/2016 BY: James Stewart					
APPROVED: Dale Mason 9/27/2019					
TRANSARCTIC INC.					
MT KIT, ISL-D, HDX ER, 2 TM-21, '19					
				SIZE	DWG NO
				D	KMC92698
				SCALE	SHEET 1 OF 1
				1:5	

REV	ECN	DESCRIPTION	DATE	BY	JRR
0		RELEASED TO PRODUCTION	10/12/2016	JRR	OK

THIS DRAWING CONTAINS PROPRIETARY CONFIDENTIAL INFORMATION OWNED BY TRANSARCTIC CANADA INC. THE DOCUMENT AND THE INFORMATION IN IT ARE NOT TO BE USED, DISCLOSED OR REPRODUCED WITHOUT EXPRESS WRITTEN PERMISSION OF THE COMPANY.

UNSPECIFIED TOLERANCES: ALL DIMS FINISH TO 0.0005
ONE DECIMAL PLACE (X1) 0.1000
TWO DECIMAL PLACE (X10) 0.0200
THREE DECIMAL PLACE (X100) 0.0025
FRACTIONAL (X1/16) 1/32

THIRD ANGLE PROJECTION

8 7 6 5 4 3 2 1

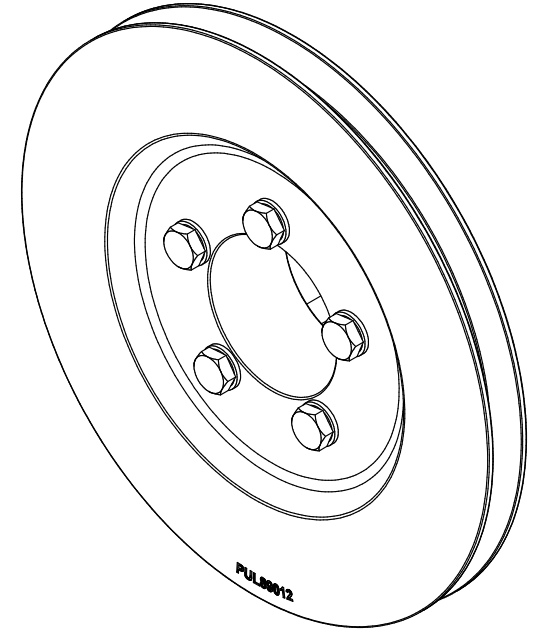
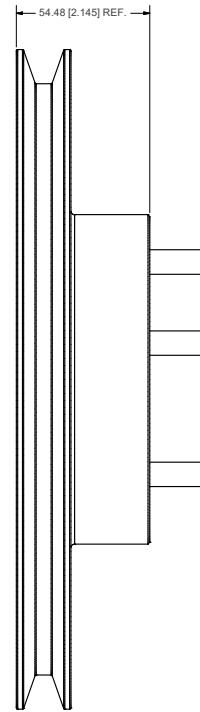
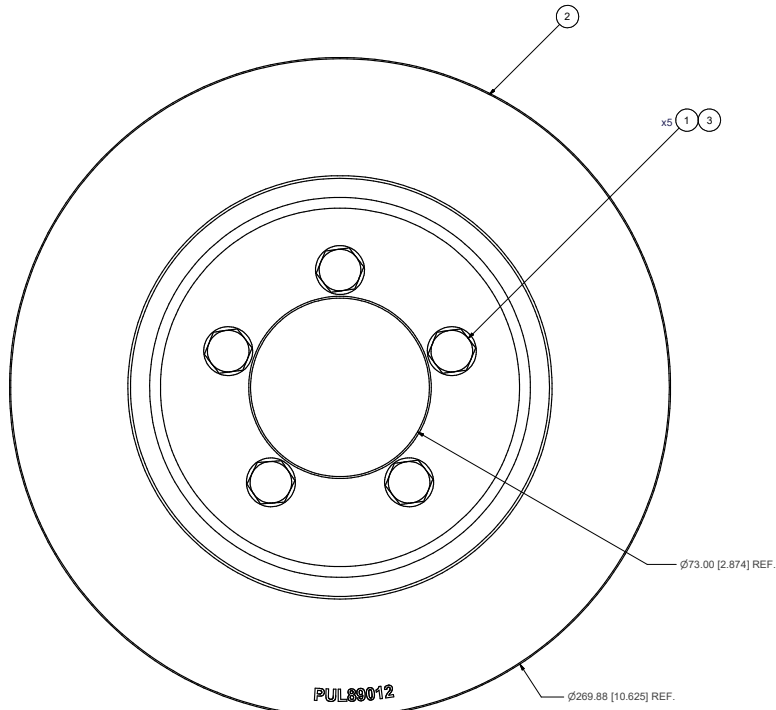
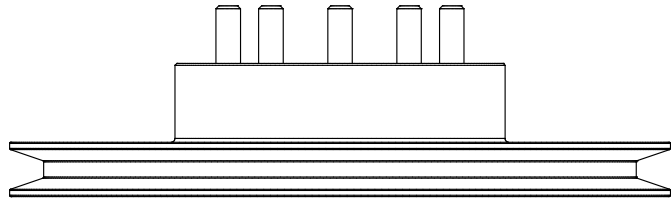

ISOMETRIC VIEW

NOTES:

- 1) USE SERVICABLE THREADLOCKER ON ALL FASTENERS TO ENGINE COMPONENTS AND TORQUE ALL BOLTS TO S.A.E. SPECIFICATIONS.
- 2) SEE "TRANSARC TIC A/C COMPRESSOR MOUNT INSTALLATION DISCLAIMER".
- 3) WT:= 21.18 LBS

ITEM	QTY	U/M	PART NUMBER	DESCRIPTION
3	5	EACH	WFA10000	WASHER, FLAT, 10mm, 8.8, PLT
2	1	EACH	PUL89012	PULLEY, CRANK, ISL, 8.9L, B/X, 10.625", '19
1	5	EACH	BTC10070	BOLT, HEX, 10 x 1.5 x 70mm, 10.9, PLT

BILL OF MATERIALS

DRAWN	jrodriguez	9/27/2019	
CHECKED	val_jakowlew	9/27/2019	
APPROVED	Ron Ingram	9/27/2019	
DATE	Dale Mason	9/27/2019	
TITLE		KIT, PULLEY, ISL, 8.9L, B/X, '19	
DWG NO		KPC89012	
REV		0	
DRAWING UNIT OF MEASURE		MM (INCH)	
SCALE		1:1	

0	RELEASED TO PRODUCTION	9/26/2019	JRR
REV	DESCRIPTION	DATE	BY
1	MPG	9/27/2019	James Stewart
2	MPG	9/27/2019	Ron Ingram
3	MPG	9/27/2019	Dale Mason

UNSPECIFIED TOLERANCES: (ALL DIM)
 DIM DECIMAL PLACE (X) .000
 DIM FRACTIONAL PLACE (X) 1/100
 DIM FRACTIONAL (X) 1/100
 ANGULAR ± .01



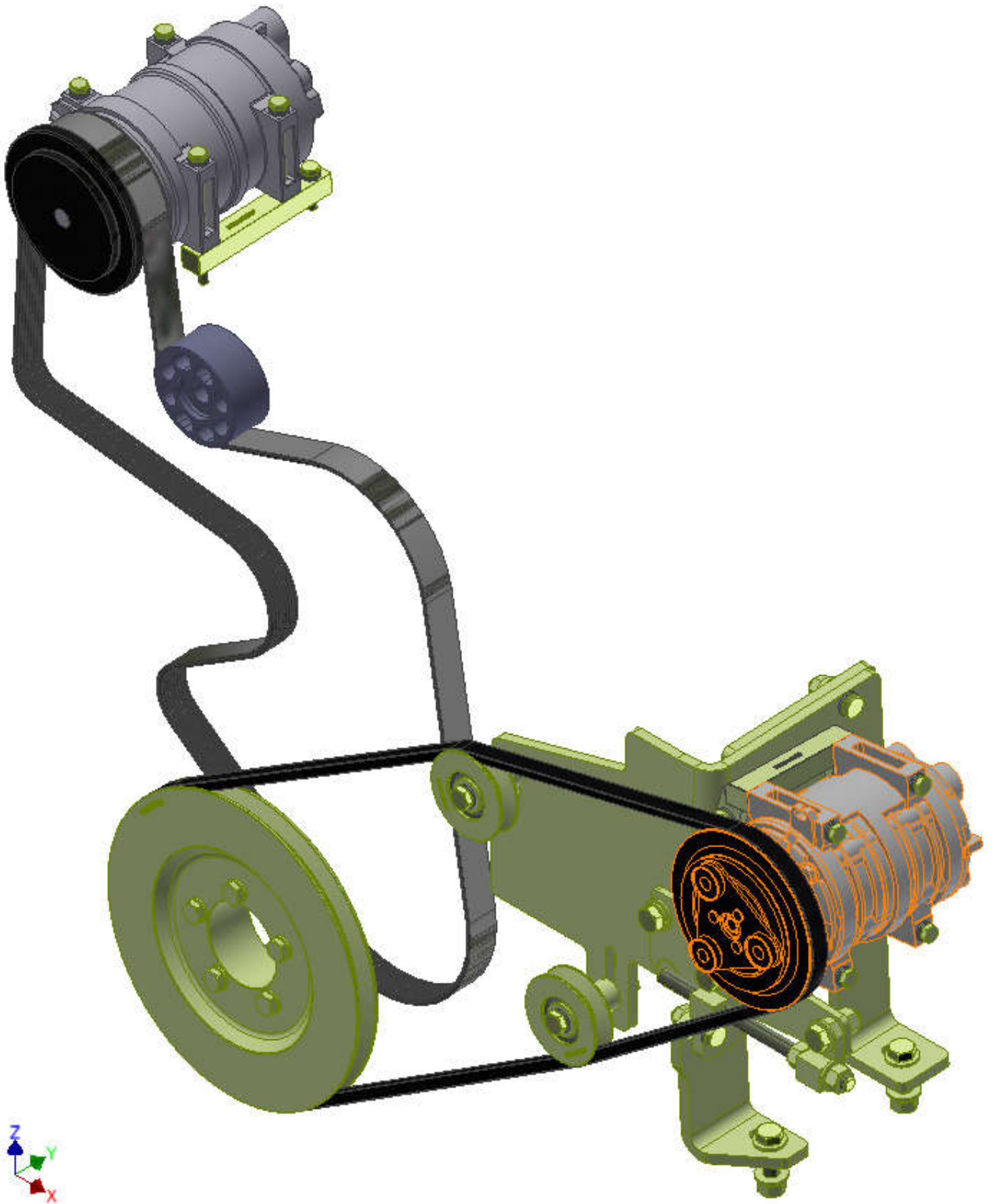

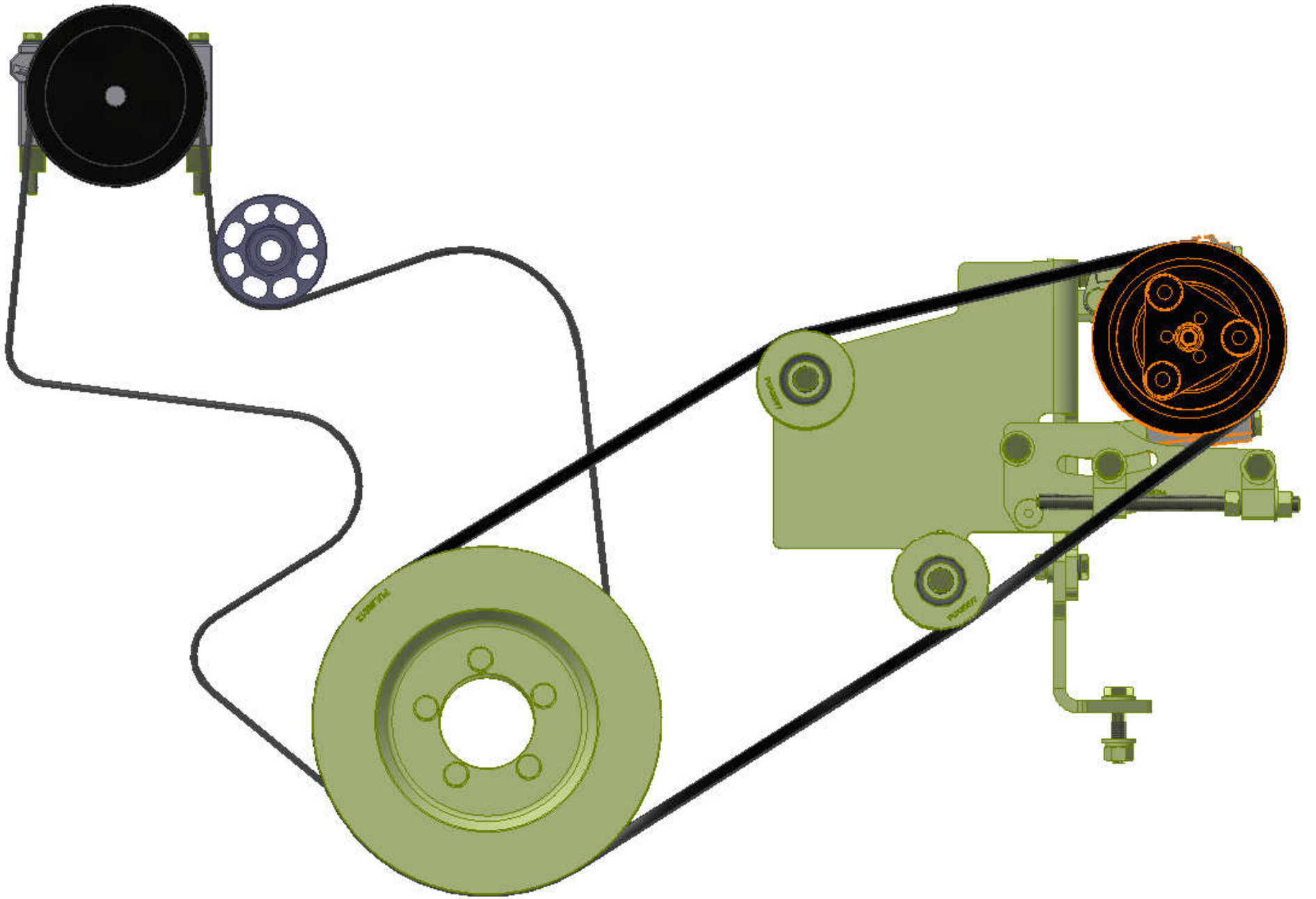

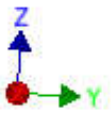
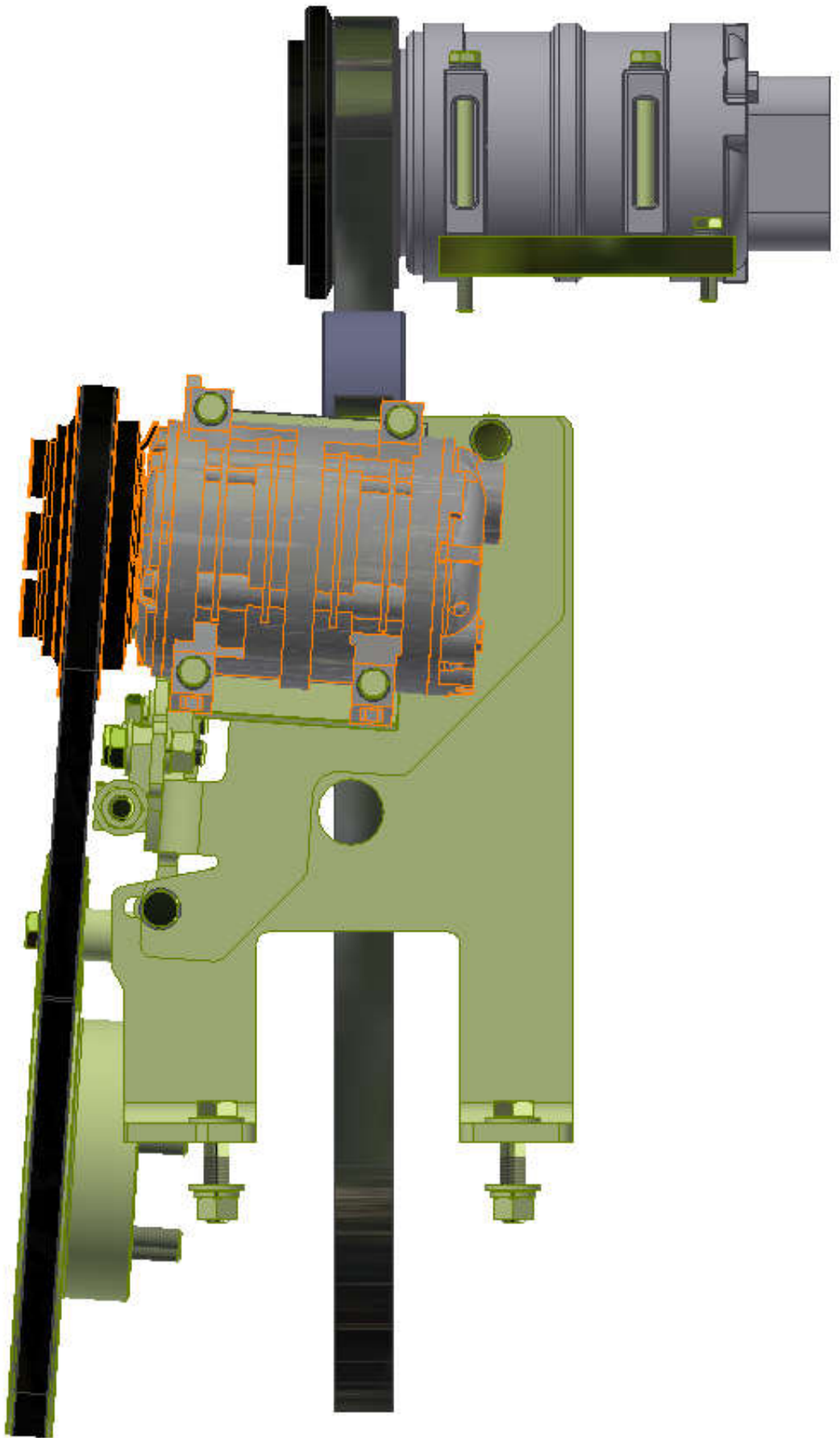

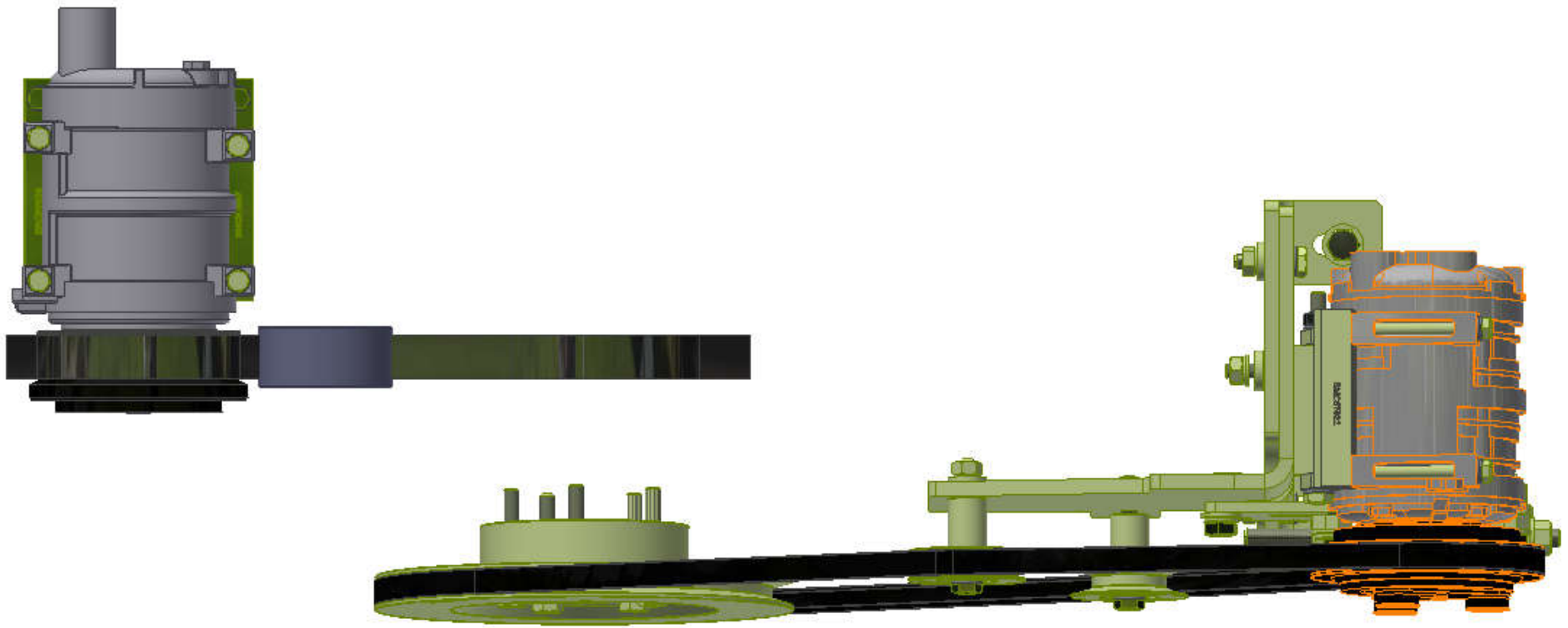

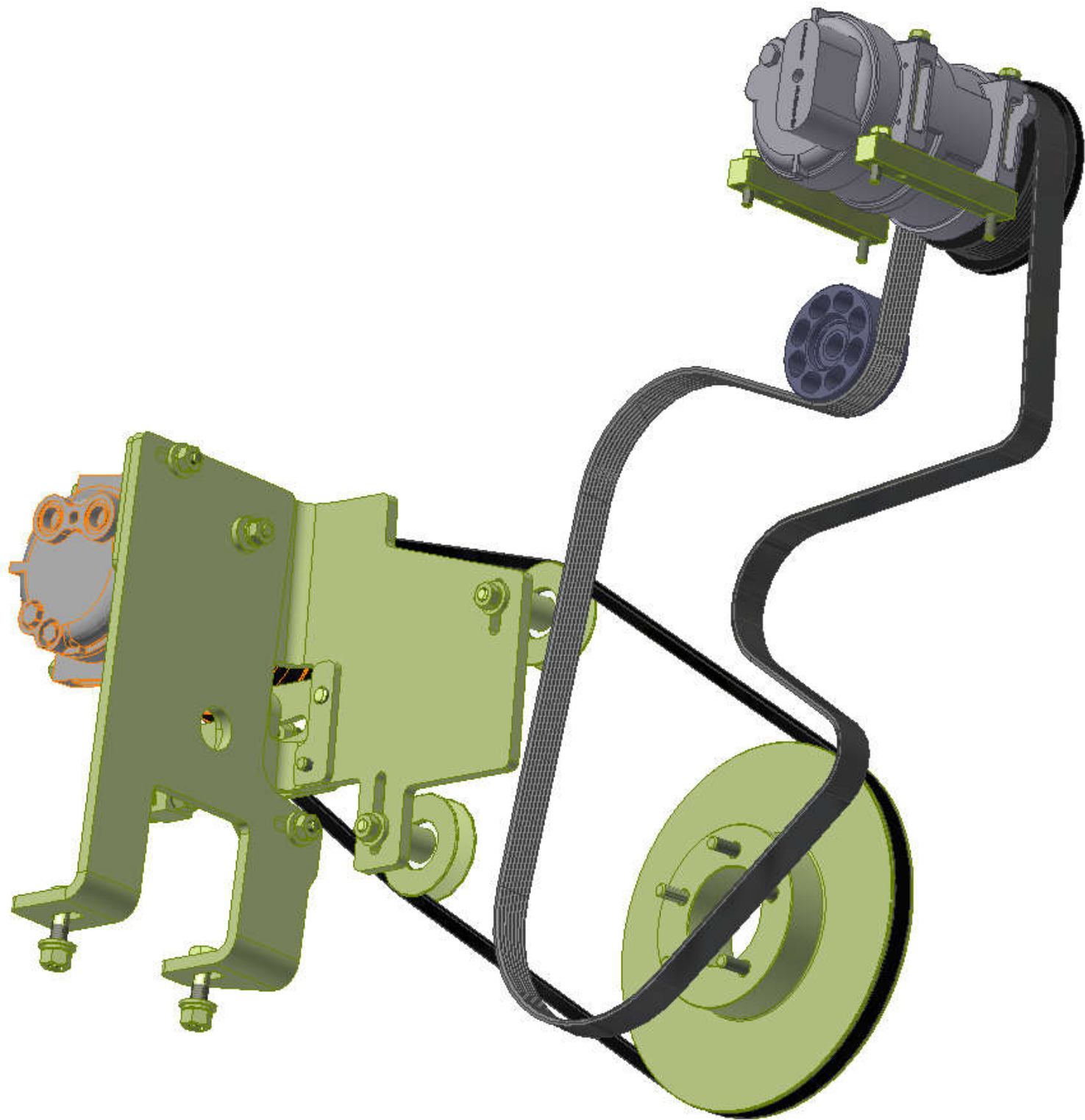

TransArctic A/C Compressor Mount Installation Disclaimer

All compressor mounts should be installed by qualified and trained personnel using proper tools and equipment in safe working conditions following industry standard guidelines for motor vehicle service and repair.

The installer of any compressor mount purchased from TransArctic must undertake all responsibility of issues arising from that compressor bracket being installed on any vehicle. As well as insure that a **proper and sufficient ground** is established between the compressors' clutches and the vehicle's engine. Mount functionality, operation and durability can all be compromised by an incompetent installation.

Due to the many different situations, parameters and application criteria, which are beyond the compressor mount manufacturer's control, TransArctic does not warrant design, durability, or operational functionality of any compressor mount improperly installed by another party.

With no implied guarantees it is the mount installer's strict responsibility to determine safety and functionality, of the compressor mount, at the time of installation.

Please contact TransArctic with any issue arising from installation so we may better improve the product. If you have any reservations about the compressor mount integrity contact TransArctic immediately at 1-877-COLD-AIR.

Mark OEM tensioner location

Install Kit

Check for Interferences

Check to ensure that the proper OEM tensioner orientation is maintained

Run engine with A/C system engaged for at least 10 minutes to run in belt

Check OEM tensioner orientation and adjust as required

Responsabilidad limitada de TransArctic en la instalación del soporte del compresor

Todos los soportes de los compresores deben ser instalados por personas calificadas y entrenadas, usando para ello los equipos y herramientas necesarios para esta labor en buenas condiciones y según las normas y guías para el servicio y/o reparación de motores de vehículos.

El instalador de los soportes comprados en TransArctic asume toda la responsabilidad de cualquier problema que surja en el soporte del compresor al vehículo; de igual manera es responsable que el cable a tierra sea conectado entre el embrague del compresor y el motor del vehículo.

Se advierte que el buen funcionamiento y la durabilidad del soporte pueden ser comprometidos por defectos en su instalación.

Debido a las diversas situaciones que se puedan presentar fuera del control del fabricante, TransArctic no garantiza el diseño, la durabilidad o el correcto funcionamiento de cualquier equipo inapropiadamente instalado por terceros.

Esta sobreentendido que el Instalador del montaje del compresor es estrictamente responsable de la seguridad y funcionamiento del equipo en el momento de la instalación.

Si tuviera algún problema o duda acerca de la instalación del soporte del compresor pongase en contacto inmediatamente con TransArctic al teléfono 1-877-COLD-AIR de modo que podamos mejorar nuestro producto.

Note la ubicación del medidor de tensión OEM

Instale el equipo

Controlar si hay interferencias.

Asegurese que el medidor de tensión mantenga la orientación justa.

Encienda el motor por lo menos 10 minutos con el sistema A/C enganchado para que la correa corra

Controle la orientación justa del medidor de tensión y ajuste a las condiciones requeridas del fabricante