

Bill of Materials Listing

TransArctic Canada Inc.

10/30/2009

Page 1 of 1

Product Number		Description	Bin	Date	Weight	Uof M	Yield
Line	Component Prod#	Description		Unit	Qty		
KMN82530		Mt. Kit, MForce DT, RE300, F400, 07-08		10/11/2007	213.80		0
10	BEL22591	Belt, B gr, 2591mm (102") (BX99)		each	2		
20	BMN80041	Bkt, Main, Front PI, ICRE, 2007		each	1		
30	BMN80042	Bkt, Main, Rear PI, ICRE, 2007		each	1		
40	BMN80008	Vibration Isolator, Bar, 16.50 x 2 x 1.50		each	2		
50	BMN80009	Bkt, Main, Base PI, IC, RE300		each	1		
70	BMN80025	Bkt, Back, PL, Slide, IC, RE300		each	1		
80	BMN80031	Bkt, Main, Slide, Assy, 05K, IC, RE300		each	1		
90	BMN80032	Bkt, Adapter, PL, IC, RE300		each	1		
100	BMN80043	Bkt, Spacer Plate, ICRE, 2007		each	1		
110	BMN80044	Bkt, Main Idler PI, ICRE, 2007		each	1		
124	BMN80057	Bkt, Comp, FRT, Bar, Bitzer, RE300		each	1		
127	BMN80058	Bkt, Comp, RR, Bar, Bitzer, RE300		each	1		
128	BMN80061	Bkt, Diag, Brace, IC, RE300, '07		each	1		
130	PUA06001	Pulley, Assy, Idler, B/S, 6", Stl, Plt		each	1		
140	PUA05012	Pulley, Assy, Idler, B/BX gr, 5", STL, Plt		each	1		
150	PUL76022	Pulley, Crank, Nav DT, 7.6L, 2B/X, 8" DIA		each	1		
160	SLV17012	Sleeve, Pulley, 16.9o x 22.23mm x 12.32i		each	2		
170	SCD14912	Spacer, Col, Drl, 14.9 mm x 31.8o x 12.3i		each	2		
200	KBN82530	Bag Kit, Fasteners, KMN82530		each	1		

Bill of Materials Listing

TransArctic Canada Inc.

3/11/2009

Page 1 of 1

Product Number	Description	Date	Weight	Uof M	Yield
Line Component Prod#	Description	Bin Unit	Qty		
KBN82530	Bag Kit, Fasteners, KMN82530	9/27/2007	7.69		0
10 BTC12100	Bolt, Hex, 12 x 1.75 x 100mm, 10.9, Plt	each	1		
20 BTC12070	Bolt, Hex, 12 x 1.75 x 70mm, 10.9, Plt	each	3		
40 BTC10050	Bolt, Hex, 10 x 1.5 x 50mm, 10.9, Plt	each	6		
50 BTC10040	Bolt, Hex, 10 x 1.5 x 40mm, 10.9, Plt,FT	each	4		
60 BTQ12250	Bolt, Hex, 3/4- 10unc, 2.50", 8, Plt	each	1		
70 BTQ10301	Bolt, Hex, 5/8-18unf, 3", 8, PLT	each	2		
80 BTQ08451	Bolt, Hex, 1/2-20unc, 4.5", 8, Plt	each	1		
90 BTQ08301	Bolt, Hex, 1/2-20unf, 3", 8, Plt	each	1		
100 BTQ08200	Bolt, Hex, 1/2-13unc, 2.0", 8, Plt	each	1		
105 BTQ08201	Bolt, Hex, 1/2-20unc, 2.0", 8, Plt	each	2		
110 BTQ08126	Bolt, Hex, 1/2-20unf, 1.25", 8, Plt	each	11		
115 BTQ08151	Bolt, Hex, 1/2-20unf, 1.5", 8, Plt	each	1		
120 BTQ10250	Bolt, Hex, 5/8-11unc, 2.5", 8, PLT	each	1		
130 BTP08653	Bolt, Hex, 1/2-13unc, 6.5", 5, Plt, FT	each	1		
135 CSF10066	Capscrew, FH, 10 x 1.5 x 65mm, 10.9,Plt	each	2		
140 CSF10031	Capscrew, FH, 10 x 1.5 x 30mm, 10.9,Plt	each	2		
145 CSF08150	Capscrew, FH, 1/2-13 x 1.50", Alloy, Plt	each	2		
147 CSF08300	Capscrew, FH, 1/2-13 x 3", Alloy, Plt	each	2		
150 NTA12000	Nut, Hex, 12 x 1.75, 8.8, Plt	each	4		
160 NTA10000	Nut, Hex, 10 x 1.5, 8.8, Plt	each	4		
165 NTL10000	Nut, Lock, Hex, 5/8-11unc, 9, Plt	each	1		
170 NTP12000	Nut, Hex, 3/4-10unc, 5, Plt	each	1		
180 NTP08000	Nut, Hex, 1/2-13unc, 5, Plt	each	5		
190 NTP07000	Nut, Hex, 7/16-14unc, 5, Plt	each	4		
200 WFA12000	Washer, Flat, 12mm, 8.8, Plt	each	4		
210 WFA10000	Washer, Flat, 10mm, 8.8, Plt	each	14		
220 WFQ12000	Washer, Flat, 3/4", 8, Plt	each	2		
225 WFQ10000	Washer, Flat, 5/8", 8, Plt	each	4		
230 WFQ08000	Washer, Flat, 1/2", 8, Plt	each	22		
240 WFN07000	Washer, Flat, 7/16", 2, Plt	each	4		
260 WLA12000	Washer, Lock, 12mm, 8.8, Plt	each	4		
270 WLA10000	Washer, Lock, 10mm, 8.8, Plt	each	4		
280 WLP12000	Washer, Lock, 3/4", 5, Plt	each	1		
290 WLP08000	Washer, Lock, 1/2", 5, Plt	each	18		
300 WLP07000	Washer, Lock, 7/16", 5, Plt	each	4		
310 WLQ10000	Washer, Lock, 5/8", 8, Plt	each	1		

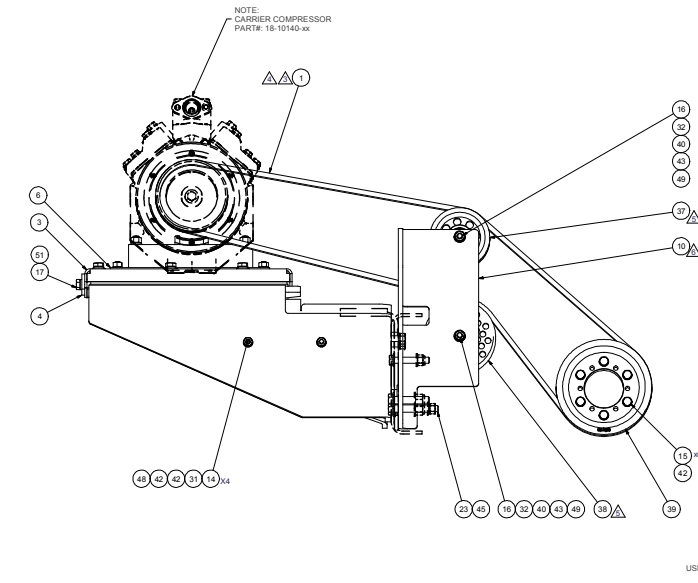
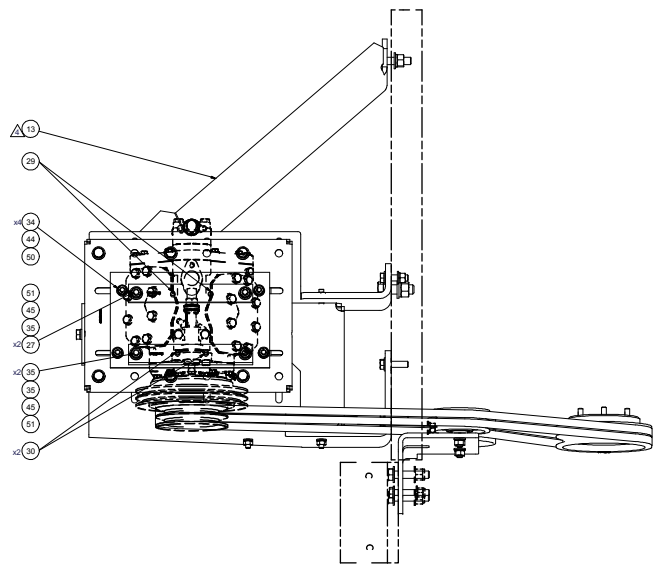

USE EXISTING LOCK NUT,
(TYPICAL 6-PLCS.)

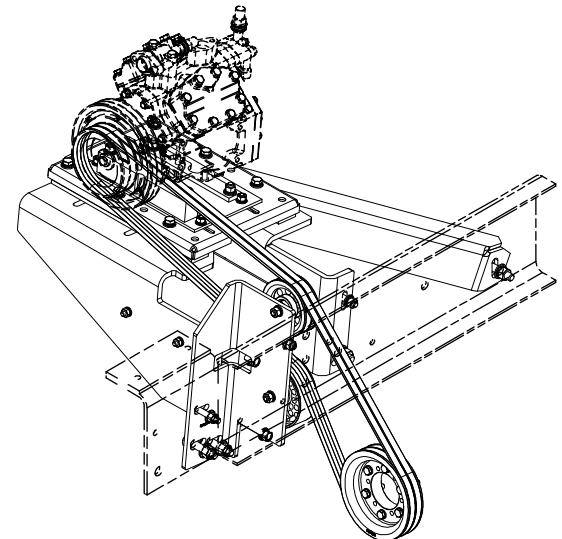
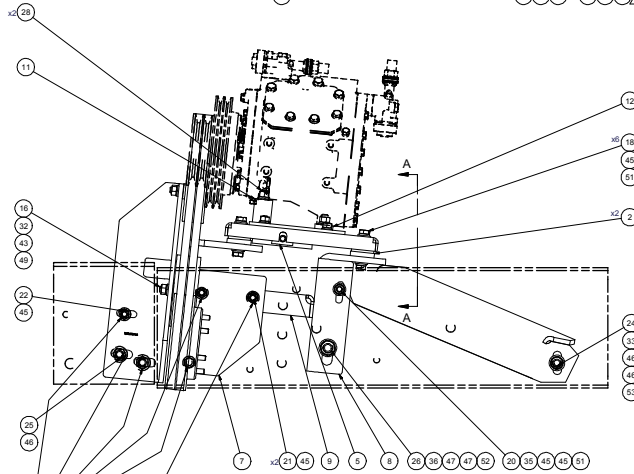
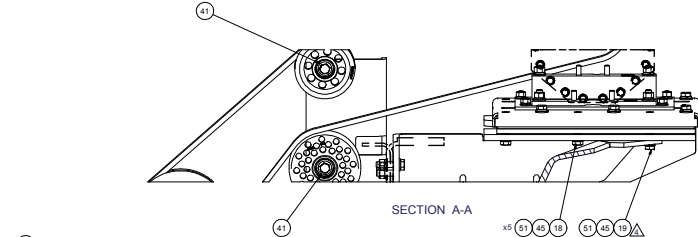

- NOTES:
1) USE SERVICABLE THREADLOCKER ON ALL FASTENERS TO ENGINE COMPONENTS AND TORQUE ALL BOLTS TO S.A.E. SPECIFICATIONS.
2) SEE "TRANSARCTIC A/C COMPRESSOR MOUNT INSTALLATION DISCLAIMER"

QTY	ITEM	UOM	PART NUMBER	DESCRIPTION
53	1	EACH	WLQ10000	WASHER LOCK, 8/8", 8, PLT
52	1	EACH	WLP12000	WASHER LOCK, 3/4", 5, PLT
51	18	EACH	WLP09000	WASHER LOCK, 1/2", 5, PLT
50	4	EACH	WLP01000	WASHER LOCK, 7/16", 5, PLT
49	2	EACH	WLA12000	WASHER LOCK, 12mm, 8.8, PLT
48	4	EACH	WLA10000	WASHER LOCK, 10mm, 8.8, PLT
47	2	EACH	WFO10000	WASHER FLAT, 3/4", 5, PLT
46	4	EACH	WFO10000	WASHER FLAT, 5/8", 8, PLT
45	22	EACH	WFO08000	WASHER FLAT, 1/2", 8, PLT
44	4	EACH	WFO10000	WASHER FLAT, 7/16", 2, PLT
43	2	EACH	WFA10000	WASHER FLAT, 12mm, 8.8, PLT
42	14	EACH	WFA10000	WASHER FLAT, 10mm, 8.8, PLT
41	2	EACH	SLV17012	SLEEVE, PULLEY, 16.86 x 22.23mm x12.18
40	2	EACH	SCD18915	SPACER, COIL, DIA. 14.8mm x 31.80 x 12.08
39	1	EACH	PUL16022	PULLEY, CRANK, NAV DT, 7.6, 2B/X, 8" DIA
38	1	EACH	PJA08001	PULLEY ASSY, IDLER, B/S, 6" STL, PLT
37	1	EACH	PJA05012	PULLEY ASSY, IDLER, B/S, 6" STL, PLT
36	1	EACH	NTP12000	NUT, HEX, 3/4-10UNC, 5, PLT
35	5	EACH	NTP08000	NUT, HEX, 1/2-13UNC, 5, PLT
34	4	EACH	NTP01000	NUT, HEX, 7/16-14UNC, 5, PLT
33	1	EACH	NTL10000	NUT, LOCK, HEX, 5/8-11UNC, 9, PLT
32	2	EACH	NTA12000	NUT, HEX, 12 x 1.75, 8.8, PLT
31	4	EACH	NTA10000	NUT, HEX, 10 x 1.5, 8.8, PLT
30	2	EACH	CSF10066	CAPSCREW, FH, 10 x 1.5 x 65mm, 10.9, PLT
29	2	EACH	CSF10031	CAPSCREW, FH, 10 x 1.5 x 30mm, 10.9, PLT
28	2	EACH	CSF08009	CAPSCREW, FH, 3/8-18 x 2", 8, PLT
27	2	EACH	CSF08150	CAPSCREW, FH, 3/8-18 x 1.5", 9, PLT
26	1	EACH	BT012250	BOLT, HEX, 3/4-10UNC, 2.50", 8, PLT
25	2	EACH	BT010031	BOLT, HEX, 5/8-18UNC x 3.00, 8, PLT
24	1	EACH	BT010250	BOLT, HEX, 5/8-11UNC, 2.50", 8, PLT
23	1	EACH	BT088451	BOLT, HEX, 1/2-20UNC x 4.50, 8, PLT
22	1	EACH	BT080391	BOLT, HEX, 1/2-20UNC x 3.00, 8, PLT
21	2	EACH	BT080201	BOLT, HEX, 1/2-20UNC x 2.00, 8, PLT
20	1	EACH	BT080200	BOLT, HEX, 1/2-13UNC x 2.00, 8, PLT
19	1	EACH	BT060151	BOLT, HEX, 1/2-20UNC x 1.50, 8, PLT
18	11	EACH	BT050125	BOLT, HEX, 1/2-20UNC x 1.25, 8, PLT
17	1	EACH	BT096553	BOLT, HEX, 1/2-13UNC x 6.50, 5, PLT, FT
16	2	EACH	BT012070	BOLT, HEX, 1/2 x 1.75 x 70mm, 10.9, PLT
15	6	EACH	BT010050	BOLT, HEX, 10 x 1.5 x 50mm, 10.9, PLT
14	4	EACH	BT010040	BOLT, HEX, 10 x 1.5 x 40mm, 10.9, PLT
13	1	EACH	BMN80061	BKT, DIAG, BRACE, RE300, 07
12	1	EACH	BMN80058	BKT, COMP, FR BAR, BITZER, RE300
11	1	EACH	BMN80057	BKT, COMP, FRT BAR, BITZER, RE300
10	1	EACH	BMN80044	BKT, MAIN, IDLER PL, ICRE, 2007
9	1	EACH	BMN80043	BKT, SPACER PLATE, ICRE, 2007
8	1	EACH	BMN80042	BKT, MAIN, REAR PL, ICRE, 2007
7	1	EACH	BMN80041	BKT, MAIN, FRONT PL, ICRE, 2007
6	1	EACH	BMN80032	BKT, ADAPTER PL, IC, RE300
5	1	EACH	BMN80031	BKT, MAIN, SLIDE ASSY, 6SK, IC, RE300
4	1	EACH	BMN80025	BKT, BACK, PL, SLIDE, IC, RE300
3	1	EACH	BMN80008	BKT, MAIN, BASE PL, IC, RE300
2	2	EACH	BMN80008	VIBRATION ISOLATOR, BAR, 16.50 x 2 x 1.50
1	2	EACH	BEL22591	BELT, B gr, 2591mm (102") (BX99)

REV	DESCRIPTION	DATE	BY	APP	DATE	REV	DESCRIPTION
1	ISSUED FOR PRODUCTION	14/2/2008	James Stewart	OK	14/2/2008	1	ISSUED FOR PRODUCTION
2	ISSUED FOR PRODUCTION	01/04/08	James Stewart	OK	01/04/08	2	ISSUED FOR PRODUCTION
3	ISSUED FOR PRODUCTION	14/2/2008	Flon Ingram	APPROVED	14/2/2008	3	ISSUED FOR PRODUCTION
4	ISSUED FOR PRODUCTION	14/2/2008	Date Mason	APPROVED	14/2/2008	4	ISSUED FOR PRODUCTION

DATE: 14/2/2008
TIME: 14:20:00
USER: jstewart

TRANSARCTIC INC.
MT KIT, MFORCE DT, RE300, F400, '07
KMN82530

DWG NO: KMN82530
SCALE: 1:1
SHEET: 1 OF 1

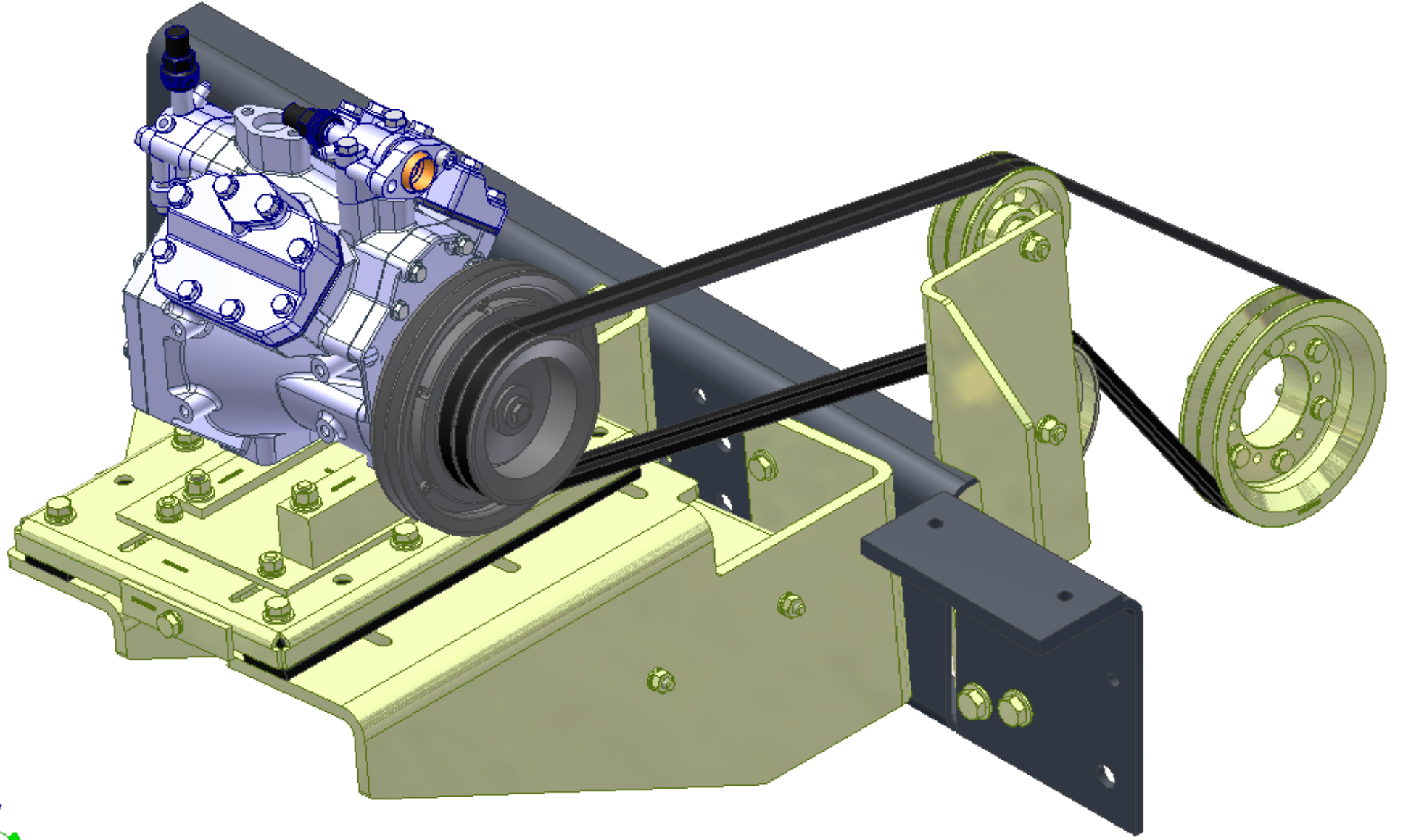

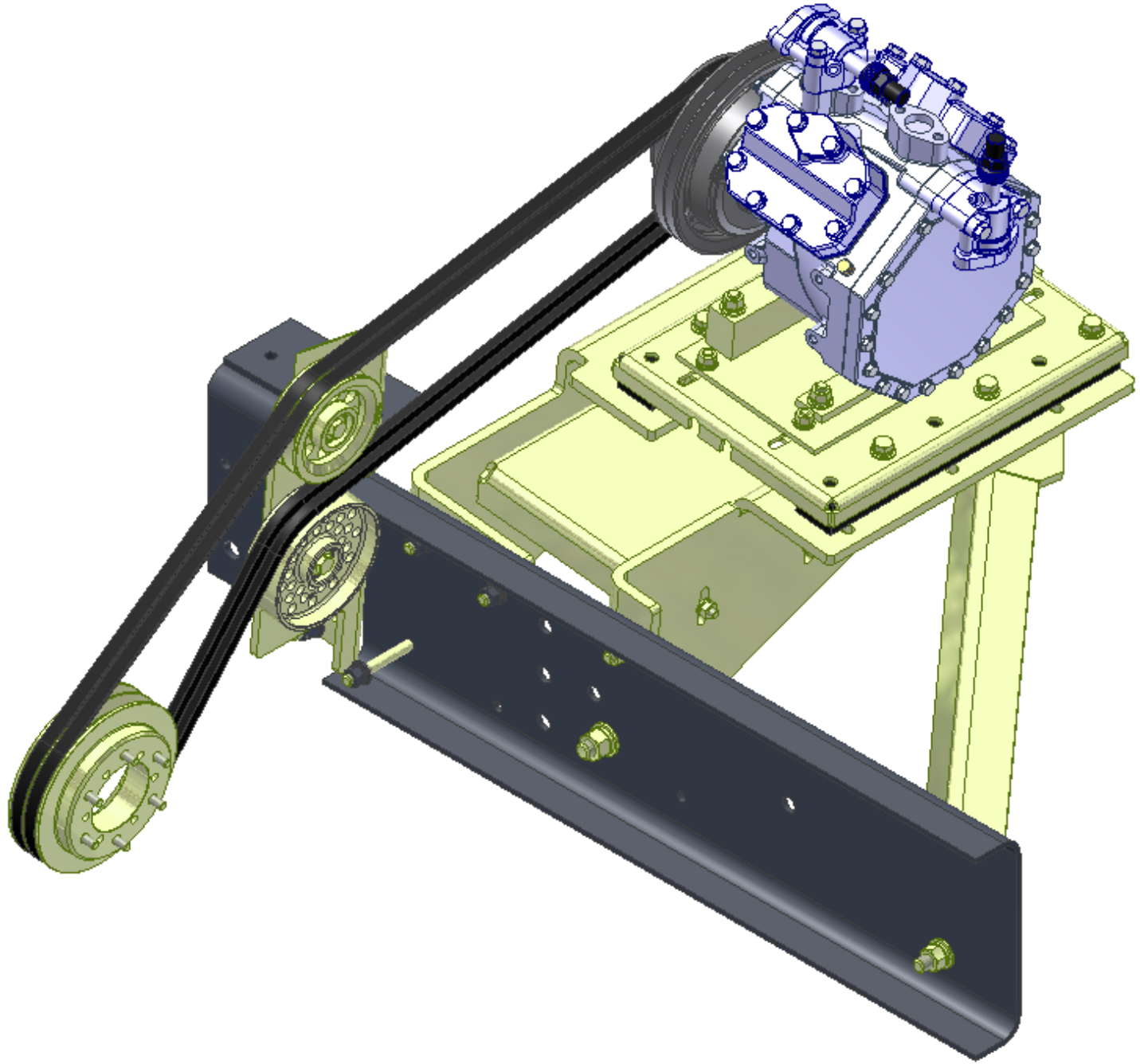

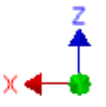
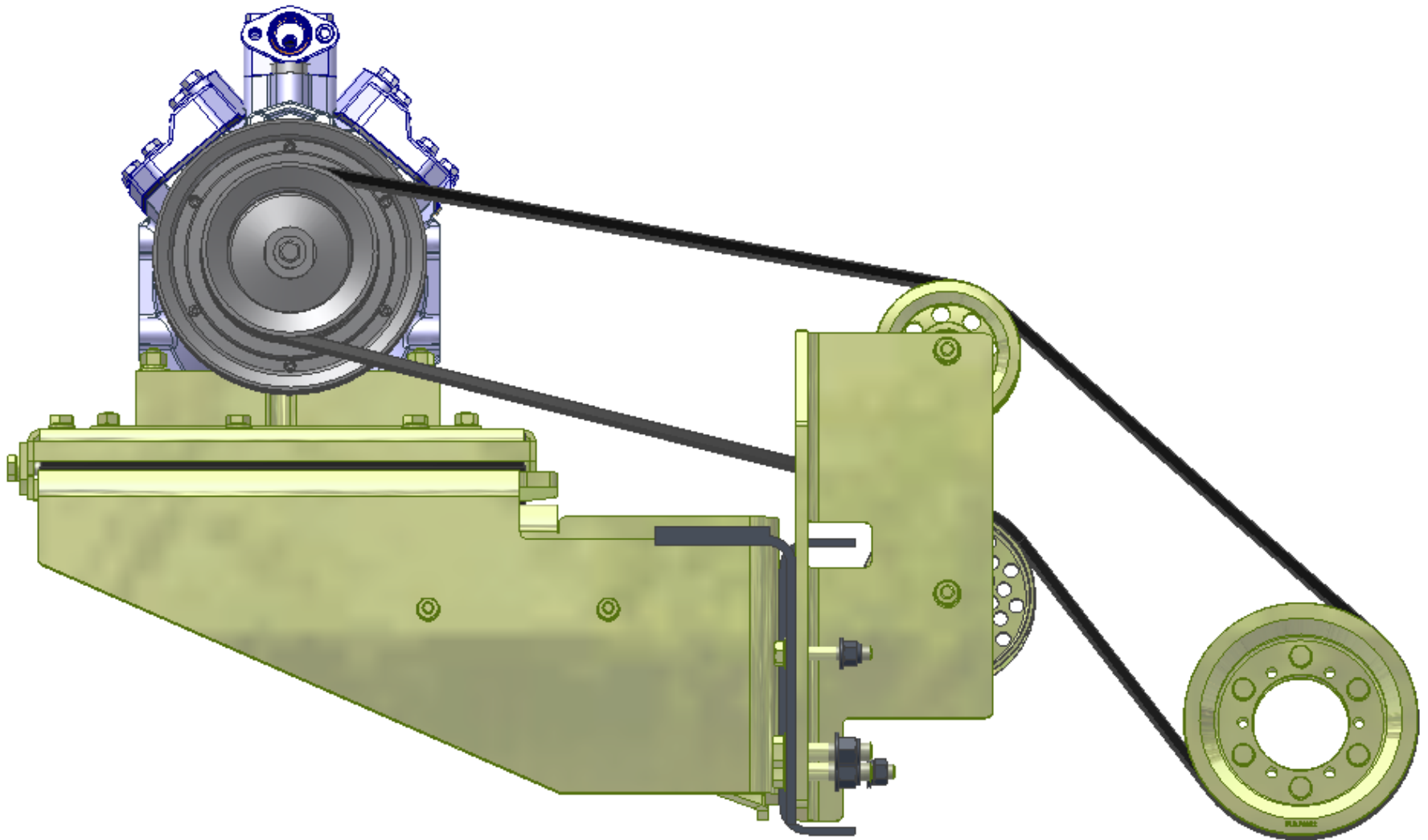

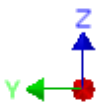
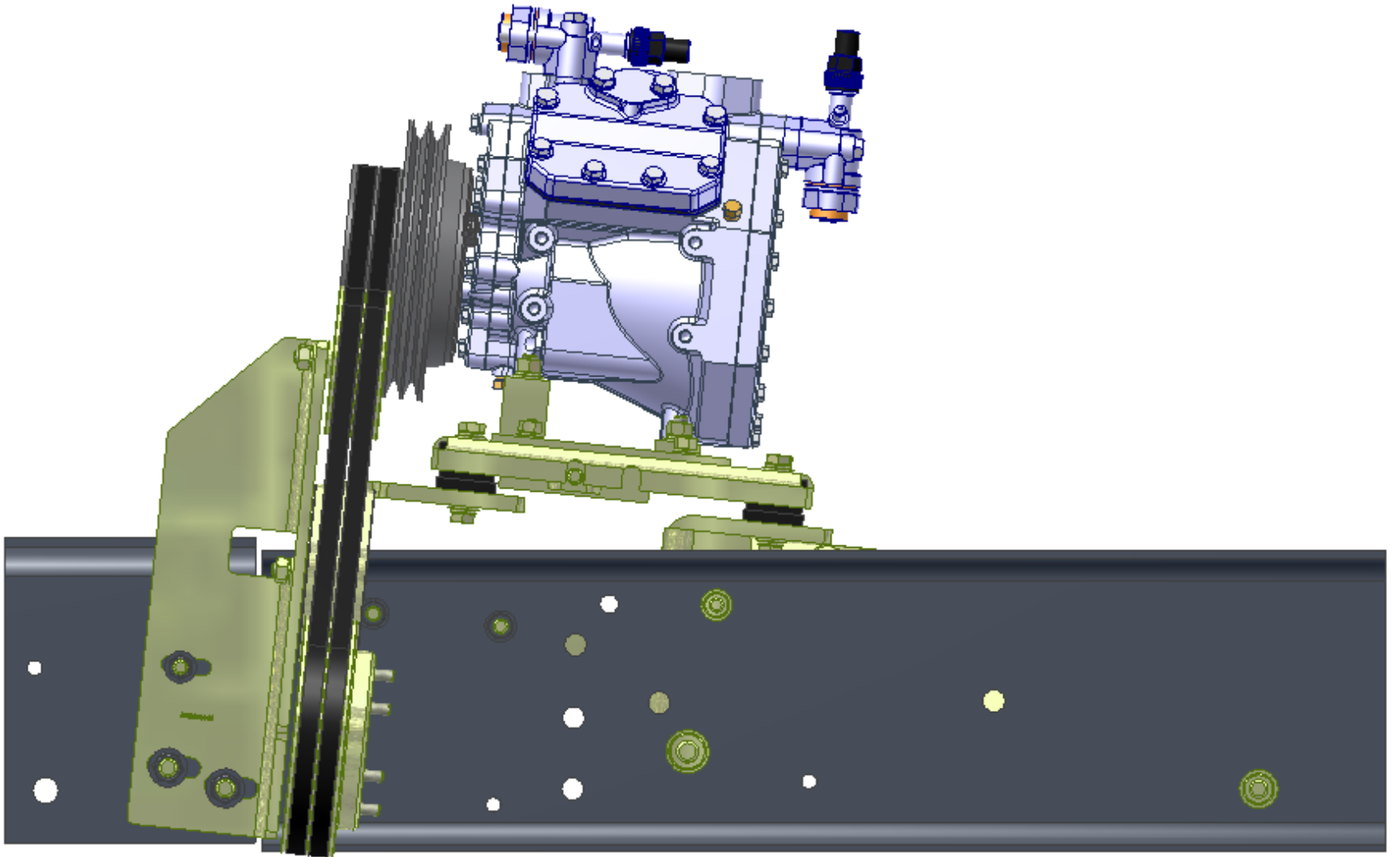

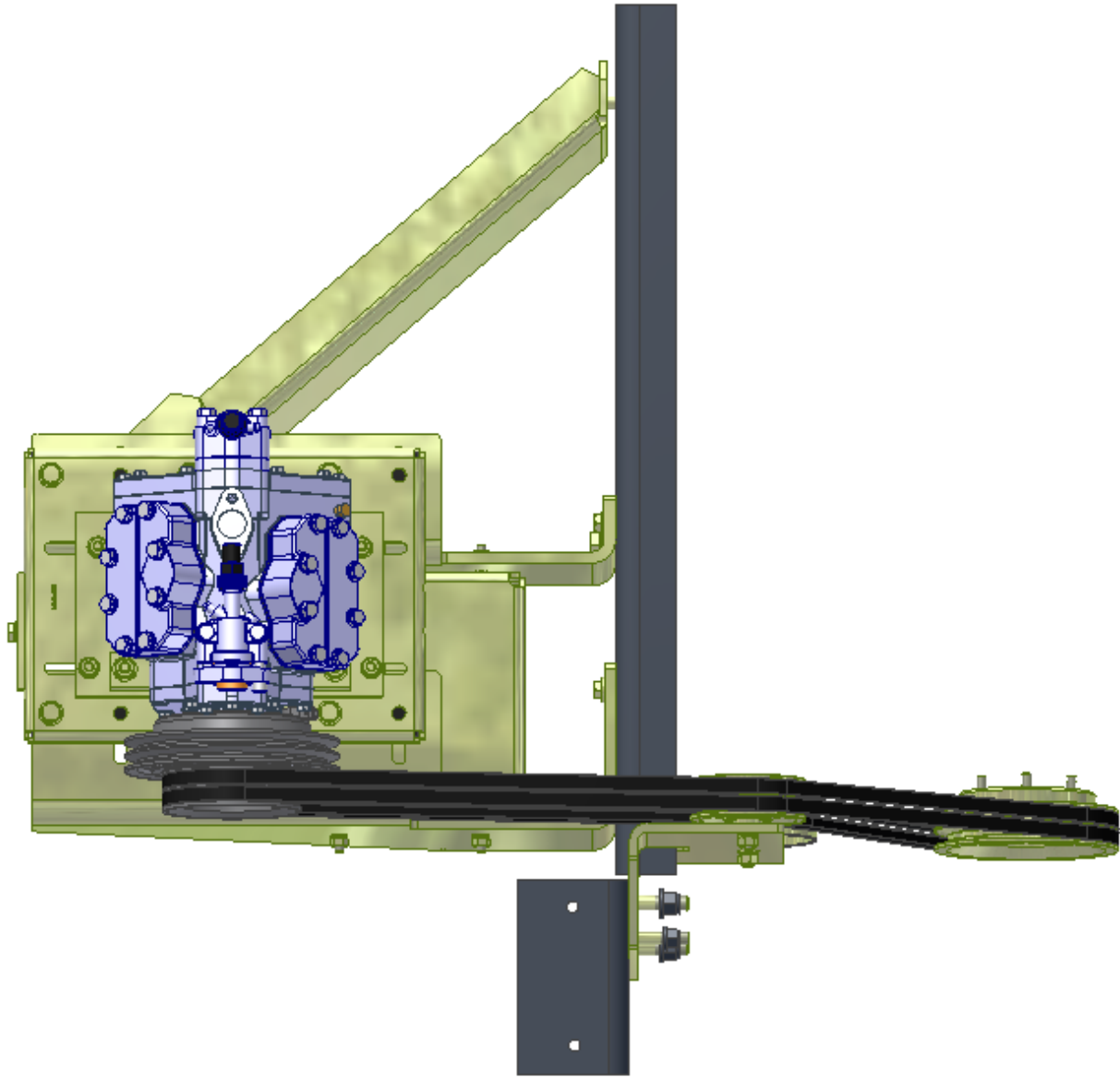

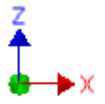
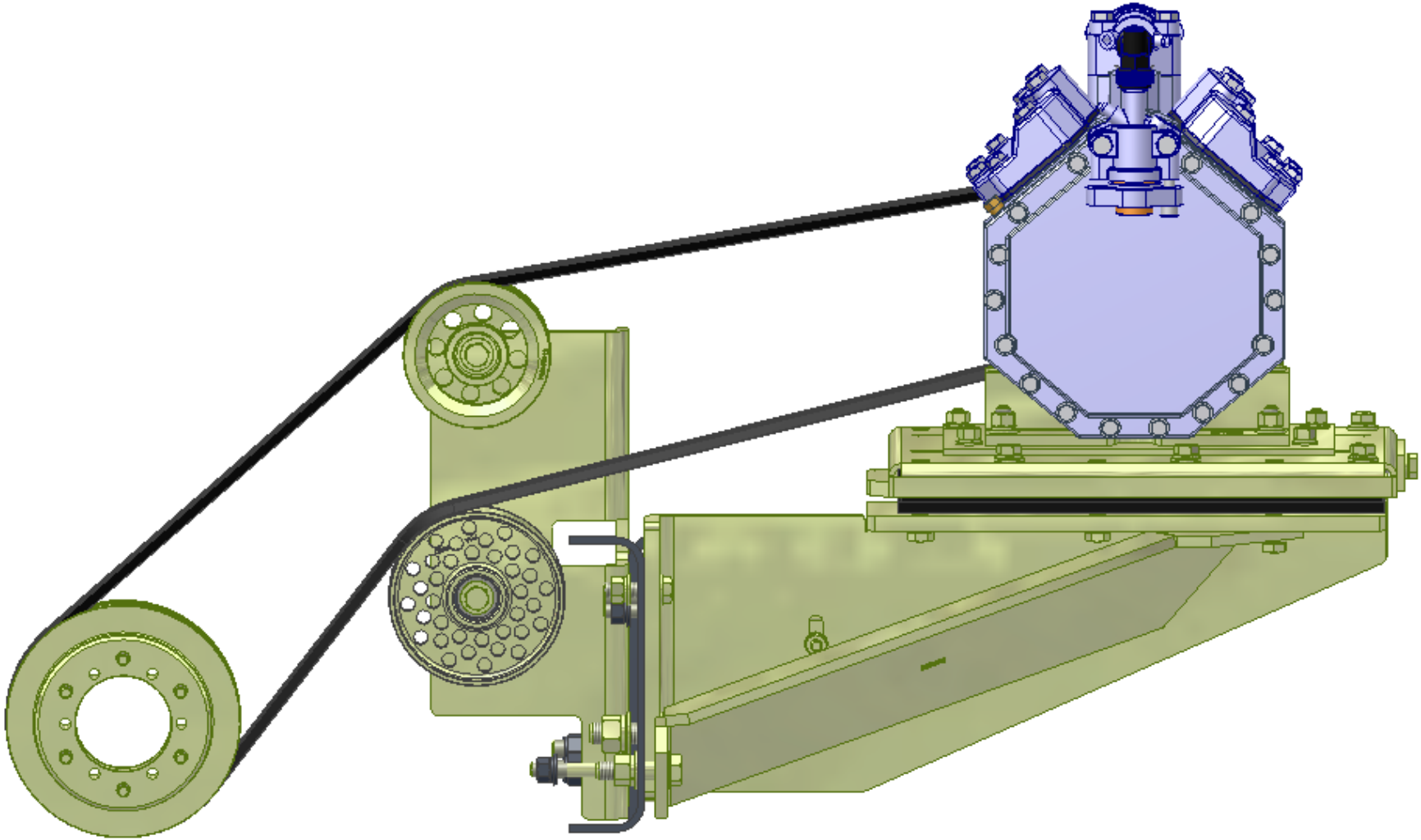

TransArctic A/C Compressor Mount Installation Disclaimer

All compressor mounts should be installed by qualified and trained personnel using proper tools and equipment in safe working conditions following industry standard guidelines for motor vehicle service and repair.

The installer of any compressor mount purchased from TransArctic must undertake all responsibility of issues arising from that compressor bracket being installed on any vehicle. As well as insure that a **proper and sufficient ground** is established between the compressors' clutches and the vehicle's engine. Mount functionality, operation and durability can all be compromised by an incompetent installation.

Due to the many different situations, parameters and application criteria, which are beyond the compressor mount manufacturer's control, TransArctic does not warrant design, durability, or operational functionality of any compressor mount improperly installed by another party.

With no implied guarantees it is the mount installer's strict responsibility to determine safety and functionality, of the compressor mount, at the time of installation.

Please contact TransArctic with any issue arising from installation so we may better improve the product. If you have any reservations about the compressor mount integrity contact TransArctic immediately at 1-877-COLD-AIR.

Mark OEM tensioner location

Install Kit

Check for Interferences

Check to ensure that the proper OEM tensioner orientation is maintained

Run engine with A/C system engaged for at least 10 minutes to run in belt

Check OEM tensioner orientation and adjust as required

Responsabilidad limitada de TransArctic en la instalación del soporte del compresor

Todos los soportes de los compresores deben ser instalados por personas calificadas y entrenadas, usando para ello los equipos y herramientas necesarios para esta labor en buenas condiciones y según las normas y guías para el servicio y/o reparación de motores de vehículos.

El instalador de los soportes comprados en TransArctic asume toda la responsabilidad de cualquier problema que surja en el soporte del compresor al vehículo; de igual manera es responsable que el cable a tierra sea conectado entre el embrague del compresor y el motor del vehículo.

Se advierte que el buen funcionamiento y la durabilidad del soporte pueden ser comprometidos por defectos en su instalación.

Debido a las diversas situaciones que se puedan presentar fuera del control del fabricante, TransArctic no garantiza el diseño, la durabilidad o el correcto funcionamiento de cualquier equipo inapropiadamente instalado por terceros.

Esta sobreentendido que el Instalador del montaje del compresor es estrictamente responsable de la seguridad y funcionamiento del equipo en el momento de la instalación.

Si tuviera algún problema o duda acerca de la instalación del soporte del compresor pongase en contacto inmediatamente con TransArctic al teléfono 1-877-COLD-AIR de modo que podamos mejorar nuestro producto.

Note la ubicación del medidor de tensión OEM

Instale el equipo

Controlar si hay interferencias.

Asegure que el medidor de tensión mantenga la orientación justa.

Encienda el motor por lo menos 10 minutos con el sistema A/C enganchado para que la correa corra

Controle la orientación justa del medidor de tensión y ajuste a las condiciones requeridas del fabricante