

Bill of Materials Listing

TransArctic Canada Inc.

4/23/2018
Page 1 of 1

Product Number		Description	Rev#	Date	Weight	Uof M	Yield
Line	Component Prod#	Description	Bin	Unit	Qty		
KMC96594		Mt Kit, ISL-D, 2013, HDX, TM-65, 12V,'13	0	4/23/2018	147.14		0
10	BEL32389	Belt, Banded B gr, 2388mm (94")		each	1		
20	BMC83123	Bkt, Main, Idler, Weldm't, ISL, HDX, '13		each	1		
30	BMC83125	Bkt, Weldm't, Adapter Pl, ISL, HDX, '13		each	1		
40	BMC83129	Bkt, Weldm't, Main Base, ISL, HDX, '13		each	1		
50	BMN80008	Vibration Isolator, Bar,16.50 x 2 x 1.50		each	2		
60	BMN80025	Bkt, Back, PL, Slide, IC, RE300		each	1		
70	BMZ00043	Bkt, Main, Base Pl, '13		each	1		
80	KBT65501	Kit, Platform, P/S, TM-55/65, '16		each	1		
90	KPC89022	Kit, Pulley, ISL, 8.9L, 2B/X,'13		each	1		
100	PUA05012	Pulley, Assy, Idler,B/BX gr,5", STL,Plt		each	1		
110	PUL80074	Pulley, Idler, B/S, Wide, 76d (89102)		each	1		
120	SCD46012	Spacer, Col, Drl, 46mm x 31.8o x 12.0i		each	1		
130	SCD49512	Spacer, Col, Drl, 49.48mmx 25.4o x 12.3i		each	1		
140	SLV17012	Sleeve, Pulley, 16.9o x 22.23mm x 12.32i		each	2		
150	KBC66594	Bag Kit, Fasteners, KMC66595		each	1		

Bill of Materials Listing

TransArctic Canada Inc.

12/20/2016
Page 1 of 1

Product Number	Description	Date	Weight	Uof M	Yield
Line	Component Prod#	Bin	Unit	Qty	
KBC66594	Bag Kit, Fasteners, KMC66594 & KMC66595	11/21/2016	3.32		0
10	BTC10035		Bolt, Hex, 10 x 1.5 x 35mm, 10.9, Plt,FT	each	3
20	BTC12100		Bolt, Hex, 12 x 1.75 x 100mm, 10.9, Plt	each	2
30	BTP08653		Bolt, Hex, 1/2-13unc, 6.5", 5, Plt, FT	each	1
40	BTQ06125		Bolt, Hex, 3/8-16unc, 1.25", 8, Plt	each	5
50	BTQ08101		Bolt, Hex, 1/2-20unf, 1.00", 8, Plt	each	4
60	BTQ08125		Bolt, Hex, 1/2-13unc, 1.25", 8, Plt	each	2
70	BTQ08151		Bolt, Hex, 1/2-20unf, 1.5", 8, Plt	each	2
80	CSF08076		Capscrew, FH, 1/2-20unf x .75",Alloy,Plt	each	2
90	CSF08101		Capscrew, FH, 1/2-20unf x 1.0",Alloy,Plt	each	4
100	NTA10000		Nut, Hex, 10 x 1.5, 8.8, Plt	each	3
110	NTA12000		Nut, Hex, 12 x 1.75, 8.8, Plt	each	2
120	NTQ06000		Nut, Hex, 3/8-16unc, 8, Plt	each	5
130	WFA10002		Washer, Flat, 10mm, Hvy, 8.8, Plt	each	6
140	WFA12002		Washer, Flat, 12mm, Hvy, 8.8, Plt	each	2
150	WFQ08000		Washer, Flat, 1/2", 8, Plt	each	8
160	WFS06002		Washer, Flat, 3/8", L9, Plt	each	10
170	WLA10000		Washer, Lock, 10mm, 8.8, Plt	each	3
180	WLA12000		Washer, Lock, 12mm, 8.8, Plt	each	2
190	WLQ06000		Washer, Lock, 3/8", 8, Plt	each	5
200	WLQ08000		Washer, Lock, 1/2", 8, Plt	each	9

Bill of Materials Listing

TransArctic Canada Inc.

12/5/2016

Page 1 of 1

Product Number		Description	Bin	Date	Weight	Uof M	Yield
Line	Component	Prod#	Description	Unit	Qty		
KBT65501			Kit, Platform, P/S, TM-55/65, '16		8/10/2016	16.08	0
10	BMN80031		Bkt, Main, Slide, Assy, 05K, IC, RE300	each	1		
20	BMZ00056		Bkt, Comp, FRT, Z, TM-65/55, '13	each	1		
30	BMZ00057		Bkt, Comp, Rear, Z, TM-65/55, '13	each	1		
40	KBZ65501		Bag Kit, Fasteners, KBT65501	each	1		

Bill of Materials Listing

TransArctic Canada Inc.

10/31/2016
Page 1 of 1

Product Number	Description	Date	Weight	Uof M	Yield
Line Component Prod#	Description	Bin Unit	Qty		
KBZ65501	Bag Kit, Fasteners, KBT65501	8/10/2016	0.69		0
10	BTC12035				
	Bolt, Hex, 12 x 1.75 x 35mm, 10.9,Plt,FT	each	4		
20	NTP07000				
	Nut, Hex, 7/16-14unc, 5, Plt	each	4		
30	WFA12000				
	Washer, Flat, 12mm, 8.8, Plt	each	4		
40	WFN07000				
	Washer, Flat, 7/16", 2, Plt	each	4		
50	WLA12000				
	Washer, Lock, 12mm, 8.8, Plt	each	4		
60	WLQ07000				
	Washer, Lock, 7/16", 8, Plt	each	4		

Bill of Materials Listing

TransArctic Canada Inc.

4/23/2018

Page 1 of 1

Product Number		Description	Rev#	Date	Weight	Uof M	Yield
Line	Component Prod#	Description	Bin	Unit	Qty		
KPC89022		Kit, Pulley, ISL, 8.9L, 2B/X,'13	0	10/15/2013	11.51		0
10	PUL89022	Pulley, Crank, ISL, 8.9L, 2B/X, 8", '13		each	1		
20	BTC10050	Bolt, Hex, 10 x 1.5 x 50mm, 10.9, Plt		each	5		
30	WFA10000	Washer, Flat, 10mm, 8.8, Plt		each	5		

8 7 6 5 4 3 2 1

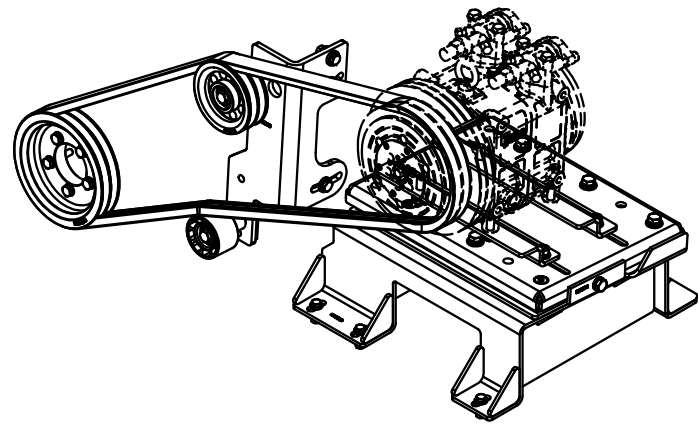
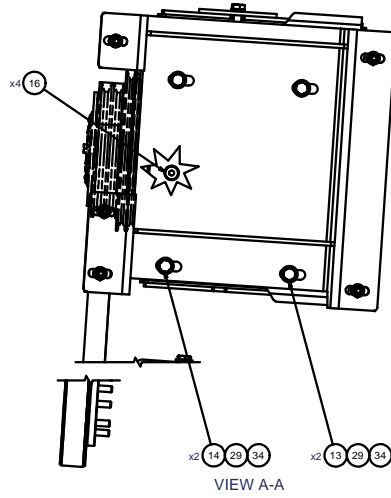
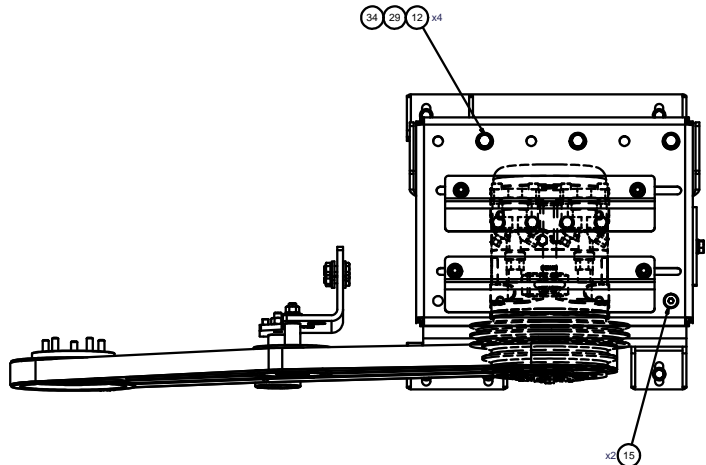

ISOMETRIC VIEW

NOTE:
SHOWING TRANSARCCTIC
COMPRESSOR PART#
CMV33643 (TM-55)
CMV38824 (TM-65)
AS REFERENCE.

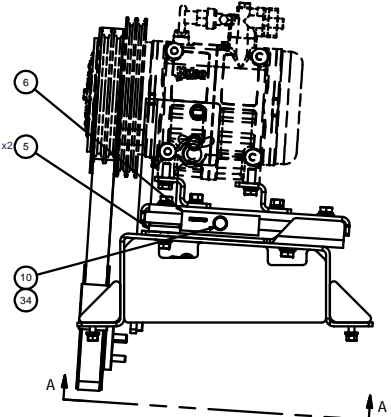
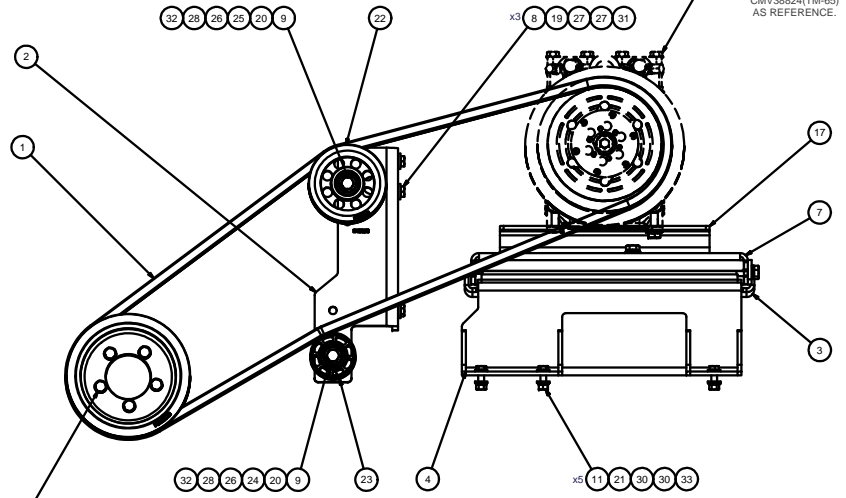

NOTE:
TORQUE TO: 48 FT-LB PLAIN & LUBRICATED W/ CLEAN ENGINE OIL (15W-40)
(HEXBOLT CAPSCREW M10 x 1.5 x 50mm)
TIGHTEN IN TWO STEPS IN A CRIS-CROSS TIGHTENING SEQUENCE PATTERN.

NOTES:
1) USE SERVICABLE THREADLOCKER ON ALL FASTENERS TO ENGINE COMPONENTS AND
TORQUE ALL BOLTS TO S.A.E. SPECIFICATIONS.
2) SEE 'TRANSARCCTIC A/C COMPRESSOR MOUNT INSTALLATION DISCLAIMER'.

ITEM	QTY	U/M	PART NUMBER	DESCRIPTION
34	9	EACH	WLO08000	WASHER, LOCK, 1/2", 8, PLT
33	5	EACH	WLO06000	WASHER, LOCK, 3/8", 8, PLT
32	2	EACH	WLA12000	WASHER, LOCK, 12mm, 8.8, PLT
31	3	EACH	WLA10000	WASHER, LOCK, 10mm, 8.8, PLT
30	10	EACH	WFS06002	WASHER, FLAT, 3/8", LV, PLT
29	8	EACH	WFO38000	WASHER, FLAT, 1/2", 8, PLT
28	2	EACH	WFA12002	WASHER, FLAT, 12mm, HVY, 8.8, PLT
27	6	EACH	WFA10002	WASHER, FLAT, 10mm, HVY, 8.8, PLT
26	2	EACH	SLV17012	SLEEVE, PULLEY, 16.9x x 22.23 mm x12.19
25	1	EACH	SCD49512	SPACER, COL, DRL, 49.48mm x 25.4x x 12.3
24	1	EACH	SCD46012	SPACER, COL, DRL, 46mm x 31.8x x 12.0
23	1	EACH	PUL80074	PULLEY, IDLER, BACKSIDE, P8, 74D, 46.27W
22	1	EACH	PUA05012	PULLEY, ASSY, IDLER, B/BX gr, 5" STL, PLT
21	5	EACH	NTQ06000	NUT, HEX, 3/8-16UNC, 8, PLT
20	2	EACH	NTA12000	NUT, HEX, 12 x 1.75, 8.8, PLT
19	3	EACH	NTA10000	NUT, HEX, 10 x 1.5, 8.8, PLT
18	1	EACH	KPC9022	KIT, PULLEY, ISL, 8.9L, 2BX, '13
17	1	EACH	KB165501	KIT, PLATFORM, P/S, TM-55/65, '16
16	4	EACH	CSF08101	CAPSCREW, FH, 1/2-20UNF x 1", ALLOY, PLT
15	2	EACH	CSF08076	CAPSCREW, FH, 1/2-20UNF x .75", ALLOY, PLT
14	2	EACH	BTO08151	BOLT, HEX, 1/2-20UNF x 1.50, 8, PLT
13	2	EACH	BTO08125	BOLT, HEX, 1/2-13UNC x 1.25, 8, PLT
12	4	EACH	BTO08101	BOLT, HEX, 1/2-20UNF x 1.00, 8, PLT
11	5	EACH	BTO08125	BOLT, HEX, 3/8-16UNC x 1.25, 8, PLT
10	1	EACH	BTP08653	BOLT, HEX, 1/2-13UNC x 6.50, 5, PLT, FT
9	2	EACH	BTC12110	BOLT, HEX, 12 x 1.75 x 110mm, 10.9, PLT
8	3	EACH	BTC10035	BOLT, HEX, 10 x 1.5 x 35mm, 10.9, PLT
7	1	EACH	BMZ00043	BKT, MAIN, BASE, PL, '13
6	1	EACH	BMN80025	BKT, BACK, PL, SLIDE, IC, RE300
5	2	EACH	BMN80008	VIBRATION ISOLATOR, BAR, 16.50 x 2 x 1.50
4	1	EACH	BMC83129	BKT, WELDMT, MAIN, BASE, ISL, HDX, '13
3	1	EACH	BMC83125	BKT, WELDMT, ADAPTER, PL, ISL, HDX, '13
2	1	EACH	BMC83123	BKT, MAIN, IDLER, WELDMT, ISL, HDX, '13
1	1	EACH	BEL32389	BELT, BANDED B gr, 2388mm (9'4")



REV	DESCRIPTION	DATE	BY
1	RELEASED TO PRODUCTION	4/23/2018	JBR
2			GA
3			James Stewart
4			Ron Ingram
5			Daia Mason

BROWN
jrochiquez 4/23/2018
CHECKED
Val Jakovlew 4/23/2018
DATE: 4/23/2018
BY: James Stewart
Ron Ingram
Daia Mason
4/23/2018

MT KIT, ISL, HDX, TM-55/ 65, 12v, '13
SIZE D DWG NO KMC96594
SCALE 1:4 SHEET 1 OF 1

8 7 6 5 4 3 2 1

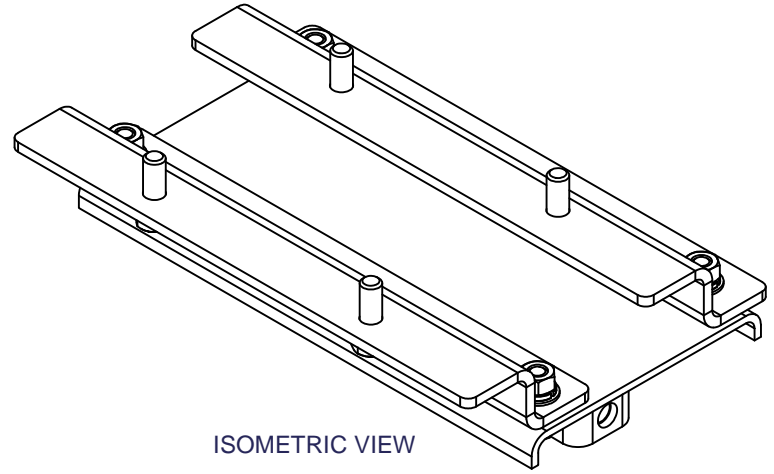
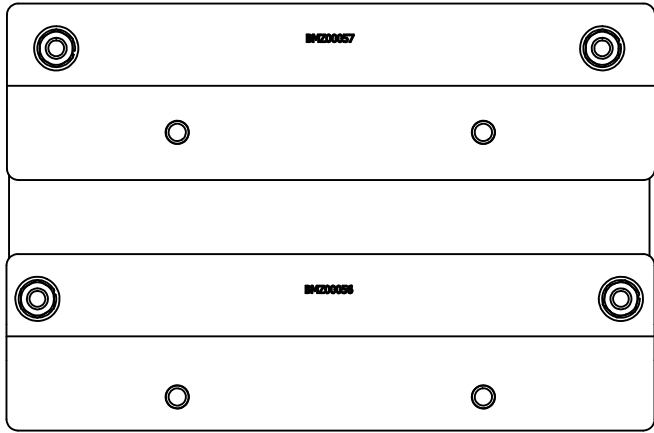

ISOMETRIC VIEW

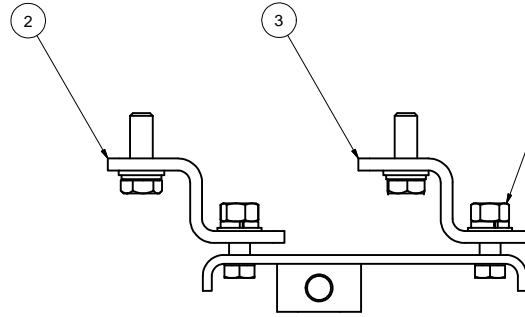
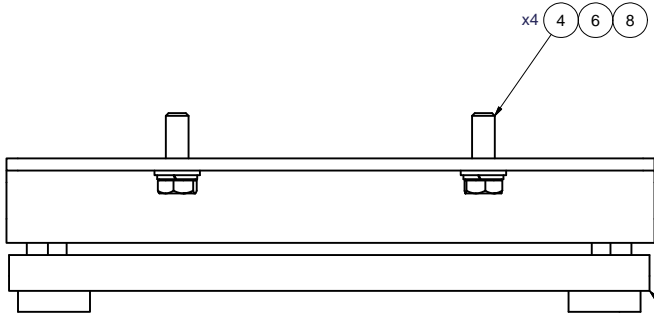

NOTES:

- 1) USE SERVICABLE THREADLOCKER ON ALL FASTENERS TO ENGINE COMPONENTS AND TORQUE **ALL** BOLTS TO S.A.E. SPECIFICATIONS.
- 2) SEE "TRANSARCTIC A/C COMPRESSOR MOUNT INSTALLATION DISCLAIMER".
- 3) WEIGHT: 16.47 LBS.

ITEM	QTY	U/M	PART NUMBER	DESCRIPTION
9	4	EACH	WLQ07000	WASHER, LOCK, 7/16", 8, PLT
8	4	EACH	WLA12000	WASHER, LOCK, 12mm, 8.8, PLT
7	4	EACH	WFN07000	WASHER, FLAT, 7/16", 2, PLT
6	4	EACH	WFA12000	WASHER, FLAT, 12mm, 8.8, PLT
5	4	EACH	NTP07000	NUT, HEX, 7/16-14UNC, 5, PLT
4	4	EACH	BTC12035	BOLT, HEX, 12 x 1.75 x 35mm, 10.9, PLT
3	1	EACH	BMZ00057	BKT, COMP, REAR, Z, TM-65/55, '13
2	1	EACH	BMZ00056	BKT, COMP, FRT, Z, TM-65/55, '13
1	1	EACH	BMN80031	BKT, MAIN, SLIDE, ASSY, 05K, IC, RE300

BILL OF MATERIALS

DRAWN	jrodriguez	8/8/2016
CHECKED	Val Jakowlew	8/8/2016
APPROVED	James Stewart	8/8/2016
MFG	James Stewart	8/8/2016
APPROVED	Dale Mason	8/8/2016



TITLE	KIT, PLATFORM, P/S, TM-55/65, '16		
SIZE	C	DWG NO	REV
SCALE	1:2	KBT65501	0

0	RELEASED TO PRODUCTION	8/8/2016	JRR
REV	ECN	DESCRIPTION	DATE
THIS DRAWING CONTAINS PROPRIETARY CONFIDENTIAL INFORMATION OWNED BY TRANSARCTIC CANADA INC. THE DOCUMENT AND THE INFORMATION IN IT ARE NOT TO BE USED, DISCLOSED OR REPRODUCED WITHOUT EXPRESS WRITTEN PERMISSION OF THE COMPANY.			
UNSPECIFIED TOLERANCES:		[ALT. DIM.]	
ONE DECIMAL PLACE (.X)	MM (.50)	[.020]	
TWO DECIMAL PLACE (.XX)	MM (.25)	[.010]	
THREE DECIMAL PLACE (.XXX)	MM (.10)	[.005]	
FRACTIONAL +/- .102"	ANGULAR +/- .50°	THIRD ANGLE PROJECTION	

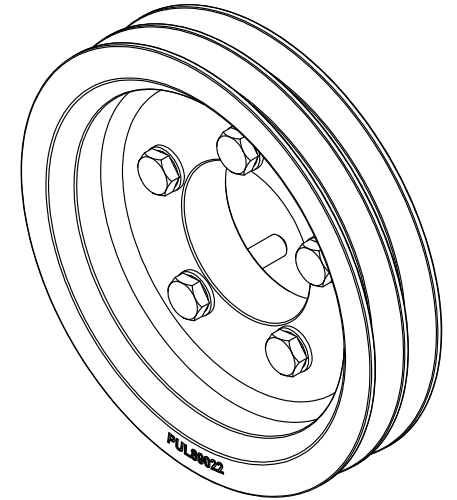
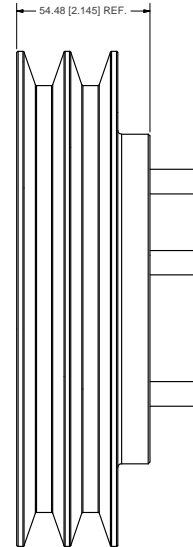
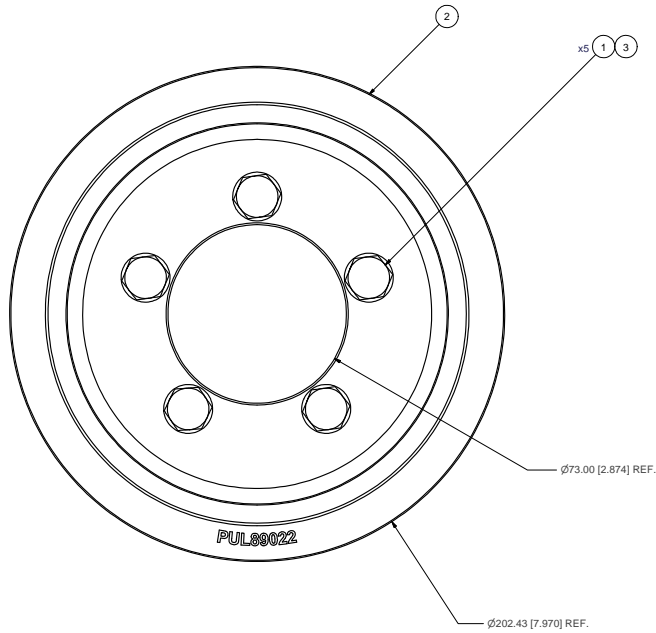
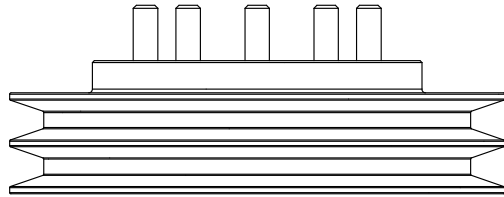

ISOMETRIC VIEW

- NOTES:**
 1) USE SERVICABLE THREADLOCKER ON ALL FASTENERS TO ENGINE COMPONENTS AND TORQUE ALL BOLTS TO S.A.E. SPECIFICATIONS.
 2) SEE "TRANSARCTIC A/C COMPRESSOR MOUNT INSTALLATION DISCLAIMER".
 3) WT:≈ 11.56 LBS

ITEM	QTY	U/M	PART NUMBER	DESCRIPTION
3	5	EACH	WFA10000	WASHER, FLAT, 10mm, 8.8, PLT
2	1	EACH	PUL89022	PULLEY, CRANK, ISL, 8.9L, 2B/X, 8", '13
1	5	EACH	BTCT0050	BOLT, HEX, 10 x 1.5 x 50mm, 10.9, PLT

BILL OF MATERIALS

DRAWN	10/15/2013	TRANSARCTIC INC.		
Checked	10/15/2013			
REV	DESCRIPTION	DATE	BY	TITLE
0	RELEASED TO PRODUCTION	10/15/2013	JRB	GA
1		10/15/2013	James Stewart	
2		10/15/2013	RFG	
3		10/15/2013	Ron Ingram	KIT, PULLEY, ISL, 8.9L, 2B/X, '13
4		10/15/2013	Dale Mason	

UNSPECIFIED TOLERANCES:		MM (INCH)
ONE DECIMAL PLACE (X.0)	±0.10 (±.004)	THIRD ANGLE PROJECTION
TWO DECIMAL PLACE (X.00)	±0.02 (±.0008)	
THREE DECIMAL PLACE (X.000)	±0.002 (±.00008)	

DWG NO	REV
D	0
SCALE	1:1
DRAWING UNIT OF MEASURE	MM (INCH)
SHEET	1 OF 1

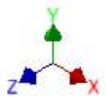
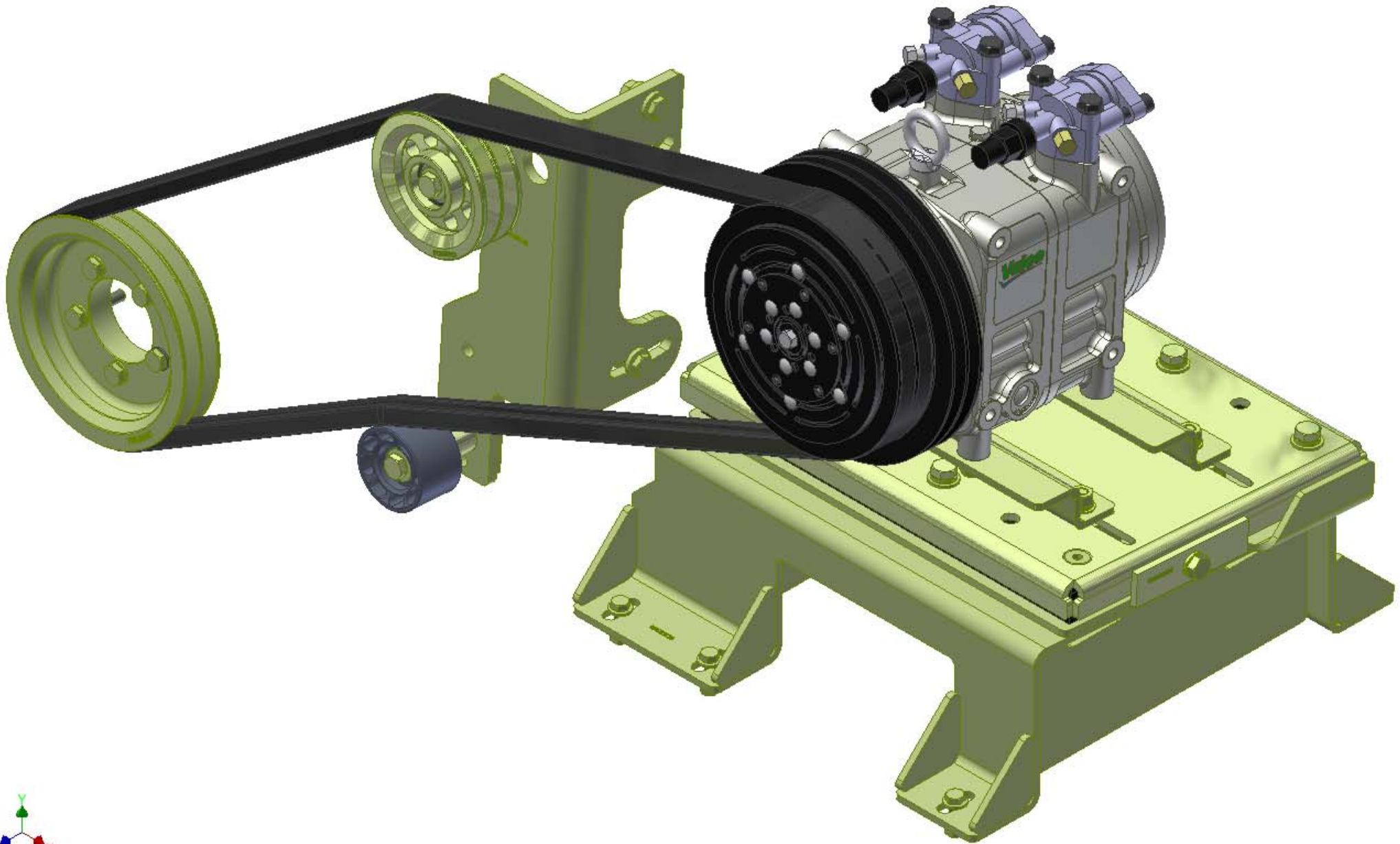

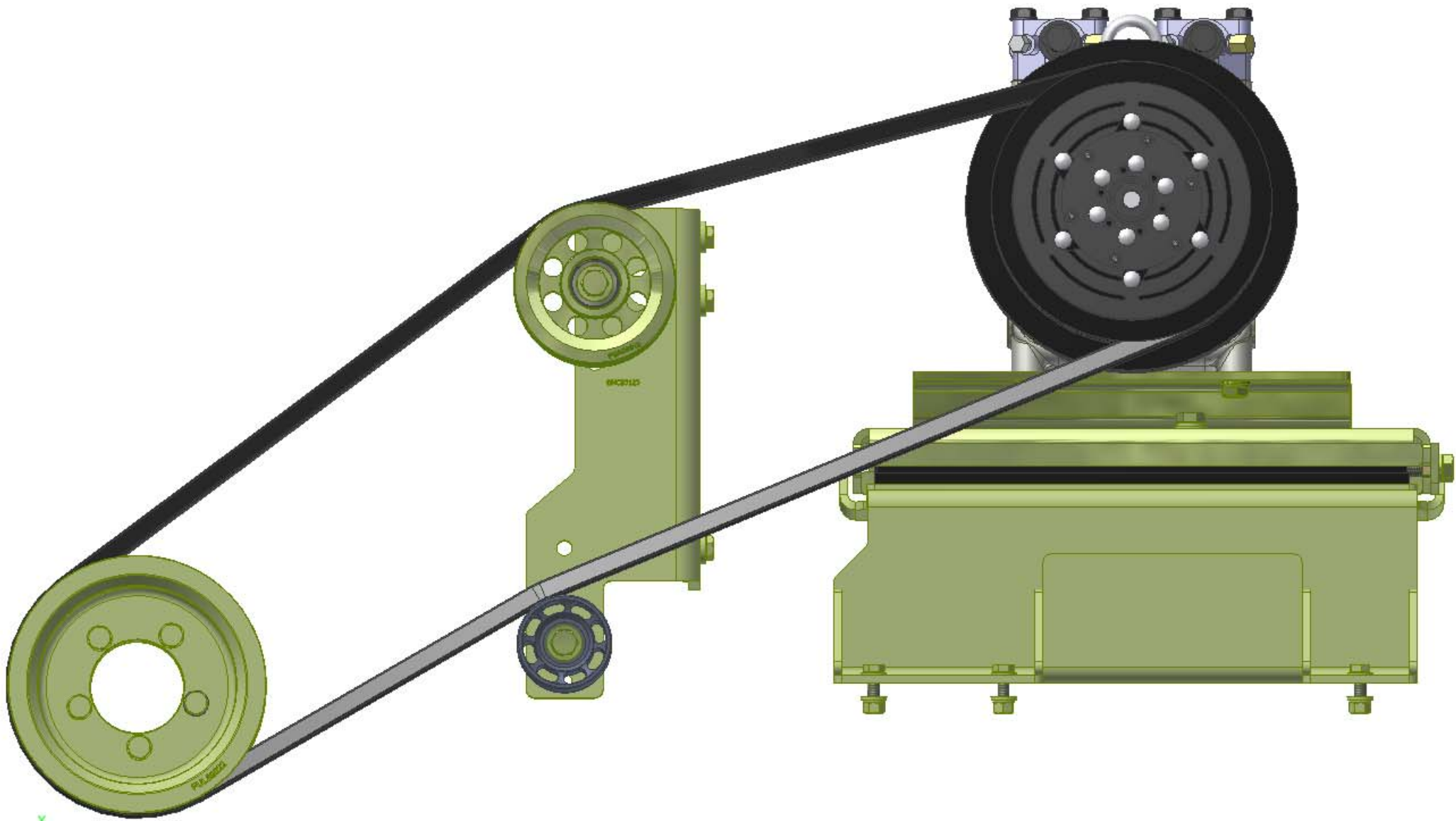

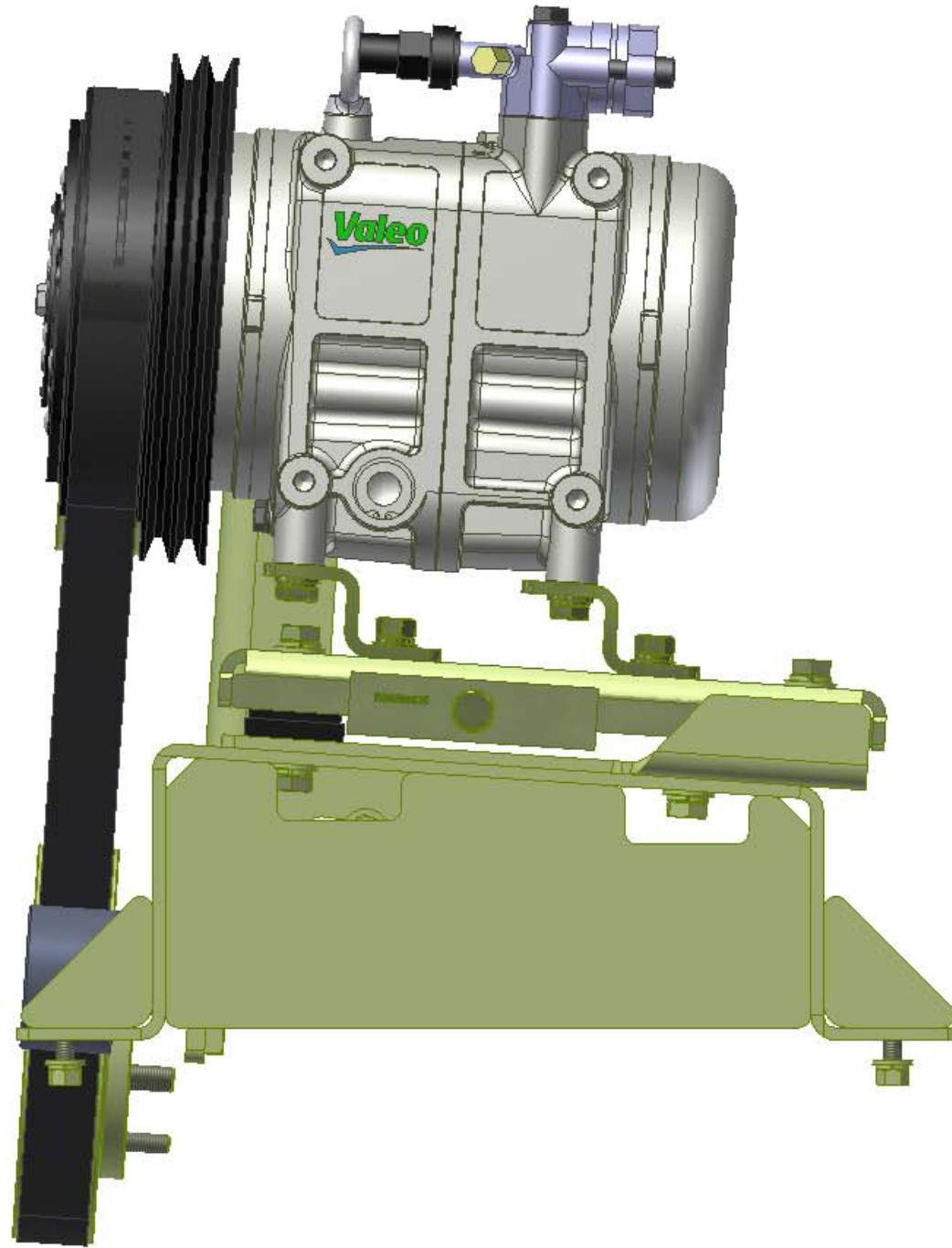

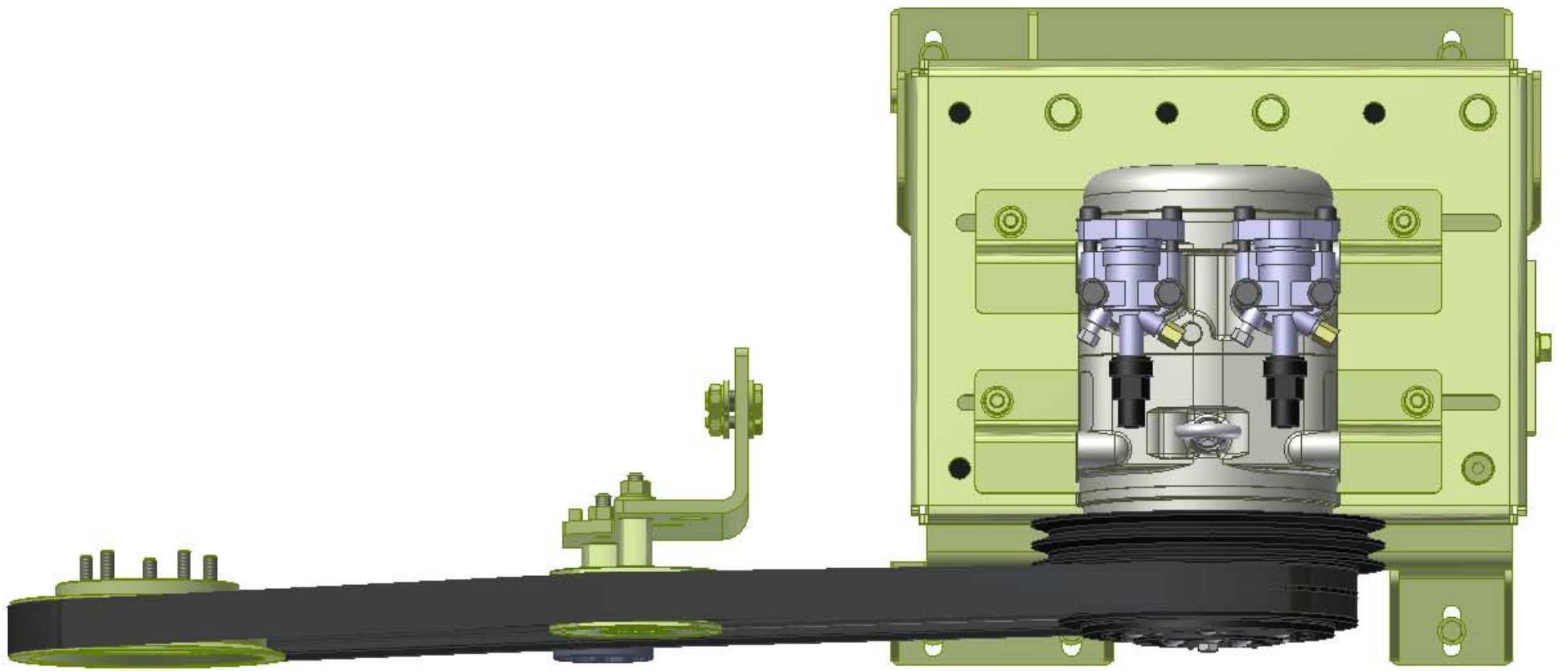

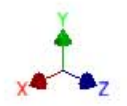
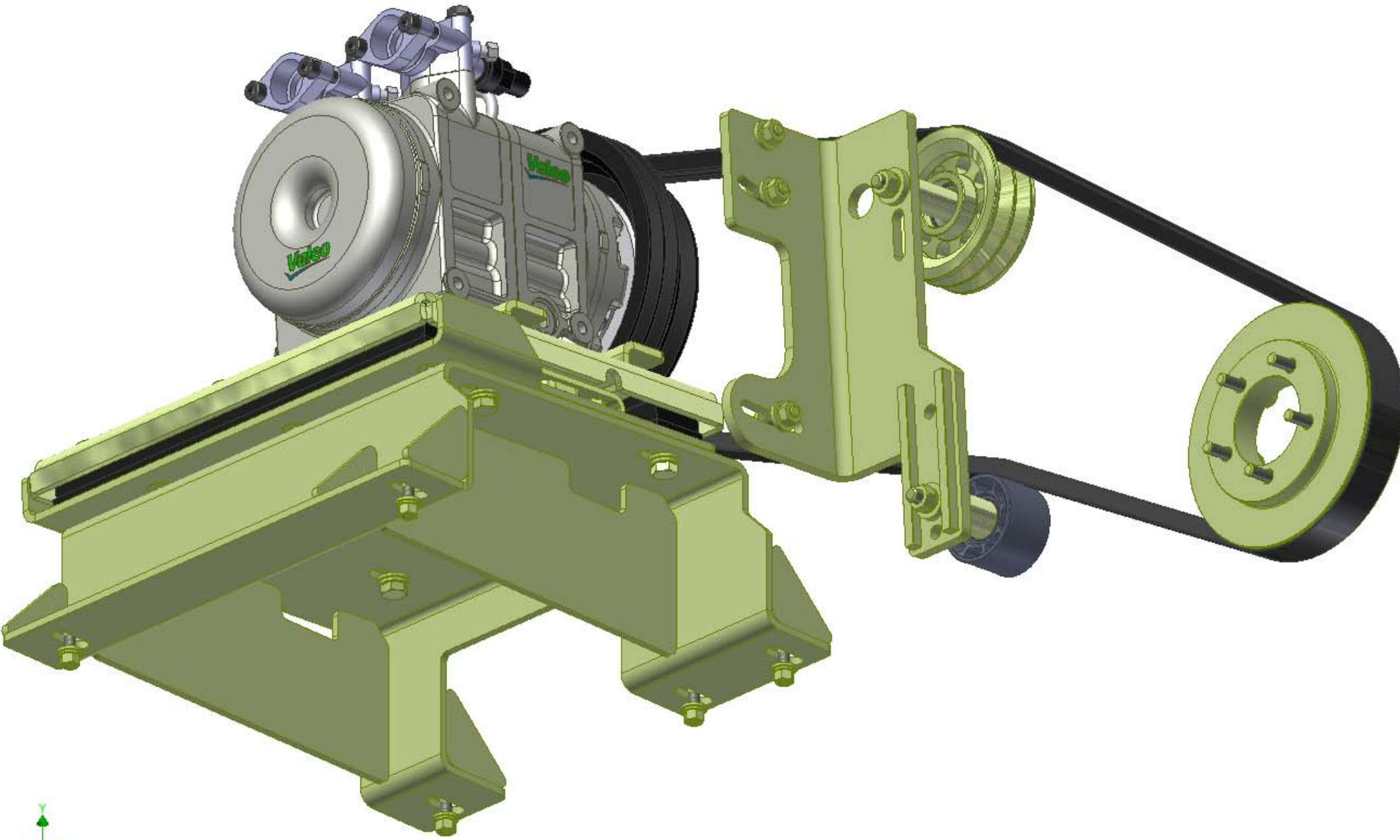

TransArctic A/C Compressor Mount Installation Disclaimer

All compressor mounts should be installed by qualified and trained personnel using proper tools and equipment in safe working conditions following industry standard guidelines for motor vehicle service and repair.

The installer of any compressor mount purchased from TransArctic must undertake all responsibility of issues arising from that compressor bracket being installed on any vehicle. As well as insure that a **proper and sufficient ground** is established between the compressors' clutches and the vehicle's engine. Mount functionality, operation and durability can all be compromised by an incompetent installation.

Due to the many different situations, parameters and application criteria, which are beyond the compressor mount manufacturer's control, TransArctic does not warrant design, durability, or operational functionality of any compressor mount improperly installed by another party.

With no implied guarantees it is the mount installer's strict responsibility to determine safety and functionality, of the compressor mount, at the time of installation.

Please contact TransArctic with any issue arising from installation so we may better improve the product. If you have any reservations about the compressor mount integrity contact TransArctic immediately at 1-877-COLD-AIR.

Mark OEM tensioner location

Install Kit

Check for Interferences

Check to ensure that the proper OEM tensioner orientation is maintained

Run engine with A/C system engaged for at least 10 minutes to run in belt

Check OEM tensioner orientation and adjust as required

Responsabilidad limitada de TransArctic en la instalación del soporte del compresor

Todos los soportes de los compresores deben ser instalados por personas calificadas y entrenadas, usando para ello los equipos y herramientas necesarios para esta labor en buenas condiciones y según las normas y guías para el servicio y/o reparación de motores de vehículos.

El instalador de los soportes comprados en TransArctic asume toda la responsabilidad de cualquier problema que surga en el soporte del compresor al vehículo; de igual manera es responsable que el cable a tierra sea conectado entre el embrague del compresor y el motor del vehículo.

Se advierte que el buen funcionamiento y la durabilidad del soporte pueden ser comprometidos por defectos en su instalación.

Debido a las diversas situaciones que se puedan presentar fuera del control del fabricante, TransArctic no garantiza el diseño, la durabilidad o el correcto funcionamiento de cualquier equipo inapropiadamente instalado por terceros.

Esta sobreentendido que el Instalador del montaje del compresor es estrictamente responsable de la seguridad y funcionamiento del equipo en el momento de la instalación.

Si tuviera algún problema o duda acerca de la instalación del soporte del compresor pongase en contacto inmediatamente con TransArctic al teléfono 1-877-COLD-AIR de modo que podamos mejorar nuestro producto.

Note la ubicación del medidor de tensión OEM

Instale el equipo

Controlar si hay interferencias.

Asegurese que el medidor de tensión mantenga la orientación justa.

Encienda el motor por lo menos 10 minutos con el sistema A/C enganchado para que la correa corra

Controle la orientación justa del medidor de tensión y ajuste a las condiciones requeridas del fabricante