

# Bill of Materials Listing

TransArctic Canada Inc.

9/22/2010

Page 1 of 1

Product Number	Description	Date	Weight	Uof M	Yield
Line Component Prod#	Description	Bin Unit	Qty		
<b>KMC64162</b>	<b>Mt Kit, ISB, D3RE, O5G, 2B, 8" Cr, '10</b>	<b>8/5/2010</b>	<b>196.65</b>		<b>0</b>
10 BEL22388	Belt, B gr, 2388mm (94") (BX91)	each	2		
20 BMC83047	Bkt, Brace, Vert, RR, Bumper, ISC, D3	each	1		
30 BMC83071	Bkt, Sup, Weldm't, ISB, D3RE, '10	each	1		
40 BMC83051	Bkt, Side, Extention, Plate	each	2		
50 BMC83052	Bkt, Main, RR Plate, MFDT, RE300	each	1		
60 BMC83053	Bkt, Diag, Brace RR, MFDT, RE300	each	1		
70 BMC83054	Bkt, Main, Idler, Weldm't, RE300	each	1		
80 BMC83057	Bkt, Main, Frt Pl, MFDT, RE300	each	1		
90 BMC83058	Bkt, Cover, Light Pl, MF DT, RE300	each	1		
100 BMC83059	Bkt, Diag, Brace Frt, MF DT, RE300	each	1		
102 BMC83075	Bkt,PI, Exhaust, Adapter, D3RE, '10	each	1		
105 BMC83076	Bkt, Brace, CAC, D3RE, '10	each	1		
110 BMN80008	Vibration Isolator, Bar, 16.50 x 2 x 1.50	each	2		
120 BMN80009	Bkt, Main, Base Pl, IC, RE300	each	1		
130 BMN80010	Bkt, Main, Slide, Assy, O5G, IC, RE300	each	1		
140 BMN80024	Bkt, Comp, FRT, Z, IC, RE300	each	1		
150 BMN80025	Bkt, Back, PL, Slide, IC, RE300	each	1		
160 KAN86530	Alt. Kit, 24V, MForce DT, RE300, 07-08	each	1		
170 PUA05012	Pulley, Assy, Idler,B/BX gr.5", STL,Plt	each	1		
180 PUL80074	Pulley, Idler, B/S, Wide, 76d (89102)	each	1		
190 PUL67322	Pulley, Crank, ADD-ON, Combo, ISB, 2B/3V	each	1		
200 SCD29213	Spacer, Col, Drl,29.21mm x 25.4o x 12.7i	each	2		
210 SCD37012	Spacer, Col, Drl, 37 mm x 25.4o x 12.3i	each	1		
220 SCD41012	Spacer, Col, Drl, 41 mm x 25.4o x 12.3i	each	1		
230 SLV17012	Sleeve, Pulley, 16.9o x 22.23mm x 12.32i	each	2		
240 TUS04096	Tube, Stl, Exh,4"o.d.,D3RE, ISB, '10	each	1		
245 BTS06400	Bolt, U, 3/8-16, 4.00 W/IS, Nut/PI, PLT	each	1		
250 HOA04083	Hose, Flex, CAC, 4.0d x 8.0, 3 ring	each	1		
251 FTS06006	Ftg, Pipe, Adapter, Bulkhead, 1/8x1-1/2	each	1		
252 FTS06007	Ftg, Pipe, Elbow, 90 DEG, Male	each	2		
253 TUP00014	Ftg, Tubing, Plastic, 1/4 OD, Black	feet	4		
254 HOA70004	Hose, Ducting, Air Filter, 7" O.D, BLK	feet	4		
260 CLP04000	Clamp, T bolt, Spring, 4", CAC	each	2		
270 KBC64162	Bag Kit, Fasteners, KMC64162	each	1		

# Bill of Materials Listing

TransArctic Canada Inc.

10/1/2010

Page 1 of 1

Product Number		Description	Bin	Date	Weight	Uof M	Yield
Line	Component Prod#	Description		Unit	Qty		
<b>KBC64162</b>		<b>Bag Kit, Fasteners, KMC64162</b>		<b>4/12/2010</b>	<b>4.45</b>		<b>0</b>
0	BTC10040	Bolt, Hex, 10 x 1.5 x 40mm, 10.9, Plt,FT		each	4		
10	BTC12035	Bolt, Hex, 12 x 1.75 x 35mm, 10.9,Plt,FT		each	1		
20	BTC12040	Bolt, Hex, 12 x 1.75 x 40mm, 10.9,Plt,FT		each	4		
30	BTC12050	Bolt, Hex, 12 x 1.75 x 50mm, 10.9,Plt		each	2		
40	BTC12100	Bolt, Hex, 12 x 1.75 x 100mm, 10.9, Plt		each	2		
50	BTP08653	Bolt, Hex, 1/2-13unc, 6.5", 5, Plt, FT		each	1		
60	BTQ06150	Bolt, Hex, 3/8-16unc, 1.50", 8, Plt		each	2		
65	BTQ05075	Bolt, Hex, 5/16-18unc, .75", 8, Plt		each	4		
70	BTQ08126	Bolt, Hex, 1/2-20unf, 1.25", 8, Plt		each	10		
80	BTQ08151	Bolt, Hex, 1/2-20unf, 1.5", 8, Plt		each	2		
90	NTA12000	Nut, Hex, 12 x 1.75, 8.8, Plt		each	9		
100	NTP07000	Nut, Hex, 7/16-14unc, 5, Plt		each	4		
101	SCP03075	Screw, PH, PD, SDT, #10-16 x .75, ST,Plt		each	3		
105	WFA10000	Washer, Flat, 10mm, 8.8, Plt		each	4		
110	WFA12000	Washer, Flat, 12mm, 8.8, Plt		each	16		
115	WFN05000	Washer, Flat, 5/16", 2, Plt		each	4		
120	WFN06000	Washer, Flat, 3/8", 2, Plt		each	2		
130	WFN07000	Washer, Flat, 7/16", 2, Plt		each	4		
140	WFAQ08000	Washer, Flat, 1/2", 8, Plt		each	12		
150	WLA12000	Washer, Lock, 12mm, 8.8, Plt		each	9		
153	WLA10000	Washer, Lock, 10mm, 8.8, Plt		each	4		
155	WLP05000	Washer, Lock, 5/16", 5, Plt		each	4		
160	WLP06000	Washer, Lock, 3/8", 5, Plt		each	2		
170	WLP07000	Washer, Lock, 7/16", 5, Plt		each	4		
180	WLP08000	Washer, Lock, 1/2", 5, Plt		each	13		

# Bill of Materials Listing

TransArctic Canada Inc.

9/7/2010  
Page 1 of 1

Product Number	Description	Date	Weight	Uof M	Yield
Line    Component    Prod#	Description	Bin                    Unit	Qty		
<b>KAN86530</b>	<b>Alt. Kit, 24V, MForce DT, RE300, 07-08</b>		<b>10.49</b>		<b>0</b>
10 BEL11245	Belt, A gr, 1245mm (49.0") (17490)	each	2		
20 BMN80051	Bkt, Alt, Weldm't, D/S, O5G/K	each	1		
30 BMN80052	Bkt, Alt, Weldm't,P/S, O5G/K	each	1		
35 PUL03321	Pulley, ALT, Idler, 3.25"d, 2A	each	1		
40 SCD84713	Spacer, Col, Drl, 84.7mm x 25.4o x 13.3i	each	1		
50 BMT10008	Bkt, Tenr, Block, Offset	each	1		
60 BMT10009	Bkt, Tenr, Block, Tapped	each	1		
70 KBN86530	Bag Kit, Fasteners, KMN86530	each	1		

# Bill of Materials Listing

TransArctic Canada Inc.

9/7/2010  
Page 1 of 1

Product Number	Description	Date	Weight	Uof M	Yield
Line    Component Prod#	Description	Bin                      Unit	Qty		
<b>KBN86530</b>	<b>Bag Kit, Fasteners, KMN86530</b>		<b>10/4/2007</b>	<b>7.35</b>	<b>0</b>
10 TRD08120	Threaded, Rod, 1/2-13unc x 12", 5, Plt		piece	1	
20 BTQ08653	Bolt, Hex, 1/2-13unc, 6.5", 8, Plt		each	1	
30 BTQ08150	Bolt, Hex, 1/2-13unc, 1.5", 8, Plt		each	1	
40 BTS06438	Bolt, Stud, 3/8-16unc, 3.25" x .88", PLT		each	12	
50 BTQ06200	Bolt, Hex, 3/8-16unc, 2.0", 8, Plt		each	1	
60 NTP08000	Nut, Hex, 1/2-13unc, 5, Plt		each	4	
70 NTP06000	Nut, Hex, 3/8-16unc, 5, Plt		each	13	
80 WFQ08000	Washer, Flat, 1/2", 8, Plt		each	5	
90 WFN06000	Washer, Flat, 3/8", 2, Plt		each	26	
100 WLP08000	Washer, Lock, 1/2", 5, Plt		each	4	
110 WLP06000	Washer, Lock, 3/8", 5, Plt		each	13	

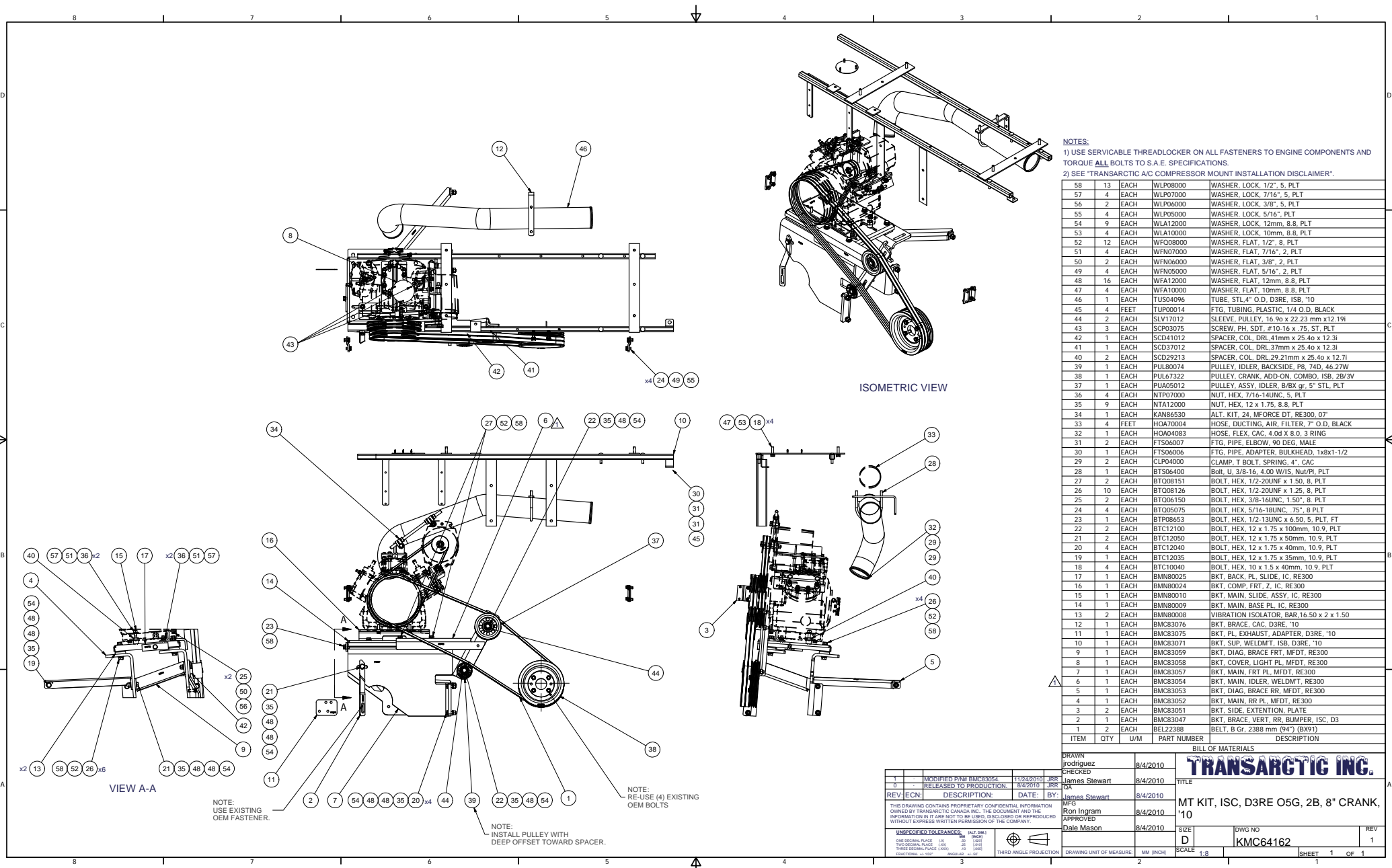

**NOTES:**  
 1) USE SERVICABLE THREADLOCKER ON ALL FASTENERS TO ENGINE COMPONENTS AND TORQUE ALL BOLTS TO S.A.E. SPECIFICATIONS.  
 2) SEE "TRANSARCTIC A/C COMPRESSOR MOUNT INSTALLATION DISCLAIMER".

ITEM	QTY	U/M	PART NUMBER	DESCRIPTION
58	13	EACH	WLP08000	WASHER, LOCK, 1/2", 5, PLT
57	4	EACH	WLP07000	WASHER, LOCK, 7/16", 5, PLT
56	2	EACH	WLP06000	WASHER, LOCK, 3/8", 5, PLT
55	4	EACH	WLP05000	WASHER, LOCK, 5/16", PLT
54	9	EACH	WLA12000	WASHER, LOCK, 12mm, 8.8, PLT
53	4	EACH	WLA10000	WASHER, LOCK, 10mm, 8.8, PLT
52	12	EACH	WFO08000	WASHER, FLAT, 1/2", 8, PLT
51	4	EACH	WFO07000	WASHER, FLAT, 7/16", 2, PLT
50	2	EACH	WFO06000	WASHER, FLAT, 3/8", 2, PLT
49	4	EACH	WFO05000	WASHER, FLAT, 5/16", 2, PLT
48	16	EACH	WFA12000	WASHER, FLAT, 12mm, 8.8, PLT
47	4	EACH	WFA10000	WASHER, FLAT, 10mm, 8.8, PLT
46	1	EACH	TUS04096	TUBE, STL 4" O.D. D3RE, ISB, 10
45	4	FEET	TUP00014	FTG. TUBING, PLASTIC, 1/4 O.D. BLACK
44	2	EACH	SLV17012	SLEEVE, PULLEY, 16.90 x 22.23 mm x12.19
43	3	EACH	SCP03075	SCREW, PL, SDT, #10-16 x .75, ST, PLT
42	1	EACH	SCD41012	SPACER, COL. DRL, 41mm x 25.40 x 12.3i
41	1	EACH	SCD37012	SPACER, COL. DRL, 37mm x 25.40 x 12.3i
40	2	EACH	SCD29213	SPACER, COL. DRL, 29.21mm x 25.40 x 12.7i
39	1	EACH	PUL80074	PULLEY, IDLER, BACKSIDE, P8, 74D, 46.27W
38	1	EACH	PUL67322	PULLEY, CRANK, ADD-ON, COMBO, ISB, 28/3V
37	1	EACH	PUL05012	PULLEY, ASSY, IDLER, B/BX w/ 5" STL, PLT
36	4	EACH	NTP07000	NUT, HEX, 7/16-14UNC, 5, PLT
35	9	EACH	NTA12000	NUT, HEX, 12 x 1.75, 8.8, PLT
34	1	EACH	KAN86530	ALT. KIT, 24, MFORCE DT, RE300, 07"
33	4	FEET	HOA70004	HOSE, DUCTING, AIR, FILTER, 7" O.D. BLACK
32	1	EACH	HOA04083	HOSE, FLEX, CAC, 4.0d X 8.0, 3 RING
31	2	EACH	FIS06007	FTG. PIPE, ELBOW, 90 DEG, MALE
30	1	EACH	FIS06006	FTG. PIPE, ADAPTER, BULKHEAD, 1x8x1-1/2
29	2	EACH	CLP04000	CLAMP, T BOLT, SPRING, 4" CAC
28	1	EACH	BTS06400	Bolt U, 3/8-16, 4.00 W/5, Nut/Pl, PLT
27	2	EACH	BTQ08151	BOLT, HEX, 1/2-20UNF x 1.50, 8, PLT
26	10	EACH	BTQ08126	BOLT, HEX, 1/2-20UNF x 1.25, 8, PLT
25	2	EACH	BTQ06150	BOLT, HEX, 3/8-16UNC, 1.50", 8, PLT
24	4	EACH	BTQ05075	BOLT, HEX, 5/16-18UNC, .75", 8, PLT
23	1	EACH	BTP08653	BOLT, HEX, 1/2-13UNC x 6.50, 5, PLT, FT
22	2	EACH	BTC12100	BOLT, HEX, 12 x 1.75 x 100mm, 10.9, PLT
21	2	EACH	BTC12050	BOLT, HEX, 12 x 1.75 x 50mm, 10.9, PLT
20	4	EACH	BTC12040	BOLT, HEX, 12 x 1.75 x 40mm, 10.9, PLT
19	1	EACH	BTC12025	BOLT, HEX, 12 x 1.75 x 25mm, 10.9, PLT
18	4	EACH	BTC10040	BOLT, HEX, 10 x 1.5 x 40mm, 10.9, PLT
17	1	EACH	BMN80025	BKT, BACK, PL, SLIDE, IC, RE300
16	1	EACH	BMN80024	BKT, COMP, FRT, Z, IC, RE300
15	1	EACH	BMN80010	BKT, MAIN, SLIDE, ASSY, IC, RE300
14	1	EACH	BMN80009	BKT, MAIN, BASE PL, IC, RE300
13	2	EACH	BMN80008	VIBRATION ISOLATOR, BAR, 16.50 x 2 x 1.50
12	1	EACH	BMC83076	BKT, BRACE, CAC, D3RE, 10
11	1	EACH	BMC83075	BKT, PL, EXHAUST, ADAPTER, D3RE, 10
10	1	EACH	BMC83071	BKT, SUP, WELDMT, ISB, D3RE, 10
9	1	EACH	BMC83059	BKT, DIAG, BRACE FRT, MFD, RE300
8	1	EACH	BMC83058	BKT, COVER, LIGHT PL, MFD, RE300
7	1	EACH	BMC83057	BKT, MAIN, FRT PL, MFD, RE300
6	1	EACH	BMC83054	BKT, MAIN, IDLER, WELDMT, RE300
5	1	EACH	BMC83053	BKT, DIAG, BRACE RR, MFD, RE300
4	1	EACH	BMC83052	BKT, MAIN, RR PL, MFD, RE300
3	2	EACH	BMC83051	BKT, SIDE, EXTENTION, PLATE
2	1	EACH	BMC83047	BKT, BRACE, WERT, RB, BUMPER, ISC, D3
1	2	EACH	BEL22388	BELT, B Gr, 2388 mm (94") (BX91)

NOTE:  
 USE EXISTING  
 OEM FASTENER.

NOTE:  
 RE-USE (4) EXISTING  
 OEM BOLTS

NOTE:  
 INSTALL PULLEY WITH  
 DEEP OFFSET TOWARD SPACER.

REVISED	DESCRIPTION:	DATE:	BY:
1	MODIFIED P/N# BMC83054	11/24/2010	JRR
0	RELEASED TO PRODUCTION	8/4/2010	JRR
1		8/4/2010	James Stewart
2		8/4/2010	James Stewart
3		8/4/2010	Ron Ingram
4		8/4/2010	Dale Mason

BROWN  
 jrodriquez 8/4/2010  
 CHECKED

**TRANSARCTIC INC.**

TITLE  
 MT KIT, ISC, D3RE OSG, 2B, 8" CRANK,  
 '10

SIZE  
 D

DWG NO  
 KMC641162

REV  
 1

SCALE  
 1:1

SHEET 1 OF 1

UNSPECIFIED TOLERANCES:	ALL DIMS
ONE DECIMAL PLACE (X.0)	±.05
TWO DECIMAL PLACES (X.00)	±.02
THREE DECIMAL PLACES (X.000)	±.010
FRACTIONAL (1/16")	±.005
ANGULAR (°)	±.05



DRAWING UNIT OF MEASURE: MM (INCH)

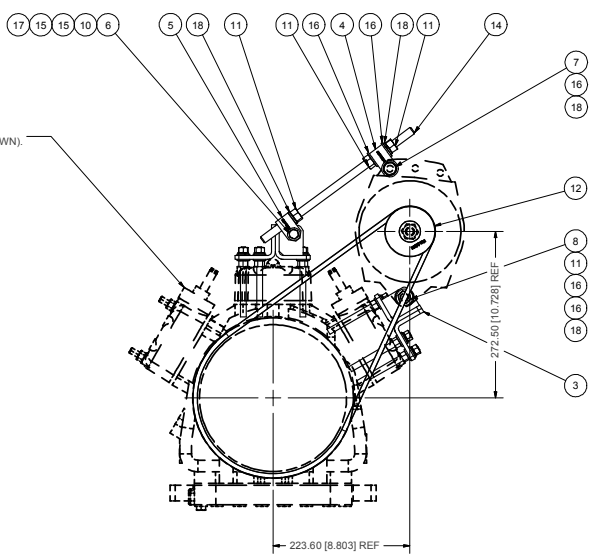
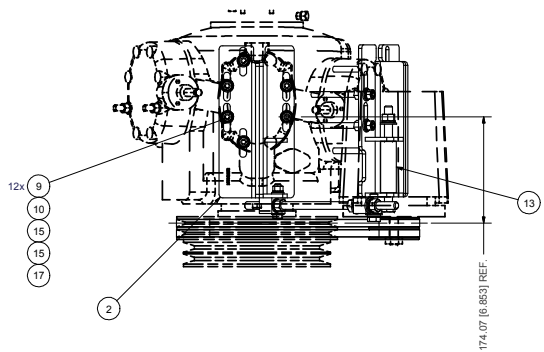

NOTE REF:  
 CARRIER COMPRESSOR  
 PART #: 68PD541-124-xx  
 (OSG COMPRESSOR-SHOWN).  
 PART #: 68PD524-204-xx  
 (OSK COMPRESSOR)

**DRIVER SIDE SETUP-SHOWN  
 PASSENGER SIDE SETUP-OPPOSITE**

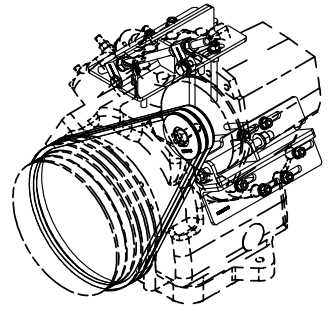

ISOMETRIC VIEW

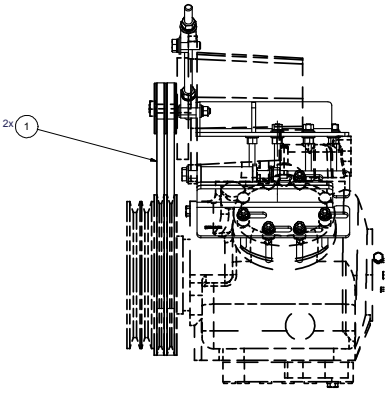

- NOTES:  
 1) USE SERVICABLE THREADLOCKER ON ALL FASTENERS TO ENGINE COMPONENTS AND TORQUE **ALL** BOLTS TO S.A.E. SPECIFICATIONS.  
 2) SEE "TRANSARCTIC A/C COMPRESSOR MOUNT INSTALLATION DISCLAIMER".

ITEM	QTY	U/M	PART NUMBER	DESCRIPTION
18	4	EACH	WLP08000	WASHER, LOCK, 1/2", 5, PLT
17	13	EACH	WLP06000	WASHER, LOCK, 3/8", 5, PLT
16	5	EACH	WFO08000	WASHER, FLAT, 1/2", 8, PLT
15	26	EACH	WFO06000	WASHER, FLAT, 3/8", 2, PLT
14	1	EACH	TRD08120	THREADED, ROD, 1/2-13UNC x 12", 5 PLT
13	1	EACH	SCD84713	SPACER, COL, DRL, 84.73mm x28.60 x13.31
12	1	EACH	PUL03321	PULLEY, ALT, IDLER, 3.25"φ, 2A
11	4	EACH	NTP08000	NUT, HEX, 1/2-13UNC, 5, PLT
10	13	EACH	NTP06000	NUT, HEX, 3/8-16UNC, 5, PLT
9	12	EACH	BTQ06438	BoRt, Stud, 3/8-16unc, 3.25" x .88", PLT
8	1	EACH	BTQ08653	BOLT, HEX, 1/2-13UNC x 6.50, 8, PLT
7	1	EACH	BTQ08150	BOLT, HEX, 1/2-13UNC x 1.50, 8, PLT
6	1	EACH	BTQ06200	BOLT, HEX, 3/8-16UNC, 2.00", 8, PLT
5	1	EACH	BMT10009	BKT, TENR, BLOCK, TAPPED
4	1	EACH	BMT10008	BKT, TENR, BLOCK, OFFSET
3	1	EACH	BMN80052	BKT, ALT, WELDMT, P/S, OSG/K
2	1	EACH	BMN80051	BKT, ALT, WELDMT, D/S, OSG/K
1	2	EACH	BEL11245	Belt, A gr, 1245mm (49.0") (17490)

BILL OF MATERIALS

RELEASE TO PRODUCTION	6/23/2008	BRK
DESCRIPTION:	DATE:	BY:
WFG	6/23/2008	James Stewart
APPROVED	6/23/2008	Ron Ingram
APPROVED	6/23/2008	Dale Mason

**TRANSARCTIC INC.**

TITLE: **ALT. KIT, 24V, MFORCE DT, RE300, '07**

SIZE: D DWG NO: **KAN86530** REV: **0**

SCALE: 1:4 SHEET 1 OF 2

DRAWING UNIT OF MEASURE: MM (INCH)

UNSPECIFIED TOLERANCES: (ALL DIM)  
 ONE DECIMAL PLACE (10, 25, 50, 100)  
 THIRSDIGIT FRACTIONS (1/32, 1/16, 3/32, 1/8, 1/4, 3/8, 1/2, 5/8, 3/4, 7/8)  
 FRACTIONAL: 1/32, 1/16, 3/32, 1/8, 1/4, 3/8, 1/2, 5/8, 3/4, 7/8

THIRD ANGLE PROJECTION

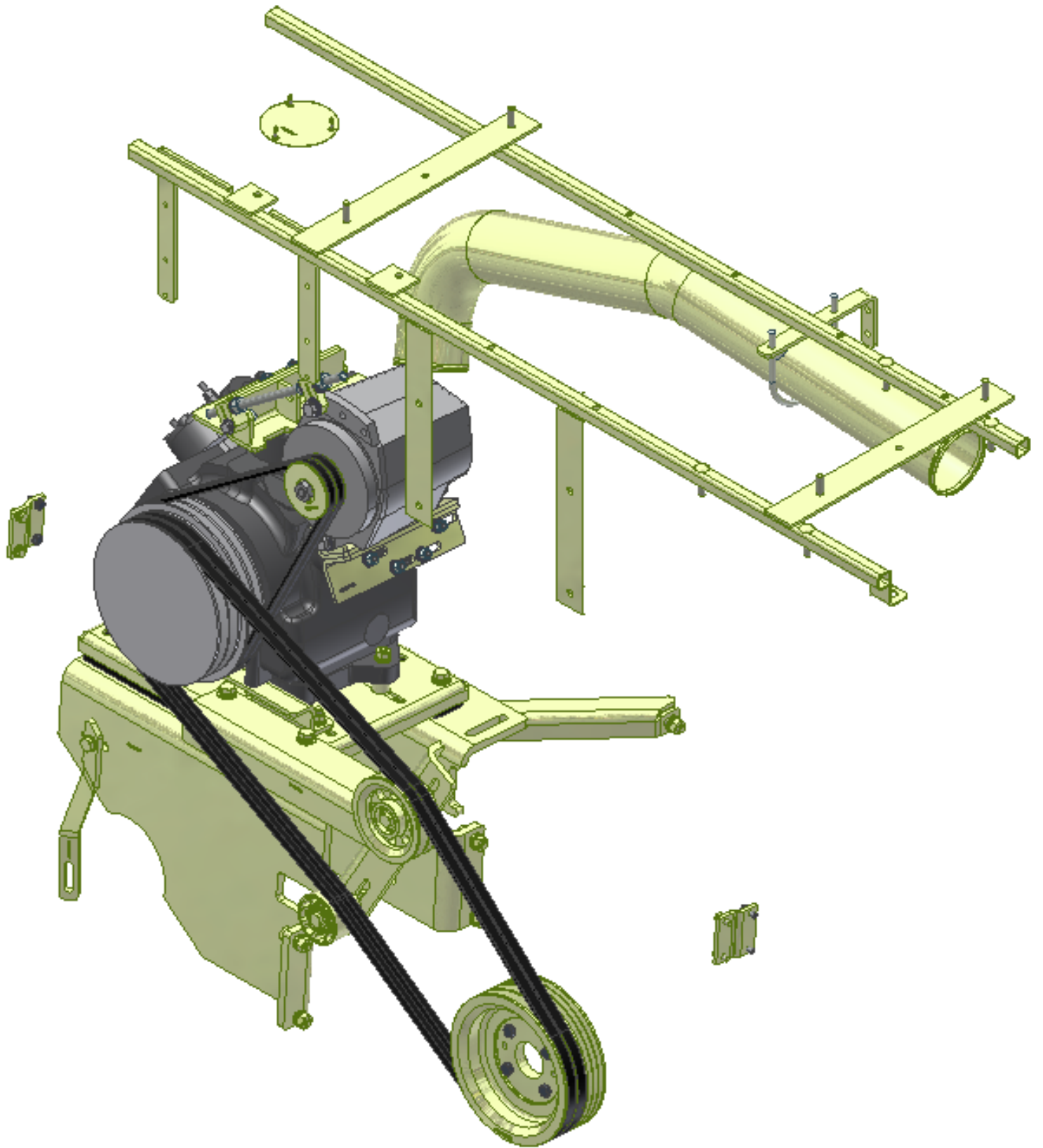

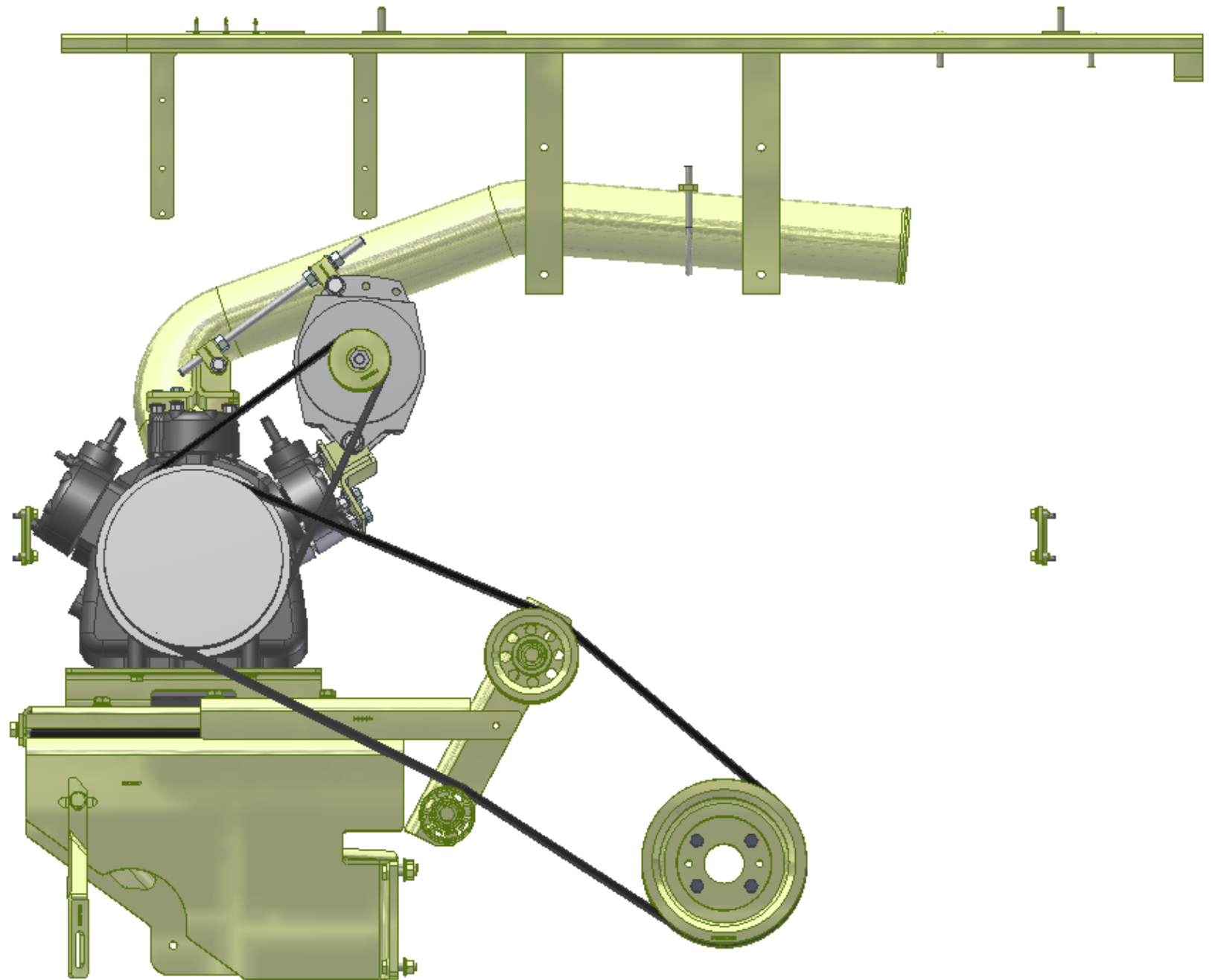



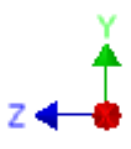
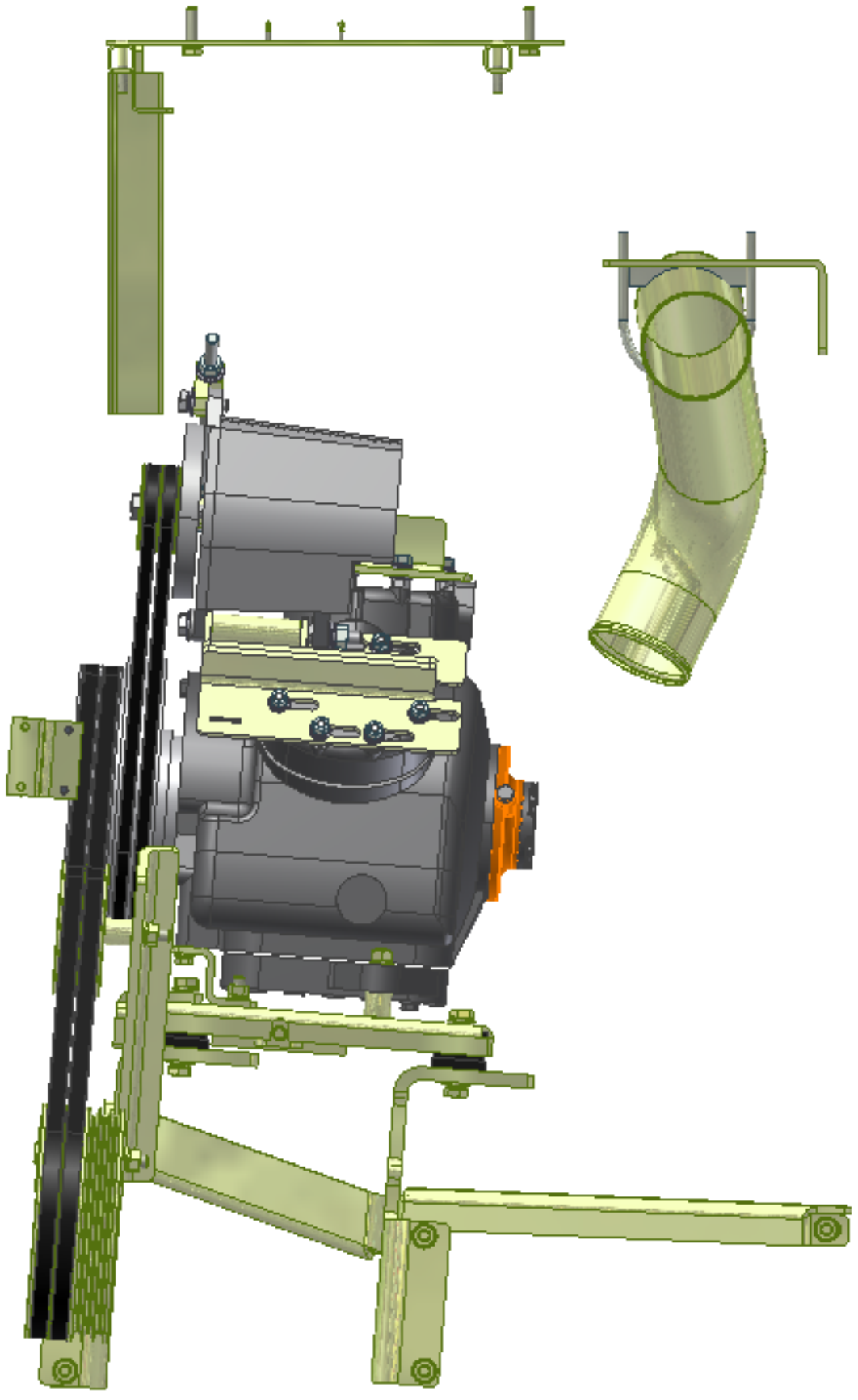

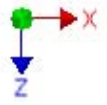
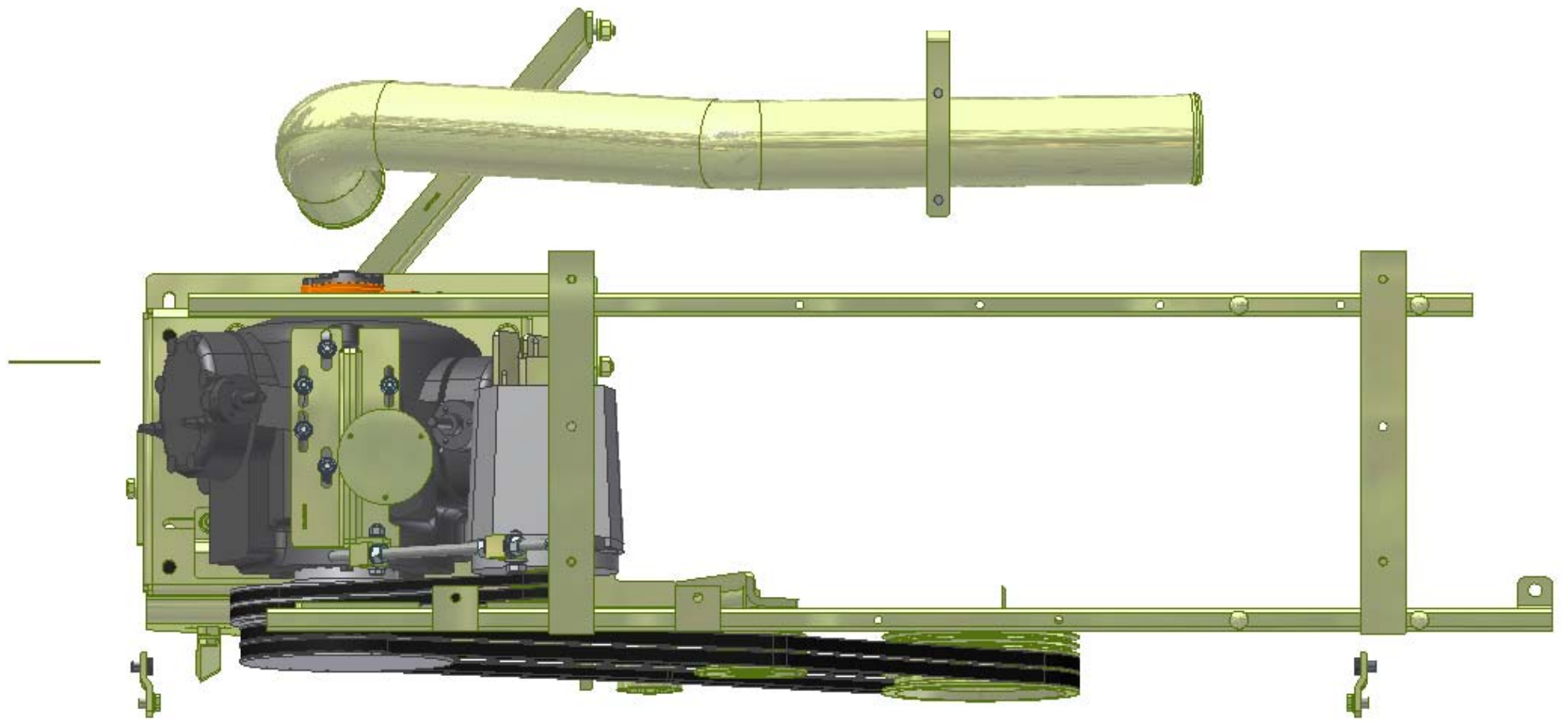

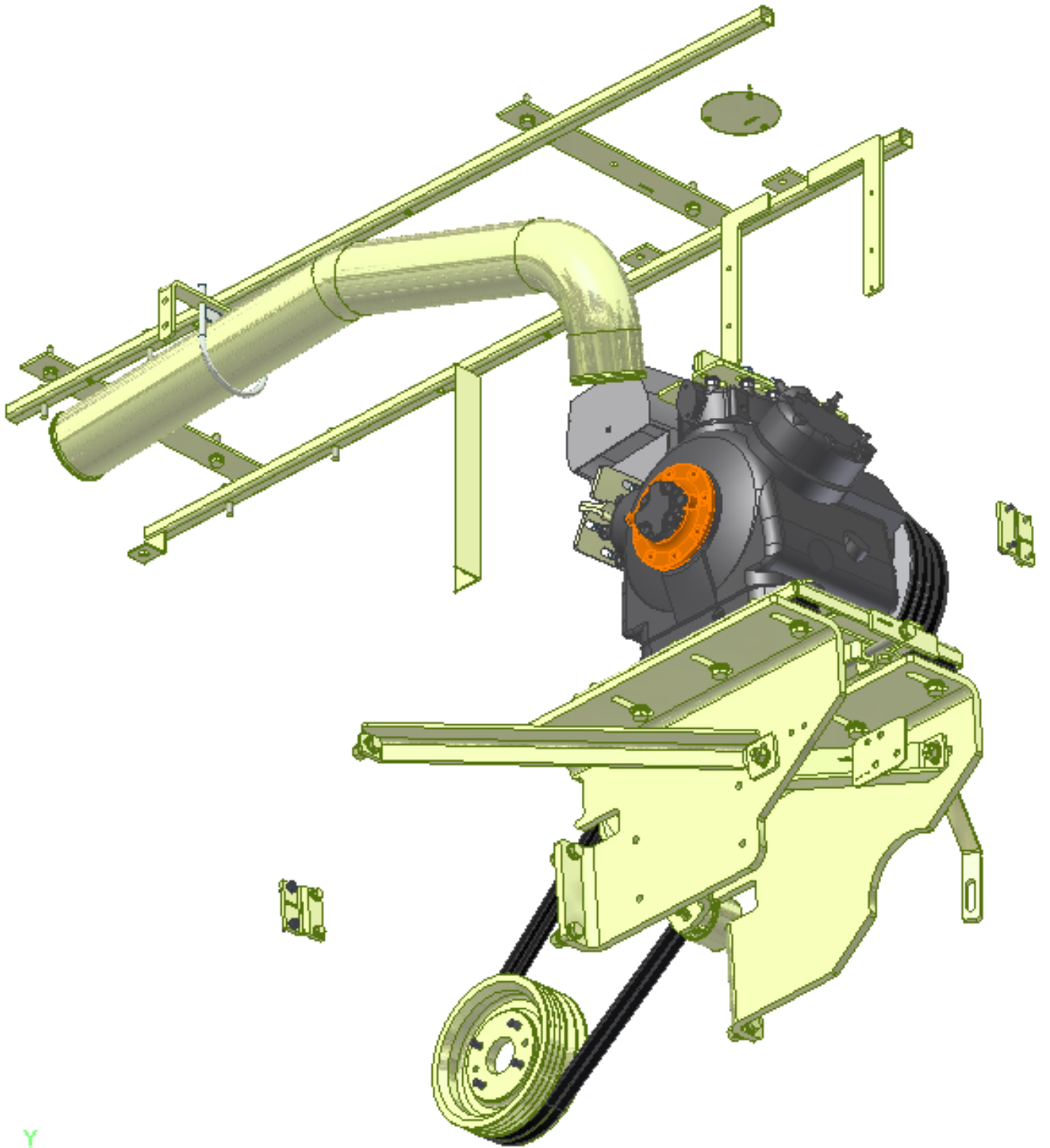

## **TransArctic A/C Compressor Mount Installation Disclaimer**

All compressor mounts should be installed by qualified and trained personnel using proper tools and equipment in safe working conditions following industry standard guidelines for motor vehicle service and repair.

The installer of any compressor mount purchased from TransArctic must undertake all responsibility of issues arising from that compressor bracket being installed on any vehicle. As well as insure that a **proper and sufficient ground** is established between the compressors' clutches and the vehicle's engine. Mount functionality, operation and durability can all be compromised by an incompetent installation.

Due to the many different situations, parameters and application criteria, which are beyond the compressor mount manufacturer's control, TransArctic does not warrant design, durability, or operational functionality of any compressor mount improperly installed by another party.

**With no implied guarantees it is the mount installer's strict responsibility to determine safety and functionality, of the compressor mount, at the time of installation.**

Please contact TransArctic with any issue arising from installation so we may better improve the product. If you have any reservations about the compressor mount integrity contact TransArctic immediately at 1-877-COLD-AIR.

**Mark OEM tensioner location**

**Install Kit**

**Check for Interferences**

**Check to ensure that the proper OEM tensioner orientation is maintained**

**Run engine with A/C system engaged for at least 10 minutes to run in belt**

**Check OEM tensioner orientation and adjust as required**

### **Responsabilidad limitada de TransArctic en la instalación del soporte del compresor**

Todos los soportes de los compresores deben ser instalados por personas calificadas y entrenadas, usando para ello los equipos y herramientas necesarios para esta labor en buenas condiciones y según las normas y guías para el servicio y/o reparación de motores de vehículos.

El instalador de los soportes comprados en TransArctic asume toda la responsabilidad de cualquier problema que surja en el soporte del compresor al vehículo; de igual manera es responsable que el cable a tierra sea conectado entre el embrague del compresor y el motor del vehículo.

Se advierte que el buen funcionamiento y la durabilidad del soporte pueden ser comprometidos por defectos en su instalación.

Debido a las diversas situaciones que se puedan presentar fuera del control del fabricante, TransArctic no garantiza el diseño, la durabilidad o el correcto funcionamiento de cualquier equipo inapropiadamente instalado por terceros.

**Esta sobreentendido que el Instalador del montaje del compresor es estrictamente responsable de la seguridad y funcionamiento del equipo en el momento de la instalación.**

Si tuviera algún problema o duda acerca de la instalación del soporte del compresor pongase en contacto inmediatamente con TransArctic al teléfono 1-877-COLD-AIR de modo que podamos mejorar nuestro producto.

**Note la ubicación del medidor de tensión OEM**

**Instale el equipo**

**Controlar si hay interferencias.**

**Asegurese que el medidor de tensión mantenga la orientación justa.**

**Encienda el motor por lo menos 10 minutos con el sistema A/C enganchado para que la correa corra**

**Controle la orientación justa del medidor de tensión y ajuste a las condiciones requeridas del fabricante**