

Bill of Materials Listing

TransArctic Canada Inc.

12/18/2012
Page 1 of 1

Product Number	Description	Date	Weight	Uof M	Yield	
Line	Component Prod#	Bin	Unit	Qty		
KMC86663	Mt Kit, ISC, D3RE, TM-65,24V, 2A/2B,'12			11/30/2012	248.69	0
10	BEL22311		Belt, B gr, 2311mm (91") (BX88)	each	2	
20	BMC83047		Bkt, Brace, Vert, RR, Bumper, ISC, D3	each	1	
30	BMC83051		Bkt, Side, Extention, Plate	each	2	
40	BMC83052		Bkt, Main, RR Plate, MFDT, RE300	each	1	
50	BMC83053		Bkt, Diag, Brace RR, MFDT, RE300	each	1	
60	BMC83054		Bkt, Main, Idler, Weldm't, RE300	each	1	
70	BMC83057		Bkt, Main, Frt Pl, MFDT, RE300	each	1	
80	BMC83058		Bkt, Cover, Light Pl, MF DT, RE300	each	1	
90	BMC83059		Bkt, Diag, Brace Frt, MF DT, RE300	each	1	
100	BMC83070		Bkt, Sup, Weldm't, ISC, D3RE, '10	each	1	
110	BMC83074		Bkt, Relay, ISC, D3RE, 2010	each	1	
120	BMC83075		Bkt,PI, Exhaust, Adapter, D3RE, '10	each	1	
130	BMN80008		Vibration Isolator, Bar,16.50 x 2 x 1.50	each	2	
140	BMN80009		Bkt, Main, Base Pl, IC, RE300	each	1	
150	BMN80025		Bkt, Back, PL, Slide, IC, RE300	each	1	
160	BMN80031		Bkt, Main, Slide, Assy, 05K, IC, RE300	each	1	
170	BMZ00039		Bkt, Comp, Rear, TM-65, '12	each	1	
180	BMZ00040		Bkt, Comp, FRT, TM-65, '12	each	1	
200	HOA05063		Hose, Flex, CAC, 5.0d x 6.0, 3 ring	each	1	
210	KAC84161		Alt. Kit, 24V, ISC, BBRE, '07	each	1	
220	PUA05012		Pulley, Assy, Idler,B/BX gr,5", STL,Plt	each	1	
230	PUL80074		Pulley, Idler, B/S, Wide, 76d (89102)	each	1	
240	PUL89322		Pulley, Crank, ADD-ON, Combo, ISL, 2B/3V	each	1	
250	SCD37012		Spacer, Col, Drl, 37 mm x 25.4o x 12.3i	each	1	
260	SCD41012		Spacer, Col, Drl, 41 mm x 25.4o x 12.3i	each	1	
270	SLV17012		Sleeve, Pulley, 16.9o x 22.23mm x 12.32i	each	2	
290	TUS05095		Tube, Stl, Exh,5"o.d.,D3RE, ISC, '13	each	1	
300	KBC86663		Bag Kit, Fasteners, KMC86663	each	1	

Include: KRC83010_Retrofit kit (supplied in SGA). /JDS_ DEC 14-12

Bill of Materials Listing

TransArctic Canada Inc.

7/4/2013

Page 1 of 1

Product Number		Description	Bin	Date	Weight	Uof M	Yield
Line	Component Prod#	Description		Unit	Qty		
KBC86663		Bag Kit, Fasteners, KMC86663		11/30/2012	5.07		0
10	BTC08035	Bolt, Hex, 8 x 1.25 x 35mm, 10.9, Plt,FT		each	4		
20	BTC10040	Bolt, Hex, 10 x 1.5 x 40mm, 10.9, Plt,FT		each	4		
30	BTC12035	Bolt, Hex, 12 x 1.75 x 35mm, 10.9,Plt,FT		each	5		
40	BTC12040	Bolt, Hex, 12 x 1.75 x 40mm, 10.9,Plt,FT		each	4		
50	BTC12050	Bolt, Hex, 12 x 1.75 x 50mm, 10.9,Plt		each	2		
60	BTC12100	Bolt, Hex, 12 x 1.75 x 100mm, 10.9, Plt		each	2		
70	BTP08653	Bolt, Hex, 1/2-13unc, 6.5", 5, Plt, FT		each	1		
80	BTQ05075	Bolt, Hex, 5/16-18unc, .75", 8, Plt		each	4		
90	BTQ08126	Bolt, Hex, 1/2-20unf, 1.25", 8, Plt		each	11		
100	BTQ08151	Bolt, Hex, 1/2-20unf, 1.5", 8, Plt		each	2		
110	NTA12000	Nut, Hex, 12 x 1.75, 8.8, Plt		each	9		
120	NTP07000	Nut, Hex, 7/16-14unc, 5, Plt		each	4		
125	SCP03075	Screw, PH, PD, SDT, #10-16 x .75, ST,Plt		each	3		
130	WFA08000	Washer, Flat, 8mm, 8.8, Plt		each	4		
140	WFA10000	Washer, Flat, 10mm, 8.8, Plt		each	4		
150	WFA12000	Washer, Flat, 12mm, 8.8, Plt		each	16		
160	WFN05000	Washer, Flat, 5/16", 2, Plt		each	4		
170	WFN07000	Washer, Flat, 7/16", 2, Plt		each	4		
180	Wfq08000	Washer, Flat, 1/2", 8, Plt		each	12		
190	WLA08000	Washer, Lock, 8mm, 8.8, Plt		each	4		
200	WLA10000	Washer, Lock, 10mm, 8.8, Plt		each	4		
210	WLA12000	Washer, Lock, 12mm, 8.8, Plt		each	13		
220	WLP05000	Washer, Lock, 5/16", 5, Plt		each	4		
230	WLP07000	Washer, Lock, 7/16", 5, Plt		each	4		
240	WLP08000	Washer, Lock, 1/2", 5, Plt		each	13		

Bill of Materials Listing

TransArctic Canada Inc.

4/21/2010
Page 1 of 1

Product Number	Description	Date	Weight	Uof M	Yield
Line Component Prod#	Description	Bin Unit	Qty		
KAC84161	Alt. Kit, 24V, ISC, BBRE, '07		10/18/2007	11.77	0
10 BEL81257	Belt, 8gr, 1257mm (49.5") (5080495)		each	1	
20 BMC83015	Bkt, Alt, Weldmt, ISC, BBRE, '07		each	1	
30 PUL83008	Pulley, Fan, Add-on, Cum, ISC, 8.3, 8gr		each	1	
40 PUL80064	Pulley,ALT,Frontside,P8,63.5d (3972808)		each	1	
50 TEN80002	Tenr, HD Spring, BackSide, CCW (89200A)		each	1	
60 KBA84161	Bag Kit, Fasteners, KAC84161		each	1	

Bill of Materials Listing

TransArctic Canada Inc.

4/27/2010
Page 1 of 1

Product Number	Description	Date	Weight	Uof M	Yield
Line Component Prod#	Description	Bin Unit	Qty		
KBA84161	Bag Kit, Fasteners, KAC84161		10/19/2007	1.07	0
10 BTC10090	Bolt, Hex, 10 x 1.5 x 90mm, 10.9, Plt	each	1		
20 BTC10055	Bolt, Hex, 10 x 1.5 x 55mm, 10.9, Plt,FT	each	3		
25 CSS10055	Capscrew, SH, 10 x 1.5 x 55mm, 12.9,Plt	each	1		
30 BTQ08653	Bolt, Hex, 1/2-13unc, 6.5", 8, Plt	each	1		
40 BTQ08150	Bolt, Hex, 1/2-13unc, 1.5", 8, Plt	each	1		
50 NTA10000	Nut, Hex, 10 x 1.5, 8.8, Plt	each	1		
60 NTP08000	Nut, Hex, 1/2-13unc, 5, Plt	each	1		
70 WFA10000	Washer, Flat, 10mm, 8.8, Plt	each	4		
80 WFAQ08000	Washer, Flat, 1/2", 8, Plt	each	3		
90 WLA10000	Washer, Lock, 10mm, 8.8, Plt	each	4		
100 WLQ08000	Washer, Lock, 1/2", 8, Plt	each	2		

Bill of Materials Listing

TransArctic Canada Inc.

7/4/2013
Page 1 of 1

Product Number	Description	Date	Weight	Uof M	Yield
Line Component Prod#	Description	Bin Unit	Qty		
KRC83010	Kit, Retrofit, CUM, ISC, Filter Mind,'12		12/14/2012	0.26	0
5	CLP05000		Clamp, T bolt, Spring, 5", CAC	each	2
10	FTS06006		Ftg, Pipe, Adapter, Bulkhead, 1/8x1-1/2	each	1
20	FTS06007		Ftg, Pipe, Elbow, 90 DEG, Male	each	2
30	TUP00014		Ftg, Tubing, Plastic, 1/4 OD, Black	teet	2.50

NOTES:

USE THIS KIT TO RELOCATE THE OEM FILTER MINDER.

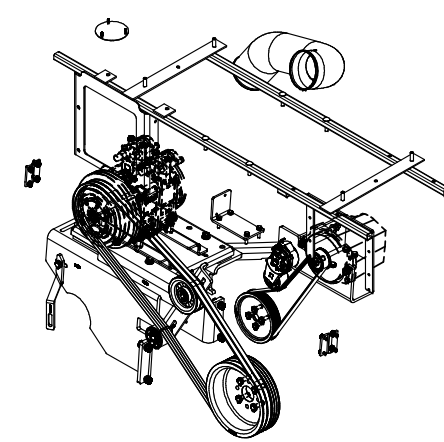
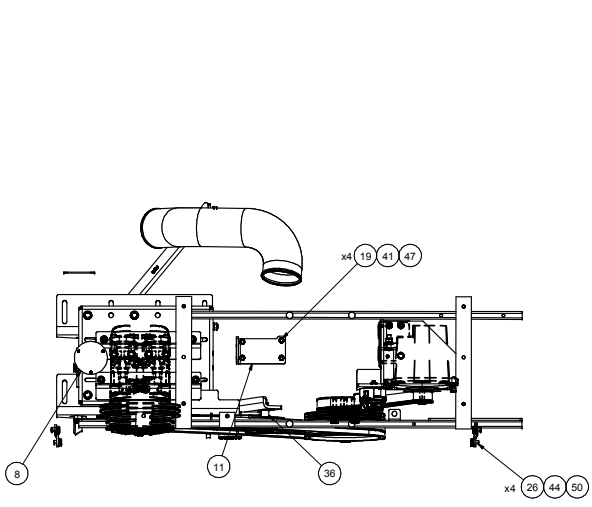

ISOMETRIC VIEW

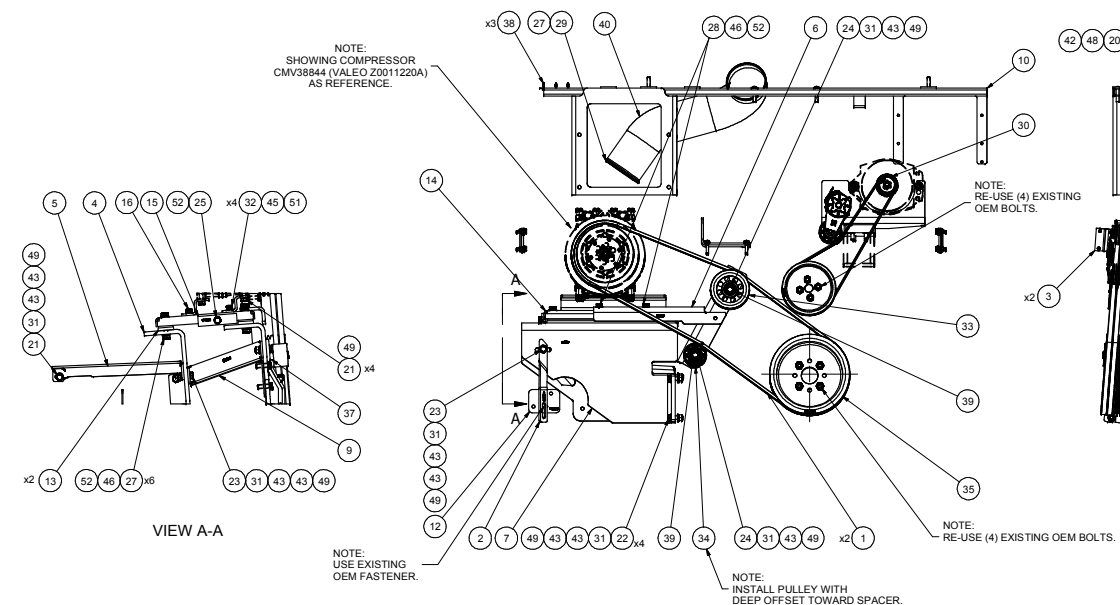

VIEW A-A

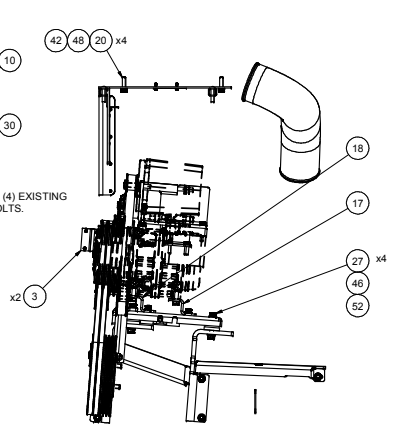

NOTES:
 1) USE SERVICABLE THREADLOCKER ON ALL FASTENERS TO ENGINE COMPONENTS AND TORQUE ALL BOLTS TO S.A.E. SPECIFICATIONS.
 2) SEE "TRANSARGTIC A/C COMPRESSOR MOUNT INSTALLATION DISCLAIMER".

ITEM	QTY	U/M	PART NUMBER	DESCRIPTION
52	13	EACH	WLP08000	WASHER, LOCK, 1/2", 5, PLT
51	4	EACH	WLP07000	WASHER, LOCK, 7/16", 5, PLT
50	4	EACH	WLP05000	WASHER, LOCK, 5/16", PLT
49	13	EACH	WLA12000	WASHER, LOCK, 12mm, 8.8, PLT
48	4	EACH	WLA10000	WASHER, LOCK, 10mm, 8.8, PLT
47	4	EACH	WLA08000	WASHER, LOCK, 8mm, 8.8, PLT
46	12	EACH	WFO08000	WASHER, FLAT, 1/2", 8, PLT
45	4	EACH	WFO07000	WASHER, FLAT, 7/16", 2, PLT
44	4	EACH	WFO05000	WASHER, FLAT, 5/16", 2, PLT
43	16	EACH	WFA12000	WASHER, FLAT, 12mm, 8.8, PLT
42	4	EACH	WFA10000	WASHER, FLAT, 10mm, 8.8, PLT
41	4	EACH	WFA08000	WASHER, FLAT, 8mm, 8.8, PLT
40	1	EACH	TUS05095	TUBE, STL, EXH, 5" O.D., D3RE, ISC, '13
39	2	EACH	SLV17012	SLEEVE, PULLEY, 16.90 x 22.23 mm x12.19
38	3	EACH	SCR03075	SCREW, PH, SDT, #10-16 x .75, ST, PLT
37	1	EACH	SCD41012	SPACER, COL, DRL, 41mm x 25.40 x 12.3
36	1	EACH	SCD37012	SPACER, COL, DRL, 37mm x 25.40 x 12.3
35	1	EACH	PUL89322	PULLEY, CRANK, ADD-ON, COMBO, ISL, 2B/3V
34	1	EACH	PUL80074	PULLEY, IDLER, BACKSIDE, P8, 74D, 46.27W
33	1	EACH	PUA05012	PULLEY, ASSY, IDLER, B/BX gr, 5" STL, PLT
32	4	EACH	NTP07000	NUT, HEX, 7/16-14UNC, 5, PLT
31	9	EACH	NTA12000	NUT, HEX, 12 x 1.75, 8.8, PLT
30	1	EACH	KAC94161	ALT. KIT, 24V, ISC, BBR6, '07
29	1	EACH	HQA05063	HOSE, FLEX, GAC, 5.00 x 6.0, 3 RING
28	2	EACH	BTQ08151	BOLT, HEX, 1/2-20UNF x 1.50, 8, PLT
27	11	EACH	BTQ08126	BOLT, HEX, 1/2-20UNF x 1.25, 8, PLT
26	4	EACH	BTQ05075	BOLT, HEX, 5/16-18UNC, .75", 8, PLT
25	1	EACH	BTP08653	BOLT, HEX, 1/2-13UNC x 6.50, 5, PLT, FT
24	2	EACH	BTC12100	BOLT, HEX, 12 x 1.75 x 100mm, 10.9, PLT
23	2	EACH	BTC12050	BOLT, HEX, 12 x 1.75 x 50mm, 10.9, PLT
22	4	EACH	BTC12040	BOLT, HEX, 12 x 1.75 x 40mm, 10.9, PLT
21	5	EACH	BTC12035	BOLT, HEX, 12 x 1.75 x 35mm, 10.9, PLT
20	4	EACH	BTC10040	BOLT, HEX, 10 x 1.5 x 40mm, 10.9, PLT
19	4	EACH	BTC08035	BOLT, HEX, 8 x 1.25 x 35mm, 10.9, PLT
18	1	EACH	BMZ00040	BKT, COMP, FRT, TM-65, '12
17	1	EACH	BMZ00039	BKT, COMP, REAR, TM-65, '12
16	1	EACH	BMN80031	BKT, MAIN, SLIDE, ASSY, 05K, IC, RE300
15	1	EACH	BMN80025	BKT, BACK, PL, SLIDE, IC, RE300
14	1	EACH	BMN80009	BKT, MAIN, BASE, PL, IC, RE300
13	2	EACH	BMN80008	VIBRATION ISOLATOR, BAR, 16.50 x 2 x 1.50
12	1	EACH	BMC83075	BKT, PL, EXHAUST, ADAPTER, D3RE, '10
11	1	EACH	BMC83074	BKT, RELAY, ISC, D3RE, 2010
10	1	EACH	BMC83070	BKT, SUP, WELDMT, ISC, D3RE, '10
9	1	EACH	BMC83059	BKT, DIAG, BRACE FRT, MFDT, RE300
8	1	EACH	BMC83058	BKT, COVER, LIGHT PL, MFDT, RE300
7	1	EACH	BMC83057	BKT, MAIN, FRT PL, MFDT, RE300
6	1	EACH	BMC83054	BKT, MAIN, IDLER, WELDMT, RE300
5	1	EACH	BMC83053	BKT, DIAG, BRACE RR, MFDT, RE300
4	1	EACH	BMC83052	BKT, MAIN, RR PL, MFDT, RE300
3	2	EACH	BMC83051	BKT, SIDE, EXTENSION, PLATE
2	1	EACH	BMC83047	BKT, BRACE, VERT, RIS, BUMPER, ISC, D3
1	2	EACH	BEL22311	BELT, B Gr, 2311 mm (91") (BX88)

DRAWN: Jodiquez		11/28/2012	TRANSARGTIC INC.
CHECKED: Val Jakowlew		11/28/2012	
REV: ECN	DESCRIPTION:	DATE:	BY:
0	RELEASED TO PRODUCTION:	11/28/2012	BRK CA
1		11/28/2012	James Stewart
2		11/28/2012	Ron Ingram
3		11/28/2012	Dale Mason

THIS DRAWING CONTAINS PROPRIETARY CONFIDENTIAL INFORMATION OWNED BY TRANSARGTIC CANADA INC. THE DOCUMENT AND THE INFORMATION IN IT ARE NOT TO BE USED, DISCLOSED OR REPRODUCED WITHOUT EXPRESS WRITTEN PERMISSION OF THE COMPANY.

UNSPECIFIED TOLERANCES:	(ALL DIMS)	GROUP
ONE DECIMAL PLACE (10)	AS SHOWN	
TWO DECIMAL PLACE (20)	AS SHOWN	
FRACTIONAL (1/32)	AS SHOWN	

DRAWING UNIT OF MEASURE:	MM (INCH)
SCALE:	1:8

MT KIT, ISC, D3RE, TM-65, 24V, 2A/2B, '12

DWG NO: KMC86663

REV: 0

SHEET 1 OF 1

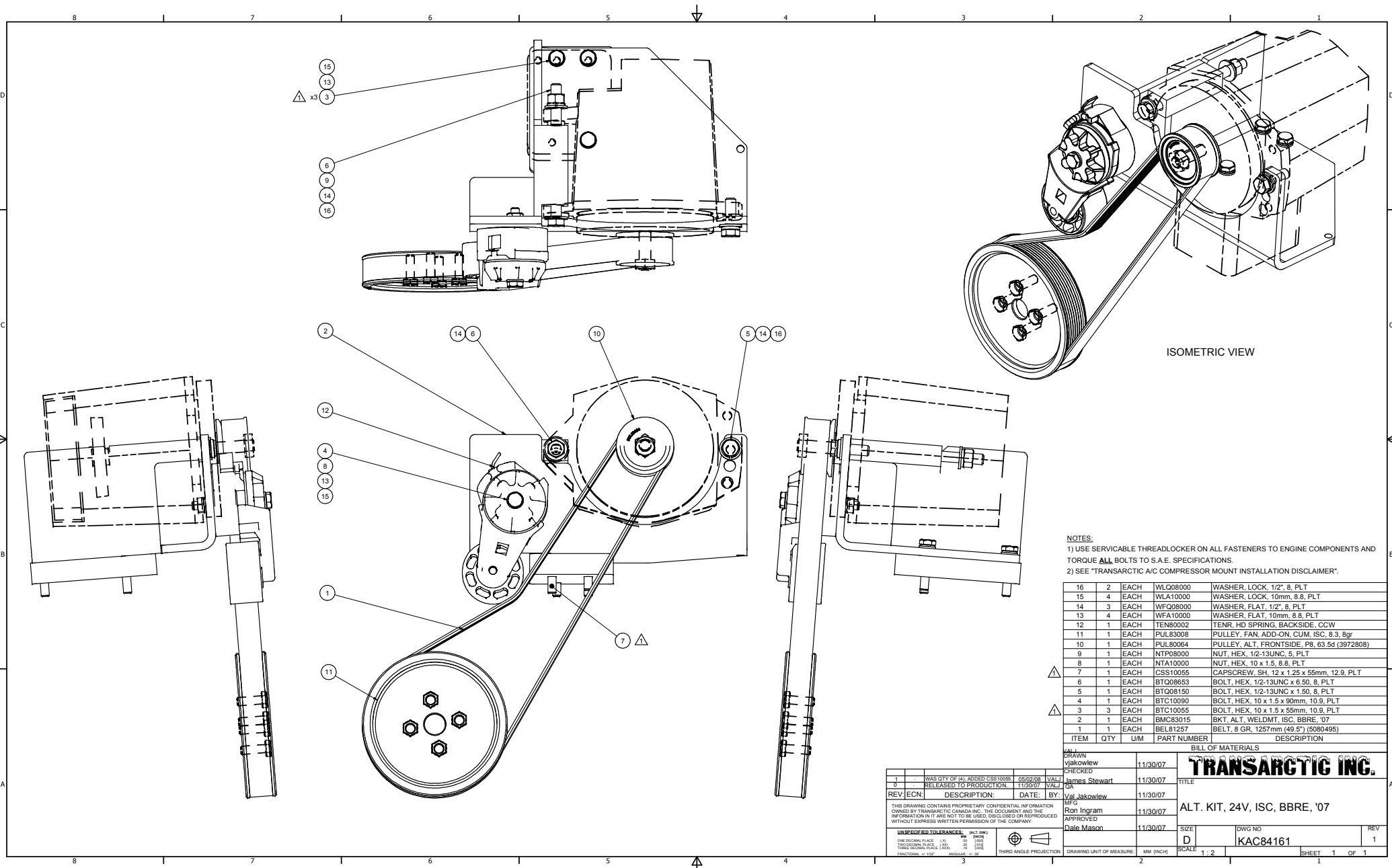

ISOMETRIC VIEW

NOTES:
 1) USE SERVICABLE THREADLOCKER ON ALL FASTENERS TO ENGINE COMPONENTS AND TORQUE **ALL** BOLTS TO S.A.E. SPECIFICATIONS.
 2) SEE "TRANSARGTIC A/C COMPRESSOR MOUNT INSTALLATION DISCLAIMER".

ITEM	QTY	UM	PART NUMBER	DESCRIPTION
16	2	EACH	WLA08000	WASHER, LOCK, 1/2", 8, PLT
15	4	EACH	WLA10000	WASHER, LOCK, 10mm, 8.8, PLT
14	3	EACH	WFA08000	WASHER, FLAT, 1/2", 8, PLT
13	4	EACH	WFA10000	WASHER, FLAT, 10mm, 8.8, PLT
12	1	EACH	TEN80002	TENR. HD SPRING, BACKSIDE, CCW
11	1	EACH	PUL83008	PULLEY, FAN, ADD-ON, CUM, ISC, 8.3, 8gr
10	1	EACH	PUL80064	PULLEY, ALT, FRONTSIDE, PB, 63.5d (3972808)
9	1	EACH	NTP08000	NUT, HEX, 1/2-13UNC, 5, PLT
8	1	EACH	NTA10000	NUT, HEX, 10 x 1.5, 8.8, PLT
7	1	EACH	CSS10055	CAPSCREW, SH, 12 x 1.25 x 55mm, 12.9, PLT
6	1	EACH	BT008653	BOLT, HEX, 1/2-13UNC x 6.50, 8, PLT
5	1	EACH	BT008150	BOLT, HEX, 1/2-13UNC x 1.50, 8, PLT
4	1	EACH	BT010090	BOLT, HEX, 10 x 1.5 x 90mm, 10.9, PLT
3	3	EACH	BT010055	BOLT, HEX, 10 x 1.5 x 55mm, 10.9, PLT
2	1	EACH	BMC83015	BKT, ALT, WELDMT, ISC, BBRE, '07
1	1	EACH	BEL81257	BELT, 8 GR, 1257mm (49.5") (5080495)

BILL OF MATERIALS				
VAL	DRAWN	11/30/07	DRAWING UNIT OF MEASURE	
VAL	CHKD	11/30/07	MM (INCH)	
VAL	CHKD	11/30/07	SCALE 1:2	
VAL	CHKD	11/30/07	SHEET 1 OF 1	
REV	DESCRIPTION	DATE	BY	
1	WAS QTY OF (4) ADDED CSS10055	05/02/08	VAL	
2	RELEASED TO PRODUCTION	11/30/07	VAL	
3			VAL	
4			VAL	
5			VAL	
6			VAL	
7			VAL	
8			VAL	
9			VAL	
10			VAL	
11			VAL	
12			VAL	
13			VAL	
14			VAL	
15			VAL	
16			VAL	

TRANSARGTIC INC.	
ALT. KIT, 24V, ISC, BBRE, '07	
REV	DESCRIPTION
1	WAS QTY OF (4) ADDED CSS10055
2	RELEASED TO PRODUCTION
3	
4	
5	
6	
7	
8	
9	
10	
11	
12	
13	
14	
15	
16	

UNSPECIFIED TOLERANCES: (ALL DIM) (UNLESS OTHERWISE SPECIFIED)
 ONE DECIMAL PLACE (10) 0.10 (10)
 TWO DECIMAL PLACE (20) 0.05 (20)
 FRACTIONAL (1/32) 0.0031 (1/32)



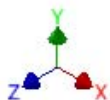
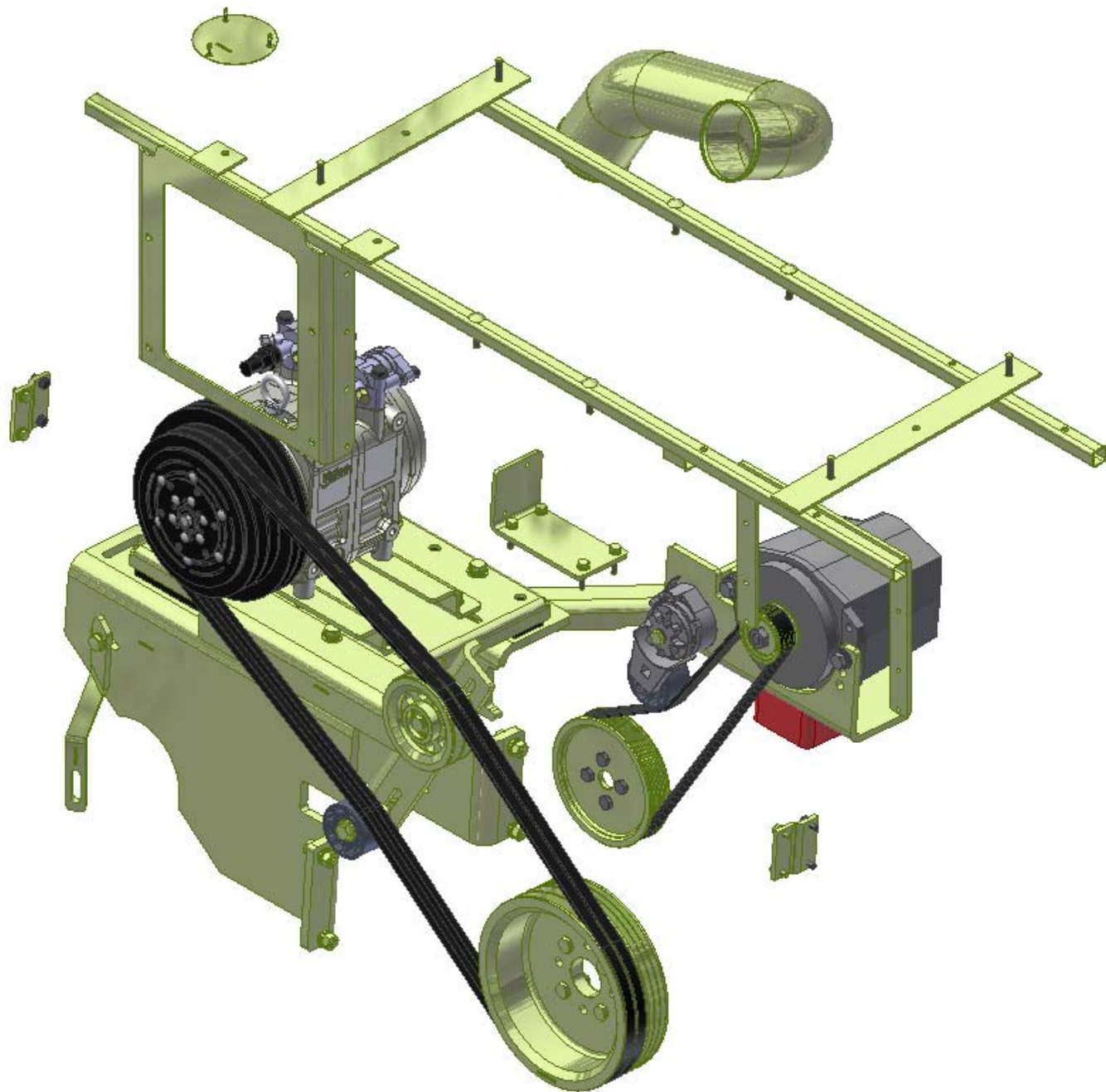

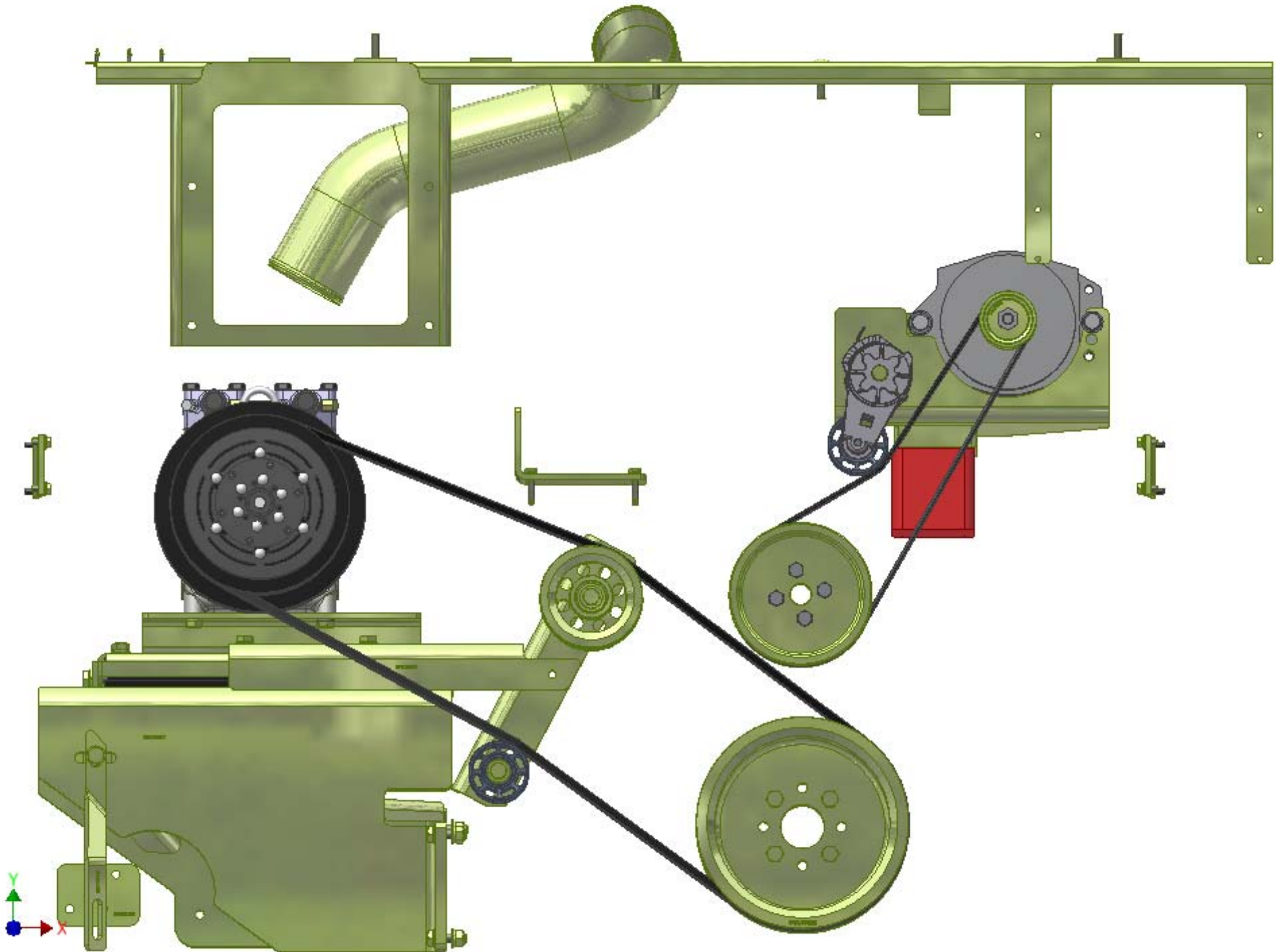

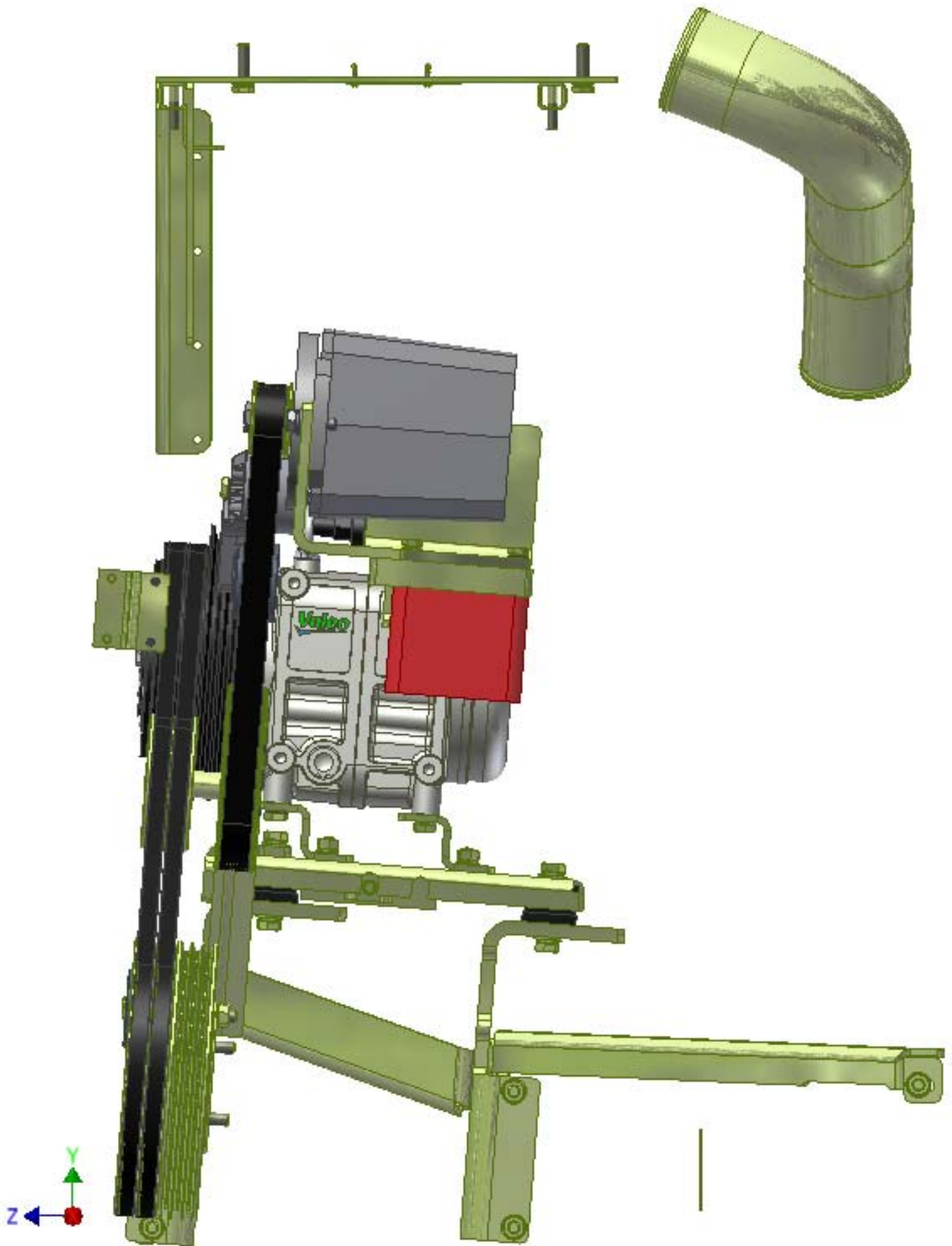

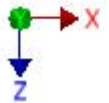
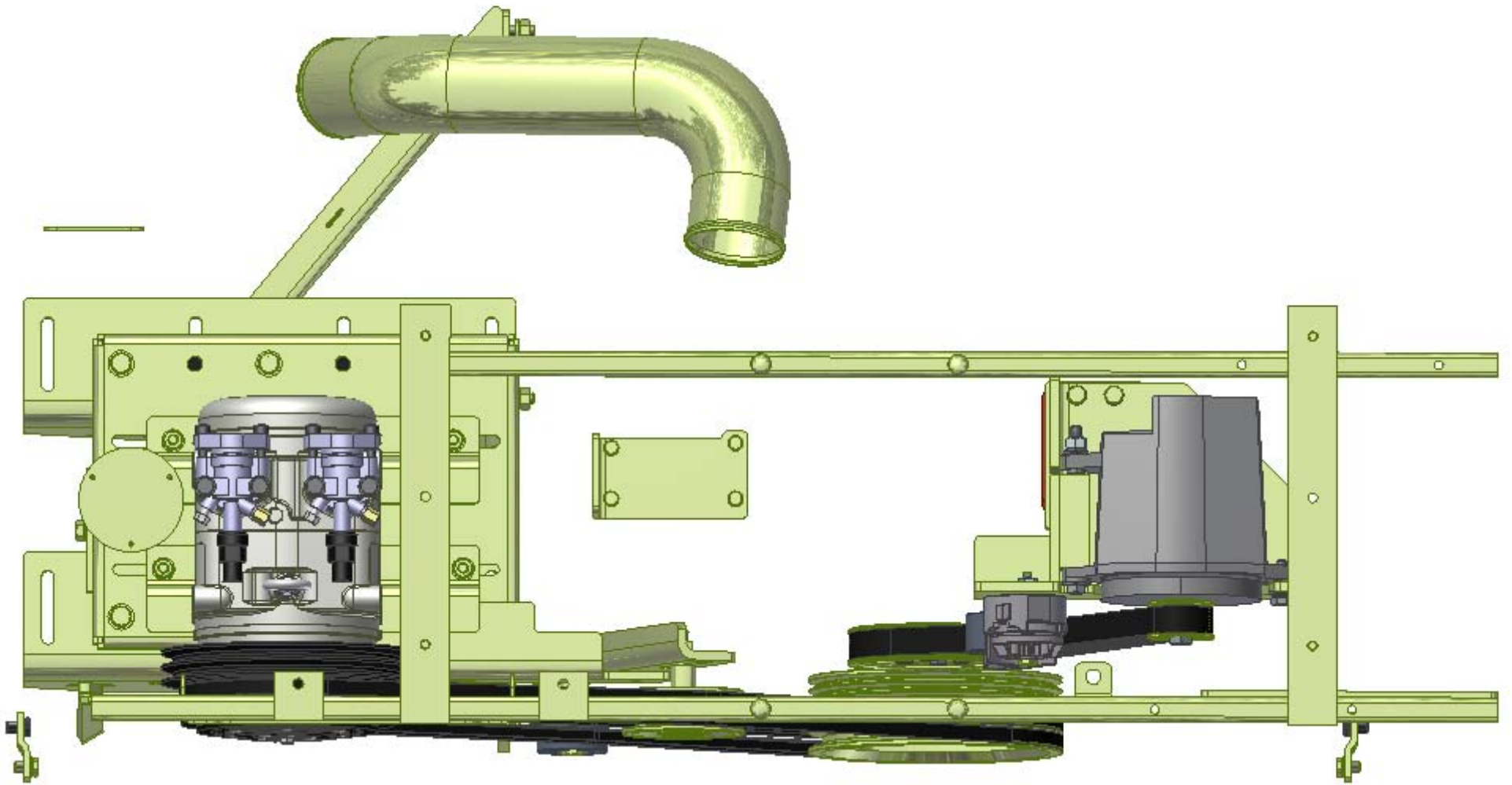

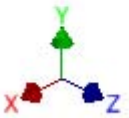
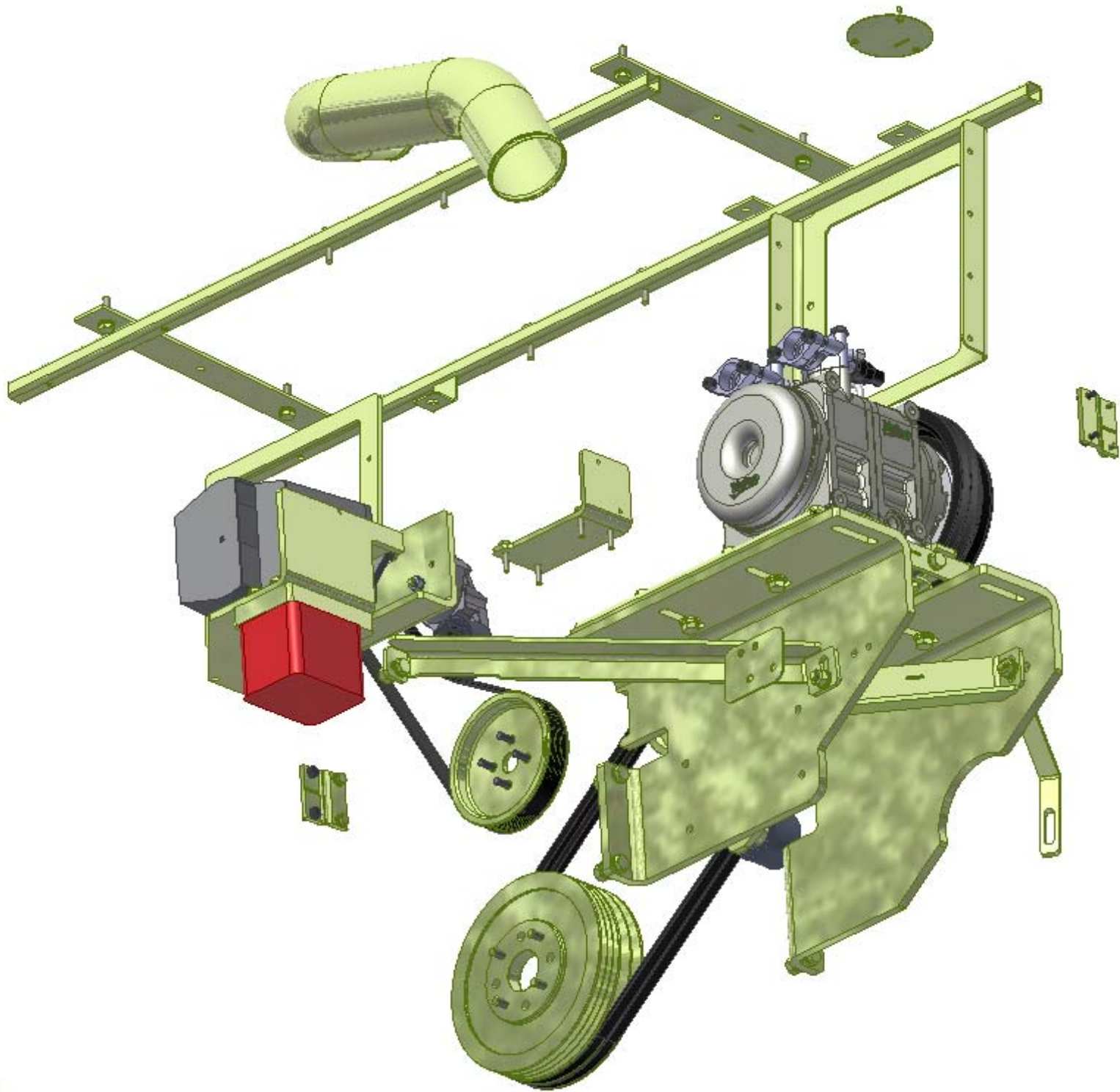

TransArctic A/C Compressor Mount Installation Disclaimer

All compressor mounts should be installed by qualified and trained personnel using proper tools and equipment in safe working conditions following industry standard guidelines for motor vehicle service and repair.

The installer of any compressor mount purchased from TransArctic must undertake all responsibility of issues arising from that compressor bracket being installed on any vehicle. As well as insure that a **proper and sufficient ground** is established between the compressors' clutches and the vehicle's engine. Mount functionality, operation and durability can all be compromised by an incompetent installation.

Due to the many different situations, parameters and application criteria, which are beyond the compressor mount manufacturer's control, TransArctic does not warrant design, durability, or operational functionality of any compressor mount improperly installed by another party.

With no implied guarantees it is the mount installer's strict responsibility to determine safety and functionality, of the compressor mount, at the time of installation.

Please contact TransArctic with any issue arising from installation so we may better improve the product. If you have any reservations about the compressor mount integrity contact TransArctic immediately at 1-877-COLD-AIR.

Mark OEM tensioner location

Install Kit

Check for Interferences

Check to ensure that the proper OEM tensioner orientation is maintained

Run engine with A/C system engaged for at least 10 minutes to run in belt

Check OEM tensioner orientation and adjust as required

Responsabilidad limitada de TransArctic en la instalación del soporte del compresor

Todos los soportes de los compresores deben ser instalados por personas calificadas y entrenadas, usando para ello los equipos y herramientas necesarios para esta labor en buenas condiciones y según las normas y guías para el servicio y/o reparación de motores de vehículos.

El instalador de los soportes comprados en TransArctic asume toda la responsabilidad de cualquier problema que surga en el soporte del compresor al vehículo; de igual manera es responsable que el cable a tierra sea conectado entre el embrague del compresor y el motor del vehículo.

Se advierte que el buen funcionamiento y la durabilidad del soporte pueden ser comprometidos por defectos en su instalación.

Debido a las diversas situaciones que se puedan presentar fuera del control del fabricante, TransArctic no garantiza el diseño, la durabilidad o el correcto funcionamiento de cualquier equipo inapropiadamente instalado por terceros.

Esta sobreentendido que el Instalador del montaje del compresor es estrictamente responsable de la seguridad y funcionamiento del equipo en el momento de la instalación.

Si tuviera algún problema o duda acerca de la instalación del soporte del compresor pongase en contacto inmediatamente con TransArctic al teléfono 1-877-COLD-AIR de modo que podamos mejorar nuestro producto.

Note la ubicación del medidor de tensión OEM

Instale el equipo

Controlar si hay interferencias.

Asegurese que el medidor de tensión mantenga la orientación justa.

Encienda el motor por lo menos 10 minutos con el sistema A/C enganchado para que la correa corra

Controle la orientación justa del medidor de tensión y ajuste a las condiciones requeridas del fabricante