

Bill of Materials Listing

TransArctic Canada Inc.

12/16/2011
Page 1 of 1

| Product Number | Description | Date | Weight | Uof M | Yield |
|----------------------------|--|---------------------|----------------------------------|---------------|----------|
| Line Component Prod# | Description | Bin Unit | Qty | | |
| KMC62560 | Mt Kit, 6.7L ISB, A3RE, F400, '07 | | 2/17/2009 | 231.96 | 0 |
| 5 | BEL22413 | | Belt, B gr, 2413mm (95") (BX92) | each | 2 |
| 10 | KAC64161 | | Alt. Kit, 24V, ISB, BBRE, '07 | each | 1 |
| 20 | KBB64161 | | Mt Kit, Base, Transit, BBRE, '07 | each | 1 |
| 30 | KFT62560 | | Mt Kit, Transit, F400, '07 | each | 1 |
| 40 | KPC64161 | | Kit, Pulley, ISB, A3RE, '07 | each | 1 |

Bill of Materials Listing

TransArctic Canada Inc.

11/25/2011
Page 1 of 1

| Product Number | Description | Date | Weight | Uof M | Yield |
|----------------------------|--------------------------------------|-------------------------------|---|--------------|----------|
| Line Component Prod# | Description | Bin Unit | Qty | | |
| KAC64161 | Alt. Kit, 24V, ISB, BBRE, '07 | | 4/21/2008 | 33.17 | 0 |
| 10 | BEL81104 | | Belt, 8gr, 1104mm (43.5") (5080435) | each | 1 |
| 20 | BMC67016 | | Bkt, Main, ALT, Weldm't, ISB, 08 | each | 1 |
| 30 | BMC67030 | | Bkt, Tenr Arm, ALT | each | 1 |
| 40 | PUL80064 | | Pulley,ALT,Frontside,P8,63.5d (3972808) | each | 1 |
| 50 | PUL80076 | | Pulley, Idler, Backside, P8, 76d (89062) | each | 1 |
| 60 | PUL83008 | | Pulley, Fan, Add-on, Cum, ISC, 8.3, 8gr | each | 1 |
| 70 | SCD09010 | | Spacer, Col, Drl, 9mm x 25.4o x10.32i | each | 1 |
| 80 | SLV17010 | | Sleeve, Pulley, 16.9o x 22.23mm x 10.32i | each | 1 |
| 90 | TEN00002 | | Tenr, Spring, Un-Direct, 90d, 3/8 x 4.5"/3.5" | each | 1 |
| 100 | PNS04012 | | Pin, Spring, 1/4" d x 3/4" lg, ST, PLT | each | 1 |
| 110 | KBA64161 | | Bag Kit, Fasteners, KAC64161 | each | 1 |

TEN00002 to be set-up as CW rotation @ 4.5" CTL base to CTL pulley.

Bill of Materials Listing

TransArctic Canada Inc.

11/25/2011
Page 1 of 1

| Product Number | Description | Date | Weight | Uof M | Yield |
|---|--|------------------|-------------|-------|----------|
| Line Component Prod# Description | Bin | Unit | Qty | | |
| KBA64161 | Bag Kit, Fasteners, KAC64161 | 4/21/2008 | 1.53 | | 0 |
| 10 BTC10055 | Bolt, Hex, 10 x 1.5 x 55mm, 10.9, Plt,FT | each | 1 | | |
| 20 BTC10100 | Bolt, Hex, 10 x 1.5 x 100mm, 10.9,Plt,FT | each | 3 | | |
| 30 BTC10030 | Bolt, Hex, 10 x 1.5 x 30mm, 10.9, Plt | each | 1 | | |
| 40 CSF06250 | Capscrew, FH, 3/8-16 x 2.5", Alloy, Plt | each | 1 | | |
| 50 BTQ08653 | Bolt, Hex, 1/2-13unc, 6.5", 8, Plt | each | 1 | | |
| 60 BTQ08150 | Bolt, Hex, 1/2-13unc, 1.5", 8, Plt | each | 2 | | |
| 70 NTA10000 | Nut, Hex, 10 x 1.5, 8.8, Plt | each | 1 | | |
| 80 NTP08000 | Nut, Hex, 1/2-13unc, 5, Plt | each | 1 | | |
| 90 WFA10000 | Washer, Flat, 10mm, 8.8, Plt | each | 5 | | |
| 100 WFQ08000 | Washer, Flat, 1/2", 8, Plt | each | 4 | | |
| 110 WLA10000 | Washer, Lock, 10mm, 8.8, Plt | each | 5 | | |
| 120 WLQ08000 | Washer, Lock, 1/2", 8, Plt | each | 3 | | |

Bill of Materials Listing

TransArctic Canada Inc.

11/24/2011
Page 1 of 1

| Product Number | Description | Date | Weight | Uof M | Yield |
|----------------------|--|------------------|---------------|-------|----------|
| Line Component Prod# | Description | Bin Unit | Qty | | |
| KBB64161 | Mt Kit, Base, Transit, BBRE, '07 | 8/31/2007 | 159.41 | | 0 |
| 20 BMC83019 | Bkt, Gusset, Bumper, ISC, BBRE, '07 | each | 1 | | |
| 30 BMC83020 | Bkt, Dampner, ISC, BBRE, '07 | each | 1 | | |
| 40 BMC83021 | Bkt, Comp, Frt, ISC, BBRE, '07 | each | 1 | | |
| 50 BMC83022 | Bkt, Comp, Rear, ISC, BBRE, '07 | each | 1 | | |
| 60 BMC83023 | Bkt, Gusset, Idler, ISC, BBRE, '07 | each | 1 | | |
| 70 BMC83043 | Bkt, Main, Idler, ISB, BBRE, '07 | each | 1 | | |
| 80 BMC83026 | Bkt, Sprt, Bump, Rear, ISC, BBRE, '07 | each | 1 | | |
| 90 BMC83027 | Bkt, Sprt, Bump, Side, ISC, BBRE, '07 | each | 1 | | |
| 100 BMC83028 | Bkt, Tray, ISC, BBRE, '07 | each | 1 | | |
| 110 BMC83029 | Bkt, Shift, Tank, Weldmt, ISC, BBRE, '07 | each | 1 | | |
| 115 BMC83031 | Bkt, Slide, Block, Idler, BBRE | each | 1 | | |
| 120 BMN80008 | Vibration Isolator, Bar, 16.50 x 2 x 1.50 | each | 2 | | |
| 130 BMN80009 | Bkt, Main, Base Pl, IC, RE300 | each | 1 | | |
| 160 BMN80025 | Bkt, Back, PL, Slide, IC, RE300 | each | 1 | | |
| 170 PUA06001 | Pulley, Assy, Idler, B/S, 6", Stl, Plt | each | 1 | | |
| 180 PUA05012 | Pulley, Assy, Idler, B/BX gr, 5", STL, Plt | each | 1 | | |
| 220 SCD32812 | Spacer, Step, Drl, 32.8mm x 50.8o x 12.3i | each | 1 | | |
| 225 SPC19010 | Spacer, Col, Drl, 19mm x 28.58o x 10.32i | each | 2 | | |
| 240 SCD48012 | Spacer, Col, Drl, 48 mm x 34.9o x 12.3i | each | 1 | | |
| 250 SLV17012 | Sleeve, Pulley, 16.9o x 22.23mm x 12.32i | each | 2 | | |
| 280 KBT84161 | Bag Kit, Fasteners, KBB84161 | each | 1 | | |

Bill of Materials Listing

TransArctic Canada Inc.

11/9/2011
Page 1 of 1

| Product Number | | Description | Bin | Date | Weight | Uof M | Yield |
|-----------------|-----------------|--|-----|------------------|-------------|-------|----------|
| Line | Component Prod# | Description | | Unit | Qty | | |
| KBT84161 | | Bag Kit, Fasteners, KBB84161 | | 8/29/2007 | 5.37 | | 0 |
| 10 | BTC08020 | Bolt, Hex, 8 x 1.25 x 20mm, 10.9, Plt | | each | 2 | | |
| 20 | BTC08035 | Bolt, Hex, 8 x 1.25 x 35mm, 10.9, Plt,FT | | each | 1 | | |
| 50 | BTC12040 | Bolt, Hex, 12 x 1.75 x 40mm, 10.9,Plt,FT | | each | 10 | | |
| 60 | BTC12050 | Bolt, Hex, 12 x 1.75 x 50mm, 10.9,Plt | | each | 1 | | |
| 70 | BTC12060 | Bolt, Hex, 12 x 1.75 x 60mm, 10.9,Plt,FT | | each | 1 | | |
| 100 | BTC12100 | Bolt, Hex, 12 x 1.75 x 100mm, 10.9, Plt | | each | 2 | | |
| 105 | BTP08653 | Bolt, Hex, 1/2-13unc, 6.5", 5, Plt, FT | | each | 1 | | |
| 115 | BTQ06200 | Bolt, Hex, 3/8-16unc, 2.0", 8, Plt | | each | 2 | | |
| 120 | BTQ08126 | Bolt, Hex, 1/2-20unf, 1.25", 8, Plt | | each | 12 | | |
| 135 | BTQ08200 | Bolt, Hex, 1/2-13unc, 2.0", 8, Plt | | each | 3 | | |
| 160 | CSF06075 | Capscrew, FH, 3/8-16 x .75", Alloy, Plt | | each | 2 | | |
| 170 | NTA08000 | Nut, Hex, 8 x 1.25, 8.8, Plt | | each | 3 | | |
| 190 | NTA12000 | Nut, Hex, 12 x 1.75, 8.8, Plt | | each | 13 | | |
| 200 | NTP06000 | Nut, Hex, 3/8-16unc, 5, Plt | | each | 2 | | |
| 230 | WFA08000 | Washer, Flat, 8mm, 8.8, Plt | | each | 4 | | |
| 250 | WFA12000 | Washer, Flat, 12mm, 8.8, Plt | | each | 24 | | |
| 270 | WFQ08000 | Washer, Flat, 1/2", 8, Plt | | each | 15 | | |
| 280 | WLA08000 | Washer, Lock, 8mm, 8.8, Plt | | each | 3 | | |
| 300 | WLA12000 | Washer, Lock, 12mm, 8.8, Plt | | each | 14 | | |
| 330 | WLQ08000 | Washer, Lock, 1/2", 8, Plt | | each | 13 | | |

Bill of Materials Listing

TransArctic Canada Inc.

12/16/2011
Page 1 of 1

| Product Number | Description | Date | Weight | Uof M | Yield |
|-------------------------|--|---------------------|------------------|--------------|----------|
| Line Component Prod# | Description | Bin Unit | Qty | | |
| KFT62560 | Mt Kit, Transit, F400, '07 | | 2/17/2009 | 24.16 | 0 |
| 10 BMN80031 | Bkt, Main, Slide, Assy, 05K, IC, RE300 | each | 1 | | |
| 20 BMN80032 | Bkt, Adapter, PL, IC, RE300 | each | 1 | | |
| 30 BMN80057 | Bkt, Comp, FRT, Bar, Bitzer, RE300 | each | 1 | | |
| 40 BMN80058 | Bkt, Comp, RR, Bar, Bitzer, RE300 | each | 1 | | |
| 50 CSF10066 | Capscrew, FH, 10 x 1.5 x 65mm, 10.9,Plt | each | 2 | | |
| 60 CSF10031 | Capscrew, FH, 10 x 1.5 x 30mm, 10.9,Plt | each | 2 | | |
| 70 CSF08150 | Capscrew, FH, 1/2-13 x 1.50", Alloy, Plt | each | 2 | | |
| 80 CSF08300 | Capscrew, FH, 1/2-13 x 3", Alloy, Plt | each | 2 | | |
| 85 NTP07000 | Nut, Hex, 7/16-14unc, 5, Plt | each | 4 | | |
| 90 NTP08000 | Nut, Hex, 1/2-13unc, 5, Plt | each | 4 | | |
| 95 WFN07000 | Washer, Flat, 7/16", 2, Plt | each | 4 | | |
| 100 WFQ08000 | Washer, Flat, 1/2", 8, Plt | each | 4 | | |
| 105 WLP07000 | Washer, Lock, 7/16", 5, Plt | each | 4 | | |
| 110 WLP08000 | Washer, Lock, 1/2", 5, Plt | each | 4 | | |

Bill of Materials Listing

TransArctic Canada Inc.

11/25/2011

Page 1 of 1

| Product Number | | Description | Bin | Date | Weight | Uof M | Yield |
|-----------------|-----------------|--|-----|------------------|--------------|-------|----------|
| Line | Component Prod# | Description | | Unit | Qty | | |
| KPC64161 | | Kit, Pulley, ISB, A3RE, '07 | | 5/13/2008 | 14.32 | | 0 |
| 10 | PUL67222 | Pulley, Crank, ADD-ON, ISB,6.7L,2B/X,'07 | | each | 1 | | |
| 20 | CSS12090 | Capscrew, SH, 12 x 1.25 x 90mm, 12.9,BLK | | each | 6 | | |
| 30 | WFS12002 | Washer, Flat, Hdn, 12mm, Stl, BLK | | each | 6 | | |

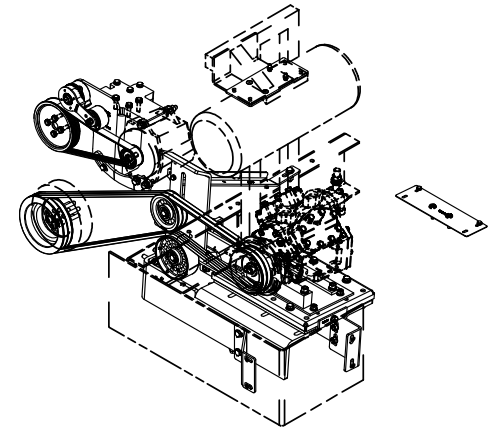
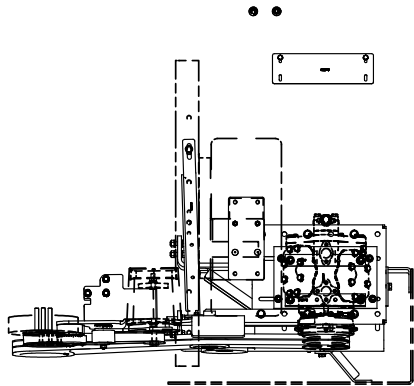

ISOMETRIC VIEW

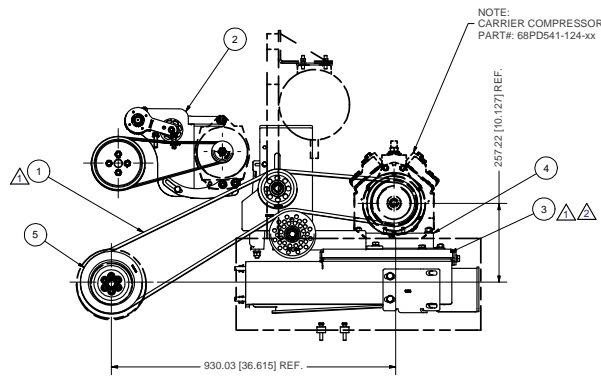

REUSE EXISTING BRACKET HARDWARE.

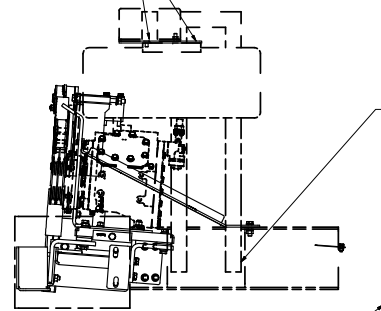

REUSE & MODIFY EXISTING EXHAUST SHIELD
(FROM REAR OEM POSITION TO
LOWERED OTHER SIDE OF TUBE.)

REUSE EXISTING MUFFLER BRACKET & HARDWARE.

NOTES:

- 1) USE SERVICABLE THREADLOCKER ON ALL FASTENERS TO ENGINE COMPONENTS AND TORQUE ALL BOLTS TO S.A.E. SPECIFICATIONS.
- 2) SEE "TRANSARCTIC A/C COMPRESSOR MOUNT INSTALLATION DISCLAIMER".

| ITEM | QTY | U/M | PART NUMBER | DESCRIPTION |
|------|-----|------|-------------|---------------------------------|
| 5 | 1 | EACH | KPC64161 | KIT, PULLEY, ISB, BBRE, 07 |
| 4 | 1 | EACH | KFT62560 | MT KIT, TRANSIT, F400, 07 |
| 3 | 1 | EACH | KBB64161 | MT KIT, BASE, TRANSIT, BBRE, 07 |
| 2 | 1 | EACH | KAC64161 | ALT. KIT, 24V, ISB, BBRE, 07 |
| 1 | 2 | EACH | BEL22413 | Belt, B gr, 2413mm (85") (BX32) |

BILL OF MATERIALS
DRAWN
Jose Rodriguez
10/22/2008
CHECKED
Val Jakowlew
10/22/2008
TITLE

TRANSARCTIC INC.

| REV | ECN | DESCRIPTION | DATE | BY |
|-----|-----|----------------------------------|------------|---------------|
| 2 | | REVISED PART# KBB64161 | 10/15/2011 | JAL |
| 1 | | WAS PART KBB64161 ADDED BEL22413 | 07/20/09 | JRR |
| 0 | | RELEASED TO PRODUCTION | 10/22/2008 | JRR |
| | | | | GA |
| | | | | James Stewart |
| | | | | MFG |
| | | | | Ron Ingram |
| | | | | APPROVED |
| | | | | Dale Mason |

THIS DRAWING CONTAINS PROPRIETARY CONFIDENTIAL INFORMATION OWNED BY TRANSARCTIC CANADA INC. THE DOCUMENT AND THE INFORMATION IN IT ARE NOT TO BE USED, DISCLOSED OR REPRODUCED WITHOUT EXPRESS WRITTEN PERMISSION OF THE COMPANY.

| UNSPECIFIED TOLERANCES: | ALL DIM. |
|----------------------------|----------|
| ONE DECIMAL PLACE (.X) | MM |
| TWO DECIMAL PLACE (.XX) | FRAC |
| THREE DECIMAL PLACE (.XXX) | FRAC |
| FRACTIONAL .125" | ANGULAR |



| | |
|-------------------------|-----------|
| DRAWING UNIT OF MEASURE | MM (INCH) |
| SCALE | 1 : 1 |
| SHEET | 1 OF 1 |

MT. KIT, 6.7L ISB, A3RE, F400, '07

DWG NO
KMC62560

REV 2

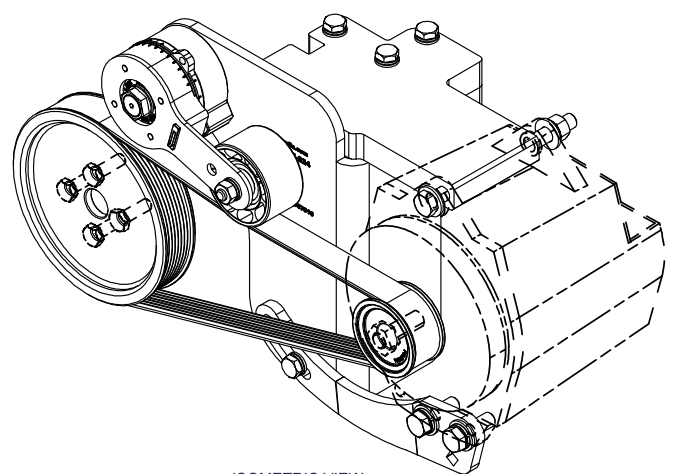
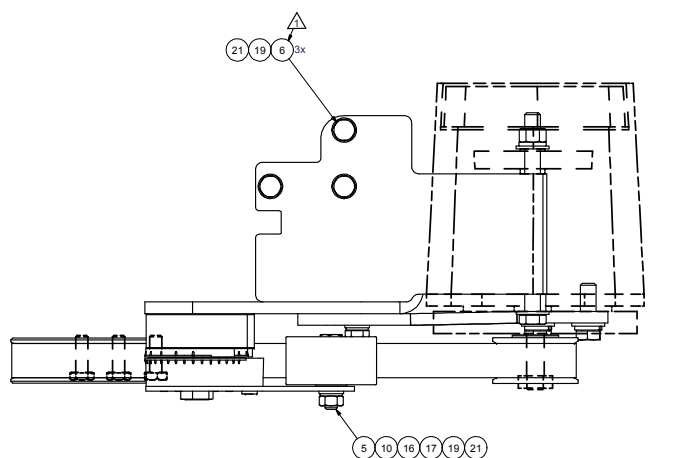

ISOMETRIC VIEW

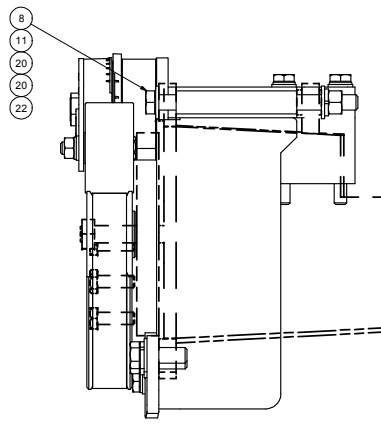
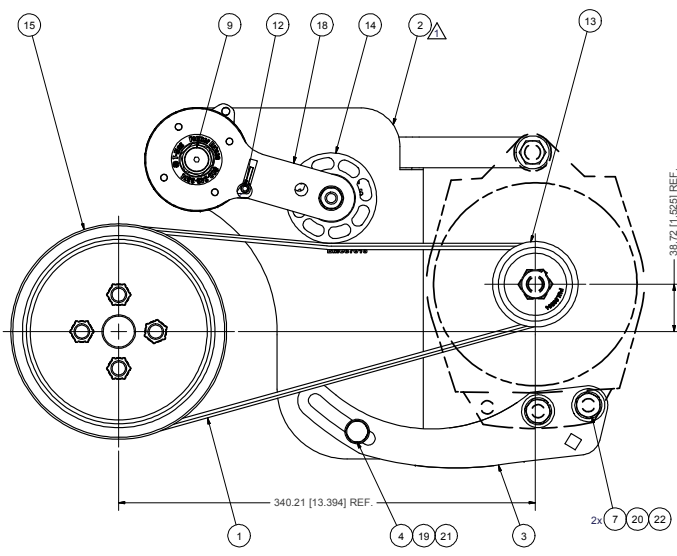

- NOTES:
- 1) USE SERVICABLE THREADLOCKER ON ALL FASTENERS TO ENGINE COMPONENTS AND TORQUE ALL BOLTS TO S.A.E. SPECIFICATIONS.
 - 2) SEE "TRANSARGTIC A/C COMPRESSOR MOUNT INSTALLATION DISCLAIMER".
 - 3) WEIGHT: 13.00 LB

| ITEM | QTY | U/M | PART NUMBER | DESCRIPTION |
|------|-----|------|-------------|---|
| 22 | 3 | EACH | WLQ08000 | WASHER, LOCK, 1/2", 8, PLT |
| 21 | 5 | EACH | WLA10000 | WASHER, LOCK, 10mm, 8.8, PLT |
| 20 | 4 | EACH | WFO08000 | WASHER, FLAT, 1/2", 8, PLT |
| 19 | 5 | EACH | WFA10000 | WASHER, FLAT, 10mm, 8.8, PLT |
| 18 | 1 | EACH | TEN00002 | TENR. SPRING, UN-DIRECT, 90D, 3/8 X 3.5" |
| 17 | 1 | EACH | SLV17010 | SLEEVE, PULLEY, 16.9x x 22.23mm x 10.32l |
| 16 | 1 | EACH | SCD09010 | SPACER, COL, DR_L, 9mm x 25.4x 10.32l |
| 15 | 1 | EACH | PUL83008 | PULLEY, FAN, ADD-ON, CUM, ISC, 8.3, 8gr |
| 14 | 1 | EACH | PUL80076 | PULLEY, IDLER, BACKSIDE, P8, 76D, 39W |
| 13 | 1 | EACH | PUL80064 | PULLEY, ALT, FRONTSIDE, P8, 63.5d (3972808) |
| 12 | 1 | EACH | PNV04012 | PIN, SPRING, 1/4" D x 3/4" L |
| 11 | 1 | EACH | NTP08000 | NUT, HEX, 1/2-13UNC, 5, PLT |
| 10 | 1 | EACH | NTA10000 | NUT, HEX, 10 x 1.5, 8.8, PLT |
| 9 | 1 | EACH | CSF06250 | CAPSCREW, FH, 3/8-16 x 2.5", 9, PLT |
| 8 | 1 | EACH | BTQ08653 | BOLT, HEX, 1/2-13UNC x 6.50, 8, PLT |
| 7 | 2 | EACH | BTQ08150 | BOLT, HEX, 1/2-13UNC x 1.50, 8, PLT |
| 6 | 3 | EACH | BTC10100 | BOLT, HEX, 10 x 1.5 x 100mm, 10.9, PLT |
| 5 | 1 | EACH | BTC10055 | BOLT, HEX, 10 x 1.5 x 55mm, 10.9, PLT |
| 4 | 1 | EACH | BTC10030 | BOLT, HEX, 10 x 1.5 x 30mm, 10.9, PLT |
| 3 | 1 | EACH | BMC67030 | BKT, TENR, ARM, ALT |
| 2 | 1 | EACH | BMC67016 | Bkt, Main, ALT, Weldmnt, ISB, 08 |
| 1 | 1 | EACH | BEL81104 | Belt, 8gr, 1104mm (43.5") (S080435) |

BILL OF MATERIALS

DRAWN: Jose Rodriguez 10/1/2008
 CHECKED: Val Jakowlew 10/1/2008
 TITLE: Alt. Kit, 24V, ISB, BBRE, '07

REV: ECN DESCRIPTION: DATE: BY: MFG
 1 REVISED BMC67016 WAS BTC10042 1/18/2010 JRR
 0 RELEASED FOR PRODUCTION 10/1/2008 JRR
 2 Ron Ingram 10/1/2008
 Dale Mason 10/1/2008

THIS DRAWING CONTAINS PROPRIETARY CONFIDENTIAL INFORMATION OWNED BY TRANSARGTIC CANADA INC. THE DOCUMENT AND THE INFORMATION IT CONTAINS ARE NOT TO BE USED, DISCLOSED OR REPRODUCED WITHOUT EXPRESS WRITTEN PERMISSION OF THE COMPANY.

UNSPECIFIED TOLERANCES: (ALL DIM) GROUP
 ONE DECIMAL PLACE (10) .05 FRACTIONAL
 TWO DECIMAL PLACE (20) .01 FRACTIONAL
 FRACTIONAL (1/32) .005 (1/64) .0025

THIRD ANGLE PROJECTION

DRAWING UNIT OF MEASURE: MM (INCH)
 SCALE: 1:2

DWG NO: KAC64161
 SHEET 1 OF 1



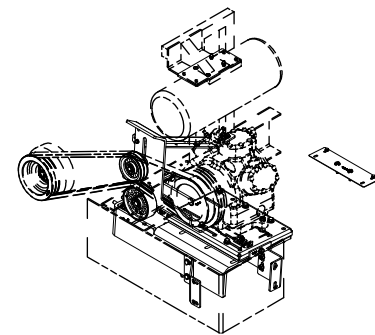
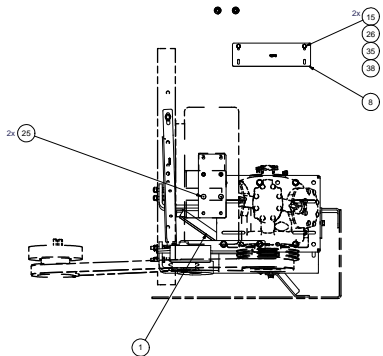

ISOMETRIC VIEW

NOTES:
 1) USE SERVICEABLE THREADLOCKER ON ALL FASTENERS TO ENGINE COMPONENTS AND TORQUE ALL BOLTS TO S.A.E. SPECIFICATION.
 2) SEE "TRANSARCTIC A/C COMPRESSOR MOUNT INSTALLATION DISCLAIMER."
 3) WEIGHT: 155.00 LB

| ITEM | QTY | UOM | PART NUMBER | DESCRIPTION |
|------|-----|------|-------------|---|
| 40 | 13 | EACH | WLO08000 | WASHER, LOCK, 1/2", 8, PLT |
| 39 | 14 | EACH | WLA12000 | WASHER, LOCK, 1/2mm, 8, 8, PLT |
| 38 | 3 | EACH | WLO08000 | WASHER, LOCK, 8mm, 8, 8, PLT |
| 37 | 15 | EACH | WFO08000 | WASHER, FLAT, 1/2", 8, PLT |
| 36 | 20 | EACH | WFA12000 | WASHER, FLAT, 1.2mm, 8, 8, PLT |
| 35 | 4 | EACH | WFO08000 | WASHER, FLAT, 8mm, 8, 8, PLT |
| 34 | 2 | EACH | SFL19010 | SPACER, COL, DBL, 19.05mm x 25.4 x 10.5 (3) |
| 33 | 2 | EACH | SLV17012 | SLEEVE, PULLEY, 16.9 x 22.23 mm x 12.19 |
| 32 | 1 | EACH | SCD48012 | SPACER, COL, DBL, 48mm x 3.31mm x 12.0 |
| 31 | 1 | EACH | SCD12812 | SPACER, COL, DBL, 32.8mm x 50.80 x 12.3 |
| 30 | 1 | EACH | PLA06001 | PULLEY, ASSY, IDLER, B/S, 6", STL, PLT |
| 29 | 1 | EACH | PLA05012 | PULLEY, ASSY, IDLER, B/BW, 5", STL, PLT |
| 28 | 2 | EACH | WTP06000 | NUT, HEX, 3/8-14UNC, 5, PLT |
| 27 | 13 | EACH | NTA12000 | NUT, HEX, 1/2 x 1.75, 8, 8, PLT |
| 26 | 3 | EACH | NTA08000 | NUT, HEX, 8 x 1.25, 8, 8, PLT |
| 25 | 2 | EACH | FS06015 | CARPEN, FH, 3/8" x 1.75", 9, PLT |
| 24 | 3 | EACH | BTQ08200 | BOLT, HEX, 1/2-13UNC x 2.00, 8, PLT |
| 23 | 12 | EACH | BTQ08126 | BOLT, HEX, 1/2-20UNC x 1.25, 8, PLT |
| 22 | 2 | EACH | BTQ06000 | BOLT, HEX, 3/8-14UNC, 1.00, 8, PLT |
| 21 | 1 | EACH | BTQ08653 | BOLT, HEX, 1/2-13UNC x 6.50, 5, PLT, FT |
| 20 | 2 | EACH | BTQ12100 | BOLT, HEX, 12 x 1.75 x 100mm, 10.9, PLT |
| 19 | 1 | EACH | BTQ12040 | BOLT, HEX, 12 x 1.75 x 40mm, 10.9, PLT |
| 18 | 1 | EACH | BTQ12050 | BOLT, HEX, 12 x 1.75 x 50mm, 10.9, PLT |
| 17 | 10 | EACH | BTQ12040 | BOLT, HEX, 12 x 1.75 x 40mm, 10.9, PLT |
| 16 | 1 | EACH | BTQ08055 | BOLT, HEX, 8 x 1.25 x 35mm, 10.9, PLT |
| 15 | 2 | EACH | BTQ08020 | BOLT, HEX, 8 x 1.25 x 20mm, 10.9, PLT |
| 14 | 1 | EACH | BMN80025 | BKT, BACK, PL, SLIDE, IC, RE 300 |
| 13 | 1 | EACH | BMN80009 | BKT, MAIN, BACK, PL, IC, RE 300 |
| 12 | 2 | EACH | BMN80008 | VIBRATION ISOLATOR, BAR, 16.50 x 2 x 1.50 |
| 11 | 1 | EACH | BMC83043 | BKT, MAIN, IDLER, ISB, BBRE, '07 |
| 10 | 1 | EACH | BMC83031 | BKT, SLIDE, BLOCK, IDLER, BBRE, '07 |
| 9 | 1 | EACH | BMC83029 | BKT, SHIFT, TANK, WELDMT, ISC, BBRE, '07 |
| 8 | 1 | EACH | BMC83028 | BKT, TRAY, ISC, BBRE, '07 |
| 7 | 1 | EACH | BMC83027 | BKT, SPRAY, BUMP, SIDE, ISC, BBRE, '07 |
| 6 | 1 | EACH | BMC83026 | BKT, SPRAY, BUMP, REAR, ISC, BBRE, '07 |
| 5 | 1 | EACH | BMC83023 | BKT, GUSSET, IDLER, ISC, BBRE, '07 |
| 4 | 1 | EACH | BMC83022 | BKT, COMP, REAR, ISC, BBRE, '07 |
| 3 | 1 | EACH | BMC83021 | BKT, COMP, FRT, ISC, BBRE, '07 |
| 2 | 1 | EACH | BMC83020 | BKT, DAMPNER, ISC, BBRE, '07 |
| 1 | 1 | EACH | BMC83019 | BKT, GUSSET, BUMPER, ISC, BBRE, '07 |

| | | | |
|-------------|-----------|------------|-----------|
| DESIGNED BY | DATE | BY | DATE |
| DATE MASON | 3/17/2009 | DATE MASON | 3/17/2009 |
| APPROVED BY | DATE | BY | DATE |
| DATE MASON | 3/17/2009 | DATE MASON | 3/17/2009 |

TRANSARCTIC INC.
 MT KIT, BASE, TRANSIT, BBRE, '07
 PART NO: KBB64161
 SHEET 1 OF 1

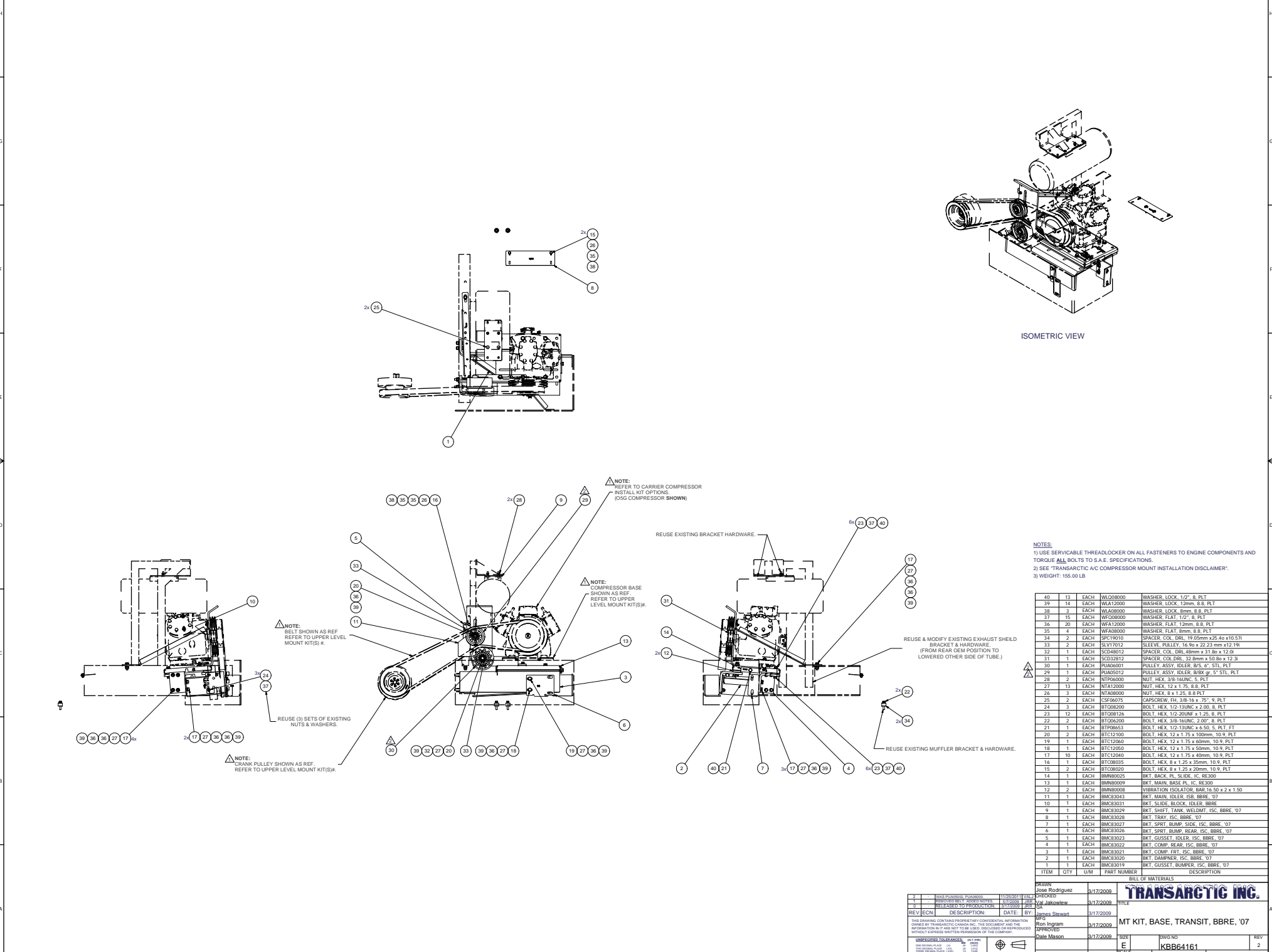

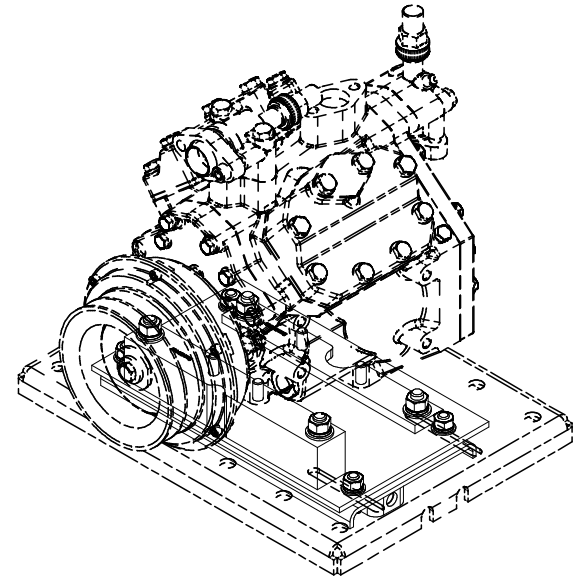
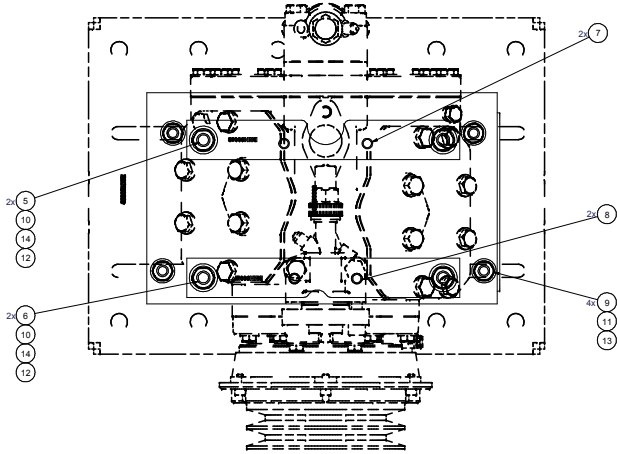

ISOMETRIC VIEW

NOTE:
CARRIER COMPRESSOR
PART#: 18-10140-05

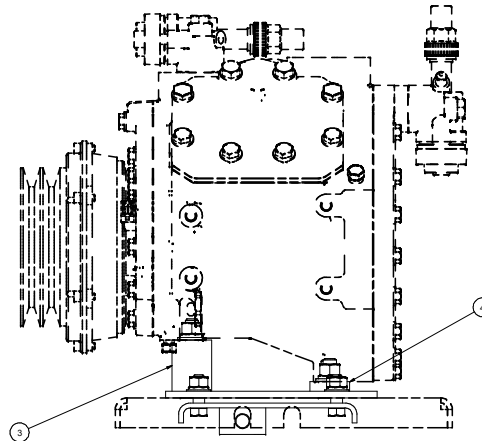
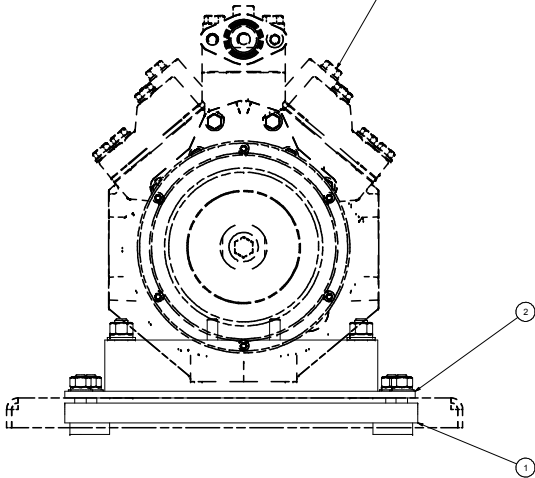

NOTES:
1) USE SERVICABLE THREADLOCKER ON ALL FASTENERS TO ENGINE COMPONENTS AND TORQUE ALL BOLTS TO S.A.E. SPECIFICATIONS.
2) SEE "TRANSARGTIC A/C COMPRESSOR MOUNT INSTALLATION DISCLAIMER".

| ITEM | QTY | U/M | PART NUMBER | DESCRIPTION |
|------|-----|------|-------------|--|
| 14 | 4 | EACH | WLP08000 | WASHER, LOCK, 1/2", 5, PLT |
| 13 | 4 | EACH | WLP07000 | WASHER, LOCK, 7/16", 5, PLT |
| 12 | 4 | EACH | WFO08000 | WASHER, FLAT, 1/2", 8, PLT |
| 11 | 4 | EACH | WFO07000 | WASHER, FLAT, 7/16", 2, PLT |
| 10 | 4 | EACH | NTP08000 | NUT, HEX, 1/2-13UNC, 5, PLT |
| 9 | 4 | EACH | NTP07000 | NUT, HEX, 7/16-14UNC, 5, PLT |
| 8 | 2 | EACH | CSF10066 | CAPSCREW, FH, 10 x 1.5 x 65mm, 10.9, PLT |
| 7 | 2 | EACH | CSF10031 | CAPSCREW, FH, 10 x 1.5 x 30mm, 10.9, PLT |
| 6 | 2 | EACH | CSF08300 | CAPSCREW, FH, 3/8-16 x 3", 9, PLT |
| 5 | 2 | EACH | CSF08150 | CAPSCREW, FH, 3/8-16 x 1.5", 9, PLT |
| 4 | 1 | EACH | BMN80058 | BKT, COMP, RR BAR, BITZER, RE300 |
| 3 | 1 | EACH | BMN80057 | BKT, COMP, RFT BAR, BITZER, RE300 |
| 2 | 1 | EACH | BMN80032 | BKT, ADAPTER, PL, IC, RE300 |
| 1 | 1 | EACH | BMN80031 | BKT, MAIN, SLIDE, ASSY, OSK, IC, RE300 |

| | | | | BILL OF MATERIALS | |
|---|------------------------|----------|---------------|----------------------------|----------|
| DRAWN | Jose Rodriguez | DATE | 5/5/2009 | TRANSARGTIC INC. | |
| CHECKED | James Stewart | DATE | 5/5/2009 | | |
| REV | DESCRIPTION | DATE | BY | TITLE | |
| 1 | RELEASED TO PRODUCTION | 05/20/09 | James Stewart | MT KIT, TRANSIF, F400, 107 | |
| 2 | | | Ron Ingram | | |
| 3 | | | Dale Mason | | |
| <small>UNAPPROVED TOLERANCES: ALL DIMS TO BE SHOWN UNLESS OTHERWISE SPECIFIED. DIMS IN PARENS ARE HIDDEN DIMS. DIMS IN SQUARE PARENS ARE HIDDEN DIMS. DIMS IN BRACKET PARENS ARE HIDDEN DIMS. DIMS IN BRACKET PARENS ARE HIDDEN DIMS.</small> | | | | SIZE | DWG NO |
| | | | | F | KFT62560 |
| <small>UNAPPROVED TOLERANCES: ALL DIMS TO BE SHOWN UNLESS OTHERWISE SPECIFIED. DIMS IN PARENS ARE HIDDEN DIMS. DIMS IN SQUARE PARENS ARE HIDDEN DIMS. DIMS IN BRACKET PARENS ARE HIDDEN DIMS.</small> | | | | SCALE | 1:2 |
| <small>THIRD ANGLE PROJECTION</small> | | | | SHEET | 1 OF 1 |

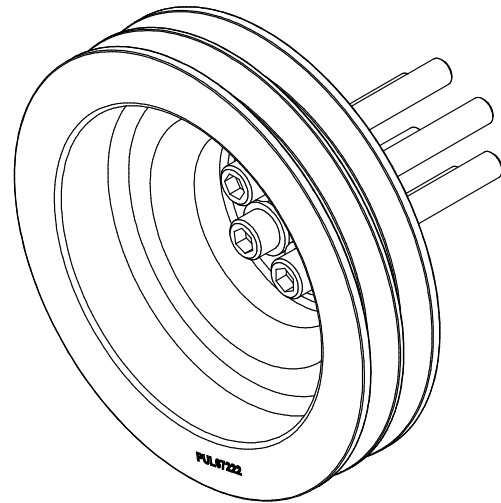
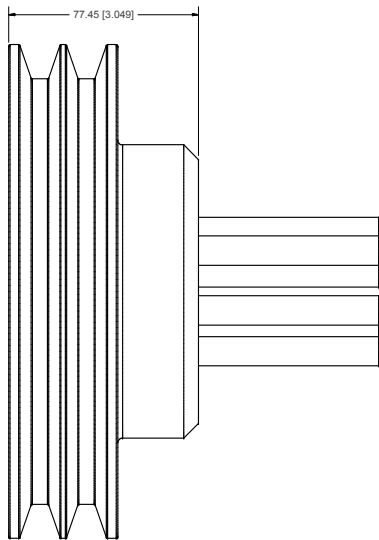
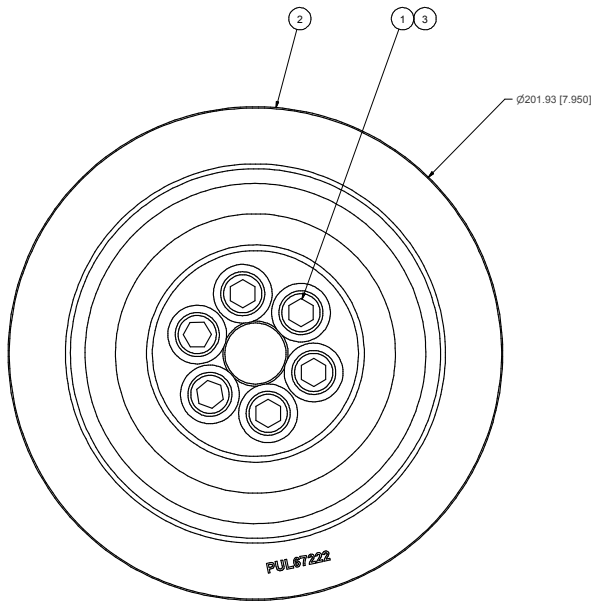
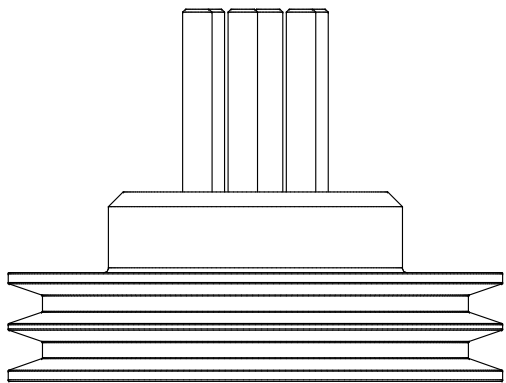

ISOMETRIC VIEW

NOTES:

- 1) USE SERVICABLE THREADLOCKER ON ALL FASTENERS TO ENGINE COMPONENTS AND TORQUE **ALL** BOLTS TO S.A.E. SPECIFICATIONS.
- 2) SEE "TRANSARC TIC A/C COMPRESSOR MOUNT INSTALLATION DISCLAIMER".
- 3) WEIGHT: 13.24 LB

| ITEM | QTY | U/M | PART NUMBER | DESCRIPTION |
|------|-----|------|-------------|---|
| 3 | 6 | EACH | WFS12002 | WASHER, FLAT, HDN, 12mm, STL, BLK |
| 2 | 1 | EACH | PUL67222 | PULLEY, CRANK, ADD-ON, ISB, 6.7L, 2B/X, '07 |
| 1 | 6 | EACH | CSS12090 | CAPSCREW, SH, 12 x 1.25 x 90mm, 12.9, PLT |

BILL OF MATERIALS

| | | | | | |
|---------|----------------|-------------|--------------------------|---------------|-----------------------------|
| DRAWN | Jose Rodriguez | 10/21/2008 | TRANSARC TIC INC. | | |
| CHECKED | James Stewart | 10/21/2008 | | | |
| REV | ECN | DESCRIPTION | DATE | BY | TITLE |
| | | | 10/21/2008 | James Stewart | KIT, PULLEY, ISB, BBRE, '07 |
| | | | 10/21/2008 | Ron Ingram | |
| | | | 10/21/2008 | Dale Mason | |

| | | | |
|---|------------------------|------------|---------------|
| 0 | RELEASED TO PRODUCTION | 10/21/2008 | DRK |
| 1 | DESCRIPTION | DATE | BY |
| | | | James Stewart |
| | | | Ron Ingram |
| | | | Dale Mason |

UNSPECIFIED TOLERANCES: (ALL DIM)
 ONE DECIMAL PLACE (10) .05 (10)
 TWO DECIMAL PLACE (20) .01 (20)
 FRACTIONAL (1/32) .005 (32)



| | |
|-------------------------|-------|
| DWG NO | REV |
| KPC64161 | 0 |
| DRAWING UNIT OF MEASURE | SCALE |
| MM (INCH) | 1:1 |

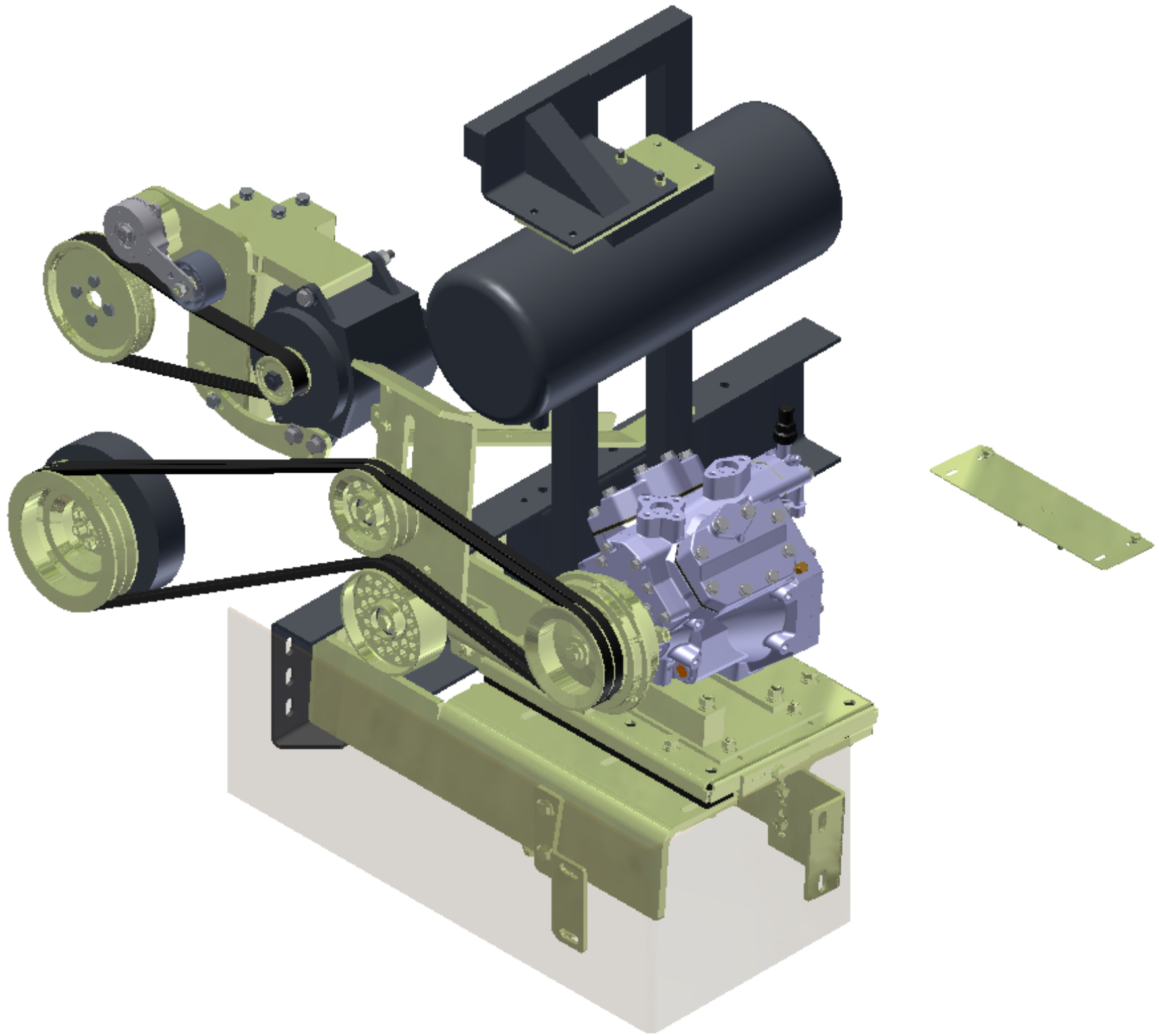

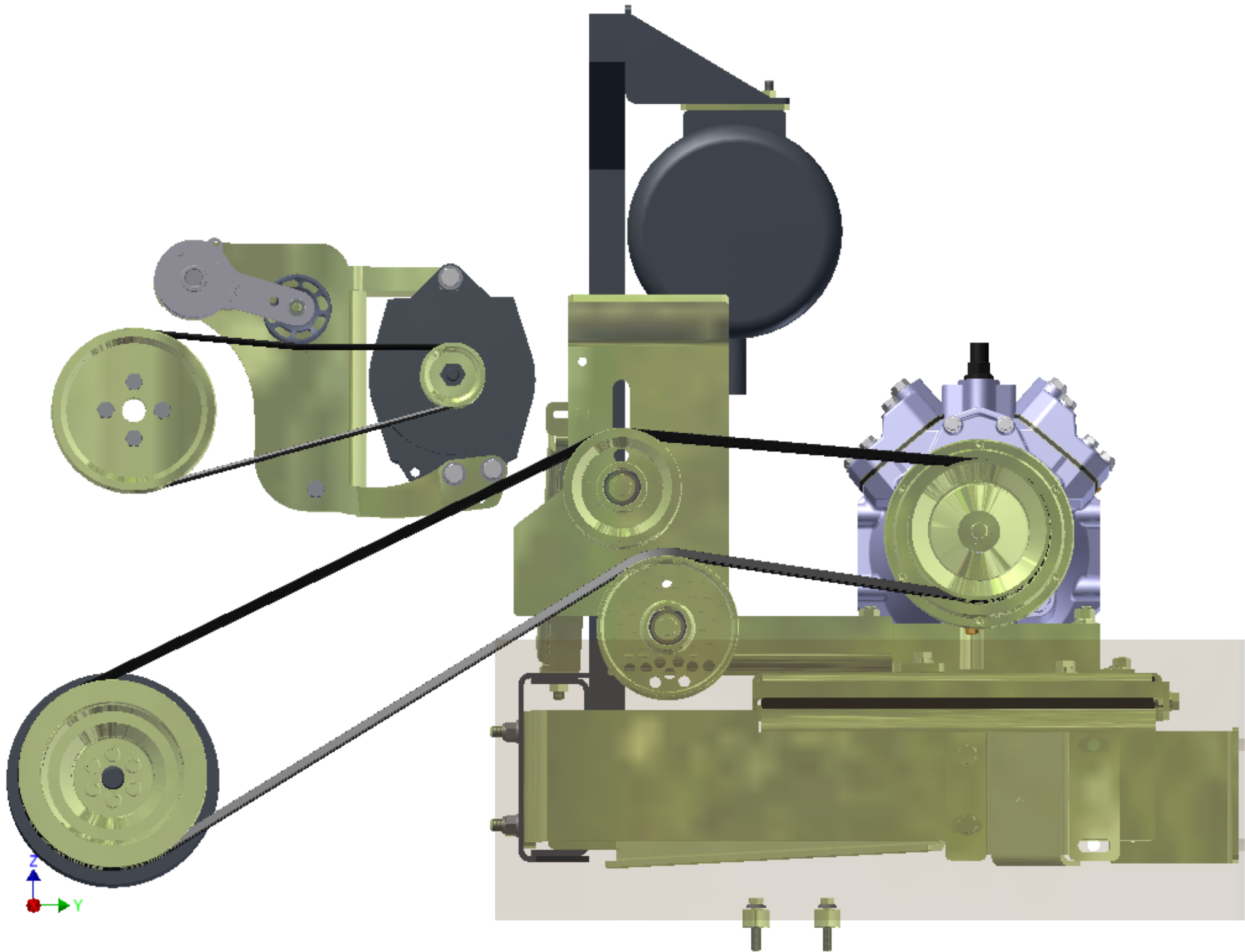

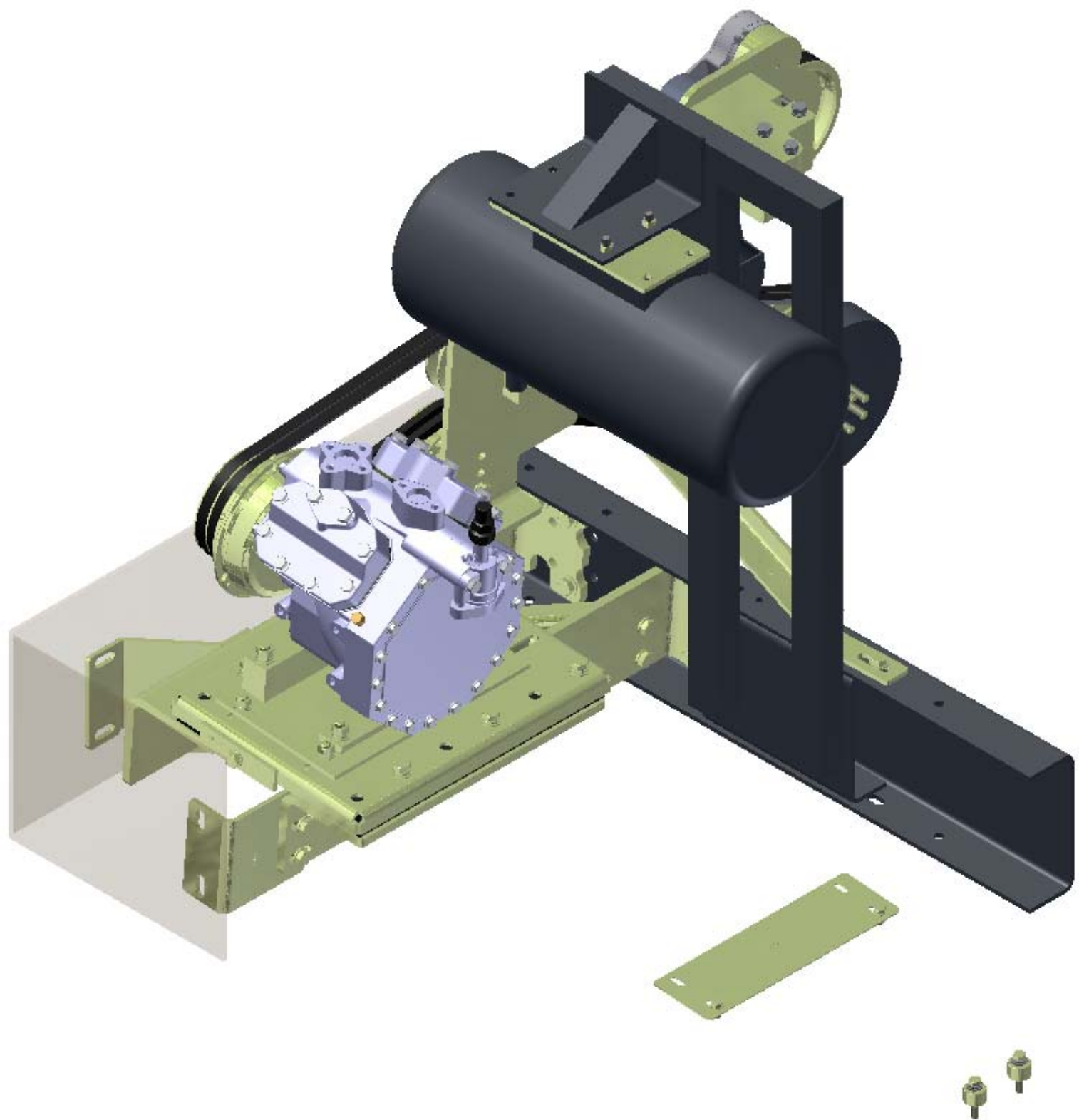

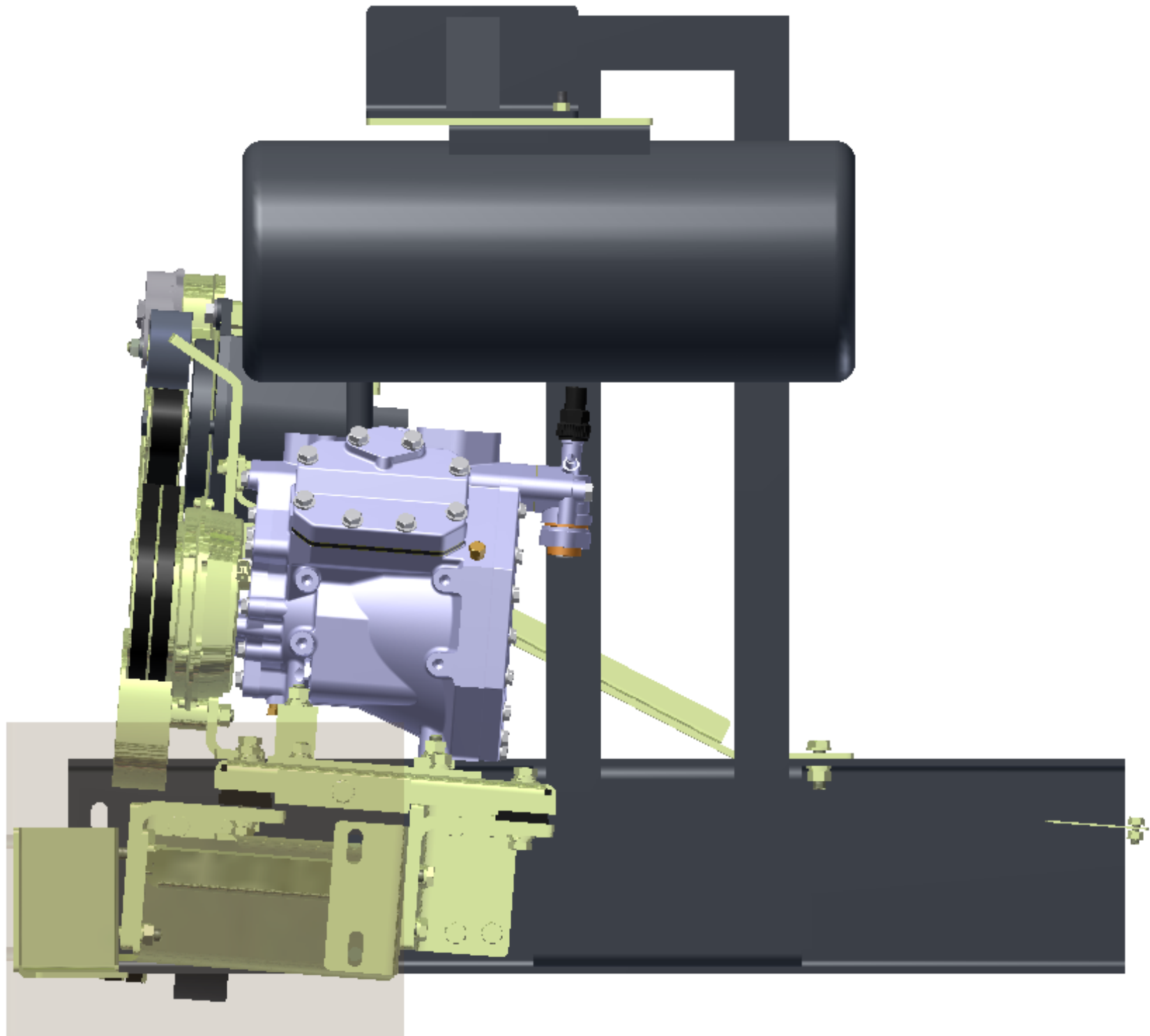

TransArctic A/C Compressor Mount Installation Disclaimer

All compressor mounts should be installed by qualified and trained personnel using proper tools and equipment in safe working conditions following industry standard guidelines for motor vehicle service and repair.

The installer of any compressor mount purchased from TransArctic must undertake all responsibility of issues arising from that compressor bracket being installed on any vehicle. As well as insure that a **proper and sufficient ground** is established between the compressors' clutches and the vehicle's engine. Mount functionality, operation and durability can all be compromised by an incompetent installation.

Due to the many different situations, parameters and application criteria, which are beyond the compressor mount manufacturer's control, TransArctic does not warrant design, durability, or operational functionality of any compressor mount improperly installed by another party.

With no implied guarantees it is the mount installer's strict responsibility to determine safety and functionality, of the compressor mount, at the time of installation.

Please contact TransArctic with any issue arising from installation so we may better improve the product. If you have any reservations about the compressor mount integrity contact TransArctic immediately at 1-877-COLD-AIR.

Mark OEM tensioner location

Install Kit

Check for Interferences

Check to ensure that the proper OEM tensioner orientation is maintained

Run engine with A/C system engaged for at least 10 minutes to run in belt

Check OEM tensioner orientation and adjust as required

Responsabilidad limitada de TransArctic en la instalación del soporte del compresor

Todos los soportes de los compresores deben ser instalados por personas calificadas y entrenadas, usando para ello los equipos y herramientas necesarios para esta labor en buenas condiciones y según las normas y guías para el servicio y/o reparación de motores de vehículos.

El instalador de los soportes comprados en TransArctic asume toda la responsabilidad de cualquier problema que surga en el soporte del compresor al vehículo; de igual manera es responsable que el cable a tierra sea conectado entre el embrague del compresor y el motor del vehículo.

Se advierte que el buen funcionamiento y la durabilidad del soporte pueden ser comprometidos por defectos en su instalación.

Debido a las diversas situaciones que se puedan presentar fuera del control del fabricante, TransArctic no garantiza el diseño, la durabilidad o el correcto funcionamiento de cualquier equipo inapropiadamente instalado por terceros.

Esta sobreentendido que el Instalador del montaje del compresor es estrictamente responsable de la seguridad y funcionamiento del equipo en el momento de la instalación.

Si tuviera algún problema o duda acerca de la instalación del soporte del compresor pongase en contacto inmediatamente con TransArctic al teléfono 1-877-COLD-AIR de modo que podamos mejorar nuestro producto.

Note la ubicación del medidor de tensión OEM

Instale el equipo

Controlar si hay interferencias.

Asegure que el medidor de tensión mantenga la orientación justa.

Encienda el motor por lo menos 10 minutos con el sistema A/C enganchado para que la correa corra

Controle la orientación justa del medidor de tensión y ajuste a las condiciones requeridas del fabricante