

# Bill of Materials Listing

TransArctic Canada Inc.

11/30/2015  
Page 1 of 1

Product Number	Description	Date	Weight	Uof M	Yield
Line Component Prod#	Description	Bin Unit	Qty		
<b>KMC84064</b>	<b>Mt Kit, ISC10, T3RE, FK40/4xFC, '13</b>	<b>6/26/2013</b>	<b>202.43</b>		<b>0</b>
20 BEL32210	Belt, Banded B gr,2210mm (87") (RBX84-2)	each	1		
30 BMC83053	Bkt, Diag, Brace RR, MFDT, RE300	each	1		
40 BMC83054	Bkt, Main, Idler, Weldm't, RE300	each	1		
50 BMC83058	Bkt, Cover, Light Pl, MF DT, RE300	each	1		
60 BMC83074	Bkt, Relay, ISC, D3RE, 2010	each	1		
70 BMC83107	Bkt, Main, FRT Support, T3RE, '13	each	1		
80 BMC83108	Bkt, Main, RR Support, T3RE, '13	each	1		
90 BMC83109	Bkt, Main, Lateral Brace, T3RE, '13	each	1		
100 BMC83113	Bkt, Brace RR/PS, PDU Panel, T3RE, '13	each	1		
120 BMC83116	Bkt, Support, PDU Panel, T3RE, '13	each	1		
130 BMC83120	Bkt, Weldm't, Sup, A.F Housing,T3RE,'13	each	1		
135 BMC83122	Bkt, Exhaust, Adapter, T3RE, '13	each	1		
140 BMZ00046	Bkt, Angle, Brace, Hanger, Hose, 2013	each	1		
165 CLP04000	Clamp, T bolt, Spring, 4", CAC	each	2		
166 TUS04093	Tube, Stl, Exh, 4"o.d., 90 deg elb,8 x 8	each	1		
167 HOA04083	Hose, Flex, CAC, 4.0d x 8.0, 3 ring	each	1		
170 KCB84064	Kit, Compressor, 24V, FK40/ 4xFC, '13	each	1		
190 PUA05012	Pulley, Assy, Idler,B/BX gr,5", STL,Plt	each	1		
210 PUL80074	Pulley, Idler, B/S, Wide, 76d (89102)	each	1		
220 PUL89322	Pulley, Crank,ADD-ON,Combo,ISC/L-G,2B/3V	each	1		
230 SCD37012	Spacer, Col, Drl, 37 mm x 25.4o x 12.3i	each	1		
240 SCD41012	Spacer, Col, Drl, 41 mm x 25.4o x 12.3i	each	1		
250 SLV17012	Sleeve, Pulley, 16.9o x 22.23mm x 12.32i	each	2		
270 KBC84064	Bag Kit, Fasteners, KMC840/841/940/94164	each	1		

WILL REQUIRE TMP00002 (TEMPLATE).

# Bill of Materials Listing

TransArctic Canada Inc.

11/30/2015  
Page 1 of 1

Product Number	Description	Date	Weight	Uof M	Yield
Line Component Prod#	Description	Bin Unit	Qty		
<b>KBC84064</b>	<b>Bag Kit, Fasteners, KMC840/841/940/94164</b>	<b>7/9/2013</b>	<b>2.97</b>		<b>0</b>
10 BTC08035	Bolt, Hex, 8 x 1.25 x 35mm, 10.9, Plt,FT	each	4		
20 BTC10035	Bolt, Hex, 10 x 1.5 x 35mm, 10.9, Plt,FT	each	2		
40 BTC12040	Bolt, Hex, 12 x 1.75 x 40mm, 10.9,Plt,FT	each	5		
50 BTC12050	Bolt, Hex, 12 x 1.75 x 50mm, 10.9,Plt	each	2		
60 BTC12100	Bolt, Hex, 12 x 1.75 x 100mm, 10.9, Plt	each	2		
70 BTQ08126	Bolt, Hex, 1/2-20unf, 1.25", 8, Plt	each	6		
80 NTA10000	Nut, Hex, 10 x 1.5, 8.8, Plt	each	2		
90 NTA12000	Nut, Hex, 12 x 1.75, 8.8, Plt	each	9		
100 SCP03075	Screw, PH, PD, SDT, #10-16 x .75, ST,Plt	each	3		
160 WFA08000	Washer, Flat, 8mm, 8.8, Plt	each	4		
170 WFA10000	Washer, Flat, 10mm, 8.8, Plt	each	4		
180 WFA12000	Washer, Flat, 12mm, 8.8, Plt	each	16		
190 WFQ08000	Washer, Flat, 1/2", 8, Plt	each	6		
200 WLA08000	Washer, Lock, 8mm, 8.8, Plt	each	4		
210 WLA10000	Washer, Lock, 10mm, 8.8, Plt	each	2		
220 WLA12000	Washer, Lock, 12mm, 8.8, Plt	each	9		
230 WLQ08000	Washer, Lock, 1/2", 8, Plt	each	6		

# Bill of Materials Listing

TransArctic Canada Inc.

11/30/2015  
Page 1 of 1

Product Number	Description	Date	Weight	Uof M	Yield
Line    Component    Prod#	Description	Bin                    Unit	Qty		
<b>KCB84064</b>	<b>Kit, Compressor, 24V, FK40/ 4xFC, '13</b>		<b>9/16/2013</b>	<b>62.73</b>	<b>0</b>
10	BEL11040		Belt, A gr, 1040mm (41") (17410)	each	2
20	BMC83114		Bkt, PI, ALT Spacer, T3RE, '13	each	1
30	BMN80008		Vibration Isolator, Bar,16.50 x 2 x 1.50	each	2
40	BMN80025		Bkt, Back, PL, Slide, IC, RE300	each	1
50	BMT10011		Bkt, Tenr, Block, Offset, 3mm	each	2
60	BMZ00043		Bkt, Main, Base PI, '13	each	1
70	KBT84064		Kit, Platform, 4xFCY W/ Alt, '13	each	1
80	PUL03321		Pulley, ALT, Idler, 3.25"d, 2A	each	1
90	TRD08120		Threaded, Rod, 1/2-13unc x 12", 5, Plt	each	1
100	KBZ84064		Bag Kit, Fasteners, KCB84064	each	1

# Bill of Materials Listing

TransArctic Canada Inc.

11/30/2015  
Page 1 of 1

Product Number	Description	Date	Weight	Uof M	Yield
Line    Component    Prod#	Description	Bin            Unit	Qty		
<b>KBZ84064</b>	<b>Bag Kit, Fasteners, KCB84064</b>	<b>10/18/2013</b>	<b>2.50</b>		<b>0</b>
10	BTP08653				
	Bolt, Hex, 1/2-13unc, 6.5", 5, Plt, FT	each	1		
20	BTQ08101				
	Bolt, Hex, 1/2-20unf, 1.00", 8, Plt	each	3		
30	BTQ08150				
	Bolt, Hex, 1/2-13unc, 1.5", 8, Plt	each	4		
40	BTQ08126				
	Bolt, Hex, 1/2-20unf, 1.25", 8, Plt	each	2		
50	BTQ08653				
	Bolt, Hex, 1/2-13unc, 6.5", 8, Plt	each	1		
60	CSF08076				
	Capscrew, FH, 1/2-20unf x .75", Alloy, Plt	each	1		
70	NTQ08000				
	Nut, Hex, 1/2-13unc, 8, Plt	each	7		
80	WFQ08000				
	Washer, Flat, 1/2", 8, Plt	each	11		
90	WLQ08000				
	Washer, Lock, 1/2", 8, Plt	each	13		

# Bill of Materials Listing

TransArctic Canada Inc.

11/30/2015  
Page 1 of 1

Product Number	Description	Date	Weight	Uof M	Yield
Line    Component    Prod#	Description	Bin                    Unit	Qty		
<b>KBT84064</b>	<b>Kit, Platform, 4xFCY W/ Alt, '13</b>		<b>2/17/2009</b>	<b>18.68</b>	<b>0</b>
10	BMN80031	Bkt, Main, Slide, Assy, 05K, IC, RE300	each	1	
20	BMC83117	Bkt, Weld't, 4xFCY W/ Alt, T3RE, '13	each	1	
30	BTC12060	Bolt, Hex, 12 x 1.75 x 60mm, 10.9,Plt,FT	each	4	
40	NTP07000	Nut, Hex, 7/16-14unc, 5, Plt	each	4	
50	WFA12000	Washer, Flat, 12mm, 8.8, Plt	each	4	
60	WFN07000	Washer, Flat, 7/16", 2, Plt	each	4	
70	WLA12000	Washer, Lock, 12mm, 8.8, Plt	each	4	
80	WLQ07000	Washer, Lock, 7/16", 8, Plt	each	4	

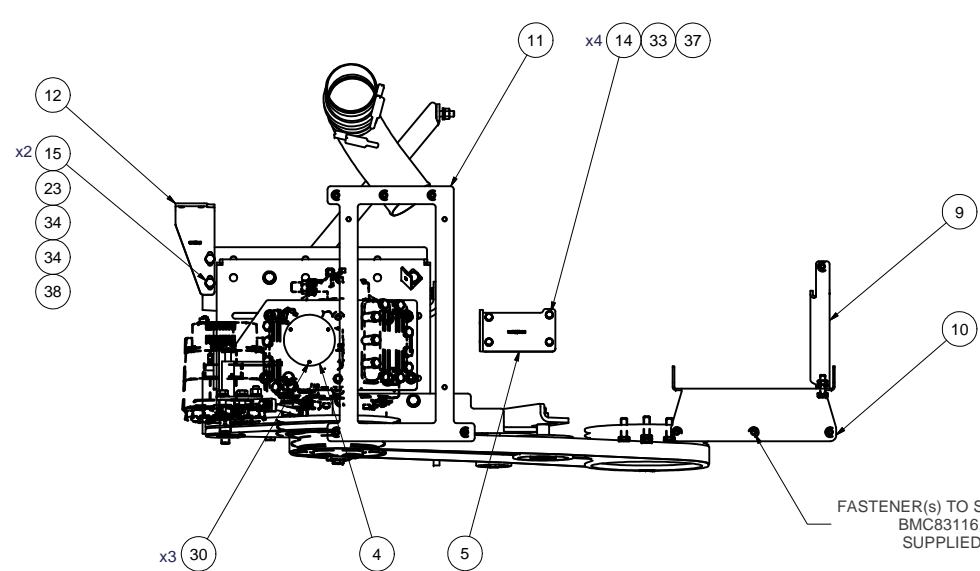

FASTENER(S) TO SECURE BMC83113, BMC83116, BMC83120, SUPPLIED BY OTHER.

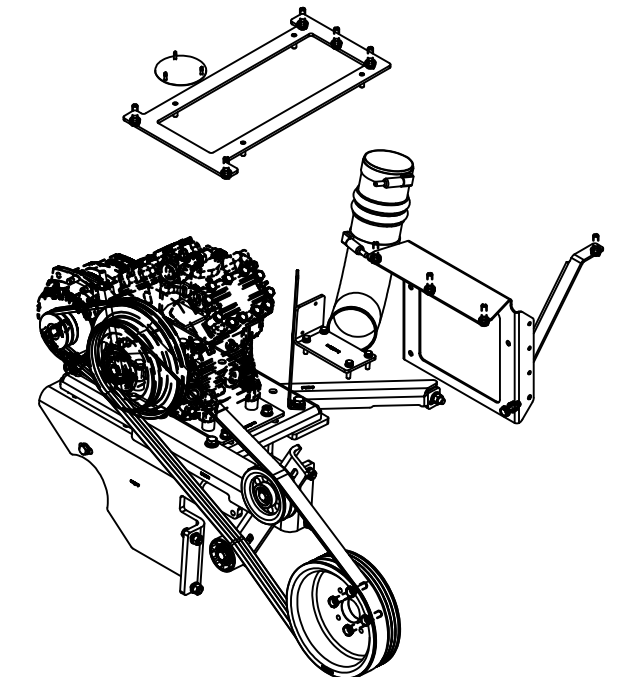

ISOMETRIC VIEW

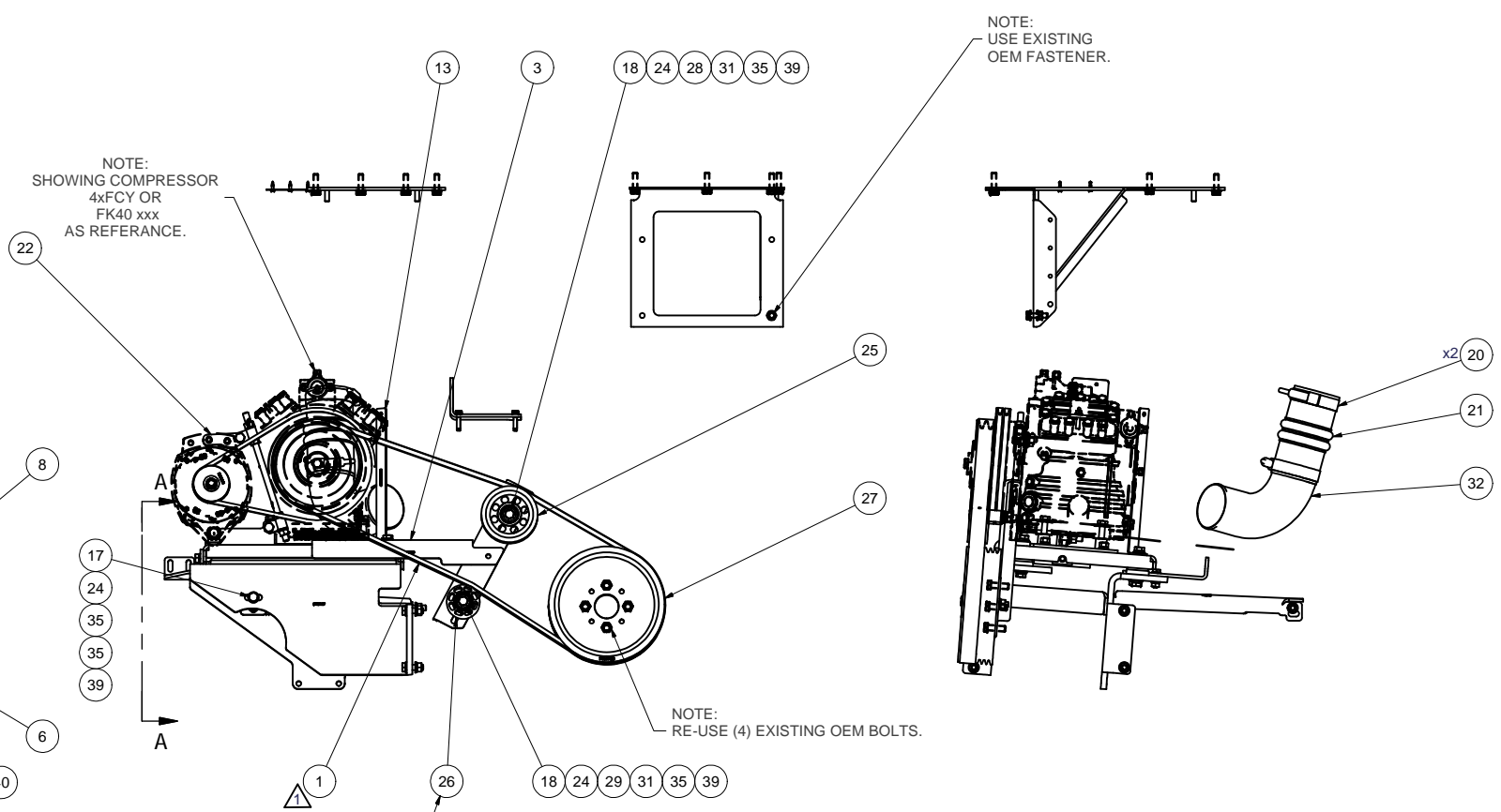

NOTE: USE EXISTING OEM FASTENER.

NOTE: SHOWING COMPRESSOR 4xFCY OR FK40 xxx AS REFERENCE.

NOTE: INSTALL PULLEY WITH DEEP OFFSET TOWARD SPACER.

NOTES:  
 1) USE SERVICABLE THREADLOCKER ON ALL FASTENERS TO ENGINE COMPONENTS AND TORQUE ALL BOLTS TO S.A.E. SPECIFICATIONS.  
 2) SEE "TRANSARCTIC A/C COMPRESSOR MOUNT INSTALLATION DISCLAIMER".

ITEM	QTY	U/M	PART NUMBER	DESCRIPTION
40	6	EACH	WLO08000	WASHER, LOCK, 1/2", 8, PLT
39	9	EACH	WLA12000	WASHER, LOCK, 12mm, 8.8, PLT
38	2	EACH	WLA10000	WASHER, LOCK, 10mm, 8.8, PLT
37	4	EACH	WLA08000	WASHER, LOCK, 8mm, 8.8, PLT
36	6	EACH	WFO08000	WASHER, FLAT, 1/2", 8, PLT
35	16	EACH	WFA12000	WASHER, FLAT, 12mm, 8.8, PLT
34	4	EACH	WFA10000	WASHER, FLAT, 10mm, 8.8, PLT
33	4	EACH	WFA08000	WASHER, FLAT, 8mm, 8.8, PLT
32	1	EACH	TUS04093	TUBE, STL, EXH, 4"o.d., 90 deg ELB, 8 x 8
31	2	EACH	SLV17012	SLEEVE, PULLEY, 16.9o x 22.23 mm x12.19i
30	3	EACH	SCP03075	SCREW, PH, SDT, #10-16 x .75, ST, PLT
29	1	EACH	SCD41012	SPACER, COL, DRL, 41mm x 25.4o x 12.3i
28	1	EACH	SCD37012	SPACER, COL, DRL, 37mm x 25.4o x 12.3i
27	1	EACH	PUL89322	PULLEY, CRANK, ADD-ON, COMBO, ISC/L-G, 2B/3V
26	1	EACH	PUL80074	PULLEY, IDLER, BACKSIDE, P8, 74D, 46.27W
25	1	EACH	PUA05012	PULLEY, ASSY, IDLER, B/BX gr, 5" STL, PLT
24	9	EACH	NTA12000	NUT, HEX, 12 x 1.75, 8.8, PLT
23	2	EACH	NTA10000	NUT, HEX, 10 x 1.5, 8.8, PLT
22	1	EACH	KCB84064	KIT, COMPRESSOR, FK40/4xFC, '13
21	1	EACH	HOA04083	HOSE, FLEX, CAC, 4.0d x 8.0, 3 RING
20	2	EACH	CLP04000	CLAMP, T BOLT, SPRING, 4", CAC
19	6	EACH	BTQ08126	BOLT, HEX, 1/2-20UNF x 1.25, 8, PLT
18	2	EACH	BTC12100	BOLT, HEX, 12 x 1.75 x 100mm, 10.9, PLT
17	2	EACH	BTC12050	BOLT, HEX, 12 x 1.75 x 50mm, 10.9, PLT
16	5	EACH	BTC12040	BOLT, HEX, 12 x 1.75 x 40mm, 10.9, PLT
15	2	EACH	BTC10035	BOLT, HEX, 10 x 1.5 x 35mm, 10.9, PLT
14	4	EACH	BTC08035	BOLT, HEX, 8 x 1.25 x 35mm, 10.9, PLT
13	1	EACH	BMZ00046	BKT, ANGLE, BRACE, HANGER, HOSE, 2013
12	1	EACH	BMC83122	BKT, EXHAUST, ADAPTER, T3RE, '13
11	1	EACH	BMC83120	BKT, WELDM'T, SUP, A.F HOUSING, T3RE, '13
10	1	EACH	BMC83116	BKT, SUPPORT, PDU PANEL, T3RE, '13
9	1	EACH	BMC83113	BKT, BRACE RR/PS, PDU PANEL, T3RE, '13
8	1	EACH	BMC83109	BKT, MAIN, LATERAL BRACE, T3RE, '13
7	1	EACH	BMC83108	BKT, MAIN, RR SUPPORT, T3RE, '13
6	1	EACH	BMC83107	BKT, MAIN, FRT SUPPORT, T3RE, '13
5	1	EACH	BMC83074	BKT, RELAY, ISC, D3RE, 2010
4	1	EACH	BMC83058	BKT, COVER, LIGHT PL, MFDT, RE300
3	1	EACH	BMC83054	BKT, MAIN, IDLER, WELDM'T, RE300
2	1	EACH	BMC83053	BKT, DIAG, BRACE RR, MFDT, RE300
1	1	EACH	BEL32210	BELT, BANDED, B GR, 2210mm (87") (Bx84-2)

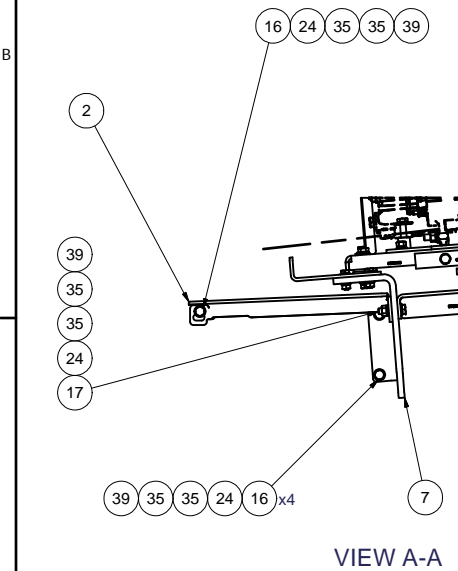

VIEW A-A

1	WAS (2) BEL22210.	11/30/15	VALJ
0	RELEASED TO PRODUCTION.	9/18/2013	JRR
REV	ECN	DESCRIPTION	DATE
			BY: James Stewart
THIS DRAWING CONTAINS PROPRIETARY CONFIDENTIAL INFORMATION OWNED BY TRANSARCTIC CANADA INC. THE DOCUMENT AND THE INFORMATION IN IT ARE NOT TO BE USED, DISCLOSED OR REPRODUCED WITHOUT EXPRESS WRITTEN PERMISSION OF THE COMPANY.			
UNSPECIFIED TOLERANCES: (ALL DIM.)			
ONE DECIMAL PLACE (X)	MM	(INCH)	
TWO DECIMAL PLACE (XX)	MM	(INCH)	
THREE DECIMAL PLACE (XXX)	MM	(INCH)	
FRACTIONAL (1/32")	ANGULAR	(1/32")	

DRAWN: jrodriguez 7/9/2013  
 CHECKED: James Stewart 7/9/2013  
 MFG: Ron Ingram 7/9/2013  
 APPROVED: Dale Mason 7/9/2013

**TRANSARCTIC INC.**

TITLE: MT KIT, ISC10, T3RE, FK40/ 4xFC, '13

SIZE: D DWG NO: KMC84064 REV: 1

DRAWING UNIT OF MEASURE: MM (INCH) SCALE: 1:8 SHEET 1 OF 1

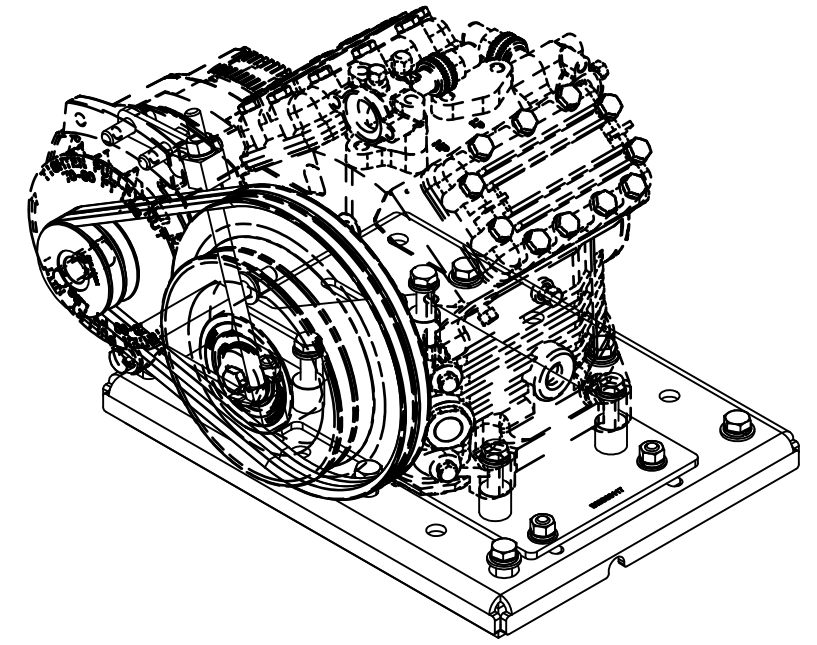
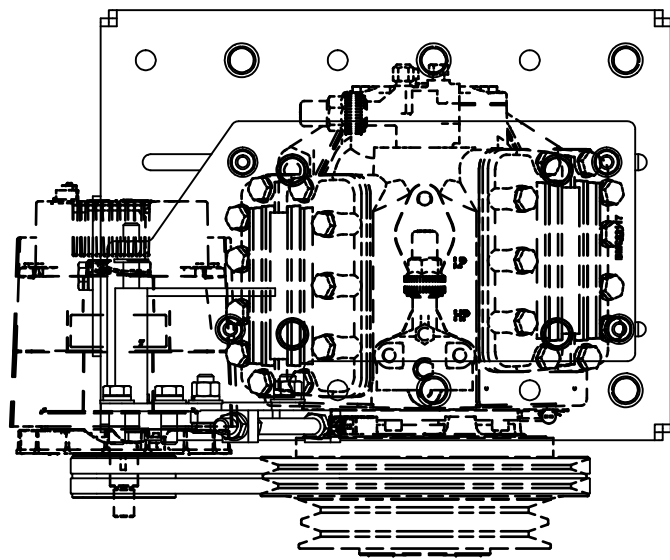
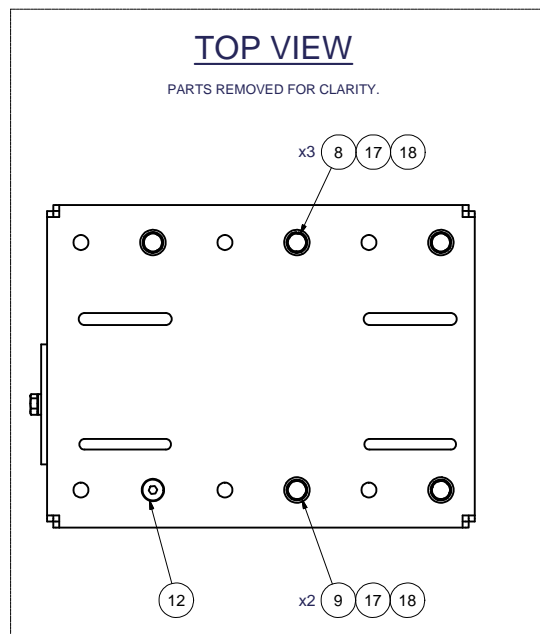

ISOMETRIC VIEW

NOTE:  
SHOWING COMPRESSOR  
4xFCY OR  
FK40 xxx  
AS REFERENCE.

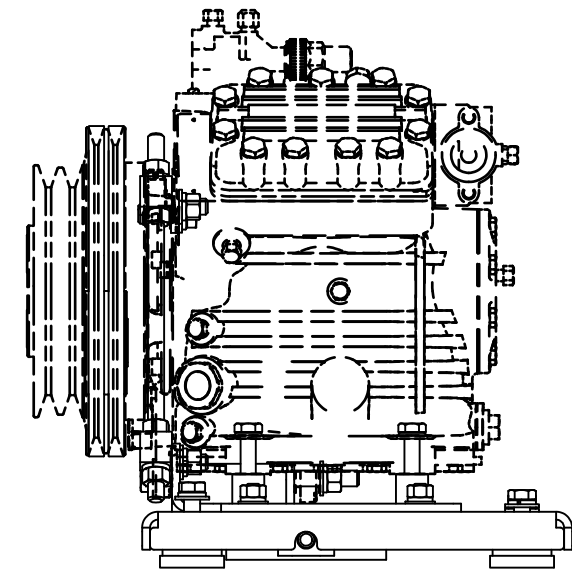
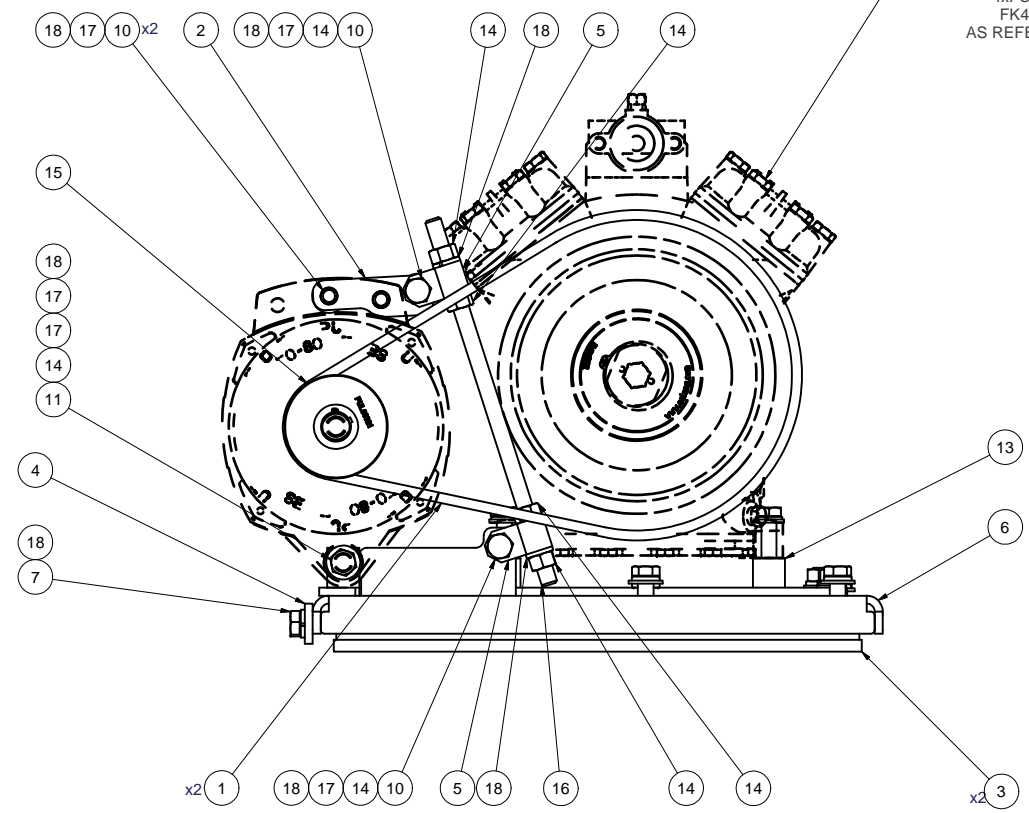

NOTES:  
1) USE SERVICABLE THREADLOCKER ON ALL FASTENERS TO ENGINE COMPONENTS AND TORQUE ALL BOLTS TO S.A.E. SPECIFICATIONS.  
2) SEE "TRANSARCTIC A/C COMPRESSOR MOUNT INSTALLATION DISCLAIMER".  
3) WEIGHT: 56.70 LBS.

ITEM	QTY	U/M	PART NUMBER	DESCRIPTION
18	13	EACH	WLQ08000	WASHER, LOCK, 1/2", 8, PLT
17	11	EACH	WFO08000	WASHER, FLAT, 1/2", 8, PLT
16	1	EACH	TRD08120	THREADED, ROD, 1/2-13UNC x 12", 5 PLT
15	1	EACH	PUL03321	PULLEY, ALT, IDLER, 3.25"o, 2A
14	7	EACH	NTQ08000	NUT, HEX, 1/2-13UNC, 8, PLT
13	1	EACH	KBT84064	MT KIT, TRANSIT, 4xFCY, '12
12	1	EACH	CSF08076	CAPSCREW, FH, 1/2-20UNF x .75", ALLOY, PLT
11	1	EACH	BTQ08653	BOLT, HEX, 1/2-13UNC x 6.50, 8, PLT
10	4	EACH	BTQ08150	BOLT, HEX, 1/2-13UNC x 1.50, 8, PLT
9	2	EACH	BTQ08126	BOLT, HEX, 1/2-20UNF x 1.25, 8, PLT
8	3	EACH	BTQ08101	BOLT, HEX, 1/2-20UNF x 1.00, 8, PLT
7	1	EACH	BTP08653	BOLT, HEX, 1/2-13UNC x 6.50, 5, PLT, FT
6	1	EACH	BMZ00043	BKT, MAIN, BASE PL, '13
5	2	EACH	BMT10011	BKT, TENR, BLOCK, OFFSET, 3mm
4	1	EACH	BMN80025	BKT, BACK, PL, SLIDE, IC, RE300
3	2	EACH	BMN80008	VIBRATION ISOLATOR, BAR, 16.50 x 2 x 1.50
2	1	EACH	BMC83114	BKT, PI, ALT SPACER, T3RE, '13
1	2	EACH	BEL11040	BELT, A gr, 1040mm (41") (17410)

BILL OF MATERIALS				
DRAWN	JRodriguez	9/16/2013		
CHECKED	Val Jakowlew	9/16/2013		
REV:ECN:	DESCRIPTION:	DATE:		BY:
0	RELEASED TO PRODUCTION	9/16/2013		JRR
THIS DRAWING CONTAINS PROPRIETARY CONFIDENTIAL INFORMATION OWNED BY TRANSARCTIC CANADA INC. THE DOCUMENT AND THE INFORMATION IN IT ARE NOT TO BE USED, DISCLOSED OR REPRODUCED WITHOUT EXPRESS WRITTEN PERMISSION OF THE COMPANY.			TITLE <b>KIT, COMPRESSOR, 24V, FK40/ 4xFC, '13</b>	
UNSPECIFIED TOLERANCES: (ALT. DIM.) ONE DECIMAL PLACE (XX) .50 (1/20) TWO DECIMAL PLACE (XXX) .25 (1/16) THREE DECIMAL PLACE (XXXX) .10 (1/32) FRACTIONAL: +/- 1/32" ANGULAR: +/- .50°		DRAWING UNIT OF MEASURE: MM (INCH)	SCALE: 1:3	
THIRD ANGLE PROJECTION			SHEET 1 OF 1	

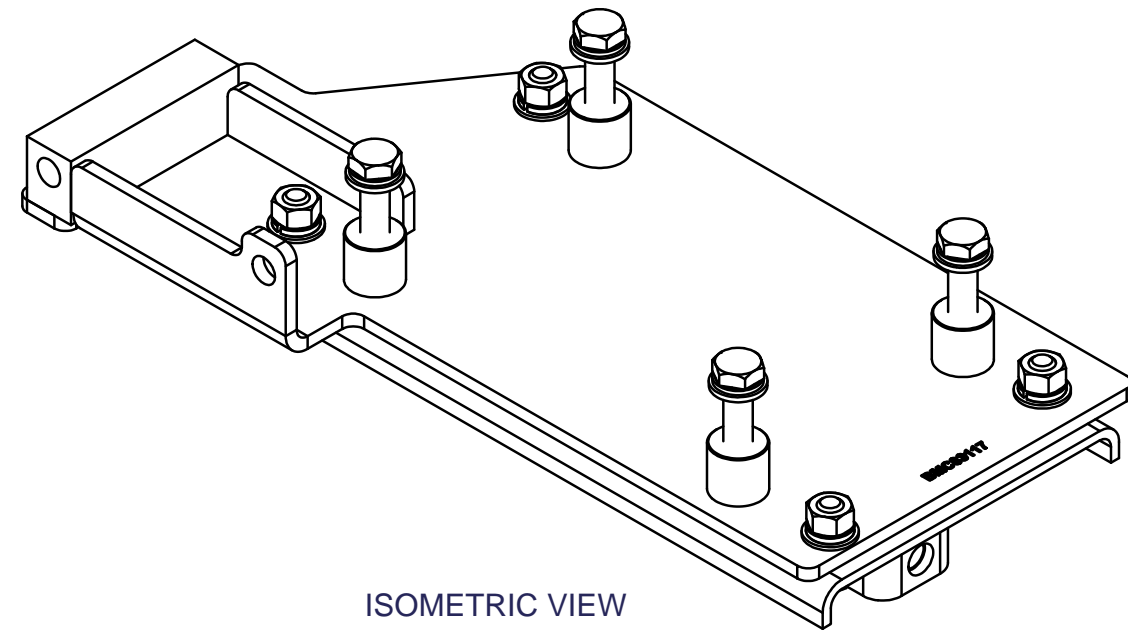
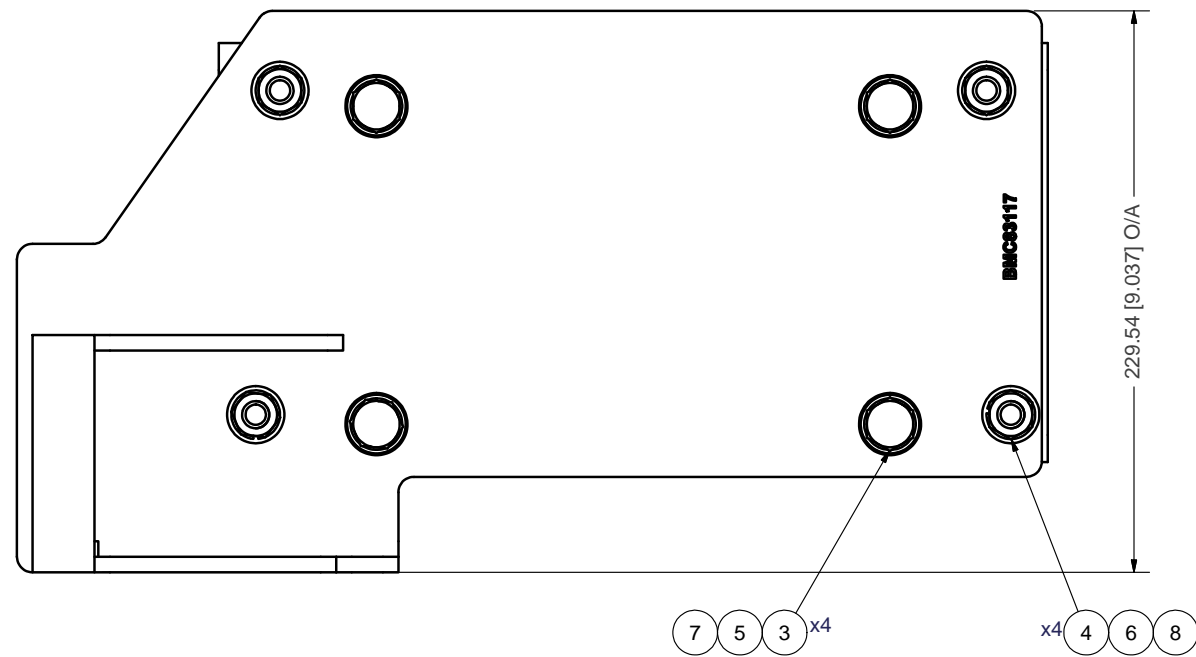

ISOMETRIC VIEW

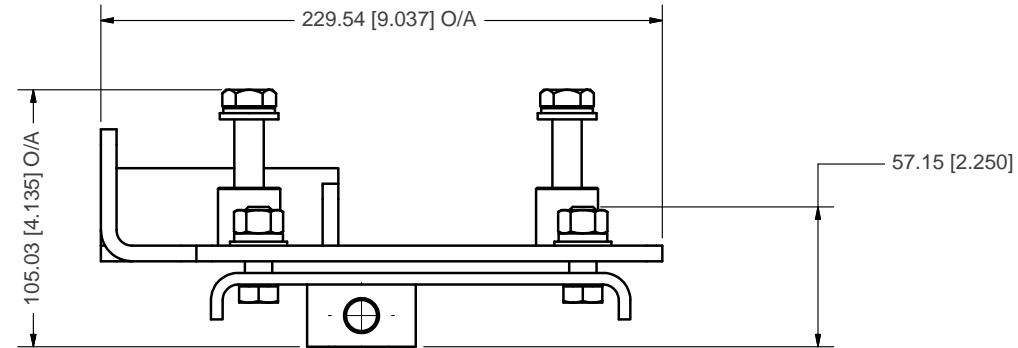
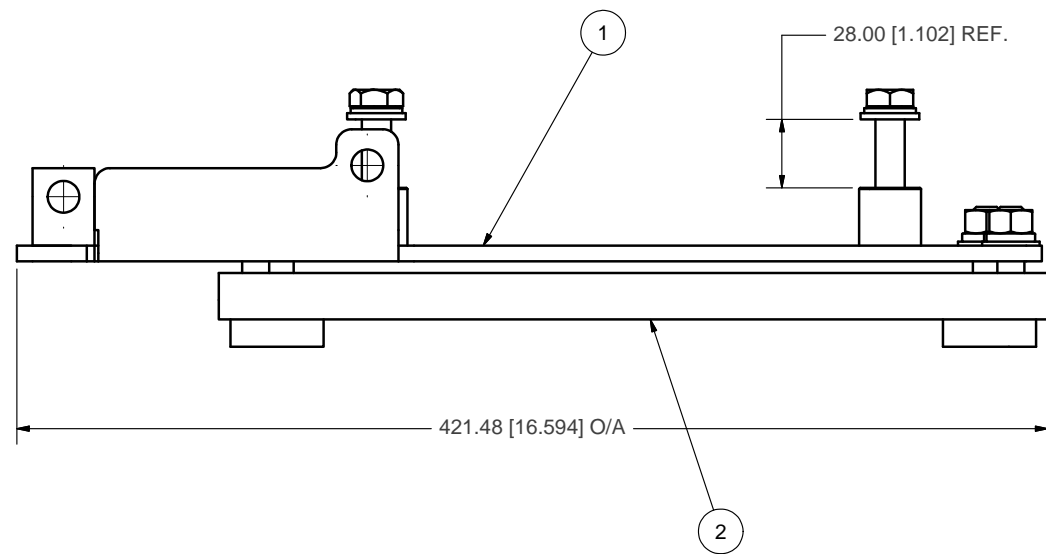

ITEM	QTY	U/M	PART NUMBER	DESCRIPTION
8	4	EACH	WLQ07000	WASHER, LOCK, 7/16", 8, PLT
7	4	EACH	WLA12000	WASHER, LOCK, 12mm, 8.8, PLT
6	4	EACH	WFN07000	WASHER, FLAT, 7/16", 2, PLT
5	4	EACH	WFA12000	WASHER, FLAT, 12mm, 8.8, PLT
4	4	EACH	NTP07000	NUT, HEX, 7/16-14UNC, 5, PLT
3	4	EACH	BTC12060	BOLT, HEX, 12 x 1.75 x 60mm, 10.9, PLT
2	1	EACH	BMN80031	BKT, MAIN, SLIDE, ASSY, 05K, IC, RE300
1	1	EACH	BMC83117	BKT, WELDM'T, 4xFCY W/ALT, T3RE, '13

BILL OF MATERIALS

DRAWN	jrodriguez	7/12/2013	<b>TRANSARCTIC INC.</b>	
CHECKED	Val Jakowlew	7/12/2013		
QA	James Stewart	7/12/2013		
MFG	Ron Ingram	7/12/2013		
APPROVED	Dale Mason	7/12/2013	TITLE	
			KIT, PLATFORM, 4xFCY W/ALT, '13	
DRAWING UNIT OF MEASURE: MM [INCH]		SCALE 1:2	DWG NO KBT84064	REV 0
			SHEET 1 OF 1	

REV: 0	ECN:	DESCRIPTION:	DATE:	BY:
		RELEASED TO PRODUCTION.	7/24/2013	JRR
THIS DRAWING CONTAINS PROPRIETARY CONFIDENTIAL INFORMATION OWNED BY TRANSARCTIC CANADA INC. THE DOCUMENT AND THE INFORMATION IN IT ARE NOT TO BE USED, DISCLOSED OR REPRODUCED WITHOUT EXPRESS WRITTEN PERMISSION OF THE COMPANY.				
UNSPECIFIED TOLERANCES:				
ONE DECIMAL PLACE (X)	.50	[.020]		
TWO DECIMAL PLACE (XX)	.25	[.010]		
THREE DECIMAL PLACE (XXX)	.10	[.005]		
FRACTIONAL +/- 1/32"	ANGULAR +/- .50°			
THIRD ANGLE PROJECTION				

NOTES:

- 1) USE SERVICABLE THREADLOCKER ON ALL FASTENERS TO ENGINE COMPONENTS AND TORQUE **ALL** BOLTS TO S.A.E. SPECIFICATIONS.
- 2) SEE "TRANSARCTIC A/C COMPRESSOR MOUNT INSTALLATION DISCLAIMER".
- 3) WEIGHT: 18.22 LBS.



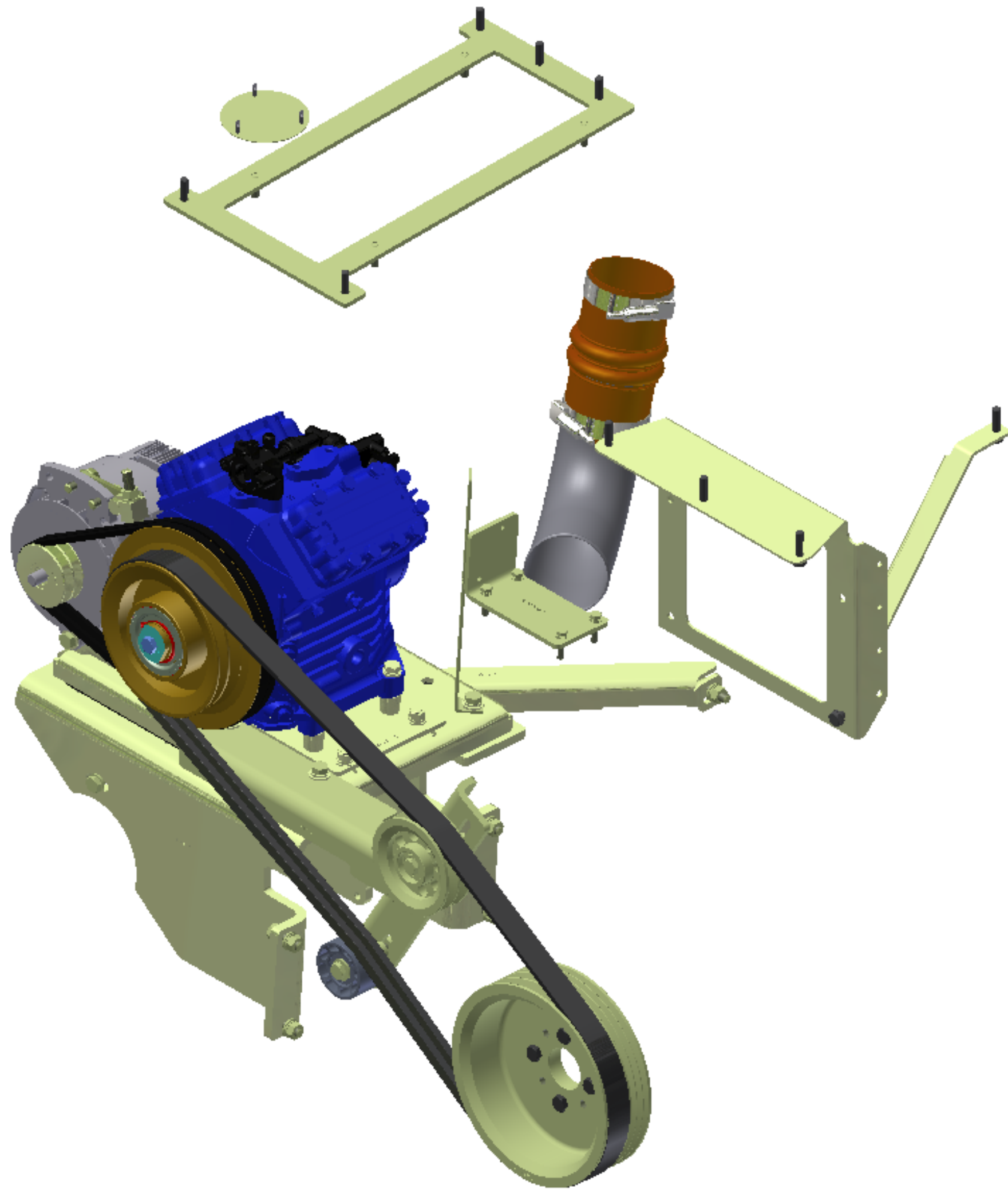

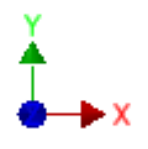
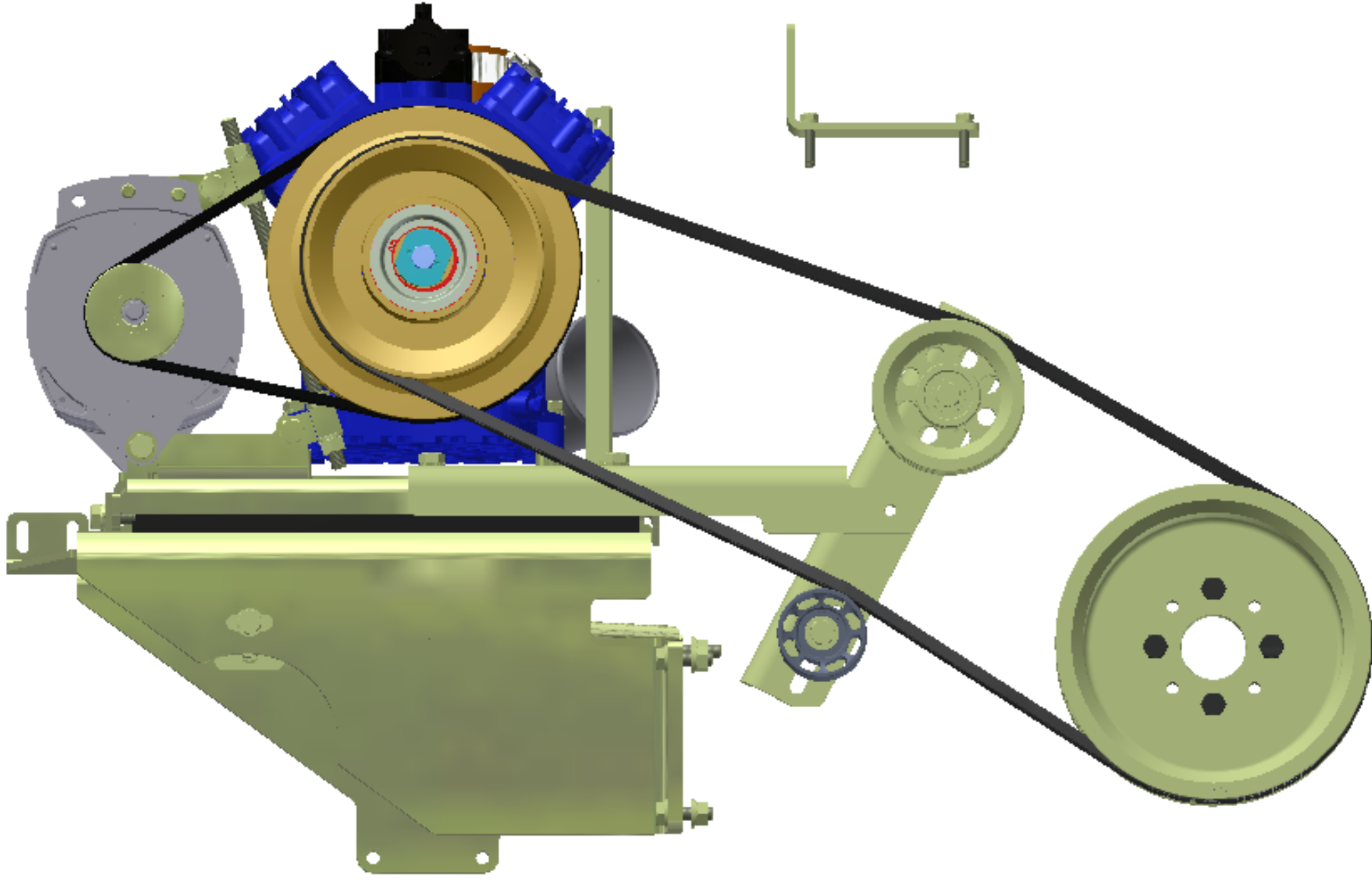
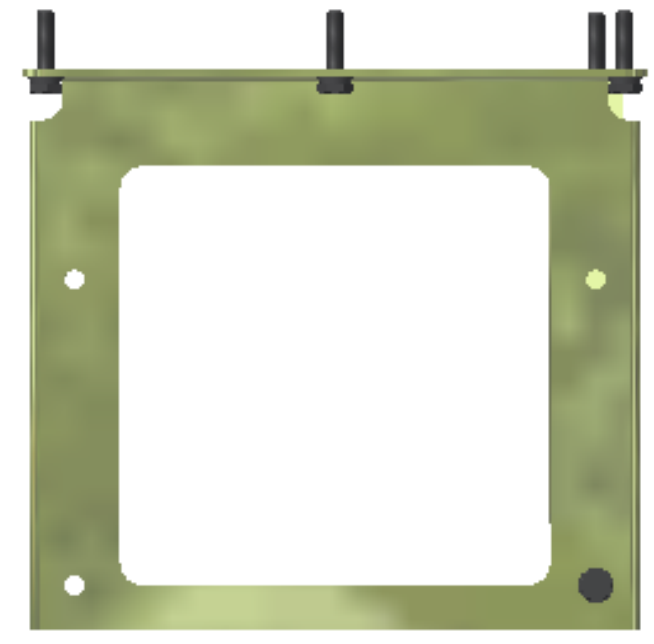

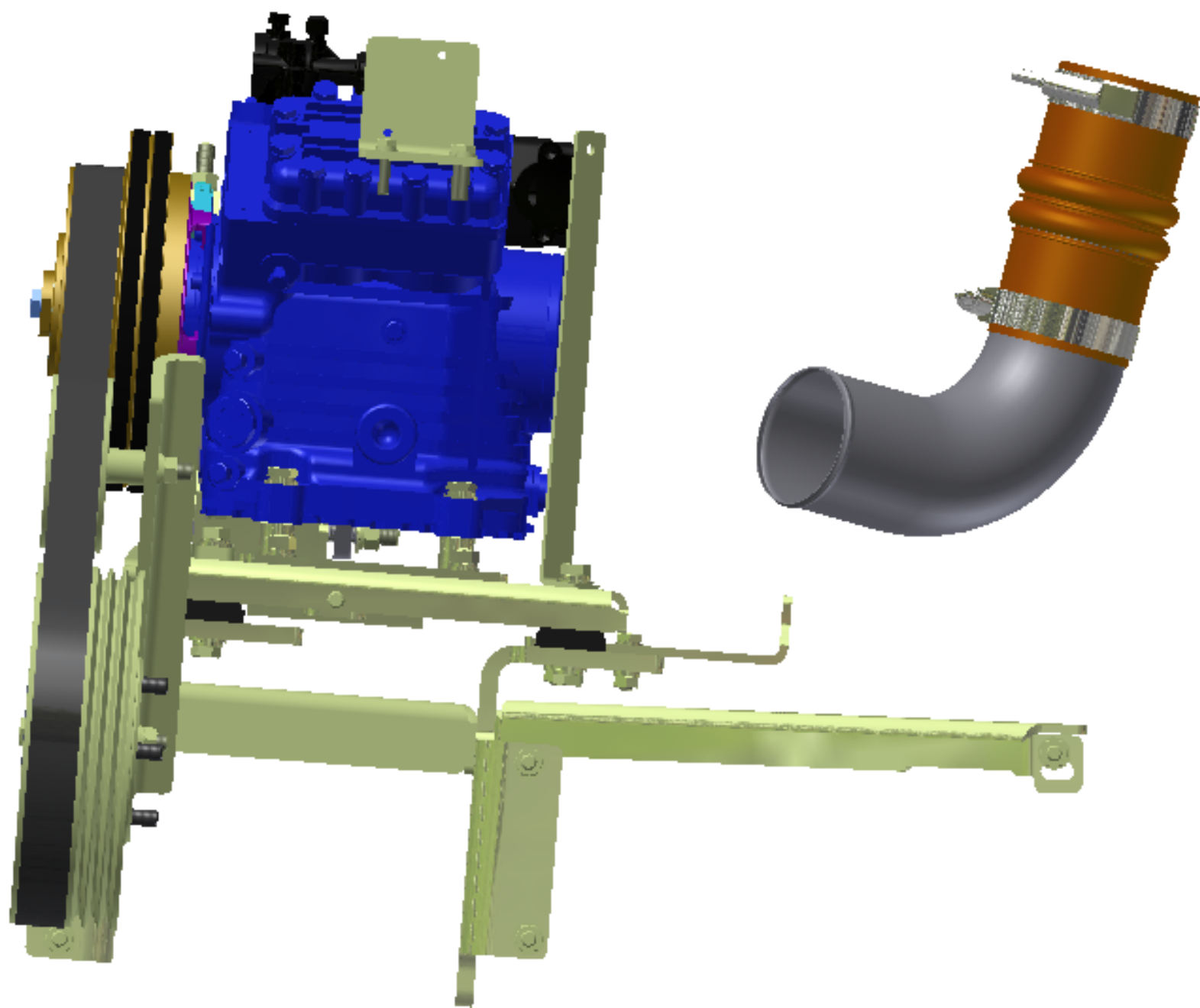
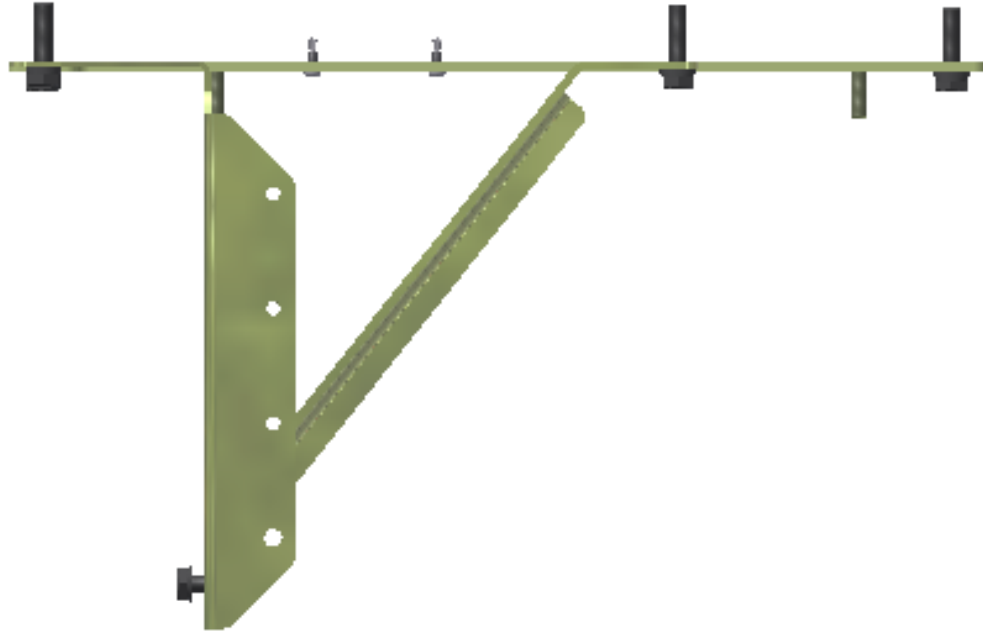

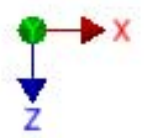
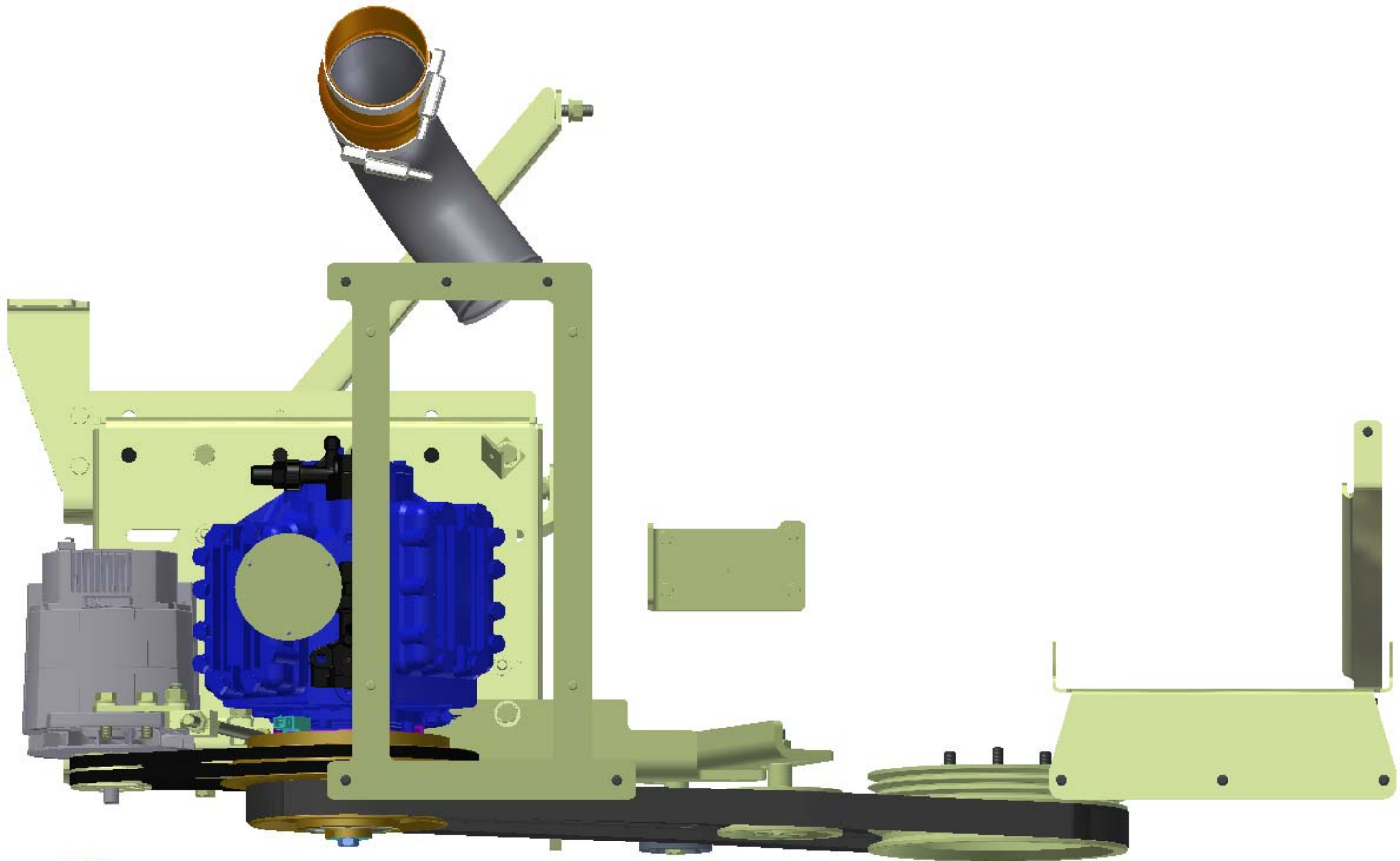

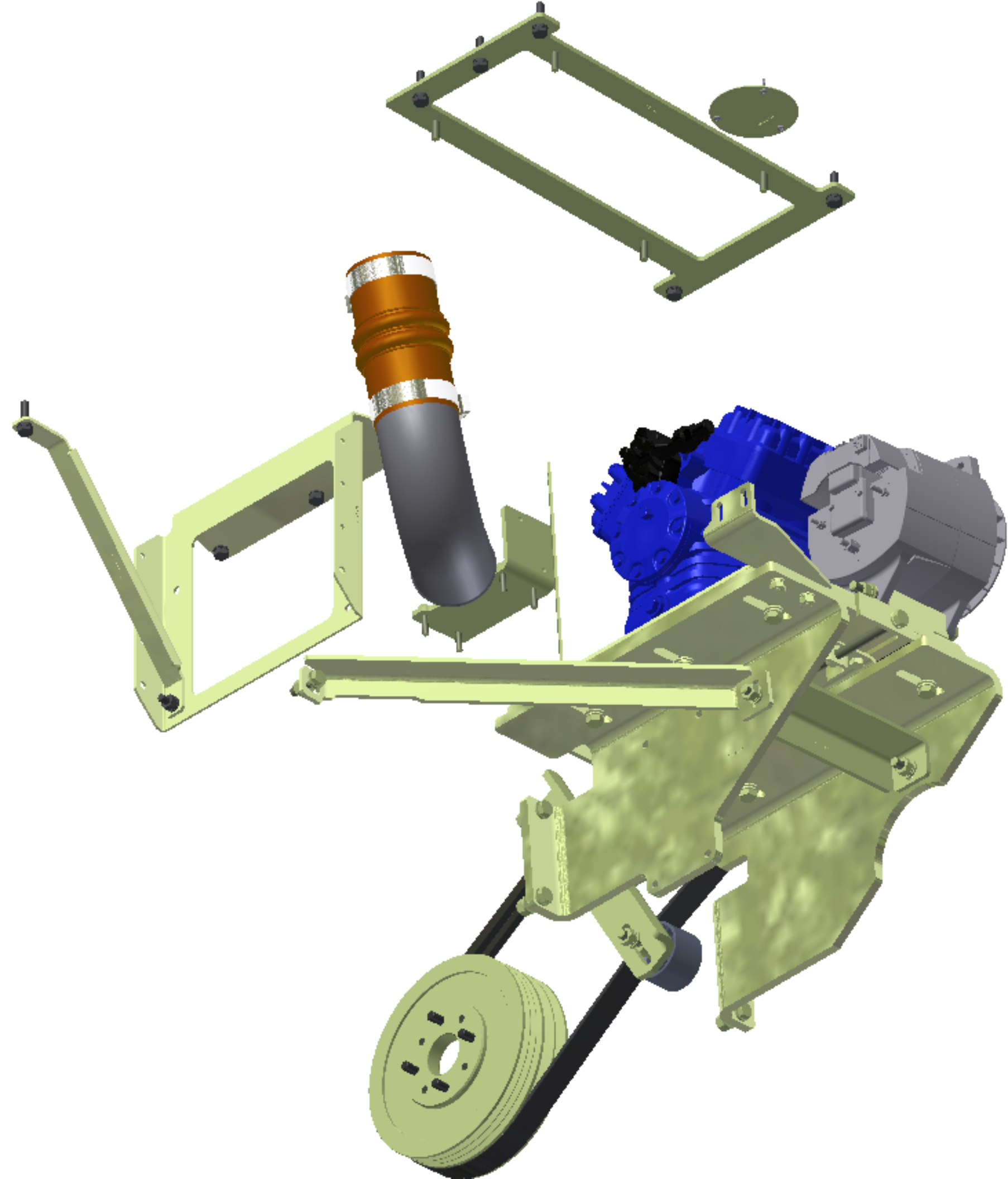

## **TransArctic A/C Compressor Mount Installation Disclaimer**

All compressor mounts should be installed by qualified and trained personnel using proper tools and equipment in safe working conditions following industry standard guidelines for motor vehicle service and repair.

The installer of any compressor mount purchased from TransArctic must undertake all responsibility of issues arising from that compressor bracket being installed on any vehicle. As well as insure that a **proper and sufficient ground** is established between the compressors' clutches and the vehicle's engine. Mount functionality, operation and durability can all be compromised by an incompetent installation.

Due to the many different situations, parameters and application criteria, which are beyond the compressor mount manufacturer's control, TransArctic does not warrant design, durability, or operational functionality of any compressor mount improperly installed by another party.

**With no implied guarantees it is the mount installer's strict responsibility to determine safety and functionality, of the compressor mount, at the time of installation.**

Please contact TransArctic with any issue arising from installation so we may better improve the product. If you have any reservations about the compressor mount integrity contact TransArctic immediately at 1-877-COLD-AIR.

**Mark OEM tensioner location**

**Install Kit**

**Check for Interferences**

**Check to ensure that the proper OEM tensioner orientation is maintained**

**Run engine with A/C system engaged for at least 10 minutes to run in belt**

**Check OEM tensioner orientation and adjust as required**

### **Responsabilidad limitada de TransArctic en la instalación del soporte del compresor**

Todos los soportes de los compresores deben ser instalados por personas calificadas y entrenadas, usando para ello los equipos y herramientas necesarios para esta labor en buenas condiciones y según las normas y guías para el servicio y/o reparación de motores de vehículos.

El instalador de los soportes comprados en TransArctic asume toda la responsabilidad de cualquier problema que surga en el soporte del compresor al vehículo; de igual manera es responsable que el cable a tierra sea conectado entre el embrague del compresor y el motor del vehículo.

Se advierte que el buen funcionamiento y la durabilidad del soporte pueden ser comprometidos por defectos en su instalación.

Debido a las diversas situaciones que se puedan presentar fuera del control del fabricante, TransArctic no garantiza el diseño, la durabilidad o el correcto funcionamiento de cualquier equipo inapropiadamente instalado por terceros.

**Esta sobreentendido que el Instalador del montaje del compresor es estrictamente responsable de la seguridad y funcionamiento del equipo en el momento de la instalación.**

Si tuviera algún problema o duda acerca de la instalación del soporte del compresor pongase en contacto inmediatamente con TransArctic al teléfono 1-877-COLD-AIR de modo que podamos mejorar nuestro producto.

**Note la ubicación del medidor de tensión OEM**

**Instale el equipo**

**Controlar si hay interferencias.**

**Asegure que el medidor de tensión mantenga la orientación justa.**

**Encienda el motor por lo menos 10 minutos con el sistema A/C enganchado para que la correa corra**

**Controle la orientación justa del medidor de tensión y ajuste a las condiciones requeridas del fabricante**