

Bill of Materials Listing

TransArctic Canada Inc.

5/11/2015
Page 1 of 1

Product Number	Description	Date	Weight	Uof M	Yield
Line Component Prod#	Description	Bin Unit	Qty		
KRK73470	Mt Kit, Retrofit, C7,Vision,TM-55/65,'07		08/11/08	39.15	0
5	BMK70111		Bkt, Alt, Angle, CAT, C7, TM-55, '07	each	1
10	BMK70107		Bkt, Main, Weldmt, BBCV C7, TM-55, '07	each	1
20	BMK70103		Bkt, RR, Brace, Weldmt, CAT C7, F400, 07	each	1
25	BMK70112		Bkt, Shroud, Cover, 12ga, CAT, C7, TM-55	each	1
30	PUL81074		Pulley, Idler, Frontside, P8,74d (89103)	each	1
40	TEN80002		Tenr, HD Spring, BackSide, CCW (89200A)	each	1
50	SCD11617		Spacer, Col, Drl, 11.6mm x 28.6o x 17i	each	1
60	NTS10460		Nut, Tensioner, 10 mm, 46.0 mm o/a, PLT	each	1
70	BEL81778		Belt, 8gr, 1765mm (70") (5080700)	each	1
200	KBK73470		Bag Kit, Fasteners, KRK73470	each	1

Bill of Materials Listing

TransArctic Canada Inc.

5/11/2015
Page 1 of 1

Product Number		Description	Bin	Date	Weight	Uof M	Yield
Line	Component Prod#	Description		Unit	Qty		
KBK73470		Bag Kit, Fasteners, KRK73470		09/05/08	2.24		0
10	BTS10001	Bolt, Shoulder, 10mm (89064)		each	1		
15	BTC08101	Bolt, Hex, 8 x 1.25 x 100mm, 10.9,Plt,FT		each	1		
17	BTC10030	Bolt, Hex, 10 x 1.5 x 30mm, 10.9, Plt		each	1		
20	BTC10035	Bolt, Hex, 10 x 1.5 x 35mm, 10.9, Plt,FT		each	4		
30	BTC10080	Bolt, Hex, 10 x 1.5 x 80mm, 10.9, Plt,FT		each	1		
40	BTC10110	Bolt, Hex, 10 x 1.5 x 110mm, 10.9, Plt		each	2		
45	BTC12030	Bolt, Hex, 12 x 1.75 x 30mm, 10.9, Plt		each	2		
50	BTC12035	Bolt, Hex, 12 x 1.75 x 35mm, 10.9,Plt,FT		each	2		
60	BTC12065	Bolt, Hex, 12 x 1.75 x 65mm, 10.9, Plt		each	4		
70	CSF10031	Capscrew, FH, 10 x 1.5 x 30mm, 10.9,Plt		each	1		
80	NTA10000	Nut, Hex, 10 x 1.5, 8.8, Plt		each	2		
90	NTA08000	Nut, Hex, 8 x 1.25, 8.8, Plt		each	3		
100	WFA08000	Washer, Flat, 8mm, 8.8, Plt		each	3		
110	WFA10000	Washer, Flat, 10mm, 8.8, Plt		each	8		
120	WFA12000	Washer, Flat, 12mm, 8.8, Plt		each	8		
130	WLA08000	Washer, Lock, 8mm, 8.8, Plt		each	1		
140	WLA10000	Washer, Lock, 10mm, 8.8, Plt		each	8		
150	WLA12000	Washer, Lock, 12mm, 8.8, Plt		each	8		

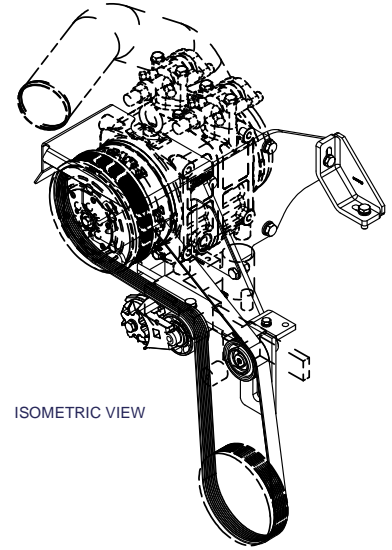
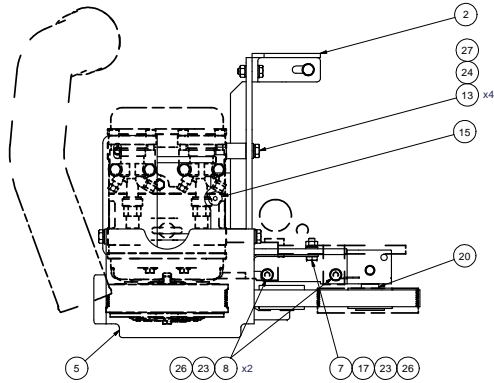

ISOMETRIC VIEW

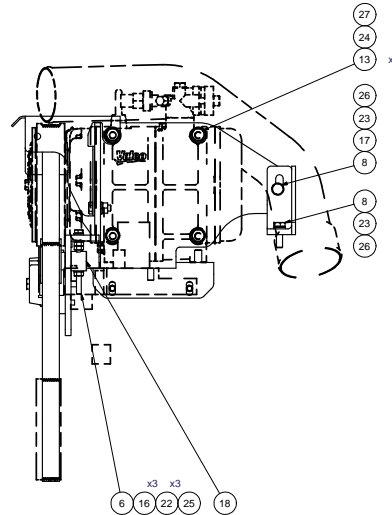
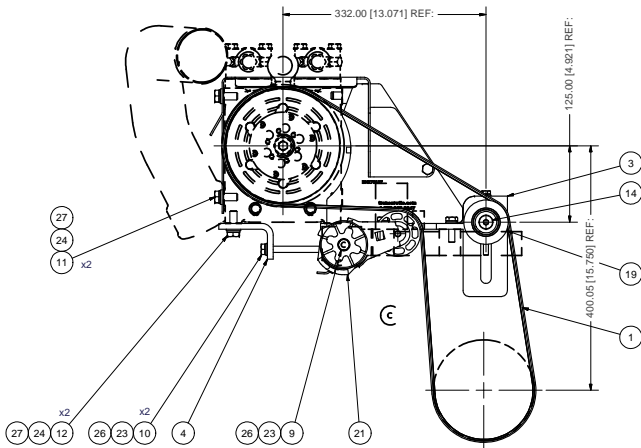

NOTES:

- 1) USE SERVICABLE THREADLOCKER ON ALL FASTENERS TO ENGINE COMPONENTS AND TORQUE ALL BOLTS TO S.A.E. SPECIFICATIONS.
- 2) SEE "TRANSARC TIC A/C COMPRESSOR MOUNT INSTALLATION DISCLAIMER".

ITEM	QTY	U/M	PART NUMBER	DESCRIPTION
27	8	EACH	WLA12000	WASHER, LOCK, 12mm, 8.8, PLT
26	8	EACH	WLA10000	WASHER, LOCK, 10mm, 8.8, PLT
25	1	EACH	WLA08000	WASHER, LOCK, 8mm, 8.8, PLT
24	8	EACH	WFA12000	WASHER, FLAT, 12mm, 8.8, PLT
23	8	EACH	WFA10000	WASHER, FLAT, 10mm, 8.8, PLT
22	3	EACH	WFA08000	WASHER, FLAT, 8mm, 8.8, PLT
21	1	EACH	TEN80002	TENR, HD SPRING, BACKSIDE, CCW
20	1	EACH	SCD11617	SPACER, COL, DR, 11.6mm x 28.66 x 17l
19	1	EACH	PUL81074	PULLEY, IDLER, FRONTSIDE, PB, 74d x 39w
18	1	EACH	NTS10460	NUT, TENSIONER, 10mm, 49.21 mm o/a, PLT
17	2	EACH	NTA10000	NUT, HEX, 10 x 1.5, 8.8, PLT
16	3	EACH	NTA08000	NUT, HEX, 8 x 1.25, 8.8, PLT
15	1	EACH	CSF10031	CAPSCREW, FH, 10 x 1.5 x 30mm, 10.9, PLT
14	1	EACH	BTS10001	BOLT, SHOULDER, 10mm (IDLER PULLEY)
13	4	EACH	BTC12065	BOLT, HEX, 12 x 1.75 x 65mm, 10.9, PLT
12	2	EACH	BTC12035	BOLT, HEX, 12 x 1.75 x 35mm, 10.9, PLT
11	2	EACH	BTC12030	BOLT, HEX, 12 x 1.75 x 30mm, 10.9, PLT
10	2	EACH	BTC10110	BOLT, HEX, 10 x 1.5 x 110mm, 10.9, PLT
9	1	EACH	BTC10080	BOLT, HEX, 10 x 1.5 x 80mm, 10.9, PLT
8	4	EACH	BTC10035	BOLT, HEX, 10 x 1.5 x 35mm, 10.9, PLT
7	1	EACH	BTC10030	BOLT, HEX, 10 x 1.5 x 30mm, 10.9, PLT
6	1	EACH	BTC08101	BOLT, HEX, 8 x 1.25 x 100mm, 10.9, PLT, FT
5	1	EACH	BMK70112	BKT, SHROUD, COVER, 12ga, CAT, C7, TM-55
4	1	EACH	BMK70111	BKT, ALT, ANGLE, CAT, C7, TM-55/65, '07
3	1	EACH	BMK70107	BKT, MAIN, WELDMT, CAT, C7, TM-55/65, '07
2	1	EACH	BMK70103	BKT, RR, BRACE, WELDMT, CAT, C7, F400, '07
1	1	EACH	BEL1778	Belt, 8gr, 1778mm (70") (508700)

BILL OF MATERIALS

0	RELEASED TO PRODUCTION	12/05/15	VAL	Jose Rodriguez	09/05/14	TITLE
A	RELEASED TO PROTOTYPE	09/05/14	VAL	GA	09/05/14	
REV	ECN	DESCRIPTION	DATE	BY		
				James Stewart	09/05/14	MT KIT, RETROFIT, C7, VISION, TM-55/65, '07
				MFG	09/05/14	
				James Stewart	09/05/14	
				APPROVED	09/05/14	
				Dale Mason	09/05/14	

UNSPECIFIED TOLERANCES:		PLT (MM)	THIRD ANGLE PROJECTION
ONE DECIMAL PLACE (X1)	0.1	0.1	THIRD ANGLE PROJECTION
TWO DECIMAL PLACE (X2)	0.05	0.05	
THREE DECIMAL PLACE (X3)	0.025	0.025	
FRACTIONAL (1/16")	ANGULAR	± .25	

DRAWING UNIT OF MEASURE:	MM (INCH)
SCALE:	1:1
DWG NO:	KRK73470
REV:	0
SHEET:	1 OF 1



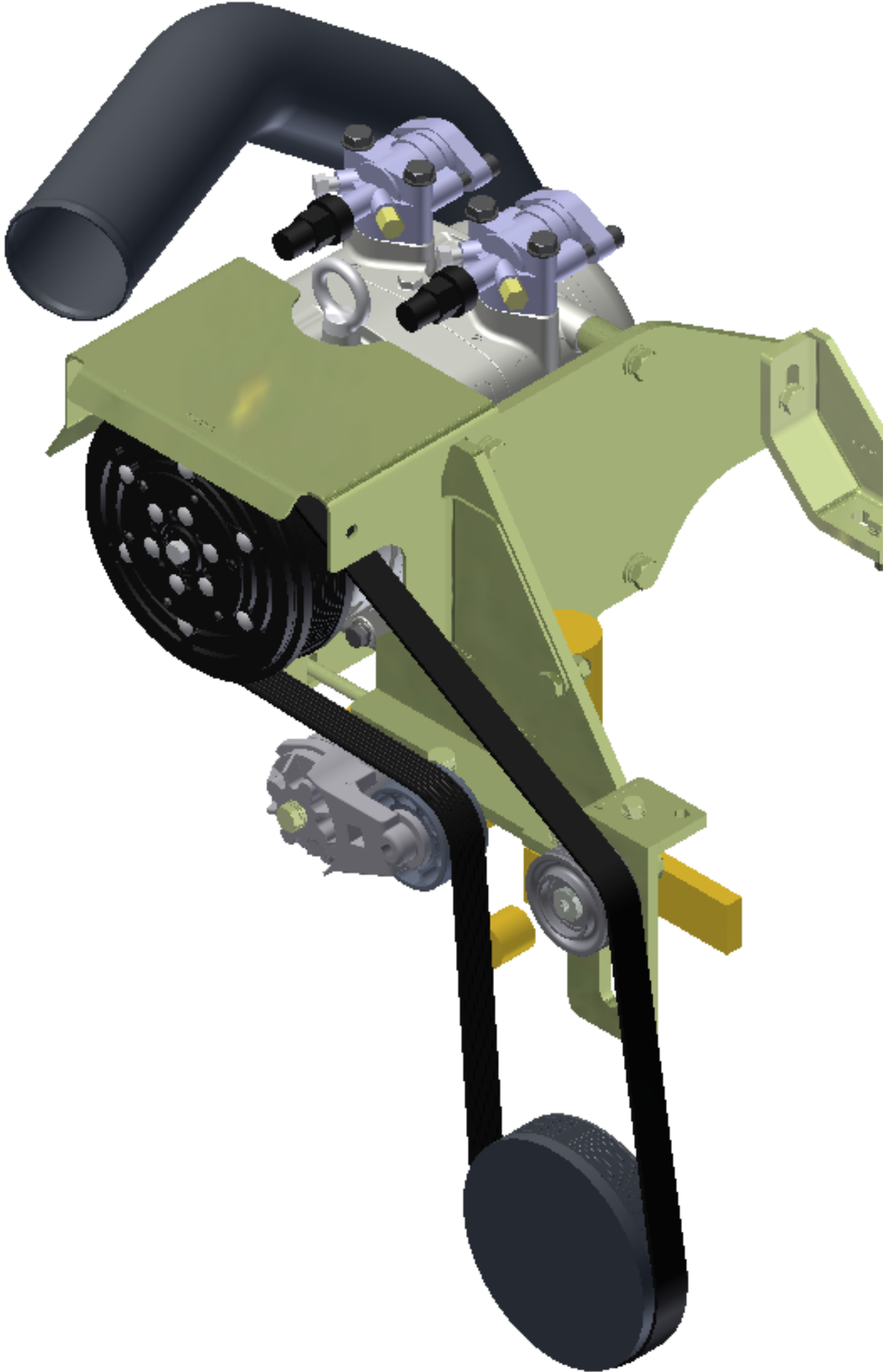

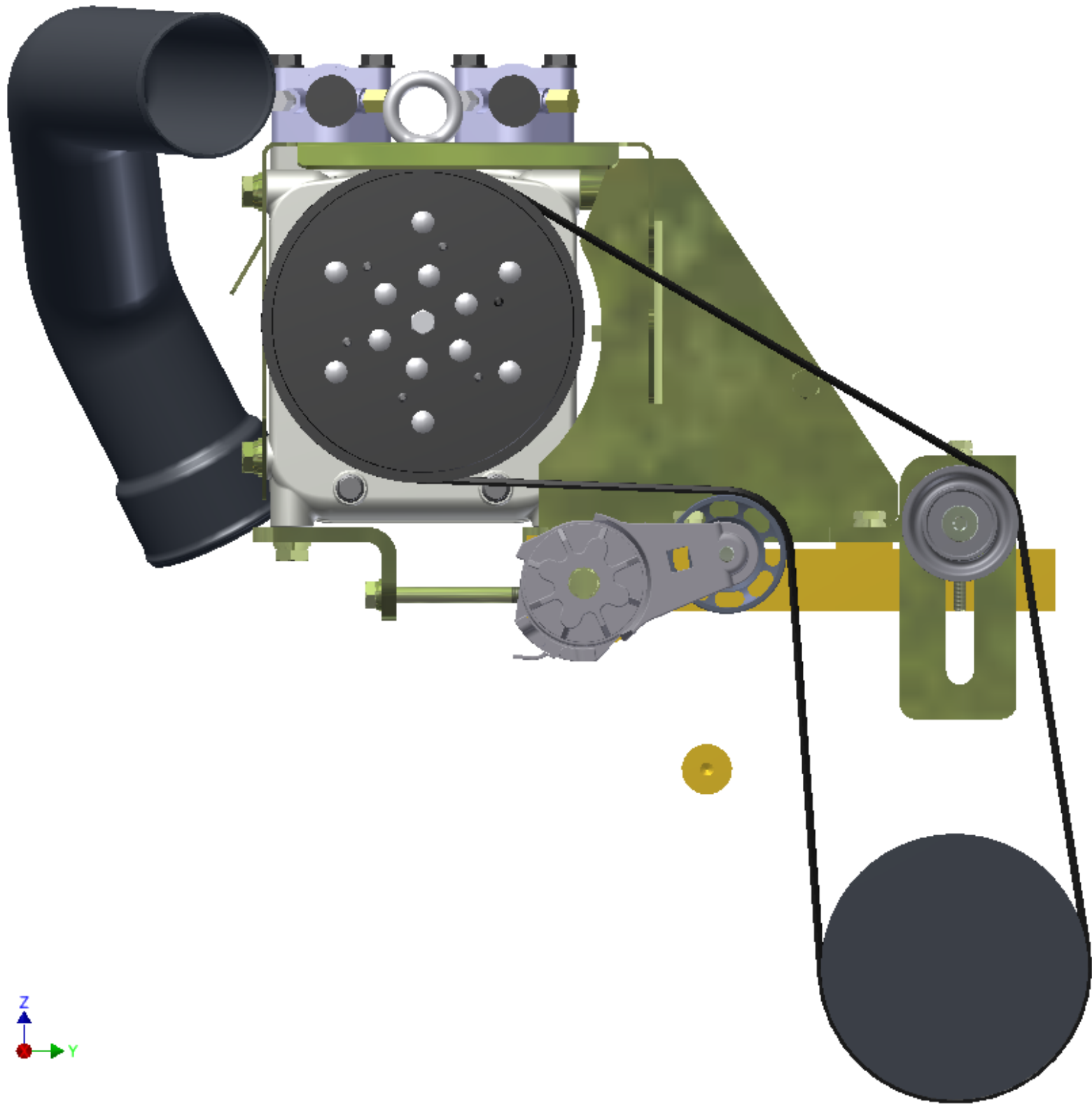

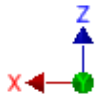
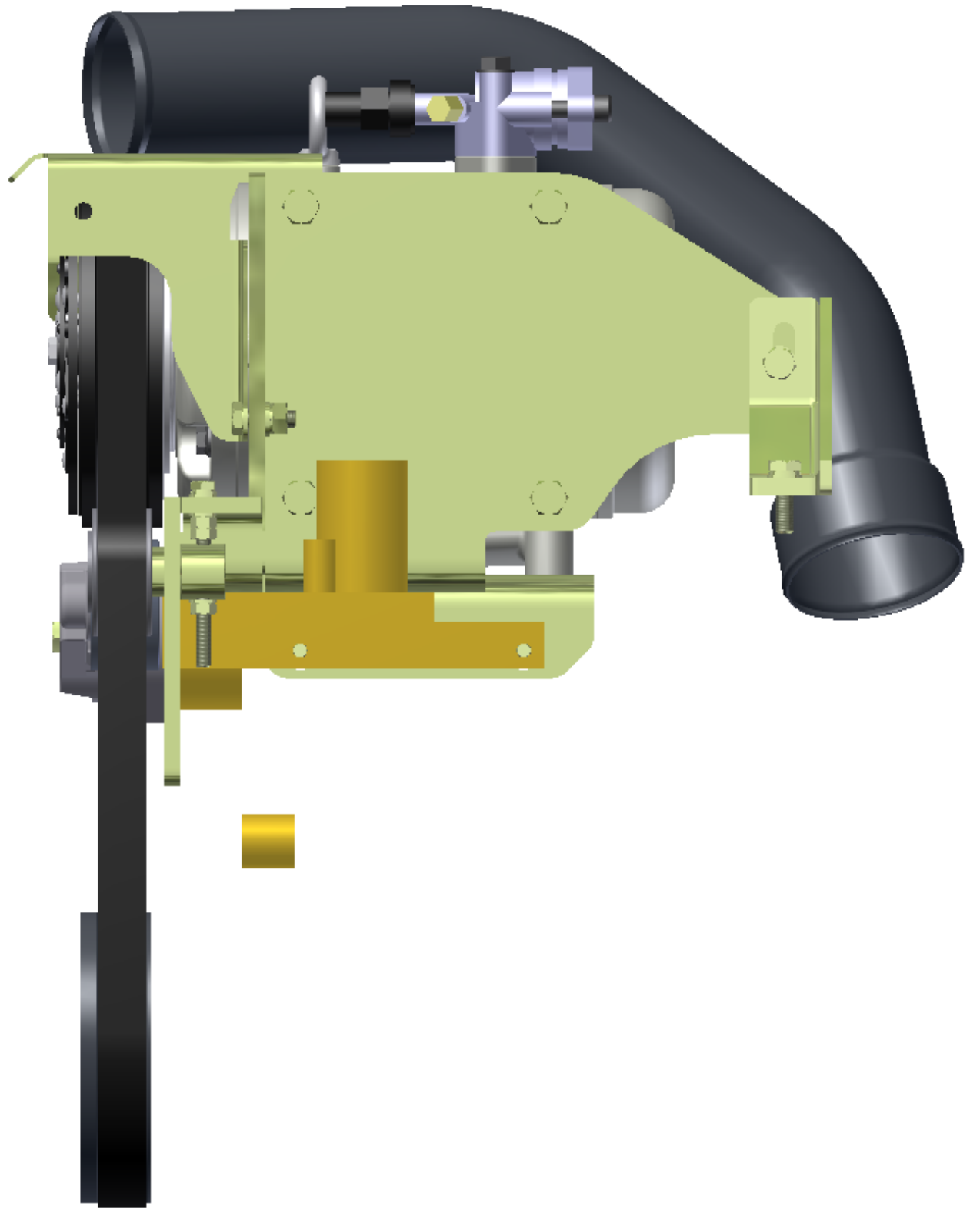

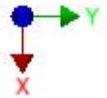
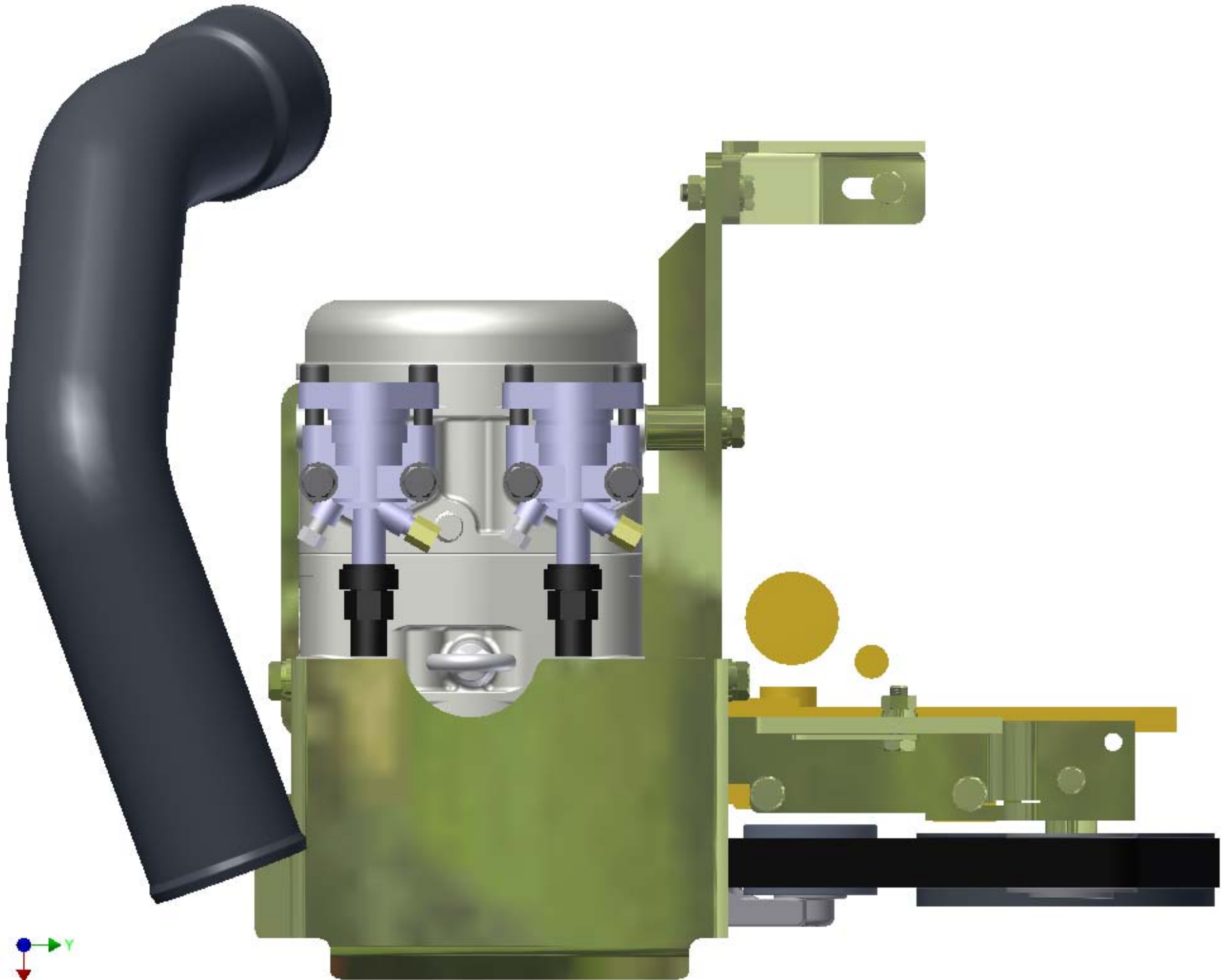

TransArctic A/C Compressor Mount Installation Disclaimer

All compressor mounts should be installed by qualified and trained personnel using proper tools and equipment in safe working conditions following industry standard guidelines for motor vehicle service and repair.

The installer of any compressor mount purchased from TransArctic must undertake all responsibility of issues arising from that compressor bracket being installed on any vehicle. As well as insure that a **proper and sufficient ground** is established between the compressors' clutches and the vehicle's engine. Mount functionality, operation and durability can all be compromised by an incompetent installation.

Due to the many different situations, parameters and application criteria, which are beyond the compressor mount manufacturer's control, TransArctic does not warrant design, durability, or operational functionality of any compressor mount improperly installed by another party.

With no implied guarantees it is the mount installer's strict responsibility to determine safety and functionality, of the compressor mount, at the time of installation.

Please contact TransArctic with any issue arising from installation so we may better improve the product. If you have any reservations about the compressor mount integrity contact TransArctic immediately at 1-877-COLD-AIR.

Mark OEM tensioner location

Install Kit

Check for Interferences

Check to ensure that the proper OEM tensioner orientation is maintained

Run engine with A/C system engaged for at least 10 minutes to run in belt

Check OEM tensioner orientation and adjust as required

Responsabilidad limitada de TransArctic en la instalación del soporte del compresor

Todos los soportes de los compresores deben ser instalados por personas calificadas y entrenadas, usando para ello los equipos y herramientas necesarios para esta labor en buenas condiciones y según las normas y guías para el servicio y/o reparación de motores de vehículos.

El instalador de los soportes comprados en TransArctic asume toda la responsabilidad de cualquier problema que surga en el soporte del compresor al vehículo; de igual manera es responsable que el cable a tierra sea conectado entre el embrague del compresor y el motor del vehículo.

Se advierte que el buen funcionamiento y la durabilidad del soporte pueden ser comprometidos por defectos en su instalación.

Debido a las diversas situaciones que se puedan presentar fuera del control del fabricante, TransArctic no garantiza el diseño, la durabilidad o el correcto funcionamiento de cualquier equipo inapropiadamente instalado por terceros.

Esta sobreentendido que el Instalador del montaje del compresor es estrictamente responsable de la seguridad y funcionamiento del equipo en el momento de la instalación.

Si tuviera algún problema o duda acerca de la instalación del soporte del compresor pongase en contacto inmediatamente con TransArctic al teléfono 1-877-COLD-AIR de modo que podamos mejorar nuestro producto.

Note la ubicación del medidor de tensión OEM

Instale el equipo

Controlar si hay interferencias.

Asegure que el medidor de tensión mantenga la orientación justa.

Encienda el motor por lo menos 10 minutos con el sistema A/C enganchado para que la correa corra

Controle la orientación justa del medidor de tensión y ajuste a las condiciones requeridas del fabricante