

Bill of Materials Listing

TransArctic Canada Inc.

5/29/2017
Page 1 of 1

Product Number	Description	Date	Weight	Uof M	Yield
Line Component Prod#	Description	Bin Unit	Qty		
KMC96562	Mt Kit,ISC,A3/D3RE,TM55/65,AFI,'07-'16		2/9/2017	48.83	0
20 BEL81537	Belt, 8gr, 1537mm (60.5") (5080605)		each	1	
30 BMC83092	Bkt, Adapter, PI, ISC, TM-55, D3RE, '12		each	1	
40 BMC83045	Bkt, Main, Weldmt, ISC, 8.3L, 09'		each	1	
50 BMC83046	Bkt, Brace, P/S, 8.3L, 09'		each	1	
60 BMC83011	Bkt, Brace, RR, Tenr, ISC, 8.3L, P8		each	1	
70 PUL83008	Pulley, Fan, Add-on, Cum, ISC, 8.3, 8gr		each	1	
80 PUL80076	Pulley, Idler, Backside, P8, 76d (89101)		each	1	
90 SCD25412	Spacer, Col, Drl,25.4mm x 25.4o x 12.3i		each	1	
120 TEN80002	Tenr, HD Spring, BackSide, CCW (89200A)		each	1	
130 KBC96562	Bag Kit, Fasteners, KMC96562		each	1	

Bill of Materials Listing

TransArctic Canada Inc.

5/29/2017
Page 1 of 1

Product Number	Description	Date	Weight	Uof M	Yield
Line Component Prod#	Description	Bin Unit	Qty		
KBC96562	Bag Kit, Fasteners, KMC96562	2/9/2017	1.37		0
10 BTC08030	Bolt, Hex, 8 x 1.25 x 30mm, 10.9, Plt,FT	each	6		
20 BTC10025	Bolt, Hex, 10 x 1.5 x 25mm, 10.9, Plt	each	4		
30 BTC10030	Bolt, Hex, 10 x 1.5 x 30mm, 10.9, Plt	each	2		
40 BTC10040	Bolt, Hex, 10 x 1.5 x 40mm, 10.9, Plt,FT	each	3		
50 BTC10050	Bolt, Hex, 10 x 1.5 x 50mm, 10.9, Plt	each	1		
60 BTC10090	Bolt, Hex, 10 x 1.5 x 90mm, 10.9, Plt	each	1		
80 BTS10001	Bolt, Shoulder, 10mm (89064)	each	1		
90 CSF10041	Capscrew, FH, 10 x 1.5 x 40mm, 10.9,Plt	each	1		
100 CSF12036	Capscrew, FH, 12 x 1.75 x 35mm, 10.9,Plt	each	4		
110 CSS10055	Capscrew, SH, 10 x 1.5 x 55mm, 12.9,Plt	each	1		
120 NTA10000	Nut, Hex, 10 x 1.5, 8.8, Plt	each	2		
130 WFA08000	Washer, Flat, 8mm, 8.8, Plt	each	6		
140 WFA10000	Washer, Flat, 10mm, 8.8, Plt	each	3		
150 WLA08000	Washer, Lock, 8mm, 8.8, Plt	each	6		
160 WLA10000	Washer, Lock, 10mm, 8.8, Plt	each	7		

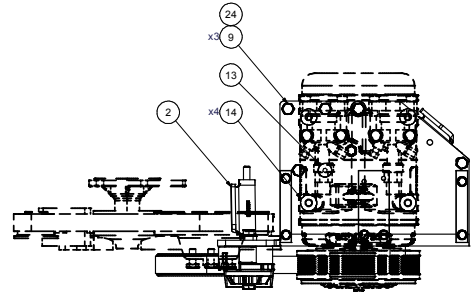

NOTE:
SHOWING TRANSARCTIC
COMPRESSOR PART#
CMV33680 (TM-55) 12V
CMV38880(TM-65) 12V
AS REFERENCE.
CMV33681 (TM-55) 24V
CMV38881 (TM-65) 24V

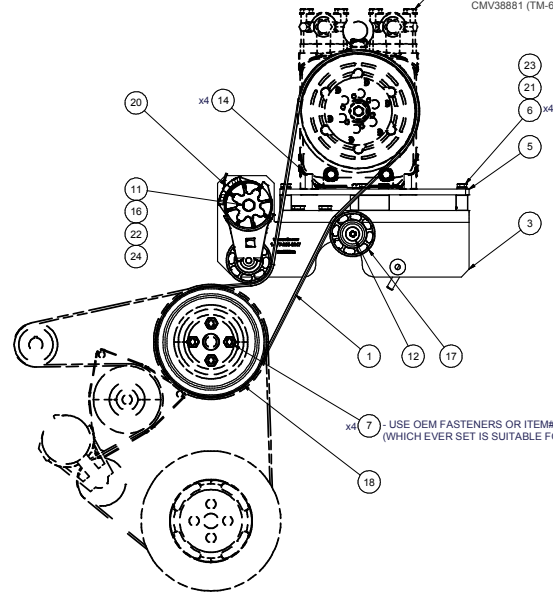

x4 7 - USE OEM FASTENERS OR ITEM# 7.
(WHICH EVER SET IS SUITABLE FOR THE INSTALL.)

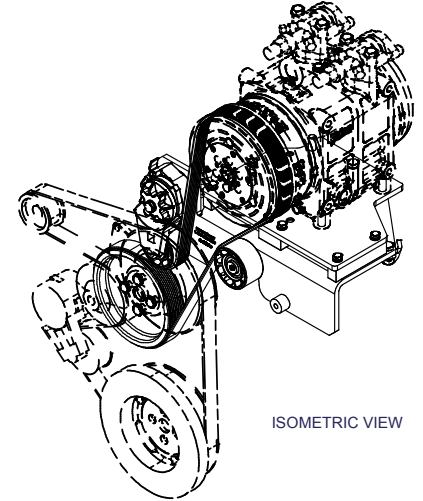
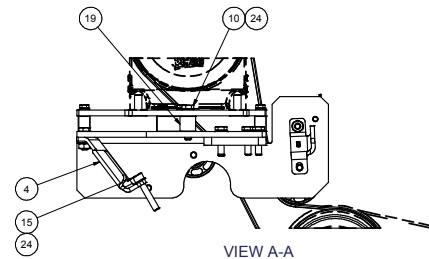
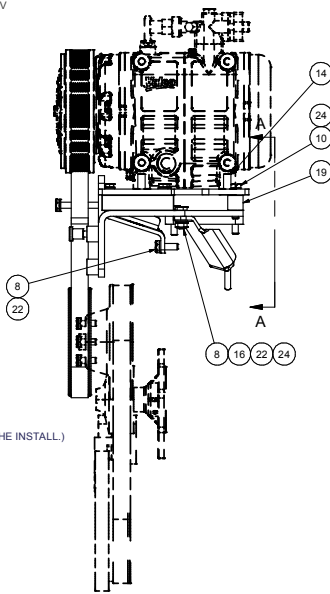

ISOMETRIC VIEW

NOTES:
1) USE SERVICABLE THREADLOCKER ON ALL FASTENERS TO ENGINE COMPONENTS AND TORQUE ALL BOLTS TO S.A.E. SPECIFICATIONS.
2) SEE "TRANSARCTIC A/C COMPRESSOR MOUNT INSTALLATION DISCLAIMER".

ITEM	QTY	U/M	PART NUMBER	DESCRIPTION
24	7	EACH	WLA10000	WASHER, LOCK, 10mm, 8.8, PLT
23	6	EACH	WLA08000	WASHER, LOCK, 8mm, 8.8, PLT
22	3	EACH	WFA10000	WASHER, FLAT, 10mm, 8.8, PLT
21	6	EACH	WFA08000	WASHER, FLAT, 8mm, 8.8, PLT
20	1	EACH	TEN80002	TENR, HD SPRING, BACKSIDE, CCW
19	1	EACH	SCD25412	SPACER, COL, DRL, 25.4mm x 25.4o x 12.3l
18	1	EACH	PUL83008	PULLEY, FAN, ADD-ON, CUM, ISC, 8.3, 8gr
17	1	EACH	PUL80076	PULLEY, IDLER, BACKSIDE, P8, 76D, 39W
16	2	EACH	NTA10000	NUT, HEX, 10 x 1.5, 8.8, PLT
15	1	EACH	CSS10055	CAPSCREW, SH, 12 x 1.25 x 55mm, 12.9, PLT
14	4	EACH	CSF12036	CAPSCREW, FH, 12 x 1.75 x 35mm, 10.9, PLT
13	1	EACH	CSF10041	CAPSCREW, FH, 10 x 1.5 x 40mm, 10.9, PLT
12	1	EACH	BTS10001	BOLT, SHOULDER, 10mm (IDLER PULLEY)
11	1	EACH	BTC10090	BOLT, HEX, 10 x 1.5 x 90mm, 10.9, PLT
10	1	EACH	BTC10050	BOLT, HEX, 10 x 1.5 x 50mm, 10.9, PLT
9	3	EACH	BTC10040	BOLT, HEX, 10 x 1.5 x 40mm, 10.9, PLT
8	2	EACH	BTC10030	BOLT, HEX, 10 x 1.5 x 30mm, 10.9, PLT
7	4	EACH	BTC10025	BOLT, HEX, 10 x 1.5 x 25mm, 10.9, PLT
6	6	EACH	BTC08030	BOLT, HEX, 8 x 1.25 x 30mm, 10.9, PLT
5	1	EACH	BMC83092	BKT, ADAPT, PL, ISC, TMS4/3, TID/A3RE, '12
4	1	EACH	BMC83046	BKT, BRACE P/S, 8.3L, '09"
3	1	EACH	BMC83045	BKT, MAIN, WELDMT, ISC, 8.3L, '09"
2	1	EACH	BMC83011	BKT, BRACE, RR, TENR, ISC, 8.3L, P8
1	1	EACH	BEL1537	BELT, 8 GR, 1537mm (60.5") (5080605)

REV	ECN	DESCRIPTION	DATE	BY
0		RELEASED TO PRODUCTION	03/22/17	VAL
				OR
				James Stewart
				03/22/17
				WFG
				DATE
				3/22/2017
				APPROVED
				James Stewart
				3/22/2017

UNSPECIFIED TOLERANCES:
ONE DECIMAL PLACE (X1) MM .005
TWO DECIMAL PLACE (X10) INCH .0005
THREE DECIMAL PLACE (X30) MM .002
FRACTIONS, IN 1/16" INCH .001

Parts List

TRANSARCTIC INC.

TITLE: Mt Kit, ISC/LA3/D3/T3RE, TM-55/65, '05-'16

DWG NO: KMC96562

SCALE: 1:4

SHEET 1 OF 1

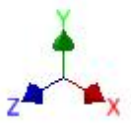

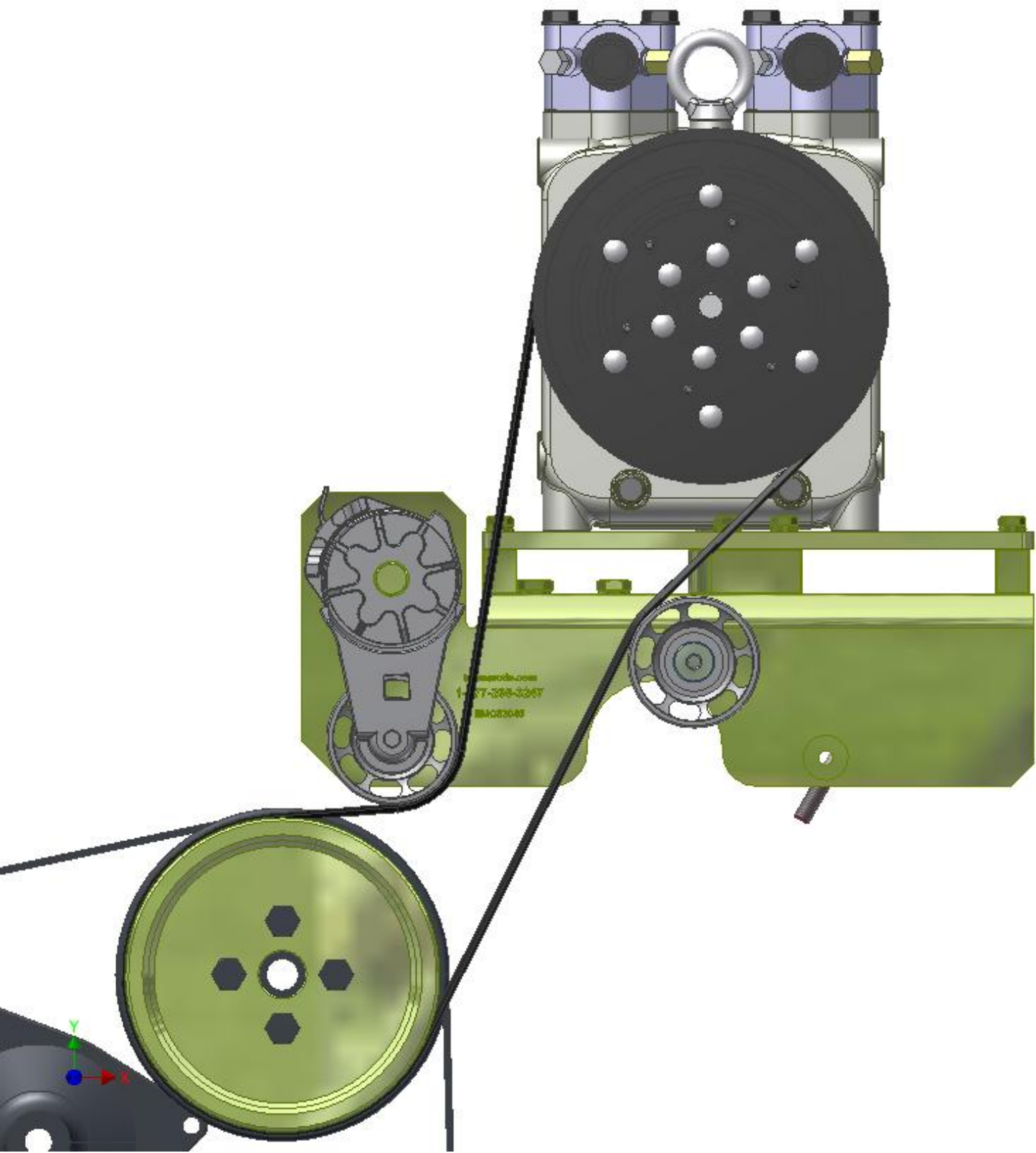

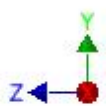
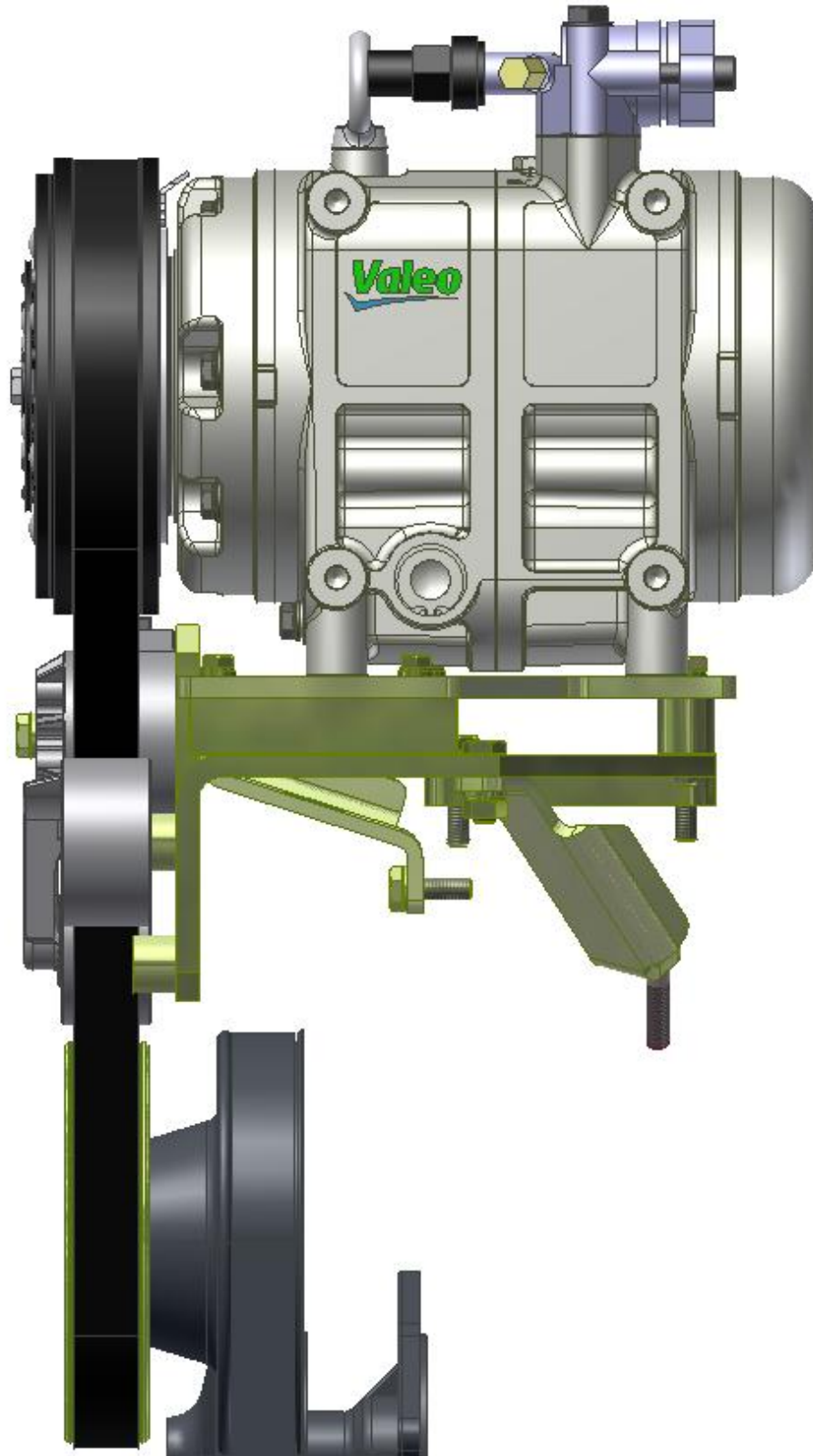

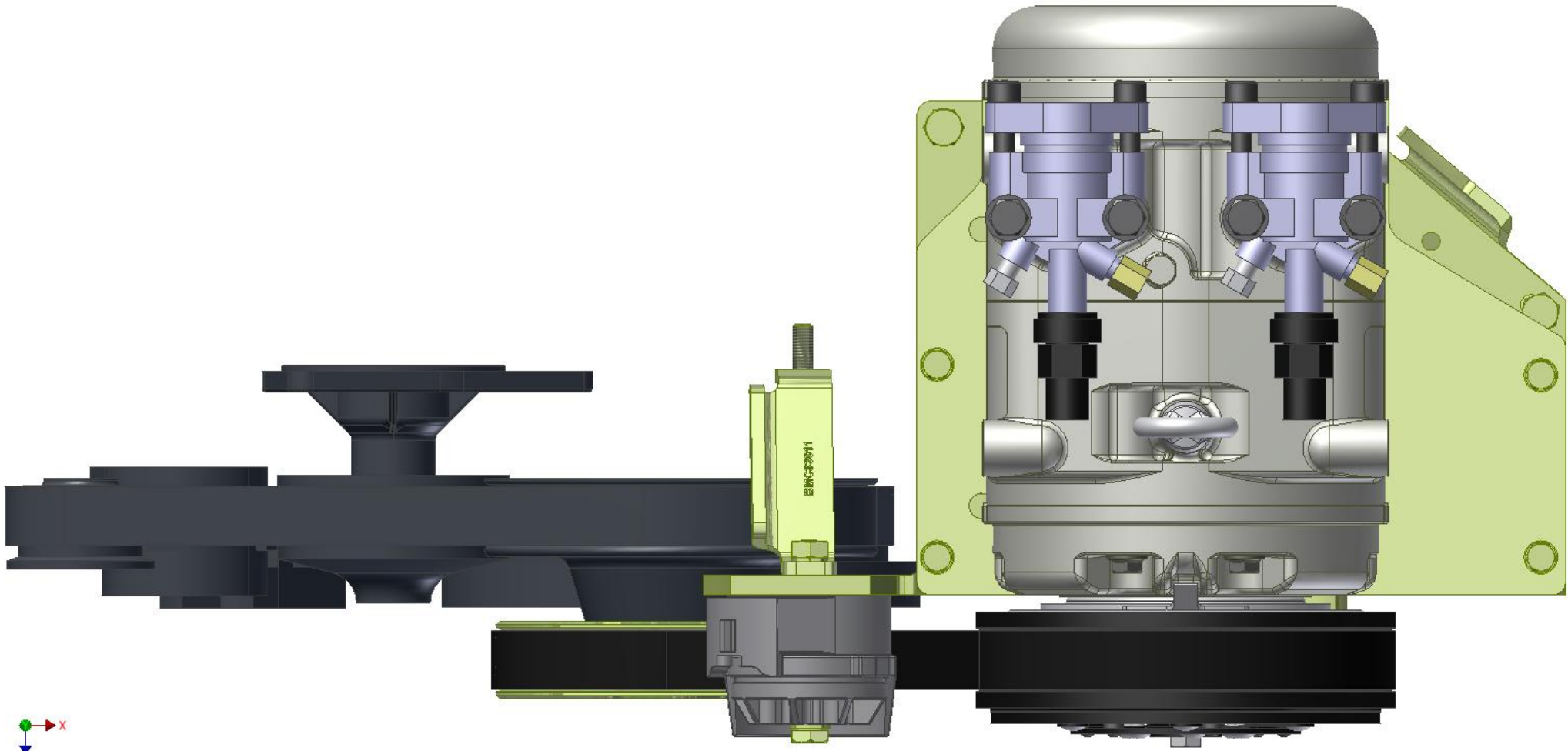

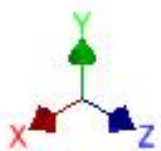
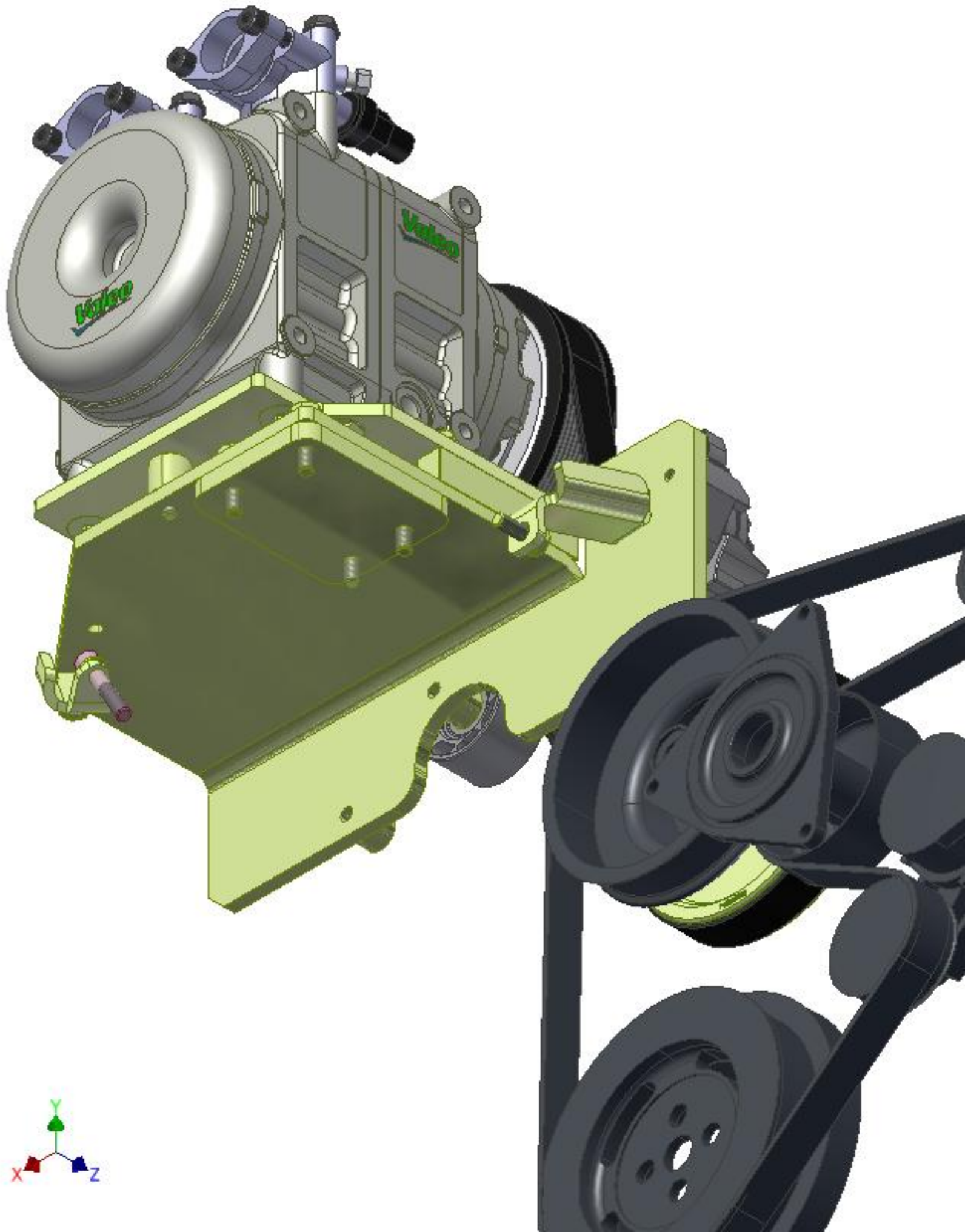

TransArctic A/C Compressor Mount Installation Disclaimer

All compressor mounts should be installed by qualified and trained personnel using proper tools and equipment in safe working conditions following industry standard guidelines for motor vehicle service and repair.

The installer of any compressor mount purchased from TransArctic must undertake all responsibility of issues arising from that compressor bracket being installed on any vehicle. As well as insure that a **proper and sufficient ground** is established between the compressors' clutches and the vehicle's engine. Mount functionality, operation and durability can all be compromised by an incompetent installation.

Due to the many different situations, parameters and application criteria, which are beyond the compressor mount manufacturer's control, TransArctic does not warrant design, durability, or operational functionality of any compressor mount improperly installed by another party.

With no implied guarantees it is the mount installer's strict responsibility to determine safety and functionality, of the compressor mount, at the time of installation.

Please contact TransArctic with any issue arising from installation so we may better improve the product. If you have any reservations about the compressor mount integrity contact TransArctic immediately at 1-877-COLD-AIR.

Mark OEM tensioner location

Install Kit

Check for Interferences

Check to ensure that the proper OEM tensioner orientation is maintained

Run engine with A/C system engaged for at least 10 minutes to run in belt

Check OEM tensioner orientation and adjust as required

Responsabilidad limitada de TransArctic en la instalación del soporte del compresor

Todos los soportes de los compresores deben ser instalados por personas calificadas y entrenadas, usando para ello los equipos y herramientas necesarios para esta labor en buenas condiciones y según las normas y guías para el servicio y/o reparación de motores de vehículos.

El instalador de los soportes comprados en TransArctic asume toda la responsabilidad de cualquier problema que surga en el soporte del compresor al vehículo; de igual manera es responsable que el cable a tierra sea conectado entre el embrague del compresor y el motor del vehículo.

Se advierte que el buen funcionamiento y la durabilidad del soporte pueden ser comprometidos por defectos en su instalación.

Debido a las diversas situaciones que se puedan presentar fuera del control del fabricante, TransArctic no garantiza el diseño, la durabilidad o el correcto funcionamiento de cualquier equipo inapropiadamente instalado por terceros.

Esta sobreentendido que el Instalador del montaje del compresor es estrictamente responsable de la seguridad y funcionamiento del equipo en el momento de la instalación.

Si tuviera algún problema o duda acerca de la instalación del soporte del compresor pongase en contacto inmediatamente con TransArctic al teléfono 1-877-COLD-AIR de modo que podamos mejorar nuestro producto.

Note la ubicación del medidor de tensión OEM

Instale el equipo

Controlar si hay interferencias.

Asegure que el medidor de tensión mantenga la orientación justa.

Encienda el motor por lo menos 10 minutos con el sistema A/C enganchado para que la correa corra

Controle la orientación justa del medidor de tensión y ajuste a las condiciones requeridas del fabricante