

# Bill of Materials Listing

TransArctic Canada Inc.

7/5/2017  
Page 1 of 1

Product Number	Description	Date	Weight	Uof M	Yield
Line    Component    Prod#	Description	Bin                    Unit	Qty		
<b>KMC63994</b>	<b>Mt Kit, ISB-D, HDX, 4xFC, '13-'16</b>		<b>148.97</b>		<b>0</b>
10	BEL32389				
	Belt, Banded B gr, 2388mm (94")			each	1
20	BMC83123				
	Bkt, Main, Idler, Weldm't, ISL, HDX, '13			each	1
30	BMC83125				
	Bkt, Weldm't, Adapter Pl, ISL, HDX, '13			each	1
40	BMC83129				
	Bkt, Weldm't, Main Base, ISL, HDX, '13			each	1
50	KCB83994				
	Kit, Compressor, PS, 4xFC, '13			each	1
60	KPC64094				
	Kit, Pulley, 2B, ISB, 2013			each	1
70	PUA05012				
	Pulley, Assy, Idler,B/BX gr,5", STL,Plt			each	1
80	PUL80074				
	Pulley, Idler, B/S, Wide, 76d (89102)			each	1
90	SCD46012				
	Spacer, Col, Drl, 46mm x 31.8o x 12.0i			each	1
100	SCD49512				
	Spacer, Col, Drl, 49.48mmx 25.4o x 12.3i			each	1
110	SLV17012				
	Sleeve, Pulley, 16.9o x 22.23mm x 12.32i			each	2
120	KBC64094				
	Bag Kit, Fasteners, KMC64094/3994			each	1

# Bill of Materials Listing

TransArctic Canada Inc.

5/3/2017  
Page 1 of 1

Product Number		Description	Bin	Date	Weight	Uof M	Yield
Line	Component Prod#	Description		Unit	Qty		
<b>KBC64094</b>		<b>Bag Kit, Fasteners, KMC64094/3994</b>		<b>9/11/2013</b>	<b>2.47</b>		<b>0</b>
10	BTC10045	Bolt, Hex, 10 x 1.5 x 45mm, 10.9, Plt,FT		each	3		
30	BTC12110	Bolt, Hex, 12 x 1.75 x 110mm, 10.9, Plt		each	2		
40	BTQ06175	Bolt, Hex, 3/8-16unc, 1.75", 8, Plt		each	5		
50	BTQ08125	Bolt, Hex, 1/2-13unc, 1.25", 8, Plt		each	2		
60	BTQ08151	Bolt, Hex, 1/2-20unf, 1.5", 8, Plt		each	2		
70	CSF08101	Capscrew, FH, 1/2-20unf x 1.0",Alloy,Plt		each	4		
80	NTA10000	Nut, Hex, 10 x 1.5, 8.8, Plt		each	3		
90	NTA12000	Nut, Hex, 12 x 1.75, 8.8, Plt		each	2		
100	NTQ06000	Nut, Hex, 3/8-16unc, 8, Plt		each	5		
110	WFA10002	Washer, Flat, 10mm, Hvy, 8.8, Plt		each	6		
120	WFA12002	Washer, Flat, 12mm, Hvy, 8.8, Plt		each	2		
130	WFS08000	Washer, Flat, 1/2", 8, Plt		each	4		
140	WFS06002	Washer, Flat, 3/8", L9, Plt		each	10		
150	WLA10000	Washer, Lock, 10mm, 8.8, Plt		each	3		
160	WLA12000	Washer, Lock, 12mm, 8.8, Plt		each	2		
170	WLQ06000	Washer, Lock, 3/8", 8, Plt		each	5		
180	WLQ08000	Washer, Lock, 1/2", 8, Plt		each	4		

# Bill of Materials Listing

TransArctic Canada Inc.

7/5/2017  
Page 1 of 1

Product Number	Description	Date	Weight	Uof M	Yield
Line    Component    Prod#	Description	Bin                    Unit	Qty		
<b>KCB83994</b>	<b>Kit, Compressor, PS, 4xFC, '13</b>		<b>11/14/2013</b>	<b>54.71</b>	<b>0</b>
10 BMN80008	Vibration Isolator, Bar,16.50 x 2 x 1.50	each	2		
20 BMN80025	Bkt, Back, PL, Slide, IC, RE300	each	1		
30 BMZ00043	Bkt, Main, Base Pl, '13	each	1		
40 KBT83990	Kit, Platform, 4xFCY, '12	each	1		
50 KBZ83994	Bag Kit, Fasteners, KCB83994	each	1		

# Bill of Materials Listing

TransArctic Canada Inc.

3/8/2017  
Page 1 of 1

Product Number	Description	Date	Weight	Uof M	Yield
Line    Component    Prod#	Description	Bin                    Unit	Qty		
<b>KBZ83994</b>	<b>Bag Kit, Fasteners, KCB83994</b>		<b>11/14/2013</b>	<b>1.06</b>	<b>0</b>
10	BTP08653		Bolt, Hex, 1/2-13unc, 6.5", 5, Plt, FT	each	1
20	BTQ08101		Bolt, Hex, 1/2-20unf, 1.00", 8, Plt	each	4
30	CSF08076		Capscrew, FH, 1/2-20unf x .75", Alloy, Plt	each	2
40	WFQ08000		Washer, Flat, 1/2", 8, Plt	each	4
50	WLQ08000		Washer, Lock, 1/2", 8, Plt	each	5

# Bill of Materials Listing

TransArctic Canada Inc.

3/8/2017  
Page 1 of 1

Product Number	Description	Date	Weight	Uof M	Yield
Line    Component    Prod#	Description	Bin            Unit	Qty		
<b>KBT83990</b>	<b>Kit, Platform, 4xFCY, '12</b>	<b>2/17/2009</b>	<b>15.25</b>		<b>0</b>
10	BMN80031			Bkt, Main, Slide, Assy, 05K, IC, RE300	each    1
20	BMZ00036			Bkt, Adaptor, Weld't, 4xFCY	each    1
30	KBZ00010			Bag Kit, Fasteners, KBT84094/83990	each    1

# Bill of Materials Listing

TransArctic Canada Inc.

3/8/2017  
Page 1 of 1

Product Number	Description	Date	Weight	Uof M	Yield
Line    Component    Prod#	Description	Bin            Unit	Qty		
<b>KBZ00010</b>	<b>Bag Kit, Fasteners, KBT84094/83990</b>	<b>11/6/2013</b>	<b>1.23</b>		<b>0</b>
10	BTC12040				
	Bolt, Hex, 12 x 1.75 x 40mm, 10.9,Plt,FT	each	4		
15	BTC12060				
	Bolt, Hex, 12 x 1.75 x 60mm, 10.9,Plt,FT	each	4		
20	NTP07000				
	Nut, Hex, 7/16-14unc, 5, Plt	each	4		
30	WFA12000				
	Washer, Flat, 12mm, 8.8, Plt	each	8		
40	WFN07000				
	Washer, Flat, 7/16", 2, Plt	each	4		
50	WLA12000				
	Washer, Lock, 12mm, 8.8, Plt	each	4		
60	WLP07000				
	Washer, Lock, 7/16", 5, Plt	each	4		

# Bill of Materials Listing

TransArctic Canada Inc.

3/9/2017  
Page 1 of 1

Product Number		Description	Bin	Date	Weight	Uof M	Yield
Line	Component Prod#	Description		Unit	Qty		
<b>KPC64094</b>		<b>Kit, Pulley, 2B, ISB, 2013</b>		<b>5/13/2008</b>	<b>14.32</b>		<b>0</b>
10	PUL67222	Pulley, Crank, ADD-ON, ISB,6.7L,2B/X,'07		each	1		
20	CSS12090	Capscrew, SH, 12 x 1.25 x 90mm, 12.9,BLK		each	6		
30	WFS12002	Washer, Flat, Hdn, 12mm, Stl, BLK		each	6		

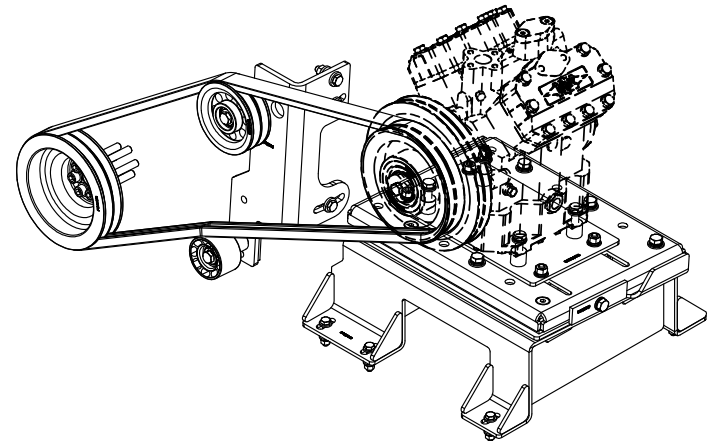
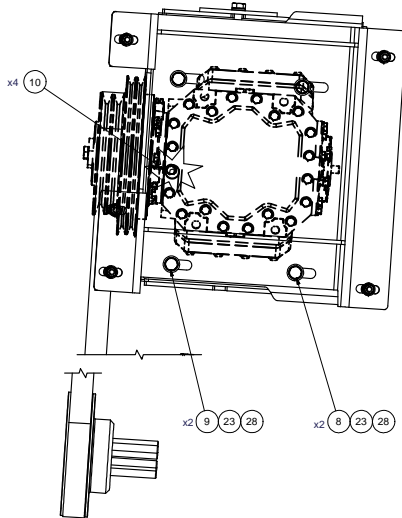
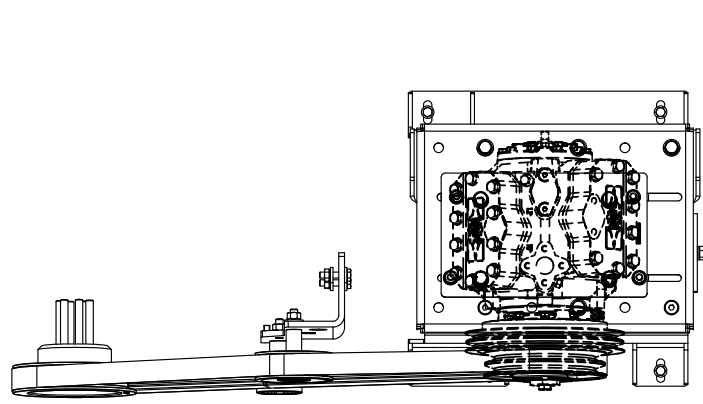

ISOMETRIC VIEW

NOTE:  
SHOWING COMPRESSOR  
4xFCY  
AS REFERENCE.

VIEW A-A

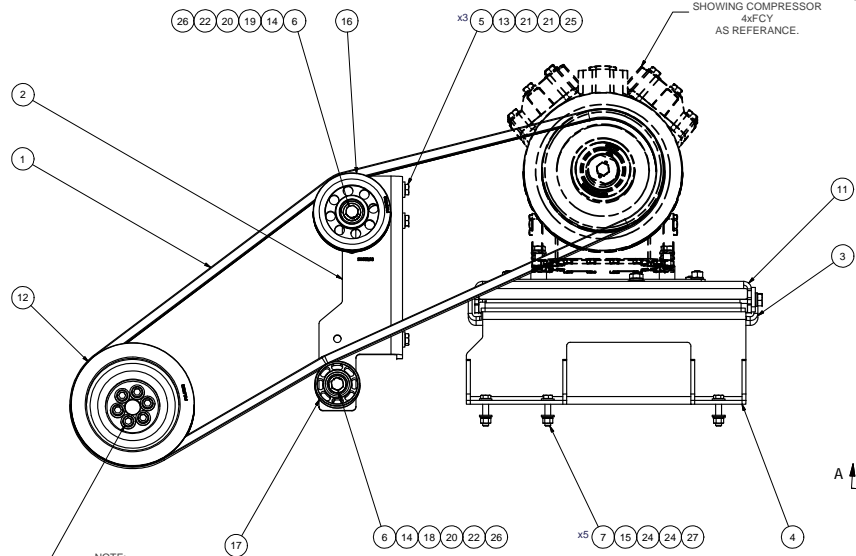

NOTE:  
TORQUE TO: 37 FT-LB PLAIN & LUBRICATED W/ CLEAN ENGINE OIL (15W-40)  
(SH. CAPSCREW M12 x 1.25 x 90mm)  
TIGHTEN IN TWO STEPS IN A CRIS-CROSS TIGHTENING SEQUENCE PATTERN.

NOTES:  
1) USE SERVICABLE THREADLOCKER ON ALL FASTENERS TO ENGINE COMPONENTS AND TORQUE ALL BOLTS TO S.A.E. SPECIFICATIONS.  
2) SEE "TRANSARGTIC A/C COMPRESSOR MOUNT INSTALLATION DISCLAIMER".

ITEM	QTY	U/M	PART NUMBER	DESCRIPTION
28	4	EACH	WL008000	WASHER, LOCK, 1/2", 8, PLT
27	5	EACH	WL006000	WASHER, LOCK, 3/8", 8, PLT
26	2	EACH	WL120000	WASHER, LOCK, 12mm, 8.8, PLT
25	3	EACH	WL100000	WASHER, LOCK, 10mm, 8.8, PLT
24	10	EACH	WFS060002	WASHER, FLAT, 3/8", L9, PLT
23	4	EACH	WFO08000	WASHER, FLAT, 1/2", 8, PLT
22	2	EACH	WFA12002	WASHER, FLAT, 12mm, HVY, 8.8, PLT
21	6	EACH	WFA10002	WASHER, FLAT, 10mm, HVY, 8.8, PLT
20	2	EACH	SLV17012	SLEEVE, PULLEY, 16.90 x 22.23 mm x12.19l
19	1	EACH	SCD49512	SPACER, COL, DRL, 49.48mm x 25.40 x 12.3
18	1	EACH	SCD46012	SPACER, COL, DRL, 46mm x 31.80 x 12.0l
17	1	EACH	PUL80074	PULLEY, IDLER, BACKSIDE, P8, 74D, 46.27W
16	1	EACH	PIU605012	PULLEY, ASSY, IDLER, B/BX gr, 5" STL, PLT
15	5	EACH	NT006000	NUT, HEX, 3/8-16UNC, 8, PLT
14	2	EACH	NTA12000	NUT, HEX, 12 x 1.75, 8.8, PLT
13	3	EACH	NTA10000	NUT, HEX, 10 x 1.5, 8.8, PLT
12	1	EACH	KPC64094	KIT, PULLEY, 28, ISB, 2013
11	1	EACH	KCB83994	KIT, COMPRESSOR, PS, 4xFC, '13
10	4	EACH	CSF08101	CAPSCREW, FH, 1/2-20UNF x 1", ALLOY, PLT
9	2	EACH	BTQ08151	BOLT, HEX, 1/2-20UNF x 1.50, 8, PLT
8	2	EACH	BTQ08125	BOLT, HEX, 1/2-13UNC x 1.25, 8, PLT
7	5	EACH	BTQ06175	BOLT, HEX, 3/8-16UNC, 1.75", 8, PLT
6	2	EACH	BTC12110	BOLT, HEX, 12 x 1.75 x 110mm, 10.9, PLT
5	3	EACH	BTC10045	BOLT, HEX, 10 x 1.5 x 45mm, 10.9, PLT
4	1	EACH	BMC83129	BKT, WELDMT, MAIN BASE, ISL, HDX, '13
3	1	EACH	BMC83125	BKT, WELDMT, ADAPTER PL, ISL, HDX, '13
2	1	EACH	BMC83123	BKT, MAIN, IDLER, WELDMT, ISL, HDX, '13
1	1	EACH	BEL32389	BELT, BANDED B gr, 2388mm (9'4")

BILL OF MATERIALS  
**TRANSARGTIC INC.**

DATE	DESCRIPTION	BY
9/11/2013	RELEASED TO PRODUCTION	JRK
9/11/2013	CHECKED	Val Jakovlew
9/11/2013	APPROVED	Ron Ingram
9/11/2013	APPROVED	Dale Mason

TITLE  
MT KIT, ISB, HDX, 4xFC, '13-'16  
SIZE D  
DWG NO KMC63994  
SCALE 1:4  
SHEET 1 OF 1

UNSPECIFIED TOLERANCES:  
DIM (INCH) DECIMAL PLACE (XX) .0001  
DIM (MILLIMETER) DECIMAL PLACE (XX) .002  
FRACTIONAL (1/16") .001  
THIRD ANGLE PROJECTION



**TOP VIEW**

PARTS REMOVED FOR CLARITY.

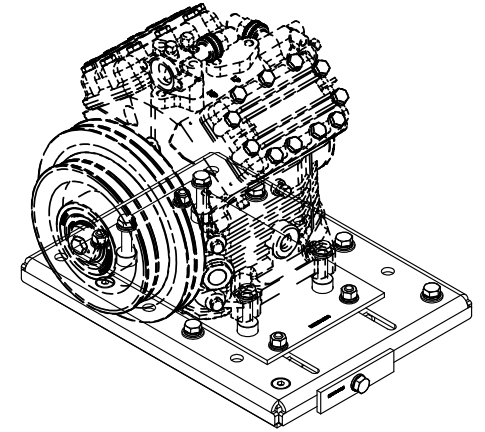
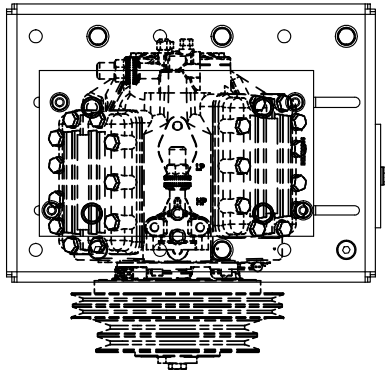
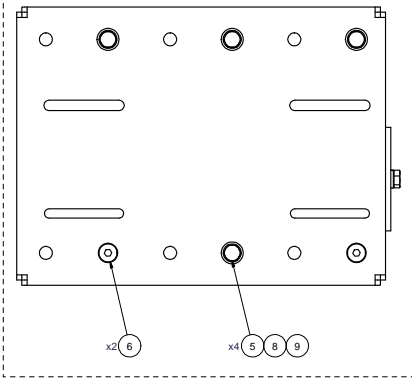

**ISOMETRIC VIEW**

NOTE:  
SHOWING COMPRESSOR  
4xFCY OR  
FK40 xxx  
AS REFERENCE.

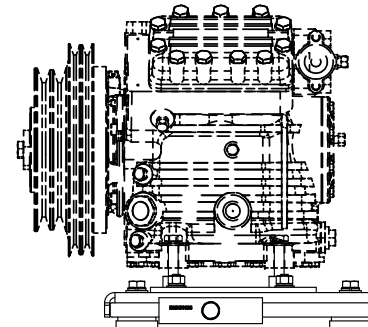
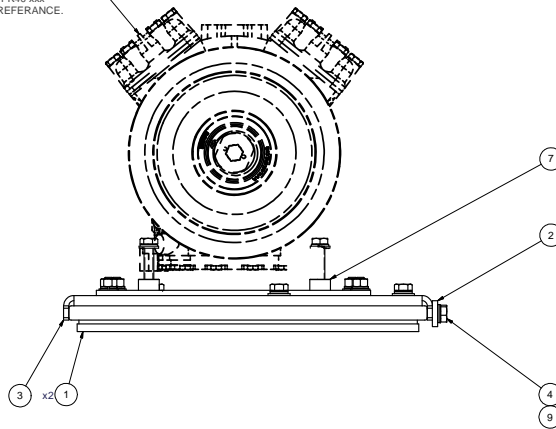

**NOTES:**

- 1) USE SERVICABLE THREADLOCKER ON ALL FASTENERS TO ENGINE COMPONENTS AND TORQUE **ALL** BOLTS TO S.A.E. SPECIFICATIONS.
- 2) SEE "TRANSARGTIC A/C COMPRESSOR MOUNT INSTALLATION DISCLAIMER".
- 3) WEIGHT: 50.93 LBS.

ITEM	QTY	U/M	PART NUMBER	DESCRIPTION
9	5	EACH	WLO08000	WASHER, LOCK, 1/2", 8, PLT
8	4	EACH	WFO08000	WASHER, FLAT, 1/2", 8, PLT
7	1	EACH	KBT83990	MT KIT, TRANSIT, 4xFCY, '12
6	2	EACH	CSF08076	CAPSCREW, FH, 1/2-20UNF x .75", ALLOY, PLT
5	4	EACH	BTQ08101	BOLT, HEX, 1/2-20UNF x 1.00, 8, PLT
4	1	EACH	BTP08653	BOLT, HEX, 1/2-13UNC x 6.50, 5, PLT, FT
3	1	EACH	BMZ00043	BKT, MAIN, BASE PL, '13
2	1	EACH	BMN80025	BKT, BACK, PL, SLIDE, IC, RE300
1	2	EACH	BMN80008	VIBRATION ISOLATOR, BAR, 1x.50 x 2 x 1.50

**BILL OF MATERIALS**

DRAWN	JRodriguez	03/03/15	<b>TRANSARGTIC INC.</b>	TITLE	
CHECKED	Jose Rodriguez	03/03/15			
REVISION	DESCRIPTION	DATE		BY	
1	RELEASED TO PRODUCTION	03/03/15	RR	GA	
2				James Stewart	03/03/15
3				MFG	03/03/15
4				James Stewart	03/03/15
5				APPROVED	
6				Date Mason	03/03/15

UNSPECIFIED TOLERANCES:	ALL DIMS	
ONE DECIMAL PLACE (.X)	30	FRS
TWO DECIMAL PLACES (.XX)	30	FRS
THREE DECIMAL PLACES (.XXX)	30	FRS
FRACTIONAL (1/16")	30	FRS
ANGULAR	± .25	



DRAWING UNIT OF MEASURE	MM (INCH)
SCALE	1:3
DWG NO	KCB83994
REV	0
SHEET	1 OF 1

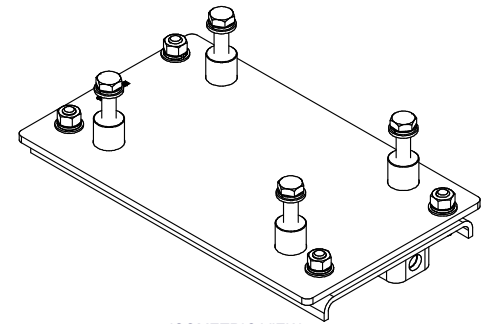
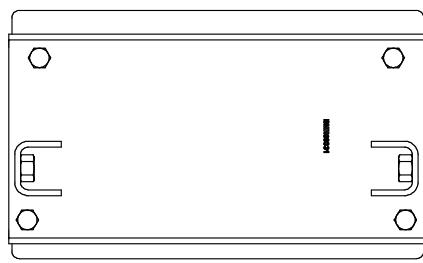
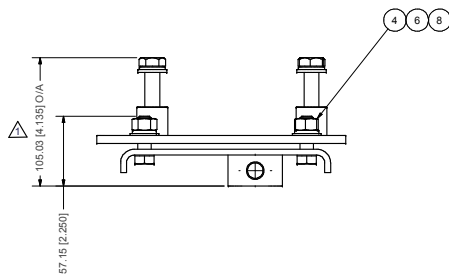
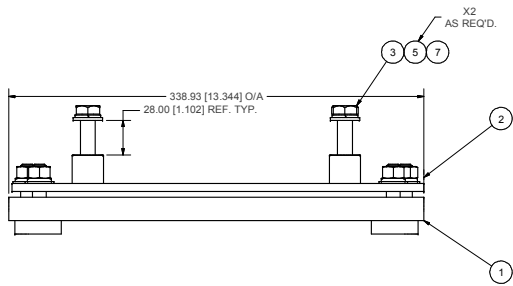
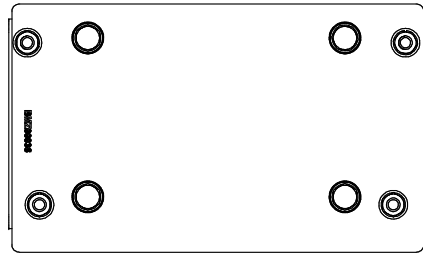

ISOMETRIC VIEW

**NOTES:**  
 1) USE SERVICABLE THREADLOCKER ON ALL FASTENERS TO ENGINE COMPONENTS AND TORQUE **ALL** BOLTS TO S.A.E. SPECIFICATIONS.  
 2) SEE "TRANSARTIC A/C COMPRESSOR MOUNT INSTALLATION DISCLAIMER".  
 3) WEIGHT: 15.17 LBS.

ITEM	QTY	U/M	PART NUMBER	DESCRIPTION
8	4	EACH	WLP07000	WASHER, LOCK, 7/16", 5, PLT
7	4	EACH	WLA12000	WASHER, LOCK, 12mm, 8.8, PLT
6	4	EACH	WFN07000	WASHER, FLAT, 7/16", 2, PLT
5	8	EACH	WFA12000	WASHER, FLAT, 12mm, 8.8, PLT
4	4	EACH	NTP07000	NUT, HEX, 7/16-14UNC, 5, PLT
3	4	EACH	BTC12060	BOLT, HEX, 12 x 1.75 x 60mm, 10.9, PLT
2	1	EACH	BM200036	BKT, ADAPTER, WELD'T, 4xFCY
1	1	EACH	BMN80031	BKT, MAIN, SLIDE, ASSY, 05K, IC, RE300

**TRANSARTIC INC.**

DRAWN: vjakowlew CHECKED: vjakowlew RELEASED TO PRODUCTION: 3/14/2012 DATE: 3/13/2012 BY: James Stewart APPROVED: Ron Ingram DATE: 3/13/2012 APPROVED: Dale Mason DATE: 3/13/2012	3/13/2012 3/13/2012 3/13/2012 3/13/2012 3/13/2012	<b>MT KIT, TRANSIT, 4xFCY, '12</b> DWG NO: KBT83990 SCALE: 1:2 SHEET 1 OF 1
---	---	--

UNSPECIFIED TOLERANCES: (ALL DIM) GROUP  
 ONE DECIMAL PLACE (10, 20, 30, 40, 50, 60, 70, 80, 90, 100) USE FRACTIONAL (1/32, 1/16, 1/8, 3/16, 1/4, 3/8, 1/2, 5/8, 3/4, 7/8, 1) USE ANGULAR ± .01



DRAWING UNIT OF MEASURE: MM (INCH)

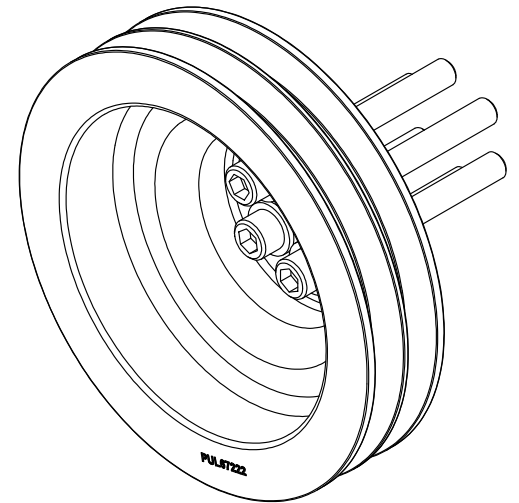
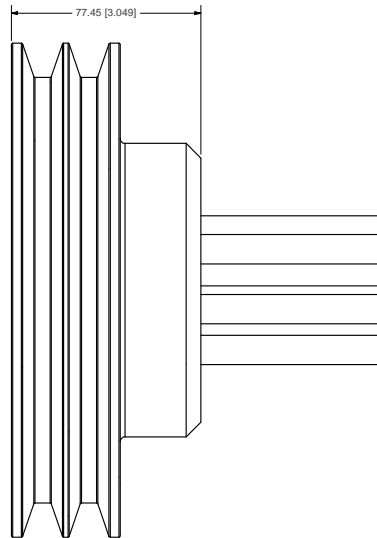
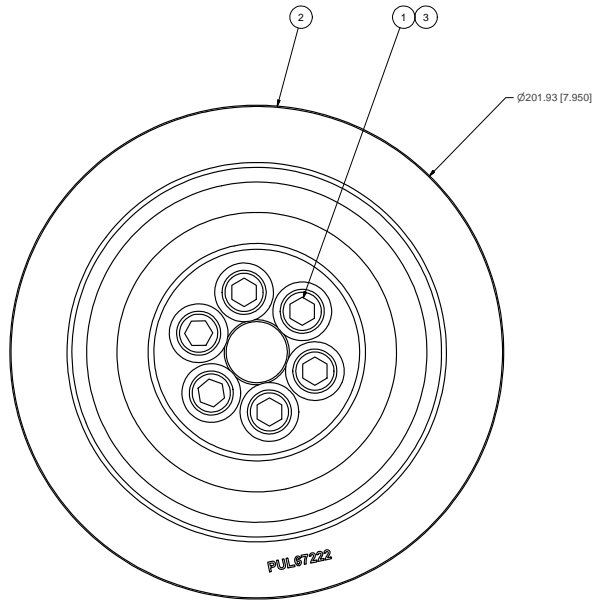
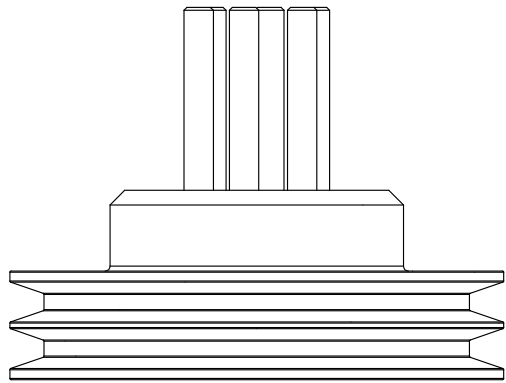

ISOMETRIC VIEW

NOTES:

- 1) USE SERVICABLE THREADLOCKER ON ALL FASTENERS TO ENGINE COMPONENTS AND TORQUE **ALL BOLTS** TO S.A.E. SPECIFICATIONS.
- 2) SEE "TRANSARCTIC A/C COMPRESSOR MOUNT INSTALLATION DISCLAIMER".
- 3) WEIGHT: 13.24 LB

ITEM	QTY	U/M	PART NUMBER	DESCRIPTION
3	6	EACH	WFS12002	WASHER, FLAT, HDN, 12mm, STL, BLK
2	1	EACH	PUL67222	PULLEY, CRANK, ADD-ON, ISB, 5.7L, 2B/IX '07
1	6	EACH	CSS12090	CAPSCREW, SH, 12 x 1.25 x 90mm, 12.9, FLT

**TRANSARCTIC INC.**

U	RELEASED TO PRODUCTION	11/6/2013	JRR
REV	DESCRIPTION	DATE	BY
1		11/6/2013	Val Jakowlew
2		10/21/2008	James Stewart
3		11/6/2013	Ron Ingram
4		11/6/2013	Dale Mason

THIS DRAWING CONTAINS PROPRIETARY CONFIDENTIAL INFORMATION OWNED BY TRANSARCTIC CANADA INC. THE DOCUMENT AND THE INFORMATION IN IT ARE NOT TO BE USED, DISCLOSED OR REPRODUCED WITHOUT EXPRESS WRITTEN PERMISSION OF THE COMPANY.

UNSPECIFIED TOLERANCES:			
ONE DECIMAL PLACE	(X)	0.1	(MM)
TWO DECIMAL PLACE	(X)	0.05	(MM)
THREE DECIMAL PLACE	(X)	0.025	(MM)
FRACTIONAL (1/16")	(X)	0.005	(INCH)



DRAWN		11/6/2013	<b>TRANSARCTIC INC.</b>	
CHECKED		11/6/2013		
TITLE		11/6/2013	KIT, PULLEY, 2B, ISB, 1013	
APPROVED		11/6/2013	DWG NO	
DATE		11/6/2013	KPC64094	
DRAWING UNIT OF MEASURE		MM (INCH)	REV	
SCALE		1:1	0	
SHEET		1	OF 1	

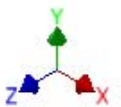
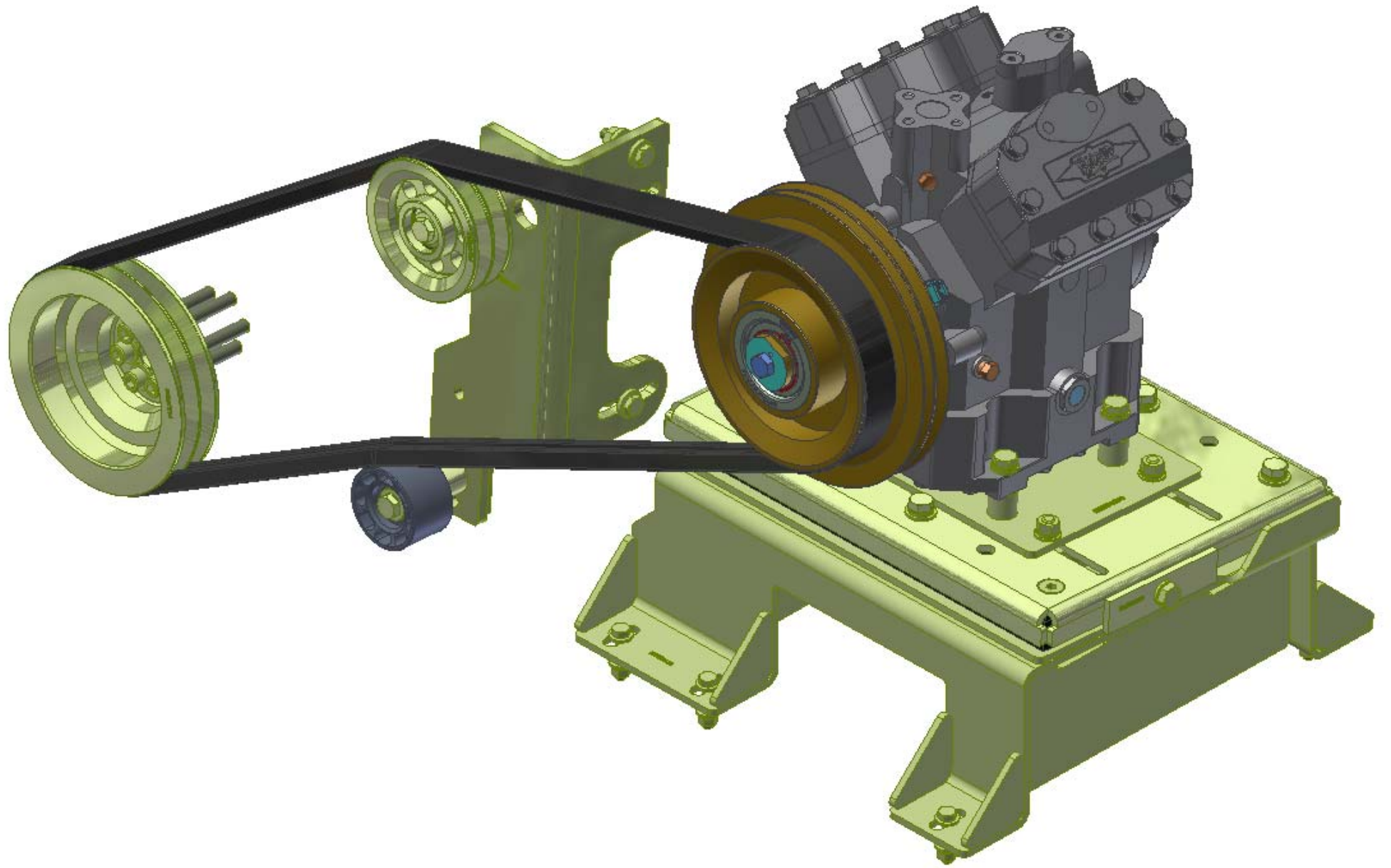

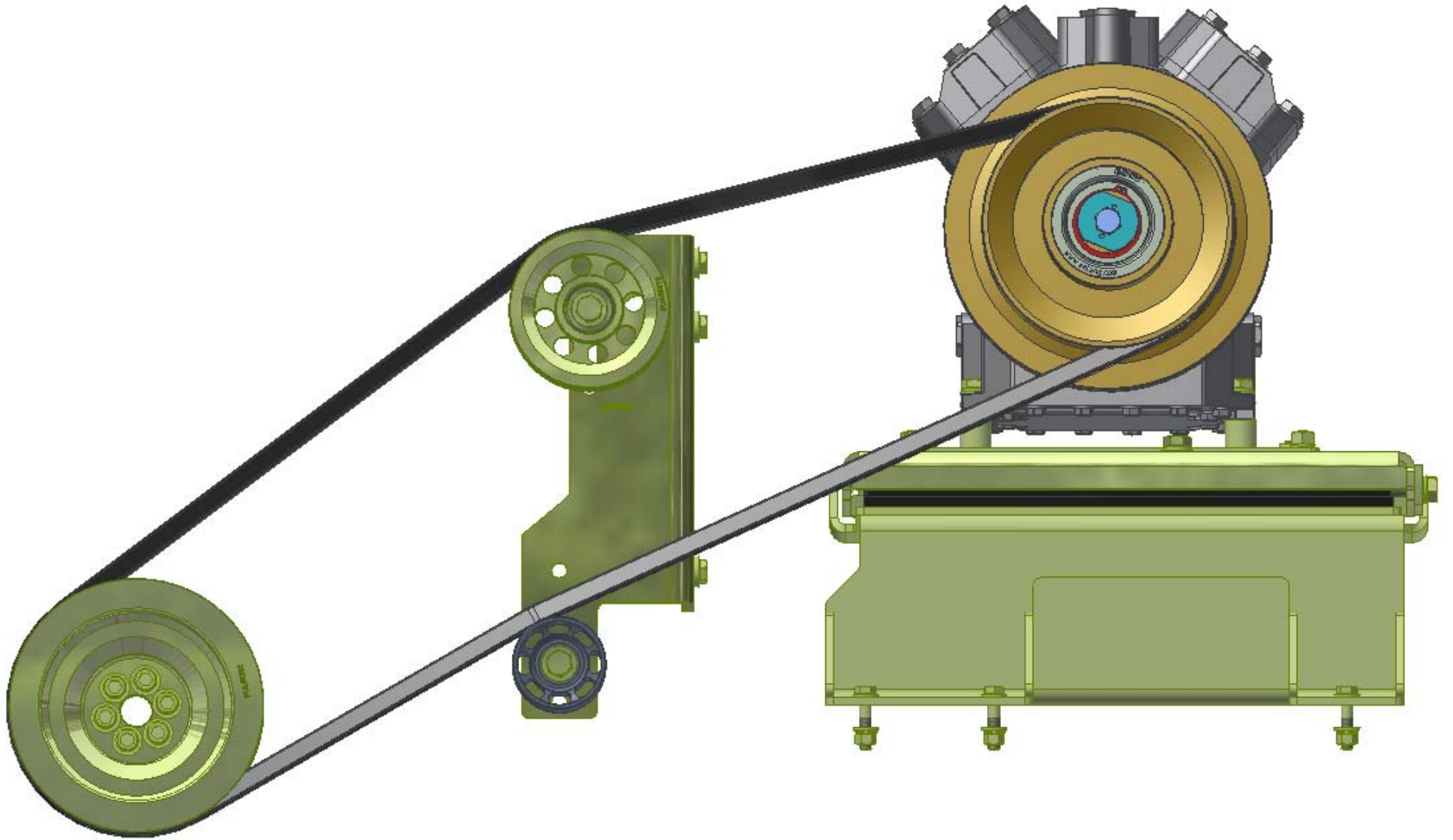

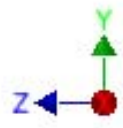
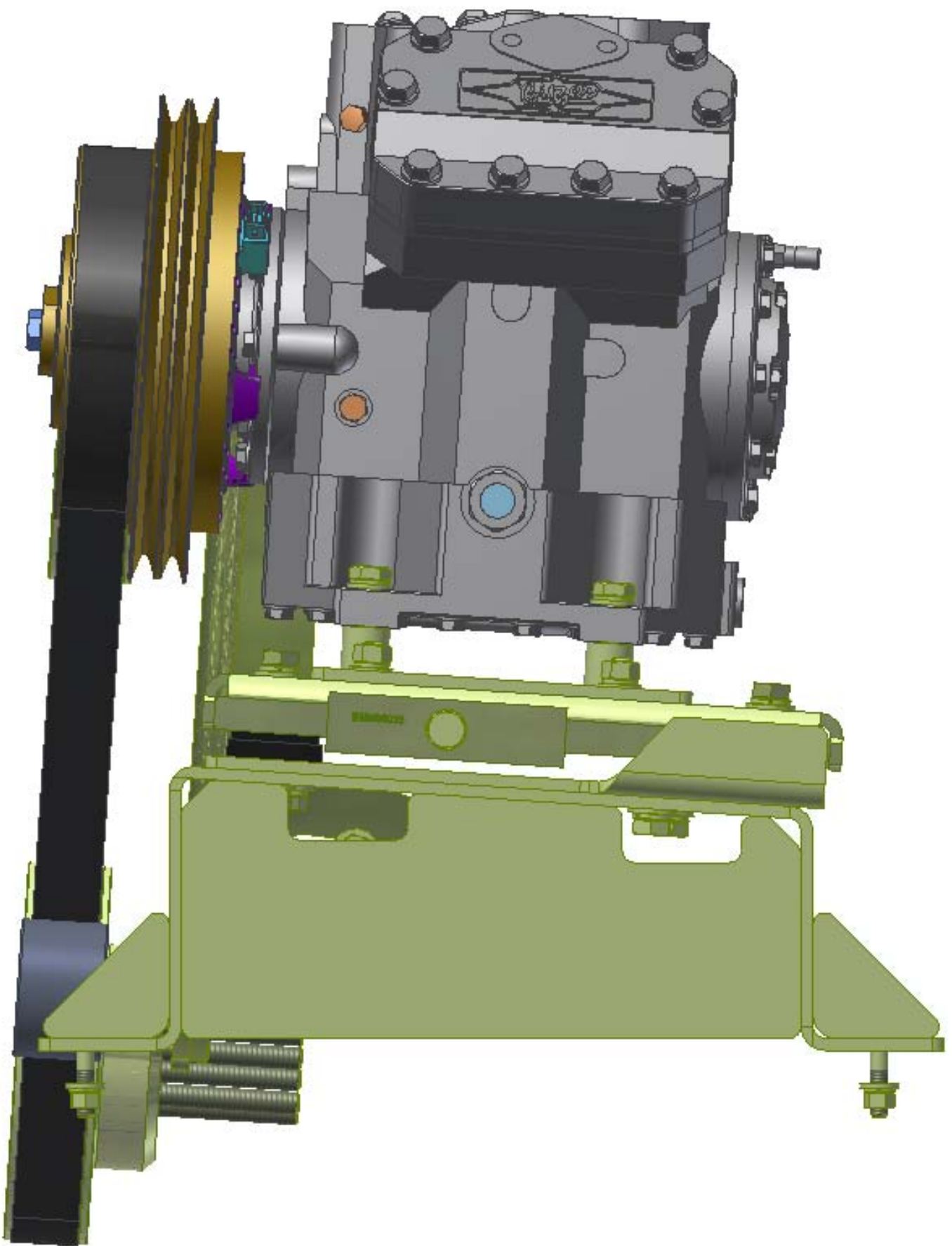

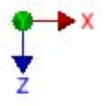
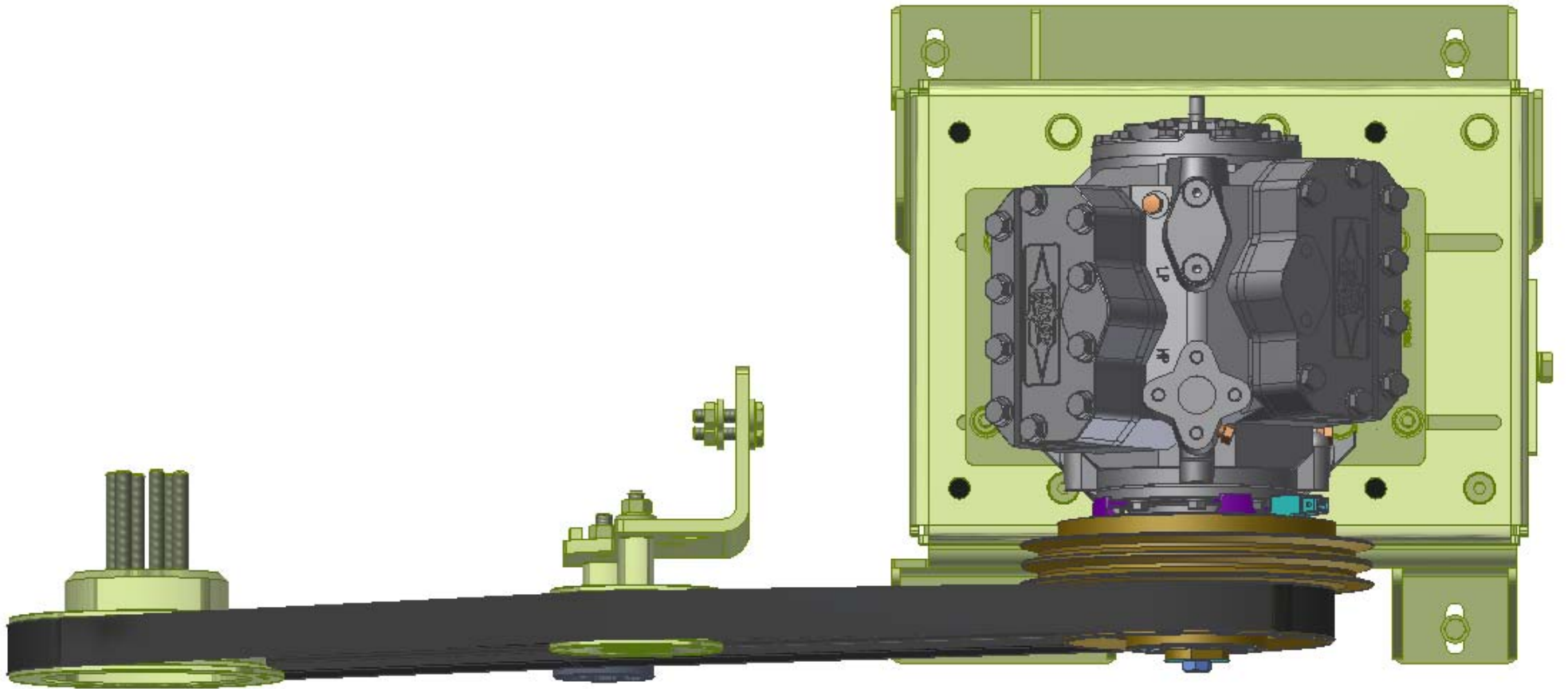

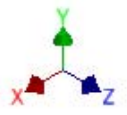
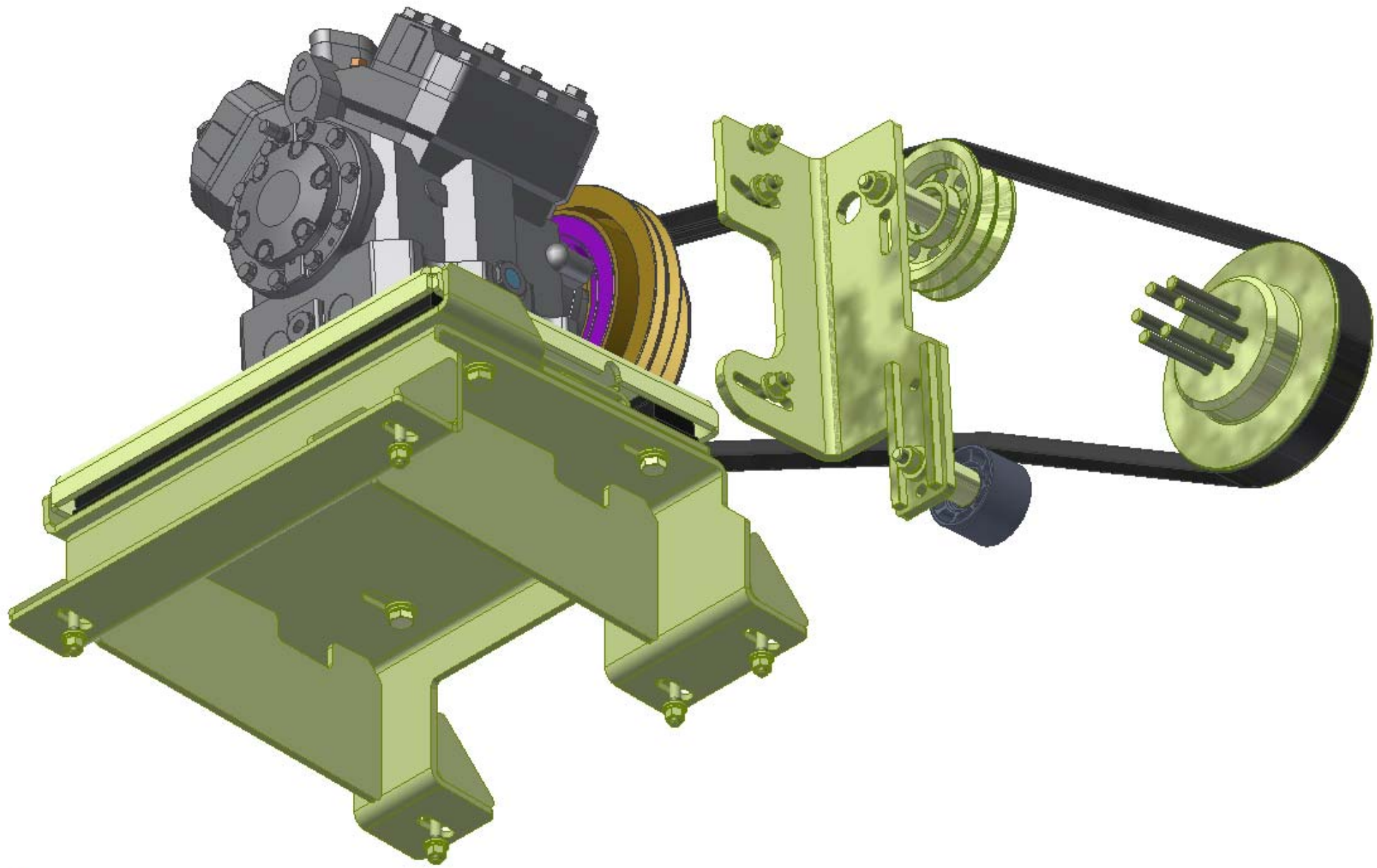



## **TransArctic A/C Compressor Mount Installation Disclaimer**

All compressor mounts should be installed by qualified and trained personnel using proper tools and equipment in safe working conditions following industry standard guidelines for motor vehicle service and repair.

The installer of any compressor mount purchased from TransArctic must undertake all responsibility of issues arising from that compressor bracket being installed on any vehicle. As well as insure that a **proper and sufficient ground** is established between the compressors' clutches and the vehicle's engine. Mount functionality, operation and durability can all be compromised by an incompetent installation.

Due to the many different situations, parameters and application criteria, which are beyond the compressor mount manufacturer's control, TransArctic does not warrant design, durability, or operational functionality of any compressor mount improperly installed by another party.

**With no implied guarantees it is the mount installer's strict responsibility to determine safety and functionality, of the compressor mount, at the time of installation.**

Please contact TransArctic with any issue arising from installation so we may better improve the product. If you have any reservations about the compressor mount integrity contact TransArctic immediately at 1-877-COLD-AIR.

**Mark OEM tensioner location**

**Install Kit**

**Check for Interferences**

**Check to ensure that the proper OEM tensioner orientation is maintained**

**Run engine with A/C system engaged for at least 10 minutes to run in belt**

**Check OEM tensioner orientation and adjust as required**

### **Responsabilidad limitada de TransArctic en la instalación del soporte del compresor**

Todos los soportes de los compresores deben ser instalados por personas calificadas y entrenadas, usando para ello los equipos y herramientas necesarios para esta labor en buenas condiciones y según las normas y guías para el servicio y/o reparación de motores de vehículos.

El instalador de los soportes comprados en TransArctic asume toda la responsabilidad de cualquier problema que surga en el soporte del compresor al vehículo; de igual manera es responsable que el cable a tierra sea conectado entre el embrague del compresor y el motor del vehículo.

Se advierte que el buen funcionamiento y la durabilidad del soporte pueden ser comprometidos por defectos en su instalación.

Debido a las diversas situaciones que se puedan presentar fuera del control del fabricante, TransArctic no garantiza el diseño, la durabilidad o el correcto funcionamiento de cualquier equipo inapropiadamente instalado por terceros.

**Esta sobreentendido que el Instalador del montaje del compresor es estrictamente responsable de la seguridad y funcionamiento del equipo en el momento de la instalación.**

Si tuviera algún problema o duda acerca de la instalación del soporte del compresor pongase en contacto inmediatamente con TransArctic al teléfono 1-877-COLD-AIR de modo que podamos mejorar nuestro producto.

**Note la ubicación del medidor de tensión OEM**

**Instale el equipo**

**Controlar si hay interferencias.**

**Asegure que el medidor de tensión mantenga la orientación justa.**

**Encienda el motor por lo menos 10 minutos con el sistema A/C enganchado para que la correa corra**

**Controle la orientación justa del medidor de tensión y ajuste a las condiciones requeridas del fabricante**