

Bill of Materials Listing

TransArctic Canada Inc.

1/6/2023
Page 1 of 1

Product Number		Date	Description		Uof M	Weight	Yield	
Line	Qty	Component Prod#	Rev#	Description	Location	Unit		
KMC62631		7/24/2020	0	Mt.Kit, ISB13, 2xTM21,Viscous, IC CE,'21			89.58	0
10	1	PAC23150		Pack, Carton, 23" x 15" x 10", 51 ECT PKG		each		
20	1	BEL82690		Belt, 8gr, 2690mm (106") (5081059) 9850		each		
30	1	BMC67063	2	Bkt, Alt, Bar, ISB, F400, BBCV, '10 4010		each		
40	1	BMC67109	0	Bkt, Shroud, Cover, BBCV, 12 Ga., '13 4010		each		
50	1	BMC67120	2	Bkt,Rad sprt.TM43/21, 6.7L. IC. Conv.'13 4010		each		
60	1	BMC67171	6	Bkt, Main, Weldm't, IC. Conv., '20 4010		each		
70	1	BMC67199	2	Bkt, Weldm't, TM-21, 6.7L, IC. Conv, '20 4010		each		
80	1	BMC67211	1	Bkt, Brace, Weldm't, Diag, VC, TM21, '20 4010		each		
90	1	BMZ00064	3	Bkt, Upper, Dual TM-21, Spacer 4010		each		
100	3	CLP02625		Clamp, Constant Torque, 1 3/4"- 2 5/8" 7050		each		
110	1	CLP03125		Clamp, Constant Torque, 2 1/4"- 3 1/8" 7050		each		
120	1	FSP59222		Spacer, Fan, Pulley, ISB, 22.2mm (.875") 4040		each		
130	1	PUL67008	0	Pulley, Crank, ADD-ON, Cum, ISB, 6.7, P8 4020		each		
140	2	PUL80076		Pulley, Idler, Backside, P8, 74d (89101) 4020		each		
150	2	PUL81074		Pulley, Idler, Frontside, P8,74d (89103) 4020		each		
170	1	SCD17917	2	Spacer, Step, Drl, 17.9mm x38.1o x17.06i 4040		each		
180	4	SLV17010	1	Sleeve, Pulley, 16.9o x 22.23mm x 10.32i 4040		each		
190	1	TEN80003		Tenr, HD Spring, BackSide, CCW (89200B) 4035		each		
200	1	TUS01894	0	Tube, Stl, Rad,1.75" O.D, C&W,15"Lg, '21 4080		each		
210	1	KBC62631	0	Bag Kit, Fasteners, TM21- KMC62631 4060		each		

Bill of Materials Listing

TransArctic Canada Inc.

1/6/2023
Page 1 of 1

Product Number	Date	Description	Uof M	Weight	Yield	
Line	Qty	Component Prod#	Rev#	Description	Location	Unit
KBC62631	7/24/2020	0		Bag Kit, Fasteners, TM21- KMC62631		
5	1	BTA08141		Bolt, Hex, 8 x 1.25 x 140mm, 8.8, Plt,FT 4070		each
10	4	BTC08025		Bolt, Hex, 8 x 1.25 x 25mm, 10.9, Plt 4070		each
20	2	BTC08030		Bolt, Hex, 8 x 1.25 x 30mm, 10.9, Plt,FT 4070		each
30	2	BTC08055		Bolt, Hex, 8 x 1.25 x 55mm, 10.9, Plt,FT 4070		each
40	12	BTC08100		Bolt, Hex, 8 x 1.25 x 100mm, 10.9, Plt 4070		each
50	6	BTC10025		Bolt, Hex, 10 x 1.5 x 25mm, 10.9, Plt 4070		each
60	7	BTC10050		Bolt, Hex, 10 x 1.5 x 50mm, 10.9, Plt 4070		each
65	4	BTC10055		Bolt, Hex, 10 x 1.5 x 55mm, 10.9, Plt,FT 4070		each
70	4	BTC10070		Bolt, Hex, 10 x 1.5 x 70mm, 10.9, Plt 4070		each
80	1	BTC10090		Bolt, Hex, 10 x 1.5 x 90mm, 10.9, Plt 4070		each
100	2	BTC10150		Bolt, Hex, 10 x 1.5 x 150mm, 10.9, Plt 4070		each
120	1	BTS06176		Bolt, U, 3/8-16, 1.75" I.D, W, Nut/PLT. 4070		each
130	1	CSF08031		Capscrew, FH, 8 x 1.25 x 30mm, 10.9,Plt 4070		Each
140	6	CSS12090		Capscrew, SH, 12 x 1.25 x 90mm, 12.9,BLK 4070		each
145	2	NTA08000		Nut, Hex, 8 x 1.25, 8.8, Plt 4070		each
150	2	NTA10000		Nut, Hex, 10 x 1.5, 8.8, Plt 4070		each
170	1	NTS10401		1 Nut, Tensioner, 10mm, 40.1mm o/a, Plt 4070		each
180	20	WFA08000		Washer, Flat, 8mm, 8.8, Plt 4070		each
190	25	WFA10000		Washer, Flat, 10mm, 8.8, Plt 4070		each
200	6	WFS12002		0 Washer, Flat, Hdn, 12mm, Stl, BLK 4070		each
210	21	WLA08000		Washer, Lock, 8mm, 8.8, Plt 4070		each
220	24	WLA10000		Washer, Lock, 10mm, 8.8, Plt 4070		each

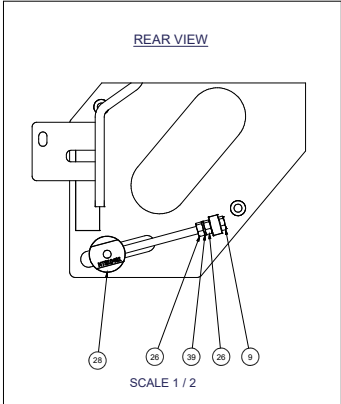

NOTE:
NOT SHOWING COMPRESSOR(S) FOR CLARITY.

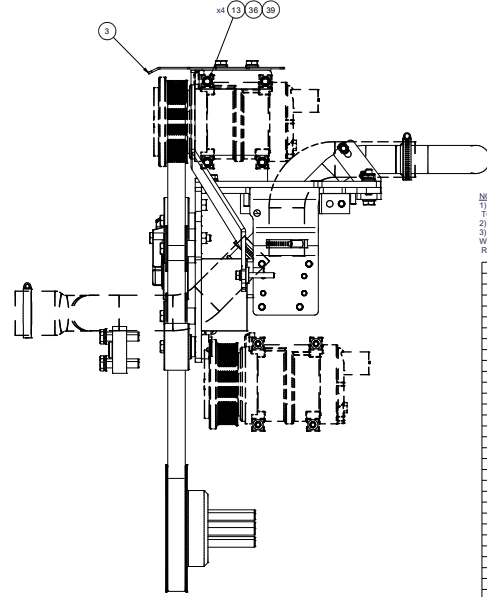
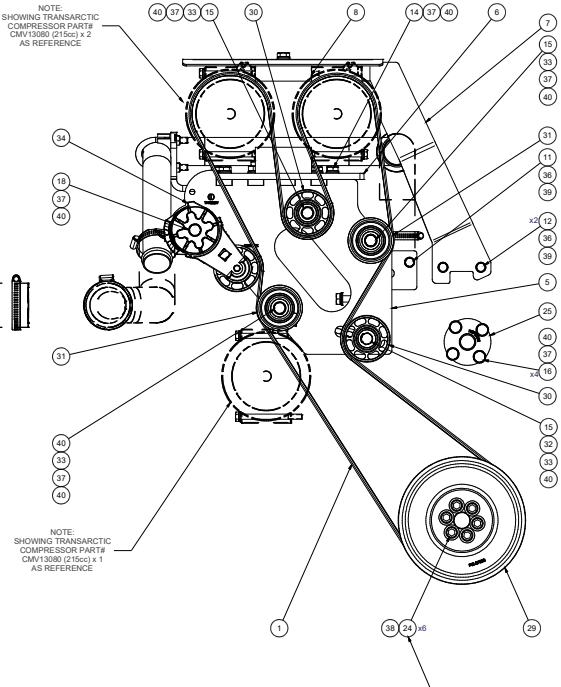
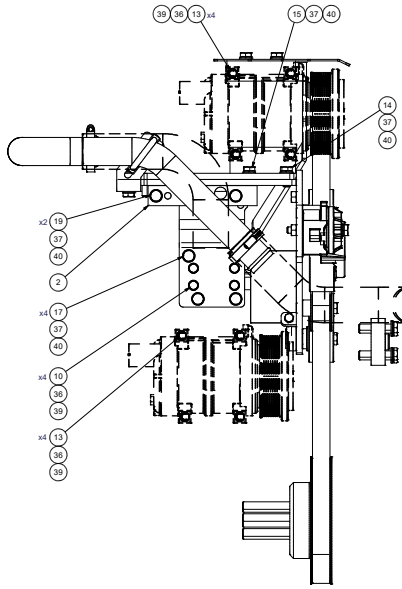
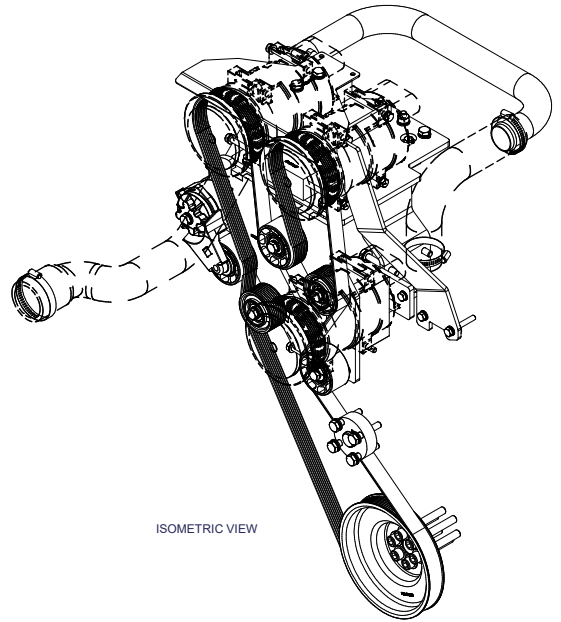
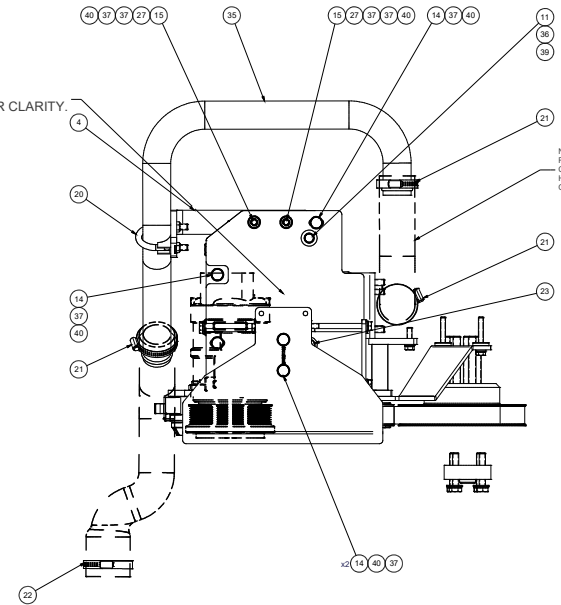

NOTE:
LOCK WASHERS ARE NOT REQUIRED.
TORQUE BOLTS TO S.A.E. SPECIFICATIONS.

NOTES:
1) USE SERVICABLE THREADLOCKER ON ALL FASTENERS TO ENGINE COMPONENTS AND TORQUE ALL BOLTS TO S.A.E. SPECIFICATIONS.
2) SEE "TRANSARCTIC A/C COMPRESSOR MOUNT INSTALLATION DISCLAIMER".
3) REMOVE ALTERNATOR MOUNT CASTING AND LIFTING LUG & REPLACE THE LIFT LUG WITH ITEM # BMC67171 AND RE-INSTALL ALTERNATOR AND MOUNT CASTING. REFER TO INSTALLATION PROCEDURE.

ITEM	QTY	U/M	PART NUMBER	DESCRIPTION
40	1	24	WLA10001	WASHER LOCK, 10mm, 8.8, PLT
49	21	EACH	WLA80000	WASHER LOCK, 8mm, 8.8, PLT
38	6	EACH	WFS12002	WASHER FLAT, HDN, 12mm, STL, BLK
37	25	EACH	WFA10000	WASHER FLAT, 10mm, 8.8, PLT
39	20	EACH	WFA60000	WASHER FLAT, 6mm, 8.8, PLT
35	1	EACH	TU501894	TUBE, STL, RAD, 1.75" O.D., CA.W., 15' LONG, '21
34	1	EACH	TENR0003	TENR, HD SPRING, BACKSIDE, CCW
33	4	EACH	SLV12101	SLEEVE, PULLEY, 16.9x x 22.2mm x 13.30
32	1	EACH	SCD17917	SPACER, STEP, DRL, 17.8mm x 28.8x x 171
31	2	EACH	PUL81074	PULLEY, OLER, FRONTSIDE, P8, 74d x 39w
30	2	EACH	PUL87078	PULLEY, OLER, BACKSIDE, P8, 70d, 39w
29	1	EACH	PUL67008	PULLEY, CRANK, ADD-ON, CLUM, ISB, 6.7, P8
28	1	EACH	NTS10401	NUT, TENSIONER, 10 mm, 40.13 mm dia, PLT
27	2	EACH	NTA10003	NUT, HEX, 10 x 1.5, 8.8, PLT
26	2	EACH	NTA60000	NUT, HEX, 8 x 1.25, 8.8, PLT
25	1	EACH	FSP95222	SPACER, FAN, PULLEY, ISB, 22.2mm (8.75")
24	6	EACH	CSJ20999	CAPSCREW, SH, 12 x 1.25 x 98mm, 12.9, PLT
23	1	EACH	CSF80031	CAPSCREW, FH, 8 x 1.25 x 30mm, 10.9, PLT
22	1	EACH	CLP3125	CLAMP, CONSTANT TORQUE, 2 1/4" - 3 1/8"
21	3	EACH	CLP2025	CLAMP, CONSTANT TORQUE, 1 3/4" - 2 5/8"
20	1	EACH	BTS89178	BKT, U, 3.8-16, 1.75", 1.5, W, N4PR1T
19	2	EACH	BTC10150	BOLT, HEX, 10 x 1.5 x 150mm, 10.9, PLT
18	1	EACH	BTC10090	BOLT, HEX, 10 x 1.5 x 90mm, 10.9, PLT
17	4	EACH	BTC10070	BOLT, HEX, 10 x 1.5 x 70mm, 10.9, PLT
16	4	EACH	BTC10055	BOLT, HEX, 10 x 1.5 x 55mm, 10.9, PLT
15	7	EACH	BTC10050	BOLT, HEX, 10 x 1.5 x 50mm, 10.9, PLT
14	6	EACH	BTC10025	BOLT, HEX, 10 x 1.5 x 25mm, 10.9, PLT
13	12	EACH	BTC08100	BOLT, HEX, 8 x 1.25 x 100mm, 10.9, PLT
12	2	EACH	BTC08055	BOLT, HEX, 8 x 1.25 x 55mm, 10.9, PLT
11	2	EACH	BTC08030	BOLT, HEX, 8 x 1.25 x 30mm, 10.9, PLT
10	4	EACH	BTC08025	BOLT, HEX, 8 x 1.25 x 25mm, 10.9, PLT
9	1	EACH	BTA68141	BOLT, HEX, 8 x 1.25 x 140mm, 8.9, PLT, FT
8	1	EACH	BMA20084	BKT, UPPER, DIA, TM21, SPACER
7	1	EACH	BMC67211	BKT, BRACE, WELDMT, DIAG, VC, TM21, IC, '20
6	1	EACH	BMC67199	BKT, WELDMT, TM21, 6.7L, IC, CONV, '20
5	1	EACH	BMC67171	BKT, MARK, WELDMT, IC, CONV, '20
4	1	EACH	BMC67120	BKT, RAD SPRT, TM43/21, 6.7L, IC, CONVI, '13
3	1	EACH	BMC67109	BKT, SHROUD COVER, BBCV, 12 Ga., '13
2	1	EACH	BMC67063	BKT, ALT, BAR, ISB, F480, BBCV, '10
1	1	EACH	BEL82690	BELT, (Spr, 2650mm (106")

DRAWN Jose Rodriguez		DATE: 10/20/2021	
CHECKED James Stewart		DATE: 10/20/2021	
REV	ECN	DESCRIPTION	DATE
1	1	RELEASED TO PRODUCTION	10/20/2021
THIS DRAWING CONTAINS PROPRIETARY OR CONFIDENTIAL INFORMATION. IT IS TO BE KEPT SECRET AND NOT REPRODUCED OR TRANSMITTED IN ANY FORM OR BY ANY MEANS, WITHOUT EXPRESS WRITTEN PERMISSION OF THE COMPANY.			
DATE APPROVED	DATE	APPROVED	
10/20/2021	10/20/2021	Dale Mason	
TRANSARCTIC INC. MT. KIT, ISB13, 2x TM21, VISCOUS, IC CE 21		DWS NO KMC62631	REV 0

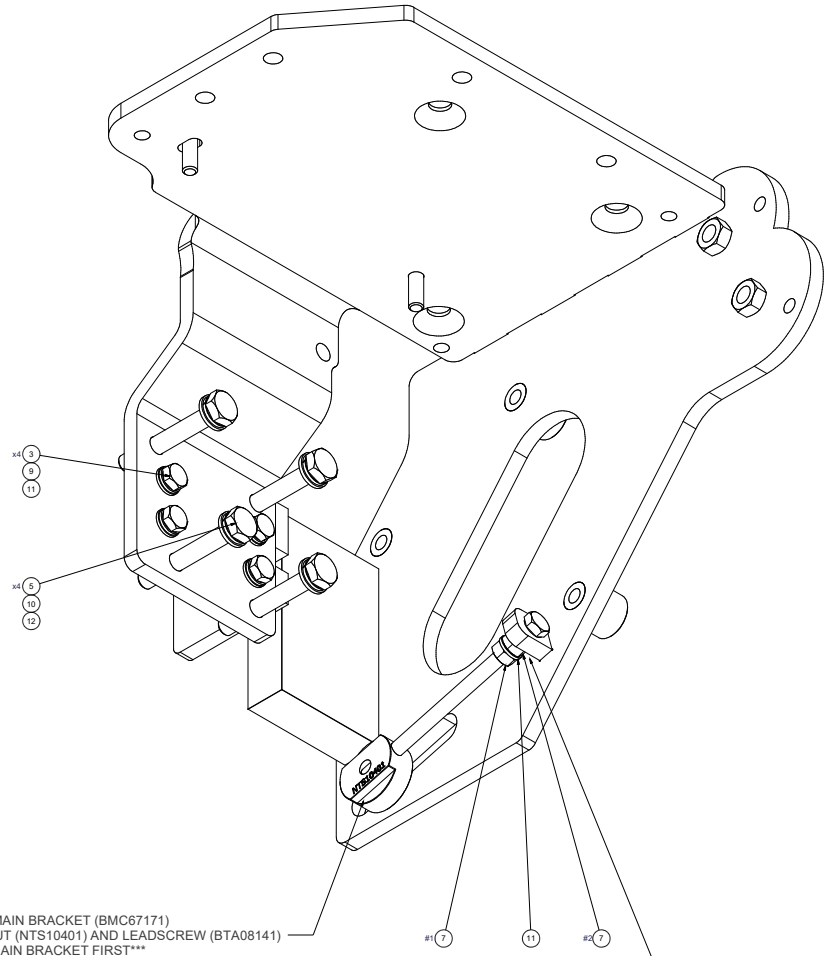
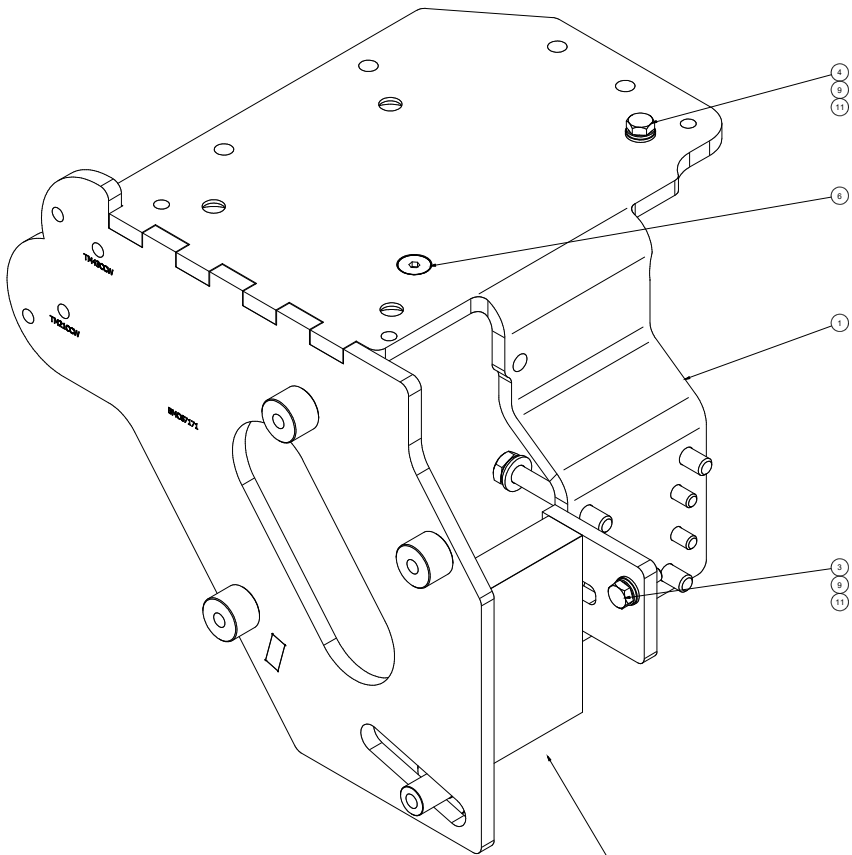

PRIOR TO INSTALLING THE MAIN BRACKET (BMC67171) ONTO ENGINE, JACKSCREW NUT (NTS10401) AND LEADSCREW (BTA08141) NEEDS TO BE INSTALLED ON MAIN BRACKET FIRST

COMPRESSOR MOUNT BRACKET (BMC67171) INSTALLATION PROCEDURE.

"NOTE: ALTERNATOR MOUNT CASTING AND LIFTING LUG NOT SHOW"

- 1) REMOVE ALTERNATOR CASTING AND LIFTING LUG.
- 2) INSTALL MOUNT BRACKET (BMC67110) WITH THE 8mm x 25mm BOLTS AND HARDWARE AS SHOWN. ITEMS (# 2, 10, 12). LEAVE HAND TIGHT FOR NOW.
- 3) INSTALL 8mm x 30mm BOLT AND HARDWARE INTO THE FRONT OF MOUNT AS SHOWN. ITEMS (# 3, 10, 12). ALSO LEAVING HAND TIGHT FOR NOW.
- 4) PLACE EXISTING ALTERNATOR MOUNT CASTING INTO POSITION USING THE 10mm x 70mm BOLTS AND HARDWARE. ITEMS (# 4, 11, 13).
- 5) HAND TIGHTEN THE 8mm COUNTERSUNK BOLT AND REAR 8MM BOLT IN THE TOP OF THE MOUNT FOR NOW. ITEMS (#5 & #3,10,12)
- 6) ONCE EVERYTHING IS ALIGNED, TIGHTEN THE 8mm X 30mm BOLT LOCATED IN THE FRONT OF THE MOUNT. THIS WILL SECURE THE MOUNT INTO THE CORRECT POSITION.
- 7) ONCE THE MOUNT HAS BEEN SECURED WITH THE FRONT BOLT. REMOVE THE ALTERNATOR CASTING AND TIGHEN THE 4 - 8mm x 25mm BOLTS.
- 8) TORQUE ALL 8mm BOLTS TO S.A.E. SPECIFICATIONS.
- 9) NOW THAT THE MOUNT IS SECURED INTO POSITION YOU CAN RE - INSTALL THE ALTERNATOR CASTING AND TIGHTEN AND TORQUE ALL REMAINING BOLTS.
- 10) NOW YOU CAN PROCEED TO INSTALL ALL REMAINING COMPONENTS.

NOTE: DO NOT OVERTIGHTEN NUT #2 TO MAIN BRACKET TAB. ONLY SNUG FIT REQUIRED, FOR BOLT TO SPIN FREELY WHEN ADJUSTING PULLEY.

NOTES:
 1) USE SERVICABLE THREADLOCKER ON ALL FASTENERS TO ENGINE COMPONENTS AND TORQUE ALL BOLTS TO S.A.E. SPECIFICATIONS.
 2) SEE "TRANSARCTIC AC COMPRESSOR MOUNT INSTALLATION DISCLAIMER"
 3) REMOVE ALTERNATOR MOUNT CASTING AND LIFTING LUG & REPLACE THE LIFT LUG WITH ITEM # BMC67171 AND RE - INSTALL ALTERNATOR AND MOUNT CASTING. REFER TO INSTALLATION PROCEDURE.

ITEM	QTY	U/M	PART NUMBER	DESCRIPTION
12	4	EACH	WLA10000	WASHER, LOCK, 10mm, 8.8, PLT
11	7	EACH	WLA06000	WASHER, LOCK, 8mm, 8.8, PLT
10	4	EACH	WFA10000	WASHER, FLAT, 10mm, 8.8, PLT
9	6	EACH	WFA08000	WASHER, FLAT, 8mm, 8.8, PLT
8	1	EACH	NTS10401	NUT, TENSIONER, 10 mm-60.13 mm o/d, PLT
7	2	EACH	NTA8000	NUT, HEX, 8 x 1.25, 8.8 PLT
6	1	EACH	CSF08031	CAPSCREW, FH, 8 x 1.25 x 30mm, 10.9, PLT
5	4	EACH	BTC08070	BOLT, HEX, 8 x 1.25 x 20mm, 10.9, PLT
4	1	EACH	BTC08030	BOLT, HEX, 8 x 1.25 x 30mm, 10.9, PLT
3	5	EACH	BTC08025	BOLT, HEX, 8 x 1.25 x 25mm, 10.9, PLT
2	1	EACH	BTAC08141	BOLT, HEX, 8 x 1.25 x 140mm, 8.8, PLT, FT
1	1	EACH	BMC67171	BKT, MAIN, WELDMT, IC, CONV, 20

DRAWN: Jose Rodriguez 10/20/2021
 CHECKED: James Stewart 10/20/2021
 REV ECN DESCRIPTION DATE BY: James Stewart 10/20/2021
 APPROVED: Valt Jakowlew 10/20/2021
 DATE: 10/20/2021
 DRAWING UNIT OF MEASURE: MM (INCH)
 SCALE: 1:1
 SHEET 2 OF 2

TRANSARCTIC INC.
 TITLE: MT. KIT, ISB13, 2x TM21, VISCOUS, IC CE '21
 DWS NO: KMC62631
 REV 0

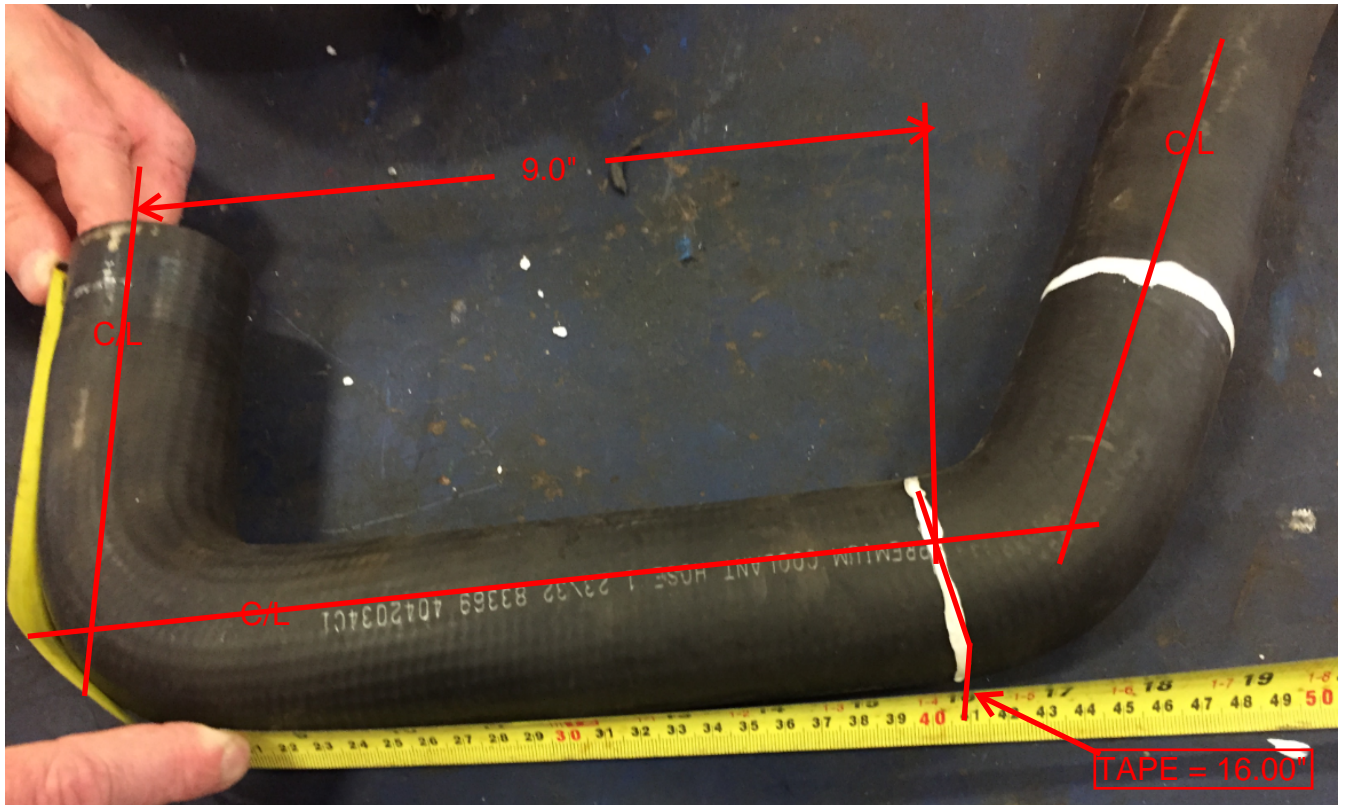

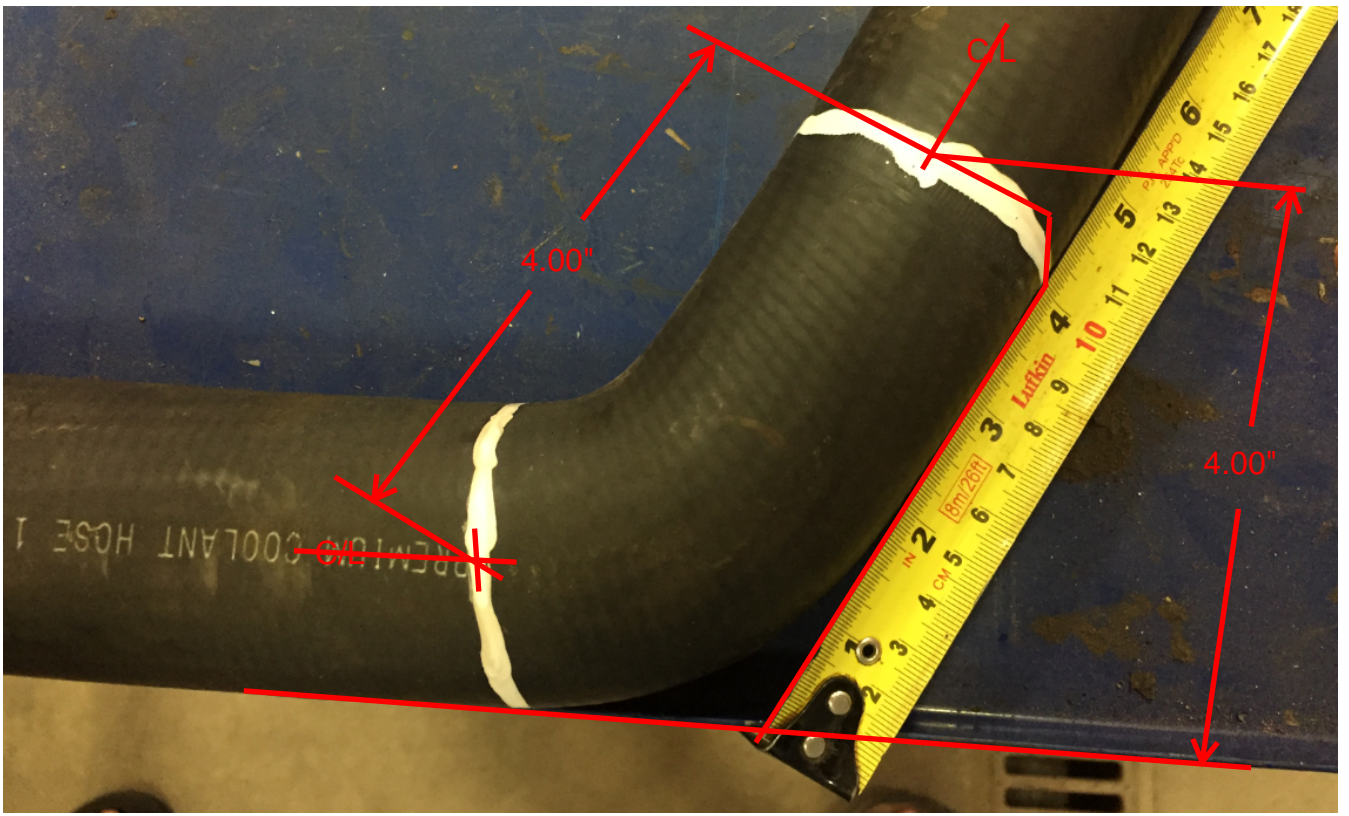

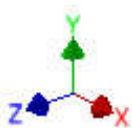
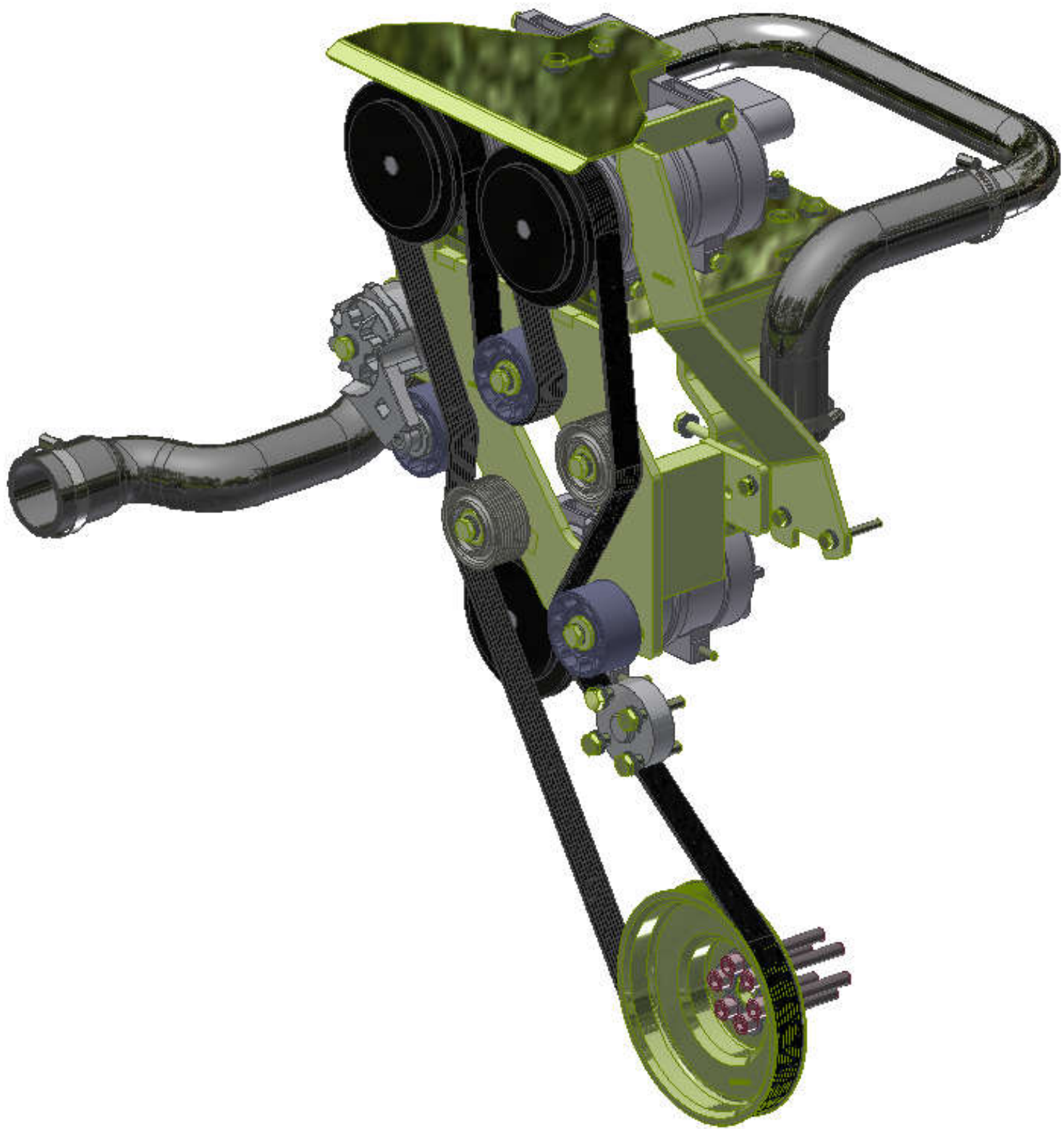

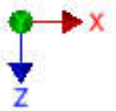
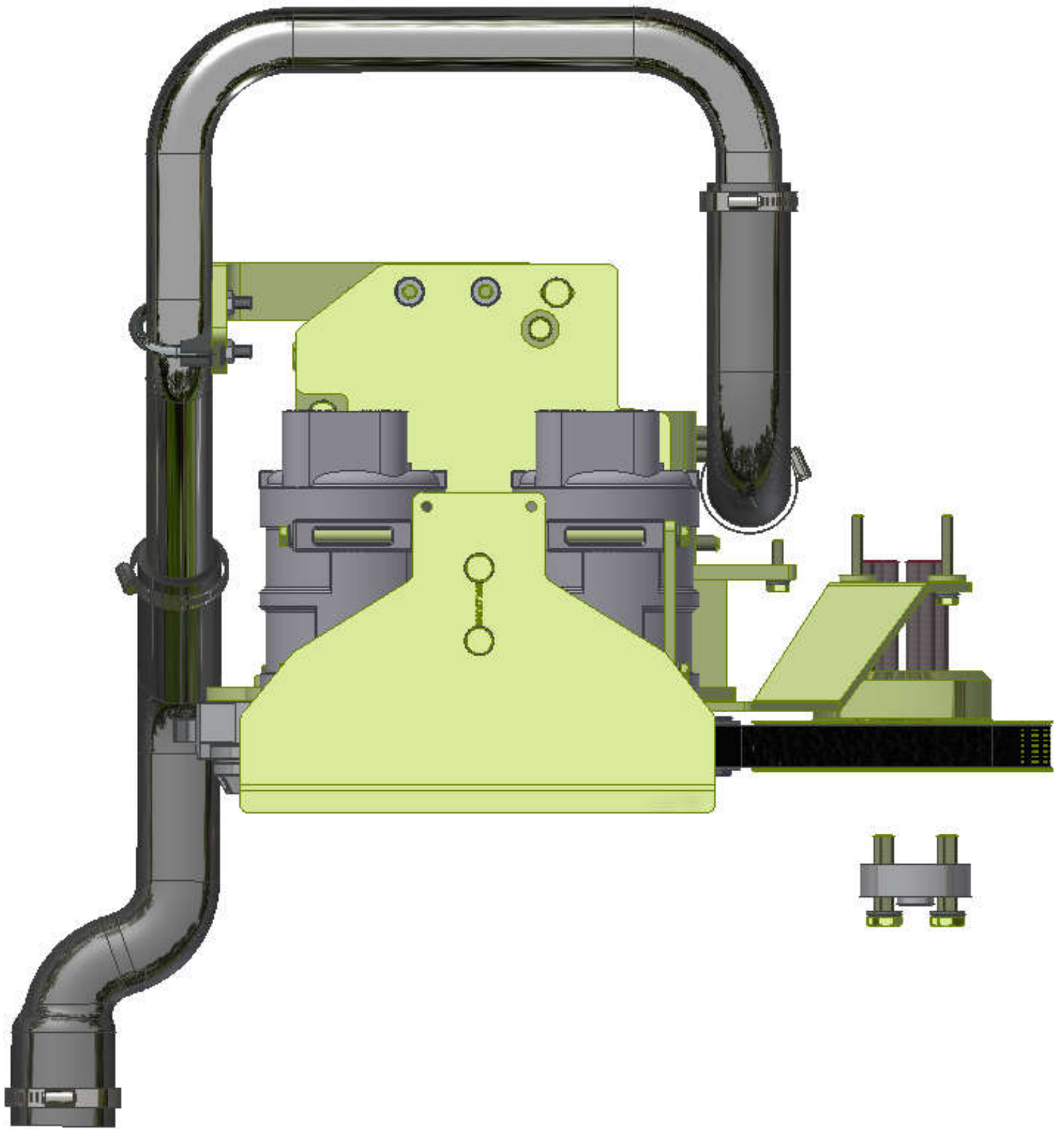

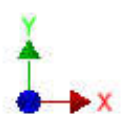
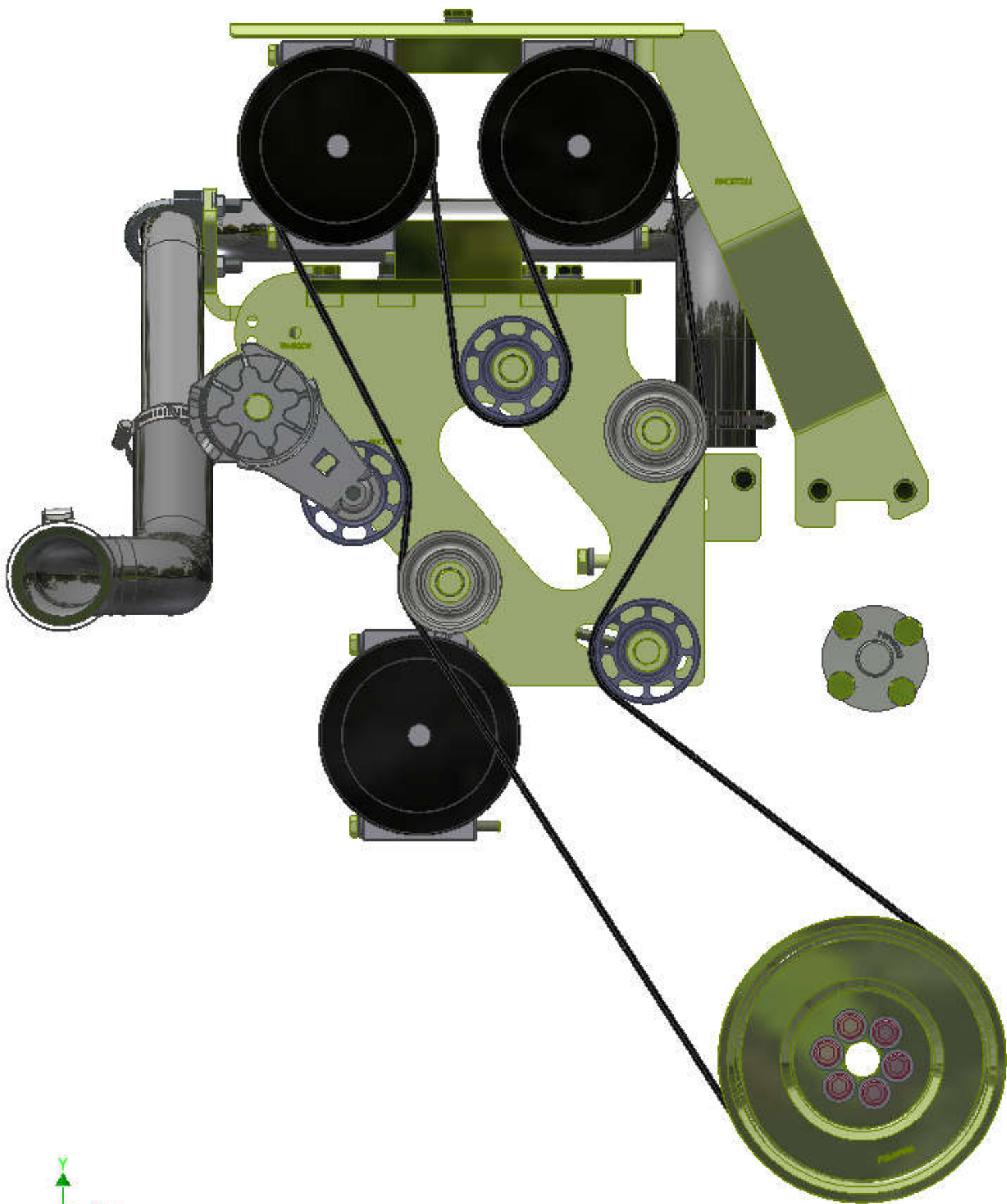

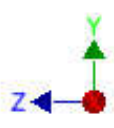
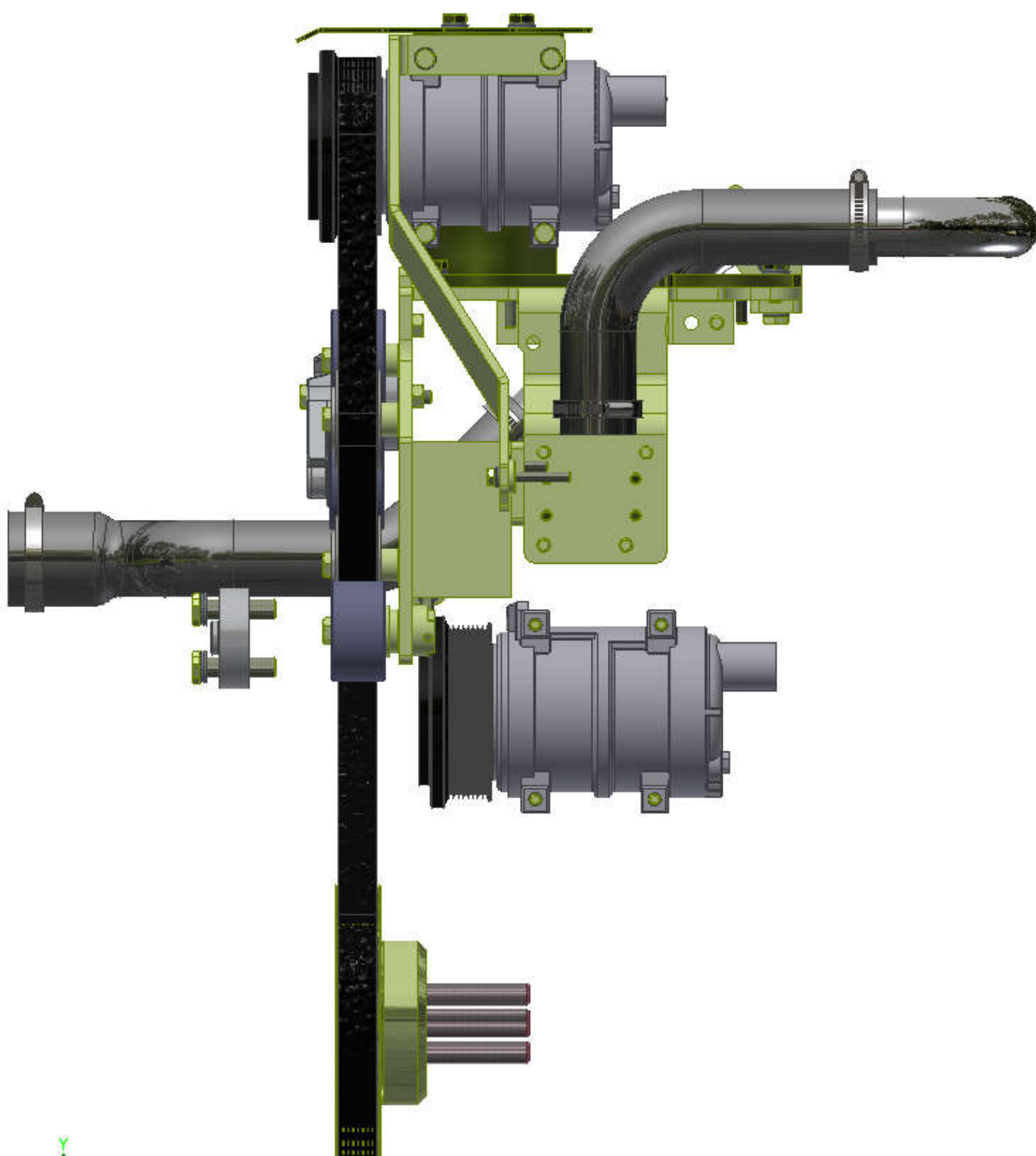

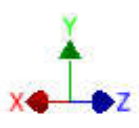
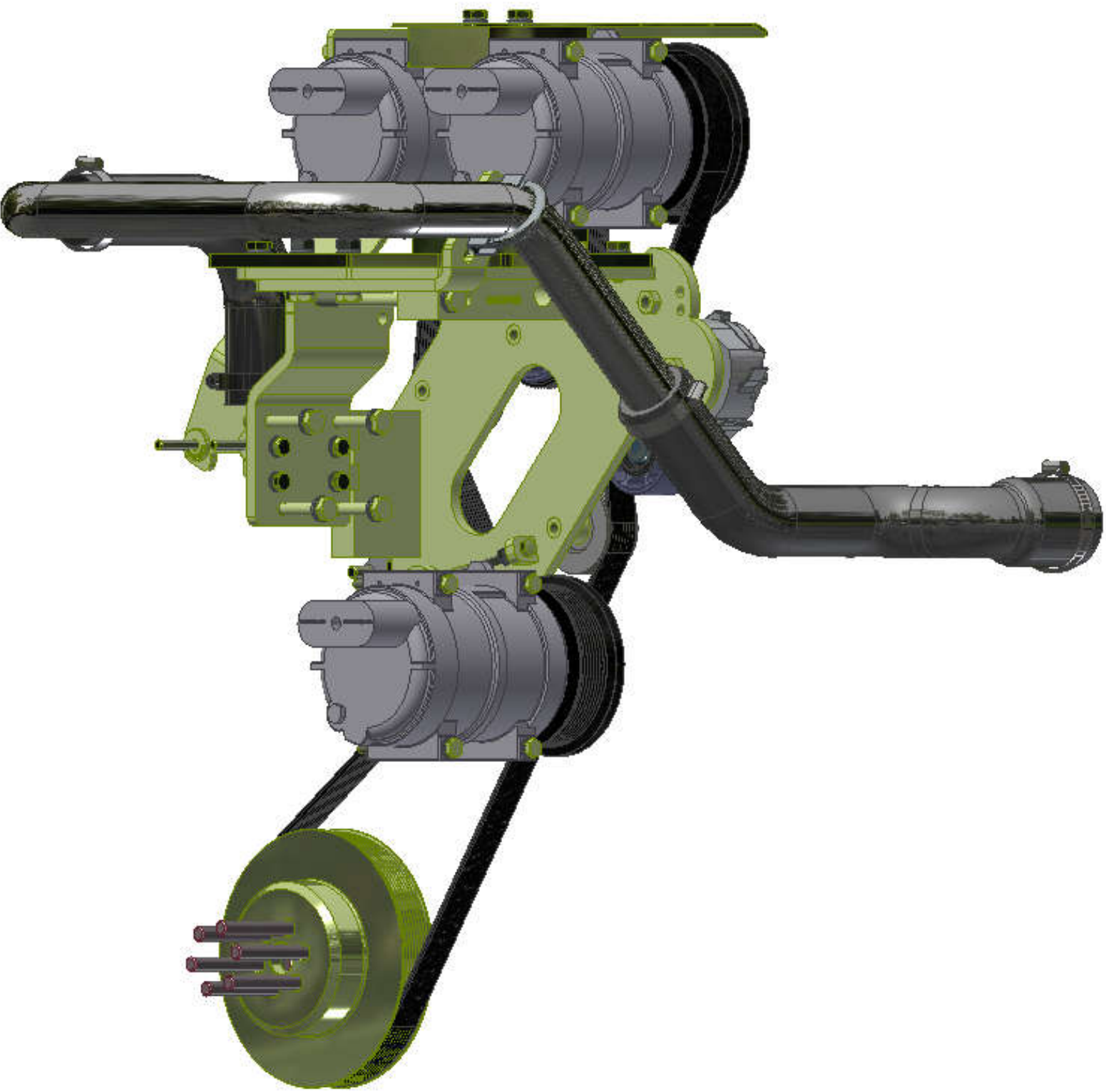

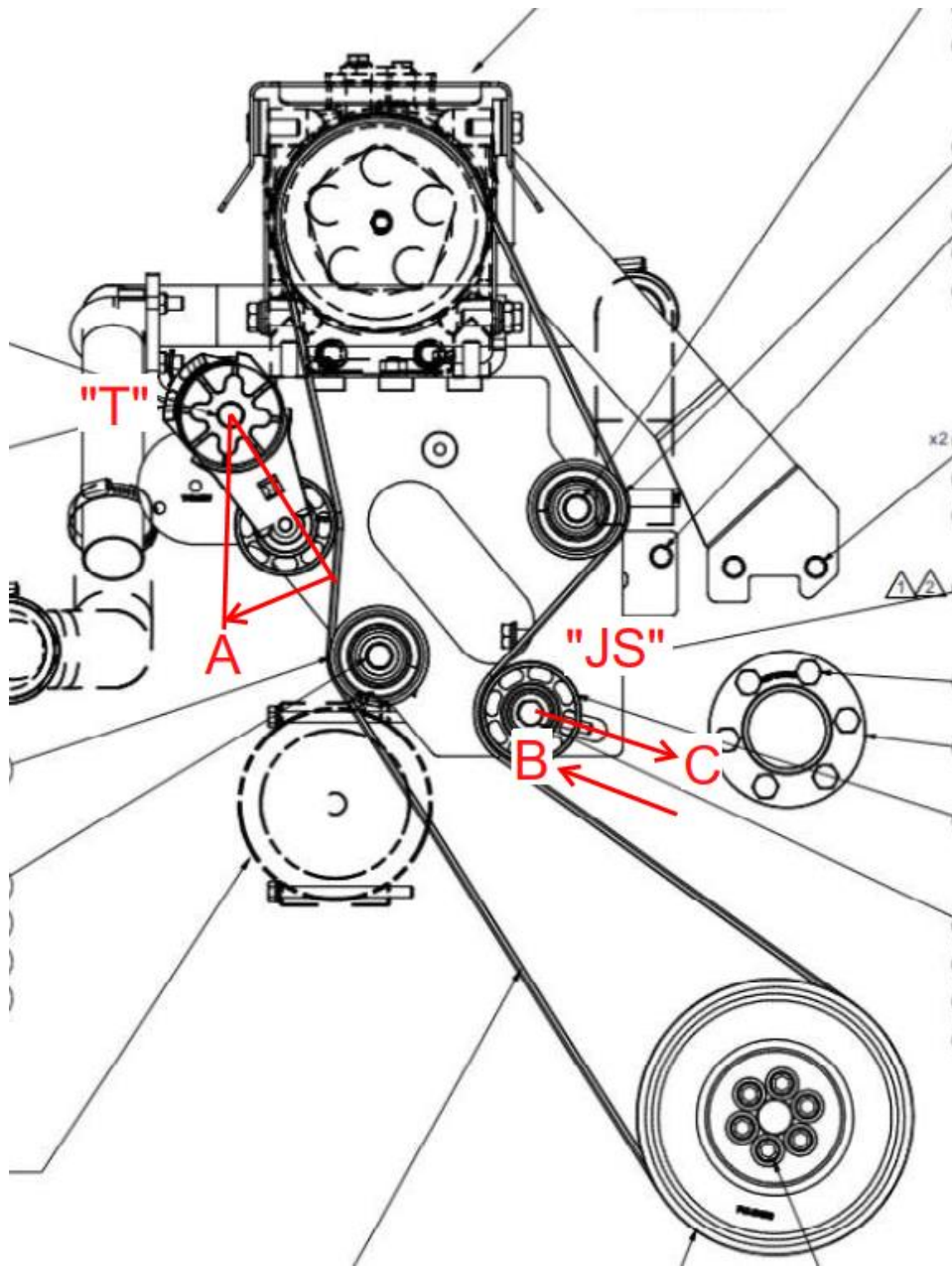

Proper "New" Belt Tensioning Procedure:

- 1) Insure engine is "locked out" from starting.
- 2) Adjust tensioner "T", clockwise rotation, till the swing arm-pulley is in "start" (zero stroke.) "A" position and **hold** in this position.
- 3) Loosen "JS" pulley bolt, (Via the "Jackscrew" adjusting head bolt – (SEE DRAWING) Adjust "JS" in the direction of "C" Approx. 1" or more till belt is slack enough to be removed.

- 4) Install new "proper" replacement belt into position insuring that all the belt's grooves align with "all" the pulleys grooves in the loop and is seated properly.
- 5) Adjust pulley "JS" in direction of "B", until the new belt is "tight" (Snug by hand.) and tighten the "JS" pulley assembly's fastener correctly.
- 6) Double check belt alignment with all the pulleys.
- 7) Release the "T" tensioner from its "start" position so it comes into direct contact with the backside of the new belt.
- 8) Make sure that the tensioner position is clocked from 50% to 60% (linear dimension is approximately 1" (25.5mm) to 1.06" (27mm)) through its stroke travel. The "full stroke" linear dimension is approximately 2.13" (54 mm) from the fixed "start" (stop face.) on the base to the corresponding face on the "swing arm" at 100% through its stroke.
- 9) Run the A/C system (Under full load.) for approximately 1-2 hours and recheck the stroke running position of tensioner "T". If not to spec than retention the "JS" pulley assembly like before (Item# 6). (NOTE: insure that tensioner "T" is at its starting stroke position (0%) before adjusting pulley assembly "JS".)

TransArctic A/C Compressor Mount Installation Disclaimer

All compressor mounts should be installed by qualified and trained personnel using proper tools and equipment in safe working conditions following industry standard guidelines for motor vehicle service and repair.

The installer of any compressor mount purchased from TransArctic must undertake all responsibility of issues arising from that compressor bracket being installed on any vehicle. As well as insure that a **proper and sufficient ground** is established between the compressors' clutches and the vehicle's engine. Mount functionality, operation and durability can all be compromised by an incompetent installation.

Due to the many different situations, parameters and application criteria, which are beyond the compressor mount manufacturer's control, TransArctic does not warrant design, durability, or operational functionality of any compressor mount improperly installed by another party.

With no implied guarantees it is the mount installer's strict responsibility to determine safety and functionality, of the compressor mount, at the time of installation.

Please contact TransArctic with any issue arising from installation so we may better improve the product. If you have any reservations about the compressor mount integrity contact TransArctic immediately at 1-877-COLD-AIR.

Mark OEM tensioner location

Install Kit

Check for Interferences

Check to ensure that the proper OEM tensioner orientation is maintained

Run engine with A/C system engaged for at least 10 minutes to run in belt

Check OEM tensioner orientation and adjust as required

Responsabilidad limitada de TransArctic en la instalación del soporte del compresor

Todos los soportes de los compresores deben ser instalados por personas calificadas y entrenadas, usando para ello los equipos y herramientas necesarios para esta labor en buenas condiciones y según las normas y guías para el servicio y/o reparación de motores de vehículos.

El instalador de los soportes comprados en TransArctic asume toda la responsabilidad de cualquier problema que surga en el soporte del compresor al vehículo; de igual manera es responsable que el cable a tierra sea conectado entre el embrague del compresor y el motor del vehículo.

Se advierte que el buen funcionamiento y la durabilidad del soporte pueden ser comprometidos por defectos en su instalación.

Debido a las diversas situaciones que se puedan presentar fuera del control del fabricante, TransArctic no garantiza el diseño, la durabilidad o el correcto funcionamiento de cualquier equipo inapropiadamente instalado por terceros.

Esta sobreentendido que el Instalador del montaje del compresor es estrictamente responsable de la seguridad y funcionamiento del equipo en el momento de la instalación.

Si tuviera algún problema o duda acerca de la instalación del soporte del compresor pongase en contacto inmediatamente con TransArctic al teléfono 1-877-COLD-AIR de modo que podamos mejorar nuestro producto.

Note la ubicación del medidor de tensión OEM

Instale el equipo

Controlar si hay interferencias.

Asegurese que el medidor de tensión mantenga la orientación justa.

Encienda el motor por lo menos 10 minutos con el sistema A/C enganchado para que la correa corra

Controle la orientación justa del medidor de tensión y ajuste a las condiciones requeridas del fabricante