

Bill of Materials Listing

TransArctic Canada Inc.

7/13/2017
Page 1 of 1

Product Number		Description	Bin	Date	Weight	Uof M	Yield
Line	Component Prod#	Description		Unit	Qty		
KMC62674		Mt Kit, ISB, 6.7L, C2, 2 TM-21, '12+		3/16/2012	53.53		0
10	BEL61791	Belt, 6gr, 1791mm (70.5") (5060705)		each	1		
20	BMC67084	Bkt, Main, Wldt, D-S, 6.7L, ISB, C2		each	1		
25	BMC67092	BKT, Hose, Brace, 12 GA.		each	1		
30	FSP59286	Spacer, Fan, Pulley, ISB, 28.6mm (1.13")		each	1		
40	FSP62905	Spacer, Fan, Pulley, ISB, 29.05mm(1.14")		each	1		
45	4933235	Gasket, Connection,Throttle Body,Cummins		each	2		
47	NTS10254	Nut, Tensioner, 10 mm, 25.4 mm o/a, PLT		each	1		
50	PUL60089	Pulley, Frontside, STL, P6,89.4d (89174)		each	1		
60	PUL67006	Pulley, Crank, ADD-ON, Cum, ISB, 6.7, P6		each	1		
70	PUL80076	Pulley, Idler, Backside, P8, 76d (89101)		each	1		
75	SCD38430	Spacer, Step, Drl,38.4mm x 34.9o x10.08i		each	1		
80	SCD12713	Spacer, Col, Drl, 12.7mm x 25.4o x12.7i		each	1		
82	SCD25408	Spacer, Col, Drl, 25.4mm x 25.4o x 8.33i		each	1		
84	SCD31512	Spacer, Col, Drl,31.48mm x 25.4o x 12.3i		each	1		
110	SLV17110	Sleeve, Pulley,S,16.9o x 22.23mm x 10.3i		each	1		
115	SPC12783	Spacer, Throttle Body, Offset,ISB,C2,'13		each	1		
120	TEN80005	Tenr, HD Spring, BackSide, CCW (89430)		each	1		
130	KBC62674	Bag Kit, Fasteners, KMC62674		each	1		

Bill of Materials Listing

TransArctic Canada Inc.

7/13/2017
Page 1 of 1

Product Number	Description	Date	Weight	Uof M	Yield
Line	Component Prod#	Bin	Unit	Qty	
KBC62674	Bag Kit, Fasteners, KMC62674	11/6/2012	5.27		0
1	BTS10001		Bolt, Shoulder, 10mm (89064)	each	1
3	BTS06015		Bolt, Hex, Flg, 6mm x 1.0 x 16, 10.9,Plt	each	4
5	BTC08050		Bolt, Hex, 8 x 1.25 x 50mm, 10.9, Plt	each	1
10	BTC08100		Bolt, Hex, 8 x 1.25 x 100mm, 10.9, Plt	each	12
20	BTC10045		Bolt, Hex, 10 x 1.5 x 45mm, 10.9, Plt,FT	each	3
30	BTC10060		Bolt, Hex, 10 x 1.5 x 60mm, 10.9, Plt	each	4
35	BTC10080		Bolt, Hex, 10 x 1.5 x 80mm, 10.9, Plt,FT	each	1
40	BTC10090		Bolt, Hex, 10 x 1.5 x 90mm, 10.9, Plt	each	1
50	BTC10130		Bolt, Hex, 10 x 1.5 x 130mm, 10.9, Plt	each	6
70	BTC12130		Bolt, Hex, 12 x 1.75 x 130mm, 10.9, Plt	each	1
75	BTQ08250		Bolt, Hex, 1/2-13unc, 2.5", 8, Plt	each	1
78	CSF04012		Capscrew, FH, M4 x 0.7 x 12, Alloy, Plt	each	2
80	CSS12090		Capscrew, SH, 12 x 1.25 x 90mm, 12.9,BLK	each	6
90	NTA10000		Nut, Hex, 10 x 1.5, 8.8, Plt	each	1
100	WFA08000		Washer, Flat, 8mm, 8.8, Plt	each	12
110	WFA10000		Washer, Flat, 10mm, 8.8, Plt	each	9
120	WFA12000		Washer, Flat, 12mm, 8.8, Plt	each	1
130	WFS12002		Washer, Flat, Hdn, 12mm, Stl, BLK	each	6
140	WLA08000		Washer, Lock, 8mm, 8.8, Plt	each	12
150	WLA10000		Washer, Lock, 10mm, 8.8, Plt	each	9
160	WLA12000		Washer, Lock, 12mm, 8.8, Plt	each	1

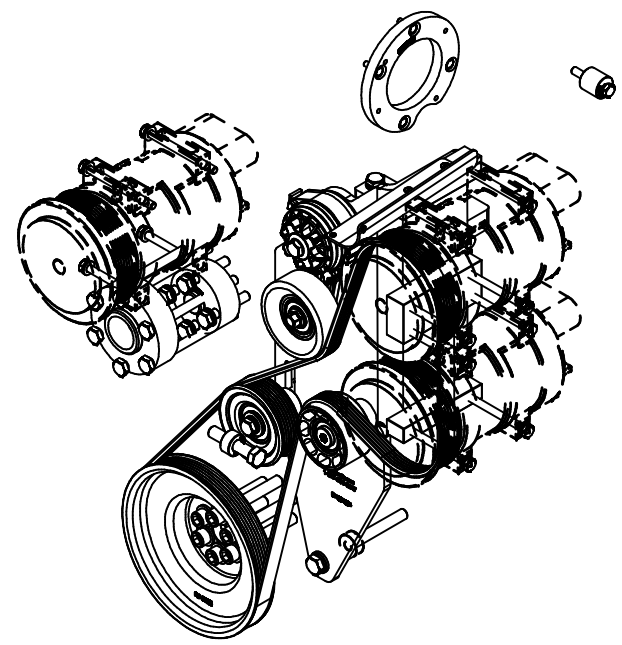
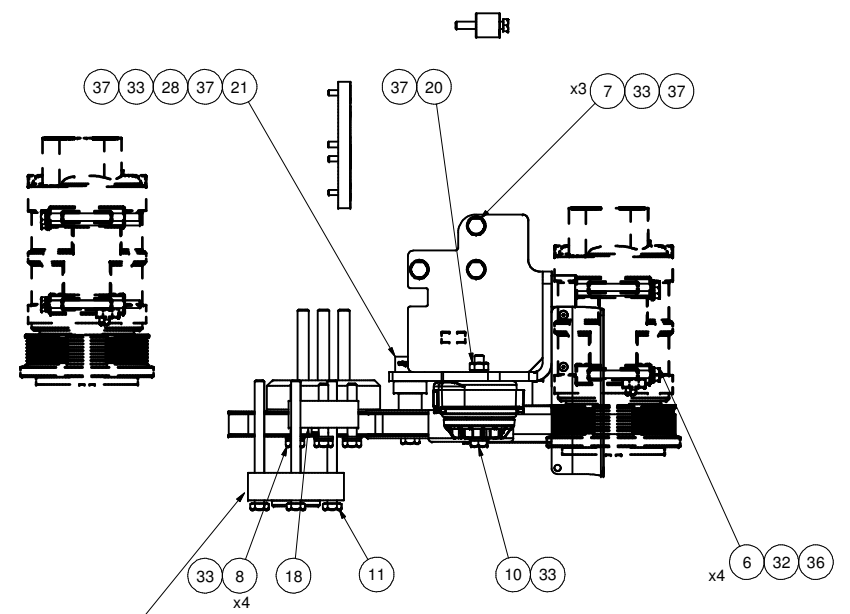

ISOMETRIC VIEW

NOTE:
INSTALL THE 6 GR. BELT ON THE
FRONT 6 GROOVES OF THE 8 GR.
COMPRESSOR PULLEY.

NOTE:
USE APPROPRIATE FAN
SPACER
& FASTENERS TO SUIT
INSTALLATION.

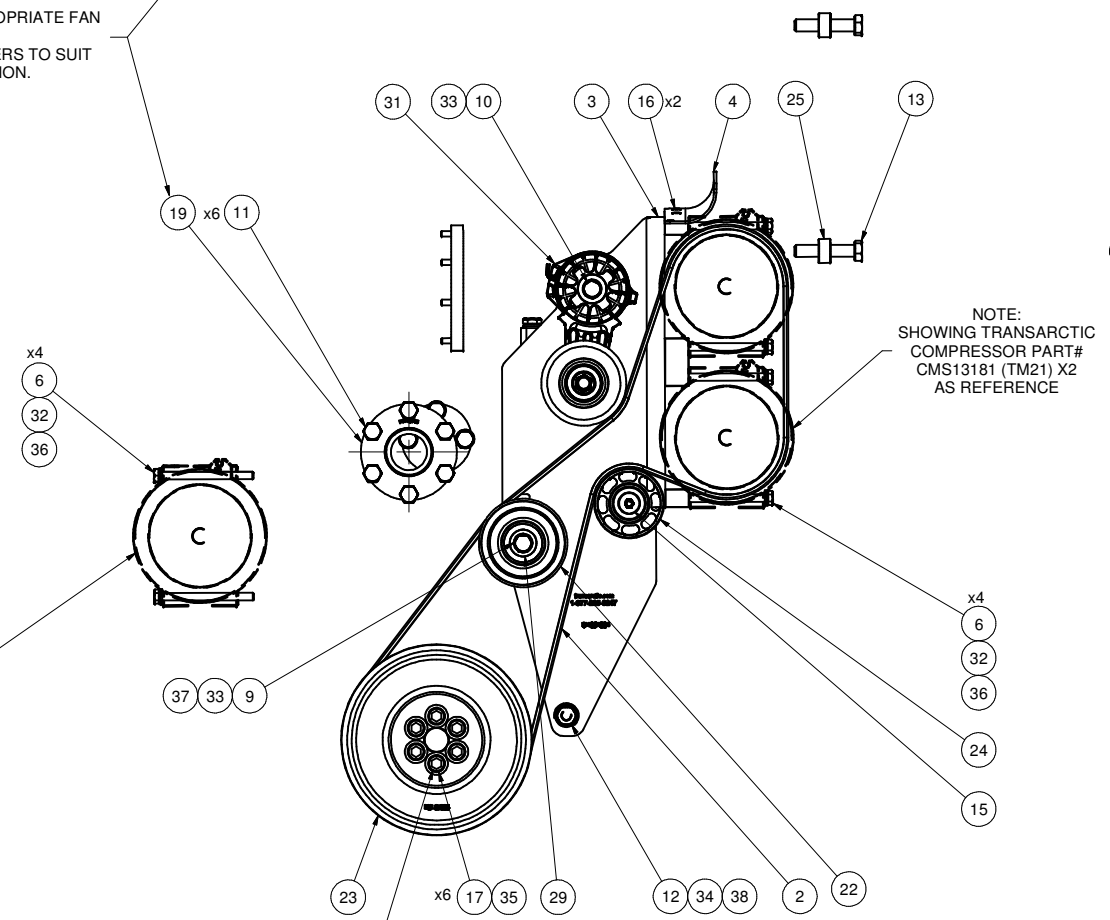

NOTE:
SHOWING TRANSARCTIC
COMPRESSOR PART#
CMS13181 (TM21) X2
AS REFERENCE

NOTE:
SHOWING TRANSARCTIC
COMPRESSOR PART#
CMS13181 (TM21) X1
AS REFERENCE

NOTE:
TORQUE TO: 37 FT-LB PLAIN & LUBRICATED W/ CLEAN ENGINE OIL (15W-40)
(SH. CAPSCREW M12 x 1.25 x 90mm)
TIGHTEN IN TWO STEPS IN A CRIS-CROSS TIGHTENING SEQUENCE PATTERN

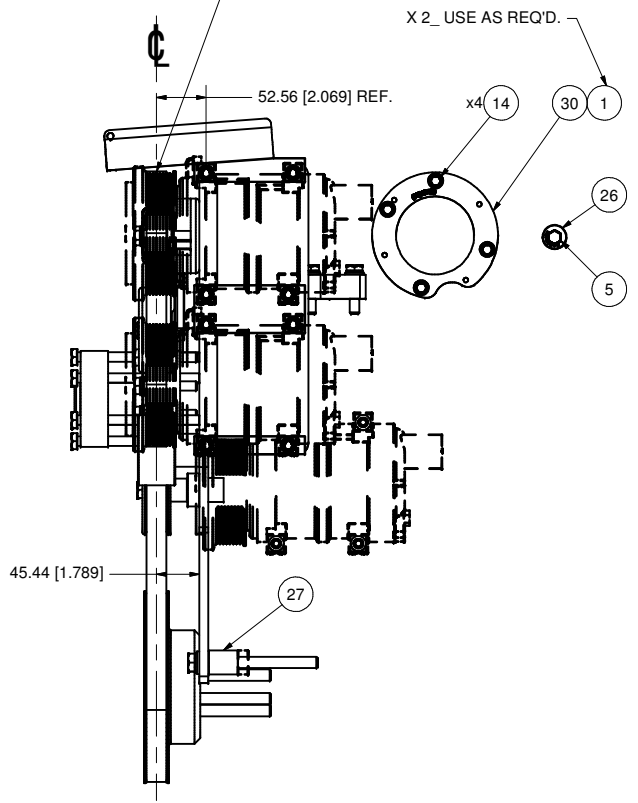

NOTES:
1) USE SERVICABLE THREADLOCKER ON ALL FASTENERS
TO ENGINE COMPONENTS AND TORQUE **ALL** BOLTS TO
S.A.E. SPECIFICATIONS.
2) SEE "TRANSARCTIC A/C COMPRESSOR MOUNT
INSTALLATION DISCLAIMER".

ITEM	QTY	U/M	PART NUMBER	DESCRIPTION
38	1	EACH	WLA12000	WASHER, LOCK, 12mm, 8.8, PLT
37	9	EACH	WLA10000	WASHER, LOCK, 10mm, 8.8, PLT
36	12	EACH	WLA08000	WASHER, LOCK, 8mm, 8.8, PLT
35	6	EACH	WFS12002	WASHER, FLAT, HDN, 12mm, STL, BLK
34	1	EACH	WFA12000	WASHER, FLAT, 12mm, 8.8, PLT
33	9	EACH	WFA10000	WASHER, FLAT, 10mm, 8.8, PLT
32	12	EACH	WFA08000	WASHER, FLAT, 8mm, 8.8, PLT
31	1	EACH	TEN80005	TENR, HD SPRING, BACKSIDE, CCW (89430)
30	1	EACH	SPC12783	SPACER, THROTTLE BODY, OFFSET, ISB, C2, '13
29	1	EACH	SLV17110	SLEEVE, PULLEY, S, 16.9o x 22.23mm x 10.3i
28	1	EACH	SCD38430	SPACER, STEP, DRL, 38.4mm x 38.1o x 10.08i
27	1	EACH	SCD31512	SPACER, COL, DRL, 31.48mm x 25.4o x 12.3
26	1	EACH	SCD25408	SPACER, COL, DRL, 25.4mm x 25.4o x 8.33i
25	1	EACH	SCD12713	SPACER, COL, DRL, 12.7mm x 25.4o x 12.7i
24	1	EACH	PUL80076	PULLEY, IDLER, BACKSIDE, P8, 76D, 39W
23	1	EACH	PUL67006	PULLEY, CRANK, ADD-ON, CUM, ISB, 6.7, P6
22	1	EACH	PUL60089	PULLEY, IDLER, FRONTSIDE, P6, 89D, 30W
21	1	EACH	NTS10254	NUT, TENSIONER, 10 mm, 25.4 mm o/a, PLT
20	1	EACH	NTA10000	NUT, HEX, 10 x 1.5, 8.8, PLT
19	1	EACH	FSP62905	SPACER, FAN, PULLEY, ISB, 29.05mm (1.14")
18	1	EACH	FSP59286	SPACER, FAN, PULLEY, ISC, 28.6mm (1.13")
17	6	EACH	CSS12090	CAPSCREW, SH, 12 x 1.25 x 90mm, 12.9, PLT
16	2	EACH	CSF04013	CAPSCREW, FH, 4 x 0.7 x 12mm, 10.9, PLT
15	1	EACH	BTS10001	BOLT, SHOULDER, 10mm (IDLER PULLEY)
14	4	EACH	BTS06015	BOLT, HEX, FLG, 6mm x 1.0 x 16, 8.8, PLT
13	1	EACH	BTQ08250	BOLT, HEX, 1/2-13UNC x 2.50, 8, PLT
12	1	EACH	BTC12130	BOLT, HEX, 12 x 1.75 x 130mm, 10.9, PLT
11	6	EACH	BTC10130	BOLT, HEX, 10 x 1.5 x 130mm, 10.9, PLT
10	1	EACH	BTC10090	BOLT, HEX, 10 x 1.5 x 90mm, 10.9, PLT
9	1	EACH	BTC10080	BOLT, HEX, 10 x 1.5 x 80mm, 10.9, PLT
8	4	EACH	BTC10060	BOLT, HEX, 10 x 1.5 x 60mm, 10.9, PLT
7	3	EACH	BTC10045	BOLT, HEX, 10 x 1.5 x 45mm, 10.9, PLT
6	12	EACH	BTC08100	BOLT, HEX, 8 x 1.25 x 100mm, 10.9, PLT
5	1	EACH	BTC08050	BOLT, HEX, 8 x 1.25 x 50mm, 10.9, PLT
4	1	EACH	BMC67092	BKT, HOSE, BRACE, 12 GA.
3	1	EACH	BMC67084	BKT, MAIN, WLDT, D-S, 6.7L, ISB, C2, '12
2	1	EACH	BEL61791	BELT, 6 GR, 1791mm (70.5") (5080705)
1	2	EACH	4933235	GASKET, CONNECTION, THROTTLE BODY, CUMMINS

REV	ECN	DESCRIPTION	DATE	BY
4	-	BMC67084 MODIFIED FOR DRAINAGE	5/30/2017	KEY
3	-	GENERAL REVISION	05/14/15	VALJ
2	-	GENERAL REVISION	06/12/14	VALJ
1	-	GENERAL REVISION	04/21/14	VALJ
0	-	RELEASED TO PRODUCTION	11/08/12	VALJ

THIS DRAWING CONTAINS PROPRIETARY CONFIDENTIAL INFORMATION OWNED BY TRANSARCTIC CANADA INC. THE DOCUMENT AND THE INFORMATION IN IT ARE NOT TO BE USED, DISCLOSED OR REPRODUCED WITHOUT EXPRESS WRITTEN PERMISSION OF THE COMPANY.

UNSPECIFIED TOLERANCES: (ALT. DIM) .005 (INCH) .15 (MM)

DRAWING UNIT OF MEASURE: MM [INCH]

DRAWN: Jose Rodriguez 11/6/2012
 CHECKED: Jose Rodriguez 11/6/2012
 MFG: James Stewart 11/06/12
 APPROVED: Dale Mason 11/6/2012

TRANSARCTIC INC.

TITLE: Mt Kit, ISB, 6.7L, C2, 2 TM-21, '13

SIZE: D DWG NO: KMC62674 REV: 4

SCALE: 1:4 SHEET 1 OF 1

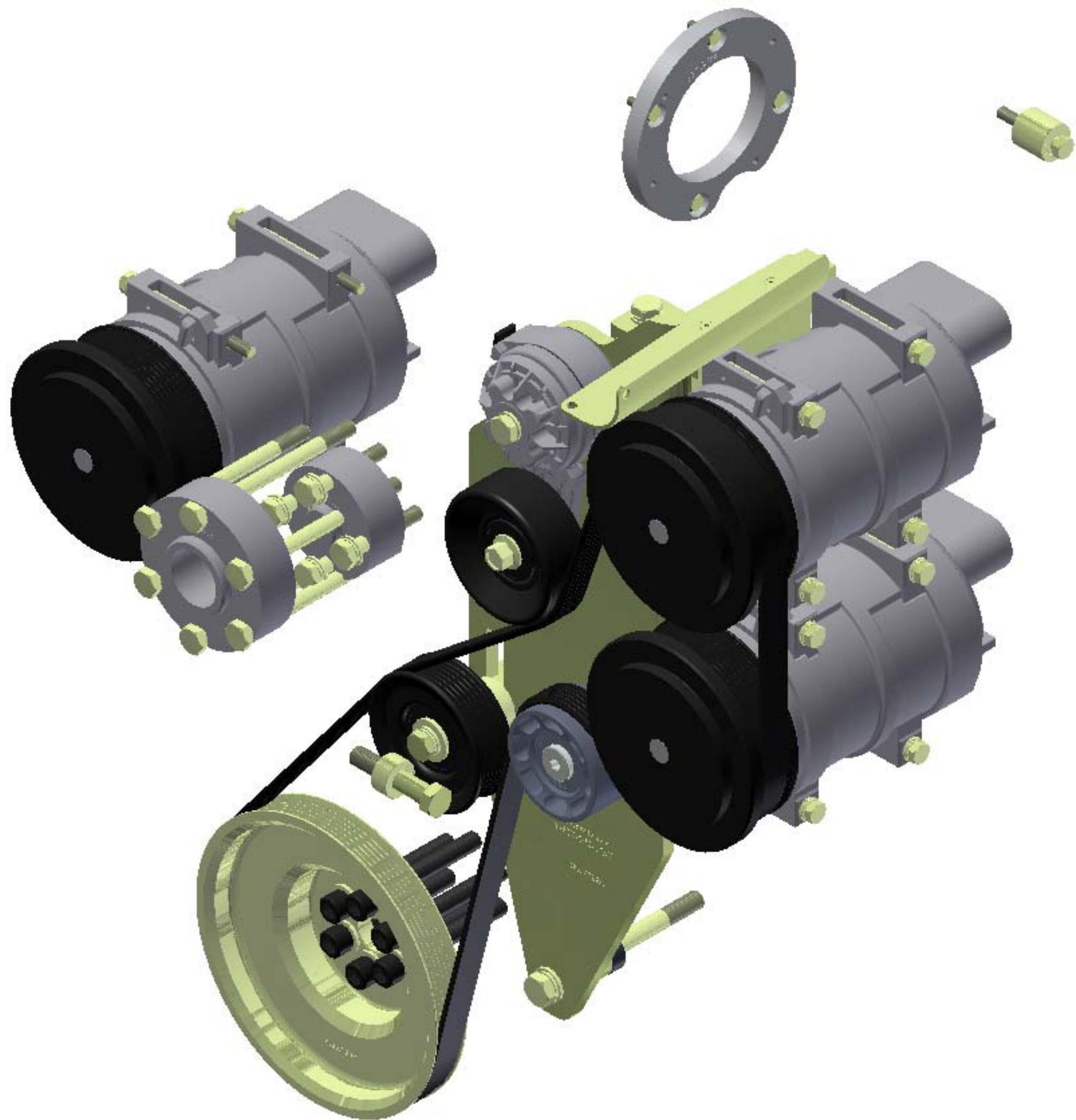

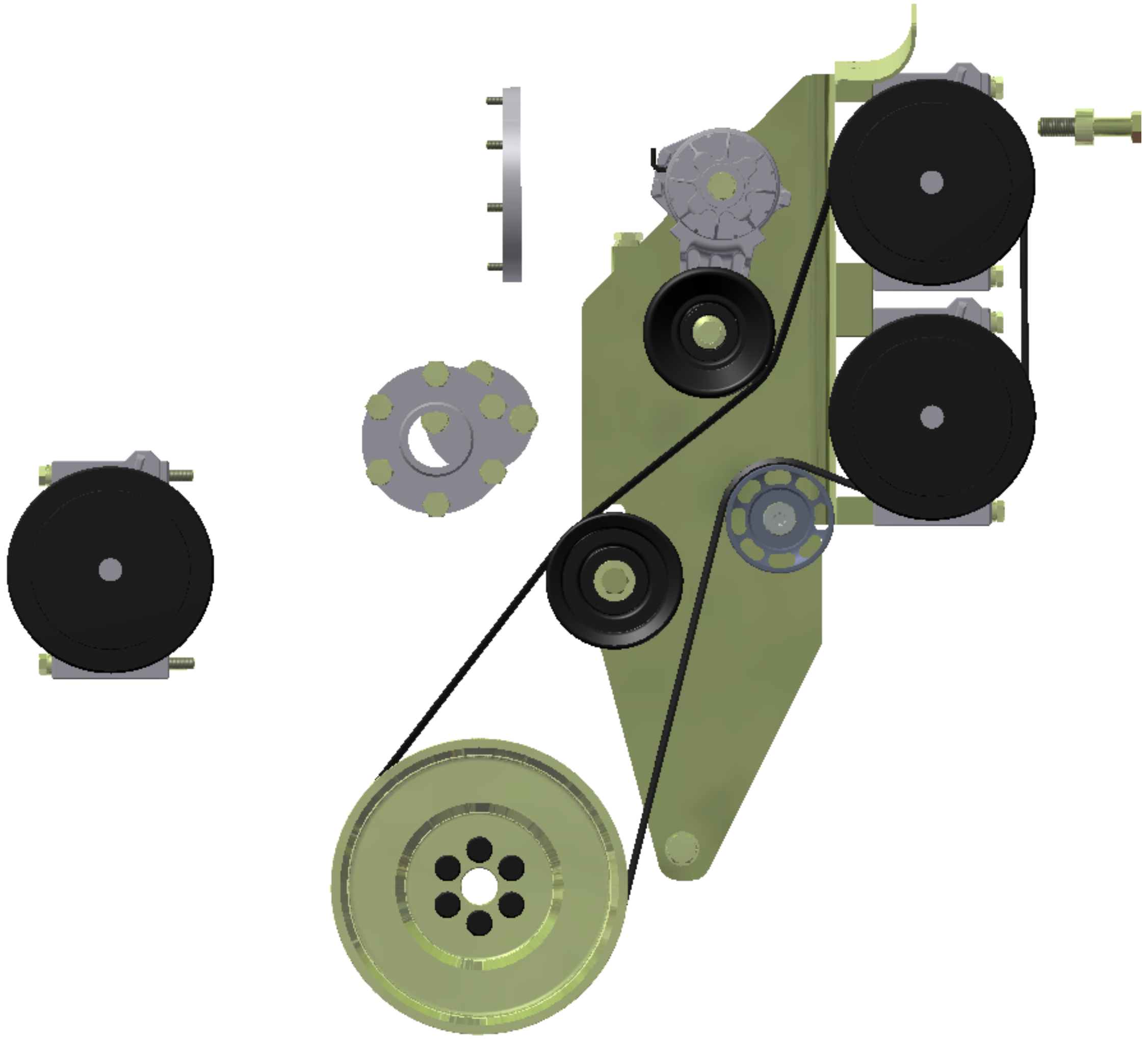
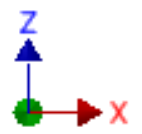

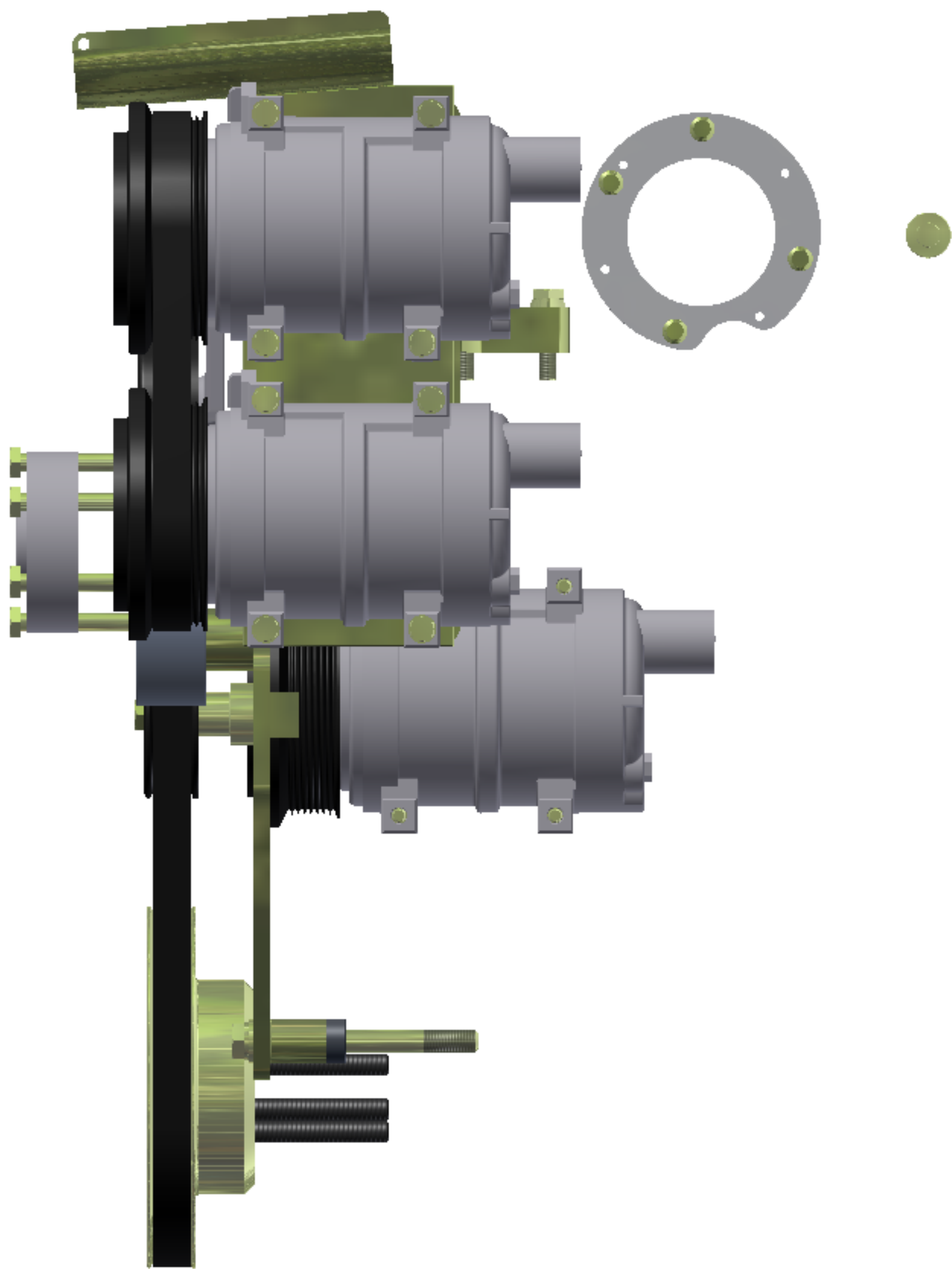
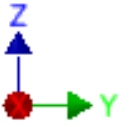

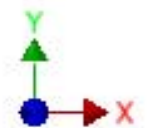

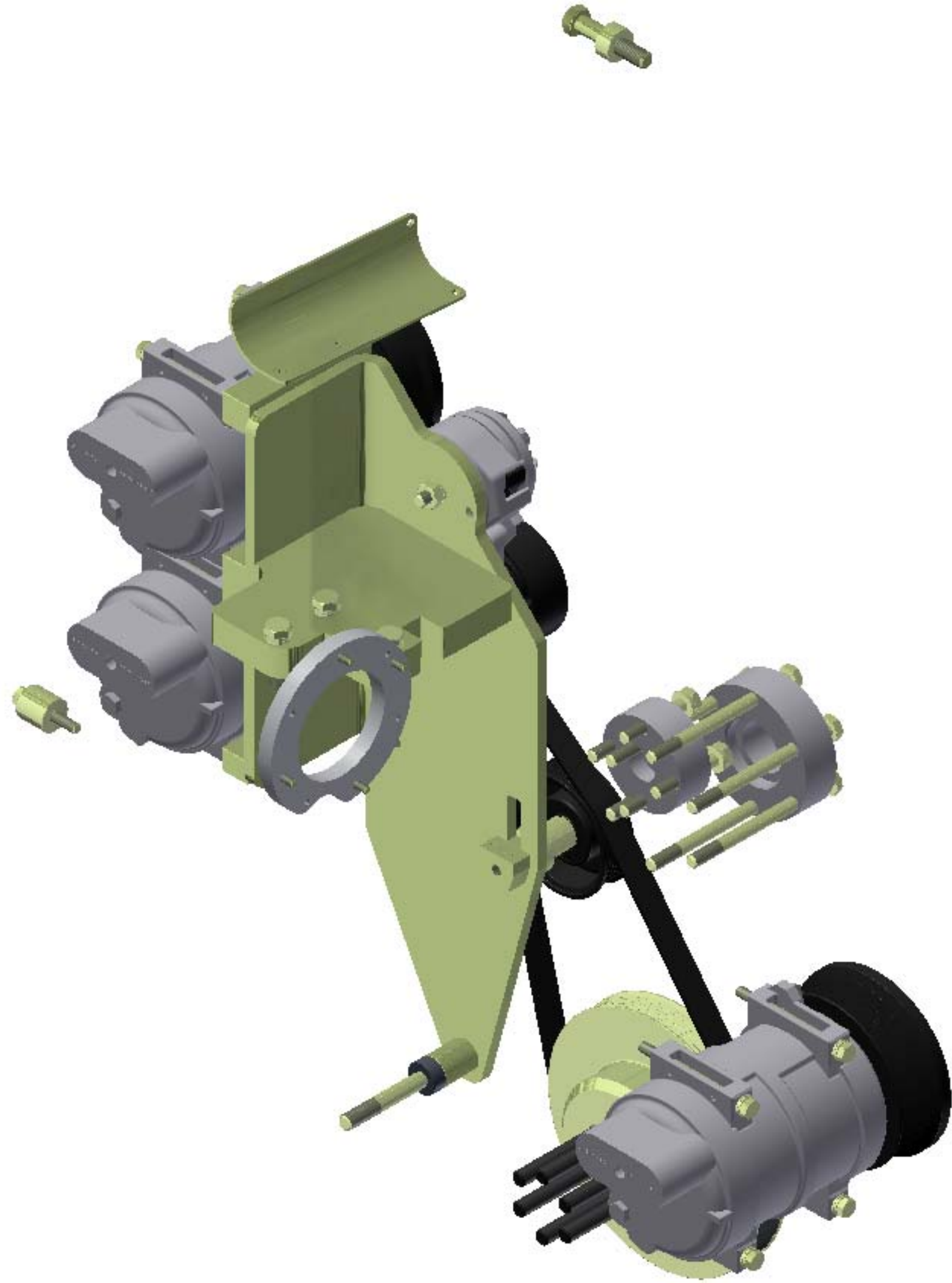

TransArctic A/C Compressor Mount Installation Disclaimer

All compressor mounts should be installed by qualified and trained personnel using proper tools and equipment in safe working conditions following industry standard guidelines for motor vehicle service and repair.

The installer of any compressor mount purchased from TransArctic must undertake all responsibility of issues arising from that compressor bracket being installed on any vehicle. As well as insure that a **proper and sufficient ground** is established between the compressors' clutches and the vehicle's engine. Mount functionality, operation and durability can all be compromised by an incompetent installation.

Due to the many different situations, parameters and application criteria, which are beyond the compressor mount manufacturer's control, TransArctic does not warrant design, durability, or operational functionality of any compressor mount improperly installed by another party.

With no implied guarantees it is the mount installer's strict responsibility to determine safety and functionality, of the compressor mount, at the time of installation.

Please contact TransArctic with any issue arising from installation so we may better improve the product. If you have any reservations about the compressor mount integrity contact TransArctic immediately at 1-877-COLD-AIR.

Mark OEM tensioner location

Install Kit

Check for Interferences

Check to ensure that the proper OEM tensioner orientation is maintained

Run engine with A/C system engaged for at least 10 minutes to run in belt

Check OEM tensioner orientation and adjust as required

Responsabilidad limitada de TransArctic en la instalación del soporte del compresor

Todos los soportes de los compresores deben ser instalados por personas calificadas y entrenadas, usando para ello los equipos y herramientas necesarios para esta labor en buenas condiciones y según las normas y guías para el servicio y/o reparación de motores de vehículos.

El instalador de los soportes comprados en TransArctic asume toda la responsabilidad de cualquier problema que surga en el soporte del compresor al vehículo; de igual manera es responsable que el cable a tierra sea conectado entre el embrague del compresor y el motor del vehículo.

Se advierte que el buen funcionamiento y la durabilidad del soporte pueden ser comprometidos por defectos en su instalación.

Debido a las diversas situaciones que se puedan presentar fuera del control del fabricante, TransArctic no garantiza el diseño, la durabilidad o el correcto funcionamiento de cualquier equipo inapropiadamente instalado por terceros.

Esta sobreentendido que el Instalador del montaje del compresor es estrictamente responsable de la seguridad y funcionamiento del equipo en el momento de la instalación.

Si tuviera algún problema o duda acerca de la instalación del soporte del compresor pongase en contacto inmediatamente con TransArctic al teléfono 1-877-COLD-AIR de modo que podamos mejorar nuestro producto.

Note la ubicación del medidor de tensión OEM

Instale el equipo

Controlar si hay interferencias.

Asegure que el medidor de tensión mantenga la orientación justa.

Encienda el motor por lo menos 10 minutos con el sistema A/C enganchado para que la correa corra

Controle la orientación justa del medidor de tensión y ajuste a las condiciones requeridas del fabricante