

# Bill of Materials Listing

TransArctic Canada Inc.

3/13/2019  
Page 1 of 1

Product Number		Description	Rev#	Date	Weight	Uof M	Yield
Line	Component Prod#	Description	Bin	Unit	Qty		
<b>KMC44094</b>		<b>Mt Kit, ISL-G, HDX,4xFC,H.MOUNT, ALT,'16</b>	<b>1</b>	<b>4/21/2017</b>	<b>169.22</b>		<b>0</b>
10	BEL32389	Belt, Banded B gr,2388mm (94") (41-1328)		each	1		
20	BMC83125	Bkt, Weldm't, Adapter Pl, ISL, HDX, '13		each	1		
30	BMC83129	Bkt, Weldm't, Main Base, ISL, HDX, '13		each	1		
40	BMC90022	Bkt, Main, Idler, Weldm't, ISL, HDX, '16		each	1		
50	BMC90026	Bkt, Alignm't Bar, Add-On, ISL, HDX, '17		each	1		
60	KCB84094	Kit, Comp, Alt, PS, 4xFC,'13		each	1		
70	KPC90009	Kit, Pulley, ISL-G, 8.9L, 2B/X,'17		each	1		
80	PUA05001	Pulley, Assy, Idler, B/S, 5", Stl, Plt		each	1		
90	PUA05012	Pulley, Assy, Idler,B/BX gr,5", STL,Plt		each	1		
100	SCD16012	Spacer, Col, Drl,16 mm x 34.9o x 12.3i		each	1		
110	SCD21912	Spacer, Col, Drl,21.9mm x 25.4o x 12.3i		each	1		
120	SLV17012	Sleeve, Pulley, 16.9o x 22.23mm x 12.32i		each	1		
130	KBC44195	Bag Kit,Fasteners,KMC44195 & Others.		each	1		

# Bill of Materials Listing

TransArctic Canada Inc.

6/23/2017  
Page 1 of 1

Product Number		Description	Bin	Date	Weight	Uof M	Yield
Line	Component Prod#	Description		Unit	Qty		
<b>KBC44195</b>		<b>Bag Kit, Fasteners, KMC44195 &amp; Others.</b>		<b>6/1/2016</b>	<b>2.41</b>		<b>0</b>
10	BTC10045	Bolt, Hex, 10 x 1.5 x 45mm, 10.9, Plt, FT		each	3		
20	BTC12080	Bolt, Hex, 12 x 1.75 x 80mm, 10.9, Plt, FT		each	2		
30	BTQ06175	Bolt, Hex, 3/8-16unc, 1.75", 8, Plt		each	5		
40	BTQ08125	Bolt, Hex, 1/2-13unc, 1.25", 8, Plt		each	2		
50	BTQ08151	Bolt, Hex, 1/2-20unf, 1.5", 8, Plt		each	2		
60	CSF08031	Capscrew, FH, 8 x 1.25 x 30mm, 10.9, Plt		each	2		
70	CSF08101	Capscrew, FH, 1/2-20unf x 1.0", Alloy, Plt		each	4		
80	NTA10000	Nut, Hex, 10 x 1.5, 8.8, Plt		each	3		
90	NTA12000	Nut, Hex, 12 x 1.75, 8.8, Plt		each	2		
100	NTQ06000	Nut, Hex, 3/8-16unc, 8, Plt		each	5		
110	WFA10002	Washer, Flat, 10mm, Hvy, 8.8, Plt		each	6		
120	WFA12002	Washer, Flat, 12mm, Hvy, 8.8, Plt		each	2		
130	WFQ08000	Washer, Flat, 1/2", 8, Plt		each	4		
150	WFS06002	Washer, Flat, 3/8", L9, Plt		each	10		
160	WLA10000	Washer, Lock, 10mm, 8.8, Plt		each	3		
170	WLA12000	Washer, Lock, 12mm, 8.8, Plt		each	2		
180	WLQ06000	Washer, Lock, 3/8", 8, Plt		each	5		
190	WLQ08000	Washer, Lock, 1/2", 8, Plt		each	4		

# Bill of Materials Listing

TransArctic Canada Inc.

4/27/2017  
Page 1 of 1

Product Number	Description	Date	Weight	Uof M	Yield
Line    Component    Prod#	Description	Bin                      Unit	Qty		
<b>KCB84094</b>	<b>Kit, Comp, 24V, ISL, HDX, FK40/ 4xFC,'13</b>		<b>9/9/2013</b>	<b>62.57</b>	<b>0</b>
10	BEL11040		Belt, A gr, 1040mm (41")	each	2
20	BMC83114		Bkt, PI, ALT Spacer, T3RE, '13	each	1
30	BMN80008		Vibration Isolator, Bar,16.50 x 2 x 1.50	each	2
40	BMN80025		Bkt, Back, PL, Slide, IC, RE300	each	1
50	BMT10011		Bkt, Tenr, Block, Offset, 3mm	each	2
60	BMZ00043		Bkt, Main, Base PI, '13	each	1
70	KBT84094		Kit, Platform, PS, 4xFC/ FK40, W/Alt,'13	each	1
80	PUL03321		Pulley, ALT, Idler, 3.25"d, 2A	each	1
90	TRD08120		Threaded, Rod, 1/2-13unc x 12", 5, Plt	each	1
100	KBZ84094		Bag Kit, Fasteners, KCB84094	each	1

# Bill of Materials Listing

TransArctic Canada Inc.

4/27/2017  
Page 1 of 1

Product Number	Description	Date	Weight	Uof M	Yield
Line    Component    Prod#	Description	Bin            Unit	Qty		
<b>KBZ84094</b>	<b>Bag Kit, Fasteners, KCB84094</b>	<b>10/18/2013</b>	<b>2.42</b>		<b>0</b>
10	BTP08653				
	Bolt, Hex, 1/2-13unc, 6.5", 5, Plt, FT	each	1		
20	BTQ08101				
	Bolt, Hex, 1/2-20unf, 1.00", 8, Plt	each	4		
30	BTQ08150				
	Bolt, Hex, 1/2-13unc, 1.5", 8, Plt	each	4		
40	BTQ08653				
	Bolt, Hex, 1/2-13unc, 6.5", 8, Plt	each	1		
50	CSF08076				
	Capscrew, FH, 1/2-20unf x .75", Alloy, Plt	each	2		
60	NTQ08000				
	Nut, Hex, 1/2-13unc, 8, Plt	each	7		
70	WFQ08000				
	Washer, Flat, 1/2", 8, Plt	each	10		
80	WLQ08000				
	Washer, Lock, 1/2", 8, Plt	each	12		

# Bill of Materials Listing

TransArctic Canada Inc.

4/27/2017  
Page 1 of 1

Product Number	Description	Date	Weight	Uof M	Yield
Line    Component    Prod#    Description	Bin	Unit	Qty		
<b>KBT84094</b>	<b>Kit, Platform, PS, 4xFC/ FK40, W/Alt,'13</b>	<b>9/9/2013</b>	<b>18.59</b>		<b>0</b>
10 BMC83131	Bkt, Weldm't, 4xFC W/ Alt, P-S, HDX, '13	each	1		
20 BMN80031	Bkt, Main, Slide, Assy, 05K, IC, RE300	each	1		
30 KBZ00010	Bag Kit, Fasteners, KBT84094/83990	each	1		

# Bill of Materials Listing

TransArctic Canada Inc.

4/27/2017  
Page 1 of 1

Product Number	Description	Date	Weight	Uof M	Yield
Line    Component    Prod#	Description	Bin            Unit	Qty		
<b>KBZ00010</b>	<b>Bag Kit, Fasteners, KBT84094/83990</b>		<b>11/6/2013</b>	<b>1.23</b>	<b>0</b>
10	BTC12040		Bolt, Hex, 12 x 1.75 x 40mm, 10.9,Plt,FT	each	4
15	BTC12060		Bolt, Hex, 12 x 1.75 x 60mm, 10.9,Plt,FT	each	4
20	NTP07000		Nut, Hex, 7/16-14unc, 5, Plt	each	4
30	WFA12000		Washer, Flat, 12mm, 8.8, Plt	each	8
40	WFN07000		Washer, Flat, 7/16", 2, Plt	each	4
50	WLA12000		Washer, Lock, 12mm, 8.8, Plt	each	4
60	WLP07000		Washer, Lock, 7/16", 5, Plt	each	4

# Bill of Materials Listing

TransArctic Canada Inc.

4/27/2017  
Page 1 of 1

Product Number	Description	Date	Weight	Uof M	Yield
Line    Component    Prod#	Description	Bin            Unit	Qty		
<b>KPC90009</b>	<b>Kit, Pulley, ISL-G, 8.9L, 2B/X,'17</b>		<b>10/15/2013</b>	<b>16.32</b>	<b>0</b>
10	PUL90009		Pulley, Crank, ISL-G, 9.0L, 2B/X, 8", '17	each	1
20	BTC12080		Bolt, Hex, 12 x 1.75 x 80mm, 10.9,Plt,FT	each	4
30	WFS12002		Washer, Flat, Hdn, 12mm, Stl, BLK	each	4

8 7 6 5 4 3 2 1

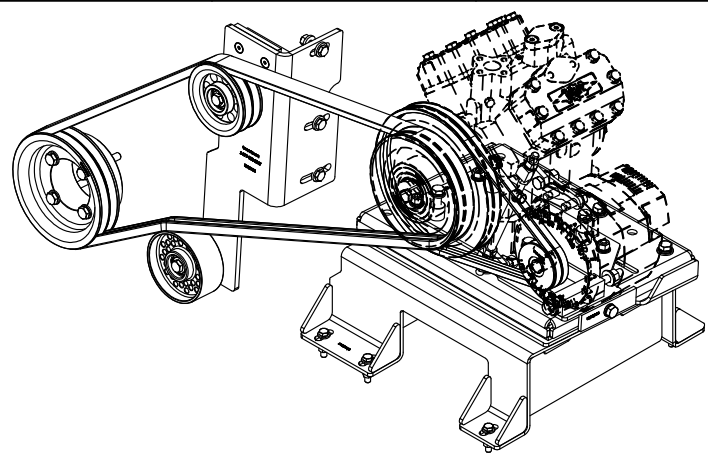
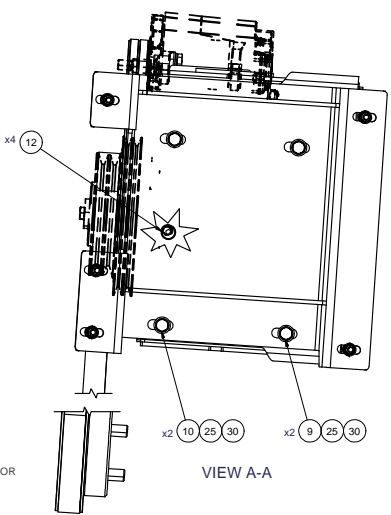
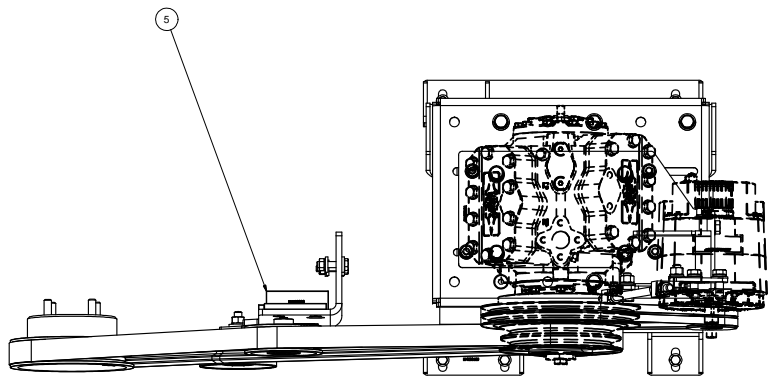

ISOMETRIC VIEW

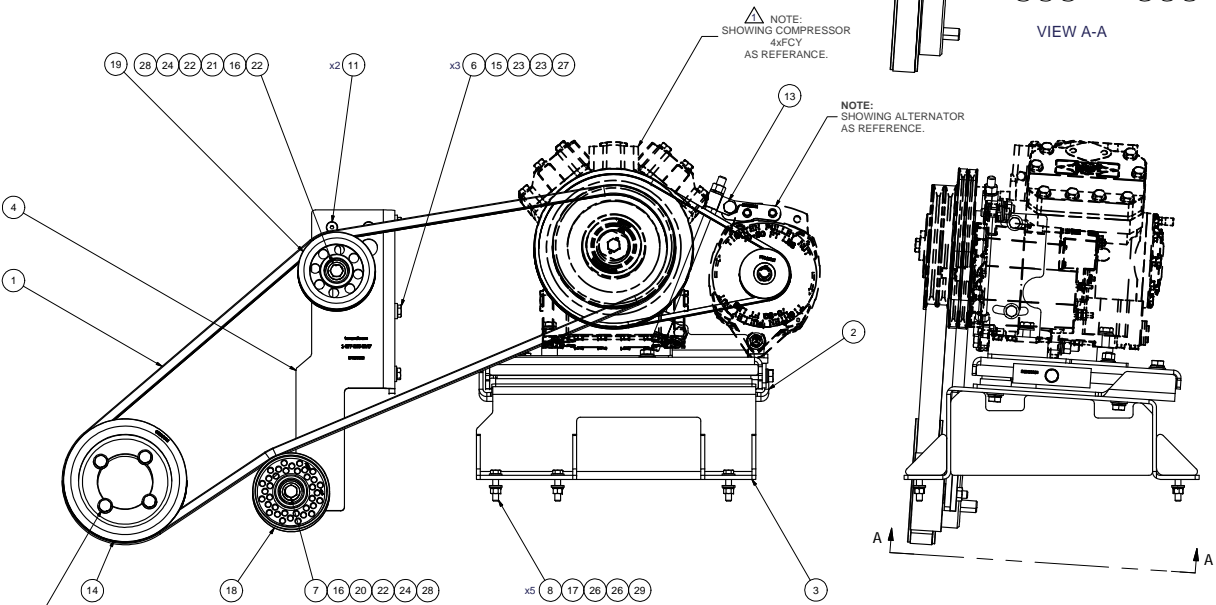

NOTE:  
SHOWING COMPRESSOR  
4xFCY  
AS REFERENCE.

NOTE:  
SHOWING ALTERNATOR  
AS REFERENCE.

NOTES:  
1) USE SERVICABLE THREADLOCKER ON ALL FASTENERS TO ENGINE COMPONENTS AND TORQUE ALL BOLTS TO S.A.E. SPECIFICATIONS.  
2) SEE "TRANSARGTIC A/C COMPRESSOR MOUNT INSTALLATION DISCLAIMER".

ITEM	QTY	U/M	PART NUMBER	DESCRIPTION
30	4	EACH	WLO88000	WASHER, LOCK, 1/2", 8, PLT
29	5	EACH	WLO84000	WASHER, LOCK, 3/8", 8, PLT
28	2	EACH	WLA12000	WASHER, LOCK, 12mm, 8.8, PLT
27	3	EACH	WLA10000	WASHER, LOCK, 10mm, 8.8, PLT
26	10	EACH	WFS06002	WASHER, FLAT, 3/8", L9, PLT
25	4	EACH	WFO80000	WASHER, FLAT, 1/2", 8, PLT
24	2	EACH	WFA12002	WASHER, FLAT, 12mm, HVY, 8.8, PLT
23	6	EACH	WFA10002	WASHER, FLAT, 10mm, HVY, 8.8, PLT
22	2	EACH	SLV17012	SLEEVE, PULLEY, 16.90 x 22.23 mm x12.19l
21	1	EACH	SCD21912	SPACER, COL, DRL, 21.9mm x 31.80 x12.3l
20	1	EACH	SCD16012	SPACER, COL, DRL, 16 mm x 31.80 x 12.0l
19	1	EACH	PLUA05012	PULLEY, ASSY, IDLER, B/BX, 5", STL, PLT
18	1	EACH	PLUA05001	PULLEY, ASSY, IDLER, B/S, 5", STL, PLT
17	5	EACH	NTQ06000	NUT, HEX, 3/8-16UNC, 8, PLT
16	2	EACH	NTA12000	NUT, HEX, 12 x 1.75, 8.8, PLT
15	3	EACH	NTA10000	NUT, HEX, 10 x 1.5, 8.8, PLT
14	1	EACH	KPC90009	KIT, PULLEY, ISL-G, 8.9L, 2B/X, '17
13	1	EACH	KCB84094	KIT, COMPRESSOR, 24V, PS, 4xFC, '13
12	4	EACH	CSF08101	CAPSCREW, FH, 1/2-20UNF x 1", ALLOY, PLT
11	2	EACH	CSF08031	CAPSCREW, FH, 8 x 1.25 x 30mm, 10.9, PLT
10	2	EACH	BTQ08151	BOLT, HEX, 1/2-20UNF x 1.50, 8, PLT
9	2	EACH	BTQ08125	BOLT, HEX, 1/2-13UNC x 1.25, 8, PLT
8	5	EACH	BTQ06175	BOLT, HEX, 3/8-16UNC, 1.75", 8, PLT
7	2	EACH	BTC12080	BOLT, HEX, 12 x 1.75 x 80mm, 10.9, PLT
6	3	EACH	BTC10045	BOLT, HEX, 10 x 1.5 x 45mm, 10.9, PLT
5	1	EACH	BMC90026	BKT, ALIGNMT BAR, ADD-ON, ISL-G, HDX, '17
4	1	EACH	BMC90022	BKT, MAIN, IDLER, WELDMT, ISL, HDX, '16
3	1	EACH	BMC83129	BKT, WELDMT, MAIN BASE, ISL, HDX, '13
2	1	EACH	BMC83125	BKT, WELDMT, ADAPTER PL, ISL, HDX, '13
1	1	EACH	BEL32389	BELT, BANDED B gr, 2389mm (9'4")

BILL OF MATERIALS  
**TRANSARGTIC INC.**

1	UPDATED NOTE(S)	7/11/2017	JRR
0	RELEASED TO PRODUCTION	4/20/2017	JRR
REV	DESCRIPTION	DATE	BY
1		4/20/2017	JRR
2		4/20/2017	GA
3		4/20/2017	JMS
4		4/20/2017	RM
5		4/20/2017	DM

BROWN  
jrodriquez  
4/21/2017  
CHECKED  
Val\_Jakowlew  
4/20/2017  
TITLE  
Jermes Stewart  
4/20/2017  
MT KIT, ISL-G, HDX, 4xFC, H.MOUNT,  
ALT, '16  
Ron Ingram  
4/20/2017  
APPROVED  
Date Mason  
4/20/2017

MT KIT, ISL-G, HDX, 4xFC, H.MOUNT,  
ALT, '16  
DWG NO  
KMC44094  
REV  
1  
SCALE 1:4  
SHEET 1 OF 1

NOTE:  
TORQUE TO: 66-73 FT-LB PLAIN & LUBRICATED W/ CLEAN ENGINE OIL (15W-40)  
(HEXBOLT CAPSCREW M12 x 1.75 x 80mm @ 10.9 GRADE)  
TIGHTEN IN TWO STEPS IN A CRIS-CROSS TIGHTENING SEQUENCE PATTERN.

UNSPECIFIED TOLERANCES:  
ONE DECIMAL PLACE (X10) 0.10 (FRACTIONAL)  
TWO DECIMAL PLACE (X100) 0.01 (FRACTIONAL)  
THREE DECIMAL PLACE (X1000) 0.001 (FRACTIONAL)  
ANGULAR 0.1°



DRAWING UNIT OF MEASURE: MM (INCH)

8 7 6 5 4 3 2 1



**TOP VIEW**

PARTS REMOVED FOR CLARITY.

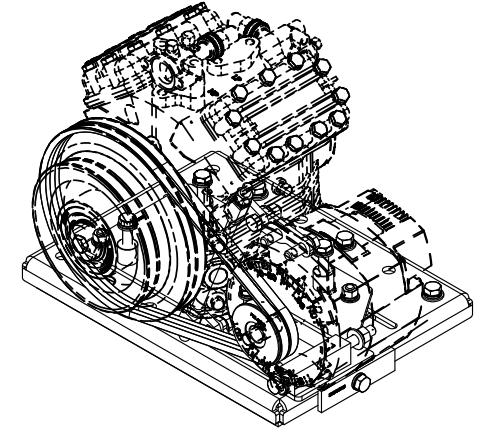
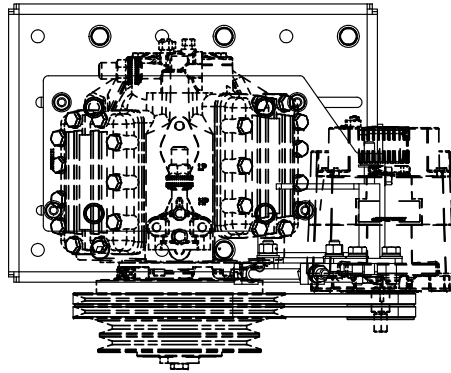
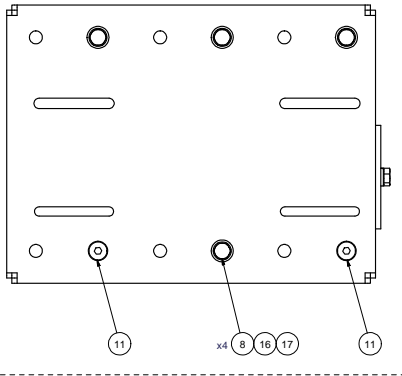

ISOMETRIC VIEW

NOTE:  
SHOWING COMPRESSOR  
4xFCY OR  
FK40 xxx  
AS REFERENCE.

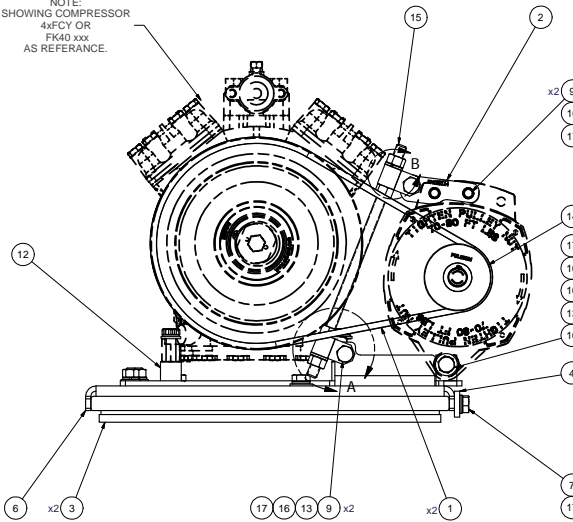

DETAIL B  
SCALE 1/2

DETAIL A  
SCALE 1/2

**NOTES:**

- 1) USE SERVICABLE THREADLOCKER ON ALL FASTENERS TO ENGINE COMPONENTS AND TORQUE ALL BOLTS TO S.A.E. SPECIFICATIONS.
- 2) SEE 'TRANSARCtic A/C COMPRESSOR MOUNT INSTALLATION DISCLAIMER'.
- 3) WEIGHT: 56.70 LBS.

ITEM	QTY	U/M	PART NUMBER	DESCRIPTION
17	12	EACH	WLO08000	WASHER, LOCK, 1/2", 8, PLT
16	10	EACH	WFO08000	WASHER, FLAT, 1/2", 8, PLT
15	1	EACH	TRD08120	THREADED, ROD, 1/2-13UNC x 12", 5 PLT
14	1	EACH	PUL03321	PULLEY, ALT, IDLER, 3.25"o, 2A
13	7	EACH	NT008000	NUT, HEX, 1/2-13UNC, 8, PLT
12	1	EACH	K8T84094	KIT, PLATFORM, PS, 4xFCY/ FK40, W/ ALT, '13
11	2	EACH	CSF00076	CAPSCREW, FH, 1/2-20UNF x .75", ALLOY, PLT
10	1	EACH	BT008653	BOLT, HEX, 1/2-13UNC x 6.50, 8, PLT
9	4	EACH	BT008150	BOLT, HEX, 1/2-13UNC x 1.50, 8, PLT
8	4	EACH	BT008101	BOLT, HEX, 1/2-20UNF x 1.00, 8, PLT
7	1	EACH	BT008653	BOLT, HEX, 1/2-13UNC x 6.50, 5, PLT, FT
6	1	EACH	BMZ00043	BKT, MAIN, BASE PL, '13
5	2	EACH	BMT10011	BKT, TENR, BLOCK, OFFSET, 3mm
4	1	EACH	BMN80025	BKT, BACK, PL, SLIDE, IC, RE300
3	2	EACH	BMN80008	VIBRATION ISOLATOR, BAR, 16.50 x 2 x 1.50
2	1	EACH	BMCS3114	BKT, PL, ALT, SPACER, T3RE, '13
1	2	EACH	BELT1040	BELT, A, gr, 1040mm (41") (17410)

**BILL OF MATERIALS**

DRAWN: jrodriquez  
CHECKED: Val\_Jakowlew

DATE: 9/9/2013

**TRANSARCtic INC.**

REV	DESCRIPTION	DATE	BY
0	RELEASED TO PRODUCTION	9/9/2013	JRR
1		9/9/2013	GA
2		9/9/2013	JStewart
3		9/9/2013	RIngram
4		9/9/2013	DaleMason

TITLE: KIT, COMPRESSOR, 24V, PS, FK40/4xFC, '13

SIZE: D DWG NO: KCB84094 REV: 0

UNSPECIFIED TOLERANCES: ALL DIMS  
ONE DECIMAL PLACE (X. ) .00 (FRACTIONAL)  
TWO DECIMAL PLACES (.XX) .00 (FRACTIONAL)  
THREE DECIMAL PLACES (.XXX) .000 (FRACTIONAL)  
FOUR DECIMAL PLACES (.XXXX) .0000 (FRACTIONAL)



DRAWING UNIT OF MEASURE: MM (INCH) SCALE: 1:3 SHEET 1 OF 1

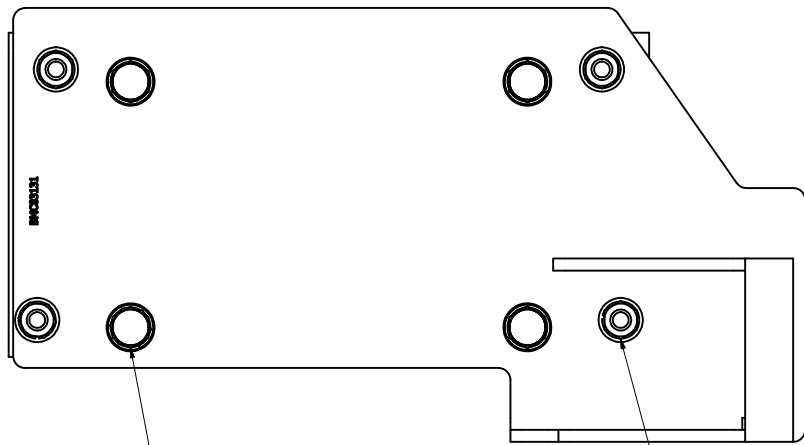

△x4 3 4 6 8

NOTE:  
USE 40mm OR 60mm LONG  
BOLT(S) DEPENDING ON  
COMPRESSOR BODY STYLE.

x4 5 7 9

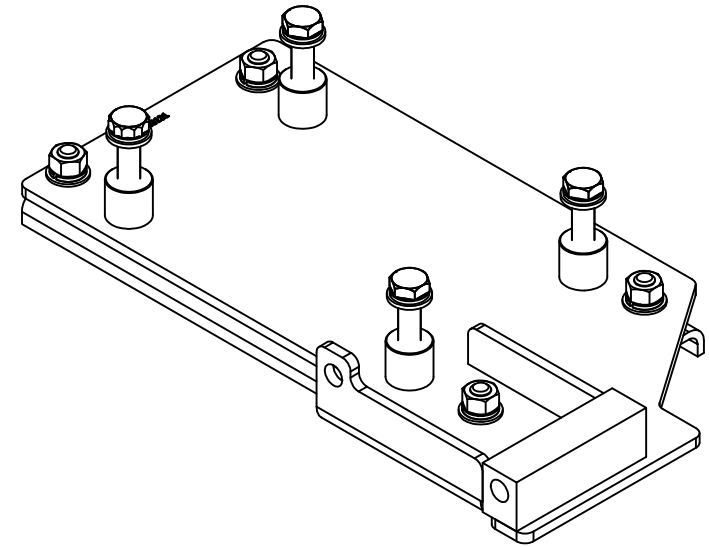

ISOMETRIC VIEW

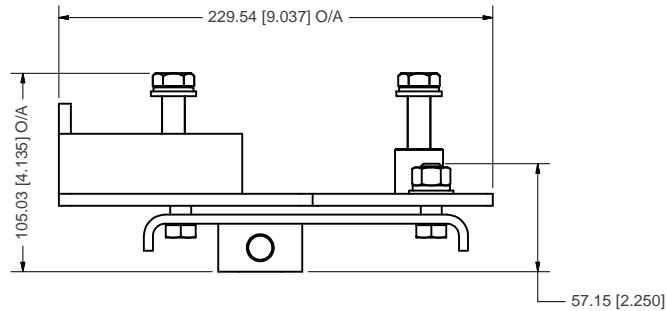
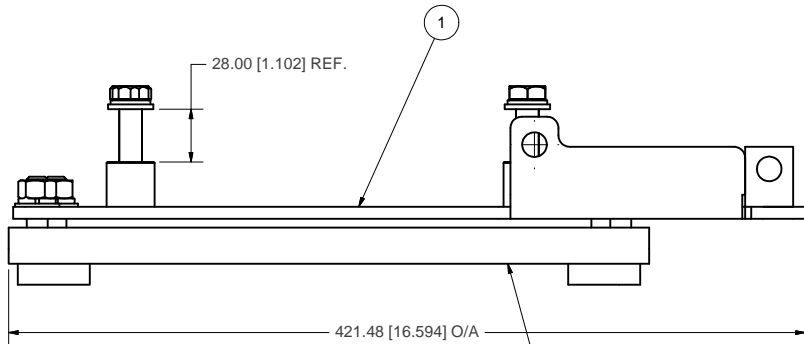

ITEM	QTY	U/M	PART NUMBER	DESCRIPTION
9	4	EACH	WLP07000	WASHER, LOCK, 7/16", 5, PLT
8	4	EACH	WLA12000	WASHER, LOCK, 12mm, 8.8, PLT
7	4	EACH	WFN07000	WASHER, FLAT, 7/16", 2, PLT
6	4	EACH	WFA12000	WASHER, FLAT, 12mm, 8.8, PLT
5	4	EACH	NTP07000	NUT, HEX, 7/16-14UNC, 5, PLT
4	4	EACH	BTC12060	BOLT, HEX, 12 x 1.75 x 60mm, 10.9, PLT
3	4	EACH	BTC12040	BOLT, HEX, 12 x 1.75 x 40mm, 10.9, PLT
2	1	EACH	BMN80031	BKT, MAIN, SLIDE, ASSY, 05K, IC, RE300
1	1	EACH	BMC83131	BKT, WELDM'T, 4xFCY W/ALT, P-S, HDX, '13

BILL OF MATERIALS

DRAWN	jrodriguez	9/5/2013
CHECKED	Val Jakowlew	9/5/2013
REV/ECN:	DESCRIPTION:	DATE:
MFG	Ron Ingram	9/5/2013
APPROVED	Dale Mason	9/5/2013

**TRANSARCTIC INC.**

TITLE: KIT, PLATFORM, PS, 4xFCY/ FK40, W/ ALT, '13

SIZE: C DWG NO: KBT84094 REV: 0

DRAWING UNIT OF MEASURE:	MM [INCH]	SCALE:	1:2	SHEET:	1	OF:	1
--------------------------	-----------	--------	-----	--------	---	-----	---

- NOTES:
- 1) USE SERVICABLE THREADLOCKER ON ALL FASTENERS TO ENGINE COMPONENTS AND TORQUE **ALL** BOLTS TO S.A.E. SPECIFICATIONS.
  - 2) SEE "TRANSARCTIC A/C COMPRESSOR MOUNT INSTALLATION DISCLAIMER".
  - 3) WEIGHT: 18.22 LBS.

0	ADDED 4x BTC12040 BOLTS.	6/5/2014	JRR
A	RELEASED TO PROTOTYPE.	9/5/2013	JRR

THIS DRAWING CONTAINS PROPRIETARY CONFIDENTIAL INFORMATION OWNED BY TRANSARCTIC CANADA INC. THE DOCUMENT AND THE INFORMATION IN IT ARE NOT TO BE USED, DISCLOSED OR REPRODUCED WITHOUT EXPRESS WRITTEN PERMISSION OF THE COMPANY.

UNSPECIFIED TOLERANCES: [ALT. DIM.]  
 ONE DECIMAL PLACE (.X) .50 [0.020]  
 TWO DECIMAL PLACE (.XX) .25 [0.010]  
 THREE DECIMAL PLACE (.XXX) .10 [0.005]

THIRD ANGLE PROJECTION

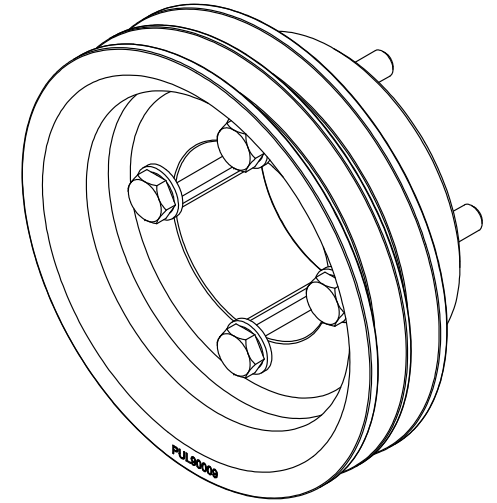
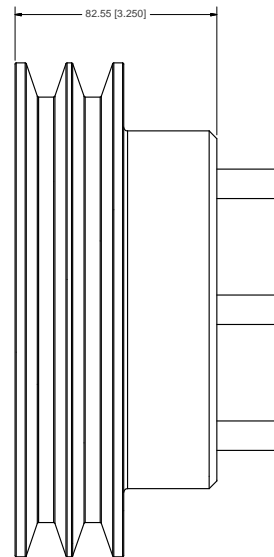
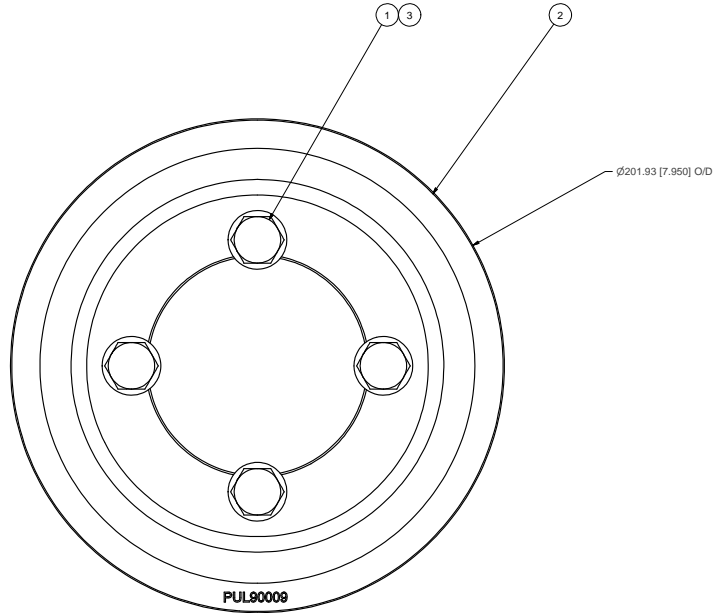

- NOTES:**
- 1) USE SERVICABLE THREADLOCKER ON ALL FASTENERS TO ENGINE COMPONENTS AND TORQUE ALL BOLTS TO S.A.E. SPECIFICATIONS.
  - 2) SEE 'TRANSARCTIC A/C COMPRESSOR MOUNT INSTALLATION DISCLAIMER'.
  - 3) WEIGHT: 16.41 LB

ITEM	QTY	U/M	PART NUMBER	DESCRIPTION
3	4	EACH	WFS12002	WASHER, FLAT, HDN, 12mm, STL, BLK
2	1	EACH	PUL90009	PULLEY, CRANK, ISL-G, 8.9L, 2B/X, 8", 17"
1	4	EACH	BTCT2080	BOLT, HEX, 12 x 1.75 x 80mm, 10.9, FLT

**BILL OF MATERIALS**

DRAWN	JRodriguez	12/16/2016	<b>TRANSARCTIC INC.</b>	
CHECKED	Jose Rodriguez	12/16/2016		
REV	CA			
RELEASED TO PRODUCTION	12/16/2016	RR	TITLE	
DESCRIPTION	DATE	BY	MFG	
APPROVED	12/16/2016	James Stewart	KIT, PULLEY, ISL-G, 8.9L, 2B/X, 17"	
DATE	12/16/2016	Dale Mason	DATE	12/16/2016
UNSPECIFIED TOLERANCES:		ALL DIMS	DWG NO	
ONE DECIMAL PLACE (X.0)	±0.05	FRACTIONAL (X/16)	KPC90009	
TWO DECIMAL PLACE (X.00)	±0.02	ANGULAR (±.05°)	REV	
THREE DECIMAL PLACE (X.000)	±0.01		0	
FRACTIONAL (X/32)	±0.005		SCALE	
			1:1	
THIRD ANGLE PROJECTION		DRAWING UNIT OF MEASURE		SHEET
		MM (INCH)		1 OF 1

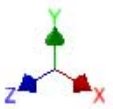
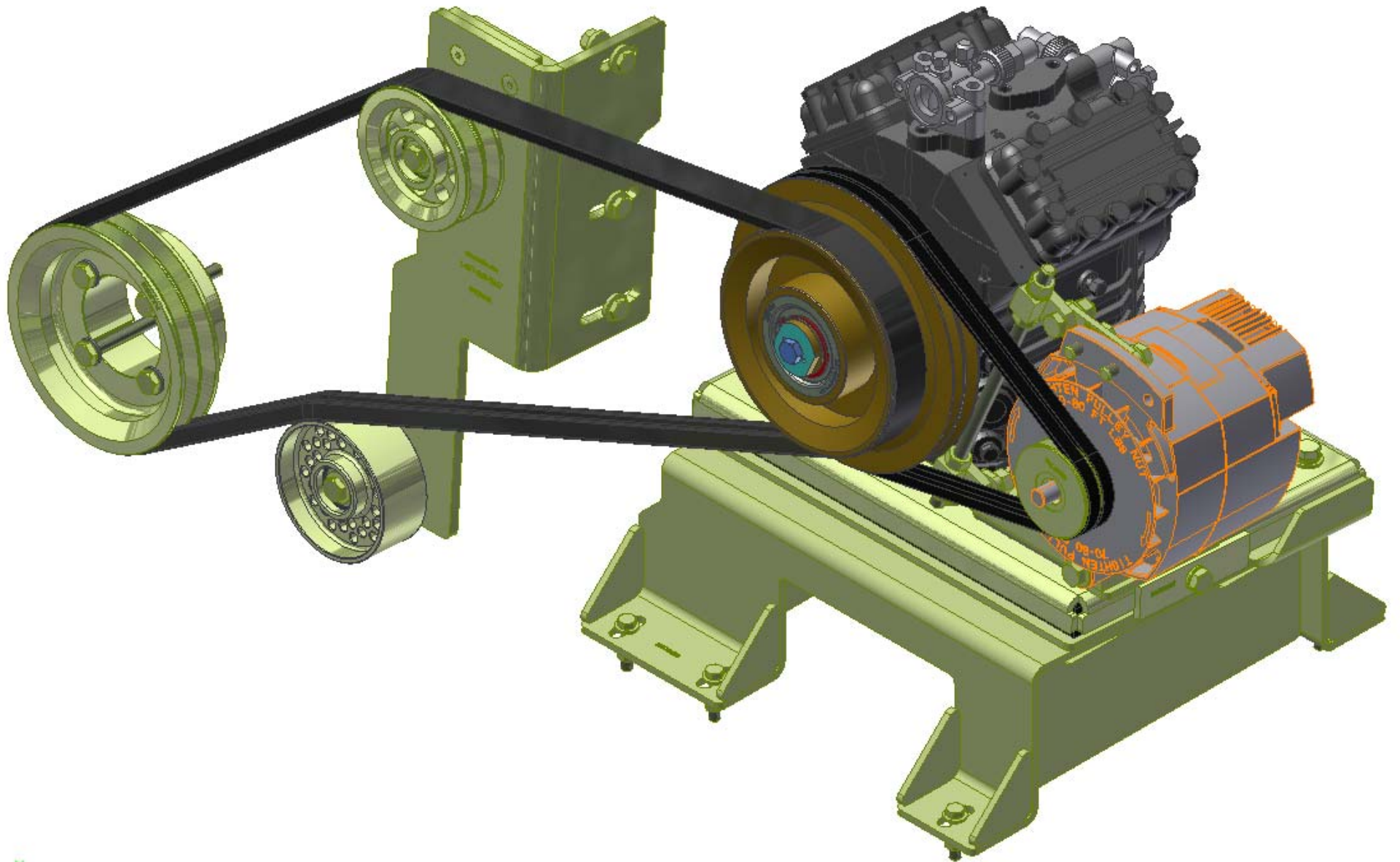

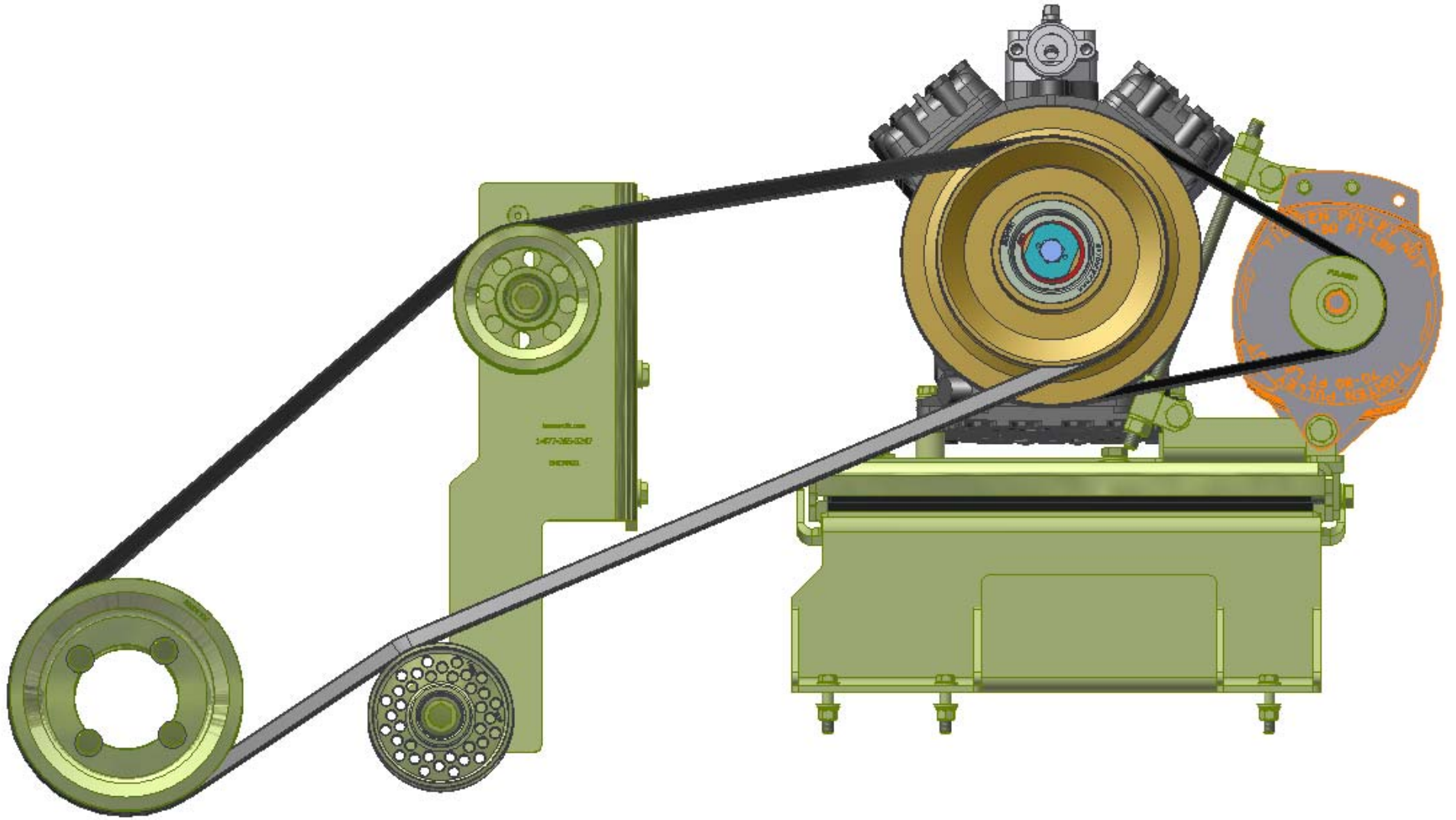

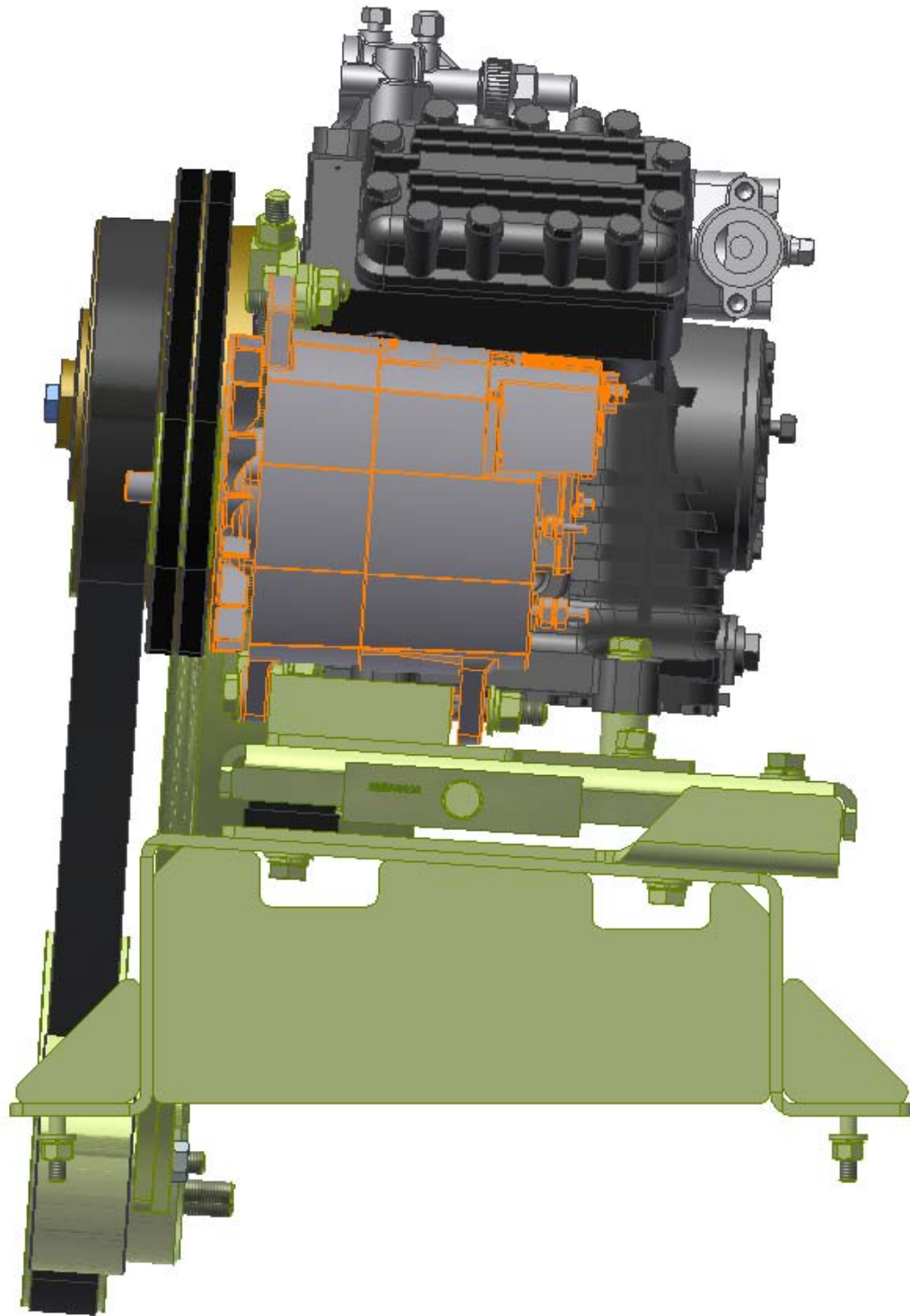

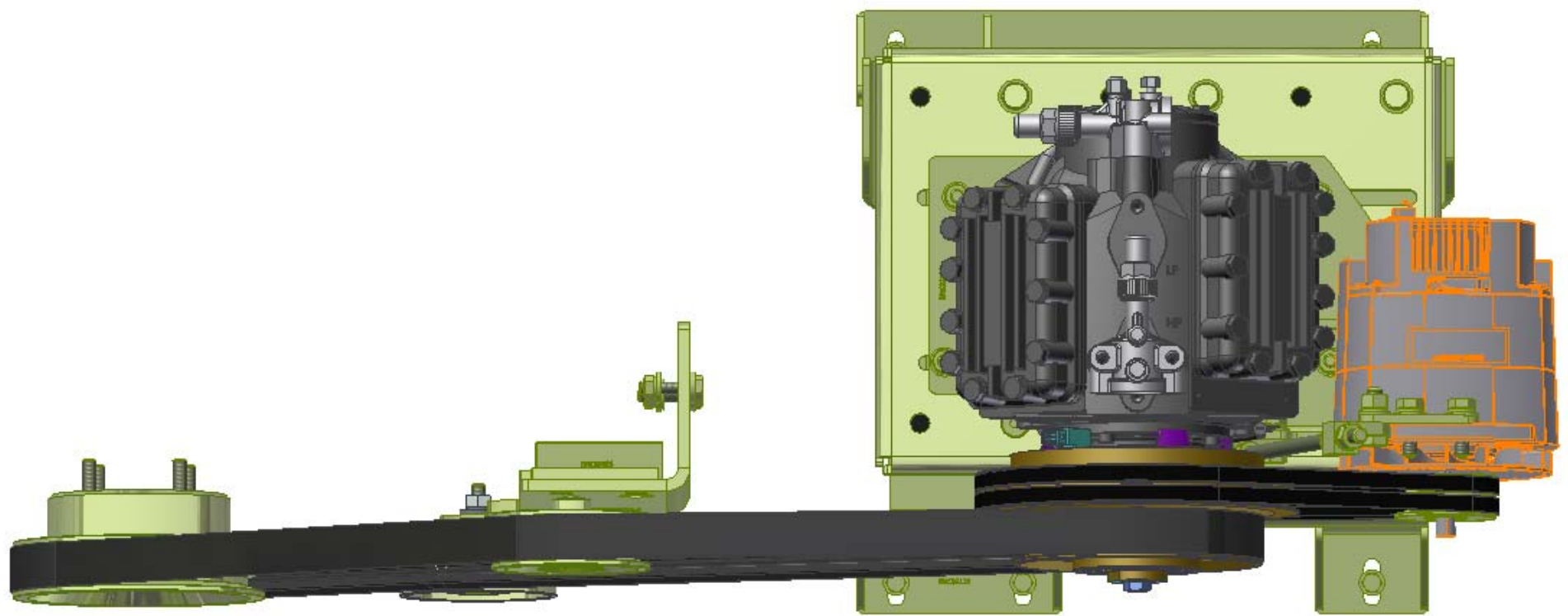

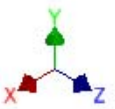
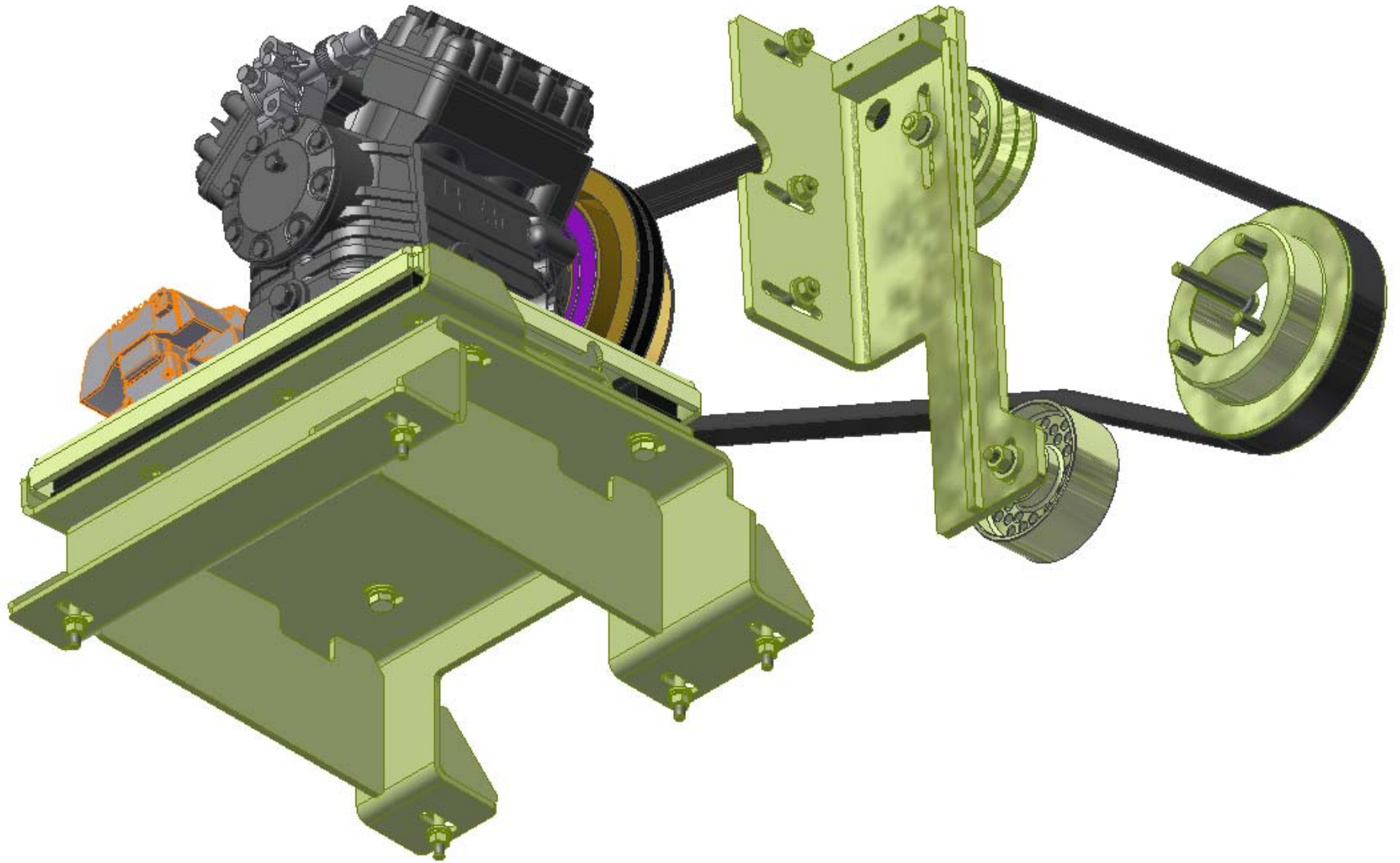



## **TransArctic A/C Compressor Mount Installation Disclaimer**

All compressor mounts should be installed by qualified and trained personnel using proper tools and equipment in safe working conditions following industry standard guidelines for motor vehicle service and repair.

The installer of any compressor mount purchased from TransArctic must undertake all responsibility of issues arising from that compressor bracket being installed on any vehicle. As well as insure that a **proper and sufficient ground** is established between the compressors' clutches and the vehicle's engine. Mount functionality, operation and durability can all be compromised by an incompetent installation.

Due to the many different situations, parameters and application criteria, which are beyond the compressor mount manufacturer's control, TransArctic does not warrant design, durability, or operational functionality of any compressor mount improperly installed by another party.

**With no implied guarantees it is the mount installer's strict responsibility to determine safety and functionality, of the compressor mount, at the time of installation.**

Please contact TransArctic with any issue arising from installation so we may better improve the product. If you have any reservations about the compressor mount integrity contact TransArctic immediately at 1-877-COLD-AIR.

**Mark OEM tensioner location**

**Install Kit**

**Check for Interferences**

**Check to ensure that the proper OEM tensioner orientation is maintained**

**Run engine with A/C system engaged for at least 10 minutes to run in belt**

**Check OEM tensioner orientation and adjust as required**

### **Responsabilidad limitada de TransArctic en la instalación del soporte del compresor**

Todos los soportes de los compresores deben ser instalados por personas calificadas y entrenadas, usando para ello los equipos y herramientas necesarios para esta labor en buenas condiciones y según las normas y guías para el servicio y/o reparación de motores de vehículos.

El instalador de los soportes comprados en TransArctic asume toda la responsabilidad de cualquier problema que surga en el soporte del compresor al vehículo; de igual manera es responsable que el cable a tierra sea conectado entre el embrague del compresor y el motor del vehículo.

Se advierte que el buen funcionamiento y la durabilidad del soporte pueden ser comprometidos por defectos en su instalación.

Debido a las diversas situaciones que se puedan presentar fuera del control del fabricante, TransArctic no garantiza el diseño, la durabilidad o el correcto funcionamiento de cualquier equipo inapropiadamente instalado por terceros.

**Esta sobreentendido que el Instalador del montaje del compresor es estrictamente responsable de la seguridad y funcionamiento del equipo en el momento de la instalación.**

Si tuviera algún problema o duda acerca de la instalación del soporte del compresor pongase en contacto inmediatamente con TransArctic al teléfono 1-877-COLD-AIR de modo que podamos mejorar nuestro producto.

**Note la ubicación del medidor de tensión OEM**

**Instale el equipo**

**Controlar si hay interferencias.**

**Asegure que el medidor de tensión mantenga la orientación justa.**

**Encienda el motor por lo menos 10 minutos con el sistema A/C enganchado para que la correa corra**

**Controle la orientación justa del medidor de tensión y ajuste a las condiciones requeridas del fabricante**