

Bill of Materials Listing

TransArctic Canada Inc.

6/20/2017
Page 1 of 1

Product Number		Description	Bin	Date	Weight	Uof M	Yield
Line	Component Prod#	Description		Unit	Qty		
KMC85562		Mt Kit, ISC/L,T3RE,TM55/65,M/AFI,'00-'07		6/8/2017	47.34		0
10	BEL81537	Belt, 8gr, 1537mm (60.5")		each	1		
20	BEL81842	Belt, 8gr, 1842mm (72.5")		each	1		
30	BMC83011	Bkt, Brace, RR, Tenr, ISC, 8.3L, P8		each	1		
40	BMC83012	Bkt, Brace, P/S, ISC, 8.3L, P8		each	1		
50	BMC83013	Bkt, Main, Weldmt, ISC, 8.3L, P8		each	1		
60	BMC83079	Bkt, Brace, MAN-FI, P/S, ISC, 8.3L, P8		each	1		
70	BMC83092	Bkt, Adapter, PI, ISC, TM-55, D3RE, '12		each	1		
80	PUL80076	Pulley, Idler, Backside, P8, 76d (89101)		each	1		
90	PUL81074	Pulley, Idler, Frontside, P8,74d (89103)		each	1		
100	SCD25412	Spacer, Col, Drl,25.4mm x 25.4o x 12.3i		each	1		
110	SCD57210	Spacer, Col, Drl,57.15mm x28.58o x10.32i		each	1		
120	SLV17010	Sleeve, Pulley, 16.9o x 22.23mm x 10.32i		each	2		
130	TEN80002	Tenr, HD Spring, BackSide, CCW (89200A)		each	1		
140	KBC85562	Bag Kit, Fasteners, KMC85562		each	1		

Bill of Materials Listing

TransArctic Canada Inc.

6/20/2017
Page 1 of 1

Product Number	Description	Date	Weight	Uof M	Yield
Line Component Prod#	Description	Bin Unit	Qty		
KBC85562	Bag Kit, Fasteners, KMC85562	6/8/2017	1.42		0
10	BTC08030	Bolt, Hex, 8 x 1.25 x 30mm, 10.9, Plt,FT	each	6	
20	BTC10030	Bolt, Hex, 10 x 1.5 x 30mm, 10.9, Plt	each	2	
30	BTC10040	Bolt, Hex, 10 x 1.5 x 40mm, 10.9, Plt,FT	each	2	
40	BTC10050	Bolt, Hex, 10 x 1.5 x 50mm, 10.9, Plt	each	2	
45	BTC10090	Bolt, Hex, 10 x 1.5 x 90mm, 10.9, Plt	each	1	
50	BTC10100	Bolt, Hex, 10 x 1.5 x 100mm, 10.9,Plt,FT	each	2	
60	CSF10041	Capscrew, FH, 10 x 1.5 x 40mm, 10.9,Plt	each	1	
70	CSF12036	Capscrew, FH, 12 x 1.75 x 35mm, 10.9,Plt	each	4	
80	CSS10055	Capscrew, SH, 10 x 1.5 x 55mm, 12.9,Plt	each	1	
90	NTA10000	Nut, Hex, 10 x 1.5, 8.8, Plt	each	2	
100	WFA08000	Washer, Flat, 8mm, 8.8, Plt	each	6	
110	WFA10000	Washer, Flat, 10mm, 8.8, Plt	each	2	
120	WLA08000	Washer, Lock, 8mm, 8.8, Plt	each	6	
130	WLA10000	Washer, Lock, 10mm, 8.8, Plt	each	8	

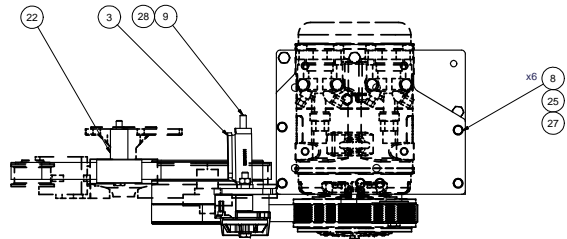

NOTE:
 -FOR USE ON ENGINE WITH
 RADIATOR ASSY' ON DRIVER SIDE.
 -RELOCATE CAC TUBE (TO SUIT) BY
 OTHERS.

NOTE:
 SHOWING TRANSARCTIC
 COMPRESSOR PART#
 CMV33680 (TM-55) 12V
 CMV38880 (TM-65) 12V
 AS REFERENCE.
 CMV33681 (TM-55) 24V
 CMV38881 (TM-65) 24V

NOTE:
 -REUSE (4) EXISTING
 OEM 'FAN' PULLEY BOLTS.
 -DISCARD OEM 'FAN' PULLEY
 AND CLAMPING RING.

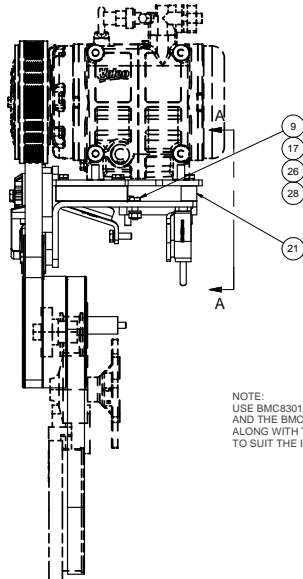
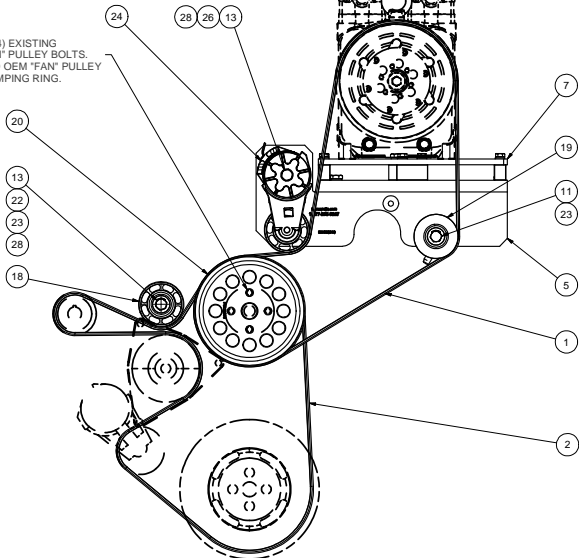

NOTE:
 USE BMC83012 ON A AUTO-FI ENGINE
 AND THE BMC83079 ON A MAN-FI ENGINE,
 ALONG WITH THE PROPER FASTENERS
 TO SUIT THE INSTALL.

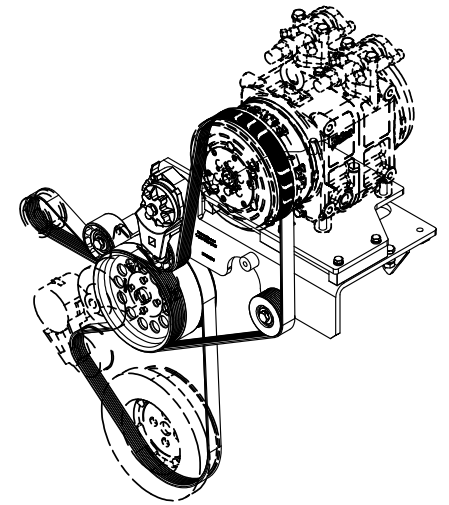
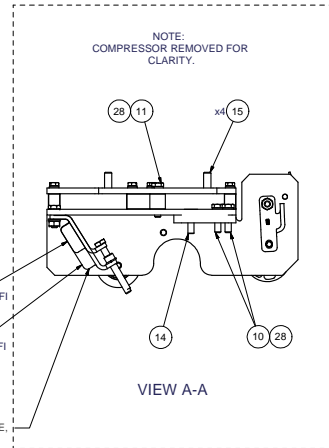

ISOMETRIC VIEW

ITEM	QTY	U/M	PART NUMBER	DESCRIPTION
28	8	EACH	WLA10000	WASHER, LOCK, 10mm, 8.8, PLT
27	6	EACH	WLA80000	WASHER, LOCK, 8mm, 8.8, PLT
26	2	EACH	WFA10000	WASHER, FLAT, 10mm, 8.8, PLT
25	6	EACH	WFA80000	WASHER, FLAT, 8mm, 8.8, PLT
24	1	EACH	TEN80002	TENR, HD SPRING, BACKSIDE, CCW
23	2	EACH	SLV17010	SLEEVE, PULLEY, 16.9x x 22.23mm x 10.32i
22	1	EACH	SCD57210	SPACER, COL, DRL, 57.15mm x28.58o x10.32i
21	1	EACH	SCD25412	SPACER, COL, DRL, 25.4mm x 25.4o x 12.3i
20	1	EACH	PUL83088	Pulley, Fan, Add-on, Combo, ISC, 8.3, 8g
19	1	EACH	PUL81074	PULLEY, IDLER, FRONTSIDE, P8, 74d x 39w
18	1	EACH	PUL80076	PULLEY, IDLER, BACKSIDE, P8, 76D, 39W
17	2	EACH	NTA10000	NUT, HEX, 10 x 1.5, 8.8, PLT
16	1	EACH	CS510055	CAPSCREW, SH, 12 x 1.25 x 55mm, 12.9, PLT
15	4	EACH	CSF12036	CAPSCREW, FH, 12 x 1.75 x 35mm, 10.9, PLT
14	1	EACH	CSF10041	CAPSCREW, FH, 10 x 1.5 x 40mm, 10.9, PLT
13	2	EACH	BTC10100	BOLT, HEX, 10 x 1.5 x 100mm, 10.9, PLT
12	1	EACH	BTC10090	BOLT, HEX, 10 x 1.5 x 90mm, 10.9, PLT
11	2	EACH	BTC10050	BOLT, HEX, 10 x 1.5 x 50mm, 10.9, PLT
10	2	EACH	BTC10040	BOLT, HEX, 10 x 1.5 x 40mm, 10.9, PLT
9	2	EACH	BTC10030	BOLT, HEX, 10 x 1.5 x 30mm, 10.9, PLT
8	6	EACH	BTC08030	BOLT, HEX, 8 x 1.25 x 30mm, 10.9, PLT
7	1	EACH	BMC83092	BKT, ADAPT, PL, ISC, TM55/43, T/D/A3RE, '12
6	1	EACH	BMC83079	BKT, BRACE, MAN-FI, P/S, ISC, 8.3L, P8
5	1	EACH	BMC83013	BKT, MAIN, WELDMT, ISC, 8.3L, P8
4	1	EACH	BMC83012	BKT, BRACE, P/S, ISC, 8.3L, P8
3	1	EACH	BMC83011	BKT, BRACE, RR, TENR, ISC, 8.3L, P8
2	1	EACH	BEL61842	BELT, 8g, 1842mm (72.5")
1	1	EACH	BEL1537	BELT, 8GR, 1537mm (60.5")

BILL OF MATERIALS			
DRAWN	Jose Rodriguez	5/29/2017	TRANSARCTIC INC.
CHECKED	Val Jakovlew	5/29/2017	
RELEASED TO PRODUCTION	5/29/2017	BY	TITLE
REVISION	DESCRIPTION	DATE	BY
1		5/29/2017	Jorge Stewart
2		5/29/2017	Ron Ingram
3		5/29/2017	Dale Mason

THIS DRAWING CONTAINS PROPRIETARY CONFIDENTIAL INFORMATION OWNED BY TRANSARCTIC CANADA INC. THE DOCUMENT AND THE INFORMATION IT IS ARE NOT TO BE USED, DISCLOSED OR REPRODUCED WITHOUT EXPRESS WRITTEN PERMISSION OF THE COMPANY.

UNSPECIFIED TOLERANCES:	FRAC TIONAL	DECIMAL	ANGULAR
ONE DECIMAL PLACE (X.0)	±.01	±.005	±.01
TWO DECIMAL PLACE (X.00)	±.005	±.002	±.01
THREE DECIMAL PLACE (X.000)	±.002	±.001	±.01

THIRD ANGLE PROJECTION	DRAWING UNIT OF MEASURE	MM (INCH)	SCALE	1:4	DWG NO	KMC85562	REV	0
------------------------	-------------------------	-----------	-------	-----	--------	----------	-----	---

NOTES:
 1) USE SERVICABLE THREADLOCKER ON ALL FASTENERS TO ENGINE COMPONENTS AND TORQUE ALL BOLTS TO S.A.E. SPECIFICATIONS.
 2) SEE 'TRANSARCTIC A/C COMPRESSOR MOUNT INSTALLATION DISCLAIMER'.

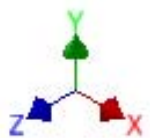
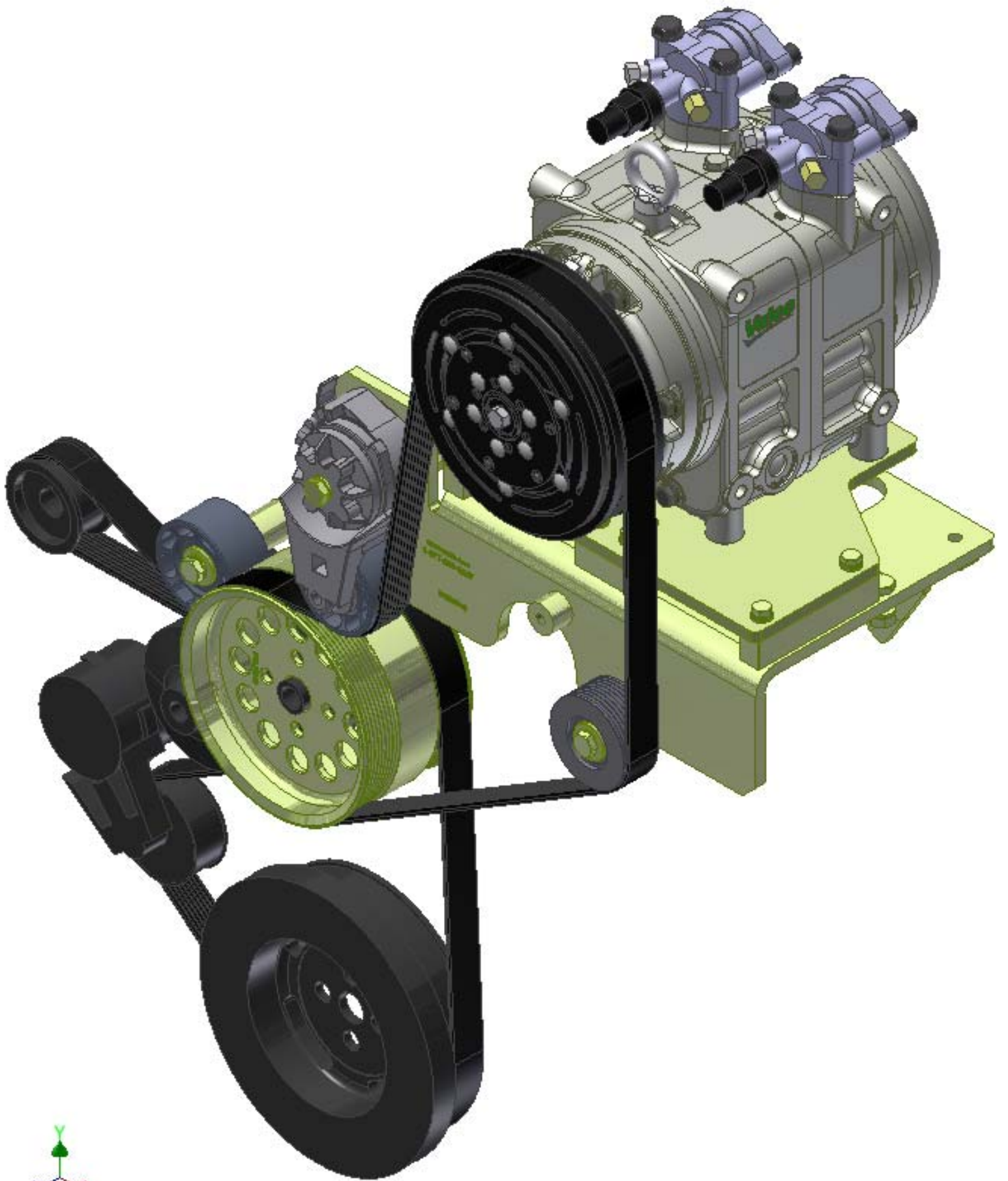

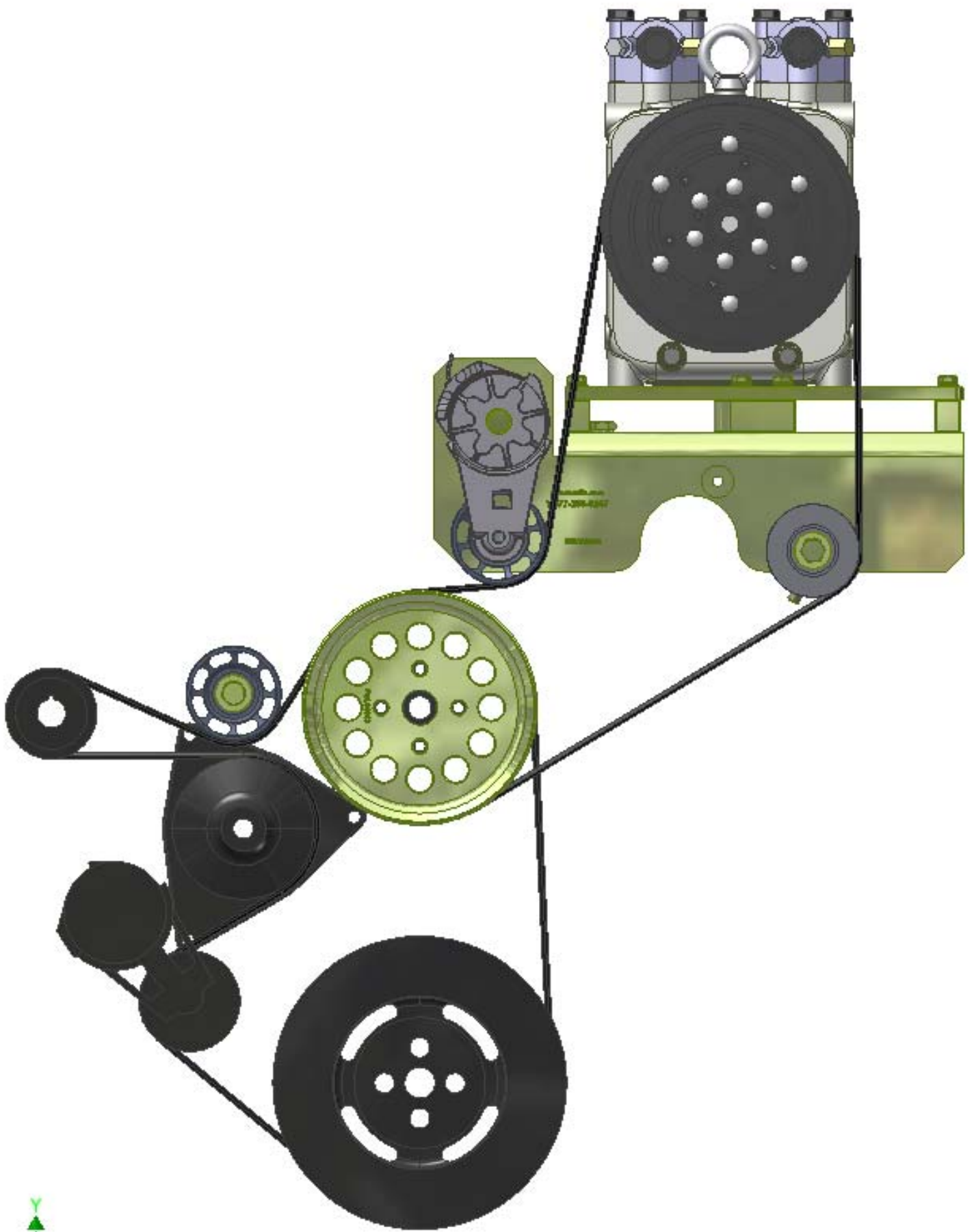

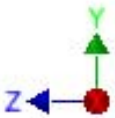
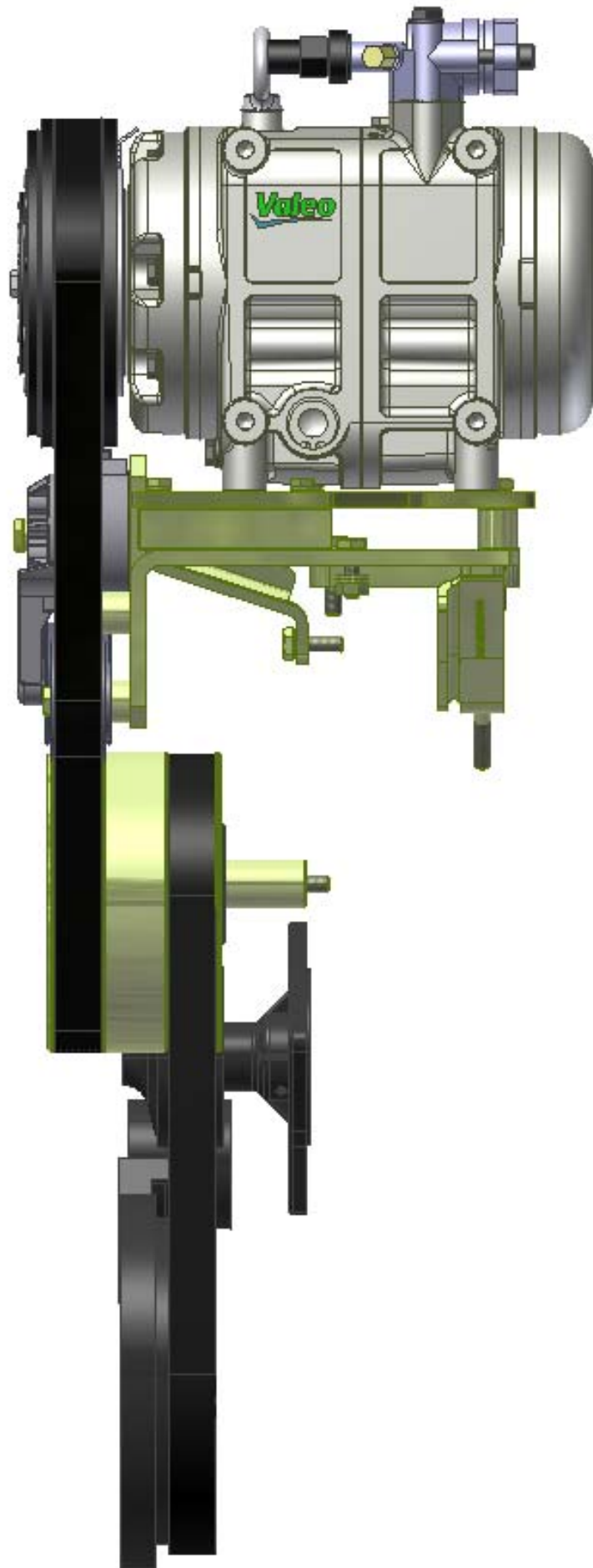

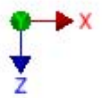
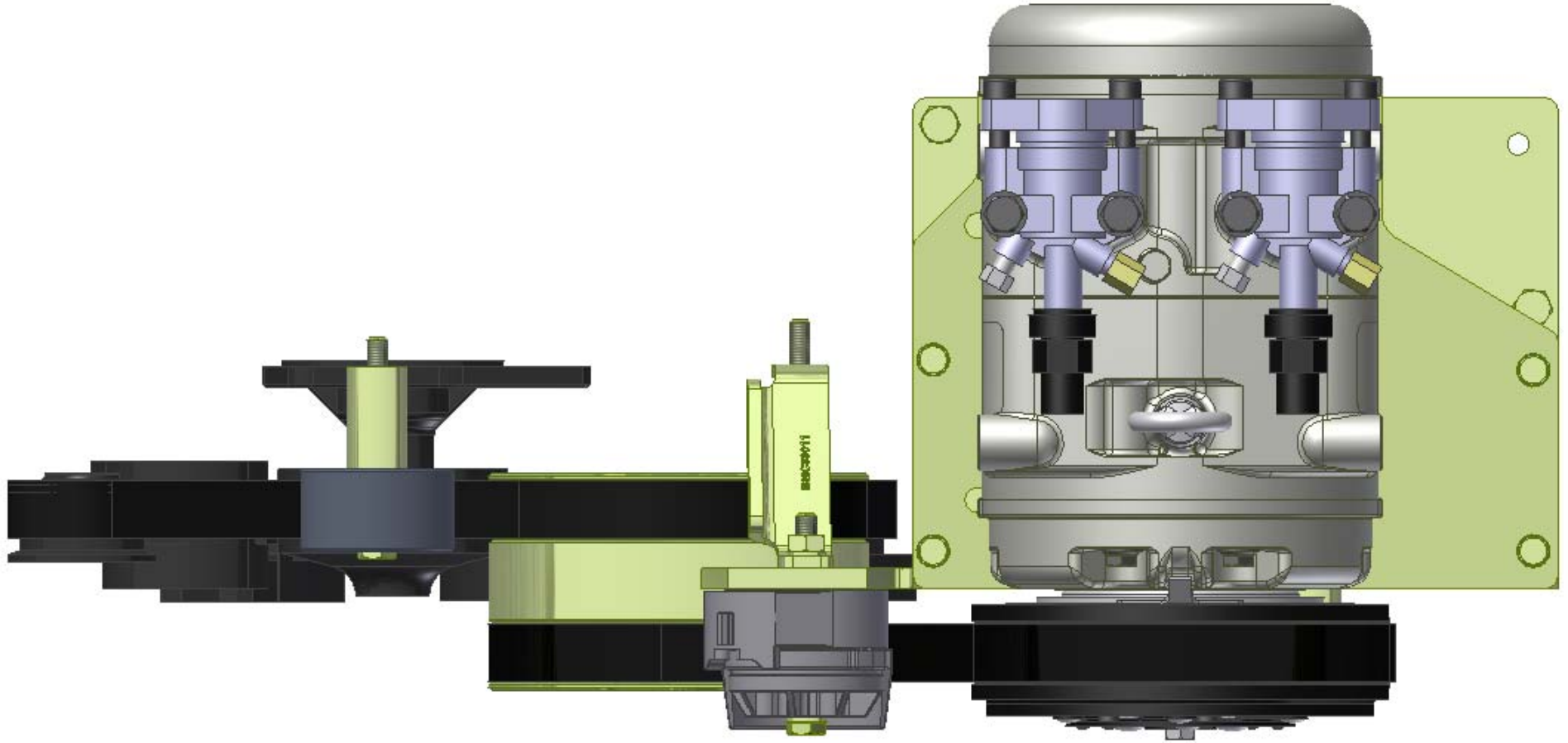

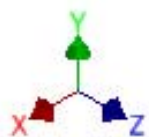
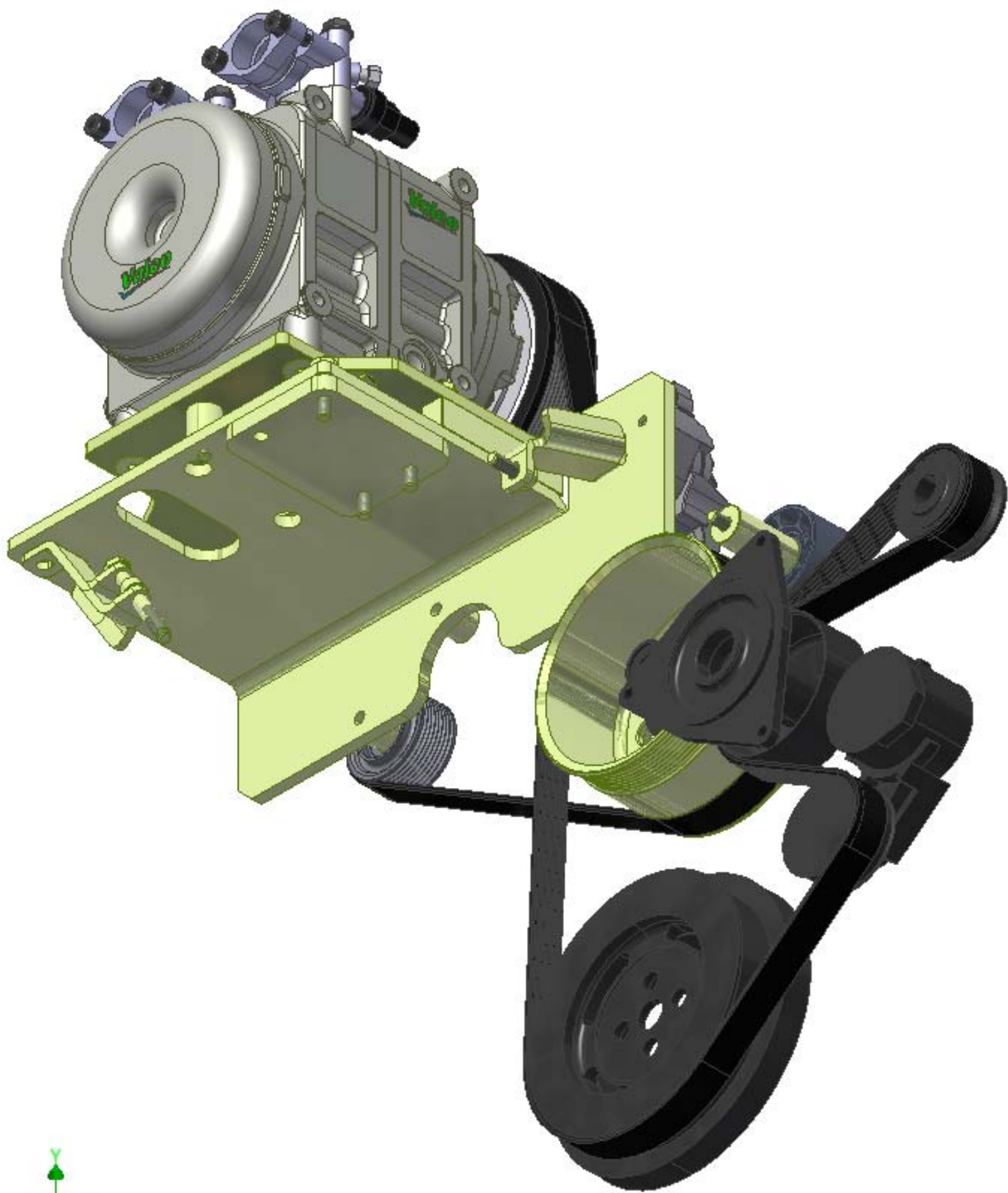

TransArctic A/C Compressor Mount Installation Disclaimer

All compressor mounts should be installed by qualified and trained personnel using proper tools and equipment in safe working conditions following industry standard guidelines for motor vehicle service and repair.

The installer of any compressor mount purchased from TransArctic must undertake all responsibility of issues arising from that compressor bracket being installed on any vehicle. As well as insure that a **proper and sufficient ground** is established between the compressors' clutches and the vehicle's engine. Mount functionality, operation and durability can all be compromised by an incompetent installation.

Due to the many different situations, parameters and application criteria, which are beyond the compressor mount manufacturer's control, TransArctic does not warrant design, durability, or operational functionality of any compressor mount improperly installed by another party.

With no implied guarantees it is the mount installer's strict responsibility to determine safety and functionality, of the compressor mount, at the time of installation.

Please contact TransArctic with any issue arising from installation so we may better improve the product. If you have any reservations about the compressor mount integrity contact TransArctic immediately at 1-877-COLD-AIR.

Mark OEM tensioner location

Install Kit

Check for Interferences

Check to ensure that the proper OEM tensioner orientation is maintained

Run engine with A/C system engaged for at least 10 minutes to run in belt

Check OEM tensioner orientation and adjust as required

Responsabilidad limitada de TransArctic en la instalación del soporte del compresor

Todos los soportes de los compresores deben ser instalados por personas calificadas y entrenadas, usando para ello los equipos y herramientas necesarios para esta labor en buenas condiciones y según las normas y guías para el servicio y/o reparación de motores de vehículos.

El instalador de los soportes comprados en TransArctic asume toda la responsabilidad de cualquier problema que surga en el soporte del compresor al vehículo; de igual manera es responsable que el cable a tierra sea conectado entre el embrague del compresor y el motor del vehículo.

Se advierte que el buen funcionamiento y la durabilidad del soporte pueden ser comprometidos por defectos en su instalación.

Debido a las diversas situaciones que se puedan presentar fuera del control del fabricante, TransArctic no garantiza el diseño, la durabilidad o el correcto funcionamiento de cualquier equipo inapropiadamente instalado por terceros.

Esta sobreentendido que el Instalador del montaje del compresor es estrictamente responsable de la seguridad y funcionamiento del equipo en el momento de la instalación.

Si tuviera algún problema o duda acerca de la instalación del soporte del compresor pongase en contacto inmediatamente con TransArctic al teléfono 1-877-COLD-AIR de modo que podamos mejorar nuestro producto.

Note la ubicación del medidor de tensión OEM

Instale el equipo

Controlar si hay interferencias.

Asegurese que el medidor de tensión mantenga la orientación justa.

Encienda el motor por lo menos 10 minutos con el sistema A/C enganchado para que la correa corra

Controle la orientación justa del medidor de tensión y ajuste a las condiciones requeridas del fabricante