

Bill of Materials Listing

TransArctic Canada Inc.

4/15/2010
Page 1 of 1

Product Number	Description	Date	Weight	Uof M	Yield	
Line	Component Prod#	Bin	Unit	Qty		
KMN82432	Mt. Kit, MForce DT, RE300, 05K, 07-08			10/11/2007	229.57	0
10	BEL22769		Belt, B gr, 2769mm (109") (BX106)	each	2	
20	BMN80041		Bkt, Main, Front PI, ICRE, 2007	each	1	
30	BMN80042		Bkt, Main, Rear PI, ICRE, 2007	each	1	
40	BMN80008		Vibration Isolator, Bar,16.50 x 2 x 1.50	each	2	
50	BMN80009		Bkt, Main, Base PI, IC, RE300	each	1	
70	BMN80025		Bkt, Back, PL, Slide, IC, RE300	each	1	
80	BMN80031		Bkt, Main, Slide, Assy, 05K, IC, RE300	each	1	
90	BMN80032		Bkt, Adapter, PL, IC, RE300	each	1	
100	BMN80043		Bkt, Spacer Plate, ICRE, 2007	each	1	
110	BMN80044		Bkt, Main Idler PI, ICRE, 2007	each	1	
125	BMN80061		Bkt, Diag, Brace, IC, RE300, '07	each	1	
127	BMN80068		Bkt, Riser,Weldm't, MF DT, RE300	each	2	
130	PUA06001		Pulley, Assy, Idler, B/S, 6", Stl, Plt	each	1	
140	PUA05012		Pulley, Assy, Idler,B/BX gr,5", STL,Plt	each	1	
150	PUL76022		Pulley, Crank, Nav DT, 7.6L, 2B/X,8" DIA	each	1	
170	SCD14912		Spacer, Col, Drl,14.9 mm x 31.8o x 12.3i	each	2	
180	SLV17012		Sleeve, Pulley, 16.9o x 22.23mm x 12.32i	each	2	
200	KBN82432		Bag Kit, Fasteners, KMN82432	each	1	

Bill of Materials Listing

TransArctic Canada Inc.

4/15/2010
Page 1 of 1

Product Number		Description	Bin	Date	Weight	Uof M	Yield
Line	Component Prod#	Description		Unit	Qty		
KBN82432		Bag Kit, Fasteners, KMN82432		9/27/2007	8.19		0
20	BTC12070	Bolt, Hex, 12 x 1.75 x 70mm, 10.9, Plt		each	2		
40	BTC10050	Bolt, Hex, 10 x 1.5 x 50mm, 10.9, Plt		each	6		
50	BTC10040	Bolt, Hex, 10 x 1.5 x 40mm, 10.9, Plt,FT		each	4		
60	BTQ12250	Bolt, Hex, 3/4- 10unc, 2.50", 8, Plt		each	1		
70	BTQ10301	Bolt, Hex, 5/8-18unf, 3", 8, PLT		each	2		
75	BTQ10250	Bolt, Hex, 5/8-11unc, 2.5", 8, PLT		each	1		
80	BTQ08451	Bolt, Hex, 1/2-20unc, 4.5", 8, Plt		each	1		
85	BTQ08401	Bolt, Hex, 1/2-20unf, 4", 8, Plt		each	6		
90	BTQ08301	Bolt, Hex, 1/2-20unf, 3", 8, Plt		each	1		
100	BTQ08200	Bolt, Hex, 1/2-13unc, 2.0", 8, Plt		each	1		
105	BTQ08201	Bolt, Hex, 1/2-20unc, 2.0", 8, Plt		each	2		
110	BTQ08126	Bolt, Hex, 1/2-20unf, 1.25", 8, Plt		each	11		
115	BTQ08151	Bolt, Hex, 1/2-20unf, 1.5", 8, Plt		each	1		
130	BTP08653	Bolt, Hex, 1/2-13unc, 6.5", 5, Plt, FT		each	1		
140	CSF08100	Capscrew, FH, 1/2-13 x 1", Alloy, Plt		each	4		
150	NTA12000	Nut, Hex, 12 x 1.75, 8.8, Plt		each	2		
160	NTA10000	Nut, Hex, 10 x 1.5, 8.8, Plt		each	4		
165	NTL10000	Nut, Lock, Hex, 5/8-11unc, 9, Plt		each	1		
170	NTP12000	Nut, Hex, 3/4-10unc, 5, Plt		each	1		
180	NTP08000	Nut, Hex, 1/2-13unc, 5, Plt		each	1		
190	NTP07000	Nut, Hex, 7/16-14unc, 5, Plt		each	4		
200	WFA12000	Washer, Flat, 12mm, 8.8, Plt		each	2		
210	WFA10000	Washer, Flat, 10mm, 8.8, Plt		each	14		
215	WLQ10000	Washer, Lock, 5/8", 8, Plt		each	1		
220	WFQ12000	Washer, Flat, 3/4", 8, Plt		each	2		
225	WFQ10000	Washer, Flat, 5/8", 8, Plt		each	4		
230	WFQ08000	Washer, Flat, 1/2", 8, Plt		each	24		
240	WFN07000	Washer, Flat, 7/16", 2, Plt		each	4		
260	WLA12000	Washer, Lock, 12mm, 8.8, Plt		each	2		
270	WLA10000	Washer, Lock, 10mm, 8.8, Plt		each	4		
280	WLP12000	Washer, Lock, 3/4", 5, Plt		each	1		
290	WLP08000	Washer, Lock, 1/2", 5, Plt		each	20		
300	WLP07000	Washer, Lock, 7/16", 5, Plt		each	4		

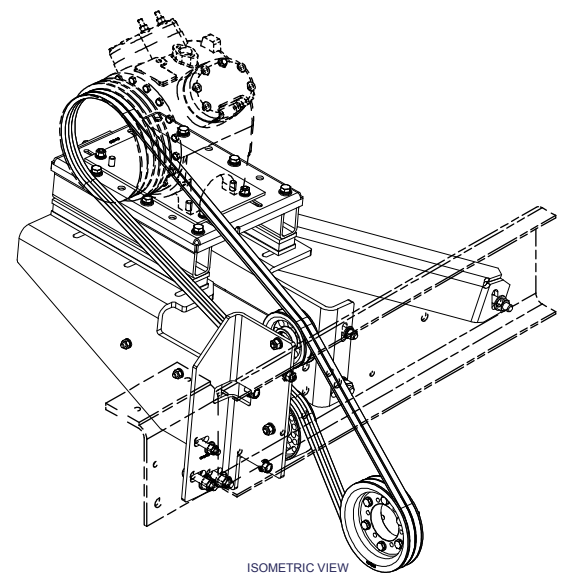
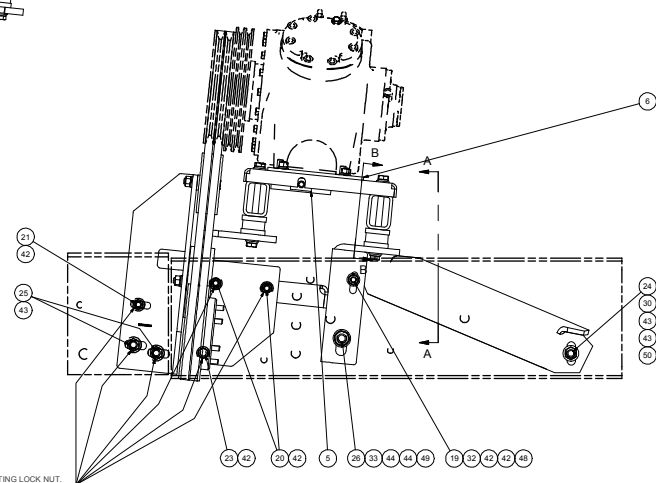
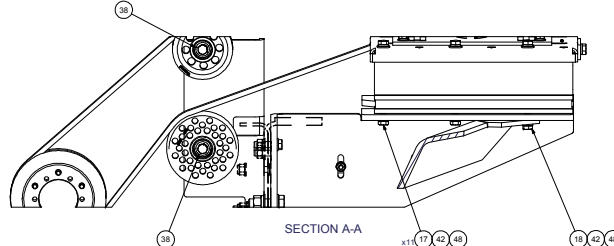
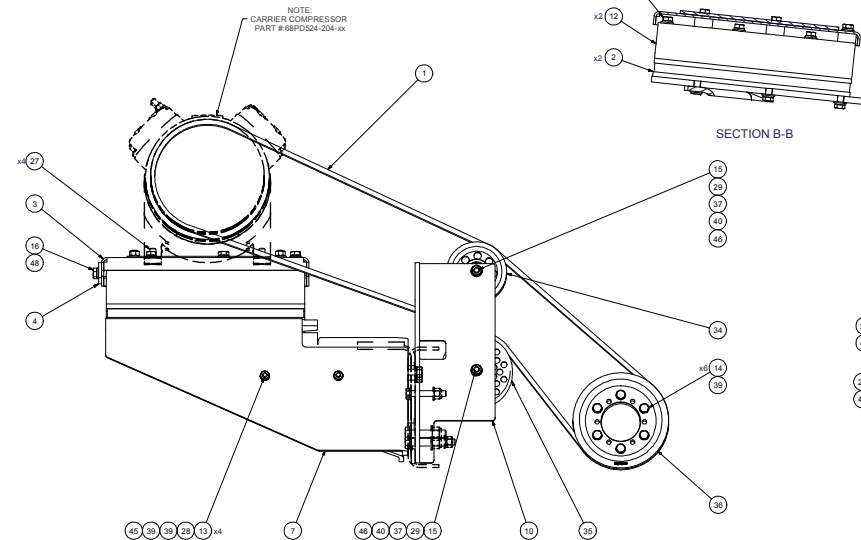
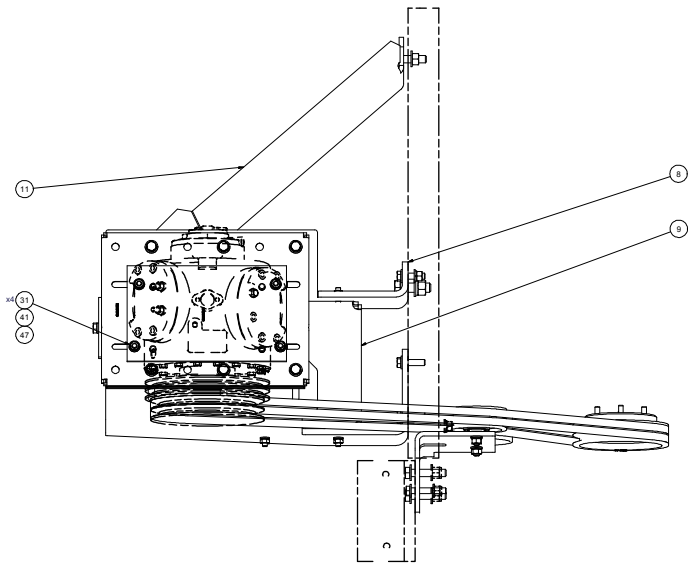

NOTES:
1) USE SERVICEABLE THREADLOCKER ON ALL FASTENERS TO ENGINE COMPONENTS AND TORQUE ALL BOLTS TO S.A.E. SPECIFICATIONS.
2) SEE "TRANSARCTIC A/C COMPRESSOR MOUNT INSTALLATION DISCLAIMER"

ITEM	QTY.	UOM.	DATE NUMBER	DESCRIPTION
50	1	EACH	WLQ10000	WASHER, LOCK, 5/8", 8, PLT
49	1	EACH	WLP12000	WASHER, LOCK, 3/4", 5, PLT
48	20	EACH	WLP08000	WASHER, LOCK, 1/2", 5, PLT
47	4	EACH	WLP07000	WASHER, LOCK, 7/16", 5, PLT
46	2	EACH	WLA12000	WASHER, LOCK, 12mm, 8.8, PLT
45	4	EACH	WLA10000	WASHER, LOCK, 10mm, 8.8, PLT
44	2	EACH	WFO12000	WASHER, FLAT, 3/4", 8, PLT
43	4	EACH	WFO10000	WASHER, FLAT, 5/8", 8, PLT
42	24	EACH	WFO08000	WASHER, FLAT, 1/2", 8, PLT
41	4	EACH	WFO07000	WASHER, FLAT, 7/16", 8, PLT
40	2	EACH	WFA12000	WASHER, FLAT, 12mm, 8.8, PLT
39	14	EACH	WFA10000	WASHER, FLAT, 10mm, 8.8, PLT
38	2	EACH	SU12012	SCREW, PULLER, 16.9x x 22.23 mm x12 IS
37	2	EACH	SCD14912	SPACER, COL, DRL, 14.9 mm x 31.80 x 12.0
36	1	EACH	PUL76022	PULLEY, CRANK, NAW DT, 7.6L, 28/36" DIA
35	1	EACH	PLA06001	PULLEY, ASSY, IDLER, B/B, 5" STL, PLT
34	1	EACH	PLA05012	PULLEY, ASSY, IDLER, B/BX gr, 5" STL, PLT
33	1	EACH	NTP12000	NUT, HEX, 3/4-10UNC, 5, PLT
32	1	EACH	NTF08000	NUT, HEX, 1/2-13UNC, 5, PLT
31	4	EACH	NTF07000	NUT, HEX, 7/16-14UNC, 5, PLT
30	1	EACH	NTL10000	NUT, LOCK, HEX, 5/8-11UNC, 5, PLT
29	2	EACH	NTA12000	NUT, HEX, 12 x 1.75, 8.8, PLT
28	4	EACH	NTA10000	NUT, HEX, 10 x 1.5, 8.8, PLT
27	4	EACH	CSF08100	CAPSCREW, FH, 3/8-16 x 1", 9, PLT
26	1	EACH	BTQ12250	BOLT, HEX, 3/4-10UNC, 2.50", 8, PLT
25	2	EACH	BTQ10301	BOLT, HEX, 5/8-8UNC x 3.00, 8, PLT
24	1	EACH	BTQ10250	BOLT, HEX, 5/8-11UNC, 2.50", 8, PLT
23	1	EACH	BTQ08451	BOLT, HEX, 1/2-20UNC x 4.50, 8, PLT
22	6	EACH	BTQ08401	BOLT, HEX, 1/2-20UNC x 4", 8, PLT
21	1	EACH	BTQ08301	BOLT, HEX, 1/2-20UNC x 3.00, 8, PLT
20	2	EACH	BTQ08201	BOLT, HEX, 1/2-20UNC x 2.00, 8, PLT
19	1	EACH	BTQ08000	BOLT, HEX, 1/2-13UNC x 2.00, 8, PLT
18	1	EACH	BTQ08151	BOLT, HEX, 1/2-20UNC x 1.50, 8, PLT
17	11	EACH	BTQ08126	BOLT, HEX, 1/2-20UNC x 1.25, 8, PLT
16	11	EACH	BTQ08049	BOLT, HEX, 1/2-13UNC x 4.50, 5, PLT FT
15	2	EACH	BTQ12070	BOLT, HEX, 12 x 1.75 x 70mm, 10.9, PLT
14	6	EACH	BTQ10050	BOLT, HEX, 10 x 1.5 x 50mm, 10.9, PLT
13	4	EACH	BTQ10049	BOLT, HEX, 10 x 1.5 x 40mm, 10.9, PLT
12	2	EACH	BMN00068	BKT, RISER, WELDINT, MF DT, RE300
11	1	EACH	BMN00061	BKT, DIAG, BRACE, RE300, 07
10	1	EACH	BMN00044	BKT, MAIN, IDLER PL, ICRE, 2007
9	1	EACH	BMN00043	BKT, SPACER PLATE, ICRE, 2007
8	1	EACH	BMN00042	BKT, MAIN, REAR PL, ICRE, 2007
7	1	EACH	BMN00041	BKT, MAIN, FRONT PL, ICRE, 2007
6	1	EACH	BMN00032	BKT, ADAPTER, PL, IC RE300
5	1	EACH	BMN00031	BKT, MAIN, SLIDE, ASSY, OSK, IC, RE300
4	1	EACH	BMN00025	BKT, BACK, PL, SLIDE, IC, RE300
3	1	EACH	BMN00009	BKT, MAIN, BASE PL, IC, RE300
2	2	EACH	BMN00008	VIBRATION ISOLATOR, BAR, 16.50 x 2 x 1.50
1	2	EACH	BEL22769	BELT, B gr, 274BELT, B gr, 2769mm (109") (BK106)

USE EXISTING LOCK NUT.
(TYPICAL 6 PLCS.)

DESIGN	vyjakow	DATE	5/11/2010
CHECKED	vyjakow	DATE	5/11/2010
REV	CCN	DESCRIPTION	DATE
1		RELEASED TO PRODUCTION	5/11/2010
2		James Stewart	5/11/2010
3		Flon Ingram	5/11/2010
4		Date Mason	5/11/2010

THIS DRAWING CONTAINS PROPRIETARY CONFIDENTIAL INFORMATION AND IS THE PROPERTY OF TRANSARCTIC INC. NO REPRODUCTION OR DISSEMINATION IS TO BE MADE WITHOUT THE WRITTEN PERMISSION OF THE COMPANY.

UNSPECIFIED TOLERANCES: HLT (H) .010
HOLE POSITION: .010
HOLE SIZE: .010

TRANSARCTIC INC. 10000 W. 100th St. Minneapolis, MN 55438

DATE: 5/11/2010

SCALE: 1:1

REV: 0

SHEET: 1 OF 1

TRANSARCTIC INC.

MT KIT, MFORCE DT, RE300, 05K, 07-08

DWG NO: KMN82432

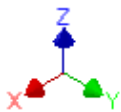
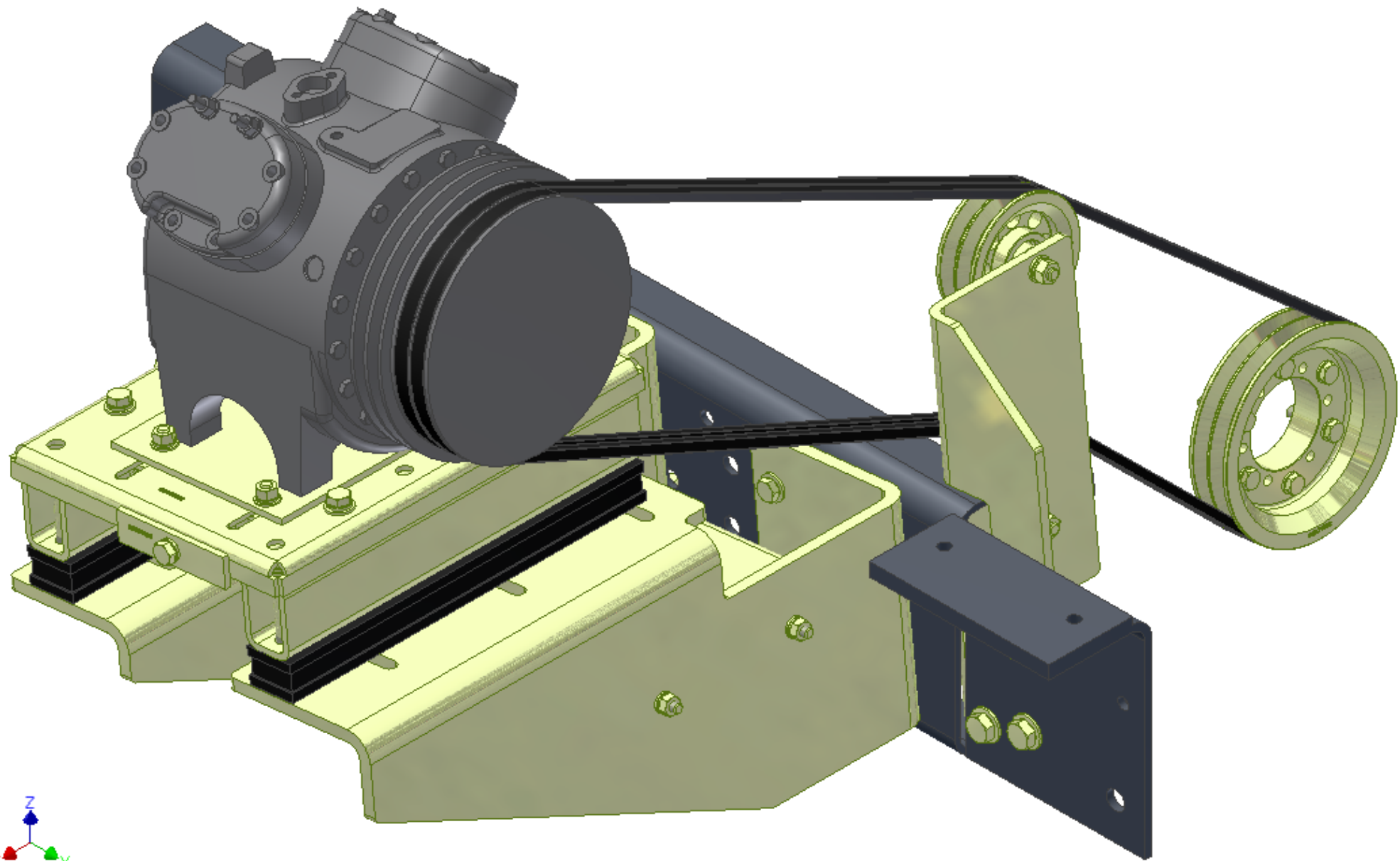

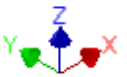
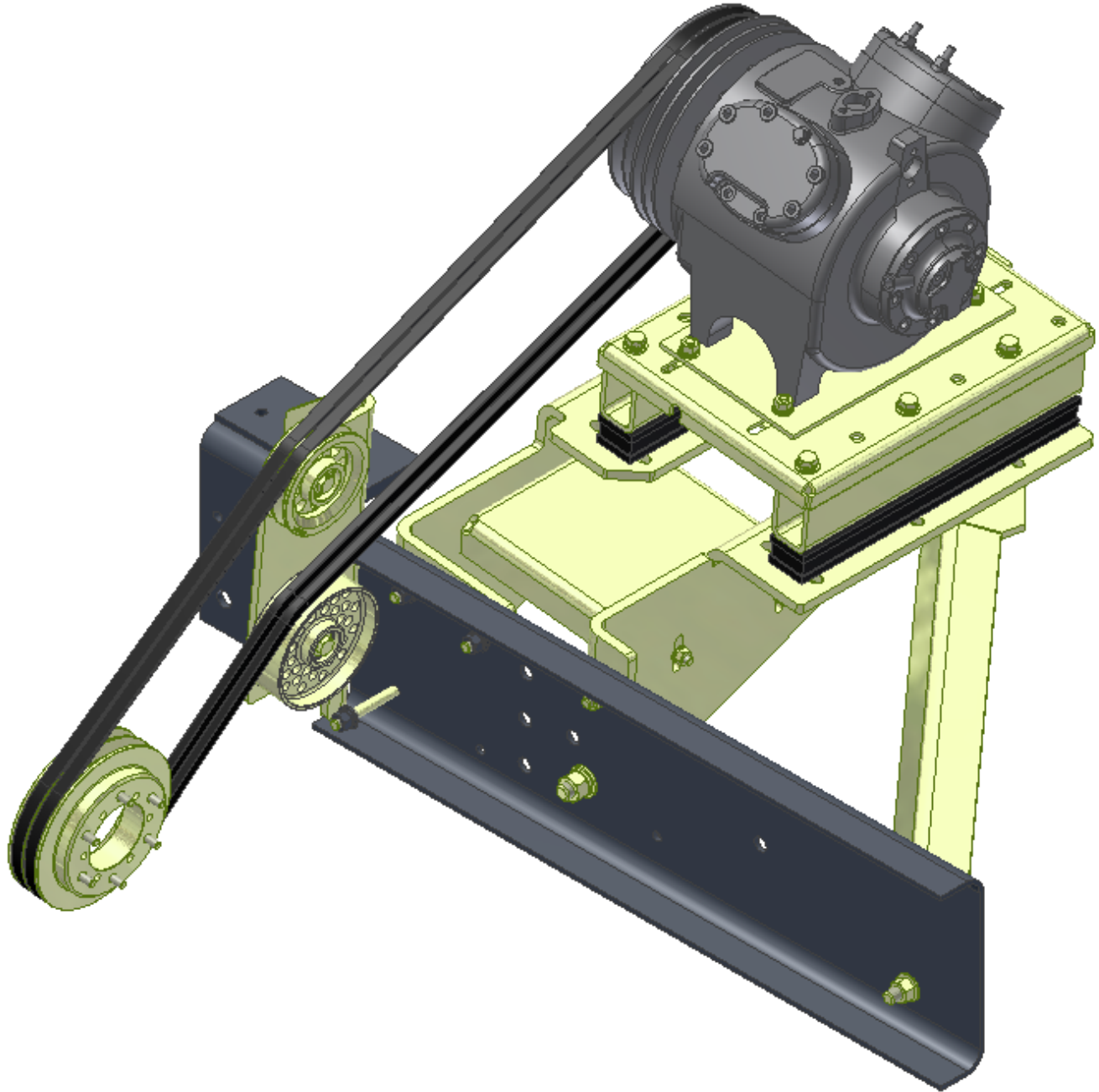

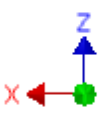
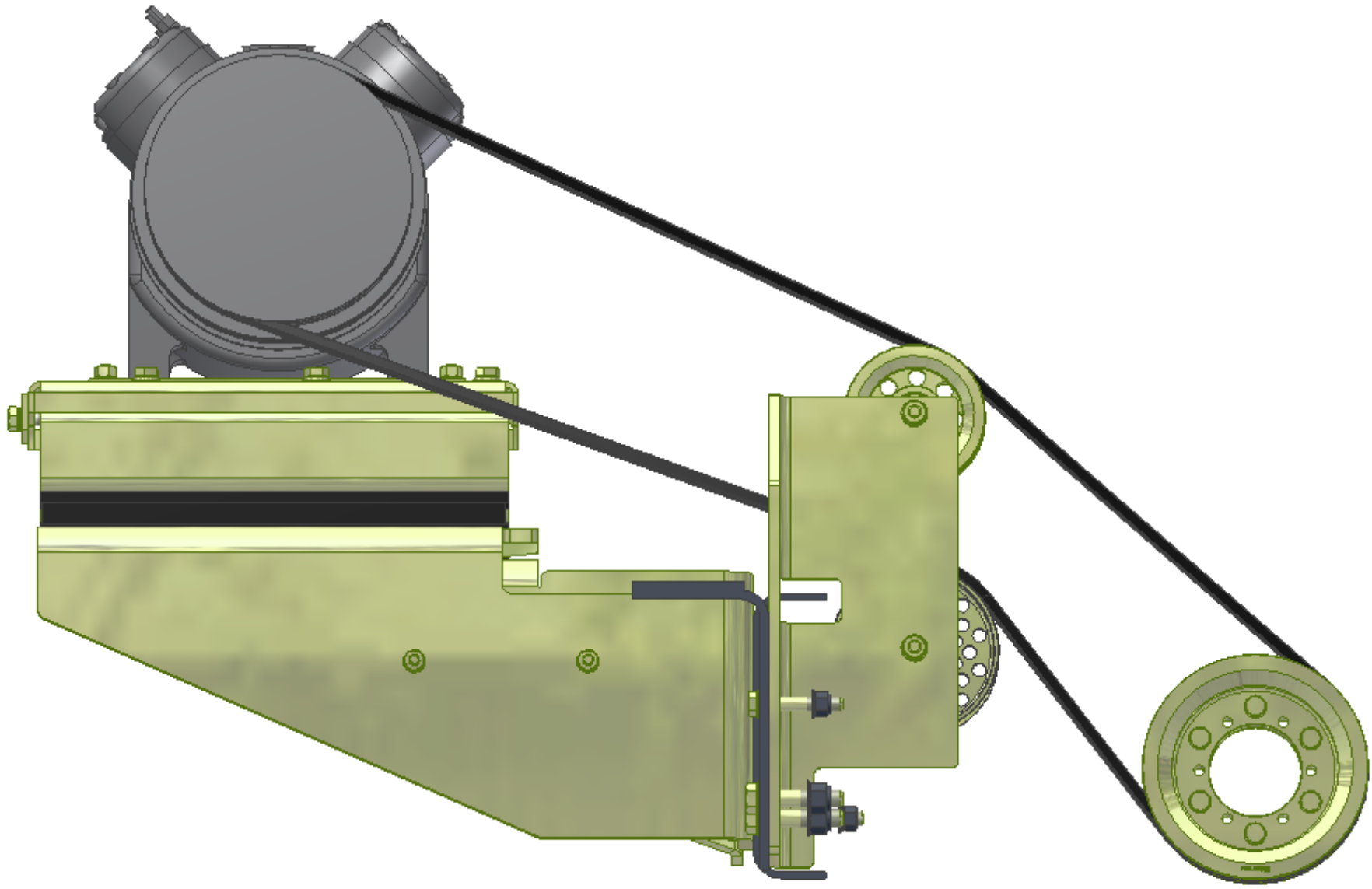

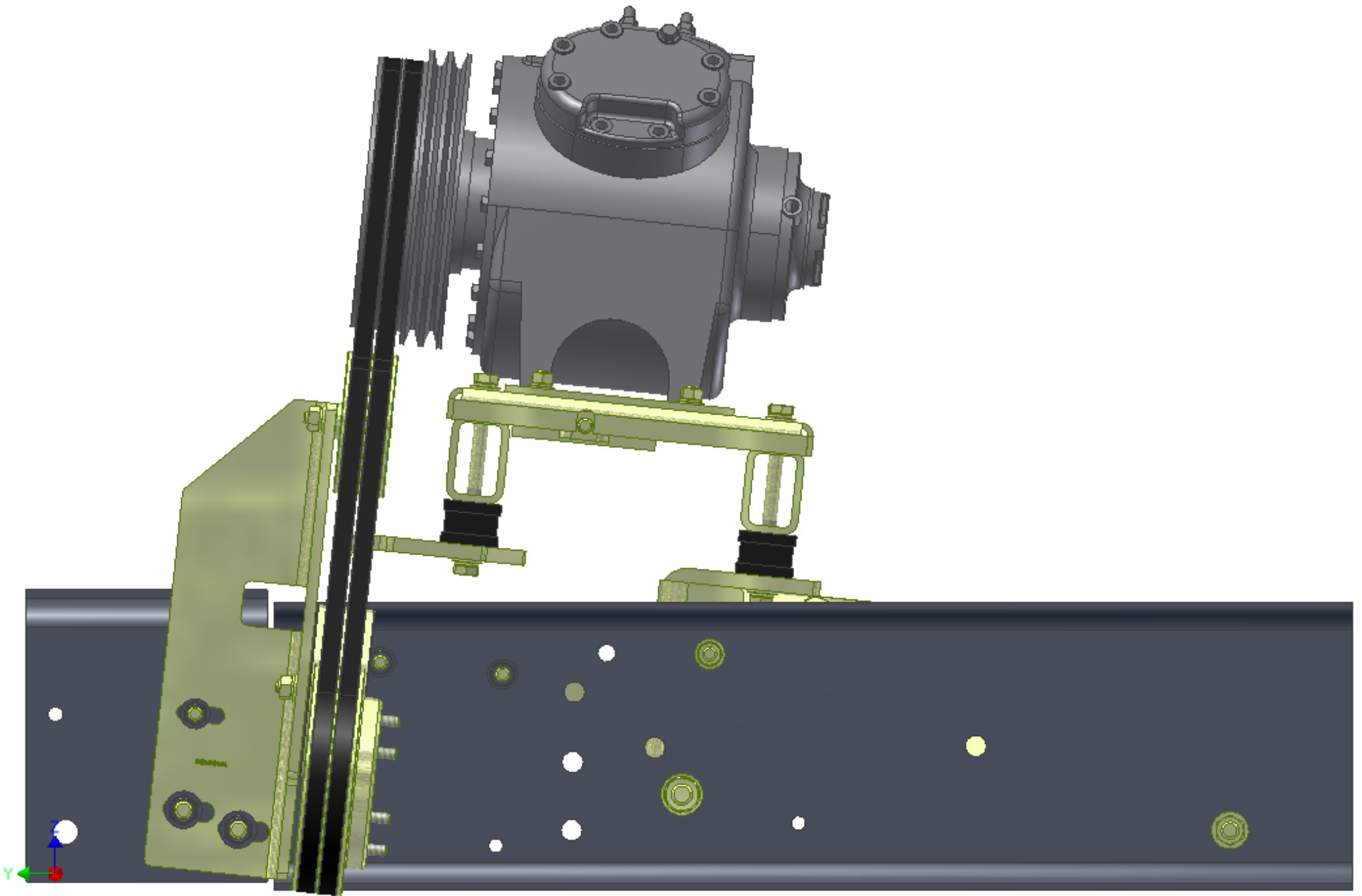

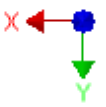
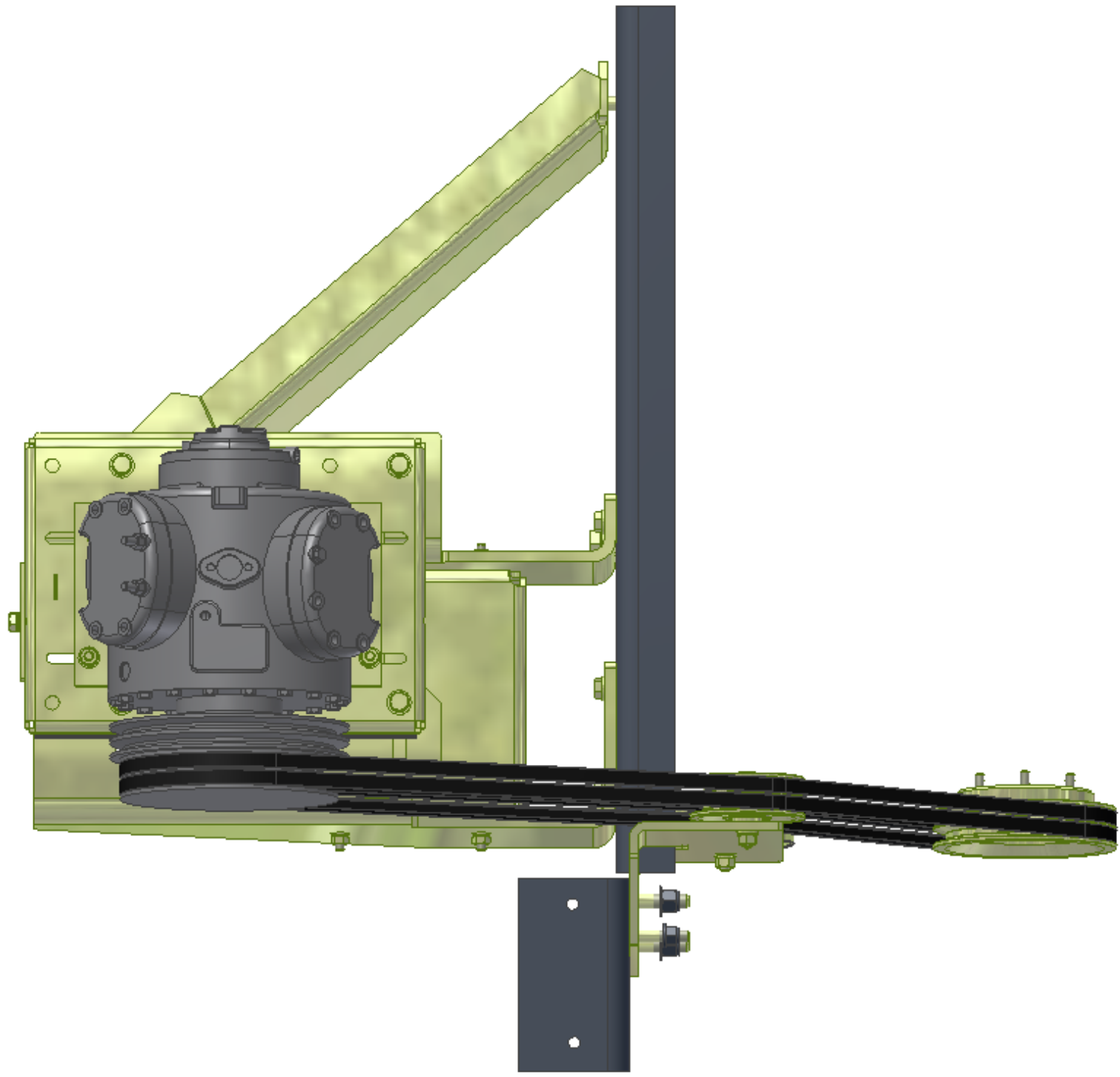

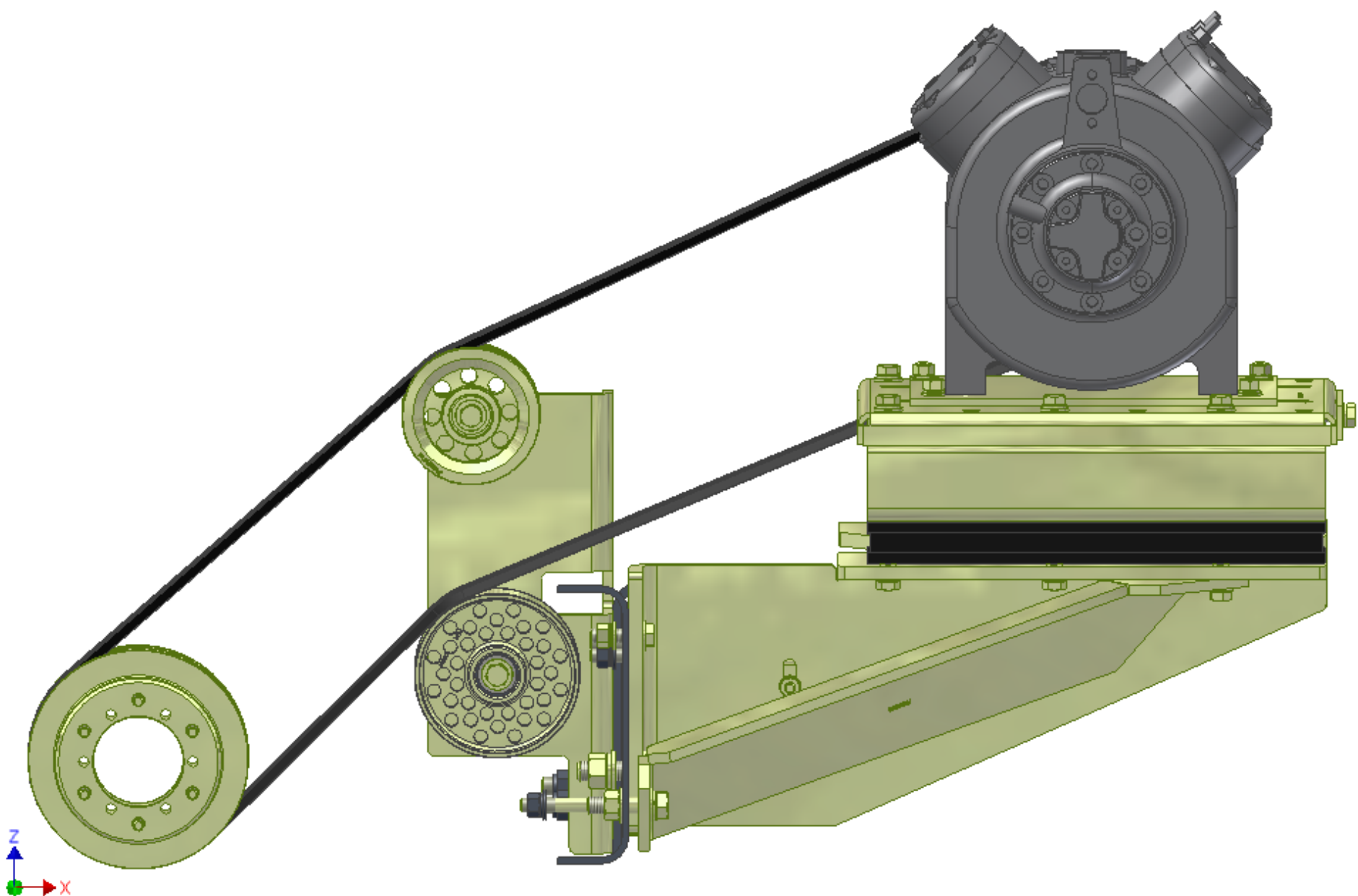

TransArctic A/C Compressor Mount Installation Disclaimer

All compressor mounts should be installed by qualified and trained personnel using proper tools and equipment in safe working conditions following industry standard guidelines for motor vehicle service and repair.

The installer of any compressor mount purchased from TransArctic must undertake all responsibility of issues arising from that compressor bracket being installed on any vehicle. As well as insure that a **proper and sufficient ground** is established between the compressors' clutches and the vehicle's engine. Mount functionality, operation and durability can all be compromised by an incompetent installation.

Due to the many different situations, parameters and application criteria, which are beyond the compressor mount manufacturer's control, TransArctic does not warrant design, durability, or operational functionality of any compressor mount improperly installed by another party.

With no implied guarantees it is the mount installer's strict responsibility to determine safety and functionality, of the compressor mount, at the time of installation.

Please contact TransArctic with any issue arising from installation so we may better improve the product. If you have any reservations about the compressor mount integrity contact TransArctic immediately at 1-877-COLD-AIR.

Mark OEM tensioner location

Install Kit

Check for Interferences

Check to ensure that the proper OEM tensioner orientation is maintained

Run engine with A/C system engaged for at least 10 minutes to run in belt

Check OEM tensioner orientation and adjust as required

Responsabilidad limitada de TransArctic en la instalación del soporte del compresor

Todos los soportes de los compresores deben ser instalados por personas calificadas y entrenadas, usando para ello los equipos y herramientas necesarios para esta labor en buenas condiciones y según las normas y guías para el servicio y/o reparación de motores de vehículos.

El instalador de los soportes comprados en TransArctic asume toda la responsabilidad de cualquier problema que surga en el soporte del compresor al vehículo; de igual manera es responsable que el cable a tierra sea conectado entre el embrague del compresor y el motor del vehículo.

Se advierte que el buen funcionamiento y la durabilidad del soporte pueden ser comprometidos por defectos en su instalación.

Debido a las diversas situaciones que se puedan presentar fuera del control del fabricante, TransArctic no garantiza el diseño, la durabilidad o el correcto funcionamiento de cualquier equipo inapropiadamente instalado por terceros.

Esta sobreentendido que el Instalador del montaje del compresor es estrictamente responsable de la seguridad y funcionamiento del equipo en el momento de la instalación.

Si tuviera algún problema o duda acerca de la instalación del soporte del compresor pongase en contacto inmediatamente con TransArctic al teléfono 1-877-COLD-AIR de modo que podamos mejorar nuestro producto.

Note la ubicación del medidor de tensión OEM

Instale el equipo

Controlar si hay interferencias.

Asegurese que el medidor de tensión mantenga la orientación justa.

Encienda el motor por lo menos 10 minutos con el sistema A/C enganchado para que la correa corra

Controle la orientación justa del medidor de tensión y ajuste a las condiciones requeridas del fabricante