

Bill of Materials Listing

TransArctic Canada Inc.

1/31/2018
Page 1 of 1

Product Number	Description	Date	Weight	Uof M	Yield
Line Component Prod# Description	Bin	Unit	Qty		
KMC92695	Mt Kit, ISL-G 2016, HDX , 2 TM-21, '17	3/17/2016	29.34		0
10 BEL11753	Belt, A gr, 1753mm (69") (17690)	each	1		
20 BEL82134	Belt, 8gr, 2134mm (84")	each	1		
30 BMC67022	Bkt, Upper, Weldmt, D/S, ISB, TM-21	each	1		
40 BMC67023	Bkt, Lower, Weldmt, D/S, ISB, TM-21	each	1		
50 BMC67141-M	Bkt, Main, Weldm't, Ten, MOD, ISL-G, HDX, '16	each	1		
55 BMZ00073	Bkt, Z Sup, CAC, Weldmt. ISL-G, '16	each	1		
60 BMC90007	Bkt, Cradle, ISL, R/H, TM-21, 87mm, 90/ccw	each	1		
70 BMC90008	Bkt, Cradle, ISL, L/H, TM-21, 92mm, 90/ccw	each	1		
80 KPC90011	Kit, Pulley, ISL-G, 8.9L, 1A/X, 8", '16	each	1		
130 TEN80007	Tenr, Spring, 94mm, A gr, CW, Assy	each	1		
140 KBC92695	Bag Kit, Fasteners, KMC92695	each	1		

Bill of Materials Listing

TransArctic Canada Inc.

1/31/2018
Page 1 of 1

Product Number	Description	Date	Weight	Uof M	Yield
Line Component Prod#	Description	Bin Unit	Qty		
KBC92695	Bag Kit, Fasteners, KMC92695	3/17/2016	1.66		0
10 BTC08035	Bolt, Hex, 8 x 1.25 x 35mm, 10.9, Plt,FT	each	2		
20 BTC08100	Bolt, Hex, 8 x 1.25 x 100mm, 10.9, Plt	each	5		
30 BTC08120	Bolt, Hex, 8 x 1.25 x 120mm, 10.9, Plt	each	2		
40 BTC10040	Bolt, Hex, 10 x 1.5 x 40mm, 10.9, Plt,FT	each	2		
45 BTC10045	Bolt, Hex, 10 x 1.5 x 45mm, 10.9, Plt,FT	each	1		
50 BTC10130	Bolt, Hex, 10 x 1.5 x 130mm, 10.9, Plt	each	1		
60 BTQ06300	Bolt, Hex, 3/8-16unc, 3.00", 8, Plt	each	1		
70 CSF10041	Capscrew, FH, 10 x 1.5 x 40mm, 10.9,Plt	each	1		
90 NTA10000	Nut, Hex, 10 x 1.5, 8.8, Plt	each	4		
100 WFA08000	Washer, Flat, 8mm, 8.8, Plt	each	9		
110 WFA10000	Washer, Flat, 10mm, 8.8, Plt	each	8		
115 WFN06000	Washer, Flat, 3/8", 2, Plt	each	1		
120 WLA08000	Washer, Lock, 8mm, 8.8, Plt	each	9		
130 WLA10000	Washer, Lock, 10mm, 8.8, Plt	each	5		
140 WLP06000	Washer, Lock, 3/8", 5, Plt	each	1		

Bill of Materials Listing

TransArctic Canada Inc.

5/3/2017
Page 1 of 1

Product Number	Description	Date	Weight	Uof M	Yield
Line Component Prod#	Description	Bin Unit	Qty		
KPC90011	Kit, Pulley, ISL-G, 8.9L, 1A/X, 8", '16	10/15/2013	12.93		0
10	PUL90011 Pulley, Crank, ISL-G, 9.0L, A/X, 8", '17	each	1		
20	BTC12080 Bolt, Hex, 12 x 1.75 x 80mm, 10.9,Plt,FT	each	4		
30	WFS12002 Washer, Flat, Hdn, 12mm, Stl, BLK	each	4		

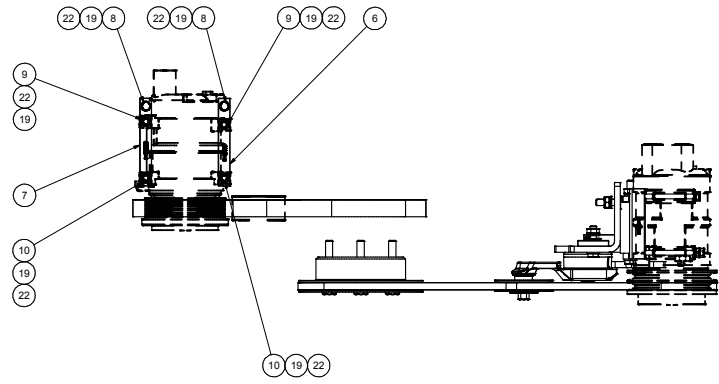

NOTE:
SHOWING COMPRESSOR
QUE P/N# QP21-1657
AS REFERENCE.

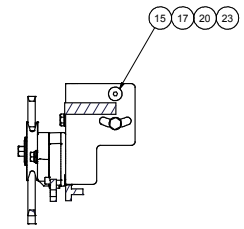

SECTION B-B

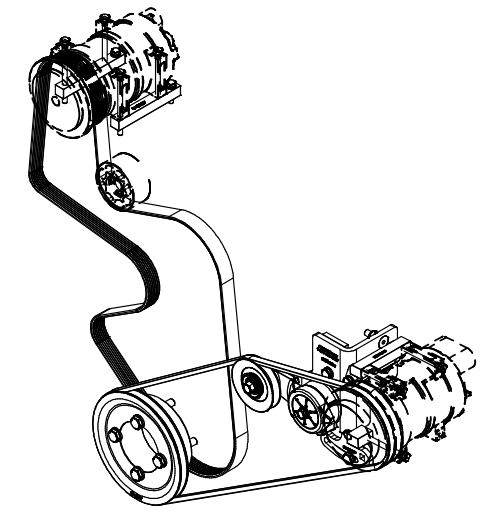

ISOMETRIC VIEW

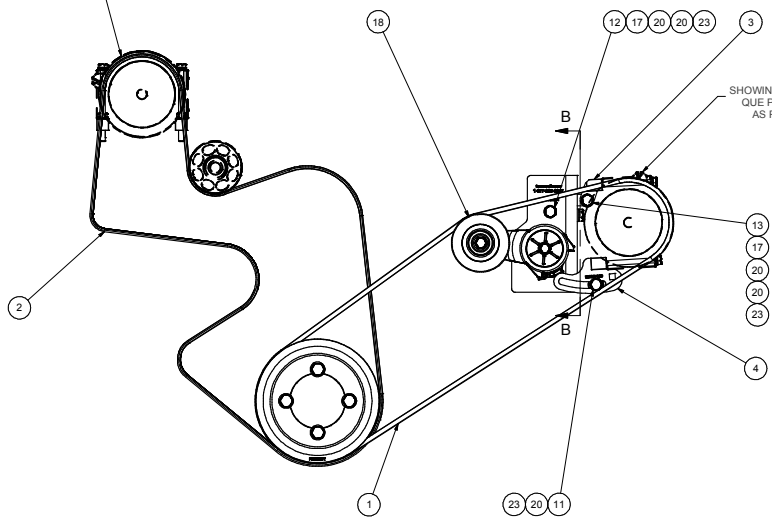

NOTE:
SHOWING COMPRESSOR
QUE P/N# QP21-1564
AS REFERENCE.

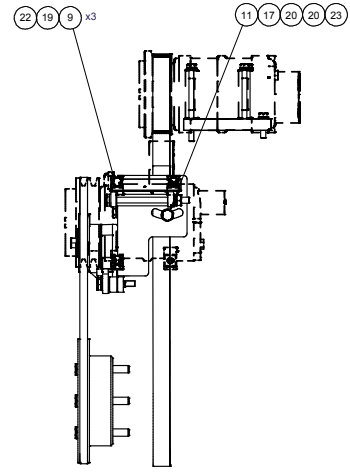

NOTES:
1) USE SERVICABLE THREADLOCKER ON ALL FASTENERS TO ENGINE COMPONENTS AND TORQUE ALL BOLTS TO S.A.E. SPECIFICATIONS.
2) SEE "TRANSARCTIC A/C COMPRESSOR MOUNT INSTALLATION DISCLAIMER".

ITEM	QTY	U/M	PART NUMBER	DESCRIPTION
24	1	EACH	WLP06000	WASHER, LOCK, 3/8", 5, PLT
23	5	EACH	WLA10000	WASHER, LOCK, 10mm, 8.8, PLT
22	9	EACH	WLA08000	WASHER, LOCK, 8mm, 8.8, PLT
21	1	EACH	WFO06000	WASHER, FLAT, 3/8", 2, PLT
20	8	EACH	WFA10000	WASHER, FLAT, 10mm, 8.8, PLT
19	9	EACH	WFA08000	WASHER, FLAT, 8mm, 8.8, PLT
18	1	EACH	TEN80007	TENR, SPRING, 94mm, A GR, CW, ASSY
17	4	EACH	NTA10000	NUT, HEX, 10 x 1.5, 8.8, PLT
16	1	EACH	KPC30011	KIT, PULLEY, ISL-G, 8.9L, 1A, X, 17
15	1	EACH	CSF10041	CAPSCREW, FH, 10 x 1.5 x 40mm, 10.9, PLT
14	1	EACH	BTQ6300	BOLT, HEX, 3/8-16UNC, 3", 8, PLT
13	1	EACH	BTC10130	BOLT, HEX, 10 x 1.5 x 130mm, 10.9, PLT
12	1	EACH	BTC10045	BOLT, HEX, 10 x 1.5 x 45mm, 10.9, PLT
11	2	EACH	BTC10040	BOLT, HEX, 10 x 1.5 x 40mm, 10.9, PLT
10	2	EACH	BTC08120	BOLT, HEX, 8 x 1.25 x 120mm, 10.9, PLT
9	5	EACH	BTC08100	BOLT, HEX, 8 x 1.25 x 100mm, 10.9, PLT
8	2	EACH	BTC08035	BOLT, HEX, 8 x 1.25 x 35mm, 10.9, PLT
7	1	EACH	BMC90008	Bkt, Cradle, ISL, L/H, TM-21, 92mm, 90/ccw
6	1	EACH	BMC90007	Bkt, Cradle, ISL, R/H, TM-21, 87mm, 90/ccw
5	1	EACH	BMC67141-M	BKT, MAIN, WELDMT, 8.9L, ISL-G, HDX, 17
4	1	EACH	BMC67023	BKT, LOWER, WELDMT, D/S, ISB, TM-21
3	1	EACH	BMC67022	BKT, UPPER, WELDMT, D/S, ISB, TM-21
2	1	EACH	BEL82134	BELT, 8GR, 2134mm (84") (5080840)
1	1	EACH	BEL11753	BELT A GR, 1753mm (69") (17690)

DRAWN				BILL OF MATERIALS			
vjakowlew				1/31/2018			
CHECKED				1/31/2018			
Jose Rodriguez				1/31/2018			
BY				1/31/2018			
James Stewart				1/31/2018			
APPROVED				1/31/2018			
Dale Mason				1/31/2018			
REV				DESCRIPTION			
0	RELEASED TO PRODUCTION			1/31/2018	VAL		
THIS DRAWING CONTAINS PROPRIETARY CONFIDENTIAL INFORMATION OWNED BY TRANSARCTIC CANADA INC. THE DOCUMENT AND THE INFORMATION IN IT ARE NOT TO BE USED, DISCLOSED OR REPRODUCED WITHOUT EXPRESS WRITTEN PERMISSION OF THE COMPANY.				TITLE			
MT KIT, ISL-G 2016, HDX, 2 TM-21, '16				SIZE			
UNSPECIFIED TOLERANCES:				DWG NO			
ONE DECIMAL PLACE (X1)				21			
TWO DECIMAL PLACE (X2)				1300			
THREE DECIMAL PLACE (X3)				25			
FRACTIONAL (X1/8)				1300			
FRACTIONAL (X1/16)				25			
THIRD ANGLE PROJECTION				DRAWING UNIT OF MEASURE			
MM (INCH)				SCALE			
1:4				SHEET 1 OF 1			



REV 0

KMC92695

1:4

SHEET 1 OF 1

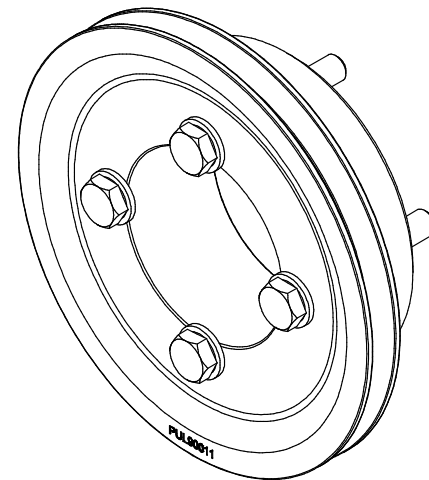
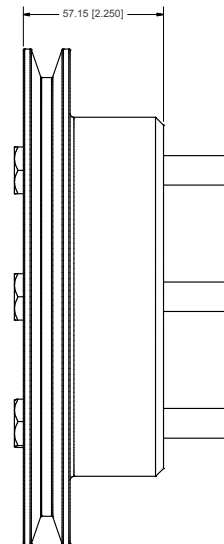
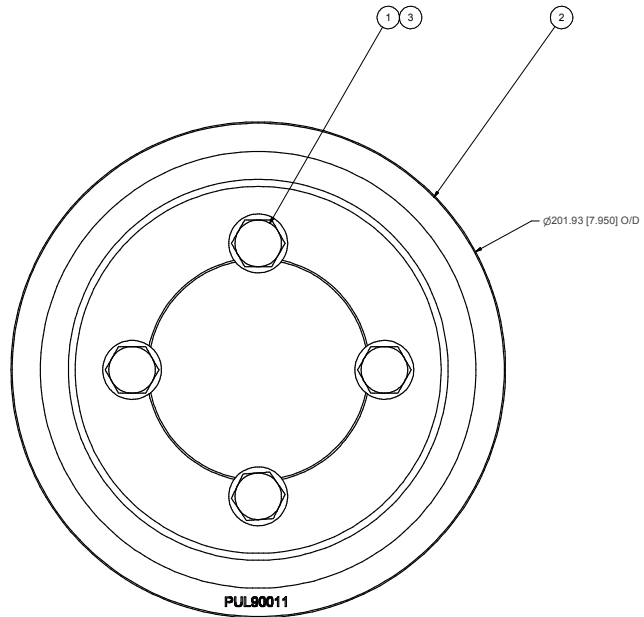

NOTES:

- 1) USE SERVICABLE THREADLOCKER ON ALL FASTENERS TO ENGINE COMPONENTS AND TORQUE ALL BOLTS TO S.A.E. SPECIFICATIONS.
- 2) SEE "TRANSARCTIC A/C COMPRESSOR MOUNT INSTALLATION DISCLAIMER".
- 3) WEIGHT: 13.03 LB

ITEM	QTY	U/M	PART NUMBER	DESCRIPTION
3	4	EACH	WFS12002	WASHER, FLAT, HDN, 12mm, STL, BLK
2	1	EACH	PUL90011	PULLEY, CRANK, ISL-G, 8.9L, A/X, 8", 17
1	4	EACH	BTC12080	BOLT, HEX, 12 x 1.75 x 80mm, 10.9, PLT

DRAWN				BILL OF MATERIALS	
jr	rodriguez	5/3/2017	CHECKED	TITLE	
0	RELEASED TO PRODUCTION	05/03/17	BY: Jose Rodriguez	KIT, PULLEY, ISL-G, 8.9L, 1A/X, '17	
REV	ECN	DESCRIPTION	DATE	BY	APPROVED
				Jose Rodriguez	05/03/17
				James Stewart	5/3/2017
				Dale Mason	5/3/2017
UNSPECIFIED TOLERANCES:				ALL DIMS	PROF
ONE DECIMAL PLACE (X1)				20	1.000
TWO DECIMAL PLACE (X2)				25	1.000
THREE DECIMAL PLACE (X3)				30	1.000
FRACTIONAL (X1/8)				ANSI & AS	
DRAWING UNIT OF MEASURE:				MM (INCH)	SCALE
DRAWN				1:1	DWG NO
PUL90011				1:1	KPC90011
REV				0	SHEET 1 OF 1



REV	ECN	DESCRIPTION	DATE	BY	APPROVED
0		RELEASED TO PRODUCTION	05/03/17	VAL	
				Jose Rodriguez	05/03/17
				James Stewart	5/3/2017
				Dale Mason	5/3/2017



THIRD ANGLE PROJECTION
DRAWING UNIT OF MEASURE: MM (INCH)
SCALE: 1:1



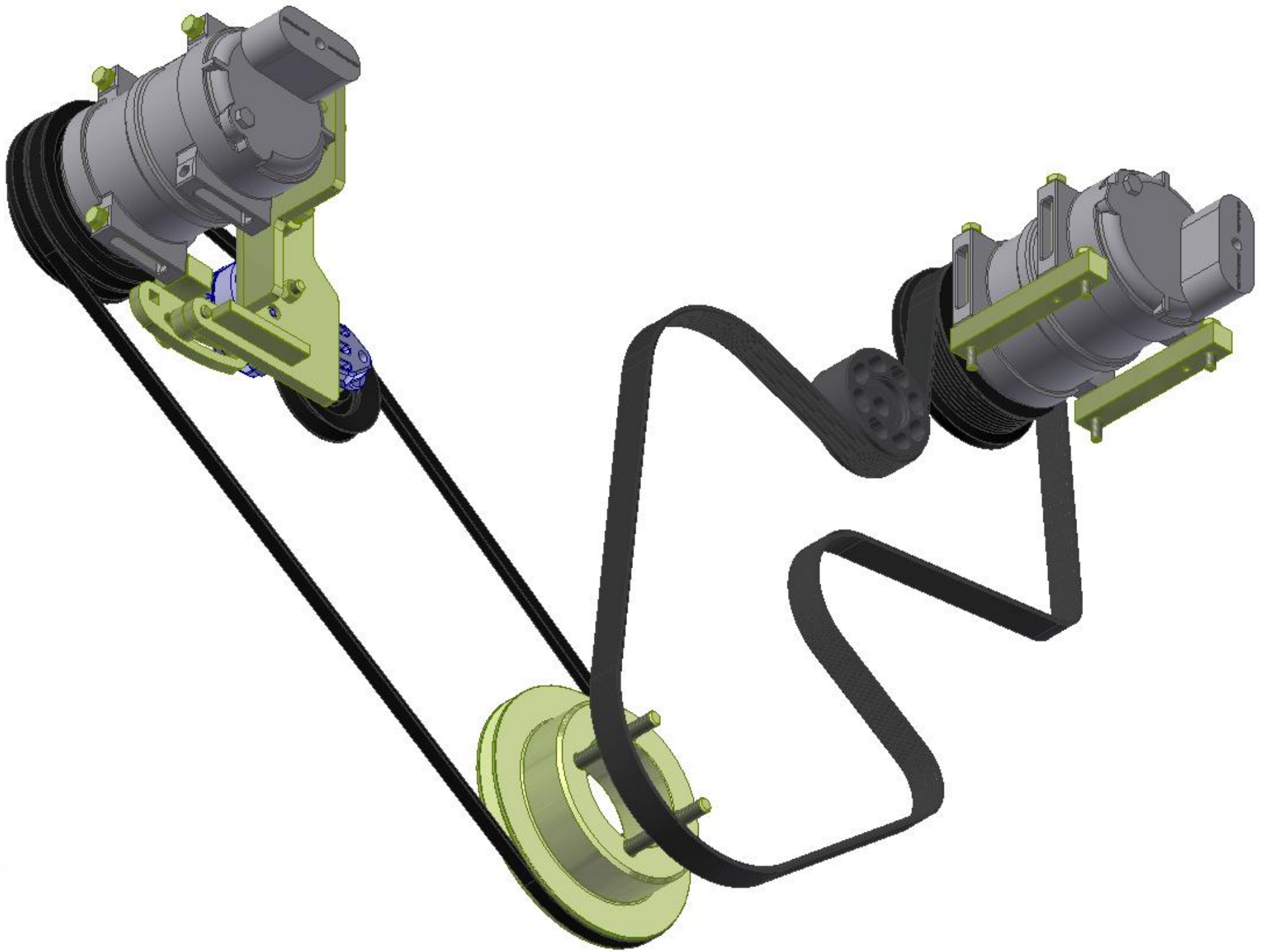

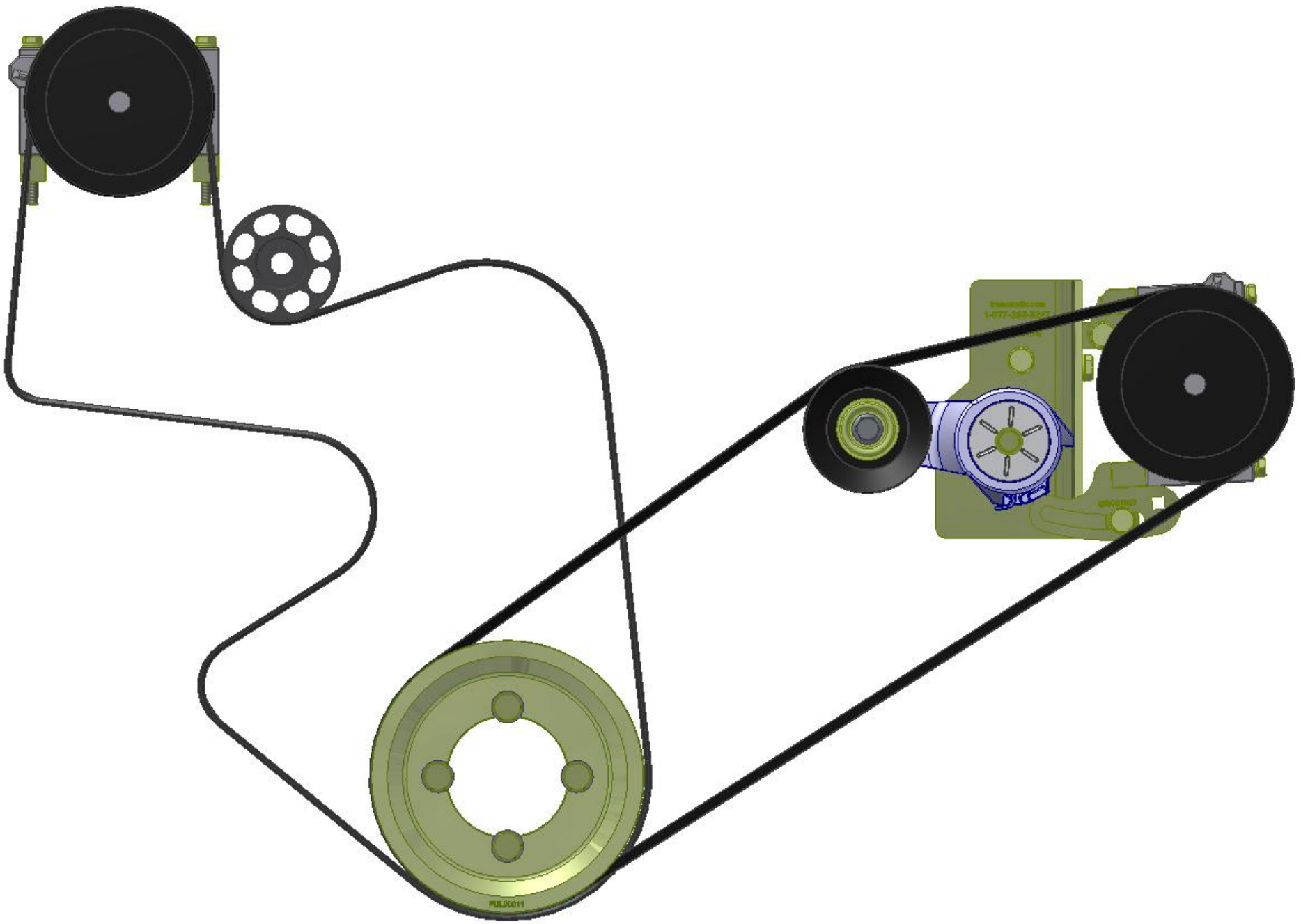

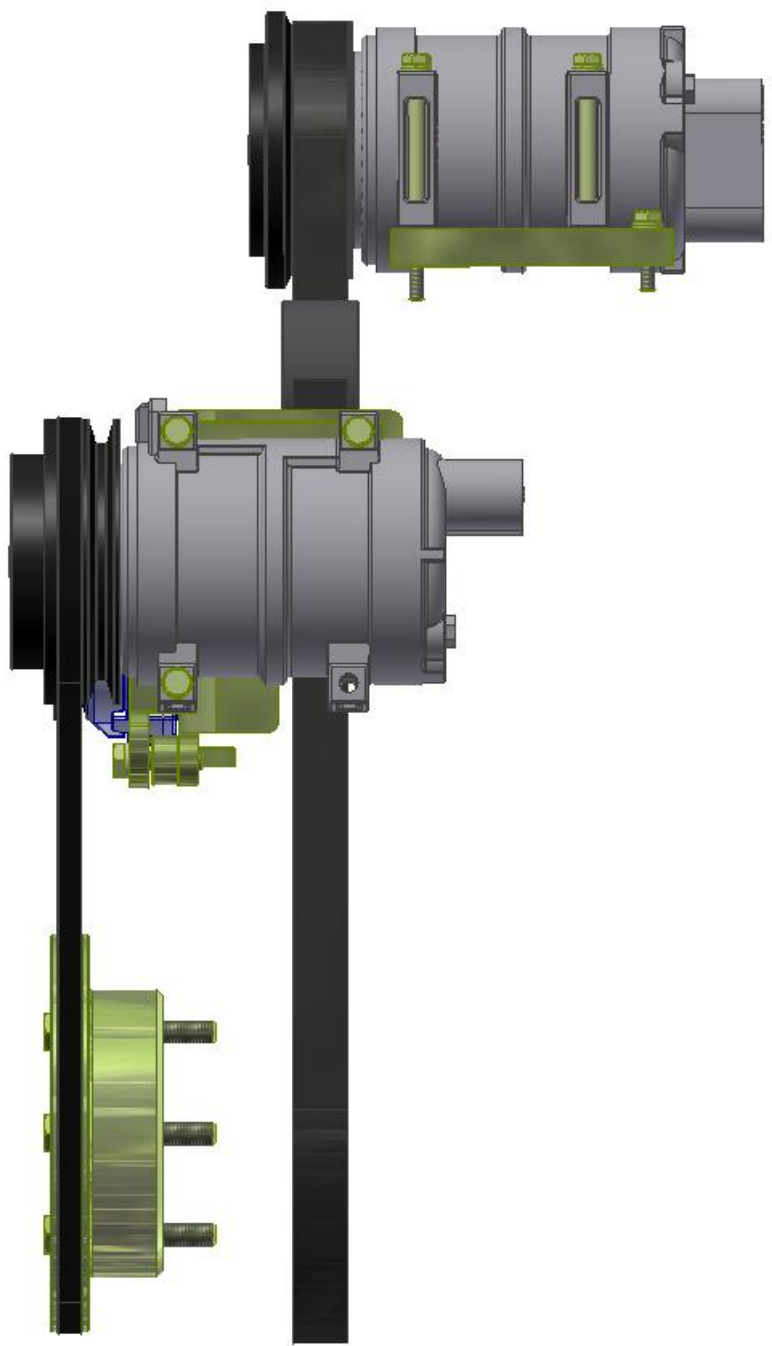

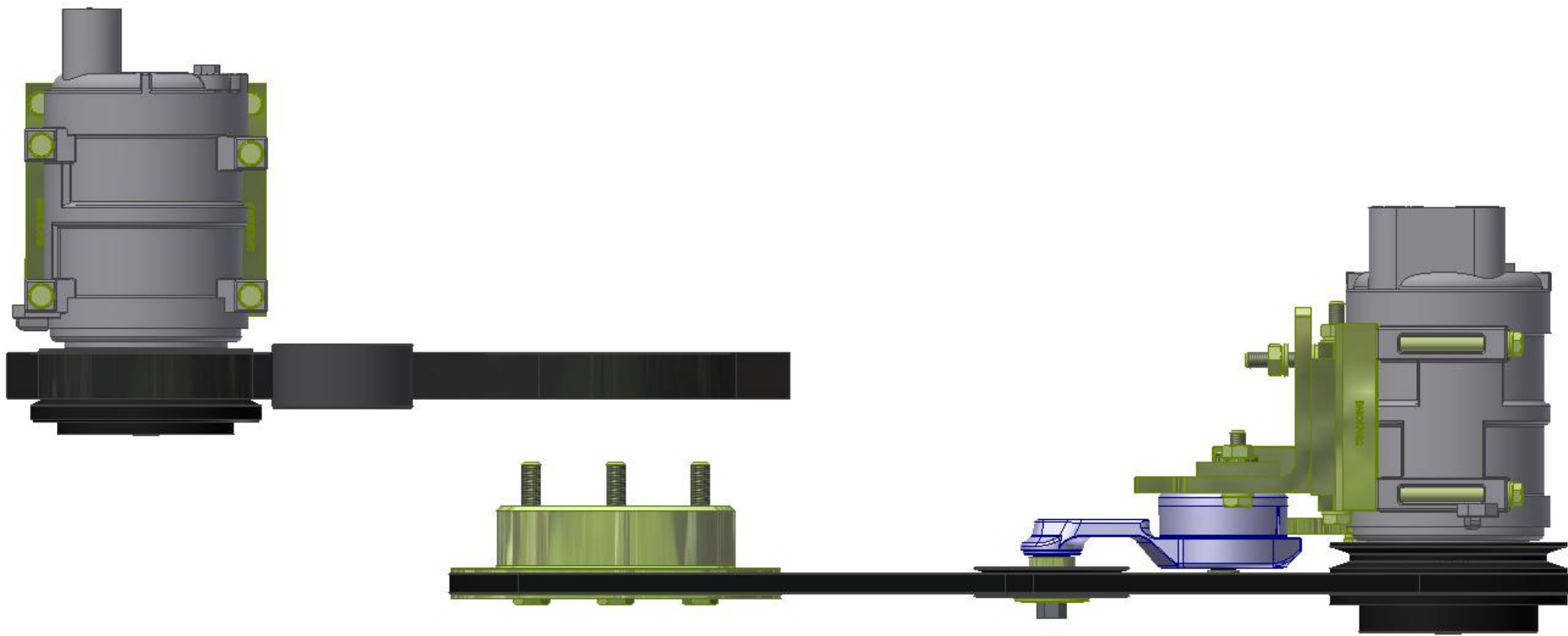

TransArctic A/C Compressor Mount Installation Disclaimer

All compressor mounts should be installed by qualified and trained personnel using proper tools and equipment in safe working conditions following industry standard guidelines for motor vehicle service and repair.

The installer of any compressor mount purchased from TransArctic must undertake all responsibility of issues arising from that compressor bracket being installed on any vehicle. As well as insure that a **proper and sufficient ground** is established between the compressors' clutches and the vehicle's engine. Mount functionality, operation and durability can all be compromised by an incompetent installation.

Due to the many different situations, parameters and application criteria, which are beyond the compressor mount manufacturer's control, TransArctic does not warrant design, durability, or operational functionality of any compressor mount improperly installed by another party.

With no implied guarantees it is the mount installer's strict responsibility to determine safety and functionality, of the compressor mount, at the time of installation.

Please contact TransArctic with any issue arising from installation so we may better improve the product. If you have any reservations about the compressor mount integrity contact TransArctic immediately at 1-877-COLD-AIR.

Mark OEM tensioner location

Install Kit

Check for Interferences

Check to ensure that the proper OEM tensioner orientation is maintained

Run engine with A/C system engaged for at least 10 minutes to run in belt

Check OEM tensioner orientation and adjust as required

Responsabilidad limitada de TransArctic en la instalación del soporte del compresor

Todos los soportes de los compresores deben ser instalados por personas calificadas y entrenadas, usando para ello los equipos y herramientas necesarios para esta labor en buenas condiciones y según las normas y guías para el servicio y/o reparación de motores de vehículos.

El instalador de los soportes comprados en TransArctic asume toda la responsabilidad de cualquier problema que surja en el soporte del compresor al vehículo; de igual manera es responsable que el cable a tierra sea conectado entre el embrague del compresor y el motor del vehículo.

Se advierte que el buen funcionamiento y la durabilidad del soporte pueden ser comprometidos por defectos en su instalación.

Debido a las diversas situaciones que se puedan presentar fuera del control del fabricante, TransArctic no garantiza el diseño, la durabilidad o el correcto funcionamiento de cualquier equipo inapropiadamente instalado por terceros.

Esta sobreentendido que el Instalador del montaje del compresor es estrictamente responsable de la seguridad y funcionamiento del equipo en el momento de la instalación.

Si tuviera algún problema o duda acerca de la instalación del soporte del compresor pongase en contacto inmediatamente con TransArctic al teléfono 1-877-COLD-AIR de modo que podamos mejorar nuestro producto.

Note la ubicación del medidor de tensión OEM

Instale el equipo

Controlar si hay interferencias.

Asegurese que el medidor de tensión mantenga la orientación justa.

Encienda el motor por lo menos 10 minutos con el sistema A/C enganchado para que la correa corra

Controle la orientación justa del medidor de tensión y ajuste a las condiciones requeridas del fabricante