

Bill of Materials Listing

TransArctic Canada Inc.

6/11/2021
Page 1 of 1

Product Number	Date	Description	Uof M	Weight	Yield	
Line	Qty	Component Prod#	Rev#	Bin	Unit	
KMP88830	6/9/2021	0 Mt. Kit, PSI 8.8, 2 TM-21, IC CE, '21			29.30	0
10	1	BEL83302			each	
20	2	BMN80086			each	
30	1	BMN80088			each	
40	1	BMN80091			each	
50	1	BMN80094			each	
60	1	BMN80126			each	
70	1	BMT10011			each	
80	1	BMT10012			each	
90	2	PUL80076			each	
100	1	KBP88830			each	

Bill of Materials Listing

TransArctic Canada Inc.

6/10/2021
Page 1 of 1

Product Number	Date	Description	Uof M	Weight	Yield
Line	Qty	Component Prod#	Rev#	Bin	Unit
KBP88830	6/9/2021	Bag Kit, Fasteners, KMP88830 & KMP88730		3.24	0
10	6	BTC08100			each
20	2	BTC08110			each
30	1	BTC10130			each
40	2	BTC10160			each
50	2	BTC10170			each
60	2	BTQ08150			each
70	1	BTS08080	0		each
80	4	NTA08000			each
90	1	NTA10000			each
100	3.00	NTQ08000			each
110	8	WFA08000			each
120	10	WFA10000			each
130	3	WFQ08000			each
140	8	WLA08000			each
150	9	WLA10000			each
160	3	WLQ08000			each

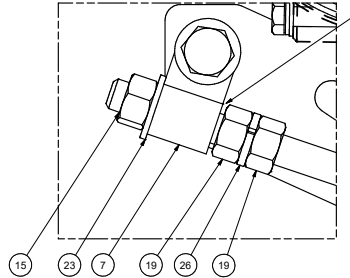

DETAIL A
SCALE 1 : 1

NOTE: DO NOT OVER TIGHTEN NUT TO BMT10011 BRACKET TAB, TO ALLOW LEAD BOLT TO SPIN FREELY WHEN ADJUSTING COMPRESSOR.

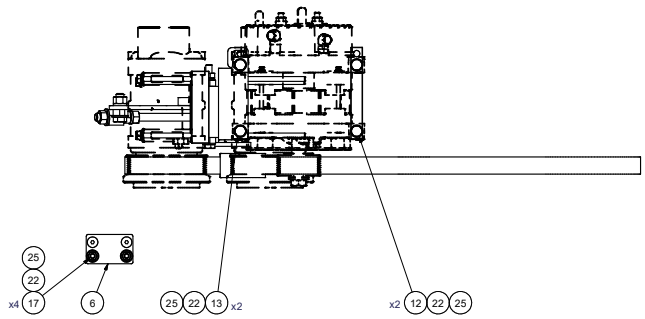

NOTE: SHOWING ALTERNATOR AS REFERENCE.

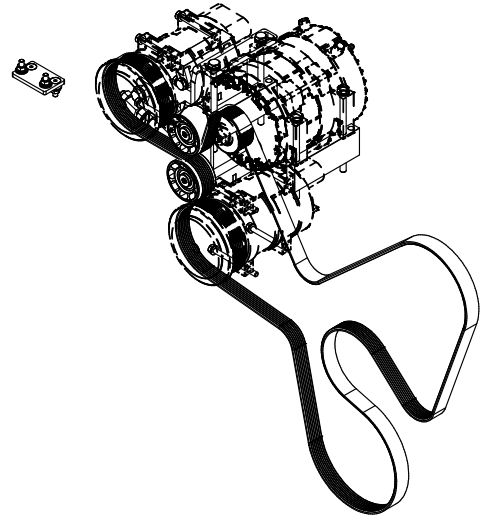

ISOMETRIC VIEW

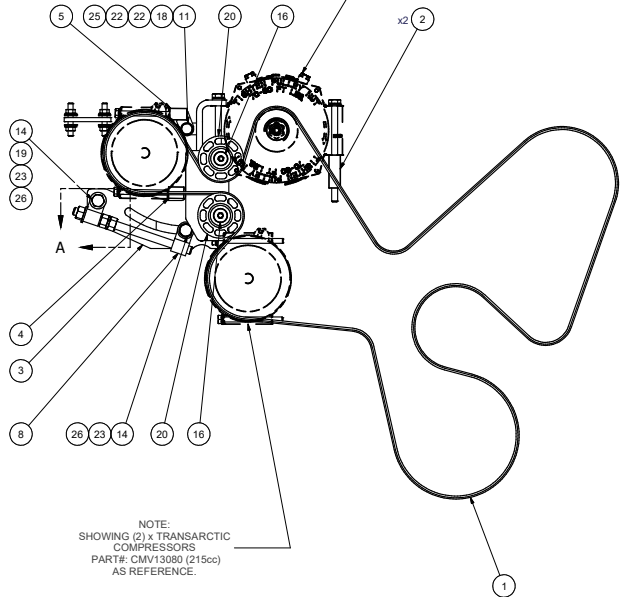
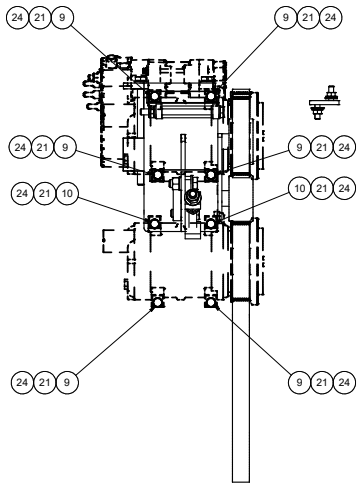

NOTE: SHOWING (2) x TRANSARTIC COMPRESSORS PART#: CMV13080 (215cc) AS REFERENCE.

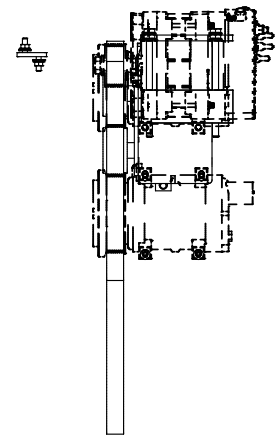

ITEM	QTY	U/M	PART NUMBER	DESCRIPTION
26	3	EACH	WLQ08000	WASHER, LOCK, 1/2", 8, PLT
25	9	EACH	WLA10000	WASHER, LOCK, 10mm, 8.8, PLT
24	8	EACH	WLA08000	WASHER, LOCK, 8mm, 8.8, PLT
23	3	EACH	WFO08000	WASHER, FLAT, 1/2", 8, PLT
22	10	EACH	WFA10000	WASHER, FLAT, 10mm, 8.8, PLT
21	8	EACH	WFA08000	WASHER, FLAT, 8mm, 8.8, PLT
20	2	EACH	PUL80076	PULLEY, IDLER, BACKSIDE, P8, 76D, 39W
19	3	EACH	NTQ08000	NUT, HEX, 1/2-13UNC, 8, PLT
18	1	EACH	NTA10000	NUT, HEX, 10 x 1.5, 8.8, PLT
17	4	EACH	NTA08000	NUT, HEX, 8 x 1.25, 8.8, PLT
16	2	EACH	BTS10001	BOLT, SHOULDER, 10mm (IDLER PULLEY)
15	1	EACH	BTS08080	BOLT, HEX, WELDMT, 1/2-13UNC x 8"
14	2	EACH	BTC08150	BOLT, HEX, 1/2-13UNC x 1.50, 8, PLT
13	2	EACH	BTC10170	BOLT, HEX, 10 x 1.5 x 170mm, 10.9, PLT
12	2	EACH	BTC10160	BOLT, HEX, 10 x 1.5 x 160mm, 10.9, PLT
11	1	EACH	BTC10130	BOLT, HEX, 10 x 1.5 x 130mm, 10.9, PLT
10	2	EACH	BTC08110	BOLT, HEX, 8 x 1.25 x 110mm, 10.9, PLT
9	6	EACH	BTC08100	BOLT, HEX, 8 x 1.25 x 100mm, 10.9, PLT
8	1	EACH	BMT10012	BKT, BLOCK, JACK SCREW, THREADED
7	1	EACH	BMT10011	BKT, TENR, BLOCK, OFFSET, 3mm
6	1	EACH	BMN80126	BKT, WELDMT, RAD COOLANT, OFFSET, IC CE, '21
5	1	EACH	BMN80094	BKT, UPPER, WELDMT, CRADLE, TM-21, '21
4	1	EACH	BMN80091	BKT, WELDMT, JACKSCREW, TM-21, CRADLE, 87mm
3	1	EACH	BMN80088	BKT, MAIN, WELDMT, 2-TM-21, IC CE, '21
2	2	EACH	BMN80086	BKT, ALT, CRADLE, TM-21, IC CE, '21
1	1	EACH	BEL83302	BELT, 8GR, 3302mm (130")

REV	ECN	DESCRIPTION	DATE	BY	JRR
0		RELEASED TO PRODUCTION	6/9/2021	JRR	
				James Stewart	6/9/2021
				Dale Mason	6/9/2021

DRAWN: jrodriguez 6/9/2021
 CHECKED: Jose Rodriguez 6/9/2021
 OR: James Stewart 6/9/2021
 APPROVED: Dale Mason 6/9/2021

TRANSARTIC INC.

MT, KIT, PSI 8.8, 2 TM-21, IC CE, '21

SIZE: DWG NO: KMP88830
 SCALE: 1:4

DRAWING UNIT OF MEASURE: MM (INCH)
 SHEET 1 OF 1

UNSPECIFIED TOLERANCES: ALL DIMS IN INCHES
 ONE DECIMAL PLACE (.X) 1/16 INCH
 TWO DECIMAL PLACE (.XX) 1/32 INCH
 THREE DECIMAL PLACE (.XXX) 1/64 INCH
 FRACTIONAL: 1/8, 1/4, 3/8, 1/2, 5/8, 3/4, 7/8

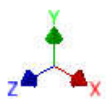
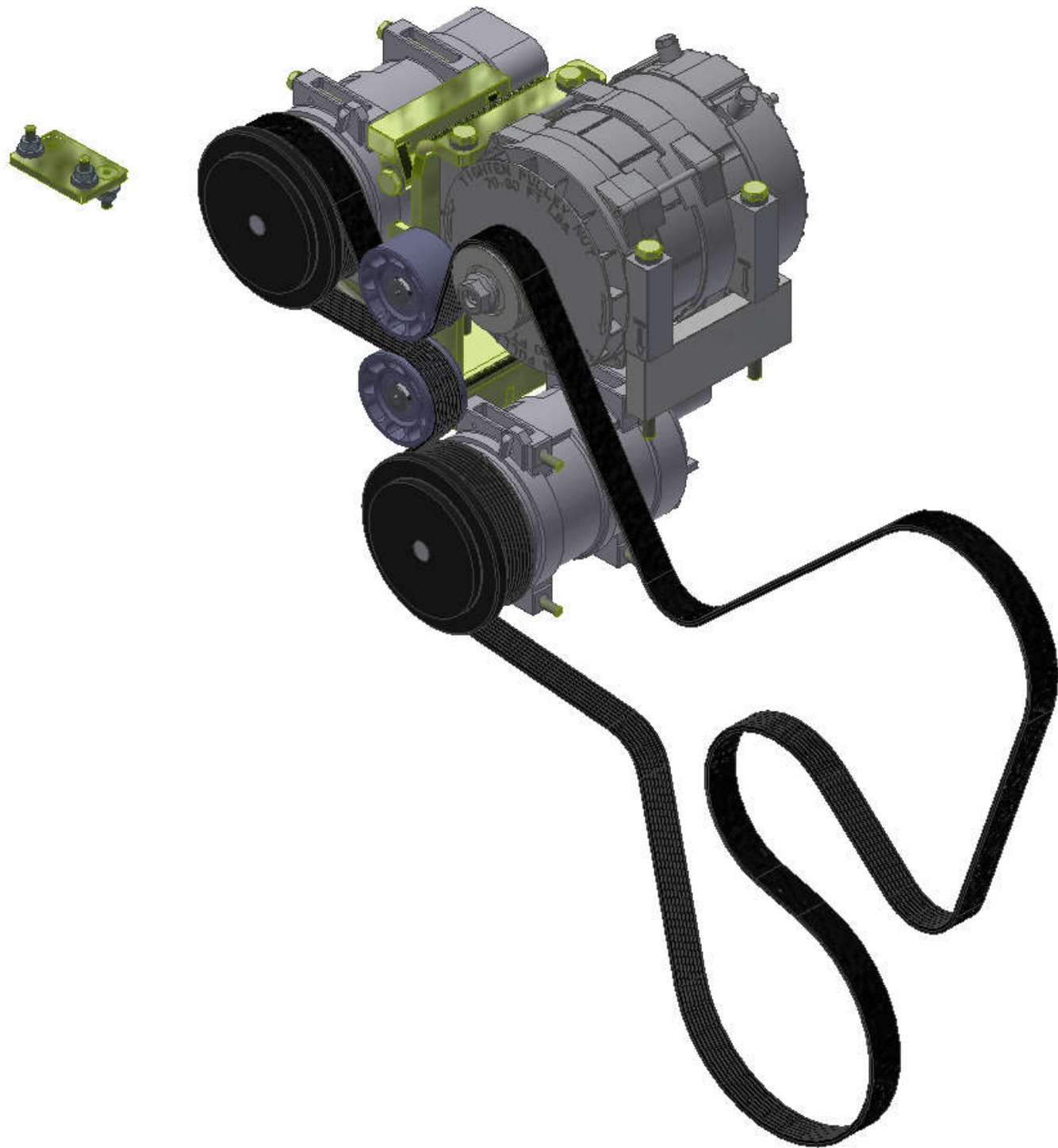

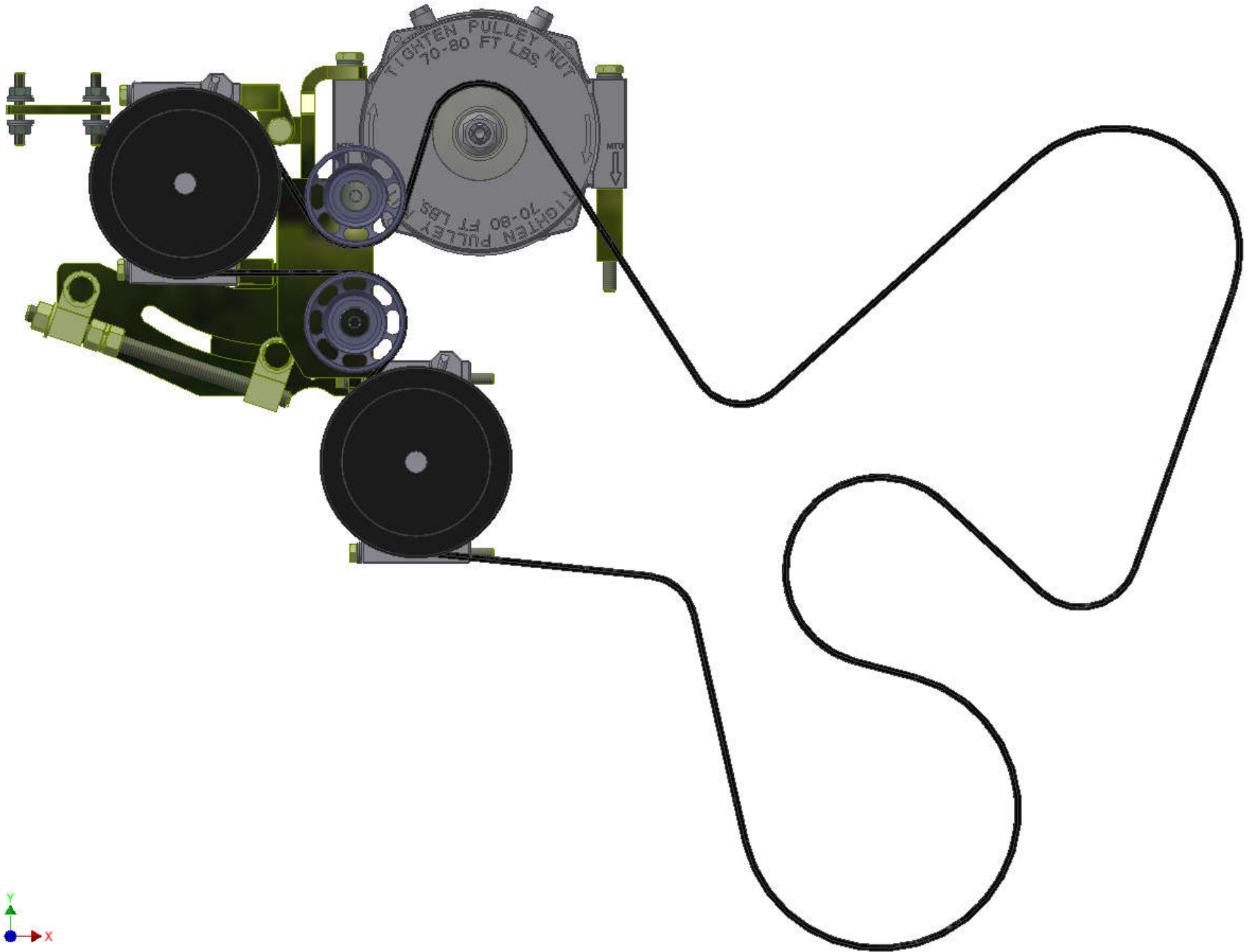

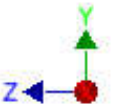
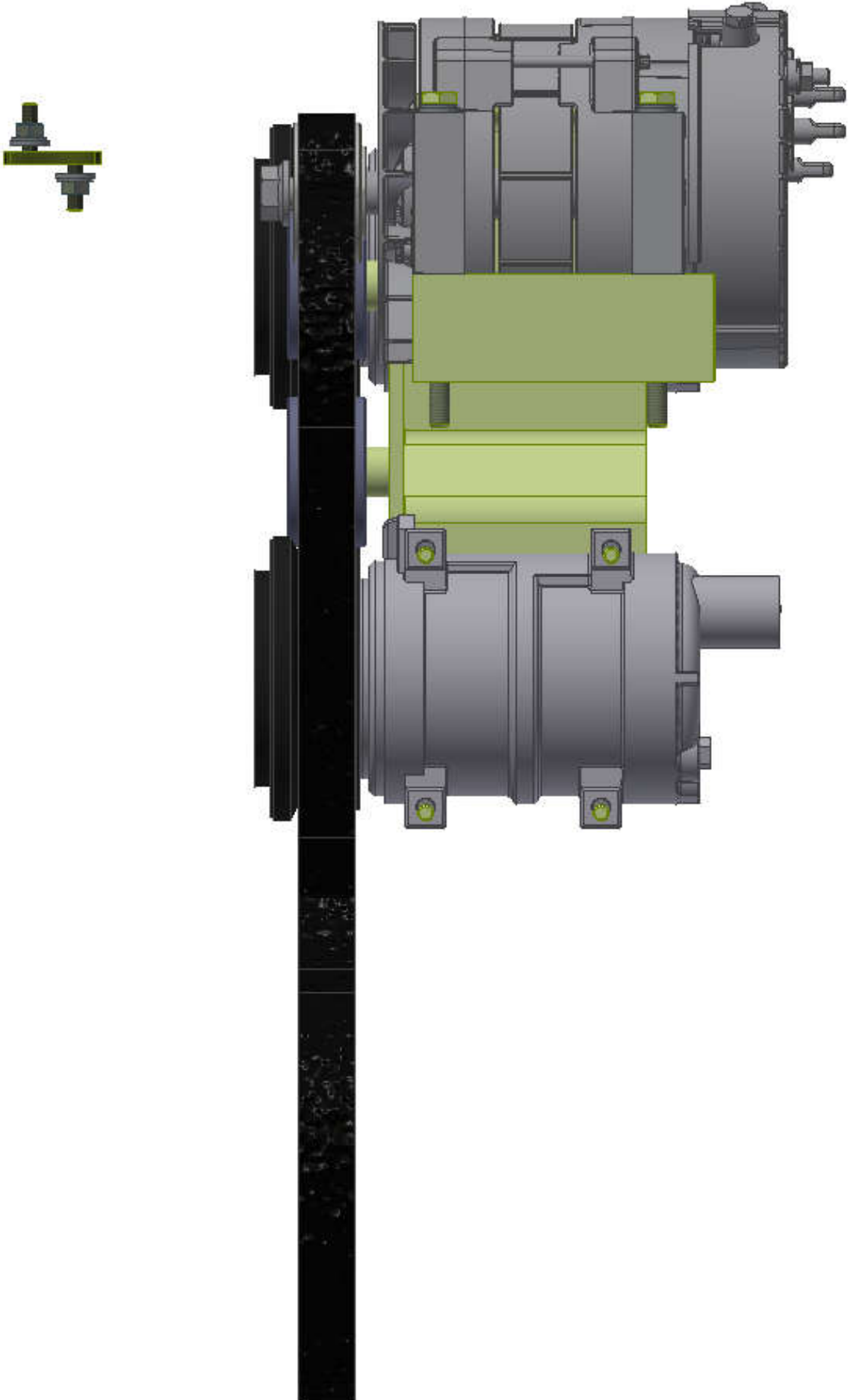

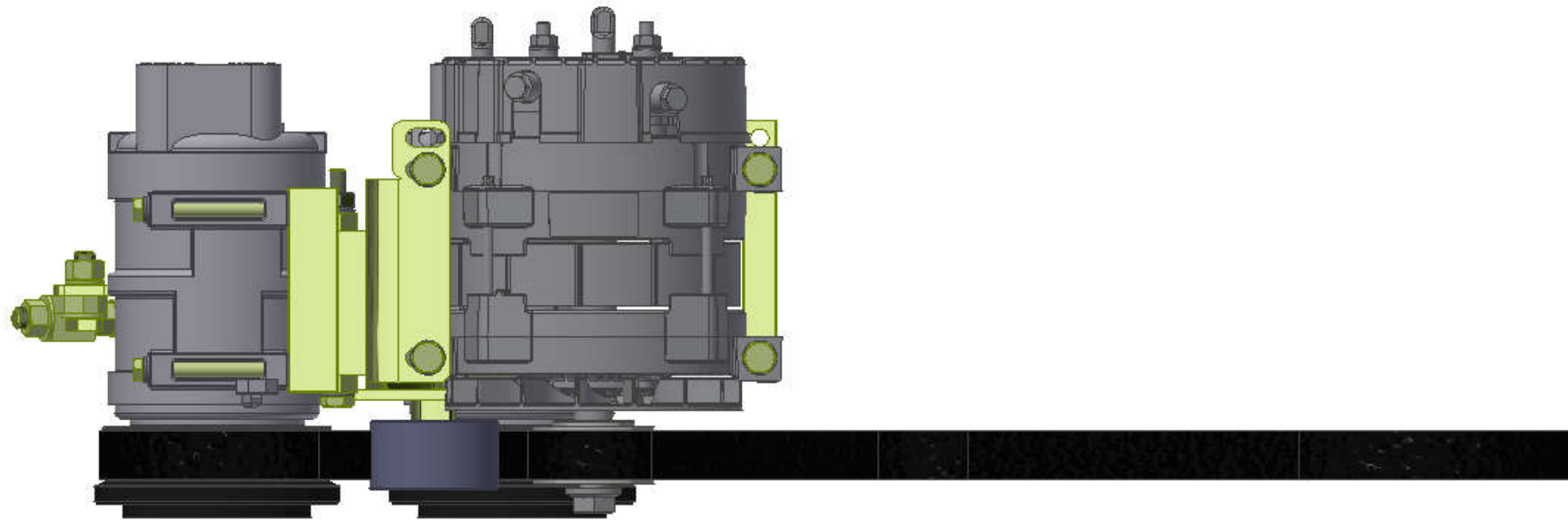

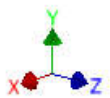

TransArctic A/C Compressor Mount Installation Disclaimer

All compressor mounts should be installed by qualified and trained personnel using proper tools and equipment in safe working conditions following industry standard guidelines for motor vehicle service and repair.

The installer of any compressor mount purchased from TransArctic must undertake all responsibility of issues arising from that compressor bracket being installed on any vehicle. As well as insure that a **proper and sufficient ground** is established between the compressors' clutches and the vehicle's engine. Mount functionality, operation and durability can all be compromised by an incompetent installation.

Due to the many different situations, parameters and application criteria, which are beyond the compressor mount manufacturer's control, TransArctic does not warrant design, durability, or operational functionality of any compressor mount improperly installed by another party.

With no implied guarantees it is the mount installer's strict responsibility to determine safety and functionality, of the compressor mount, at the time of installation.

Please contact TransArctic with any issue arising from installation so we may better improve the product. If you have any reservations about the compressor mount integrity contact TransArctic immediately at 1-877-COLD-AIR.

Mark OEM tensioner location

Install Kit

Check for Interferences

Check to ensure that the proper OEM tensioner orientation is maintained

Run engine with A/C system engaged for at least 10 minutes to run in belt

Check OEM tensioner orientation and adjust as required

Responsabilidad limitada de TransArctic en la instalación del soporte del compresor

Todos los soportes de los compresores deben ser instalados por personas calificadas y entrenadas, usando para ello los equipos y herramientas necesarios para esta labor en buenas condiciones y según las normas y guías para el servicio y/o reparación de motores de vehículos.

El instalador de los soportes comprados en TransArctic asume toda la responsabilidad de cualquier problema que surja en el soporte del compresor al vehículo; de igual manera es responsable que el cable a tierra sea conectado entre el embrague del compresor y el motor del vehículo.

Se advierte que el buen funcionamiento y la durabilidad del soporte pueden ser comprometidos por defectos en su instalación.

Debido a las diversas situaciones que se puedan presentar fuera del control del fabricante, TransArctic no garantiza el diseño, la durabilidad o el correcto funcionamiento de cualquier equipo inapropiadamente instalado por terceros.

Esta sobreentendido que el Instalador del montaje del compresor es estrictamente responsable de la seguridad y funcionamiento del equipo en el momento de la instalación.

Si tuviera algún problema o duda acerca de la instalación del soporte del compresor pongase en contacto inmediatamente con TransArctic al teléfono 1-877-COLD-AIR de modo que podamos mejorar nuestro producto.

Note la ubicación del medidor de tensión OEM

Instale el equipo

Controlar si hay interferencias.

Asegurese que el medidor de tensión mantenga la orientación justa.

Encienda el motor por lo menos 10 minutos con el sistema A/C enganchado para que la correa corra

Controle la orientación justa del medidor de tensión y ajuste a las condiciones requeridas del fabricante