

Bill of Materials Listing

TransArctic Canada Inc.

4/15/2010
Page 1 of 1

Product Number	Description	Date	Weight	Uof M	Yield
Line Component Prod#	Description	Bin Unit	Qty		
KMN82532	Mt. Kit, MForce DT, RE300, F400, 07-08	10/11/2007	239.71		0
10 BEL22616	Belt, B gr, 2616mm (103") (BX100)	each	2		
20 BMN80041	Bkt, Main, Front PI, ICRE, 2007	each	1		
30 BMN80042	Bkt, Main, Rear PI, ICRE, 2007	each	1		
40 BMN80008	Vibration Isolator, Bar, 16.50 x 2 x 1.50	each	2		
50 BMN80009	Bkt, Main, Base PI, IC, RE300	each	1		
70 BMN80025	Bkt, Back, PL, Slide, IC, RE300	each	1		
80 BMN80031	Bkt, Main, Slide, Assy, 05K, IC, RE300	each	1		
90 BMN80032	Bkt, Adapter, PL, IC, RE300	each	1		
100 BMN80043	Bkt, Spacer Plate, ICRE, 2007	each	1		
110 BMN80044	Bkt, Main Idler PI, ICRE, 2007	each	1		
124 BMN80057	Bkt, Comp, FRT, Bar, Bitzer, RE300	each	1		
127 BMN80058	Bkt, Comp, RR, Bar, Bitzer, RE300	each	1		
128 BMN80061	Bkt, Diag, Brace, IC, RE300, '07	each	1		
129 BMN80068	Bkt, Riser, Weldm't, MF DT, RE300	each	2		
130 PUA06001	Pulley, Assy, Idler, B/S, 6", Stl, Plt	each	1		
140 PUA05012	Pulley, Assy, Idler, B/BX gr, 5", STL, Plt	each	1		
150 PUL76022	Pulley, Crank, Nav DT, 7.6L, 2B/X, 8" DIA	each	1		
160 SLV17012	Sleeve, Pulley, 16.9o x 22.23mm x 12.32i	each	2		
170 SCD14912	Spacer, Col, Drl, 14.9 mm x 31.8o x 12.3i	each	2		
200 KBN82532	Bag Kit, Fasteners, KMN82532	each	1		

Bill of Materials Listing

TransArctic Canada Inc.

4/15/2010
Page 1 of 1

Product Number		Description	Bin	Date	Weight	Uof M	Yield
Line	Component Prod#	Description		Unit	Qty		
KBN82532		Bag Kit, Fasteners, KMN82532		9/27/2007	8.94		0
20	BTC12070	Bolt, Hex, 12 x 1.75 x 70mm, 10.9, Plt		each	2		
40	BTC10050	Bolt, Hex, 10 x 1.5 x 50mm, 10.9, Plt		each	6		
50	BTC10040	Bolt, Hex, 10 x 1.5 x 40mm, 10.9, Plt,FT		each	4		
60	BTQ12250	Bolt, Hex, 3/4- 10unc, 2.50", 8, Plt		each	1		
70	BTQ10301	Bolt, Hex, 5/8-18unf, 3", 8, PLT		each	2		
80	BTQ08451	Bolt, Hex, 1/2-20unc, 4.5", 8, Plt		each	1		
85	BTQ08401	Bolt, Hex, 1/2-20unf, 4", 8, Plt		each	6		
90	BTQ08301	Bolt, Hex, 1/2-20unf, 3", 8, Plt		each	1		
100	BTQ08200	Bolt, Hex, 1/2-13unc, 2.0", 8, Plt		each	1		
105	BTQ08201	Bolt, Hex, 1/2-20unc, 2.0", 8, Plt		each	2		
110	BTQ08126	Bolt, Hex, 1/2-20unf, 1.25", 8, Plt		each	11		
115	BTQ08151	Bolt, Hex, 1/2-20unf, 1.5", 8, Plt		each	1		
120	BTQ10250	Bolt, Hex, 5/8-11unc, 2.5", 8, PLT		each	1		
130	BTP08653	Bolt, Hex, 1/2-13unc, 6.5", 5, Plt, FT		each	1		
135	CSF10066	Capscrew, FH, 10 x 1.5 x 65mm, 10.9,Plt		each	2		
140	CSF10031	Capscrew, FH, 10 x 1.5 x 30mm, 10.9,Plt		each	2		
145	CSF08150	Capscrew, FH, 1/2-13 x 1.50", Alloy, Plt		each	2		
147	CSF08300	Capscrew, FH, 1/2-13 x 3", Alloy, Plt		each	2		
150	NTA12000	Nut, Hex, 12 x 1.75, 8.8, Plt		each	2		
160	NTA10000	Nut, Hex, 10 x 1.5, 8.8, Plt		each	4		
165	NTL10000	Nut, Lock, Hex, 5/8-11unc, 9, Plt		each	1		
170	NTP12000	Nut, Hex, 3/4-10unc, 5, Plt		each	1		
180	NTP08000	Nut, Hex, 1/2-13unc, 5, Plt		each	5		
190	NTP07000	Nut, Hex, 7/16-14unc, 5, Plt		each	4		
200	WFA12000	Washer, Flat, 12mm, 8.8, Plt		each	2		
210	WFA10000	Washer, Flat, 10mm, 8.8, Plt		each	14		
220	WFQ12000	Washer, Flat, 3/4", 8, Plt		each	2		
225	WFQ10000	Washer, Flat, 5/8", 8, Plt		each	4		
230	WFQ08000	Washer, Flat, 1/2", 8, Plt		each	28		
240	WFN07000	Washer, Flat, 7/16", 2, Plt		each	4		
260	WLA12000	Washer, Lock, 12mm, 8.8, Plt		each	2		
270	WLA10000	Washer, Lock, 10mm, 8.8, Plt		each	4		
280	WLP12000	Washer, Lock, 3/4", 5, Plt		each	1		
290	WLP08000	Washer, Lock, 1/2", 5, Plt		each	24		
300	WLP07000	Washer, Lock, 7/16", 5, Plt		each	4		
310	WLQ10000	Washer, Lock, 5/8", 8, Plt		each	1		

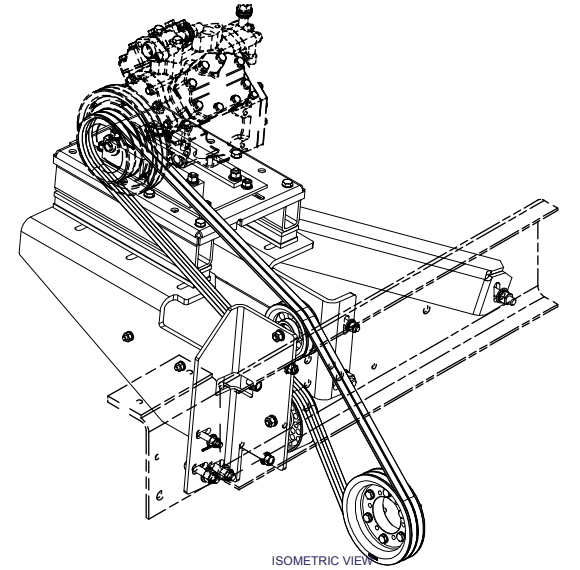
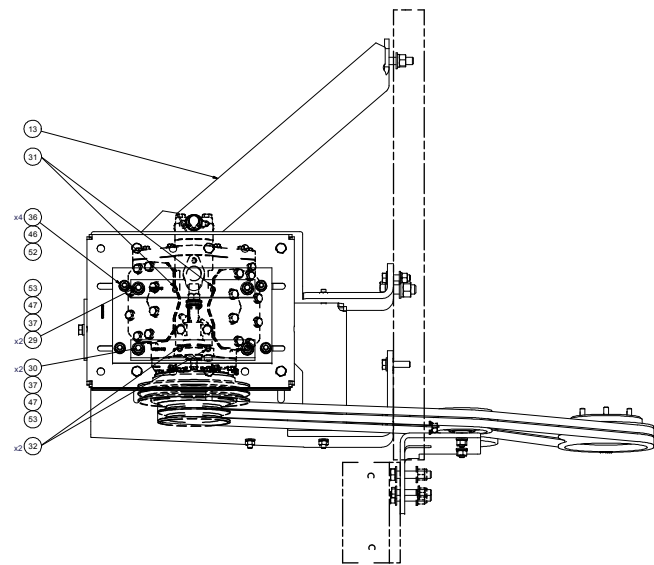

ISOMETRIC VIEW

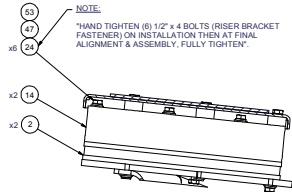

NOTE:
HAND TIGHTEN (6) 1/2" x 4 BOLTS (RISER BRACKET FASTENER) ON INSTALLATION THEN AT FINAL ALIGNMENT & ASSEMBLY, FULLY TIGHTEN

SECTION B-B

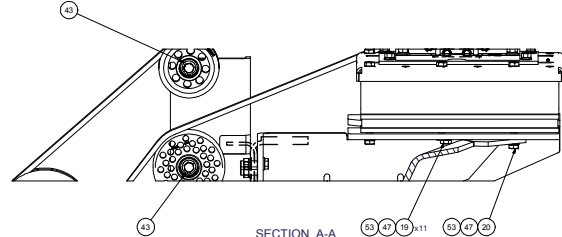

SECTION A-A

NOTE:
*CARRIER COMPRESSOR PART#: 18-10140-05

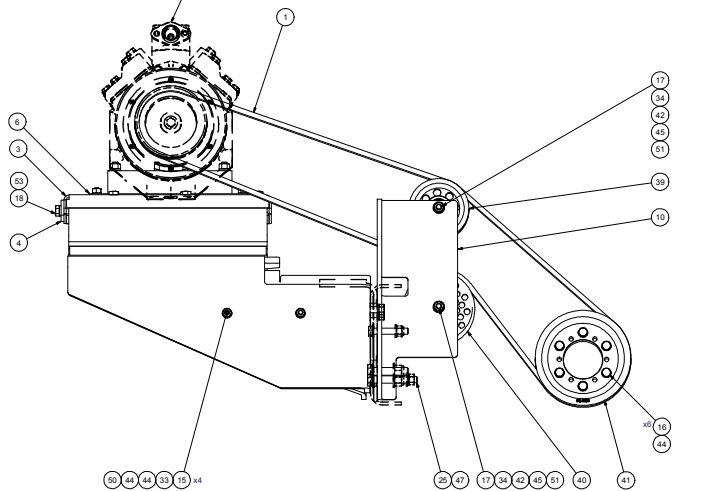

USE EXISTING LOCK NUT (TYPICAL 6 PLCS.)

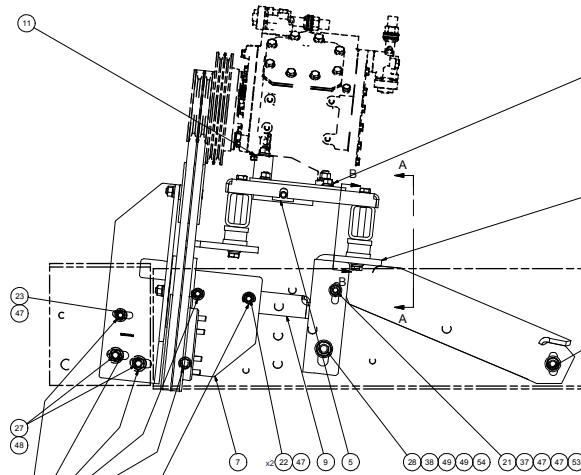

NOTES:
1) USE SERVICABLE THREADLOCKER ON ALL FASTENERS TO ENGINE COMPONENTS AND TORQUE ALL BOLTS TO S.A.E. SPECIFICATIONS.
2) SEE "TRANSARTIC A/C COMPRESSOR MOUNT INSTALLATION DISCLAIMER"

ITEM	QTY.	UOM.	PART NUMBER	PART DESCRIPTION
55	1	EACH	WLG10000	WASHER LOCK 5/8" 8. PLT
54	1	EACH	WLP12000	WASHER LOCK 3/4" 5. PLT
53	24	EACH	WLP08000	WASHER LOCK 1/2" 5. PLT
52	4	EACH	WLP07000	WASHER LOCK 7/16" 5. PLT
51	2	EACH	WLA12000	WASHER LOCK 12mm 8.8 PLT
50	4	EACH	WLA10000	WASHER LOCK 10mm 8.8 PLT
49	2	EACH	WFG12000	WASHER FLAT 3/4" 8. PLT
48	4	EACH	WFG10000	WASHER FLAT 5/8" 8. PLT
47	28	EACH	WFG08000	WASHER FLAT 1/2" 8. PLT
46	4	EACH	WFG07000	WASHER FLAT 7/16" 8. PLT
45	2	EACH	WFA12000	WASHER FLAT 12mm 8.8 PLT
44	14	EACH	WFA10000	WASHER FLAT 10mm 8.8 PLT
43	2	EACH	SU151012	SLEEVE PULLEY 15.50 x 22.23 mm x 12.19
42	2	EACH	SGD14912	SPACER COL. DRL 14.9 mm x 31.80 x 12.0
41	1	EACH	PUL78022	PULLEY CRANK NAV DT. 7.6L 28X.8" DIA
40	1	EACH	PUM09001	PULLEY ASSY IDLER B/S 8" STL PLT
39	1	EACH	PUM09012	PULLEY ASSY IDLER B/BX gr 5" STL PLT
38	1	EACH	NTF12000	NUT HEX 3/4-10UNC 5. PLT
37	5	EACH	NTF08000	NUT HEX 1/2-13UNC 5. PLT
36	4	EACH	NTF07000	NUT HEX 7/16-14UNC 5. PLT
35	1	EACH	NTA10000	NUT LOCK HEX 5/8-11UNC 9. PLT
34	2	EACH	NTA12000	NUT HEX 12 x 1.75 8.8 PLT
33	4	EACH	NTA10000	NUT HEX 10 x 1.5 8.8 PLT
32	2	EACH	CSF10085	CAPSCREW FH 10 x 1.5 x 65mm 10.9 PLT
31	2	EACH	CSF10033	CAPSCREW FH 10 x 1.5 x 30mm 10.9 PLT
30	2	EACH	CSF08300	CAPSCREW FH 3/8-18 x 3" 9. PLT
29	2	EACH	CSF08150	CAPSCREW FH 3/8-18 x 1.5" 9. PLT
28	1	EACH	BTQ12250	BOLT HEX 3/4-10UNC 2.50" 8. PLT
27	2	EACH	BTQ10501	BOLT HEX 5/8-18UNC x 3.00 8. PLT
26	1	EACH	BTQ10290	BOLT HEX 5/8-11UNC 2.50" 8. PLT
25	1	EACH	BTQ08451	BOLT HEX 1/2-20UNC x 4.50 8. PLT
24	6	EACH	BTQ08401	BOLT HEX 1/2-20UNC 4" 8. PLT
23	1	EACH	BTQ08301	BOLT HEX 1/2-20UNC x 3.00 8. PLT
22	2	EACH	BTQ08201	BOLT HEX 1/2-20UNC x 2.00 8. PLT
21	1	EACH	BTQ08200	BOLT HEX 1/2-13UNC x 2.00 8. PLT
20	1	EACH	BTQ08151	BOLT HEX 1/2-20UNC x 1.50 8. PLT
19	11	EACH	BTQ08129	BOLT HEX 1/2-20UNC x 1.25 8. PLT
18	1	EACH	BTQ08053	BOLT HEX 1/2-13UNC x 6.50 5. PLT FT
17	2	EACH	BTC12070	BOLT HEX 12 x 1.75 x 70mm 10.9 PLT
16	8	EACH	BTC10550	BOLT HEX 10 x 1.5 x 50mm 10.9 PLT
15	4	EACH	BTQ10440	BOLT HEX 10 x 1.5 x 40mm 10.9 PLT
14	2	EACH	BMN80056	BKT. RISER WELDDMT MF DT. RE300
13	1	EACH	BMN80061	BKT. DIAG. BRACE RE300 07
12	1	EACH	BMN80058	BKT. COMP. FR. BAR. BITZER RE300
11	1	EACH	BMN80057	BKT. COMP. FR. BAR. BITZER RE300
10	1	EACH	BMN80044	BKT. MANN. IDLER PL. ICRE 2007
9	1	EACH	BMN80043	BKT. SPACER PLATE ICRE 2007
8	1	EACH	BMN80042	BKT. MANN. REAR PL. ICRE 2007
7	1	EACH	BMN80041	BKT. MANN. FRONT PL. ICRE 2007
6	1	EACH	BMN80032	BKT. ADAPTER PL. IC. RE300
5	1	EACH	BMN80031	BKT. MANN. SLIDE ASSY. 6SK. IC. RE300
4	1	EACH	BMN80025	BKT. BACK PL. SLIDE IC. RE300
3	1	EACH	BMN80009	BKT. MANN. BASE PL. IC. RE300
2	2	EACH	BMN80008	VIBRATION ISOLATOR BAR 16.50 x 2 x 1.50
1	2	EACH	BEL22816	BELT B gr 2816mm (103") (BX100)

REV	DESCRIPTION	DATE	BY
01	ISSUED FOR PRODUCTION	5/14/2010	James Stewart
02	REVISED	5/14/2010	James Stewart
03	REVISED	5/14/2010	Ron Ingram
04	REVISED	5/14/2010	Date Mason

TITLE: MT KIT, MFORCE DT. RE300, F400, 07-08
 DWG NO: KMN82532
 SCALE: 1:1
 SHEET: 1 OF 1

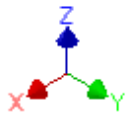
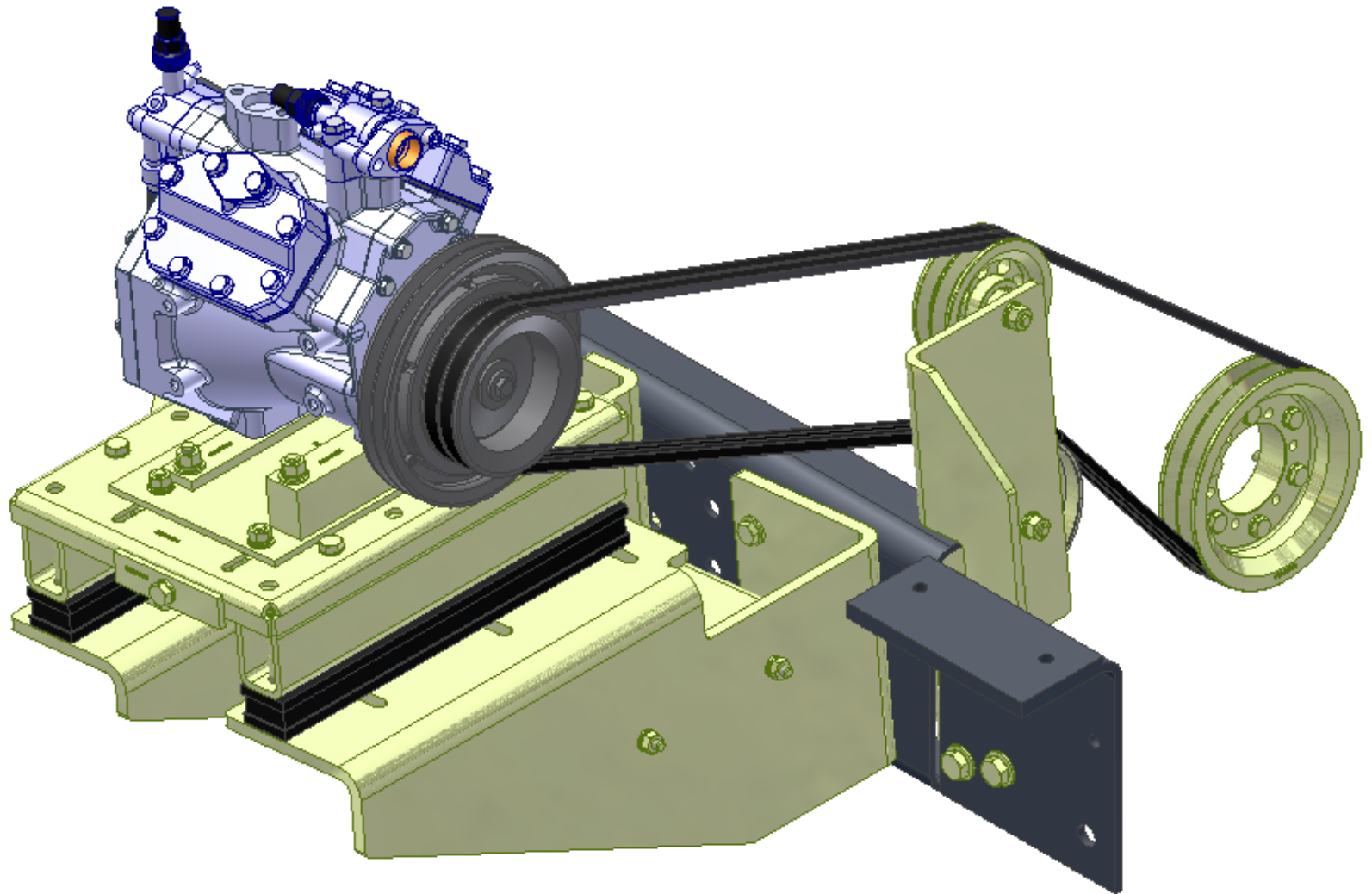

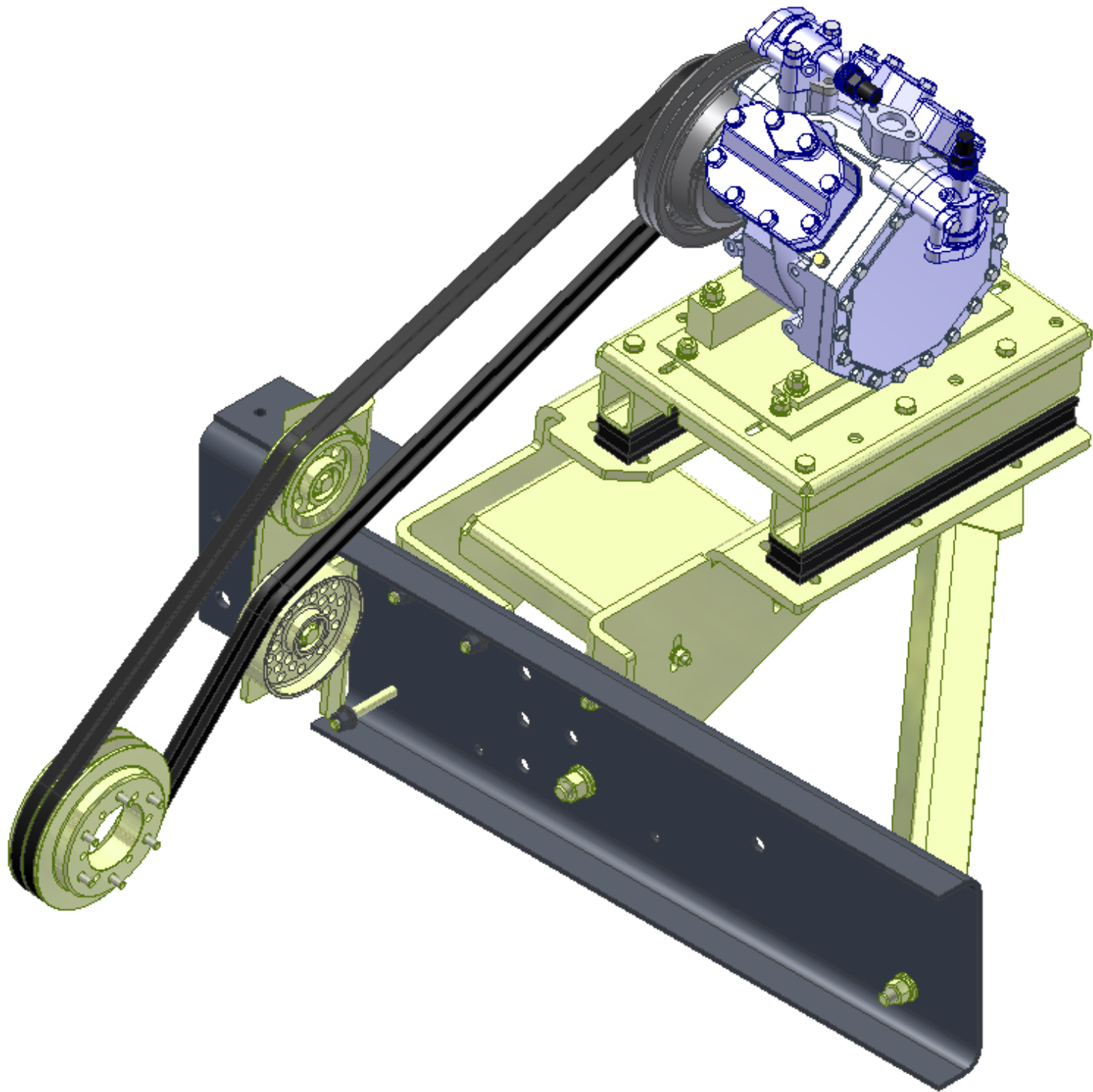

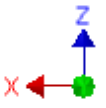
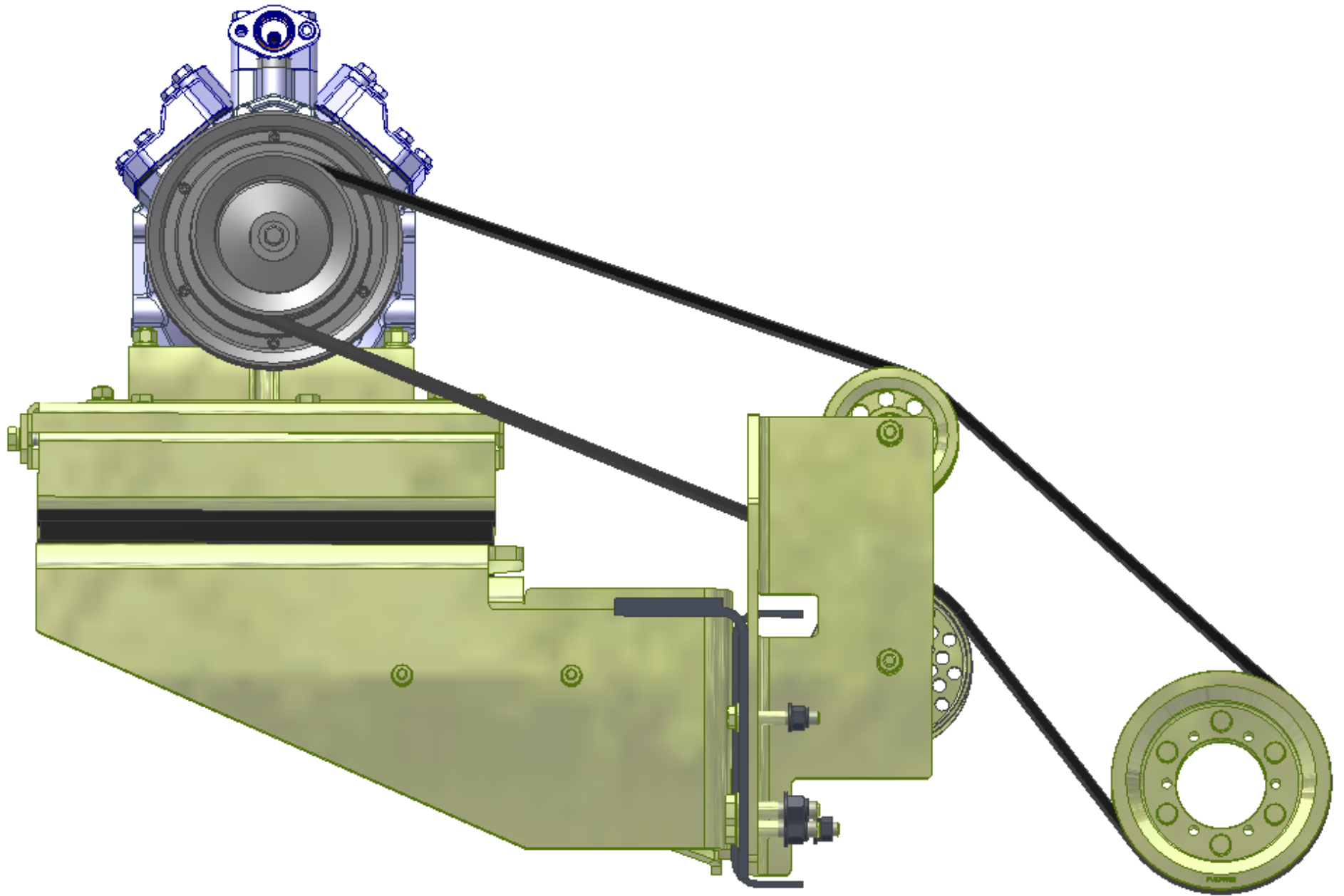

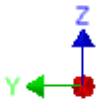
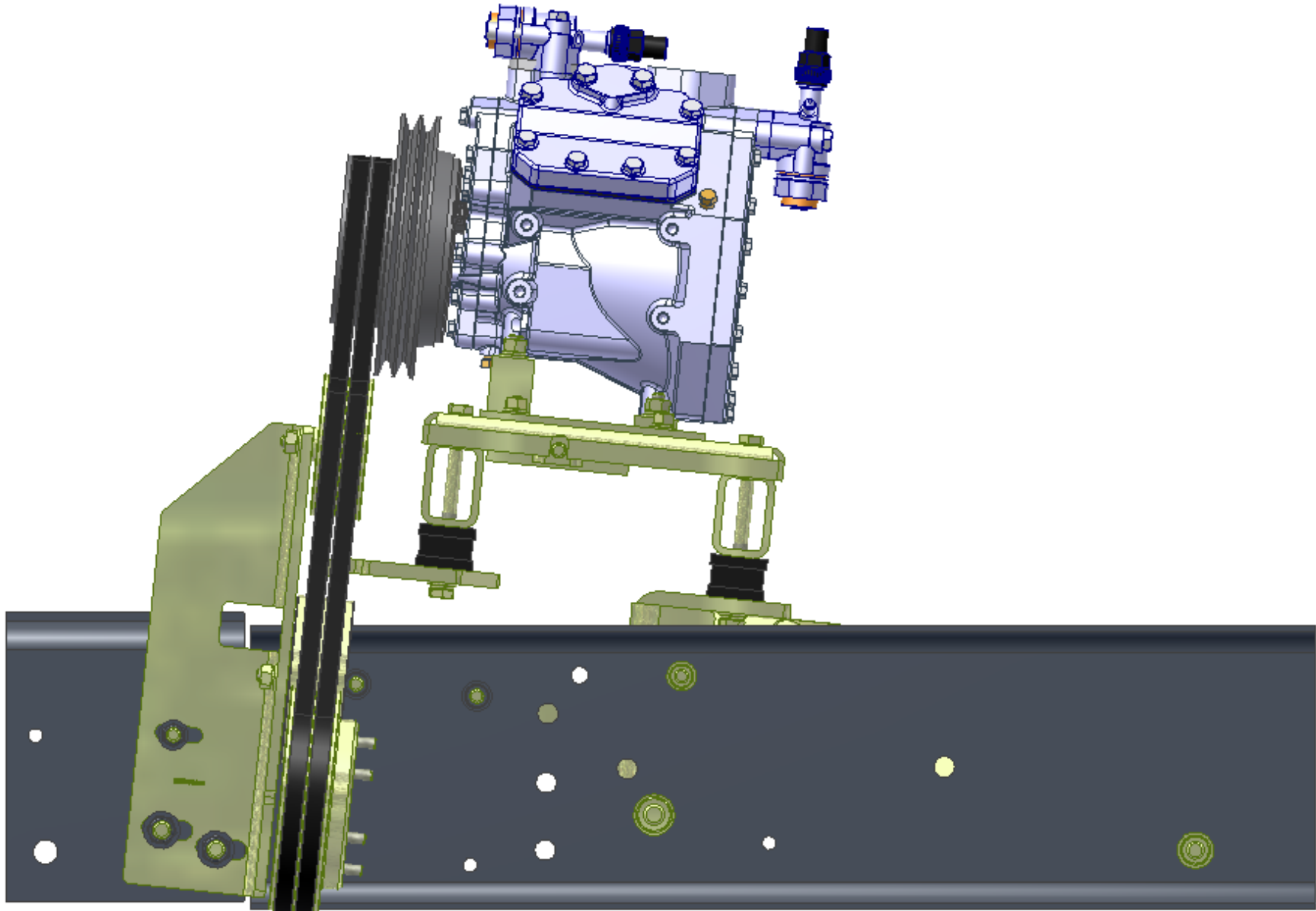

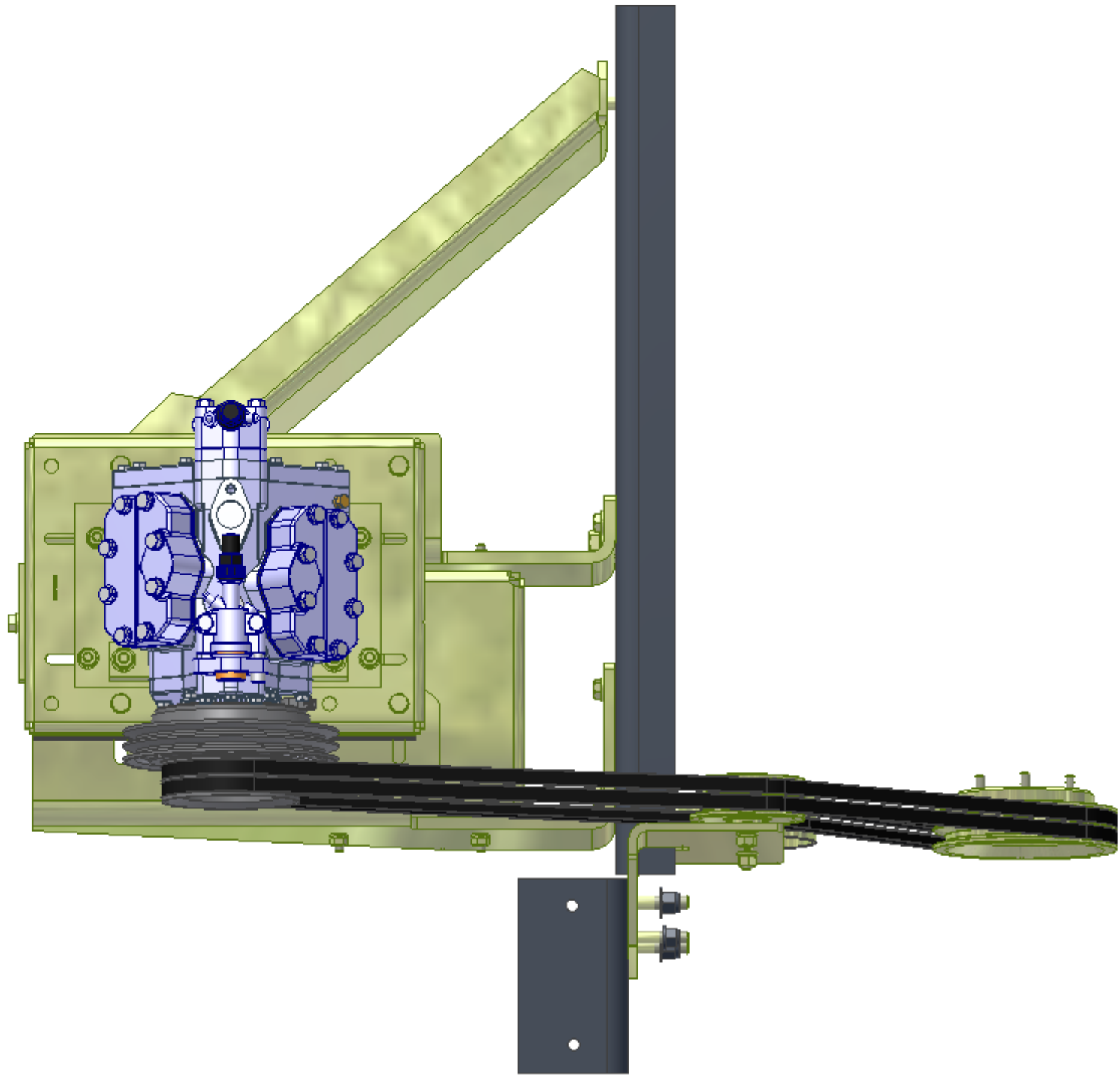

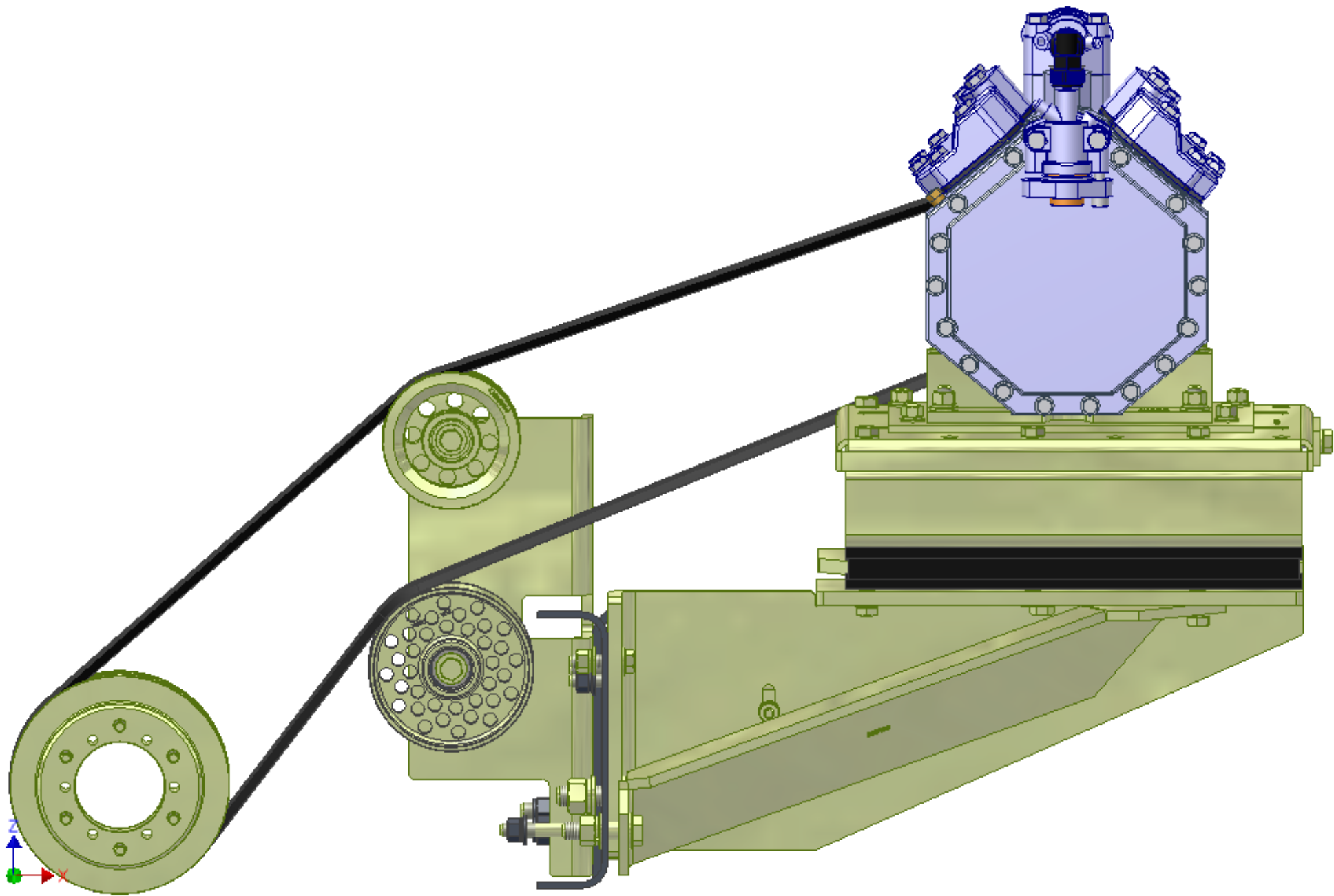

TransArctic A/C Compressor Mount Installation Disclaimer

All compressor mounts should be installed by qualified and trained personnel using proper tools and equipment in safe working conditions following industry standard guidelines for motor vehicle service and repair.

The installer of any compressor mount purchased from TransArctic must undertake all responsibility of issues arising from that compressor bracket being installed on any vehicle. As well as insure that a **proper and sufficient ground** is established between the compressors' clutches and the vehicle's engine. Mount functionality, operation and durability can all be compromised by an incompetent installation.

Due to the many different situations, parameters and application criteria, which are beyond the compressor mount manufacturer's control, TransArctic does not warrant design, durability, or operational functionality of any compressor mount improperly installed by another party.

With no implied guarantees it is the mount installer's strict responsibility to determine safety and functionality, of the compressor mount, at the time of installation.

Please contact TransArctic with any issue arising from installation so we may better improve the product. If you have any reservations about the compressor mount integrity contact TransArctic immediately at 1-877-COLD-AIR.

Mark OEM tensioner location

Install Kit

Check for Interferences

Check to ensure that the proper OEM tensioner orientation is maintained

Run engine with A/C system engaged for at least 10 minutes to run in belt

Check OEM tensioner orientation and adjust as required

Responsabilidad limitada de TransArctic en la instalación del soporte del compresor

Todos los soportes de los compresores deben ser instalados por personas calificadas y entrenadas, usando para ello los equipos y herramientas necesarios para esta labor en buenas condiciones y según las normas y guías para el servicio y/o reparación de motores de vehículos.

El instalador de los soportes comprados en TransArctic asume toda la responsabilidad de cualquier problema que surja en el soporte del compresor al vehículo; de igual manera es responsable que el cable a tierra sea conectado entre el embrague del compresor y el motor del vehículo.

Se advierte que el buen funcionamiento y la durabilidad del soporte pueden ser comprometidos por defectos en su instalación.

Debido a las diversas situaciones que se puedan presentar fuera del control del fabricante, TransArctic no garantiza el diseño, la durabilidad o el correcto funcionamiento de cualquier equipo inapropiadamente instalado por terceros.

Esta sobreentendido que el Instalador del montaje del compresor es estrictamente responsable de la seguridad y funcionamiento del equipo en el momento de la instalación.

Si tuviera algún problema o duda acerca de la instalación del soporte del compresor pongase en contacto inmediatamente con TransArctic al teléfono 1-877-COLD-AIR de modo que podamos mejorar nuestro producto.

Note la ubicación del medidor de tensión OEM

Instale el equipo

Controlar si hay interferencias.

Asegurese que el medidor de tensión mantenga la orientación justa.

Encienda el motor por lo menos 10 minutos con el sistema A/C enganchado para que la correa corra

Controle la orientación justa del medidor de tensión y ajuste a las condiciones requeridas del fabricante