

Bill of Materials Listing

10/26/2009

TransArctic Canada Inc.

Page 1 of 1

Product Number		Description	Bin	Date	Weight	Uof M	Yield
Line	Component Prod#	Description		Unit	Qty		
KMN84130		Mt. Kit, MForce DT, RE300, 05G, 07-08		10/3/2007	200.49		0
10	BEL22743	Belt, B gr, 2743mm (108") (BX105)		each	2		
20	BMN80041	Bkt, Main, Front PI, ICRE, 2007		each	1		
30	BMN80042	Bkt, Main, Rear PI, ICRE, 2007		each	1		
40	BMN80008	Vibration Isolator, Bar, 16.50 x 2 x 1.50		each	2		
50	BMN80009	Bkt, Main, Base PI, IC, RE300		each	1		
60	BMN80010	Bkt, Main, Slide, Assy, O5G, IC, RE300		each	1		
70	BMN80024	Bkt, Comp, FRT, Z, IC, RE300		each	1		
80	BMN80025	Bkt, Back, PL, Slide, IC, RE300		each	1		
90	BMN80043	Bkt, Spacer Plate, ICRE, 2007		each	1		
100	BMN80044	Bkt, Main Idler PI, ICRE, 2007		each	1		
115	BMN80061	Bkt, Diag, Brace, IC, RE300, '07		each	1		
120	PUA06001	Pulley, Assy, Idler, B/S, 6", Stl, Plt		each	1		
130	PUA05012	Pulley, Assy, Idler, B/BX gr, 5", STL, Plt		each	1		
140	PUL76022	Pulley, Crank, Nav DT, 7.6L, 2B/X, 8" DIA		each	1		
150	SLV17012	Sleeve, Pulley, 16.9o x 22.23mm x 12.32i		each	2		
160	SCD14912	Spacer, Col, Drl, 14.9 mm x 31.8o x 12.3i		each	2		
170	SCD29213	Spacer, Col, Drl, 29.21mm x 25.4o x 12.7i		each	2		
200	KBN84130	Bag Kit, Fasteners, KMN84130		each	1		

Bill of Materials Listing

6/22/2010

TransArctic Canada Inc.

Page 1 of 1

Product Number	Description	Date	Weight	Uof M	Yield
Line Component Prod#	Description	Bin Unit	Qty		
KBN84130	Bag Kit, Fasteners, KMN84130	9/10/2007	6.39		0
20 BTC12070	Bolt, Hex, 12 x 1.75 x 70mm, 10.9, Plt	each	2		
40 BTC10050	Bolt, Hex, 10 x 1.5 x 50mm, 10.9, Plt	each	6		
50 BTC10040	Bolt, Hex, 10 x 1.5 x 40mm, 10.9, Plt,FT	each	4		
55 BTQ08151	Bolt, Hex, 1/2-20unf, 1.5", 8, Plt	each	1		
60 BTQ12250	Bolt, Hex, 3/4- 10unc, 2.50", 8, Plt	each	1		
65 BTQ10250	Bolt, Hex, 5/8-11unc, 2.5", 8, PLT	each	1		
70 BTQ10301	Bolt, Hex, 5/8-18unf, 3", 8, PLT	each	2		
80 BTQ08451	Bolt, Hex, 1/2-20unc, 4.5", 8, Plt	each	1		
90 BTQ08301	Bolt, Hex, 1/2-20unf, 3", 8, Plt	each	1		
100 BTQ08200	Bolt, Hex, 1/2-13unc, 2.0", 8, Plt	each	1		
110 BTQ08201	Bolt, Hex, 1/2-20unc, 2.0", 8, Plt	each	2		
120 BTQ08126	Bolt, Hex, 1/2-20unf, 1.25", 8, Plt	each	11		
130 BTQ06150	Bolt, Hex, 3/8-16unc, 1.50", 8, Plt	each	2		
140 BTP08653	Bolt, Hex, 1/2-13unc, 6.5", 5, Plt, FT	each	1		
150 NTA12000	Nut, Hex, 12 x 1.75, 8.8, Plt	each	2		
160 NTA10000	Nut, Hex, 10 x 1.5, 8.8, Plt	each	4		
165 NTL10000	Nut, Lock, Hex, 5/8-11unc, 9, Plt	each	1		
170 NTP12000	Nut, Hex, 3/4-10unc, 5, Plt	each	1		
180 NTP08000	Nut, Hex, 1/2-13unc, 5, Plt	each	1		
190 NTP07000	Nut, Hex, 7/16-14unc, 5, Plt	each	4		
200 WFA12000	Washer, Flat, 12mm, 8.8, Plt	each	2		
210 WFA10000	Washer, Flat, 10mm, 8.8, Plt	each	14		
220 WFAQ12000	Washer, Flat, 3/4", 8, Plt	each	2		
230 WFAQ10000	Washer, Flat, 5/8", 8, Plt	each	4		
240 WFAQ08000	Washer, Flat, 1/2", 8, Plt	each	18		
250 WFN07000	Washer, Flat, 7/16", 2, Plt	each	4		
260 WFN06000	Washer, Flat, 3/8", 2, Plt	each	2		
270 WLA12000	Washer, Lock, 12mm, 8.8, Plt	each	2		
280 WLA10000	Washer, Lock, 10mm, 8.8, Plt	each	4		
290 WLP12000	Washer, Lock, 3/4", 5, Plt	each	1		
300 WLP08000	Washer, Lock, 1/2", 5, Plt	each	14		
310 WLP07000	Washer, Lock, 7/16", 5, Plt	each	4		
320 WLP06000	Washer, Lock, 3/8", 5, Plt	each	2		
330 WLQ10000	Washer, Lock, 5/8", 8, Plt	each	1		

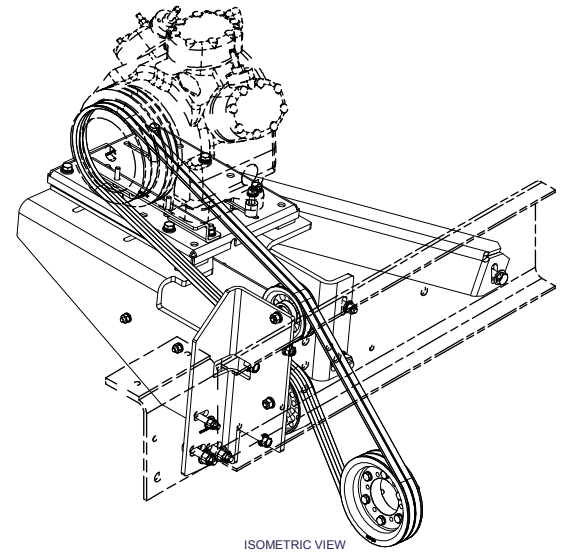
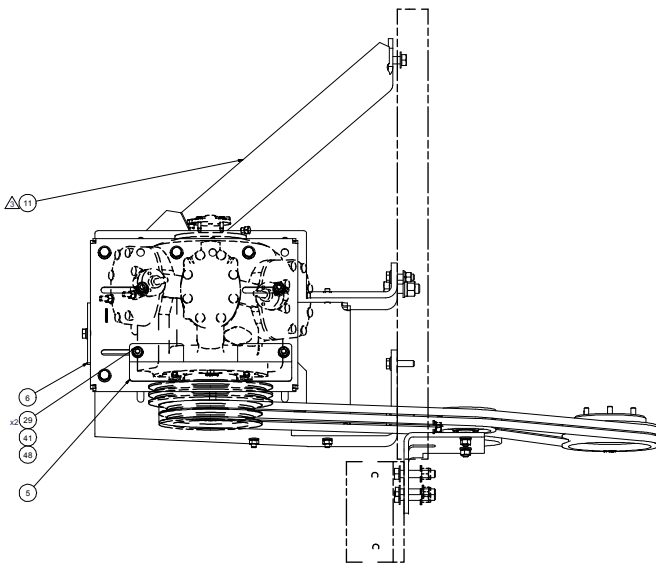

ISOMETRIC VIEW

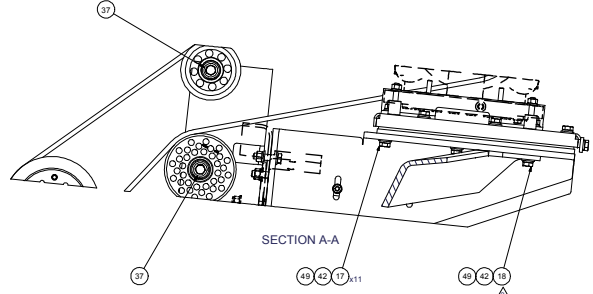

SECTION A-A

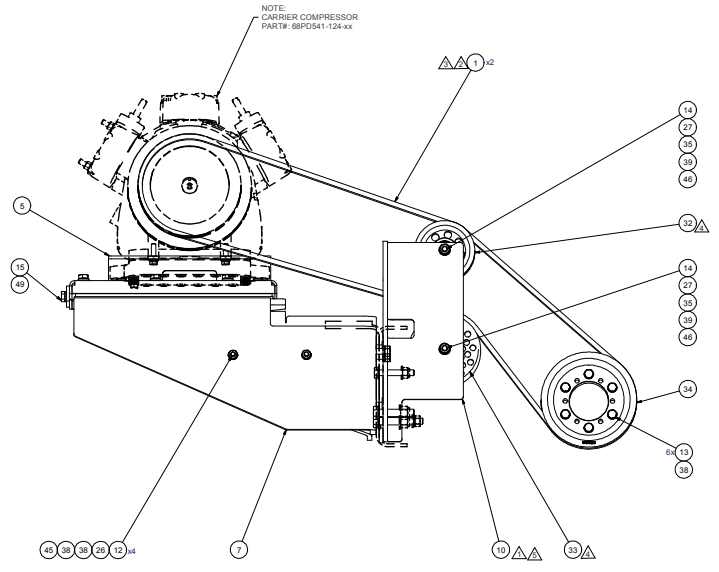

NOTE
CARRIER COMPRESSOR
PART#: 68PDS41-124-xx

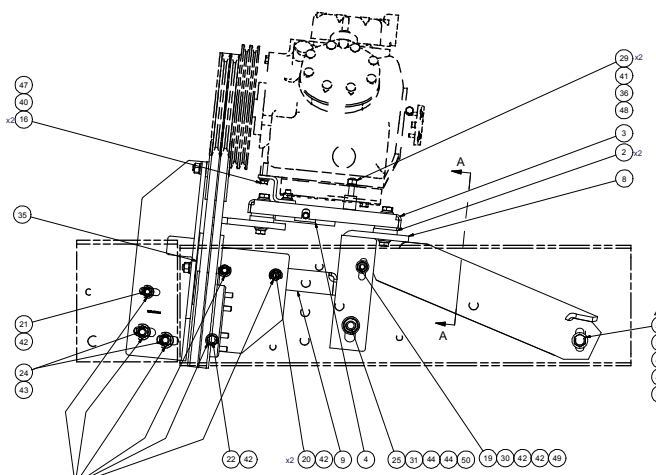

USE EXISTING LUG NUT
(TYPICAL 6 PLCS.)

ITEM	QTY	UOM	DATE NUMBER	DESCRIPTION
51	1	EACH	WLQ10000	WASHER, LOCK, 5/8", 8, PLT
50	1	EACH	WLP12000	WASHER, LOCK, 3/4", 5, PLT
49	14	EACH	WLP08000	WASHER, LOCK, 1/2", 5, PLT
48	4	EACH	WLP07000	WASHER, LOCK, 7/16", 5, PLT
47	2	EACH	WLP06000	WASHER, LOCK, 3/8", 5, PLT
46	2	EACH	WLA12000	WASHER, LOCK, 12mm, 8.8, PLT
45	4	EACH	WLA10000	WASHER, LOCK, 10mm, 8.8, PLT
44	2	EACH	WFO12000	WASHER, FLAT, 3/4", 8, PLT
43	4	EACH	WFO10000	WASHER, FLAT, 5/8", 8, PLT
42	18	EACH	WFO08000	WASHER, FLAT, 1/2", 8, PLT
41	4	EACH	WFO6000	WASHER, FLAT, 7/16", 5, PLT
40	2	EACH	WFO6000	WASHER, FLAT, 3/8", 2, PLT
39	2	EACH	WFA12000	WASHER, FLAT, 12mm, 8.8, PLT
38	14	EACH	WFA10000	WASHER, FLAT, 10mm, 8.8, PLT
37	2	EACH	SLV17612	SLEEVE, PULLEY, 16.90 x 22.23 mm x12.18
36	2	EACH	SCD29213	SPACER, COL, DRIL, 29.21mm x 25.40 x 12.7
35	2	EACH	SCD14612	SPACER, COL, DRIL, 14.9 mm x 31.80 x 12.8
34	1	EACH	PUL76022	PULLEY, CRANK, NAV DT, 7.6L, 28/8, 6" DSA
33	1	EACH	PUL06001	PULLEY, ASSY, IDLER, B/BK, 6", STL, PLT
32	1	EACH	PUL05012	PULLEY, ASSY, IDLER, B/BK, 5", STL, PLT
31	1	EACH	NTP12000	NUT, HEX, 3/4-10UNC, 5, PLT
30	1	EACH	NTP08000	NUT, HEX, 1/2-13UNC, 5, PLT
29	4	EACH	NTP07000	NUT, HEX, 7/16-14UNC, 5, PLT
28	1	EACH	NTL10000	NUT, LOCK, HEX, 5/8-11UNC, 5, PLT
27	2	EACH	NTA12000	NUT, HEX, 12 x 1.75, 8.8, PLT
26	4	EACH	NTA10000	NUT, HEX, 10 x 1.5, 8.8, PLT
25	1	EACH	BTQ12250	BOLT, HEX, 3/8-10UNC, 2.50", 8, PLT
24	2	EACH	BTQ10301	BOLT, HEX, 5/8-18UNF x 3.00, 8, PLT
23	1	EACH	BTQ10250	BOLT, HEX, 5/8-11UNC, 2.50", 8, PLT
22	1	EACH	BTQ08451	BOLT, HEX, 1/2-20UNF x 4.50, 8, PLT
21	1	EACH	BTQ08301	BOLT, HEX, 1/2-20UNF x 3.00, 8, PLT
20	2	EACH	BTQ08201	BOLT, HEX, 1/2-20UNF x 2.00, 8, PLT
19	1	EACH	BTQ08000	BOLT, HEX, 1/2-13UNC x 2.00, 8, PLT
18	1	EACH	BTQ08151	BOLT, HEX, 1/2-20UNF x 1.50, 8, PLT
17	11	EACH	BTQ08126	BOLT, HEX, 1/2-20UNF x 1.25, 8, PLT
16	2	EACH	BTQ06150	BOLT, HEX, 3/8-16UNC, 1.50", 8, PLT
15	1	EACH	BTQ06053	BOLT, HEX, 1/2-13UNC x 6.50, 5, PLT, FT
14	2	EACH	BTQ12070	BOLT, HEX, 12 x 1.75 x 70mm, 10.9, PLT
13	6	EACH	BTQ10050	BOLT, HEX, 10 x 1.5 x 50mm, 10.9, PLT
12	4	EACH	BTQ10040	BOLT, HEX, 10 x 1.5 x 40mm, 10.9, PLT
11	1	EACH	BMN80061	BKT, DIAG, BRACE, RE300, 07
10	1	EACH	BMN80044	BKT, MAIN, IDLER PL, ICRE, 2007
9	1	EACH	BMN80043	BKT, SPACER PLATE, ICRE, 2007
8	1	EACH	BMN80042	BKT, MAIN, REAR PL, ICRE, 2007
7	1	EACH	BMN80041	BKT, MAIN, FRONT PL, ICRE, 2007
6	1	EACH	BMN80025	BKT, BACK, PL, SLIDE, IC, RE300
5	1	EACH	BMN80024	BKT, COMP, FRNT, 2, IC, RE300
4	1	EACH	BMN80010	BKT, MAIN, SLIDE, ASSY, IC, RE300
3	1	EACH	BMN80009	BKT, MAIN, BASE PL, IC, RE300
2	2	EACH	BMN80008	VIBRATION ISOLATOR, BAR, 16.50 x 2 x 1.50
1	2	EACH	BEL2743	BELT, B gr, 2743mm (108") (BX105)

TRANSARCTIC INC.

DATE: 11/8/2007
BY: James Stewart
APPROVED: Date Mason

BILL OF MATERIALS

MT KIT, MForce DT, RE300, 05G, '07

DWG NO: KMN84130
REV: 5

SCALE: 1:1
SHEET: 1 OF 1

NOTES:
1) USE SERVICABLE THREADLOCKER ON ALL FASTENERS TO ENGINE COMPONENTS AND TORQUE ALL BOLTS TO S.A.E. SPECIFICATIONS.
2) SEE 'TRANSARCTIC A/C COMPRESSOR MOUNT INSTALLATION DISCLAIMER'.

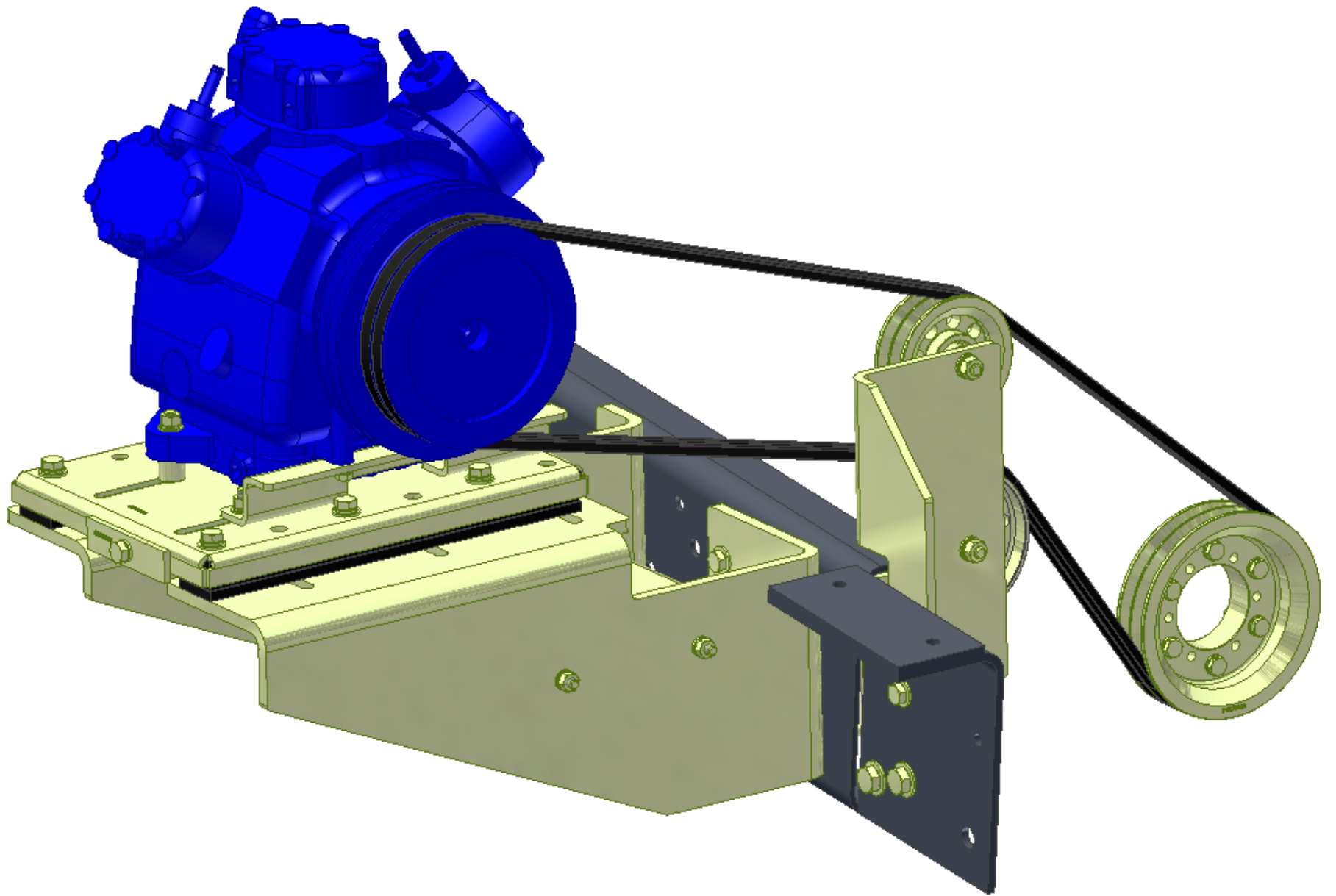

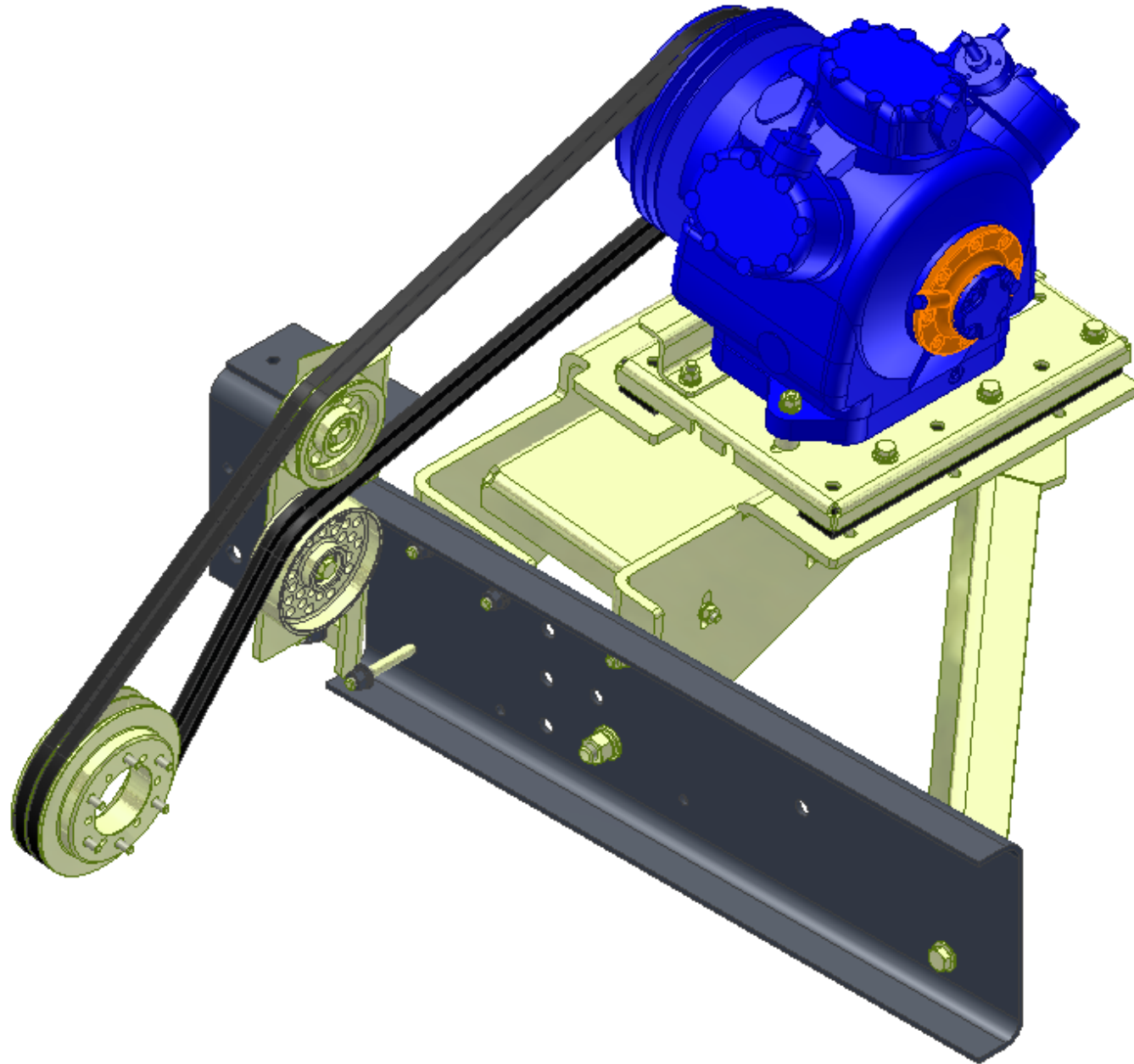

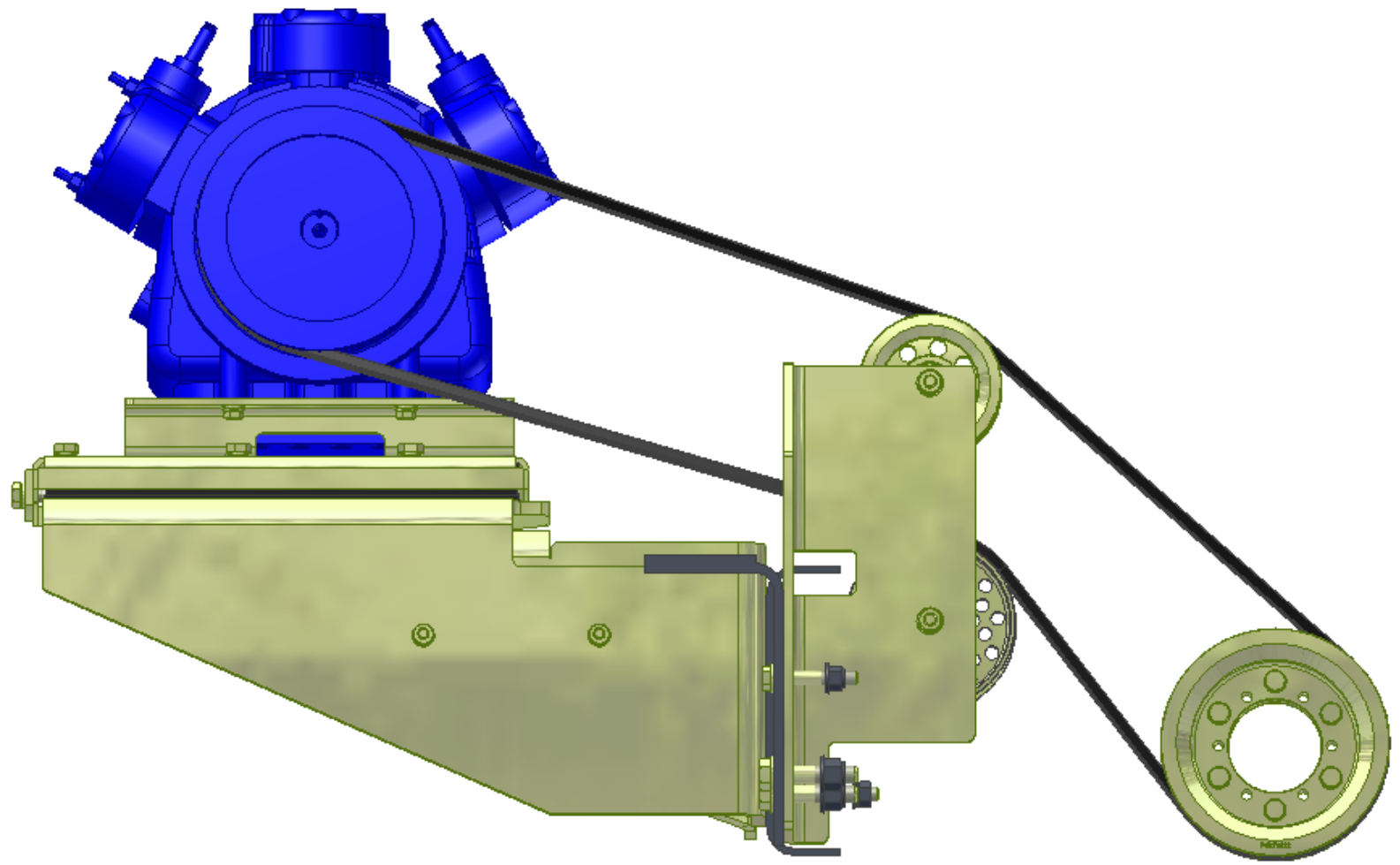

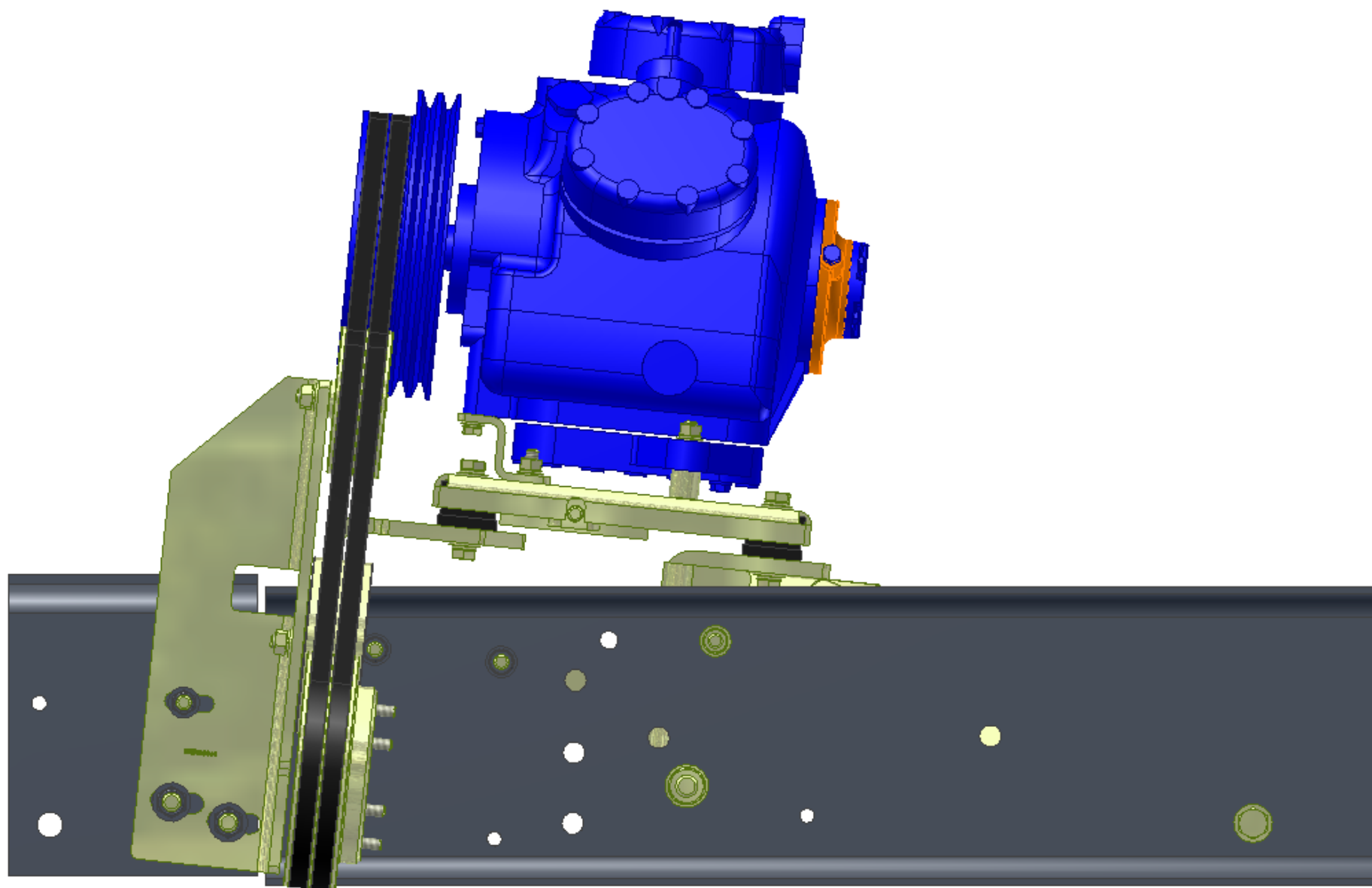

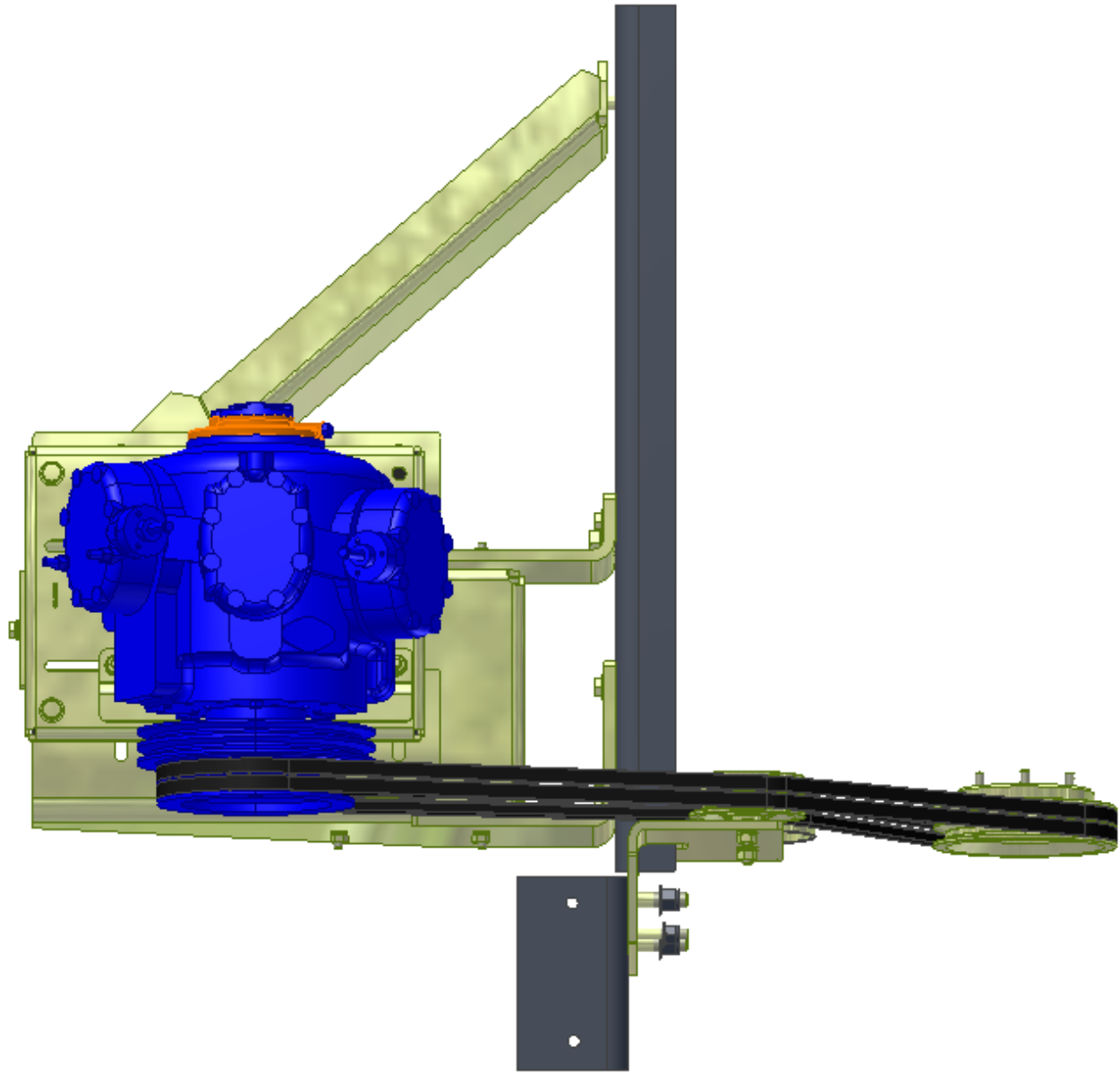

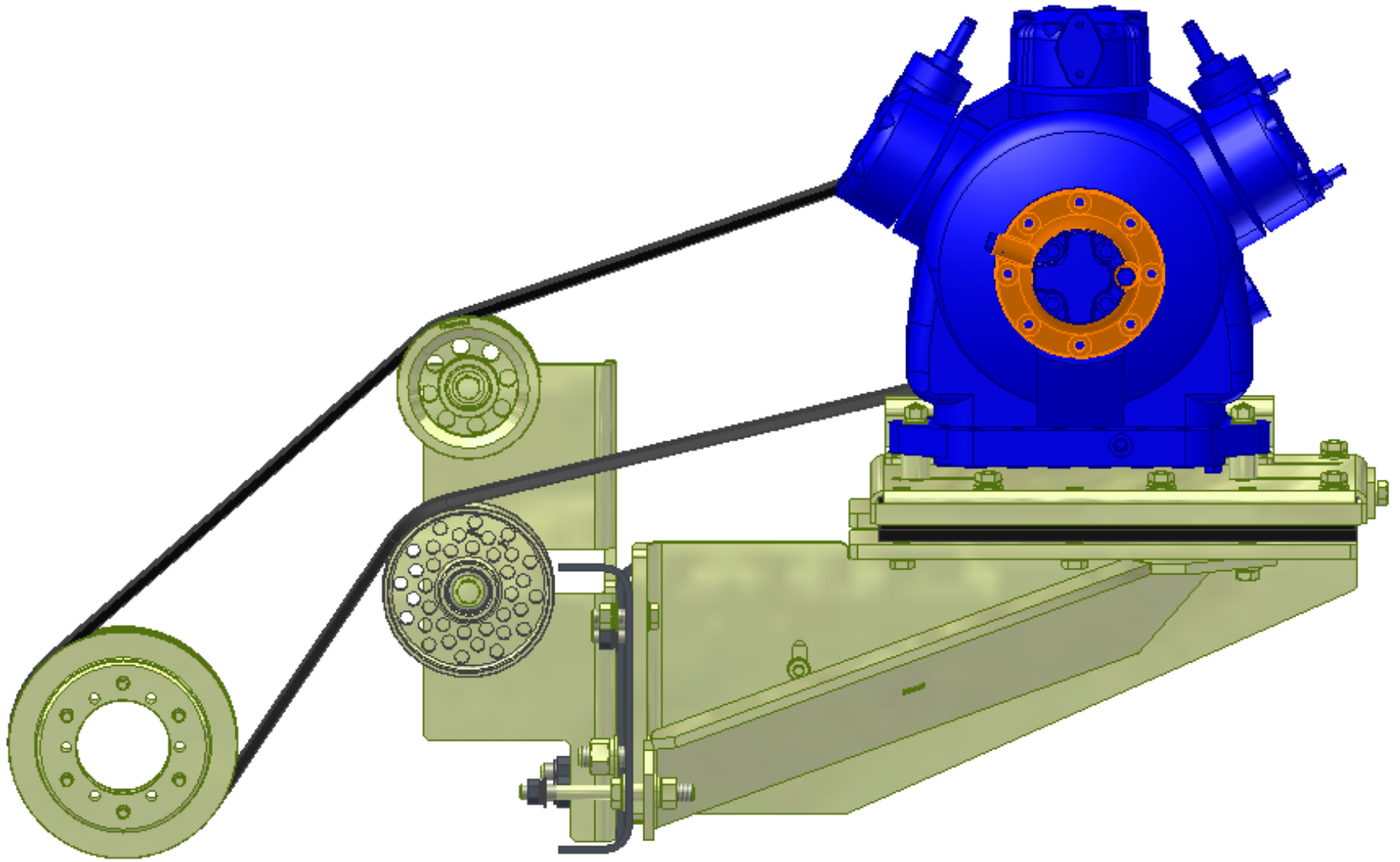

TransArctic A/C Compressor Mount Installation Disclaimer

All compressor mounts should be installed by qualified and trained personnel using proper tools and equipment in safe working conditions following industry standard guidelines for motor vehicle service and repair.

The installer of any compressor mount purchased from TransArctic must undertake all responsibility of issues arising from that compressor bracket being installed on any vehicle. As well as insure that a **proper and sufficient ground** is established between the compressors' clutches and the vehicle's engine. Mount functionality, operation and durability can all be compromised by an incompetent installation.

Due to the many different situations, parameters and application criteria, which are beyond the compressor mount manufacturer's control, TransArctic does not warrant design, durability, or operational functionality of any compressor mount improperly installed by another party.

With no implied guarantees it is the mount installer's strict responsibility to determine safety and functionality, of the compressor mount, at the time of installation.

Please contact TransArctic with any issue arising from installation so we may better improve the product. If you have any reservations about the compressor mount integrity contact TransArctic immediately at 1-877-COLD-AIR.