

Bill of Materials Listing

TransArctic Canada Inc.

7/21/2017
Page 1 of 1

Product Number		Description	Bin	Date	Weight	Uof M	Yield
Line	Component	Prod#	Description	Unit	Qty		
KMC62705			Mt Kit, ISB, C2, TM-43, 12V, '13		5/14/2015	55.46	0
5	PAC23150		Pack, Carton, 23" x 15" x 10", 51 ECT	each	1		
10	BEL61524		Belt, 6gr, 1524mm (60.0") (5060600)	each	1		
20	BMC67122		BKT, MAIN,WLDT, D-S,6.7L, ISB, C2, TM-43	each	1		
30	BMC67125		BKT, WELDM'T, RAD, ISB, C2, KMC62705	each	1		
40	BMC67130		BKT,SPACER, RAD, ISB, C2, KMC62705	each	1		
41	FSP59286		Spacer, Fan, Pulley, ISB, 28.6mm (1.13")	each	1		
42	FSP62905		Spacer, Fan, Pulley, ISB, 29.05mm(1.14")	each	1		
60	PUL67006		Pulley, Crank, ADD-ON, Cum, ISB, 6.7, P6	each	1		
70	PUL60076		Pulley, Idler, Frontside, P6,76d (89051)	each	1		
90	SCD38430		Spacer, Step, Drl,38.4mm x 34.9o x10.08i	each	1		
91	SCD14213		Spacer, Col, Drl, 14.2mm x25.4o x12.7i	each	1		
92	SCD32512		Spacer, Col, Drl, 32.5mm x 25.4o x 12.3i	each	1		
95	SLV17110		Sleeve, Pulley,S,16.9o x 22.23mm x 10.3i	each	1		
100	NTS10254		Nut, Tensioner, 10 mm, 25.4 mm o/a, PLT	each	1		
185	TEN80005		Tenr, HD Spring, BackSide, CCW (89430)	each	1		
200	HOA01002		Hose, Air, 1" ID	feet	3.00		
210	KBC62705		Bag Kit, Fasteners, KMC62705	each	1		

Bill of Materials Listing

TransArctic Canada Inc.

7/13/2017
Page 1 of 1

Product Number		Description	Bin	Date	Weight	Uof M	Yield
Line	Component Prod#	Description		Unit	Qty		
KBC62705		Bag Kit, Fasteners, KMC62705		5/14/2015	4.36		0
10	BTC10060	Bolt, Hex, 10 x 1.5 x 60mm, 10.9, Plt		each	4		
20	BTC10065	Bolt, Hex, 10 x 1.5 x 65mm, 10.9, Plt,FT		each	3		
40	BTC10090	Bolt, Hex, 10 x 1.5 x 90mm, 10.9, Plt		each	2		
50	BTC10130	Bolt, Hex, 10 x 1.5 x 130mm, 10.9, Plt		each	6		
55	BTC12035	Bolt, Hex, 12 x 1.75 x 35mm, 10.9,Plt,FT		each	3		
70	BTC12130	Bolt, Hex, 12 x 1.75 x 130mm, 10.9, Plt		each	1		
80	CSS12090	Capscrew, SH, 12 x 1.25 x 90mm, 12.9,BLK		each	6		
90	NTA10000	Nut, Hex, 10 x 1.5, 8.8, Plt		each	1		
110	WFA10000	Washer, Flat, 10mm, 8.8, Plt		each	10		
120	WFA12000	Washer, Flat, 12mm, 8.8, Plt		each	4		
130	WFS12002	Washer, Flat, Hdn, 12mm, Stl, BLK		each	6		
150	WLA10000	Washer, Lock, 10mm, 8.8, Plt		each	9		
160	WLA12000	Washer, Lock, 12mm, 8.8, Plt		each	4		
190	CSF10051	Capscrew, FH, 10 x 1.5 x 50mm, 10.9,Plt		each	2		
200	BTQ08150	Bolt, Hex, 1/2-13unc, 1.5", 8, Plt		each	1		
210	NTQ08000	Nut, Hex, 1/2-13unc, 8, Plt		each	1		
220	WLQ08000	Washer, Lock, 1/2", 8, Plt		each	1		
230	WFQ08000	Washer, Flat, 1/2", 8, Plt		each	1		

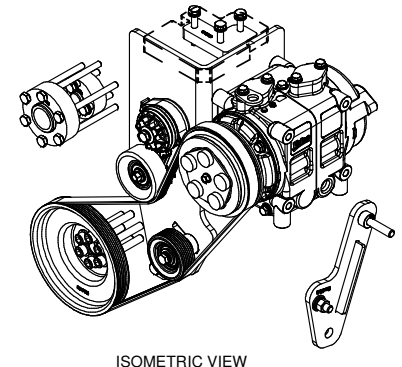
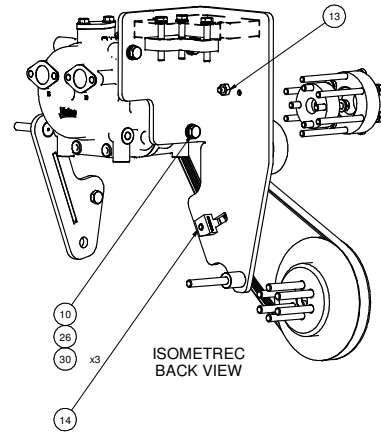
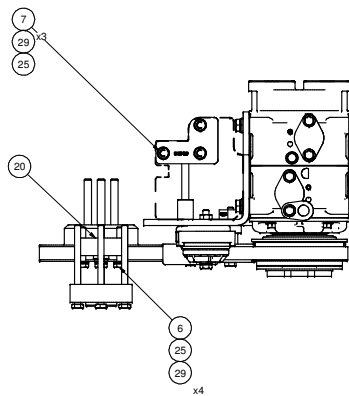

ISOMETRIC VIEW

BELT SITS IN FRONT 6 GROOVES OF COMPRESSOR PULLEY

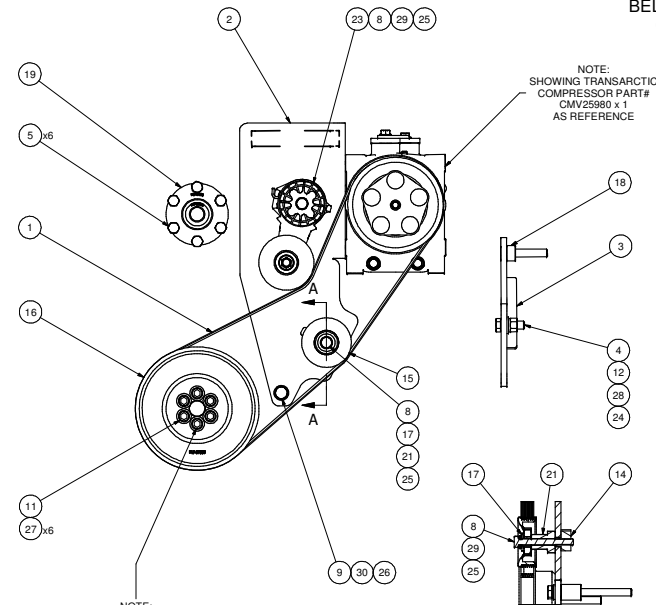

NOTE:
SHOWING TRANSARGTIC
COMPRESSOR PART#
CMV25980 x 1
AS REFERENCE

SECTION A-A
SCALE 1 / 4

NOTE:
TORQUE TO: 37 FT-LB PLAIN & LUBRICATED W/ CLEAN ENGINE OIL (15W-40)
(SH. CAPSCREW M12 x 1.25 x 90mm)
TIGHTEN IN TWO STEPS IN A CRIS-CROSS TIGHTENING SEQUENCE PATTERN

- NOTES:
1) USE SERVICABLE THREADLOCKER ON ALL FASTENERS TO ENGINE COMPONENTS AND TORQUE ALL BOLTS TO S.A.E SPECIFICATIONS.
2) SEE "TRANSARGTIC A/C COMPRESSOR MOUNT INSTALLATION DISCLAIMER"

ITEM	QTY	UM	PART NUMBER	DESCRIPTION
108	1	EACH	CMV25980	TM-43 8PK150 12V AWA '2
30	4	EACH	WLA12000	WASHER, LOCK, 12mm, 8.8, PLT
29	9	EACH	WLA10000	WASHER, LOCK, 10mm, 8.8, PLT
28	1	EACH	WLG08000	WASHER, LOCK, 1/2", 8, PLT
27	6	EACH	WFS12002	WASHER, FLAT, HDN, 12mm, STL, BLK
26	4	EACH	WFA12000	WASHER, FLAT, 12mm, 8.8, PLT
25	10	EACH	WFA10000	WASHER, FLAT, 10mm, 8.8, PLT
24	1	EACH	WFO08000	WASHER, FLAT, 1/2", 8, PLT
23	2	EACH	TENR00005	TENR, HD SPRING, BACKSIDE, CCW (89430)
22	1	EACH	SCD32512	Spacer, Col, Drl, 32.5 mm x 25.4 o x12.3l
21	1	EACH	SCD38430	SPACER, STEP, DRL, 38.4mm x 38.1o x10.08l
20	1	EACH	FSP59286	SPACER, FAN, PULLEY, ISC, 28.6mm (1.13")
19	1	EACH	FSP62905	SPACER, FAN, PULLEY, ISB, 29.05mm (1.14")
18	1	EACH	SCD14213	SPACER, COL, DPL, 14.2mm x25.4o x12.7l
17	1	EACH	SLV17110	SLEEVE, PULLEY, S, 16.9o x 22.23mm x 10.3l
16	1	EACH	PUL67006	PULLEY, CRANK, ADD-ON, CUM, ISB, 6.7, P6
15	1	EACH	PUL60076	PULLEY, P6, 3.195" DIA.
14	1	EACH	NTS10254	NUT, TENSIONER, 10 mm, 25.4 mm o/a, PLT
13	1	EACH	NTA10000	NUT, HEX, 10 x 1.5, 8.8, PLT
12	1	EACH	NTQ08000	NUT, HEX, 1/2-13UNC, 8, PLT
11	6	EACH	CSS12090	CAPSCREW, SH, 12 x 1.25 x 90mm, 12.9, PLT
10	3	EACH	BTC12035	BOLT, HEX, 12 x 1.75 x 35mm, 10.9, PLT
9	1	EACH	BTC12130	BOLT, HEX, 12 x 1.75 x 130mm, 10.9, PLT
8	2	EACH	BTC10090	BOLT, HEX, 10 x 1.5 x 90mm, 10.9, PLT
7	3	EACH	BTC10065	BOLT, HEX, 10 x 1.5 x 65mm, 10.9, PLT
6	4	EACH	BTC10060	BOLT, HEX, 10 x 1.5 x 60mm, 10.9, PLT
5	6	EACH	BTC10130	BOLT, HEX, 10 x 1.5 x 130mm, 10.9, PLT
4	1	EACH	BTQ08150	BOLT, HEX, 1/2-13UNC x 1.50, 8, PLT
3	1	EACH	BMC67125	BKT, WELDMT, RAD, ISB, C2, KMC62705
2	1	EACH	BMC67122	BKT, MAIN, WLDT, D-S, 6.7L, ISB, C2, TM-43
1	1	EACH	BEL61524	BELT, 6Gr, 1524mm (60")

1	MODIFIED BMC67122	6/14/2017	KEY	1/4/2016
0	RELEASED TO PRODUCTION	7/4/2016	REV	CA
REV/ECN	DESCRIPTION:	DATE:	BY:	
			Val Jakowlew	1/4/2016
			James Stewart	1/4/2016
			Dale Mason	1/4/2016

TRANSARGTIC INC.

Mt Kit, ISB, 6.7L, C2, TM-43

SIZE: D DWG NO: KMC62705 REV: 1

SCALE: 1 : 4 SHEET 1 OF 1

UNSPECIFIED TOLERANCES: (ALL DIM) (UNLESS OTHERWISE SPECIFIED)
 ONE DECIMAL PLACE (10) .05 (10.00) .010
 TWO DECIMAL PLACE (20) .010 (20.00) .005
 FRACTIONAL (1/32) ANGULAR ± .01

THIRD ANGLE PROJECTION

DRAWING UNIT OF MEASURE: MM (INCH)

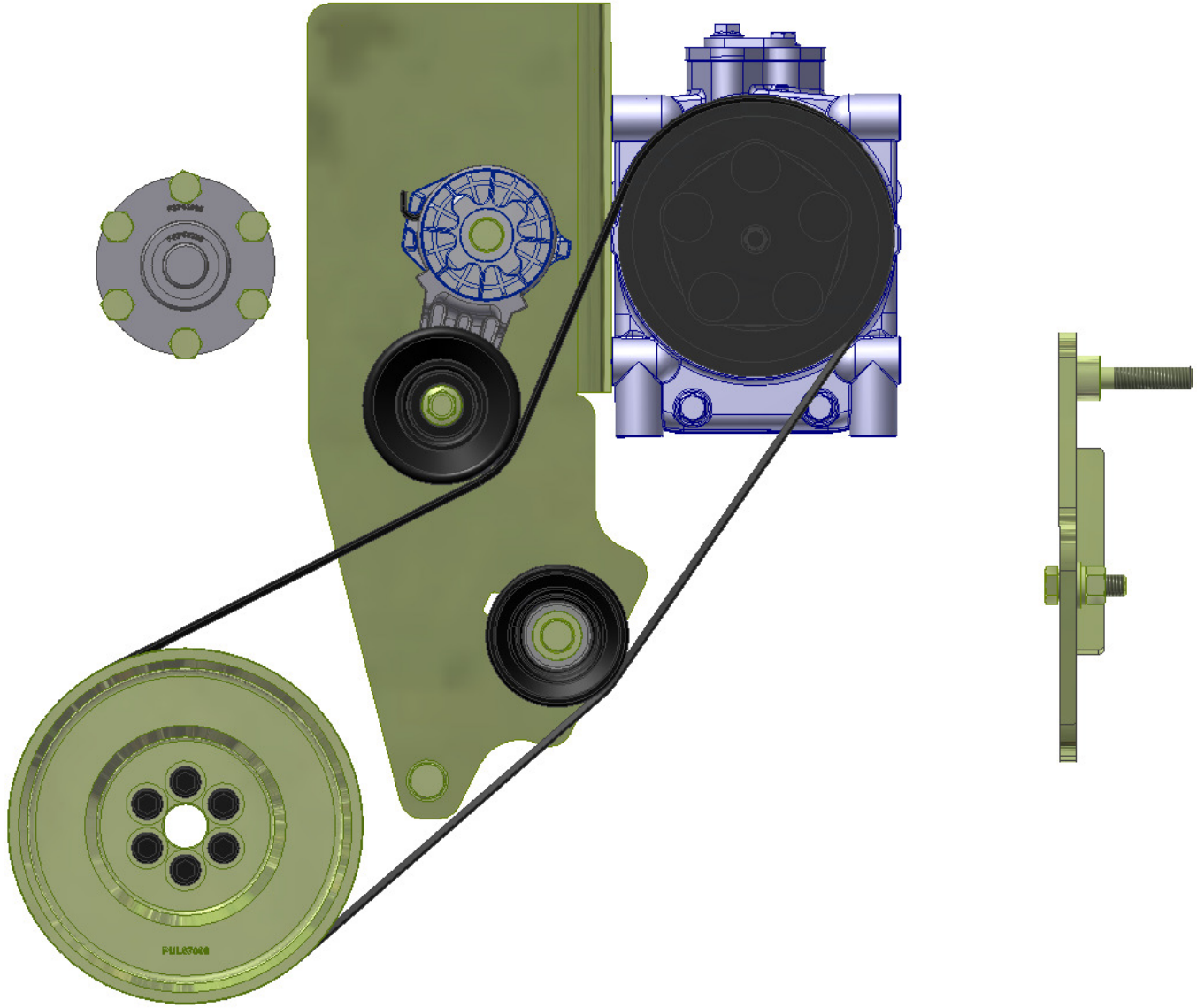

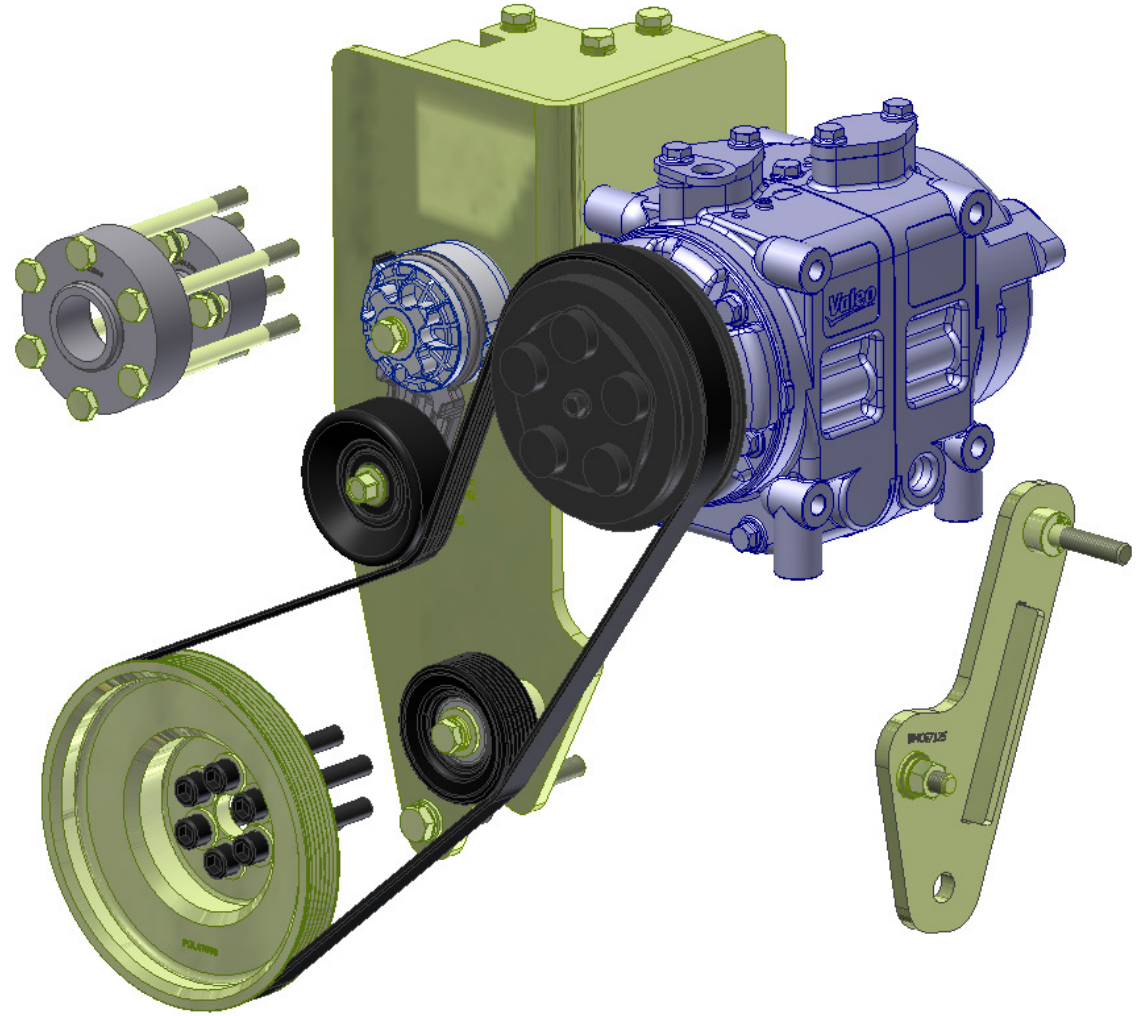

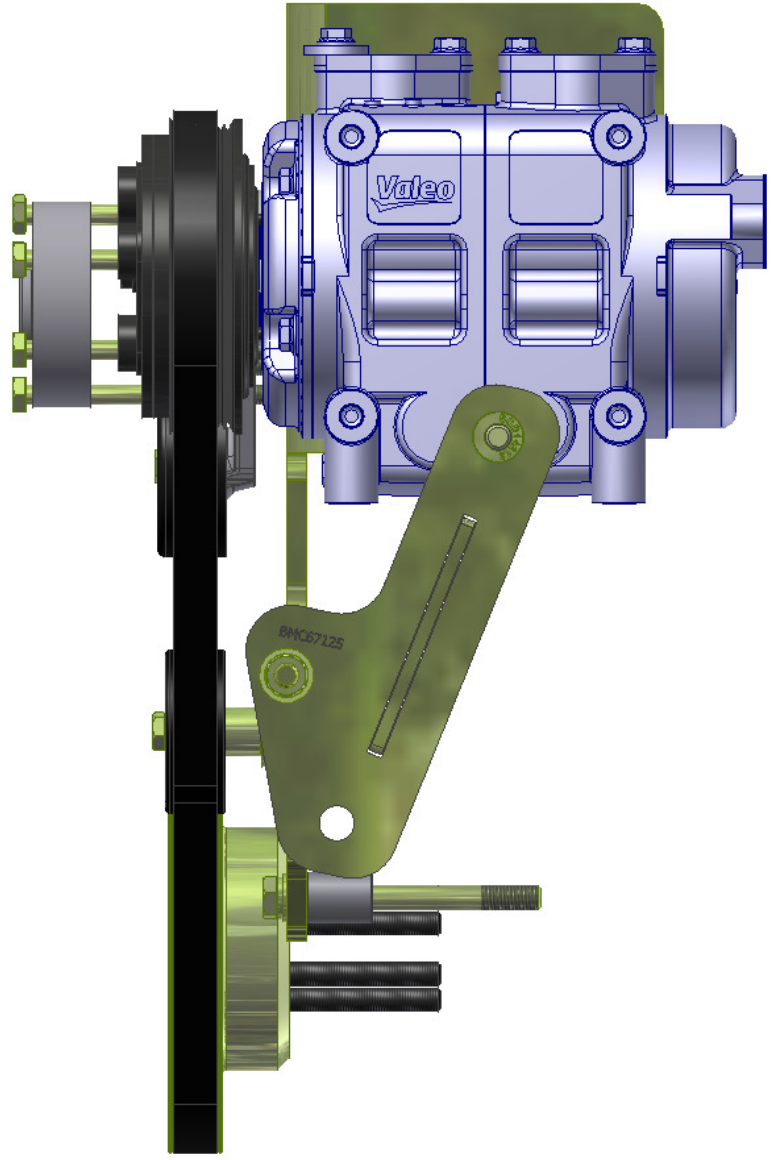

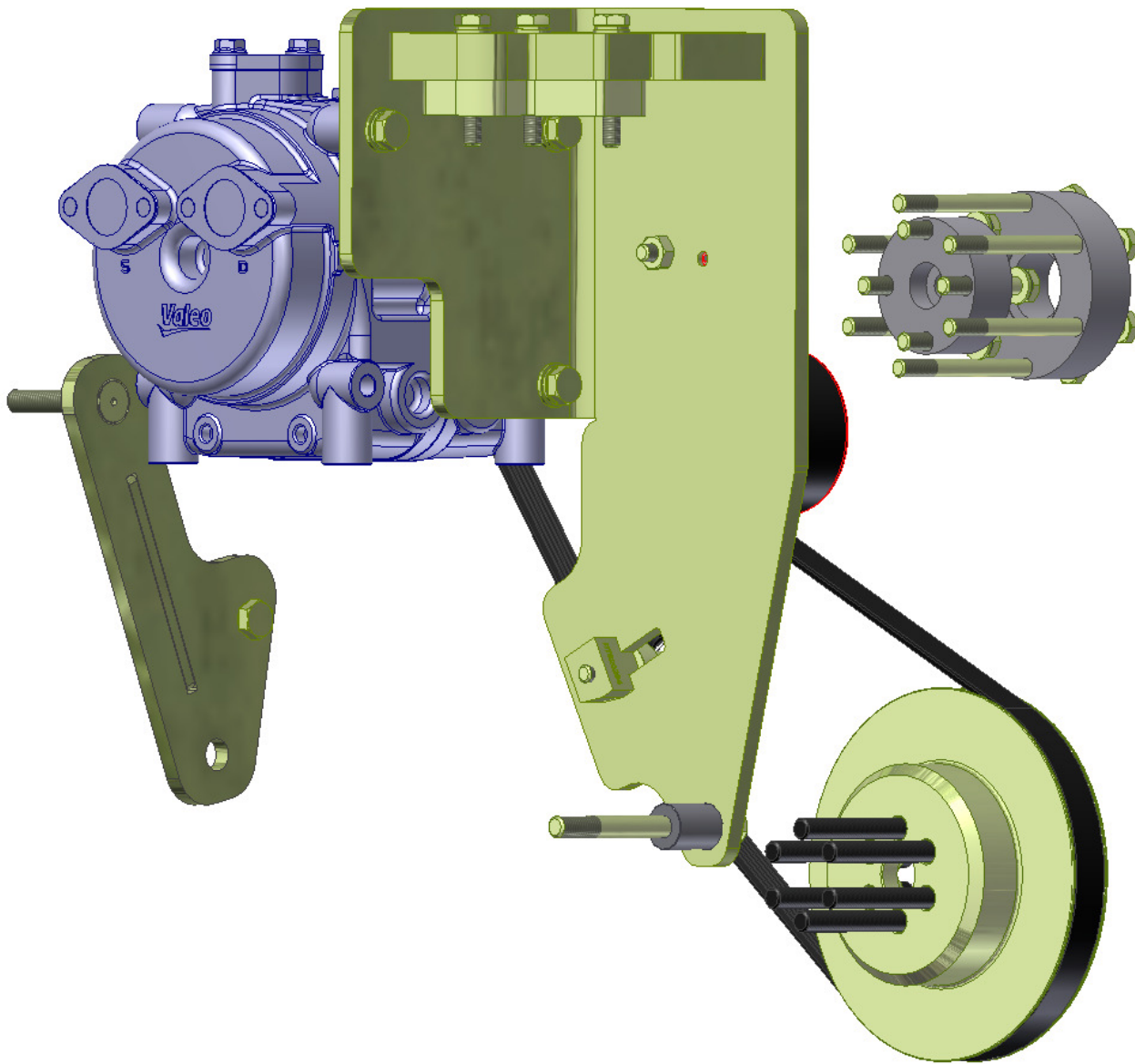

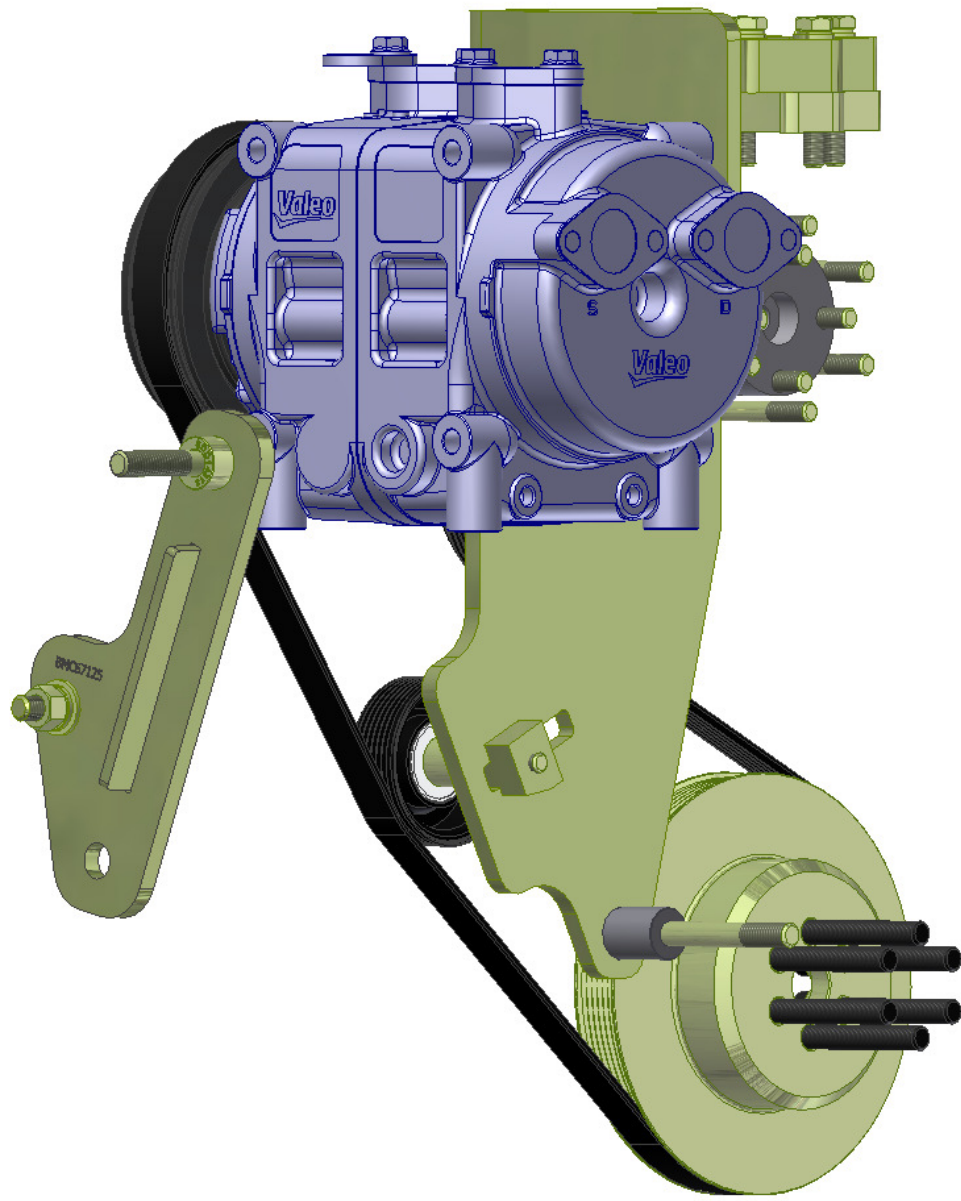

TransArctic A/C Compressor Mount Installation Disclaimer

All compressor mounts should be installed by qualified and trained personnel using proper tools and equipment in safe working conditions following industry standard guidelines for motor vehicle service and repair.

The installer of any compressor mount purchased from TransArctic must undertake all responsibility of issues arising from that compressor bracket being installed on any vehicle. As well as insure that a **proper and sufficient ground** is established between the compressors' clutches and the vehicle's engine. Mount functionality, operation and durability can all be compromised by an incompetent installation.

Due to the many different situations, parameters and application criteria, which are beyond the compressor mount manufacturer's control, TransArctic does not warrant design, durability, or operational functionality of any compressor mount improperly installed by another party.

With no implied guarantees it is the mount installer's strict responsibility to determine safety and functionality, of the compressor mount, at the time of installation.

Please contact TransArctic with any issue arising from installation so we may better improve the product. If you have any reservations about the compressor mount integrity contact TransArctic immediately at 1-877-COLD-AIR.

Mark OEM tensioner location

Install Kit

Check for Interferences

Check to ensure that the proper OEM tensioner orientation is maintained

Run engine with A/C system engaged for at least 10 minutes to run in belt

Check OEM tensioner orientation and adjust as required

Responsabilidad limitada de TransArctic en la instalación del soporte del compresor

Todos los soportes de los compresores deben ser instalados por personas calificadas y entrenadas, usando para ello los equipos y herramientas necesarios para esta labor en buenas condiciones y según las normas y guías para el servicio y/o reparación de motores de vehículos.

El instalador de los soportes comprados en TransArctic asume toda la responsabilidad de cualquier problema que surga en el soporte del compresor al vehículo; de igual manera es responsable que el cable a tierra sea conectado entre el embrague del compresor y el motor del vehículo.

Se advierte que el buen funcionamiento y la durabilidad del soporte pueden ser comprometidos por defectos en su instalación.

Debido a las diversas situaciones que se puedan presentar fuera del control del fabricante, TransArctic no garantiza el diseño, la durabilidad o el correcto funcionamiento de cualquier equipo inapropiadamente instalado por terceros.

Esta sobreentendido que el Instalador del montaje del compresor es estrictamente responsable de la seguridad y funcionamiento del equipo en el momento de la instalación.

Si tuviera algún problema o duda acerca de la instalación del soporte del compresor pongase en contacto inmediatamente con TransArctic al teléfono 1-877-COLD-AIR de modo que podamos mejorar nuestro producto.

Note la ubicación del medidor de tensión OEM

Instale el equipo

Controlar si hay interferencias.

Asegure que el medidor de tensión mantenga la orientación justa.

Encienda el motor por lo menos 10 minutos con el sistema A/C enganchado para que la correa corra

Controle la orientación justa del medidor de tensión y ajuste a las condiciones requeridas del fabricante