

Bill of Materials Listing

TransArctic Canada Inc.

11/29/2011
Page 1 of 1

Product Number	Description	Date	Weight	Uof M	Yield
Line Component Prod#	Description	Bin Unit	Qty		
KMC92461	Mt Kit, ISL-G 8.9L, A3RE, 05K, '09		12/22/2008	225.69	0
5	BEL32592		Belt, Banded B, 2591mm (102") (RBX99-2)	each	1
10	KBB84161		Mt Kit, Base, Transit, A3RE, '07	each	1
20	KKT82461		Mt Kit, Transit, O5K, '07	each	1
30	KPC92461		Kit, Pulley, ISL-G, A3RE, '09	each	1
40	KAC94161		Alt. Kit, 24V, ISC, A3RE, '09	each	1

Bill of Materials Listing

TransArctic Canada Inc.

11/9/2011
Page 1 of 1

Product Number		Description	Bin	Date	Weight	Uof M	Yield
Line	Component Prod#	Description		Unit	Qty		
KBB84161		Mt Kit, Base, Transit, A3RE, '07		8/31/2007	162.00		0
20	BMC83019	Bkt, Gusset, Bumper, ISC, BBRE, '07		each	1		
30	BMC83020	Bkt, Dampner, ISC, BBRE, '07		each	1		
40	BMC83021	Bkt, Comp, Frt, ISC, BBRE, '07		each	1		
50	BMC83022	Bkt, Comp, Rear, ISC, BBRE, '07		each	1		
60	BMC83023	Bkt, Gusset, Idler, ISC, BBRE, '07		each	1		
70	BMC83024	Bkt, Main, Idler, ISC, BBRE, '07		each	1		
80	BMC83026	Bkt, Sprt, Bump, Rear, ISC, BBRE, '07		each	1		
90	BMC83027	Bkt, Sprt, Bump, Side, ISC, BBRE, '07		each	1		
100	BMC83028	Bkt, Tray, ISC, BBRE, '07		each	1		
110	BMC83029	Bkt, Shift, Tank, Weldmt, ISC, BBRE, '07		each	1		
115	BMC83031	Bkt, Slide, Block, Idler, BBRE		each	1		
120	BMN80008	Vibration Isolator, Bar, 16.50 x 2 x 1.50		each	2		
130	BMN80009	Bkt, Main, Base Pl, IC, RE300		each	1		
160	BMN80025	Bkt, Back, PL, Slide, IC, RE300		each	1		
170	PUA05012	Pulley, Assy, Idler, B/BX gr, 5", STL, Plt		each	1		
180	PUA06001	Pulley, Assy, Idler, B/S, 6", Stl, Plt		each	1		
220	SCD32812	Spacer, Step, Drl, 32.8mm x 50.8o x 12.3i		each	1		
225	SPC19010	Spacer, Col, Drl, 19mm x 28.58o x 10.32i		each	2		
240	SCD48012	Spacer, Col, Drl, 48 mm x 34.9o x 12.3i		each	1		
250	SLV17012	Sleeve, Pulley, 16.9o x 22.23mm x 12.32i		each	2		
280	KBT84161	Bag Kit, Fasteners, KBB84161		each	1		

Bill of Materials Listing

TransArctic Canada Inc.

11/9/2011
Page 1 of 1

Product Number		Description	Bin	Date	Weight	Uof M	Yield
Line	Component Prod#	Description		Unit	Qty		
KBT84161		Bag Kit, Fasteners, KBB84161		8/29/2007	5.37		0
10	BTC08020	Bolt, Hex, 8 x 1.25 x 20mm, 10.9, Plt		each	2		
20	BTC08035	Bolt, Hex, 8 x 1.25 x 35mm, 10.9, Plt,FT		each	1		
50	BTC12040	Bolt, Hex, 12 x 1.75 x 40mm, 10.9,Plt,FT		each	10		
60	BTC12050	Bolt, Hex, 12 x 1.75 x 50mm, 10.9,Plt		each	1		
70	BTC12060	Bolt, Hex, 12 x 1.75 x 60mm, 10.9,Plt,FT		each	1		
100	BTC12100	Bolt, Hex, 12 x 1.75 x 100mm, 10.9, Plt		each	2		
105	BTP08653	Bolt, Hex, 1/2-13unc, 6.5", 5, Plt, FT		each	1		
115	BTQ06200	Bolt, Hex, 3/8-16unc, 2.0", 8, Plt		each	2		
120	BTQ08126	Bolt, Hex, 1/2-20unf, 1.25", 8, Plt		each	12		
135	BTQ08200	Bolt, Hex, 1/2-13unc, 2.0", 8, Plt		each	3		
160	CSF06075	Capscrew, FH, 3/8-16 x .75", Alloy, Plt		each	2		
170	NTA08000	Nut, Hex, 8 x 1.25, 8.8, Plt		each	3		
190	NTA12000	Nut, Hex, 12 x 1.75, 8.8, Plt		each	13		
200	NTP06000	Nut, Hex, 3/8-16unc, 5, Plt		each	2		
230	WFA08000	Washer, Flat, 8mm, 8.8, Plt		each	4		
250	WFA12000	Washer, Flat, 12mm, 8.8, Plt		each	24		
270	WFQ08000	Washer, Flat, 1/2", 8, Plt		each	15		
280	WLA08000	Washer, Lock, 8mm, 8.8, Plt		each	3		
300	WLA12000	Washer, Lock, 12mm, 8.8, Plt		each	14		
330	WLQ08000	Washer, Lock, 1/2", 8, Plt		each	13		

Bill of Materials Listing

TransArctic Canada Inc.

11/9/2011
Page 1 of 1

Product Number	Description	Date	Weight	Uof M	Yield
Line Component Prod#	Description	Bin Unit	Qty		
KKT82461	Mt Kit, Transit, O5K, '07		10/19/2007	13.98	0
10	BMN80031	Bkt, Main, Slide, Assy, 05K, IC, RE300	each	1	
20	BMN80032	Bkt, Adapter, PL, IC, RE300	each	1	
30	CSF08100	Capscrew, FH, 1/2-13 x 1", Alloy, Plt	each	4	
40	NTP07000	Nut, Hex, 7/16-14unc, 5, Plt	each	4	
50	WFN07000	Washer, Flat, 7/16", 2, Plt	each	4	
60	WLP07000	Washer, Lock, 7/16", 5, Plt	each	4	

Bill of Materials Listing

TransArctic Canada Inc.

11/23/2011

Page 1 of 1

Product Number		Description	Bin	Date	Weight	Uof M	Yield
Line	Component	Prod#	Description	Unit	Qty		
KPC92461			Kit, Pulley, ISL-G, A3RE, '09		10/19/2007	13.74	0
10	PUL89009		Pulley, Crank, ISL, 8.9L, 2B/X, 8", '09	each	1		
20	BTC12060		Bolt, Hex, 12 x 1.75 x 60mm, 10.9,Plt,FT	each	4		
30	WFS12002		Washer, Flat, Hdn, 12mm, Stl, BLK	each	4		

Bill of Materials Listing

TransArctic Canada Inc.

11/9/2011
Page 1 of 1

Product Number		Description	Bin	Date	Weight	Uof M	Yield
Line	Component Prod#	Description		Unit	Qty		
KAC94161		Alt. Kit, 24V, ISC, A3RE, '09		2/25/2009	34.67		0
10	BEL82705	Belt, 8gr, 2705mm (106.5") (5081065)		each	1		
20	BMC83040	Bkt, Pl, Alt, Weldm't, ISC, A3RE, '09		each	1		
30	BMC83042	Bkt, Main, Alt, Weldm't, ISC, A3RE, '09		each	1		
40	PUL80064	Pulley,ALT,Frontside,P8,63.5d (3972808)		each	1		
50	PUL80076	Pulley, Idler, Backside, P8, 76d (89062)		each	2		
70	KBA94161	Bag Kit, Fasteners, KAC94161		each	1		

Bill of Materials Listing

TransArctic Canada Inc.

11/9/2011
Page 1 of 1

Product Number		Description	Bin	Date	Weight	Uof M	Yield
Line	Component Prod#	Description		Unit	Qty		
KBA94161		Bag Kit, Fasteners, KAC94161		3/2/2009	1.81		0
5	BTC08030	Bolt, Hex, 8 x 1.25 x 30mm, 10.9, Plt,FT		each	1		
10	BTC08035	Bolt, Hex, 8 x 1.25 x 35mm, 10.9, Plt,FT		each	6		
20	BTC08065	Bolt, Hex, 8 x 1.25 x 65mm, 10.9, Plt		each	2		
30	BTC10040	Bolt, Hex, 10 x 1.5 x 40mm, 10.9, Plt,FT		each	5		
40	BTQ08150	Bolt, Hex, 1/2-13unc, 1.5", 8, Plt		each	1		
50	BTQ08653	Bolt, Hex, 1/2-13unc, 6.5", 8, Plt		each	1		
60	BTS10001	Bolt, Shoulder, 10mm (89064)		each	2		
65	NTA08000	Nut, Hex, 8 x 1.25, 8.8, Plt		each	1		
70	NTA10000	Nut, Hex, 10 x 1.5, 8.8, Plt		each	5		
80	NTQ08000	Nut, Hex, 1/2-13unc, 8, Plt		each	1		
90	WFA08000	Washer, Flat, 8mm, 8.8, Plt		each	8		
100	WFA10000	Washer, Flat, 10mm, 8.8, Plt		each	10		
110	WFQ08000	Washer, Flat, 1/2", 8, Plt		each	3		
120	WLA08000	Washer, Lock, 8mm, 8.8, Plt		each	9		
130	WLA10000	Washer, Lock, 10mm, 8.8, Plt		each	5		
140	WLQ08000	Washer, Lock, 1/2", 8, Plt		each	2		

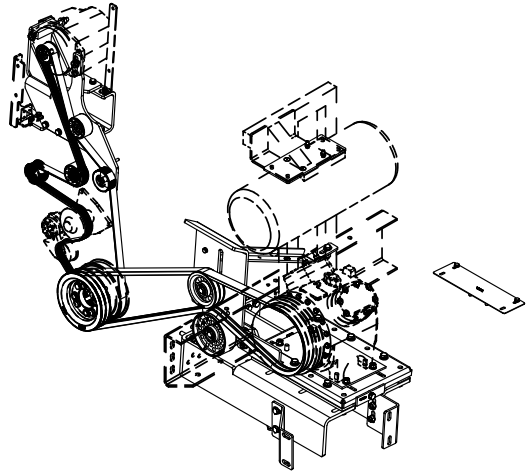
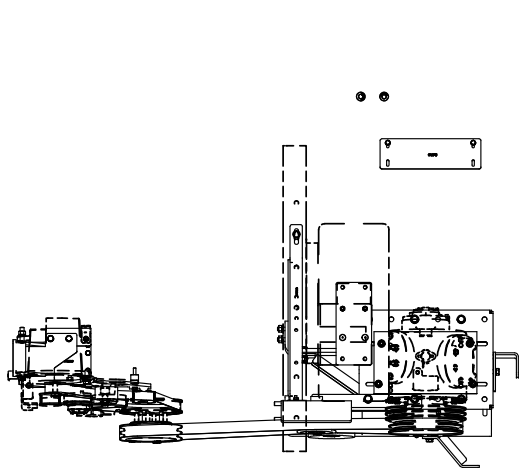

ISOMETRIC VIEW

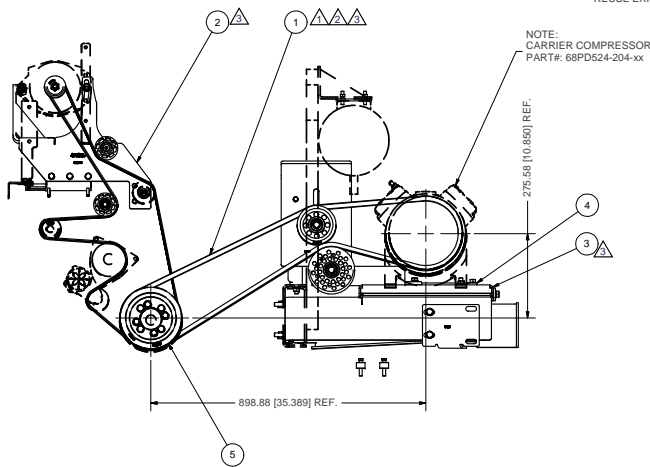

REUSE EXISTING BRACKET HARDWARE.

NOTE:
CARRIER COMPRESSOR
PART#: 68PD524-204-xx

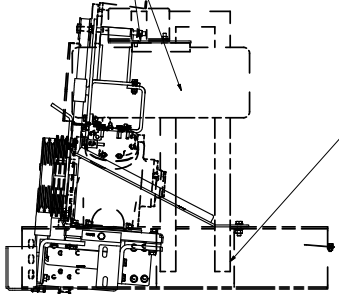

REUSE & MODIFY EXISTING EXHAUST SHIELD
BRACKET & HARDWARE.
(FROM REAR OEM POSITION TO
LOWERED OTHER SIDE OF TUBE.)

REUSE EXISTING MUFFLER BRACKET & HARDWARE.

NOTES:
1) USE SERVICABLE THREADLOCKER ON ALL FASTENERS TO ENGINE COMPONENTS AND TORQUE ALL BOLTS TO S.A.E. SPECIFICATIONS.
2) SEE "TRANSARCTIC A/C COMPRESSOR MOUNT INSTALLATION DISCLAIMER".



ITEM	QTY	U/M	PART NUMBER	DESCRIPTION
5	1	EACH	KPC92461	KIT, PULLEY, ISL-G, A3RE, '09
4	1	EACH	KKT82461	MT KIT, TRANSIT, O5K, '07
3	1	EACH	KBB84161	MT KIT, BASE, TRANSIT, A3RE, '07
2	1	EACH	KAC94161	Air Kit, 24V, ISC, A3RE, '09
1	1	EACH	BEL32592	BELT, BANDED B, 2591mm (102") (RBX99-2)

BILL OF MATERIALS

3	REVISED KAC94161 & KBB84161	11/30/2011	JRR	
2	WAS BEL32592	8/10/2011	JRR	
1	ADDED PN BEL32592	8/19/2009	JRR	
0	RELEASED TO PRODUCTION	4/30/2009	JRR	
REVIEW	DESCRIPTION:	DATE:	BY:	
			JRR	
			GA	
			James Stewart	4/30/2009
			Ron Ingram	4/30/2009
			Dale Mason	4/30/2009

DRAWN		4/30/2009	TRANSARCTIC INC.
Jose Rodriguez			
CHECKED			TITLE
James Stewart			
APPROVED			MT. KIT, ISL-G 8.9L, A3RE, O5K, '09
Ron Ingram			
DATE		4/30/2009	SIZE
			D
			DWG NO
			KMC92461
			REV
			3

UNSPECIFIED TOLERANCES:		ALL DIMS
ONE DECIMAL PLACE (X.0)	±.05	(FRACTIONAL)
TWO DECIMAL PLACES (X.00)	±.010	(FRACTIONAL)
THREE DECIMAL PLACES (X.000)	±.005	(FRACTIONAL)
FRACTIONAL (1/16")	±.005	(FRACTIONAL)
ANGULAR	±.25°	(FRACTIONAL)

THIRD ANGLE PROJECTION	DRAWING UNIT OF MEASURE	MM (INCH)
SCALE	1:1	
SHEET	1	OF 1

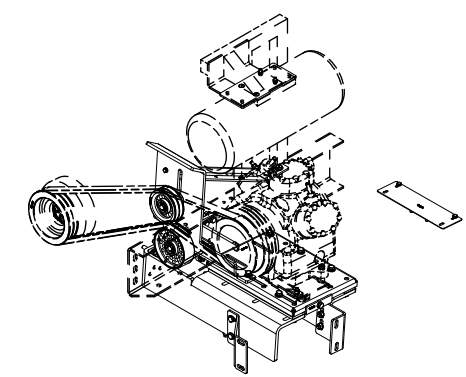

ISOMETRIC VIEW

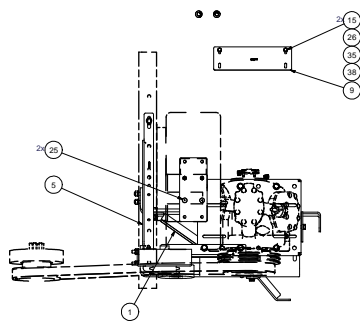

NOTE:
REFER TO CARRIER COMPRESSOR
INSTALL KIT OPTIONS
(OSC COMPRESSOR SHOWN)

NOTE:
COMPRESSOR BASE
SHOWN AS REF.
REFER TO UPPER
LEVEL MOUNT KIT(S).

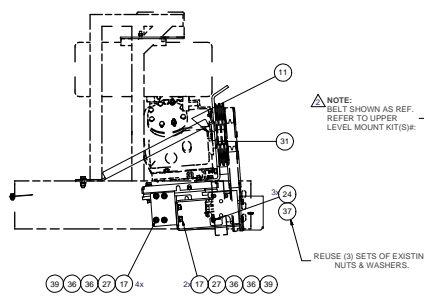

NOTE:
PULLEY SHOWN AS REF.
REFER TO UPPER
LEVEL MOUNT KIT(S).

NOTE:
PULLEY SHOWN AS REF.
REFER TO UPPER LEVEL MOUNT KIT(S).

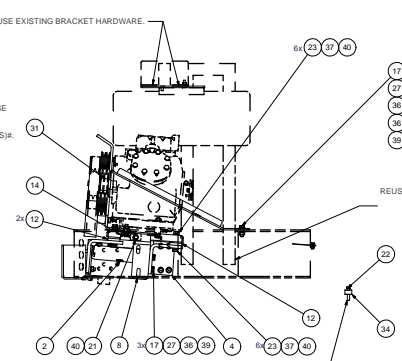

REUSE & MODIFY EXISTING EXHAUST SHIELD
BRACKET & HARDWARE.
(FROM REAR OEM POSITION TO
LOWERED OTHER SIDE OF TUBE.)

REUSE EXISTING MUFFLER BRACKET & HARDWARE.

NOTES:
1) USE SERVICABLE THREADLOCKER ON ALL FASTENERS TO ENGINE COMPONENTS AND TORQUE ALL BOLTS TO S.A.E. SPECIFICATIONS.
2) SEE TRANSTARCTIC A/C COMPRESSOR MOUNT INSTALLATION DISCLAIMER.
3) WEIGHT: 155.00 LB

ITEM	QTY	UOM	PART NUMBER	DESCRIPTION
40	13	EACH	WLO08000	WASHER, LOCK, 1/2", 8, PLT
39	14	EACH	WLA12000	WASHER, LOCK, 12mm, 8, 8, PLT
28	3	EACH	WLO08000	WASHER, LOCK, 8mm, 8, 8, PLT
37	15	EACH	WFO08000	WASHER, FLAT, 1/2", 8, PLT
36	20	EACH	WFA12000	WASHER, FLAT, 12mm, 8, 8, PLT
35	4	EACH	WFO08000	WASHER, FLAT, 8mm, 8, 8, PLT
34	2	EACH	SFC19010	SPACER, COL, DRL, 19.05mm x 25.4 x 10.57
33	2	EACH	SLV17012	SLEEVE, PULLEY, 16.90 x 22.23 mm x 12.19
32	1	EACH	SCD46012	SPACER, COL, DRL, 46mm x 31.80 x 12.0
31	1	EACH	SCD12812	SPACER, COL, DRL, 32.8mm x 50.80 x 12.3
30	1	EACH	PJA06001	PULLEY, ASSY, IDLER, B/S, 6", STL, PLT
29	1	EACH	PJA05012	PULLEY, ASSY, IDLER, B/B, 6", 5" STL, PLT
28	2	EACH	WTP06000	NUT, HEX, 3/8-14UNC, 5, PLT
27	13	EACH	NTA12000	NUT, HEX, 12 x 1.75, 8.8, PLT
26	3	EACH	NTA08000	NUT, HEX, 8 x 1.25, 8.8, PLT
25	2	EACH	CSF06015	CARSPW, FH, 3/8 x 1.75, 9, PLT
24	3	EACH	BT08000	BOLT, HEX, 1/2-13UNC x 2.00, 8, PLT
23	12	EACH	BT08126	BOLT, HEX, 1/2-20UNC x 1.25, 8, PLT
22	2	EACH	BT06000	BOLT, HEX, 3/8-14UNC, 2.00, 8, PLT
21	1	EACH	BTR08653	BOLT, HEX, 1/2-13UNC x 6.50, 5, PLT, FT
20	2	EACH	BTC12100	BOLT, HEX, 12 x 1.75 x 100mm, 10.9, PLT
19	1	EACH	BTC12060	BOLT, HEX, 12 x 1.75 x 60mm, 10.9, PLT
18	1	EACH	BTC12050	BOLT, HEX, 12 x 1.75 x 50mm, 10.9, PLT
17	10	EACH	BTC12040	BOLT, HEX, 12 x 1.75 x 40mm, 10.9, PLT
16	1	EACH	BT08015	BOLT, HEX, 8 x 1.25 x 35mm, 10.9, PLT
15	2	EACH	BT08020	BOLT, HEX, 8 x 1.25 x 20mm, 10.9, PLT
14	1	EACH	BMN80025	BKT, BACK, PL, SLIDE, IC, RE300
13	1	EACH	BMN80009	BKT, MAIN, BLOC, PL, IC, RE300
12	2	EACH	BMN80008	VIBRATION ISOLATOR, BAR, 16.50 x 2 x 1.50
11	1	EACH	BMC83031	BKT, SLIDE, BLOCK, IDLER, BBRE, '07
10	1	EACH	BMC83029	BKT, SHFT, TANK, WELDMT, ISC, BBRE, '07
9	1	EACH	BMC83028	BKT, TRAY, ISC, BBRE, '07
8	1	EACH	BMC83027	BKT, SPRT, BUMP, SIDE, ISC, BBRE, '07
7	1	EACH	BMC83026	BKT, SPRT, BUMP, REAR, ISC, BBRE, '07
6	1	EACH	BMC83024	BKT, MAIN, IDLER, ISC, BBRE, '07
5	1	EACH	BMC83023	BKT, GUSSET, IDLER, ISC, BBRE, '07
4	1	EACH	BMC83022	BKT, COMP, REAR, ISC, BBRE, '07
3	1	EACH	BMC83021	BKT, COMP, FR, ISC, BBRE, '07
2	1	EACH	BMC83020	BKT, DAMPNER, ISC, BBRE, '07
1	1	EACH	BMC83019	BKT, GUSSET, BUMPER, ISC, BBRE, '07

DRAWN: Jose Rodriguez 10/20/2008
 CHECKED: J. Jakobowitz 10/20/2008
 TITLE: MT KIT, BASE, TRANSIT, A3RE, '07
 DATE: 10/20/2008
 APPROVED: Date Mason 10/20/2008
 DATE: 10/20/2008

TRANSARCTIC INC.
 KBB84161
 SHEET 1 OF 1

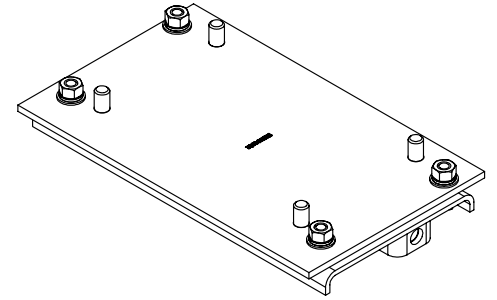
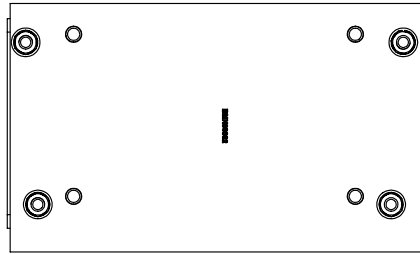

ISOMETRIC VIEW

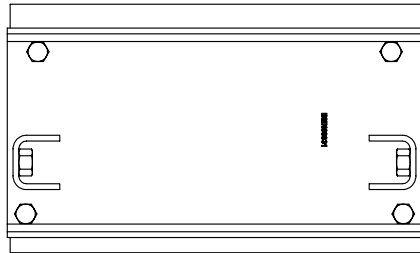
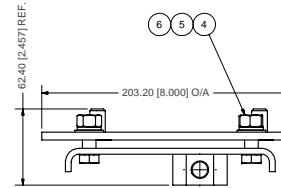
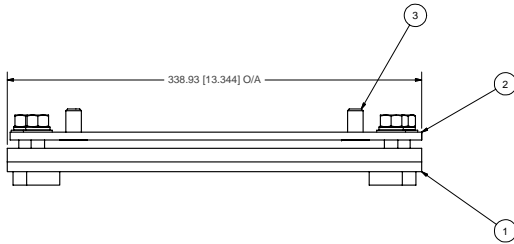

NOTES:

- 1) USE SERVICABLE THREADLOCKER ON ALL FASTENERS TO ENGINE COMPONENTS AND TORQUE ALL BOLTS TO S.A.E. SPECIFICATIONS.
- 2) SEE 'TRANSARCTIC A/C COMPRESSOR MOUNT INSTALLATION DISCLAIMER'.
- 3) WEIGHT: 13.96 LB

ITEM	QTY	U/M	PART NUMBER	DESCRIPTION
6	4	EACH	WLP07000	WASHER, LOCK, 7/16", 5, PLT
5	4	EACH	WFO7000	WASHER, FLAT, 7/16", 2, PLT
4	4	EACH	NTP07000	NUT, HEX, 7/16-14UNC, 5, PLT
3	4	EACH	CSP08100	CAPSCREW, FH, 3/8-16 x 1", 9, PLT
2	1	EACH	BMN80032	BKT, ADAPTER, PL, IC, RE300
1	1	EACH	BMN80031	BKT, MAIN, SLIDE, ASSY, OSK, IC, RE300



DRAWN Jose Rodriguez 10/20/2008 CHECKED Val Jakowlew 10/20/2008 TITLE TRANSARCTIC INC.	DATE: 10/20/2008 BY: Val Jakowlew	DESCRIPTION: RELEASED TO PRODUCTION DATE: 10/20/2008 BY: Jose Rodriguez	DATE: 10/20/2008 BY: James Stewart	DATE: 10/20/2008 BY: Ron Ingram	DATE: 10/20/2008 BY: Dale Mason
THIS DRAWING CONTAINS PROPRIETARY CONFIDENTIAL INFORMATION OWNED BY TRANSARCTIC CANADA INC. THE DOCUMENT AND THE INFORMATION IN IT ARE NOT TO BE USED, DISCLOSED OR REPRODUCED WITHOUT EXPRESS WRITTEN PERMISSION OF THE COMPANY.					
UNspecified TOLERANCES: HOLE DIM (+0.000) (0.000) (0.000) DIM DECIMAL PLACE (X) .00 (0.00) (0.00) DIM FRACTIONAL PLACE (X) 00 (0.00) (0.00) DIM FRACTIONAL PLACES (X) 00 (0.00) (0.00)					
THIRD ANGLE PROJECTION			DWG NO KKT82461	REV 0	SCALE 1:2
DRAWING UNIT OF MEASURE: MM (INCH)			SHEET 1 OF 1	TITLE MT KIT, TRANSIT, OSK, '07	

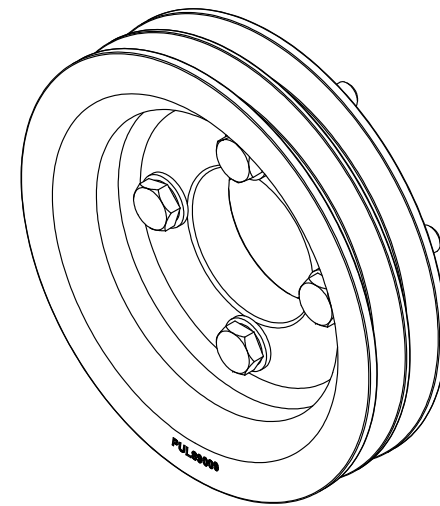
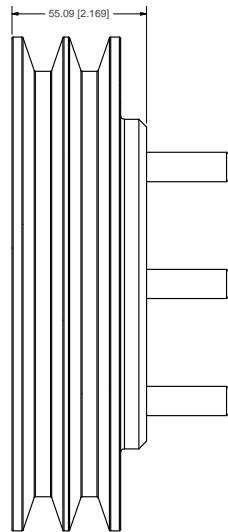
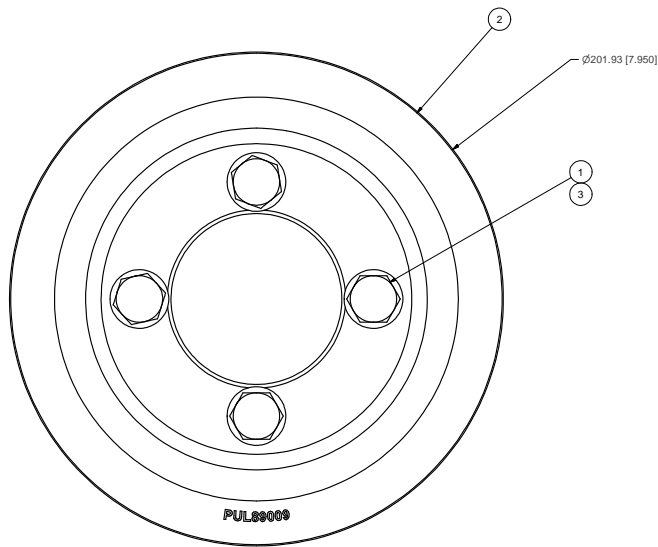
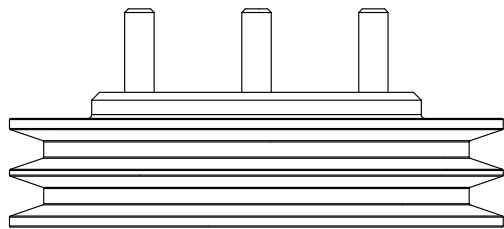

ISOMETRIC VIEW

NOTES:

- 1) USE SERVICABLE THREADLOCKER ON ALL FASTENERS TO ENGINE COMPONENTS AND TORQUE ALL BOLTS TO S.A.E. SPECIFICATIONS.
- 2) SEE "TRANSARCTIC A/C COMPRESSOR MOUNT INSTALLATION DISCLAIMER".
- 3) WEIGHT: 13.80 LB

ITEM	QTY	U/M	PART NUMBER	DESCRIPTION
3	4	EACH	WFS12002	WASHER, FLAT, HDN, 12mm, STL, BLK
2	1	EACH	PUL89009	PULLEY, CRANK, ISL, 8.9L, 2B/X, 8", '09
1	4	EACH	BTCT2060	BOLT, HEX, 12 x 1.75 x 60mm, T0.9, FLT

BILL OF MATERIALS

TRANSARCTIC INC.

0	RELEASED TO PRODUCTION	4/17/2009	JRR
REV	DESCRIPTION	DATE	BY
1	James Stewart	4/17/2009	GA
2	Ron Ingram	4/17/2009	MFG
3	Date Mason	4/17/2009	APPROVED

DRAWN	Jose Rodriguez	4/17/2009
CHECKED	Val Jakowlew	4/17/2009
TITLE	Kit, Pulley, ISL-G, A3RE, '09	
SIZE	D	DWG NO
SCALE	1:1	KPC92461
DRAWING UNIT OF MEASURE	MM (INCH)	REV
		0
		SHEET 1 OF 1

UNSPECIFIED TOLERANCES:			
ONE DECIMAL PLACE (X.0)	±.05	FRS	
TWO DECIMAL PLACE (X.00)	±.02	FRS	
THREE DECIMAL PLACE (X.000)	±.010	FRS	
FRACTIONAL (1/16")	±.010	FRS	
ANGULAR (1/2°)	±.01	FRS	



THIRD ANGLE PROJECTION

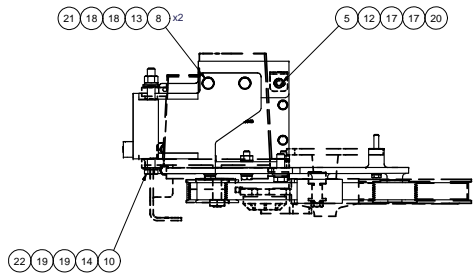

NOTE:
 DRILL $\phi 21/64"$ HOLE TO
 SUIT PROPER HEIGHT
 ADJUSTMENT TO CLAMP ENGINE
 COOLING SYSTEM HOSE.
 RE-USE EXISTING FASTENER(S)

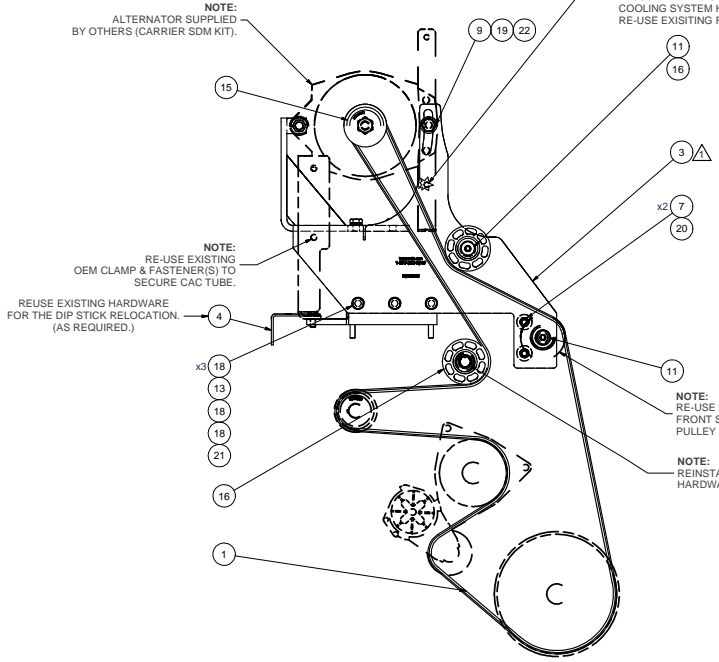

NOTE:
 ALTERNATOR SUPPLIED
 BY OTHERS (CARRIER SDM KIT).

NOTE:
 RE-USE EXISTING
 OEM CLAMP & FASTENER(S) TO
 SECURE CAC TUBE.

REUSE EXISTING HARDWARE
 FOR THE DIP STICK RELOCATION.
 (AS REQUIRED.)

NOTE:
 RE-USE EXISTING OEM
 FRONT SIDE IDLER
 PULLEY

NOTE:
 REINSTALL OEM
 HARDWARE.

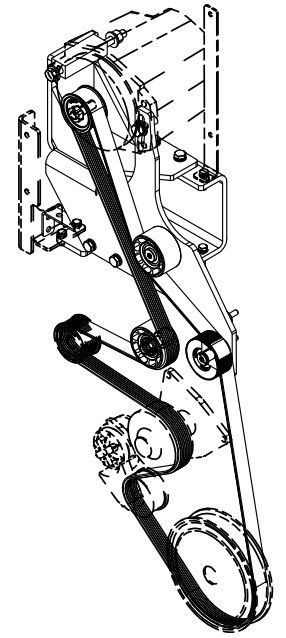
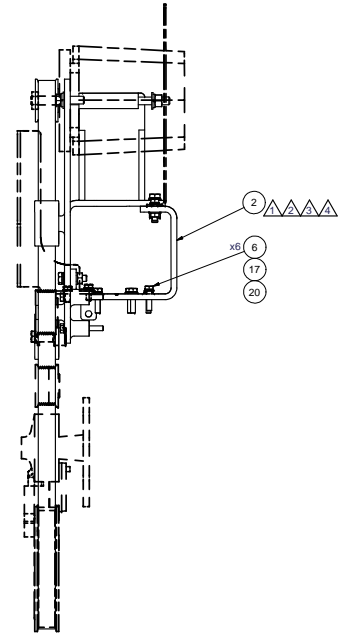

ISOMETRIC VIEW

ITEM	QTY	U/M	PART NUMBER	DESCRIPTION
22	2	EACH	WLO08000	WASHER, LOCK, 1/2", 8, PLT
21	5	EACH	WLA10000	WASHER, LOCK, 10mm, 8.8, PLT
20	9	EACH	WLA08000	WASHER, LOCK, 8mm, 8.8, PLT
19	3	EACH	WFO08000	WASHER, FLAT, 1/2", 8, PLT
18	10	EACH	WFA10000	WASHER, FLAT, 10mm, 8.8, PLT
17	8	EACH	WFA08000	WASHER, FLAT, 8mm, 8.8, PLT
16	2	EACH	PUL80076	PULLEY, IDLER, BACKSIDE, P8, 76D, 39W
15	1	EACH	PUL80064	PULLEY, ALT, FRONT, ISC, A3RE, 109
14	1	EACH	NTQ08000	NUT, HEX, 1/2-13UNC, 8, PLT
13	5	EACH	NTA10000	NUT, HEX, 10 x 1.5, 8.8, PLT
12	1	EACH	NTA08000	NUT, HEX, 8 x 1.25, 8.8, PLT
11	2	EACH	BT150001	BOLT, SHOULDER, 10mm (IDLER PULLEY)
10	1	EACH	BTQ08A53	BOLT, HEX, 1/2-13UNC x 6.50, 8, PLT
9	1	EACH	BTQ08150	BOLT, HEX, 1/2-13UNC x 1.50, 8, PLT
8	5	EACH	BTC10040	BOLT, HEX, 10 x 1.5 x 40mm, 10.9, PLT
7	2	EACH	BTC08065	BOLT, HEX, 8 x 1.25 x 65mm, 10.9, PLT
6	6	EACH	BTC08035	BOLT, HEX, 8 x 1.25 x 35mm, 10.9, PLT
5	1	EACH	BTC08030	BOLT, HEX, 8 x 1.25 x 30mm, 10.9, PLT
4	1	EACH	BMZ00029	BKT, UNIVER, HOSE/CABLE, MT, U/S CHASSIS
3	1	EACH	BMCS3042	BKT, MAIN, ALT, WELDMT, ISC, A3RE, 109
2	1	EACH	BMCS3040	BKT, PL, ALT, REAR, ISC, A3RE, 109
1	1	EACH	BELB2705	Belt, Sgr, 2705mm (106.5") (5081065)

BILL OF MATERIALS

4	MODIFIED BMCS3040	11/28/2011	VALJ
3	MODIFIED BMCS3040	11/30/2010	JRR
2	MODIFIED BMCS3040	8/15/2010	JRR
1	MODIFIED BMCS3040 4.2	8/8/2010	JRR
0	RELEASED TO PRODUCTION	2/25/2009	JRR

REV: ECN | DESCRIPTION: | DATE: | BY: |
 JRR | MFG | James Stewart | 2/25/2009
 JRR | MFG | James Stewart | 2/25/2009
 JRR | MFG | Ron Ingram | 2/25/2009
 JRR | MFG | Dale Mason | 2/25/2009

UNSPECIFIED TOLERANCES: ALL DIMS
 ONE DECIMAL PLACE (X1) .10 (FRA) .005
 TWO DECIMAL PLACES (X2) .05 (FRA) .0025
 THREE DECIMAL PLACES (X3) .010 (FRA) .0010
 FRACTIONAL (X4) 1/32 (FRA) .03125

THIRD ANGLE PROJECTION

DRAWING UNIT OF MEASURE: MM (INCH)

TRANSARGTIG INC.

TITLE: Alt. Kit, 24V, ISC, A3RE, '09

SCALE: 1:2

DWG NO: KAC94161

REV: 4

SHEET 1 OF 1

NOTES:
 1) USE SERVICABLE THREADLOCKER ON ALL FASTENERS TO ENGINE COMPONENTS AND TORQUE ALL BOLTS TO S.A.E. SPECIFICATIONS.
 2) SEE "TRANSARGTIG A/C COMPRESSOR MOUNT INSTALLATION DISCLAIMER".

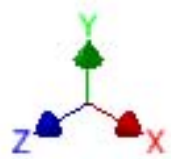
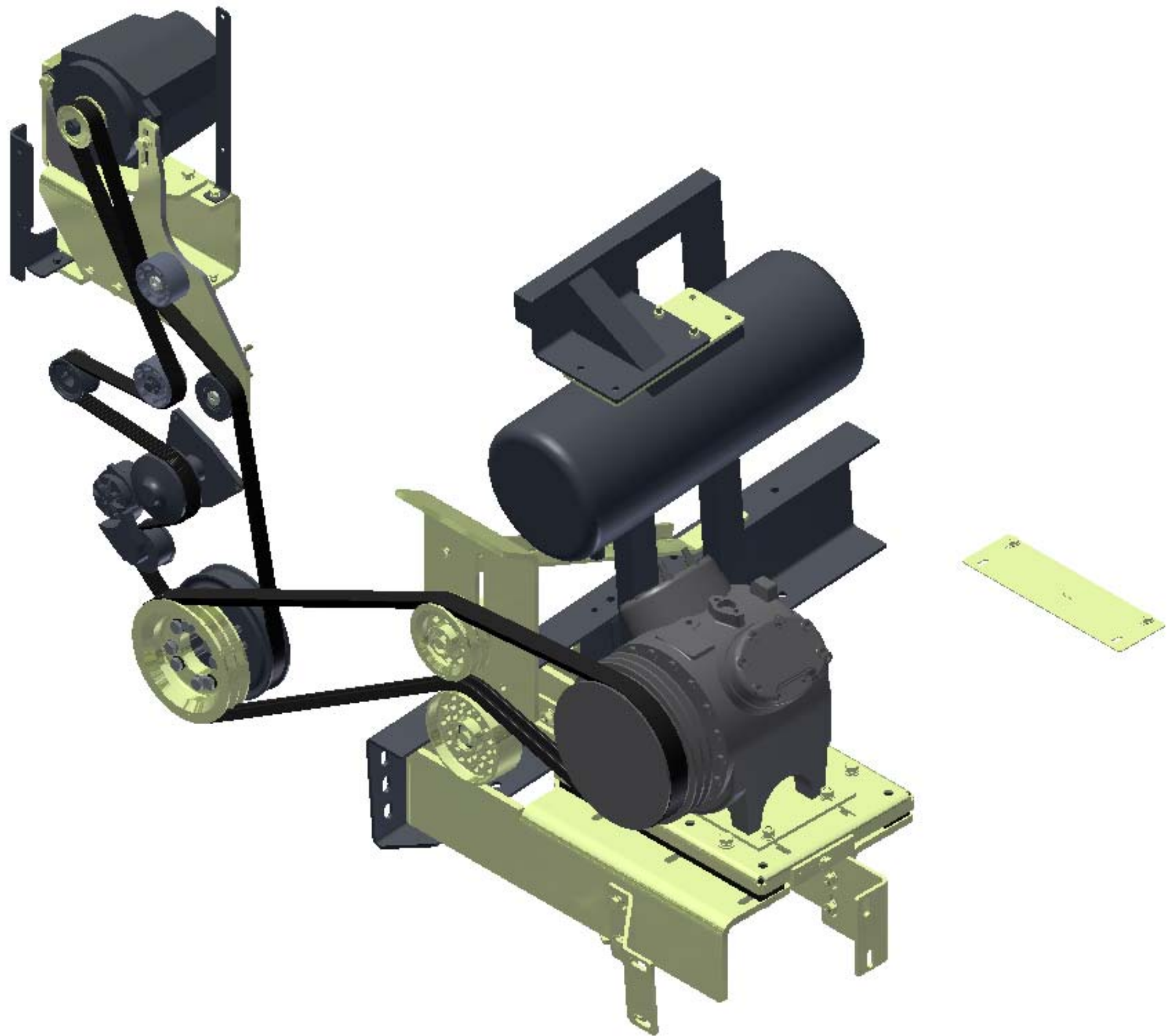

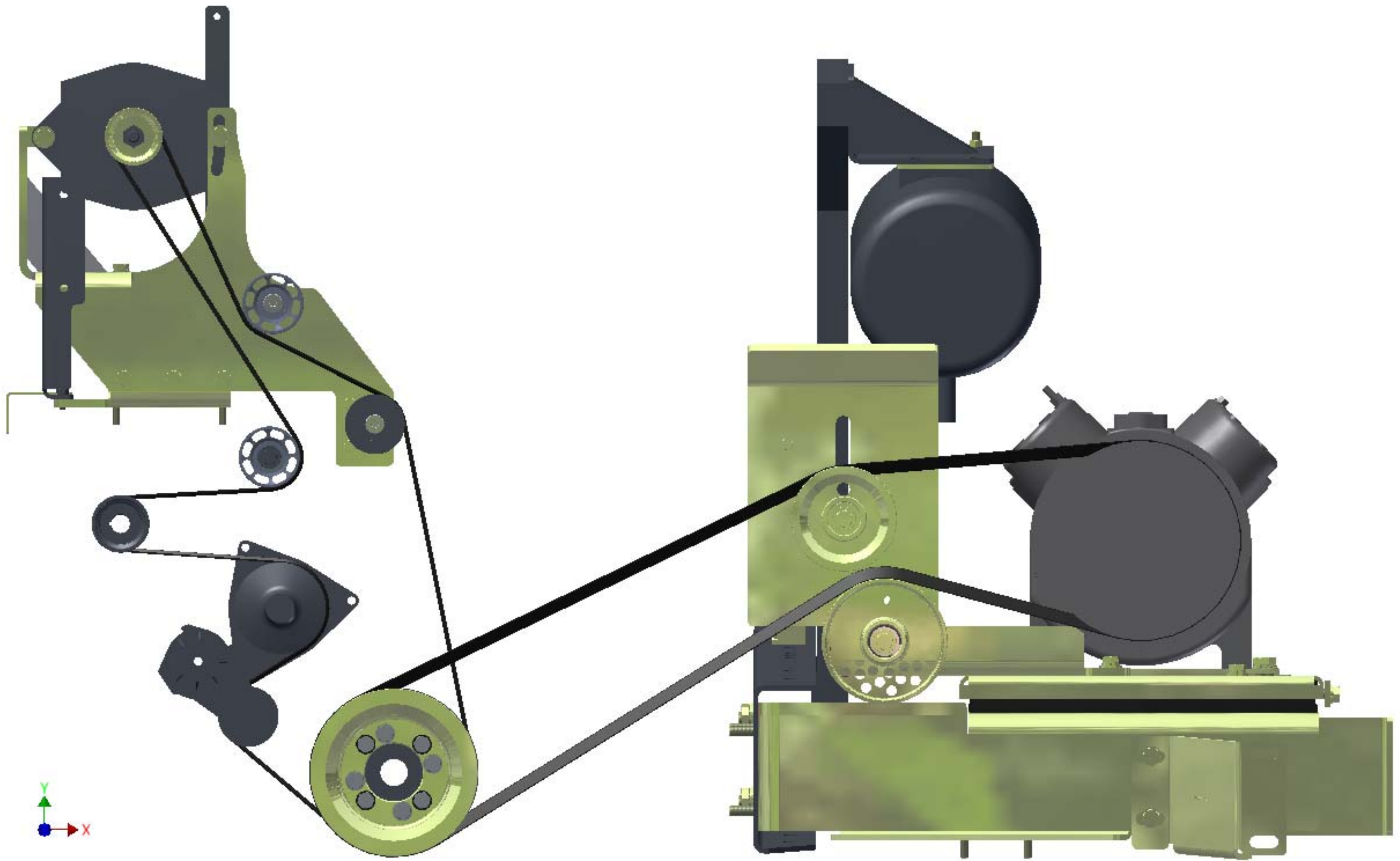

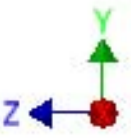
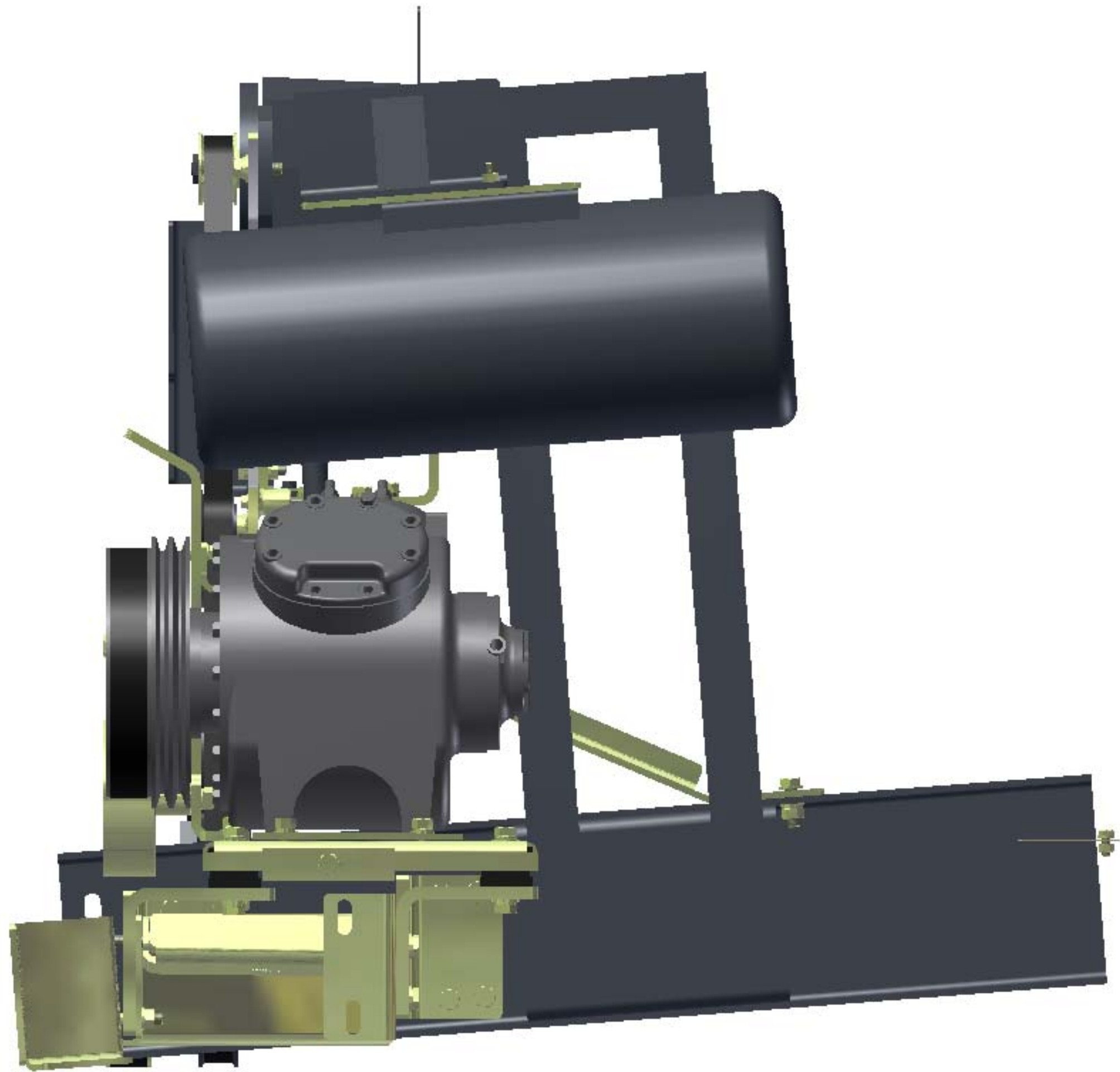

TransArctic A/C Compressor Mount Installation Disclaimer

All compressor mounts should be installed by qualified and trained personnel using proper tools and equipment in safe working conditions following industry standard guidelines for motor vehicle service and repair.

The installer of any compressor mount purchased from TransArctic must undertake all responsibility of issues arising from that compressor bracket being installed on any vehicle. As well as insure that a **proper and sufficient ground** is established between the compressors' clutches and the vehicle's engine. Mount functionality, operation and durability can all be compromised by an incompetent installation.

Due to the many different situations, parameters and application criteria, which are beyond the compressor mount manufacturer's control, TransArctic does not warrant design, durability, or operational functionality of any compressor mount improperly installed by another party.

With no implied guarantees it is the mount installer's strict responsibility to determine safety and functionality, of the compressor mount, at the time of installation.

Please contact TransArctic with any issue arising from installation so we may better improve the product. If you have any reservations about the compressor mount integrity contact TransArctic immediately at 1-877-COLD-AIR.

Mark OEM tensioner location

Install Kit

Check for Interferences

Check to ensure that the proper OEM tensioner orientation is maintained

Run engine with A/C system engaged for at least 10 minutes to run in belt

Check OEM tensioner orientation and adjust as required

Responsabilidad limitada de TransArctic en la instalación del soporte del compresor

Todos los soportes de los compresores deben ser instalados por personas calificadas y entrenadas, usando para ello los equipos y herramientas necesarios para esta labor en buenas condiciones y según las normas y guías para el servicio y/o reparación de motores de vehículos.

El instalador de los soportes comprados en TransArctic asume toda la responsabilidad de cualquier problema que surga en el soporte del compresor al vehículo; de igual manera es responsable que el cable a tierra sea conectado entre el embrague del compresor y el motor del vehículo.

Se advierte que el buen funcionamiento y la durabilidad del soporte pueden ser comprometidos por defectos en su instalación.

Debido a las diversas situaciones que se puedan presentar fuera del control del fabricante, TransArctic no garantiza el diseño, la durabilidad o el correcto funcionamiento de cualquier equipo inapropiadamente instalado por terceros.

Esta sobreentendido que el Instalador del montaje del compresor es estrictamente responsable de la seguridad y funcionamiento del equipo en el momento de la instalación.

Si tuviera algún problema o duda acerca de la instalación del soporte del compresor pongase en contacto inmediatamente con TransArctic al teléfono 1-877-COLD-AIR de modo que podamos mejorar nuestro producto.

Note la ubicación del medidor de tensión OEM

Instale el equipo

Controlar si hay interferencias.

Asegurese que el medidor de tensión mantenga la orientación justa.

Encienda el motor por lo menos 10 minutos con el sistema A/C enganchado para que la correa corra

Controle la orientación justa del medidor de tensión y ajuste a las condiciones requeridas del fabricante