

Bill of Materials Listing

TransArctic Canada Inc.

3/10/2017
Page 1 of 1

Product Number	Description	Date	Weight	Uof M	Yield
Line Component Prod#	Description	Bin Unit	Qty		
KMC66694	Mt Kit, ISB, HDX, TM-65/55, Alt, '13		3/9/2017	111.25	0
10	BEL32389		Belt, Banded B gr, 2388mm (94")	each	1
20	BMC83123		Bkt, Main, Idler, Weldm't, ISL, HDX, '13	each	1
30	BMC83125		Bkt, Weldm't, Adapter Pl, ISL, HDX, '13	each	1
40	BMC83129		Bkt, Weldm't, Main Base, ISL, HDX, '13	each	1
50	KCB65501		Kit, Compressor, P/S, Alt, TM-65/55, '16	each	1
60	KPC64094		Kit, Pulley, 2B, ISB, 2013	each	1
70	PUA05012		Pulley, Assy, Idler,B/BX gr,5", STL,Plt	each	1
80	PUL80074		Pulley, Idler, B/S, Wide, 76d (89102)	each	1
90	SCD21912		Spacer, Col, Drl,21.9mm x 25.4o x 12.3i	each	1
100	SCD25412		Spacer, Col, Drl,25.4mm x 25.4o x 12.3i	each	1
110	SLV17012		Sleeve, Pulley, 16.9o x 22.23mm x 12.32i	each	2
120	KBC66694		Bag Kit, Fasteners, KMC66694	each	1

Bill of Materials Listing

TransArctic Canada Inc.

3/10/2017
Page 1 of 1

Product Number		Description	Bin	Date	Weight	Uof M	Yield
Line	Component Prod#	Description		Unit	Qty		
KBC66694		Bag Kit, Fasteners, KMC66694		3/10/2017	2.36		0
10	BTC10035	Bolt, Hex, 10 x 1.5 x 35mm, 10.9, Plt,FT		each	3		
20	BTC12110	Bolt, Hex, 12 x 1.75 x 110mm, 10.9, Plt		each	2		
30	BTQ06125	Bolt, Hex, 3/8-16unc, 1.25", 8, Plt		each	5		
40	BTQ08125	Bolt, Hex, 1/2-13unc, 1.25", 8, Plt		each	2		
50	BTQ08151	Bolt, Hex, 1/2-20unf, 1.5", 8, Plt		each	2		
60	CSF08101	Capscrew, FH, 1/2-20unf x 1.0",Alloy,Plt		each	4		
70	NTA10000	Nut, Hex, 10 x 1.5, 8.8, Plt		each	3		
80	NTA12000	Nut, Hex, 12 x 1.75, 8.8, Plt		each	2		
90	NTQ06000	Nut, Hex, 3/8-16unc, 8, Plt		each	5		
100	WFA10002	Washer, Flat, 10mm, Hvy, 8.8, Plt		each	6		
110	WFA12002	Washer, Flat, 12mm, Hvy, 8.8, Plt		each	2		
120	WFO08000	Washer, Flat, 1/2", 8, Plt		each	4		
130	WFS06002	Washer, Flat, 3/8", L9, Plt		each	10		
140	WLA10000	Washer, Lock, 10mm, 8.8, Plt		each	3		
150	WLA12000	Washer, Lock, 12mm, 8.8, Plt		each	2		
160	WLQ06000	Washer, Lock, 3/8", 8, Plt		each	5		
170	WLQ08000	Washer, Lock, 1/2", 8, Plt		each	4		

Bill of Materials Listing

TransArctic Canada Inc.

2/4/2022
Page 1 of 1

Product Number	Date	Description		Uof M	Weight	Yield
Line	Qty	Component Prod#	Rev#	Description	Bin	Unit
KCB65501	08/10/16	2	Kit, Compressor, P/S, Alt, TM-65/55, '16			166.11
10	2	BMN80008	1	Vibration Isolator, Bar, 16.50 x 2 x 1.50		each
20	1	BMN80025	0	Bkt, Back, PL, Slide, IC, RE300		each
30	1	BMZ00043	3	Bkt, Main, Base Pl, '13		each
40	1	BTP08653		Bolt, Hex, 1/2-13unc, 6.5", 5, Plt, FT		each
50	3	BTQ08101		Bolt, Hex, 1/2-20unf, 1.00", 8, Plt		each
60	3	CSF08076		Capscrew, FH, 1/2-20unf x .75", Alloy, Plt		each
70	1	KAC65501	3	Kit, Alternator, TM-65, Curb Side, '13		each
80	1	KBT65501	0	Kit, Platform, P/S, TM-55/65, '16		each
90	3	WFQ08000		Washer, Flat, 1/2", 8, Plt		each
100	4	WLQ08000		Washer, Lock, 1/2", 8, Plt		each

Bill of Materials Listing

TransArctic Canada Inc.

2/4/2022
Page 1 of 1

Product Number	Date	Description		Uof M	Weight	Yield	
Line	Qty	Component Prod#	Rev#	Description	Bin	Unit	
KAC65501	08/10/16		3	Kit, Alternator, TM-65, Curb Side, '13		45.31	0
10	2	BEL11040		Belt, A gr, 1040mm (41")		each	
20	1	BMC90020	A	Bkt, Alt, Weldm't, Curb Side, TM65/55, '16		each	
30	2	BMT10011	0	Bkt, Tenr, Block, Offset, 3mm		each	
40	1	PUL03321	1	Pulley, ALT, Idler, 3.25"d, 2A		each	
45	1	KBA84064	0	Bag Kit, ALT Shim, KC84064, KAC65501/02		each	
47	1	SCD05513	0	Spacer, Col, Drl, 5.51mm x 25.4o x12.7i	Alley	each	
50	1	TRD08080		Threaded, Rod, 1/2-13unc x 8", 5, Plt		each	
60	1	KBA65501	0	Bag Kit, Fasteners, KAC65501		each	

NOTE:

1) Use KBA84064 "Shim bag kit", as required, to align the Alternator correctly.

Bill of Materials Listing

TransArctic Canada Inc.

2/4/2022
Page 1 of 1

Product Number	Date	Description	Uof M	Weight	Yield			
Line	Qty	Component Prod#	Rev#	Description	Bin	Unit	Weight	Yield
KBA65501	08/10/16	0		Bag Kit, Fasteners, KAC65501			1.45	0
10	4	BTC12035		Bolt, Hex, 12 x 1.75 x 35mm, 10.9,Plt,FT		each		
20	1	BTQ08125		Bolt, Hex, 1/2-13unc, 1.25", 8, Plt		each		
30	1	BTQ08150		Bolt, Hex, 1/2-13unc, 1.5", 8, Plt		each		
40	1	BTQ08653		Bolt, Hex, 1/2-13unc, 6.5", 8, Plt		each		
50	6	NTQ08000		Nut, Hex, 1/2-13unc, 8, Plt		each		
60	4	WFA12000		Washer, Flat, 12mm, 8.8, Plt		each		
70	3	WFQ08000		Washer, Flat, 1/2", 8, Plt		each		
80	4	WLA12000		Washer, Lock, 12mm, 8.8, Plt		each		
90	4	WLQ08000		Washer, Lock, 1/2", 8, Plt		each		

Bill of Materials Listing

TransArctic Canada Inc.

2/4/2022
Page 1 of 1

Product Number	Date	Description			Uof M	Weight	Yield	
Line	Qty	Component	Prod#	Rev#	Description	Bin	Unit	
KBA84064	10/19/21	0			Bag Kit, ALT Shim, KC84064, KAC65501/02		0.09	0
10	1	SCD03613		0	Spacer, Col, Drl, 3.56mm x 25.4o x12.7i	Alley	each	
20	2	WFA14000			Washer, Flat, 14mm, 8.8, Plt		each	
30	2	WFQ08000			Washer, Flat, 1/2", 8, Plt		each	

NOTE:

1) Use (1) SCD03613, (2) WFA14000, (2) WFQ08000, in any arrg'mt/qtys as required to align the Alternator correctly.

Bill of Materials Listing

TransArctic Canada Inc.

3/10/2017
Page 1 of 1

Product Number	Description	Date	Weight	Uof M	Yield
Line Component Prod# Description	Bin	Unit	Qty		
KBT65501	Kit, Platform, P/S, TM-55/65, '16	8/10/2016	16.08		0
10 BMN80031	Bkt, Main, Slide, Assy, 05K, IC, RE300	each	1		
20 BMZ00056	Bkt, Comp, FRT, Z, TM-65/55, '13	each	1		
30 BMZ00057	Bkt, Comp, Rear, Z, TM-65/55, '13	each	1		
40 KBZ65501	Bag Kit, Fasteners, KBT65501	each	1		

Bill of Materials Listing

TransArctic Canada Inc.

3/10/2017
Page 1 of 1

Product Number	Description	Date	Weight	Uof M	Yield
Line Component Prod#	Description	Bin Unit	Qty		
KBZ65501	Bag Kit, Fasteners, KBT65501		8/10/2016	0.69	0
10	BTC12035		Bolt, Hex, 12 x 1.75 x 35mm, 10.9,Plt,FT	each	4
20	NTP07000		Nut, Hex, 7/16-14unc, 5, Plt	each	4
30	WFA12000		Washer, Flat, 12mm, 8.8, Plt	each	4
40	WFN07000		Washer, Flat, 7/16", 2, Plt	each	4
50	WLA12000		Washer, Lock, 12mm, 8.8, Plt	each	4
60	WLQ07000		Washer, Lock, 7/16", 8, Plt	each	4

Bill of Materials Listing

TransArctic Canada Inc.

3/10/2017
Page 1 of 1

Product Number		Description	Bin	Date	Weight	Uof M	Yield
Line	Component Prod#	Description		Unit	Qty		
KPC64094		Kit, Pulley, 2B, ISB, 2013		5/13/2008	14.32		0
10	PUL67222	Pulley, Crank, ADD-ON, ISB,6.7L,2B/X,'07		each	1		
20	CSS12090	Capscrew, SH, 12 x 1.25 x 90mm, 12.9,BLK		each	6		
30	WFS12002	Washer, Flat, Hdn, 12mm, Stl, BLK		each	6		

8 7 6 5 4 3 2 1

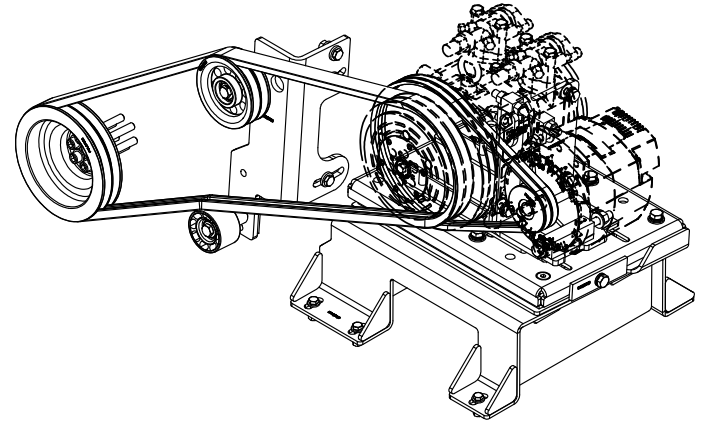
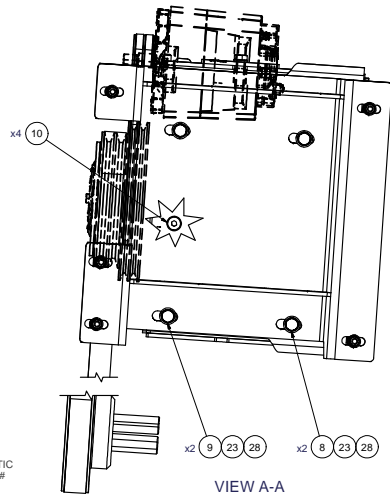
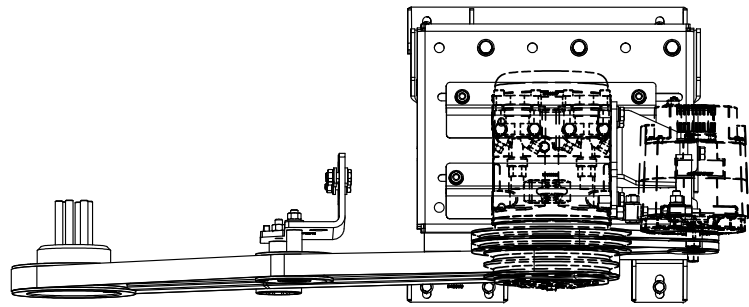

ISOMETRIC VIEW

NOTE:
SHOWING TRANSARCTIC
COMPRESSOR PART#
CMV33644 (TM-55)/
CMV38844(TM-65)
AS REFERENCE.

NOTE:
SHOWING ALTERNATOR
AS REFERENCE.

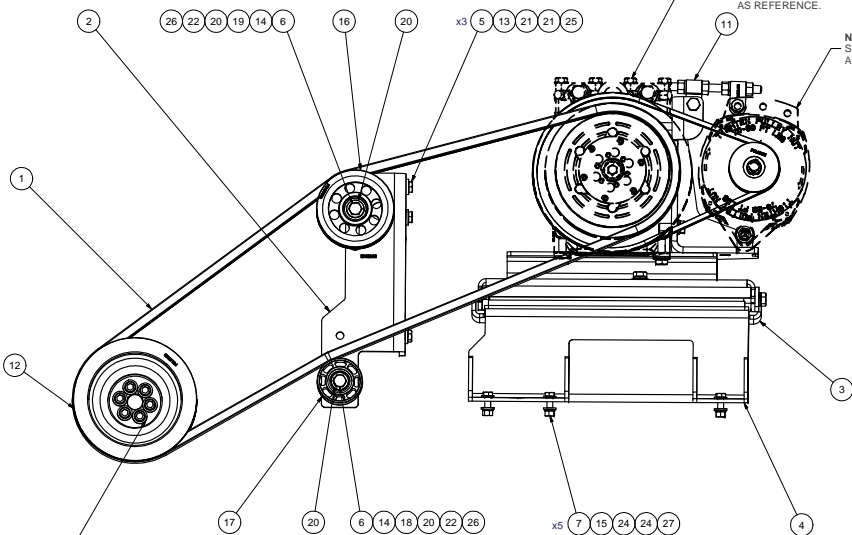

NOTE:
TORQUE TO: 37 FT-LB PLAIN & LUBRICATED W/ CLEAN ENGINE OIL (15W-40)
(SH. CAPSCREW M12 x 1.25 x 90mm)
TIGHTEN IN TWO STEPS IN A CRIS-CROSS TIGHTENING SEQUENCE PATTERN.

NOTES:
1) USE SERVICABLE THREADLOCKER ON ALL FASTENERS TO ENGINE COMPONENTS AND TORQUE ALL BOLTS TO S.A.E. SPECIFICATIONS.
2) SEE "TRANSARCTIC A/C COMPRESSOR MOUNT INSTALLATION DISCLAIMER".

ITEM	QTY	U/M	PART NUMBER	DESCRIPTION
28	4	EACH	WLO08000	WASHER, LOCK, 1/2", 8, PLT
27	5	EACH	WLO06000	WASHER, LOCK, 3/8", 8, PLT
26	2	EACH	WLA12000	WASHER, LOCK, 12mm, 8.8, PLT
25	3	EACH	WLA10000	WASHER, LOCK, 10mm, 8.8, PLT
24	10	EACH	WFS06002	WASHER, FLAT, 3/8", L9, PLT
23	4	EACH	WFO08000	WASHER, FLAT, 1/2", 8, PLT
22	2	EACH	WFA12002	WASHER, FLAT, 12mm, HVY, 8.8, PLT
21	6	EACH	WFA10002	WASHER, FLAT, 10mm, HVY, 8.8, PLT
20	2	EACH	SLV17012	SLEEVE, PULLEY, 16.90 x 22.23 mm x12.19l
19	1	EACH	SCD49512	SPACER, COL, DRL, 49.48mm x 25.40 x 12.3
18	1	EACH	SCD46012	SPACER, COL, DRL, 46mm x 31.80 x 12.0l
17	1	EACH	PUL80074	PULLEY, IDLER, BACKSIDE, P8, 74D, 46.27W
16	1	EACH	PUA05012	PULLEY, ASSY, IDLER, B/BX gr, 5" STL, PLT
15	5	EACH	NTQ06000	NUT, HEX, 3/8-16UNC, 8, PLT
14	2	EACH	NTA12000	NUT, HEX, 12 x 1.75, 8.8, PLT
13	3	EACH	NTA10000	NUT, HEX, 10 x 1.5, 8.8, PLT
12	1	EACH	KPC64094	KIT, PULLEY, 28, 158, 2013
11	1	EACH	KCB65501	KIT, COMPRESSOR, P/S, ALT, TM-65/55, '16
10	4	EACH	CSF08101	CAPSCREW, FH, 1/2-20UNF x 1", ALLOY, PLT
9	2	EACH	BTQ08151	BOLT, HEX, 1/2-20UNF x 1.50, 8, PLT
8	2	EACH	BTQ08125	BOLT, HEX, 1/2-13UNC x 1.25, 8, PLT
7	5	EACH	BTQ06125	BOLT, HEX, 3/8-16UNC x 1.25, 8, PLT
6	2	EACH	BTC12110	BOLT, HEX, 12 x 1.75 x 110mm, 10.9, PLT
5	3	EACH	BTC10035	BOLT, HEX, 10 x 1.5 x 35mm, 10.9, PLT
4	1	EACH	BMC83129	BKT, WELDMT, MAIN BASE, ISL, HDX, '13
3	1	EACH	BMC83125	BKT, WELDMT, ADAPTER PL, ISL, HDX, '13
2	1	EACH	BMC83123	BKT, MAIN, IDLER, WELDMT, ISL, HDX, '13
1	1	EACH	BEL32389	BELT, BANDED B gr, 2389mm (9'4")

BILL OF MATERIALS
TRANSARCTIC INC.

DATE:	8/8/2016	BY:	JRK
RELEASED TO PROTOTYPE:	8/8/2016	DATE:	8/8/2016
REVIEWER:	Val Jakovlew	DATE:	8/8/2016
APPROVED:	Ron Ingram	DATE:	8/8/2016
APPROVED:	Dale Mason	DATE:	8/8/2016

TITLE	MT KIT, ISB, HDX, TM-55/ 65, ALT, '13
SIZE	D
DWG NO	KMC66694
REV	0
SCALE	1:4
SHEET	1 OF 1

UNSPECIFIED TOLERANCES: ALL DIMS
 ONE DECIMAL PLACE (X2) .05 (FRA)
 TWO DECIMAL PLACE (X20) .005 (FRA)
 THREE DECIMAL PLACE (X200) .0005 (FRA)
 FRACTIONAL (X16) .000625 (FRA)
 ANGULAR (X10) .005 (FRA)



DRAWING UNIT OF MEASURE: MM (INCH)

8 7 6 5 4 3 2 1

TOP VIEW

PARTS REMOVED FOR CLARITY.

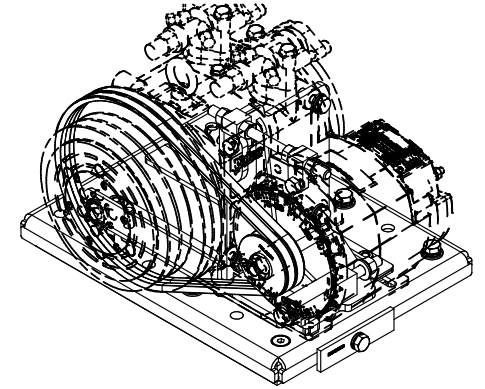
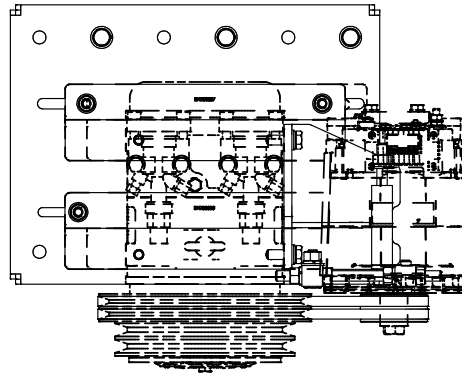
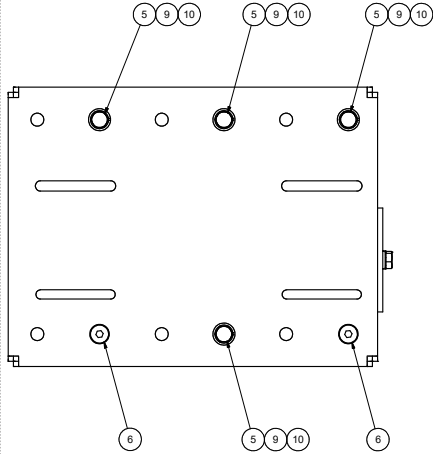

ISOMETRIC VIEW

NOTE:
SHOWING TRANSARCTIC
COMPRESSOR PART#
CMV33644 (TM-55)
CMV33844 (TM-65)
AS REFERENCE.

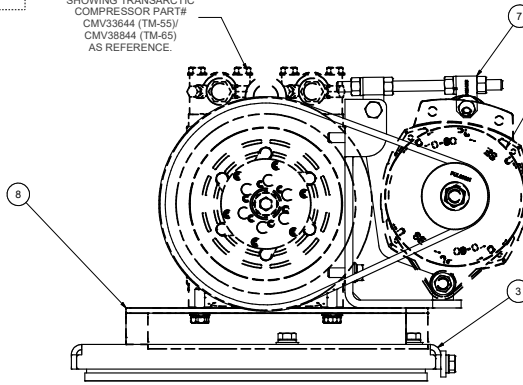

NOTE:
SHOWING ALTERNATOR
AS REFERENCE.

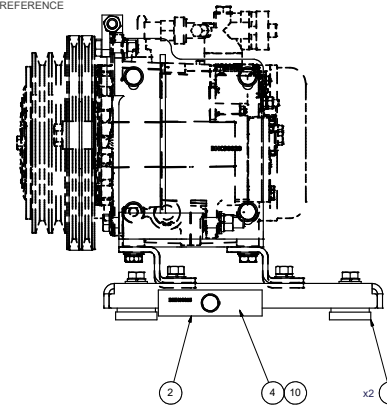

NOTES:

- 1) USE SERVICABLE THREADLOCKER ON ALL FASTENERS TO ENGINE COMPONENTS AND TORQUE **ALL** BOLTS TO S.A.E. SPECIFICATIONS.
- 2) SEE 'TRANSARCTIC A/C COMPRESSOR MOUNT INSTALLATION DISCLAIMER'.
- 3) WEIGHT: 68.75 LBS.

ITEM	QTY	U/M	PART NUMBER	DESCRIPTION
10	5	EACH	IWLQ08000	WASHER, LOCK, 1/2", 8, PLT
9	4	EACH	WFC08000	WASHER, FLAT, 1/2", 8, PLT
8	1	EACH	KBT65501	KIT, PLATFORM, P/S, TM-55/65, '16
7	1	EACH	KAC65501	KIT, ALTERNATOR, TM-65, CURB SIDE, '13
6	2	EACH	CSF08076	CAPSCREW, FH, 1/2-20UNF x .75", ALLOY, PLT
5	4	EACH	BTQ08101	BOLT, HEX, 1/2-20UNF x 1.00, 8, PLT
4	1	EACH	BTP08653	BOLT, HEX, 1/2-13UNC x 6.50, 5, PLT, FT
3	1	EACH	BMZ00043	BKT, MAIN, BASE PL, '13
2	1	EACH	BMN80025	BKT, BACK, PL, SLIDE, IC, RE300
1	2	EACH	BMN80008	VIBRATION ISOLATOR, BAR, 16.50 x 2 x 1.50

DRAWN				CHECKED				TITLE			
vjakowlew				8/3/2016				TRANSARCTIC INC.			
0				RELEASED TO PRODUCTION				8/3/2016			
REV:ECN				DESCRIPTION:				DATE: BY:			
1				REVISED KAC65501				11/2/2016 JBR			
0				RELEASED TO PRODUCTION				8/3/2016 JBR			
1				James Stewart				8/3/2016			
2				James Stewart				8/3/2016			
3				Dale Mason				8/3/2016			
1				KIT, COMPRESSOR, P/S, ALT, TM-65/55, '16				DWG NO			
1				KCB65501				REV			
1				1				1			

UNSPECIFIED TOLERANCES:	ALL DIMS	FINISH
ONE DECIMAL PLACE (.X)	1/16	1/32
TWO DECIMAL PLACE (.XX)	1/32	1/64
THREE DECIMAL PLACE (.XXX)	1/64	1/128
FRACTIONAL (1/16")	1/16	1/32



DRAWING UNIT OF MEASURE: MM (INCH) SCALE: 1:3 SHEET 1 OF 1

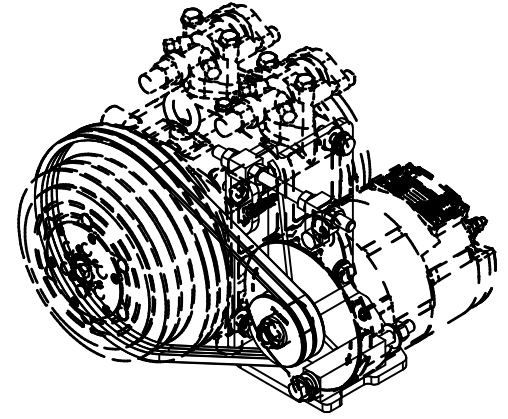
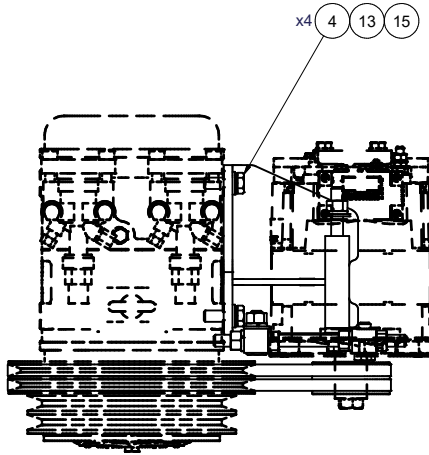

ISOMETRIC VIEW

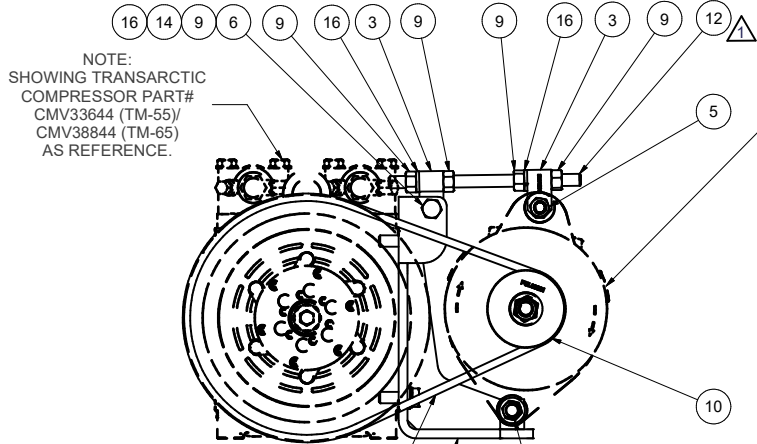

NOTE:
SHOWING TRANSARCTIC
COMPRESSOR PART#
CMV33644 (TM-55/
CMV38844 (TM-65)
AS REFERENCE.

NOTE:
SHOWING ALTERNATOR
AS REFERENCE

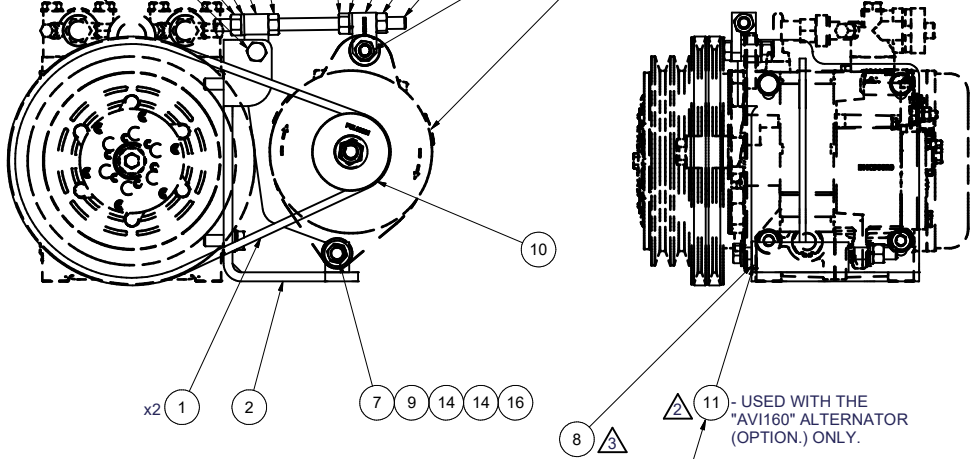

USE KBA84064 SHIM KIT AS REQUIRED
TO ALIGN ALTERNATOR PULLEY TO
COMPRESSOR PULLEY "A" GROOVES.

11 - USED WITH THE
"AVI160" ALTERNATOR
(OPTION.) ONLY.

NOTES:

- 1) USE SERVICABLE THREADLOCKER ON ALL FASTENERS TO ENGINE COMPONENTS AND TORQUE **ALL** BOLTS TO S.A.E. SPECIFICATIONS.
- 2) SEE "TRANSARCTIC A/C COMPRESSOR MOUNT INSTALLATION DISCLAIMER".
- 3) WEIGHT: 18.11 LB

ITEM	QTY	U/M	PART NUMBER	DESCRIPTION
16	4	EACH	WLQ08000	WASHER, LOCK, 1/2", 8, PLT
15	4	EACH	WLA12000	WASHER, LOCK, 12mm, 8.8, PLT
14	3	EACH	WFO08000	WASHER, FLAT, 1/2", 8, PLT
13	4	EACH	WFA12000	WASHER, FLAT, 12mm, 8.8, PLT
12	1	EACH	TRD08080	THREADED, ROD, 1/2-13UNC x 8", 5 PLT
11	1	EACH	SCD05513	SPACER, COL, DRL, 5.51mm x 25.4o x 12.7i
10	1	EACH	PUL03321	PULLEY, ALT, IDLER, 3.25"o, 2A
9	6	EACH	NTQ08000	NUT, HEX, 1/2-13UNC, 8, PLT
8	1	EACH	KBA84064	BAG KIT, ALT SHIM, KC84064, KAC65501/02
7	1	EACH	BTQ08653	BOLT, HEX, 1/2-13UNC x 6.50, 8, PLT
6	1	EACH	BTQ08150	BOLT, HEX, 1/2-13UNC x 1.50, 8, PLT
5	1	EACH	BTQ08125	BOLT, HEX, 1/2-13UNC x 1.25, 8, PLT
4	4	EACH	BTC12035	BOLT, HEX, 12 x 1.75 x 35mm, 10.9, PLT
3	2	EACH	BMT10011	BKT, TENR, BLOCK, OFFSET, 3mm
2	1	EACH	BMCS90020	BKT, ALT, WELDM'T, CURB SIDE, TM-65/55, '16
1	2	EACH	BEL11040	BELT, A gr, 1040mm (41")

BILL OF MATERIALS

3	ADDED KBA84064 SHIM BAG KIT.	02/03/2022	VALJ	
2	ADDED SCD05513.	05/11/2021	JRR	
1	WAS TRD08060, NOW TRD08080	10/2/2018	JRR	
0	RELEASED TO PRODUCTION.	8/3/2016	JRR	
REV:	ECN:	DESCRIPTION:	DATE:	BY:
THIS DRAWING CONTAINS PROPRIETARY CONFIDENTIAL INFORMATION OWNED BY TRANSARCTIC CANADA INC. THE DOCUMENT AND THE INFORMATION IN IT ARE NOT TO BE USED, DISCLOSED OR REPRODUCED WITHOUT EXPRESS WRITTEN PERMISSION OF THE COMPANY.				
UNSPECIFIED TOLERANCES: [ALT. DIM.]				
ONE DECIMAL PLACE (X)	MM	(INCH)		
TWO DECIMAL PLACE (XX)	.50	[.005]		
THREE DECIMAL PLACE (XXX)	.25	[.010]		
FRACTIONAL (1/16")	.10	[.005]		
	ANGULAR	+/- .50°		
THIRD ANGLE PROJECTION				
DRAWN		08/03/16		
vjakowlew				
CHECKED				
Jose Rodriguez		08/03/16		
REV:		DATE:		KIT, ALTERNATOR, TM-55/65, CURB SIDE, '13
James Stewart		8/3/2016		
MFG				
James Stewart		08/03/16		
APPROVED				SIZE: C DWG NO: KAC65501 REV: 3
Dale Mason		08/03/16		
DRAWING UNIT OF MEASURE:		MM [INCH]		SCALE: 1:4

DRAWN		08/03/16		
vjakowlew				
CHECKED				
Jose Rodriguez		08/03/16		
REV:		DATE:		KIT, ALTERNATOR, TM-55/65, CURB SIDE, '13
James Stewart		8/3/2016		
MFG				
James Stewart		08/03/16		
APPROVED				SIZE: C DWG NO: KAC65501 REV: 3
Dale Mason		08/03/16		
DRAWING UNIT OF MEASURE:		MM [INCH]		SCALE: 1:4

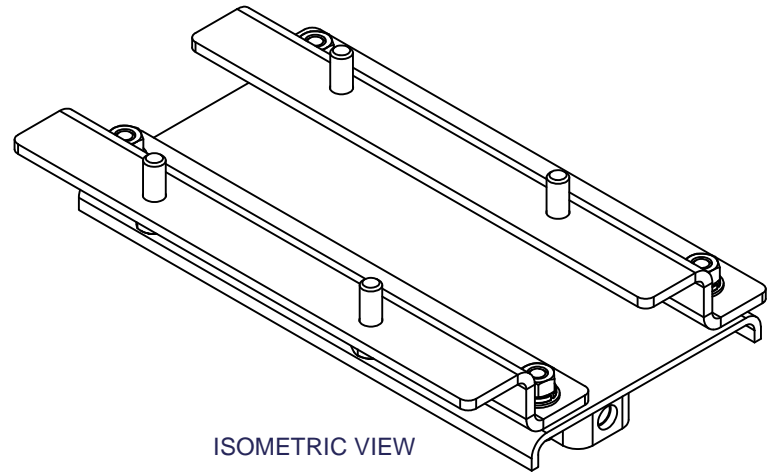
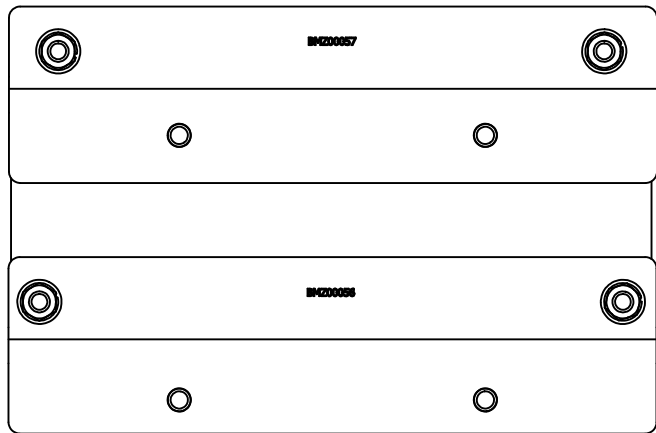

ISOMETRIC VIEW

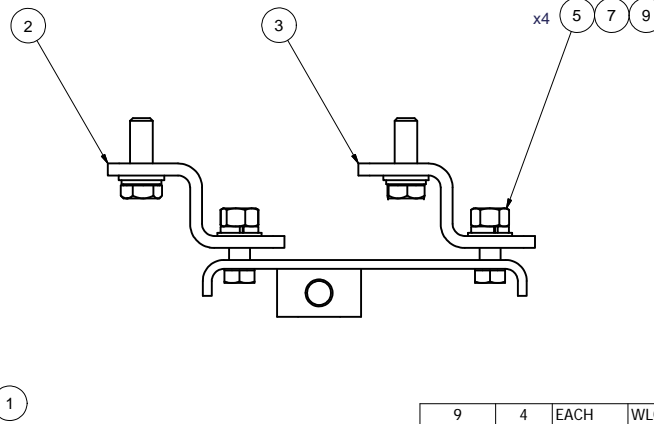
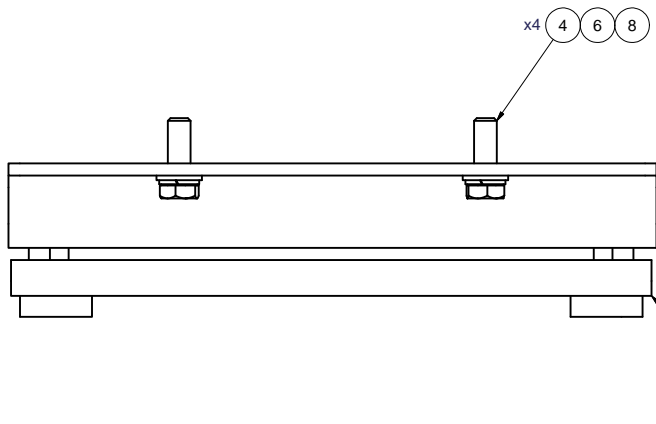

ITEM	QTY	U/M	PART NUMBER	DESCRIPTION
9	4	EACH	WLQ07000	WASHER, LOCK, 7/16", 8, PLT
8	4	EACH	WLA12000	WASHER, LOCK, 12mm, 8.8, PLT
7	4	EACH	WFN07000	WASHER, FLAT, 7/16", 2, PLT
6	4	EACH	WFA12000	WASHER, FLAT, 12mm, 8.8, PLT
5	4	EACH	NTP07000	NUT, HEX, 7/16-14UNC, 5, PLT
4	4	EACH	BTC12035	BOLT, HEX, 12 x 1.75 x 35mm, 10.9, PLT
3	1	EACH	BMZ00057	BKT, COMP, REAR, Z, TM-65/55, '13
2	1	EACH	BMZ00056	BKT, COMP, FRT, Z, TM-65/55, '13
1	1	EACH	BMN80031	BKT, MAIN, SLIDE, ASSY, 05K, IC, RE300

BILL OF MATERIALS

DRAWN	jrodriguez	8/8/2016
CHECKED	Val Jakowlew	8/8/2016
APPROVED	James Stewart	8/8/2016
MFG	James Stewart	8/8/2016
APPROVED	Dale Mason	8/8/2016



TITLE	KIT, PLATFORM, P/S, TM-55/65, '16		
SIZE	C	DWG NO	REV
		KBT65501	0

0	RELEASED TO PRODUCTION	8/8/2016	JRR
REV	ECN	DESCRIPTION	DATE
THIS DRAWING CONTAINS PROPRIETARY CONFIDENTIAL INFORMATION OWNED BY TRANSARCTIC CANADA INC. THE DOCUMENT AND THE INFORMATION IN IT ARE NOT TO BE USED, DISCLOSED OR REPRODUCED WITHOUT EXPRESS WRITTEN PERMISSION OF THE COMPANY.			
UNSPECIFIED TOLERANCES: (ALT. DIM.) ONE DECIMAL PLACE (X) .50 (0.020) TWO DECIMAL PLACE (XX) .25 (0.010) THREE DECIMAL PLACE (XXX) .10 (0.005) FRACTIONAL +/- 1/32" ANGULAR +/- .50°			
THIRD ANGLE PROJECTION		DRAWING UNIT OF MEASURE: MM (INCH)	

NOTES:

- 1) USE SERVICABLE THREADLOCKER ON ALL FASTENERS TO ENGINE COMPONENTS AND TORQUE **ALL** BOLTS TO S.A.E. SPECIFICATIONS.
- 2) SEE "TRANSARCTIC A/C COMPRESSOR MOUNT INSTALLATION DISCLAIMER".
- 3) WEIGHT: 16.47 LBS.

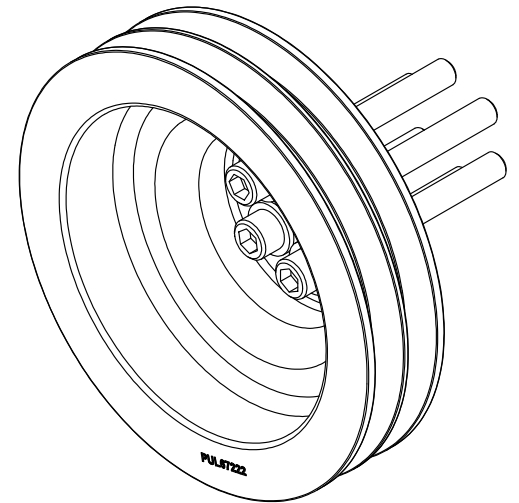
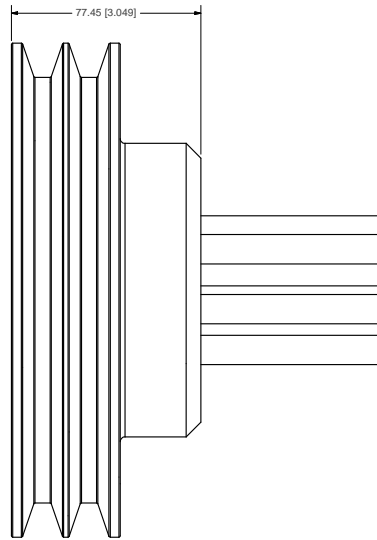
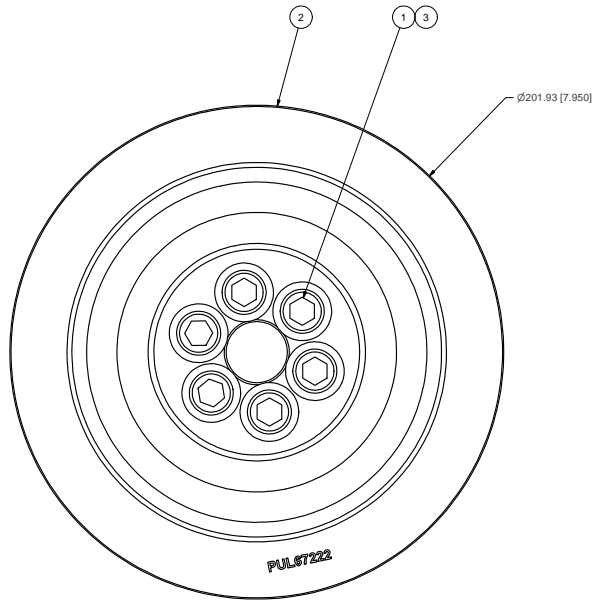
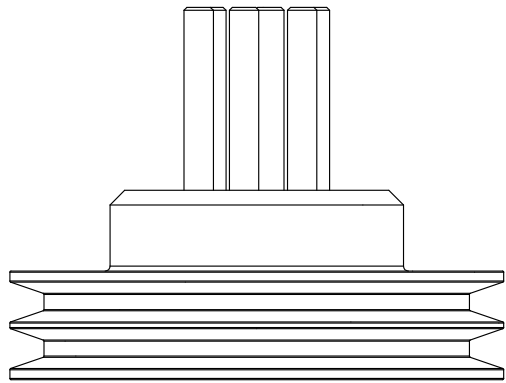

ISOMETRIC VIEW

NOTES:

- 1) USE SERVICABLE THREADLOCKER ON ALL FASTENERS TO ENGINE COMPONENTS AND TORQUE **ALL BOLTS** TO S.A.E. SPECIFICATIONS.
- 2) SEE "TRANSARTIC A/C COMPRESSOR MOUNT INSTALLATION DISCLAIMER".
- 3) WEIGHT: 13.24 LB

ITEM	QTY	U/M	PART NUMBER	DESCRIPTION
3	6	EACH	WFS12002	WASHER, FLAT, HDN, 12mm, STL, BLK
2	1	EACH	PUL67222	PULLEY, CRANK, ADD-ON, ISB, 5.7L, 2B/IX '07
1	6	EACH	CSS12090	CAPSCREW, SH, 12 x 1.25 x 90mm, 12.9, FLT

TRANSARTIG INC.

UNSPECIFIED TOLERANCES:	INCH DIM.	MILLIMETER DIM.
ONE DECIMAL PLACE (X.1)	±.010	±.25
TWO DECIMAL PLACE (X.01)	±.005	±.13
THREE DECIMAL PLACE (X.001)	±.002	±.05
FRACTIONAL (1/16")	±.005	±.13
ANGULAR (1°)	±.005	±.13

DRAWN	Jose Rodriguez	11/6/2013
CHECKED	Val Jakowlew	11/6/2013
REVISION	DESCRIPTION	DATE
1	RELEASED TO PRODUCTION	11/6/2013
2	APPROVED	11/6/2013

TITLE	KIT, PULLEY, 2B, ISB, 1013		
SIZE	D	DWG NO	KPC64094
SCALE	1:1	SHEET	1 OF 1

THIS DRAWING CONTAINS PROPRIETARY CONFIDENTIAL INFORMATION OWNED BY TRANSARTIC CANADA INC. THE DOCUMENT AND THE INFORMATION IN IT ARE NOT TO BE USED, DISCLOSED OR REPRODUCED WITHOUT EXPRESS WRITTEN PERMISSION OF THE COMPANY.



DRAWING UNIT OF MEASURE: MM (INCH)

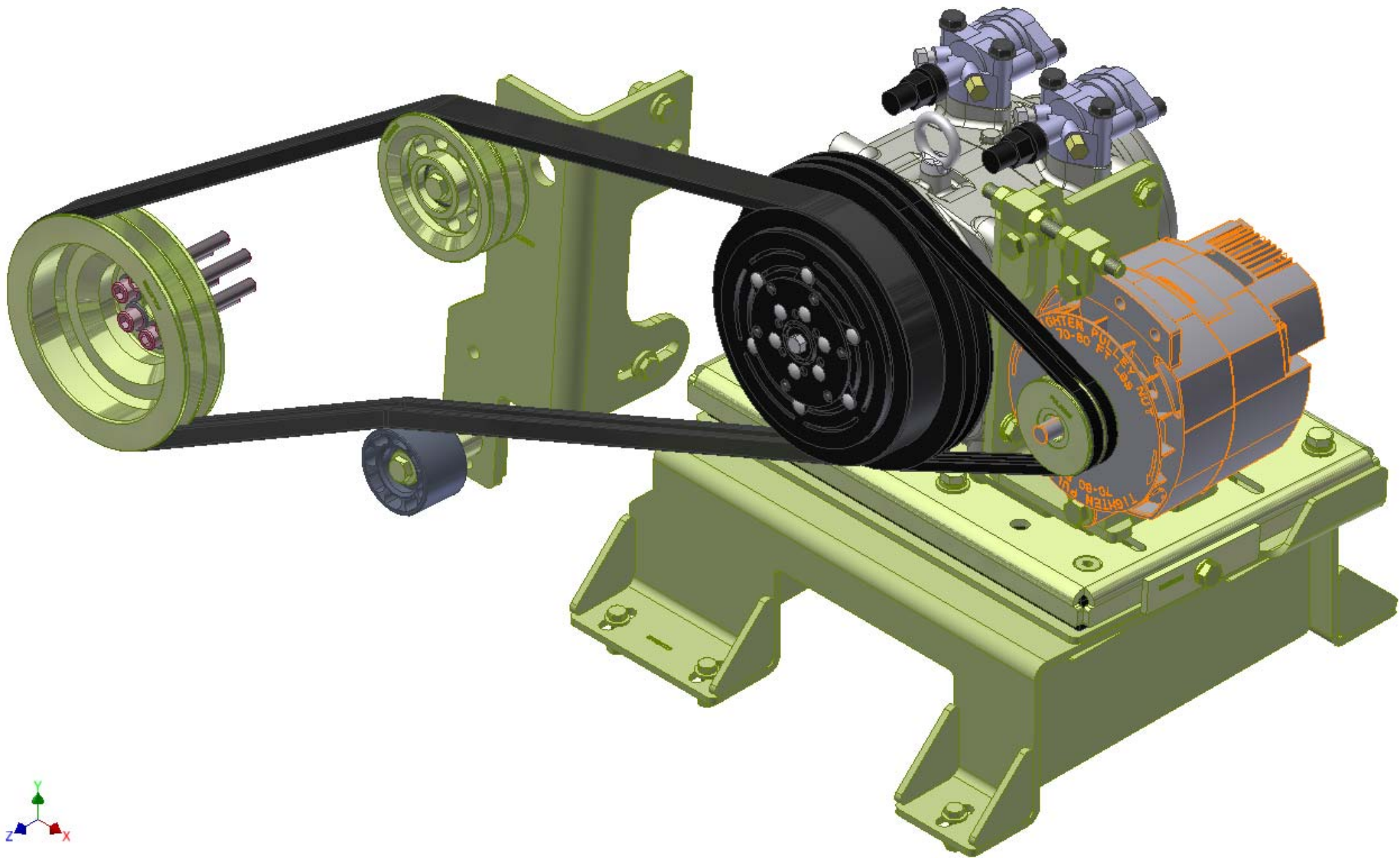

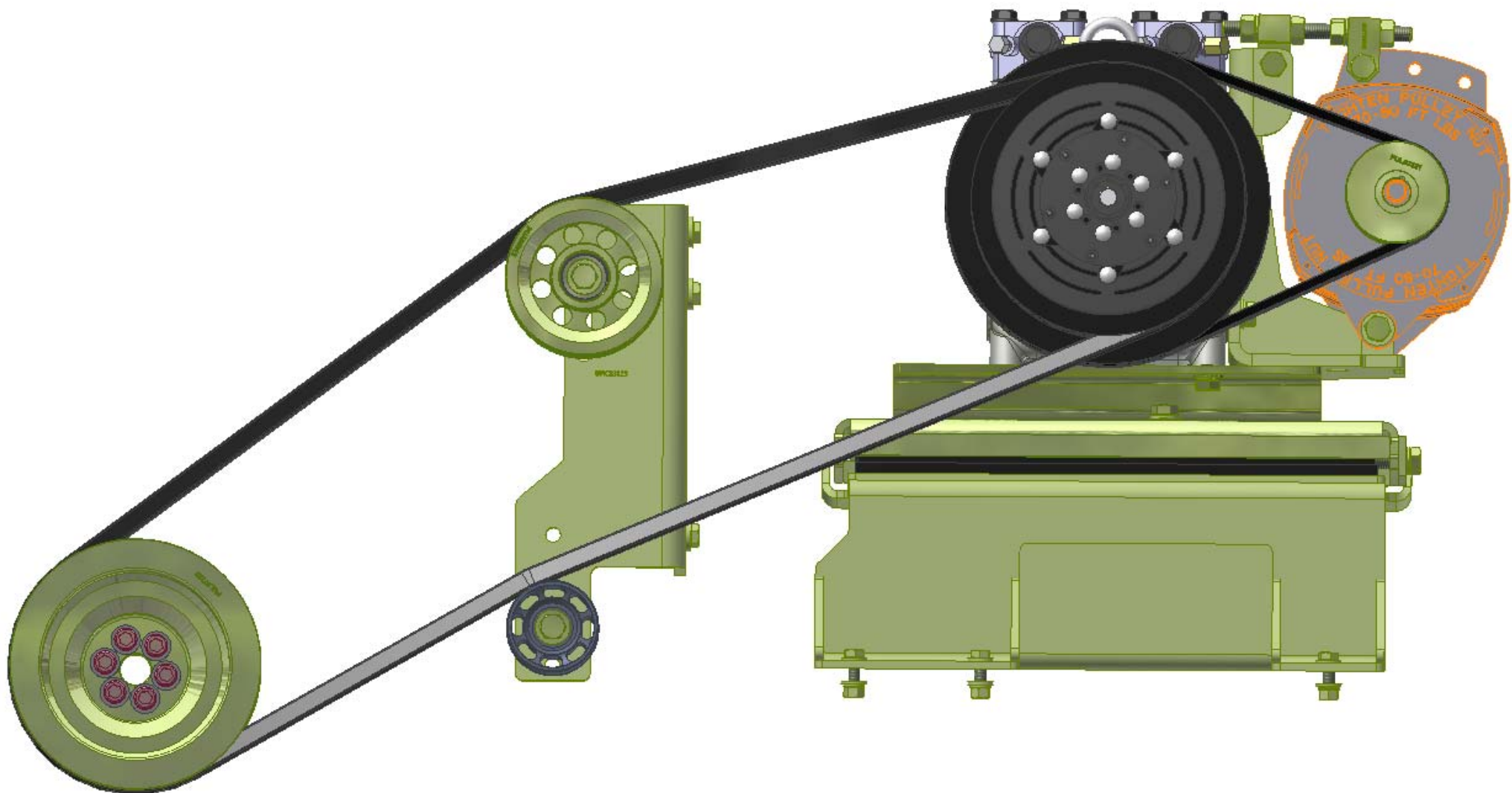

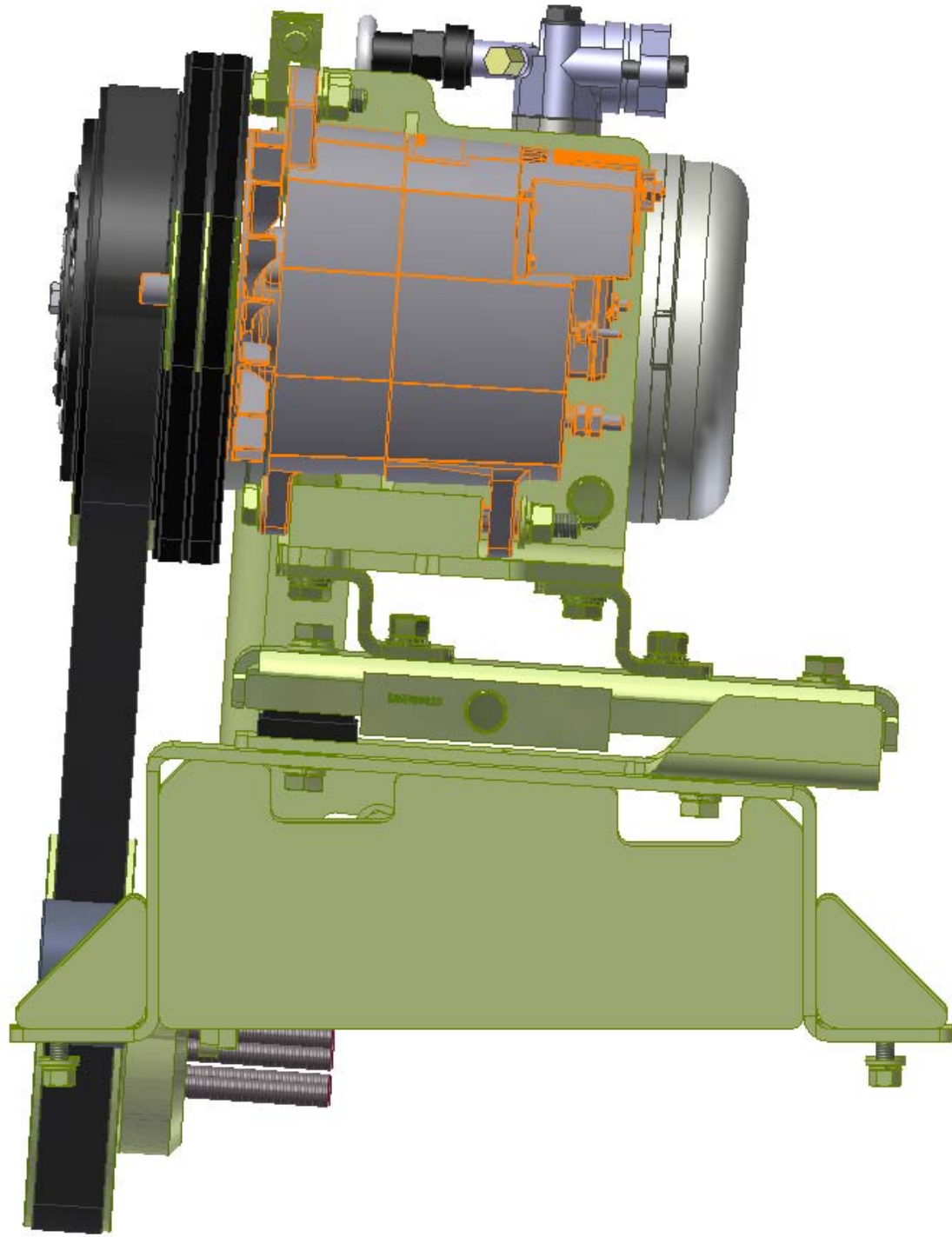

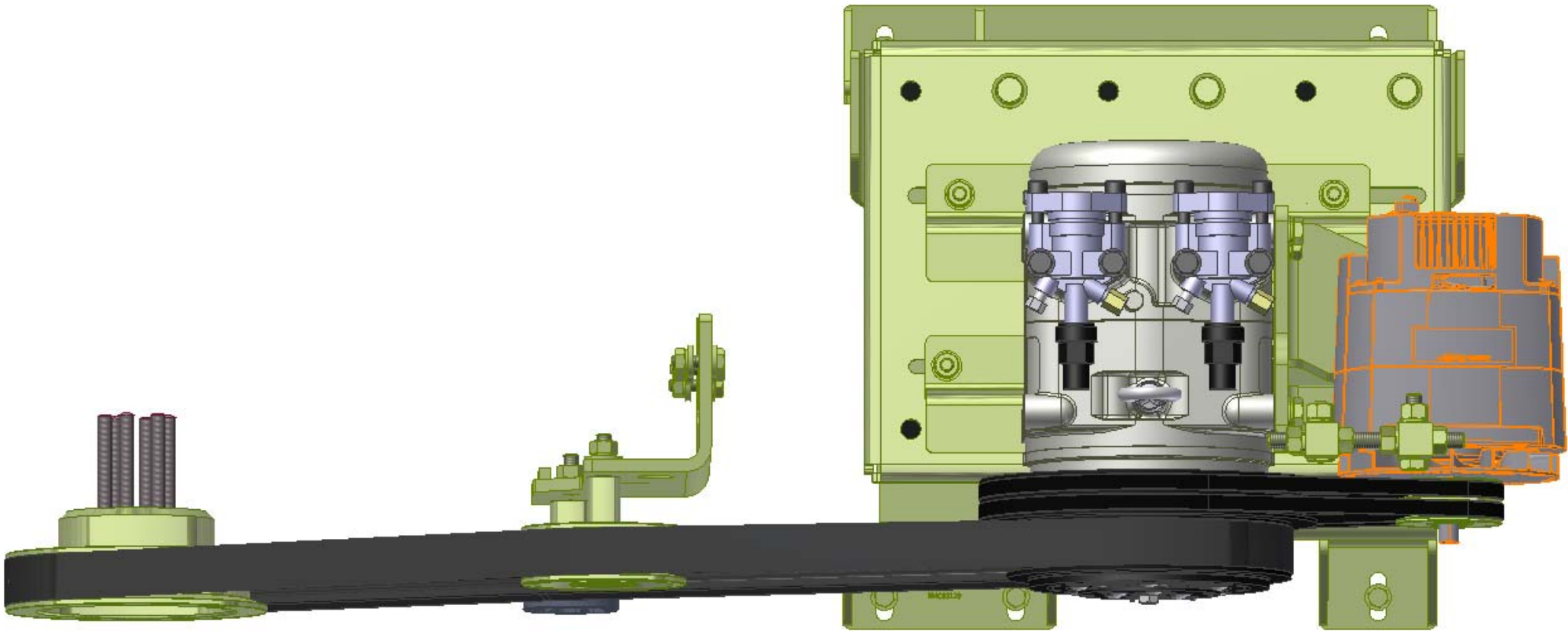

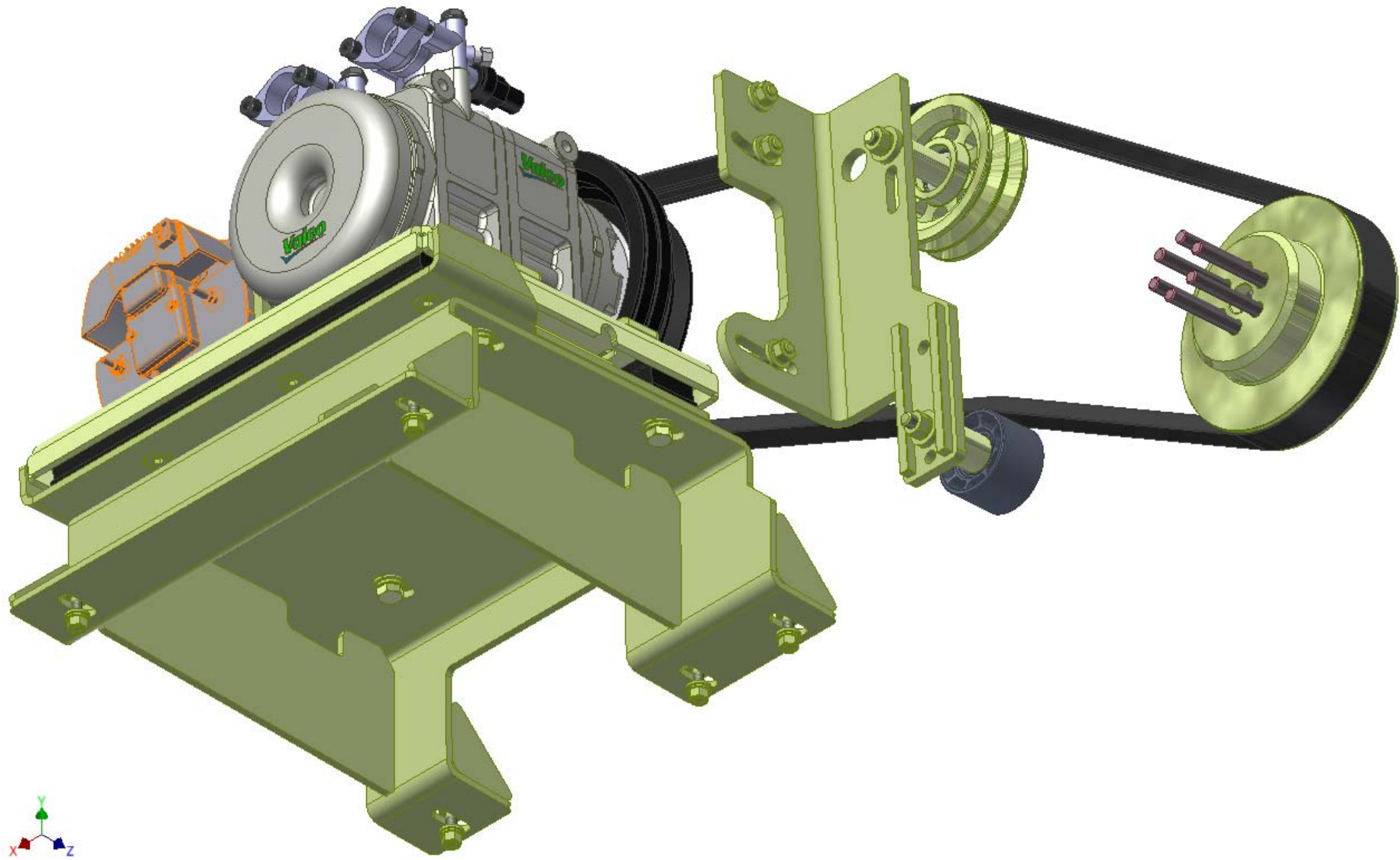

TransArctic A/C Compressor Mount Installation Disclaimer

All compressor mounts should be installed by qualified and trained personnel using proper tools and equipment in safe working conditions following industry standard guidelines for motor vehicle service and repair.

The installer of any compressor mount purchased from TransArctic must undertake all responsibility of issues arising from that compressor bracket being installed on any vehicle. As well as insure that a **proper and sufficient ground** is established between the compressors' clutches and the vehicle's engine. Mount functionality, operation and durability can all be compromised by an incompetent installation.

Due to the many different situations, parameters and application criteria, which are beyond the compressor mount manufacturer's control, TransArctic does not warrant design, durability, or operational functionality of any compressor mount improperly installed by another party.

With no implied guarantees it is the mount installer's strict responsibility to determine safety and functionality, of the compressor mount, at the time of installation.

Please contact TransArctic with any issue arising from installation so we may better improve the product. If you have any reservations about the compressor mount integrity contact TransArctic immediately at 1-877-COLD-AIR.

Mark OEM tensioner location

Install Kit

Check for Interferences

Check to ensure that the proper OEM tensioner orientation is maintained

Run engine with A/C system engaged for at least 10 minutes to run in belt

Check OEM tensioner orientation and adjust as required

Responsabilidad limitada de TransArctic en la instalación del soporte del compresor

Todos los soportes de los compresores deben ser instalados por personas calificadas y entrenadas, usando para ello los equipos y herramientas necesarios para esta labor en buenas condiciones y según las normas y guías para el servicio y/o reparación de motores de vehículos.

El instalador de los soportes comprados en TransArctic asume toda la responsabilidad de cualquier problema que surga en el soporte del compresor al vehículo; de igual manera es responsable que el cable a tierra sea conectado entre el embrague del compresor y el motor del vehículo.

Se advierte que el buen funcionamiento y la durabilidad del soporte pueden ser comprometidos por defectos en su instalación.

Debido a las diversas situaciones que se puedan presentar fuera del control del fabricante, TransArctic no garantiza el diseño, la durabilidad o el correcto funcionamiento de cualquier equipo inapropiadamente instalado por terceros.

Esta sobreentendido que el Instalador del montaje del compresor es estrictamente responsable de la seguridad y funcionamiento del equipo en el momento de la instalación.

Si tuviera algún problema o duda acerca de la instalación del soporte del compresor pongase en contacto inmediatamente con TransArctic al teléfono 1-877-COLD-AIR de modo que podamos mejorar nuestro producto.

Note la ubicación del medidor de tensión OEM

Instale el equipo

Controlar si hay interferencias.

Asegure que el medidor de tensión mantenga la orientación justa.

Encienda el motor por lo menos 10 minutos con el sistema A/C enganchado para que la correa corra

Controle la orientación justa del medidor de tensión y ajuste a las condiciones requeridas del fabricante