

Bill of Materials Listing

TransArctic Canada Inc.

5/6/2019
Page 1 of 1

Product Number		Description	Rev#	Date	Weight	Uof M	Yield
Line	Component Prod#	Description	Bin	Unit	Qty		
KMD84195		Mt Kit, Detroit DD8, HDX, O5G, 24V, '19	0	2/26/2019	144.72		0
10	BEL32389	Belt, Banded B gr,2388mm (94") (41-1328)		each	1		
20	BMC83125	Bkt, Weldm't, Adapter PI, ISL, HDX, '13		each	1		
30	BMC90012	Bkt, Weldm't, Main Base, HDX, 16'		each	1		
35	BMD80003	Bkt, Hanger, Reservoir, DD8 RE		each	1		
50	KTT00005	Kit, 05G, Tensioner Bracket, Ass'y, '19		each	1		
60	KCB94195	Kit, Compressor, Alt, O5G, '16		each	1		
120	KBD84195	Bag Kit, Fasteners,KMD84195		each	1		

Bill of Materials Listing

TransArctic Canada Inc.

5/6/2019
Page 1 of 1

Product Number		Description	Rev#	Date	Weight	Uof M	Yield
Line	Component Prod#	Description	Bin	Unit	Qty		
KTT00005		Kit, 05G, Tensioner Bracket, Ass'y, '19	0	9/21/2017	27.95		0
5	BMD80001	Bkt, Idler, F/S-B/S Add-On, '19		each	1		
10	BMD80002	Bkt, Angle, HOR, HDX, DD8		each	1		
20	PUA05012	Pulley, Assy, Idler, B/BX gr, 5", STL, Plt		each	1		
25	PUA05001	Pulley, Assy, Idler, B/S, 5", Stl, Plt		each	1		
30	SCD21912	Spacer, Col, Drl, 21.9mm x 25.4o x 12.3i		each	2		
40	SLV17012	Sleeve, Pulley, 16.9o x 22.23mm x 12.32i		each	2		
50	KBT00005	Bag Kit, Fasteners, KTT00005		each	1		

Bill of Materials Listing

TransArctic Canada Inc.

4/29/2019
Page 1 of 1

Product Number		Description	Rev#	Date	Weight	Uof M	Yield
Line	Component Prod#	Description	Bin	Unit	Qty		
KBT00005		Bag Kit, Fasteners, KTT00005		9/21/2017	1.22		0
10	BTC12080	Bolt, Hex, 12 x 1.75 x 80mm, 10.9,Plt,FT		each	2		
15	BTC12040	Bolt, Hex, 12 x 1.75 x 40mm, 10.9,Plt,FT		each	2		
20	BTQ08126	Bolt, Hex, 1/2-20unf, 1.25", 8, Plt		each	3		
30	NTA12000	Nut, Hex, 12 x 1.75, 8.8, Plt		each	4		
35	WFA12000	Washer, Flat, 12mm, 8.8, Plt		each	2		
40	WFA12002	Washer, Flat, 12mm, Hvy, 8.8, Plt		each	2		
50	WFQ08000	Washer, Flat, 1/2", 8, Plt		each	3		
60	WLA12000	Washer, Lock, 12mm, 8.8, Plt		each	4		
70	WLQ08000	Washer, Lock, 1/2", 8, Plt		each	3		

Bill of Materials Listing

TransArctic Canada Inc.

4/25/2019
Page 1 of 1

Product Number		Description	Rev#	Date	Weight	Uof M	Yield
Line	Component Prod#	Description	Bin	Unit	Qty		
KCB94195		Kit, Compressor, Alt, O5G, '16	0	5/31/2016	60.37		0
10	BEL11138	Belt, A gr, 1138mm (44.8")		each	2		
20	BMC83114	Bkt, PI, ALT Spacer, T3RE, '13		each	1		
30	BMN80008	Vibration Isolator, Bar,16.50 x 2 x 1.50		each	2		
40	BMN80025	Bkt, Back, PL, Slide, IC, RE300		each	1		
50	BMT10011	Bkt, Tenr, Block, Offset, 3mm		each	2		
60	BMZ00043	Bkt, Main, Base PI, '13		each	1		
70	KBT94195	Kit, Platform, O5G W/ Alt, '16		each	1		
80	PUL03321	Pulley, ALT, Idler, 3.25"d, 2A		each	1		
90	KBZ94195	Bag Kit, Fasteners, KCB92495 & KCB94195		each	1		

Bill of Materials Listing

TransArctic Canada Inc.

7/15/2016
Page 1 of 1

Product Number	Description	Date	Weight	Uof M	Yield
Line Component Prod#	Description	Bin Unit	Qty		
KBT94195	Kit, Platform, O5G W/ Alt, '16	5/31/2016	16.33		0
10	BMC90015				
	Bkt, Weldm't, Alt Extension, HDX, 16'	each	1		
20	BMN80010				
	Bkt, Main, Slide, Assy, O5G, IC, RE300	each	1		
30	BTQ06150				
	Bolt, Hex, 3/8-16unc, 1.50", 8, Plt	each	2		
40	NTP07000				
	Nut, Hex, 7/16-14unc, 5, Plt	each	4		
50	SCD29213				
	Spacer, Col, Drl,29.21mm x 25.4o x 12.7i	each	1		
60	WFN06000				
	Washer, Flat, 3/8", 2, Plt	each	2		
70	WFN07000				
	Washer, Flat, 7/16", 2, Plt	each	4		
80	WLQ06000				
	Washer, Lock, 3/8", 8, Plt	each	2		
90	WLQ07000				
	Washer, Lock, 7/16", 8, Plt	each	4		

Bill of Materials Listing

TransArctic Canada Inc.

4/25/2019
Page 1 of 1

Product Number		Description	Rev#	Date	Weight	Uof M	Yield
Line	Component Prod#	Description	Bin	Unit	Qty		
KBZ94195		Bag Kit, Fasteners, KCB92495 & KCB94195		6/13/2016	2.45		0
10	BTP08653	Bolt, Hex, 1/2-13unc, 6.5", 5, Plt, FT		each	1		
20	BTQ08101	Bolt, Hex, 1/2-20unf, 1.00", 8, Plt		each	4		
30	BTQ08150	Bolt, Hex, 1/2-13unc, 1.5", 8, Plt		each	3		
40	BTQ08200	Bolt, Hex, 1/2-13unc, 2.0", 8, Plt		each	1		
50	BTQ08653	Bolt, Hex, 1/2-13unc, 6.5", 8, Plt		each	1		
60	CSF08076	Capscrew, FH, 1/2-20unf x .75",Alloy,Plt		each	2		
70	NTQ08000	Nut, Hex, 1/2-13unc, 8, Plt		each	7		
80	TRD08120	Threaded, Rod, 1/2-13unc x 12", 5, Plt		each	1		
90	WFQ08000	Washer, Flat, 1/2", 8, Plt		each	10		
100	WLQ08000	Washer, Lock, 1/2", 8, Plt		each	12		

Bill of Materials Listing

TransArctic Canada Inc.

5/2/2019
Page 1 of 1

Product Number		Description	Rev#	Date	Weight	Uof M	Yield
Line	Component Prod#	Description	Bin	Unit	Qty		
KBD84195		Bag Kit, Fasteners,KMD84195	0	6/1/2016	1.59		0
30	BTQ06175	Bolt, Hex, 3/8-16unc, 1.75", 8, Plt		each	5		
35	BTQ06100	Bolt, Hex, 3/8-16unc, 1", 8, Plt		each	2		
40	BTQ08125	Bolt, Hex, 1/2-13unc, 1.25", 8, Plt		each	2		
50	BTQ08151	Bolt, Hex, 1/2-20unf, 1.5", 8, Plt		each	2		
55	CSF08101	Capscrew, FH, 1/2-20unf x 1.0",Alloy,Plt		each	4		
80	NTQ06000	Nut, Hex, 3/8-16unc, 8, Plt		each	7		
110	WFQ08000	Washer, Flat, 1/2", 8, Plt		each	4		
115	WFP06000	Washer, Flat, 3/8", 5, Plt		each	2		
120	WFS06002	Washer, Flat, 3/8", L9, Plt		each	10		
150	WLQ06000	Washer, Lock, 3/8", 8, Plt		each	7		
160	WLQ08000	Washer, Lock, 1/2", 8, Plt		each	4		

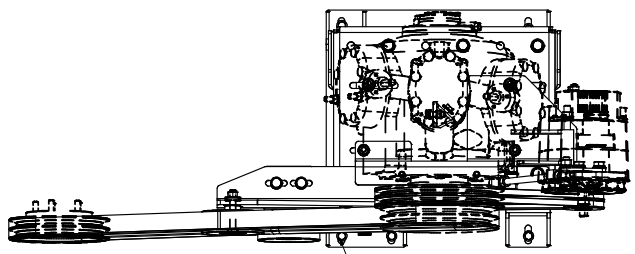

x5 6 12 15 16 18

4

NOTE:
CARRIER COMPRESSOR
PART#: 68PD541-124-xx

x2 18

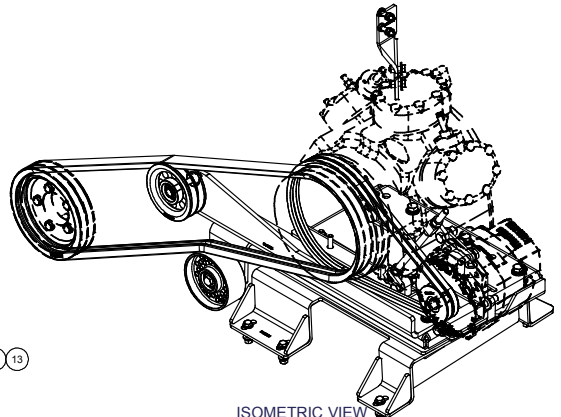

ISOMETRIC VIEW

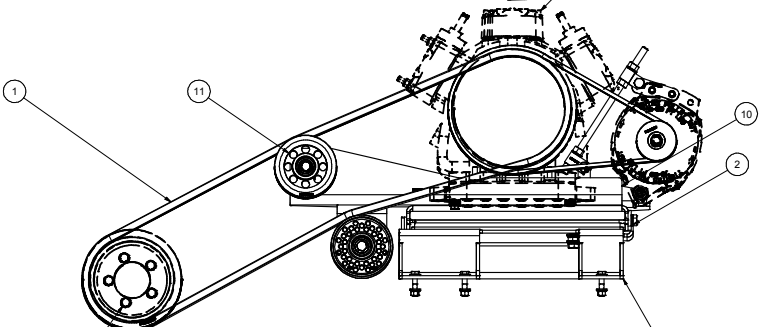

1

11

10

2

NOTE:
TORQUE TO: 48 FT-LB PLAIN & LUBRICATED W/ CLEAN ENGINE OIL (15W-40)
(HEXBOLT CAPSCREW M10 x 1.5 x 50mm)
TIGHTEN IN TWO STEPS IN A CRIS-CROSS TIGHTENING SEQUENCE PATTERN.

3

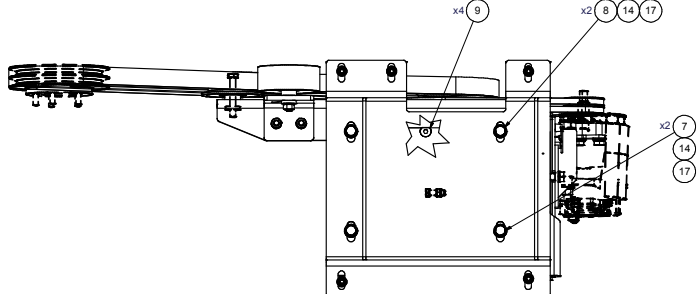

x4 9

x2 8 14 17

x2 7

14

17

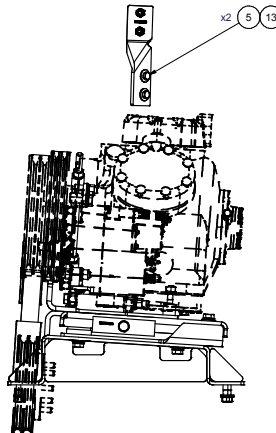

x2 5 13

NOTES:
1) USE SERVICABLE THREADLOCKER ON ALL FASTENERS TO ENGINE COMPONENTS AND TORQUE ALL BOLTS TO S.A.E. SPECIFICATIONS.
2) SEE "TRANSARCIC A/C COMPRESSOR MOUNT INSTALLATION DISCLAIMER".

ITEM	QTY	U/M	PART NUMBER	DESCRIPTION
17	4	EACH	WLQ08000	WASHER, LOCK, 1/2", 8, PLT
16	7	EACH	WLQ06000	WASHER, LOCK, 3/8", 8, PLT
15	10	EACH	WFS06002	WASHER, FLAT, 3/8", L9, PLT
14	4	EACH	WFP08000	WASHER, FLAT, 1/2", 8, PLT
13	2	EACH	WFP06000	WASHER, FLAT, 3/8", 8, PLT
12	7	EACH	NTQ06000	NUT, HEX, 3/8-16UNC, 8, PLT
11	1	EACH	KTTO0005	KIT, 05G, TENSIONER BRACKET ASSY, '19
10	1	EACH	KCB94195	KIT, COMPRESSOR, ALT, 05G, '16
9	4	EACH	CSF08101	CAPSCREW, FH, 1/2-20UNF x 1", ALLOY, PLT
8	2	EACH	BTQ08151	BOLT, HEX, 1/2-20UNF x 1.50, 8, PLT
7	2	EACH	BTQ08125	BOLT, HEX, 1/2-13UNC x 1.25, 8, PLT
6	5	EACH	BTQ06175	BOLT, HEX, 3/8-16UNC, 1.75", 8, PLT
5	2	EACH	BTQ06100	BOLT, HEX, 3/8-16UNC, 1", 8, PLT
4	1	EACH	BMD80003	BKT, HANGER, RESEVOIR, DD8 RE
3	1	EACH	BMC90012	BKT, WELDMT, MAIN BASE, HDX, '16
2	1	EACH	BMC8125	BKT, WELDMT, ADAPTER PL, ISL, HDX, '13
1	1	EACH	BEL32388	BELT, BANDED B GR, 2388mm (94)

DRAWN				BILL OF MATERIALS			
DRAWN		vjakowlew		DATE		4/26/2019	
CHECKED		Jose Rodriguez		DATE		4/26/2019	
BY		James Stewart		DATE		4/26/2019	
APPROVED		Dale Mason		DATE		4/26/2019	
TITLE				TRANSARCITIC INC.			
DESCRIPTION				MT KIT, DETROIT DD8, HDX, 05G, 24V, '19			
DWG NO				KMD84195			
SCALE				1:5			
SHEET				1 OF 1			

REV	ECN	DESCRIPTION	DATE	BY	VAL
0		RELEASED TO PRODUCTION	5/7/2018		

UNSPECIFIED TOLERANCES: HOLE DIM: .0005
ONE DECIMAL PLACE (X1) .01 .0005
TWO DECIMAL PLACE (X10) .001 .0005
THREE DECIMAL PLACE (X100) .0005 .0005
FRACTIONAL: 1/16" .0005 .0005



DRAWING UNIT OF MEASURE: MM (INCH)

REV 0

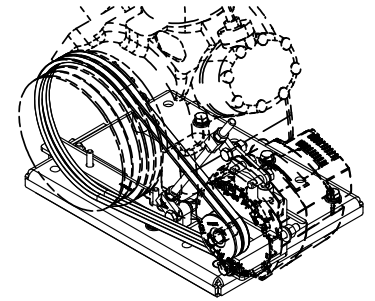
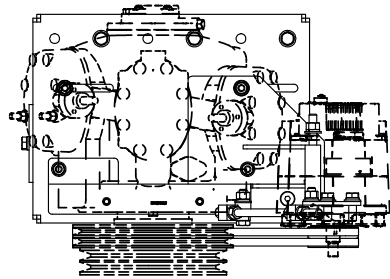
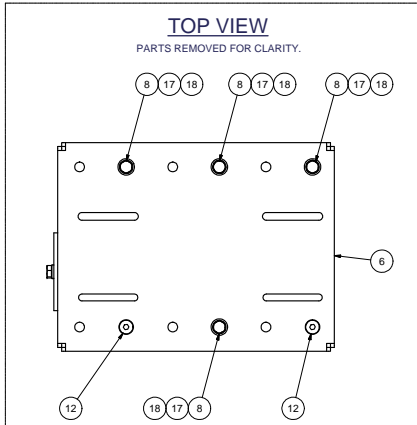

ISOMETRIC VIEW

NOTE:
CARRIER COMPRESSOR
PART#: 68PD541-124-xx

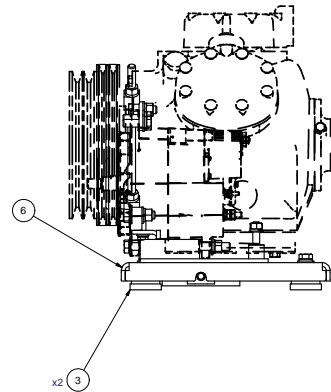
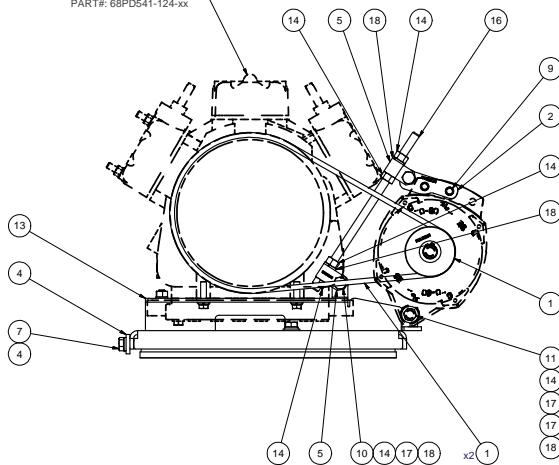

NOTES:

- 1) USE SERVICABLE THREADLOCKER ON ALL FASTENERS TO ENGINE COMPONENTS AND TORQUE **ALL** BOLTS TO S.A.E. SPECIFICATIONS.
- 2) SEE "TRANSARCTIC A/C COMPRESSOR MOUNT INSTALLATION DISCLAIMER".
- 3) WEIGHT: 56.87LBS.

ITEM	QTY	U/M	PART NUMBER	DESCRIPTION
18	12	EACH	WLO08000	WASHER, LOCK, 1/2", 8, PLT
17	10	EACH	WFO08000	WASHER, FLAT, 1/2", 8, PLT
16	1	EACH	TRD08120	THREADED, ROD, 1/2-13UNC x 12", 5 PLT
15	1	EACH	PUL03321	PULLEY, ALT, IDLER, 3.25"o, 2A
14	7	EACH	NT008000	NUT, HEX, 1/2-13UNC, 8, PLT
13	1	EACH	K8194195	KIT, PLATFORM, O5G W/ ALT, '16
12	2	EACH	CSF08076	CAPSCREW, FH, 1/2-20UNF x .75", ALLOY, PLT
11	1	EACH	BTQ08653	BOLT, HEX, 1/2-13UNC x 6.50, 8, PLT
10	1	EACH	BTQ08200	BOLT, HEX, 1/2-13UNC x 2.00, 8, PLT
9	3	EACH	BTQ08150	BOLT, HEX, 1/2-13UNC x 1.50, 8, PLT
8	4	EACH	BTQ08101	BOLT, HEX, 1/2-20UNF x 1.00, 8, PLT
7	1	EACH	BTQ08653	BOLT, HEX, 1/2-13UNC x 6.50, 5, PLT, FT
6	1	EACH	BMZ00043	BKT, MAIN, BASE PL, '13
5	2	EACH	BMT10011	BKT, TENR, BLOCK, OFFSET, 3mm
4	1	EACH	BMN80025	BKT, BACK, PL, SLIDE, IC, RE300
3	2	EACH	BMN80008	VIBRATION ISOLATOR, BAR, 16.50 x 2 x 1.50
2	1	EACH	BMCS3114	BKT, PL, ALT, SPACER, T3RE, '13
1	2	EACH	BELT1138	BELT, A GR, 1138mm (44.8") (17448)

BILL OF MATERIALS
TRANSARCTIC INC.

BROWN	5/30/2016	J Rodriguez	
CHECKED	5/30/2016	Jose Rodriguez	
REV	DESCRIPTION	DATE	BY
0	RELEASED TO PRODUCTION	5/30/2016	JRR
1	APPROVED	5/30/2016	James Stewart
2	APPROVED	5/30/2016	James Stewart
3	APPROVED	5/30/2016	Dale Mason

TITLE	KIT, COMPRESSOR, 24V, O5G, '16		
SIZE	D	DWG NO	KCB94195
SCALE	1:4	SHEET	1 OF 1

UNSPECIFIED TOLERANCES: ALL DIMS
 DIM DECIMAL PLACE (X) .00 (FRACTIONAL) 1/32
 DIM FRACTIONAL PLACE (X) 1/32 (FRACTIONAL) 1/32
 DIM FRACTIONAL PLACE (X) 1/32 (FRACTIONAL) 1/32
 DIM FRACTIONAL PLACE (X) 1/32 (FRACTIONAL) 1/32



DRAWING UNIT OF MEASURE: MM (INCH)

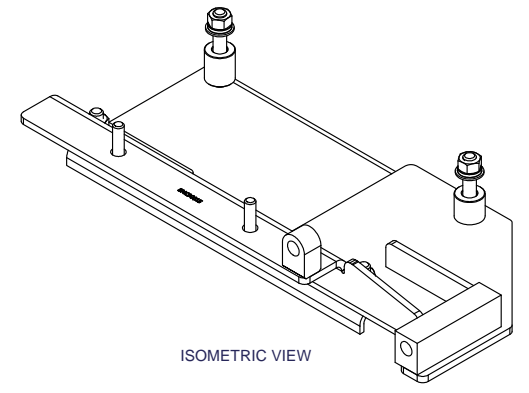
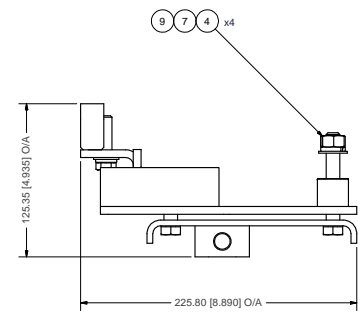
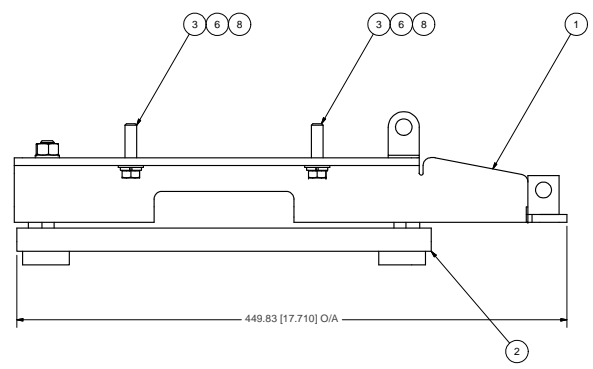
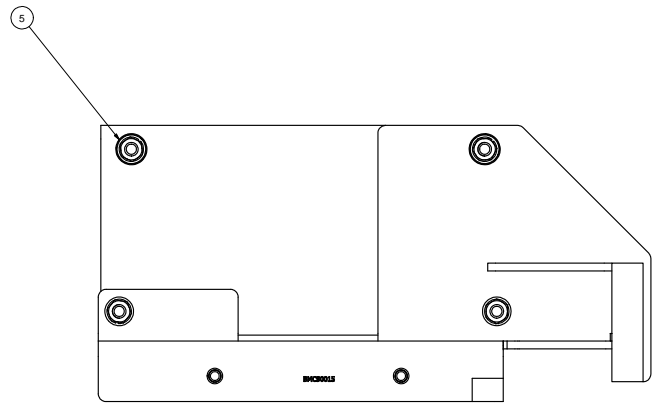

ISOMETRIC VIEW

- NOTES:**
- 1) USE SERVICABLE THREADLOCKER ON ALL FASTENERS TO ENGINE COMPONENTS AND TORQUE **ALL** BOLTS TO S.A.E. SPECIFICATIONS.
 - 2) SEE "TRANSARCTIC A/C COMPRESSOR MOUNT INSTALLATION DISCLAIMER".
 - 3) WEIGHT: 16.25 LBS.

ITEM	QTY	U/M	PART NUMBER	DESCRIPTION
9	4	EACH	WLO07000	WASHER, LOCK, 7/16", 8, PLT
8	2	EACH	WLO06000	WASHER, LOCK, 3/8", 8, PLT
7	4	EACH	WFN07000	WASHER, FLAT, 7/16", 2, PLT
6	2	EACH	WFN06000	WASHER, FLAT, 3/8", 2, PLT
5	1	EACH	SCD29213	SPACER, COL, DRL, 29.21mm x 25.4o x 12.7i
4	4	EACH	NTP07000	NUT, HEX, 7/16-14UNC, 5, PLT
3	2	EACH	BTO06150	BOLT, HEX, 3/8-16UNC, 1.50", 8, PLT
2	1	EACH	BMN00010	BKT, MAIN, SLIDE, ASSY, IC, RE300
1	1	EACH	BMC90015	BKT, WELDMT, ALT EXTENSION, HDX, '16

BILL OF MATERIALS

TRANSARCTIC INC.

DRAWN jrodriguez	5/31/2016	TITLE	
CHECKED Jose Rodriguez	5/31/2016	SIZE	D
REVISION A	RELEASED TO PROTOTYPE 5/31/2016 JRR	SCALE	1:2
DESCRIPTION	DATE	BY	
		GA	
		James Stewart	
		MFG	
		James Stewart	
		APPROVED	
		Date Mason	
		5/31/2016	
UNSPECIFIED TOLERANCES:		DRAWING UNIT OF MEASURE	
ONE DECIMAL PLACE (X.0)	±.05	MM (INCH)	
TWO DECIMAL PLACE (X.00)	±.02	THIRD ANGLE PROJECTION	
THREE DECIMAL PLACE (X.000)	±.010		
FRACTIONAL (1/32")	±.005		
ANGULAR (±.5°)	±.25		

KIT, PLATFORM, O5G W/ ALT, '16

DWG NO
KBT94195

REV
0

SHEET **1** OF **1**

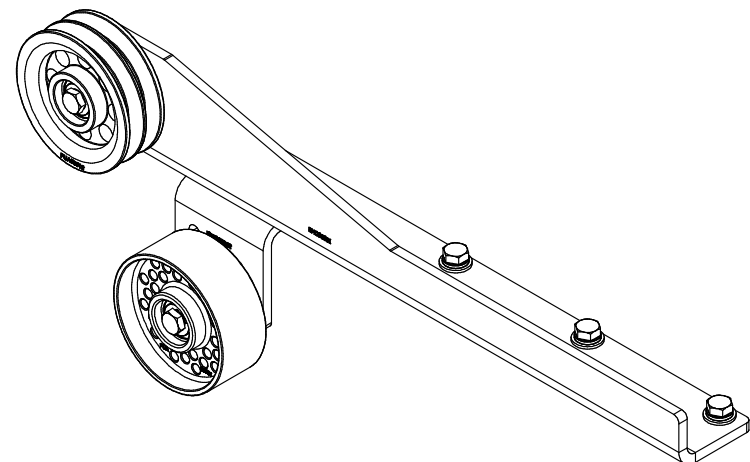
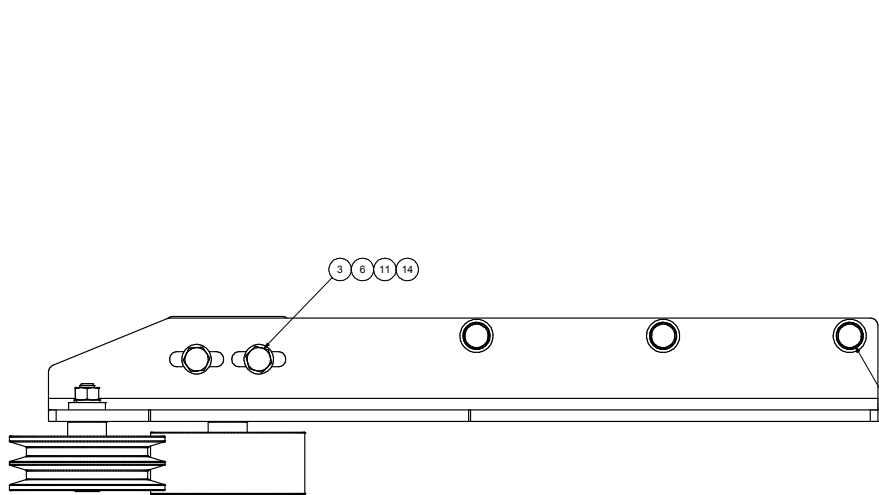

ISOMETRIC VIEW

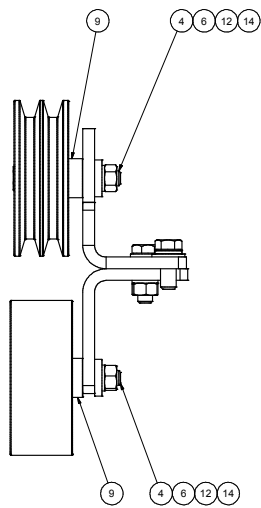
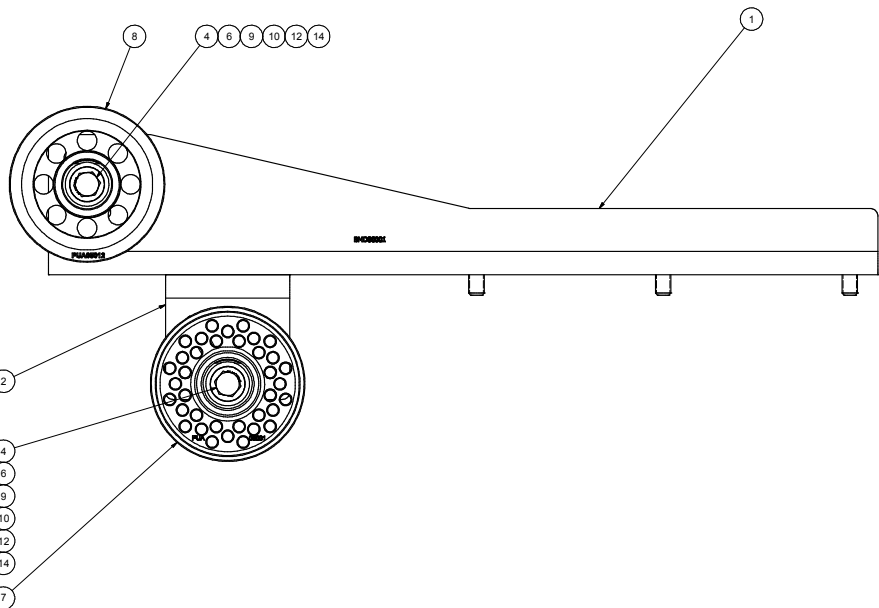

- NOTES:
- 1) USE SERVICABLE THREADLOCKER ON ALL FASTENERS TO ENGINE COMPONENTS AND TORQUE **ALL** BOLTS TO S.A.E. SPECIFICATIONS.
 - 2) SEE "TRANSARCTIC A/C COMPRESSOR MOUNT INSTALLATION DISCLAIMER".

ITEM	QTY	U/M	PART NUMBER	DESCRIPTION
15	3	EACH	WL08000	WASHER, LOCK, 1/2", 8, PLT
14	4	EACH	WLA12000	WASHER, LOCK, 12mm, 8.8, PLT
13	3	EACH	WFP06000	WASHER, FLAT, 3/8", 8, PLT
12	2	EACH	WFA12002	WASHER, FLAT, 12mm, HVY, 8.8, PLT
11	2	EACH	WFA12000	WASHER, FLAT, 12mm, 8.8, PLT
10	2	EACH	SLV17012	SLEEVE, PULLEY, 16.90 x 22.23 mm x12.19l
9	2	EACH	SCD21912	SPACER, COL, DRL, 21.9mm x 31.80 x12.3l
8	1	EACH	PLA05012	PULLEY, ASSY, IDLER, 8/8X gr, 5" STL, PLT
7	1	EACH	PLA05001	PULLEY, ASSY, IDLER, 8/5, 5", STL, PLT
6	4	EACH	NTA12000	NUT, HEX, 12 x 1.75, 8.8, PLT
5	3	EACH	BTQ08126	BOLT, HEX, 1/2-20UNF x 1.25, 8, PLT
4	2	EACH	BTC12080	BOLT, HEX, 12 x 1.75 x 80mm, 10.9, PLT
3	2	EACH	BTC12040	BOLT, HEX, 12 x 1.75 x 40mm, 10.9, PLT
2	1	EACH	BMD80002	BKT, ANGLE, HOR, HDX, DD8
1	1	EACH	BMD80001	BKT, IDLER, F/S-B/S ADD-ON, '19

DRAWN				BILL OF MATERIALS			
DRAWN		vjakowlew		DATE		4/11/2019	
CHECKED		Jose Rodriguez		DATE		4/29/2019	
APPROVED		James Stewart		DATE		4/29/2019	
APPROVED		Dale Mason		DATE		4/29/2019	
TITLE				KIT, 05G, TENSIONER BRACKET ASSY, '19			
DWG NO				KTT00005			
SCALE				1:2			
DRAWING UNIT OF MEASURE				MM (INCH)			
SHEET				1 OF 1			
REV				0			

REV	ECN	DESCRIPTION	DATE	BY
0		RELEASED TO PRODUCTION	5/7/2019	VAL

UNSPECIFIED TOLERANCES: (ALL DIM) FRACTIONAL: 1/32" DECIMAL: .005" ANGLES: .01" THIRD ANGLE PROJECTION



DWG NO: KTT00005
SCALE: 1:2
SHEET: 1 OF 1
REV: 0

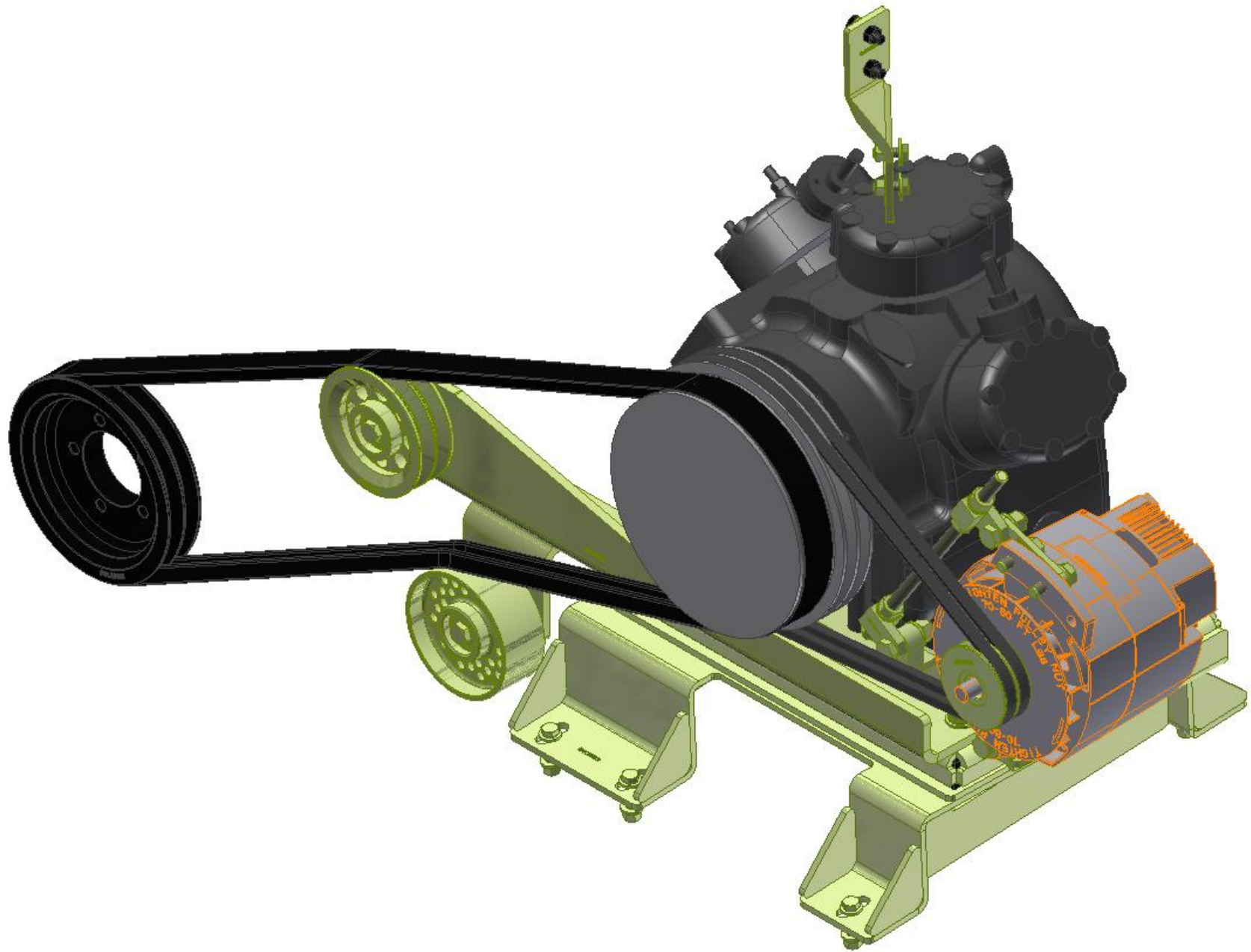

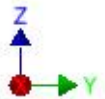
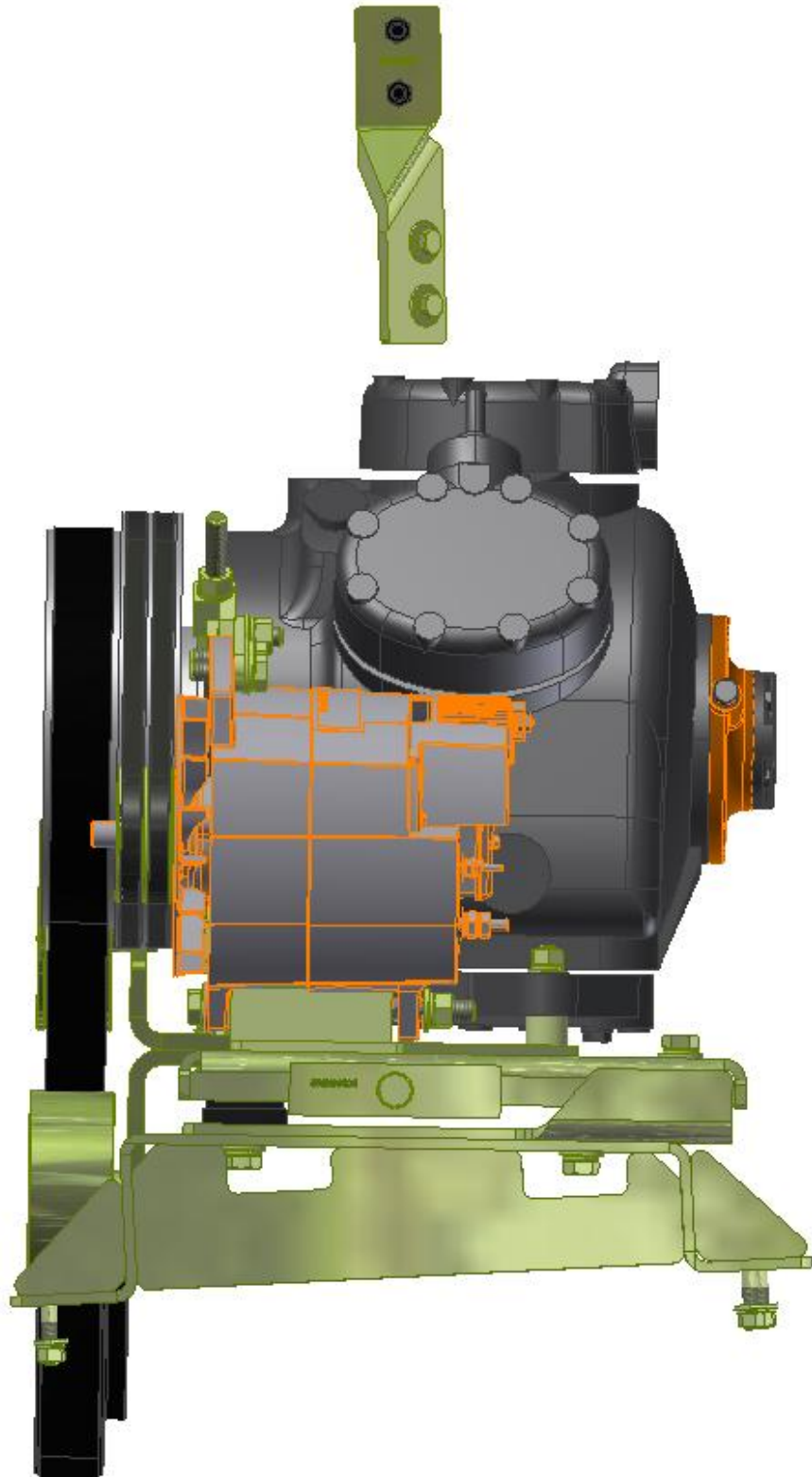

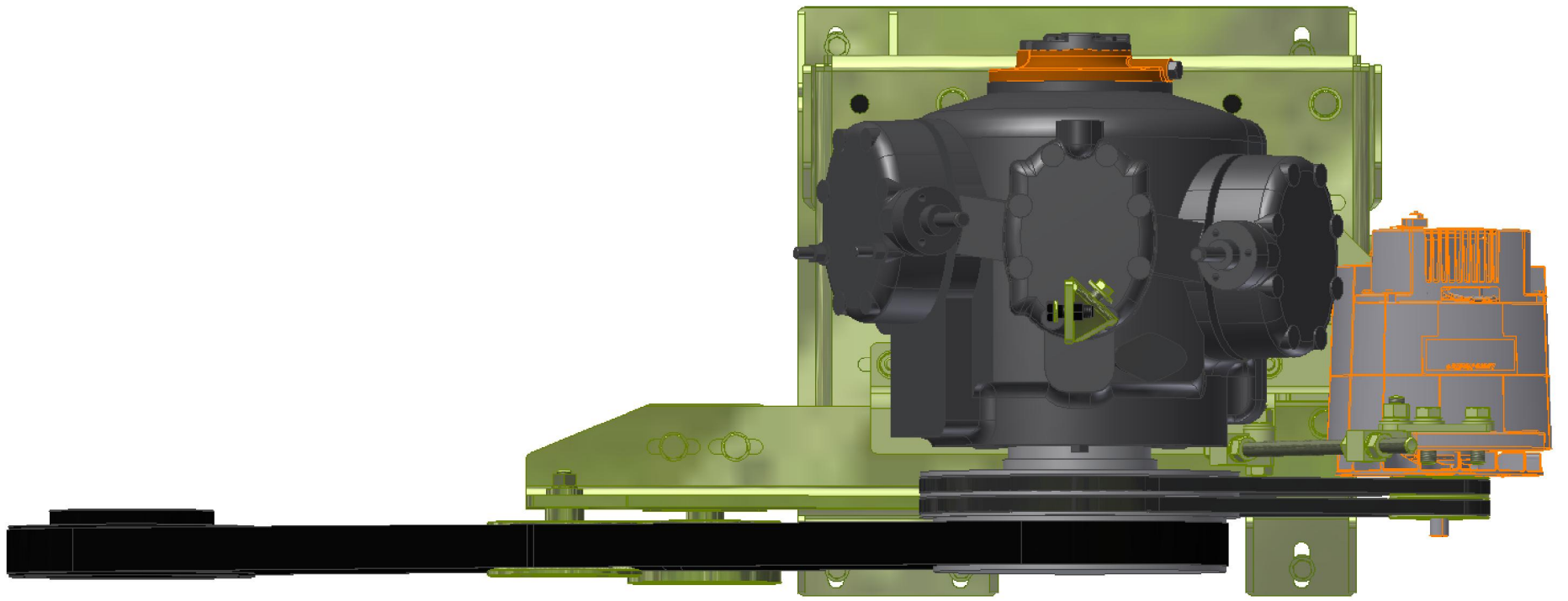

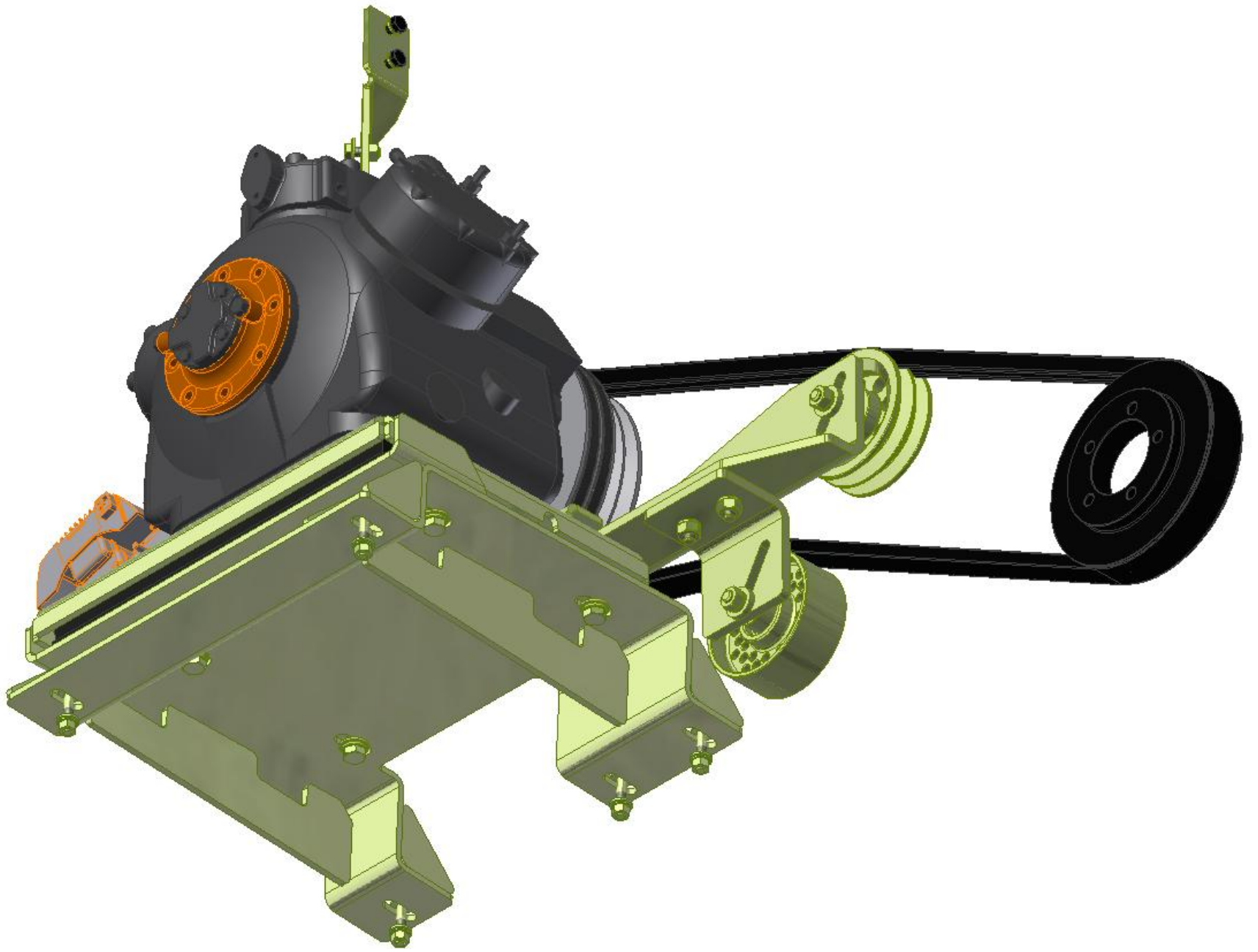

TransArctic A/C Compressor Mount Installation Disclaimer

All compressor mounts should be installed by qualified and trained personnel using proper tools and equipment in safe working conditions following industry standard guidelines for motor vehicle service and repair.

The installer of any compressor mount purchased from TransArctic must undertake all responsibility of issues arising from that compressor bracket being installed on any vehicle. As well as insure that a **proper and sufficient ground** is established between the compressors' clutches and the vehicle's engine. Mount functionality, operation and durability can all be compromised by an incompetent installation.

Due to the many different situations, parameters and application criteria, which are beyond the compressor mount manufacturer's control, TransArctic does not warrant design, durability, or operational functionality of any compressor mount improperly installed by another party.

With no implied guarantees it is the mount installer's strict responsibility to determine safety and functionality, of the compressor mount, at the time of installation.

Please contact TransArctic with any issue arising from installation so we may better improve the product. If you have any reservations about the compressor mount integrity contact TransArctic immediately at 1-877-COLD-AIR.

Mark OEM tensioner location

Install Kit

Check for Interferences

Check to ensure that the proper OEM tensioner orientation is maintained

Run engine with A/C system engaged for at least 10 minutes to run in belt

Check OEM tensioner orientation and adjust as required

Responsabilidad limitada de TransArctic en la instalación del soporte del compresor

Todos los soportes de los compresores deben ser instalados por personas calificadas y entrenadas, usando para ello los equipos y herramientas necesarios para esta labor en buenas condiciones y según las normas y guías para el servicio y/o reparación de motores de vehículos.

El instalador de los soportes comprados en TransArctic asume toda la responsabilidad de cualquier problema que surga en el soporte del compresor al vehículo; de igual manera es responsable que el cable a tierra sea conectado entre el embrague del compresor y el motor del vehículo.

Se advierte que el buen funcionamiento y la durabilidad del soporte pueden ser comprometidos por defectos en su instalación.

Debido a las diversas situaciones que se puedan presentar fuera del control del fabricante, TransArctic no garantiza el diseño, la durabilidad o el correcto funcionamiento de cualquier equipo inapropiadamente instalado por terceros.

Esta sobreentendido que el Instalador del montaje del compresor es estrictamente responsable de la seguridad y funcionamiento del equipo en el momento de la instalación.

Si tuviera algún problema o duda acerca de la instalación del soporte del compresor pongase en contacto inmediatamente con TransArctic al teléfono 1-877-COLD-AIR de modo que podamos mejorar nuestro producto.

Note la ubicación del medidor de tensión OEM

Instale el equipo

Controlar si hay interferencias.

Asegurese que el medidor de tensión mantenga la orientación justa.

Encienda el motor por lo menos 10 minutos con el sistema A/C enganchado para que la correa corra

Controle la orientación justa del medidor de tensión y ajuste a las condiciones requeridas del fabricante