

Bill of Materials Listing

TransArctic Canada Inc.

11/10/2016
Page 1 of 1

Product Number	Description	Date	Weight	Uof M	Yield
Line Component Prod#	Description	Bin Unit	Qty		
KMC92494	Mt Kit, ISL-D 2013, HDX, O5K, 12V, '13		8/26/2013	146.89	0
10	BEL32464		Belt, Banded B gr, 2464mm (97")(Special)	each	2
20	BMC83123		Bkt, Main, Idler, Weldm't, ISL, HDX, '13	each	1
30	BMC83125		Bkt, Weldm't, Adapter Pl, ISL, HDX, '13	each	1
40	BMC83129		Bkt, Weldm't, Main Base, ISL, HDX, '13	each	1
50	KCB92494		Kit, Compressor, 12V,O5K, ISL, '13	each	1
60	KPC89022		Kit, Pulley, ISL, 8.9L, 2B/X,'13	each	1
70	PUA05012		Pulley, Assy, Idler,B/BX gr,5", STL,Plt	each	1
80	PUL80074		Pulley, Idler, B/S, Wide, 76d (89102)	each	1
90	SCD21912		Spacer, Col, Drl,21.9mm x 25.4o x 12.3i	each	1
95	SCD25412		Spacer, Col, Drl,25.4mm x 25.4o x 12.3i	each	1
100	SLV17012		Sleeve, Pulley, 16.9o x 22.23mm x 12.32i	each	2
110	KBC84094		Bag Kit,Fasteners,KMC840/39/4194-9/62494	each	1

Bill of Materials Listing

TransArctic Canada Inc.

7/4/2014
Page 1 of 1

Product Number	Description	Date	Weight	Uof M	Yield
Line Component Prod#	Description	Bin Unit	Qty		
KBC84094	Bag Kit, Fasteners, KMC840/39/4194	9/11/2013	2.12		0
10 BTC10035	Bolt, Hex, 10 x 1.5 x 35mm, 10.9, Plt,FT	each	3		
30 BTC12080	Bolt, Hex, 12 x 1.75 x 80mm, 10.9,Plt,FT	each	2		
40 BTQ06125	Bolt, Hex, 3/8-16unc, 1.25", 8, Plt	each	5		
50 BTQ08125	Bolt, Hex, 1/2-13unc, 1.25", 8, Plt	each	2		
60 BTQ08151	Bolt, Hex, 1/2-20unf, 1.5", 8, Plt	each	2		
70 CSF08101	Capscrew, FH, 1/2-20unf x 1.0",Alloy,Plt	each	4		
80 NTA10000	Nut, Hex, 10 x 1.5, 8.8, Plt	each	3		
90 NTA12000	Nut, Hex, 12 x 1.75, 8.8, Plt	each	2		
100 NTQ06000	Nut, Hex, 3/8-16unc, 8, Plt	each	5		
110 WFA10000	Washer, Flat, 10mm, 8.8, Plt	each	6		
120 WFA12000	Washer, Flat, 12mm, 8.8, Plt	each	2		
130 WFS06002	Washer, Flat, 3/8", L9, Plt	each	10		
140 WFQ08000	Washer, Flat, 1/2", 8, Plt	each	4		
150 WLA10000	Washer, Lock, 10mm, 8.8, Plt	each	3		
160 WLA12000	Washer, Lock, 12mm, 8.8, Plt	each	2		
170 WLQ06000	Washer, Lock, 3/8", 8, Plt	each	5		
180 WLQ08000	Washer, Lock, 1/2", 8, Plt	each	4		

Bill of Materials Listing

TransArctic Canada Inc.

1/13/2015
Page 1 of 1

Product Number	Description	Date	Weight	Uof M	Yield
Line Component Prod#	Description	Bin Unit	Qty		
KCB92494	Kit, Compressor, 12V,O5K, ISL, '13		8/27/2013	53.44	0
10	BMN80008		Vibration Isolator, Bar,16.50 x 2 x 1.50	each	2
20	BMN80025		Bkt, Back, PL, Slide, IC, RE300	each	1
30	BMZ00043		Bkt, Main, Base Pl, '13	each	1
40	KKT82461		Kit, Platform, O5K, '07	each	1
50	KBZ84194		Bag Kit, Fasteners, KCB84194/92494	each	1

Bill of Materials Listing

TransArctic Canada Inc.

1/13/2015
Page 1 of 1

Product Number	Description	Date	Weight	Uof M	Yield
Line Component Prod#	Description	Bin Unit	Qty		
KBZ84194	Bag Kit, Fasteners, KCB84194/92494	10/18/2013	1.06		0
10 BTP08653	Bolt, Hex, 1/2-13unc, 6.5", 5, Plt, FT	each	1		
20 BTQ08101	Bolt, Hex, 1/2-20unf, 1.00", 8, Plt	each	4		
30 CSF08076	Capscrew, FH, 1/2-20unf x .75", Alloy, Plt	each	2		
40 WFQ08000	Washer, Flat, 1/2", 8, Plt	each	4		
50 WLQ08000	Washer, Lock, 1/2", 8, Plt	each	5		

Bill of Materials Listing

TransArctic Canada Inc.

1/13/2015
Page 1 of 1

Product Number	Description	Date	Weight	Uof M	Yield
Line Component Prod# Description	Bin	Unit	Qty		
KKT82461	Kit, Platform, O5K, '07	10/19/2007	13.98		0
10 BMN80031	Bkt, Main, Slide, Assy, 05K, IC, RE300	each	1		
20 BMN80032	Bkt, Adapter, PL, IC, RE300	each	1		
30 CSF08100	Capscrew, FH, 1/2-13 x 1", Alloy, Plt	each	4		
40 NTP07000	Nut, Hex, 7/16-14unc, 5, Plt	each	4		
50 WFN07000	Washer, Flat, 7/16", 2, Plt	each	4		
60 WLP07000	Washer, Lock, 7/16", 5, Plt	each	4		

Bill of Materials Listing

TransArctic Canada Inc.

10/28/2013

Page 1 of 1

Product Number		Description	Bin	Date	Weight	Uof M	Yield
Line	Component Prod#	Description		Unit	Qty		
KPC89022		Kit, Pulley, ISL, 8.9L, 2B/X,'13		10/15/2013	11.51		0
10	PUL89022	Pulley, Crank, ISL, 8.9L, 2B/X, 8", '13		each	1		
20	BTC10050	Bolt, Hex, 10 x 1.5 x 50mm, 10.9, Plt		each	5		
30	WFA10000	Washer, Flat, 10mm, 8.8, Plt		each	5		

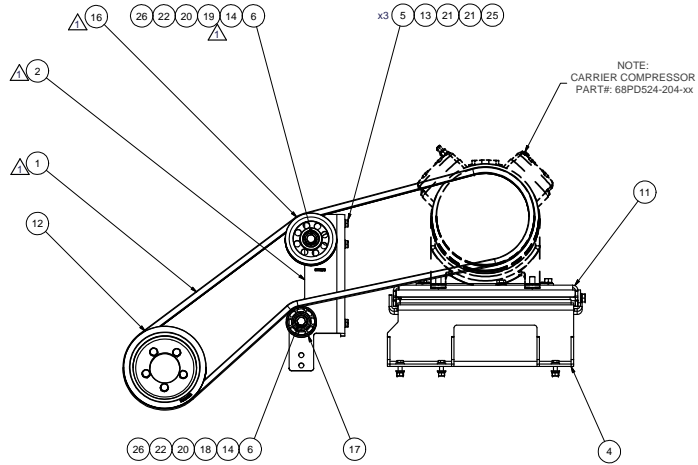
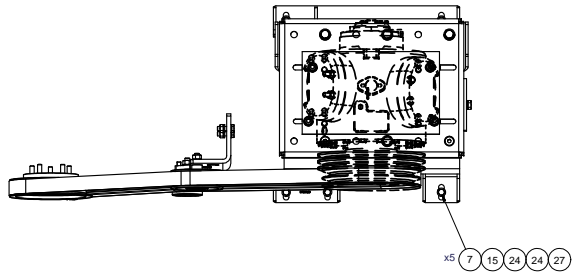

NOTE:
CARRIER COMPRESSOR
PART#: 68PD524-204-xx

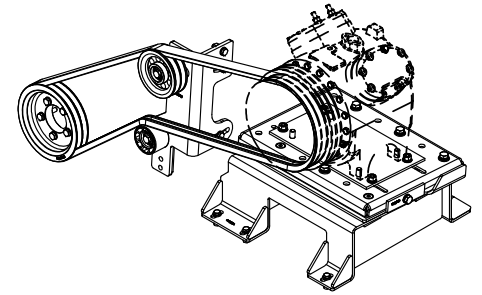

ISOMETRIC VIEW

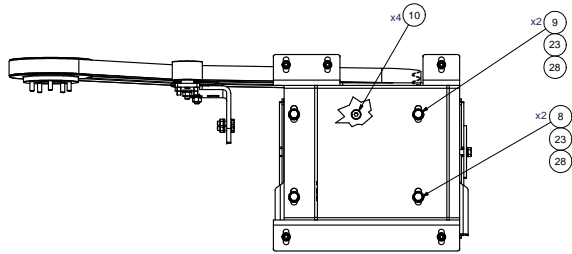
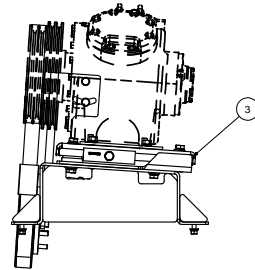

NOTES:
1) USE SERVICABLE THREADLOCKER ON ALL FASTENERS TO ENGINE COMPONENTS AND TORQUE ALL BOLTS TO S.A.E. SPECIFICATIONS.
2) SEE 'TRANSARCTIC A/C COMPRESSOR MOUNT INSTALLATION DISCLAIMER'.

ITEM	QTY	U/M	PART NUMBER	DESCRIPTION
28	4	EACH	WLO08000	WASHER, LOCK, 1/2", 8, PLT
27	5	EACH	WLO06000	WASHER, LOCK, 3/8", 8, PLT
26	2	EACH	WLA12000	WASHER, LOCK, 12mm, 8.8, PLT
25	3	EACH	WLA10000	WASHER, LOCK, 10mm, 8.8, PLT
24	10	EACH	WFS06002	WASHER, FLAT, 3/8", L9, PLT
23	4	EACH	WFO08000	WASHER, FLAT, 1/2", 8, PLT
22	2	EACH	WFA12000	WASHER, FLAT, 12mm, 8.8, PLT
21	6	EACH	WFA10000	WASHER, FLAT, 10mm, 8.8, PLT
20	2	EACH	SLV17012	SLEEVE, PULLEY, 16.90 x 22.23 mm x12.19f
19	1	EACH	SCD25412	SPACER, COL, DRL, 25.4mm x 25.40 x 12.3f
18	1	EACH	SCD21912	SPACER, COL, DRL, 21.9mm x 31.80 x 12.3f
17	1	EACH	PUL80074	PULLEY, IDLER, BACKSIDE, P8, 74D, 46.27W
16	1	EACH	PUA05012	PULLEY, ASSY, IDLER, B/BX gr, 5" STL, PLT
15	5	EACH	NTQ06000	NUT, HEX, 3/8-16UNC, 8, PLT
14	2	EACH	NTA12000	NUT, HEX, 12 x 1.75, 8.8, PLT
13	3	EACH	NTA10000	NUT, HEX, 10 x 1.5, 8.8, PLT
12	1	EACH	KPC89022	KIT, PULLEY, ISL, 8.9L, 2B/X, '13
11	1	EACH	KCB92494	KIT, COMPRESSOR, 12V, O5K, ISL, '13
10	4	EACH	CSF08101	CAPSCREW, FH, 1/2-20UNF x 1", ALLOY, PLT
9	2	EACH	BTQ08151	BOLT, HEX, 1/2-20UNF x 1.50, 8, PLT
8	2	EACH	BTQ08125	BOLT, HEX, 1/2-13UNC x 1.25, 8, PLT
7	5	EACH	BTQ06125	BOLT, HEX, 3/8-16UNC x 1.25, 8, PLT
6	2	EACH	BTC12080	BOLT, HEX, 12 x 1.75 x 80mm, 10.9, PLT
5	3	EACH	BTC10035	BOLT, HEX, 10 x 1.5 x 35mm, 10.9, PLT
4	1	EACH	BMC83129	BKT, WELDMT, MAIN BASE, ISL, HDX, '13
3	1	EACH	BMC83125	BKT, WELDMT, ADAPTER PL, ISL, HDX, '13
2	1	EACH	BMC83123	BKT, MAIN, IDLER, WELDMT, ISL, HDX, '13
1	1	EACH	BEL32464	BELT, BANDED B gr, 2464mm (97")

TRANSARCTIC INC.

DRAWN: jrodriquez		1/12/2015	TITLE
CHECKED: James Stewart		1/12/2015	
RELEASED TO PRODUCTION: James Stewart		1/12/2015	MT KIT, ISL-D 2013, HDX, O5K, 12V, '13
REVISION: DESCRIPTION: DATE: BY: Ron Ingram		1/12/2015	
APPROVED: Dale Mason		1/12/2015	SIZE: D
UNSPECIFIED TOLERANCES: H4.1 4M4		THIRD ANGLE PROJECTION	DWG NO: KMC92494
ONE DECIMAL PLACE (X1) .1		DRAWING UNIT OF MEASURE: MM (INCH)	REV: 1
TWO DECIMAL PLACE (X2) .05		SCALE: 1:1	SHEET 1 OF 1
THREE DECIMAL PLACE (X3) .02			
FOUR DECIMAL PLACE (X4) .01			

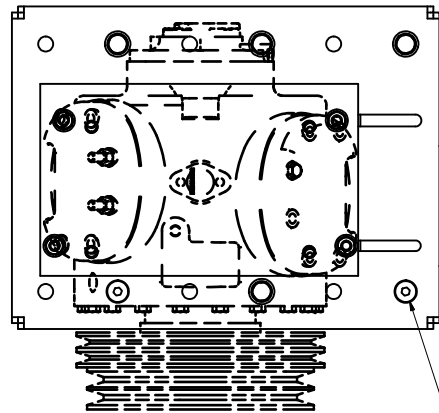

x2 6

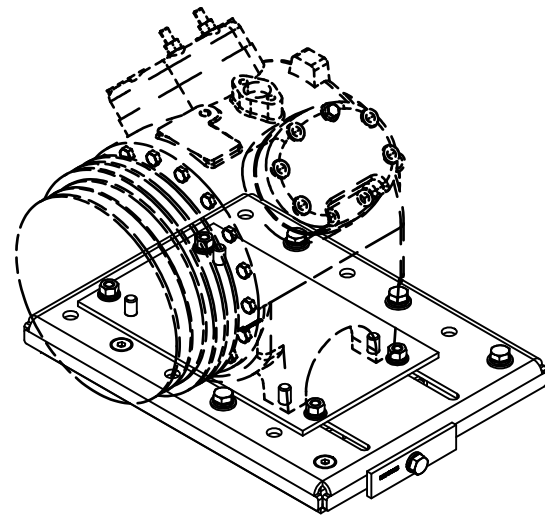

ISOMETRIC VIEW

NOTE:
CARRIER COMPRESSOR
PART#: 68PD524-204-xx

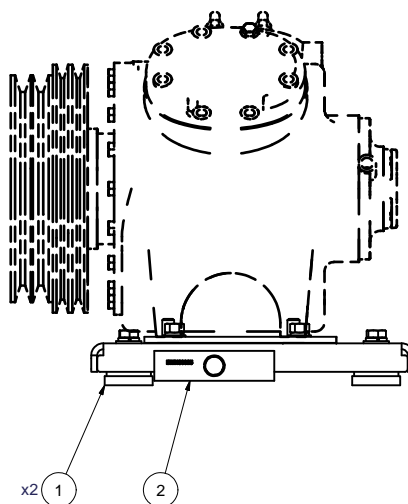
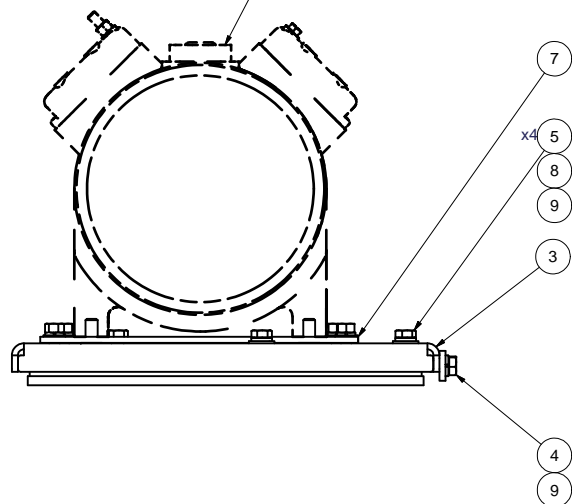

NOTES:

- 1) USE SERVICABLE THREADLOCKER ON ALL FASTENERS TO ENGINE COMPONENTS AND TORQUE **ALL** BOLTS TO S.A.E. SPECIFICATIONS.
- 2) SEE "TRANSARCTIC A/C COMPRESSOR MOUNT INSTALLATION DISCLAIMER".
- 3) WEIGHT: 49.71 LBS.

ITEM	QTY	U/M	PART NUMBER	DESCRIPTION
9	5	EACH	WLQ08000	WASHER, LOCK, 1/2", 8, PLT
8	4	EACH	WFO08000	WASHER, FLAT, 1/2", 8, PLT
7	1	EACH	KKT82461	MT KIT, TRANSIT, O5K, '07
6	2	EACH	CSF08076	CAPSCREW, FH, 1/2-20UNF x.75" ALLOY, PLT
5	4	EACH	BTQ08101	BOLT, HEX, 1/2-20UNF x 1.00, 8, PLT
4	1	EACH	BTP08653	BOLT, HEX, 1/2-13UNC x 6.50, 5, PLT, FT
3	1	EACH	BMZ00043	BKT, MAIN, BASE PL, '13
2	1	EACH	BMN80025	BKT, BACK, PL, SLIDE, IC, RE300
1	2	EACH	BMN80008	VIBRATION ISOLATOR, BAR, 16.50 x 2 x 1.50

BILL OF MATERIALS

DRAWN	jrodriguez	1/8/2015	TRANSARCTIC INC.
CHECKED	Val Jakowlew	1/8/2015	
APPROVED	James Stewart	1/8/2015	
MFG	Ron Ingram	1/8/2015	
APPROVED	Dale Mason	1/8/2015	TITLE
			KIT, COMPRESSOR, 12V, O5K, ISL, '13
SIZE	C	DWG NO	REV
		KCB92494	0
DRAWING UNIT OF MEASURE:	MM [INCH]	SCALE	1:4
		SHEET	1 OF 1

0	RELEASED TO PRODUCTION.	1/8/2015	JRR										
REV	ECN	DESCRIPTION	DATE										
<p>THIS DRAWING CONTAINS PROPRIETARY CONFIDENTIAL INFORMATION OWNED BY TRANSARCTIC CANADA INC. THE DOCUMENT AND THE INFORMATION IN IT ARE NOT TO BE USED, DISCLOSED OR REPRODUCED WITHOUT EXPRESS WRITTEN PERMISSION OF THE COMPANY.</p>													
<p>UNSPECIFIED TOLERANCES: [ALT. DIM.]</p> <table border="1"> <tr> <td>MM</td> <td>[INCH]</td> </tr> <tr> <td>ONE DECIMAL PLACE (.X)</td> <td>.50 (.020)</td> </tr> <tr> <td>TWO DECIMAL PLACE (.XX)</td> <td>.25 (.010)</td> </tr> <tr> <td>THREE DECIMAL PLACE (.XXX)</td> <td>.10 (.005)</td> </tr> <tr> <td>FRACTIONAL +/- 1/32"</td> <td>ANGULAR +/- .50°</td> </tr> </table>				MM	[INCH]	ONE DECIMAL PLACE (.X)	.50 (.020)	TWO DECIMAL PLACE (.XX)	.25 (.010)	THREE DECIMAL PLACE (.XXX)	.10 (.005)	FRACTIONAL +/- 1/32"	ANGULAR +/- .50°
MM	[INCH]												
ONE DECIMAL PLACE (.X)	.50 (.020)												
TWO DECIMAL PLACE (.XX)	.25 (.010)												
THREE DECIMAL PLACE (.XXX)	.10 (.005)												
FRACTIONAL +/- 1/32"	ANGULAR +/- .50°												
		THIRD ANGLE PROJECTION											

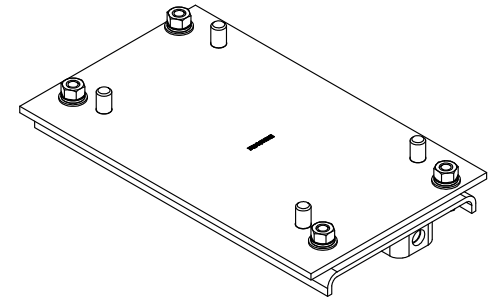
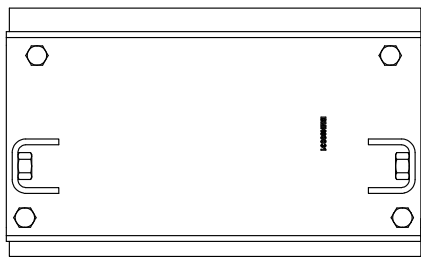
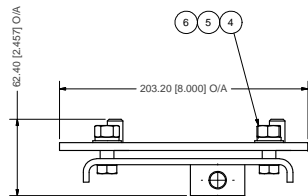
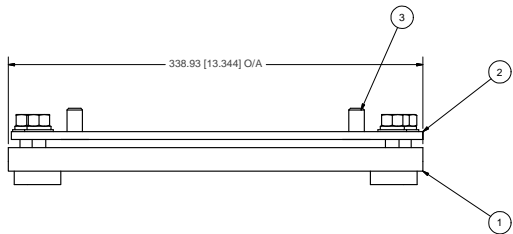
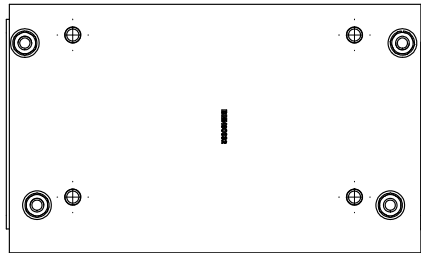

ISOMETRIC VIEW

NOTES:

- 1) USE SERVICABLE THREADLOCKER ON ALL FASTENERS TO ENGINE COMPONENTS AND TORQUE **ALL** BOLTS TO S.A.E. SPECIFICATIONS.
- 2) SEE 'TRANSARCTIC A/C COMPRESSOR MOUNT INSTALLATION DISCLAIMER'.
- 3) WEIGHT: 13.96 LBS.

ITEM	QTY	U/M	PART NUMBER	DESCRIPTION
5	4	EACH	WPN07000	WASHER, FLAT, 7/16", 2, PLT
6	4	EACH	WLP07000	WASHER, LOCK, 7/16", 5, PLT
4	4	EACH	NTP07000	NUT, HEX, 7/16-14UNC, 5, PLT
3	4	EACH	CSF08100	CAPSCREW, FH, 3/8-16 x 1", 9, PLT
2	1	EACH	BMN80032	BKT, ADAPTER, PL, IC, RE300
1	1	EACH	BMN80031	BKT, MAIN, SLIDE, ASSY, 05K, IC, RE300

BILL OF MATERIALS

<table border="1"> <tr> <td>UNSPECIFIED TOLERANCES:</td> <td>PLT DIM (MM)</td> <td>FRONT</td> </tr> <tr> <td>ONE DECIMAL PLACE (X0)</td> <td>30</td> <td>FRONT</td> </tr> <tr> <td>TWO DECIMAL PLACE (X00)</td> <td>30</td> <td>FRONT</td> </tr> <tr> <td>THREE DECIMAL PLACE (X000)</td> <td>30</td> <td>FRONT</td> </tr> <tr> <td>FRACTIONAL (X1/32)</td> <td>30</td> <td>FRONT</td> </tr> <tr> <td>ANGULAR</td> <td>1/2</td> <td>FRONT</td> </tr> </table>	UNSPECIFIED TOLERANCES:	PLT DIM (MM)	FRONT	ONE DECIMAL PLACE (X0)	30	FRONT	TWO DECIMAL PLACE (X00)	30	FRONT	THREE DECIMAL PLACE (X000)	30	FRONT	FRACTIONAL (X1/32)	30	FRONT	ANGULAR	1/2	FRONT		<table border="1"> <tr> <td>DRAWN</td> <td>vjakowlew</td> <td>10/20/2008</td> <td>TITLE</td> </tr> <tr> <td>CHECKED</td> <td>vjakowlew</td> <td>10/20/2008</td> <td></td> </tr> <tr> <td>REVISION</td> <td>RELEASED TO PRODUCTION</td> <td>10/20/2008</td> <td>JRR</td> </tr> <tr> <td></td> <td>DATE:</td> <td>BY:</td> <td></td> </tr> <tr> <td></td> <td>James Stewart</td> <td>10/20/2008</td> <td></td> </tr> <tr> <td></td> <td>Ron Ingram</td> <td>10/20/2008</td> <td></td> </tr> <tr> <td></td> <td>Date Mason</td> <td>10/20/2008</td> <td></td> </tr> </table>	DRAWN	vjakowlew	10/20/2008	TITLE	CHECKED	vjakowlew	10/20/2008		REVISION	RELEASED TO PRODUCTION	10/20/2008	JRR		DATE:	BY:			James Stewart	10/20/2008			Ron Ingram	10/20/2008			Date Mason	10/20/2008		<p>TRANSARCTIC INC.</p> <p>MT KIT, TRANSIT, 05K, '07</p> <p>DWG NO KKT82461</p> <p>REV 0</p>
UNSPECIFIED TOLERANCES:	PLT DIM (MM)	FRONT																																															
ONE DECIMAL PLACE (X0)	30	FRONT																																															
TWO DECIMAL PLACE (X00)	30	FRONT																																															
THREE DECIMAL PLACE (X000)	30	FRONT																																															
FRACTIONAL (X1/32)	30	FRONT																																															
ANGULAR	1/2	FRONT																																															
DRAWN	vjakowlew	10/20/2008	TITLE																																														
CHECKED	vjakowlew	10/20/2008																																															
REVISION	RELEASED TO PRODUCTION	10/20/2008	JRR																																														
	DATE:	BY:																																															
	James Stewart	10/20/2008																																															
	Ron Ingram	10/20/2008																																															
	Date Mason	10/20/2008																																															
<p>THIS DRAWING CONTAINS PROPRIETARY CONFIDENTIAL INFORMATION OWNED BY TRANSARCTIC CANADA INC. THE DOCUMENT AND THE INFORMATION IN IT ARE NOT TO BE USED, DISCLOSED OR REPRODUCED WITHOUT EXPRESS WRITTEN PERMISSION OF THE COMPANY.</p>		<p>DRAWING UNIT OF MEASURE: MM (INCH)</p> <p>SCALE: 1:2</p>	<p>SHEET 1 OF 1</p>																																														

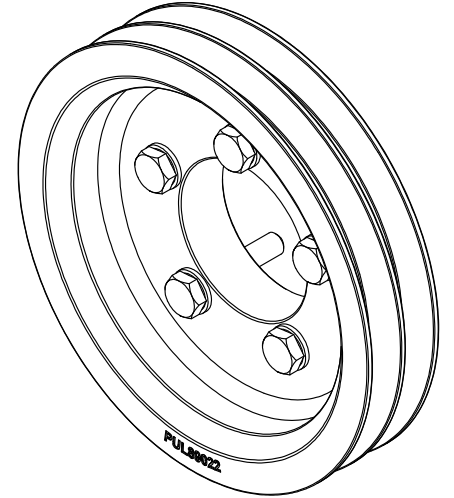
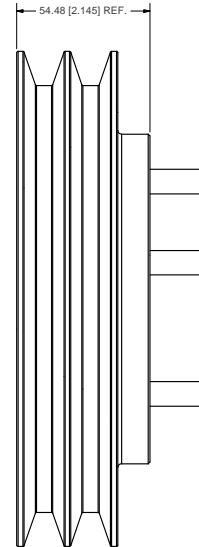
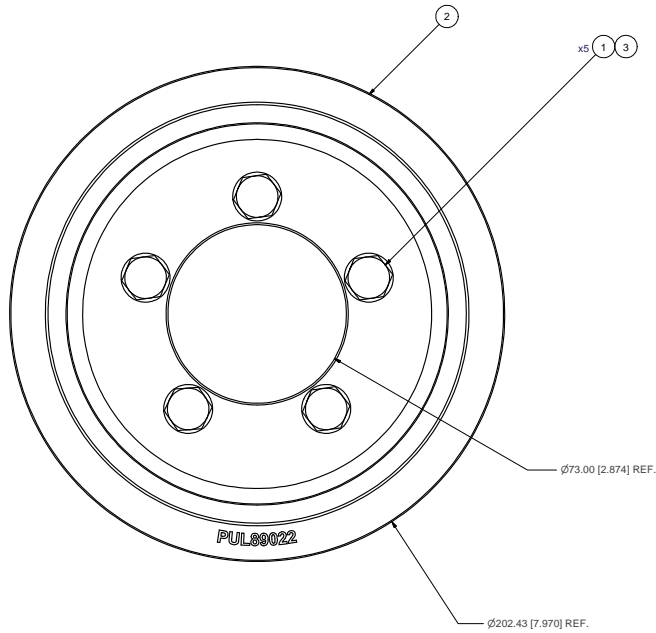
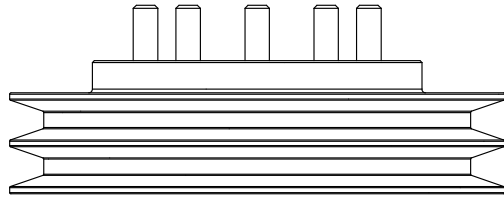

ISOMETRIC VIEW

- NOTES:**
- 1) USE SERVICABLE THREADLOCKER ON ALL FASTENERS TO ENGINE COMPONENTS AND TORQUE ALL BOLTS TO S.A.E. SPECIFICATIONS.
 - 2) SEE "TRANSARCTIC A/C COMPRESSOR MOUNT INSTALLATION DISCLAIMER".
 - 3) WT:≈ 11.56 LBS

ITEM	QTY	U/M	PART NUMBER	DESCRIPTION
3	5	EACH	WFA10000	WASHER, FLAT, 10mm, 8.8, PLT
2	1	EACH	PUL89022	PULLEY, CRANK, ISL, 8.9L, 2B/X, 8", '13
1	5	EACH	BTCT0050	BOLT, HEX, 10 x 1.5 x 50mm, 10.9, PLT

TRANSARCTIC INC.

UNSPECIFIED TOLERANCES:	MM (INCH)
ONE DECIMAL PLACE (X.0)	±0.10 (±0.004)
TWO DECIMAL PLACE (X.00)	±0.02 (±0.0008)
THREE DECIMAL PLACE (X.000)	±0.002 (±0.00008)
FRACTIONAL (1/16")	±0.005 (±0.0002)

REV	DATE	BY	DESCRIPTION
0	10/15/2013	JRB	RELEASED TO PRODUCTION
1	10/15/2013	James Stewart	REVISION
2	10/15/2013	Ron Ingram	APPROVED
3	10/15/2013	Dale Mason	APPROVED

KIT, PULLEY, ISL, 8.9L, 2B/X, '13

SCALE: 1:1

DWG NO: KPC89022

REV: 0

SHEET 1 OF 1

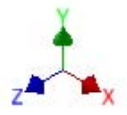
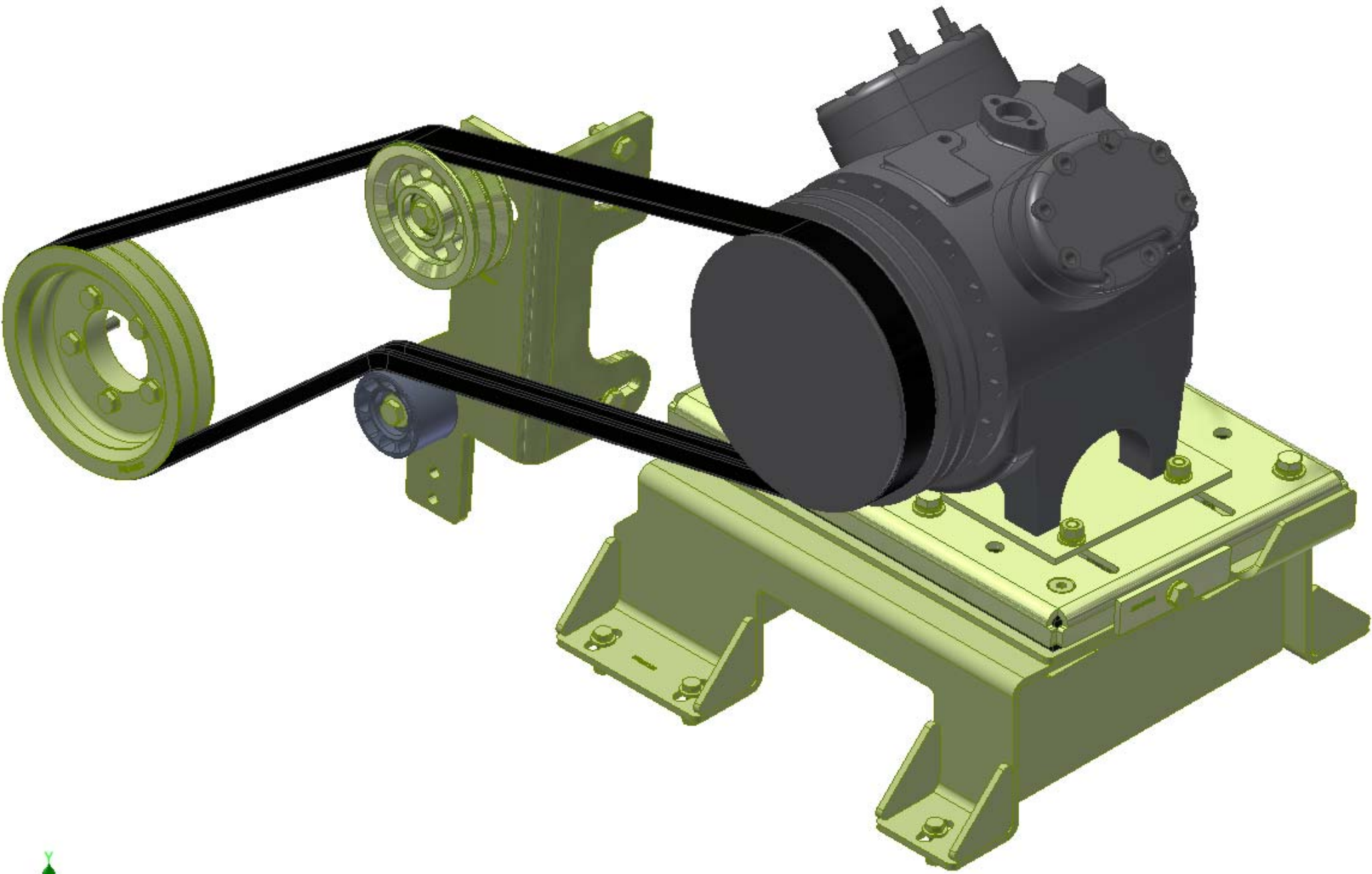

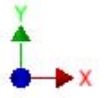
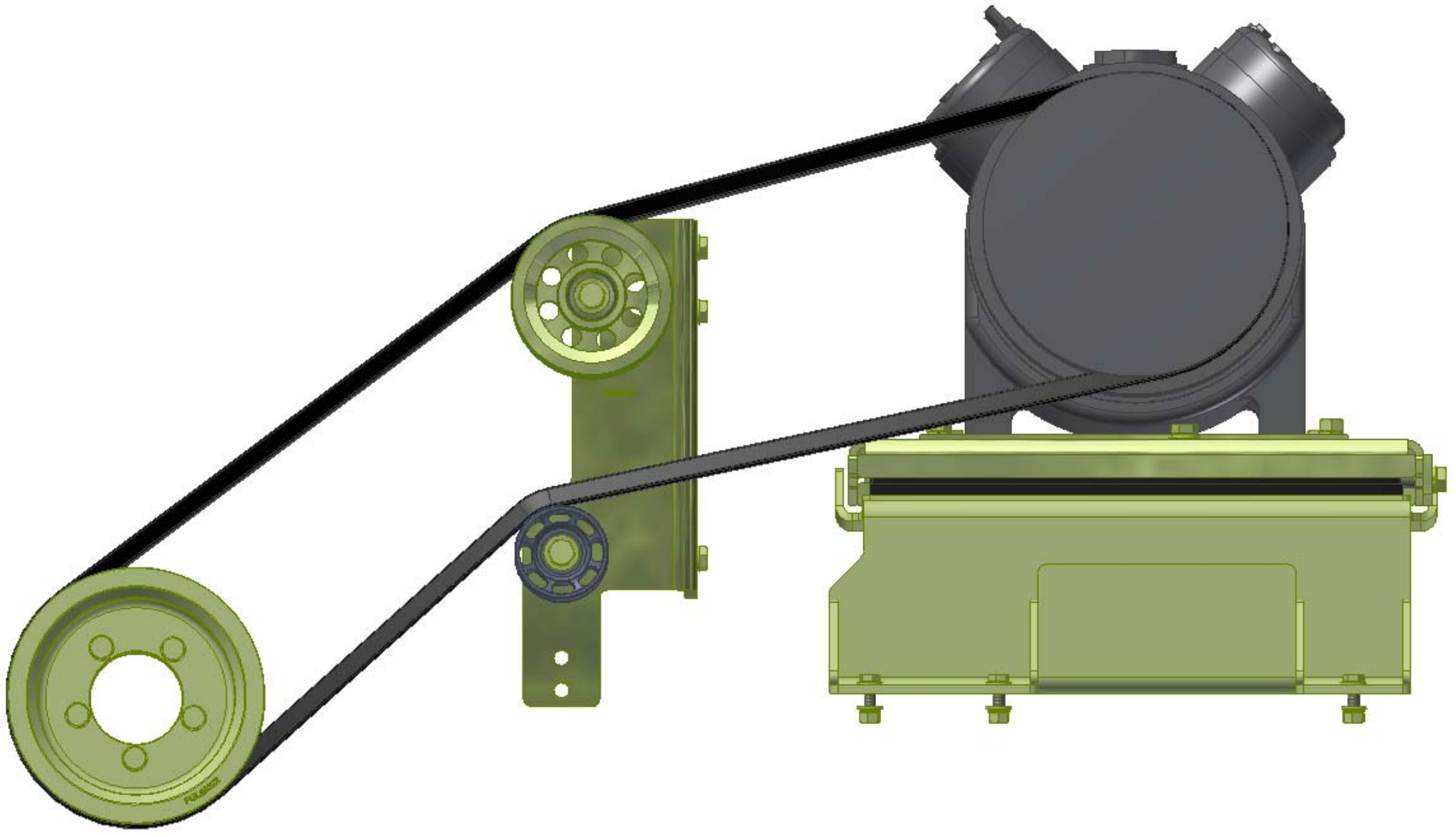

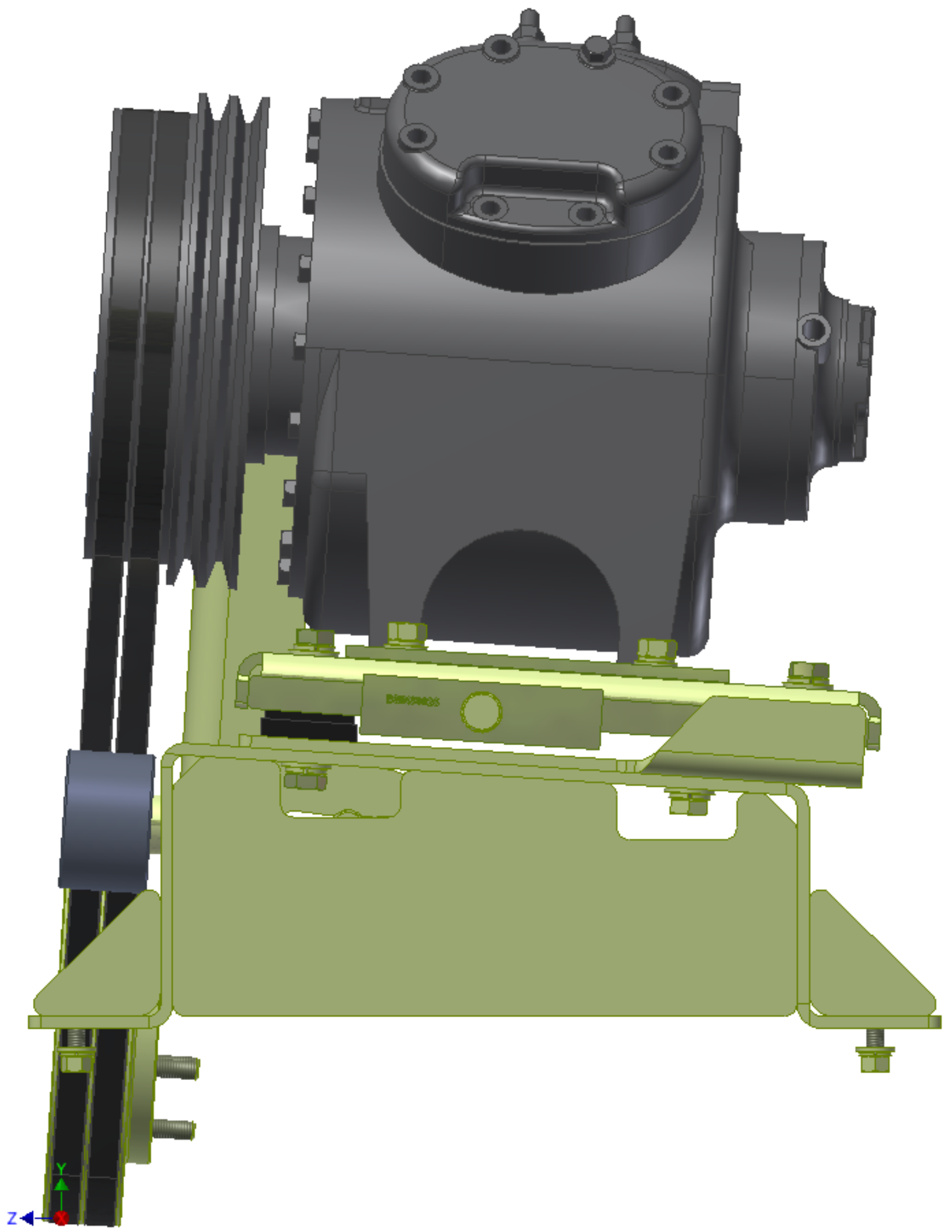

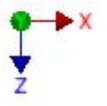
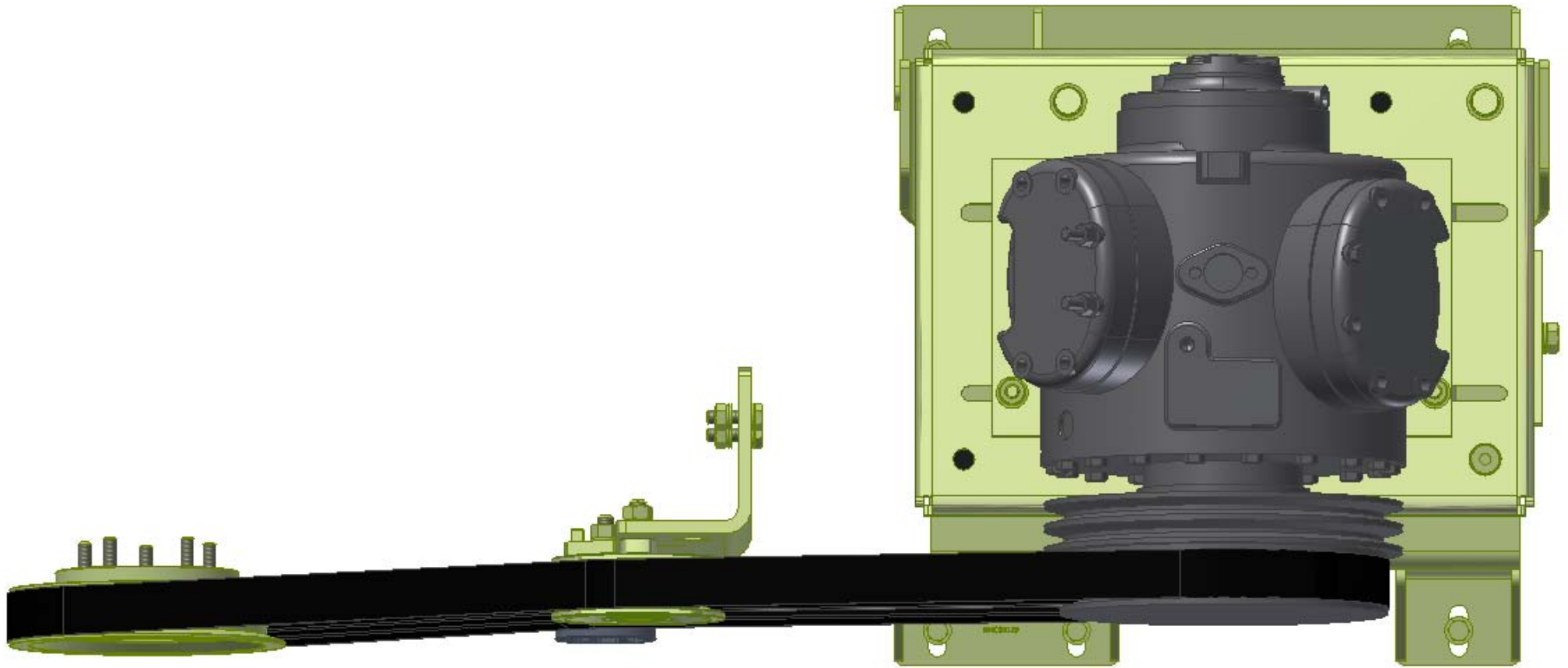

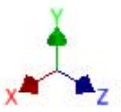
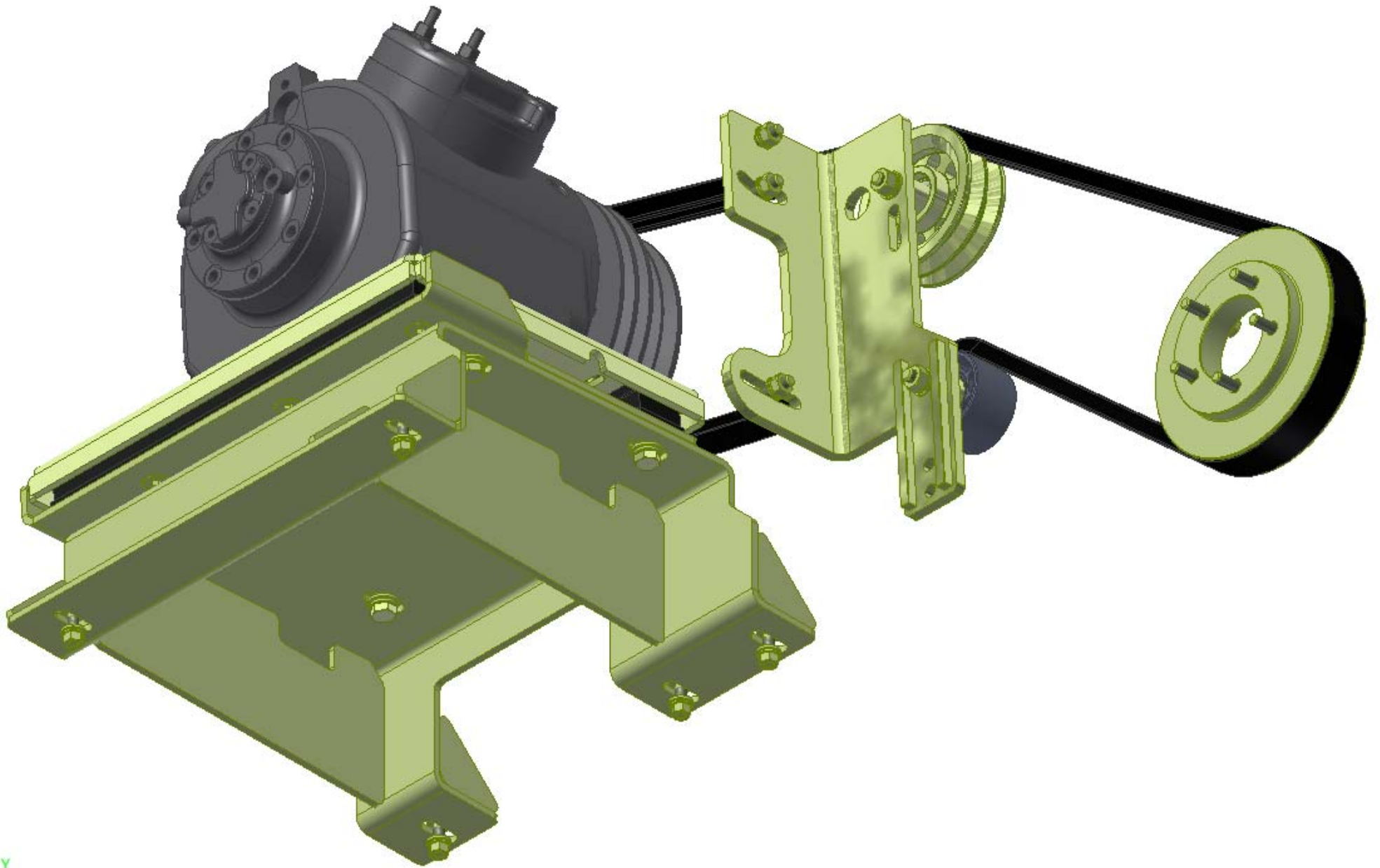

TransArctic A/C Compressor Mount Installation Disclaimer

All compressor mounts should be installed by qualified and trained personnel using proper tools and equipment in safe working conditions following industry standard guidelines for motor vehicle service and repair.

The installer of any compressor mount purchased from TransArctic must undertake all responsibility of issues arising from that compressor bracket being installed on any vehicle. As well as insure that a **proper and sufficient ground** is established between the compressors' clutches and the vehicle's engine. Mount functionality, operation and durability can all be compromised by an incompetent installation.

Due to the many different situations, parameters and application criteria, which are beyond the compressor mount manufacturer's control, TransArctic does not warrant design, durability, or operational functionality of any compressor mount improperly installed by another party.

With no implied guarantees it is the mount installer's strict responsibility to determine safety and functionality, of the compressor mount, at the time of installation.

Please contact TransArctic with any issue arising from installation so we may better improve the product. If you have any reservations about the compressor mount integrity contact TransArctic immediately at 1-877-COLD-AIR.

Mark OEM tensioner location

Install Kit

Check for Interferences

Check to ensure that the proper OEM tensioner orientation is maintained

Run engine with A/C system engaged for at least 10 minutes to run in belt

Check OEM tensioner orientation and adjust as required

Responsabilidad limitada de TransArctic en la instalación del soporte del compresor

Todos los soportes de los compresores deben ser instalados por personas calificadas y entrenadas, usando para ello los equipos y herramientas necesarios para esta labor en buenas condiciones y según las normas y guías para el servicio y/o reparación de motores de vehículos.

El instalador de los soportes comprados en TransArctic asume toda la responsabilidad de cualquier problema que surga en el soporte del compresor al vehículo; de igual manera es responsable que el cable a tierra sea conectado entre el embrague del compresor y el motor del vehículo.

Se advierte que el buen funcionamiento y la durabilidad del soporte pueden ser comprometidos por defectos en su instalación.

Debido a las diversas situaciones que se puedan presentar fuera del control del fabricante, TransArctic no garantiza el diseño, la durabilidad o el correcto funcionamiento de cualquier equipo inapropiadamente instalado por terceros.

Esta sobreentendido que el Instalador del montaje del compresor es estrictamente responsable de la seguridad y funcionamiento del equipo en el momento de la instalación.

Si tuviera algún problema o duda acerca de la instalación del soporte del compresor pongase en contacto inmediatamente con TransArctic al teléfono 1-877-COLD-AIR de modo que podamos mejorar nuestro producto.

Note la ubicación del medidor de tensión OEM

Instale el equipo

Controlar si hay interferencias.

Asegurese que el medidor de tensión mantenga la orientación justa.

Encienda el motor por lo menos 10 minutos con el sistema A/C enganchado para que la correa corra

Controle la orientación justa del medidor de tensión y ajuste a las condiciones requeridas del fabricante