

# Bill of Materials Listing

TransArctic Canada Inc.

12/13/2011  
Page 1 of 1

Product Number	Description	Date	Weight	Uof M	Yield
Line    Component    Prod#	Description	Bin                    Unit	Qty		
<b>KMC62461</b>	<b>Mt Kit, ISB, BBRE, O5K, 2B, 8" Cr, '07</b>		<b>12/5/2007</b>	<b>222.18</b>	<b>0</b>
5	BEL32592		Belt, Banded B, 2591mm (102") (RBX99-2)	each	1
10	KBB64161		Mt Kit, Base, Transit, BBRE, '07	each	1
20	KKT82461		Mt Kit, Transit, O5K, '07	each	1
30	KPC64161		Kit, Pulley, ISB, A3RE, '07	each	1
40	KAC64161		Alt. Kit, 24V, ISB, BBRE, '07	each	1

# Bill of Materials Listing

TransArctic Canada Inc.

11/24/2011  
Page 1 of 1

Product Number	Description	Date	Weight	Uof M	Yield
Line Component Prod#	Description	Bin Unit	Qty		
<b>KBB64161</b>	<b>Mt Kit, Base, Transit, BBRE, '07</b>	<b>8/31/2007</b>	<b>159.41</b>		<b>0</b>
20 BMC83019	Bkt, Gusset, Bumper, ISC, BBRE, '07	each	1		
30 BMC83020	Bkt, Dampner, ISC, BBRE, '07	each	1		
40 BMC83021	Bkt, Comp, Frt, ISC, BBRE, '07	each	1		
50 BMC83022	Bkt, Comp, Rear, ISC, BBRE, '07	each	1		
60 BMC83023	Bkt, Gusset, Idler, ISC, BBRE, '07	each	1		
70 BMC83043	Bkt, Main, Idler, ISB, BBRE, '07	each	1		
80 BMC83026	Bkt, Sprt, Bump, Rear, ISC, BBRE, '07	each	1		
90 BMC83027	Bkt, Sprt, Bump, Side, ISC, BBRE, '07	each	1		
100 BMC83028	Bkt, Tray, ISC, BBRE, '07	each	1		
110 BMC83029	Bkt, Shift, Tank, Weldmt, ISC, BBRE, '07	each	1		
115 BMC83031	Bkt, Slide, Block, Idler, BBRE	each	1		
120 BMN80008	Vibration Isolator, Bar, 16.50 x 2 x 1.50	each	2		
130 BMN80009	Bkt, Main, Base Pl, IC, RE300	each	1		
160 BMN80025	Bkt, Back, PL, Slide, IC, RE300	each	1		
170 PUA06001	Pulley, Assy, Idler, B/S, 6", Stl, Plt	each	1		
180 PUA05012	Pulley, Assy, Idler, B/BX gr, 5", STL, Plt	each	1		
220 SCD32812	Spacer, Step, Drl, 32.8mm x 50.8o x 12.3i	each	1		
225 SPC19010	Spacer, Col, Drl, 19mm x 28.58o x 10.32i	each	2		
240 SCD48012	Spacer, Col, Drl, 48 mm x 34.9o x 12.3i	each	1		
250 SLV17012	Sleeve, Pulley, 16.9o x 22.23mm x 12.32i	each	2		
280 KBT84161	Bag Kit, Fasteners, KBB84161	each	1		

# Bill of Materials Listing

TransArctic Canada Inc.

11/9/2011  
Page 1 of 1

Product Number		Description	Bin	Date	Weight	Uof M	Yield
Line	Component Prod#	Description		Unit	Qty		
<b>KBT84161</b>		<b>Bag Kit, Fasteners, KBB84161</b>		<b>8/29/2007</b>	<b>5.37</b>		<b>0</b>
10	BTC08020	Bolt, Hex, 8 x 1.25 x 20mm, 10.9, Plt		each	2		
20	BTC08035	Bolt, Hex, 8 x 1.25 x 35mm, 10.9, Plt,FT		each	1		
50	BTC12040	Bolt, Hex, 12 x 1.75 x 40mm, 10.9,Plt,FT		each	10		
60	BTC12050	Bolt, Hex, 12 x 1.75 x 50mm, 10.9,Plt		each	1		
70	BTC12060	Bolt, Hex, 12 x 1.75 x 60mm, 10.9,Plt,FT		each	1		
100	BTC12100	Bolt, Hex, 12 x 1.75 x 100mm, 10.9, Plt		each	2		
105	BTP08653	Bolt, Hex, 1/2-13unc, 6.5", 5, Plt, FT		each	1		
115	BTQ06200	Bolt, Hex, 3/8-16unc, 2.0", 8, Plt		each	2		
120	BTQ08126	Bolt, Hex, 1/2-20unf, 1.25", 8, Plt		each	12		
135	BTQ08200	Bolt, Hex, 1/2-13unc, 2.0", 8, Plt		each	3		
160	CSF06075	Capscrew, FH, 3/8-16 x .75", Alloy, Plt		each	2		
170	NTA08000	Nut, Hex, 8 x 1.25, 8.8, Plt		each	3		
190	NTA12000	Nut, Hex, 12 x 1.75, 8.8, Plt		each	13		
200	NTP06000	Nut, Hex, 3/8-16unc, 5, Plt		each	2		
230	WFA08000	Washer, Flat, 8mm, 8.8, Plt		each	4		
250	WFA12000	Washer, Flat, 12mm, 8.8, Plt		each	24		
270	WFQ08000	Washer, Flat, 1/2", 8, Plt		each	15		
280	WLA08000	Washer, Lock, 8mm, 8.8, Plt		each	3		
300	WLA12000	Washer, Lock, 12mm, 8.8, Plt		each	14		
330	WLQ08000	Washer, Lock, 1/2", 8, Plt		each	13		

# Bill of Materials Listing

TransArctic Canada Inc.

12/13/2011  
Page 1 of 1

Product Number	Description	Date	Weight	Uof M	Yield
Line    Component    Prod#	Description	Bin            Unit	Qty		
<b>KKT82461</b>	<b>Mt Kit, Transit, O5K, '07</b>	<b>10/19/2007</b>	<b>13.98</b>		<b>0</b>
10	BMN80031	Bkt, Main, Slide, Assy, 05K, IC, RE300	each	1	
20	BMN80032	Bkt, Adapter, PL, IC, RE300	each	1	
30	CSF08100	Capscrew, FH, 1/2-13 x 1", Alloy, Plt	each	4	
40	NTP07000	Nut, Hex, 7/16-14unc, 5, Plt	each	4	
50	WFN07000	Washer, Flat, 7/16", 2, Plt	each	4	
60	WLP07000	Washer, Lock, 7/16", 5, Plt	each	4	

# Bill of Materials Listing

TransArctic Canada Inc.

11/25/2011  
Page 1 of 1

Product Number		Description	Bin	Date	Weight	Uof M	Yield
Line	Component Prod#	Description		Unit	Qty		
<b>KPC64161</b>		<b>Kit, Pulley, ISB, A3RE, '07</b>		<b>5/13/2008</b>	<b>14.32</b>		<b>0</b>
10	PUL67222	Pulley, Crank, ADD-ON, ISB,6.7L,2B/X,'07		each	1		
20	CSS12090	Capscrew, SH, 12 x 1.25 x 90mm, 12.9,BLK		each	6		
30	WFS12002	Washer, Flat, Hdn, 12mm, Stl, BLK		each	6		

# Bill of Materials Listing

TransArctic Canada Inc.

11/25/2011  
Page 1 of 1

Product Number	Description	Date	Weight	Uof M	Yield
Line    Component    Prod#    Description	Bin	Unit	Qty		
<b>KAC64161</b>	<b>Alt. Kit, 24V, ISB, BBRE, '07</b>	<b>4/21/2008</b>	<b>33.17</b>		<b>0</b>
10 BEL81104	Belt, 8gr, 1104mm (43.5") (5080435)	each	1		
20 BMC67016	Bkt, Main, ALT, Weldm't, ISB, 08	each	1		
30 BMC67030	Bkt, Tenr Arm, ALT	each	1		
40 PUL80064	Pulley,ALT,Frontside,P8,63.5d (3972808)	each	1		
50 PUL80076	Pulley, Idler, Backside, P8, 76d (89062)	each	1		
60 PUL83008	Pulley, Fan, Add-on, Cum, ISC, 8.3, 8gr	each	1		
70 SCD09010	Spacer, Col, Drl, 9mm x 25.4o x10.32i	each	1		
80 SLV17010	Sleeve, Pulley, 16.9o x 22.23mm x 10.32i	each	1		
90 TEN00002	Tenr, Spring, Un-Direct, 90d, 3/8 x 4.5"/3.5"	each	1		
100 PNS04012	Pin, Spring, 1/4" d x 3/4" lg, ST, PLT	each	1		
110 KBA64161	Bag Kit, Fasteners, KAC64161	each	1		

TEN00002 to be set-up as CW rotation @ 4.5" CTL base to CTL pulley.

# Bill of Materials Listing

TransArctic Canada Inc.

11/25/2011  
Page 1 of 1

Product Number	Description	Date	Weight	Uof M	Yield
Line    Component    Prod#    Description	Bin	Unit	Qty		
<b>KBA64161</b>	<b>Bag Kit, Fasteners, KAC64161</b>	<b>4/21/2008</b>	<b>1.53</b>		<b>0</b>
10 BTC10055	Bolt, Hex, 10 x 1.5 x 55mm, 10.9, Plt,FT	each	1		
20 BTC10100	Bolt, Hex, 10 x 1.5 x 100mm, 10.9,Plt,FT	each	3		
30 BTC10030	Bolt, Hex, 10 x 1.5 x 30mm, 10.9, Plt	each	1		
40 CSF06250	Capscrew, FH, 3/8-16 x 2.5", Alloy, Plt	each	1		
50 BTQ08653	Bolt, Hex, 1/2-13unc, 6.5", 8, Plt	each	1		
60 BTQ08150	Bolt, Hex, 1/2-13unc, 1.5", 8, Plt	each	2		
70 NTA10000	Nut, Hex, 10 x 1.5, 8.8, Plt	each	1		
80 NTP08000	Nut, Hex, 1/2-13unc, 5, Plt	each	1		
90 WFA10000	Washer, Flat, 10mm, 8.8, Plt	each	5		
100 WFQ08000	Washer, Flat, 1/2", 8, Plt	each	4		
110 WLA10000	Washer, Lock, 10mm, 8.8, Plt	each	5		
120 WLQ08000	Washer, Lock, 1/2", 8, Plt	each	3		

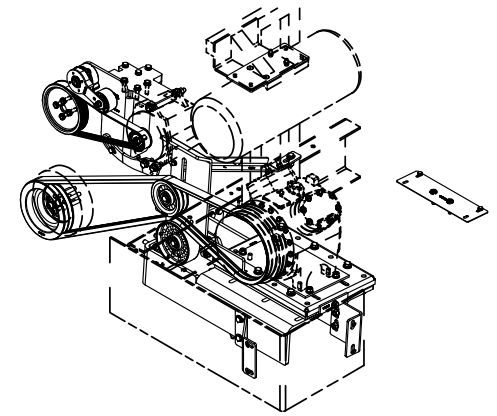
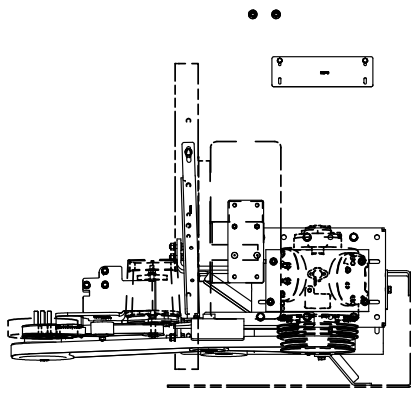

ISOMETRIC VIEW

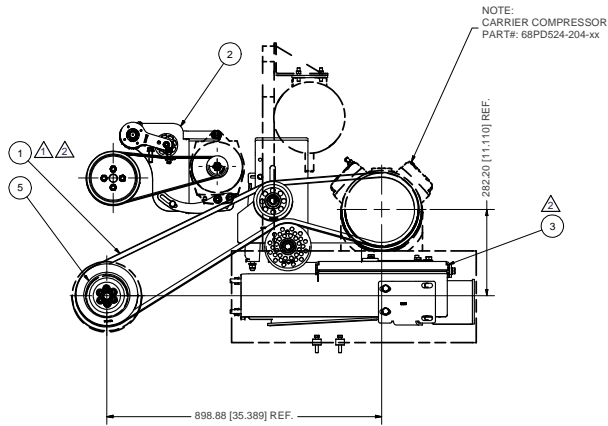

REUSE EXISTING BRACKET HARDWARE.

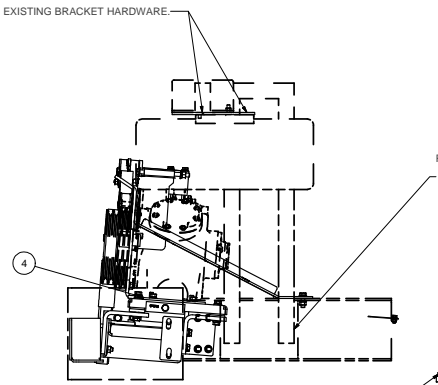

REUSE & MODIFY EXISTING EXHAUST SHIELD (FROM REAR OEM POSITION TO LOWERED OTHER SIDE OF TUBE.)

REUSE EXISTING MUFFLER BRACKET & HARDWARE.

- NOTES:
- 1) USE SERVICABLE THREADLOCKER ON ALL FASTENERS TO ENGINE COMPONENTS AND TORQUE ALL BOLTS TO S.A.E. SPECIFICATIONS.
  - 2) SEE "TRANSARCTIC A/C COMPRESSOR MOUNT INSTALLATION DISCLAIMER".

ITEM	QTY	U/M	PART NUMBER	DESCRIPTION
5	1	EACH	KPC64161	KIT, PULLEY, ISB, BBRE, '07
4	1	EACH	KKT82461	MT KIT, TRANSIT, O5K, '07
3	1	EACH	KBB64161	MT KIT, BASE, TRANSIT, BBRE, '07
2	1	EACH	KAC64161	ALT. KIT, 24V, ISB, BBRE, '07
1	1	EACH	BEL32592	BELT, BANDED B, 2591MM (102") (RBX99-2)

BILL OF MATERIALS

DRAWN	Jose Rodriguez	10/22/2008
CHECKED	Vaj Jakowlew	10/22/2008
RELEASED TO PRODUCTION	James Stewart	10/22/2008
APPROVED	Ron Ingram	10/22/2008
	Dale Mason	10/22/2008

**TRANSARCTIC INC.**

MT KIT, ISB, BBRE, O5K, 2B, 8" CRANK, '07

2	UNAS BEL32592, BEL32D KBB64161	10/14/2011	VJA/L
1	ADDED P/N# BEL32592	01/12/2008	JRR
0	RELEASED TO PRODUCTION	10/20/2008	JRR

REV/ECDN: DESCRIPTION: DATE: BY:

THIS DRAWING CONTAINS PROPRIETARY CONFIDENTIAL INFORMATION OWNED BY TRANSARCTIC CANADA INC. THE DOCUMENT AND THE INFORMATION IN IT ARE NOT TO BE USED, DISCLOSED OR REPRODUCED WITHOUT EXPRESS WRITTEN PERMISSION OF THE COMPANY.

UNSPECIFIED TOLERANCES:		UNLESS SHOWN OTHERWISE
ONE DECIMAL PLACE (X.0)	±0.1	FRACTIONAL
TWO DECIMAL PLACE (X.00)	±0.02	ANGULAR
THREE DECIMAL PLACE (X.000)	±0.002	

THIRD ANGLE PROJECTION

DWG NO	KMC62461	REV	2
SCALE	1:8	SHEET	1 OF 1



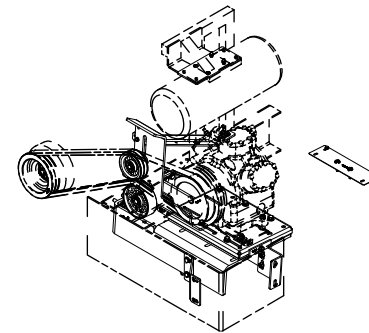
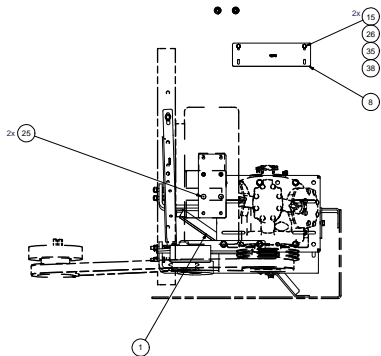

ISOMETRIC VIEW

- NOTES:
- 1) USE SERVICABLE THREADLOCKER ON ALL FASTENERS TO ENGINE COMPONENTS AND TORQUE ALL BOLTS TO S.A.E. SPECIFICATION.
  - 2) SEE "TRANSARCTIC A/C COMPRESSOR MOUNT INSTALLATION DISCLAIMER".
  - 3) WEIGHT: 155.00 LB

ITEM	QTY	UOM	PART NUMBER	DESCRIPTION
40	13	EACH	WLO08000	WASHER, LOCK, 1/2", 8, PLT
39	14	EACH	WLA12000	WASHER, LOCK, 12mm, 8, 8, PLT
38	3	EACH	WLO08000	WASHER, LOCK, 8mm, 8, 8, PLT
37	15	EACH	WFO08000	WASHER, FLAT, 1/2", 8, PLT
36	20	EACH	WFA12000	WASHER, FLAT, 12mm, 8, 8, PLT
35	4	EACH	WFO08000	WASHER, FLAT, 8mm, 8, 8, PLT
34	2	EACH	SPL19010	SPACER, COL, DBL, 19.05mm x 25.4 x 10.57
33	2	EACH	SLV17012	SLEEVE, PULLEY, 16.9 x 22.23 mm x 12.19
32	1	EACH	SCD48012	SPACER, COL, DBL, 48mm x 31.8mm x 12.0
31	1	EACH	SCD12812	SPACER, COL, DBL, 32.8mm x 50.8 x 12.3
30	1	EACH	PLA06001	PULLEY, ASSY, IDLER, B/S, 6", STL, PLT
29	1	EACH	PLA05012	PULLEY, ASSY, IDLER, B/BK, 6", 5" STL, PLT
28	2	EACH	WTP06000	NUT, HEX, 3/8-16UNC, 5, PLT
27	13	EACH	NTA12000	NUT, HEX, 12 x 1.75, 8.8, PLT
26	3	EACH	NTA08000	NUT, HEX, 8 x 1.25, 8.8, PLT
25	2	EACH	CSF06015	CARBIDE, FH, 3/8" x 1.75", 9, PLT
24	3	EACH	BTQ08200	BOLT, HEX, 1/2-13UNC x 2.00, 8, PLT
23	12	EACH	BTQ08126	BOLT, HEX, 1/2-20UNC x 1.25, 8, PLT
22	2	EACH	BTQ06000	BOLT, HEX, 3/8-16UNC, 1.00, 8, PLT
21	1	EACH	BTQ08653	BOLT, HEX, 1/2-13UNC x 6.50, 5, PLT, FT
20	2	EACH	BTQ12100	BOLT, HEX, 12 x 1.75 x 100mm, 10.9, PLT
19	1	EACH	BTQ12040	BOLT, HEX, 12 x 1.75 x 40mm, 10.9, PLT
18	1	EACH	BTQ12050	BOLT, HEX, 12 x 1.75 x 50mm, 10.9, PLT
17	10	EACH	BTQ12040	BOLT, HEX, 12 x 1.75 x 40mm, 10.9, PLT
16	1	EACH	BTQ08015	BOLT, HEX, 8 x 1.25 x 35mm, 10.9, PLT
15	2	EACH	BTQ08020	BOLT, HEX, 8 x 1.25 x 20mm, 10.9, PLT
14	1	EACH	BMN80025	BKT, BACK, PL, SLIDE, IC, RE 300
13	1	EACH	BMN80009	BKT, MAIN, BACK, PL, IC, RE 300
12	2	EACH	BMN80008	VIBRATION ISOLATOR, BAR, 16.50 x 2 x 1.50
11	1	EACH	BMC83043	BKT, MAIN, IDLER, ISB, BBRE, '07
10	1	EACH	BMC83031	BKT, SLIDE, BLOCK, IDLER, BBRE
9	1	EACH	BMC83029	BKT, SHIFT, TANK, WELDMT, ISC, BBRE, '07
8	1	EACH	BMC83028	BKT, TRAY, ISC, BBRE, '07
7	1	EACH	BMC83027	BKT, SPRAY, BUMP, SIDE, ISC, BBRE, '07
6	1	EACH	BMC83026	BKT, SPRAY, BUMP, REAR, ISC, BBRE, '07
5	1	EACH	BMC83023	BKT, GUSSET, IDLER, ISC, BBRE, '07
4	1	EACH	BMC83022	BKT, COMP, REAR, ISC, BBRE, '07
3	1	EACH	BMC83021	BKT, COMP, FRT, ISC, BBRE, '07
2	1	EACH	BMC83020	BKT, DAMPNER, ISC, BBRE, '07
1	1	EACH	BMC83019	BKT, GUSSET, BUMPER, ISC, BBRE, '07

REV	DATE	DESCRIPTION	BY	CHK
1	3/17/2009	ISSUE FOR PRODUCTION	DA	DA
2	3/17/2009	REVISED TO ADD PART 11	DA	DA
3	3/17/2009	REVISED TO ADD PART 12	DA	DA
4	3/17/2009	REVISED TO ADD PART 13	DA	DA
5	3/17/2009	REVISED TO ADD PART 14	DA	DA
6	3/17/2009	REVISED TO ADD PART 15	DA	DA
7	3/17/2009	REVISED TO ADD PART 16	DA	DA
8	3/17/2009	REVISED TO ADD PART 17	DA	DA
9	3/17/2009	REVISED TO ADD PART 18	DA	DA
10	3/17/2009	REVISED TO ADD PART 19	DA	DA
11	3/17/2009	REVISED TO ADD PART 20	DA	DA
12	3/17/2009	REVISED TO ADD PART 21	DA	DA
13	3/17/2009	REVISED TO ADD PART 22	DA	DA
14	3/17/2009	REVISED TO ADD PART 23	DA	DA
15	3/17/2009	REVISED TO ADD PART 24	DA	DA
16	3/17/2009	REVISED TO ADD PART 25	DA	DA
17	3/17/2009	REVISED TO ADD PART 26	DA	DA
18	3/17/2009	REVISED TO ADD PART 27	DA	DA
19	3/17/2009	REVISED TO ADD PART 28	DA	DA
20	3/17/2009	REVISED TO ADD PART 29	DA	DA
21	3/17/2009	REVISED TO ADD PART 30	DA	DA
22	3/17/2009	REVISED TO ADD PART 31	DA	DA
23	3/17/2009	REVISED TO ADD PART 32	DA	DA
24	3/17/2009	REVISED TO ADD PART 33	DA	DA
25	3/17/2009	REVISED TO ADD PART 34	DA	DA
26	3/17/2009	REVISED TO ADD PART 35	DA	DA
27	3/17/2009	REVISED TO ADD PART 36	DA	DA
28	3/17/2009	REVISED TO ADD PART 37	DA	DA
29	3/17/2009	REVISED TO ADD PART 38	DA	DA
30	3/17/2009	REVISED TO ADD PART 39	DA	DA
31	3/17/2009	REVISED TO ADD PART 40	DA	DA

DATE: 3/17/2009  
 DRAWN BY: DA  
 CHECKED BY: DA  
 TITLE: MT KIT, BASE, TRANSIT, BBRE, '07  
 Dwg No: KBB64161  
 SHEET 1 OF 1

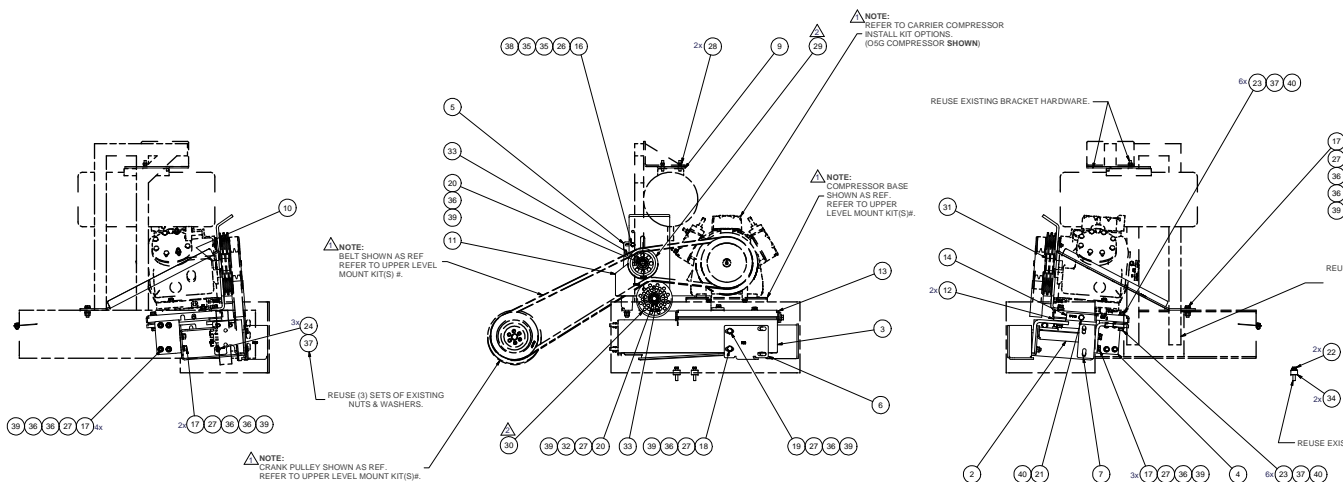

REV	DATE	DESCRIPTION	BY	CHK
1	3/17/2009	ISSUE FOR PRODUCTION	DA	DA
2	3/17/2009	REVISED TO ADD PART 11	DA	DA
3	3/17/2009	REVISED TO ADD PART 12	DA	DA
4	3/17/2009	REVISED TO ADD PART 13	DA	DA
5	3/17/2009	REVISED TO ADD PART 14	DA	DA
6	3/17/2009	REVISED TO ADD PART 15	DA	DA
7	3/17/2009	REVISED TO ADD PART 16	DA	DA
8	3/17/2009	REVISED TO ADD PART 17	DA	DA
9	3/17/2009	REVISED TO ADD PART 18	DA	DA
10	3/17/2009	REVISED TO ADD PART 19	DA	DA
11	3/17/2009	REVISED TO ADD PART 20	DA	DA
12	3/17/2009	REVISED TO ADD PART 21	DA	DA
13	3/17/2009	REVISED TO ADD PART 22	DA	DA
14	3/17/2009	REVISED TO ADD PART 23	DA	DA
15	3/17/2009	REVISED TO ADD PART 24	DA	DA
16	3/17/2009	REVISED TO ADD PART 25	DA	DA
17	3/17/2009	REVISED TO ADD PART 26	DA	DA
18	3/17/2009	REVISED TO ADD PART 27	DA	DA
19	3/17/2009	REVISED TO ADD PART 28	DA	DA
20	3/17/2009	REVISED TO ADD PART 29	DA	DA
21	3/17/2009	REVISED TO ADD PART 30	DA	DA
22	3/17/2009	REVISED TO ADD PART 31	DA	DA
23	3/17/2009	REVISED TO ADD PART 32	DA	DA
24	3/17/2009	REVISED TO ADD PART 33	DA	DA
25	3/17/2009	REVISED TO ADD PART 34	DA	DA
26	3/17/2009	REVISED TO ADD PART 35	DA	DA
27	3/17/2009	REVISED TO ADD PART 36	DA	DA
28	3/17/2009	REVISED TO ADD PART 37	DA	DA
29	3/17/2009	REVISED TO ADD PART 38	DA	DA
30	3/17/2009	REVISED TO ADD PART 39	DA	DA
31	3/17/2009	REVISED TO ADD PART 40	DA	DA

DATE: 3/17/2009  
 DRAWN BY: DA  
 CHECKED BY: DA  
 TITLE: MT KIT, BASE, TRANSIT, BBRE, '07  
 Dwg No: KBB64161  
 SHEET 1 OF 1

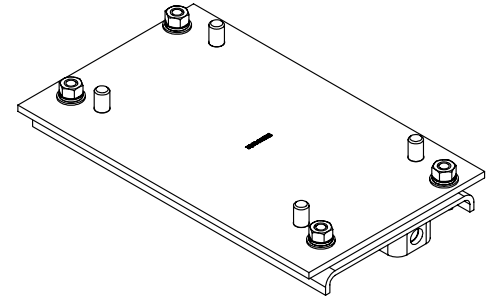
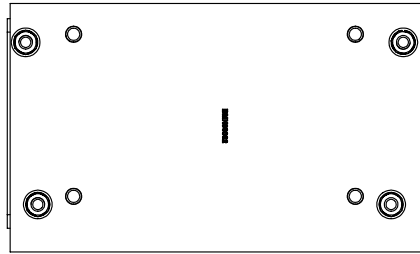

ISOMETRIC VIEW

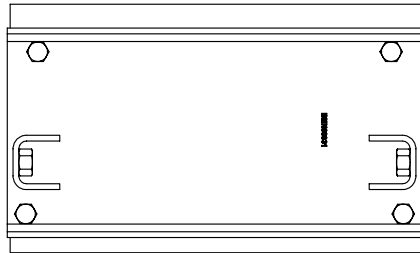
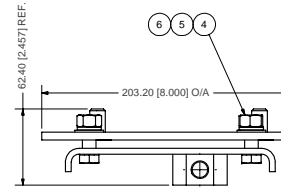
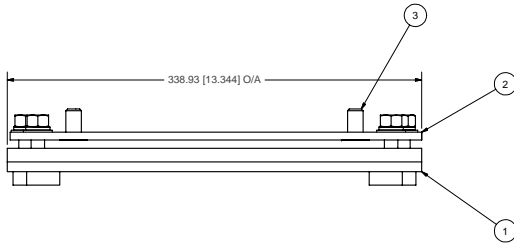

- NOTES:**
- 1) USE SERVICABLE THREADLOCKER ON ALL FASTENERS TO ENGINE COMPONENTS AND TORQUE **ALL BOLTS** TO S.A.E. SPECIFICATIONS.
  - 2) SEE 'TRANSARGTIC A/C COMPRESSOR MOUNT INSTALLATION DISCLAIMER'.
  - 3) WEIGHT: 13.96 LB

ITEM	QTY	U/M	PART NUMBER	DESCRIPTION
6	4	EACH	WLP07000	WASHER, LOCK, 7/16", 5, PLT
5	4	EACH	WFO7000	WASHER, FLAT, 7/16", 2, PLT
4	4	EACH	NTP07000	NUT, HEX, 7/16-14UNC, 5, PLT
3	4	EACH	CSP08100	CAPSCREW, FH, 3/8-16 x 1", 9, PLT
2	1	EACH	BMN80032	BKT. ADAPTER, PL, IC, RE300
1	1	EACH	BMN80031	BKT. MAIN SLIDE, ASSY, OSK, IC, RE300

**TRANSARGTIC INC.**

DRAWN Jose Rodriguez 10/20/2008 CHECKED Val Jakowlew 10/20/2008 DATE: 10/20/2008 BY: Val Jakowlew TITLE 	RELEASED TO PRODUCTION 10/20/2008 DATE: 10/20/2008 BY: Val Jakowlew 	APPROVED Ron Ingram 10/20/2008 DATE: 10/20/2008 BY: Ron Ingram 	APPROVED Dale Mason 10/20/2008 DATE: 10/20/2008 BY: Dale Mason 	DWG NO KKT82461 	REV 0 
UNspecified TOLERANCES: HOLE DIM (+0.000) (+0.000) (+0.000) DIM DECIMAL PLACE (.00) (.00) (.00) DIM FRACTIONAL PLACE (1/32) (1/32) (1/32) DIM FRACTIONAL PLACES (1/32) (1/32) (1/32)			THIRD ANGLE PROJECTION	DRAWING UNIT OF MEASURE: MM (INCH)	SCALE: 1:2

MT KIT, TRANSIT, OSK, '07

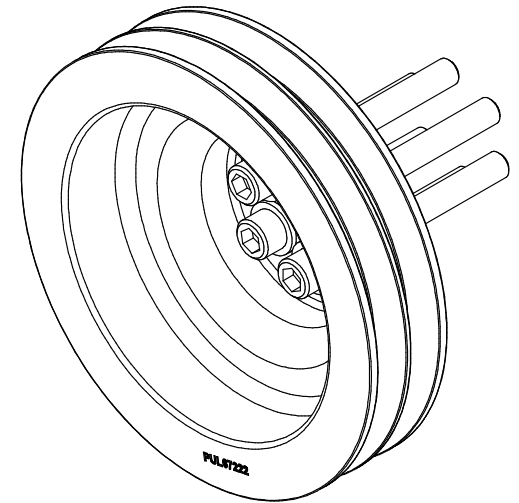
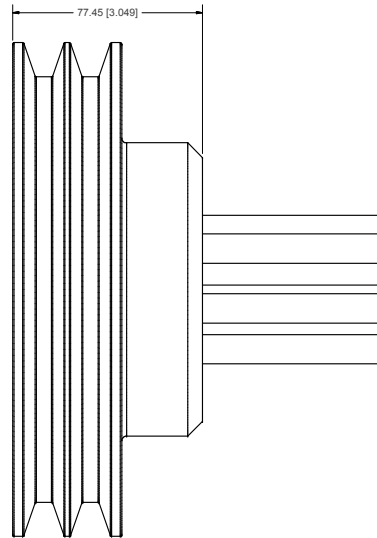
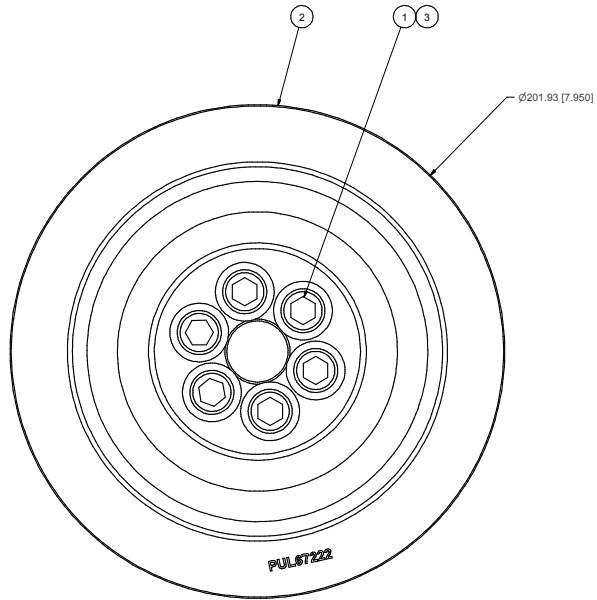
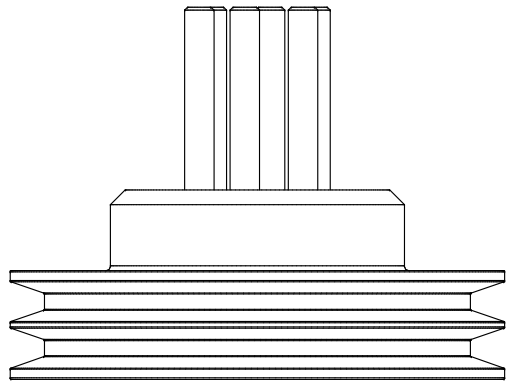

ISOMETRIC VIEW

**NOTES:**

- 1) USE SERVICABLE THREADLOCKER ON ALL FASTENERS TO ENGINE COMPONENTS AND TORQUE **ALL** BOLTS TO S.A.E. SPECIFICATIONS.
- 2) SEE "TRANSARC TIC A/C COMPRESSOR MOUNT INSTALLATION DISCLAIMER".
- 3) WEIGHT: 13.24 LB

ITEM	QTY	U/M	PART NUMBER	DESCRIPTION
3	6	EACH	WFS12002	WASHER, FLAT, HDN, 12mm, STL, BLK
2	1	EACH	PUL67222	PULLEY, CRANK, ADD-ON, ISB, 6.7L, 2B/X, '07
1	6	EACH	CSS12090	CAPSCREW, SH, 12 x 1.25 x 90mm, 12.9, PLT

**BILL OF MATERIALS**

DRAWN	Jose Rodriguez	10/21/2008	<b>TRANSARC TIC INC.</b>		
CHECKED	James Stewart	10/21/2008			
REV	ECN	DESCRIPTION	DATE	BY	TITLE
			10/21/2008	James Stewart	
			10/21/2008	Ron Ingram	
			10/21/2008	Dale Mason	

**KIT, PULLEY, ISB, BBRE, '07**

UNSPECIFIED TOLERANCES:		(ALL DIM)	THIRD ANGLE PROJECTION					
ONE DECIMAL PLACE (10)	AS SHOWN	GROUP						
TWO DECIMAL PLACE (20)	AS SHOWN	SIZE						
FRACTIONAL (1/32)	AS SHOWN	USE						
DRAWING UNIT OF MEASURE		MM (INCH)	SCALE	1:1	DWG NO	KPC64161	REV	0

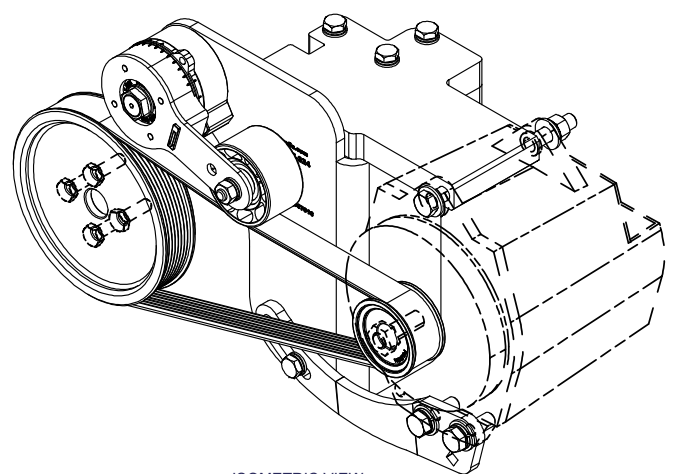
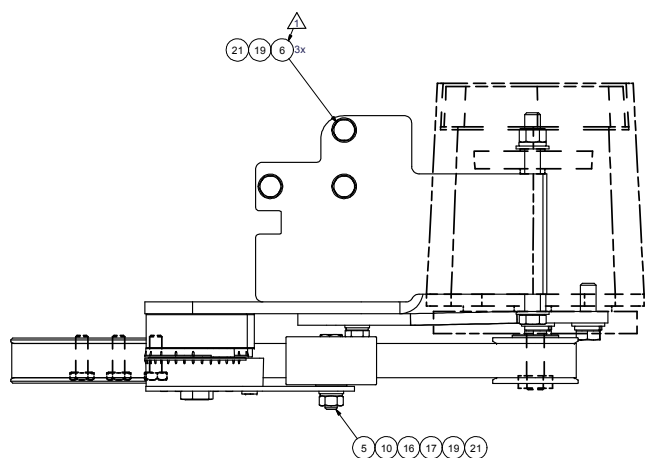

ISOMETRIC VIEW

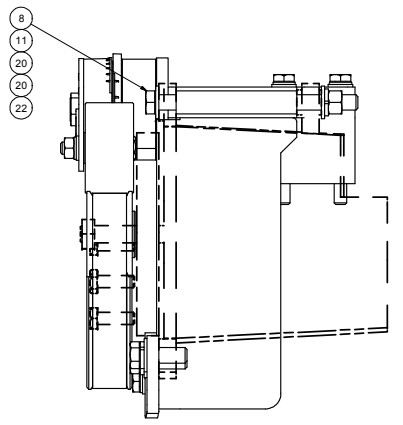
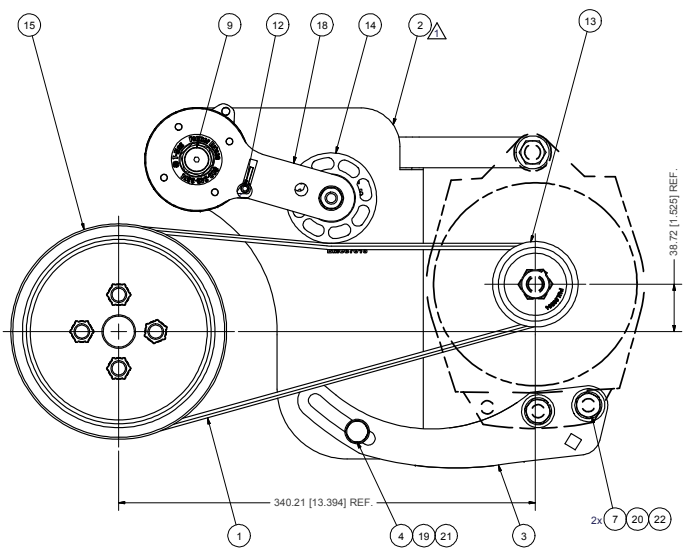

- NOTES:
- 1) USE SERVICABLE THREADLOCKER ON ALL FASTENERS TO ENGINE COMPONENTS AND TORQUE ALL BOLTS TO S.A.E. SPECIFICATIONS.
  - 2) SEE "TRANSARGTIC A/C COMPRESSOR MOUNT INSTALLATION DISCLAIMER".
  - 3) WEIGHT: 13.00 LB

ITEM	QTY	U/M	PART NUMBER	DESCRIPTION
22	3	EACH	WLQ08000	WASHER, LOCK, 1/2", 8, PLT
21	5	EACH	WLA10000	WASHER, LOCK, 10mm, 8.8, PLT
20	4	EACH	WFO08000	WASHER, FLAT, 1/2", 8, PLT
19	5	EACH	WFA10000	WASHER, FLAT, 10mm, 8.8, PLT
18	1	EACH	TEN00002	TENR. SPRING, UN-DIRECT, 90D, 3/8 X 3.5"
17	1	EACH	SLV17010	SLEEVE, PULLEY, 16.9x x 22.23mm x 10.32l
16	1	EACH	SCD09010	SPACER, COL, DR_L, 9mm x 25.4x 10.32l
15	1	EACH	PUL83008	PULLEY, FAN, ADD-ON, CUM, ISC, 8.3, 8gr
14	1	EACH	PUL80076	PULLEY, IDLER, BACKSIDE, P8, 76D, 39W
13	1	EACH	PUL80064	PULLEY, ALT, FRONTSIDE, P8, 63.5d (3972808)
12	1	EACH	PNV04012	PIN, SPRING, 1/4" D x 3/4" L
11	1	EACH	NTP08000	NUT, HEX, 1/2-13UNC, 5, PLT
10	1	EACH	NTA10000	NUT, HEX, 10 x 1.5, 8.8, PLT
9	1	EACH	CSF06250	CAPSCREW, FH, 3/8-16 x 2.5", 9, PLT
8	1	EACH	BTQ08653	BOLT, HEX, 1/2-13UNC x 6.50, 8, PLT
7	2	EACH	BTQ08150	BOLT, HEX, 1/2-13UNC x 1.50, 8, PLT
6	3	EACH	BTC10100	BOLT, HEX, 10 x 1.5 x 100mm, 10.9, PLT
5	1	EACH	BTC10055	BOLT, HEX, 10 x 1.5 x 55mm, 10.9, PLT
4	1	EACH	BTC10030	BOLT, HEX, 10 x 1.5 x 30mm, 10.9, PLT
3	1	EACH	BMC67030	BKT, TENR, ARM, ALT
2	1	EACH	BMC67016	Bkt, Main, ALT, Weldmt, ISB, 08
1	1	EACH	BEL81104	Belt, 8gr, 1104mm (43.5") (S080435)

**BILL OF MATERIALS**

DRAWN: Jose Rodriguez 10/1/2008  
 CHECKED: Val Jakowlew 10/1/2008  
 TITLE: Alt. Kit, 24V, ISB, BBRE, '07

REV: ECN DESCRIPTION: DATE: BY: MFG  
 1 REVISED BMC67016 WAS BTC10042 1/18/2010 JRR  
 0 RELEASED FOR PRODUCTION 10/1/2008 JRR  
 2 Ron Ingram 10/1/2008  
 Dale Mason 10/1/2008

THIS DRAWING CONTAINS PROPRIETARY CONFIDENTIAL INFORMATION OWNED BY TRANSARGTIC CANADA INC. THE DOCUMENT AND THE INFORMATION IT CONTAINS ARE NOT TO BE USED, DISCLOSED OR REPRODUCED WITHOUT EXPRESS WRITTEN PERMISSION OF THE COMPANY.

UNSPECIFIED TOLERANCES: (ALL DIM) .0005  
 ONE DECIMAL PLACE (10) .05  
 TWO DECIMAL PLACE (20) .01  
 FRACTIONAL (1/32) .003125

THIRD ANGLE PROJECTION

DRAWING UNIT OF MEASURE: MM (INCH)  
 SCALE: 1:2

SIZE: DWG NO: KAC64161  
 SHEET 1 OF 1

1	REVISED BMC67016 WAS BTC10042	1/18/2010	JRR
0	RELEASED FOR PRODUCTION	10/1/2008	JRR
REV: ECN	DESCRIPTION:	DATE:	BY:
2		10/1/2008	Ron Ingram
1		10/1/2008	Dale Mason

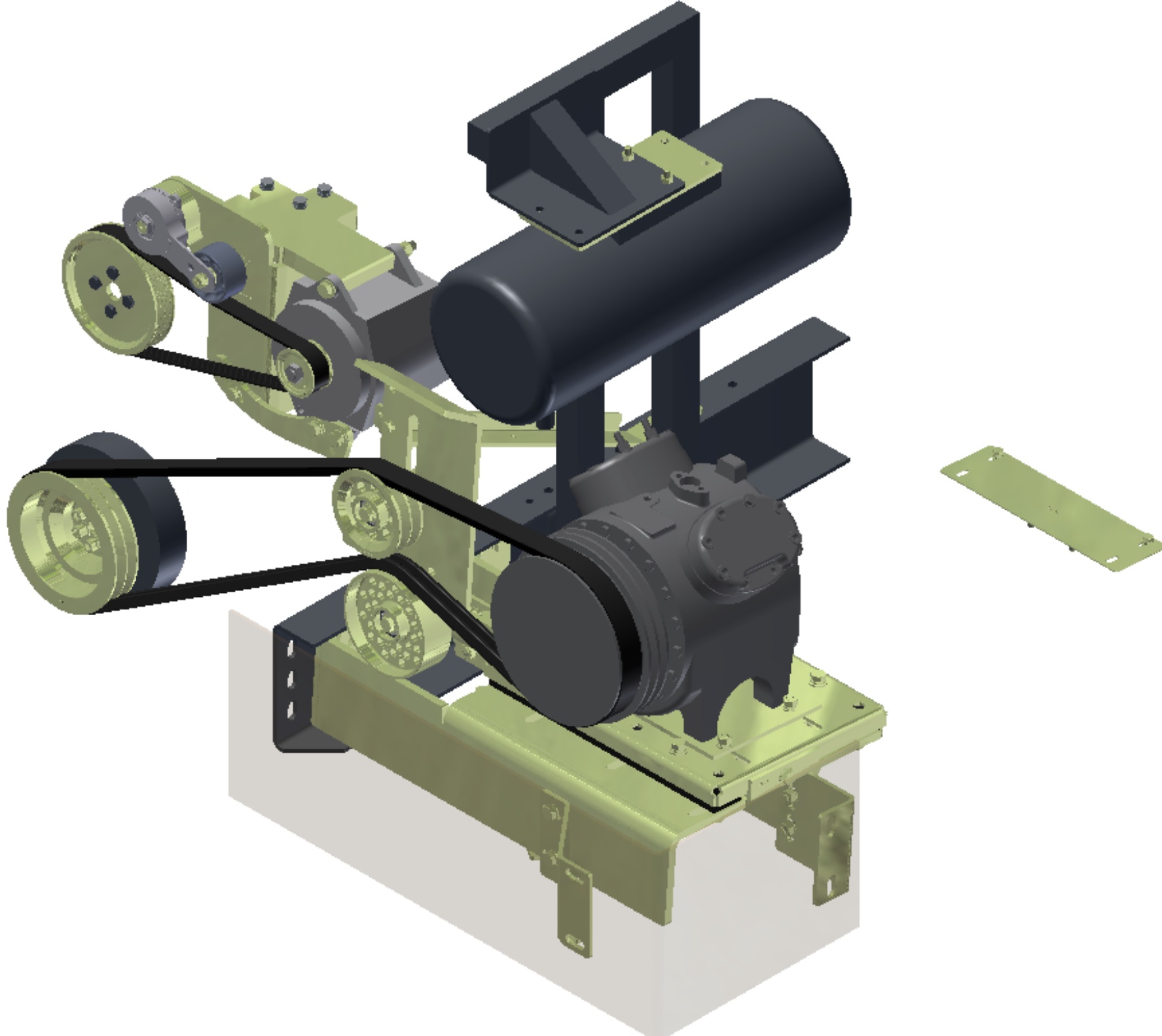

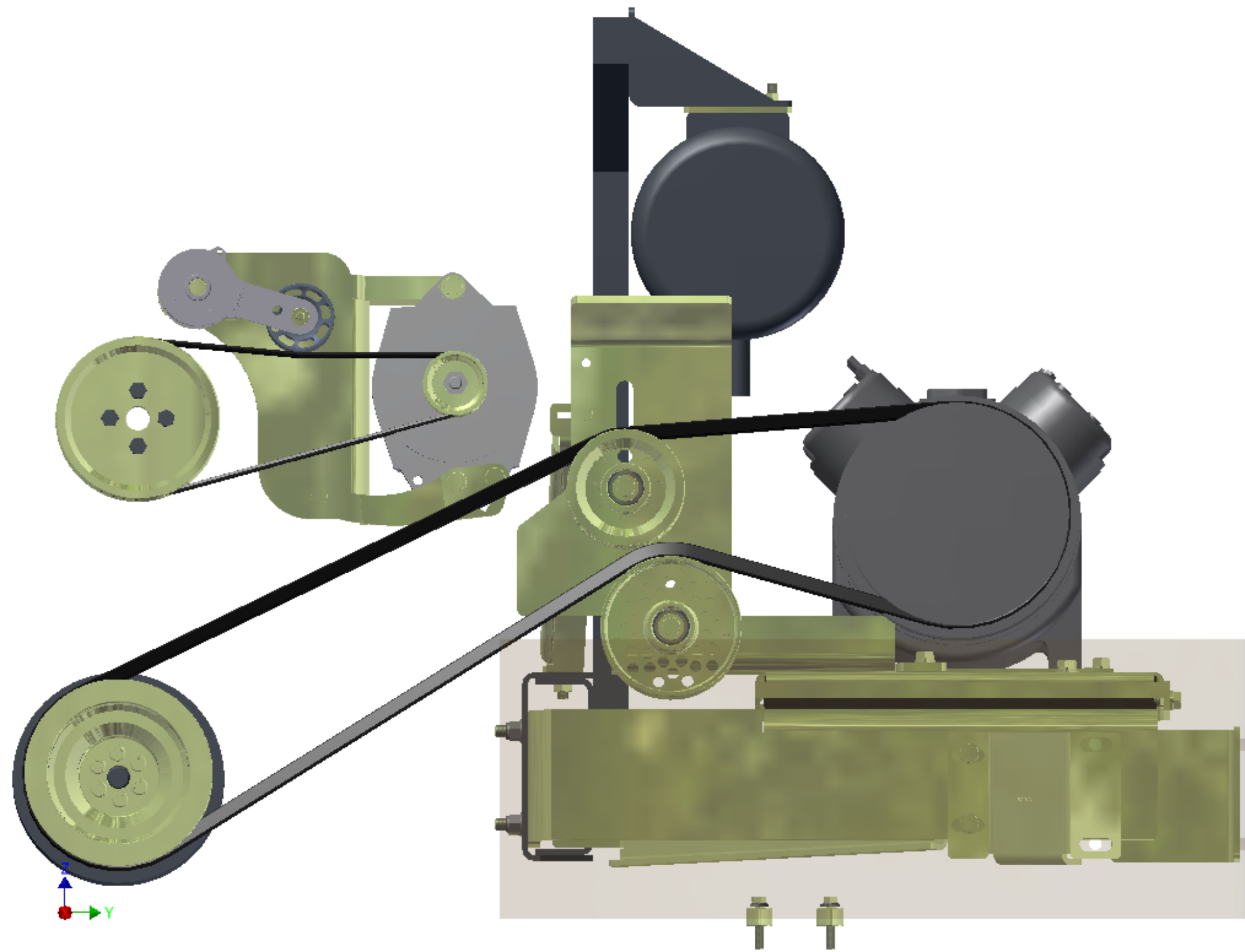

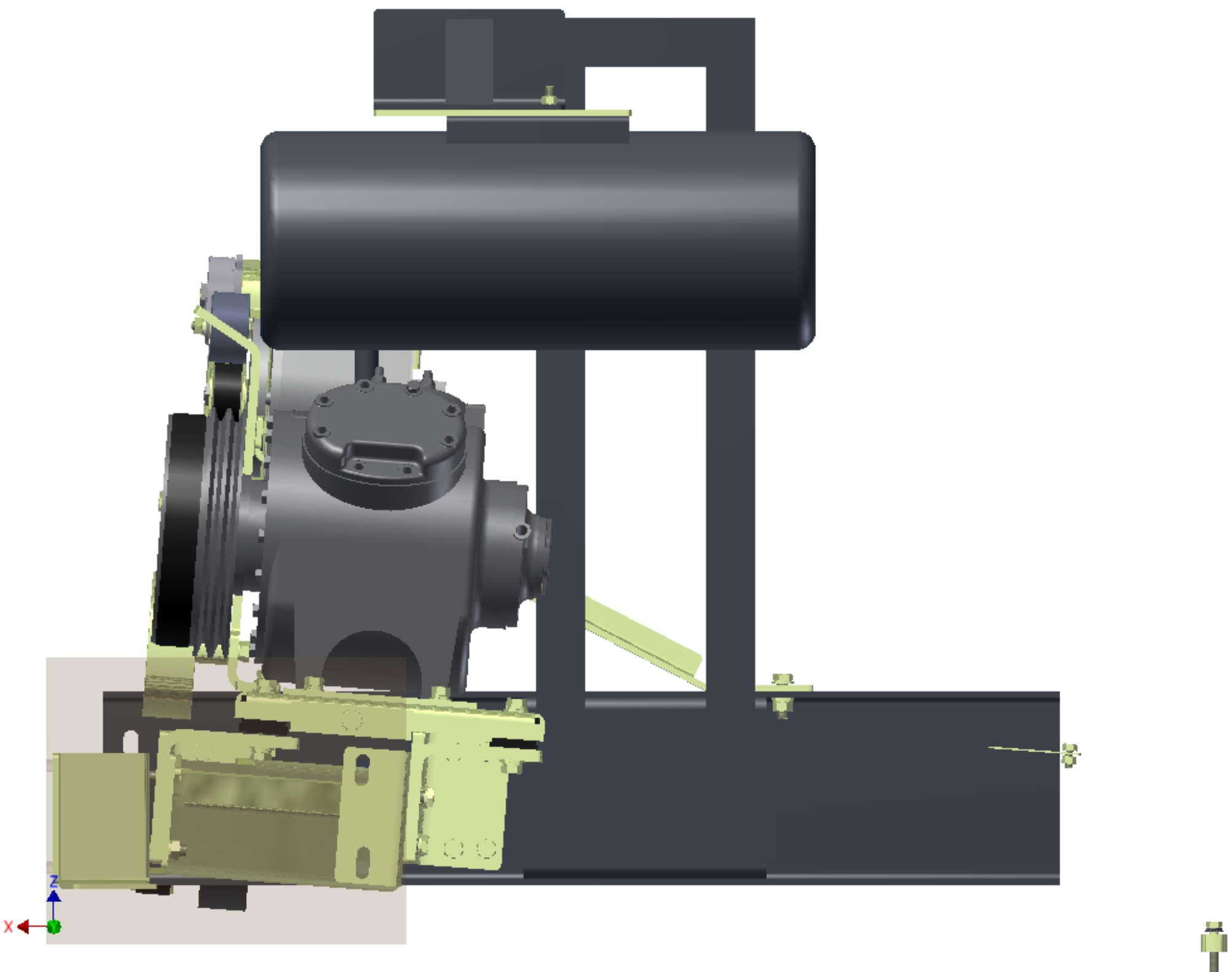

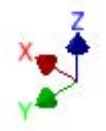
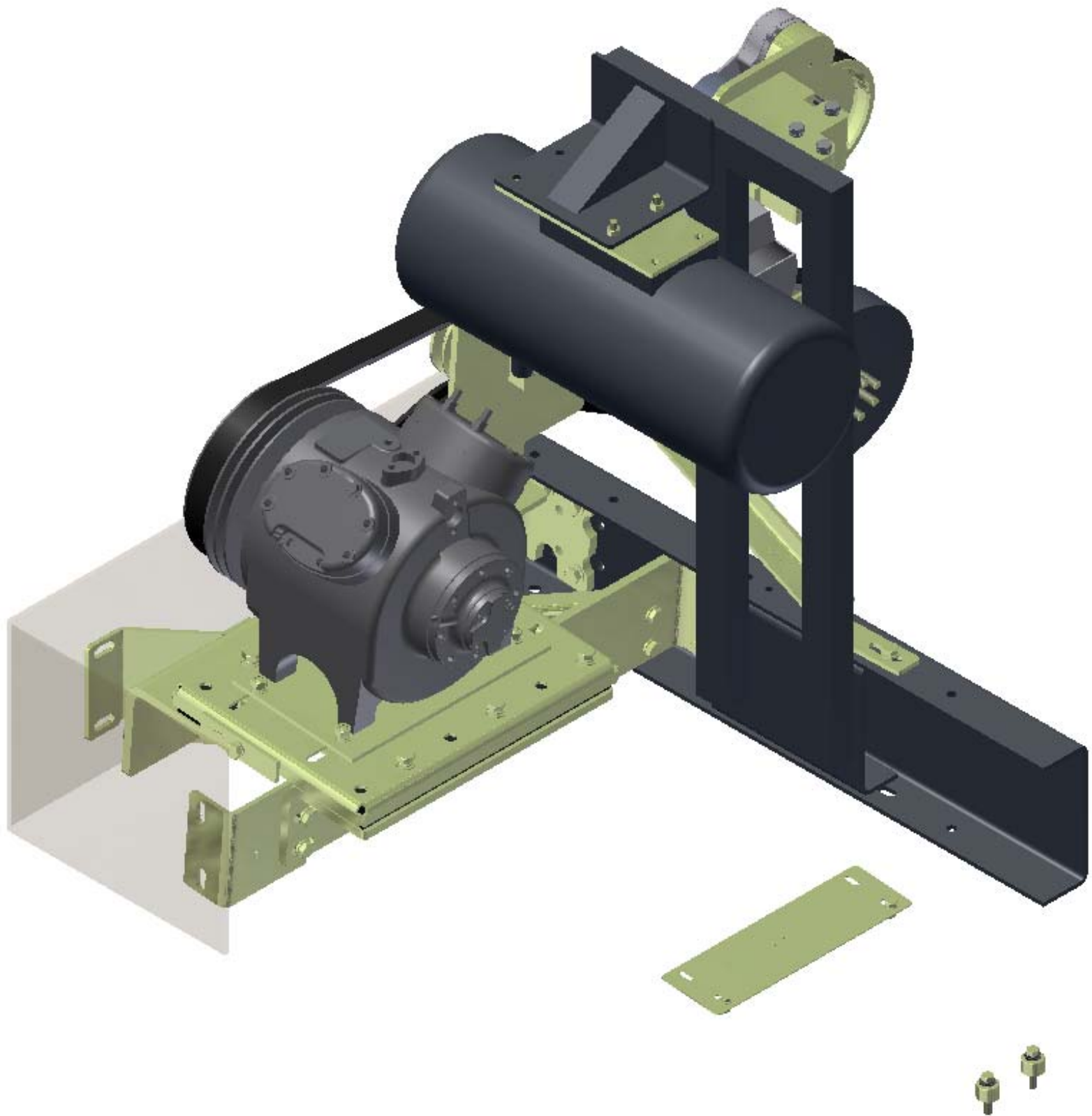



## **TransArctic A/C Compressor Mount Installation Disclaimer**

All compressor mounts should be installed by qualified and trained personnel using proper tools and equipment in safe working conditions following industry standard guidelines for motor vehicle service and repair.

The installer of any compressor mount purchased from TransArctic must undertake all responsibility of issues arising from that compressor bracket being installed on any vehicle. As well as insure that a **proper and sufficient ground** is established between the compressors' clutches and the vehicle's engine. Mount functionality, operation and durability can all be compromised by an incompetent installation.

Due to the many different situations, parameters and application criteria, which are beyond the compressor mount manufacturer's control, TransArctic does not warrant design, durability, or operational functionality of any compressor mount improperly installed by another party.

**With no implied guarantees it is the mount installer's strict responsibility to determine safety and functionality, of the compressor mount, at the time of installation.**

Please contact TransArctic with any issue arising from installation so we may better improve the product. If you have any reservations about the compressor mount integrity contact TransArctic immediately at 1-877-COLD-AIR.

**Mark OEM tensioner location**

**Install Kit**

**Check for Interferences**

**Check to ensure that the proper OEM tensioner orientation is maintained**

**Run engine with A/C system engaged for at least 10 minutes to run in belt**

**Check OEM tensioner orientation and adjust as required**

### **Responsabilidad limitada de TransArctic en la instalación del soporte del compresor**

Todos los soportes de los compresores deben ser instalados por personas calificadas y entrenadas, usando para ello los equipos y herramientas necesarios para esta labor en buenas condiciones y según las normas y guías para el servicio y/o reparación de motores de vehículos.

El instalador de los soportes comprados en TransArctic asume toda la responsabilidad de cualquier problema que surga en el soporte del compresor al vehículo; de igual manera es responsable que el cable a tierra sea conectado entre el embrague del compresor y el motor del vehículo.

Se advierte que el buen funcionamiento y la durabilidad del soporte pueden ser comprometidos por defectos en su instalación.

Debido a las diversas situaciones que se puedan presentar fuera del control del fabricante, TransArctic no garantiza el diseño, la durabilidad o el correcto funcionamiento de cualquier equipo inapropiadamente instalado por terceros.

**Esta sobreentendido que el Instalador del montaje del compresor es estrictamente responsable de la seguridad y funcionamiento del equipo en el momento de la instalación.**

Si tuviera algún problema o duda acerca de la instalación del soporte del compresor pongase en contacto inmediatamente con TransArctic al teléfono 1-877-COLD-AIR de modo que podamos mejorar nuestro producto.

**Note la ubicación del medidor de tensión OEM**

**Instale el equipo**

**Controlar si hay interferencias.**

**Asegure que el medidor de tensión mantenga la orientación justa.**

**Encienda el motor por lo menos 10 minutos con el sistema A/C enganchado para que la correa corra**

**Controle la orientación justa del medidor de tensión y ajuste a las condiciones requeridas del fabricante**