

Bill of Materials Listing

TransArctic Canada Inc.

2/10/2022
Page 1 of 1

Product Number	Date	Description	Uof M	Weight	Yield	
Line	Qty	Component Prod#	Rev#	Bin	Unit	
KMC96631	04/25/17	0 Mt Kit, ISL, ICRE, TM-55/65, Alt, '21			1385.76	0
5	1	PAC39131			each	
10	2	BEL21626			each	
20	1	BEL82096			each	
30	1	BMC90047	0		each	
40	1	BMC90052	0		each	
50	1	BMN80109	2		each	
60	1	BMN80116	3		each	
70	1	BMN80119	3		each	
80	1	BMN80123	1		each	
90	2	CLP72001			each	
100	1	HOA04530	0		each	
110	1	KAC65502	3		each	
130	1	KBB00003	0		each	
140	1	KCB95501	0		each	
150	1	PUA84101	0		each	
160	1	KBC96631	0		each	

Bill of Materials Listing

TransArctic Canada Inc.

9/7/2021
Page 1 of 1

Product Number	Date	Description	Uof M	Weight	Yield	
Line	Qty	Component Prod#	Rev#	Bin	Unit	
KBC96631	7/14/2016	0 Bag Kit, Fasteners, KMC96631 & KMC96531			3.59	0
10	6	BTC08035			each	
20	4	BTC10060			each	
40	1	BTC12030			each	
50	1	BTC12120			each	
60	2	BTC16070			each	
70	6	BTQ08126			each	
80	4	CSF10046			each	
90	8	NTA10000			each	
100	1	NTA12000			each	
110	2	NTA16000			each	
120	6	WFA08000			each	
130	4	WFA10000			each	
140	8	WFA10002			each	
150	2	WFA12002			each	
160	4	WFA16000			each	
170	6	WFQ08000			each	
180	1	WFS12001			each	
190	6	WLA08000			each	
200	8	WLA10000			each	
210	2	WLA12000			each	
220	2	WLA16000			each	
230	6	WLQ08000			each	

Bill of Materials Listing

TransArctic Canada Inc.

2/8/2022
Page 1 of 1

Product Number	Date	Description		Uof M	Weight	Yield		
Line	Qty	Component	Prod#	Rev#	Description	Bin	Unit	
KAC65502	08/11/16	3	Kit, Alternator, TM-65, Driver Side, '13				31.53	0
5	1	PAC12110			Pack, Carton, 12" x 11" x 5", 51 ECT		each	
10	2	BEL11040			Belt, A gr, 1040mm (41")		each	
20	1	BMC96663			1 Bkt, Main, Alt, Weldmt,ISL,TM-65/55,'13		each	
40	2	BMT10011			0 Bkt, Tenr, Block, Offset, 3mm		each	
50	1	PUL03321			1 Pulley, ALT, Idler, 3.25"d, 2A		each	
55	1	KBA84064			0 Bag Kit, ALT Shim, KC84064, KAC65501/02		each	
60	1	TRD08080			Threaded, Rod, 1/2-13unc x 8", 5, Plt		each	
70	1	KBA65502			0 Bag Kit, Fasteners, KAC65502			

NOTE:

1) Use KBA84064 "Shim bag kit", as required, to align the Alternator correctly.

Bill of Materials Listing

TransArctic Canada Inc.

2/8/2022
Page 1 of 1

Product Number	Date	Description			Uof M	Weight	Yield		
Line	Qty	Component	Prod#	Rev#	Description	Bin	Unit		
KBA65502	08/10/16	0	Bag Kit, Fasteners, KAC65502					1.52	0
10	4	BTC12035			Bolt, Hex, 12 x 1.75 x 35mm, 10.9,Plt,FT		each		
20	1	BTQ08150			Bolt, Hex, 1/2-13unc, 1.5", 8, Plt		each		
30	1	BTQ08200			Bolt, Hex, 1/2-13unc, 2.0", 8, Plt		each		
40	1	BTQ08653			Bolt, Hex, 1/2-13unc, 6.5", 8, Plt		each		
50	6	NTQ08000			Nut, Hex, 1/2-13unc, 8, Plt		each		
60	4	WFA12000			Washer, Flat, 12mm, 8.8, Plt		each		
70	4	WFQ08000			Washer, Flat, 1/2", 8, Plt		each		
80	4	WLA12000			Washer, Lock, 12mm, 8.8, Plt		each		
90	5	WLQ08000			Washer, Lock, 1/2", 8, Plt		each		

Bill of Materials Listing

TransArctic Canada Inc.

2/4/2022
Page 1 of 1

Product Number	Date	Description			Uof M	Weight	Yield	
Line	Qty	Component	Prod#	Rev#	Description	Bin	Unit	
KBA84064	10/19/21	0			Bag Kit, ALT Shim, KC84064, KAC65501/02		0.09	0
10	1	SCD03613		0	Spacer, Col, Drl, 3.56mm x 25.4o x12.7i	Alley	each	
20	2	WFA14000			Washer, Flat, 14mm, 8.8, Plt		each	
30	2	WFQ08000			Washer, Flat, 1/2", 8, Plt		each	

NOTE:

1) Use (1) SCD03613, (2) WFA14000, (2) WFQ08000, in any arrg'mt/qtys as required to align the Alternator correctly.

Bill of Materials Listing

TransArctic Canada Inc.

9/7/2021
Page 1 of 1

Product Number	Date	Description	Uof M	Weight	Yield		
Line	Qty	Component Prod#	Rev#	Description	Bin	Unit	
KBB00003	6/20/2012	0		MT KIT, PLATFORM, TRANSIT, ADM, '21		847.29	0
10	1	BMZ01034		2 Bkt, Spring, Support Arm, ADM, '12		each	
20	1	BMZ01070		0 Bkt, Main, Pivot, Ass'y, 05G,Transit,'21		each	
30	1	BMZ01037		2 Bkt, Fork, Knuckle-Joint, Adm, '12		each	
40	1	BMZ00043		3 Bkt, Main, Base Pl, '13		each	
50	1	BMZ01040		0 Bkt, Ass'y, THRD Rod, Isolator, ADM, '12		each	
60	2	BMZ01041		2 Shaft Key, 5/16" SQ x .540" Long		each	
70	2	BMN80008		1 Vibration Isolator, Bar, 16.50 x 2 x 1.50		each	
71	1	BMN80025		0 Bkt, Back, PL, Slide, IC, RE300		each	
72	1	BMN80104		0 Bkt, Main, Slide, Assy, ICRE		each	
80	1	BMZ01072		0 Bkt, Assy, Cradle, Pivot, 05G,Transit,21		each	
110	1	PIS01010		2 Shaft, Stl, Grease, ADM Transit, '12		each	
120	1	SPR00002		0 Spring, Comp, R/H, 110 x 50 x 8.4, Red		each	
130	1	WFS16001		0 Washer, Flat, Dbl Step, 17mm, 50mm, Plt		each	
140	1	WFS27001		0 Washer, Flat, Dbl Step, 27mm, 63.5, Plt		each	
150	1	KBB00027		0 Bag Kit, Fasteners, Spring Assy,KBB00003		each	
160	1	KBB00028		0 Bag Kit, Fasteners, Pivot Assy, KBB00003		each	

NOTE:

Use Blue "Loctite" on the (4) fasteners to fasten BMZ01034 in place.
 1/2 -13 UNC grd. 8 bolts, c/w L'whrs torque... used on the PIS01010 Shaft
 = 45 FT*LBS. (/VTS@ JAN-25-2019)

Bill of Materials Listing

TransArctic Canada Inc.

9/9/2021
Page 1 of 1

Product Number	Date	Description	Uof M	Weight	Yield			
Line	Qty	Component Prod#	Rev#	Description	Bin	Unit	Weight	Yield
KBB00027	8/1/2012	0		Bag Kit, Fasteners, Spring Assy,KBB00003			1.38	0
10	5	BTQ08150		Bolt, Hex, 1/2-13unc, 1.5", 8, Plt		each		
20	1	BTQ10351		Bolt, Hex, 5/8-18unf, 3.5", 8. PLT		each		
30	5	NTQ08000		Nut, Hex, 1/2-13unc, 8, Plt		each		
50	2	NTQ10000		Nut, Hex, 5/8-11unc, 8, Plt		each		
60	1	NTQ10001		Nut, Hex, 5/8-18unf, 8, Plt		each		
70	2	WFQ08000		Washer, Flat, 1/2", 8, Plt		each		
80	2	WFQ10000		Washer, Flat, 5/8", 8, Plt		each		
110	1	WLQ08000		Washer, Lock, 1/2", 8, Plt		each		
120	2	WLQ10000		Washer, Lock, 5/8", 8, Plt		each		

Bill of Materials Listing

TransArctic Canada Inc.

9/7/2021
Page 1 of 1

Product Number	Date	Description	Uof M	Weight	Yield		
Line	Qty	Component Prod#	Rev#	Description	Bin	Unit	
KBB00028	8/1/2012	0		Bag Kit, Fasteners, Pivot Assy, KBB00003		115.26	0
10	1	BTM08100	0	Bolt, 1/2-13 x 1.0" w/ Grease Nipple FTG		each	
20	1	BTP08653		Bolt, Hex, 1/2-13unc, 6.5", 5, Plt, FT		each	
30	1	BTQ08100		Bolt, Hex, 1/2-13unc, 1.00", 8, Plt		each	
40	3	BTQ08101		Bolt, Hex, 1/2-20unf, 1.00", 8, Plt		each	
50	3	CSF08076		Capscrew, FH, 1/2-20unf x .75",Alloy,Plt		each	
60	4	NTP07000		Nut, Hex, 7/16-14unc, 5, Plt		each	
70	4	WFN07000		Washer, Flat, 7/16", 2, Plt		each	
80	3	WFQ08000		Washer, Flat, 1/2", 8, Plt		each	
90	2	WFS08001		Washer, Flat, 1/2", 8, USS, Plt		each	
100	4	WLP07000		Washer, Lock, 7/16", 5, Plt		each	
110	6	WLQ08000		Washer, Lock, 1/2", 8, Plt		each	

Bill of Materials Listing

TransArctic Canada Inc.

9/7/2021
Page 1 of 1

Product Number	Date			Description	Uof M	Weight	Yield	
Line	Qty	Component	Prod#	Rev#	Description	Bin	Unit	
KCB95501				0	Kit, Compressor, Tilt, 12v, TM-55/65,'21		0.48	0
10	4	BTC12035			Bolt, Hex, 12 x 1.75 x 35mm, 10.9,Plt,FT		each	
20	4	WFA12000			Washer, Flat, 12mm, 8.8, Plt		each	
30	4	WLA12000			Washer, Lock, 12mm, 8.8, Plt		each	

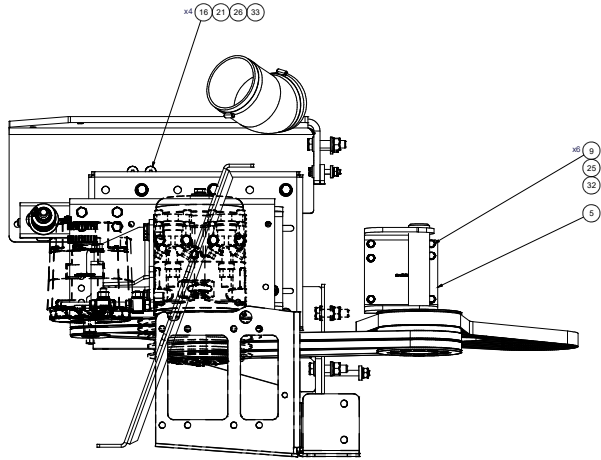

NOTE: USE QTY (5) RV104083 TO FASTEN BMN0047 TO ENGINE BAY ENCLOSURE.

NOTE: REMOVE OEM CAC TUBE AND CUT TO SUIT. REFER TO "MOUNT PAPER WORK" FOR DIMENSION.

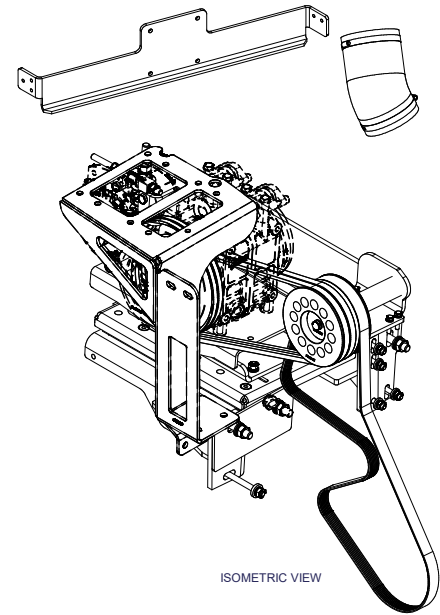

ISOMETRIC VIEW

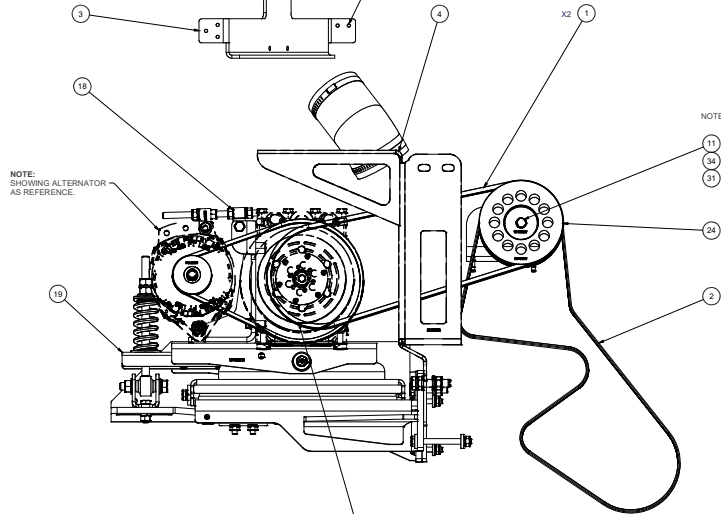

NOTE: SHOWING ALTERNATOR AS REFERENCE.

NOTE: RE-USE OEM FASTENERS

NOTE: SHOWING TRANSARCTIC COMPRESSOR PARTS CMV33844 (550cc) CMV28844 (835cc) AS REFERENCE.

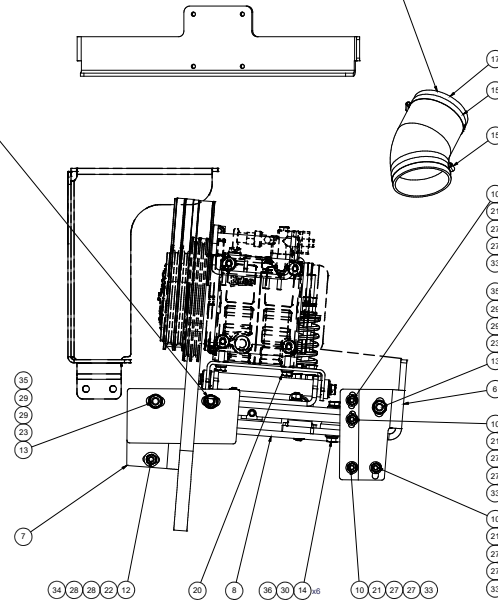

NOTES:
 1) USE SERVICABLE THREADLOCKER ON ALL FASTENERS TO ENGINE COMPONENTS AND TORQUE ALL BOLTS TO S.A.E. SPECIFICATIONS.
 2) SEE "TRANSARCTIC A/C COMPRESSOR MOUNT INSTALLATION DISCLAIMER".

QTY	U/M	PART NUMBER	DESCRIPTION
6	EACH	WLQ08000	WASHER, LOCK, 1/2", 8, PLT
2	EACH	WLA16000	WASHER, LOCK, 16mm, 8.8, PLT
2	EACH	WLA12000	WASHER, LOCK, 12mm, 8.8, PLT
8	EACH	WLA10000	WASHER, LOCK, 10mm, 8.8, PLT
6	EACH	WLA08000	WASHER, LOCK, 8mm, 8.8, PLT
1	EACH	WFS12001	WASHER, FLAT, STEP, 12mm, 69.85, PLT
6	EACH	WFO08000	WASHER, FLAT, 1/2", 8, PLT
4	EACH	WFA16000	WASHER, FLAT, 16mm, 8.8, PLT
2	EACH	WFA12002	WASHER, FLAT, 12mm, HVY, 8.8, PLT
8	EACH	WFA10002	WASHER, FLAT, 10mm, HVY, 8.8, PLT
4	EACH	WFA10000	WASHER, FLAT, 10mm, 8.8, PLT
6	EACH	WFA08000	WASHER, FLAT, 8mm, 8.8, PLT
1	EACH	PLA8101	PULLEY, ASSY, IDLER, 90/28 0/2" STL, PRT
2	EACH	NTA16000	NUT, HEX, 16 x 2, 8.8, PLT
1	EACH	NTA12000	NUT, HEX, 12 x 1.75, 8.8, PLT
8	EACH	NTA10000	NUT, HEX, 10 x 1.5, 8.8, PLT
1	EACH	KCB95501	KIT, COMPRESSOR, TILT, 12v, TMS5/65, 21
1	EACH	KBR00003	MT KIT, PLATFORM, TRANSIT, ADM, 21
1	EACH	KAC05502	KIT, ALTERNATOR, TMS5, DRIVER SIDE, 13
1	EACH	HD04530	HOSE, FLEX, CAC, ELB, SILICON, 4.5 X 30 DEG, BLU
4	EACH	CSF10045	CAPSCREW, FH, 10 x 1.5 x 45mm, 10.9, PLT
2	EACH	CD77301	CLAMP, GRAB, #22, 3"-5" (76.2/127mm)
6	EACH	BTQ08126	BOLT, HEX, 1/2-20UNF x 1.25, 8, PLT
2	EACH	BTCL6070	BOLT, HEX, 16 x 2 x 70mm, 10.9, PLT
1	EACH	BTCL1210	BOLT, HEX, 12 x 1.25 x 120mm, 10.9, PLT
1	EACH	BTCL2030	BOLT, HEX, 12 x 1.25 x 30mm, 10.9, PLT
4	EACH	BTCL0060	BOLT, HEX, 10 x 1.5 x 60mm, 10.9, PLT
6	EACH	BTCL0035	BOLT, HEX, 8 x 1.25 x 35mm, 10.9, PLT
1	EACH	BMN8019	BKT, MAIN, BRACE, ICSE, 21
1	EACH	BMN8019	BKT, MAIN, RR, WELDMT, ICSE, 21
1	EACH	BMN8016	BKT, MAIN, FRT, WELDMT, ICSE, 21
1	EACH	BMN8019	BKT, JACK SHAKY CLIMBERS, ICSE, 21
1	EACH	BMK30052	BRK, RESERVOIR TANK, LABEL, ICSE, 21
1	EACH	BMK30047	BRK, BRACE, AIR FILTER BOX
1	EACH	BE163096	BELT, 5/8", 2086mm (82.5')
2	EACH	BEL21626	BELT, B GR, 1626mm (64") (BX63)

DRAWN: Jose Rodriguez 8/30/2021
 CHECKED: Val Jakobow 8/30/2021
 REV ECN DESCRIPTION DATE BY: James Stewart 8/30/2021
 APPROVED: Ron Ingram 8/30/2021
 DATE: Dale Mason 8/30/2021

TRANSARCTIC INC.
 MT KIT, ISL, ICSE, TM-55/65, ALT, '21

DWS NO: KMC96631
 SHEET 1 OF 1

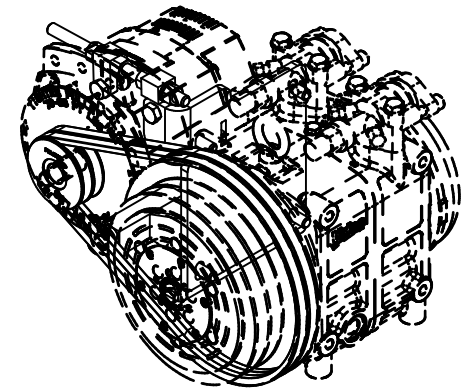
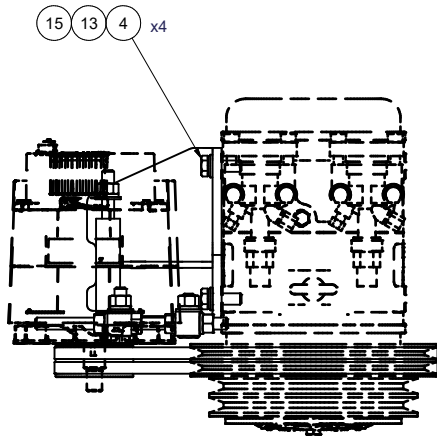

ISOMETRIC VIEW

NOTE:
SHOWING TRANSARCTIC
COMPRESSOR PART#
CMV33644 (550cc)/
CMV38844 (635cc)
AS REFERENCE.

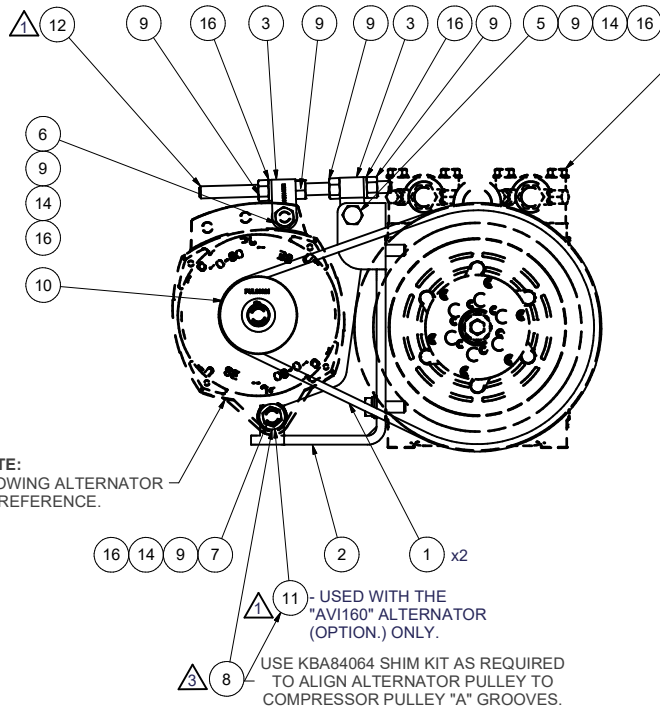

NOTE:
SHOWING ALTERNATOR
AS REFERENCE.

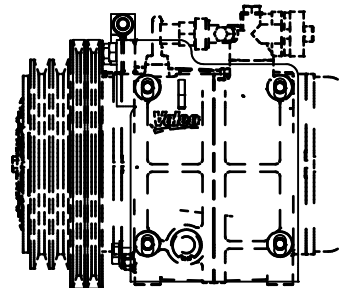

NOTES:

- 1) USE SERVICABLE THREADLOCKER ON ALL FASTENERS TO ENGINE COMPONENTS AND TORQUE **ALL** BOLTS TO S.A.E. SPECIFICATIONS.
- 2) SEE "TRANSARCTIC A/C COMPRESSOR MOUNT INSTALLATION DISCLAIMER".
- 3) WEIGHT: 18.11 LB

16	5	EACH	WVQ08000	WASHER, LOCK, 1/2", 8, PLT
15	4	EACH	WLA12000	WASHER, LOCK, 12mm, 8.8, PLT
14	4	EACH	WVQ08000	WASHER, FLAT, 1/2", 8, PLT
13	4	EACH	WFA12000	WASHER, FLAT, 12mm, 8.8, PLT
12	1	EACH	TRD08080	THREADED, ROD, 1/2-13UNC x 8", 5 PLT
11	1	EACH	SCD05513	SPACER, COL, DRL, 5.51mm x 25.4o x 12.7i
10	1	EACH	PUL03321	PULLEY, ALT, IDLER, 3.25"o, 2A
9	7	EACH	NTQ08000	NUT, HEX, 1/2-13UNC, 8, PLT
8	1	EACH	KBA84064	BAG KIT, ALT SHIM, KC84064, KAC65501/02
7	1	EACH	BTQ08653	BOLT, HEX, 1/2-13UNC x 6.50, 8, PLT
6	1	EACH	BTQ08200	BOLT, HEX, 1/2-13UNC x 2.00, 8, PLT
5	1	EACH	BTQ08150	BOLT, HEX, 1/2-13UNC x 1.50, 8, PLT
4	4	EACH	BTC12035	BOLT, HEX, 12 x 1.75 x 35mm, 10.9, PLT
3	2	EACH	BMT10011	BKT, TENR, BLOCK, OFFSET, 3mm
2	1	EACH	BMC96663	BKT, MAIN, ALT, WELDM'T, ISL, TM-65/55, '13
1	2	EACH	BEL11118	BELT, A gr, 1040mm (41")
ITEM	QTY	U/M	PART NUMBER	DESCRIPTION

BILL OF MATERIALS

DRAWN	vjakowlew	10/04/16
CHECKED	Jose Rodriguez	10/04/16
QA	James Stewart	10/4/2016
MFG	James Stewart	10/04/16
APPROVED	Dale Mason	10/04/16

TRANSARCTIC INC.

TITLE
KIT, ALTERNATOR, TM-65, DRIVER
SIDE, '13

SIZE C DWG NO KAC65502 REV 3

3	ADDED KBA84064 SHIM BAG KIT.	02/03/2022	VALJ	
2	WAS KBA96663 FASTENER BAG KIT.	10/11/2021	JRR	
1	WAS TRD08060 ADDED SCD05513	05/11/2021	VALJ	
0	RELEASED TO PRODUCTION.	10/4/2016	JRR	
REV:	ECN:	DESCRIPTION:	DATE:	BY:
THIS DRAWING CONTAINS PROPRIETARY CONFIDENTIAL INFORMATION OWNED BY TRANSARCTIC CANADA INC. THE DOCUMENT AND THE INFORMATION IN IT ARE NOT TO BE USED, DISCLOSED OR REPRODUCED WITHOUT EXPRESS WRITTEN PERMISSION OF THE COMPANY.				
UNSPECIFIED TOLERANCES: [ALT. DIM.]				
ONE DECIMAL PLACE (X)	MM	(INCH)		
TWO DECIMAL PLACE (XX)	.25	(.010)		
THREE DECIMAL PLACE (XXX)	.10	(.005)		
FRACTIONAL +/- .002"	ANGULAR +/- .50°			
		THIRD ANGLE PROJECTION		

DRAWING UNIT OF MEASURE: MM [INCH] SCALE 1:4 SHEET 1 OF 1

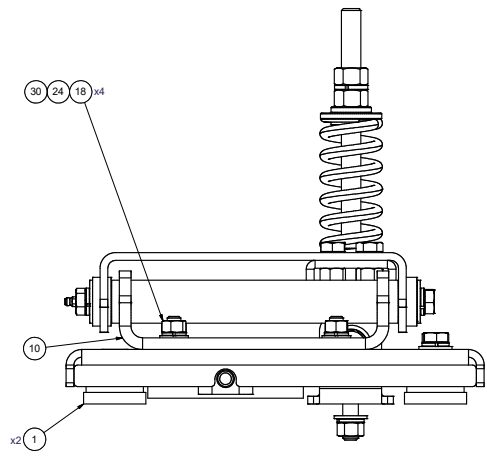
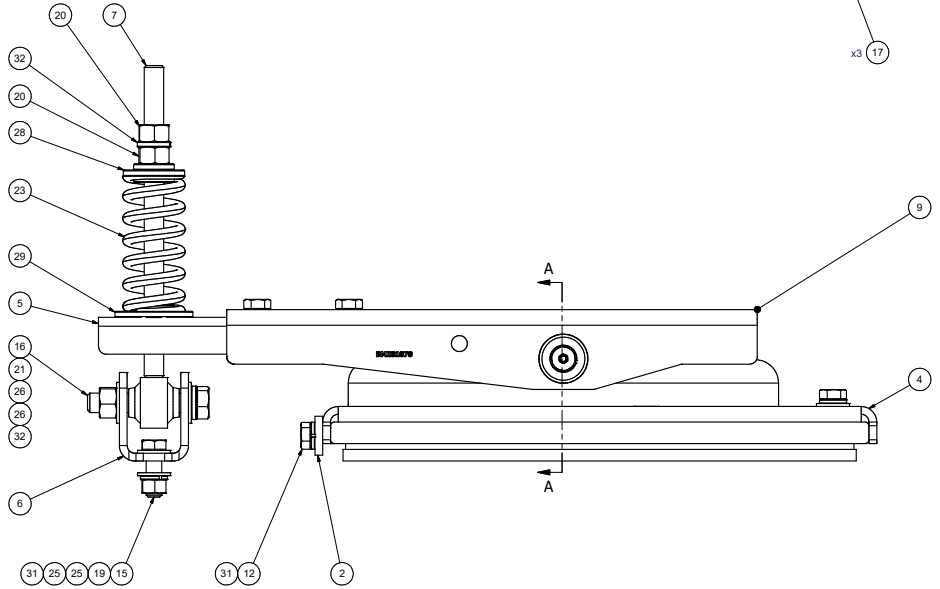
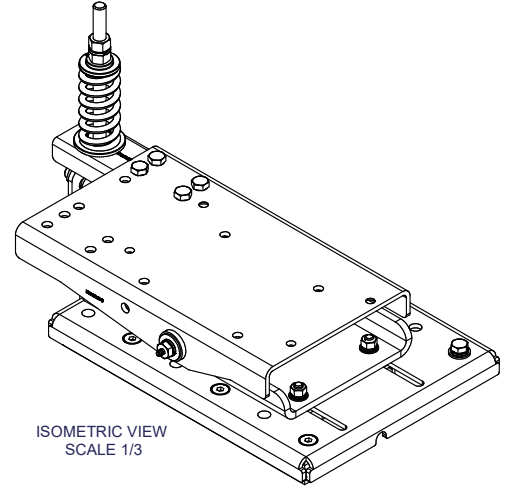
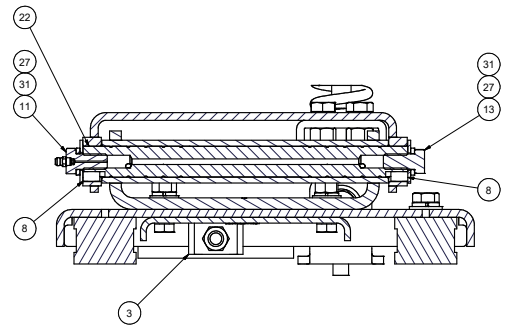
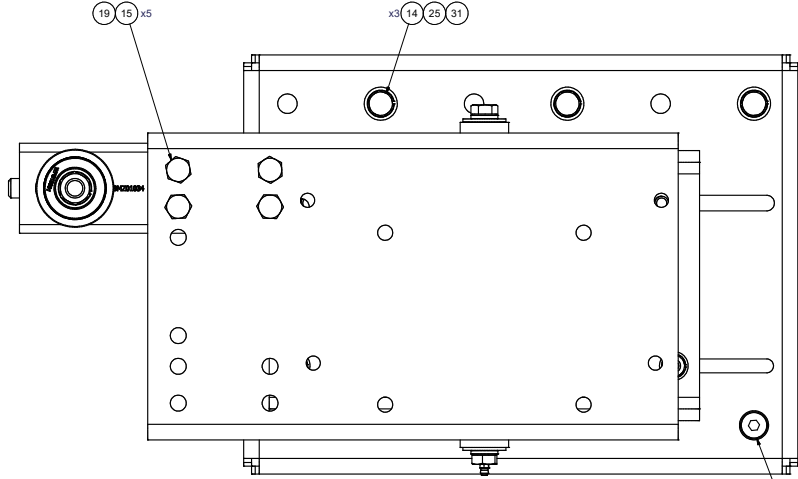

ITEM	QTY	U/M	PART NUMBER	DESCRIPTION
32	2	EACH	WLQ10000	WASHER, LOCK, 5/8", 8, PLT
31	7	EACH	WLQ08000	WASHER, LOCK, 1/2", 8, PLT
30	4	EACH	WLP07000	WASHER, LOCK, 7/16", 5, PLT
29	1	EACH	WFS27001	WASHER, FLAT, DBL STEP, 28mm, 63.5, PLT
28	1	EACH	WFS16001	WASHER, FLAT, DBL STEP, 16mm, 50mm, PLT
27	2	EACH	WFS08001	WASHER, FLAT, 1/2", 8, USS, PLT
26	2	EACH	WFO10000	WASHER, FLAT, 5/8", 8, PLT
25	5	EACH	WFO08000	WASHER, FLAT, 1/2", 8, PLT
24	4	EACH	WFO07000	WASHER, FLAT, 7/16", 2, PLT
23	1	EACH	SPR00002	SPRING, COMP, R/H, 110 x 50 x 8.4, RED
22	1	EACH	PIS01010	SHAFT, STL, GREASE, ADM TRANSIT, '12
21	1	EACH	NTQ10001	NUT, HEX, 5/8-18UNF, 8, PLT
20	2	EACH	NTQ10000	NUT, HEX, 5/8-11UNC, 8, PLT
19	5	EACH	NTQ08000	NUT, HEX, 1/2-13UNC, 8, PLT
18	4	EACH	NTPO7000	NUT, HEX, 7/16-14UNC, 5, PLT
17	3	EACH	CSF08076	CAPSCREW, FH, 1/2-20UNF x .75", ALLOY, PLT
16	1	EACH	BTQ10351	BOLT, HEX, 5/8-18UNF x 3.50, 8, PLT
15	5	EACH	BTQ08150	BOLT, HEX, 1/2-13UNC x 1.50, 8, PLT
14	3	EACH	BTQ08101	BOLT, HEX, 1/2-20UNF x 1.00, 8, PLT
13	1	EACH	BTQ08100	BOLT, HEX, 1/2-13UNC x 1.00, 5, PLT, FT
12	1	EACH	BTP08653	BOLT, HEX, 1/2-13UNC x 6.50, 5, PLT, FT
11	1	EACH	BTM08100	BOLT, 1/2-13 x 1.0" w/ GREASE NIPPLE FTG
10	1	EACH	BMZ01072	BKT, ASSY, CRADLE, PIVOT, 05G, TRANSIT, '21
9	1	EACH	BMZ01070	BKT, MAIN, PIVOT, ASSY, 05G, TRANSIT, '21
8	2	EACH	BMZ01041	Shaft Key, 5/16" SQ x .540" Long
7	1	EACH	BMZ01040	BKT, ASSY, THRD ROD, ISOLATOR, ADM, '12
6	1	EACH	BMZ01037	BKT, FORK, KNUCKLE-JOINT, ADM, '12
5	1	EACH	BMZ01034	BKT, SPRING, SUPPORT ARM, ADM, '12
4	1	EACH	BMZ00043	BKT, MAIN, BASE PL, '13
3	1	EACH	BMN80104	BKT, MAIN, SLIDE, ASSY, ICRE
2	1	EACH	BMN80025	BKT, BACK, PL, SLIDE, IC, RE300
1	2	EACH	BMN80008	VIBRATION ISOLATOR, BAR, 16.50 x 2 x 1.50

NOTES:
 1) USE SERVICABLE THREADLOCKER ON ALL FASTENERS TO ENGINE COMPONENTS AND TORQUE ALL BOLTS TO S.A.E. SPECIFICATIONS.
 2) SEE "TRANSARCTIC A/C COMPRESSOR MOUNT INSTALLATION DISCLAIMER".

REVISIONS 0 RELEASED TO PRODUCTION: 3/25/2021 JRR 1 James Stewart 3/25/2021 2 Dale Mason 3/25/2021		DRAWN: vjakowlew 3/25/2021 CHECKED: Jose Rodriguez 3/25/2021 APPROVED: James Stewart 3/25/2021 Dale Mason 3/25/2021		TRANSARCTIC INC. TITLE: MT KIT, PLATFORM, TRANSIT, ADM, '21 SIZE: D DWG NO: KBB00003 REV: 0	
UNspecified TOLERANCES: ALL DIMS IN INCH ONE DECIMAL PLACE (X1) .10 TWO DECIMAL PLACE (X2) .05 THREE DECIMAL PLACE (X3) .010 FRACTIONAL: 1/16" MINIMUM		THIRD ANGLE PROJECTION		DRAWING UNIT OF MEASURE: MM (INCH) SCALE: 1:2 SHEET 1 OF 1	

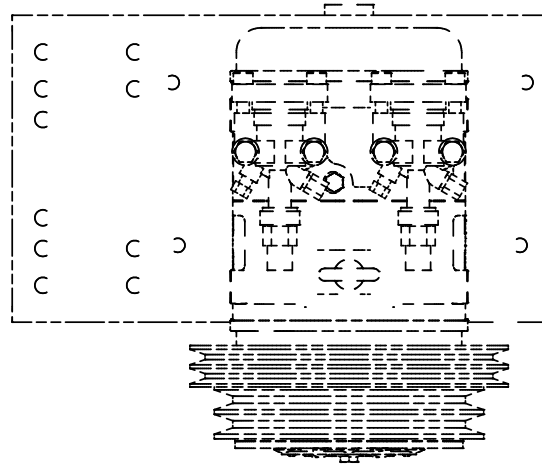

NOTE:
SHOWING TRANSARCTIC
COMPRESSOR
CMV38844 (635cc)
AS REFERENCE.

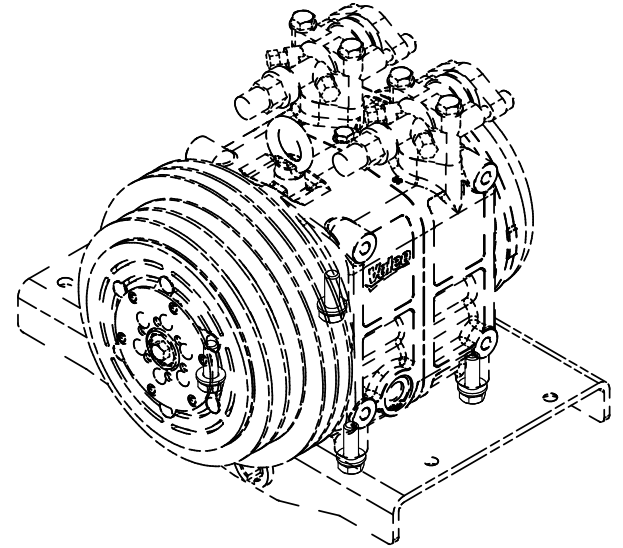
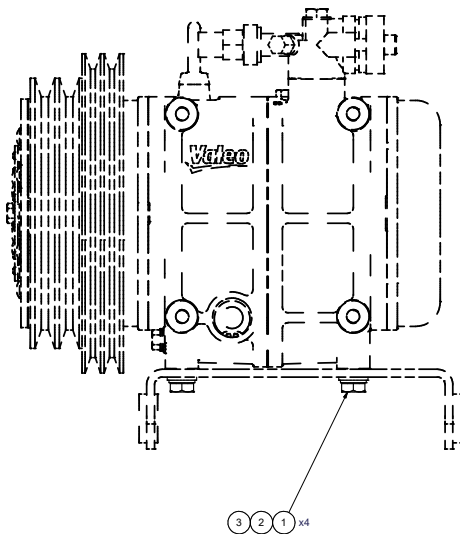
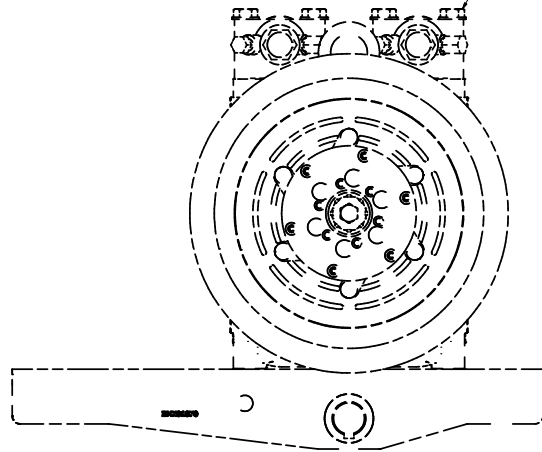

ISOMETRIC VIEW

NOTES:

- 1) USE SERVICABLE THREADLOCKER ON ALL FASTENERS TO ENGINE COMPONENTS AND TORQUE ALL BOLTS TO S.A.E. SPECIFICATIONS.
- 2) SEE "TRANSARCTIC A/C COMPRESSOR MOUNT INSTALLATION DISCLAIMER".

ITEM	QTY	U/M	PART NUMBER	DESCRIPTION
3	4	EACH	WLA12000	WASHER, LOCK, 12mm, 8.8, PLT
2	4	EACH	WFA12000	WASHER, FLAT, 12mm, 8.8, PLT
1	4	EACH	BTC12035	BOLT, HEX, 12 x 1.75 x 35mm, 10.9, PLT

BILL OF MATERIALS

DRAWN	8/27/2021	
Checked	8/27/2021	
By	8/27/2021	
Approved	8/27/2021	
DRAWING UNIT OF MEASURE		MM (INCH)
SCALE		1:2

REV	ECN	DESCRIPTION	DATE	BY
0		RELEASED TO PRODUCTION	8/27/2021	JRR
1		James Stewart	8/27/2021	James Stewart
2		Dale Mason	8/27/2021	Dale Mason

UNSPECIFIED TOLERANCES: ALL DIMS IN INCHES
 ONE DECIMAL PLACE (.X) 1/16 INCH
 TWO DECIMAL PLACE (.XX) 1/32 INCH
 THREE DECIMAL PLACE (.XXX) 1/64 INCH
 FRACTIONAL: 1/8, 1/4, 3/8, 1/2, 5/8, 3/4, 7/8

THIRD ANGLE PROJECTION

TITLE
KIT, COMPRESSOR, TILT, 12V,
TM55/65, '21

SIZE
DWG NO
KCB95501

REV
0

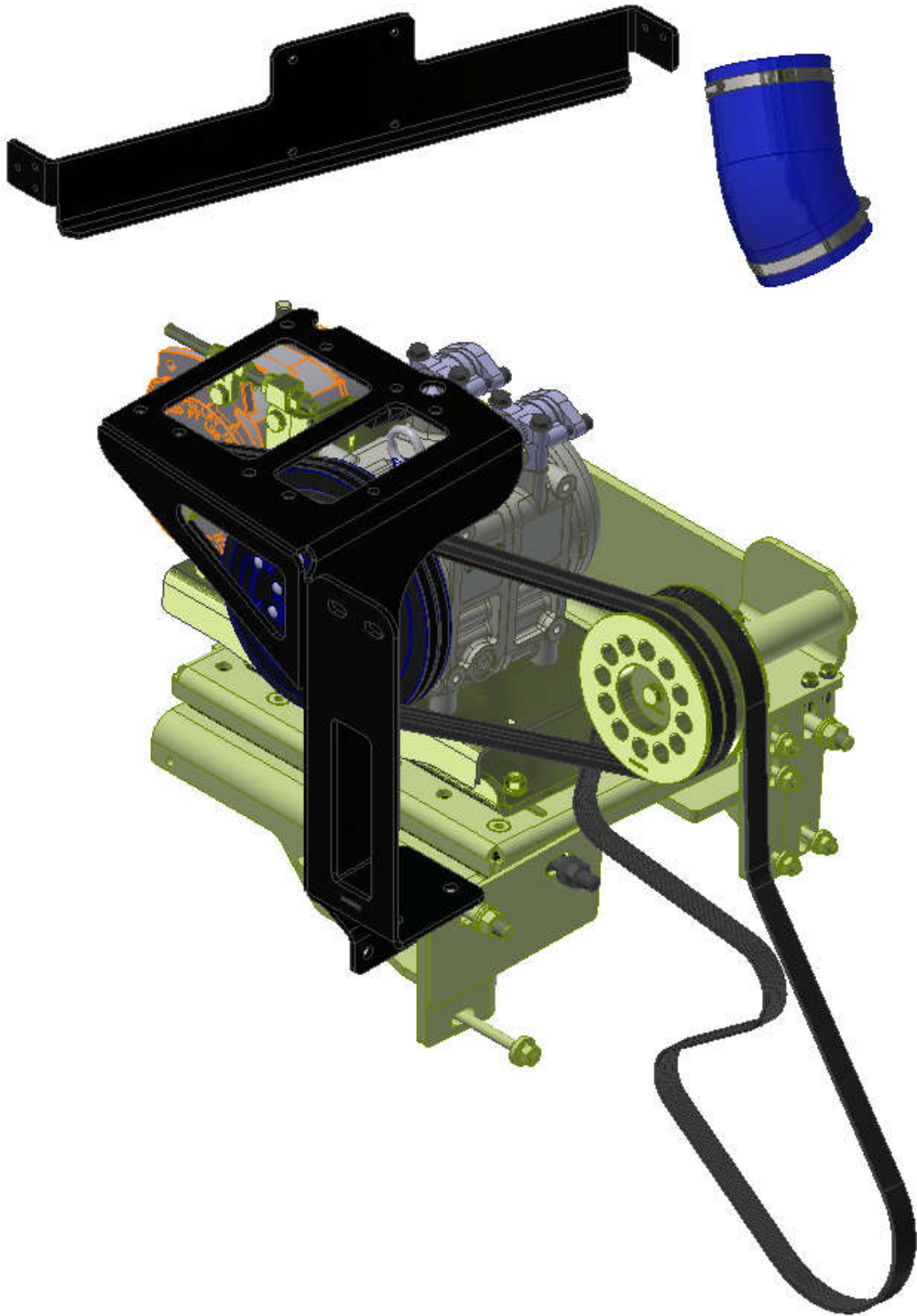

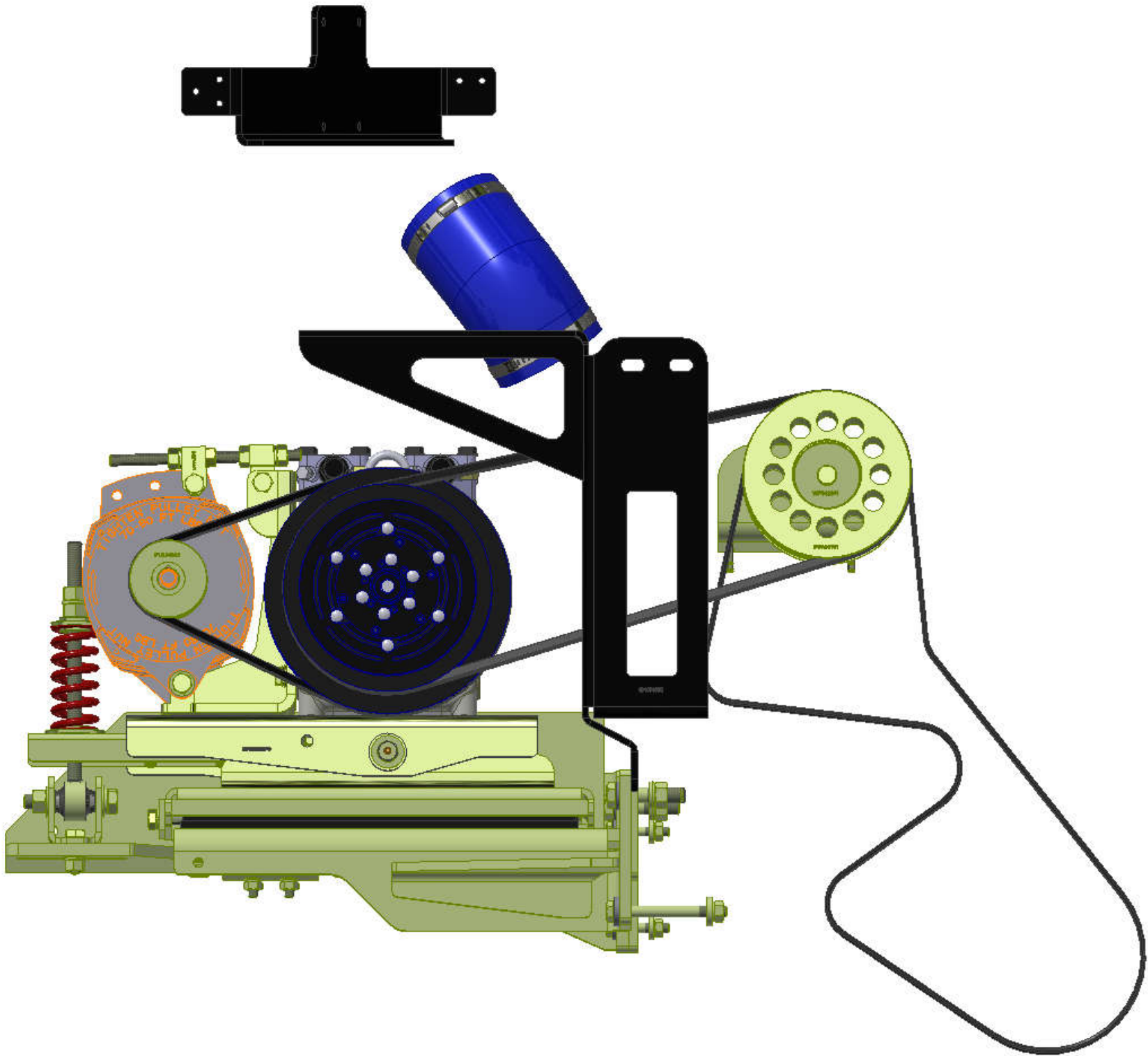

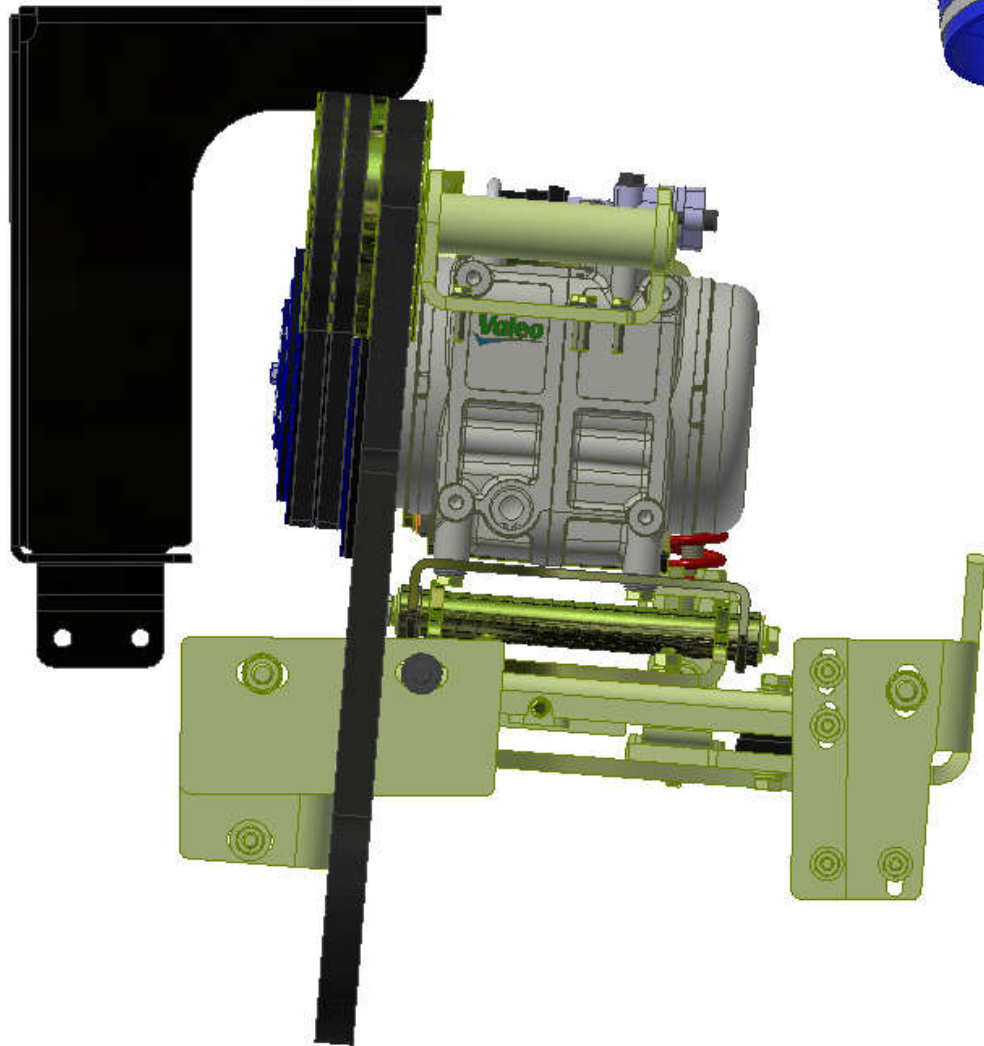

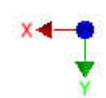
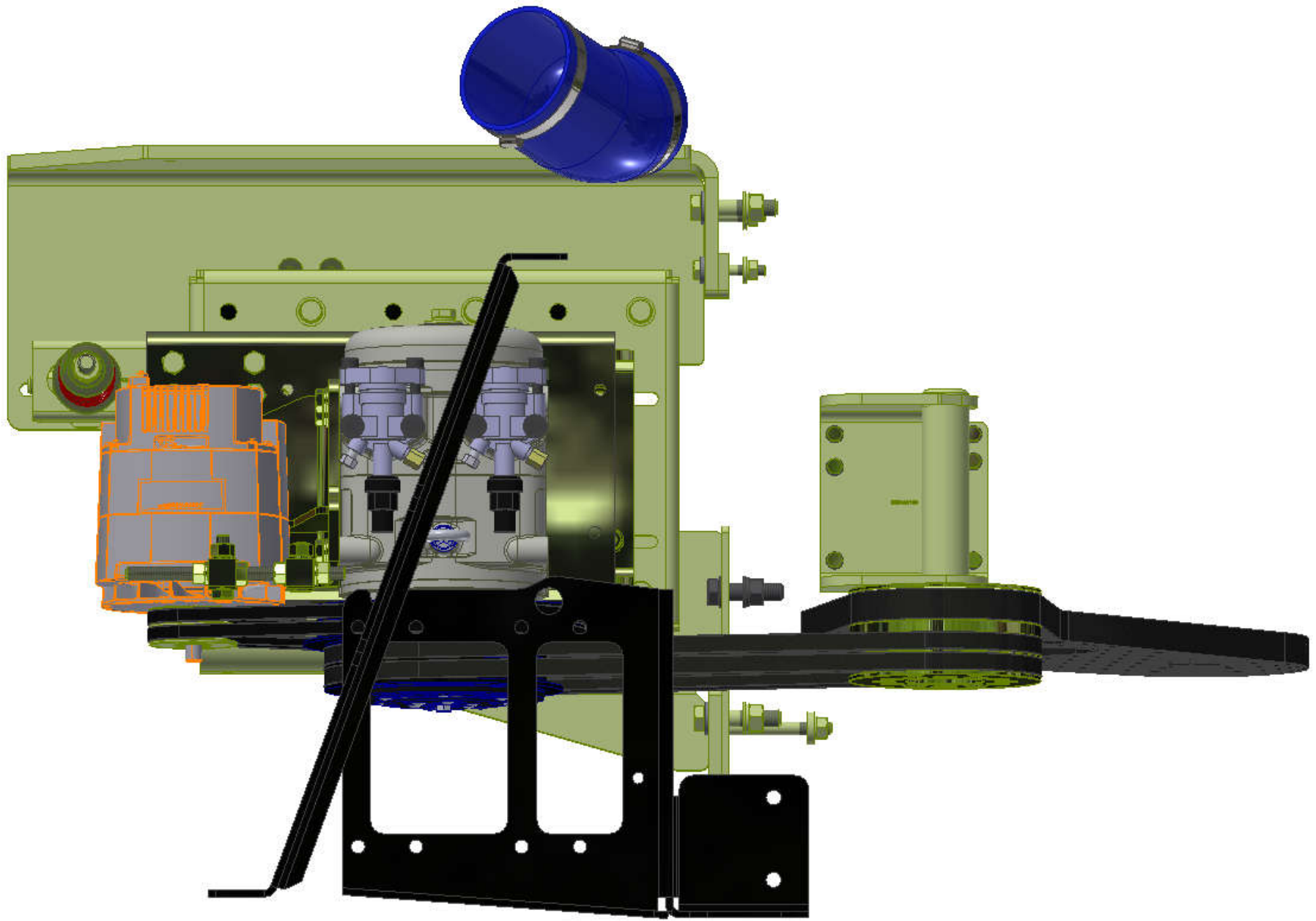

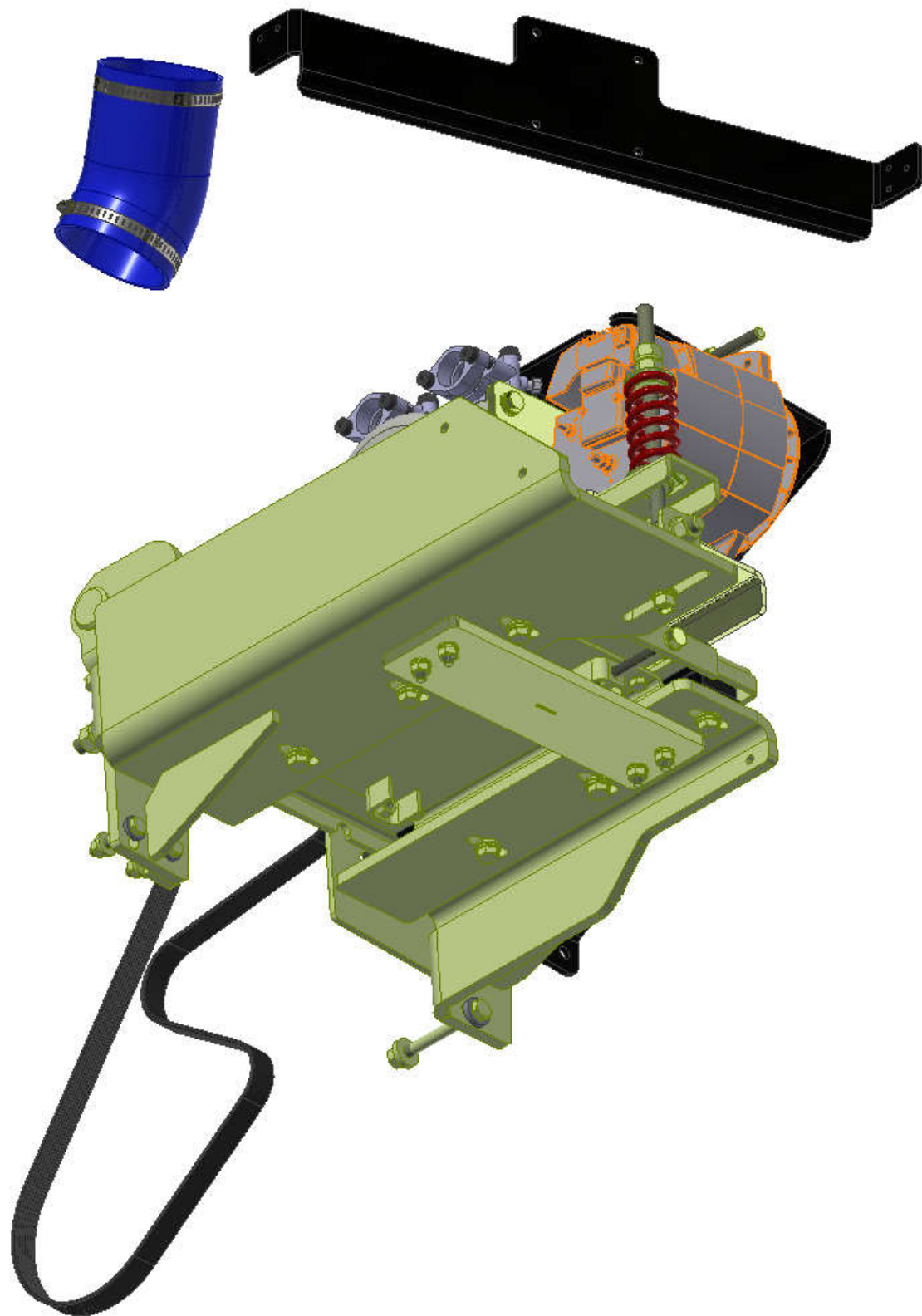

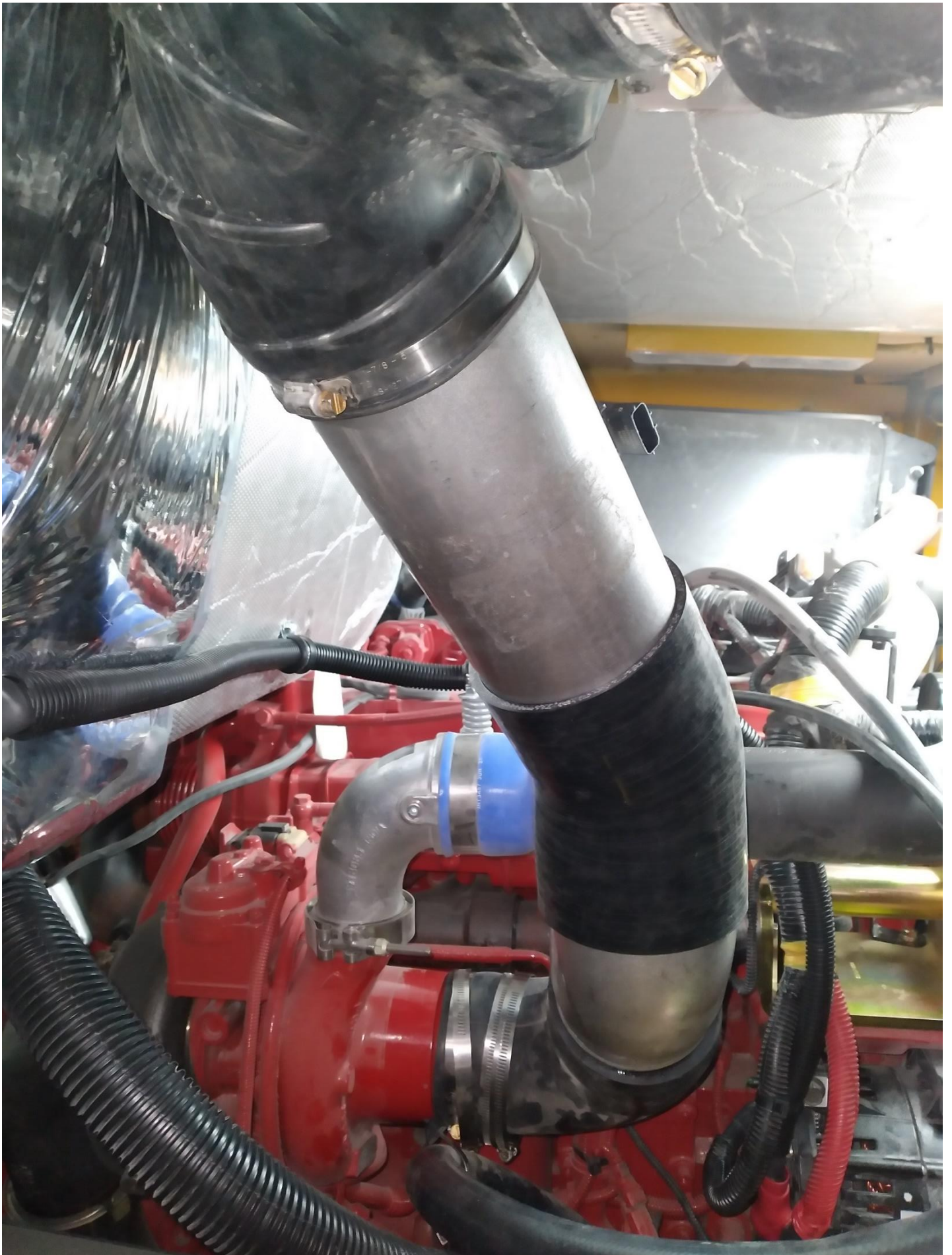



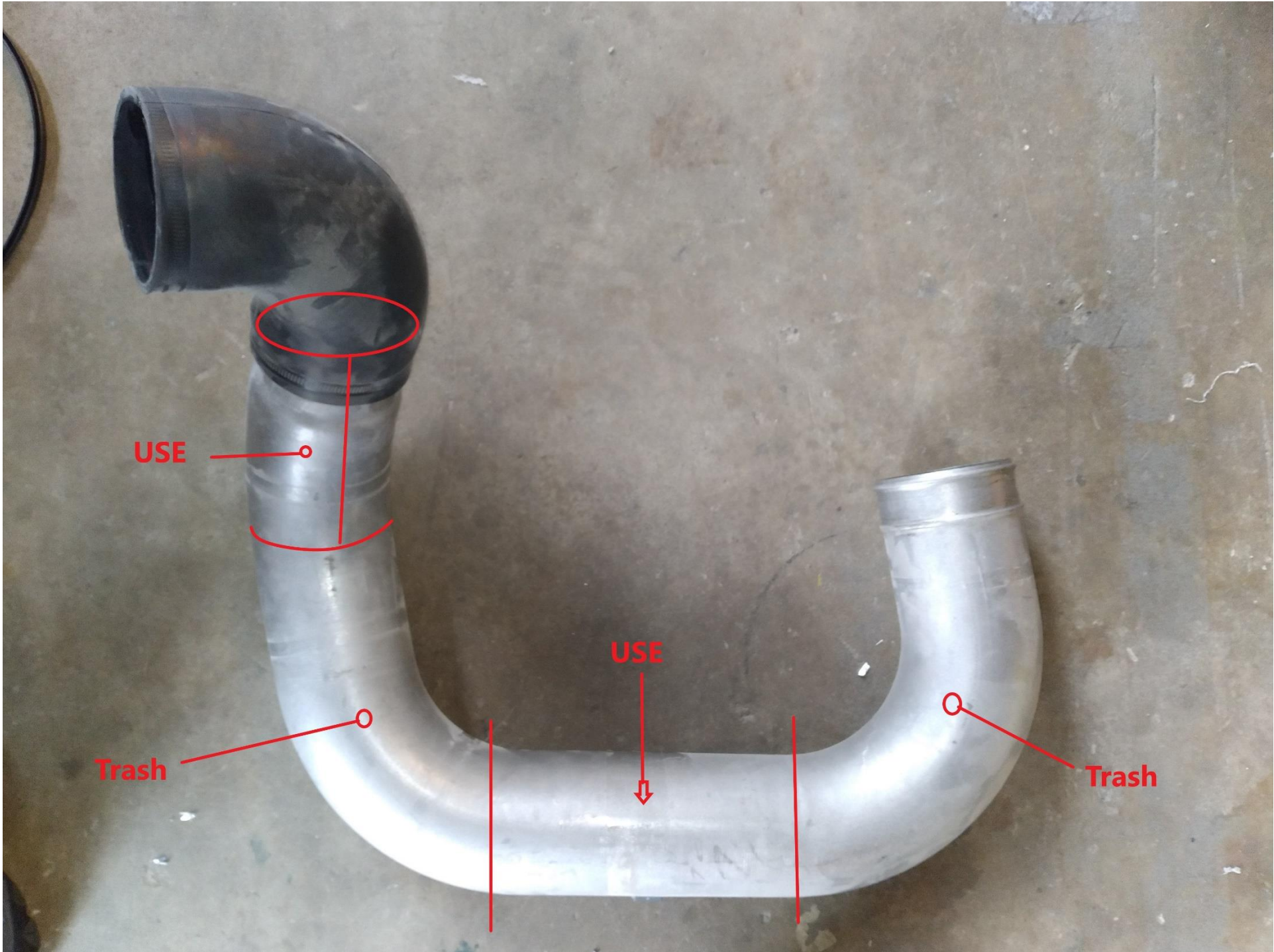

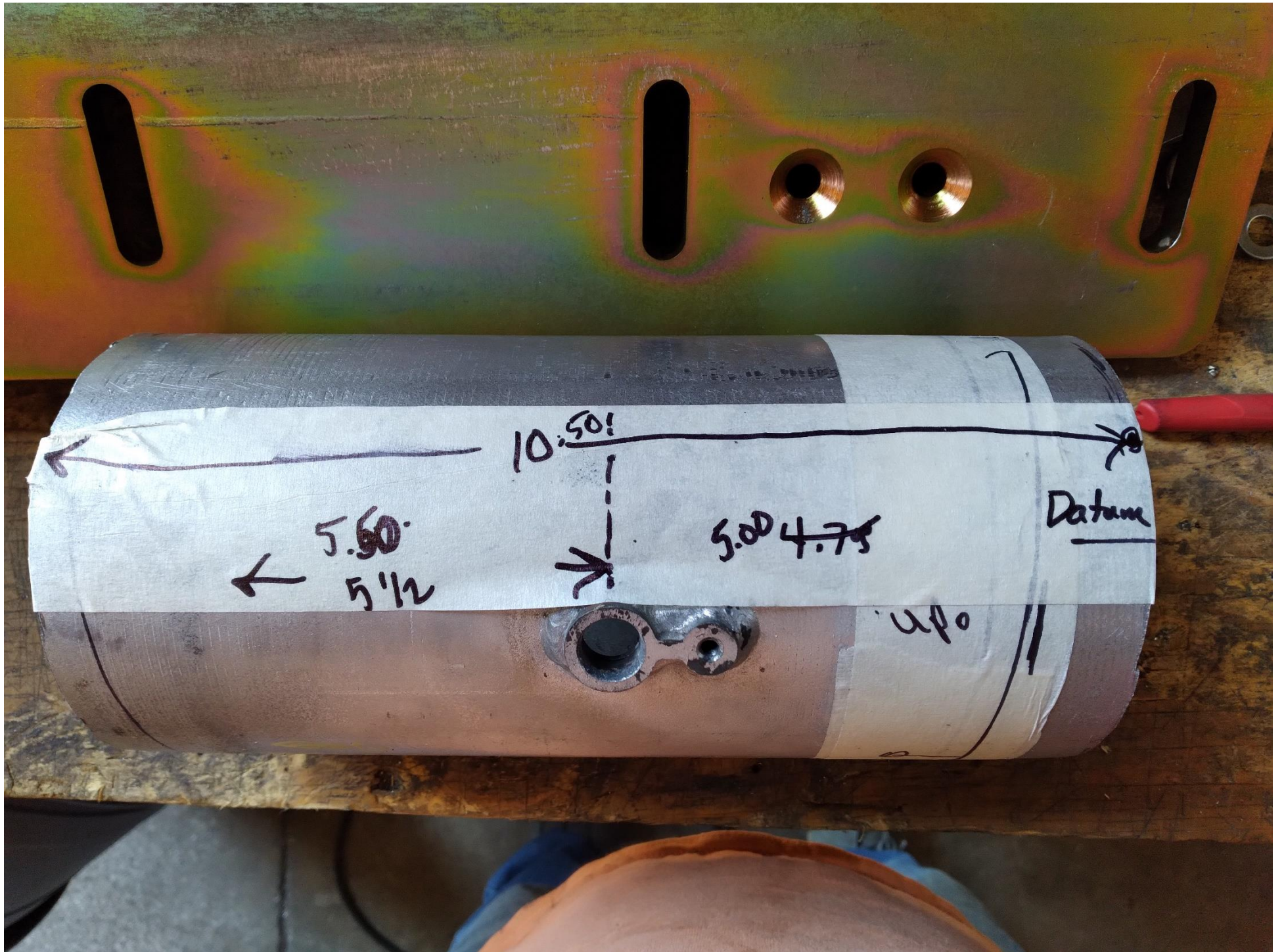

← 10.50 →
← 5.60 →
5 1/2
5.00 4.75
Datum

240





4.75

1 RAD

TransArctic A/C Compressor Mount Installation Disclaimer

All compressor mounts should be installed by qualified and trained personnel using proper tools and equipment in safe working conditions following industry standard guidelines for motor vehicle service and repair.

The installer of any compressor mount purchased from TransArctic must undertake all responsibility of issues arising from that compressor bracket being installed on any vehicle. As well as insure that a **proper and sufficient ground** is established between the compressors' clutches and the vehicle's engine. Mount functionality, operation and durability can all be compromised by an incompetent installation.

Due to the many different situations, parameters and application criteria, which are beyond the compressor mount manufacturer's control, TransArctic does not warrant design, durability, or operational functionality of any compressor mount improperly installed by another party.

With no implied guarantees it is the mount installer's strict responsibility to determine safety and functionality, of the compressor mount, at the time of installation.

Please contact TransArctic with any issue arising from installation so we may better improve the product. If you have any reservations about the compressor mount integrity contact TransArctic immediately at 1-877-COLD-AIR.

Mark OEM tensioner location

Install Kit

Check for Interferences

Check to ensure that the proper OEM tensioner orientation is maintained

Run engine with A/C system engaged for at least 10 minutes to run in belt

Check OEM tensioner orientation and adjust as required

Responsabilidad limitada de TransArctic en la instalación del soporte del compresor

Todos los soportes de los compresores deben ser instalados por personas calificadas y entrenadas, usando para ello los equipos y herramientas necesarios para esta labor en buenas condiciones y según las normas y guías para el servicio y/o reparación de motores de vehículos.

El instalador de los soportes comprados en TransArctic asume toda la responsabilidad de cualquier problema que surga en el soporte del compresor al vehículo; de igual manera es responsable que el cable a tierra sea conectado entre el embrague del compresor y el motor del vehículo.

Se advierte que el buen funcionamiento y la durabilidad del soporte pueden ser comprometidos por defectos en su instalación.

Debido a las diversas situaciones que se puedan presentar fuera del control del fabricante, TransArctic no garantiza el diseño, la durabilidad o el correcto funcionamiento de cualquier equipo inapropiadamente instalado por terceros.

Esta sobreentendido que el Instalador del montaje del compresor es estrictamente responsable de la seguridad y funcionamiento del equipo en el momento de la instalación.

Si tuviera algún problema o duda acerca de la instalación del soporte del compresor pongase en contacto inmediatamente con TransArctic al teléfono 1-877-COLD-AIR de modo que podamos mejorar nuestro producto.

Note la ubicación del medidor de tensión OEM

Instale el equipo

Controlar si hay interferencias.

Asegurese que el medidor de tensión mantenga la orientación justa.

Encienda el motor por lo menos 10 minutos con el sistema A/C enganchado para que la correa corra

Controle la orientación justa del medidor de tensión y ajuste a las condiciones requeridas del fabricante