

Bill of Materials Listing

TransArctic Canada Inc.

4/11/2017
Page 1 of 1

Product Number	Description	Date	Weight	Uof M	Yield
Line Component Prod#	Description	Bin Unit	Qty		
KMC94195	Mt Kit, ISL-D, 2016, HDX, O5G, 24V,'16		6/1/2016	153.11	0
10 BEL32389	Belt, Banded B gr, 2388mm (94")		each	1	
20 BMC83125	Bkt, Weldm't, Adapter PI, ISL, HDX, '13		each	1	
30 BMC90012	Bkt, Weldm't, Main Base, HDX, 16'		each	1	
40 BMC90022	Bkt, Main, Idler, Weldm't, ISL, HDX, '16		each	1	
50 KCB94195	Kit, Compressor, 24V,O5G, '16		each	1	
60 KPC89022	Kit, Pulley, ISL, 8.9L, 2B/X,'13		each	1	
65 PUA05001	Pulley, Assy, Idler, B/S, 5", Stl, Plt		each	1	
70 PUA05012	Pulley, Assy, Idler,B/BX gr,5", STL,Plt		each	1	
80 SCD16012	Spacer, Col, Drl,16 mm x 34.9o x 12.3i		each	1	
85 SCD21912	Spacer, Col, Drl,21.9mm x 25.4o x 12.3i		each	1	
90 SLV17012	Sleeve, Pulley, 16.9o x 22.23mm x 12.32i		each	2	
100 KBC94195	Bag Kit, Fasteners,KMC94195 & KMC92495		each	1	

Bill of Materials Listing

TransArctic Canada Inc.

6/23/2017
Page 1 of 1

Product Number		Description	Bin	Date	Weight	Uof M	Yield
Line	Component Prod#	Description		Unit	Qty		
KBC94195		Bag Kit, Fasteners, KMC94195 & Others.		6/1/2016	2.36		0
10	BTC10045	Bolt, Hex, 10 x 1.5 x 45mm, 10.9, Plt, FT		each	3		
20	BTC12080	Bolt, Hex, 12 x 1.75 x 80mm, 10.9, Plt, FT		each	2		
30	BTQ06175	Bolt, Hex, 3/8-16unc, 1.75", 8, Plt		each	5		
40	BTQ08125	Bolt, Hex, 1/2-13unc, 1.25", 8, Plt		each	2		
50	BTQ08151	Bolt, Hex, 1/2-20unf, 1.5", 8, Plt		each	2		
55	CSF08101	Capscrew, FH, 1/2-20unf x 1.0", Alloy, Plt		each	4		
60	NTA10000	Nut, Hex, 10 x 1.5, 8.8, Plt		each	3		
70	NTA12000	Nut, Hex, 12 x 1.75, 8.8, Plt		each	2		
80	NTQ06000	Nut, Hex, 3/8-16unc, 8, Plt		each	5		
90	WFA10002	Washer, Flat, 10mm, Hvy, 8.8, Plt		each	6		
100	WFA12002	Washer, Flat, 12mm, Hvy, 8.8, Plt		each	2		
110	WFS08000	Washer, Flat, 1/2", 8, Plt		each	4		
120	WFS06002	Washer, Flat, 3/8", L9, Plt		each	10		
130	WLA10000	Washer, Lock, 10mm, 8.8, Plt		each	3		
140	WLA12000	Washer, Lock, 12mm, 8.8, Plt		each	2		
150	WLQ06000	Washer, Lock, 3/8", 8, Plt		each	5		
160	WLQ08000	Washer, Lock, 1/2", 8, Plt		each	4		

Bill of Materials Listing

TransArctic Canada Inc.

6/17/2016
Page 1 of 1

Product Number	Description	Date	Weight	Uof M	Yield
Line Component Prod#	Description	Bin Unit	Qty		
KCB94195	Kit, Compressor, 24V,O5G, '16		5/31/2016	58.91	0
10	BEL11138		Belt, A gr, 1138mm (44.8") (17448)	each	2
20	BMC83114		Bkt, PI, ALT Spacer, T3RE, '13	each	1
30	BMN80008		Vibration Isolator, Bar,16.50 x 2 x 1.50	each	2
40	BMN80025		Bkt, Back, PL, Slide, IC, RE300	each	1
50	BMT10011		Bkt, Tenr, Block, Offset, 3mm	each	2
60	BMZ00043		Bkt, Main, Base PI, '13	each	1
70	KBT94195		Kit, Platform, O5G W/ Alt, '16	each	1
80	PUL03321		Pulley, ALT, Idler, 3.25"d, 2A	each	1
90	KBZ94195		Bag Kit, Fasteners, KCB94195	each	1

Bill of Materials Listing

TransArctic Canada Inc.

7/15/2016
Page 1 of 1

Product Number	Description	Date	Weight	Uof M	Yield
Line Component Prod#	Description	Bin Unit	Qty		
KBT94195	Kit, Platform, O5G W/ Alt, '16	5/31/2016	16.33		0
10	BMC90015				
	Bkt, Weldm't, Alt Extension, HDX, 16'	each	1		
20	BMN80010				
	Bkt, Main, Slide, Assy, O5G, IC, RE300	each	1		
30	BTQ06150				
	Bolt, Hex, 3/8-16unc, 1.50", 8, Plt	each	2		
40	NTP07000				
	Nut, Hex, 7/16-14unc, 5, Plt	each	4		
50	SCD29213				
	Spacer, Col, Drl,29.21mm x 25.4o x 12.7i	each	1		
60	WFN06000				
	Washer, Flat, 3/8", 2, Plt	each	2		
70	WFN07000				
	Washer, Flat, 7/16", 2, Plt	each	4		
80	WLQ06000				
	Washer, Lock, 3/8", 8, Plt	each	2		
90	WLQ07000				
	Washer, Lock, 7/16", 8, Plt	each	4		

Bill of Materials Listing

TransArctic Canada Inc.

6/17/2016
Page 1 of 1

Product Number	Description	Date	Weight	Uof M	Yield
Line Component Prod#	Description	Bin Unit	Qty		
KBZ94195	Bag Kit, Fasteners, KCB94195	6/13/2016	2.45		0
10	BTP08653				
	Bolt, Hex, 1/2-13unc, 6.5", 5, Plt, FT	each	1		
20	BTQ08101				
	Bolt, Hex, 1/2-20unf, 1.00", 8, Plt	each	4		
30	BTQ08150				
	Bolt, Hex, 1/2-13unc, 1.5", 8, Plt	each	3		
40	BTQ08200				
	Bolt, Hex, 1/2-13unc, 2.0", 8, Plt	each	1		
50	BTQ08653				
	Bolt, Hex, 1/2-13unc, 6.5", 8, Plt	each	1		
60	CSF08076				
	Capscrew, FH, 1/2-20unf x .75", Alloy, Plt	each	2		
70	NTQ08000				
	Nut, Hex, 1/2-13unc, 8, Plt	each	7		
80	TRD08120				
	Threaded, Rod, 1/2-13unc x 12", 5, Plt	each	1		
90	WFQ08000				
	Washer, Flat, 1/2", 8, Plt	each	10		
100	WLQ08000				
	Washer, Lock, 1/2", 8, Plt	each	12		

Bill of Materials Listing

TransArctic Canada Inc.

6/17/2016
Page 1 of 1

Product Number	Description	Date	Weight	Uof M	Yield
Line Component Prod#	Description	Bin Unit	Qty		
KPC89022	Kit, Pulley, ISL, 8.9L, 2B/X,'13		10/15/2013	11.51	0
10	PUL89022		Pulley, Crank, ISL, 8.9L, 2B/X, 8", '13	each	1
20	BTC10050		Bolt, Hex, 10 x 1.5 x 50mm, 10.9, Plt	each	5
30	WFA10000		Washer, Flat, 10mm, 8.8, Plt	each	5

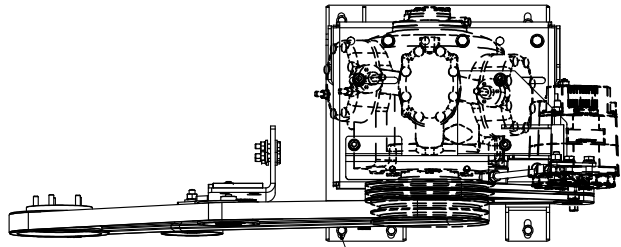

x5 7 15 24 24 27

NOTE:
CARRIER COMPRESSOR
PART#: 68PD541-124-xx

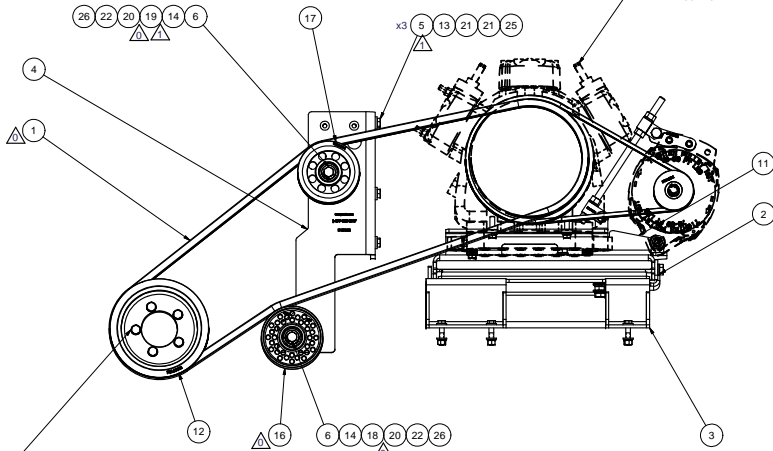

NOTE:
TORQUE TO: 48 FT-LB PLAIN & LUBRICATED W/ CLEAN ENGINE OIL (15W-40)
(HEXBOLT CAPSCREW M10 x 1.5 x 50mm)
TIGHTEN IN TWO STEPS IN A CRIS-CROSS TIGHTENING SEQUENCE PATTERN.

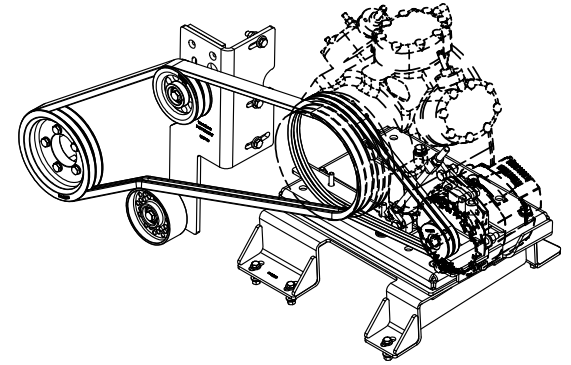
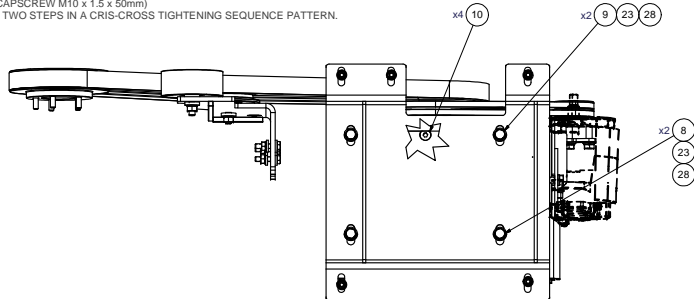

ISOMETRIC VIEW

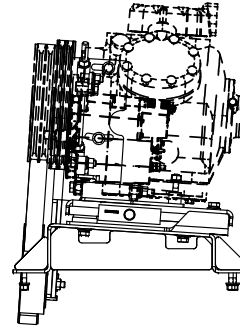

NOTES:

- 1) USE SERVICABLE THREADLOCKER ON ALL FASTENERS TO ENGINE COMPONENTS AND TORQUE ALL BOLTS TO S.A.E. SPECIFICATIONS.
- 2) SEE "TRANSARGTIC A/C COMPRESSOR MOUNT INSTALLATION DISCLAIMER".

ITEM	QTY	U/M	PART NUMBER	DESCRIPTION
28	4	EACH	WL008000	WASHER, LOCK, 1/2", 8, PLT
27	5	EACH	WL006000	WASHER, LOCK, 3/8", 8, PLT
26	2	EACH	WL120000	WASHER, LOCK, 12mm, 8.8, PLT
25	3	EACH	WL100000	WASHER, LOCK, 10mm, 8.8, PLT
24	10	EACH	WFS06002	WASHER, FLAT, 3/8", L9, PLT
23	4	EACH	WFO08000	WASHER, FLAT, 1/2", 8, PLT
22	2	EACH	WFA12002	WASHER, FLAT, 12mm, HVY, 8.8, PLT
21	6	EACH	WFA10002	WASHER, FLAT, 10mm, HVY, 8.8, PLT
20	2	EACH	SLV17012	SLEEVE, PULLEY, 16.90 x 22.23 mm x12.19
19	1	EACH	SCD21912	SPACER, COL, DRL, 21.9mm x 31.80 x12.31
18	1	EACH	SCD16012	SPACER, COL, DRL, 16 mm x 31.80 x 12.01
17	1	EACH	PUA05012	PULLEY, ASSY, IDLER, B/BX gr, 5" STL, PLT
16	1	EACH	PUA05001	PULLEY, ASSY, IDLER, B/S, 5", STL, PLT
15	5	EACH	NTQ06000	NUT, HEX, 3/8-16UNC, 8, PLT
14	2	EACH	NTA12000	NUT, HEX, 12 x 1.75, 8.8, PLT
13	3	EACH	NTA10000	NUT, HEX, 10 x 1.5, 8.8, PLT
12	1	EACH	KPC89022	KIT, PULLEY, ISL, 8.9L, 2B/X, '13
11	1	EACH	KCB94195	KIT, COMPRESSOR, 24V, O5G, '16
10	4	EACH	CSF08101	CAPSCREW, FH, 1/2-20UNF x 1", ALLOY, PLT
9	2	EACH	BTQ08151	BOLT, HEX, 1/2-20UNF x 1.50, 8, PLT
8	2	EACH	BTQ06125	BOLT, HEX, 1/2-13UNC x 1.25, 8, PLT
7	5	EACH	BTQ06175	BOLT, HEX, 3/8-16UNC, 1.75", 8, PLT
6	2	EACH	BTC12080	BOLT, HEX, 12 x 1.75 x 80mm, 10.9, PLT
5	3	EACH	BTC10045	BOLT, HEX, 10 x 1.5 x 45mm, 10.9, PLT
4	1	EACH	BMC90022	BKT, MAIN, IDLER, WELDMT, ISL, HDX, '16
3	1	EACH	BMC90012	BKT, WELDMT, MAIN BASE, HDX, '16
2	1	EACH	BMC33125	BKT, WELDMT, ADAPTER PL, ISL, HDX, '13
1	1	EACH	BEL32359	BELT, BANDED B GR, 2388mm (94)

TRANSARGTIC INC.

1	WAS BYC10055 & 62, SCD16012	2/11/2012	JRR	
0	RELEASED TO PRODUCTION	11/25/2016	JRR	
A	RELEASED TO PROTOTYPE	6/1/2016	JRR	
REV	ECN	DESCRIPTION	DATE	BY
				JRR
				James Stewart
				James Stewart
				Dale Mason

MT KIT, ISL, 2016, HDX, O5G, 24V, '16

SIZE D DWG NO KMC941195

SCALE 1:5 SHEET 1 OF 1

UNSPECIFIED TOLERANCES: ALL DIMS
 ONE DECIMAL PLACE (X) .00 (FRA)
 TWO DECIMAL PLACES (X) .00 (FRA)
 THREE DECIMAL PLACES (X) .000 (FRA)
 FRACTIONAL (X) 1/16 (FRA)
 ANGULAR (X) .01 (FRA)

THIRD ANGLE PROJECTION

DRAWING UNIT OF MEASURE: MM (INCH)

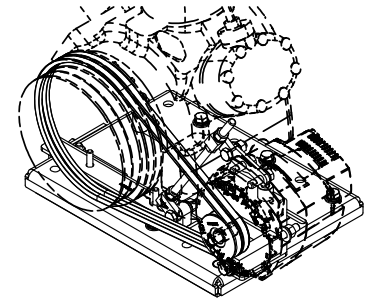
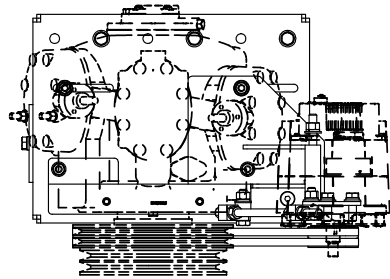
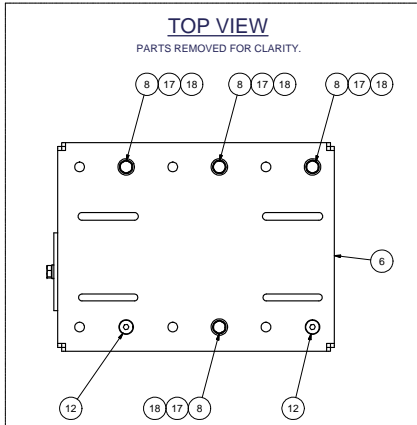

ISOMETRIC VIEW

NOTE:
CARRIER COMPRESSOR
PART#: 68PD541-124-xx

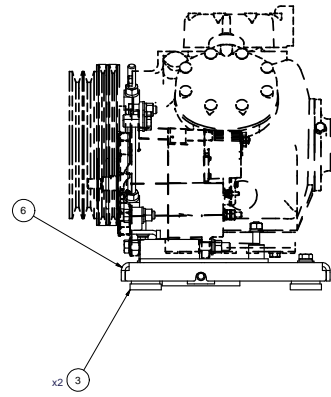
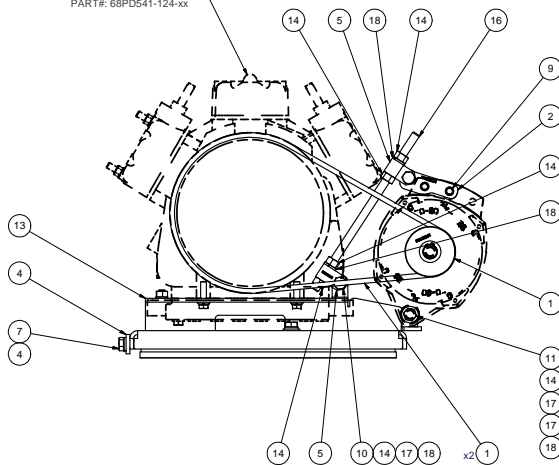

NOTES:

- 1) USE SERVICABLE THREADLOCKER ON ALL FASTENERS TO ENGINE COMPONENTS AND TORQUE **ALL** BOLTS TO S.A.E. SPECIFICATIONS.
- 2) SEE "TRANSARCTIC A/C COMPRESSOR MOUNT INSTALLATION DISCLAIMER".
- 3) WEIGHT: 56.87LBS.

ITEM	QTY	U/M	PART NUMBER	DESCRIPTION
18	12	EACH	WLO08000	WASHER, LOCK, 1/2", 8, PLT
17	10	EACH	WFO08000	WASHER, FLAT, 1/2", 8, PLT
16	1	EACH	TRD08120	THREADED, ROD, 1/2-13UNC x 12", 5 PLT
15	1	EACH	PUL03321	PULLEY, ALT, IDLER, 3.25"o, 2A
14	7	EACH	NT008000	NUT, HEX, 1/2-13UNC, 8, PLT
13	1	EACH	K8194195	KIT, PLATFORM, O5G W/ ALT, '16
12	2	EACH	CSF08076	CAPSCREW, FH, 1/2-20UNF x .75", ALLOY, PLT
11	1	EACH	BTQ08653	BOLT, HEX, 1/2-13UNC x 6.50, 8, PLT
10	1	EACH	BTQ08200	BOLT, HEX, 1/2-13UNC x 2.00, 8, PLT
9	3	EACH	BTQ08150	BOLT, HEX, 1/2-13UNC x 1.50, 8, PLT
8	4	EACH	BTQ08101	BOLT, HEX, 1/2-20UNF x 1.00, 8, PLT
7	1	EACH	BTQ08653	BOLT, HEX, 1/2-13UNC x 6.50, 5, PLT, FT
6	1	EACH	BMZ00043	BKT, MAIN, BASE PL, '13
5	2	EACH	BMT10011	BKT, TENR, BLOCK, OFFSET, 3mm
4	1	EACH	BMN80025	BKT, BACK, PL, SLIDE, IC, RE300
3	2	EACH	BMN80008	VIBRATION ISOLATOR, BAR, 16.50 x 2 x 1.50
2	1	EACH	BMCS3114	BKT, PL, ALT, SPACER, T3RE, '13
1	2	EACH	BELT1138	BELT, A GR, 1138mm (44.8") (17448)

BILL OF MATERIALS
TRANSARCTIC INC.

BROWN	5/30/2016	J Rodriguez	
CHECKED	5/30/2016	Jose Rodriguez	
REV	DESCRIPTION	DATE	BY
0	RELEASED TO PRODUCTION	5/30/2016	JRR
1	APPROVED	5/30/2016	James Stewart
2	APPROVED	5/30/2016	James Stewart
3	APPROVED	5/30/2016	Dale Mason

TITLE	KIT, COMPRESSOR, 24V, O5G, '16		
SIZE	D	DWG NO	KCB94195
SCALE	1:4	SHEET	1 OF 1

UNSPECIFIED TOLERANCES: ALL DIMS
 DIM DECIMAL PLACE (.XX) .XX (FRACTIONAL)
 DIM FRACTIONAL PLACE (X/XX) XX/XX (FRACTIONAL)
 DIM FRACTIONAL PLACE (X/XX) XX/XX (FRACTIONAL)
 DIM FRACTIONAL PLACE (X/XX) XX/XX (FRACTIONAL)



DRAWING UNIT OF MEASURE: MM [INCH]

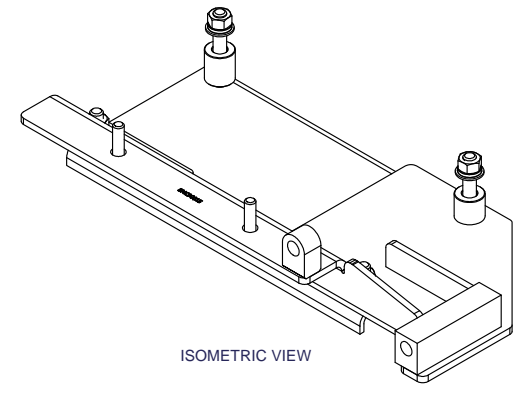
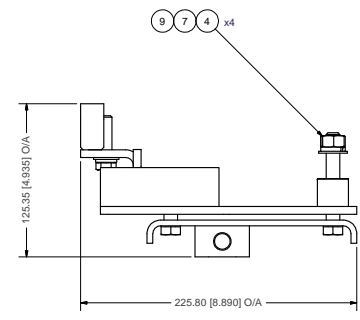
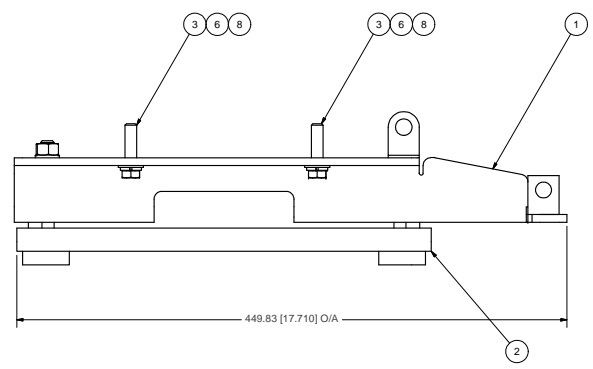
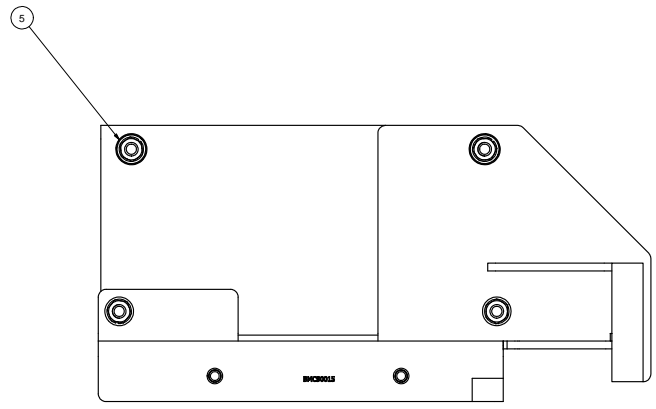

ISOMETRIC VIEW

- NOTES:**
- 1) USE SERVICABLE THREADLOCKER ON ALL FASTENERS TO ENGINE COMPONENTS AND TORQUE **ALL** BOLTS TO S.A.E. SPECIFICATIONS.
 - 2) SEE "TRANSARCTIC A/C COMPRESSOR MOUNT INSTALLATION DISCLAIMER".
 - 3) WEIGHT: 16.25 LBS.

ITEM	QTY	U/M	PART NUMBER	DESCRIPTION
9	4	EACH	WLO07000	WASHER, LOCK, 7/16", 8, PLT
8	2	EACH	WLO06000	WASHER, LOCK, 3/8", 8, PLT
7	4	EACH	WFN07000	WASHER, FLAT, 7/16", 2, PLT
6	2	EACH	WFN06000	WASHER, FLAT, 3/8", 2, PLT
5	1	EACH	SCD29213	SPACER, COL, DRL, 29.21mm x 25.4o x 12.7i
4	4	EACH	NTP07000	NUT, HEX, 7/16-14UNC, 5, PLT
3	2	EACH	BT006150	BOLT, HEX, 3/8-16UNC, 1.50", 8, PLT
2	1	EACH	BMN00010	BKT, MAIN, SLIDE, ASSY, IC, RE300
1	1	EACH	BMC90015	BKT, WELDMT, ALT EXTENSION, HDX, '16

BILL OF MATERIALS

TRANSARCTIC INC.

DRAWN jrodriguez	5/31/2016	TITLE	
CHECKED Jose Rodriguez	5/31/2016	SIZE	D
REVISION A	RELEASED TO PROTOTYPE 5/31/2016 JRR	DWG NO	KBT94195
DESCRIPTION	DATE	BY	REV
		James Stewart	0
		MFG	
		James Stewart	
		APPROVED	
		Date Mason	
		5/31/2016	
UNSPECIFIED TOLERANCES:		THIRD ANGLE PROJECTION	
ONE DECIMAL PLACE (X.0)	±.005	DRAWING UNIT OF MEASURE: MM [INCH]	
TWO DECIMAL PLACE (X.00)	±.002	SCALE: 1:2	
THREE DECIMAL PLACE (X.000)	±.001	SHEET 1 OF 1	
FRACTIONAL (1/16")	±.001		

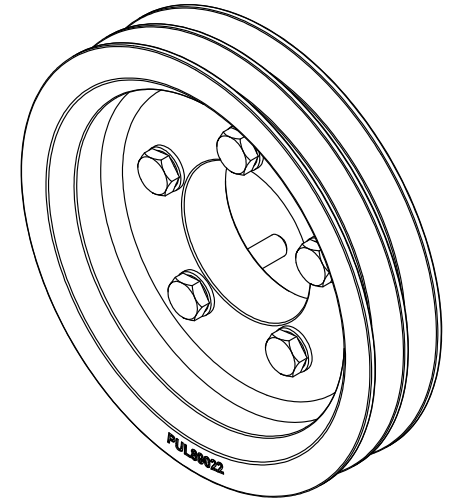
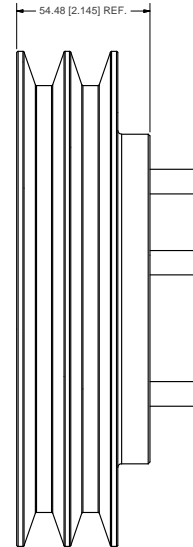
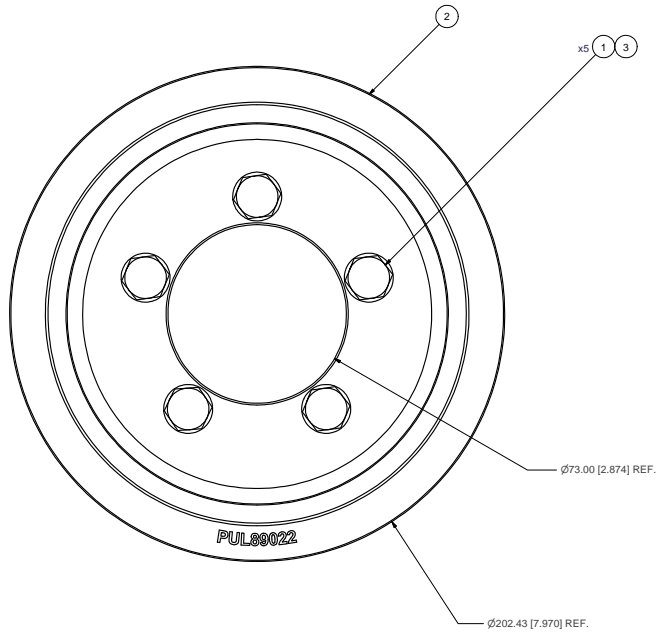
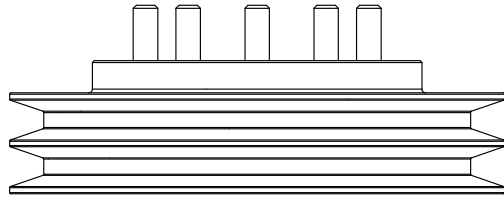

ISOMETRIC VIEW

NOTES:

- 1) USE SERVICABLE THREADLOCKER ON ALL FASTENERS TO ENGINE COMPONENTS AND TORQUE ALL BOLTS TO S.A.E. SPECIFICATIONS.
- 2) SEE "TRANSARCTIC A/C COMPRESSOR MOUNT INSTALLATION DISCLAIMER".
- 3) WT:≈ 11.56 LBS

ITEM	QTY	U/M	PART NUMBER	DESCRIPTION
3	5	EACH	WFA10000	WASHER, FLAT, 10mm, 8.8, PLT
2	1	EACH	PUL89022	PULLEY, CRANK, ISL, 8.9L, 2B/X, 8", '13
1	5	EACH	BTCT0050	BOLT, HEX, 10 x 1.5 x 50mm, 10.9, PLT

BILL OF MATERIALS

DRAWN	10/15/2013	TRANSARCTIC INC.		
Checked	10/15/2013			
REV	DESCRIPTION	DATE	BY	TITLE
0	RELEASED TO PRODUCTION	10/15/2013	JRB	GA
1		10/15/2013	James Stewart	
2		10/15/2013	Ron Ingram	KIT, PULLEY, ISL, 8.9L, 2B/X, '13
3		10/15/2013	Dale Mason	

UNSPECIFIED TOLERANCES:		MM (INCH)
ONE DECIMAL PLACE (X.0)	±0.10 (±.004)	THIRD ANGLE PROJECTION
TWO DECIMAL PLACE (X.00)	±0.02 (±.0008)	
THREE DECIMAL PLACE (X.000)	±0.002 (±.00008)	

DWG NO	REV
D	0
KPC89022	
SCALE 1:1	SHEET 1 OF 1

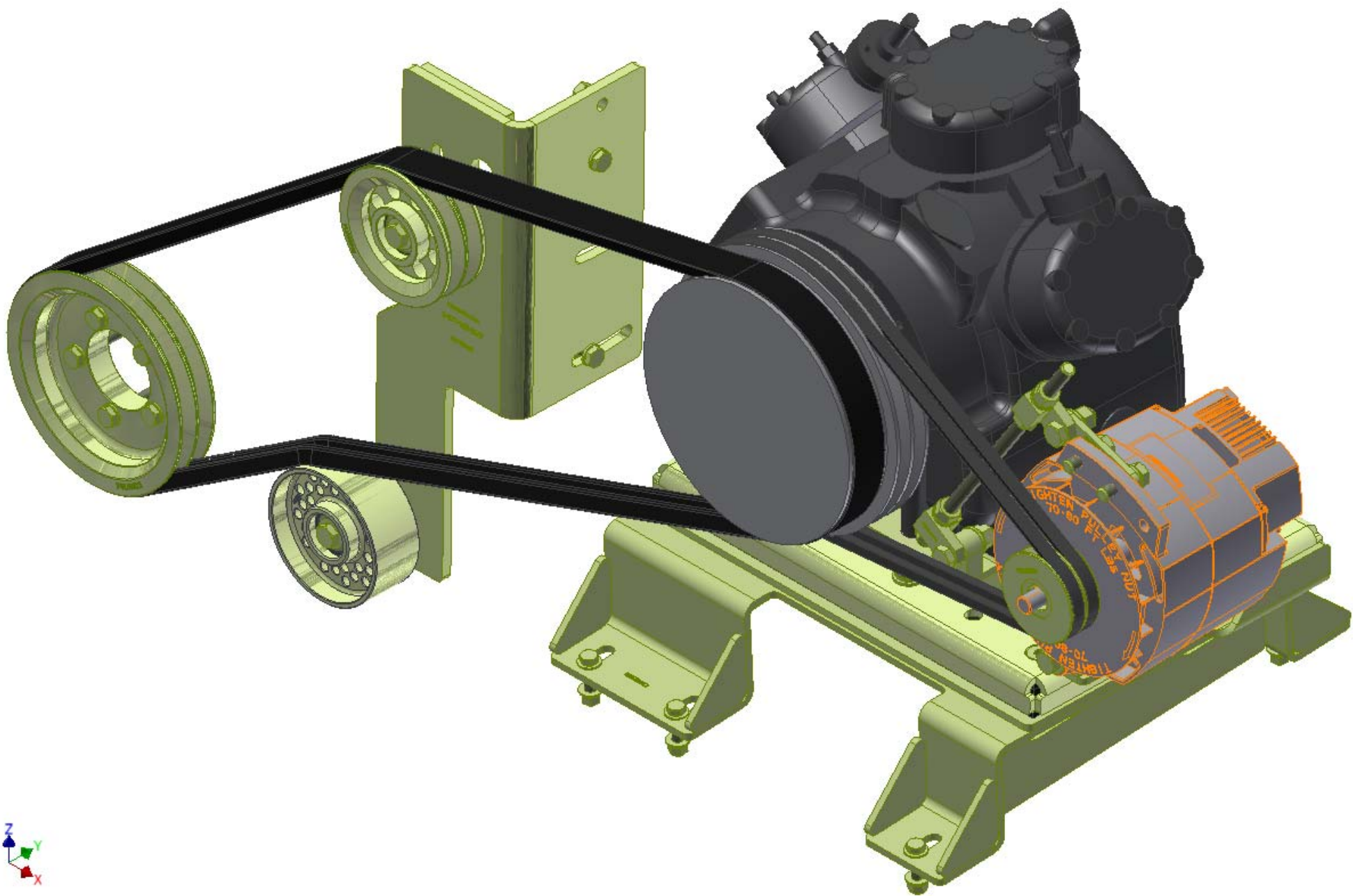

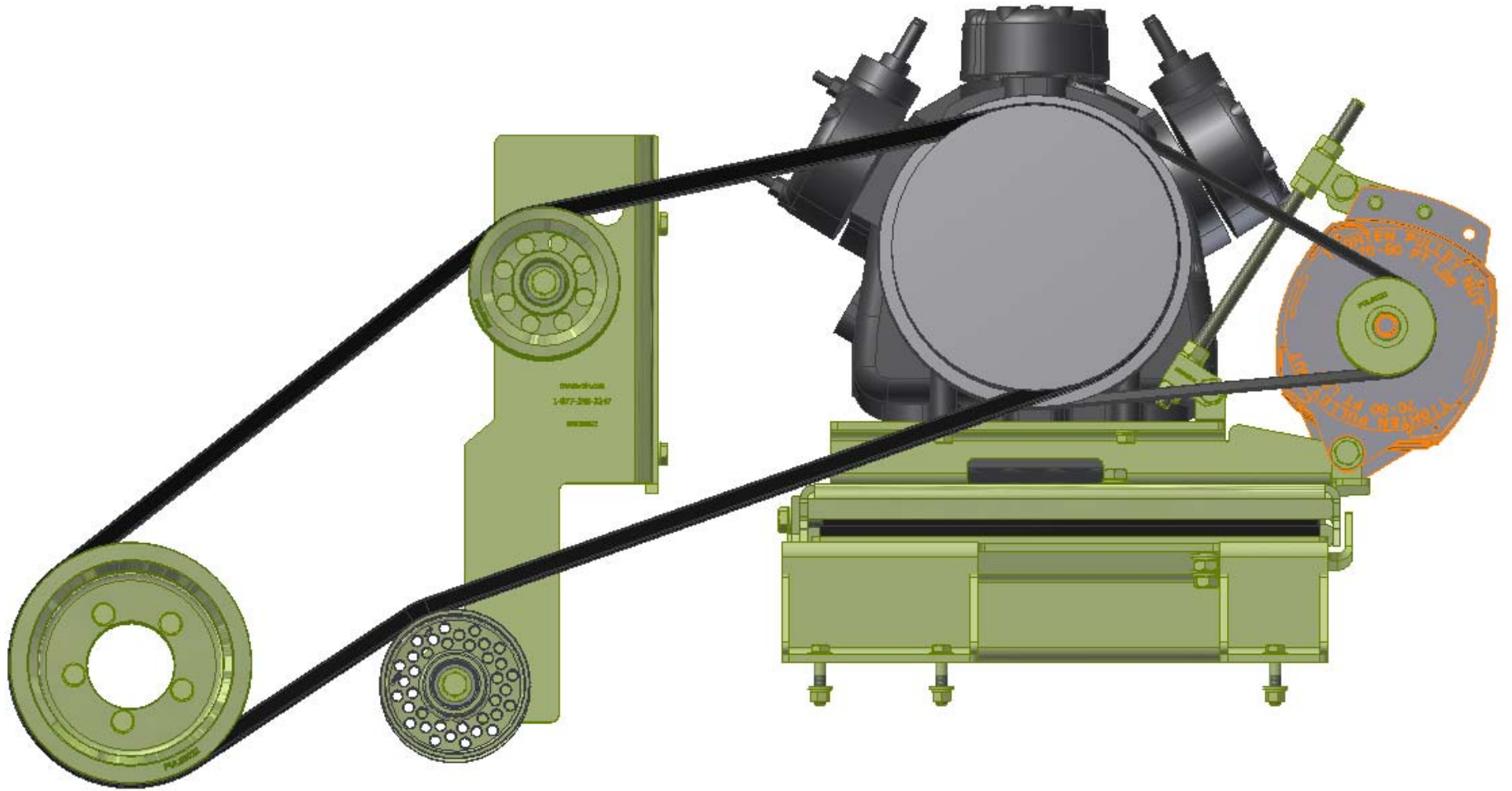

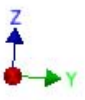
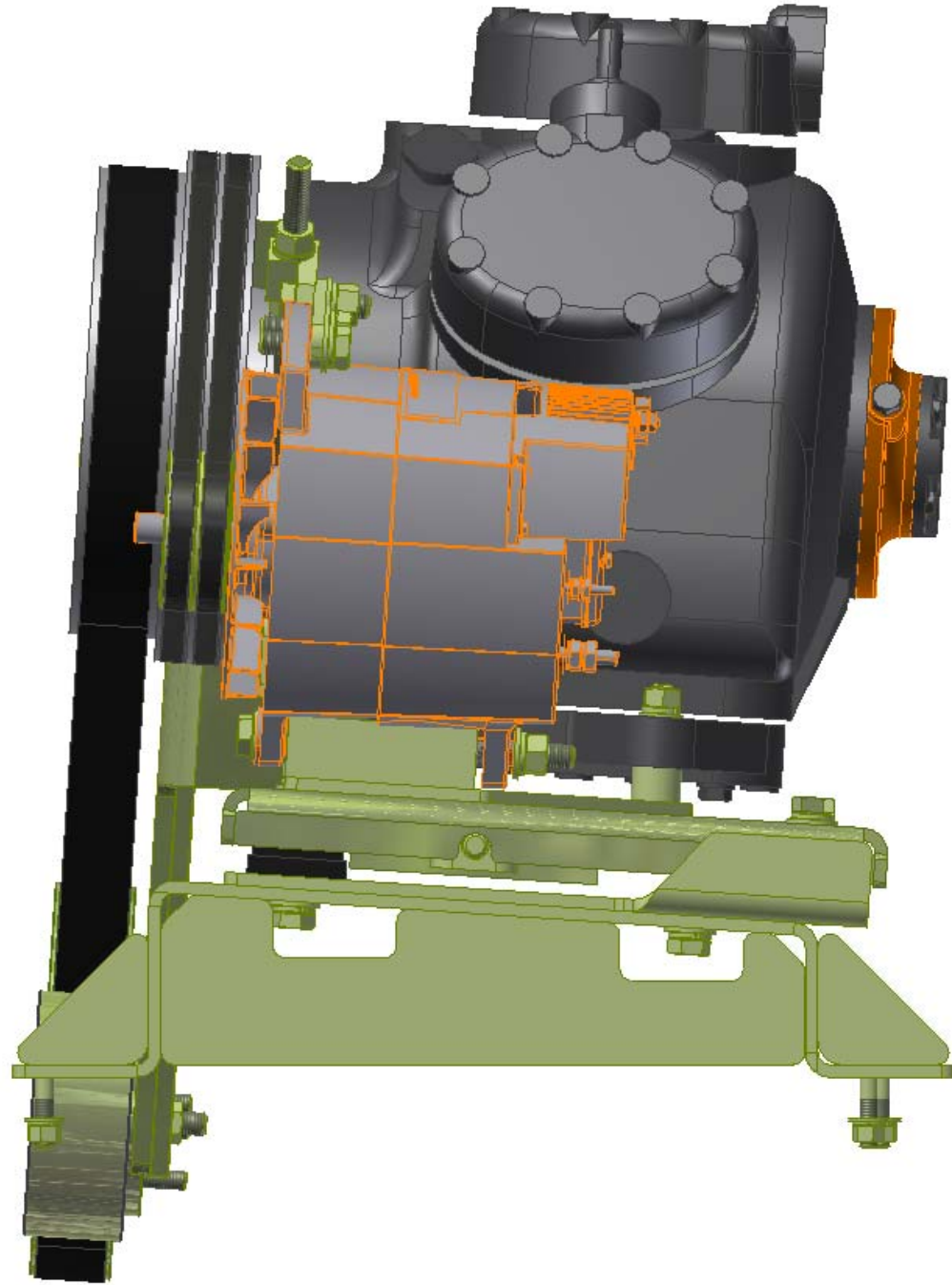

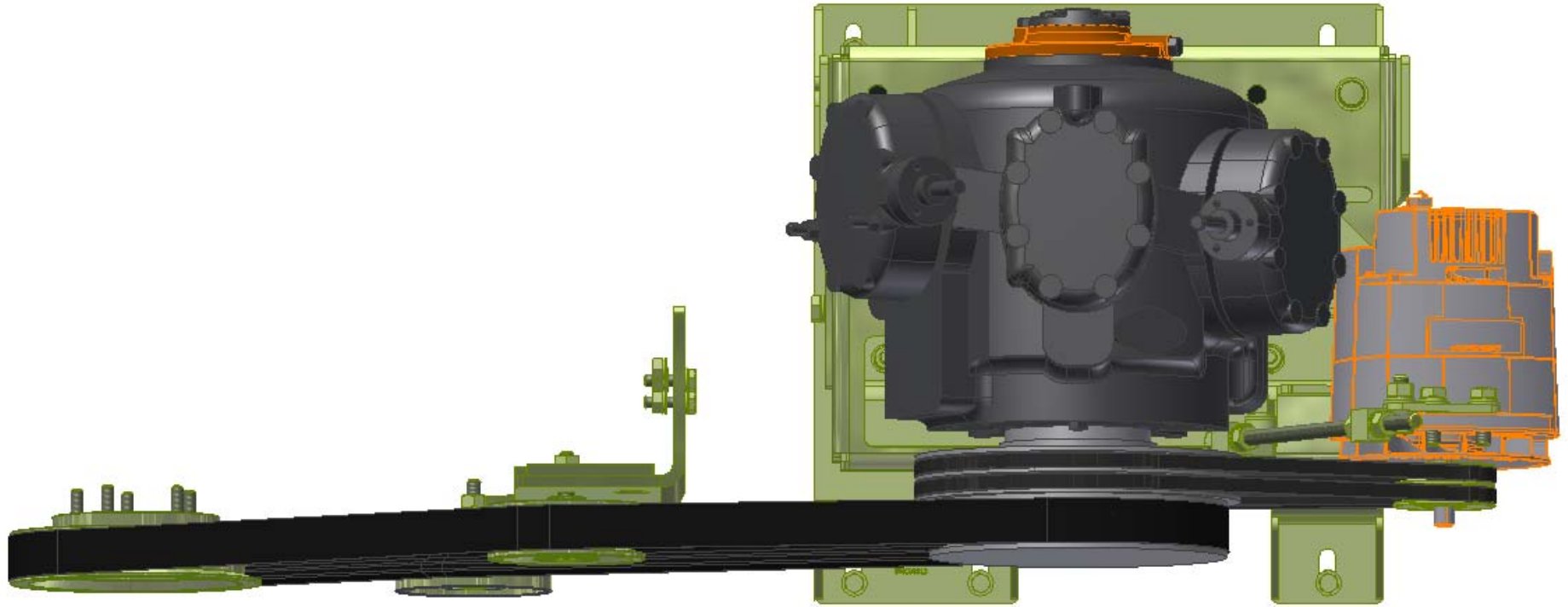

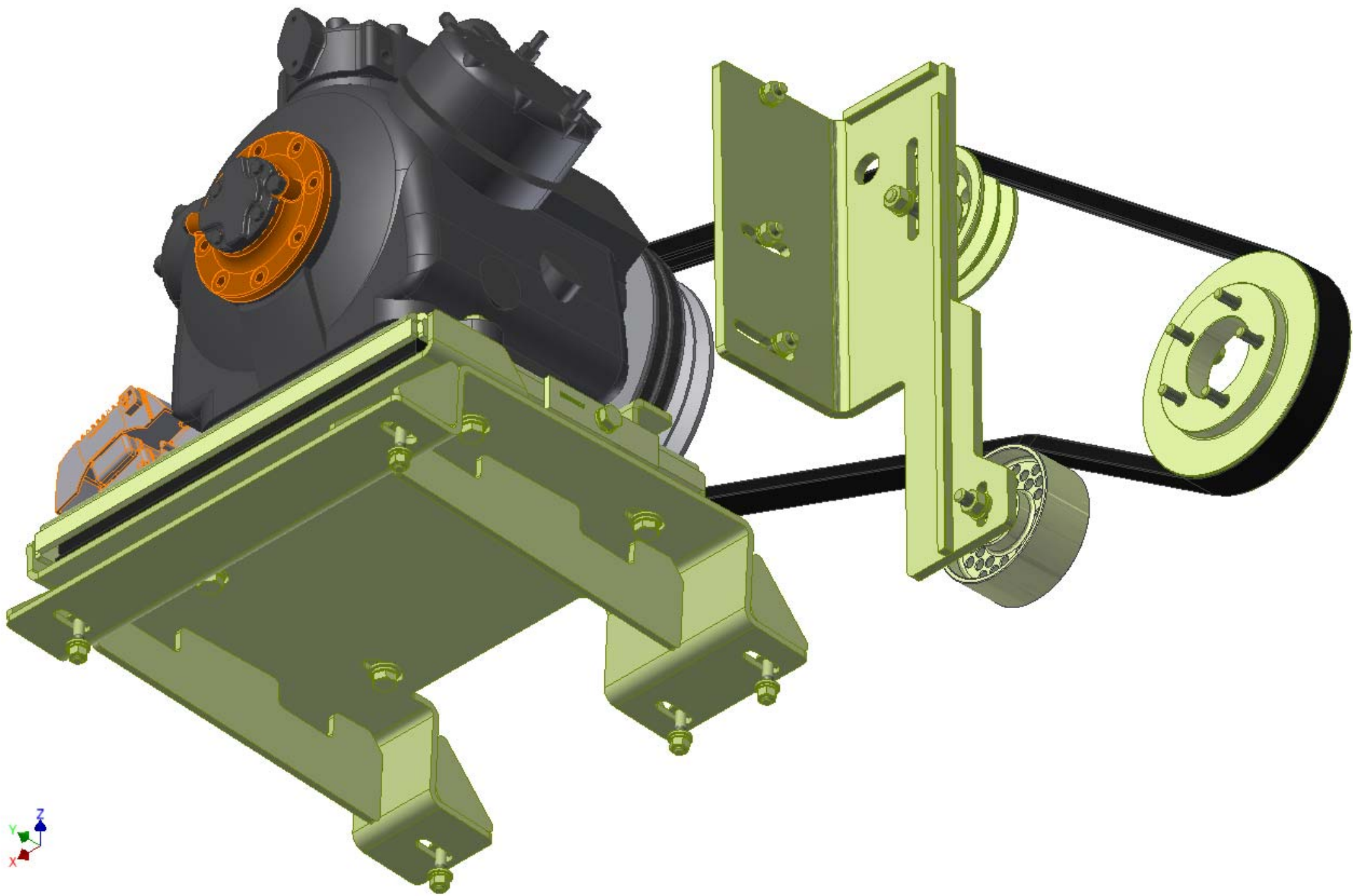

TransArctic A/C Compressor Mount Installation Disclaimer

All compressor mounts should be installed by qualified and trained personnel using proper tools and equipment in safe working conditions following industry standard guidelines for motor vehicle service and repair.

The installer of any compressor mount purchased from TransArctic must undertake all responsibility of issues arising from that compressor bracket being installed on any vehicle. As well as insure that a **proper and sufficient ground** is established between the compressors' clutches and the vehicle's engine. Mount functionality, operation and durability can all be compromised by an incompetent installation.

Due to the many different situations, parameters and application criteria, which are beyond the compressor mount manufacturer's control, TransArctic does not warrant design, durability, or operational functionality of any compressor mount improperly installed by another party.

With no implied guarantees it is the mount installer's strict responsibility to determine safety and functionality, of the compressor mount, at the time of installation.

Please contact TransArctic with any issue arising from installation so we may better improve the product. If you have any reservations about the compressor mount integrity contact TransArctic immediately at 1-877-COLD-AIR.

Mark OEM tensioner location

Install Kit

Check for Interferences

Check to ensure that the proper OEM tensioner orientation is maintained

Run engine with A/C system engaged for at least 10 minutes to run in belt

Check OEM tensioner orientation and adjust as required

Responsabilidad limitada de TransArctic en la instalación del soporte del compresor

Todos los soportes de los compresores deben ser instalados por personas calificadas y entrenadas, usando para ello los equipos y herramientas necesarios para esta labor en buenas condiciones y según las normas y guías para el servicio y/o reparación de motores de vehículos.

El instalador de los soportes comprados en TransArctic asume toda la responsabilidad de cualquier problema que surja en el soporte del compresor al vehículo; de igual manera es responsable que el cable a tierra sea conectado entre el embrague del compresor y el motor del vehículo.

Se advierte que el buen funcionamiento y la durabilidad del soporte pueden ser comprometidos por defectos en su instalación.

Debido a las diversas situaciones que se puedan presentar fuera del control del fabricante, TransArctic no garantiza el diseño, la durabilidad o el correcto funcionamiento de cualquier equipo inapropiadamente instalado por terceros.

Esta sobreentendido que el Instalador del montaje del compresor es estrictamente responsable de la seguridad y funcionamiento del equipo en el momento de la instalación.

Si tuviera algún problema o duda acerca de la instalación del soporte del compresor pongase en contacto inmediatamente con TransArctic al teléfono 1-877-COLD-AIR de modo que podamos mejorar nuestro producto.

Note la ubicación del medidor de tensión OEM

Instale el equipo

Controlar si hay interferencias.

Asegurese que el medidor de tensión mantenga la orientación justa.

Encienda el motor por lo menos 10 minutos con el sistema A/C enganchado para que la correa corra

Controle la orientación justa del medidor de tensión y ajuste a las condiciones requeridas del fabricante