

Bill of Materials Listing

TransArctic Canada Inc.

4/21/2017
Page 1 of 1

Product Number	Description	Date	Weight	Uof M	Yield
Line Component Prod#	Description	Bin Unit	Qty		
KMC94160	Mt Kit, ISL-G 8.9L, A3RE, 05G, '10		6/17/2010	220.00	0
10 BEL32592	Belt, Banded B, 2591mm (102") (41-1267)		each	1	
20 KBB94160	Mt Kit, Base, Transit, A3RE, '10		each	1	
30 KGT84161	Kit, Platform, O5G, '07		each	1	
40 KPC94160	Kit, Pulley, ISL-G, A3RE, '10		each	1	
50 KAC94161	Kit, Alt. 24V, ISC, A3RE, '09		each	1	

Bill of Materials Listing

TransArctic Canada Inc.

4/21/2017
Page 1 of 1

Product Number	Description	Date	Weight	Uof M	Yield
Line Component Prod#	Description	Bin Unit	Qty		
KBB94160	Mt Kit, Base, Transit, A3RE, '10	8/31/2007	157.96		0
20 BMC83019	Bkt, Gusset, Bumper, ISC, BBRE, '07	each	1		
30 BMC83020	Bkt, Dampner, ISC, BBRE, '07	each	1		
40 BMC83021	Bkt, Comp, Frt, ISC, BBRE, '07	each	1		
50 BMC83022	Bkt, Comp, Rear, ISC, BBRE, '07	each	1		
60 BMC83023	Bkt, Gusset, Idler, ISC, BBRE, '07	each	1		
70 BMC83064	Bkt, Main, Idler, ISL-G, A3RE, '10	each	1		
80 BMC83026	Bkt, Sprt, Bump, Rear, ISC, BBRE, '07	each	1		
90 BMC83027	Bkt, Sprt, Bump, Side, ISC, BBRE, '07	each	1		
110 BMC83029	Bkt, Shift, Tank, Weldmt, ISC, BBRE, '07	each	1		
115 BMC83031	Bkt, Slide, Block, Idler, BBRE	each	1		
120 BMN80008	Vibration Isolator, Bar, 16.50 x 2 x 1.50	each	2		
130 BMN80009	Bkt, Main, Base PI, IC, RE300	each	1		
160 BMN80025	Bkt, Back, PL, Slide, IC, RE300	each	1		
170 PUA05001	Pulley, Assy, Idler, B/S, 5", Stl, Plt	each	1		
180 PUA05012	Pulley, Assy, Idler, B/BX gr, 5", STL, Plt	each	1		
220 SCD32812	Spacer, Step, Drl, 32.8mm x 50.8o x 12.3i	each	1		
225 SPC19010	Spacer, Col, Drl, 19mm x 28.58o x 10.32i	each	2		
240 SCD48012	Spacer, Col, Drl, 48 mm x 34.9o x 12.3i	each	1		
250 SLV17012	Sleeve, Pulley, 16.9o x 22.23mm x 12.32i	each	2		
280 KBT94160	Bag Kit, Fasteners, KBB94160	each	1		

Bill of Materials Listing

TransArctic Canada Inc.

4/21/2017
Page 1 of 1

Product Number	Description	Date	Weight	Uof M	Yield
Line Component Prod#	Description	Bin Unit	Qty		
KBT94160	Bag Kit, Fasteners, KBB94160	8/29/2007	5.21		0
20 BTC08035	Bolt, Hex, 8 x 1.25 x 35mm, 10.9, Plt,FT	each	1		
50 BTC12040	Bolt, Hex, 12 x 1.75 x 40mm, 10.9,Plt,FT	each	10		
60 BTC12050	Bolt, Hex, 12 x 1.75 x 50mm, 10.9,Plt	each	1		
70 BTC12060	Bolt, Hex, 12 x 1.75 x 60mm, 10.9,Plt,FT	each	1		
90 BTC12100	Bolt, Hex, 12 x 1.75 x 100mm, 10.9, Plt	each	2		
105 BTP08653	Bolt, Hex, 1/2-13unc, 6.5", 5, Plt, FT	each	1		
115 BTQ06200	Bolt, Hex, 3/8-16unc, 2.0", 8, Plt	each	2		
120 BTQ08126	Bolt, Hex, 1/2-20unf, 1.25", 8, Plt	each	12		
135 BTQ08200	Bolt, Hex, 1/2-13unc, 2.0", 8, Plt	each	3		
160 CSF06075	Capscrew, FH, 3/8-16 x .75", Alloy, Plt	each	2		
170 NTA08000	Nut, Hex, 8 x 1.25, 8.8, Plt	each	1		
190 NTA12000	Nut, Hex, 12 x 1.75, 8.8, Plt	each	13		
200 NTP06000	Nut, Hex, 3/8-16unc, 5, Plt	each	2		
230 WFA08000	Washer, Flat, 8mm, 8.8, Plt	each	2		
250 WFA12000	Washer, Flat, 12mm, 8.8, Plt	each	21		
270 WFAQ08000	Washer, Flat, 1/2", 8, Plt	each	15		
280 WLA08000	Washer, Lock, 8mm, 8.8, Plt	each	1		
300 WLA12000	Washer, Lock, 12mm, 8.8, Plt	each	14		
330 WLQ08000	Washer, Lock, 1/2", 8, Plt	each	13		

Bill of Materials Listing

TransArctic Canada Inc.

11/23/2011
Page 1 of 1

Product Number	Description	Date	Weight	Uof M	Yield
Line Component Prod# Description	Bin	Unit	Qty		
KGT84161	Mt Kit, Transit, O5G, '07	10/19/2007	10.76		0
10 BMN80010	Bkt, Main, Slide, Assy, O5G, IC, RE300	each	1		
20 BMN80024	Bkt, Comp, FRT, Z, IC, RE300	each	1		
30 SCD29213	Spacer, Col, Drl, 29.21mm x 25.4o x 12.7i	each	2		
40 BTQ06150	Bolt, Hex, 3/8-16unc, 1.50", 8, Plt	each	2		
50 NTP07000	Nut, Hex, 7/16-14unc, 5, Plt	each	4		
60 WFN06000	Washer, Flat, 3/8", 2, Plt	each	2		
70 WLP07000	Washer, Lock, 7/16", 5, Plt	each	4		
80 WLP06000	Washer, Lock, 3/8", 5, Plt	each	2		

Bill of Materials Listing

TransArctic Canada Inc.

11/23/2011
Page 1 of 1

Product Number	Description	Date	Weight	Uof M	Yield
Line Component Prod#	Description	Bin Unit	Qty		
KPC94160	Kit, Pulley, ISL-G, A3RE, '10		10/19/2007	13.70	0
10	PUL89009		Pulley, Crank, ISL, 8.9L, 2B/X, 8", '09	each	1
20	BTC12055		Bolt, Hex, 12 x 1.75 x 55mm, 10.9,Plt,FT	each	4
30	WFS12002		Washer, Flat, Hdn, 12mm, Stl, BLK	each	4

Bill of Materials Listing

TransArctic Canada Inc.

2/28/2012
Page 1 of 1

Product Number		Description	Bin	Date	Weight	Uof M	Yield
Line	Component	Prod#	Description	Unit	Qty		
KAC94161		Alt. Kit, 24V, ISC, A3RE, '09		2/25/2009	34.95		0
10	BEL82705		Belt, 8gr, 2705mm (106.5") (5081065)	each	1		
20	BMC83040		Bkt, PI, ALT, Rear, ISC, A3RE, '09	each	1		
30	BMC83042		Bkt, Main, Alt, Weldm't, ISC, A3RE, '09	each	1		
35	BMZ00029		BKT, UNIVER, HOSE/CABLE, MT, U/S CHASε	each	1		
40	PUL80064		Pulley,ALT,Frontside,P8,63.5d (3972808)	each	1		
50	PUL80076		Pulley, Idler, Backside, P8, 76d (89062)	each	2		
70	KBA94161		Bag Kit, Fasteners, KAC94161	each	1		

Bill of Materials Listing

TransArctic Canada Inc.

6/28/2010
Page 1 of 1

Product Number	Description	Date	Weight	Uof M	Yield
Line	Component Prod#	Bin	Unit	Qty	
KBA94161	Bag Kit, Fasteners, KAC94161	3/2/2009	1.81		0
5	BTC08030		Bolt, Hex, 8 x 1.25 x 30mm, 10.9, Plt,FT	each	1
10	BTC08035		Bolt, Hex, 8 x 1.25 x 35mm, 10.9, Plt,FT	each	6
20	BTC08065		Bolt, Hex, 8 x 1.25 x 65mm, 10.9, Plt	each	2
30	BTC10040		Bolt, Hex, 10 x 1.5 x 40mm, 10.9, Plt,FT	each	5
40	BTQ08150		Bolt, Hex, 1/2-13unc, 1.5", 8, Plt	each	1
50	BTQ08653		Bolt, Hex, 1/2-13unc, 6.5", 8, Plt	each	1
60	BTS10001		Bolt, Shoulder, 10mm (89064)	each	2
65	NTA08000		Nut, Hex, 8 x 1.25, 8.8, Plt	each	1
70	NTA10000		Nut, Hex, 10 x 1.5, 8.8, Plt	each	5
80	NTQ08000		Nut, Hex, 1/2-13unc, 8, Plt	each	1
90	WFA08000		Washer, Flat, 8mm, 8.8, Plt	each	8
100	WFA10000		Washer, Flat, 10mm, 8.8, Plt	each	10
110	WFQ08000		Washer, Flat, 1/2", 8, Plt	each	3
120	WLA08000		Washer, Lock, 8mm, 8.8, Plt	each	9
130	WLA10000		Washer, Lock, 10mm, 8.8, Plt	each	5
140	WLQ08000		Washer, Lock, 1/2", 8, Plt	each	2

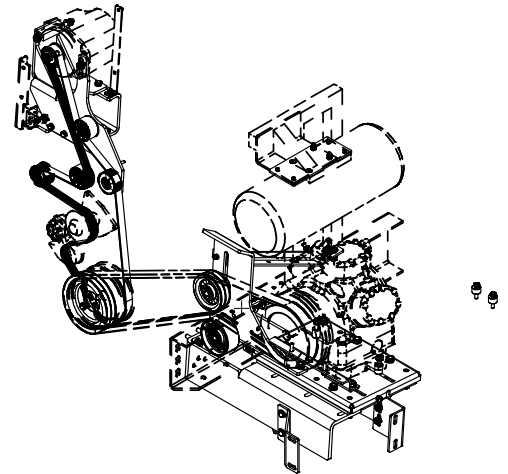
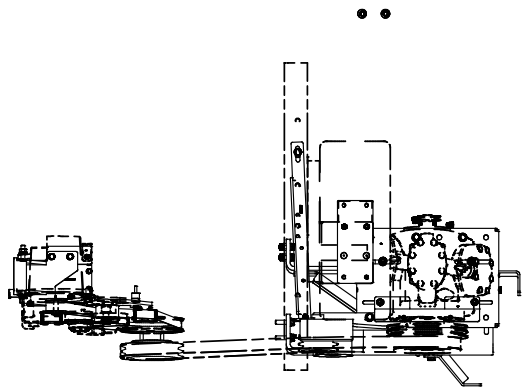

ISOMETRIC VIEW

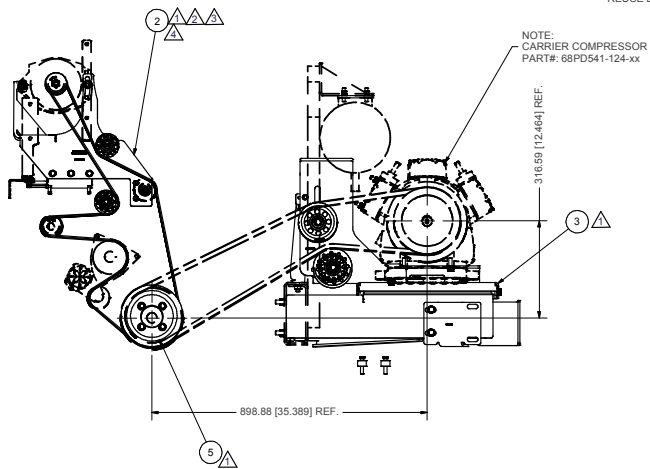

REUSE EXISTING BRACKET HARDWARE.

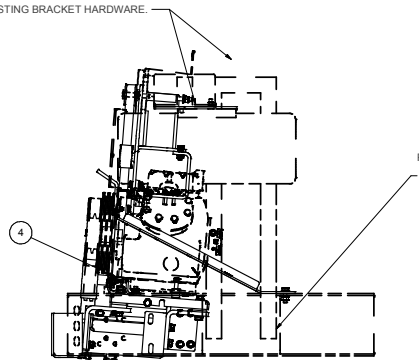

REUSE EXISTING MUFFLER BRACKET & HARDWARE.

REUSE & MODIFY EXISTING EXHAUST SHIELD
BRACKET & HARDWARE.
(FROM REAR OEM POSITION TO
LOWERED OTHER SIDE OF TUBE.)

NOTES:

- 1) USE SERVICABLE THREADLOCKER ON ALL FASTENERS TO ENGINE COMPONENTS AND TORQUE ALL BOLTS TO S.A.E. SPECIFICATIONS.
- 2) SEE "TRANSARTIC A/C COMPRESSOR MOUNT INSTALLATION DISCLAIMER".

ITEM	QTY	U/M	PART NUMBER	DESCRIPTION
5	1	EACH	KPC94160	KIT, PULLEY, ISL-G, A3RE, '10
4	1	EACH	KG784161	MT KIT, TRANSIT, O5G, 07"
3	1	EACH	KBB94160	MT KIT, BASE, TRANSIT, A3RE, '10
2	1	EACH	KAC94161	Alt. Kit, 24V, ISC, A3RE, '09
1	1	EACH	BEL32592	BELT, BANDED B, 2591mm (102") (RBX99-2)

REV	ECN	DESCRIPTION	DATE	BY	APPROVED	TITLE	SIZE	DWG NO	REV
4		GENERAL REVISION	04/21/17	VALJ		MT. KIT, ISL-G 8.9L, A3RE, O5G, '10	D	KMC94160	4
3		MODIFIED KAC94161	01/15/2011	JRR	Jose Rodriguez				
2		MODIFIED KAC94161	11/10/2010	VALJ	CHECKED				
1		MODIFIED KBB94160	07/25/2010	JRR	James Stewart				
0		RELEASED TO PRODUCTION	02/29/2010	VALJ	James Stewart				
					Ron Ingram				
					Dale Mason				

UNSPECIFIED TOLERANCES:	FINISH	PROF
ONE DECIMAL PLACE (XX)	12	1:100
TWO DECIMAL PLACE (XXX)	25	1:500
THREE DECIMAL PLACE (XXXX)	50	1:2500
FRACTIONAL (1/16")	ANSI & AS	



DRAWING UNIT OF MEASURE: MM (INCH) SCALE: 1:8 SHEET 1 OF 1

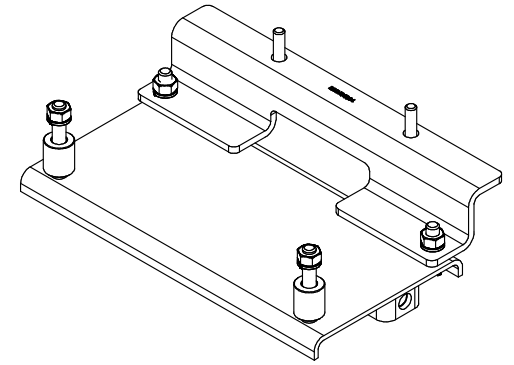
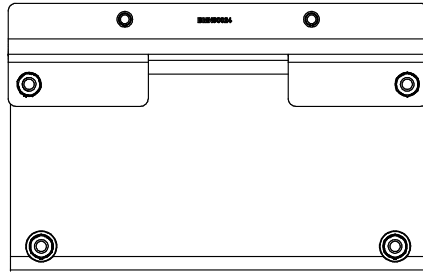

ISOMETRIC VIEW

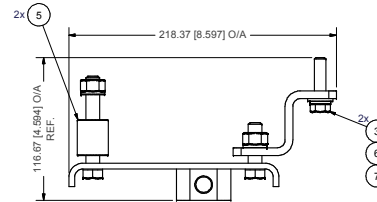
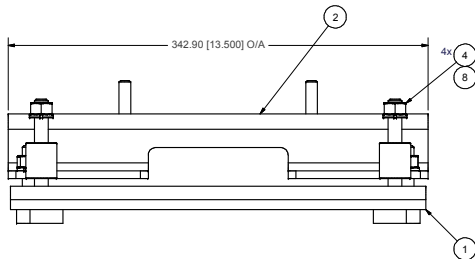

NOTES:

- 1) USE SERVICABLE THREADLOCKER ON ALL FASTENERS TO ENGINE COMPONENTS AND TORQUE ALL BOLTS TO S.A.E. SPECIFICATIONS.
- 2) SEE "TRANSARCTIC A/C COMPRESSOR MOUNT INSTALLATION DISCLAIMER".
- 3) WEIGHT: 10.67 LB

ITEM	QTY	U/M	PART NUMBER	DESCRIPTION
8	4	EACH	WLP07000	WASHER, LOCK, 7/16", 5, PLT
7	2	EACH	WLP06000	WASHER, LOCK, 3/8", 5, PLT
6	2	EACH	WFN06000	WASHER, FLAT, 3/8", 2, PLT
5	2	EACH	SCD29213	SPACER, COL, DRL, 29.21mm x 25.4o x 12.7l
4	4	EACH	NTP07000	NUT, HEX, 7/16-14UNC, 5, PLT
3	2	EACH	BTQ06150	BOLT, HEX, 3/8-18UNC, 1.50", 8, PLT
2	1	EACH	BMN80024	BKT, COMP, FRT, Z, IC, RE300
1	1	EACH	BMN80010	BKT, MAIN, SLIDE, ASSY, IC, RE300

Parts List

DRAWN	Jose Rodriguez	10/21/2008	TRANSARCTIC INC.
CHECKED	Val Jakowlew	10/21/2008	

REV	ECN	DESCRIPTION	DATE	BY
		RELEASED TO PRODUCTION	10/20/2008	BRK
		1) G		CA
		2) G		James Stewart
		3) G		Ron Ingram
		4) G		Dale Mason

THIS DRAWING CONTAINS PROPRIETARY CONFIDENTIAL INFORMATION OWNED BY TRANSARCTIC CANADA INC. THE DOCUMENT AND THE INFORMATION IN IT ARE NOT TO BE USED, DISCLOSED OR REPRODUCED WITHOUT EXPRESS WRITTEN PERMISSION OF THE COMPANY.

UNSPECIFIED TOLERANCES:		(ALL DIM)	GROUP
ONE DECIMAL PLACE	(10)	20	STAIR
TWO DECIMAL PLACE	(20)	50	USE
FRACTIONAL	(1/32)	50	USE
		ANGULAR	(1/32)



DRAWING UNIT OF MEASURE	MM (INCH)	SCALE	1 : 2	DWG NO	KGT84161	REV	0
-------------------------	-----------	-------	-------	--------	----------	-----	---

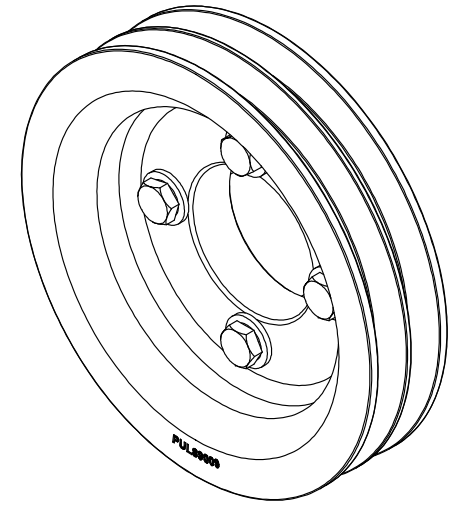
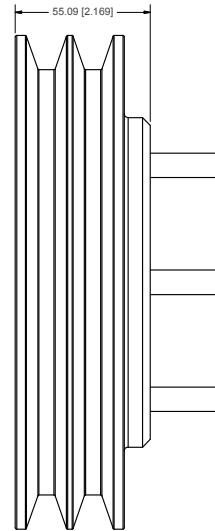
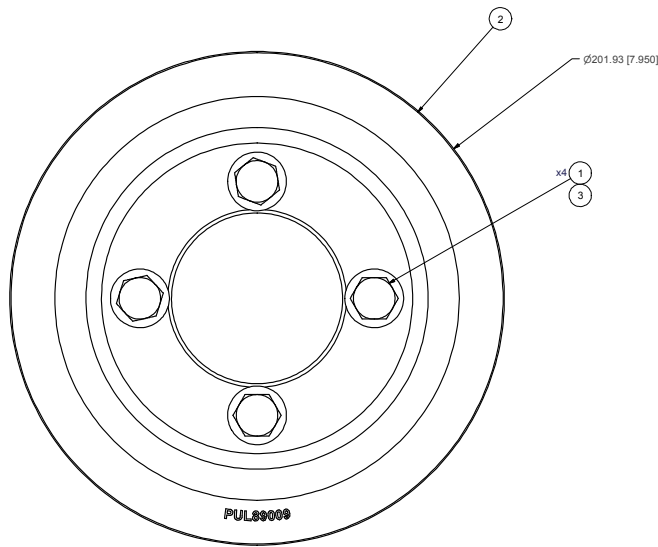
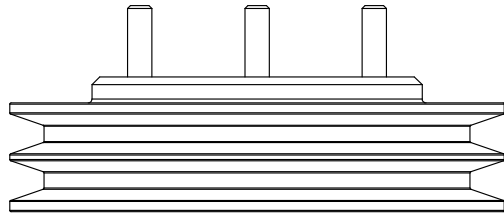

ISOMETRIC VIEW

NOTES:

- 1) USE SERVICABLE THREADLOCKER ON ALL FASTENERS TO ENGINE COMPONENTS AND TORQUE ALL BOLTS TO S.A.E. SPECIFICATIONS.
- 2) SEE "TRANSARGTIC A/C COMPRESSOR MOUNT INSTALLATION DISCLAIMER".
- 3) WEIGHT: 13.58 LB

ITEM	QTY	U/M	PART NUMBER	DESCRIPTION
3	4	EACH	WFS12002	WASHER, FLAT, HDN, 12mm, STL, BLK
2	1	EACH	PUL89009	PULLEY, CRANK, ISL, 8.9L, 287X, 8", '09
1	4	EACH	BTC10055	BOLT, HEX, 10 x 1.5 x 55mm, 10.9, PLT

BILL OF MATERIALS

DRAWN	Jose Rodriguez	9/17/2010	TRANSARGTIC INC.		
CHECKED	Val Jakovlev	9/17/2010			
REV	ECN	DESCRIPTION	DATE	BY	TITLE
			9/17/2010	James Stewart	Kit, Pulley, ISL-G, A3RE, '10
			9/17/2010	Ron Ingram	
			9/17/2010	Dale Mason	
UNSPECIFIED TOLERANCES:			ALL DIM	GROUP	
ONE DECIMAL PLACE	10	AS SHOWN			
TWO DECIMAL PLACE	100	AS SHOWN			
FRACTIONAL	1/32	AS SHOWN			
DRAWING UNIT OF MEASURE			MM (INCH)	SCALE	1:1
DWG NO			KPC94160	REV	0
SHEET			1	OF	1

RELEASED TO PRODUCTION	9/17/2010	JRR
THIS DRAWING CONTAINS PROPRIETARY CONFIDENTIAL INFORMATION OWNED BY TRANSARGTIC CANADA INC. THE DOCUMENT AND THE INFORMATION IN IT ARE NOT TO BE USED, DISCLOSED OR REPRODUCED WITHOUT EXPRESS WRITTEN PERMISSION OF THE COMPANY.		
THIRD ANGLE PROJECTION		

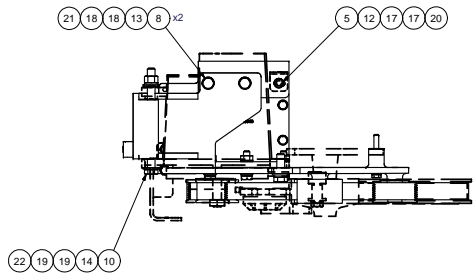

NOTE:
 DRILL $\phi 21/64"$ HOLE TO
 SUIT PROPER HEIGHT
 ADJUSTMENT TO CLAMP ENGINE
 COOLING SYSTEM HOSE.
 RE-USE EXISTING FASTENER(S)

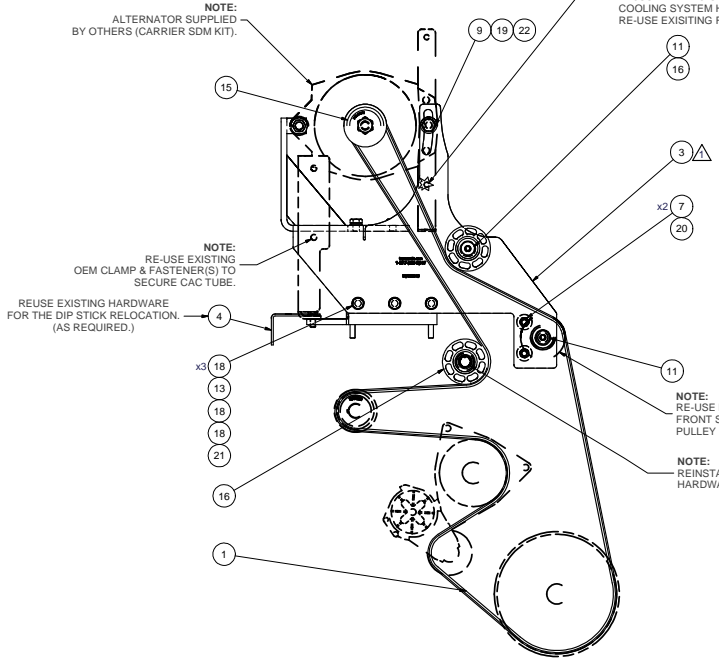

NOTE:
 ALTERNATOR SUPPLIED
 BY OTHERS (CARRIER SDM KIT).

NOTE:
 RE-USE EXISTING
 OEM CLAMP & FASTENER(S) TO
 SECURE CAC TUBE.

REUSE EXISTING HARDWARE
 FOR THE DIP STICK RELOCATION.
 (AS REQUIRED.)

NOTE:
 RE-USE EXISTING OEM
 FRONT SIDE IDLER
 PULLEY

NOTE:
 REINSTALL OEM
 HARDWARE.

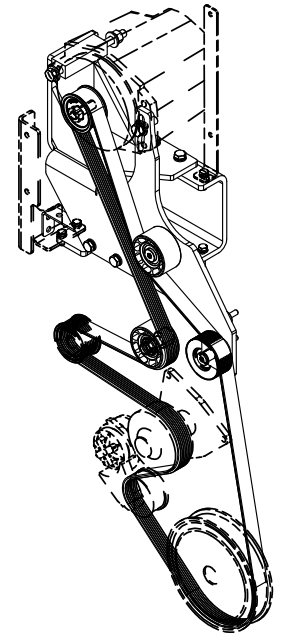
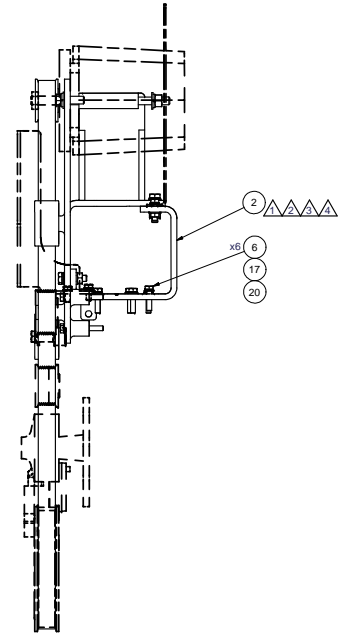

ISOMETRIC VIEW

ITEM	QTY	U/M	PART NUMBER	DESCRIPTION
22	2	EACH	WLO08000	WASHER, LOCK, 1/2", 8, PLT
21	5	EACH	WLA10000	WASHER, LOCK, 10mm, 8.8, PLT
20	9	EACH	WLA08000	WASHER, LOCK, 8mm, 8.8, PLT
19	3	EACH	WFO08000	WASHER, FLAT, 1/2", 8, PLT
18	10	EACH	WFA10000	WASHER, FLAT, 10mm, 8.8, PLT
17	8	EACH	WFA08000	WASHER, FLAT, 8mm, 8.8, PLT
16	2	EACH	PUL80076	PULLEY, IDLER, BACKSIDE, P8, 76D, 39W
15	1	EACH	PUL80064	PULLEY, ALT, FRONT, ISC, A3RE, '09
14	1	EACH	NTQ08000	NUT, HEX, 1/2-13UNC, 8, PLT
13	5	EACH	NTA10000	NUT, HEX, 10 x 1.5, 8.8, PLT
12	1	EACH	NTA08000	NUT, HEX, 8 x 1.25, 8.8, PLT
11	2	EACH	BT130001	BOLT, SHOULDER, 10mm (IDLER PULLEY)
10	1	EACH	BTQ08A53	BOLT, HEX, 1/2-13UNC x 6.50, 8, PLT
9	1	EACH	BTQ08150	BOLT, HEX, 1/2-13UNC x 1.50, 8, PLT
8	5	EACH	BTC10040	BOLT, HEX, 10 x 1.5 x 40mm, 10.9, PLT
7	2	EACH	BTC08065	BOLT, HEX, 8 x 1.25 x 65mm, 10.9, PLT
6	6	EACH	BTC08035	BOLT, HEX, 8 x 1.25 x 35mm, 10.9, PLT
5	1	EACH	BTC08030	BOLT, HEX, 8 x 1.25 x 30mm, 10.9, PLT
4	1	EACH	BMZ00029	BKT, UNIVER, HOSE/CABLE, MT, U/S CHASSIS
3	1	EACH	BMCS3042	BKT, MAIN, ALT, WELDMT, ISC, A3RE, '09
2	1	EACH	BMCS3040	BKT, PL, ALT, REAR, ISC, A3RE, '09
1	1	EACH	BELB2705	Belt, Sgr, 2705mm (106.5") (5081065)

BILL OF MATERIALS

REV	ECN	DESCRIPTION	DATE	BY
4		MODIFIED BMCS3040	11/28/2011	VALJ
3		MODIFIED BMCS3040	11/29/2010	JRR
2		MODIFIED BMCS3040	8/15/2010	JRR
1		MODIFIED BMCS3040 4.2	8/8/2010	JRR
0		RELEASED TO PRODUCTION	2/25/2009	JRR

DRAWN: Jose Rodriguez 2/25/2009
 CHECKED: James Stewart 2/25/2009
 APPROVED: Ron Ingram 2/25/2009
 DATE: Dale Mason 2/25/2009

TRANSARGTIG INC.

TITLE: Alt. Kit, 24V, ISC, A3RE, '09

SIZE: D DWG NO: KAC94161 REV: 4

SCALE: 1:2 SHEET 1 OF 1

NOTES:
 1) USE SERVICABLE THREADLOCKER ON ALL FASTENERS TO ENGINE COMPONENTS AND TORQUE ALL BOLTS TO S.A.E. SPECIFICATIONS.
 2) SEE "TRANSARGTIG A/C COMPRESSOR MOUNT INSTALLATION DISCLAIMER".

UNSPECIFIED TOLERANCES:	FINISH	THIRD ANGLE PROJECTION
ONE DECIMAL PLACE (X1)	AS SHOWN	THIRD ANGLE PROJECTION
TWO DECIMAL PLACES (X2)		
FRACTIONAL (1/16")		

DRAWING UNIT OF MEASURE:	MM (INCH)
SCALE: 1:2	

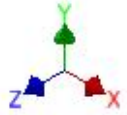

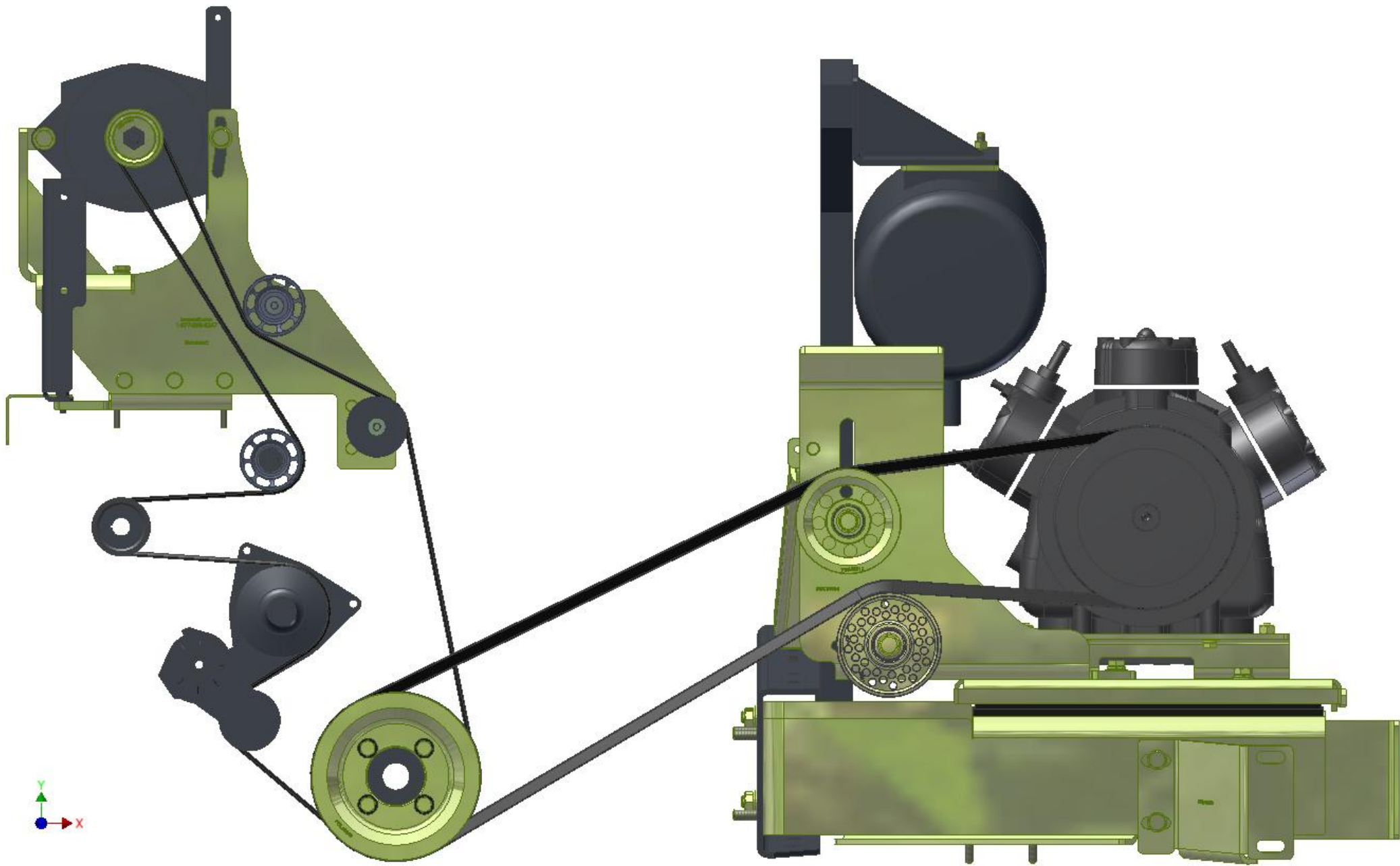

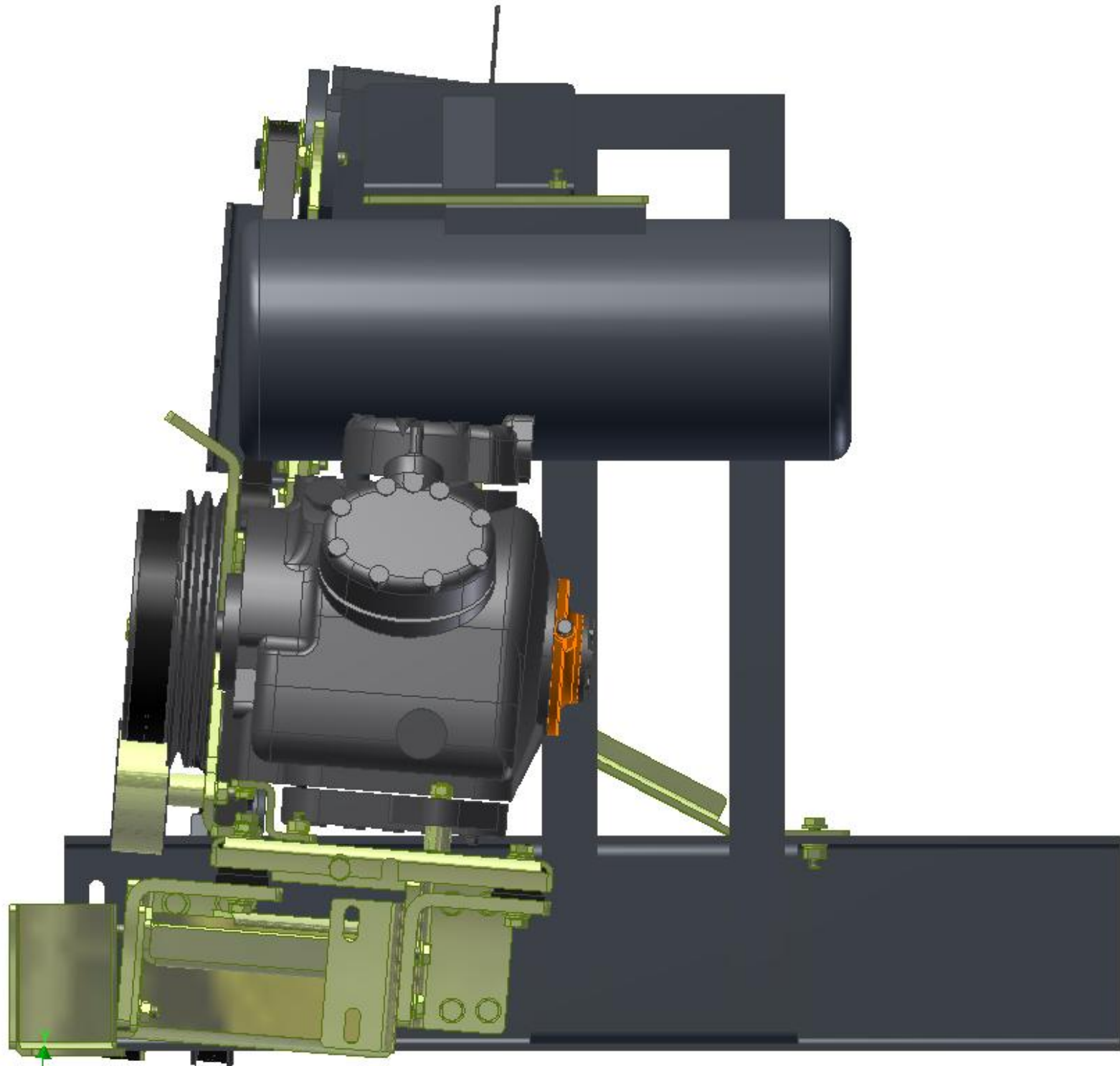

z ←



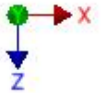

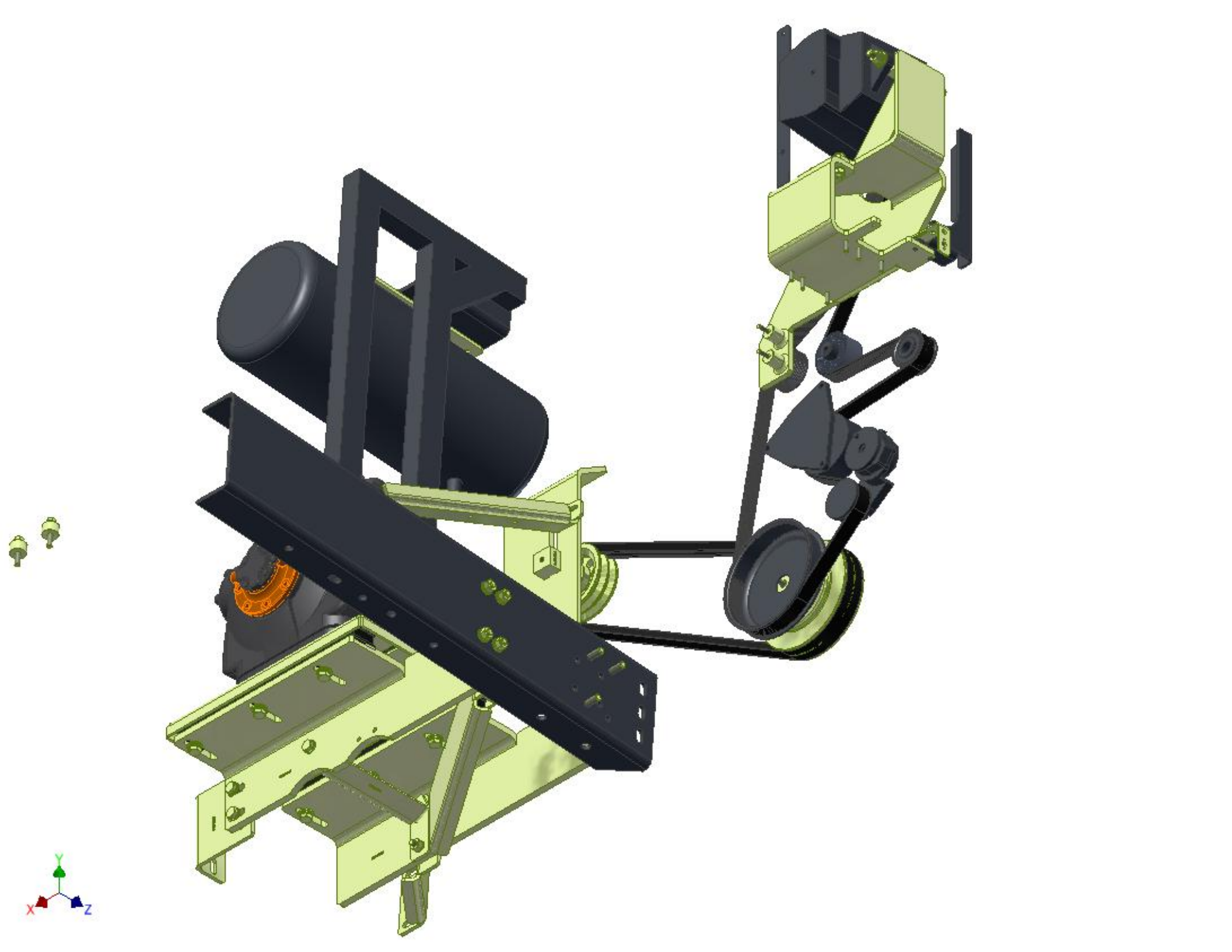

TransArctic A/C Compressor Mount Installation Disclaimer

All compressor mounts should be installed by qualified and trained personnel using proper tools and equipment in safe working conditions following industry standard guidelines for motor vehicle service and repair.

The installer of any compressor mount purchased from TransArctic must undertake all responsibility of issues arising from that compressor bracket being installed on any vehicle. As well as insure that a **proper and sufficient ground** is established between the compressors' clutches and the vehicle's engine. Mount functionality, operation and durability can all be compromised by an incompetent installation.

Due to the many different situations, parameters and application criteria, which are beyond the compressor mount manufacturer's control, TransArctic does not warrant design, durability, or operational functionality of any compressor mount improperly installed by another party.

With no implied guarantees it is the mount installer's strict responsibility to determine safety and functionality, of the compressor mount, at the time of installation.

Please contact TransArctic with any issue arising from installation so we may better improve the product. If you have any reservations about the compressor mount integrity contact TransArctic immediately at 1-877-COLD-AIR.

Mark OEM tensioner location

Install Kit

Check for Interferences

Check to ensure that the proper OEM tensioner orientation is maintained

Run engine with A/C system engaged for at least 10 minutes to run in belt

Check OEM tensioner orientation and adjust as required

Responsabilidad limitada de TransArctic en la instalación del soporte del compresor

Todos los soportes de los compresores deben ser instalados por personas calificadas y entrenadas, usando para ello los equipos y herramientas necesarios para esta labor en buenas condiciones y según las normas y guías para el servicio y/o reparación de motores de vehículos.

El instalador de los soportes comprados en TransArctic asume toda la responsabilidad de cualquier problema que surja en el soporte del compresor al vehículo; de igual manera es responsable que el cable a tierra sea conectado entre el embrague del compresor y el motor del vehículo.

Se advierte que el buen funcionamiento y la durabilidad del soporte pueden ser comprometidos por defectos en su instalación.

Debido a las diversas situaciones que se puedan presentar fuera del control del fabricante, TransArctic no garantiza el diseño, la durabilidad o el correcto funcionamiento de cualquier equipo inapropiadamente instalado por terceros.

Esta sobreentendido que el Instalador del montaje del compresor es estrictamente responsable de la seguridad y funcionamiento del equipo en el momento de la instalación.

Si tuviera algún problema o duda acerca de la instalación del soporte del compresor pongase en contacto inmediatamente con TransArctic al teléfono 1-877-COLD-AIR de modo que podamos mejorar nuestro producto.

Note la ubicación del medidor de tensión OEM

Instale el equipo

Controlar si hay interferencias.

Asegurese que el medidor de tensión mantenga la orientación justa.

Encienda el motor por lo menos 10 minutos con el sistema A/C enganchado para que la correa corra

Controle la orientación justa del medidor de tensión y ajuste a las condiciones requeridas del fabricante