

# Bill of Materials Listing

TransArctic Canada Inc.

9/18/2015  
Page 1 of 1

Product Number	Description	Date	Weight	Uof M	Yield
Line    Component    Prod#	Description	Bin                    Unit	Qty		
<b>KMN82661</b>	<b>Mt. Kit, DT466, RE300, 2 TM-21</b>		<b>08/30/04</b>	<b>39.37</b>	<b>0</b>
10	BEL83035		Belt, 8gr, 3035mm (119.5") (5081195)	each	1
20	BMN60001		Bkt, Spacer, DT466, CE300	each	1
30	BMN80001		Bkt, Main, DT466, CE300, 2 TM-21/TM-16	each	1
40	PUL80076		Pulley, Idler, Backside, P8, 76d (89101)	each	2
50	SLV17010		Sleeve, Pulley, 16.9o x 22.23mm x 10.32i	each	1
60	SCD39710		Spacer, Col, Drl, 39.7mm x 25.4o x 10.3i	each	1
63	FTP06090		Ftg, Pipe,Elb,1/4"npt to 3/8" barb,Brass	each	1
66	FTS12001		Ftg, Adap, M12 x 1.5 x 1/4" fnpt, STL	each	1
68	ORS12001		O Ring, Seal, 12 mm metric	each	1
70	HOR03800		Hose, Heater, 3/8" ID, (250' - 80235GL)	feet	5.00
80	KBN84570		Bag Kit, Fasteners,KMN84570/1960/2661	each	1

\*\*\*\* NOTE: Please insure that the inboard backside idler pulley's 10 mm x 90mm lg. bolt has flattened/tightened the lockwasher properly and NOT bottomed out due to insufficient thread depth. \*\*\* to adjust this issue, add (1) or (2) 10mm flatwashers between the Sleeve's flange face and the lockwasher in question. \*\*\*

# Bill of Materials Listing

TransArctic Canada Inc.

12/28/2005

Page 1 of 1

Product Number		Description	Bin	Date	Weight	Uof M	Yield
Line	Component Prod#	Description		Unit	Qty		
<b>KBN84570</b>		<b>Bag Kit, Fasteners, KMN84570/1960/2661</b>		<b>9/1/2004</b>	<b>1.00</b>		<b>1</b>
10	BTC10090	Bolt, Hex, 10 x 1.5 x 90mm, 10.9, Plt		each	1		
20	BTC10040	Bolt, Hex, 10 x 1.5 x 40mm, 10.9, Plt		each	4		
30	BTC08100	Bolt, Hex, 8 x 1.25 x 100mm, 10.9, Plt		each	7		
40	BTS10001	Bolt, Shoulder, 10mm (89064)		each	1		
50	CSS08040	Capscrew, SH, 8 x 1.25 x 40mm, 12.9, Plt		each	4		
60	WDS17001	Washer, Dust Cover (89060)		each	1		
70	WFA08000	Washer, Flat, 8mm, 8.8, Plt		each	7		
80	WLA10000	Washer, Lock, 10mm, 8.8, Plt		each	5		
90	WLA08000	Washer, Lock, 8mm, 8.8, Plt		each	7		

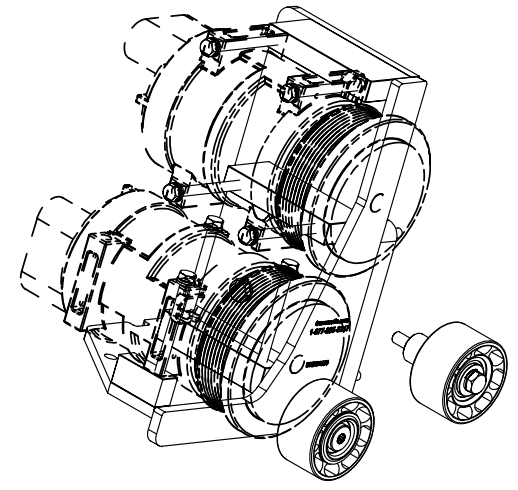
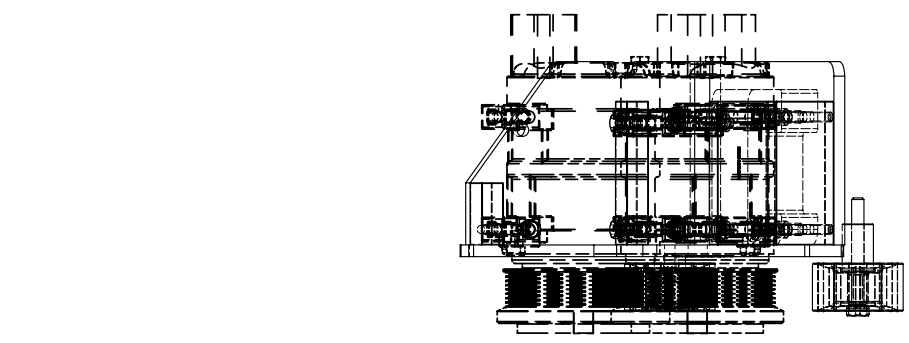

ISOMETRIC VIEW

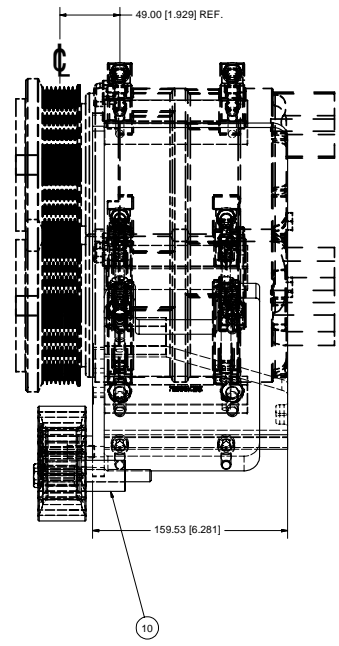
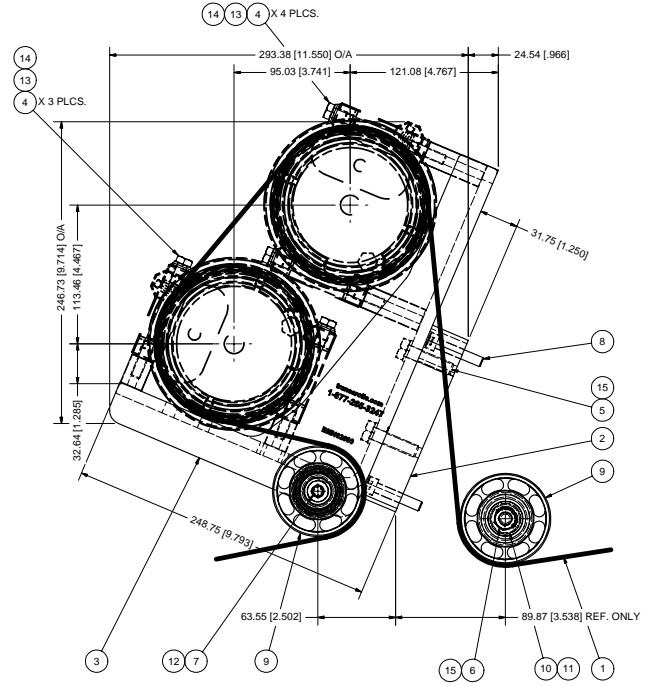
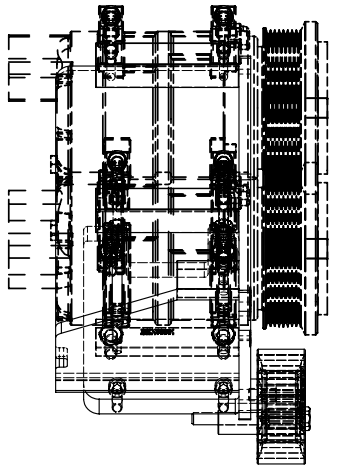

ITEM	QTY	U/M	PART NUMBER	DESCRIPTION
18	1	EACH	ORS12001	O RING, SEAL, 12mm METRIC
17	1	EACH	FTS12001	FTG. ADAP. M12 x 1.5 x 1/4" FNPT, STL
16	1	EACH	FTS06090	FTG. PIPE, ELB, 1/4" NPT TO 3/8" BARB, BRASS
15	5	EACH	WLA10000	WASHER, LOCK, 10mm, 8.8, PLT
14	7	EACH	WLA08000	WASHER, LOCK, 8mm, 8.8, PLT
13	7	EACH	WFA08000	WASHER, FLAT, 8mm, 8.8, PLT
12	1	EACH	WDS17001	WASHER, DUST COVER (PUL80076)
11	1	EACH	SLV17010	SLEEVE, PULLEY, 16.96 x 22.23mm x 10.32
10	1	EACH	SCD39710	SPACER, COL, DRL, 39.7mm x 25.40 x 10.31
9	2	EACH	PUL80076	PULLEY, IDLER, BACKSIDE, P8, 76D, 39W
8	4	EACH	CSS08040	CAPSCREW, SH, 8 x 1.25 x 40mm, 12.9, PLT
7	1	EACH	BTS10001	BOLT, SHOULDER, 10mm (IDLER PULLEY)
6	1	EACH	BTC10090	BOLT, HEX, 10 x 1.5 x 90mm, 10.9, PLT
5	4	EACH	BTC10040	BOLT, HEX, 10 x 1.5 x 40mm, 10.9, PLT
4	7	EACH	BTC08100	BOLT, HEX, 8 x 1.25 x 100mm, 10.9, PLT
3	1	EACH	BMN80001	BKT, MAIN, DT466, CE300, 2 TM-21/TM-16
2	1	EACH	BMN80001	BKT, SPACER, DT466, CE300
1	1	EACH	BEL83035	BELT, 8gr, 3035mm (119.5") (5081195)

**TRANSARGTIG INC.**

DATE	12/24/2005	BY	GA
RELEASED TO PRODUCTION	12/24/2005	VAL	GA
REVIEW	DATE	BY	DATE
	12/24/2005	James Stewart	12/24/2005
	12/24/2005	Val Jakowlew	12/24/2005
	12/24/2005	Dale Mason	12/24/2005

Mtr Kit, DT466, RE300, 2 TM-21		SIZE	DWG NO	REV
		D	KMN82661	0
DRAWING UNIT OF MEASURE		MM [INCH]	SCALE	1:2
SHEET		1	OF	1

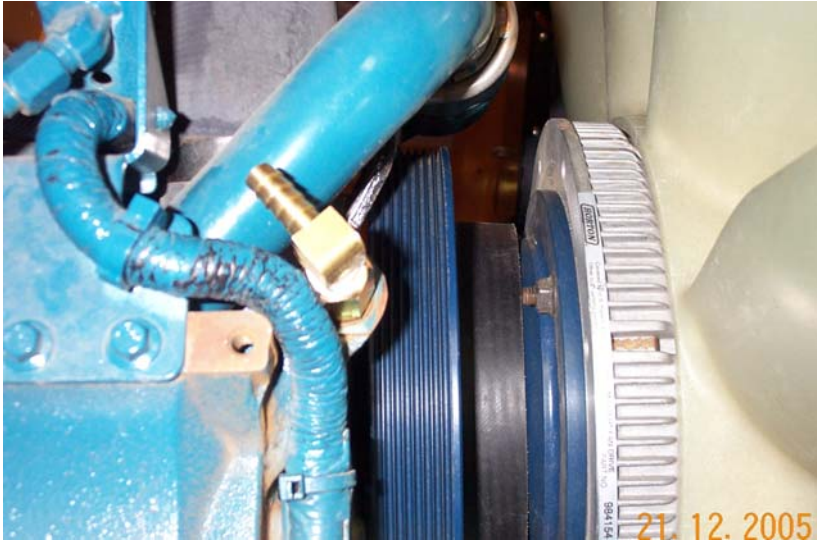

Install fitting and new overflow tube.



Install BMN60001 & Rotate Turbo intake tube away from Alternator.



Mount Main Bracket, secure all hoses and tubes and check belt alignment.

## **TransArctic A/C Compressor Mount Installation Disclaimer**

All compressor mounts should be installed by qualified and trained personnel using proper tools and equipment in safe working conditions following industry standard guidelines for motor vehicle service and repair.

The installer of any compressor mount purchased from TransArctic must undertake all responsibility of issues arising from that compressor bracket being installed on any vehicle. As well as insure that a **proper and sufficient ground** is established between the compressors' clutches and the vehicle's engine. Mount functionality, operation and durability can all be compromised by an incompetent installation.

Due to the many different situations, parameters and application criteria, which are beyond the compressor mount manufacturer's control, TransArctic does not warrant design, durability, or operational functionality of any compressor mount improperly installed by another party.

**With no implied guarantees it is the mount installer's strict responsibility to determine safety and functionality, of the compressor mount, at the time of installation.**

Please contact TransArctic with any issue arising from installation so we may better improve the product. If you have any reservations about the compressor mount integrity contact TransArctic immediately at 1-877-COLD-AIR.

**Mark OEM tensioner location**

**Install Kit**

**Check for Interferences**

**Check to ensure that the proper OEM tensioner orientation is maintained**

**Run engine with A/C system engaged for at least 10 minutes to run in belt**

**Check OEM tensioner orientation and adjust as required**

### **Responsabilidad limitada de TransArctic en la instalación del soporte del compresor**

Todos los soportes de los compresores deben ser instalados por personas calificadas y entrenadas, usando para ello los equipos y herramientas necesarios para esta labor en buenas condiciones y según las normas y guías para el servicio y/o reparación de motores de vehículos.

El instalador de los soportes comprados en TransArctic asume toda la responsabilidad de cualquier problema que surja en el soporte del compresor al vehículo; de igual manera es responsable que el cable a tierra sea conectado entre el embrague del compresor y el motor del vehículo.

Se advierte que el buen funcionamiento y la durabilidad del soporte pueden ser comprometidos por defectos en su instalación.

Debido a las diversas situaciones que se puedan presentar fuera del control del fabricante, TransArctic no garantiza el diseño, la durabilidad o el correcto funcionamiento de cualquier equipo inapropiadamente instalado por terceros.

**Esta sobreentendido que el Instalador del montaje del compresor es estrictamente responsable de la seguridad y funcionamiento del equipo en el momento de la instalación.**

Si tuviera algún problema o duda acerca de la instalación del soporte del compresor pongase en contacto inmediatamente con TransArctic al teléfono 1-877-COLD-AIR de modo que podamos mejorar nuestro producto.

**Note la ubicación del medidor de tensión OEM**

**Instale el equipo**

**Controlar si hay interferencias.**

**Asegurese que el medidor de tensión mantenga la orientación justa.**

**Encienda el motor por lo menos 10 minutos con el sistema A/C enganchado para que la correa corra**

**Controle la orientación justa del medidor de tensión y ajuste a las condiciones requeridas del fabricante**