

# Bill of Materials Listing

TransArctic Canada Inc.

10/8/2021  
Page 1 of 1

Product Number	Date	Description		Uof M	Weight	Yield		
Line	Qty	Component	Prod#	Rev#	Description	Bin	Unit	
<b>KMC94168</b>	<b>9/26/2013</b>	<b>5</b>	<b>Mt Kit, ISL13, T3RE, 05G, '22</b>				<b>860.33</b>	<b>0</b>
5	1	PAC39131			Pack, Carton, 39" x 13" x 16.25", 51 BC		each	
10	1	BEL32286			Belt, Banded B gr,2286mm (90")		each	
20	1	BMC67197		0	Bkt, Main, Idler, Weldm't, '20		each	
30	1	BMC67198		0	Bkt, Brace, Idler, Support, '20		each	
35	1	BMC83053		1	Bkt, Diag, Brace RR, MFDT, RE300		each	
40	1	BMC83058		0	Bkt, Cover, Light Pl, MF DT, RE300		each	
50	1	BMC83074		1	Bkt, Relay, ISC, D3RE, 2010		each	
60	1	BMC83107		1	Bkt, Main, FRT Support, T3RE, '13		each	
70	1	BMC83108		0	Bkt, Main, RR Support, T3RE, '13		each	
80	1	BMC83109		0	Bkt, Main, Lateral Brace, T3RE, '13		each	
90	1	BMC83113		0	Bkt, Brace RR/PS, PDU Panel, T3RE, '13		each	
100	1	BMC83116		0	Bkt, Support, PDU Panel, T3RE, '13		each	
110	1	BMC83120		0	Bkt, Weldm't, Sup, A.F Housing,T3RE,'13		each	
120	1	BMC83122		0	Bkt, Exhaust, Adapter, T3RE, '13		each	
130	2	CLP04000			Clamp, T bolt, Spring, 4", CAC		each	
140	1	HOA04083		0	Hose, Flex, CAC, 4.0d x 8.0, 3 ring		each	
150	1	KCB84164		2	Kit, Compressor, 24V,O5G, '13		each	
170	1	PUA05012		0	Pulley, Assy, Idler,B/BX gr,5", STL,Plt		each	
180	1	PUL80074			Pulley, Idler, B/S, Wide, 74d (89102)		each	
190	1	PUL89024		1	Pulley, Crank, ADD-ON, ISL, 2B, '21		each	
200	1	SCD37012		0	Spacer, Col, Drl, 37 mm x 25.4o x 12.3i		each	
210	1	SCD41012		0	Spacer, Col, Drl, 41 mm x 25.4o x 12.3i		each	
220	2	SLV17012		0	Sleeve, Pulley, 16.9o x 22.23mm x 12.32i		each	
230	1	TUS04093		0	Tube, Stl, Exh, 4"o.d., 90 deg elb,8 x 8		each	
240	1	KBC94168		0	Bag Kit, Fasteners, KMC94168		each	

WILL REQUIRE TMP00002 (TEMPLATE).

# Bill of Materials Listing

TransArctic Canada Inc.

10/8/2021  
Page 1 of 1

Product Number	Date	Description	Uof M	Weight	Yield	
Line	Qty	Component Prod#	Rev#	Bin	Unit	
<b>KBC94168</b>	<b>7/9/2013</b>	<b>0 Bag Kit, Fasteners, KMC94168</b>			<b>3.74</b>	<b>0</b>
10	4	BTC08035			each	
20	3	BTC10035			each	
30	5	BTC10070			each	
40	5	BTC12040			each	
50	2	BTC12050			each	
60	2	BTC12100			each	
70	7	BTQ08126			each	
80	3	NTA10000			each	
90	9	NTA12000			each	
100	3	SCP03075			each	
160	4	WFA08000			each	
170	6	WFA10000			each	
180	16	WFA12000			each	
190	6	WFQ08000			each	
200	4	WLA08000			each	
210	3	WLA10000			each	
220	9	WLA12000			each	
230	6	WLQ08000			each	

# Bill of Materials Listing

TransArctic Canada Inc.

9/21/2021  
Page 1 of 1

Product Number	Date	Description	Uof M	Weight	Yield			
Line	Qty	Component Prod#	Rev#	Description	Bin	Unit	Weight	Yield
<b>KCB84164</b>	<b>8/2/2013</b>	<b>2</b>	<b>2</b>	<b>Kit, Compressor, 24V,O5G, '13</b>			<b>446.29</b>	<b>0</b>
10	2	BEL11143		Belt, A gr, 1143mm (45") (17450)		each		
30	2	BMN80008		1 Vibration Isolator, Bar, 16.50 x 2 x 1.50		each		
40	1	BMZ00043		3 Bkt, Main, Base Pl, '13		each		
50	1	BMN80025		0 Bkt, Back, PL, Slide, IC, RE300		each		
60	2	BMT10011		0 Bkt, Tenr, Block, Offset, 3mm		each		
70	1	KBT84164		1 Kit, Platform, O5G W/ Alt, '13		each		
80	1	PUL03321		1 Pulley, ALT, Idler, 3.25"d, 2A		each		
90	1	TRD08120		Threaded, Rod, 1/2-13unc x 12", 5, Plt		each		
100	1	KBZ84164		1 Bag Kit, Fasteners, KCB84164		each		

# Bill of Materials Listing

TransArctic Canada Inc.

10/8/2021  
Page 1 of 1

Product Number	Date	Description	Uof M	Weight	Yield			
Line	Qty	Component Prod#	Rev#	Description	Bin	Unit	Weight	Yield
<b>KBZ84164</b>	<b>10/18/2013</b>	<b>1</b>	<b>1</b>	<b>Bag Kit, Fasteners, KCB84164</b>			<b>2.16</b>	<b>0</b>
10	1	BTP08653		Bolt, Hex, 1/2-13unc, 6.5", 5, Plt, FT		each		
20	3	BTQ08101		Bolt, Hex, 1/2-20unf, 1.00", 8, Plt		each		
30	2	BTQ08126		Bolt, Hex, 1/2-20unf, 1.25", 8, Plt		each		
35	1	BTQ08150		Bolt, Hex, 1/2-13unc, 1.5", 8, Plt		each		
40	1	BTQ08200		Bolt, Hex, 1/2-13unc, 2.0", 8, Plt		each		
50	1	BTQ08653		Bolt, Hex, 1/2-13unc, 6.5", 8, Plt		each		
60	1	CSF08076		Capscrew, FH, 1/2-20unf x .75", Alloy, Plt		each		
70	6	NTQ08000		Nut, Hex, 1/2-13unc, 8, Plt		each		
80	8	WFQ08000		Washer, Flat, 1/2", 8, Plt		each		
90	11	WLQ08000		Washer, Lock, 1/2", 8, Plt		each		

# Bill of Materials Listing

TransArctic Canada Inc.

9/21/2021  
Page 1 of 1

Product Number	Date	Description		Uof M	Weight	Yield		
Line	Qty	Component Prod#	Rev#	Description	Bin	Unit		
<b>KBT84164</b>	<b>8/2/2013</b>	<b>1</b>	<b>1</b>	<b>Kit, Platform, O5G W/ Alt, '13</b>			<b>71.01</b>	<b>0</b>
10	1	BMC83111	1	Bkt, Weldm't, Alt Extension, T3RE, '13		each		
20	1	BMN80010	0	Bkt, Main, Slide, Assy, O5G, IC, RE300		each		
50	1	SCD29213	0	Spacer, Col, Drl, 29.21mm x 25.4o x 12.7i		each		
60	1	KBZ94164	0	Bag Kit, Fasteners, KBT84164		each		

# Bill of Materials Listing

TransArctic Canada Inc.

10/8/2021  
Page 1 of 1

Product Number	Date	Description			Uof M	Weight	Yield		
Line	Qty	Component	Prod#	Rev#	Description	Bin	Unit		
<b>KBZ94164</b>		<b>1/21/2015</b>		<b>0</b>	<b>Bag Kit, Fasteners, KBT84164</b>			<b>0.38</b>	<b>0</b>
10	2	BTQ06150			Bolt, Hex, 3/8-16unc, 1.50", 8, Plt		each		
15	4	NTP07000			Nut, Hex, 7/16-14unc, 5, Plt		each		
20	2	WFN06000			Washer, Flat, 3/8", 2, Plt		each		
30	4	WFN07000			Washer, Flat, 7/16", 2, Plt		each		
40	2	WLQ06000			Washer, Lock, 3/8", 8, Plt		each		
50	4	WLQ07000			Washer, Lock, 7/16", 8, Plt		each		

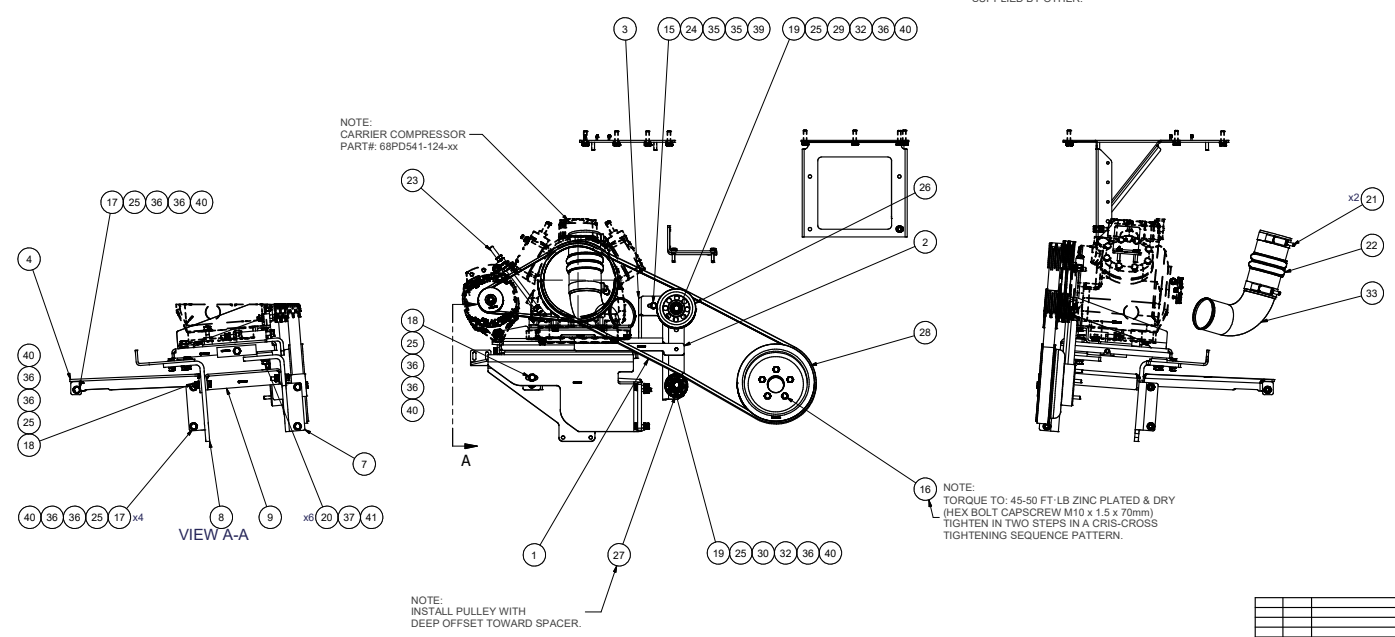
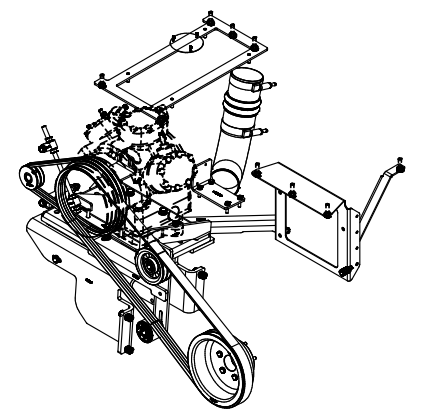
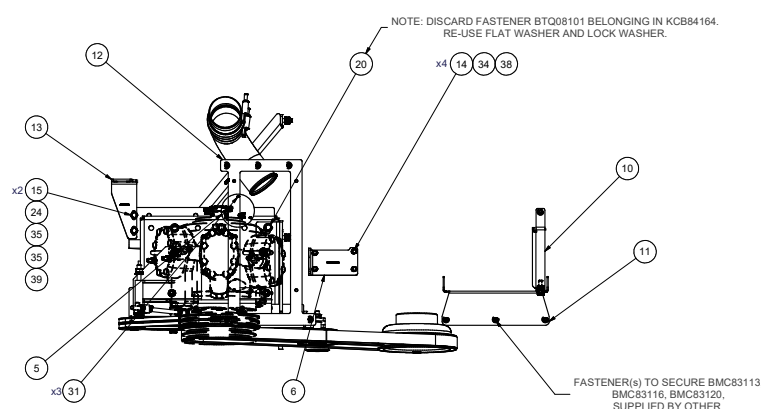

ITEM	QTY	U/M	PART NUMBER	DESCRIPTION
41	6	EACH	WLQ08000	WASHER, LOCK, 1/2", 8, PLT
40	9	EACH	WLA12000	WASHER, LOCK, 12mm, 8.8, PLT
39	3	EACH	WLA10000	WASHER, LOCK, 10mm, 8.8, PLT
38	4	EACH	WLA08000	WASHER, LOCK, 8mm, 8.8, PLT
37	6	EACH	WLF08000	WASHER, FLAT, 1/2", 8, PLT
36	16	EACH	WFA12000	WASHER, FLAT, 12mm, 8.8, PLT
35	6	EACH	WFA10000	WASHER, FLAT, 10mm, 8.8, PLT
34	4	EACH	WFA08000	WASHER, FLAT, 8mm, 8.8, PLT
33	1	EACH	TUS04093	TUBE, STL, EXH, 4"o.d., 90 deg ELB, 8 x 8
32	2	EACH	SLV17012	SLEEVE, PULLEY, 16.9o x 22.23 mm x12.19i
31	3	EACH	SCP03075	SCREW, PH, SDT, #10-16 x .75, ST, PLT
30	1	EACH	SCD41012	SPACER, COL, DRL, 41mm x 25.4o x 12.3i
29	1	EACH	SCD37012	SPACER, COL, DRL, 37mm x 25.4o x 12.3i
28	1	EACH	PUL89024	PULLEY, CRANK, ADD-ON, ISL, 2B, 21
27	1	EACH	PUL80074	PULLEY, IDLER, BACKSIDE, P8, 74D, 46.27W
26	1	EACH	PIA05012	PULLEY, ASSY, IDLER, B/BX gr, 5" STL, PLT
25	9	EACH	NTA12000	NUT, HEX, 12 x 1.75, 8.8, PLT
24	3	EACH	NTA10000	NUT, HEX, 10 x 1.5, 8.8, PLT
23	1	EACH	KCB84164	KIT, COMPRESSOR, 24V, OSG, '13
22	1	EACH	HOA04083	HOSE, FLEX, CAC, 4.0d x 8.0, 3 RING
21	2	EACH	CLP04000	CLAMP, T BOLT, SPRING, 4", CAC
20	7	EACH	BTQ08126	BOLT, HEX, 1/2-20UNF x 1.25, 8, PLT
19	2	EACH	BTCL12100	BOLT, HEX, 12 x 1.75 x 100mm, 10.9, PLT
18	2	EACH	BTCL2050	BOLT, HEX, 12 x 1.75 x 50mm, 10.9, PLT
17	5	EACH	BTCL2040	BOLT, HEX, 12 x 1.75 x 40mm, 10.9, PLT
16	5	EACH	BTCL0070	BOLT, HEX, 10 x 1.5 x 70mm, 10.9, PLT
15	3	EACH	BTCL0035	BOLT, HEX, 10 x 1.5 x 35mm, 10.9, PLT
14	4	EACH	BTCL08035	BOLT, HEX, 8 x 1.25 x 35mm, 10.9, PLT
13	1	EACH	BMC83122	BKT, EXHAUST, ADAPTER, T3RE, '13
12	1	EACH	BMC83120	BKT, WELDMT, SUP. A.F HOUSING, T3RE, '13
11	1	EACH	BMC83116	BKT, SUPPORT, PDU PANEL, T3RE, '13
10	1	EACH	BMC83113	BKT, BRACE RR/PS, PDU PANEL, T3RE, '13
9	1	EACH	BMC83109	BKT, MAIN, LATERAL BRACE, T3RE, '13
8	1	EACH	BMC83108	BKT, MAIN, RR SUPPORT, T3RE, '13
7	1	EACH	BMC83107	BKT, MAIN, FRT SUPPORT, T3RE, '13
6	1	EACH	BMC83074	BKT, RELAY, ISC, D3RE, 2010
5	1	EACH	BMC83058	BKT, COVER, LIGHT PL, MFDOT, RE300
4	1	EACH	BMC83053	BKT, DIAG, BRACE RR, MFDOT, RE300
3	1	EACH	BMC67198	BKT, BRACE, IDLER, SUPPORT, '20
2	1	EACH	BMC67197	BKT, MAIN, IDLER, WELDMT, '20
1	1	EACH	BEL32286	BELT, BANDED B Gr, 2286 mm (90")

**TRANSARCTIC INC.**

MT KIT, ISL13, T3RE 05G, '22

DATE: 10/8/2021

BY: James Stewart

APPROVED: Dale Mason

SCALE: 1:8

SHEET 1 OF 1

NOTES:  
 1) USE SERVICABLE THREADLOCKER ON ALL FASTENERS TO ENGINE COMPONENTS AND TORQUE ALL BOLTS TO S.A.E. SPECIFICATIONS.  
 2) SEE "TRANSARCTIC A/C COMPRESSOR MOUNT INSTALLATION DISCLAIMER".

REV	ECN	DESCRIPTION	DATE	BY	VAL
0		RELEASED TO PRODUCTION	10/08/21	James Stewart	

UNSPECIFIED TOLERANCES:	ALL DIMS
ONE DECIMAL PLACE (X1)	FRONT
TWO DECIMAL PLACE (X2)	SIDE
THREE DECIMAL PLACE (X3)	TOP
FRACTIONAL (1/16")	ANGLE

SIZE	DWG NO	REV
D	KMC94168	0

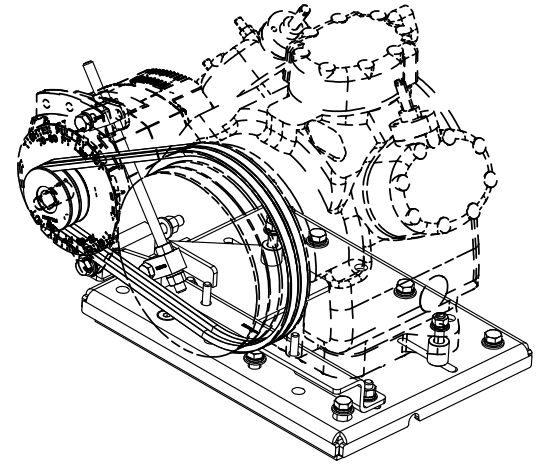
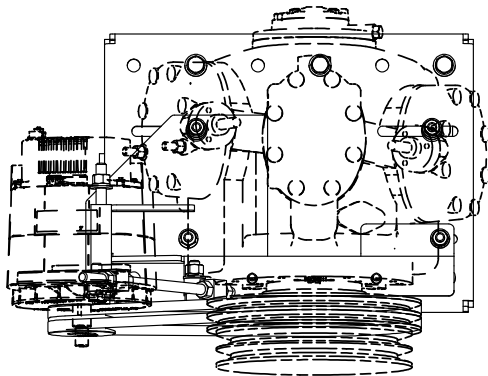
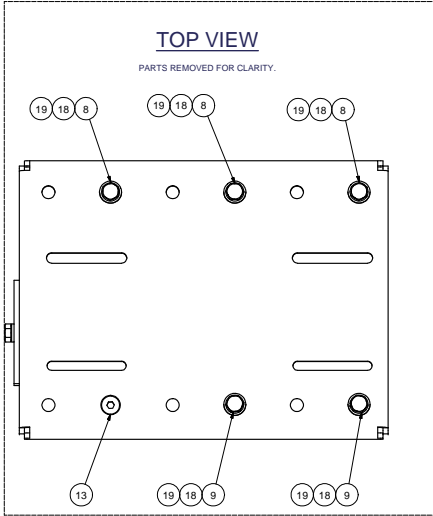

ISOMETRIC VIEW

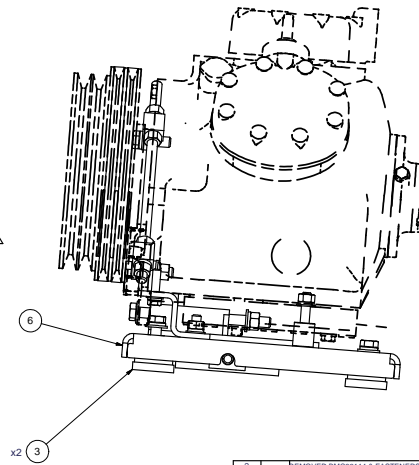
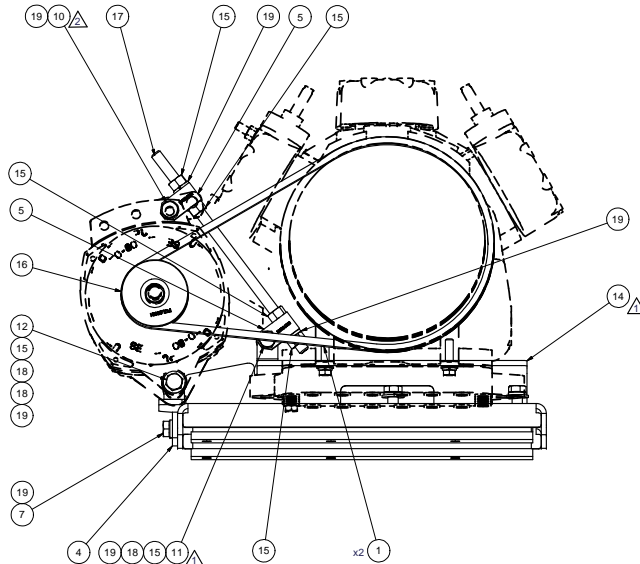

**NOTES:**

- 1) USE SERVICABLE THREADLOCKER ON ALL FASTENERS TO ENGINE COMPONENTS AND TORQUE **ALL** BOLTS TO S.A.E. SPECIFICATIONS.
- 2) SEE "TRANSARCTIC A/C COMPRESSOR MOUNT INSTALLATION DISCLAIMER".
- 3) WEIGHT: 49.38 LBS.

ITEM	QTY	U/M	PART NUMBER	DESCRIPTION
19	11	EACH	WLO08000	WASHER, LOCK, 1/2", 8, PLT
18	8	EACH	WFO08000	WASHER, FLAT, 1/2", 8, PLT
17	1	EACH	TRD08120	THREADED, ROD, 1/2-13UNC x 12", 5 PLT
16	1	EACH	PUL03321	PULLEY, ALT, IDLER, 3.25"o, 2A
15	6	EACH	NTO08000	NUT, HEX, 1/2-13UNC, 8, PLT
14	1	EACH	KBT84164	KIT, PLATFORM, OS6 W/ ALT, '13
13	1	EACH	CSF08076	CAPSCREW, FH, 1/2-20UNF x .75", ALLOY, PLT
12	1	EACH	BT008653	BOLT, HEX, 1/2-13UNC x 6.50, 8, PLT
11	1	EACH	BT008200	BOLT, HEX, 1/2-13UNC x 2.00, 8, PLT
10	1	EACH	BT008150	BOLT, HEX, 1/2-13UNC x 1.50, 8, PLT
9	2	EACH	BT008126	BOLT, HEX, 1/2-20UNF x 1.25, 8, PLT
8	3	EACH	BT008101	BOLT, HEX, 1/2-20UNF x 1.00, 8, PLT
7	1	EACH	BTP08653	BOLT, HEX, 1/2-13UNC x 6.50, 5, PLT, FT
6	1	EACH	BMZ00043	BKT, MAIN, BASE PL, '13
5	2	EACH	BMT10011	BKT, TENR, BLOCK, OFFSET, 3mm
4	1	EACH	BMN00025	BKT, BACK, PL, SLIDE, IC, RE300
3	2	EACH	BMN00008	VIBRATION ISOLATOR, BAR, 16.50 x 2 x 1.50
1	2	EACH	BELT1145	BELT, A GR, T138mm (44.8")

**BILL OF MATERIALS**

DRAWN	9/24/2013
Checked	
REVISED	
RELEASED TO PRODUCTION	9/24/2013
DATE:	9/24/2013
BY:	James Stewart
APPROVED	
DATE:	9/24/2013
BY:	Dale Mason

**TRANSARCTIC INC.**

TITLE: **KIT, COMPRESSOR, 24V, OS6, '13**

SIZE: **D** DWG NO: **KCB84164** REV: **2**

SCALE: **1:4** SHEET **1** OF **1**

UNSPECIFIED TOLERANCES:	MM (INCH)
ONE DECIMAL PLACE (.X)	.05 (0.002)
TWO DECIMAL PLACE (.XX)	.01 (0.0005)
THREE DECIMAL PLACE (.XXX)	.005 (0.0002)
FRACTIONAL (1/16")	NO CALL



DRAWING UNIT OF MEASURE: **MM (INCH)**



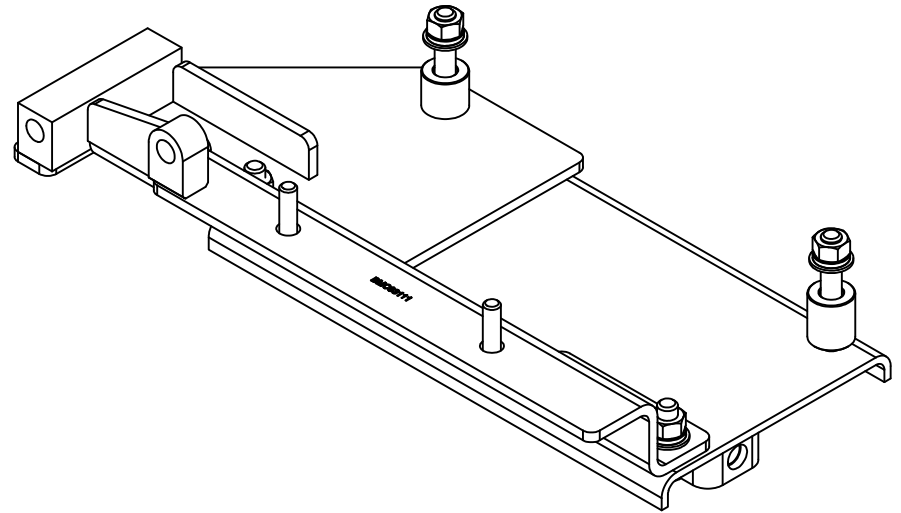
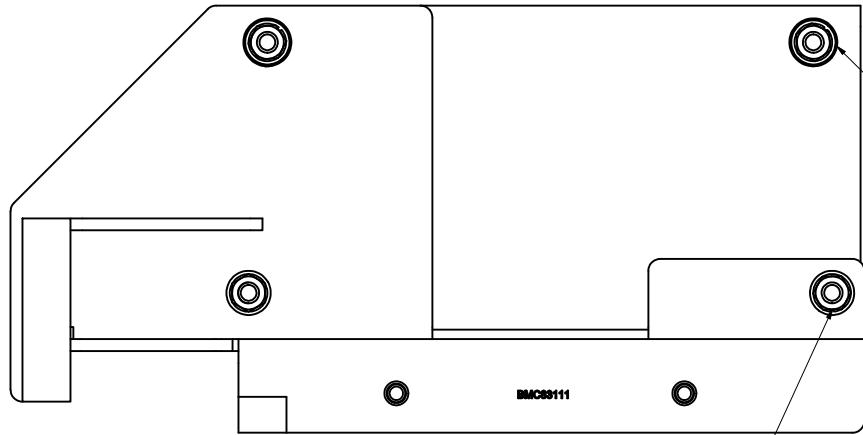

ISOMETRIC VIEW

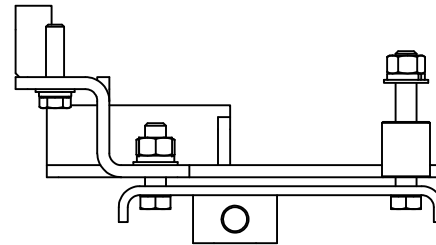
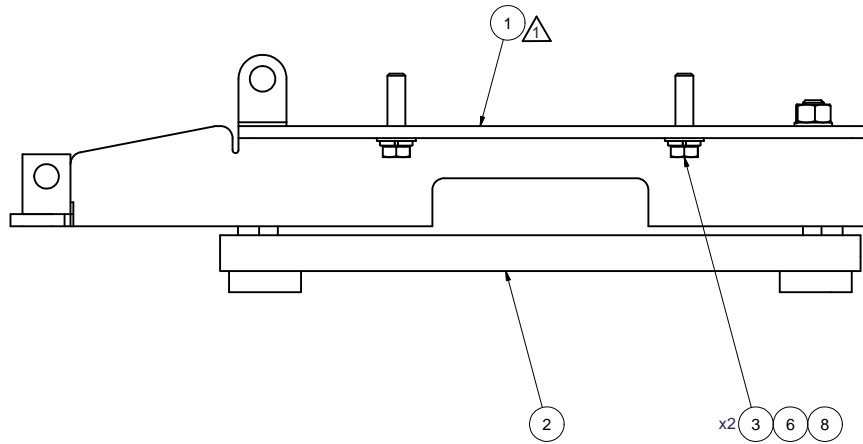

ITEM	QTY	U/M	PART NUMBER	DESCRIPTION
9	4	EACH	WLQ07000	WASHER, LOCK, 7/16", 8, PLT
8	2	EACH	WLQ06000	WASHER, LOCK, 3/8", 8, PLT
7	4	EACH	WFN07000	WASHER, FLAT, 7/16", 2, PLT
6	2	EACH	WFN06000	WASHER, FLAT, 3/8", 2, PLT
5	1	EACH	SCD29213	SPACER, COL, DRL, 29.21mm x 25.4o x 12.7i
4	4	EACH	NTP07000	NUT, HEX, 7/16-14UNC, 5, PLT
3	2	EACH	BTQ06150	BOLT, HEX, 3/8-16UNC, 1.50", 8, PLT
2	1	EACH	BMN80010	BKT, MAIN, SLIDE, ASSY, IC, RE300
1	1	EACH	BMC83111	BKT, WELDM'T, ALT EXTENSION, T3RE, '13

BILL OF MATERIALS

DRAWN	jrodriguez	9/25/2013
CHECKED	Val Jakowlew	9/25/2013
APPROVED	Dale Mason	9/25/2013
MFG	Ron Ingram	9/25/2013



TITLE	KIT, PLATFORM, O5G W/ ALT, '13		
SIZE	C	DWG NO	KBT84164
REV	1		

1	REVISED BMC83111	1/19/2015	JRR
0	RELEASED TO PRODUCTION	9/25/2013	JRR
REV/ECN:	DESCRIPTION:	DATE:	BY:
THIS DRAWING CONTAINS PROPRIETARY CONFIDENTIAL INFORMATION OWNED BY TRANSARCTIC CANADA INC. THE DOCUMENT AND THE INFORMATION IN IT ARE NOT TO BE USED, DISCLOSED OR REPRODUCED WITHOUT EXPRESS WRITTEN PERMISSION OF THE COMPANY.			
UNSPECIFIED TOLERANCES:		[ALT. DIM.]	
ONE DECIMAL PLACE (.X)	.50	[.020]	
TWO DECIMAL PLACE (.XX)	.25	[.010]	
THREE DECIMAL PLACE (.XXX)	.10	[.005]	
FRACTIONAL +/- 1/32"	ANGULAR +/- .50°	THIRD ANGLE PROJECTION	

- NOTES:
- USE SERVICABLE THREADLOCKER ON ALL FASTENERS TO ENGINE COMPONENTS AND TORQUE **ALL** BOLTS TO S.A.E. SPECIFICATIONS.
  - SEE "TRANSARCTIC A/C COMPRESSOR MOUNT INSTALLATION DISCLAIMER".
  - WEIGHT: 16.18 LBS.

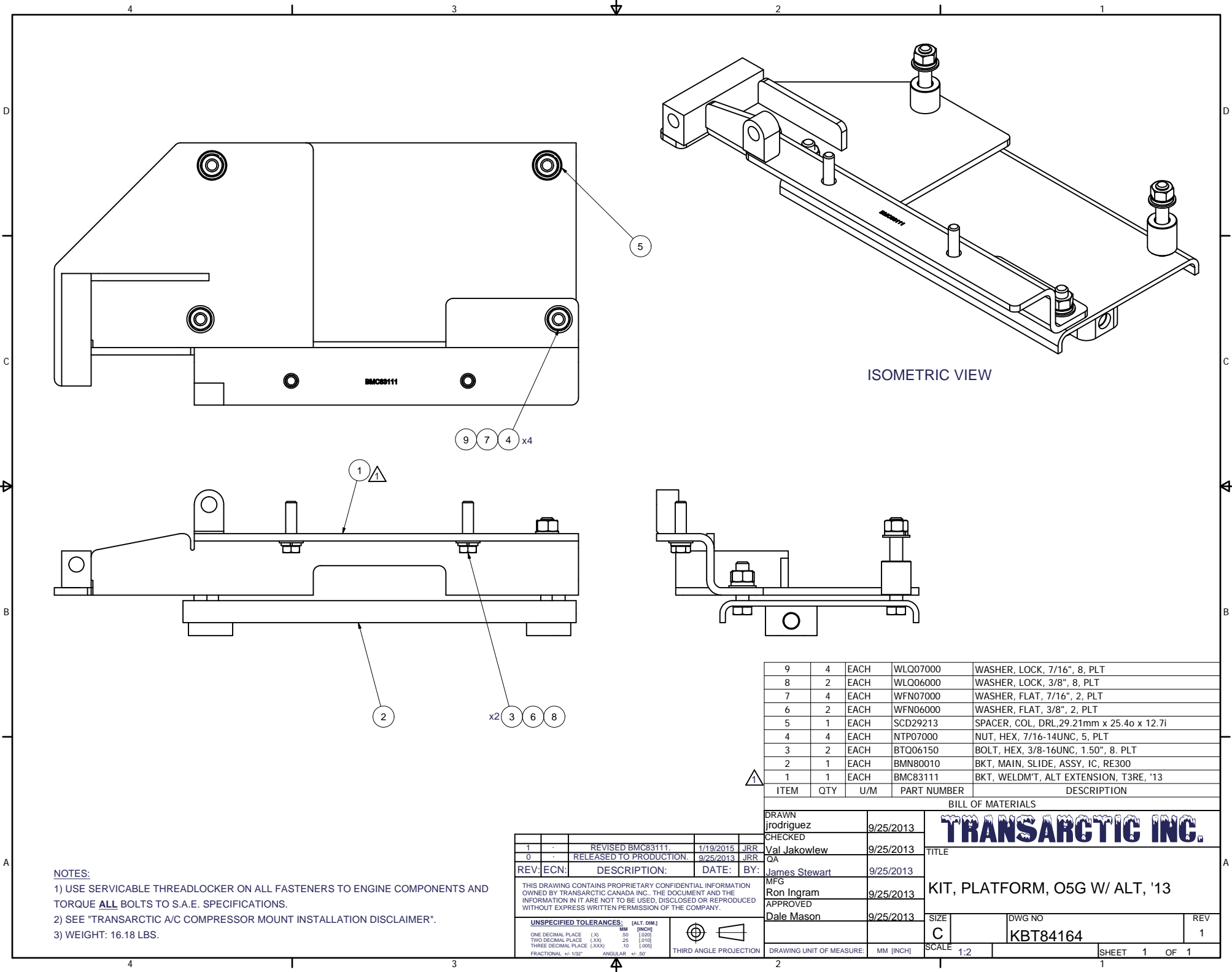

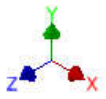
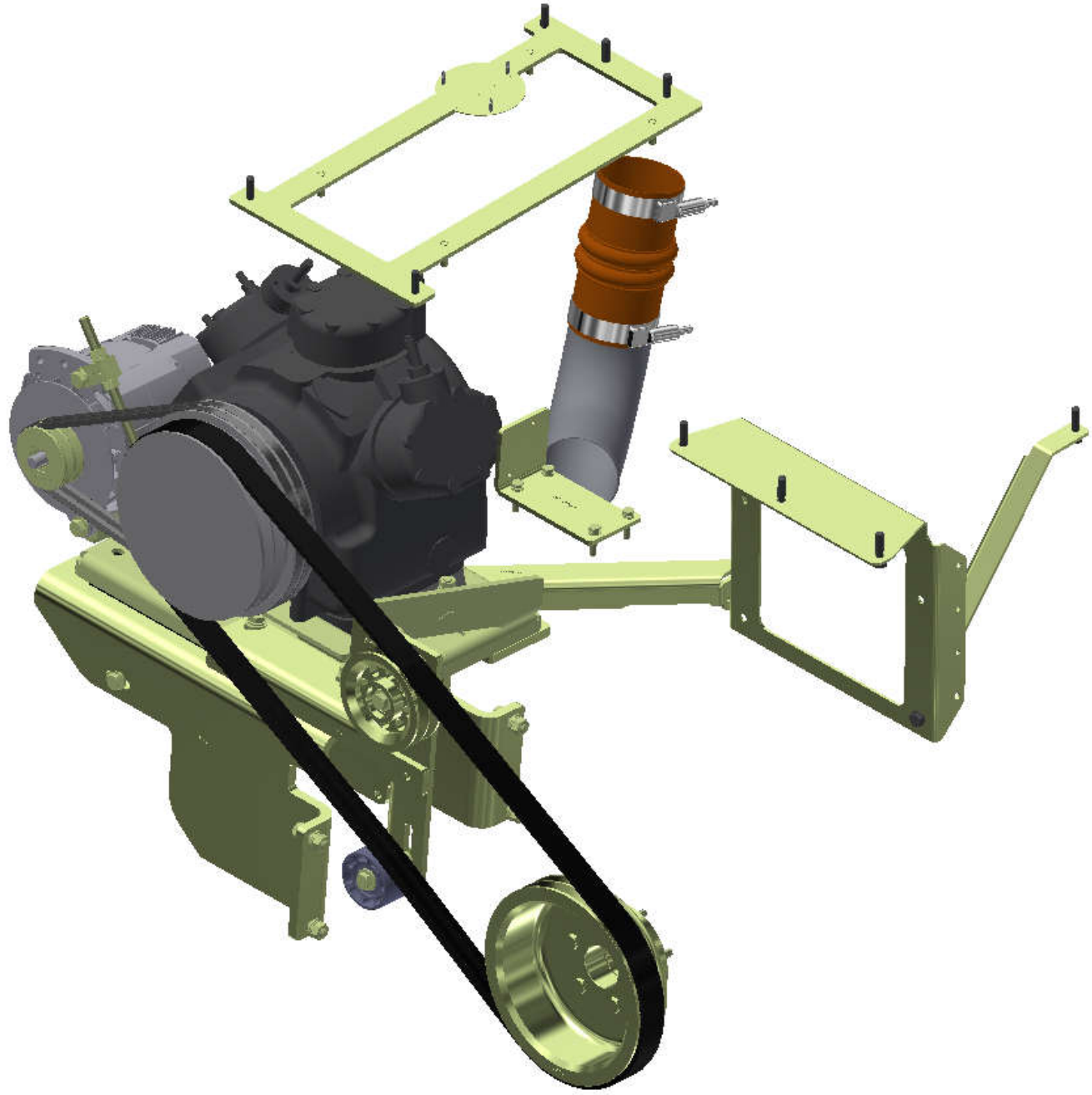

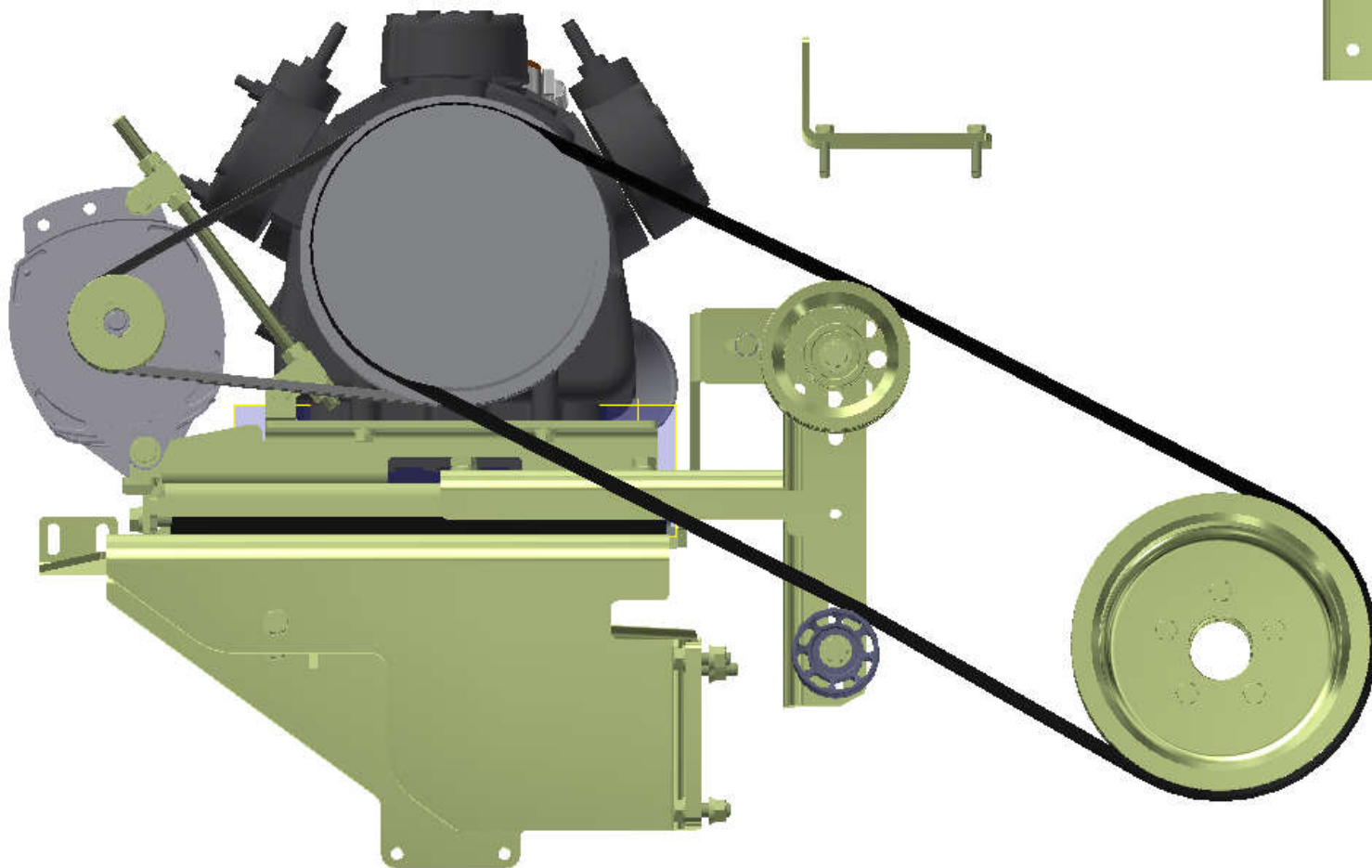
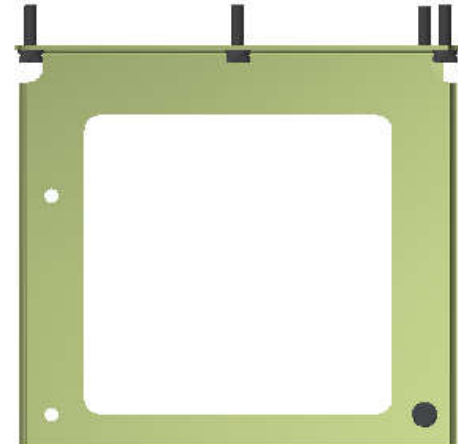

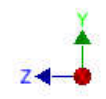
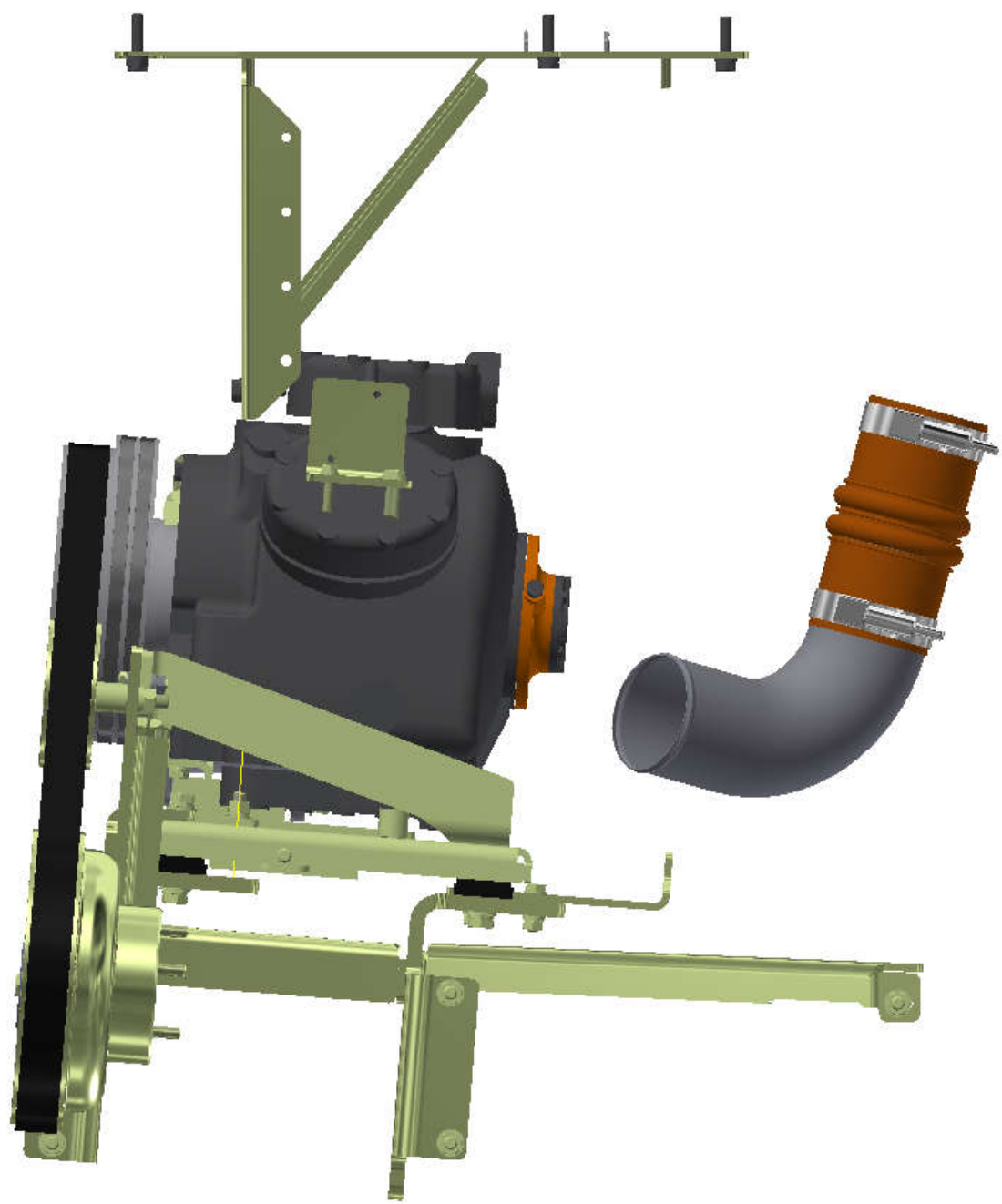

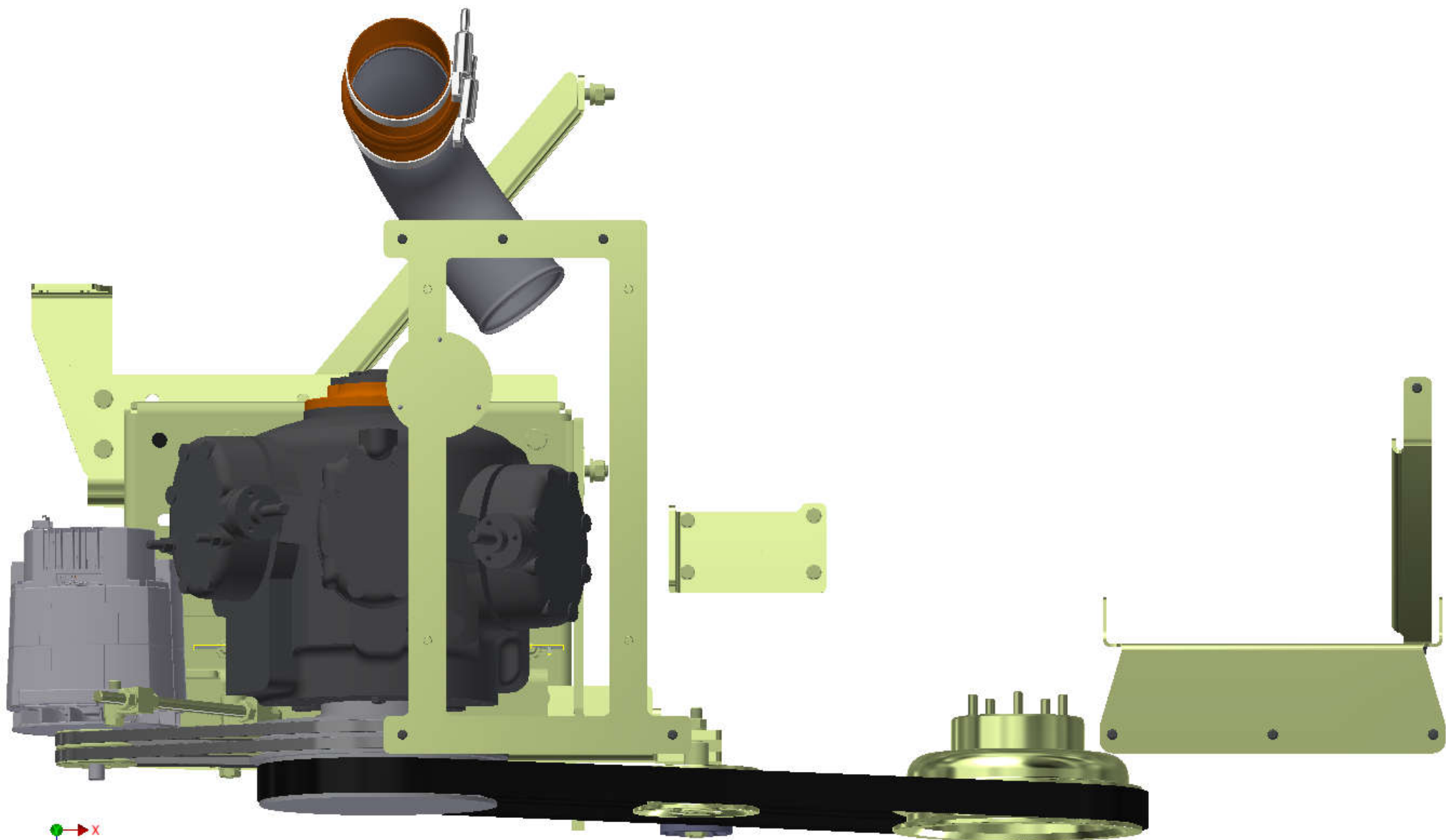

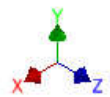
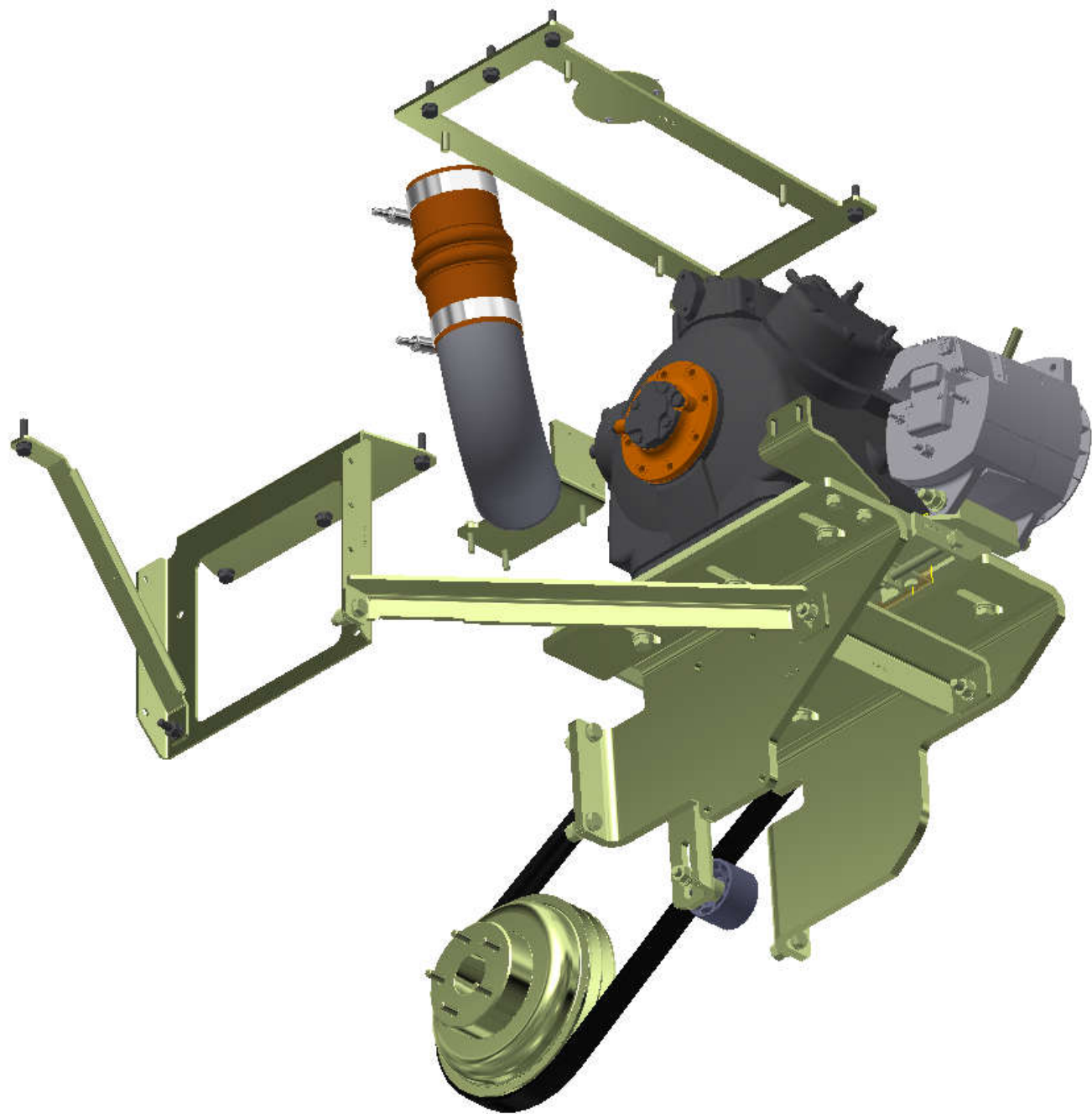

## **TransArctic A/C Compressor Mount Installation Disclaimer**

All compressor mounts should be installed by qualified and trained personnel using proper tools and equipment in safe working conditions following industry standard guidelines for motor vehicle service and repair.

The installer of any compressor mount purchased from TransArctic must undertake all responsibility of issues arising from that compressor bracket being installed on any vehicle. As well as insure that a **proper and sufficient ground** is established between the compressors' clutches and the vehicle's engine. Mount functionality, operation and durability can all be compromised by an incompetent installation.

Due to the many different situations, parameters and application criteria, which are beyond the compressor mount manufacturer's control, TransArctic does not warrant design, durability, or operational functionality of any compressor mount improperly installed by another party.

**With no implied guarantees it is the mount installer's strict responsibility to determine safety and functionality, of the compressor mount, at the time of installation.**

Please contact TransArctic with any issue arising from installation so we may better improve the product. If you have any reservations about the compressor mount integrity contact TransArctic immediately at 1-877-COLD-AIR.

**Mark OEM tensioner location**

**Install Kit**

**Check for Interferences**

**Check to ensure that the proper OEM tensioner orientation is maintained**

**Run engine with A/C system engaged for at least 10 minutes to run in belt**

**Check OEM tensioner orientation and adjust as required**

### **Responsabilidad limitada de TransArctic en la instalación del soporte del compresor**

Todos los soportes de los compresores deben ser instalados por personas calificadas y entrenadas, usando para ello los equipos y herramientas necesarios para esta labor en buenas condiciones y según las normas y guías para el servicio y/o reparación de motores de vehículos.

El instalador de los soportes comprados en TransArctic asume toda la responsabilidad de cualquier problema que surja en el soporte del compresor al vehículo; de igual manera es responsable que el cable a tierra sea conectado entre el embrague del compresor y el motor del vehículo.

Se advierte que el buen funcionamiento y la durabilidad del soporte pueden ser comprometidos por defectos en su instalación.

Debido a las diversas situaciones que se puedan presentar fuera del control del fabricante, TransArctic no garantiza el diseño, la durabilidad o el correcto funcionamiento de cualquier equipo inapropiadamente instalado por terceros.

**Esta sobreentendido que el Instalador del montaje del compresor es estrictamente responsable de la seguridad y funcionamiento del equipo en el momento de la instalación.**

Si tuviera algún problema o duda acerca de la instalación del soporte del compresor pongase en contacto inmediatamente con TransArctic al teléfono 1-877-COLD-AIR de modo que podamos mejorar nuestro producto.

**Note la ubicación del medidor de tensión OEM**

**Instale el equipo**

**Controlar si hay interferencias.**

**Asegurese que el medidor de tensión mantenga la orientación justa.**

**Encienda el motor por lo menos 10 minutos con el sistema A/C enganchado para que la correa corra**

**Controle la orientación justa del medidor de tensión y ajuste a las condiciones requeridas del fabricante**