

# Bill of Materials Listing

TransArctic Canada Inc.

10/13/2021  
Page 1 of 1

Product Number	Date	Description		Uof M	Weight	Yield	
Line	Qty	Component	Prod#	Rev#	Description	Bin	Unit
<b>KMC96531</b>	<b>4/25/2017</b>			<b>0</b>	<b>Mt Kit, ISL, ICRE, TM-55/65, '21</b>		
5	1	PAC39131			Pack, Carton, 39" x 13" x 16.25", 51 BC		each
10	2	BEL21626			Belt, B gr, 1626mm (64") (BX61)		each
20	1	BEL82096			Belt, 8gr, 2096mm (82.5") (5080825)		each
30	1	BMC90047		0	Brk, Brace, Air Filter Box		each
40	1	BMC90052		0	Brk, Reservoir Tank, Label, ICRE, '21		each
50	1	BMN80109		1	Bkt, Jack Shaft, Cummins, ICRE, '21		each
60	1	BMN80116		2	Bkt, Main, FRT, Weldmt, ICRE, '21		each
70	1	BMN80119		2	Bkt, Main, RR, Weldmt, ICRE, '21		each
80	1	BMN80123		1	Bkt, Main, Xbrace, ICRE, '21		each
90	2	CLP72001			Clamp, Gear, #72, 3" - 5" (76.2/127mm)		each
100	1	HOA04530		0	Hose, Flex,CAC,Elb,Silicon,4.5 x 30d,BLU		each
110	1	KBB00003		0	Mt Kit, Platform, Transit, ADM, '21		each
120	1	KCB95501		0	Kit, Compressor, Tilt, 12v, TM-55/65,'21		each
130	1	PUA84101		0	Pulley, Assy, Idler, P8/2B gr,7",STL,Pit		each
140	1	KBC96631		0	Bag Kit, Fasteners, KMC96631 & KMC96531		each
							<b>1684.53</b>
							<b>0</b>

# Bill of Materials Listing

TransArctic Canada Inc.

9/7/2021  
Page 1 of 1

Product Number	Date	Description			Uof M	Weight	Yield	
Line	Qty	Component	Prod#	Rev#	Description	Bin	Unit	
<b>KBC96631</b>	<b>7/14/2016</b>	<b>0</b>	<b>Bag Kit, Fasteners, KMC96631 &amp; KMC96531</b>				<b>3.59</b>	<b>0</b>
10	6	BTC08035			Bolt, Hex, 8 x 1.25 x 35mm, 10.9, Plt,FT		each	
20	4	BTC10060			Bolt, Hex, 10 x 1.5 x 60mm, 10.9, Plt		each	
40	1	BTC12030			Bolt, Hex, 12 x 1.75 x 30mm, 10.9, Plt		each	
50	1	BTC12120			Bolt, Hex, 12 x 1.75 x 120mm, 10.9, Plt		each	
60	2	BTC16070			Bolt, Hex, 16 x 2 x 70mm, 10.9, Plt		each	
70	6	BTQ08126			Bolt, Hex, 1/2-20unf, 1.25", 8, Plt		each	
80	4	CSF10046			Capscrew, FH, 10 x 1.5 x 45mm, 10.9,Plt		each	
90	8	NTA10000			Nut, Hex, 10 x 1.5, 8.8, Plt		each	
100	1	NTA12000			Nut, Hex, 12 x 1.75, 8.8, Plt		each	
110	2	NTA16000			Nut, Hex, 16 x 2, 8.8, Plt		each	
120	6	WFA08000			Washer, Flat, 8mm, 8.8, Plt		each	
130	4	WFA10000			Washer, Flat, 10mm, 8.8, Plt		each	
140	8	WFA10002			Washer, Flat, 10mm, Hvy, 8.8, Plt		each	
150	2	WFA12002			Washer, Flat, 12mm, Hvy, 8.8, Plt		each	
160	4	WFA16000			Washer, Flat, 16mm, 8.8, Plt		each	
170	6	WFQ08000			Washer, Flat, 1/2", 8, Plt		each	
180	1	WFS12001			1 Washer, Flat, Step, 12mm, 69.85, Plt		each	
190	6	WLA08000			Washer, Lock, 8mm, 8.8, Plt		each	
200	8	WLA10000			Washer, Lock, 10mm, 8.8, Plt		each	
210	2	WLA12000			Washer, Lock, 12mm, 8.8, Plt		each	
220	2	WLA16000			Washer, Lock, 16mm, 8.8, Plt		each	
230	6	WLQ08000			Washer, Lock, 1/2", 8, Plt		each	

# Bill of Materials Listing

TransArctic Canada Inc.

9/7/2021  
Page 1 of 1

Product Number	Date	Description	Uof M	Weight	Yield	
Line	Qty	Component Prod#	Rev#	Bin	Unit	
<b>KBB00003</b>	<b>6/20/2012</b>	<b>0 MT KIT, PLATFORM, TRANSIT, ADM, '21</b>			<b>847.29</b>	<b>0</b>
10	1	BMZ01034			2 Bkt, Spring, Support Arm, ADM, '12	each
20	1	BMZ01070			0 Bkt, Main, Pivot, Ass'y, 05G,Transit,'21	each
30	1	BMZ01037			2 Bkt, Fork, Knuckle-Joint, Adm, '12	each
40	1	BMZ00043			3 Bkt, Main, Base Pl, '13	each
50	1	BMZ01040			0 Bkt, Ass'y, THRD Rod, Isolator, ADM, '12	each
60	2	BMZ01041			2 Shaft Key, 5/16" SQ x .540" Long	each
70	2	BMN80008			1 Vibration Isolator, Bar, 16.50 x 2 x 1.50	each
71	1	BMN80025			0 Bkt, Back, PL, Slide, IC, RE300	each
72	1	BMN80104			0 Bkt, Main, Slide, Assy, ICRE	each
80	1	BMZ01072			0 Bkt, Assy, Cradle, Pivot, 05G,Transit,21	each
110	1	PIS01010			2 Shaft, Stl, Grease, ADM Transit, '12	each
120	1	SPR00002			0 Spring, Comp, R/H, 110 x 50 x 8.4, Red	each
130	1	WFS16001			0 Washer, Flat, Dbl Step, 17mm, 50mm, Plt	each
140	1	WFS27001			0 Washer, Flat, Dbl Step, 27mm, 63.5, Plt	each
150	1	KBB00027			0 Bag Kit, Fasteners, Spring Assy,KBB00003	each
160	1	KBB00028			0 Bag Kit, Fasteners, Pivot Assy, KBB00003	each

**NOTE:**

Use Blue "Loctite" on the (4) fasteners to fasten BMZ01034 in place.  
 1/2 -13 UNC grd. 8 bolts, c/w L'whrs torque... used on the PIS01010 Shaft  
 = 45 FT\*LBS. (/VTS@ JAN-25-2019)

# Bill of Materials Listing

TransArctic Canada Inc.

9/9/2021  
Page 1 of 1

Product Number	Date	Description		Uof M	Weight	Yield		
Line	Qty	Component	Prod#	Rev#	Description	Bin	Unit	
<b>KBB00027</b>	<b>8/1/2012</b>	<b>0</b>	<b>Bag Kit, Fasteners, Spring Assy,KBB00003</b>				<b>1.38</b>	<b>0</b>
10	5	BTQ08150			Bolt, Hex, 1/2-13unc, 1.5", 8, Plt		each	
20	1	BTQ10351			Bolt, Hex, 5/8-18unf, 3.5", 8. PLT		each	
30	5	NTQ08000			Nut, Hex, 1/2-13unc, 8, Plt		each	
50	2	NTQ10000			Nut, Hex, 5/8-11unc, 8, Plt		each	
60	1	NTQ10001			Nut, Hex, 5/8-18unf, 8, Plt		each	
70	2	WFQ08000			Washer, Flat, 1/2", 8, Plt		each	
80	2	WFQ10000			Washer, Flat, 5/8", 8, Plt		each	
110	1	WLQ08000			Washer, Lock, 1/2", 8, Plt		each	
120	2	WLQ10000			Washer, Lock, 5/8", 8, Plt		each	

# Bill of Materials Listing

TransArctic Canada Inc.

9/7/2021  
Page 1 of 1

Product Number	Date	Description	Uof M	Weight	Yield		
Line	Qty	Component Prod#	Rev#	Description	Bin	Unit	
<b>KBB00028</b>	<b>8/1/2012</b>	<b>0</b>		<b>Bag Kit, Fasteners, Pivot Assy, KBB00003</b>		<b>115.26</b>	<b>0</b>
10	1	BTM08100	0	Bolt, 1/2-13 x 1.0" w/ Grease Nipple FTG		each	
20	1	BTP08653		Bolt, Hex, 1/2-13unc, 6.5", 5, Plt, FT		each	
30	1	BTQ08100		Bolt, Hex, 1/2-13unc, 1.00", 8, Plt		each	
40	3	BTQ08101		Bolt, Hex, 1/2-20unf, 1.00", 8, Plt		each	
50	3	CSF08076		Capscrew, FH, 1/2-20unf x .75",Alloy,Plt		each	
60	4	NTP07000		Nut, Hex, 7/16-14unc, 5, Plt		each	
70	4	WFN07000		Washer, Flat, 7/16", 2, Plt		each	
80	3	WFQ08000		Washer, Flat, 1/2", 8, Plt		each	
90	2	WFS08001		Washer, Flat, 1/2", 8, USS, Plt		each	
100	4	WLP07000		Washer, Lock, 7/16", 5, Plt		each	
110	6	WLQ08000		Washer, Lock, 1/2", 8, Plt		each	

# Bill of Materials Listing

TransArctic Canada Inc.

9/7/2021  
Page 1 of 1

Product Number	Date			Description	Uof M	Weight	Yield	
Line	Qty	Component	Prod#	Rev#	Description	Bin	Unit	
<b>KCB95501</b>	<b>8/12/2021</b>			<b>0</b>	<b>Kit, Compressor, Tilt, 12v, TM-55/65,'21</b>		<b>0.48</b>	<b>0</b>
10	4	BTC12035			Bolt, Hex, 12 x 1.75 x 35mm, 10.9,Plt,FT		each	
20	4	WFA12000			Washer, Flat, 12mm, 8.8, Plt		each	
30	4	WLA12000			Washer, Lock, 12mm, 8.8, Plt		each	

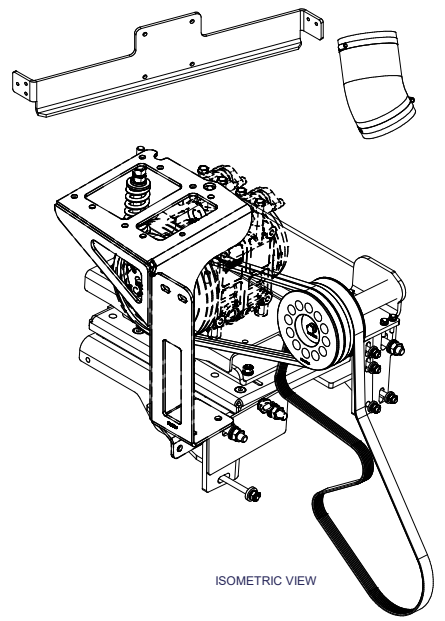
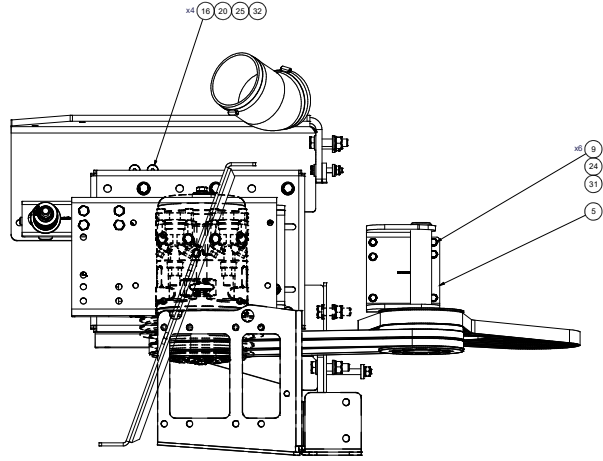

ISOMETRIC VIEW

NOTE: USE QTY (5) RV104083 TO FASTEN BMN80047 TO ENGINE BAY ENCLOSURE.

NOTE: REMOVE EXISTING OEM CAC TUBE AND CUT TO SUIT FOR ELBOW (NO48452) ON BOTH ENDS. ELBOW MUST BE INSTALLED NO LESS 2" ONTO TUBE(S). REFER TO "MOUNT PAPER WORK" FOR DIMENSIONS.

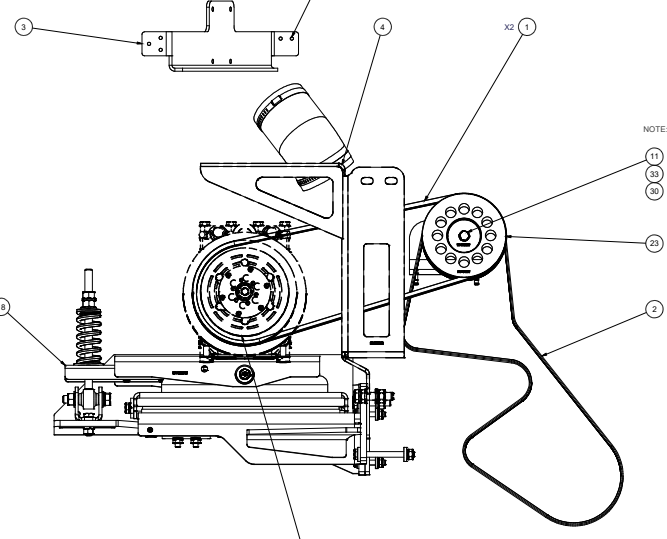

NOTE: RE-USE OEM FASTENERS

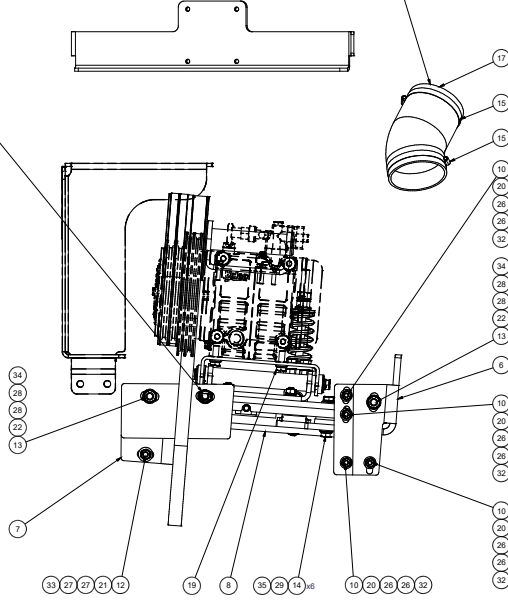

NOTES:  
 1) USE SERVICABLE THREADLOCKER ON ALL FASTENERS TO ENGINE COMPONENTS AND TORQUE ALL BOLTS TO S.A.E. SPECIFICATIONS.  
 2) SEE "TRANSARCTIC A/C COMPRESSOR MOUNT INSTALLATION DISCLAIMER".

ITEM	QTY	U/M	PART NUMBER	DESCRIPTION
35	6	EACH	WLQ08000	WASHER, LOCK, 1/2", 8, PLT
34	2	EACH	WL110000	WASHER, LOCK, 16mm, 8.8, PLT
33	2	EACH	WL120000	WASHER, LOCK, 12mm, 8.8, PLT
32	8	EACH	WL110000	WASHER, LOCK, 10mm, 8.8, PLT
31	6	EACH	WL030000	WASHER, LOCK, 8mm, 8.8, PLT
30	1	EACH	WF512001	WASHER, FLAT, STEP, 12mm, 12mm, 69.85, PLT
29	6	EACH	WF090000	WASHER, FLAT, 1/2", 8, PLT
28	4	EACH	WFA15000	WASHER, FLAT, 16mm, 8.8, PLT
27	2	EACH	WFA12000	WASHER, FLAT, 12mm, HWY, 8.8, PLT
26	8	EACH	WFA10002	WASHER, FLAT, 10mm, HWY, 8.8, PLT
25	4	EACH	WFA10000	WASHER, FLAT, 10mm, 8.8, PLT
24	6	EACH	WFA08000	WASHER, FLAT, 8mm, 8.8, PLT
23	1	EACH	PUA8101	PULLEY, ASSY, IDLER, PB/28 gp, 7" STL, PLT
22	2	EACH	NTA16000	NUT, HEX, 16 x 2, 8.8, PLT
21	1	EACH	NTA12000	NUT, HEX, 12 x 1.75, 8.8, PLT
20	8	EACH	NTA10000	NUT, HEX, 10 x 1.5, 8.8, PLT
19	1	EACH	KCB95501	KIT, COMPRESSOR, TILT, 12v, TM55/65, '21
18	1	EACH	KSB00003	MT KIT, PLATFORM, TRANSIT, 40M, '21
17	1	EACH	HDA04530	HOSE, FLEX, CAC, ELB, SILICON, 4.5 X 30 DEG, BLU
16	4	EACH	CFP10045	CAPSCREW, FH, 10 x 1.5 x 45mm, 10.9, PLT
15	2	EACH	CU77301	CLAMP, CAR, #22, 3" x 5" (76.2x127mm)
14	6	EACH	BTC008126	BOLT, HEX, 1/2-20UNF x 1.25, 8, PLT
13	2	EACH	BTC16070	BOLT, HEX, 16 x 2 x 70mm, 10.9, PLT
12	1	EACH	BTC12120	BOLT, HEX, 12 x 1.75 x 120mm, 10.9, PLT
11	1	EACH	BTC12030	BOLT, HEX, 12 x 1.75 x 30mm, 10.9, PLT
10	4	EACH	BTC10060	BOLT, HEX, 10 x 1.5 x 60mm, 10.9, PLT
9	6	EACH	BTC08035	BOLT, HEX, 8 x 1.25 x 35mm, 10.9, PLT
8	1	EACH	BMN80123	BKT, MAIN, BRACE, ICRE, '21
7	1	EACH	BMN80119	BKT, MAIN, RR, WELDMT, ICRE, '21
6	1	EACH	BMN80116	BKT, MAIN, FRT, WELDMT, ICRE, '21
5	1	EACH	BMN80109	BKT, JACK SHAKY, CLIMBING, ICRE, '21
4	1	EACH	BMK30052	BRK, RESERVOIR TANK, LABEL, ICRE, '21
3	1	EACH	BMK30047	BRK, BRACE, AIR FILTER BOX
2	1	EACH	BE163096	BELT, 5/8", 2086mm (82.5")
1	2	EACH	BEL121626	BELT, B GR, 1626mm (64")BX63

DRAWN: Jose Rodriguez 8/30/2021  
 CHECKED: Val Jakobow 8/30/2021  
 REVISED TO PRODUCTION: 8/30/2021  
 DATE: BY: James Stewart 8/30/2021  
 APPROVED: Ron Ingram 8/30/2021  
 DATE: Dale Mason 8/30/2021

**TRANSARCTIC INC.**  
 MT KIT, ISL, ICRE, TM-55/65, '21  
 DWS NO: KMC096531  
 SCALE: 1:1  
 SHEET 1 OF 1

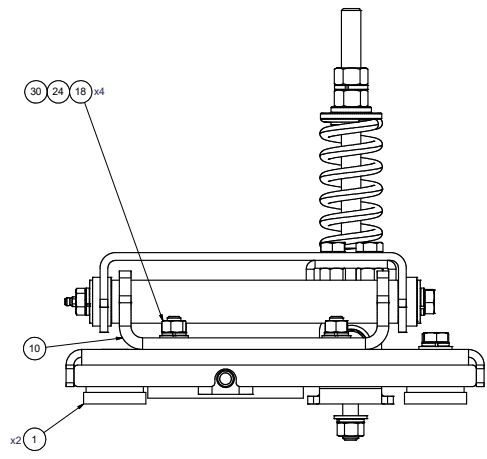
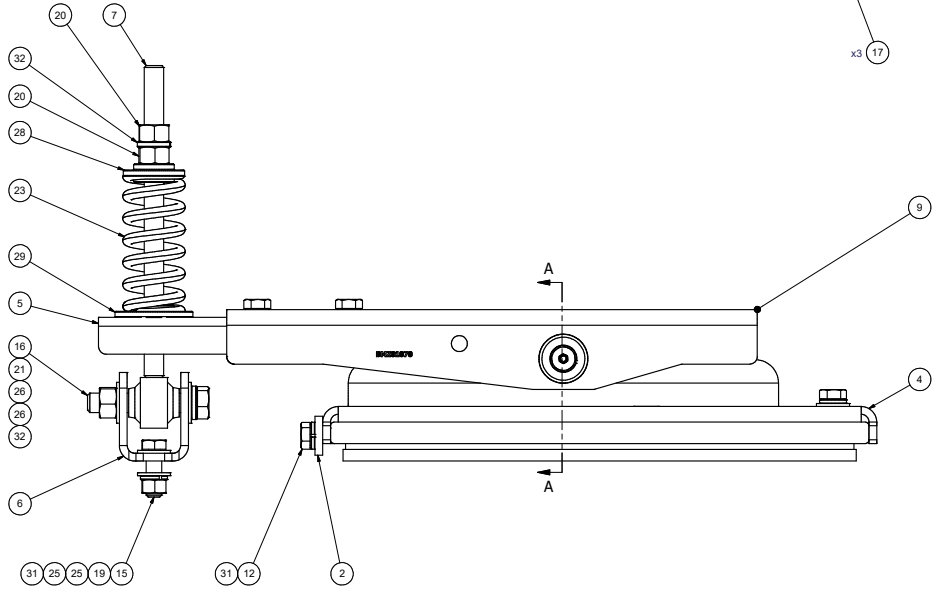
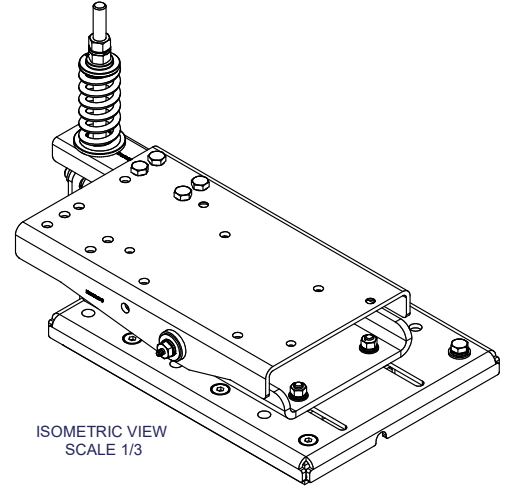
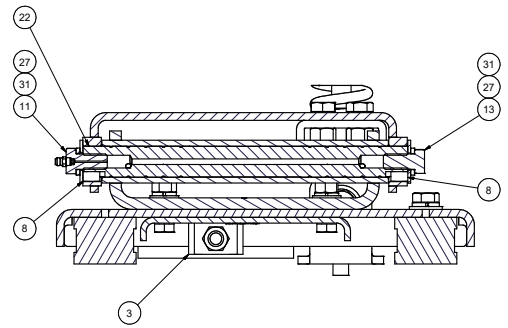
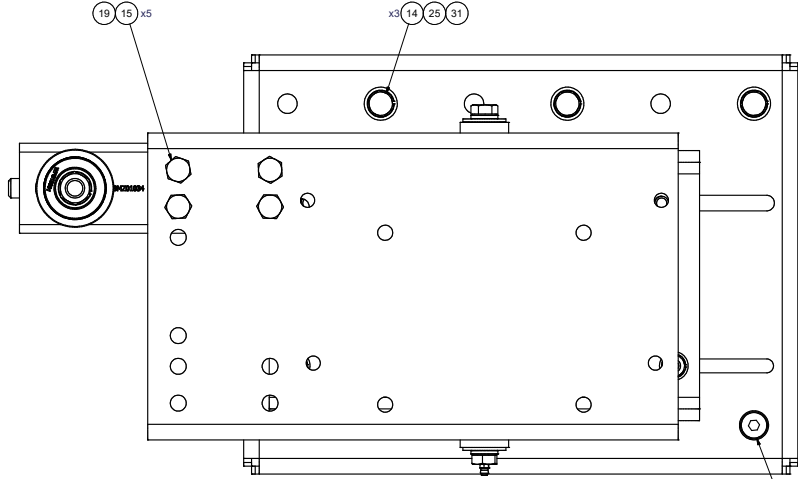

ITEM	QTY	U/M	PART NUMBER	DESCRIPTION
32	2	EACH	WLQ10000	WASHER, LOCK, 5/8", 8, PLT
31	7	EACH	WLQ08000	WASHER, LOCK, 1/2", 8, PLT
30	4	EACH	WLP07000	WASHER, LOCK, 7/16", 5, PLT
29	1	EACH	WFS27001	WASHER, FLAT, DBL STEP, 28mm, 63.5, PLT
28	1	EACH	WFS16001	WASHER, FLAT, DBL STEP, 16mm, 50mm, PLT
27	2	EACH	WFS08001	WASHER, FLAT, 1/2", 8, USS, PLT
26	2	EACH	WFQ10000	WASHER, FLAT, 5/8", 8, PLT
25	5	EACH	WFQ08000	WASHER, FLAT, 1/2", 8, PLT
24	4	EACH	WFN07000	WASHER, FLAT, 7/16", 2, PLT
23	1	EACH	SPR00002	SPRING, COMP, R/H, 110 x 50 x 8.4, RED
22	1	EACH	PIS01010	SHAFT, STL, GREASE, ADM TRANSIT, '12
21	1	EACH	NTQ10001	NUT, HEX, 5/8-18UNF, 8, PLT
20	2	EACH	NTQ10000	NUT, HEX, 5/8-11UNC, 8, PLT
19	5	EACH	NTQ08000	NUT, HEX, 1/2-13UNC, 8, PLT
18	4	EACH	NTPO7000	NUT, HEX, 7/16-14UNC, 5, PLT
17	3	EACH	CSF08076	CAPSCREW, FH, 1/2-20UNF x .75", ALLOY, PLT
16	1	EACH	BTQ010351	BOLT, HEX, 5/8-18UNF x 3.50, 8, PLT
15	5	EACH	BTQ08150	BOLT, HEX, 1/2-13UNC x 1.50, 8, PLT
14	3	EACH	BTQ08101	BOLT, HEX, 1/2-20UNF x 1.00, 8, PLT
13	1	EACH	BTQ08100	BOLT, HEX, 1/2-13UNC x 1.00, 5, PLT, FT
12	1	EACH	BTP08653	BOLT, HEX, 1/2-13UNC x 6.50, 5, PLT, FT
11	1	EACH	BTM08100	BOLT, 1/2-13 x 1.0" w/ GREASE NIPPLE FTG
10	1	EACH	BMZ01072	BKT, ASSY, CRADLE, PIVOT, 05G, TRANSIT, '21
9	1	EACH	BMZ01070	BKT, MAIN, PIVOT, ASSY, 05G, TRANSIT, '21
8	2	EACH	BMZ01041	Shaft Key, 5/16" SQ x .540" Long
7	1	EACH	BMZ01040	BKT, ASSY, THRD ROD, ISOLATOR, ADM, '12
6	1	EACH	BMZ01037	BKT, FORK, KNUCKLE-JOINT, ADM, '12
5	1	EACH	BMZ01034	BKT, SPRING, SUPPORT ARM, ADM, '12
4	1	EACH	BMZ00043	BKT, MAIN, BASE PL, '13
3	1	EACH	BMN80104	BKT, MAIN, SLIDE, ASSY, ICRE
2	1	EACH	BMN80025	BKT, BACK, PL, SLIDE, IC, RE300
1	2	EACH	BMN80008	VIBRATION ISOLATOR, BAR, 16.50 x 2 x 1.50

**NOTES:**  
 1) USE SERVICABLE THREADLOCKER ON ALL FASTENERS TO ENGINE COMPONENTS AND TORQUE ALL BOLTS TO S.A.E. SPECIFICATIONS.  
 2) SEE "TRANSARCTIC A/C COMPRESSOR MOUNT INSTALLATION DISCLAIMER".

REV	ECN	DESCRIPTION	DATE	BY	APPROVED
0		RELEASED TO PRODUCTION	3/25/2021	JRR	
1			3/25/2021	James Stewart	
2			3/25/2021	Dale Mason	

DRAWN: vjakowlew  
 CHECKED: Jose Rodriguez  
 DATE: 3/25/2021  
 BY: James Stewart  
 APPROVED: Dale Mason  
 DATE: 3/25/2021

**TRANSARCTIC INC.**  
 TITLE: MT KIT, PLATFORM, TRANSIT, ADM, '21  
 SIZE: D  
 DWG NO: KBB00003  
 SCALE: 1:2  
 SHEET 1 OF 1



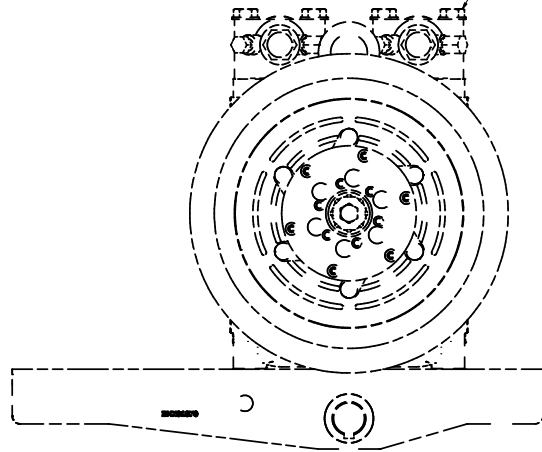
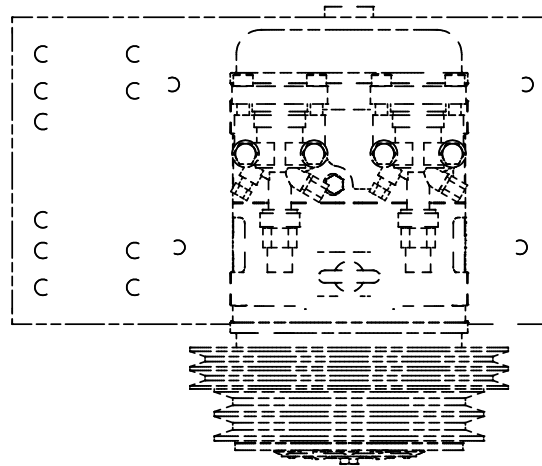

NOTE:  
SHOWING TRANSARTIC  
COMPRESSOR  
CMV38844 (635cc)  
AS REFERENCE.

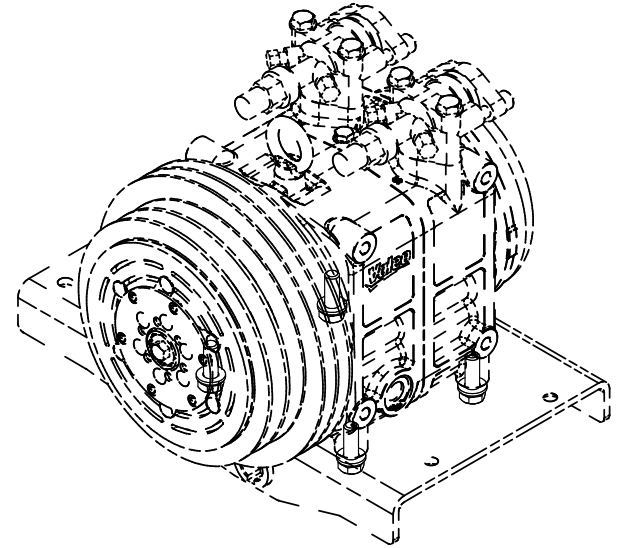
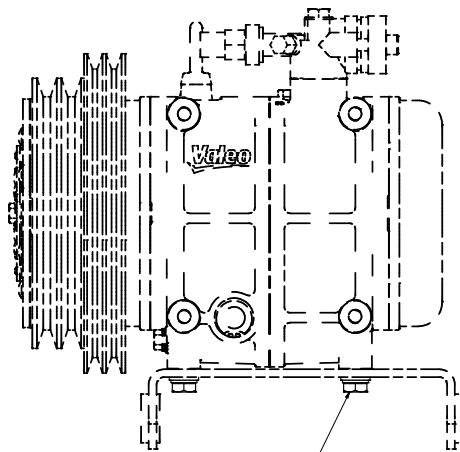

ISOMETRIC VIEW

NOTES:

- 1) USE SERVICABLE THREADLOCKER ON ALL FASTENERS TO ENGINE COMPONENTS AND TORQUE ALL BOLTS TO S.A.E. SPECIFICATIONS.
- 2) SEE "TRANSARTIC A/C COMPRESSOR MOUNT INSTALLATION DISCLAIMER".

ITEM	QTY	U/M	PART NUMBER	DESCRIPTION
3	4	EACH	WLA12000	WASHER, LOCK, 12mm, 8.8, PLT
2	4	EACH	WFA12000	WASHER, FLAT, 12mm, 8.8, PLT
1	4	EACH	BTC12035	BOLT, HEX, 12 x 1.75 x 35mm, 10.9, PLT

BILL OF MATERIALS				
DRAWN	8/27/2021			
Checked	8/27/2021			
By	8/27/2021			
Approved	8/27/2021			
DRAWING UNIT OF MEASURE		MM (INCH)	SCALE	1:2
DRAWING UNIT OF MEASURE		MM (INCH)	SCALE	1:2
TITLE			KIT, COMPRESSOR, TILT, 12v, TM55/65, '21	
DWG NO			KCB95501	
REV			0	

REV	ECN	DESCRIPTION	DATE	BY
0		RELEASED TO PRODUCTION	8/27/2021	JRR
1			8/27/2021	James Stewart
2			8/27/2021	James Stewart
3			8/27/2021	Dale Mason

UNSPECIFIED TOLERANCES: ALL DIMS TO FINISH UNLESS OTHERWISE SPECIFIED  
 ONE DECIMAL PLACE (X1) .10 FRACTIONAL, .0125 ANGULAR  
 TWO DECIMAL PLACE (X2) .02 FRACTIONAL, .0150 ANGULAR  
 THREE DECIMAL PLACE (X3) .005 FRACTIONAL, .0100 ANGULAR  
 FRACTIONAL, .0100 ANGULAR



3 2 1 x4

8 7 6 5 4 3 2 1

8 7 6 5 4 3 2 1

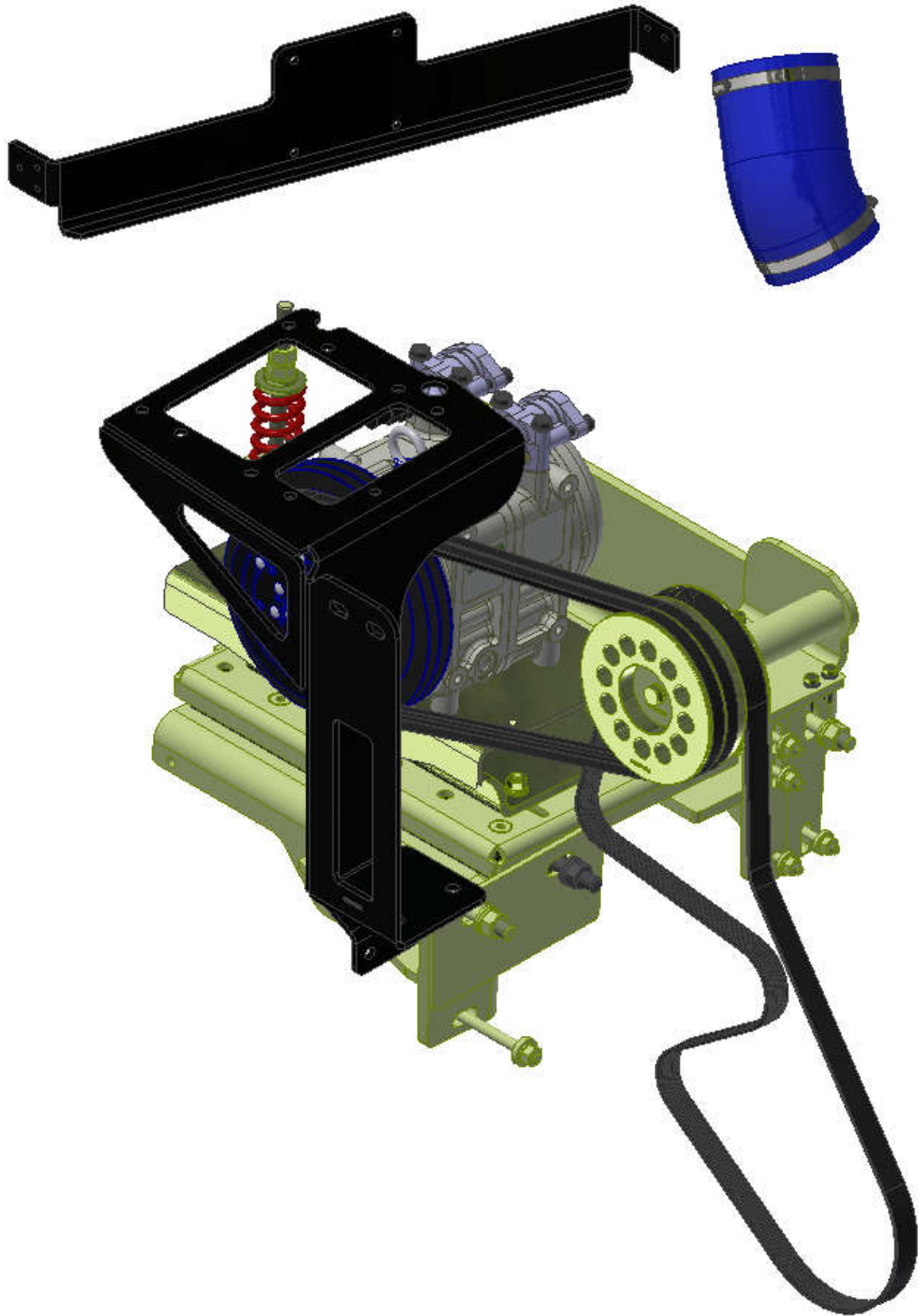

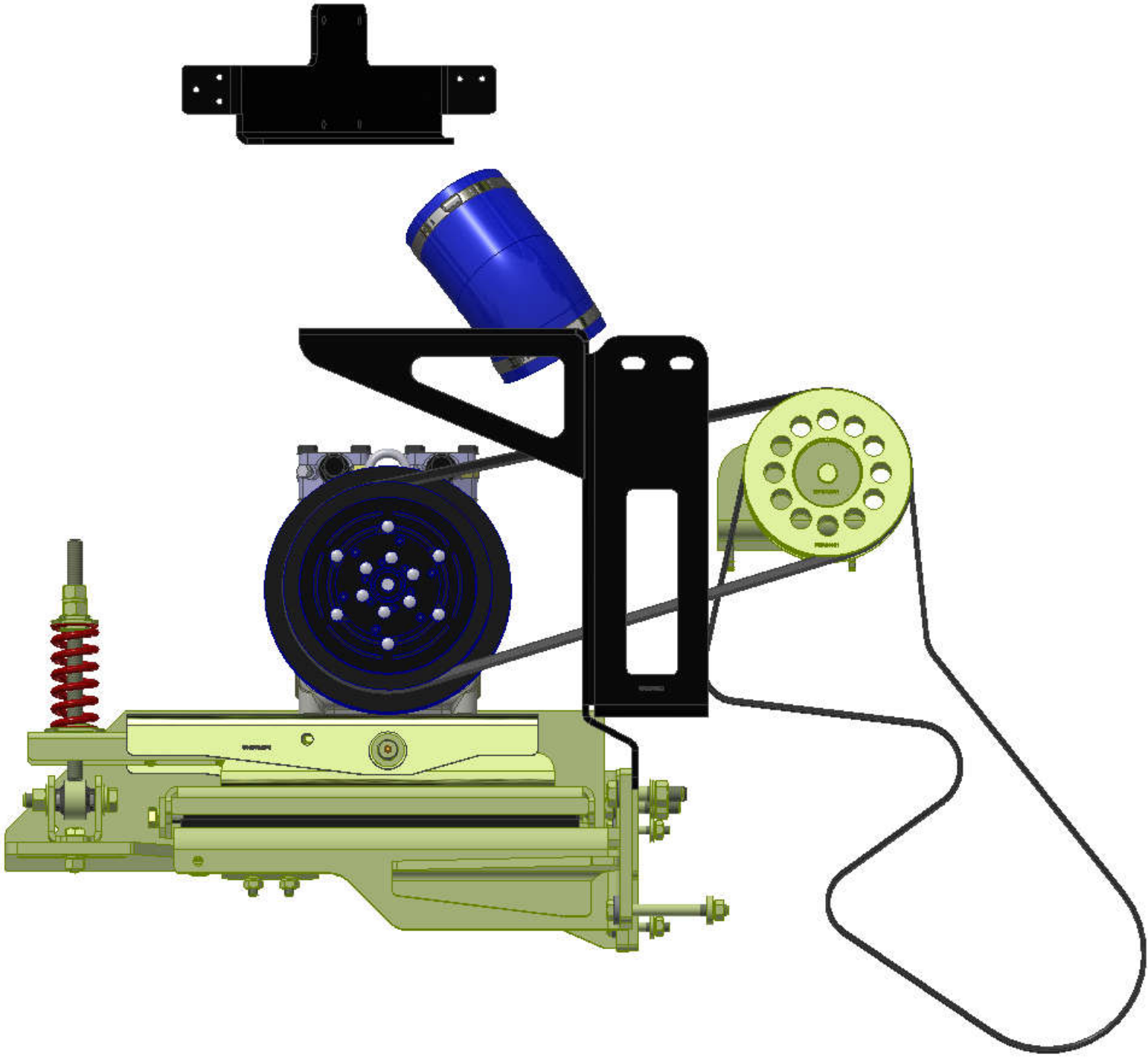

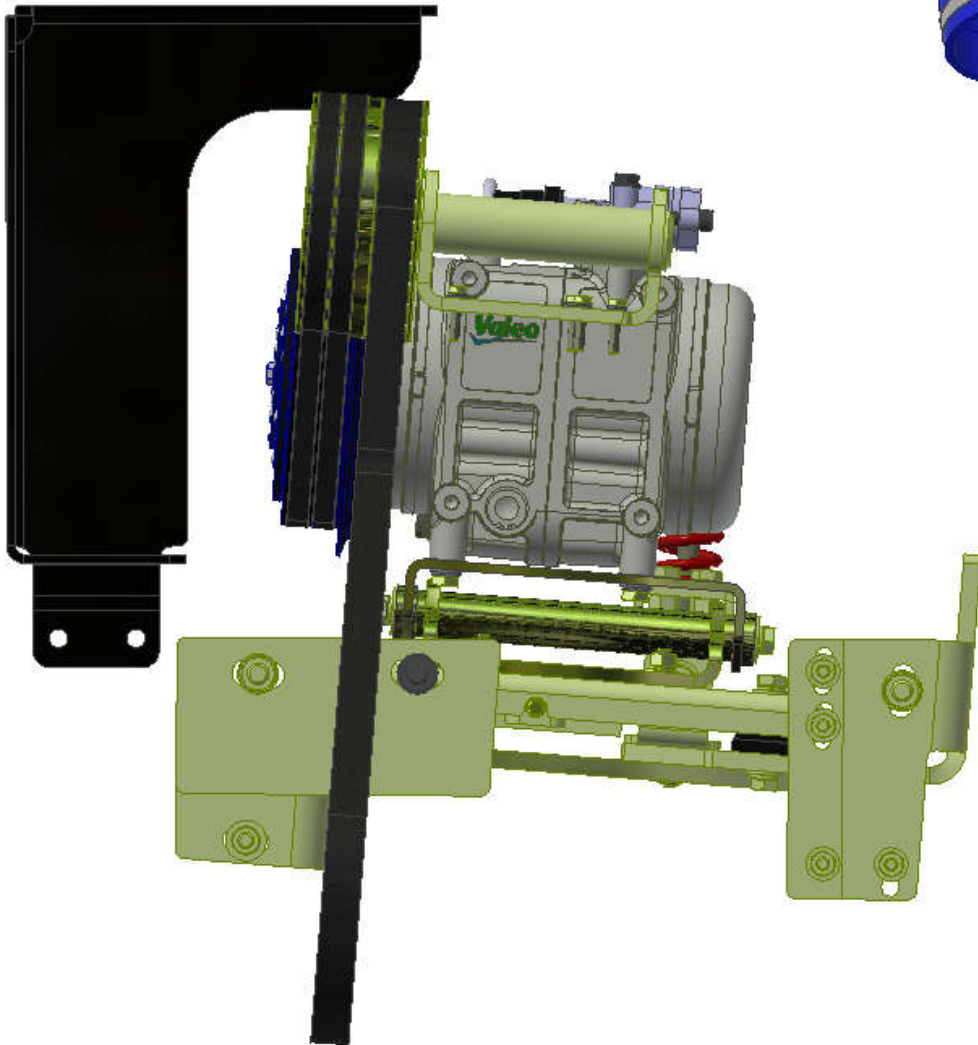

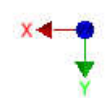
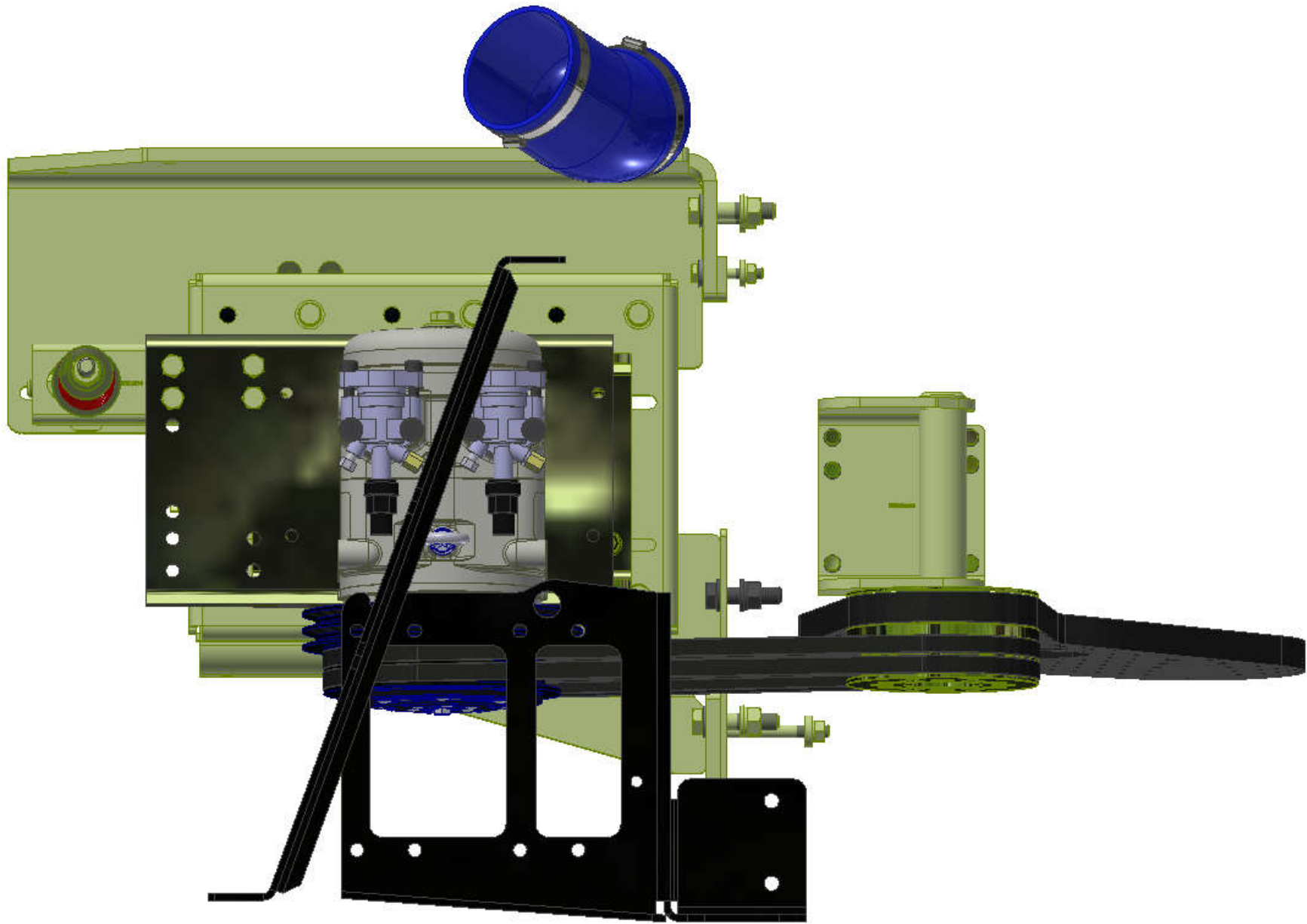

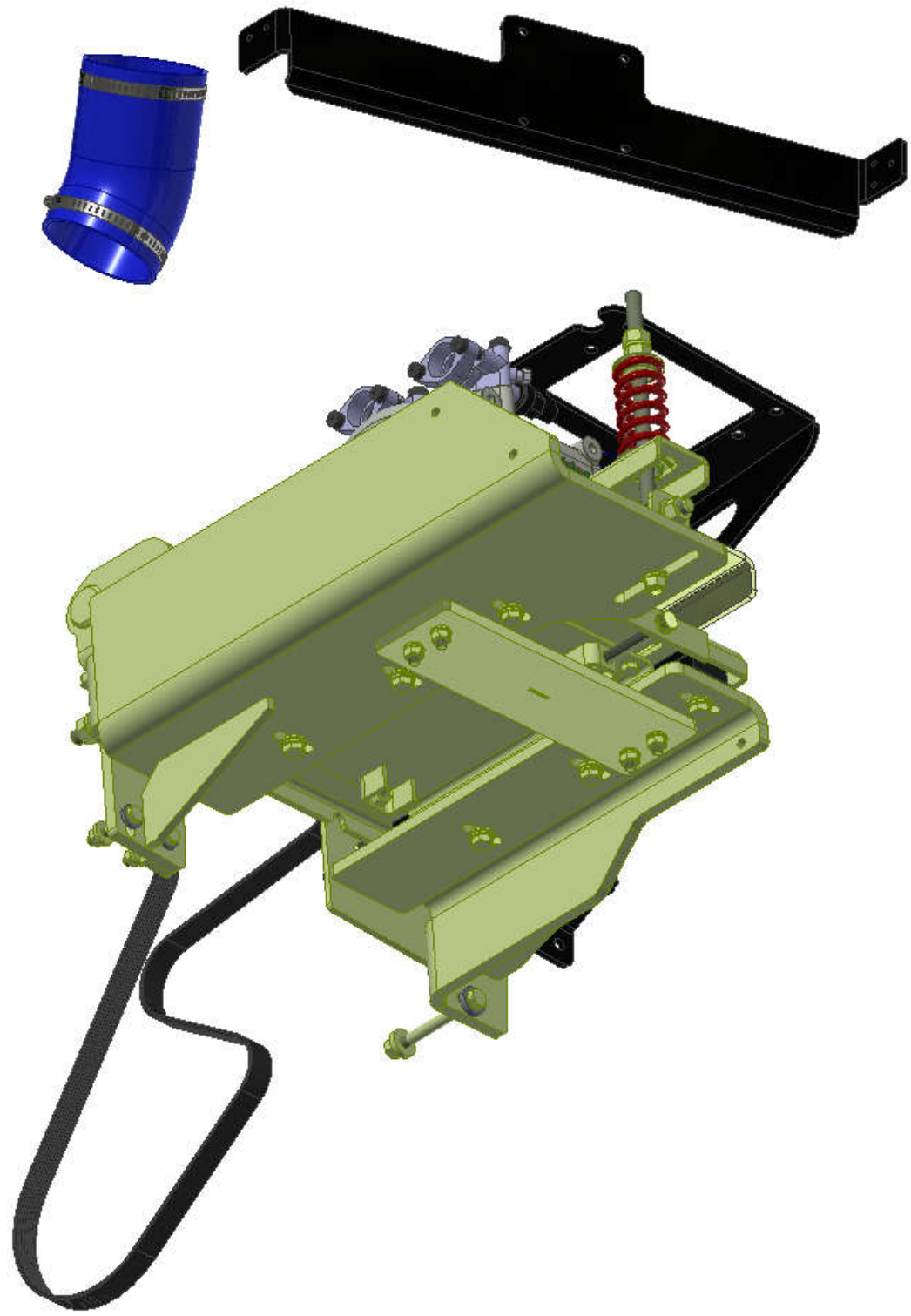

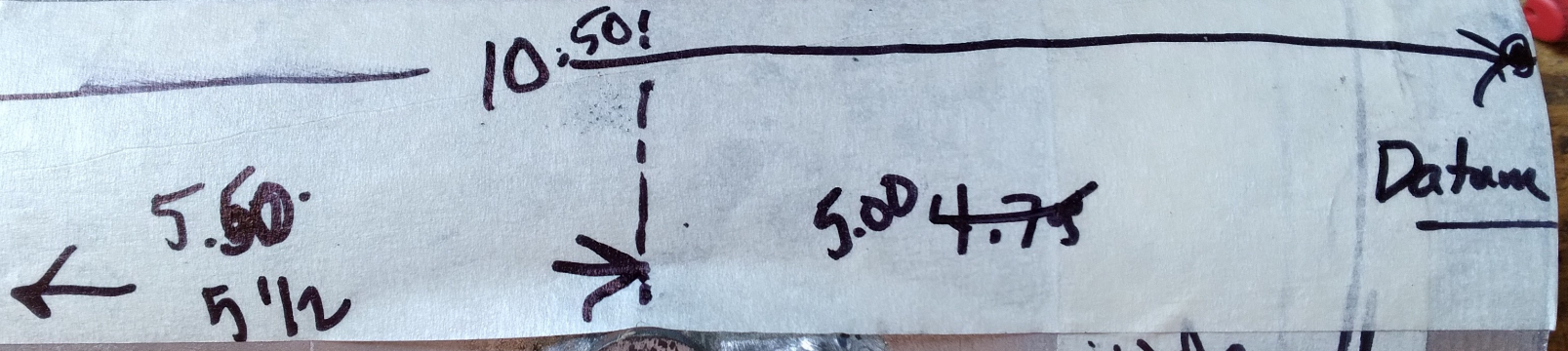

10.50

5.50  
5 1/2

5.00  
4.75

Datum

240

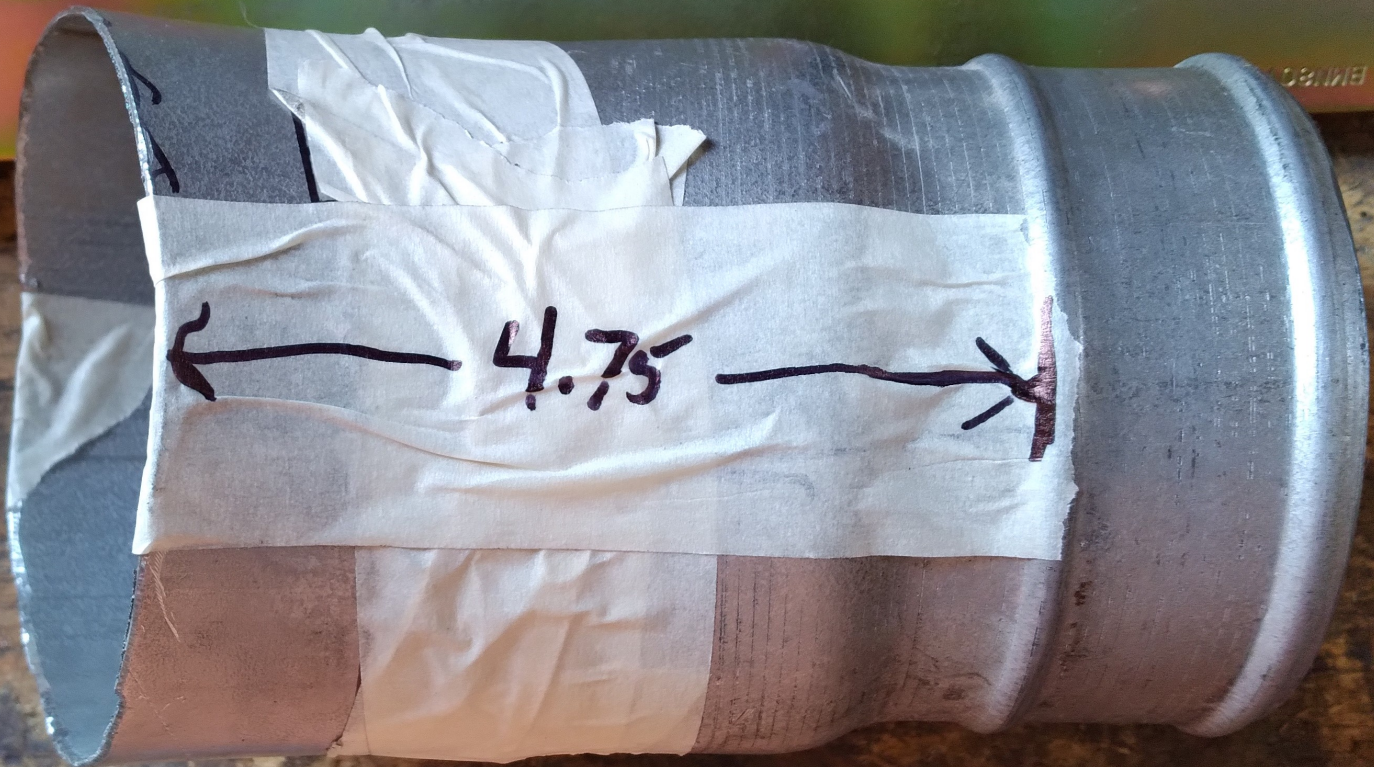

← 4.75 →



## **TransArctic A/C Compressor Mount Installation Disclaimer**

All compressor mounts should be installed by qualified and trained personnel using proper tools and equipment in safe working conditions following industry standard guidelines for motor vehicle service and repair.

The installer of any compressor mount purchased from TransArctic must undertake all responsibility of issues arising from that compressor bracket being installed on any vehicle. As well as insure that a **proper and sufficient ground** is established between the compressors' clutches and the vehicle's engine. Mount functionality, operation and durability can all be compromised by an incompetent installation.

Due to the many different situations, parameters and application criteria, which are beyond the compressor mount manufacturer's control, TransArctic does not warrant design, durability, or operational functionality of any compressor mount improperly installed by another party.

**With no implied guarantees it is the mount installer's strict responsibility to determine safety and functionality, of the compressor mount, at the time of installation.**

Please contact TransArctic with any issue arising from installation so we may better improve the product. If you have any reservations about the compressor mount integrity contact TransArctic immediately at 1-877-COLD-AIR.

**Mark OEM tensioner location**

**Install Kit**

**Check for Interferences**

**Check to ensure that the proper OEM tensioner orientation is maintained**

**Run engine with A/C system engaged for at least 10 minutes to run in belt**

**Check OEM tensioner orientation and adjust as required**

### **Responsabilidad limitada de TransArctic en la instalación del soporte del compresor**

Todos los soportes de los compresores deben ser instalados por personas calificadas y entrenadas, usando para ello los equipos y herramientas necesarios para esta labor en buenas condiciones y según las normas y guías para el servicio y/o reparación de motores de vehículos.

El instalador de los soportes comprados en TransArctic asume toda la responsabilidad de cualquier problema que surga en el soporte del compresor al vehículo; de igual manera es responsable que el cable a tierra sea conectado entre el embrague del compresor y el motor del vehículo.

Se advierte que el buen funcionamiento y la durabilidad del soporte pueden ser comprometidos por defectos en su instalación.

Debido a las diversas situaciones que se puedan presentar fuera del control del fabricante, TransArctic no garantiza el diseño, la durabilidad o el correcto funcionamiento de cualquier equipo inapropiadamente instalado por terceros.

**Esta sobreentendido que el Instalador del montaje del compresor es estrictamente responsable de la seguridad y funcionamiento del equipo en el momento de la instalación.**

Si tuviera algún problema o duda acerca de la instalación del soporte del compresor pongase en contacto inmediatamente con TransArctic al teléfono 1-877-COLD-AIR de modo que podamos mejorar nuestro producto.

**Note la ubicación del medidor de tensión OEM**

**Instale el equipo**

**Controlar si hay interferencias.**

**Asegure que el medidor de tensión mantenga la orientación justa.**

**Encienda el motor por lo menos 10 minutos con el sistema A/C enganchado para que la correa corra**

**Controle la orientación justa del medidor de tensión y ajuste a las condiciones requeridas del fabricante**