

Bill of Materials Listing

TransArctic Canada Inc.

1/6/2017
Page 1 of 1

Product Number	Description	Date	Weight	Uof M	Yield
Line Component Prod#	Description	Bin Unit	Qty		
KMC44195	Mt Kit, ISL-G, 2017, HDX, O5G, 24V,'17		6/1/2016	159.14	0
10 BEL32389	Belt, Banded B gr, 2388mm (94")		each	1	
20 BMC83125	Bkt, Weldm't, Adapter PI, ISL, HDX, '13		each	1	
30 BMC90012	Bkt, Weldm't, Main Base, HDX, '16'		each	1	
40 BMC90022	Bkt, Main, Idler, Weldm't, ISL, HDX, '16		each	1	
50 BMC90026	Bkt, Alignm't Bar, Add-On, ISL, HDX, '17		each	1	
60 KCB94195	Kit, Compressor, 24V,O5G, '16		each	1	
70 KPC90009	Kit, Pulley, ISL-G, 8.9L, 2B/X,'17		each	1	
80 PUA05001	Pulley, Assy, Idler, B/S, 5", Stl, Plt		each	1	
90 PUA05012	Pulley, Assy, Idler,B/BX gr,5", STL,Plt		each	1	
100 SCD21912	Spacer, Col, Drl,21.9mm x 25.4o x 12.3i		each	2	
110 SLV17012	Sleeve, Pulley, 16.9o x 22.23mm x 12.32i		each	2	
120 KBC44195	Bag Kit, Fasteners,KMC44195		each	1	

Bill of Materials Listing

TransArctic Canada Inc.

6/23/2017
Page 1 of 1

Product Number		Description	Bin	Date	Weight	Uof M	Yield
Line	Component Prod#	Description		Unit	Qty		
KBC44195		Bag Kit, Fasteners, KMC44195 & Others.		6/1/2016	2.41		0
10	BTC10045	Bolt, Hex, 10 x 1.5 x 45mm, 10.9, Plt, FT		each	3		
20	BTC12080	Bolt, Hex, 12 x 1.75 x 80mm, 10.9, Plt, FT		each	2		
30	BTQ06175	Bolt, Hex, 3/8-16unc, 1.75", 8, Plt		each	5		
40	BTQ08125	Bolt, Hex, 1/2-13unc, 1.25", 8, Plt		each	2		
50	BTQ08151	Bolt, Hex, 1/2-20unf, 1.5", 8, Plt		each	2		
60	CSF08031	Capscrew, FH, 8 x 1.25 x 30mm, 10.9, Plt		each	2		
70	CSF08101	Capscrew, FH, 1/2-20unf x 1.0", Alloy, Plt		each	4		
80	NTA10000	Nut, Hex, 10 x 1.5, 8.8, Plt		each	3		
90	NTA12000	Nut, Hex, 12 x 1.75, 8.8, Plt		each	2		
100	NTQ06000	Nut, Hex, 3/8-16unc, 8, Plt		each	5		
110	WFA10002	Washer, Flat, 10mm, Hvy, 8.8, Plt		each	6		
120	WFA12002	Washer, Flat, 12mm, Hvy, 8.8, Plt		each	2		
130	WFQ08000	Washer, Flat, 1/2", 8, Plt		each	4		
150	WFS06002	Washer, Flat, 3/8", L9, Plt		each	10		
160	WLA10000	Washer, Lock, 10mm, 8.8, Plt		each	3		
170	WLA12000	Washer, Lock, 12mm, 8.8, Plt		each	2		
180	WLQ06000	Washer, Lock, 3/8", 8, Plt		each	5		
190	WLQ08000	Washer, Lock, 1/2", 8, Plt		each	4		

Bill of Materials Listing

TransArctic Canada Inc.

12/16/2016

Page 1 of 1

Product Number		Description	Bin	Date	Weight	Uof M	Yield
Line	Component Prod#	Description		Unit	Qty		
KCB94195		Kit, Compressor, 24V,O5G, '16		5/31/2016	60.37		0
10	BEL11138	Belt, A gr, 1138mm (44.8") (17448)		each	2		
20	BMC83114	Bkt, PI, ALT Spacer, T3RE, '13		each	1		
30	BMN80008	Vibration Isolator, Bar,16.50 x 2 x 1.50		each	2		
40	BMN80025	Bkt, Back, PL, Slide, IC, RE300		each	1		
50	BMT10011	Bkt, Tenr, Block, Offset, 3mm		each	2		
60	BMZ00043	Bkt, Main, Base PI, '13		each	1		
70	KBT94195	Kit, Platform, O5G W/ Alt, '16		each	1		
80	PUL03321	Pulley, ALT, Idler, 3.25"d, 2A		each	1		
90	KBZ94195	Bag Kit, Fasteners, KCB92495 & KCB94195		each	1		

Bill of Materials Listing

TransArctic Canada Inc.

12/16/2016

Page 1 of 1

Product Number		Description	Bin	Date	Weight	Uof M	Yield
Line	Component Prod#	Description		Unit	Qty		
KBZ94195		Bag Kit, Fasteners, KCB92495 & KCB94195		6/13/2016	2.45		0
10	BTP08653	Bolt, Hex, 1/2-13unc, 6.5", 5, Plt, FT		each	1		
20	BTQ08101	Bolt, Hex, 1/2-20unf, 1.00", 8, Plt		each	4		
30	BTQ08150	Bolt, Hex, 1/2-13unc, 1.5", 8, Plt		each	3		
40	BTQ08200	Bolt, Hex, 1/2-13unc, 2.0", 8, Plt		each	1		
50	BTQ08653	Bolt, Hex, 1/2-13unc, 6.5", 8, Plt		each	1		
60	CSF08076	Capscrew, FH, 1/2-20unf x .75",Alloy,Plt		each	2		
70	NTQ08000	Nut, Hex, 1/2-13unc, 8, Plt		each	7		
80	TRD08120	Threaded, Rod, 1/2-13unc x 12", 5, Plt		each	1		
90	WFQ08000	Washer, Flat, 1/2", 8, Plt		each	10		
100	WLQ08000	Washer, Lock, 1/2", 8, Plt		each	12		

Bill of Materials Listing

TransArctic Canada Inc.

12/16/2016

Page 1 of 1

Product Number		Description	Bin	Date	Weight	Uof M	Yield
Line	Component Prod#	Description		Unit	Qty		
KBT94195		Kit, Platform, O5G W/ Alt, '16		5/31/2016	16.33		0
10	BMC90015	Bkt, Weldm't, Alt Extension, HDX, 16'		each	1		
20	BMN80010	Bkt, Main, Slide, Assy, O5G, IC, RE300		each	1		
30	BTQ06150	Bolt, Hex, 3/8-16unc, 1.50", 8, Plt		each	2		
40	NTP07000	Nut, Hex, 7/16-14unc, 5, Plt		each	4		
50	SCD29213	Spacer, Col, Drl,29.21mm x 25.4o x 12.7i		each	1		
60	WFN06000	Washer, Flat, 3/8", 2, Plt		each	2		
70	WFN07000	Washer, Flat, 7/16", 2, Plt		each	4		
80	WLQ06000	Washer, Lock, 3/8", 8, Plt		each	2		
90	WLQ07000	Washer, Lock, 7/16", 8, Plt		each	4		

Bill of Materials Listing

TransArctic Canada Inc.

12/16/2016

Page 1 of 1

Product Number		Description	Bin	Date	Weight	Uof M	Yield
Line	Component	Prod#	Description	Unit	Qty		
KPC90009			Kit, Pulley, ISL-G, 8.9L, 2B/X,'17		10/15/2013	16.32	0
10	PUL90009		Pulley, Crank, ISL-G, 9.0L, 2B/X, 8", '17	each	1		
20	BTC12080		Bolt, Hex, 12 x 1.75 x 80mm, 10.9,Plt,FT	each	4		
30	WFS12002		Washer, Flat, Hdn, 12mm, Stl, BLK	each	4		

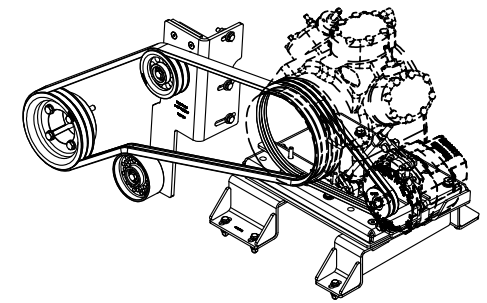
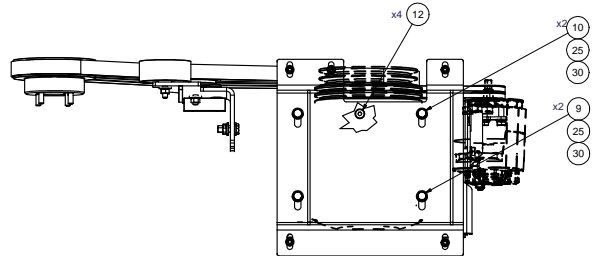
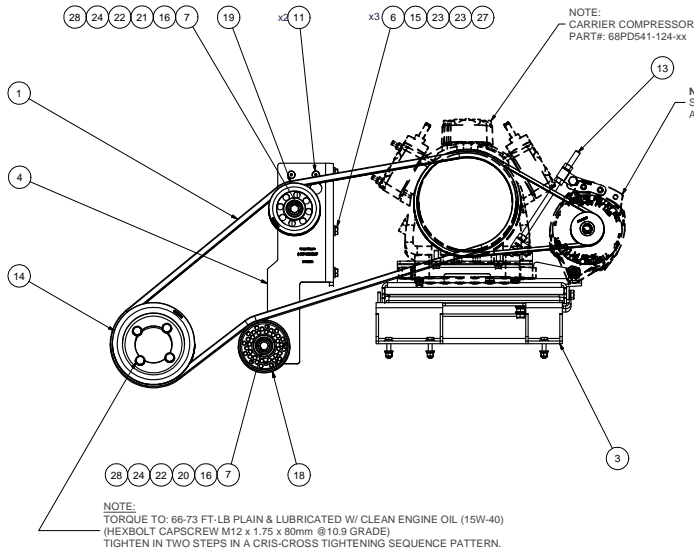
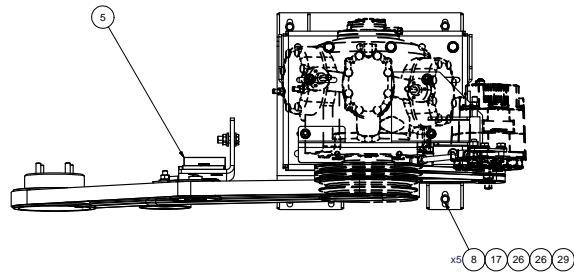

ISOMETRIC VIEW

- NOTES:
- 1) USE SERVICABLE THREADLOCKER ON ALL FASTENERS TO ENGINE COMPONENTS AND TORQUE ALL BOLTS TO S.A.E. SPECIFICATIONS.
 - 2) SEE "TRANSARCTIC A/C COMPRESSOR MOUNT INSTALLATION DISCLAIMER".

ITEM	QTY	U/M	PART NUMBER	DESCRIPTION
30	4	EACH	WLO08000	WASHER, LOCK, 1/2", 8, PLT
29	5	EACH	WLO06000	WASHER, LOCK, 3/8", 8, PLT
28	2	EACH	WLA12000	WASHER, LOCK, 12mm, 8.8, PLT
27	3	EACH	WLA10000	WASHER, LOCK, 10mm, 8.8, PLT
26	10	EACH	WFS06002	WASHER, FLAT, 3/8", L9, PLT
25	4	EACH	WFO08000	WASHER, FLAT, 1/2", 8, PLT
24	2	EACH	WFA12002	WASHER, FLAT, 12mm, HVY, 8.8, PLT
23	6	EACH	WFA10002	WASHER, FLAT, 10mm, HVY, 8.8, PLT
22	2	EACH	SLV17012	SLEEVE, PULLEY, 16.90 x 22.23 mm x12.19l
21	1	EACH	SCD21912	SPACER, COL, DRL, 21.9mm x 31.80 x12.3l
20	1	EACH	SCD16012	SPACER, COL, DRL, 16 mm x 31.80 x 12.0l
19	1	EACH	PLUA05012	PULLEY, ASSY, IDLER, B/BX gr, 5" STL, PLT
18	1	EACH	PLUA05001	PULLEY, ASSY, IDLER, B/S, 5", STL, PLT
17	5	EACH	NTQ06000	NUT, HEX, 3/8-16UNC, 8, PLT
16	2	EACH	NTA12000	NUT, HEX, 12 x 1.75, 8.8, PLT
15	3	EACH	NTA10000	NUT, HEX, 10 x 1.5, 8.8, PLT
14	1	EACH	KPC90009	KIT, PULLEY, ISL-G, 8.9L, 2B/X, '17
13	1	EACH	KCB94195	KIT, COMPRESSOR, 24V, O5G, '16
12	4	EACH	CSF08101	CAPSCREW, FH, 1/2-20UNF x 1", ALLOY, PLT
11	2	EACH	CSF0031	CAPSCREW, FH, 8 x 1.25 x 30mm, 10.9, PLT
10	2	EACH	BTQ08151	BOLT, HEX, 1/2-20UNF x 1.50, 8, PLT
9	2	EACH	BTQ08125	BOLT, HEX, 1/2-13UNC x 1.25, 8, PLT
8	5	EACH	BTQ06175	BOLT, HEX, 3/8-16UNC, 1.75", 8, PLT
7	2	EACH	BTC12080	BOLT, HEX, 12 x 1.75 x 80mm, 10.9, PLT
6	3	EACH	BTC10045	BOLT, HEX, 10 x 1.5 x 45mm, 10.9, PLT
5	1	EACH	BMC90026	BKT, ALIGNMT BAR, ADD-ON, ISL-G, HDX, '17
4	1	EACH	BMC90022	BKT, MAIN, IDLER, WELDMT, ISL, HDX, '16
3	1	EACH	BMC90012	BKT, WELDMT, MAIN BASE, HDX, '16
2	1	EACH	BMC03125	BKT, WELDMT, ADAPTER PL, ISL, HDX, '13
1	1	EACH	BEL32359	BELT, BANDED B gr, 2388mm (94")

REV	DESCRIPTION	DATE	BY	TITLE
0	GENERAL REVISION	12/14/2016	JRK	GA
1		12/14/2016	James Stewart	
2		12/14/2016	Ron Ingram	
3		12/14/2016	Dale Mason	

THIS DRAWING CONTAINS PROPRIETARY CONFIDENTIAL INFORMATION OWNED BY TRANSARCTIC CANADA INC. THE DOCUMENT AND THE INFORMATION IT IS NOT TO BE USED, DISCLOSED OR REPRODUCED WITHOUT EXPRESS WRITTEN PERMISSION OF THE COMPANY.

UNSPECIFIED TOLERANCES:	MM (4th)	THIRD ANGLE PROJECTION
ONE DECIMAL PLACE (X0)	0.1	
TWO DECIMAL PLACE (X00)	0.05	
THREE DECIMAL PLACE (X000)	0.025	
FRACTIONAL (1/16")	0.0625	

BROWN	12/14/2016	TRANSARCTIC INC.
JRodriguez	CHECKED	
Vaj Jakovlew	12/14/2016	TITLE
DRAWN		MT KIT, ISL-G 2017, HDX, O5G, 24V, '16
DATE	12/14/2016	SIZE
APPROVED	12/14/2016	DWG NO
		KMC44195
		REV
		0
		SHEET 1 OF 1

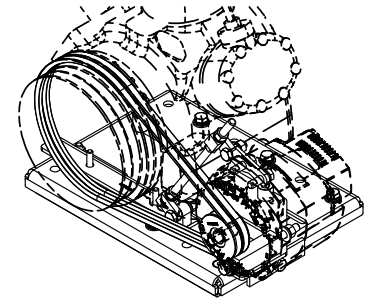
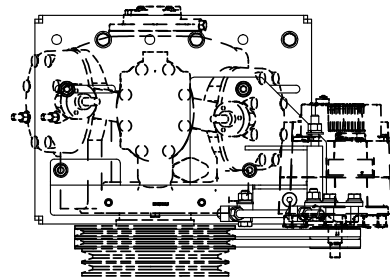
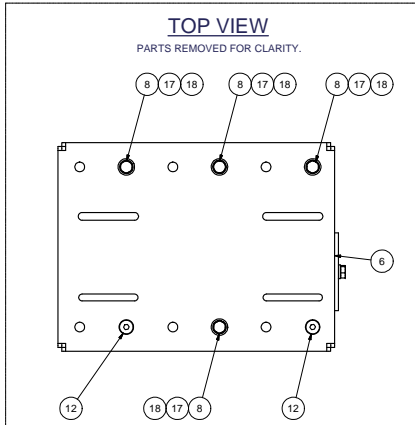

ISOMETRIC VIEW

NOTE:
CARRIER COMPRESSOR
PART#: 68PD541-124-xx

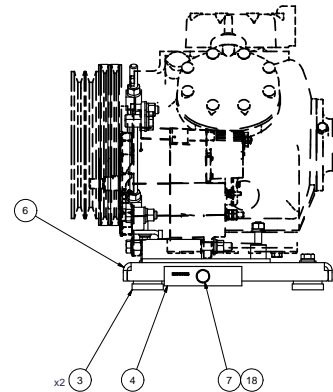
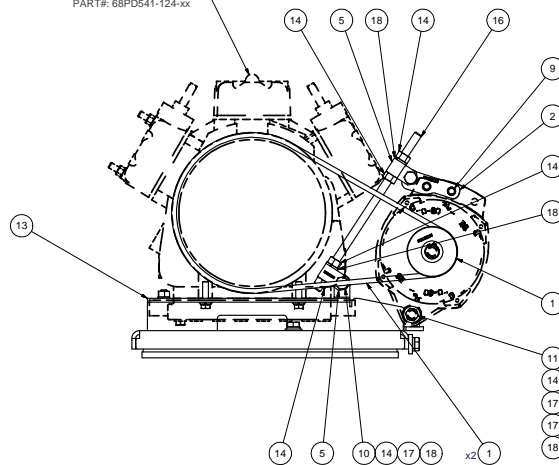

NOTES:

- 1) USE SERVICABLE THREADLOCKER ON ALL FASTENERS TO ENGINE COMPONENTS AND TORQUE **ALL** BOLTS TO S.A.E. SPECIFICATIONS.
- 2) SEE "TRANSARCTIC A/C COMPRESSOR MOUNT INSTALLATION DISCLAIMER".
- 3) WEIGHT: 56.87LBS.

ITEM	QTY	U/M	PART NUMBER	DESCRIPTION
18	12	EACH	WLO08000	WASHER, LOCK, 1/2", 8, PLT
17	10	EACH	WFO08000	WASHER, FLAT, 1/2", 8, PLT
16	1	EACH	TRD08120	THREADED, ROD, 1/2-13UNC x 12", 5 PLT
15	1	EACH	PUL03321	PULLEY, ALT, IDLER, 3.25"o, 2A
14	7	EACH	NT008000	NUT, HEX, 1/2-13UNC, 8, PLT
13	1	EACH	K8194195	KIT, PLATFORM, O5G W/ ALT, '16
12	2	EACH	CSF08076	CAPSCREW, FH, 1/2-20UNF x .75", ALLOY, PLT
11	1	EACH	BTQ08653	BOLT, HEX, 1/2-13UNC x 6.50, 8, PLT
10	1	EACH	BTQ08200	BOLT, HEX, 1/2-13UNC x 2.00, 8, PLT
9	3	EACH	BTQ08150	BOLT, HEX, 1/2-13UNC x 1.50, 8, PLT
8	4	EACH	BTQ08101	BOLT, HEX, 1/2-20UNF x 1.00, 8, PLT
7	1	EACH	BTQ08653	BOLT, HEX, 1/2-13UNC x 6.50, 5, PLT, FT
6	1	EACH	BMZ00043	BKT, MAIN, BASE PL, '13
5	2	EACH	BMT10011	BKT, TENR, BLOCK, OFFSET, 3mm
4	1	EACH	BMN80025	BKT, BACK, PL, SLIDE, IC, RE300
3	2	EACH	BMN80008	VIBRATION ISOLATOR, BAR, 16.50 x 2 x 1.50
2	1	EACH	BMCS3114	BKT, PL, ALT, SPACER, T3RE, '13
1	2	EACH	BELT1138	BELT, A GR, 1138mm (44.8") (17448)

BILL OF MATERIALS

BROWN
jrodriquez
5/30/2016

CHECKED
Jose Rodriguez
5/30/2016

BY
James Stewart
5/30/2016

APPROVED
Dale Mason
5/30/2016

TRANSARCTIC INC.
TITLE

KIT, COMPRESSOR, 24V, O5G, '16

SIZE
D
DWG NO
KCB94195

SCALE
1:4
SHEET 1 OF 1

UNSPECIFIED TOLERANCES:	ALL DIMS	THIRD ANGLE PROJECTION
ONE DECIMAL PLACE (X.0)	.05 (FRACTION)	
TWO DECIMAL PLACE (X.00)	.01 (FRACTION)	
THREE DECIMAL PLACE (X.000)	.005 (FRACTION)	
FRACTIONAL (1/16)	.001 (FRACTION)	



DRAWING UNIT OF MEASURE
MM (INCH)

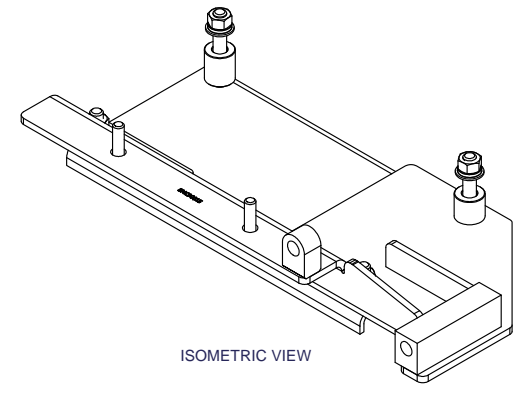
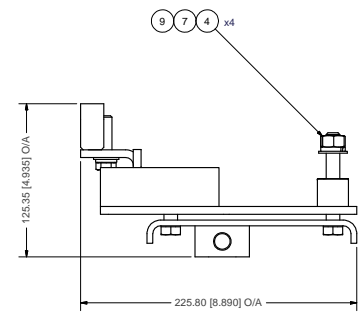
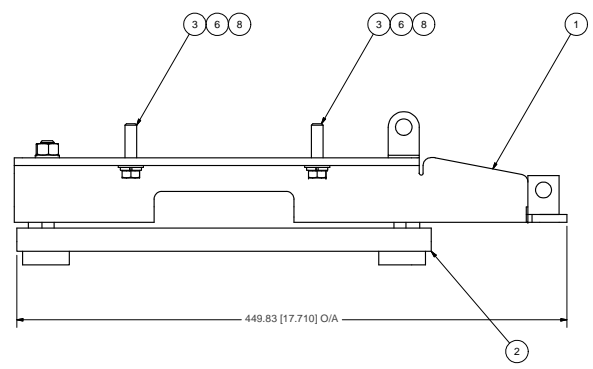
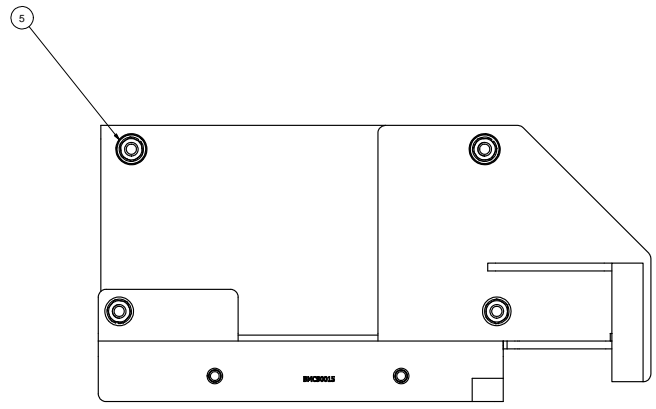

ISOMETRIC VIEW

- NOTES:**
- 1) USE SERVICABLE THREADLOCKER ON ALL FASTENERS TO ENGINE COMPONENTS AND TORQUE **ALL** BOLTS TO S.A.E. SPECIFICATIONS.
 - 2) SEE "TRANSARCTIC A/C COMPRESSOR MOUNT INSTALLATION DISCLAIMER".
 - 3) WEIGHT: 16.25 LBS.

ITEM	QTY	U/M	PART NUMBER	DESCRIPTION
9	4	EACH	WLO07000	WASHER, LOCK, 7/16", 8, PLT
8	2	EACH	WLO06000	WASHER, LOCK, 3/8", 8, PLT
7	4	EACH	WFN07000	WASHER, FLAT, 7/16", 2, PLT
6	2	EACH	WFN06000	WASHER, FLAT, 3/8", 2, PLT
5	1	EACH	SCD29213	SPACER, COL, DRL, 29.21mm x 25.4o x 12.7i
4	4	EACH	NTP07000	NUT, HEX, 7/16-14UNC, 5, PLT
3	2	EACH	BT006150	BOLT, HEX, 3/8-16UNC, 1.50", 8, PLT
2	1	EACH	BMN00010	BKT, MAIN, SLIDE, ASSY, IC, RE300
1	1	EACH	BMC90015	BKT, WELDMT, ALT EXTENSION, HDX, '16

TRANSARCTIC INC.

UNSPECIFIED TOLERANCES:	PLT DIM	FINISH
ONE DECIMAL PLACE (X.0)	30	SPR
TWO DECIMAL PLACE (X.XX)	100	SPR
THREE DECIMAL PLACE (X.XXX)	300	SPR
FRACTIONAL (X/16)	100	SPR
ANGULAR (X-XX)		

DRAWN	J Rodriguez	5/31/2016
CHECKED	Jose Rodriguez	5/31/2016
REVISION	DESCRIPTION	DATE
A	RELEASED TO PROTOTYPE	5/31/2016
	BY: JRR	
	GA	
	James Stewart	5/31/2016
	MFG	
	James Stewart	5/31/2016
	APPROVED	
	Dale Mason	5/31/2016

TITLE	KIT, PLATFORM, O5G W/ ALT, '16	
SIZE	D	DWG NO
SCALE	1:2	KBT94195
		REV 0
		SHEET 1 OF 1

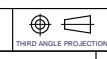

DRAWING UNIT OF MEASURE: MM [INCH]

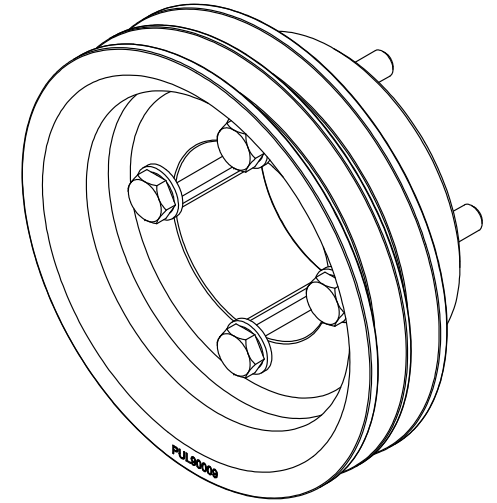
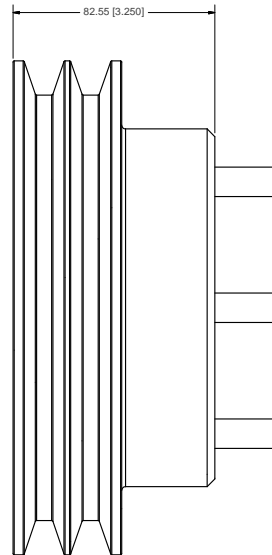
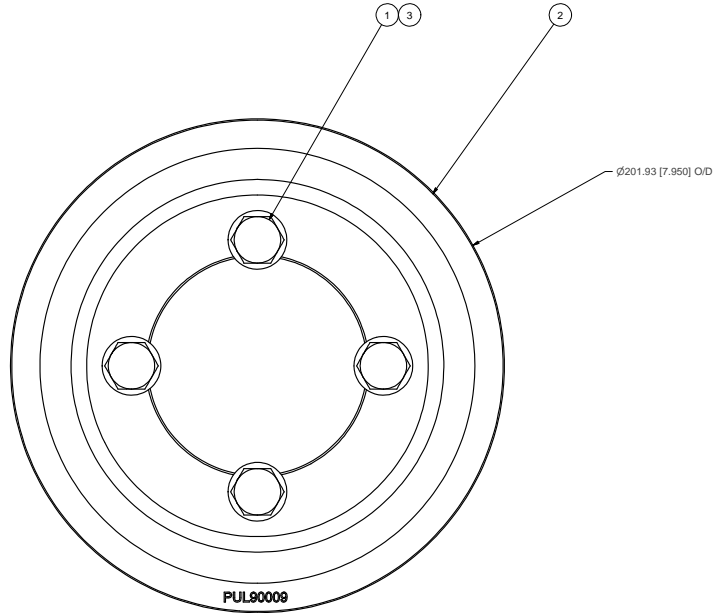

- NOTES:**
- 1) USE SERVICABLE THREADLOCKER ON ALL FASTENERS TO ENGINE COMPONENTS AND TORQUE **ALL** BOLTS TO S.A.E. SPECIFICATIONS.
 - 2) SEE "TRANSARCTIC A/C COMPRESSOR MOUNT INSTALLATION DISCLAIMER".
 - 3) WEIGHT: 16.41 LB

ITEM	QTY	U/M	PART NUMBER	DESCRIPTION
3	4	EACH	WFS12002	WASHER, FLAT, HDN, 12mm, STL, BLK
2	1	EACH	PUL90009	PULLEY, CRANK, ISL-G, 8.9L, 2B/X, 8", '17
1	4	EACH	BTCT2080	BOLT, HEX, 12 x 1.75 x 80mm, 10.9, FLT

TRANSARCTIC INC.

BILL OF MATERIALS			
DRAWN	12/16/2016	TITLE	
Checked	12/16/2016	DATE	
BY: Jose Rodriguez		DATE	
REV	DESCRIPTION	DATE	BY
0	RELEASED TO PRODUCTION	12/16/2016	JRR
1	MFG	12/16/2016	James Stewart
2	APPROVED	12/16/2016	James Stewart
3	APPROVED	12/16/2016	Dale Mason
UNSPECIFIED TOLERANCES:		MM (INCH)	REV
ONE DECIMAL PLACE (X.0)	±0.10 (±.004)	D	0
TWO DECIMAL PLACE (X.00)	±0.02 (±.0008)		
THREE DECIMAL PLACE (X.000)	±0.005 (±.0002)		
FRACTIONAL (1/16")	±.005 (±.0002)		
THIRD ANGLE PROJECTION		DWG NO	SCALE
		KPC90009	1:1
		DRAWING UNIT OF MEASURE	SHEET 1 OF 1
		MM (INCH)	

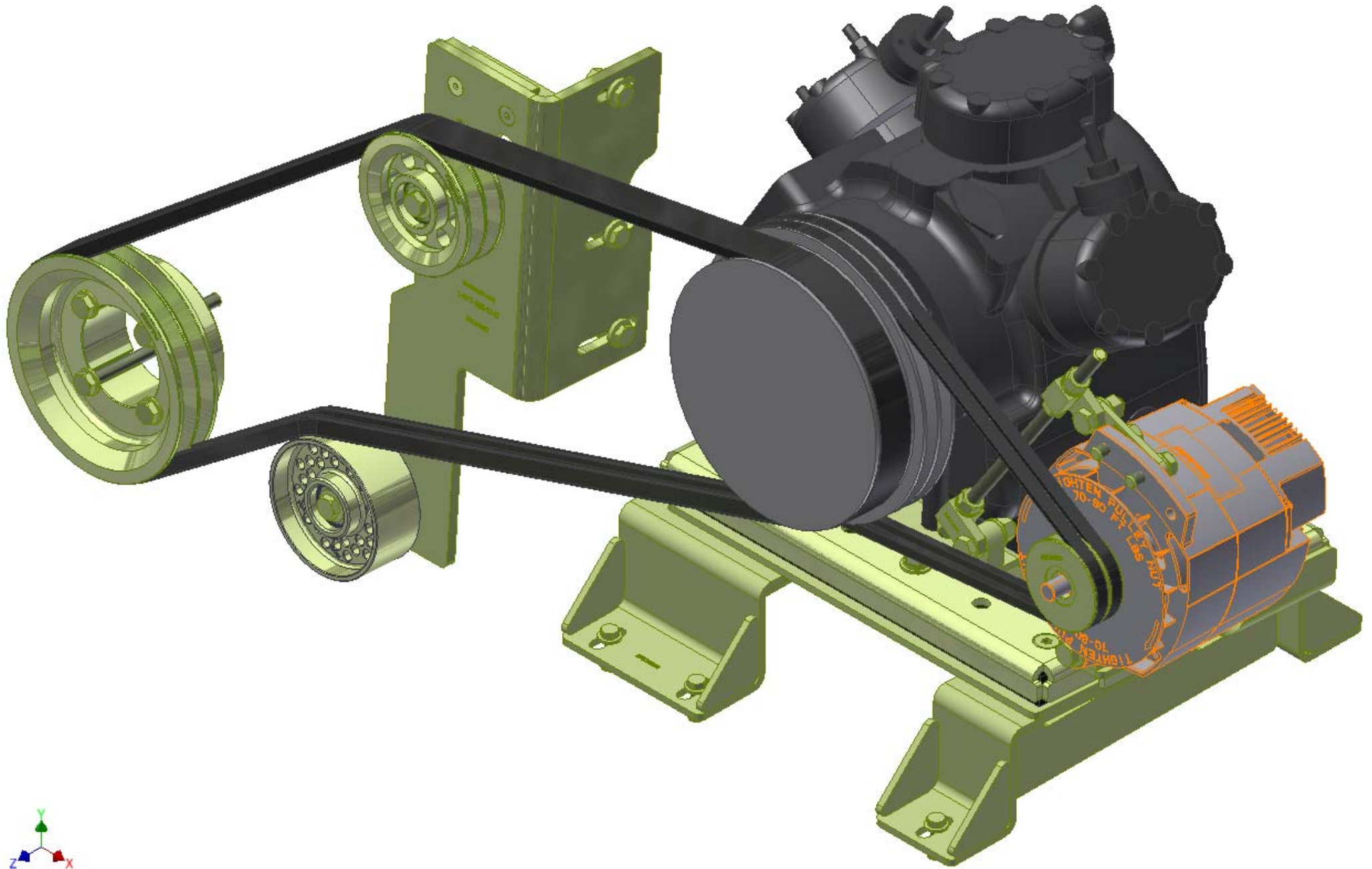

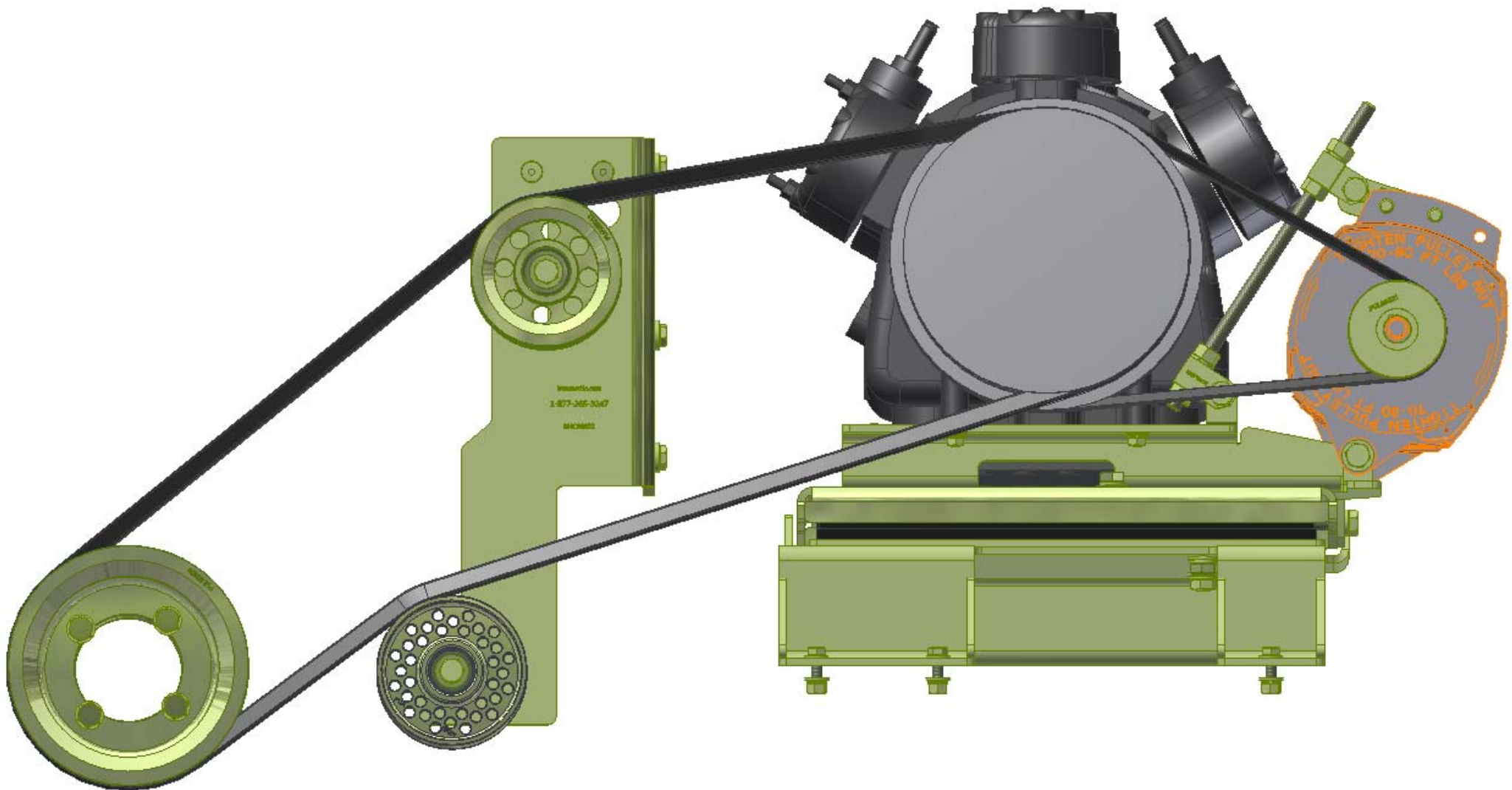

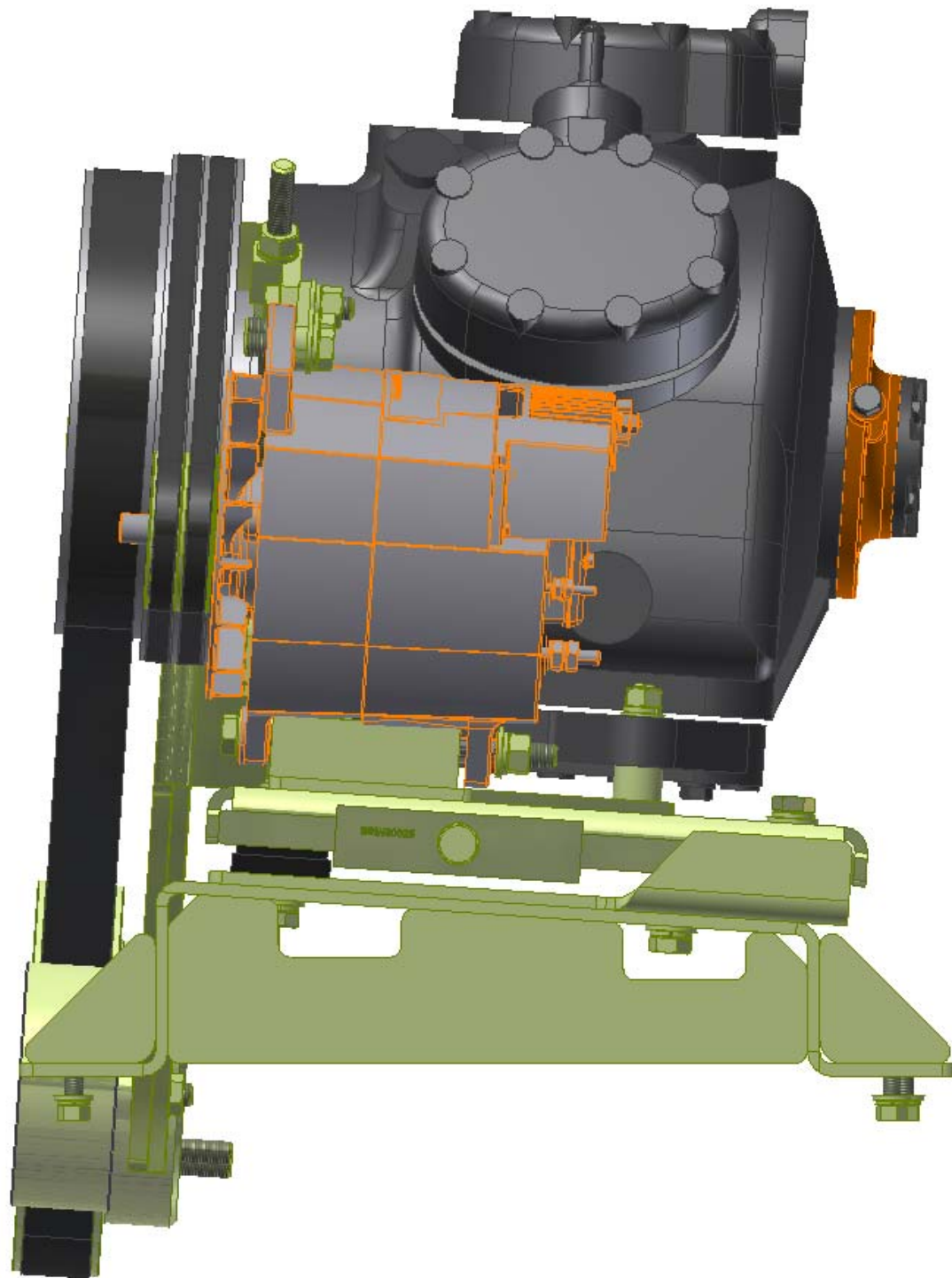

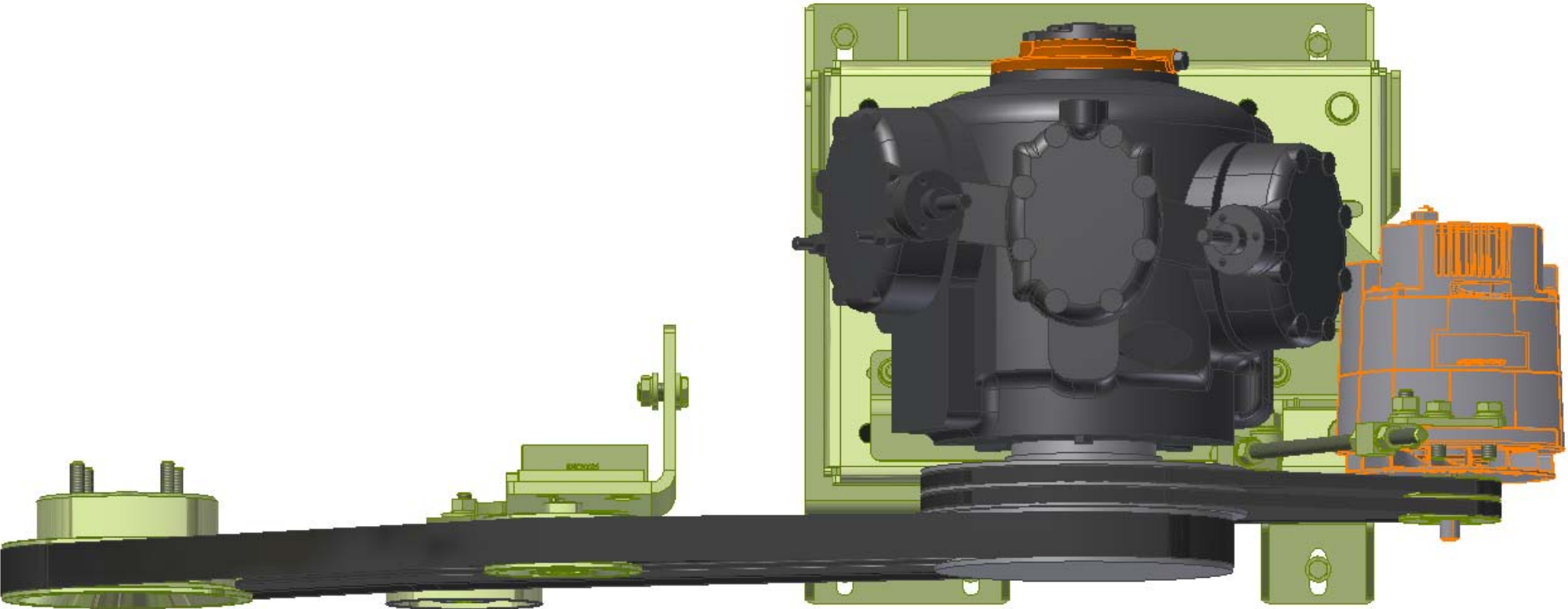

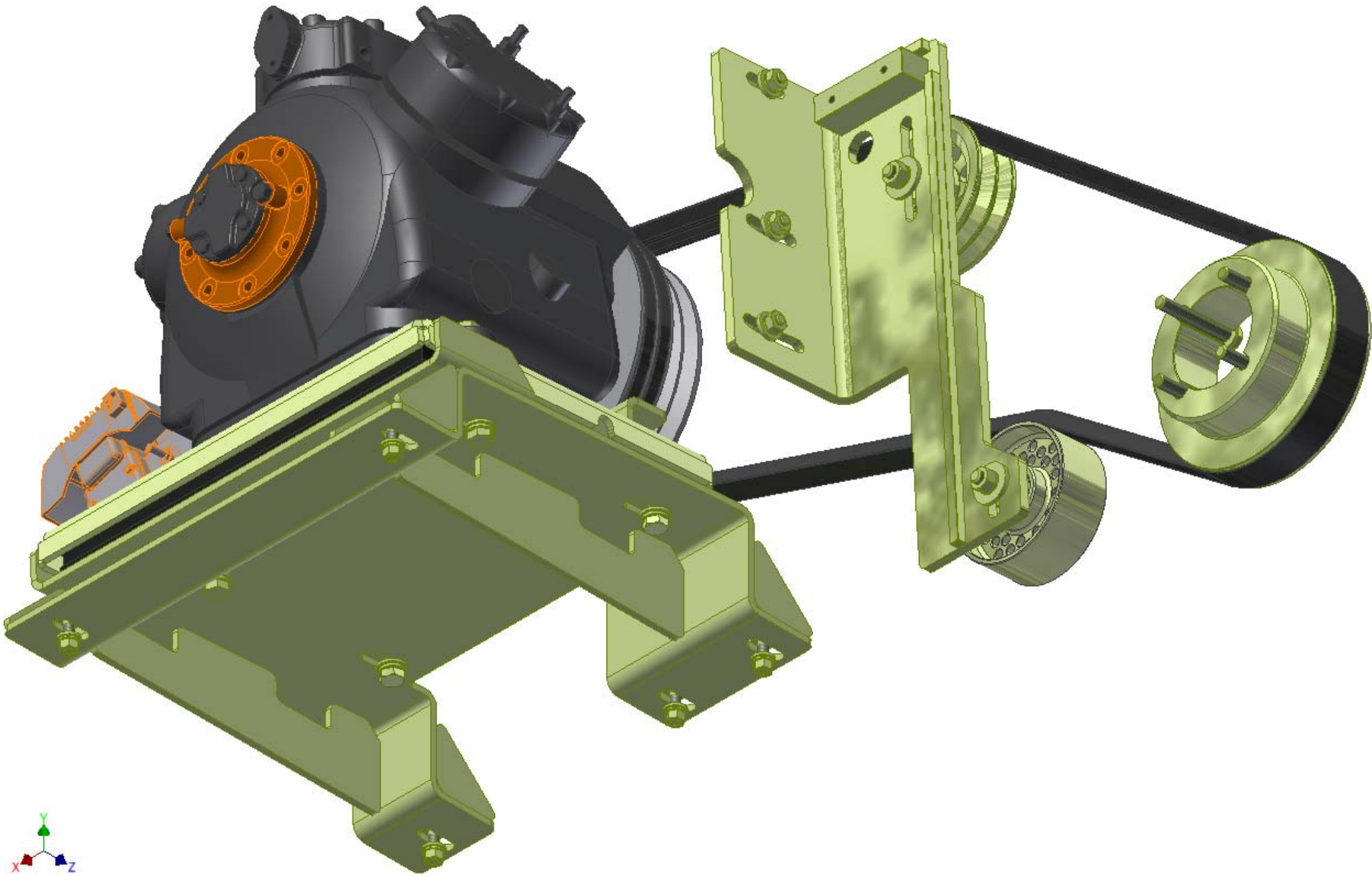

TransArctic A/C Compressor Mount Installation Disclaimer

All compressor mounts should be installed by qualified and trained personnel using proper tools and equipment in safe working conditions following industry standard guidelines for motor vehicle service and repair.

The installer of any compressor mount purchased from TransArctic must undertake all responsibility of issues arising from that compressor bracket being installed on any vehicle. As well as insure that a **proper and sufficient ground** is established between the compressors' clutches and the vehicle's engine. Mount functionality, operation and durability can all be compromised by an incompetent installation.

Due to the many different situations, parameters and application criteria, which are beyond the compressor mount manufacturer's control, TransArctic does not warrant design, durability, or operational functionality of any compressor mount improperly installed by another party.

With no implied guarantees it is the mount installer's strict responsibility to determine safety and functionality, of the compressor mount, at the time of installation.

Please contact TransArctic with any issue arising from installation so we may better improve the product. If you have any reservations about the compressor mount integrity contact TransArctic immediately at 1-877-COLD-AIR.

Mark OEM tensioner location

Install Kit

Check for Interferences

Check to ensure that the proper OEM tensioner orientation is maintained

Run engine with A/C system engaged for at least 10 minutes to run in belt

Check OEM tensioner orientation and adjust as required

Responsabilidad limitada de TransArctic en la instalación del soporte del compresor

Todos los soportes de los compresores deben ser instalados por personas calificadas y entrenadas, usando para ello los equipos y herramientas necesarios para esta labor en buenas condiciones y según las normas y guías para el servicio y/o reparación de motores de vehículos.

El instalador de los soportes comprados en TransArctic asume toda la responsabilidad de cualquier problema que surga en el soporte del compresor al vehículo; de igual manera es responsable que el cable a tierra sea conectado entre el embrague del compresor y el motor del vehículo.

Se advierte que el buen funcionamiento y la durabilidad del soporte pueden ser comprometidos por defectos en su instalación.

Debido a las diversas situaciones que se puedan presentar fuera del control del fabricante, TransArctic no garantiza el diseño, la durabilidad o el correcto funcionamiento de cualquier equipo inapropiadamente instalado por terceros.

Esta sobreentendido que el Instalador del montaje del compresor es estrictamente responsable de la seguridad y funcionamiento del equipo en el momento de la instalación.

Si tuviera algún problema o duda acerca de la instalación del soporte del compresor pongase en contacto inmediatamente con TransArctic al teléfono 1-877-COLD-AIR de modo que podamos mejorar nuestro producto.

Note la ubicación del medidor de tensión OEM

Instale el equipo

Controlar si hay interferencias.

Asegurese que el medidor de tensión mantenga la orientación justa.

Encienda el motor por lo menos 10 minutos con el sistema A/C enganchado para que la correa corra

Controle la orientación justa del medidor de tensión y ajuste a las condiciones requeridas del fabricante