

Bill of Materials Listing

TransArctic Canada Inc.

12/9/2021
Page 1 of 1

Product Number	Date	Description	Uof M	Weight	Yield	
Line	Qty	Component Prod#	Rev#	Bin	Unit	
KMC94069	6/26/2013	0 Mt Kit, ISL-G, T3RE, FK40/4xFC, '22			433.77	0
20	1	BEL32210			each	
30	1	BMC67096	0		each	
40	1	BMC67212	0		each	
50	1	BMC67214	0		each	
70	1	BMC83107	1		each	
73	1	BMC83113	0		each	
75	1	BMC83116	0		each	
80	1	BMC90009	0		each	
90	1	BMC83109	0		each	
140	1	BMZ00046	0		each	
170	1	KCB84064	1		each	
190	1	PUA05012	0		each	
210	1	PUL80074			each	
220	1	PUL89025	0		each	
230	1	SCD11612	0		each	
240	1	SCD16012	1		each	
250	2	SLV17012	0		each	
270	1	KBC94069	0		each	

Bill of Materials Listing

TransArctic Canada Inc.

12/9/2021
Page 1 of 1

Product Number	Date	Description	Uof M	Weight	Yield	
Line	Qty	Component Prod#	Rev#	Bin	Unit	
KBC94069	7/9/2013	0 Bag Kit, Fasteners, KMC94069			3.77	0
10	1	BTC10035			each	
20	5	BTC10040			each	
40	5	BTC12040			each	
45	4	BTC12045			each	
50	2	BTC12050			each	
60	2	BTC12070			each	
70	6	BTQ08126			each	
80	1	BTQ08151			each	
90	9	NTA12000			each	
100	2	NTA10000			each	
170	8	WFA10000			each	
180	16	WFA12000			each	
185	4	WFA12002			each	
190	6	WFQ08000			each	
210	6	WLA10000			each	
220	9	WLA12000			each	
230	6	WLQ08000			each	

Bill of Materials Listing

TransArctic Canada Inc.

12/9/2021
Page 1 of 1

Product Number	Date	Description	Uof M	Weight	Yield	
Line	Qty	Component Prod#	Rev#	Bin	Unit	
KCB84064	9/16/2013	1 Kit, Compressor, 24V, FK40/ 4xFC, '13			506.08	0
10	2	BEL11040			each	
20	1	BMC83114			each	
30	2	BMN80008			each	
40	1	BMN80025			each	
50	2	BMT10011			each	
60	1	BMZ00043			each	
70	1	KBT84064			each	
80	1	PUL03321			each	
85	1	KBA84064			each	
90	1	TRD08120			each	
100	1	KBZ84064			each	

NOTE:

1) Use KBA84064 "Shim bag kit", as required, to align the Alternator correctly.

Bill of Materials Listing

TransArctic Canada Inc.

12/9/2021
Page 1 of 1

Product Number	Date	Description	Uof M	Weight	Yield	
Line	Qty	Component Prod#	Rev#	Bin	Unit	
KBZ84064	10/18/2013	0 Bag Kit, Fasteners, KCB84064			2.50	0
10	1	BTP08653			each	
20	3	BTQ08101			each	
30	4	BTQ08150			each	
40	2	BTQ08126			each	
50	1	BTQ08653			each	
60	1	CSF08076			each	
70	7	NTQ08000			each	
80	11	WFQ08000			each	
90	13	WLQ08000			each	

Bill of Materials Listing

TransArctic Canada Inc.

12/16/2021
Page 1 of 1

Product Number	Date	Description		Uof M	Weight	Yield		
Line	Qty	Component	Prod#	Rev#	Description	Bin	Unit	
KBT84064	2/17/2009	0	Kit, Platform, 4xFCY W/ Alt, '13				18.62	0
10	1	BMN80031		0	Bkt, Main, Slide, Assy, 05K, IC, RE300		each	
20	1	BMC83117		0	Bkt, Weld't, 4xFCY W/ Alt, T3RE, '13		each	
30	4	BTC12050			Bolt, Hex, 12 x 1.75 x 50mm, 10.9,Plt		each	
40	4	NTP07000			Nut, Hex, 7/16-14unc, 5, Plt		each	
50	4	WFA12000			Washer, Flat, 12mm, 8.8, Plt		each	
60	4	WFN07000			Washer, Flat, 7/16", 2, Plt		each	
70	4	WLA12000			Washer, Lock, 12mm, 8.8, Plt		each	
80	4	WLQ07000			Washer, Lock, 7/16", 8, Plt		each	

Bill of Materials Listing

TransArctic Canada Inc.

12/16/2021
Page 1 of 1

Product Number	Date	Description		Uof M	Weight	Yield
Line	Qty	Component Prod#	Rev# Description	Bin	Unit	
KBA84064	10/19/2021		0 Bag Kit, ALT Shim, KC84064, KAC65501/02			0.09
10	1	SCD03613	0 Spacer, Col, Drl, 3.56mm x 25.4o x12.7i	Alley	each	
20	2	WFA14000	Washer, Flat, 14mm, 8.8, Plt		each	
30	2	WFQ08000	Washer, Flat, 1/2", 8, Plt		each	

NOTE:

1) Use (1) SCD03613, (2) WFA14000, (2) WFQ08000, in any arrg'mt/qtys as required to align the Alternator correctly.

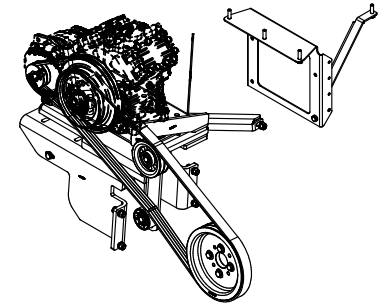
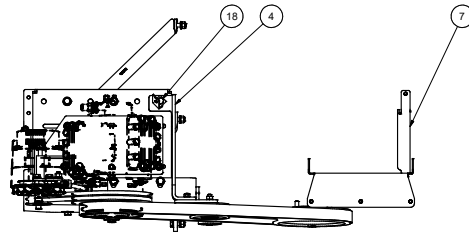

ISOMETRIC VIEW

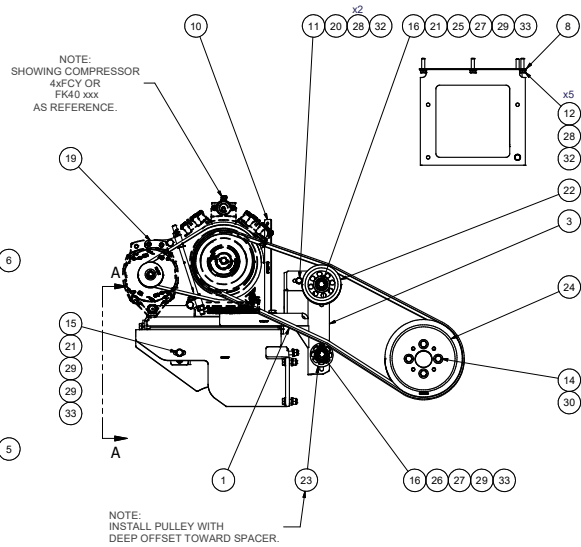

VIEW A-A

NOTE:
INSTALL PULLEY WITH
DEEP OFFSET TOWARD SPACER.

- NOTES:
1) USE SERVICABLE THREADLOCKER ON ALL FASTENERS TO ENGINE COMPONENTS AND TORQUE **ALL** BOLTS TO S.A.E. SPECIFICATIONS.
2) SEE "TRANSARCTIC A/C COMPRESSOR MOUNT INSTALLATION DISCLAIMER".

34	6	EACH	WL008000	WASHER, LOCK, 1/2", 8, PLT
33	9	EACH	WLA12000	WASHER, LOCK, 12mm, 8.8, PLT
32	6	EACH	WLA10000	WASHER, LOCK, 10mm, 8.8, PLT
31	6	EACH	WFO08000	WASHER, FLAT, 1/2", 8, PLT
30	4	EACH	WFA12002	WASHER, FLAT, 12mm, HVY, 8.8, PLT
29	16	EACH	WFA12000	WASHER, FLAT, 12mm, 8.8, PLT
28	8	EACH	WFA10000	WASHER, FLAT, 10mm, 8.8, PLT
27	2	EACH	SLV17012	SLEEVE, PULLER, 16.96 x 22.23 mm x12.19l
26	1	EACH	SCD16012	SPACER, COL, DRL, 16 mm x 31.86 x 12.0l
25	1	EACH	SCD11612	SPACER, COL, DRL, 11.6mm x 25.46 x 12.3l
24	1	EACH	PUL89025	PULLEY, CRANK, ADD-ON, ISL-G, 2B, '21
23	1	EACH	PUL80074	PULLEY, IDLER, BACKSIDE, P8, 74D, 46.27W
22	1	EACH	PUA05012	PULLEY, ASSY, IDLER, B/BX gr, 5" STL, PLT
21	9	EACH	NTA12000	NUT, HEX, 12 x 1.75, 8.8, PLT
20	2	EACH	NTA10000	NUT, HEX, 10 x 1.5, 8.8, PLT
19	1	EACH	KCB84064	KIT, COMPRESSOR, FK40/4xFC, '13
18	1	EACH	BTQ08151	BOLT, HEX, 1/2-20UNF x 1.50, 8, PLT
17	6	EACH	BTQ08126	BOLT, HEX, 1/2-20UNF x 1.25, 8, PLT
16	2	EACH	BTC12070	BOLT, HEX, 12 x 1.75 x 70mm, 10.9, PLT
15	2	EACH	BTC12050	BOLT, HEX, 12 x 1.75 x 50mm, 10.9, PLT
14	4	EACH	BTC12045	BOLT, HEX, 12 x 1.75 x 45mm, 10.9, PLT
13	5	EACH	BTC12040	BOLT, HEX, 12 x 1.75 x 40mm, 10.9, PLT
12	5	EACH	BTC10040	BOLT, HEX, 10 x 1.5 x 40mm, 10.9, PLT
11	1	EACH	BTC10035	BOLT, HEX, 10 x 1.5 x 35mm, 10.9, PLT
10	1	EACH	BMZ00046	BKT, ANGLE, BRACE, HANGER, HOSE, 2013
9	1	EACH	BMC90009	BKT, MAIN, RR SUPPORT, CNG, T3RE, '13
8	1	EACH	BMC83116	BKT, SUPPORT, PDU PANEL, T3RE, '13
7	1	EACH	BMC83113	BKT, BRACE RR/PS, PDU PANEL, T3RE, '13
6	1	EACH	BMC83109	BKT, MAIN, LATERAL BRACE, T3RE, '13
5	1	EACH	BMC83107	BKT, MAIN, FRT SUPPORT, T3RE, '13
4	1	EACH	BMC67214	BKT, BRACE, IDLER, SUPPORT, ISL-G, '22
3	1	EACH	BMC67212	BKT, MAIN, IDLER, WELDMT, ISL-G, '22
2	1	EACH	BMC67096	BKT, DIAG BRACE, DS, FRAME RAIL, T3RE
1	1	EACH	BEL32210	BELT, Banded, B GR, 2210mm (87") (BX84-2)

ITEM	QTY	U/M	PART NUMBER	DESCRIPTION
BILL OF MATERIALS				
DRAWN: vjakowlew 12/16/2021				
CHECKED: Jose Rodriguez 12/16/2021				
OR: James Stewart 12/16/2021				
APPROVED: Dale Mason 12/16/2021				
MFG				
TITLE: MT KIT, ISL-G, T3RE, FK40/ 4xFC, '22				
DWG NO: KMC94069				REV: 0
SCALE: 1:8				SHEET 1 OF 1

REV	ECN	DESCRIPTION	DATE	BY
0		RELEASED TO PRODUCTION	12/16/2021	VAL

UNSPECIFIED TOLERANCES:		ALL DIMS
ONE DECIMAL PLACE (X1)	MM	FRACTION
TWO DECIMAL PLACE (X2)	MM	THREE
THREE DECIMAL PLACE (X3)	MM	SIXTEEN
FRACTIONAL (X1/16)	INCHES	32

THIRD ANGLE PROJECTION

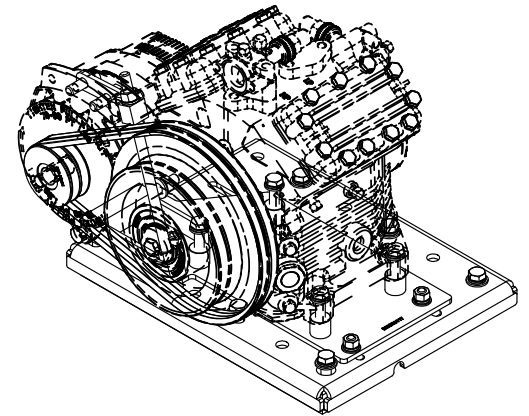
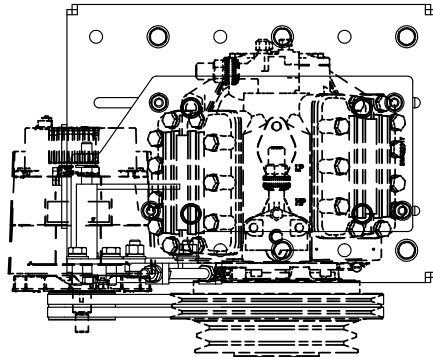
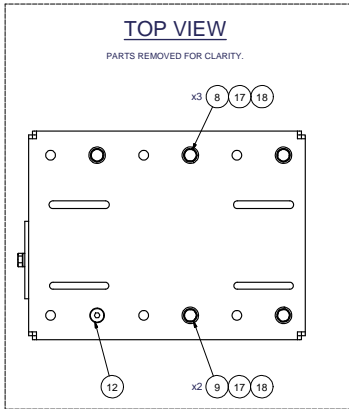

ISOMETRIC VIEW

NOTE:
SHOWING COMPRESSOR
4xFCY OR
FK40 xxx
AS REFERENCE.

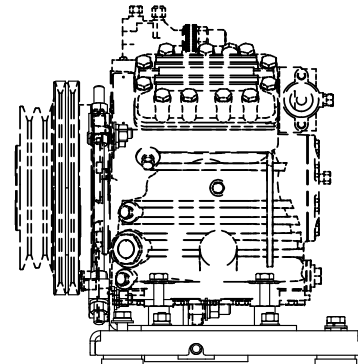
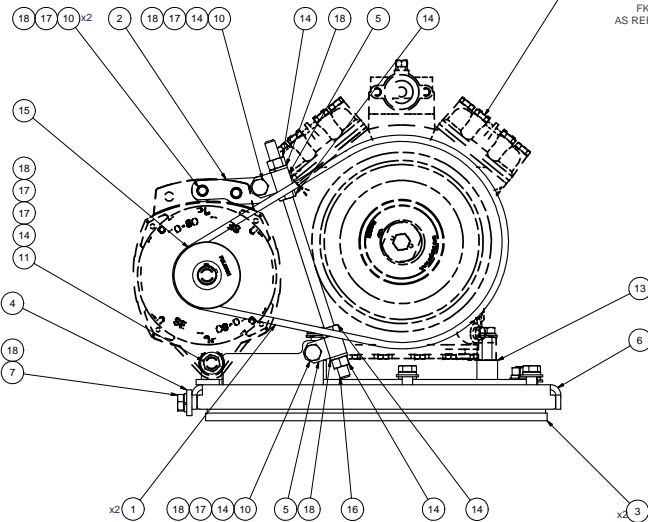

NOTES:

- 1) USE SERVICABLE THREADLOCKER ON ALL FASTENERS TO ENGINE COMPONENTS AND TORQUE ALL BOLTS TO S.A.E. SPECIFICATIONS.
- 2) SEE "TRANSARGTIC A/C COMPRESSOR MOUNT INSTALLATION DISCLAIMER".
- 3) WEIGHT: 56.70 LBS.

ITEM	QTY	U/M	PART NUMBER	DESCRIPTION
18	13	EACH	WFO08000	WASHER, LOCK, 1/2", 8, PLT
17	11	EACH	WFO08000	WASHER, FLAT, 1/2", 8, PLT
16	1	EACH	TRD08120	THREADED, ROD, 1/2-13UNC x 12", 5 PLT
15	1	EACH	PUL03321	PULLEY, ALT, IDLER, 3.25"o, 2A
14	7	EACH	NT008000	NUT, HEX, 1/2-13UNC, 8, PLT
13	1	EACH	K8T84064	MT KIT, TRANSIT, 4xFCY, '12
12	1	EACH	CSF08076	CAPSCREW, FH, 1/2-20UNF x .75", ALLOY, PLT
11	1	EACH	BT008653	BOLT, HEX, 1/2-13UNC x 6.50, 8, PLT
10	4	EACH	BT008150	BOLT, HEX, 1/2-13UNC x 1.50, 8, PLT
9	2	EACH	BT008126	BOLT, HEX, 1/2-20UNF x 1.25, 8, PLT
8	3	EACH	BT008101	BOLT, HEX, 1/2-20UNF x 1.00, 8, PLT
7	1	EACH	BT008653	BOLT, HEX, 1/2-13UNC x 6.50, 5, PLT, FT
6	1	EACH	BMZ00043	BKT, MAIN, BASE PL, '13
5	2	EACH	BMT10011	BKT, TENR, BLOCK, OFFSET, 3mm
4	1	EACH	BMN80025	BKT, BACK, PL, SLIDE, IC, RE300
3	2	EACH	BMN80008	VIBRATION ISOLATOR, BAR, 16.50 x 2 x 1.50
2	1	EACH	BMCS3114	BKT, PL, ALT, SPACER, T3RE, '13
1	2	EACH	BELT1040	BELT, A, gr, 1040mm (41") (17410)

BILL OF MATERIALS

DRAWN: jrodriquez
CHECKED: Val_Jakowlew

9/16/2013

TRANSARGTIC INC.

REV	DESCRIPTION	DATE	BY
0	RELEASED TO PRODUCTION	9/16/2013	JRR
1		9/16/2013	GA
2		9/16/2013	James Stewart
3		9/16/2013	RF3
4		9/16/2013	Ron Ingram
5		9/16/2013	APPROVED
6		9/16/2013	Dale Mason

TITLE
KIT, COMPRESSOR, 24V, FK40/ 4xFC, '13

SIZE
D

DWG NO
KCB84064

REV
0

UNSPECIFIED TOLERANCES:	FINISH	THIRD ANGLE PROJECTION
ONE DECIMAL PLACE (X.1)	AS SHOWN	THIRD ANGLE PROJECTION
TWO DECIMAL PLACES (X.01)		
FRACTIONAL (1/16")		

DRAWING UNIT OF MEASURE
MM (INCH)

SCALE
1:3

SHEET 1 OF 1

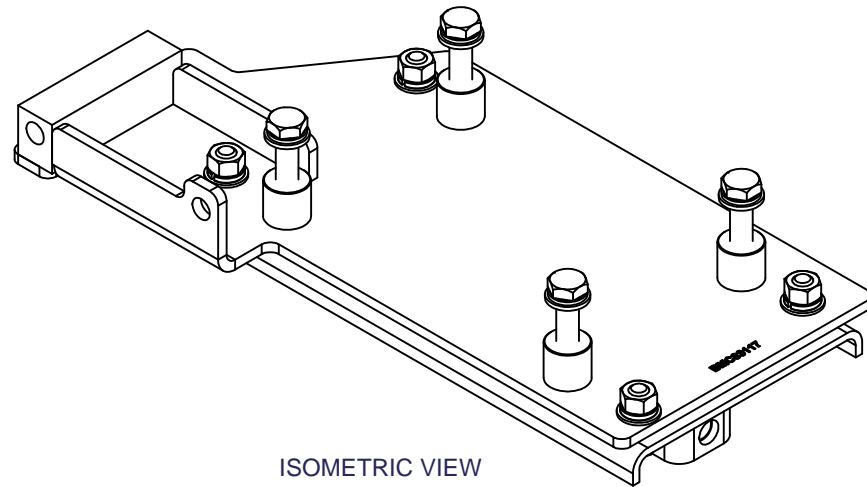
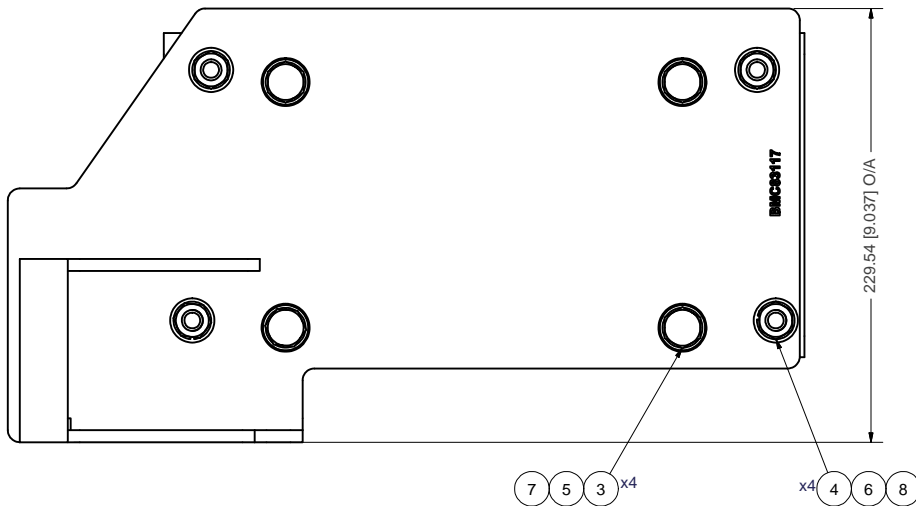

ISOMETRIC VIEW

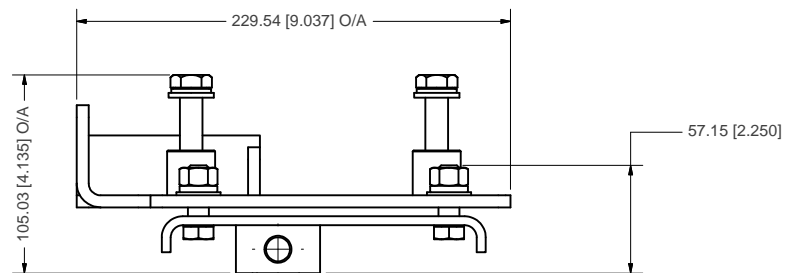
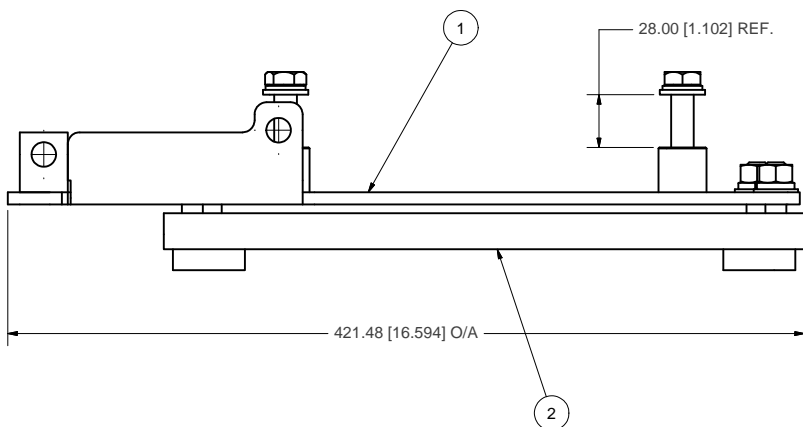

ITEM	QTY	U/M	PART NUMBER	DESCRIPTION
8	4	EACH	WLQ07000	WASHER, LOCK, 7/16", 8, PLT
7	4	EACH	WLA12000	WASHER, LOCK, 12mm, 8.8, PLT
6	4	EACH	WFN07000	WASHER, FLAT, 7/16", 2, PLT
5	4	EACH	WFA12000	WASHER, FLAT, 12mm, 8.8, PLT
4	4	EACH	NTP07000	NUT, HEX, 7/16-14UNC, 5, PLT
3	4	EACH	BTC12060	BOLT, HEX, 12 x 1.75 x 60mm, 10.9, PLT
2	1	EACH	BMN80031	BKT, MAIN, SLIDE, ASSY, 05K, IC, RE300
1	1	EACH	BMC83117	BKT, WELDM'T, 4xFCY W/ALT, T3RE, '13

BILL OF MATERIALS

DRAWN	jrodriguez	7/12/2013
CHECKED	Val Jakowlew	7/12/2013
REV	0	RELEASED TO PRODUCTION
REV	ECN:	DESCRIPTION: DATE: BY:
		James Stewart 7/12/2013
		MFG Ron Ingram 7/12/2013
		APPROVED Dale Mason 7/12/2013

TRANSARCTIC INC.

TITLE
KIT, PLATFORM, 4xFCY W/ALT, '13

SIZE	C	DWG NO	KBT84064	REV	0
------	---	--------	----------	-----	---

0	RELEASED TO PRODUCTION	7/24/2013	JRR
REV	ECN:	DESCRIPTION:	DATE: BY:
THIS DRAWING CONTAINS PROPRIETARY CONFIDENTIAL INFORMATION OWNED BY TRANSARCTIC CANADA INC. THE DOCUMENT AND THE INFORMATION IN IT ARE NOT TO BE USED, DISCLOSED OR REPRODUCED WITHOUT EXPRESS WRITTEN PERMISSION OF THE COMPANY.			
UNSPECIFIED TOLERANCES: (ALT. DIM.)			
ONE DECIMAL PLACE (.X)	.50	(.020)	
TWO DECIMAL PLACE (.XX)	.25	(.010)	
THREE DECIMAL PLACE (.XXX)	.10	(.005)	
FRACTIONAL +/- .002"	ANGULAR +/- .50°		
THIRD ANGLE PROJECTION			

DRAWING UNIT OF MEASURE:	MM [INCH]	SCALE	1:2	SHEET	1	OF	1
--------------------------	-----------	-------	-----	-------	---	----	---

- NOTES:
- 1) USE SERVICABLE THREADLOCKER ON ALL FASTENERS TO ENGINE COMPONENTS AND TORQUE **ALL** BOLTS TO S.A.E. SPECIFICATIONS.
 - 2) SEE "TRANSARCTIC A/C COMPRESSOR MOUNT INSTALLATION DISCLAIMER".
 - 3) WEIGHT: 18.22 LBS.

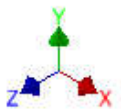
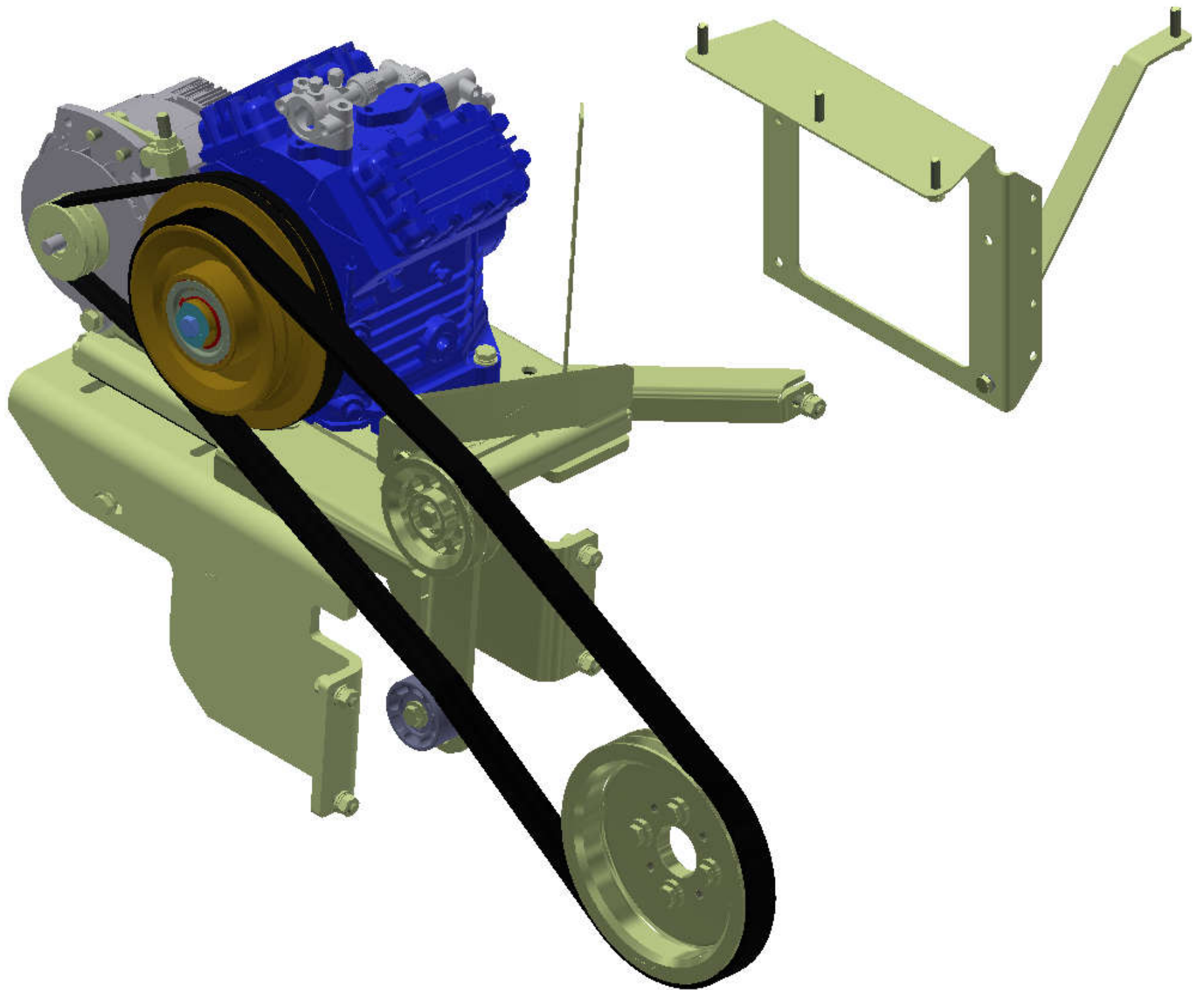

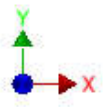
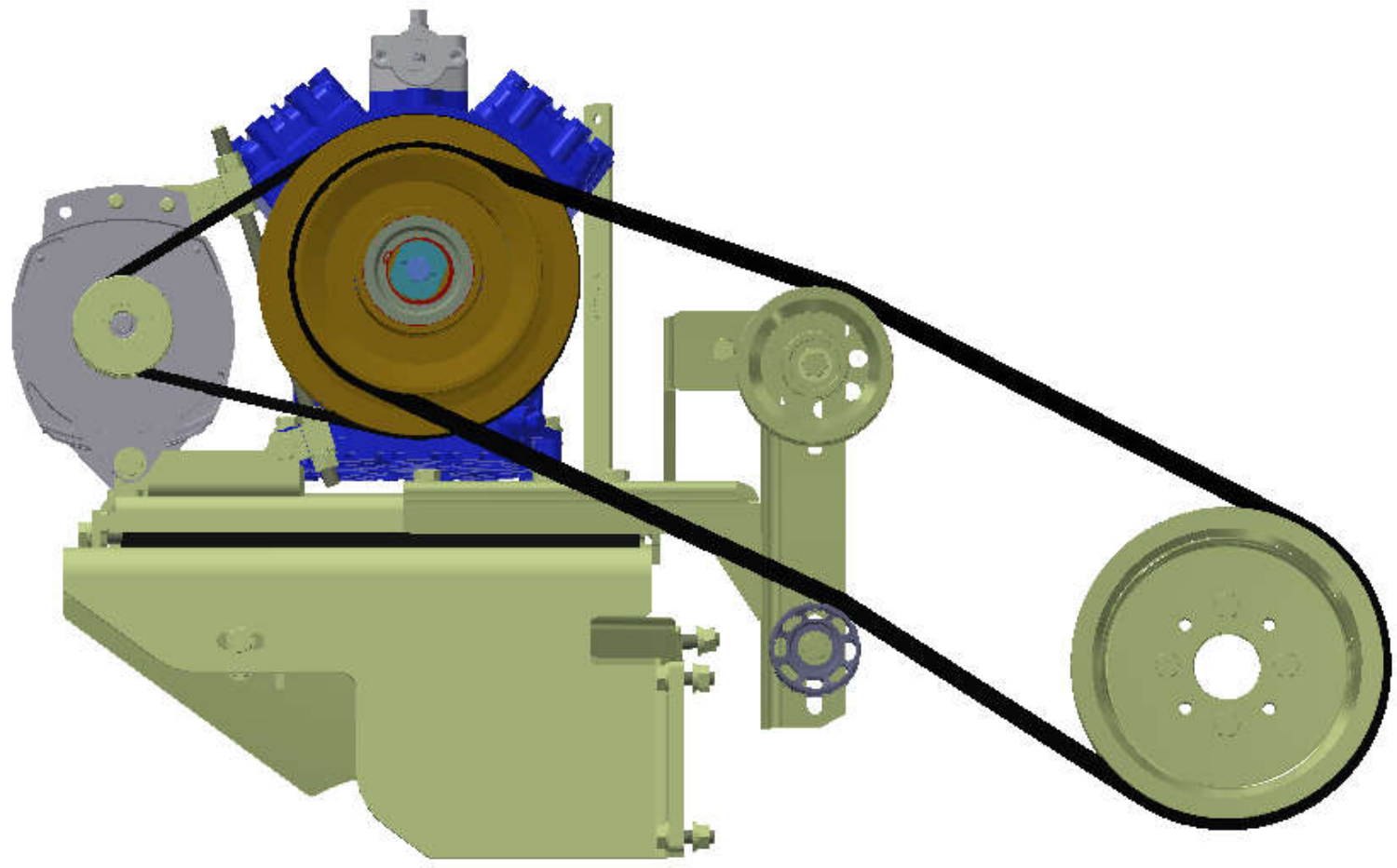
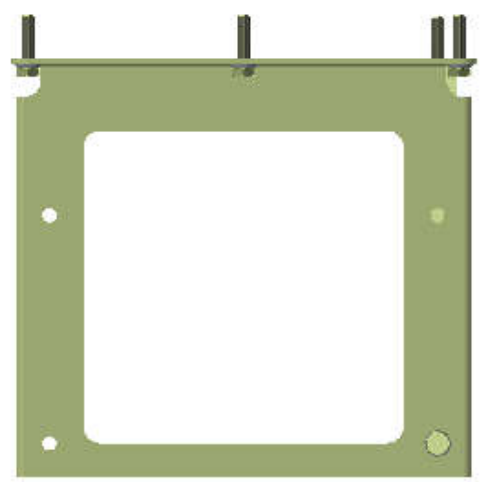

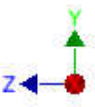
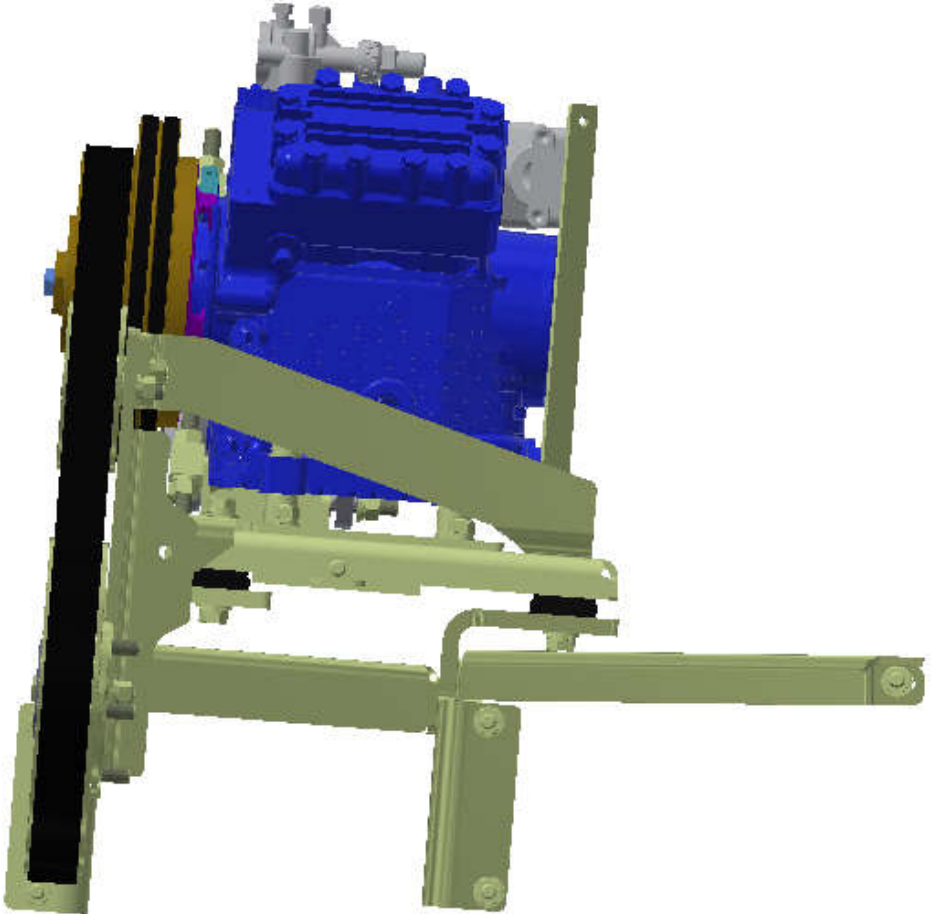
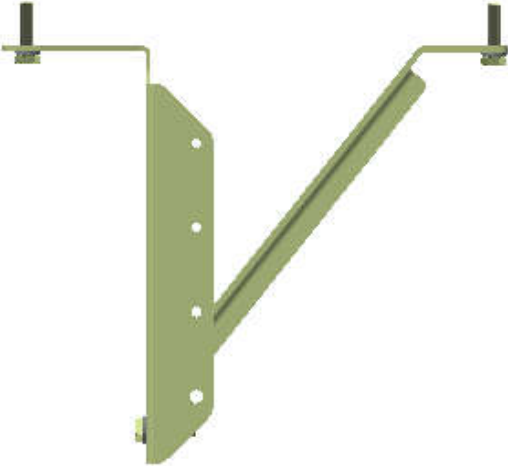

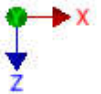
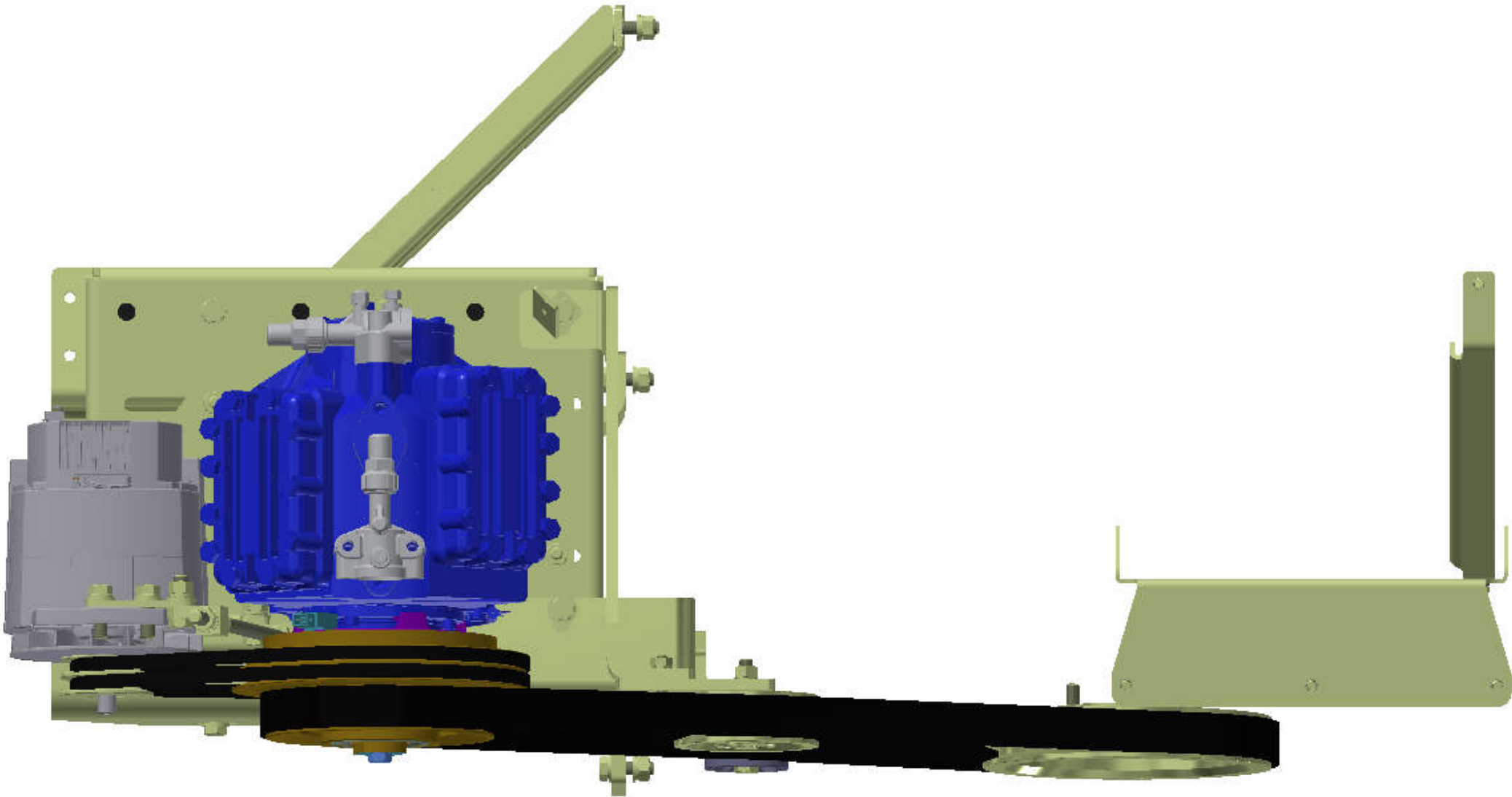

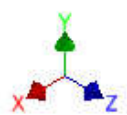
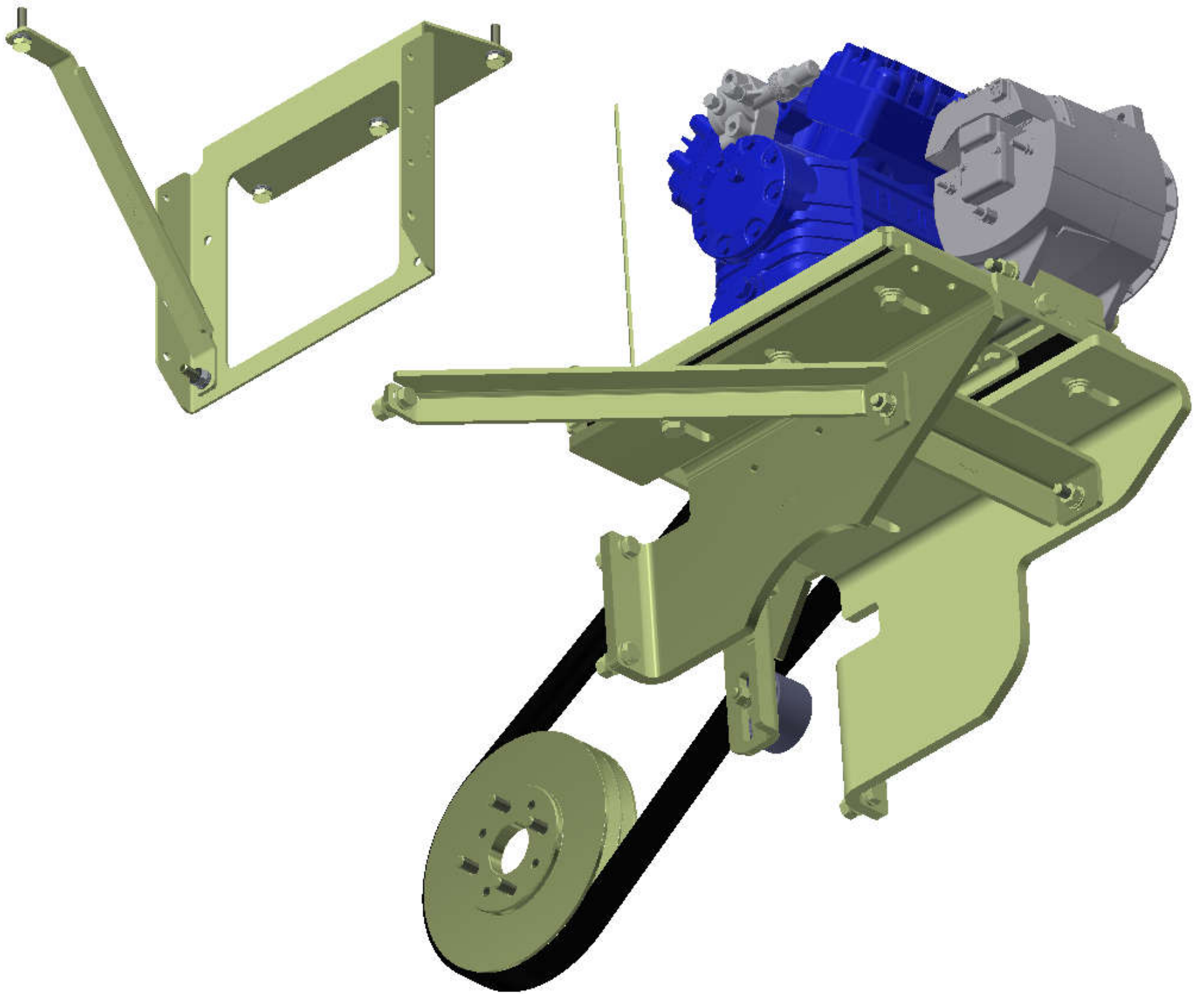

TransArctic A/C Compressor Mount Installation Disclaimer

All compressor mounts should be installed by qualified and trained personnel using proper tools and equipment in safe working conditions following industry standard guidelines for motor vehicle service and repair.

The installer of any compressor mount purchased from TransArctic must undertake all responsibility of issues arising from that compressor bracket being installed on any vehicle. As well as insure that a **proper and sufficient ground** is established between the compressors' clutches and the vehicle's engine. Mount functionality, operation and durability can all be compromised by an incompetent installation.

Due to the many different situations, parameters and application criteria, which are beyond the compressor mount manufacturer's control, TransArctic does not warrant design, durability, or operational functionality of any compressor mount improperly installed by another party.

With no implied guarantees it is the mount installer's strict responsibility to determine safety and functionality, of the compressor mount, at the time of installation.

Please contact TransArctic with any issue arising from installation so we may better improve the product. If you have any reservations about the compressor mount integrity contact TransArctic immediately at 1-877-COLD-AIR.

Mark OEM tensioner location

Install Kit

Check for Interferences

Check to ensure that the proper OEM tensioner orientation is maintained

Run engine with A/C system engaged for at least 10 minutes to run in belt

Check OEM tensioner orientation and adjust as required

Responsabilidad limitada de TransArctic en la instalación del soporte del compresor

Todos los soportes de los compresores deben ser instalados por personas calificadas y entrenadas, usando para ello los equipos y herramientas necesarios para esta labor en buenas condiciones y según las normas y guías para el servicio y/o reparación de motores de vehículos.

El instalador de los soportes comprados en TransArctic asume toda la responsabilidad de cualquier problema que surja en el soporte del compresor al vehículo; de igual manera es responsable que el cable a tierra sea conectado entre el embrague del compresor y el motor del vehículo.

Se advierte que el buen funcionamiento y la durabilidad del soporte pueden ser comprometidos por defectos en su instalación.

Debido a las diversas situaciones que se puedan presentar fuera del control del fabricante, TransArctic no garantiza el diseño, la durabilidad o el correcto funcionamiento de cualquier equipo inapropiadamente instalado por terceros.

Esta sobreentendido que el Instalador del montaje del compresor es estrictamente responsable de la seguridad y funcionamiento del equipo en el momento de la instalación.

Si tuviera algún problema o duda acerca de la instalación del soporte del compresor pongase en contacto inmediatamente con TransArctic al teléfono 1-877-COLD-AIR de modo que podamos mejorar nuestro producto.

Note la ubicación del medidor de tensión OEM

Instale el equipo

Controlar si hay interferencias.

Asegurese que el medidor de tensión mantenga la orientación justa.

Encienda el motor por lo menos 10 minutos con el sistema A/C enganchado para que la correa corra

Controle la orientación justa del medidor de tensión y ajuste a las condiciones requeridas del fabricante