

Bill of Materials Listing

TransArctic Canada Inc.

11/1/2016
Page 1 of 1

Product Number	Description	Date	Weight	Uof M	Yield
Line Component Prod#	Description	Bin Unit	Qty		
KMC96563	Mt Kit, ISL-G, T3RE, TM-65/55, 12V, '13	6/26/2013	183.18		0
10 BEL32210	Belt, Banded B gr,2210mm (87")	each	1		
50 BMC67096	Bkt, Diag Brace, DS, Frame Raill, T3RE	each	1		
60 BMC83054	Bkt, Main, Idler, Weldm't, RE300	each	1		
70 BMC83107	Bkt, Main, FRT Support, T3RE, '13	each	1		
80 BMC83109	Bkt, Main, Lateral Brace, T3RE, '13	each	1		
90 BMC90009	Bkt, Main, RR Support, CNG,T3RE, '13	each	1		
110 BMN80008	Vibration Isolator, Bar,16.50 x 2 x 1.50	each	2		
130 BMZ00043	Bkt, Main, Base Pl, '13	each	1		
140 BMZ00046	Bkt, Angle, Brace, Hanger, Hose, 2013	each	1		
170 KCB86664	Kit, Compressor, 24/12V, TM-65/55, '13	each	1		
180 KIZ00001	Kit, Inst, Relocate PDU, Transit Mts	each	1		
190 PUA05012	Pulley, Assy, Idler,B/BX gr,5", STL,Pit	each	1		
210 PUL80074	Pulley, Idler, B/S, Wide, 76d (89102)	each	1		
220 PUL89322	Pulley, Crank,ADD-ON,Combo,ISC/L-G,2B/3V	each	1		
230 SCD46012	Spacer, Col, Drl, 46mm x 31.8o x 12.0i	each	1		
240 SCD49512	Spacer, Col, Drl, 49.48mmx 25.4o x 12.3i	each	1		
250 SLV17012	Sleeve, Pulley, 16.9o x 22.23mm x 12.32i	each	2		
270 KBC96563	Bag Kit, Fasteners, KMC96563	each	1		

Bill of Materials Listing

TransArctic Canada Inc.

3/1/2017
Page 1 of 1

Product Number	Description	Date	Weight	Uof M	Yield
Line Component Prod#	Description	Bin Unit	Qty		
KBC96563	Bag Kit, Fasteners, KMC96563		7/9/2013	3.28	0
40	BTC12040	Bolt, Hex, 12 x 1.75 x 40mm, 10.9,Plt,FT	each	5	
50	BTC12050	Bolt, Hex, 12 x 1.75 x 50mm, 10.9,Plt	each	2	
60	BTC12100	Bolt, Hex, 12 x 1.75 x 100mm, 10.9, Plt	each	2	
65	BTQ08101	Bolt, Hex, 1/2-20unf, 1.00", 8, Plt	each	3	
70	BTQ08126	Bolt, Hex, 1/2-20unf, 1.25", 8, Plt	each	8	
80	CSF08076	Capscrew, FH, 1/2-20unf x .75",Alloy,Plt	each	1	
90	NTA12000	Nut, Hex, 12 x 1.75, 8.8, Plt	each	9	
180	WFA12000	Washer, Flat, 12mm, 8.8, Plt	each	16	
190	WFQ08000	Washer, Flat, 1/2", 8, Plt	each	11	
220	WLA12000	Washer, Lock, 12mm, 8.8, Plt	each	9	
230	WLQ08000	Washer, Lock, 1/2", 8, Plt	each	11	

Bill of Materials Listing

TransArctic Canada Inc.

1/8/2016
Page 1 of 1

Product Number	Description	Date	Weight	Uof M	Yield
Line Component Prod#	Description	Bin Unit	Qty		
KCB86664	Kit, Compressor, 24/12V, TM-65/55, '13	9/16/2013	16.86		0
10 BMN80031	Bkt, Main, Slide, Assy, 05K, IC, RE300	each	1		
20 BMZ00056	Bkt, Comp, FRT, Z, TM-65/55, '13	each	1		
30 BMZ00057	Bkt, Comp, Rear, Z, TM-65/55, '13	each	1		
40 BMN80025	Bkt, Back, PL, Slide, IC, RE300	each	1		
50 KBZ86664	Bag Kit, Fasteners, KCB86664	each	1		

Bill of Materials Listing

TransArctic Canada Inc.

1/8/2016
Page 1 of 1

Product Number	Description	Date	Weight	Uof M	Yield
Line Component Prod#	Description	Bin Unit	Qty		
KBZ86664	Bag Kit, Fasteners, KCB86664	10/18/2013	1.04		0
10	BTP08653				
	Bolt, Hex, 1/2-13unc, 6.5", 5, Plt, FT	each	1		
20	BTC12035				
	Bolt, Hex, 12 x 1.75 x 35mm, 10.9,Plt,FT	each	4		
30	NTP07000				
	Nut, Hex, 7/16-14unc, 5, Plt	each	4		
35	WFA12000				
	Washer, Flat, 12mm, 8.8, Plt	each	4		
40	WFN07000				
	Washer, Flat, 7/16", 2, Plt	each	4		
45	WLA12000				
	Washer, Lock, 12mm, 8.8, Plt	each	4		
50	WLQ08000				
	Washer, Lock, 1/2", 8, Plt	each	1		
60	WLQ07000				
	Washer, Lock, 7/16", 8, Plt	each	4		

Bill of Materials Listing

TransArctic Canada Inc.

11/1/2016
Page 1 of 1

Product Number	Description	Date	Weight	Uof M	Yield
Line Component Prod#	Description	Bin Unit	Qty		
KIZ00001	Kit, Inst, Relocate PDU, Transit Mts	6/11/2014	10.38		0
10	BMC67093	Bkt, Fuse Panel, Vert., ISB, T3RE	each	1	
20	BMC67094	Bkt, Diag, Brace DS, Fuse Panel, T3RE	each	1	
30	BMC67095	Bkt, Diag, Brace PS, Fuse Panel, T3RE	each	1	
40	KBZ00001	Bag Kit, Fasteners, KIZ00001	each	1	

Bill of Materials Listing

TransArctic Canada Inc.

11/1/2016
Page 1 of 1

Product Number	Description	Date	Weight	Uof M	Yield
Line Component Prod#	Description	Bin Unit	Qty		
KBZ00001	Bag Kit, Fasteners, KIZ00001		11/7/2014	0.55	0
10 BTQ06100	Bolt, Hex, 3/8-16unc, 1", 8, Plt	each	2		
20 BTQ06125	Bolt, Hex, 3/8-16unc, 1.25", 8, Plt	each	5		
30 NTQ06000	Nut, Hex, 3/8-16unc, 8, Plt	each	2		
40 WFN06000	Washer, Flat, 3/8", 2, Plt	each	9		
50 WLQ06000	Washer, Lock, 3/8", 8, Plt	each	7		

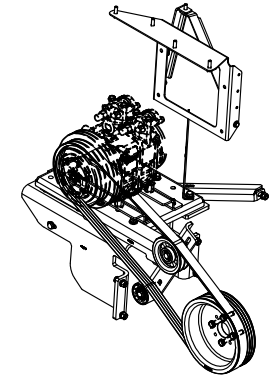
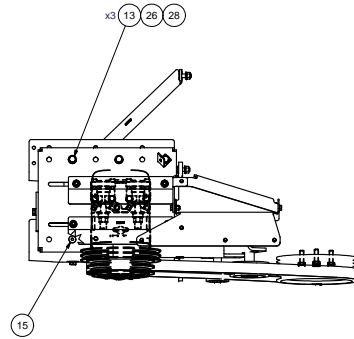

ISOMETRIC VIEW

- NOTES:**
- 1) USE SERVICABLE THREADLOCKER ON ALL FASTENERS TO ENGINE COMPONENTS AND TORQUE **ALL BOLTS** TO S.A.E. SPECIFICATIONS.
 - 2) SEE "TRANSARTIC A/C COMPRESSOR MOUNT INSTALLATION DISCLAIMER".

NOTE:
SHOWING TRANSARTIC
COMPRESSOR PART#
CMV33643 (TM-55)/
CMV38824 (TM-65)
AS REFERENCE.

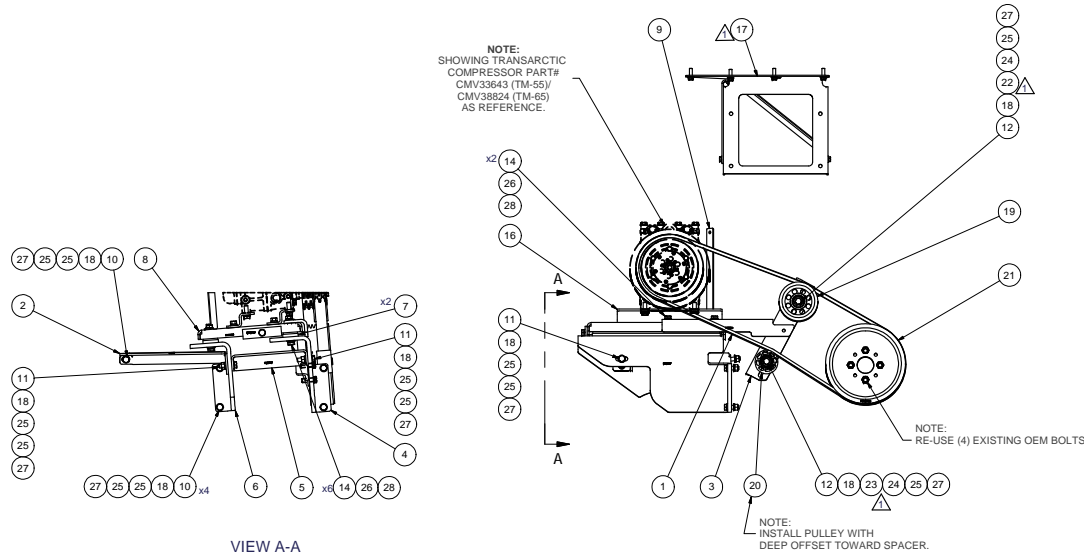

VIEW A-A

ITEM	QTY	U/M	PART NUMBER	DESCRIPTION
28	11	EACH	WLO08000	WASHER, LOCK, 1/2", 8, PLT
27	9	EACH	WL12000	WASHER, LOCK, 12mm, 8, 8, PLT
26	11	EACH	WFO08000	WASHER, FLAT, 1/2", 8, PLT
25	16	EACH	WFA12000	WASHER, FLAT, 12mm, 8, 8, PLT
24	2	EACH	SLV17012	SLEEVE, PULLEY, 16.90 x 22.23 mm x12.19i
23	1	EACH	SCD49512	SPACER, COL, DRL, 49.48mm x 25.40 x 12.3
22	1	EACH	SCD46012	SPACER, COL, DRL, 46mm x 31.80 x 12.0i
21	1	EACH	PUL89322	PULLEY, CRANK, ADD-ON, COMBO, ISL/G, 2B/3V
20	1	EACH	PUL80074	PULLEY, IDLER, BACKSIDE, PB, 74D, 46.27W
19	1	EACH	PLA05012	PULLEY, ASSY, IDLER, B/BX, gr, 5" STL, PLT
18	9	EACH	NTA12000	NUT, HEX, 12 x 1.75, 8, 8, PLT
17	1	EACH	KIZ00001	KIT, INST, RELOCATE PDU, TRANSIT MTS
16	1	EACH	KCB86664	KIT, COMPRESSOR, 24/12V, TM-65/55, '13
15	1	EACH	CSF08076	CAPSCREW, FH, 1/2-20UNF x .75", ALLOY, PLT
14	8	EACH	BT008126	BOLT, HEX, 1/2-20UNF x 1.25, 8, PLT
13	3	EACH	BT008101	BOLT, HEX, 1/2-20UNF x 1.00, 8, PLT
12	2	EACH	BTCT12100	BOLT, HEX, 12 x 1.75 x 100mm, 10.9, PLT
11	2	EACH	BTCT12050	BOLT, HEX, 12 x 1.75 x 50mm, 10.9, PLT
10	5	EACH	BTCT12040	BOLT, HEX, 12 x 1.75 x 40mm, 10.9, PLT
9	1	EACH	BMZ00046	BKT, ANGLE, BRACE, HANGER, HOSE, 2013
8	1	EACH	BMZ00043	BKT, MAIN, BASE PL, '13
7	2	EACH	BMN80008	VIBRATION ISOLATOR, BAR, 16.50 x 2 x 1.50
6	1	EACH	BMC90009	BKT, MAIN, RR SUPPORT, CNG, T3RE, '13
5	1	EACH	BMC83109	BKT, MAIN, LATERAL BRACE, T3RE, '13
4	1	EACH	BMC83107	BKT, MAIN, FRT SUPPORT, T3RE, '13
3	1	EACH	BMC83054	BKT, MAIN, IDLER, WELDMT, RE300
2	1	EACH	BMC87096	BKT, DIAG BRACE, DS, FRAME RAIL, T3RE
1	1	EACH	BEL32210	BELT, BANDED, B GR, 2210mm (87")

BILL OF MATERIALS

1	UPDATED SPACERS	10/28/2015	JRR
0	RELEASED TO PRODUCTION	01/12/16	VAL/GA
REV	DESCRIPTION	DATE	BY
1	James Stewart	1/12/2016	JMS
2	APPROVED	1/12/2016	Dale Mason

UNSPECIFIED TOLERANCES: ALL DIMS
 ONE DECIMAL PLACE (X) .00 (FRA)
 TWO DECIMAL PLACE (X) .00 (FRA)
 THREE DECIMAL PLACE (X) .000 (FRA)
 FRACTIONAL (X) 1/16" (FRA)

DRAWN: vjakowlew
 CHECKED: 1/12/2016
 TITLE: **TRANSARTIC INC.**
 DESCRIPTION: **MT KIT, ISL-G, T3RE, TM-65/55, 12V, '13**
 SIZE: D
 DWG NO: **KMC96563**
 SCALE: 1:1
 SHEET 1 OF 1

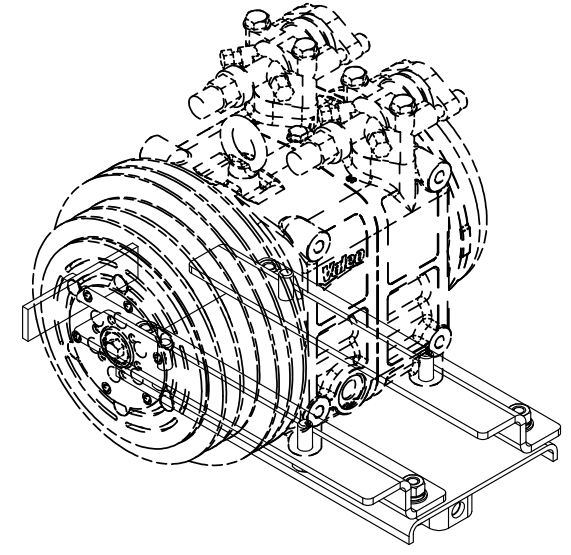
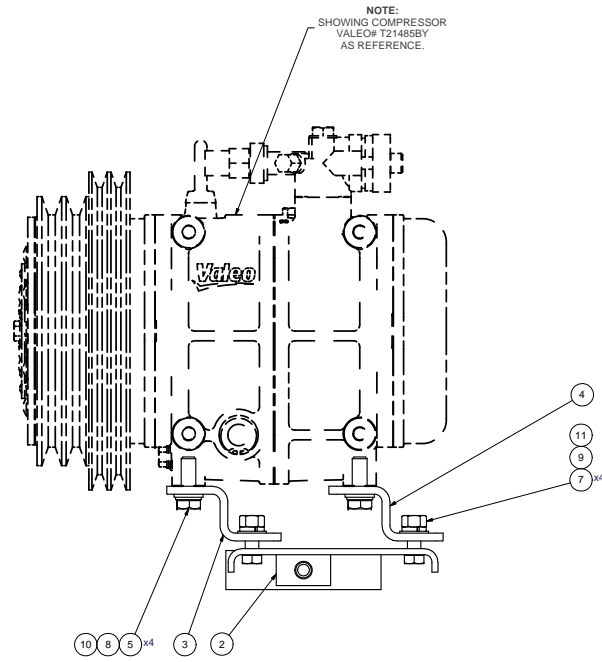
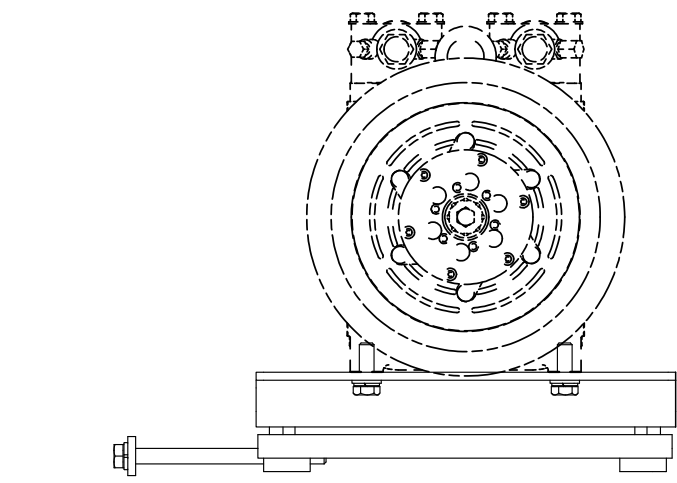
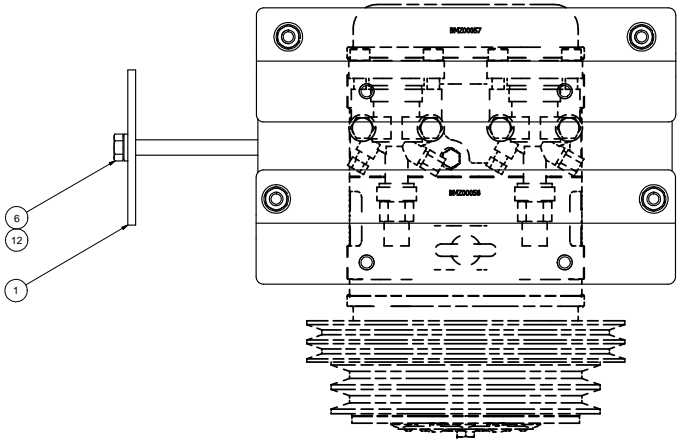

ISOMETRIC VIEW

- NOTES:
 1) USE SERVICABLE THREADLOCKER ON ALL FASTENERS TO ENGINE COMPONENTS AND TORQUE ALL BOLTS TO S.A.E. SPECIFICATIONS.
 2) SEE "TRANSARCTIC A/C COMPRESSOR MOUNT INSTALLATION DISCLAIMER".
 3) WEIGHT: 16.86 LBS.

ITEM	QTY	U/M	PART NUMBER	DESCRIPTION
12	1	EACH	WLO8000	WASHER, LOCK, 1/2", 8, PLT
11	4	EACH	WLA12000	WASHER, LOCK, 7/16", 8, PLT
10	4	EACH	WLA12000	WASHER, LOCK, 12mm, 8, 8, PLT
9	4	EACH	WFN07000	WASHER, FLAT, 7/16", 2, PLT
8	4	EACH	WFA12000	WASHER, FLAT, 12mm, 8, 8, PLT
7	4	EACH	NTP07000	NUT, HEX, 7/16-14UNC, 5, PLT
6	1	EACH	BTP08653	BOLT, HEX, 1/2-13UNC x 6.50, 5, PLT, FT
5	4	EACH	BTC12035	BOLT, HEX, 12 x 1.75 x 35mm, 10, 9, PLT
4	1	EACH	BMZ00057	BKT, COMP, REAR, Z, TM-65/55, '13
3	1	EACH	BMZ00056	BKT, COMP, FRT, Z, TM-65/55, '13
2	1	EACH	BMN80031	BKT, MAIN, SLIDE, ASSY, OSK, IC, RE300
1	1	EACH	BMN80025	BKT, BACK, PL, SLIDE, IC, RE300

BILL OF MATERIALS
TRANSARCTIC INC.

DATE	07/17/15	BY	GA
REVISION	RELEASED TO PRODUCTION	DATE	07/17/15
APPROVED	James Stewart	DATE	07/16/15
APPROVED	Dale Mason	DATE	07/16/15

DRAWN	vjakowlew	07/16/15	TITLE	KIT, COMPRESSOR, 24/12V, TM-65/55, '13
CHECKED	Jose Rodriguez	07/16/15	SIZE	D
APPROVED	James Stewart	07/16/15	DWG NO	KCB86664
APPROVED	Dale Mason	07/16/15	SCALE	1:3
UNSPECIFIED TOLERANCES:	ALL DIMS	THIRD ANGLE PROJECTION	DRAWING UNIT OF MEASURE	MM (INCH)
ONE DECIMAL PLACE (X.1)	30 (1000)			REV 0
TWO DECIMAL PLACES (X.01)	10 (100)			
THREE DECIMAL PLACES (X.001)	10 (100)			
FRACTIONAL (1/16")	16 (128)			

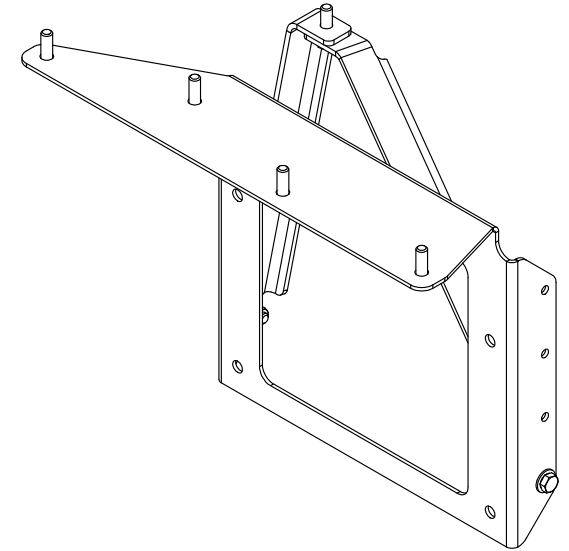
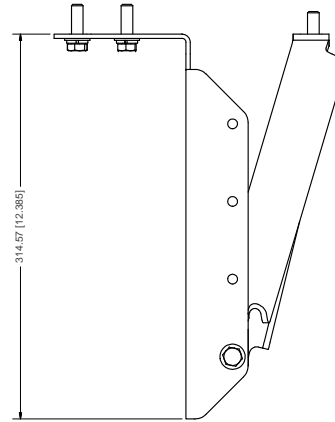
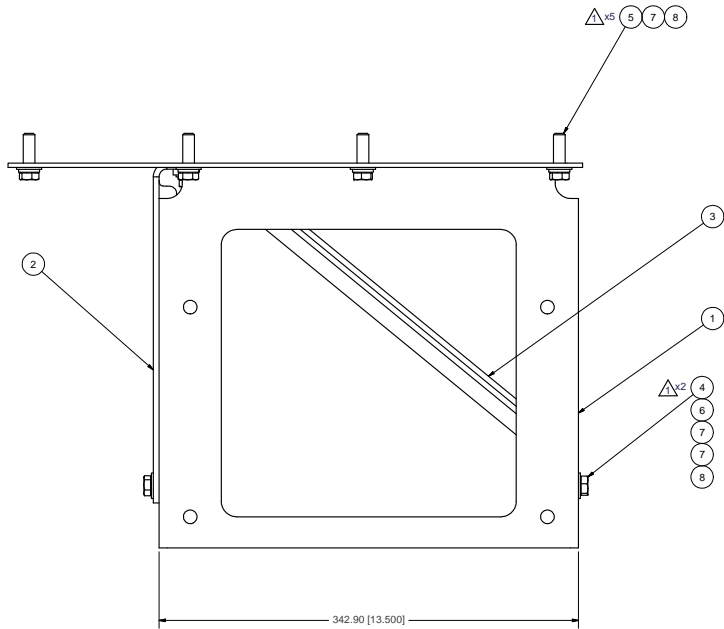
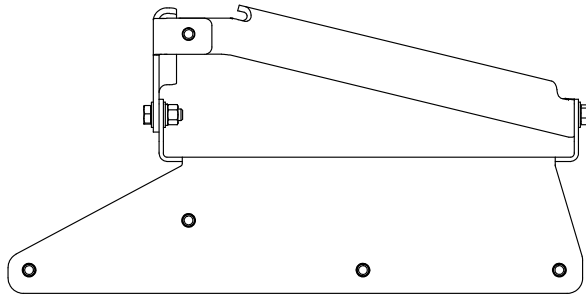

ISOMETRIC VIEW

- NOTES:
- 1) USE SERVICABLE THREADLOCKER ON ALL FASTENERS TO ENGINE COMPONENTS AND TORQUE **ALL** BOLTS TO S.A.E. SPECIFICATIONS.
 - 2) SEE "TRANSARCTIC A/C COMPRESSOR MOUNT INSTALLATION DISCLAIMER".

ITEM	QTY	U/M	PART NUMBER	DESCRIPTION
8	7	EACH	WLO06000	WASHER, LOCK, 3/8", 8, PLT
7	9	EACH	WFO06000	WASHER, FLAT, 3/8", 2, PLT
6	2	EACH	NTQ06000	NUT, HEX, 3/8-16UNC, 8, PLT
5	5	EACH	BTQ06125	BOLT, HEX, 3/8-16UNC x 1.25, 8, PLT
4	2	EACH	BTQ06100	BOLT, HEX, 3/8-16UNC, 1", 8, PLT
3	1	EACH	BMC67095	BKT. DIAG. BRACE PS, FUSE PANEL, T3RE
2	1	EACH	BMC67094	BKT. DIAG. BRACE DS, FUSE PANEL, T3RE
1	1	EACH	BMC67093	BKT. FUSE PANEL, VERT., ISB, T3RE

TRANSARCTIC INC.

DRAWN	jrodriquez	11/7/2014
CHECKED	Vaj_Jakowlew	11/7/2014
RELEASED TO PRODUCTION	GA	11/7/2014
REVISION	DESCRIPTION	DATE
1	WAS METRIC FASTENERS	3/1/2016
2	RELEASED TO PRODUCTION	11/7/2014
3	DATE	BY
1	James Stewart	11/7/2014
2	Ron Ingram	11/7/2014
3	Date Mason	11/7/2014

THIS DRAWING CONTAINS PROPRIETARY CONFIDENTIAL INFORMATION OWNED BY TRANSARCTIC CANADA INC. THE DOCUMENT AND THE INFORMATION IN IT ARE NOT TO BE USED, DISCLOSED OR REPRODUCED WITHOUT EXPRESS WRITTEN PERMISSION OF THE COMPANY.

UNSPECIFIED TOLERANCES:			
ONE DECIMAL PLACE (X.0)	±0.10	FRAC	
TWO DECIMAL PLACE (X.00)	±0.02	FRAC	
THREE DECIMAL PLACE (X.000)	±0.002	FRAC	
FRACTIONAL (1/16")	±0.005	ANGULAR	±30'



DRAWING UNIT OF MEASURE: MM (INCH)

TITLE: KIT, INST, RELOCATE PDU, TRANSIT MTS

SIZE: D

DWG NO: KIZ00001

REV: 1

SCALE: 1:2

SHEET 1 OF 1

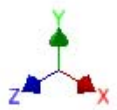
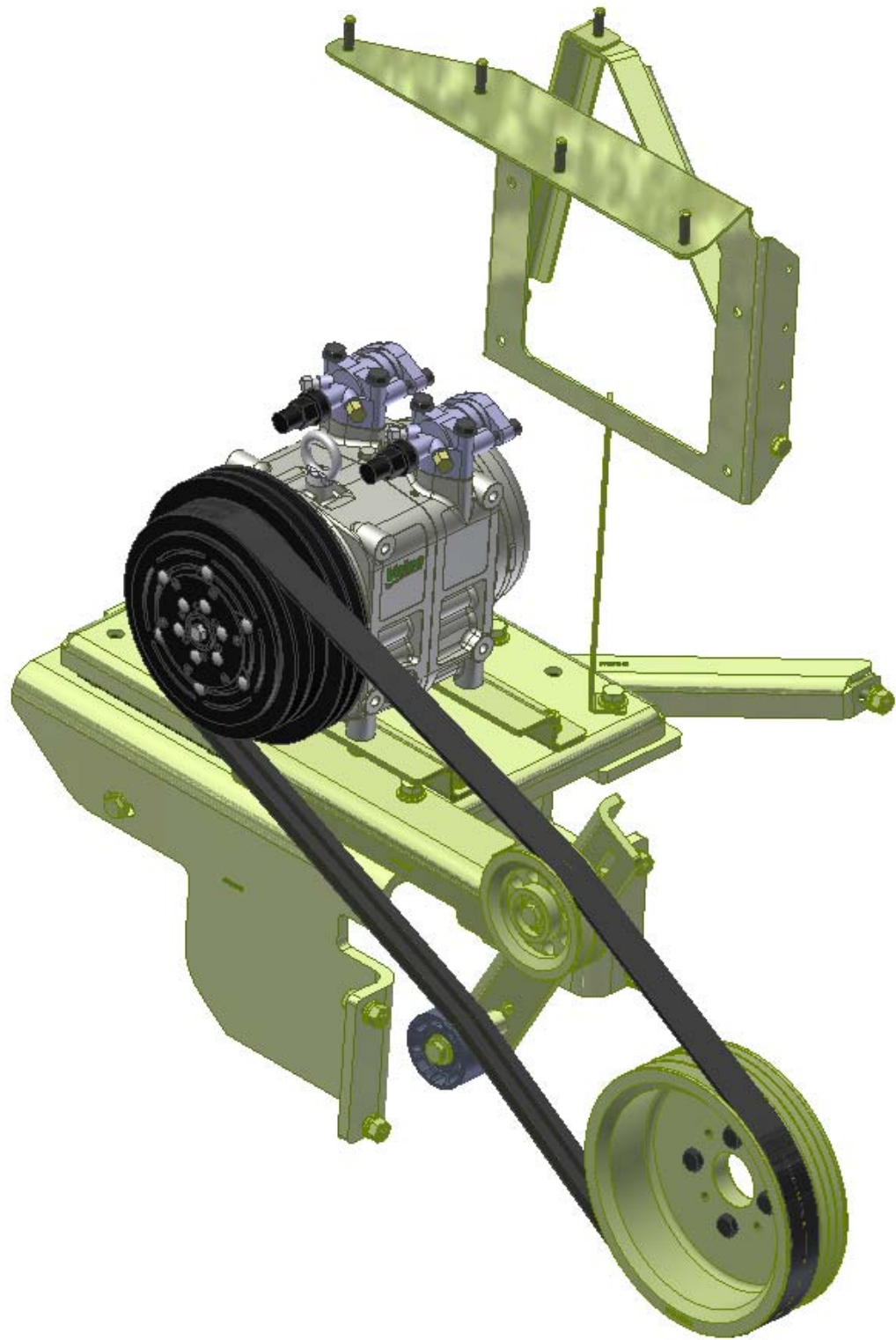

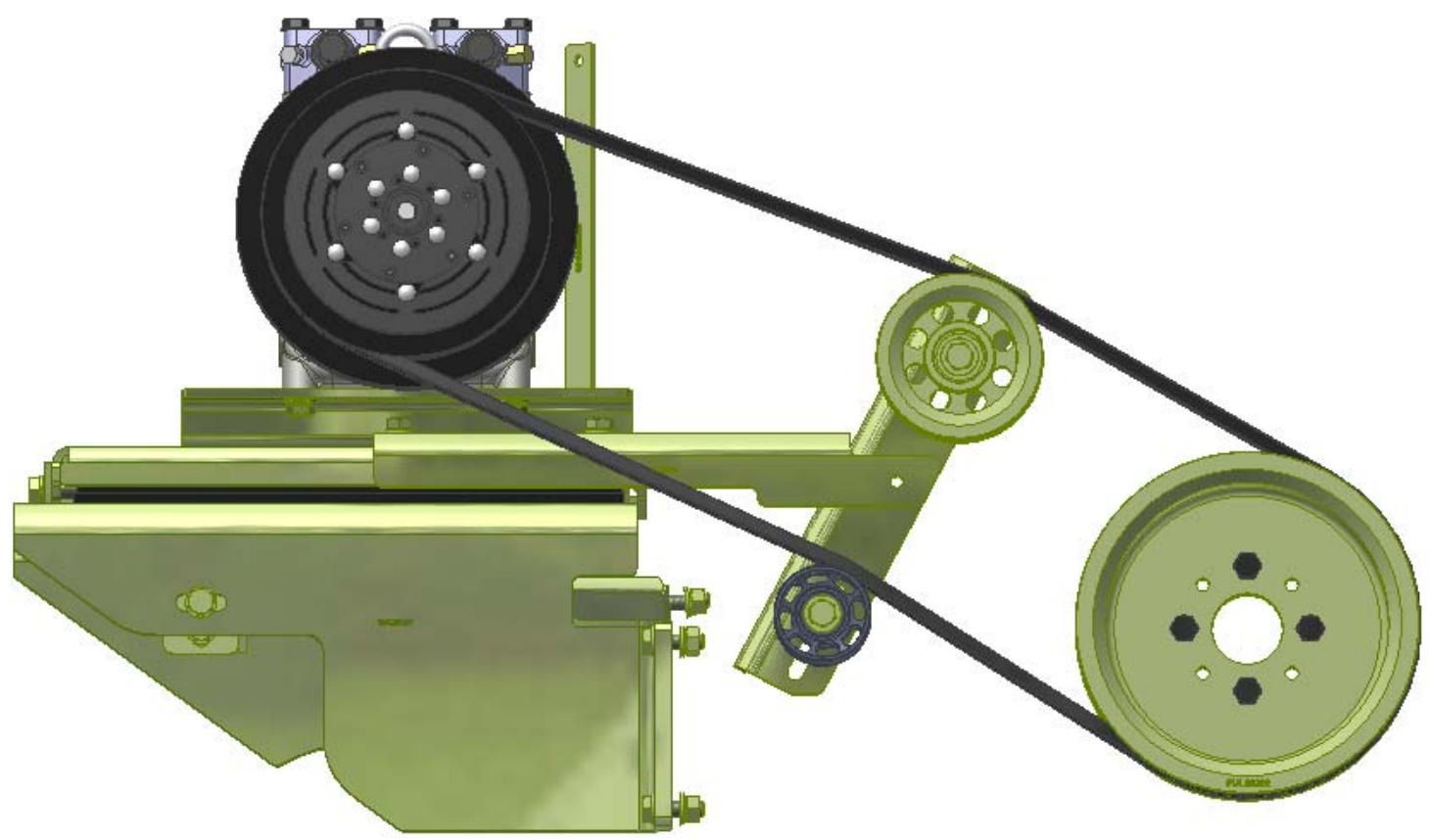
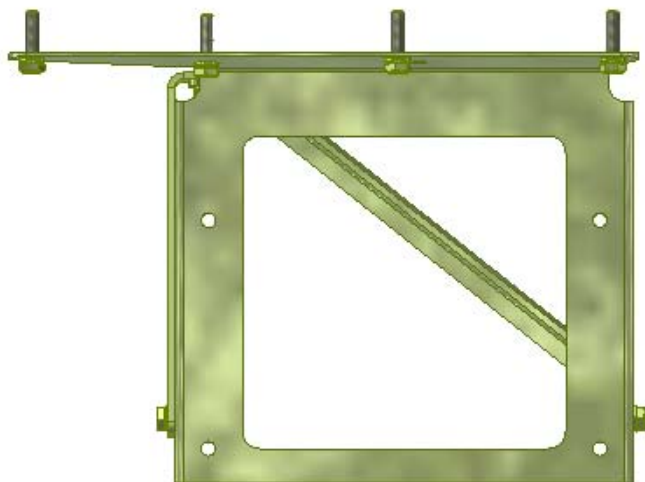

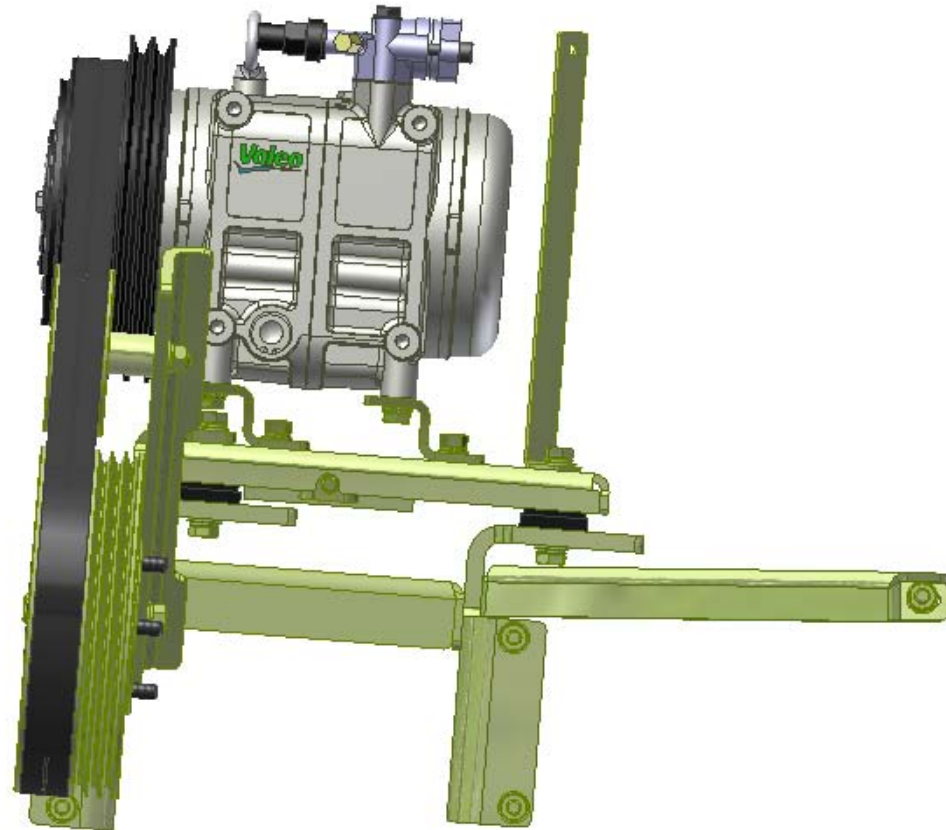
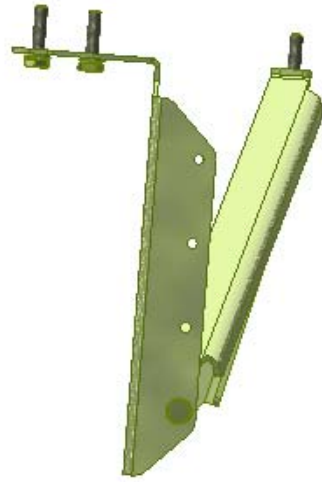

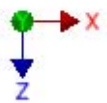
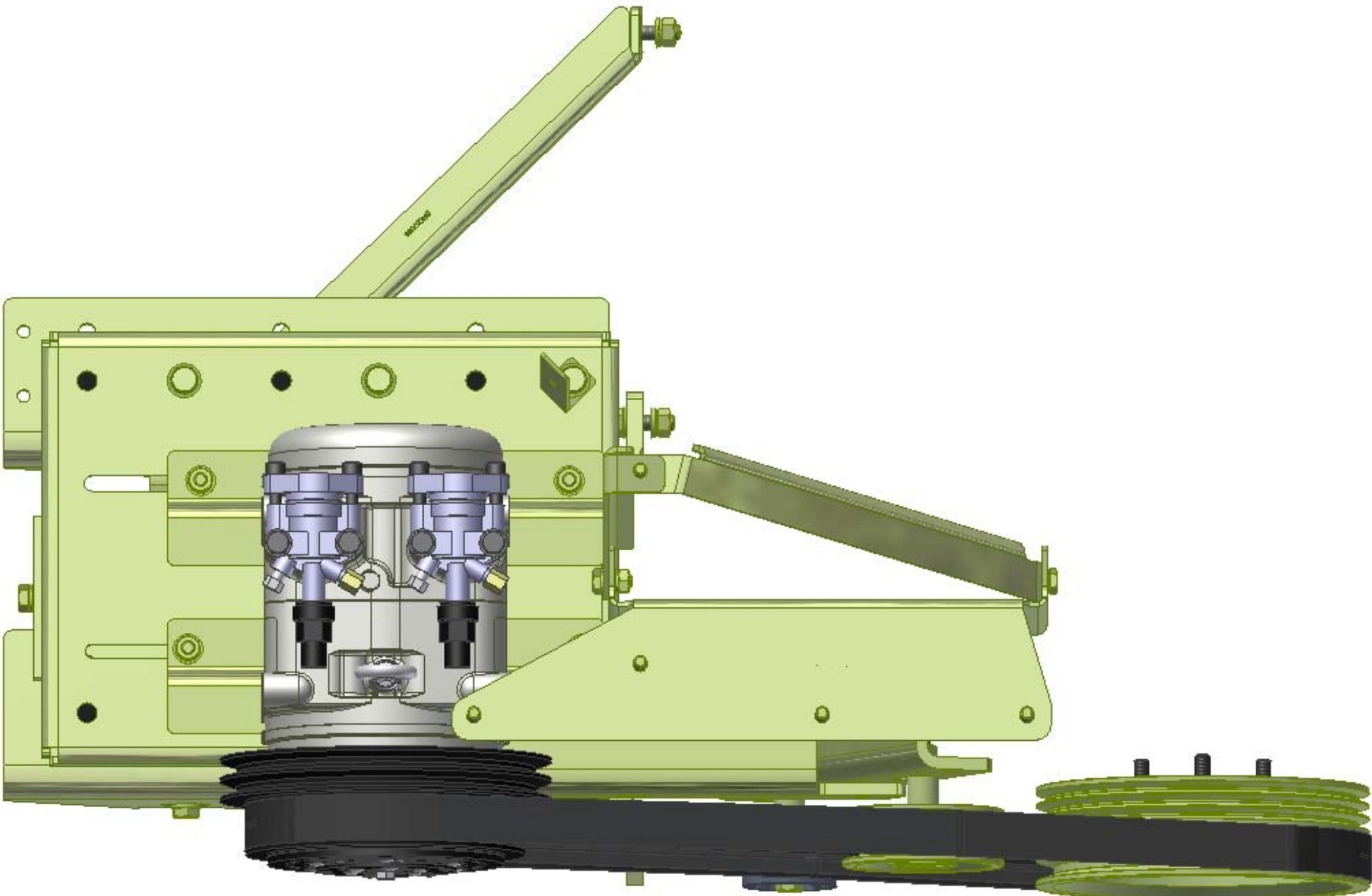

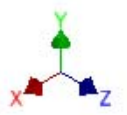
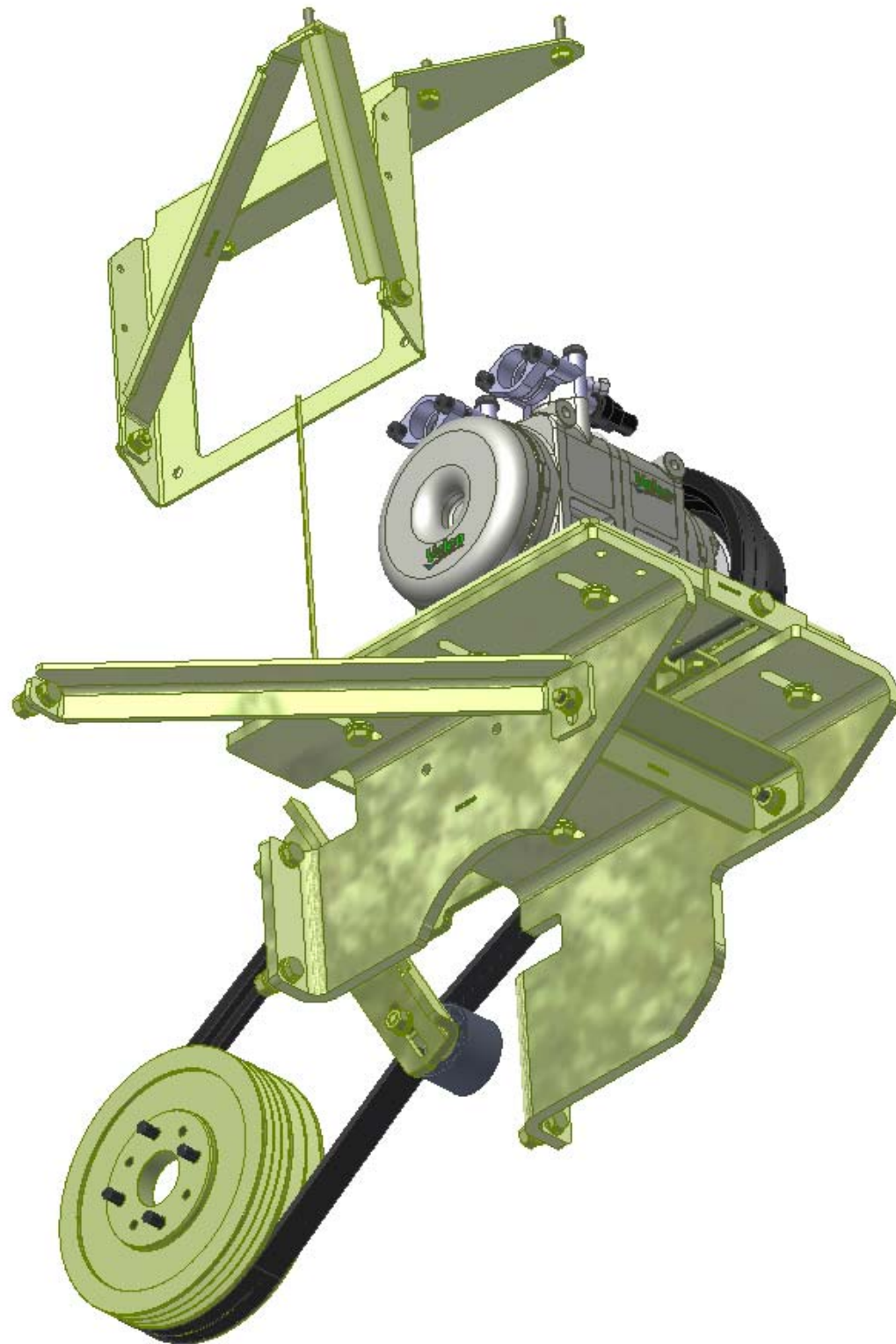

TransArctic A/C Compressor Mount Installation Disclaimer

All compressor mounts should be installed by qualified and trained personnel using proper tools and equipment in safe working conditions following industry standard guidelines for motor vehicle service and repair.

The installer of any compressor mount purchased from TransArctic must undertake all responsibility of issues arising from that compressor bracket being installed on any vehicle. As well as insure that a **proper and sufficient ground** is established between the compressors' clutches and the vehicle's engine. Mount functionality, operation and durability can all be compromised by an incompetent installation.

Due to the many different situations, parameters and application criteria, which are beyond the compressor mount manufacturer's control, TransArctic does not warrant design, durability, or operational functionality of any compressor mount improperly installed by another party.

With no implied guarantees it is the mount installer's strict responsibility to determine safety and functionality, of the compressor mount, at the time of installation.

Please contact TransArctic with any issue arising from installation so we may better improve the product. If you have any reservations about the compressor mount integrity contact TransArctic immediately at 1-877-COLD-AIR.

Mark OEM tensioner location

Install Kit

Check for Interferences

Check to ensure that the proper OEM tensioner orientation is maintained

Run engine with A/C system engaged for at least 10 minutes to run in belt

Check OEM tensioner orientation and adjust as required

Responsabilidad limitada de TransArctic en la instalación del soporte del compresor

Todos los soportes de los compresores deben ser instalados por personas calificadas y entrenadas, usando para ello los equipos y herramientas necesarios para esta labor en buenas condiciones y según las normas y guías para el servicio y/o reparación de motores de vehículos.

El instalador de los soportes comprados en TransArctic asume toda la responsabilidad de cualquier problema que surga en el soporte del compresor al vehículo; de igual manera es responsable que el cable a tierra sea conectado entre el embrague del compresor y el motor del vehículo.

Se advierte que el buen funcionamiento y la durabilidad del soporte pueden ser comprometidos por defectos en su instalación.

Debido a las diversas situaciones que se puedan presentar fuera del control del fabricante, TransArctic no garantiza el diseño, la durabilidad o el correcto funcionamiento de cualquier equipo inapropiadamente instalado por terceros.

Esta sobreentendido que el Instalador del montaje del compresor es estrictamente responsable de la seguridad y funcionamiento del equipo en el momento de la instalación.

Si tuviera algún problema o duda acerca de la instalación del soporte del compresor pongase en contacto inmediatamente con TransArctic al teléfono 1-877-COLD-AIR de modo que podamos mejorar nuestro producto.

Note la ubicación del medidor de tensión OEM

Instale el equipo

Controlar si hay interferencias.

Asegurese que el medidor de tensión mantenga la orientación justa.

Encienda el motor por lo menos 10 minutos con el sistema A/C enganchado para que la correa corra

Controle la orientación justa del medidor de tensión y ajuste a las condiciones requeridas del fabricante