

# Bill of Materials Listing

TransArctic Canada Inc.

10/4/2017  
Page 1 of 1

Product Number	Description	Date	Weight	Uof M	Yield
Line    Component    Prod#	Description	Bin                    Unit	Qty		
<b>KMC46694</b>	<b>Mt Kit, ISL-G, HDX, TM-55/65, ALT,'16</b>		<b>1/12/2017</b>	<b>199.07</b>	<b>0</b>
10	BEL32389		Belt, Banded B gr, 2388mm (94")	each	1
20	BMC83125		Bkt, Weldm't, Adapter PI, ISL, HDX, '13	each	1
30	BMC83129		Bkt, Weldm't, Main Base, ISL, HDX, '13	each	1
40	BMC90022		Bkt, Main, Idler, Weldm't, ISL, HDX, '16	each	1
45	BMC90026		Bkt, Alignm't Bar, Add-On, ISL, HDX, '17	each	1
50	KCB65501		Kit, Compressor, P/S, Alt, TM-65/55, '16	each	1
60	KPC90009		Kit, Pulley, ISL-G, 8.9L, 2B/X,'17	each	1
70	PUA05001		Pulley, Assy, Idler, B/S, 5", Stl, Plt	each	1
80	PUA05012		Pulley, Assy, Idler,B/BX gr,5", STL,Plt	each	1
85	SCD16012		Spacer, Col, Drl,16 mm x 34.9o x 12.3i	each	1
95	SCD21912		Spacer, Col, Drl,21.9mm x 25.4o x 12.3i	each	1
100	SLV17012		Sleeve, Pulley, 16.9o x 22.23mm x 12.32i	each	2
110	KBC44195		Bag Kit,Fasteners,KMC44195 & Others.	each	1

# Bill of Materials Listing

TransArctic Canada Inc.

10/4/2017  
Page 1 of 1

Product Number		Description	Bin	Date	Weight	Uof M	Yield
Line	Component Prod#	Description		Unit	Qty		
<b>KBC44195</b>		<b>Bag Kit, Fasteners, KMC44195 &amp; Others.</b>		<b>6/1/2016</b>	<b>2.41</b>		<b>0</b>
10	BTC10045	Bolt, Hex, 10 x 1.5 x 45mm, 10.9, Plt, FT		each	3		
20	BTC12080	Bolt, Hex, 12 x 1.75 x 80mm, 10.9, Plt, FT		each	2		
30	BTQ06175	Bolt, Hex, 3/8-16unc, 1.75", 8, Plt		each	5		
40	BTQ08125	Bolt, Hex, 1/2-13unc, 1.25", 8, Plt		each	2		
50	BTQ08151	Bolt, Hex, 1/2-20unf, 1.5", 8, Plt		each	2		
60	CSF08031	Capscrew, FH, 8 x 1.25 x 30mm, 10.9, Plt		each	2		
70	CSF08101	Capscrew, FH, 1/2-20unf x 1.0", Alloy, Plt		each	4		
80	NTA10000	Nut, Hex, 10 x 1.5, 8.8, Plt		each	3		
90	NTA12000	Nut, Hex, 12 x 1.75, 8.8, Plt		each	2		
100	NTQ06000	Nut, Hex, 3/8-16unc, 8, Plt		each	5		
110	WFA10002	Washer, Flat, 10mm, Hvy, 8.8, Plt		each	6		
120	WFA12002	Washer, Flat, 12mm, Hvy, 8.8, Plt		each	2		
130	WFQ08000	Washer, Flat, 1/2", 8, Plt		each	4		
150	WFS06002	Washer, Flat, 3/8", L9, Plt		each	10		
160	WLA10000	Washer, Lock, 10mm, 8.8, Plt		each	3		
170	WLA12000	Washer, Lock, 12mm, 8.8, Plt		each	2		
180	WLQ06000	Washer, Lock, 3/8", 8, Plt		each	5		
190	WLQ08000	Washer, Lock, 1/2", 8, Plt		each	4		

# Bill of Materials Listing

TransArctic Canada Inc.

2/4/2022  
Page 1 of 1

Product Number	Date	Description		Uof M	Weight	Yield	
Line	Qty	Component Prod#	Rev#	Description	Bin	Unit	
<b>KCB65501</b>	<b>08/10/16</b>	<b>2</b>		<b>Kit, Compressor, P/S, Alt, TM-65/55, '16</b>		<b>166.11</b>	<b>0</b>
10	2	BMN80008		1 Vibration Isolator, Bar, 16.50 x 2 x 1.50		each	
20	1	BMN80025		0 Bkt, Back, PL, Slide, IC, RE300		each	
30	1	BMZ00043		3 Bkt, Main, Base Pl, '13		each	
40	1	BTP08653		Bolt, Hex, 1/2-13unc, 6.5", 5, Plt, FT		each	
50	3	BTQ08101		Bolt, Hex, 1/2-20unf, 1.00", 8, Plt		each	
60	3	CSF08076		Capscrew, FH, 1/2-20unf x .75", Alloy, Plt		each	
70	1	KAC65501		3 Kit, Alternator, TM-65, Curb Side, '13		each	
80	1	KBT65501		0 Kit, Platform, P/S, TM-55/65, '16		each	
90	3	WFQ08000		Washer, Flat, 1/2", 8, Plt		each	
100	4	WLQ08000		Washer, Lock, 1/2", 8, Plt		each	

# Bill of Materials Listing

TransArctic Canada Inc.

2/4/2022  
Page 1 of 1

Product Number	Date	Description		Uof M	Weight	Yield	
Line	Qty	Component Prod#	Rev#	Description	Bin	Unit	
<b>KAC65501</b>	<b>08/10/16</b>		<b>3</b>	<b>Kit, Alternator, TM-65, Curb Side, '13</b>		<b>45.31</b>	<b>0</b>
10	2	BEL11040		Belt, A gr, 1040mm (41")		each	
20	1	BMC90020	A	Bkt, Alt, Weldm't, Curb Side, TM65/55, '16		each	
30	2	BMT10011	0	Bkt, Tenr, Block, Offset, 3mm		each	
40	1	PUL03321	1	Pulley, ALT, Idler, 3.25"d, 2A		each	
45	1	KBA84064	0	Bag Kit, ALT Shim, KC84064, KAC65501/02		each	
47	1	SCD05513	0	Spacer, Col, Drl, 5.51mm x 25.4o x12.7i	Alley	each	
50	1	TRD08080		Threaded, Rod, 1/2-13unc x 8", 5, Plt		each	
60	1	KBA65501	0	Bag Kit, Fasteners, KAC65501		each	

**NOTE:**

1) Use KBA84064 "Shim bag kit", as required, to align the Alternator correctly.

# Bill of Materials Listing

TransArctic Canada Inc.

2/4/2022  
Page 1 of 1

Product Number	Date	Description		Uof M	Weight	Yield			
Line	Qty	Component	Prod#	Rev#	Description	Bin	Unit	Weight	Yield
<b>KBA65501</b>	<b>08/10/16</b>	<b>0</b>	<b>Bag Kit, Fasteners, KAC65501</b>					<b>1.45</b>	<b>0</b>
10	4	BTC12035			Bolt, Hex, 12 x 1.75 x 35mm, 10.9,Plt,FT		each		
20	1	BTQ08125			Bolt, Hex, 1/2-13unc, 1.25", 8, Plt		each		
30	1	BTQ08150			Bolt, Hex, 1/2-13unc, 1.5", 8, Plt		each		
40	1	BTQ08653			Bolt, Hex, 1/2-13unc, 6.5", 8, Plt		each		
50	6	NTQ08000			Nut, Hex, 1/2-13unc, 8, Plt		each		
60	4	WFA12000			Washer, Flat, 12mm, 8.8, Plt		each		
70	3	WFQ08000			Washer, Flat, 1/2", 8, Plt		each		
80	4	WLA12000			Washer, Lock, 12mm, 8.8, Plt		each		
90	4	WLQ08000			Washer, Lock, 1/2", 8, Plt		each		

# Bill of Materials Listing

TransArctic Canada Inc.

2/4/2022  
Page 1 of 1

Product Number	Date	Description		Uof M	Weight	Yield			
Line	Qty	Component	Prod#	Rev#	Description	Bin	Unit	Weight	Yield
<b>KBA84064</b>			<b>10/19/21</b>	<b>0</b>	<b>Bag Kit, ALT Shim, KC84064, KAC65501/02</b>			<b>0.09</b>	<b>0</b>
10	1	SCD03613		0	Spacer, Col, Drl, 3.56mm x 25.4o x12.7i	Alley	each		
20	2	WFA14000			Washer, Flat, 14mm, 8.8, Plt		each		
30	2	WFQ08000			Washer, Flat, 1/2", 8, Plt		each		

**NOTE:**

1) Use (1) SCD03613, (2) WFA14000, (2) WFQ08000, in any arrg'mt/qtys as required to align the Alternator correctly.

# Bill of Materials Listing

TransArctic Canada Inc.

10/3/2017  
Page 1 of 1

Product Number	Description	Date	Weight	Uof M	Yield
Line    Component    Prod#    Description	Bin	Unit	Qty		
<b>KBT65501</b>	<b>Kit, Platform, P/S, TM-55/65, '16</b>	<b>8/10/2016</b>	<b>16.08</b>		<b>0</b>
10 BMN80031	Bkt, Main, Slide, Assy, 05K, IC, RE300	each	1		
20 BMZ00056	Bkt, Comp, FRT, Z, TM-65/55, '13	each	1		
30 BMZ00057	Bkt, Comp, Rear, Z, TM-65/55, '13	each	1		
40 KBZ65501	Bag Kit, Fasteners, KBT65501	each	1		

# Bill of Materials Listing

TransArctic Canada Inc.

10/3/2017  
Page 1 of 1

Product Number	Description	Date	Weight	Uof M	Yield
Line    Component    Prod#	Description	Bin            Unit	Qty		
<b>KBZ65501</b>	<b>Bag Kit, Fasteners, KBT65501</b>		<b>8/10/2016</b>	<b>0.69</b>	<b>0</b>
10	BTC12035		Bolt, Hex, 12 x 1.75 x 35mm, 10.9,Plt,FT	each	4
20	NTP07000		Nut, Hex, 7/16-14unc, 5, Plt	each	4
30	WFA12000		Washer, Flat, 12mm, 8.8, Plt	each	4
40	WFN07000		Washer, Flat, 7/16", 2, Plt	each	4
50	WLA12000		Washer, Lock, 12mm, 8.8, Plt	each	4
60	WLQ07000		Washer, Lock, 7/16", 8, Plt	each	4



# Bill of Materials Listing

TransArctic Canada Inc.

4/27/2017  
Page 1 of 1

Product Number		Description	Bin	Date	Weight	Uof M	Yield
Line	Component Prod#	Description		Unit	Qty		
<b>KPC90009</b>		<b>Kit, Pulley, ISL-G, 8.9L, 2B/X,'17</b>		<b>10/15/2013</b>	<b>16.32</b>		<b>0</b>
10	PUL90009	Pulley, Crank, ISL-G, 9.0L, 2B/X, 8", '17		each	1		
20	BTC12080	Bolt, Hex, 12 x 1.75 x 80mm, 10.9,Plt,FT		each	4		
30	WFS12002	Washer, Flat, Hdn, 12mm, Stl, BLK		each	4		

8 7 6 5 4 3 2 1

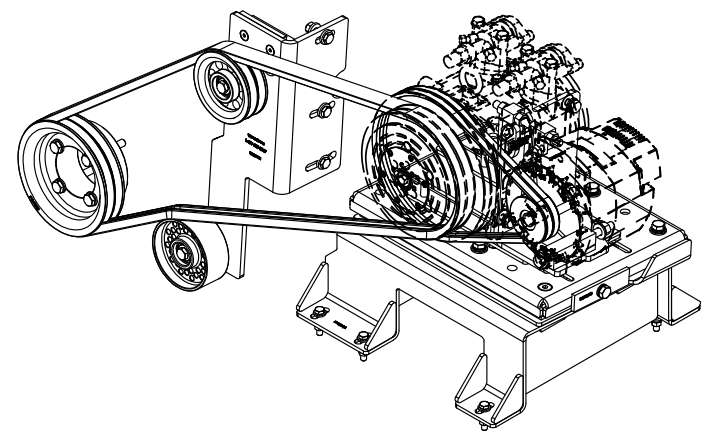
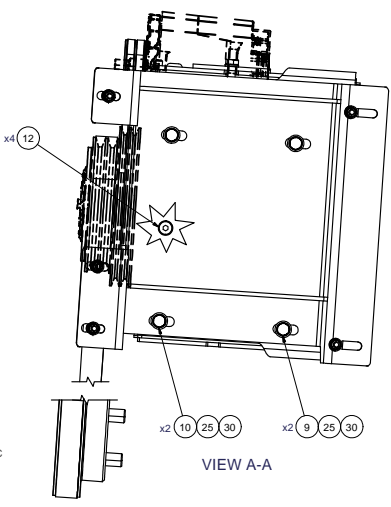
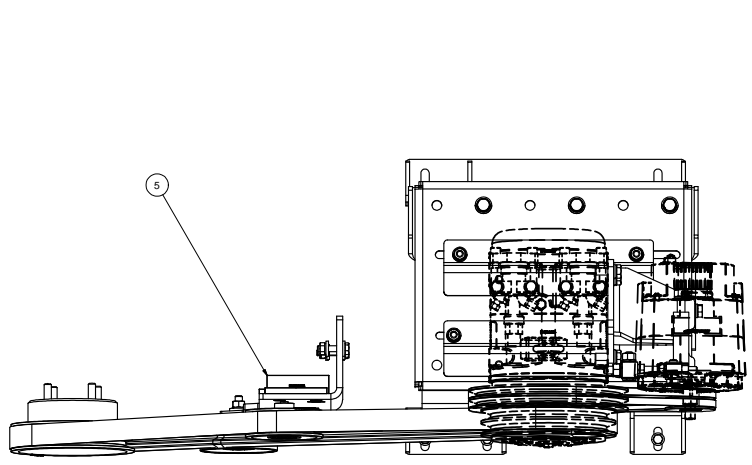

ISOMETRIC VIEW

NOTE:  
SHOWING TRANSARTIC  
COMPRESSOR PART#  
CMV33644 (TM-55)  
CMV38844 (TM-65)  
AS REFERENCE.

NOTE:  
SHOWING ALTERNATOR  
AS REFERENCE.

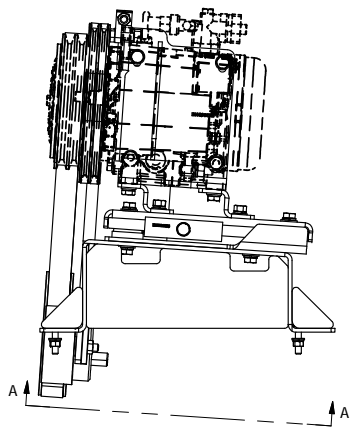
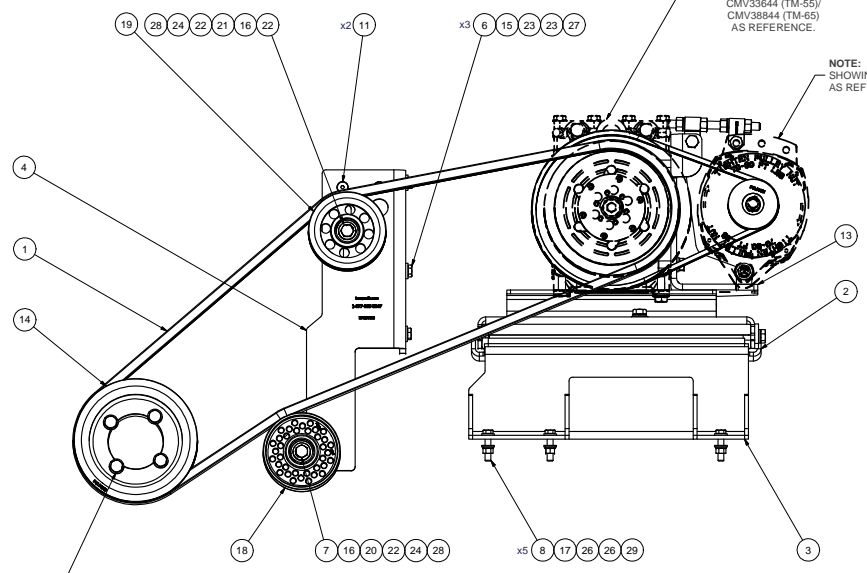

NOTE:  
TORQUE TO: 66-73 FT-LB PLAIN & LUBRICATED W/ CLEAN ENGINE OIL (15W-40)  
(HEXBOLT CAPSCREW M12 x 1.75 x 80mm @ 10.9 GRADE)  
TIGHTEN IN TWO STEPS IN A CRIS-CROSS TIGHTENING SEQUENCE PATTERN.

NOTES:

- 1) USE SERVICABLE THREADLOCKER ON ALL FASTENERS TO ENGINE COMPONENTS AND TORQUE ALL BOLTS TO S.A.E. SPECIFICATIONS.
- 2) SEE "TRANSARTIC A/C COMPRESSOR MOUNT INSTALLATION DISCLAIMER".

ITEM	QTY	U/M	PART NUMBER	DESCRIPTION
30	4	EACH	WLO8000	WASHER, LOCK, 1/2", 8, PLT
29	5	EACH	WLO8000	WASHER, LOCK, 3/8", 8, PLT
28	2	EACH	WL12000	WASHER, LOCK, 12mm, 8.8, PLT
27	3	EACH	WL10000	WASHER, LOCK, 10mm, 8.8, PLT
26	10	EACH	WFS06002	WASHER, FLAT, 3/8", L9, PLT
25	4	EACH	WFO8000	WASHER, FLAT, 1/2", 8, PLT
24	2	EACH	WFA12002	WASHER, FLAT, 12mm, HVY, 8.8, PLT
23	6	EACH	WFA10002	WASHER, FLAT, 10mm, HVY, 8.8, PLT
22	2	EACH	SLV17012	SLEEVE, PULLEY, 16.90 x 22.23 mm x12.19l
21	1	EACH	SCD21912	SPACER, COL, DRL, 21.9mm x 31.80 x 12.0l
20	1	EACH	SCD16012	SPACER, COL, DRL, 16 mm x 31.80 x 12.0l
19	1	EACH	PLUA05012	PULLEY, ASSY, IDLER, B/BX, 5", STL, PLT
18	1	EACH	PLUA05001	PULLEY, ASSY, IDLER, B/S, 5", STL, PLT
17	5	EACH	NTQ06000	NUT, HEX, 3/8-16UNC, 8, PLT
16	2	EACH	NTA12000	NUT, HEX, 12 x 1.75, 8.8, PLT
15	3	EACH	NTA10000	NUT, HEX, 10 x 1.5, 8.8, PLT
14	1	EACH	KPC90009	KIT, PULLEY, ISL-G, 8.9L, 2B/X, '17
13	1	EACH	KCB65501	KIT, COMPRESSOR, P/S, ALT, TM-65/55, '16
12	4	EACH	CSF08101	CAPSCREW, FH, 1/2-20UNF x 1", ALLOY, PLT
11	2	EACH	CSF08031	CAPSCREW, FH, 8 x 1.25 x 30mm, 10.9, PLT
10	2	EACH	BTQ08151	BOLT, HEX, 1/2-20UNF x 1.50, 8, PLT
9	2	EACH	BTQ08125	BOLT, HEX, 1/2-13UNC x 1.25, 8, PLT
8	5	EACH	BTQ06175	BOLT, HEX, 3/8-16UNC, 1.75", 8, PLT
7	2	EACH	BTC12080	BOLT, HEX, 12 x 1.75 x 80mm, 10.9, PLT
6	3	EACH	BTC10045	BOLT, HEX, 10 x 1.5 x 45mm, 10.9, PLT
5	1	EACH	BMC90026	BKT, ALIGNMT BAR, ADD-ON, ISL-G, HDX, '17
4	1	EACH	BMC90022	BKT, MAIN, IDLER, WELDMT, ISL, HDX, '16
3	1	EACH	BMC83129	BKT, WELDMT, MAIN BASE, ISL, HDX, '13
2	1	EACH	BMC83125	BKT, WELDMT, ADAPTER PL, ISL, HDX, '13
1	1	EACH	BEL32388	BELT, BANDED B gr, 2388mm ('94)

BILL OF MATERIALS

BROWN	10/2/2017	
Checked		
RELEASED TO PRODUCTION	10/2/2017	JRK
REVIEWED		
BY:		GA
BY:		Jrmas Stewart
APPROVED	10/2/2017	
APPROVED		
DATE		
DATE		
DATE		

**TRANSARTIC INC.**

TITLE

MT KIT, ISL-G, HDX, TM-55/65, ALT, '17

SIZE

DWG NO

KMC46694

REV

0

SCALE

1:4

SHEET

1 OF 1

UNSPECIFIED TOLERANCES:

ONE DECIMAL PLACE (X.1)

TWO DECIMAL PLACE (X.00)

THREE DECIMAL PLACE (X.000)

FRACTIONAL (1/16")

ANGULAR (1/2°)

THIRD ANGLE PROJECTION

DRAWING UNIT OF MEASURE: MM (INCH)

8 7 6 5 4 3 2 1

**TOP VIEW**

PARTS REMOVED FOR CLARITY.

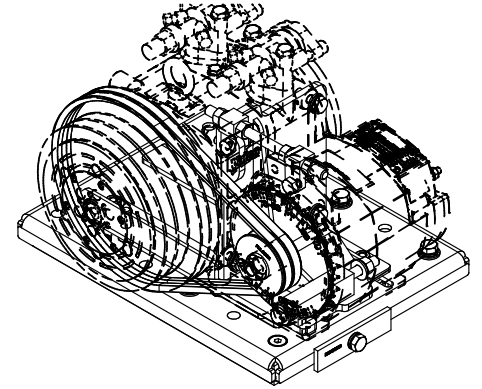
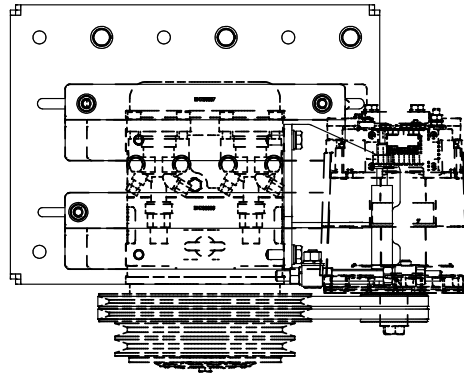
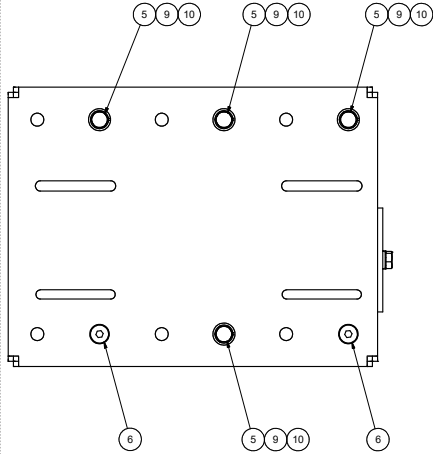

ISOMETRIC VIEW

NOTE:  
SHOWING TRANSARCTIC  
COMPRESSOR PART#  
CMV33644 (TM-55)  
CMV33844 (TM-65)  
AS REFERENCE.

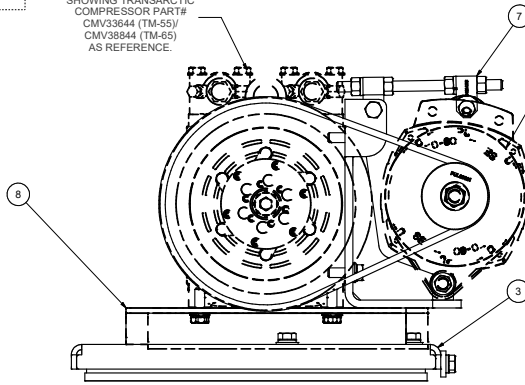

NOTE:  
SHOWING ALTERNATOR  
AS REFERENCE.

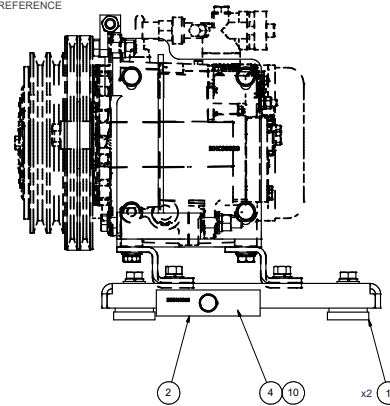

NOTES:

- 1) USE SERVICABLE THREADLOCKER ON ALL FASTENERS TO ENGINE COMPONENTS AND TORQUE **ALL** BOLTS TO S.A.E. SPECIFICATIONS.
- 2) SEE 'TRANSARCTIC A/C COMPRESSOR MOUNT INSTALLATION DISCLAIMER'.
- 3) WEIGHT: 68.75 LBS.

ITEM	QTY	U/M	PART NUMBER	DESCRIPTION
10	5	EACH	IWLQ08000	WASHER, LOCK, 1/2", 8, PLT
9	4	EACH	WFC08000	WASHER, FLAT, 1/2", 8, PLT
8	1	EACH	KBT65501	KIT, PLATFORM, P/S, TM-55/65, '16
7	1	EACH	KAC65501	KIT, ALTERNATOR, TM-65, CURB SIDE, '13
6	2	EACH	CSF08076	CAPSCREW, FH, 1/2-20UNF x .75", ALLOY, PLT
5	4	EACH	BTQ08101	BOLT, HEX, 1/2-20UNF x 1.00, 8, PLT
4	1	EACH	BTP08653	BOLT, HEX, 1/2-13UNC x 6.50, 5, PLT, FT
3	1	EACH	BMZ00043	BKT, MAIN, BASE PL, '13
2	1	EACH	BMN80025	BKT, BACK, PL, SLIDE, IC, RE300
1	2	EACH	BMN80008	VIBRATION ISOLATOR, BAR, 16.50 x 2 x 1.50

DRAWN				CHECKED				TITLE			
vjakowlew				8/3/2016				TRANSARCTIC INC.			
0				RELEASED TO PRODUCTION				8/3/2016			
REV				ECN				DESCRIPTION			
1				REVISED KAC65501				11/2/2016			
0				RELEASED TO PRODUCTION				8/3/2016			
REV				ECN				DATE			
1				BY: James Stewart				8/3/2016			
APPROVED				BY: James Stewart				8/3/2016			
APPROVED				BY: Dale Mason				8/3/2016			
UNSPECIFIED TOLERANCES:				ALL DIMS				DWG NO			
ONE DECIMAL PLACE (.X)				.005				KCB65501			
TWO DECIMAL PLACE (.XX)				.002				REV			
THREE DECIMAL PLACE (.XXX)				.001				1			
FRACTIONAL (X/16)				.0005				SCALE			
FRACTIONAL (X/32)				.0002				1:3			
FRACTIONAL (X/64)				.0001				SHEET			
THIRD ANGLE PROJECTION				DRAWING UNIT OF MEASURE				1			
				MM (INCH)				1			
				SCALE				1			
				1:3				1			
				SHEET				1			
				1				1			
				OF				1			

REV	ECN	DESCRIPTION	DATE	BY
1		REVISED KAC65501	11/2/2016	JRR
0		RELEASED TO PRODUCTION	8/3/2016	JRR



DRAWING UNIT OF MEASURE: MM (INCH)

SCALE: 1:3

SHEET 1 OF 1

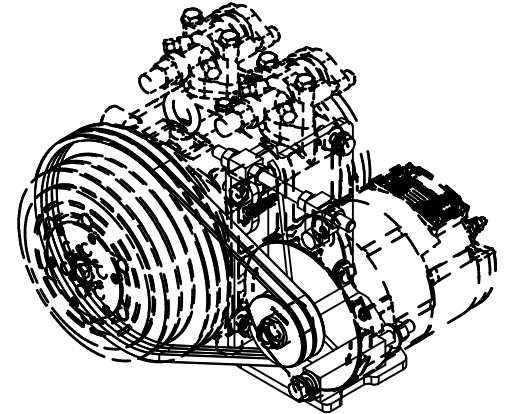
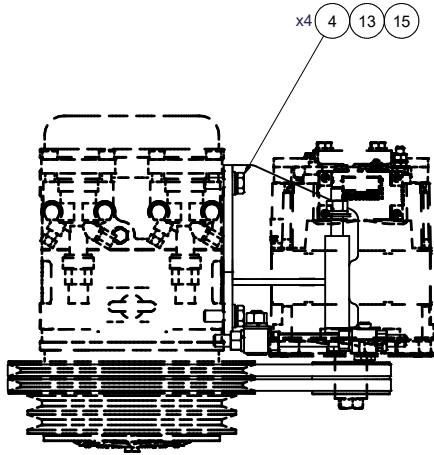

ISOMETRIC VIEW

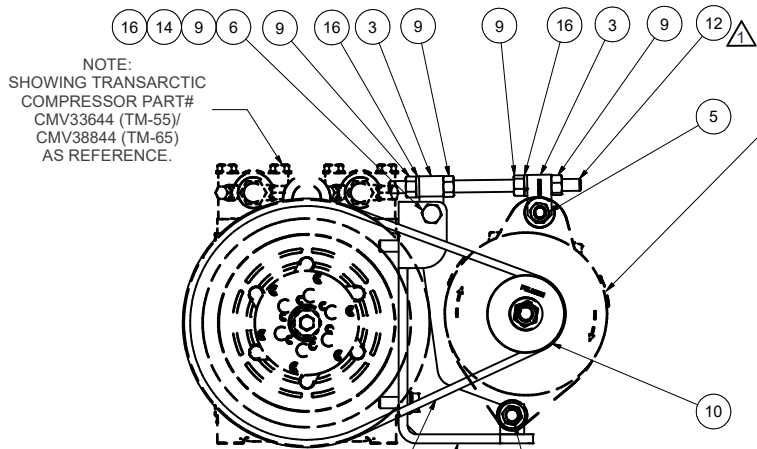

NOTE:  
SHOWING TRANSARCTIC  
COMPRESSOR PART#  
CMV33644 (TM-55/  
CMV38844 (TM-65)  
AS REFERENCE.

NOTE:  
SHOWING ALTERNATOR  
AS REFERENCE

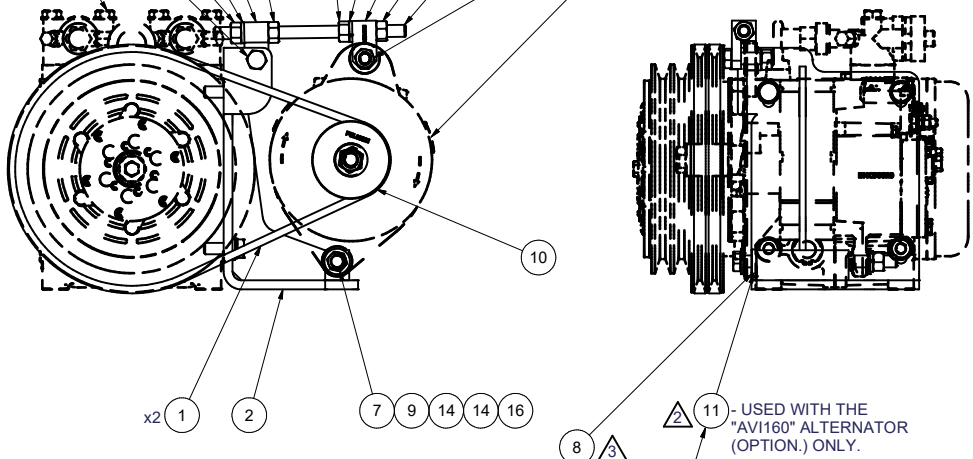

USE KBA84064 SHIM KIT AS REQUIRED  
TO ALIGN ALTERNATOR PULLEY TO  
COMPRESSOR PULLEY "A" GROOVES.

11 - USED WITH THE  
"AVI160" ALTERNATOR  
(OPTION.) ONLY.

- NOTES:  
1) USE SERVICABLE THREADLOCKER ON ALL FASTENERS TO ENGINE COMPONENTS AND TORQUE **ALL** BOLTS TO S.A.E. SPECIFICATIONS.  
2) SEE "TRANSARCTIC A/C COMPRESSOR MOUNT INSTALLATION DISCLAIMER".  
3) WEIGHT: 18.11 LB

16	4	EACH	WLQ08000	WASHER, LOCK, 1/2", 8, PLT
15	4	EACH	WLA12000	WASHER, LOCK, 12mm, 8.8, PLT
14	3	EACH	WFO08000	WASHER, FLAT, 1/2", 8, PLT
13	4	EACH	WFA12000	WASHER, FLAT, 12mm, 8.8, PLT
12	1	EACH	TRD08080	THREADED, ROD, 1/2-13UNC x 8", 5 PLT
11	1	EACH	SCD05513	SPACER, COL, DRL, 5.51mm x 25.4o x 12.7i
10	1	EACH	PUL03321	PULLEY, ALT, IDLER, 3.25"o, 2A
9	6	EACH	NTQ08000	NUT, HEX, 1/2-13UNC, 8, PLT
8	1	EACH	KBA84064	BAG KIT, ALT SHIM, KC84064, KAC65501/02
7	1	EACH	BTQ08653	BOLT, HEX, 1/2-13UNC x 6.50, 8, PLT
6	1	EACH	BTQ08150	BOLT, HEX, 1/2-13UNC x 1.50, 8, PLT
5	1	EACH	BTQ08125	BOLT, HEX, 1/2-13UNC x 1.25, 8, PLT
4	4	EACH	BTC12035	BOLT, HEX, 12 x 1.75 x 35mm, 10.9, PLT
3	2	EACH	BMT10011	BKT, TENR, BLOCK, OFFSET, 3mm
2	1	EACH	BMCS90020	BKT, ALT, WELDM'T, CURB SIDE, TM-65/55, '16
1	2	EACH	BEL11040	BELT, A gr, 1040mm (41")
ITEM	QTY	U/M	PART NUMBER	DESCRIPTION

BILL OF MATERIALS

3	ADDED KBA84064 SHIM BAG KIT.	02/03/2022	VALJ	
2	ADDED SCD05513.	05/11/2021	JRR	
1	WAS TRD08060, NOW TRD08080	10/2/2018	JRR	
0	RELEASED TO PRODUCTION.	8/3/2016	JRR	
REV:	ECN:	DESCRIPTION:	DATE:	BY:
THIS DRAWING CONTAINS PROPRIETARY CONFIDENTIAL INFORMATION OWNED BY TRANSARCTIC CANADA INC. THE DOCUMENT AND THE INFORMATION IN IT ARE NOT TO BE USED, DISCLOSED OR REPRODUCED WITHOUT EXPRESS WRITTEN PERMISSION OF THE COMPANY.				
UNSPECIFIED TOLERANCES: [ALT. DIM.]				
ONE DECIMAL PLACE (X)	MM	(INCH)		
TWO DECIMAL PLACE (XX)	.50	[.005]		
THREE DECIMAL PLACE (XXX)	.25	[.010]		
FRACTIONAL (1/16")	.10	[.005]		
ANGULAR	±.50°			
THIRD ANGLE PROJECTION				
DRAWN		08/03/16		
vjakowlew				
CHECKED				
Jose Rodriguez		08/03/16		
QA				
MFG		8/3/2016		
James Stewart		08/03/16		
APPROVED				
Dale Mason		08/03/16		
DRAWING UNIT OF MEASURE:		MM [INCH]		SIZE C DWG NO KAC65501 SCALE 1:4
				REV 3
SHEET 1 OF 1				

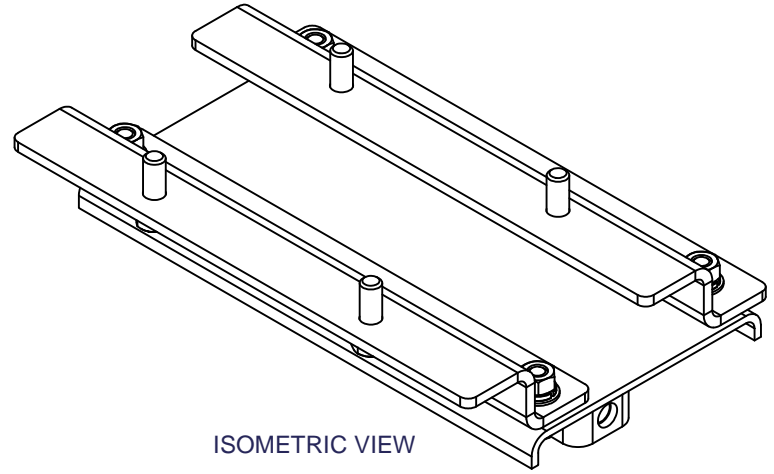
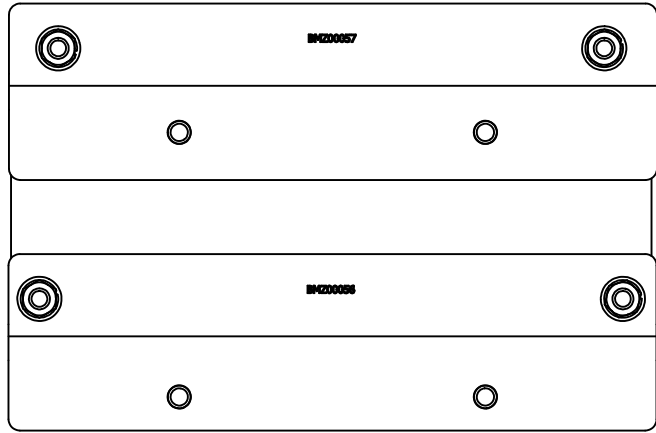

ISOMETRIC VIEW

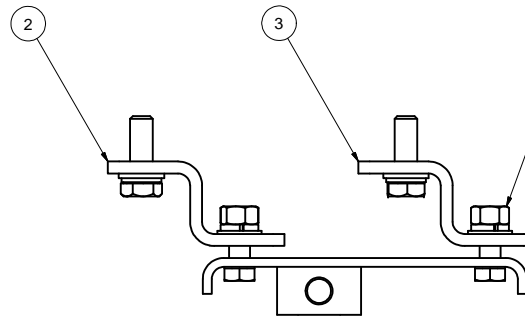
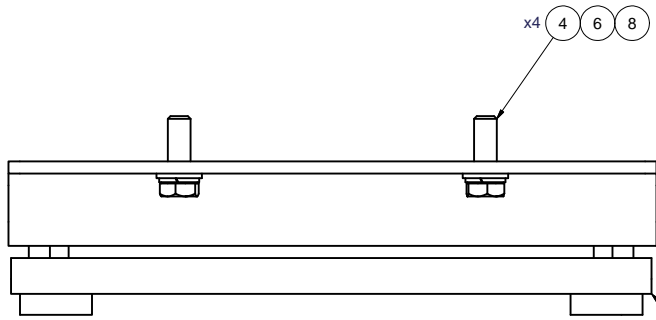

x4 5 7 9

ITEM	QTY	U/M	PART NUMBER	DESCRIPTION
9	4	EACH	WLQ07000	WASHER, LOCK, 7/16", 8, PLT
8	4	EACH	WLA12000	WASHER, LOCK, 12mm, 8.8, PLT
7	4	EACH	WFN07000	WASHER, FLAT, 7/16", 2, PLT
6	4	EACH	WFA12000	WASHER, FLAT, 12mm, 8.8, PLT
5	4	EACH	NTP07000	NUT, HEX, 7/16-14UNC, 5, PLT
4	4	EACH	BTC12035	BOLT, HEX, 12 x 1.75 x 35mm, 10.9, PLT
3	1	EACH	BMZ00057	BKT, COMP, REAR, Z, TM-65/55, '13
2	1	EACH	BMZ00056	BKT, COMP, FRT, Z, TM-65/55, '13
1	1	EACH	BMN80031	BKT, MAIN, SLIDE, ASSY, 05K, IC, RE300

BILL OF MATERIALS

DRAWN	jrodriguez	8/8/2016
CHECKED	Val Jakowlew	8/8/2016
APPROVED	James Stewart	8/8/2016
MFG	James Stewart	8/8/2016
APPROVED	Dale Mason	8/8/2016



TITLE	KIT, PLATFORM, P/S, TM-55/65, '16		
SIZE	C	DWG NO	REV
		KBT65501	0

0	RELEASED TO PRODUCTION	8/8/2016	JRR
REV	ECN	DESCRIPTION	DATE
THIS DRAWING CONTAINS PROPRIETARY CONFIDENTIAL INFORMATION OWNED BY TRANSARCTIC CANADA INC. THE DOCUMENT AND THE INFORMATION IN IT ARE NOT TO BE USED, DISCLOSED OR REPRODUCED WITHOUT EXPRESS WRITTEN PERMISSION OF THE COMPANY.			
UNSPECIFIED TOLERANCES: (ALT. DIM.)			
ONE DECIMAL PLACE (.X)	MM	(.020)	(.001)
TWO DECIMAL PLACE (.XX)	MM	.25	[.010]
THREE DECIMAL PLACE (.XXX)	MM	.10	[.005]
FRACTIONAL +/- .102"	ANGULAR	+/- .50°	
THIRD ANGLE PROJECTION			
DRAWING UNIT OF MEASURE: MM (INCH)			

NOTES:

- 1) USE SERVICABLE THREADLOCKER ON ALL FASTENERS TO ENGINE COMPONENTS AND TORQUE **ALL** BOLTS TO S.A.E. SPECIFICATIONS.
- 2) SEE "TRANSARCTIC A/C COMPRESSOR MOUNT INSTALLATION DISCLAIMER".
- 3) WEIGHT: 16.47 LBS.

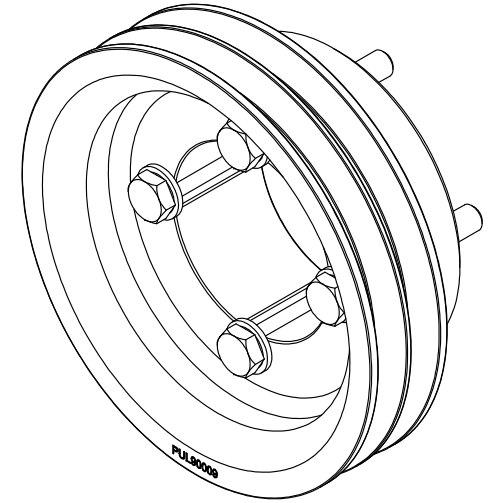
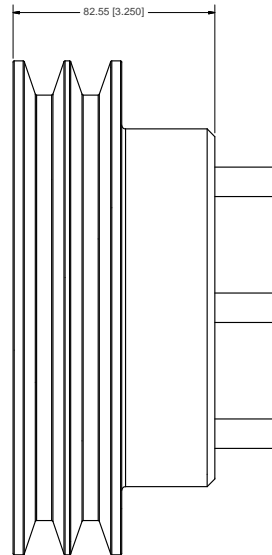
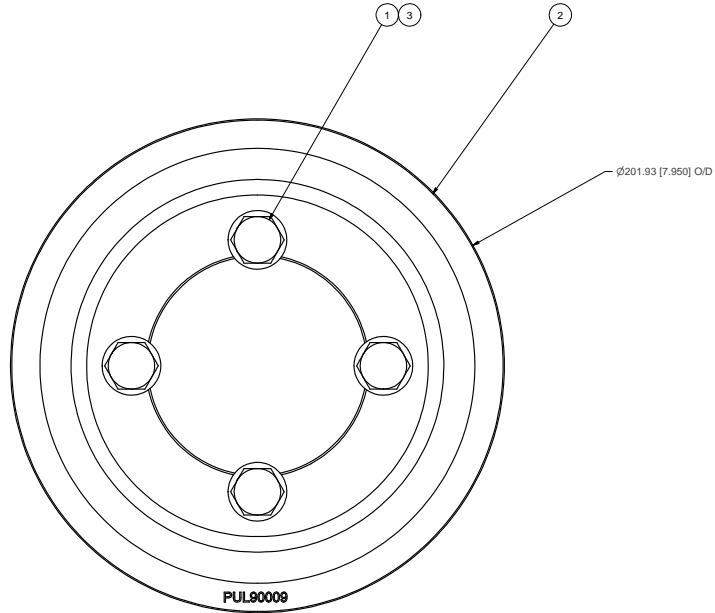

- NOTES:
- 1) USE SERVICABLE THREADLOCKER ON ALL FASTENERS TO ENGINE COMPONENTS AND TORQUE **ALL** BOLTS TO S.A.E. SPECIFICATIONS.
  - 2) SEE "TRANSARCTIC A/C COMPRESSOR MOUNT INSTALLATION DISCLAIMER".
  - 3) WEIGHT: 16.41 LB

ITEM	QTY	U/M	PART NUMBER	DESCRIPTION
3	4	EACH	WFS12002	WASHER, FLAT, HDN, 12mm, STL, BLK
2	1	EACH	PUL90009	PULLEY, CRANK, ISL-G, 8.9L, 2B/X, 8", 17
1	4	EACH	BTCT2080	BOLT, HEX, 12 x 1.75 x 80mm, 10.9, FLT

BILL OF MATERIALS

**TRANSARCTIC INC.**

DRWN	JRodriguez	12/16/2016	TITLE
CHKD	Jose Rodriguez	12/16/2016	
REV	ECN	DESCRIPTION	DATE
		RELEASED TO PRODUCTION	12/16/2016
		BY: Jose Rodriguez	
		DATE: 12/16/2016	
		BY: MFG	
		DATE: 12/16/2016	
		APPROVED	
		DATE: 12/16/2016	
		DATE: 12/16/2016	
UNSPECIFIED TOLERANCES:			MM (INCH)
ONE DECIMAL PLACE (X.0)	±0.10	FRONT	THIRD ANGLE PROJECTION
TWO DECIMAL PLACE (X.00)	±0.02	DRILL	
THREE DECIMAL PLACE (X.000)	±0.002	DRILL	
FRACTIONAL (1/16")	±0.005	ANGULAR	
DRAWING UNIT OF MEASURE:			MM (INCH)
SCALE:			1:1
DWG NO:			KPC90009
REV:			0
SHEET:			1 OF 1



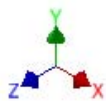
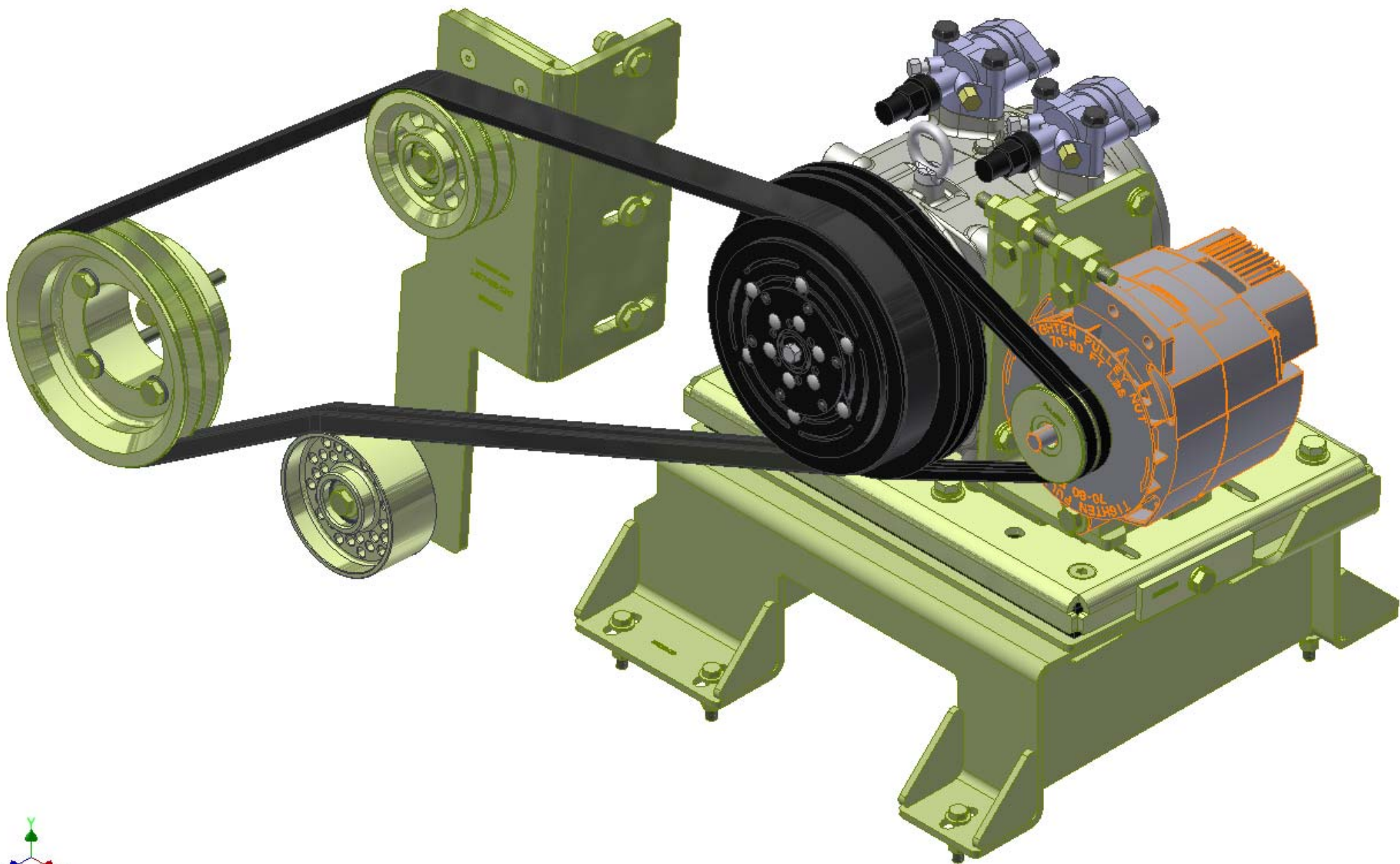

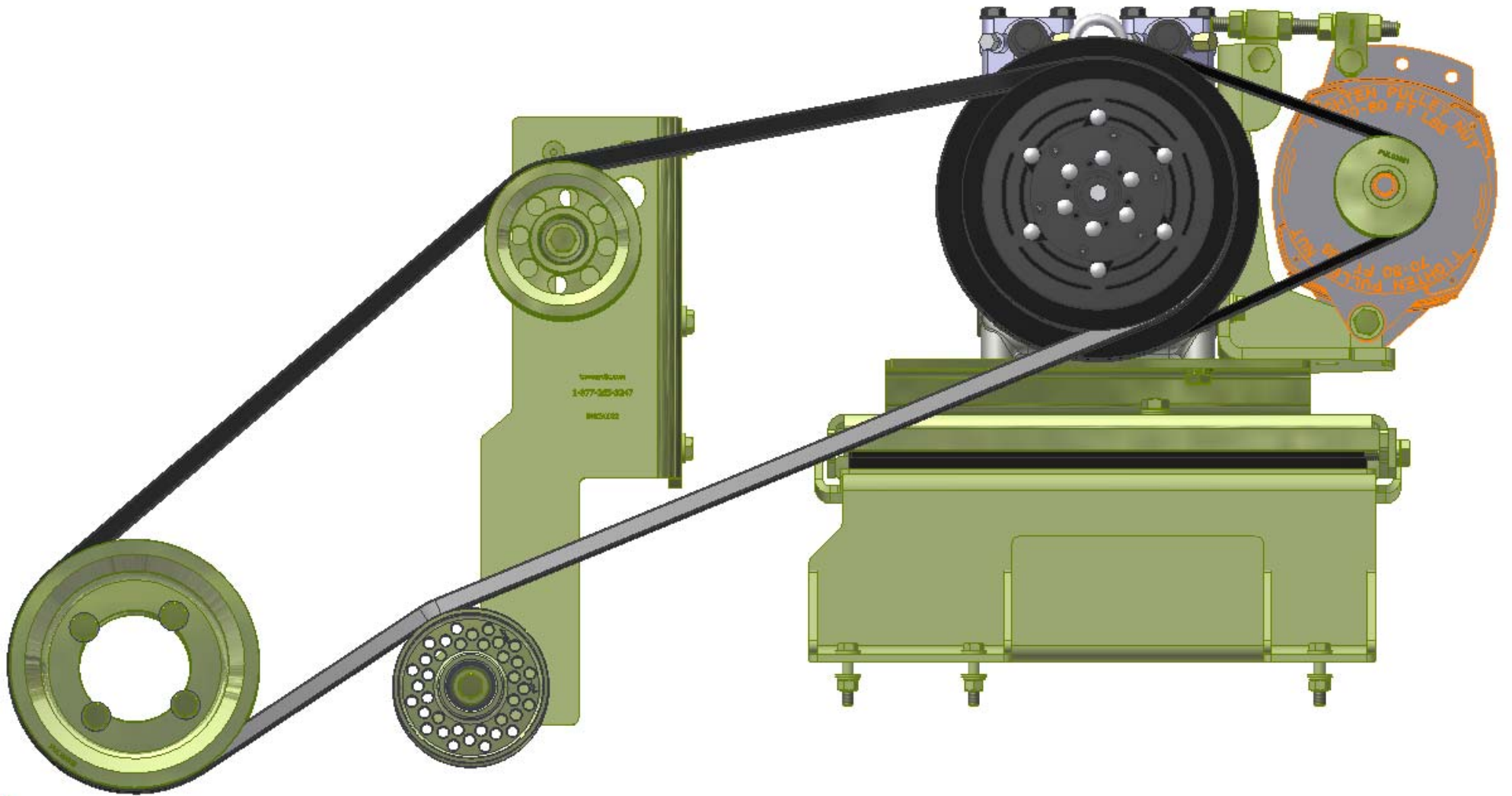



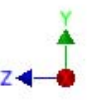
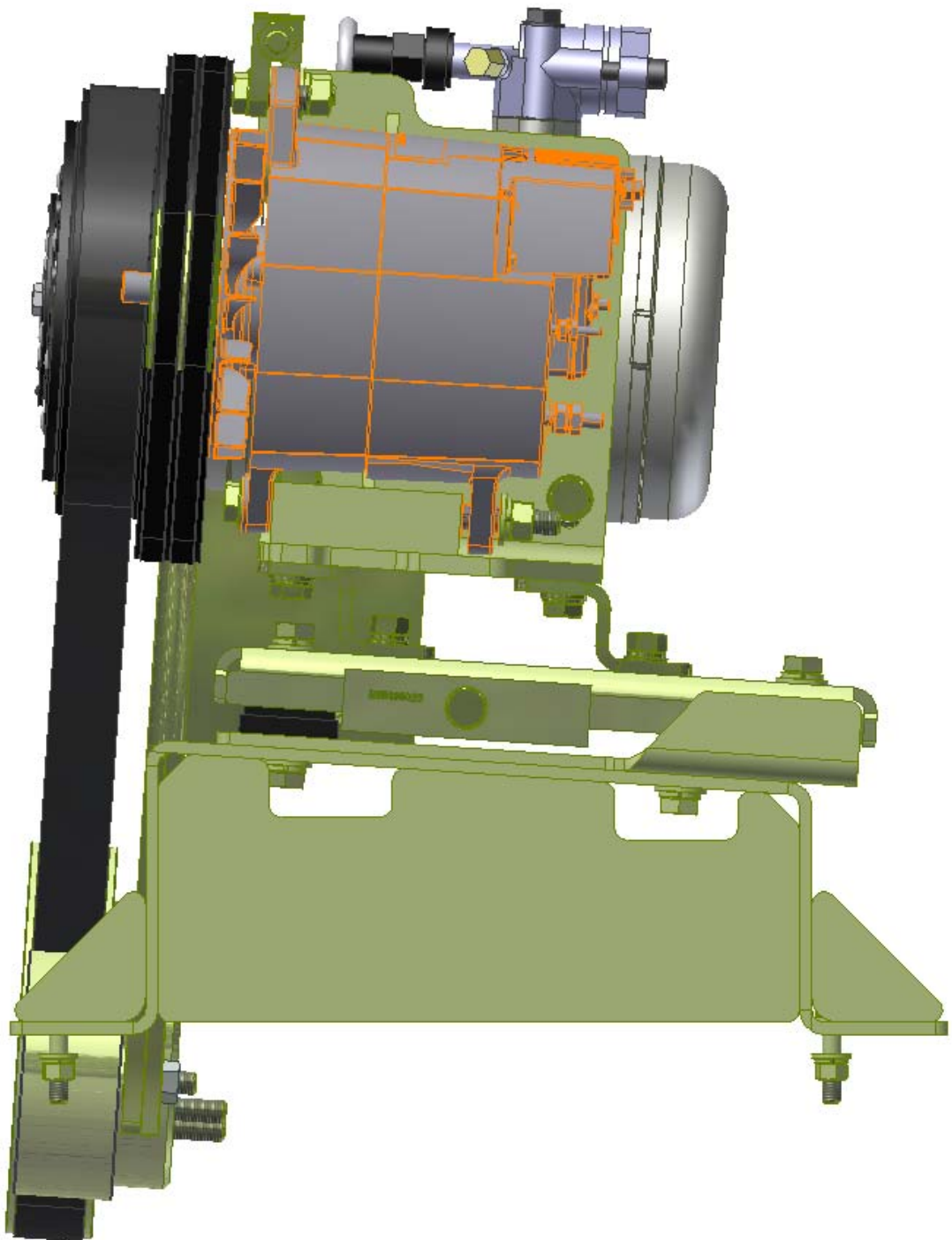

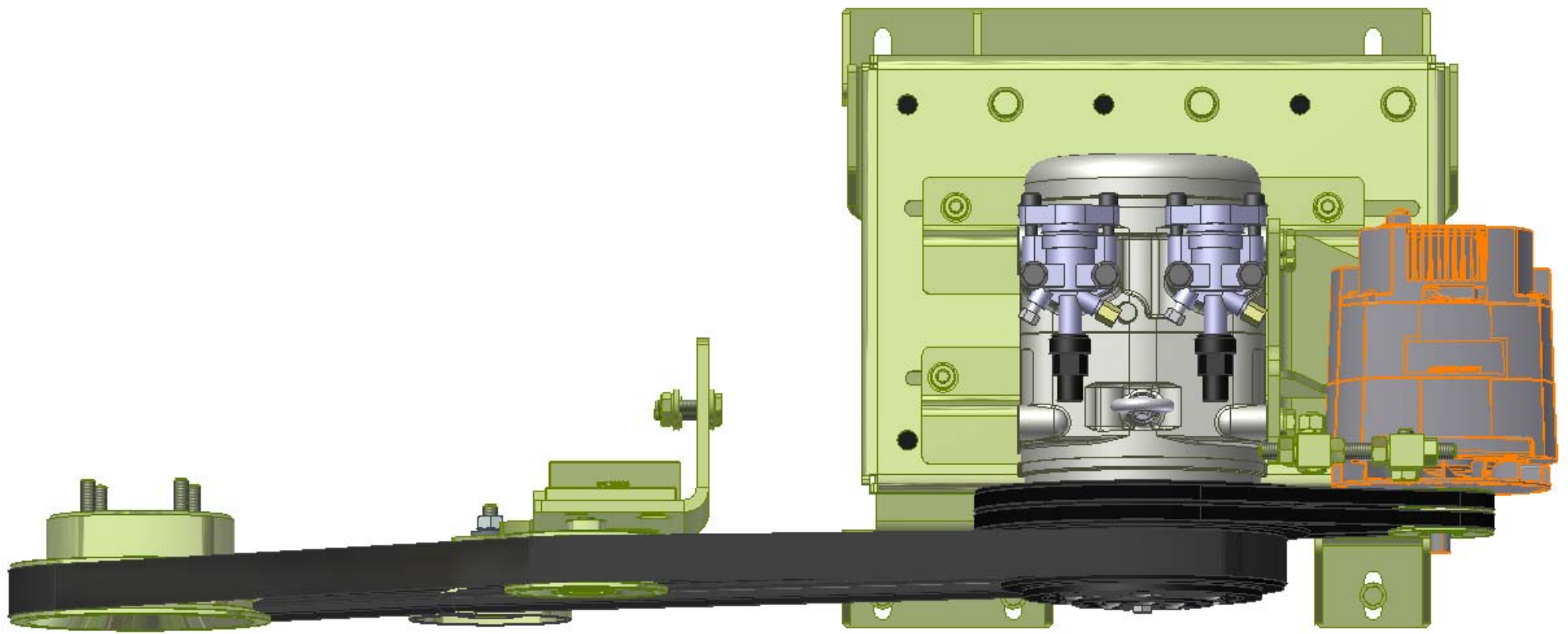

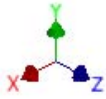
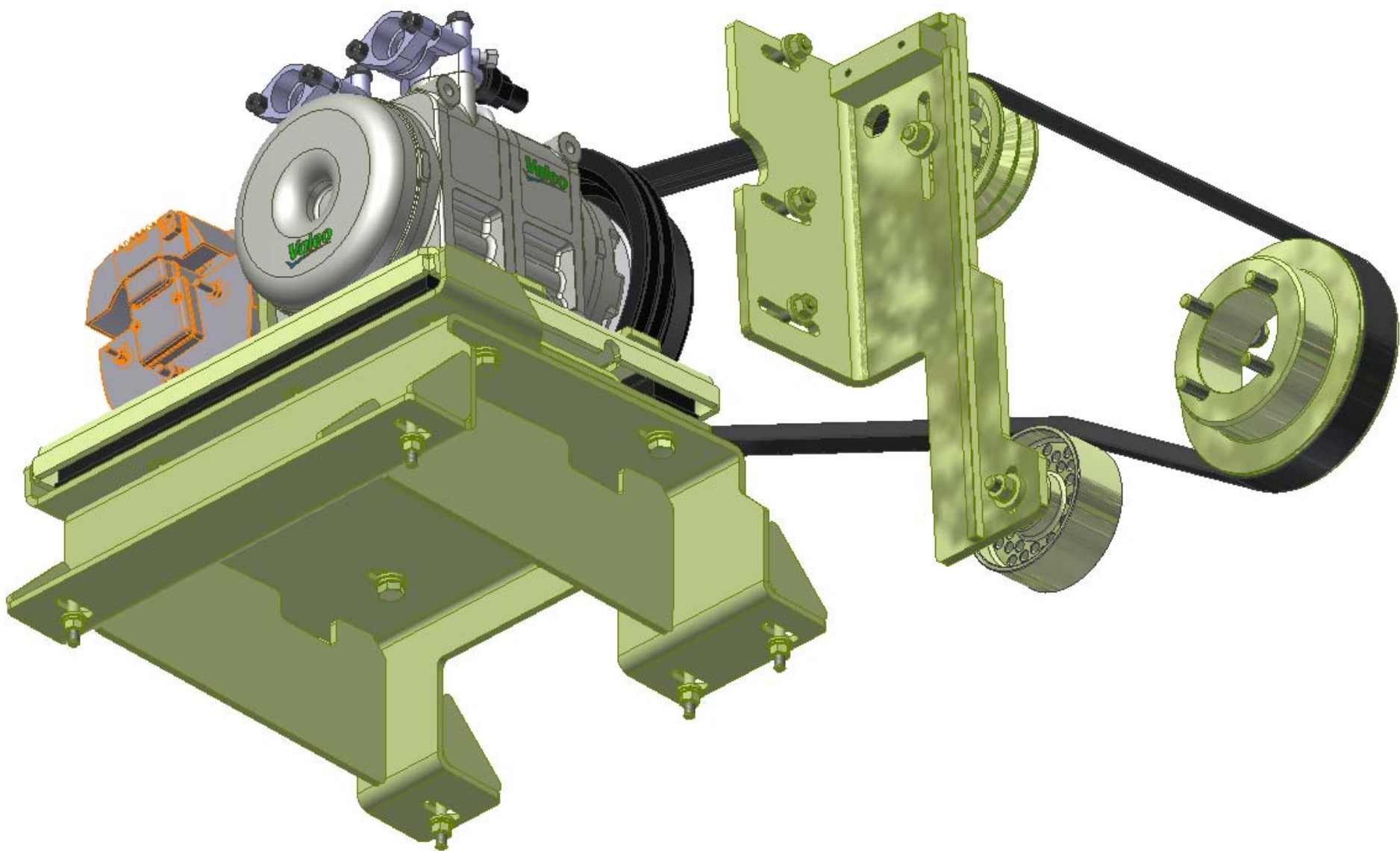

## **TransArctic A/C Compressor Mount Installation Disclaimer**

All compressor mounts should be installed by qualified and trained personnel using proper tools and equipment in safe working conditions following industry standard guidelines for motor vehicle service and repair.

The installer of any compressor mount purchased from TransArctic must undertake all responsibility of issues arising from that compressor bracket being installed on any vehicle. As well as insure that a **proper and sufficient ground** is established between the compressors' clutches and the vehicle's engine. Mount functionality, operation and durability can all be compromised by an incompetent installation.

Due to the many different situations, parameters and application criteria, which are beyond the compressor mount manufacturer's control, TransArctic does not warrant design, durability, or operational functionality of any compressor mount improperly installed by another party.

**With no implied guarantees it is the mount installer's strict responsibility to determine safety and functionality, of the compressor mount, at the time of installation.**

Please contact TransArctic with any issue arising from installation so we may better improve the product. If you have any reservations about the compressor mount integrity contact TransArctic immediately at 1-877-COLD-AIR.

**Mark OEM tensioner location**

**Install Kit**

**Check for Interferences**

**Check to ensure that the proper OEM tensioner orientation is maintained**

**Run engine with A/C system engaged for at least 10 minutes to run in belt**

**Check OEM tensioner orientation and adjust as required**

### **Responsabilidad limitada de TransArctic en la instalación del soporte del compresor**

Todos los soportes de los compresores deben ser instalados por personas calificadas y entrenadas, usando para ello los equipos y herramientas necesarios para esta labor en buenas condiciones y según las normas y guías para el servicio y/o reparación de motores de vehículos.

El instalador de los soportes comprados en TransArctic asume toda la responsabilidad de cualquier problema que surga en el soporte del compresor al vehículo; de igual manera es responsable que el cable a tierra sea conectado entre el embrague del compresor y el motor del vehículo.

Se advierte que el buen funcionamiento y la durabilidad del soporte pueden ser comprometidos por defectos en su instalación.

Debido a las diversas situaciones que se puedan presentar fuera del control del fabricante, TransArctic no garantiza el diseño, la durabilidad o el correcto funcionamiento de cualquier equipo inapropiadamente instalado por terceros.

**Esta sobreentendido que el Instalador del montaje del compresor es estrictamente responsable de la seguridad y funcionamiento del equipo en el momento de la instalación.**

Si tuviera algún problema o duda acerca de la instalación del soporte del compresor pongase en contacto inmediatamente con TransArctic al teléfono 1-877-COLD-AIR de modo que podamos mejorar nuestro producto.

**Note la ubicación del medidor de tensión OEM**

**Instale el equipo**

**Controlar si hay interferencias.**

**Asegure que el medidor de tensión mantenga la orientación justa.**

**Encienda el motor por lo menos 10 minutos con el sistema A/C enganchado para que la correa corra**

**Controle la orientación justa del medidor de tensión y ajuste a las condiciones requeridas del fabricante**