

# Bill of Materials Listing

TransArctic Canada Inc.

6/28/2017  
Page 1 of 1

Product Number	Description	Date	Weight	Uof M	Yield
Line    Component    Prod#	Description	Bin                    Unit	Qty		
<b>KMC63995</b>	<b>Mt Kit, ISB, HDX, 4xFC, '16</b>		<b>4/24/2017</b>	<b>150.30</b>	<b>0</b>
10	BEL32388		Belt, Banded B gr,2388mm (94") (RBX91-2)	each	1
20	BMC83125		Bkt, Weldm't, Adapter PI, ISL, HDX, '13	each	1
30	BMC90012		Bkt, Weldm't, Main Base, HDX, '16'	each	1
40	BMC90022		Bkt, Main, Idler, Weldm't, ISL, HDX, '16	each	1
50	KCB83994		Kit, Compressor, PS, 4xFC, '13	each	1
60	KPC64094		Kit, Pulley, 2B, ISB, 2013	each	1
70	PUA05001		Pulley, Assy, Idler, B/S, 5", Stl, Plt	each	1
80	PUA05012		Pulley, Assy, Idler,B/BX gr,5", STL,Plt	each	1
90	SCD16012		Spacer, Col, Drl,16 mm x 34.9o x 12.3i	each	1
100	SCD21912		Spacer, Col, Drl,21.9mm x 25.4o x 12.3i	each	1
110	SLV17012		Sleeve, Pulley, 16.9o x 22.23mm x 12.32i	each	2
120	KBC94195		Bag Kit, Fasteners,KMC94195 & Others.	each	1

# Bill of Materials Listing

TransArctic Canada Inc.

6/23/2017  
Page 1 of 1

Product Number		Description	Bin	Date	Weight	Uof M	Yield
Line	Component Prod#	Description		Unit	Qty		
<b>KBC94195</b>		<b>Bag Kit, Fasteners,KMC94195 &amp; Others.</b>		<b>6/1/2016</b>	<b>2.36</b>		<b>0</b>
10	BTC10045	Bolt, Hex, 10 x 1.5 x 45mm, 10.9, Plt,FT		each	3		
20	BTC12080	Bolt, Hex, 12 x 1.75 x 80mm, 10.9,Plt,FT		each	2		
30	BTQ06175	Bolt, Hex, 3/8-16unc, 1.75", 8, Plt		each	5		
40	BTQ08125	Bolt, Hex, 1/2-13unc, 1.25", 8, Plt		each	2		
50	BTQ08151	Bolt, Hex, 1/2-20unf, 1.5", 8, Plt		each	2		
55	CSF08101	Capscrew, FH, 1/2-20unf x 1.0",Alloy,Plt		each	4		
60	NTA10000	Nut, Hex, 10 x 1.5, 8.8, Plt		each	3		
70	NTA12000	Nut, Hex, 12 x 1.75, 8.8, Plt		each	2		
80	NTQ06000	Nut, Hex, 3/8-16unc, 8, Plt		each	5		
90	WFA10002	Washer, Flat, 10mm, Hvy, 8.8, Plt		each	6		
100	WFA12002	Washer, Flat, 12mm, Hvy, 8.8, Plt		each	2		
110	WFS08000	Washer, Flat, 1/2", 8, Plt		each	4		
120	WFS06002	Washer, Flat, 3/8", L9, Plt		each	10		
130	WLA10000	Washer, Lock, 10mm, 8.8, Plt		each	3		
140	WLA12000	Washer, Lock, 12mm, 8.8, Plt		each	2		
150	WLQ06000	Washer, Lock, 3/8", 8, Plt		each	5		
160	WLQ08000	Washer, Lock, 1/2", 8, Plt		each	4		

# Bill of Materials Listing

TransArctic Canada Inc.

6/28/2017  
Page 1 of 1

Product Number	Description	Date	Weight	Uof M	Yield
Line    Component    Prod#	Description	Bin                    Unit	Qty		
<b>KCB83994</b>	<b>Kit, Compressor, PS, 4xFC, '13</b>		<b>11/14/2013</b>	<b>54.71</b>	<b>0</b>
10	BMN80008		Vibration Isolator, Bar,16.50 x 2 x 1.50	each	2
20	BMN80025		Bkt, Back, PL, Slide, IC, RE300	each	1
30	BMZ00043		Bkt, Main, Base Pl, '13	each	1
40	KBT83990		Kit, Platform, 4xFCY, '12	each	1
50	KBZ83994		Bag Kit, Fasteners, KCB83994	each	1

# Bill of Materials Listing

TransArctic Canada Inc.

4/26/2017

Page 1 of 1

Product Number		Description	Bin	Date	Weight	Uof M	Yield
Line	Component Prod#	Description		Unit	Qty		
<b>KBZ83994</b>		<b>Bag Kit, Fasteners, KCB83994</b>		<b>11/14/2013</b>	<b>1.06</b>		<b>0</b>
10	BTP08653	Bolt, Hex, 1/2-13unc, 6.5", 5, Plt, FT		each	1		
20	BTQ08101	Bolt, Hex, 1/2-20unf, 1.00", 8, Plt		each	4		
30	CSF08076	Capscrew, FH, 1/2-20unf x .75",Alloy,Plt		each	2		
40	WFQ08000	Washer, Flat, 1/2", 8, Plt		each	4		
50	WLQ08000	Washer, Lock, 1/2", 8, Plt		each	5		

# Bill of Materials Listing

TransArctic Canada Inc.

4/26/2017  
Page 1 of 1

Product Number	Description		Date	Weight	Uof M	Yield
Line    Component    Prod#	Description	Bin	Unit	Qty		
<b>KBT83990</b>	<b>Kit, Platform, 4xFCY, '12</b>		<b>2/17/2009</b>	<b>15.25</b>		<b>0</b>
10	BMN80031		Bkt, Main, Slide, Assy, 05K, IC, RE300	each	1	
20	BMZ00036		Bkt, Adaptor, Weld't, 4xFCY	each	1	
30	KBZ00010		Bag Kit, Fasteners, KBT84094/83990	each	1	

# Bill of Materials Listing

TransArctic Canada Inc.

6/28/2017  
Page 1 of 1

Product Number	Description	Date	Weight	Uof M	Yield
Line    Component    Prod#	Description	Bin                    Unit	Qty		
<b>KBZ00010</b>	<b>Bag Kit, Fasteners, KBT84094/83990</b>		<b>11/6/2013</b>	<b>0.76</b>	<b>0</b>
15	BTC12050		Bolt, Hex, 12 x 1.75 x 50mm, 10.9,Plt	each	4
20	NTP07000		Nut, Hex, 7/16-14unc, 5, Plt	each	4
30	WFA12000		Washer, Flat, 12mm, 8.8, Plt	each	4
40	WFN07000		Washer, Flat, 7/16", 2, Plt	each	4
50	WLA12000		Washer, Lock, 12mm, 8.8, Plt	each	4
60	WLP07000		Washer, Lock, 7/16", 5, Plt	each	4

# Bill of Materials Listing

TransArctic Canada Inc.

5/8/2017  
Page 1 of 1

Product Number	Description	Date	Weight	Uof M	Yield
Line    Component    Prod#	Description	Bin            Unit	Qty		
<b>KPC64094</b>	<b>Kit, Pulley, 2B, ISB, 2013</b>	<b>5/13/2008</b>	<b>14.32</b>		<b>0</b>
10 PUL67222	Pulley, Crank, ADD-ON, ISB,6.7L,2B/X,'07	each	1		
20 CSS12090	Capscrew, SH, 12 x 1.25 x 90mm, 12.9,BLK	each	6		
30 WFS12002	Washer, Flat, Hdn, 12mm, Stl, BLK	each	6		

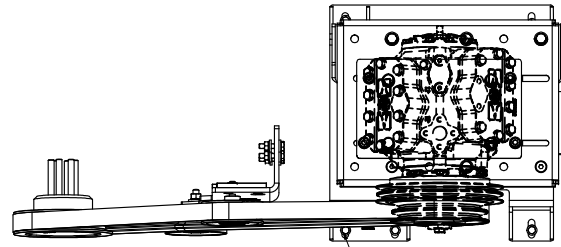

x5 7 15 24 27

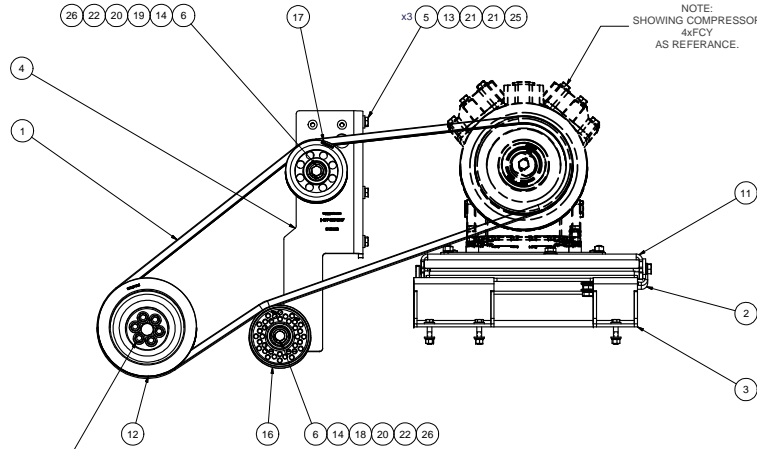

NOTE:  
SHOWING COMPRESSOR  
4xFCY  
AS REFERENCE.

NOTE:  
TORQUE TO: 37 FT-LB PLAIN & LUBRICATED W/ CLEAN ENGINE OIL (15W-40)  
(S4) CAPSCREW M12 x 1.25 x 90mm)  
TIGHTEN IN TWO STEPS IN A CRIS-CROSS TIGHTENING SEQUENCE PATTERN.

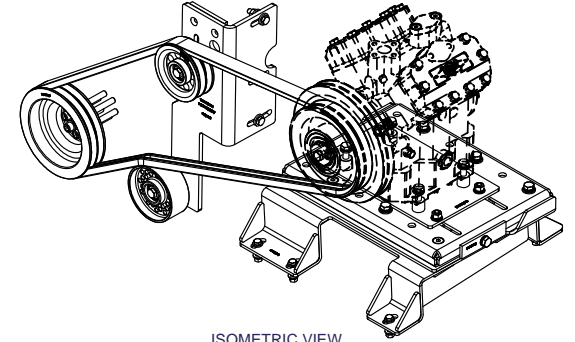
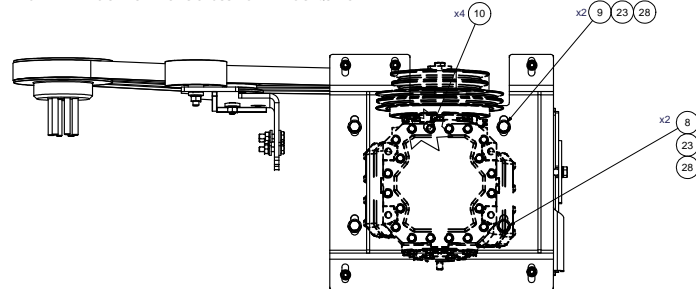

ISOMETRIC VIEW

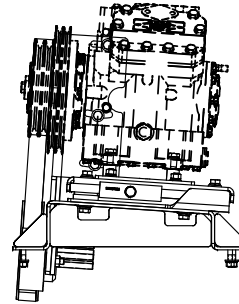

NOTES:

- 1) USE SERVICABLE THREADLOCKER ON ALL FASTENERS TO ENGINE COMPONENTS AND TORQUE ALL BOLTS TO S.A.E. SPECIFICATIONS.
- 2) SEE "TRANSARGTIC A/C COMPRESSOR MOUNT INSTALLATION DISCLAIMER".

ITEM	QTY	U/M	PART NUMBER	DESCRIPTION
28	4	EACH	WL08000	WASHER, LOCK, 1/2", 8, PLT
27	5	EACH	WL06000	WASHER, LOCK, 3/8", 8, PLT
26	2	EACH	WL12000	WASHER, LOCK, 12mm, 8.8, PLT
25	3	EACH	WL10000	WASHER, LOCK, 10mm, 8.8, PLT
24	10	EACH	WFS06002	WASHER, FLAT, 3/8", L9, PLT
23	4	EACH	WFO8000	WASHER, FLAT, 1/2", 8, PLT
22	2	EACH	WFA12002	WASHER, FLAT, 12mm, HVY, 8.8, PLT
21	6	EACH	WFA10002	WASHER, FLAT, 10mm, HVY, 8.8, PLT
20	2	EACH	SLV17012	SLEEVE, PULLEY, 16.90 x 22.23 mm x12.19)
19	1	EACH	SCD21912	SPACER, COL, DRL, 21.9mm x 31.80 x12.3)
18	1	EACH	SCD16012	SPACER, COL, DRL, 16 mm x 31.80 x 12.0)
17	1	EACH	PUA05012	PULLEY, ASSY, IDLER, B/BX gr, 5" STL, PLT
16	1	EACH	PUA05001	PULLEY, ASSY, IDLER, B/S, 5", STL, PLT
15	5	EACH	NTQ06000	NUT, HEX, 3/8-16UNC, 8, PLT
14	2	EACH	NTA12000	NUT, HEX, 12 x 1.75, 8.8, PLT
13	3	EACH	NTA10000	NUT, HEX, 10 x 1.5, 8.8, PLT
12	1	EACH	KPC64094	KIT, PULLEY, 28, ISB, 2013
11	1	EACH	KCB83994	KIT, COMPRESSOR, PS, 4wFC, '13
10	4	EACH	CSF08101	CAPSCREW, FH, 1/2-20UNF x 1", ALLOY, PLT
9	2	EACH	BTQ08151	BOLT, HEX, 1/2-20UNF x 1.50, 8, PLT
8	2	EACH	BTQ08125	BOLT, HEX, 1/2-13UNC x 1.25, 8, PLT
7	5	EACH	BTQ06175	BOLT, HEX, 3/8-16UNC, 1.75", 8, PLT
6	2	EACH	BTC12080	BOLT, HEX, 12 x 1.75 x 80mm, 10.9, PLT
5	3	EACH	BTC10045	BOLT, HEX, 10 x 1.5 x 45mm, 10.9, PLT
4	1	EACH	BMC90022	BKT, MAIN, IDLER, WELDMT, ISL, HDX, '16
3	1	EACH	BMC90012	BKT, WELDMT, MAIN BASE, HDX, '16
2	1	EACH	BMC33125	BKT, WELDMT, ADAPTER PL, ISL, HDX, '13
1	1	EACH	BEL32358	BELT, BANDED B GR, 2388mm (94)



UNSPECIFIED TOLERANCES:	MM (INCH)	THIRD ANGLE PROJECTION
ONE DECIMAL PLACE (X0)	0.1 (0.004)	THIRD ANGLE PROJECTION
TWO DECIMAL PLACE (X00)	0.02 (0.0008)	
FRACTIONAL (1/16")	0.0031 (0.00012)	

DRAWN	4/24/2017	
CHECKED	4/24/2017	
REVISION	4/24/2017	
DATE	4/24/2017	

TITLE	MT KIT, ISB, HDX, 4xFC, '16
SIZE	D
DWG NO	KMC63995
SCALE	1:1
SHEET	1 OF 1



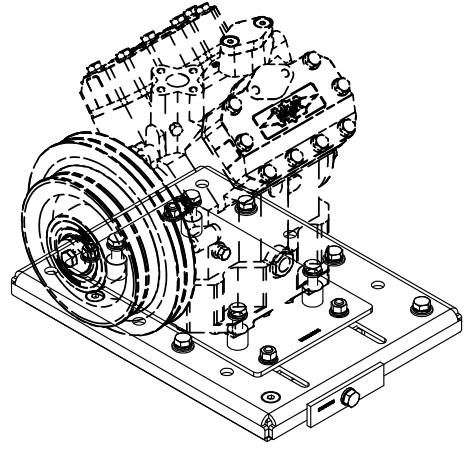
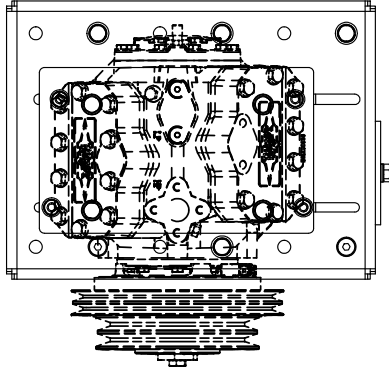
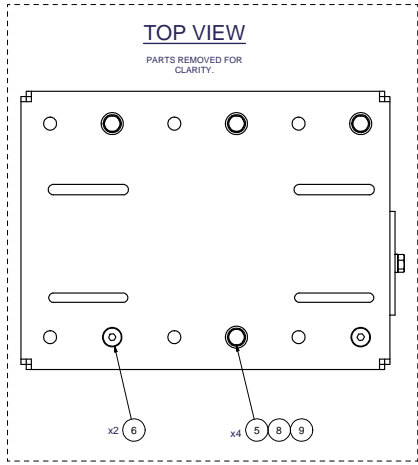

ISOMETRIC VIEW

NOTE:  
SHOWING COMPRESSOR  
4xFCY  
AS REFERENCE.

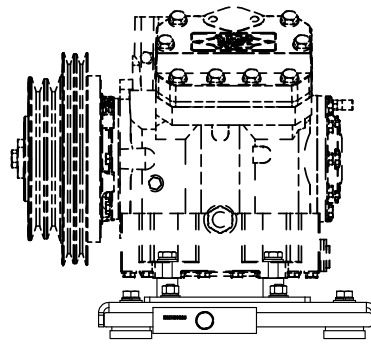
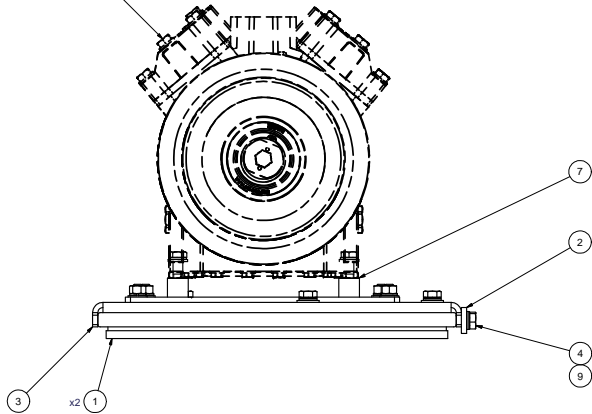

**NOTES:**

- 1) USE SERVICABLE THREADLOCKER ON ALL FASTENERS TO ENGINE COMPONENTS AND TORQUE ALL BOLTS TO S.A.E. SPECIFICATIONS.
- 2) SEE "TRANSARGTIC A/C COMPRESSOR MOUNT INSTALLATION DISCLAIMER".
- 3) WEIGHT: 50.93 LBS.

ITEM	QTY	U/M	PART NUMBER	DESCRIPTION
9	5	EACH	WLO08000	WASHER, LOCK, 1/2", 8, PLT
8	4	EACH	WFO08000	WASHER, FLAT, 1/2", 8, PLT
7	1	EACH	KBT83990	MT KIT, TRANSIT, 4xFCY, '12
6	2	EACH	CSF08076	CAPSCREW, FH, 1/2-20UNF x .75", ALLOY, PLT
5	4	EACH	BTQ08101	BOLT, HEX, 1/2-20UNF x 1.00, 5, PLT
4	1	EACH	BTP08653	BOLT, HEX, 1/2-13UNC x 6.50, 5, PLT, FT
3	1	EACH	BMZ00043	BKT, MAIN, BASE PL, '13
2	1	EACH	BMN80025	BKT, BACK, PL, SLIDE, IC, RE300
1	2	EACH	BMN80008	VIBRATION ISOLATOR, BAR, 1x.50 x 2 x 1.50

**BILL OF MATERIALS**

BROWN	3/3/2015
JRodriguez	3/3/2015
Checked	3/3/2015
Jose Rodriguez	3/3/2015
GA	3/3/2015
James Stewart	03/03/15
MFG	3/3/2015
James Stewart	3/3/2015
APPROVED	3/3/2015
Dale Mason	3/3/2015

**TRANSARGTIC INC.**  
TITLE

KIT, COMPRESSOR, PS, 4xFC, '13

SIZE D DWG NO KCB83994 REV 1  
SCALE 1:3 SHEET 1 OF 1

1	UPDATED NOTE/TITLE	3/26/17	JRR
0	RELEASED TO PRODUCTION	3/3/15	JRR
REV	DESCRIPTION	DATE	BY
THIS DRAWING CONTAINS PROPRIETARY CONFIDENTIAL INFORMATION OWNED BY TRANSARGTIC CANADA INC. THE DOCUMENT AND THE INFORMATION IT IS NOT TO BE USED, DISCLOSED OR REPRODUCED WITHOUT EXPRESS WRITTEN PERMISSION OF THE COMPANY.			
<b>UNSPECIFIED TOLERANCES:</b> ALL DIMS			
ONE DECIMAL PLACE (.X)	30	FRACTIONAL	1/32
TWO DECIMAL PLACE (.XX)	10	FRACTIONAL	1/64
THREE DECIMAL PLACE (.XXX)	10	FRACTIONAL	1/128
FRACTIONAL (1/16)	10	ANGULAR	1/2°
THIRD ANGLE PROJECTION			

DRAWING UNIT OF MEASURE: MM (INCH)

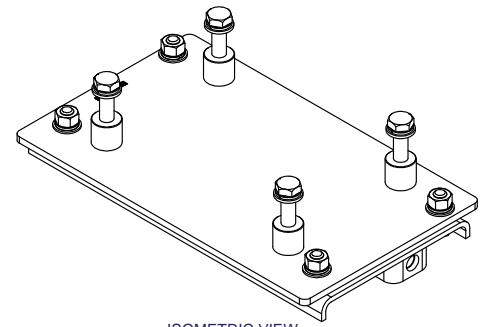
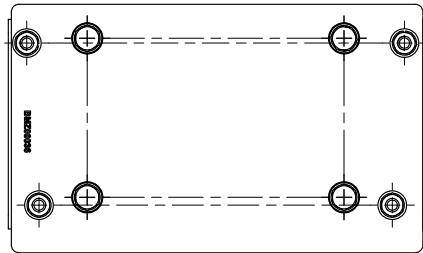

ISOMETRIC VIEW

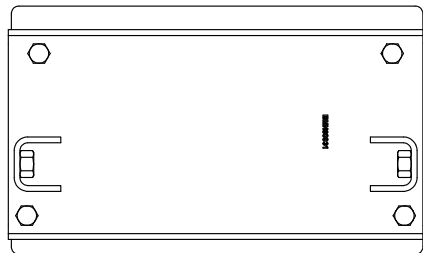
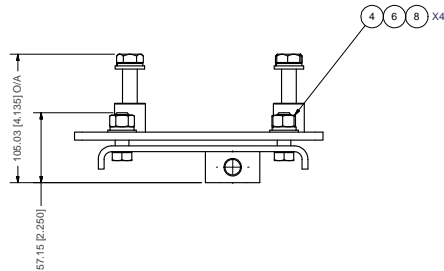
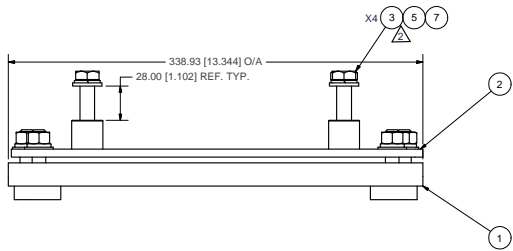

- NOTES:
- 1) USE SERVICABLE THREADLOCKER ON ALL FASTENERS TO ENGINE COMPONENTS AND TORQUE **ALL** BOLTS TO S.A.E. SPECIFICATIONS.
  - 2) SEE "TRANSARCTIC A/C COMPRESSOR MOUNT INSTALLATION DISCLAIMER".
  - 3) WEIGHT: 15.17 LBS.

ITEM	QTY	U/M	PART NUMBER	DESCRIPTION
8	4	EACH	WLP07000	WASHER, LOCK, 7/16", 5, PLT
7	4	EACH	WLA12000	WASHER, LOCK, 12mm, 8.8, PLT
6	4	EACH	WFO7000	WASHER, FLAT, 7/16", 2, PLT
5	4	EACH	WFA12000	WASHER, FLAT, 12mm, 8.8, PLT
4	4	EACH	NTP07000	NUT, HEX, 7/16-14UNC, 5, PLT
3	4	EACH	BTC12050	BOLT, HEX, 1/2 x 1.75 x 50mm, 10.9, PLT
2	1	EACH	BMZ00036	BKT, ADAPTER, WELDT, 4WFCY
1	1	EACH	BMN80031	BKT, MAIN, SLIDE, ASSY, 08K, IC, RE300

TRANSARCTIC INC.

MT KIT, TRANSIT, 4xFCY, '12

SIZE: D DWG NO: KBT83990 REV: 2

SCALE: 1:2 SHEET 1 OF 1

REV	ECN	DESCRIPTION	DATE	BY	CHK
2		WAS BTC12050	6/27/2012	JRP	
1		WAS BTC12050	4/24/2013	JJP	
0		RELEASED TO PRODUCTION	3/14/2012	GA	
				James Stewart	3/13/2012
				Ron Ingram	3/13/2012
				Dale Mason	3/13/2012

UNSPECIFIED TOLERANCES: HOLE DIM: .005  
 DIM DECIMAL PLACE (.X) .00 .010  
 DIM FRACTIONAL PLACE (X/64) .00 .005  
 DIM FRACTIONAL PLACE (X/32) .00 .010  
 DIM FRACTIONAL PLACE (X/16) .00 .015  
 DIM FRACTIONAL PLACE (X/8) .00 .030  
 DIM FRACTIONAL PLACE (X/4) .00 .125  
 DIM FRACTIONAL PLACE (X/2) .00 .500  
 DIM FRACTIONAL PLACE (X/1) .00 1.000

THIRD ANGLE PROJECTION

DRAWING UNIT OF MEASURE: MM (INCH)

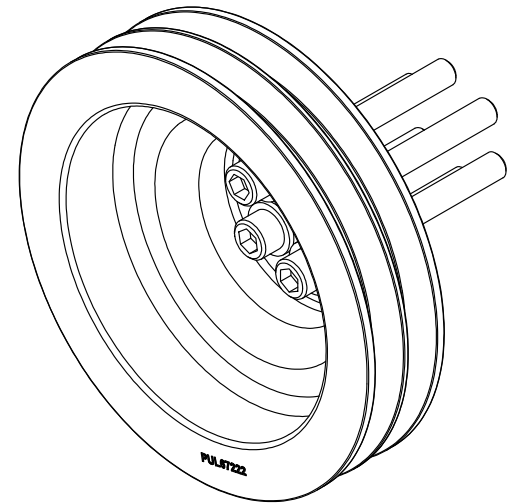
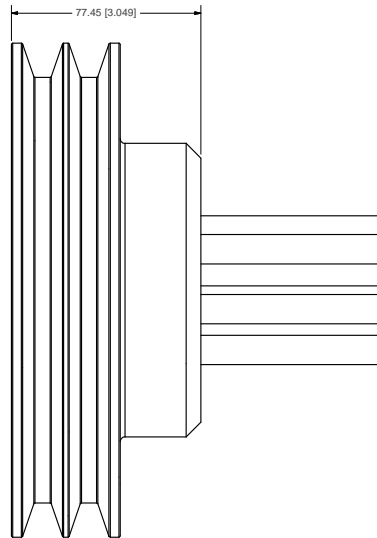
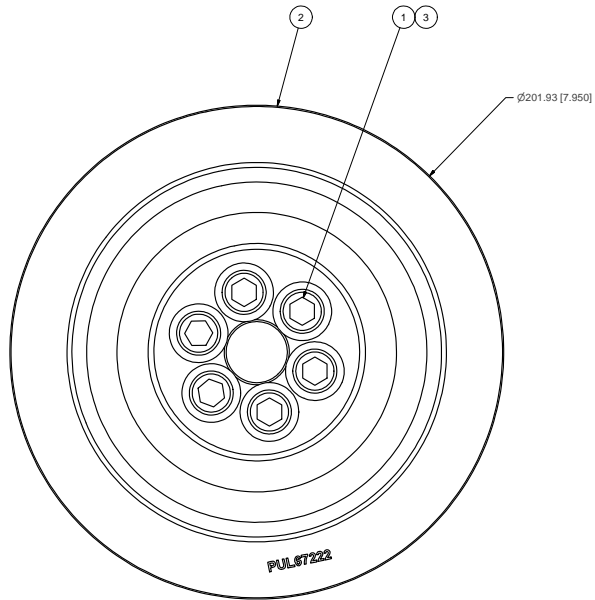
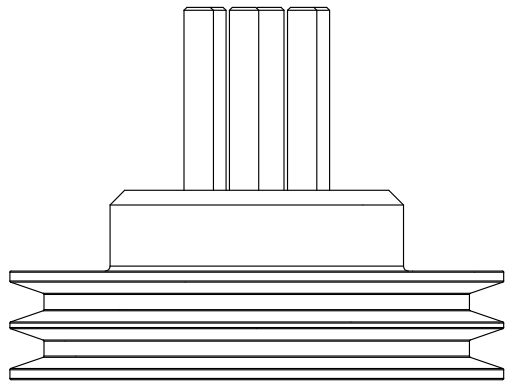

ISOMETRIC VIEW

- NOTES:
- 1) USE SERVICABLE THREADLOCKER ON ALL FASTENERS TO ENGINE COMPONENTS AND TORQUE **ALL BOLTS** TO S.A.E. SPECIFICATIONS.
  - 2) SEE "TRANSARCTIC A/C COMPRESSOR MOUNT INSTALLATION DISCLAIMER".
  - 3) WEIGHT: 13.24 LB

ITEM	QTY	U/M	PART NUMBER	DESCRIPTION
3	6	EACH	WFS12002	WASHER, FLAT, HDN, 12mm, STL, BLK
2	1	EACH	PUL67222	PULLEY, CRANK, ADD-ON, ISB, 5.7L, 2B/IX '07
1	6	EACH	CSS12090	CAPSCREW, SH, 12 x 1.25 x 90mm, 12.9, FLT

**TRANSARCTIC INC.**

UNSPECIFIED TOLERANCES:	MM (INCH)
ONE DECIMAL PLACE (X.0)	±0.10 (±0.004)
TWO DECIMAL PLACE (X.00)	±0.02 (±0.0008)
THREE DECIMAL PLACE (X.000)	±0.002 (±0.00008)
FRACTIONAL (1/16")	±0.005 (±0.0002)

DRAWN	Jose Rodriguez	11/6/2013
CHECKED	Val Jakowlew	11/6/2013
RELEASED TO PRODUCTION	11/6/2013	JRR
REVISION	DESCRIPTION	DATE
1	James Stewart	10/21/2008
2	Ron Ingram	11/6/2013
3	Date Mason	11/6/2013

TITLE	KIT, PULLEY, 2B, ISB, 2013		
SIZE	D	DWG NO	KPC64094
SCALE	1:1	SHEET	1 OF 1



DRAWING UNIT OF MEASURE: MM (INCH)

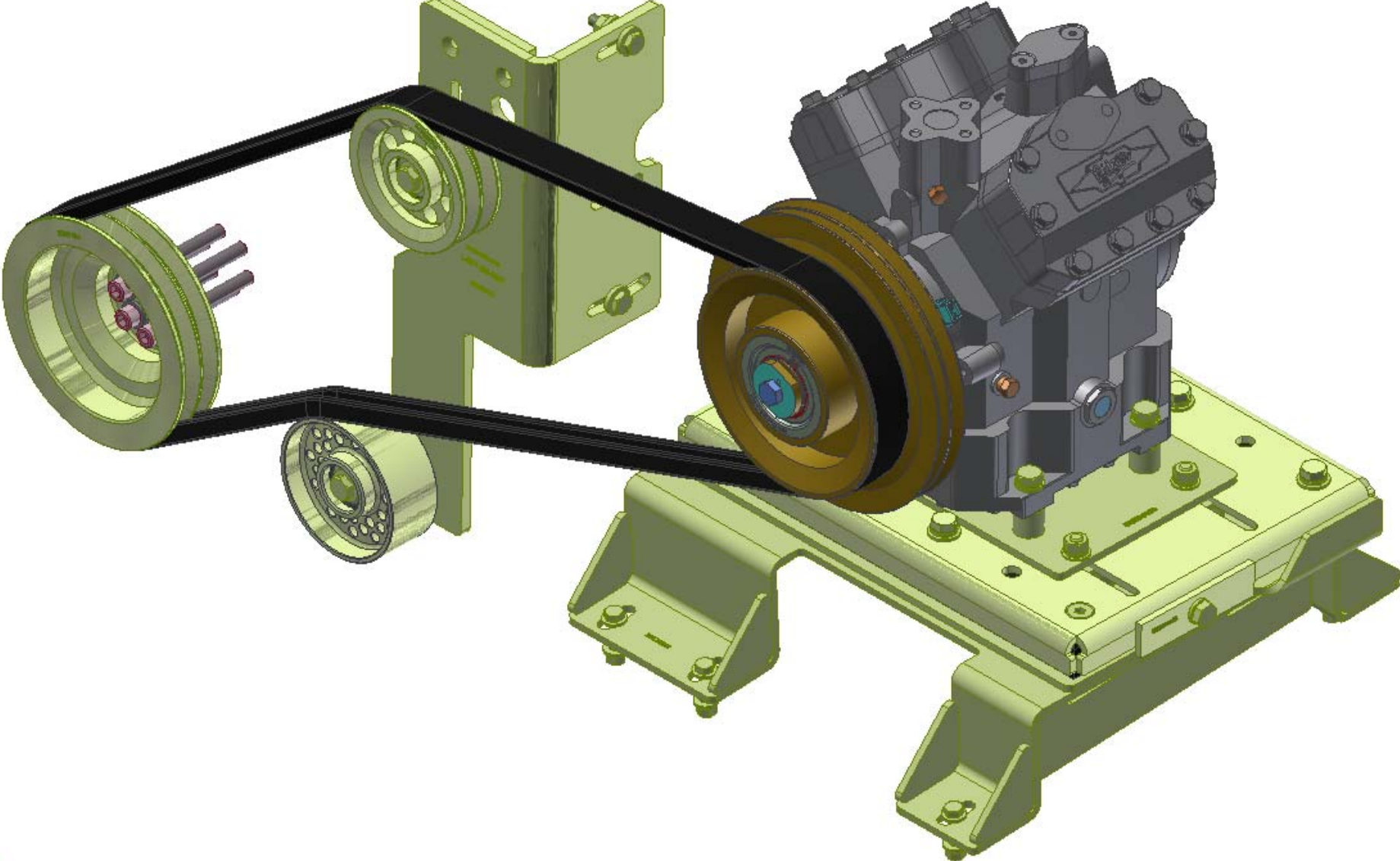

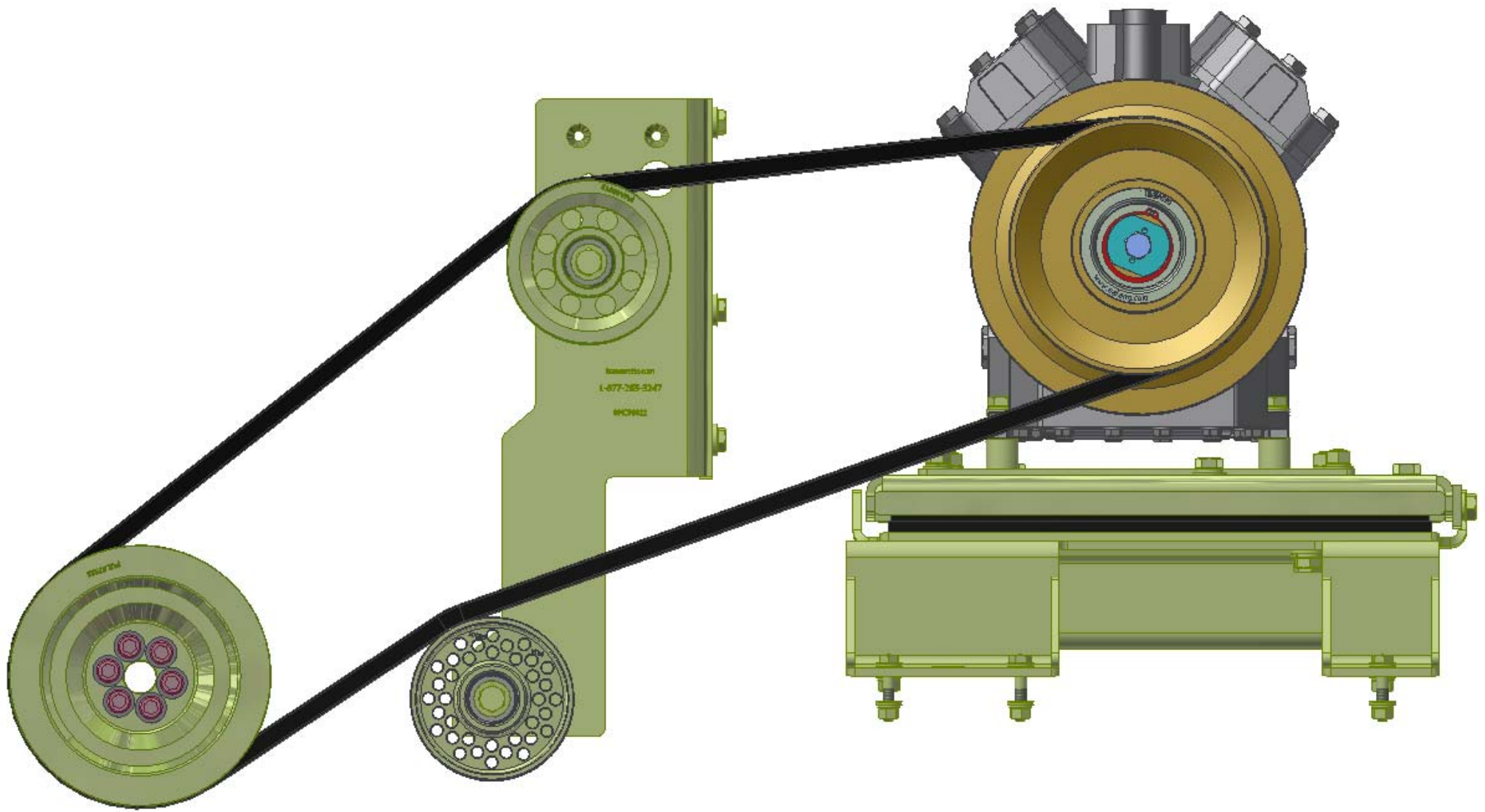

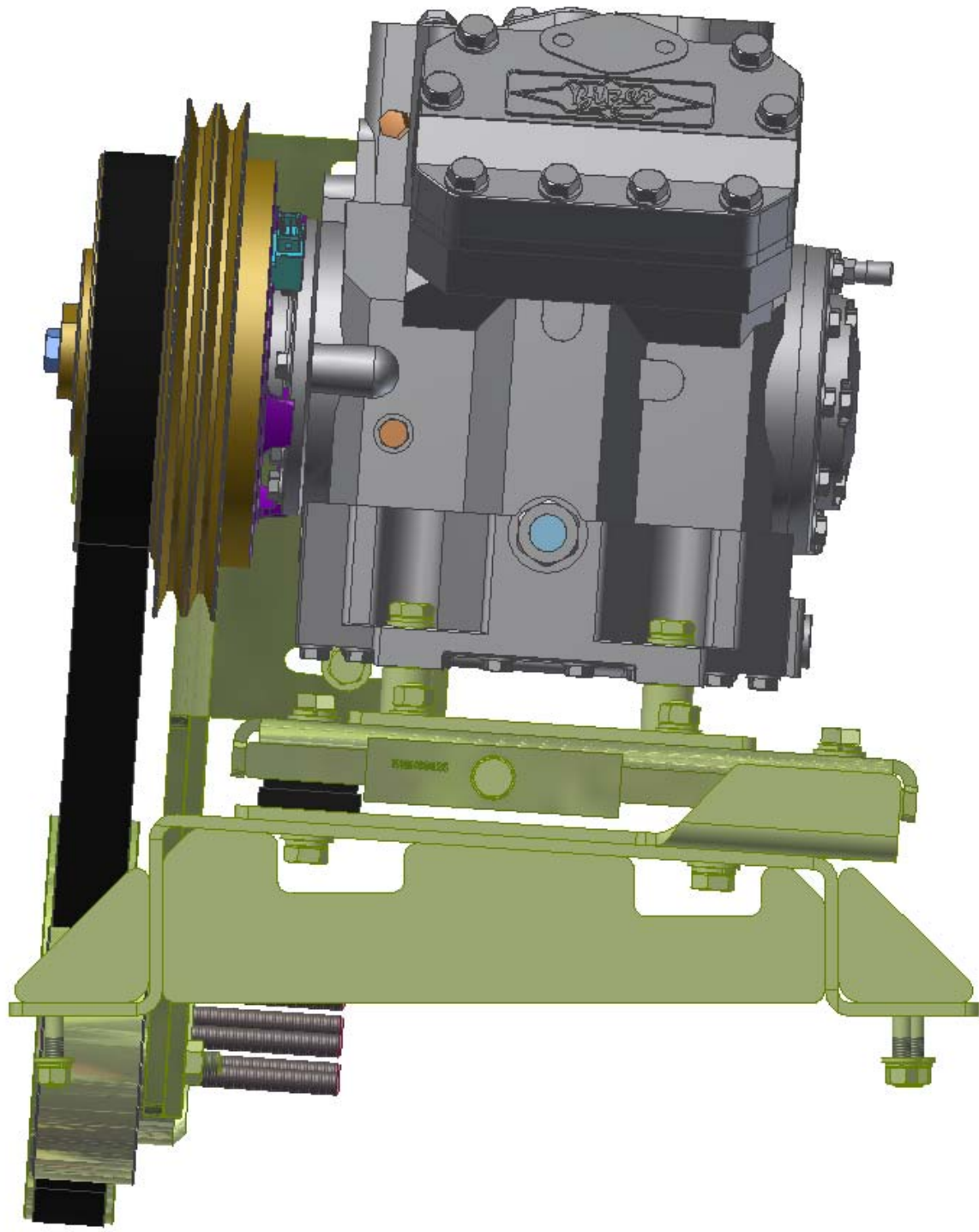

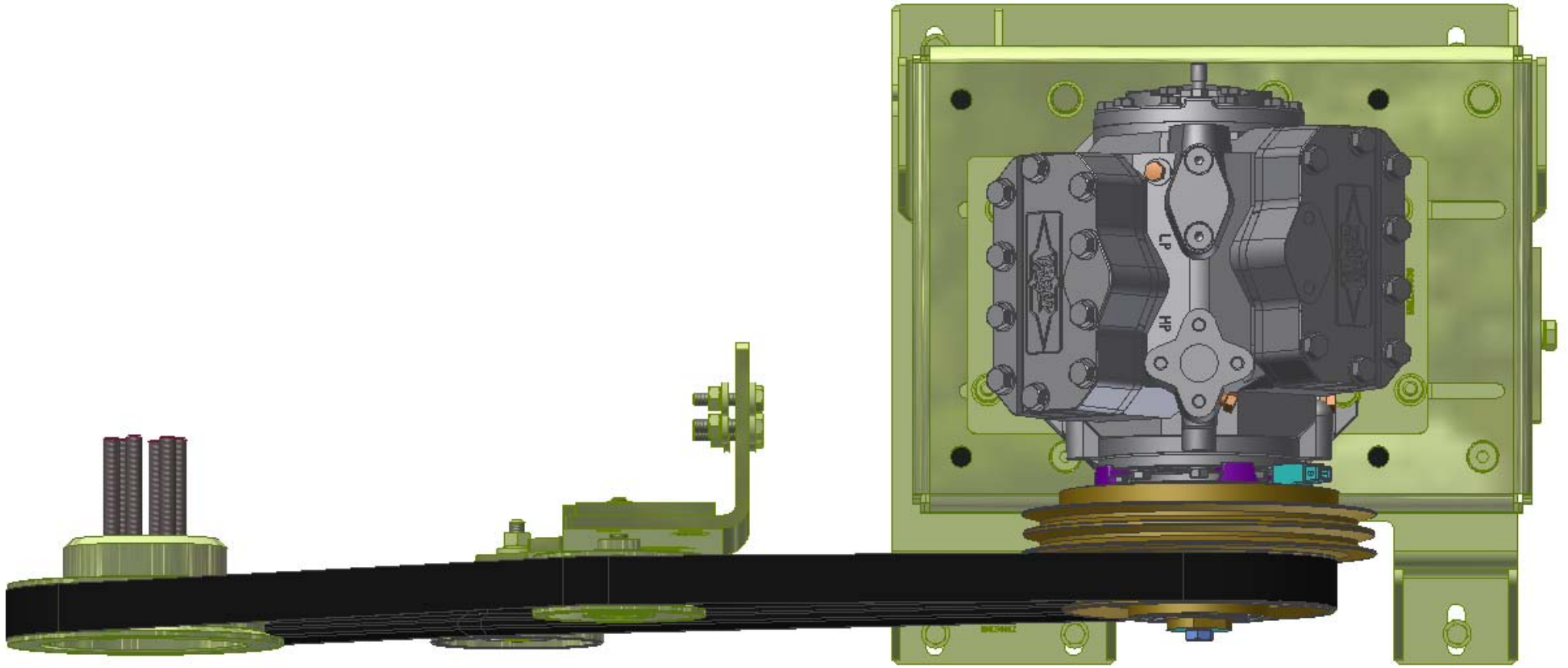

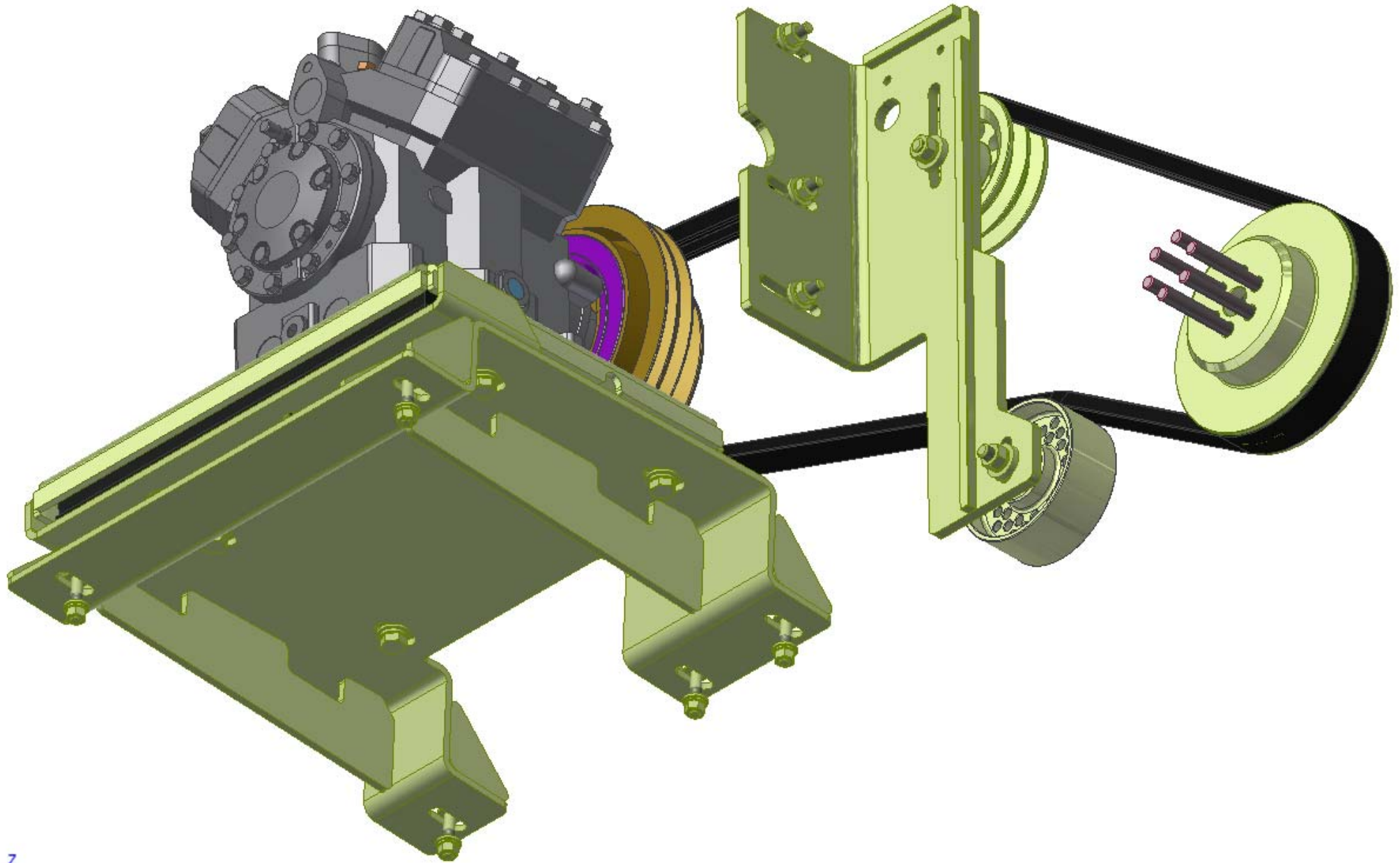



## **TransArctic A/C Compressor Mount Installation Disclaimer**

All compressor mounts should be installed by qualified and trained personnel using proper tools and equipment in safe working conditions following industry standard guidelines for motor vehicle service and repair.

The installer of any compressor mount purchased from TransArctic must undertake all responsibility of issues arising from that compressor bracket being installed on any vehicle. As well as insure that a **proper and sufficient ground** is established between the compressors' clutches and the vehicle's engine. Mount functionality, operation and durability can all be compromised by an incompetent installation.

Due to the many different situations, parameters and application criteria, which are beyond the compressor mount manufacturer's control, TransArctic does not warrant design, durability, or operational functionality of any compressor mount improperly installed by another party.

**With no implied guarantees it is the mount installer's strict responsibility to determine safety and functionality, of the compressor mount, at the time of installation.**

Please contact TransArctic with any issue arising from installation so we may better improve the product. If you have any reservations about the compressor mount integrity contact TransArctic immediately at 1-877-COLD-AIR.

**Mark OEM tensioner location**

**Install Kit**

**Check for Interferences**

**Check to ensure that the proper OEM tensioner orientation is maintained**

**Run engine with A/C system engaged for at least 10 minutes to run in belt**

**Check OEM tensioner orientation and adjust as required**

### **Responsabilidad limitada de TransArctic en la instalación del soporte del compresor**

Todos los soportes de los compresores deben ser instalados por personas calificadas y entrenadas, usando para ello los equipos y herramientas necesarios para esta labor en buenas condiciones y según las normas y guías para el servicio y/o reparación de motores de vehículos.

El instalador de los soportes comprados en TransArctic asume toda la responsabilidad de cualquier problema que surga en el soporte del compresor al vehículo; de igual manera es responsable que el cable a tierra sea conectado entre el embrague del compresor y el motor del vehículo.

Se advierte que el buen funcionamiento y la durabilidad del soporte pueden ser comprometidos por defectos en su instalación.

Debido a las diversas situaciones que se puedan presentar fuera del control del fabricante, TransArctic no garantiza el diseño, la durabilidad o el correcto funcionamiento de cualquier equipo inapropiadamente instalado por terceros.

**Esta sobreentendido que el Instalador del montaje del compresor es estrictamente responsable de la seguridad y funcionamiento del equipo en el momento de la instalación.**

Si tuviera algún problema o duda acerca de la instalación del soporte del compresor pongase en contacto inmediatamente con TransArctic al teléfono 1-877-COLD-AIR de modo que podamos mejorar nuestro producto.

**Note la ubicación del medidor de tensión OEM**

**Instale el equipo**

**Controlar si hay interferencias.**

**Asegure que el medidor de tensión mantenga la orientación justa.**

**Encienda el motor por lo menos 10 minutos con el sistema A/C enganchado para que la correa corra**

**Controle la orientación justa del medidor de tensión y ajuste a las condiciones requeridas del fabricante**