

Bill of Materials Listing

TransArctic Canada Inc.

8/8/2011
Page 1 of 1

Product Number	Description	Date	Weight	Uof M	Yield
Line Component Prod#	Description	Bin Unit	Qty		
KMG81972	Mt Kit, GMC 8.1L LPG, BBCV, TM-31, '11		8/12/2008	37.79	0
10	BEL81684		Belt, 8gr, 1684mm (66.3") (5080663)	each	1
20	BMG81002		Bkt, Cradle, TM-31, GM, LPG	each	1
30	BMG81003		Bkt, Main, 8.1L GM, 2008-10, ALUM	each	1
35	BMG81005		Bkt, CAC, Sup, 8.1L GM, TM-31, 2010	each	1
36	BMG81006		Bkt, Water Valve/Chassis, 8.1L GM, 2010	each	1
40	PUL80076		Pulley, Idler, Backside, P8, 76d (89062)	each	1
50	PUL81003		Pulley, Crank, Add-on, GM, 8.1L, P8	each	1
55	PUL81005		Pulley, Crank, OEM, GM, LPG, 8.1L,P8,'11	each	1
60	PUL81074		Pulley, Idler, Frontside, P8,74d (89103)	each	1
70	TEN80005		Tenr, HD Spring, BackSide, CCW (89430)	each	1
75	HOR02000		Hose, Heater, 2" ID, 36" (76200)	each	0.20
80	KBG81972		Bag Kit, Fasteners, KMG81972	each	1

Bill of Materials Listing

TransArctic Canada Inc.

8/8/2011
Page 1 of 1

Product Number	Description	Date	Weight	Uof M	Yield
Line Component Prod#	Description	Bin Unit	Qty		
KBG81972	Bag Kit, Fasteners, KMG81972		8/20/2008	1.57	0
5	BTC08025	Bolt, Hex, 8 x 1.25 x 25mm, 10.9, Plt	each	2	
10	BTC10035	Bolt, Hex, 10 x 1.5 x 35mm, 10.9, Plt,FT	each	4	
20	CSF08031	Capscrew, FH, 8 x 1.25 x 30mm, 10.9,Plt	each	4	
30	BTC10130	Bolt, Hex, 10 x 1.5 x 130mm, 10.9, Plt	each	3	
40	BTC10180	Bolt, Hex, 10 x 1.5 x 180mm, 10.9, Plt	each	1	
50	BTS10001	Bolt, Shoulder, 10mm (89064)	each	2	
60	WFA10000	Washer, Flat, 10mm, 8.8, Plt	each	9	
70	WLA10000	Washer, Lock, 10mm, 8.8, Plt	each	9	
80	BTC10090	Bolt, Hex, 10 x 1.5 x 90mm, 10.9, Plt	each	1	
90	BTC08030	Bolt, Hex, 8 x 1.25 x 30mm, 10.9, Plt,FT	each	6	
100	WFA08000	Washer, Flat, 8mm, 8.8, Plt	each	8	
110	WLA08000	Washer, Lock, 8mm, 8.8, Plt	each	2	

8 7 6 5 4 3 2 1

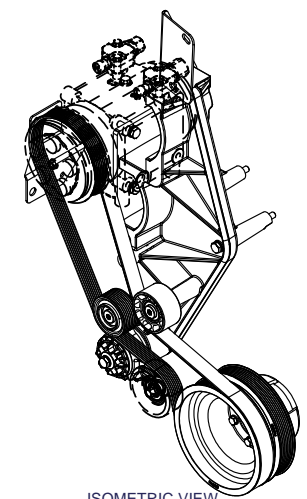
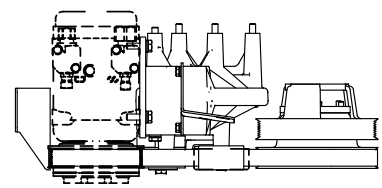

ISOMETRIC VIEW

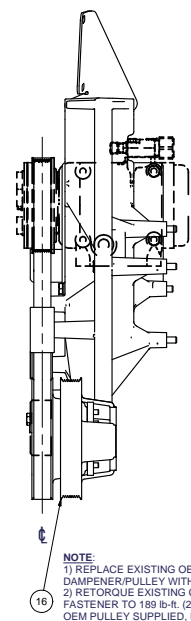
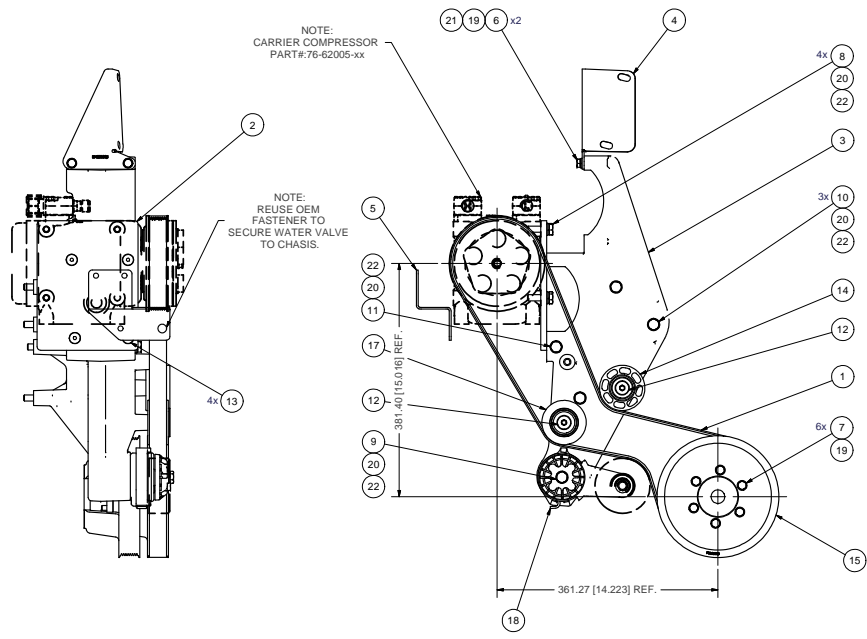

NOTES:
1) USE SERVICABLE THREADLOCKER ON ALL FASTENERS TO ENGINE COMPONENTS AND TORQUE ALL BOLTS TO S.A.E. SPECIFICATIONS.
2) SEE "TRANSARCTIC A/C COMPRESSOR MOUNT INSTALLATION DISCLAIMER".

ITEM	QTY	U/M	PART NUMBER	DESCRIPTION
22	9	EACH	WLA10000	WASHER, LOCK, 10mm, 8.8, PLT
21	2	EACH	WLA8000	WASHER, LOCK, 8mm, 8.8, PLT
20	9	EACH	WFA10000	WASHER, FLAT, 10mm, 8.8, PLT
19	8	EACH	WFA8000	WASHER, FLAT, 8mm, 8.8, PLT
18	1	EACH	TEN80005	TENR, HD SPRING, BACKSIDE, CCW (89430)
17	1	EACH	PUL81074	PULLEY, IDLER, FRONTSIDE, P8, 74d x 39w
16	1	EACH	PUL81005	PULLEY, CRANK, OEM, GM, LPG, 8.1L, P8, 11
15	1	EACH	PUL81003	PULLEY, CRANK, ADD-ON, GM, 8.1L, P8
14	1	EACH	PUL80076	PULLEY, IDLER, BACKSIDE, P8, 76d, 39W
13	4	EACH	CSF8031	CAPSCREW, FH, 8 x 1.25 x 30mm, 10.9, PLT
12	2	EACH	BTS10001	BOLT, SHOULDER, 10mm (IDLER PULLEY)
11	1	EACH	BTC10180	BOLT, HEX, 10 x 1.5 x 180mm, 10.9, PLT
10	3	EACH	BTC10130	BOLT, HEX, 10 x 1.5 x 130mm, 10.9, PLT
9	1	EACH	BTC10090	BOLT, HEX, 10 x 1.5 x 90mm, 10.9, PLT
8	4	EACH	BTC10035	BOLT, HEX, 10 x 1.5 x 35mm, 10.9, PLT
7	6	EACH	BTC8030	BOLT, HEX, 8 x 1.25 x 30mm, 10.9, PLT
6	2	EACH	BTC8025	BOLT, HEX, 8 x 1.25 x 25mm, 10.9, PLT
5	1	EACH	BMG81006	BKT, WATER VALVE/CHASSIS, 8.1L GM, 2010
4	1	EACH	BMG81005	BKT, CAC, SUP, 8.1L GM, TM-31, 2010
3	1	EACH	BMG81003	BKT, MAIN, 8.1L GM, 2008, ALUM
2	1	EACH	BMG81002	BKT, CRADLE, TM-31, GM, LPG
1	1	EACH	BEL81684	BELT, 8GR, 1684mm (66.3") (5080643)

BILL OF MATERIALS
TRANSARCTIC INC.

UNSPECIFIED TOLERANCES:	ALL DIM.	
ONE DECIMAL PLACE (X.1)	FRAC	
TWO DECIMAL PLACE (X.01)	FRAC	
THREE DECIMAL PLACE (X.001)	FRAC	
FRACTIONAL (1/16")	ANGULAR	± .01°

DRAWN	Jose Rodriguez	4/29/2011
CHECKED	Val Jakovlew	4/29/2011
RELEASED TO PRODUCTION	4/29/2011	RR
REVIEWED	James Stewart	4/29/2011
APPROVED	Ron Ingram	4/29/2011
DATE	Dale Mason	4/29/2011

TITLE	MT KIT, GMC 8.1L LPG, BBCV, TM-31, '11
SIZE	D
DWG NO	KMG81972
SCALE	1:4
SHEET	1 OF 1

8 7 6 5 4 3 2 1



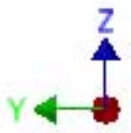
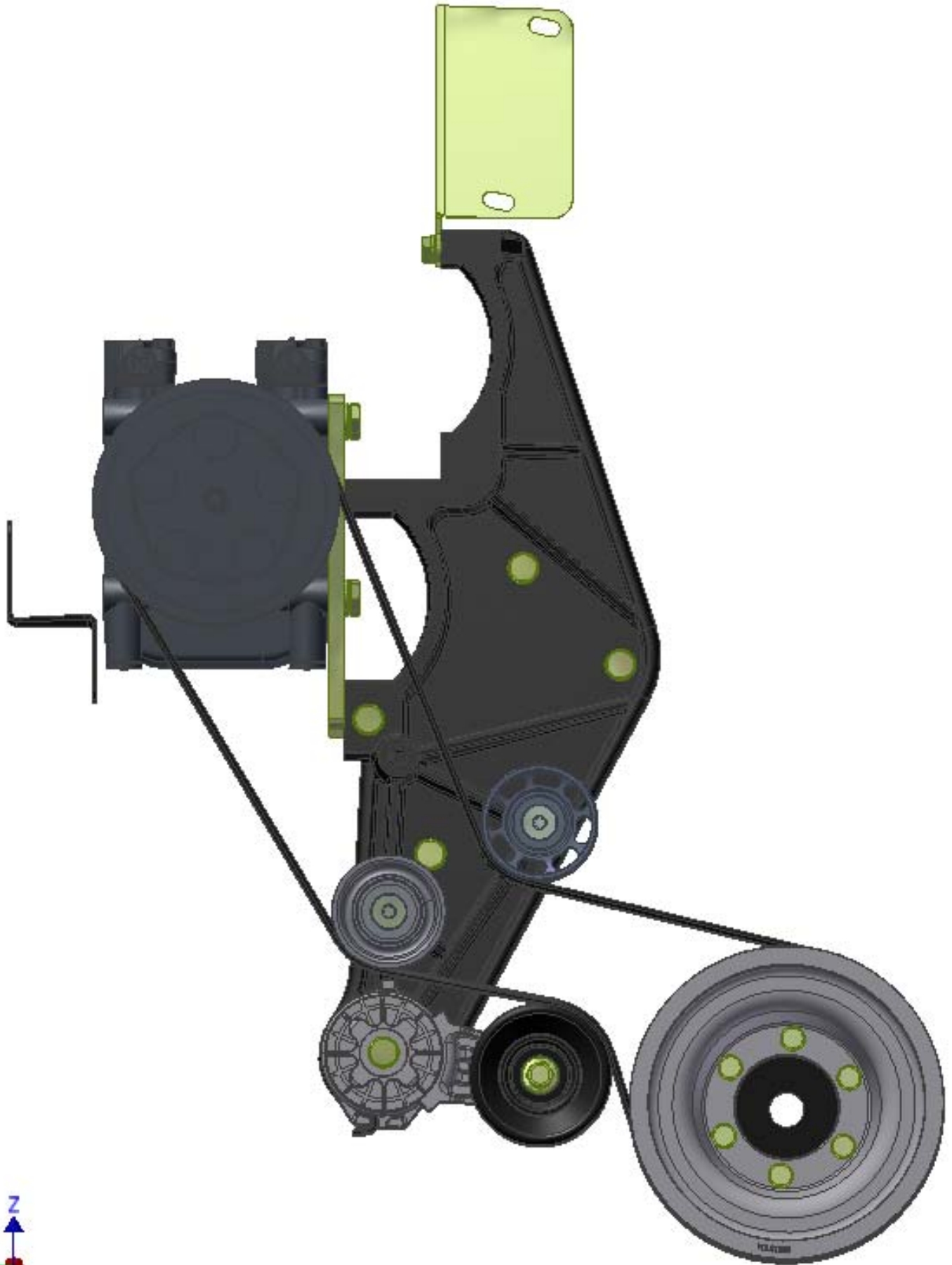

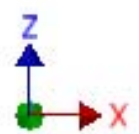

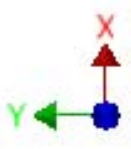

TransArctic A/C Compressor Mount Installation Disclaimer

All compressor mounts should be installed by qualified and trained personnel using proper tools and equipment in safe working conditions following industry standard guidelines for motor vehicle service and repair.

The installer of any compressor mount purchased from TransArctic must undertake all responsibility of issues arising from that compressor bracket being installed on any vehicle. As well as insure that a **proper and sufficient ground** is established between the compressors' clutches and the vehicle's engine. Mount functionality, operation and durability can all be compromised by an incompetent installation.

Due to the many different situations, parameters and application criteria, which are beyond the compressor mount manufacturer's control, TransArctic does not warrant design, durability, or operational functionality of any compressor mount improperly installed by another party.

With no implied guarantees it is the mount installer's strict responsibility to determine safety and functionality, of the compressor mount, at the time of installation.

Please contact TransArctic with any issue arising from installation so we may better improve the product. If you have any reservations about the compressor mount integrity contact TransArctic immediately at 1-877-COLD-AIR.

Mark OEM tensioner location

Install Kit

Check for Interferences

Check to ensure that the proper OEM tensioner orientation is maintained

Run engine with A/C system engaged for at least 10 minutes to run in belt

Check OEM tensioner orientation and adjust as required

Responsabilidad limitada de TransArctic en la instalación del soporte del compresor

Todos los soportes de los compresores deben ser instalados por personas calificadas y entrenadas, usando para ello los equipos y herramientas necesarios para esta labor en buenas condiciones y según las normas y guías para el servicio y/o reparación de motores de vehículos.

El instalador de los soportes comprados en TransArctic asume toda la responsabilidad de cualquier problema que surga en el soporte del compresor al vehículo; de igual manera es responsable que el cable a tierra sea conectado entre el embrague del compresor y el motor del vehículo.

Se advierte que el buen funcionamiento y la durabilidad del soporte pueden ser comprometidos por defectos en su instalación.

Debido a las diversas situaciones que se puedan presentar fuera del control del fabricante, TransArctic no garantiza el diseño, la durabilidad o el correcto funcionamiento de cualquier equipo inapropiadamente instalado por terceros.

Esta sobreentendido que el Instalador del montaje del compresor es estrictamente responsable de la seguridad y funcionamiento del equipo en el momento de la instalación.

Si tuviera algún problema o duda acerca de la instalación del soporte del compresor pongase en contacto inmediatamente con TransArctic al teléfono 1-877-COLD-AIR de modo que podamos mejorar nuestro producto.

Note la ubicación del medidor de tensión OEM

Instale el equipo

Controlar si hay interferencias.

Asegure que el medidor de tensión mantenga la orientación justa.

Encienda el motor por lo menos 10 minutos con el sistema A/C enganchado para que la correa corra

Controle la orientación justa del medidor de tensión y ajuste a las condiciones requeridas del fabricante