

# Bill of Materials Listing

TransArctic Canada Inc.

4/11/2011  
Page 1 of 1

| Product Number       | Description                                | Date             | Weight       | Uof M | Yield    |
|----------------------|--|------------------|--------------|-------|----------|
| Line Component Prod# | Description                                | Bin Unit         | Qty          |       |          |
| <b>KMC62571</b>      | <b>Mt Kit, 6.7L ISB, BBCV, F400, '10</b>   | <b>4/13/2009</b> | <b>49.98</b> |       | <b>0</b> |
| 10 BEL61511          | Belt, 6gr, 1511mm (59.5") (5060595)        | each             | 1            |       |          |
| 20 BMC67062          | Bkt, Main, Vert, Weldmt, ISB, F400, '10    | each             | 1            |       |          |
| 30 BMC67063          | Bkt, Alt, Bar, ISB, F400, BBCV, '10        | each             | 1            |       |          |
| 40 BMC67064          | Bkt, Main, Weldmt, 6.7L, ISB, F400, '10    | each             | 1            |       |          |
| 50 BMC67036          | Bkt, Pl, Brace, ISB, F400, '09             | each             | 1            |       |          |
| 60 BMC67066          | Bkt, Shroud, Cover, 12ga, ISB, F400, '10   | each             | 1            |       |          |
| 63 BMC67069          | Bkt, Angle, Brace, Hanger, Hose, 2010      | each             | 2            |       |          |
| 65 BMZ00028          | Bkt, Universal Hose & Cable                | each             | 1            |       |          |
| 70 TEN60000          | Tenr, HD Spring, BackSide, CW (89204)      | each             | 1            |       |          |
| 80 FTS04000          | Ftg, Pipe, St, 1/8" NPT, Brass, F-M        | each             | 1            |       |          |
| 90 FTS04090          | Ftg, Pipe, Elbow, 1/8" NPT, Brass, F-M     | each             | 2            |       |          |
| 95 FTS04091          | Ftg, Pipe, Elbow, 1/8" NPT, Brass, F-F     | each             | 1            |       |          |
| 100 FTS04003         | Ftg, Pipe, Cap, Hex, 1/8" NPT, Brass       | each             | 1            |       |          |
| 110 FTS04004         | Ftg, Pipe, Nipple, 1/8" NPT x 3", Brass    | each             | 2            |       |          |
| 120 FTS16001         | Ftg, Hose, Splice, 1" d, STL, PLT          | each             | 1            |       |          |
| 125 FTS40001         | Ftg, Block, Manifold, F400, ALUM           | each             | 1            |       |          |
| 130 CLP20001         | Clamp, Gear, #20, 3/4-1 3/4 (19/44mm), S   | each             | 2            |       |          |
| 135 SCD19008         | Spacer, Col, Drl, 19.05mm x 19.05o x 8.33i | each             | 1            |       |          |
| 140 KBC62571         | Bag Kit, Fasteners, KMC62571               | each             | 1            |       |          |

NOTE: THE "TURBO TUBE" IS ROTATED "END TO END" WHEN RE-INSTALLING IT BACK ONTO THE BUS.

# Bill of Materials Listing

TransArctic Canada Inc.

4/11/2011  
Page 1 of 1

| Product Number  |                 | Description                              | Bin | Date             | Weight      | Uof M | Yield    |
|-----------------|-----------------|--|-----|------------------|-------------|-------|----------|
| Line            | Component Prod# | Description                              |     | Unit             | Qty         |       |          |
| <b>KBC62571</b> |                 | <b>Bag Kit, Fasteners, KMC62571</b>      |     | <b>8/11/2009</b> | <b>2.66</b> |       | <b>0</b> |
| 10              | BTC08030        | Bolt, Hex, 8 x 1.25 x 30mm, 10.9, Plt,FT |     | each             | 3           |       |          |
| 20              | BTC08035        | Bolt, Hex, 8 x 1.25 x 35mm, 10.9, Plt,FT |     | each             | 1           |       |          |
| 30              | BTC10030        | Bolt, Hex, 10 x 1.5 x 30mm, 10.9, Plt    |     | each             | 9           |       |          |
| 35              | BTC10025        | Bolt, Hex, 10 x 1.5 x 25mm, 10.9, Plt    |     | each             | 4           |       |          |
| 37              | BTC10055        | Bolt, Hex, 10 x 1.5 x 55mm, 10.9, Plt,FT |     | each             | 2           |       |          |
| 40              | BTC10070        | Bolt, Hex, 10 x 1.5 x 70mm, 10.9, Plt    |     | each             | 4           |       |          |
| 45              | BTC10095        | Bolt, Hex, 10 x 1.5 x 95mm, 10.9, Plt    |     | each             | 2           |       |          |
| 50              | BTC10140        | Bolt, Hex, 10 x 1.5 x 140mm, 10.9, Plt   |     | each             | 2           |       |          |
| 60              | BTC12090        | Bolt, Hex, 12 x 1.75 x 90mm, 10.9, Plt   |     | each             | 1           |       |          |
| 65              | CSB08035        | Capscrew, BH, 8 x 1.25 x 35, 10.9, Plt   |     | each             | 1           |       |          |
| 70              | CSF10031        | Capscrew, FH, 10 x 1.5 x 30mm, 10.9,Plt  |     | each             | 2           |       |          |
| 80              | NTA08000        | Nut, Hex, 8 x 1.25, 8.8, Plt             |     | each             | 2           |       |          |
| 100             | WFA08000        | Washer, Flat, 8mm, 8.8, Plt              |     | each             | 4           |       |          |
| 110             | WFA10000        | Washer, Flat, 10mm, 8.8, Plt             |     | each             | 12          |       |          |
| 120             | WFA12000        | Washer, Flat, 12mm, 8.8, Plt             |     | each             | 1           |       |          |
| 130             | WLA08000        | Washer, Lock, 8mm, 8.8, Plt              |     | each             | 4           |       |          |
| 140             | WLA10000        | Washer, Lock, 10mm, 8.8, Plt             |     | each             | 23          |       |          |
| 150             | WLA12000        | Washer, Lock, 12mm, 8.8, Plt             |     | each             | 1           |       |          |

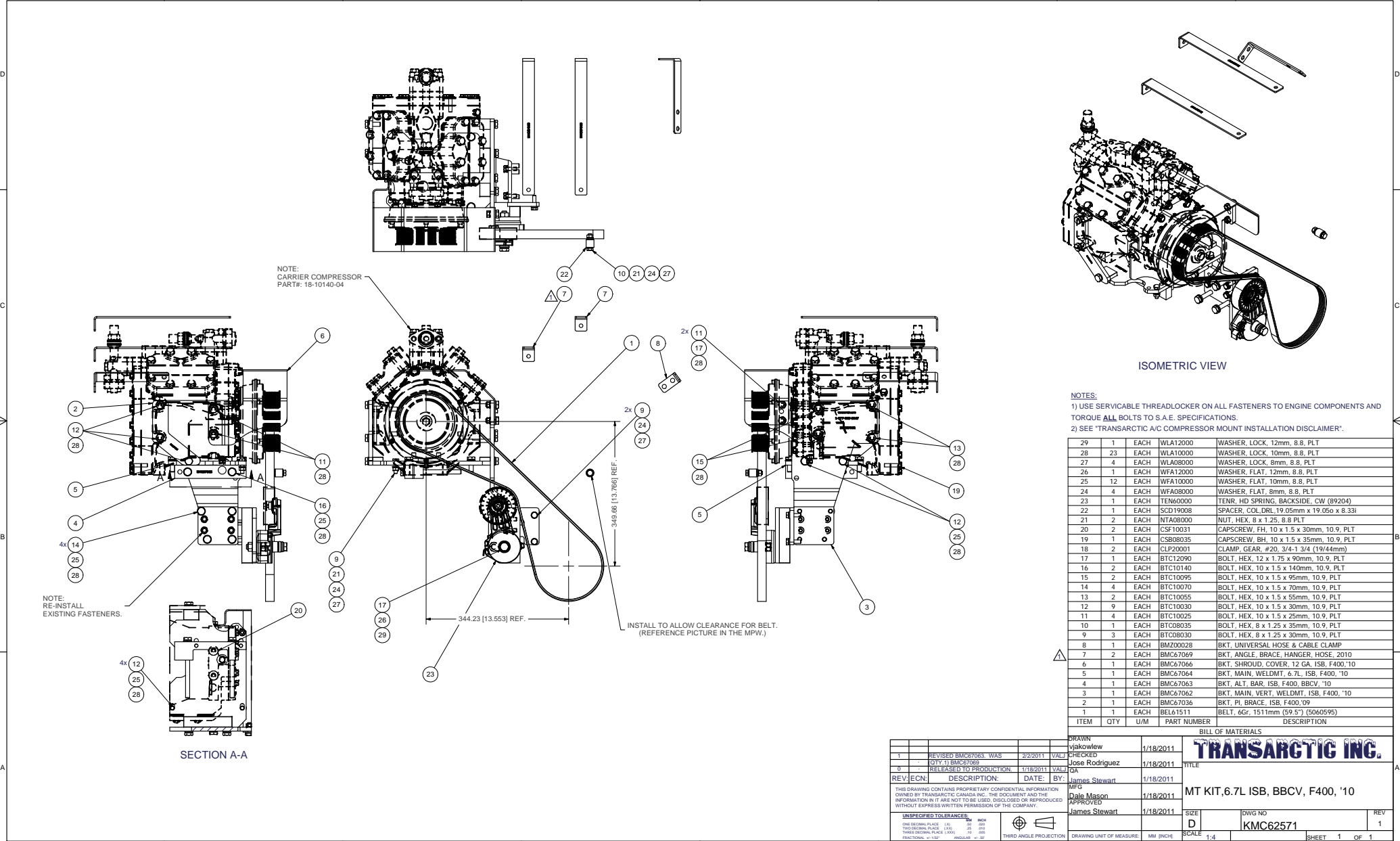

NOTES:  
 1) USE SERVICABLE THREADLOCKER ON ALL FASTENERS TO ENGINE COMPONENTS AND TORQUE ALL BOLTS TO S.A.E. SPECIFICATIONS.  
 2) SEE 'TRANSARGTIC A/C COMPRESSOR MOUNT INSTALLATION DISCLAIMER'.

| ITEM | QTY | U/M  | PART NUMBER | DESCRIPTION                               |
|------|-----|------|-------------|---|
| 29   | 1   | EACH | WL1A12000   | WASHER, LOCK, 12mm, 8.8, PLT              |
| 28   | 23  | EACH | WL1A10000   | WASHER, LOCK, 10mm, 8.8, PLT              |
| 27   | 4   | EACH | WLA80000    | WASHER, LOCK, 8mm, 8.8, PLT               |
| 26   | 1   | EACH | WFA12000    | WASHER, FLAT, 12mm, 8.8, PLT              |
| 25   | 12  | EACH | WFA10000    | WASHER, FLAT, 10mm, 8.8, PLT              |
| 24   | 4   | EACH | WFA80000    | WASHER, FLAT, 8mm, 8.8, PLT               |
| 23   | 1   | EACH | TEN60000    | TENR, HD SPRING, BACKSIDE, CW (89204)     |
| 22   | 1   | EACH | SCD19008    | SPACER, COL DRL, 19.05mm x 19.05o x 8.33i |
| 21   | 2   | EACH | N1A80000    | NUT, HEX, 8 x 1.25, 8.8 PLT               |
| 20   | 2   | EACH | CSF10031    | CAPSCREW, FH, 10 x 1.5 x 30mm, 10.9, PLT  |
| 19   | 1   | EACH | CSB80325    | CAPSCREW, BH, 10 x 1.5 x 25mm, 10.9, PLT  |
| 18   | 2   | EACH | CLP20001    | CLAMP, GEAR, #20, 3/4-1 3/4 (19/44mm)     |
| 17   | 1   | EACH | BTC12090    | BOLT, HEX, 12 x 1.75 x 90mm, 10.9, PLT    |
| 16   | 2   | EACH | BTC10140    | BOLT, HEX, 10 x 1.5 x 140mm, 10.9, PLT    |
| 15   | 2   | EACH | BTC10095    | BOLT, HEX, 10 x 1.5 x 95mm, 10.9, PLT     |
| 14   | 4   | EACH | BTC10070    | BOLT, HEX, 10 x 1.5 x 70mm, 10.9, PLT     |
| 13   | 2   | EACH | BTC10055    | BOLT, HEX, 10 x 1.5 x 55mm, 10.9, PLT     |
| 12   | 9   | EACH | BTC10030    | BOLT, HEX, 10 x 1.5 x 30mm, 10.9, PLT     |
| 11   | 4   | EACH | BTC10025    | BOLT, HEX, 10 x 1.5 x 25mm, 10.9, PLT     |
| 10   | 1   | EACH | BTC08035    | BOLT, HEX, 8 x 1.25 x 35mm, 10.9, PLT     |
| 9    | 3   | EACH | BTC08030    | BOLT, HEX, 8 x 1.25 x 30mm, 10.9, PLT     |
| 8    | 1   | EACH | BMZ00028    | BKT, UNIVERSAL HOSE & CABLE CLAMP         |
| 7    | 2   | EACH | BMC67069    | BKT, ANGLE, BRACE, HANGER, HOSE, 2010     |
| 6    | 1   | EACH | BMC67066    | BKT, SHROUD, COVER, 12 GA, ISB, F400, '10 |
| 5    | 1   | EACH | BMC67064    | BKT, MAIN, WELDMT, 6.7L, ISB, F400, '10   |
| 4    | 1   | EACH | BMC67063    | BKT, ALT, BAR, ISB, F400, BBCV, '10       |
| 3    | 1   | EACH | BMC67062    | BKT, MAIN, VERT, WELDMT, ISB, F400, '10   |
| 2    | 1   | EACH | BMC67036    | BKT, PI, BRACE, ISB, F400, '09            |
| 1    | 1   | EACH | BEL15111    | BELT, 6gr, 1511mm (59") (5060595)         |

BILL OF MATERIALS

|   |                                      |           |     |                           |           |   |
|---|--------------------------------------|-----------|-----|---------------------------|-----------|---|
| 1   | REVISED BMC67061 WAS QTY 11 BMC67069 | 2/2/2011  | VAL | DRAWN<br>vjakovlew        | 1/18/2011 |   |
| 2   | RELEASED TO PRODUCTION               | 1/18/2011 | VAL | CHECKED<br>Jose Rodriguez | 1/18/2011 |   |
| REV/EN  | DESCRIPTION:                         | DATE:     | BY: | APPROVED<br>James Stewart | 1/18/2011 |   |
| THIS DRAWING CONTAINS PROPRIETARY CONFIDENTIAL INFORMATION OWNED BY TRANSARGTIC CANADA INC. THE DOCUMENT AND THE INFORMATION IN IT ARE NOT TO BE USED, DISCLOSED OR REPRODUCED WITHOUT EXPRESS WRITTEN PERMISSION OF THE COMPANY. |                                      |           |     |                           |           | TITLE<br><b>MT KIT, 6.7L ISB, BBCV, F400, '10</b> |
| UNSPECIFIED TOLERANCES:<br>ONE DECIMAL PLACE (X) .10 MM<br>THIRDS DECIMAL PLACE (XXX) .005 MM<br>FRACTIONAL (1/16) .031 MM  |                                      |           |     |                           |           | SIZE<br>D<br>SCALE 1:4                            |
| THIRD ANGLE PROJECTION  |                                      |           |     |                           |           | DWG NO<br><b>KMC62571</b>                         |
| DRAWING UNIT OF MEASURE: MM (INCH)  |                                      |           |     |                           |           | REV<br>1  |
| SHEET 1 OF 1  |                                      |           |     |                           |           |   |

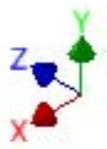
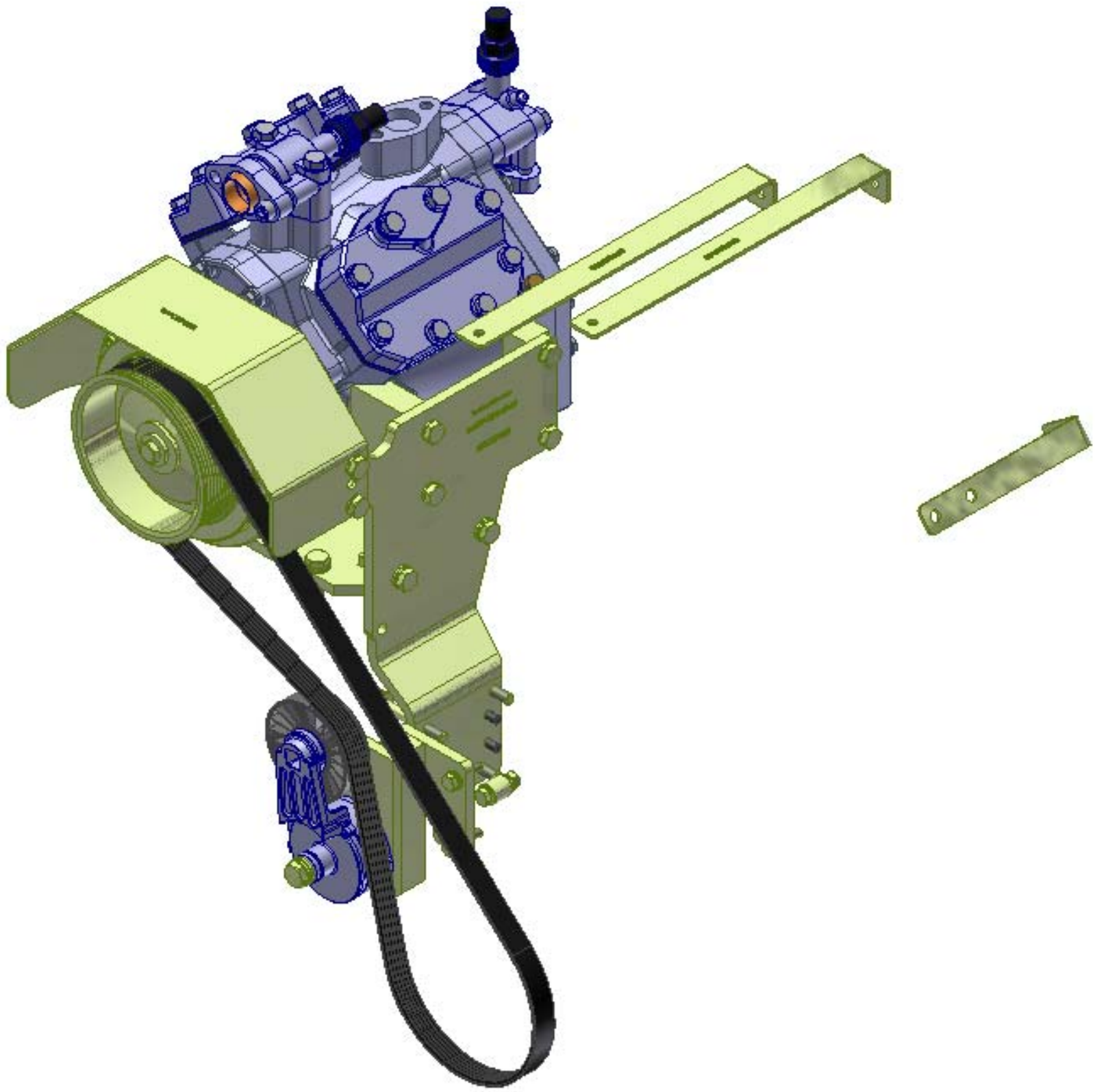

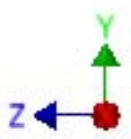
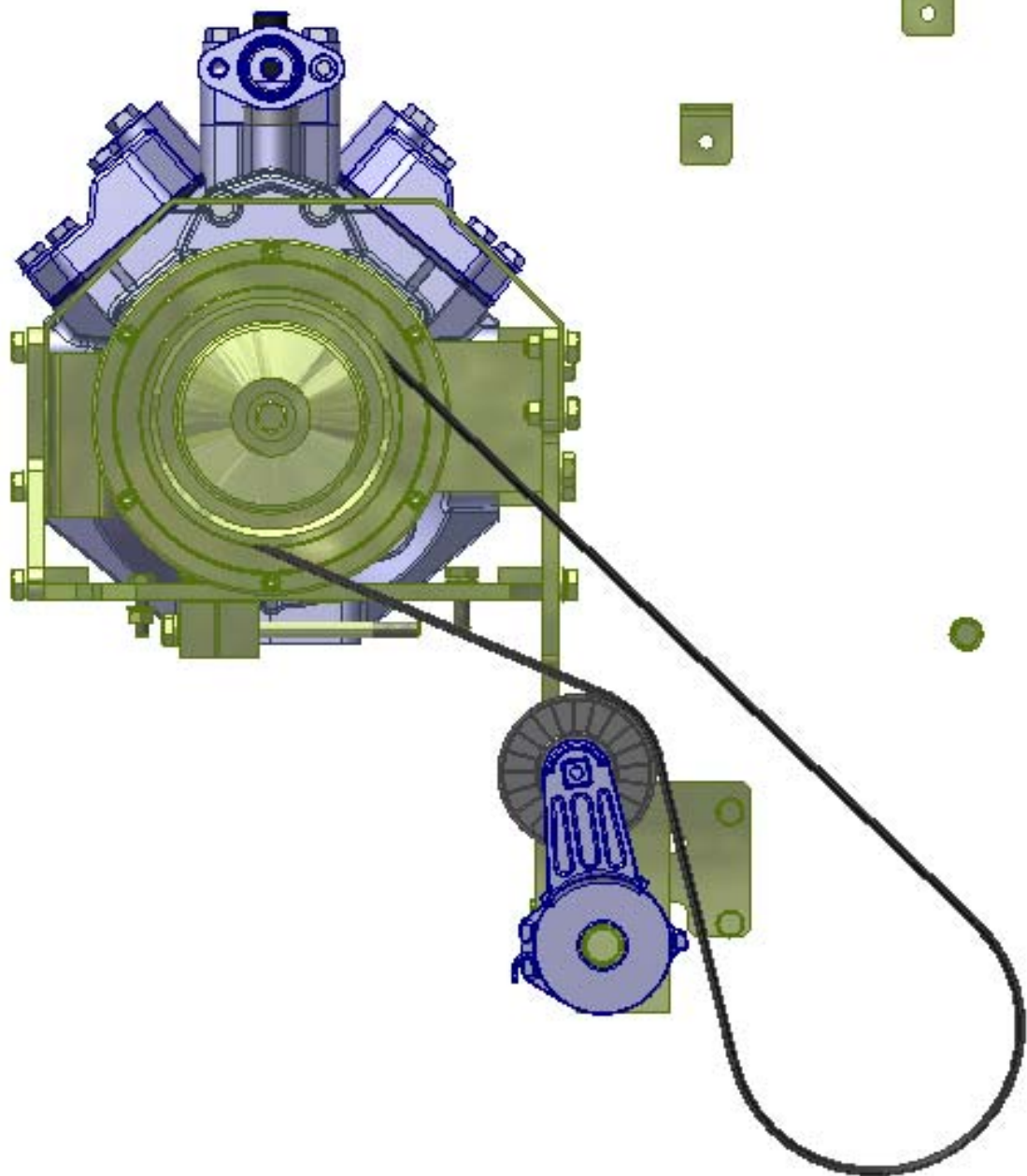

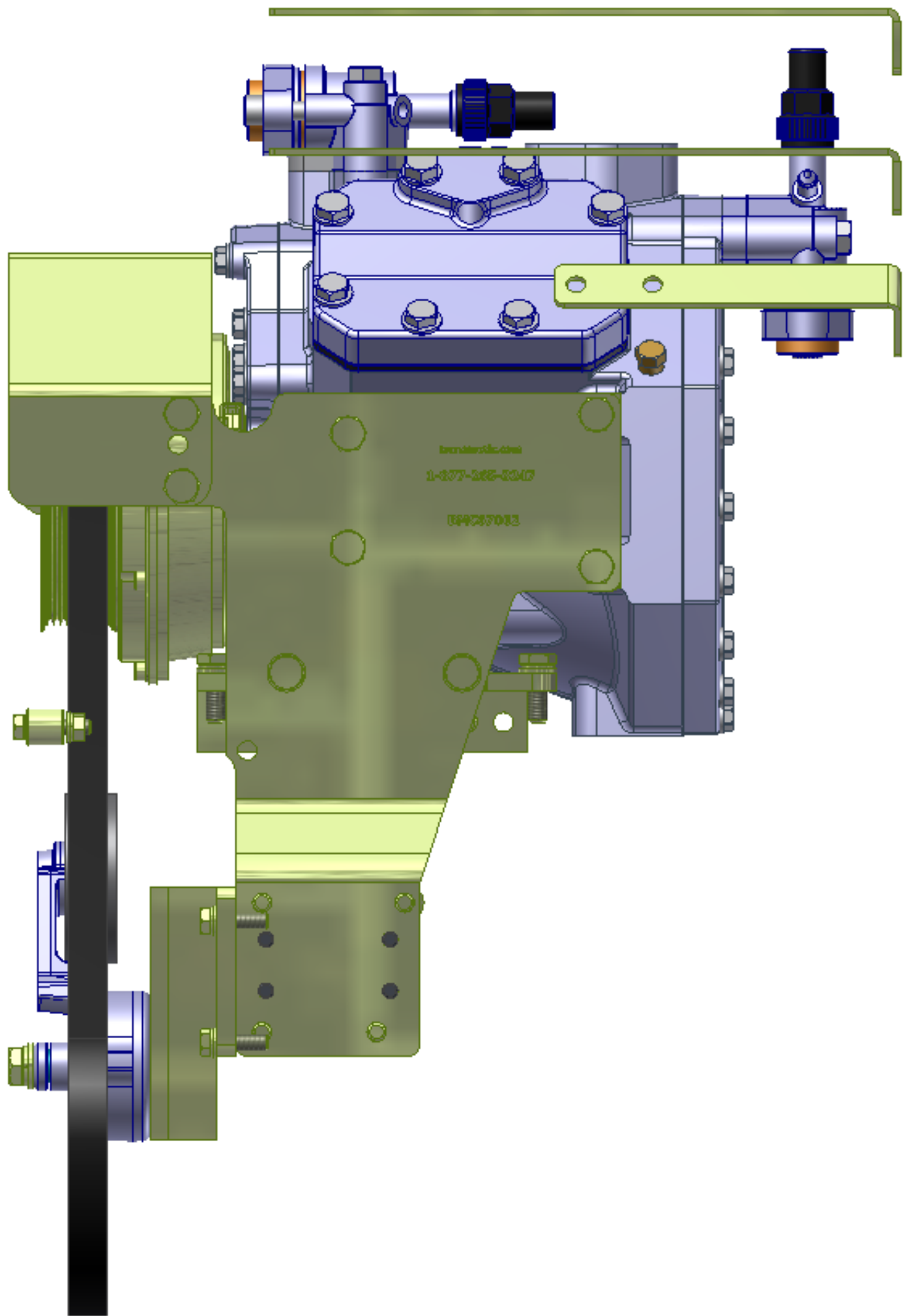

brndt@kic.com  
1-877-366-3347  
04027012

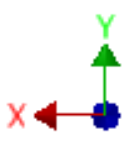

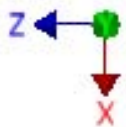
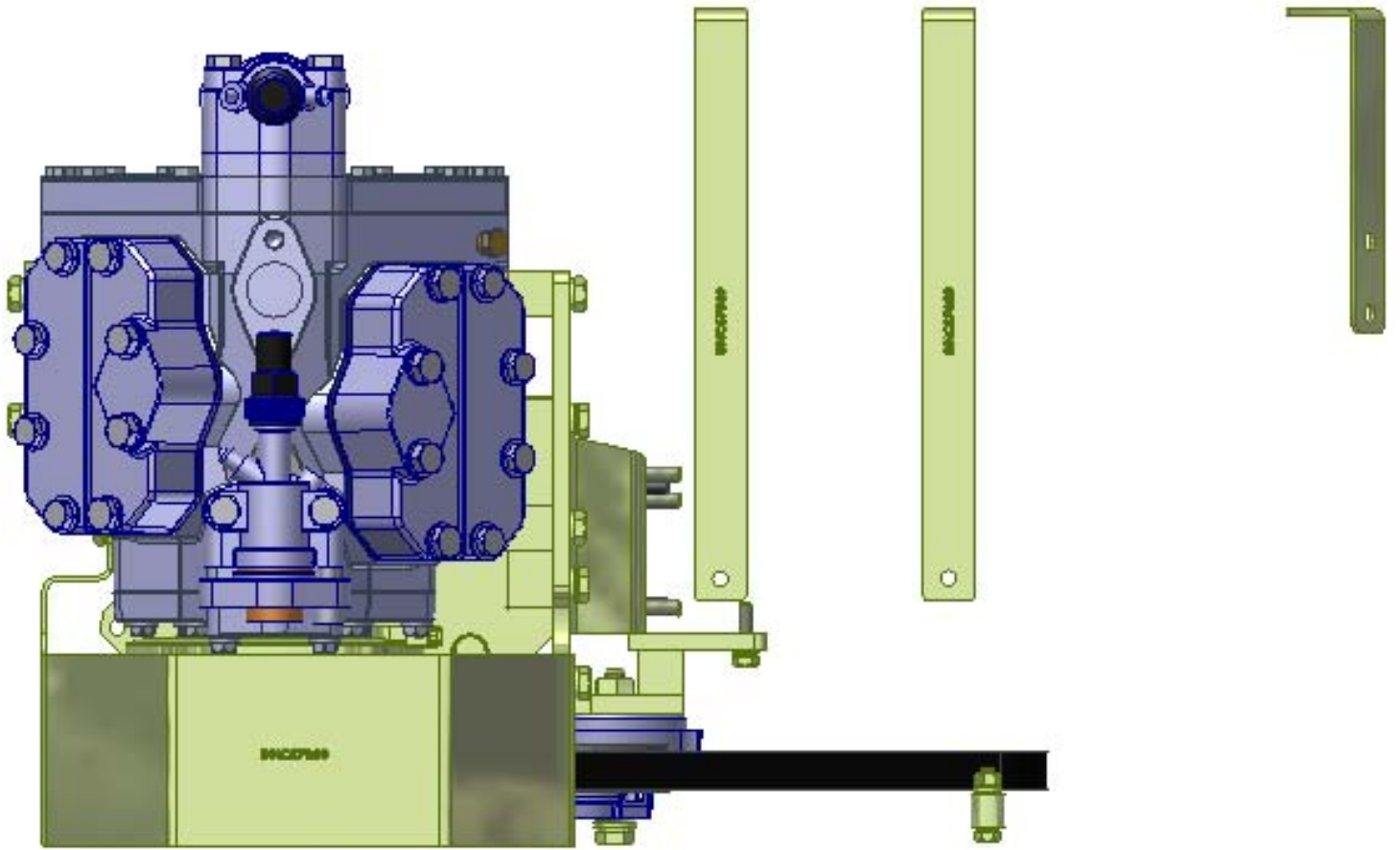

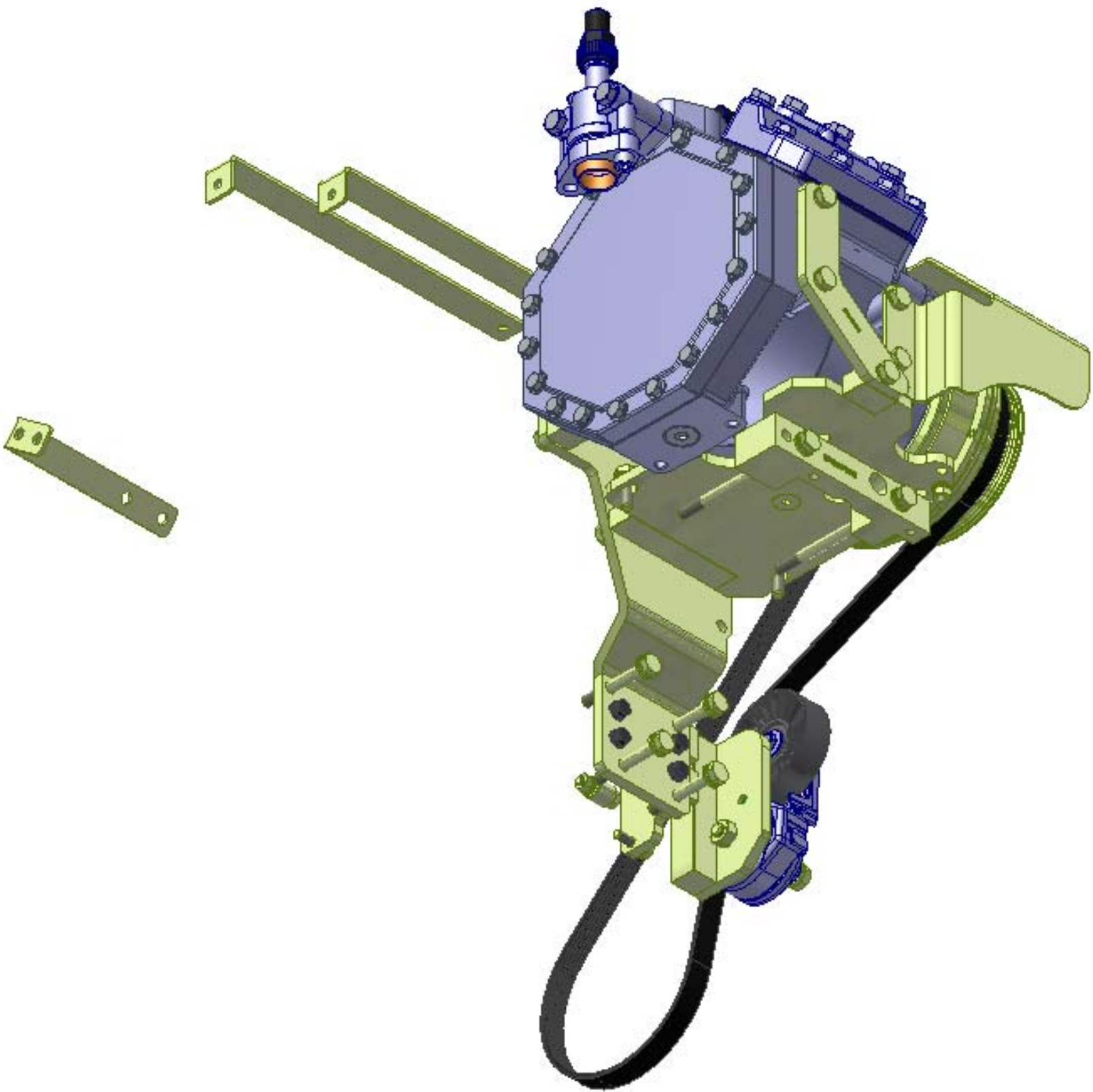



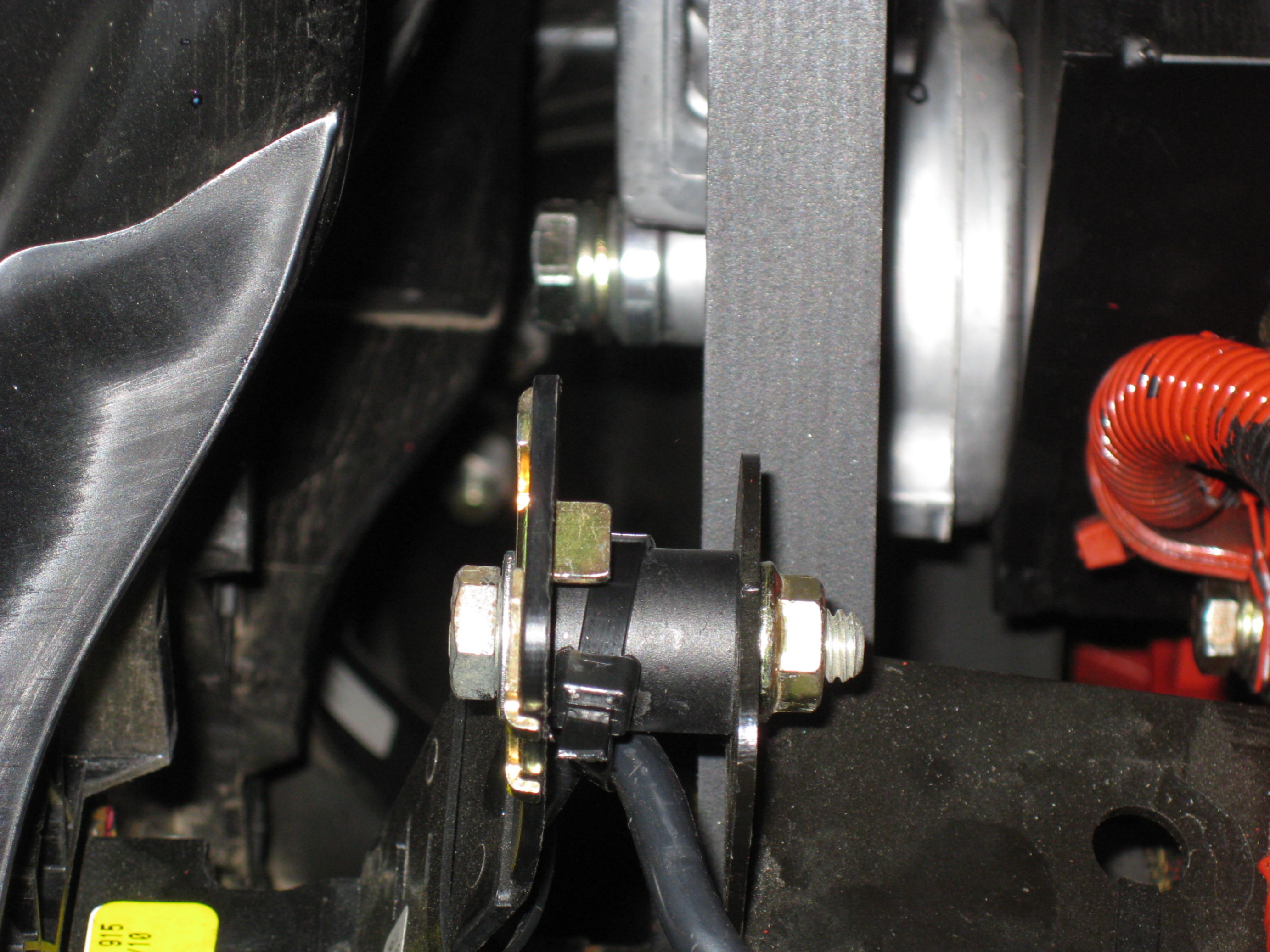

915  
110

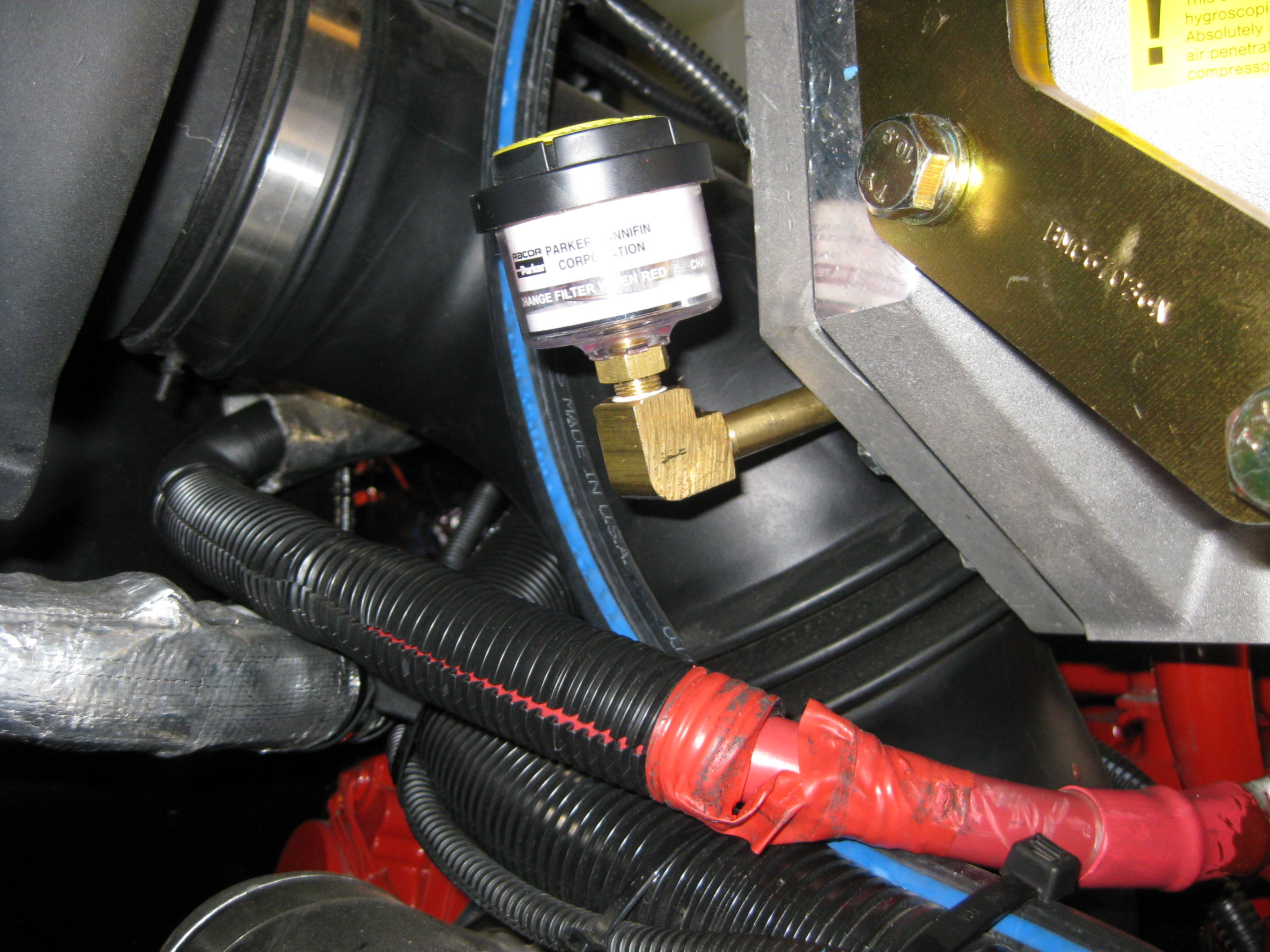

RACOR PARKER HANNIFIN CORPORATION  
CHANGE FILTER WHEN RED

! This is a hygroscopic  
Absolutely  
air penetrat  
compressor

REPLACE EXISITING M8 HEX HEAD BOLT & WASHER WITH CSB08035.  
(BUTTON HD.) AND TORQUE TO 20-25 FT\*LBS.

LOOSEN FITTING & RELOCATE  
LINE AS SHOWN.

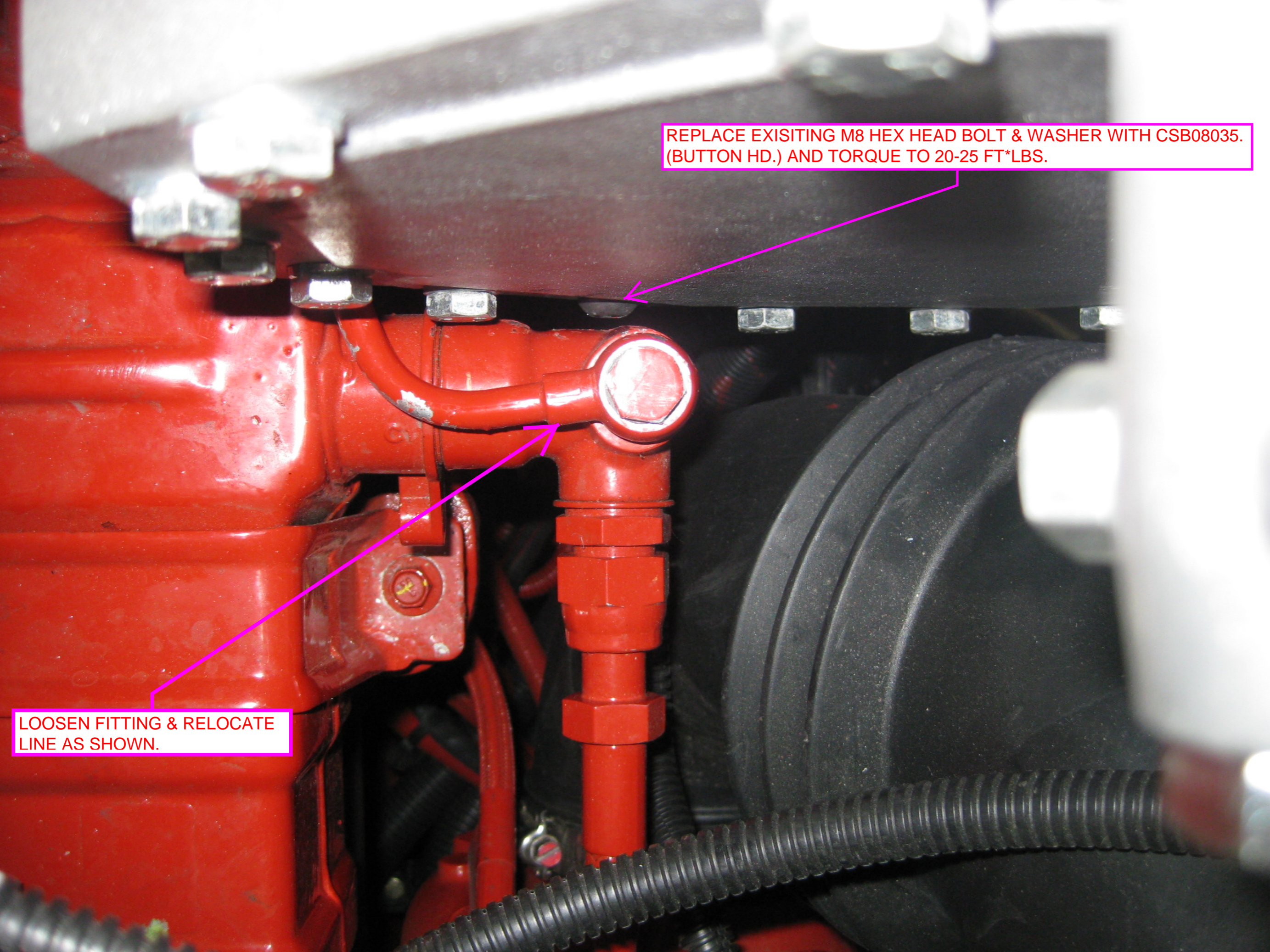

2x BMC67069

POWER STEERING  
RESERVOIR  
FILL WITH FINE  
MULTI-PURPOSE ATF

BMZ00028

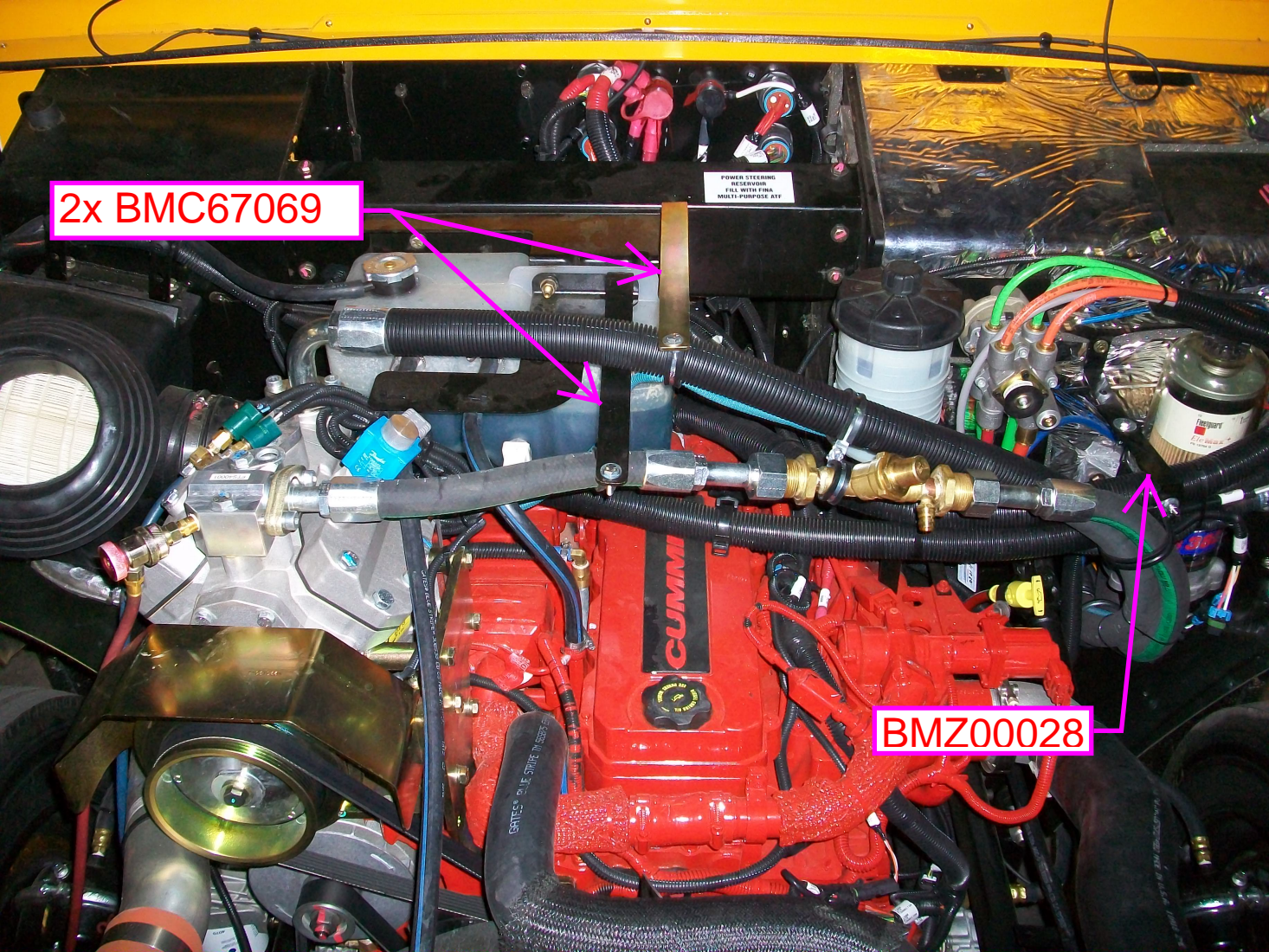

## **TransArctic A/C Compressor Mount Installation Disclaimer**

All compressor mounts should be installed by qualified and trained personnel using proper tools and equipment in safe working conditions following industry standard guidelines for motor vehicle service and repair.

The installer of any compressor mount purchased from TransArctic must undertake all responsibility of issues arising from that compressor bracket being installed on any vehicle. As well as insure that a **proper and sufficient ground** is established between the compressors' clutches and the vehicle's engine. Mount functionality, operation and durability can all be compromised by an incompetent installation.

Due to the many different situations, parameters and application criteria, which are beyond the compressor mount manufacturer's control, TransArctic does not warrant design, durability, or operational functionality of any compressor mount improperly installed by another party.

**With no implied guarantees it is the mount installer's strict responsibility to determine safety and functionality, of the compressor mount, at the time of installation.**

Please contact TransArctic with any issue arising from installation so we may better improve the product. If you have any reservations about the compressor mount integrity contact TransArctic immediately at 1-877-COLD-AIR.

**Mark OEM tensioner location**

**Install Kit**

**Check for Interferences**

**Check to ensure that the proper OEM tensioner orientation is maintained**

**Run engine with A/C system engaged for at least 10 minutes to run in belt**

**Check OEM tensioner orientation and adjust as required**

### **Responsabilidad limitada de TransArctic en la instalación del soporte del compresor**

Todos los soportes de los compresores deben ser instalados por personas calificadas y entrenadas, usando para ello los equipos y herramientas necesarios para esta labor en buenas condiciones y según las normas y guías para el servicio y/o reparación de motores de vehículos.

El instalador de los soportes comprados en TransArctic asume toda la responsabilidad de cualquier problema que surga en el soporte del compresor al vehículo; de igual manera es responsable que el cable a tierra sea conectado entre el embrague del compresor y el motor del vehículo.

Se advierte que el buen funcionamiento y la durabilidad del soporte pueden ser comprometidos por defectos en su instalación.

Debido a las diversas situaciones que se puedan presentar fuera del control del fabricante, TransArctic no garantiza el diseño, la durabilidad o el correcto funcionamiento de cualquier equipo inapropiadamente instalado por terceros.

**Esta sobreentendido que el Instalador del montaje del compresor es estrictamente responsable de la seguridad y funcionamiento del equipo en el momento de la instalación.**

Si tuviera algún problema o duda acerca de la instalación del soporte del compresor pongase en contacto inmediatamente con TransArctic al teléfono 1-877-COLD-AIR de modo que podamos mejorar nuestro producto.

**Note la ubicación del medidor de tensión OEM**

**Instale el equipo**

**Controlar si hay interferencias.**

**Asegure que el medidor de tensión mantenga la orientación justa.**

**Encienda el motor por lo menos 10 minutos con el sistema A/C enganchado para que la correa corra**

**Controle la orientación justa del medidor de tensión y ajuste a las condiciones requeridas del fabricante**