

Bill of Materials Listing

TransArctic Canada Inc.

5/16/2012
Page 1 of 1

Product Number	Description	Date	Weight	Uof M	Yield
Line	Component Prod#	Bin	Unit	Qty	
KMC82560	Mt Kit, ISC, D3RE, 7" Tri Combo Fan, '12	04/11/12	105.54		0
10	BEL81537		Belt, 8gr, 1537mm (60.5") (5080605)	each	1
20	BEL81842		Belt, 8gr, 1842mm (72.5") (5080725)	each	1
30	BMC83011		Bkt, Brace, RR, Tenr, ISC, 8.3L, P8	each	1
40	BMC83045		Bkt, Main, Weldmt, ISC, 8.3L, 09'	each	1
50	BMC83046		Bkt, Brace, P/S, 8.3L, 09'	each	1
60	BMC83098		Bkt, Adapter, PI, ISC, F400, D3RE, '12	each	1
70	BMC83099		Bkt, Comp, FRT Bar, Bitzer, D3RE,CFP,'12	each	1
80	KAC82560		Alt. Kit, 24V, ISC, A3RE, '12	each	1
90	PUL80076		Pulley, Idler, Backside, P8, 76d (89101)	each	1
100	PUL81074		Pulley, Idler, Frontside, P8,74d (89103)	each	1
110	PUL83868		Pulley, Fan, Add-on, Tri Combo,ISC,8/6/8	each	1
120	SCD57210		Spacer, Col, Drl,57.15mm x28.58o x10.32i	each	1
130	SLV17010		Sleeve, Pulley, 16.9o x 22.23mm x 10.32i	each	2
140	TEN80002		Tenr, HD Spring, BackSide, CCW (89200A)	each	1
150	KBC82560		Bag Kit, Fasteners, KMC82560	each	1

Bill of Materials Listing

TransArctic Canada Inc.

5/16/2012
Page 1 of 1

Product Number	Description	Date	Weight	Uof M	Yield
Line	Component Prod#	Bin	Unit	Qty	
KBC82560	Bag Kit, Fasteners, KMC82560		05/02/12	1.82	0
10	BTC08030		Bolt, Hex, 8 x 1.25 x 30mm, 10.9, Plt,FT	each	6
20	BTC10030		Bolt, Hex, 10 x 1.5 x 30mm, 10.9, Plt	each	2
30	BTC10040		Bolt, Hex, 10 x 1.5 x 40mm, 10.9, Plt,FT	each	3
40	BTC10090		Bolt, Hex, 10 x 1.5 x 90mm, 10.9, Plt	each	1
50	BTC10100		Bolt, Hex, 10 x 1.5 x 100mm, 10.9,Plt,FT	each	1
60	BTS10001		Bolt, Shoulder, 10mm (89064)	each	1
69	CSF10061		Capscrew, FH, 10 x 1.5 x 60mm, 10.9,Plt	each	2
70	CSF10041		Capscrew, FH, 10 x 1.5 x 40mm, 10.9,Plt	each	1
80	CSF10031		Capscrew, FH, 10 x 1.5 x 30mm, 10.9,Plt	each	2
90	CSF08300		Capscrew, FH, 1/2-13 x 3", Alloy, Plt	each	2
100	CSS10055		Capscrew, SH, 10 x 1.5 x 55mm, 12.9,Plt	each	1
110	NTA10000		Nut, Hex, 10 x 1.5, 8.8, Plt	each	2
120	NTA12000		Nut, Hex, 12 x 1.75, 8.8, Plt	each	2
130	WFA08000		Washer, Flat, 8mm, 8.8, Plt	each	6
140	WFA10000		Washer, Flat, 10mm, 8.8, Plt	each	2
150	WFA12000		Washer, Flat, 12mm, 8.8, Plt	each	4
160	WLA08000		Washer, Lock, 8mm, 8.8, Plt	each	6
170	WLA10000		Washer, Lock, 10mm, 8.8, Plt	each	8
180	WLA12000		Washer, Lock, 12mm, 8.8, Plt	each	4

Bill of Materials Listing

TransArctic Canada Inc.

5/16/2012
Page 1 of 1

Product Number	Description	Date	Weight	Uof M	Yield
Line Component Prod# Description	Bin	Unit	Qty		
KAC82560	Alt. Kit, 24V, ISC, A3RE, '12	04/26/12	44.61		0
10 BEL61537	Belt, 6gr, 1537mm (60.5") (5060605)	each	1		
20 BMC83100	Bkt, Main, Alt, Weldm't, ISC, A3RE, '12	each	1		
30 BMC83102	Bkt, BTM, Alt, Weldm't, ISC, A3RE, '12	each	1		
40 BMZ00029	BKT, UNIVER, HOSE/CABLE, MT, U/S CHASε	each	1		
50 PUL80064	Pulley,ALT,Frontside,P8,63.5d (3972808)	each	1		
60 PUL80076	Pulley, Idler, Backside, P8, 76d (89101)	each	1		
70 PUL81074	Pulley, Idler, Frontside, P8,74d (89103)	each	1		
80 SCD54010	Spacer, Col, Drl, 54mm x 28.58o x 10.32i	each	1		
90 SLV17010	Sleeve, Pulley, 16.9o x 22.23mm x 10.32i	each	1		
100 TEN80001	Tenr, HD Spring, BackSide, CW (89200D)	each	1		
110 KBA82560	Bag Kit, Fasteners, KAC82560	each	1		

Bill of Materials Listing

TransArctic Canada Inc.

5/16/2012
Page 1 of 1

Product Number	Description	Date	Weight	Uof M	Yield
Line	Component Prod#	Bin	Unit	Qty	
KBA82560	Bag Kit, Fasteners, KAC82560	04/26/12	2.26		0
10	BTC08035		Bolt, Hex, 8 x 1.25 x 35mm, 10.9, Plt,FT	each	6
20	BTC08065		Bolt, Hex, 8 x 1.25 x 65mm, 10.9, Plt	each	2
30	BTC10040		Bolt, Hex, 10 x 1.5 x 40mm, 10.9, Plt,FT	each	8
40	BTC10090		Bolt, Hex, 10 x 1.5 x 90mm, 10.9, Plt	each	1
50	BTC10100		Bolt, Hex, 10 x 1.5 x 100mm, 10.9,Plt,FT	each	1
60	BTQ08150		Bolt, Hex, 1/2-13unc, 1.5", 8, Plt	each	1
70	BTQ08653		Bolt, Hex, 1/2-13unc, 6.5", 8, Plt	each	1
80	BTS10001		Bolt, Shoulder, 10mm (89064)	each	1
90	NTA10000		Nut, Hex, 10 x 1.5, 8.8, Plt	each	9
100	NTQ08000		Nut, Hex, 1/2-13unc, 8, Plt	each	1
110	WFA08000		Washer, Flat, 8mm, 8.8, Plt	each	6
120	WFA10000		Washer, Flat, 10mm, 8.8, Plt	each	16
130	WFQ08000		Washer, Flat, 1/2", 8, Plt	each	3
140	WLA08000		Washer, Lock, 8mm, 8.8, Plt	each	8
150	WLA10000		Washer, Lock, 10mm, 8.8, Plt	each	10
160	WLQ08000		Washer, Lock, 1/2", 8, Plt	each	2

8 7 6 5 4 3 2 1

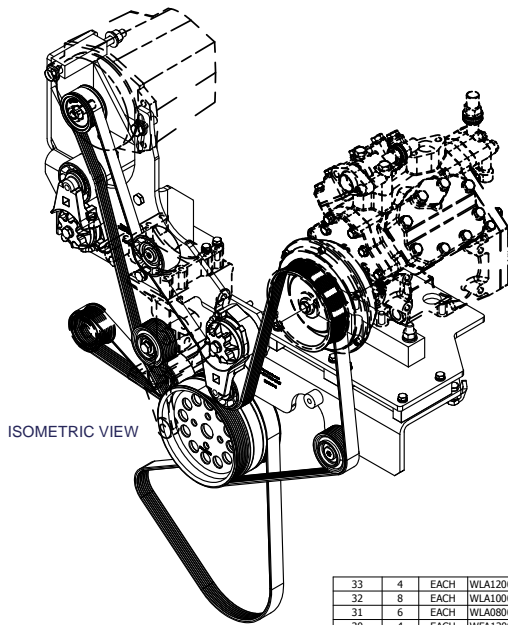
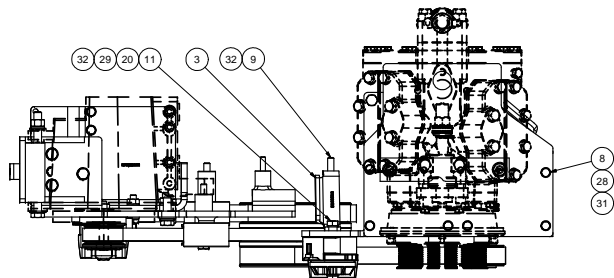

ISOMETRIC VIEW

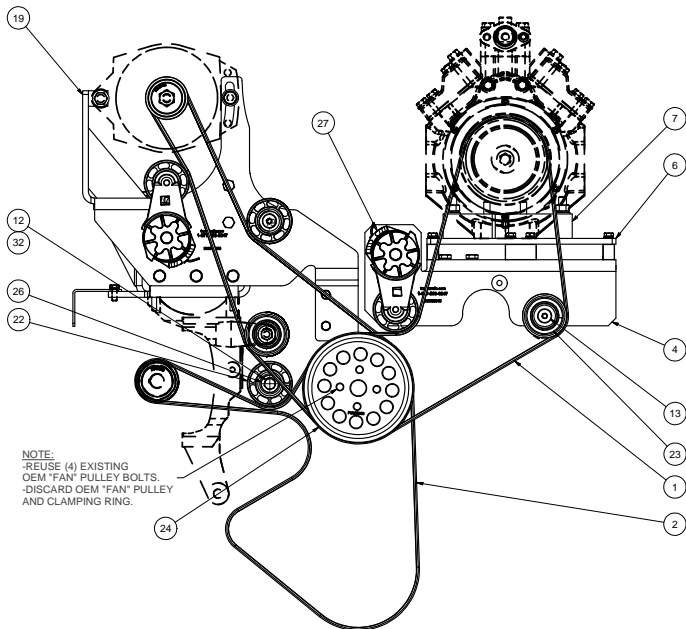

NOTE:
-REUSE (4) EXISTING
OEM "FAN" PULLEY BOLTS.
-DISCARD OEM "FAN" PULLEY
AND CLAMPING RING.

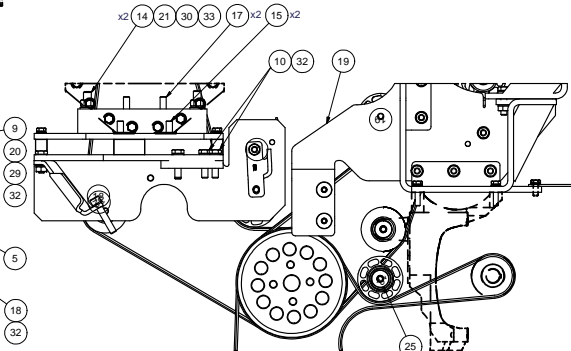
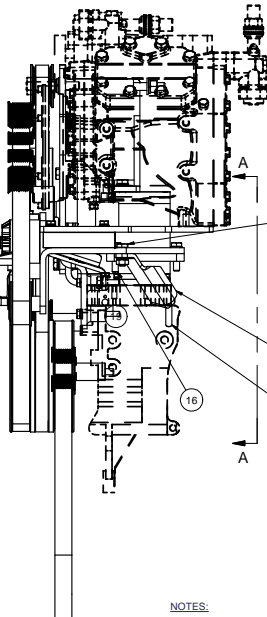

VIEW A-A
SCALE 1 / 4

ITEM	QTY	U/M	PART NUMBER	DESCRIPTION
33	4	EACH	WLA12000	WASHER, LOCK, 12mm, 8.8, PLT
32	8	EACH	WLA10000	WASHER, LOCK, 10mm, 8.8, PLT
31	6	EACH	WLA08000	WASHER, LOCK, 8mm, 8.8, PLT
30	4	EACH	WFA12000	WASHER, FLAT, 12mm, 8.8, PLT
29	2	EACH	WFA10000	WASHER, FLAT, 10mm, 8.8, PLT
28	6	EACH	WFA08000	WASHER, FLAT, 8mm, 8.8, PLT
27	1	EACH	TEN80002	TENR, HD SPRING, BACKSIDE, CCW
26	2	EACH	SLV17010	SLEEVE, PULLEY, 16.90 x 22.23mm x 10.32i
25	1	EACH	SCD57210	SPACER, COL, DRL, 57.15mm x28.58o x10.32i
24	1	EACH	PUL83868	Pulley, Fan, Add-on, Tri Combo, ISC, 8/6/8gr
23	1	EACH	PUL81074	PULLEY, IDLER, FRONTSIDE, P8, 74d x 39w
22	1	EACH	PUL80076	PULLEY, IDLER, BACKSIDE, P8, 76D, 39W
21	2	EACH	NTA12000	NUT, HEX, 12 x 1.75, 8.8, PLT
20	2	EACH	NTA10000	NUT, HEX, 10 x 1.5, 8.8, PLT
19	1	EACH	KAC82560	Alt. Kit, 24V, ISC, A3RE, 12
18	1	EACH	CSS10055	CAPSCREW, SH, 12 x 1.25 x 55mm, 12.9, PLT
17	2	EACH	CSF10061	CAPSCREW, FH, 10 x 1.5 x 60mm, 10.9, PLT
16	1	EACH	CSF10041	CAPSCREW, FH, 10 x 1.5 x 40mm, 10.9, PLT
15	2	EACH	CSF10031	CAPSCREW, FH, 10 x 1.5 x 30mm, 10.9, PLT
14	2	EACH	CSF08300	CAPSCREW, FH, 1/2-13 x 3", 9, PLT
13	1	EACH	BTS10001	BOLT, SHOULDER, 10mm (IDLER PULLEY)
12	1	EACH	BTC10100	BOLT, HEX, 10 x 1.5 x 100mm, 10.9, PLT
11	1	EACH	BTC10090	BOLT, HEX, 10 x 1.5 x 90mm, 10.9, PLT
10	3	EACH	BTC10040	BOLT, HEX, 10 x 1.5 x 40mm, 10.9, PLT
9	2	EACH	BTC10030	BOLT, HEX, 10 x 1.5 x 30mm, 10.9, PLT
8	6	EACH	BTC08030	BOLT, HEX, 8 x 1.25 x 30mm, 10.9, PLT
7	1	EACH	BMC83099	BKT, COMP, FRT BAR, BITZER,D3RE, CFP, '12
6	1	EACH	BMC83098	BKT, ADAPTER, PL, ISC, F400, D3RE, '12
5	1	EACH	BMC83046	BKT, BRACE, P/S, 8.3L, 09'
4	1	EACH	BMC83045	BKT, MAIN, WELDMT, ISC, 8.3L, 09'
3	1	EACH	BMC83011	BKT, BRACE, RR, TENR, ISC, 8.3L, P8
2	1	EACH	BEL81842	BELT, 8gr, 1842mm (72.5") (S080725)
1	1	EACH	BEL1537	BELT, 8gr, 1537mm (60.5") (S080605)

NOTES:
1) USE SERVICABLE THREADLOCKER ON ALL FASTENERS TO ENGINE COMPONENTS AND TORQUE ALL BOLTS TO S.A.E. SPECIFICATIONS.
2) SEE "TRANSARTIC A/C COMPRESSOR MOUNT INSTALLATION DISCLAIMER".

BILL OF MATERIALS			
DRAWN	vjakovlew	04/11/12	
CHECKED	Jose Rodriguez	04/26/12	
RELEASED TO PRODUCTION	GA	11/3/2011	
DATE	BY	VAL	
REV	DESCRIPTION	DATE	TITLE
1	James Stewart	04/26/12	MT, KIT, ISC, D3RE, 7" Combo Fan, '12
2	James Stewart	04/26/12	
3	James Stewart	04/26/12	
4	James Stewart	04/26/12	
5	James Stewart	04/26/12	
6	James Stewart	04/26/12	
7	James Stewart	04/26/12	
8	James Stewart	04/26/12	
9	James Stewart	04/26/12	
10	James Stewart	04/26/12	
11	James Stewart	04/26/12	
12	James Stewart	04/26/12	
13	James Stewart	04/26/12	
14	James Stewart	04/26/12	
15	James Stewart	04/26/12	
16	James Stewart	04/26/12	
17	James Stewart	04/26/12	
18	James Stewart	04/26/12	
19	James Stewart	04/26/12	
20	James Stewart	04/26/12	
21	James Stewart	04/26/12	
22	James Stewart	04/26/12	
23	James Stewart	04/26/12	
24	James Stewart	04/26/12	
25	James Stewart	04/26/12	
26	James Stewart	04/26/12	
27	James Stewart	04/26/12	
28	James Stewart	04/26/12	
29	James Stewart	04/26/12	
30	James Stewart	04/26/12	
31	James Stewart	04/26/12	
32	James Stewart	04/26/12	
33	James Stewart	04/26/12	

8 7 6 5 4 3 2 1

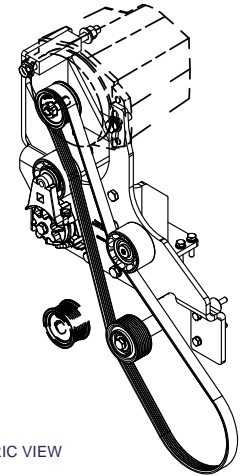
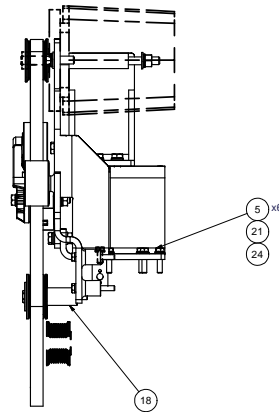
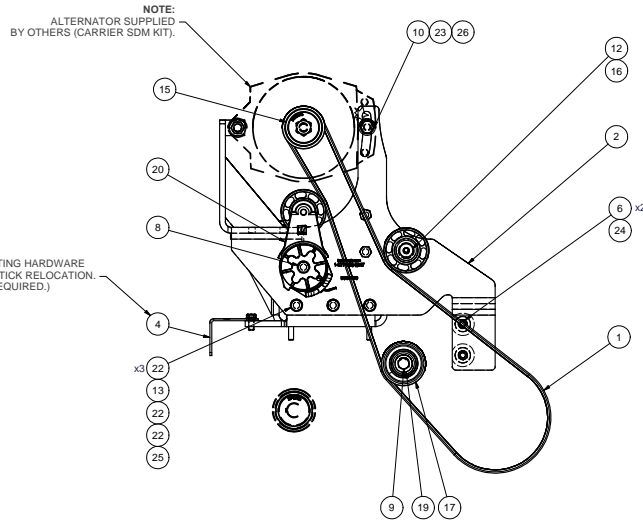
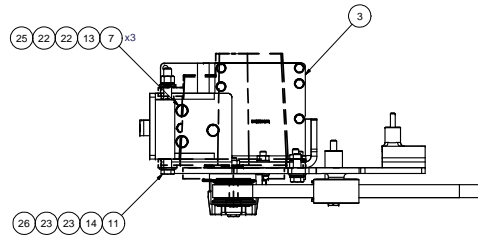

ISOMETRIC VIEW

ITEM	QTY	U/M	PART NUMBER	DESCRIPTION
26	2	EACH	WLQ08000	WASHER, LOCK, 1/2", 8, PLT
25	10	EACH	WLA10000	WASHER, LOCK, 10mm, 8.8, PLT
24	8	EACH	WLA08000	WASHER, LOCK, 8mm, 8.8, PLT
23	3	EACH	WFO08000	WASHER, FLAT, 1/2", 8, PLT
22	16	EACH	WFA10000	WASHER, FLAT, 10mm, 8.8, PLT
21	6	EACH	WFA08000	WASHER, FLAT, 8mm, 8.8, PLT
20	1	EACH	TEN80001	TENR, HD SPRING, BACKSIDE, CW
19	1	EACH	SLV17010	SLEEVE, PULLEY, 16.90 x 22.23mm x 10.32i
18	1	EACH	SCD54010	SPACER, COL, DRL, 54.01mm x28.58o x10.32i
17	1	EACH	PUL81074	PULLEY, IDLER, FRONTSIDE, P8, 74d x 39w
16	1	EACH	PUL80076	PULLEY, IDLER, BACKSIDE, P8, 76d, 39w
15	1	EACH	PUL80064	PULLEY, ALT, FRONTSIDE, P8, 63.5d (3972808)
14	1	EACH	NTQ08000	NUT, HEX, 1/2-13UNC, 8, PLT
13	9	EACH	NTA10000	NUT, HEX, 10 x 1.5, 8.8, PLT
12	1	EACH	BTS10001	BOLT, SHOULDER, 10mm (IDLER PULLEY)
11	1	EACH	BTQ08653	BOLT, HEX, 1/2-13UNC x 6.50, 8, PLT
10	1	EACH	BTQ08150	BOLT, HEX, 1/2-13UNC x 1.50, 8, PLT
9	1	EACH	BTIC0100	BOLT, HEX, 10 x 1.5 x 100mm, 10.9, PLT
8	1	EACH	BTIC0090	BOLT, HEX, 10 x 1.5 x 90mm, 10.9, PLT
7	8	EACH	BTIC0040	BOLT, HEX, 10 x 1.5 x 40mm, 10.9, PLT
6	2	EACH	BTC08065	BOLT, HEX, 8 x 1.25 x 65mm, 10.9, PLT
5	6	EACH	BTC08035	BOLT, HEX, 8 x 1.25 x 35mm, 10.9, PLT
4	1	EACH	BMZ00029	BKT, UNIVER, HOSE/CABLE, MT, U/S CHASSIS
3	1	EACH	BMCS3102	BKT, BTM, ALT, WELDMT, ISC, A3RE, 12
2	1	EACH	BMCS3100	BKT, MAIN, ALT, WELDMT, ISC, A3RE, 12
1	1	EACH	BEL61537	Belt, 6gr, 1537mm (60.5") (5080605)

BILL OF MATERIALS

TRANSARGTIG INC.

DRAWN	vjakowlew	04/12/12	
CHECKED	Jose Rodriguez	04/26/12	
RELEASED TO PRODUCTION	04/26/12	VAL	GA
REVISION	DESCRIPTION	DATE	BY
1	James Stewart	04/26/12	MFG
2	James Stewart	04/26/12	APPROVED
3	Dale Mason	04/26/12	

TITLE	Alt. Kit, 24V, ISC, A3RE, '12		
SIZE	DWG NO	REV	0
D	KAC82560		
SCALE	1:2	SHEET	1 OF 1

- NOTES:**
- 1) USE SERVICABLE THREADLOCKER ON ALL FASTENERS TO ENGINE COMPONENTS AND TORQUE ALL BOLTS TO S.A.E. SPECIFICATIONS.
 - 2) SEE "TRANSARGTIG A/C COMPRESSOR MOUNT INSTALLATION DISCLAIMER".

UNSPECIFIED TOLERANCES:	ALL DIM	±.005
ONE DECIMAL PLACE (X.0)	±.010	
TWO DECIMAL PLACE (X.00)	±.002	
FRACTIONAL (1/16")	±.001	



DRAWING UNIT OF MEASURE: MM (INCH)

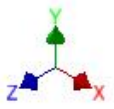
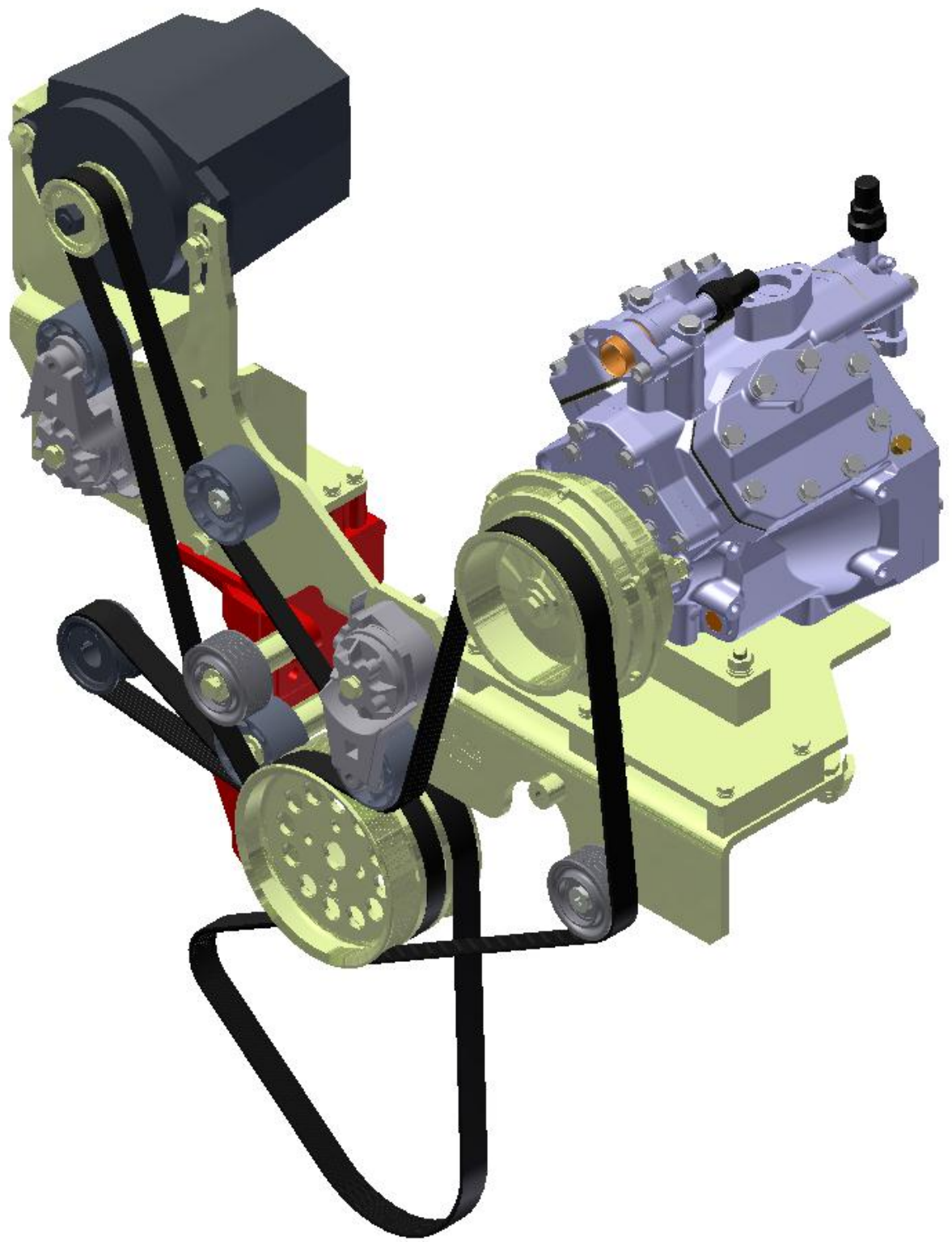

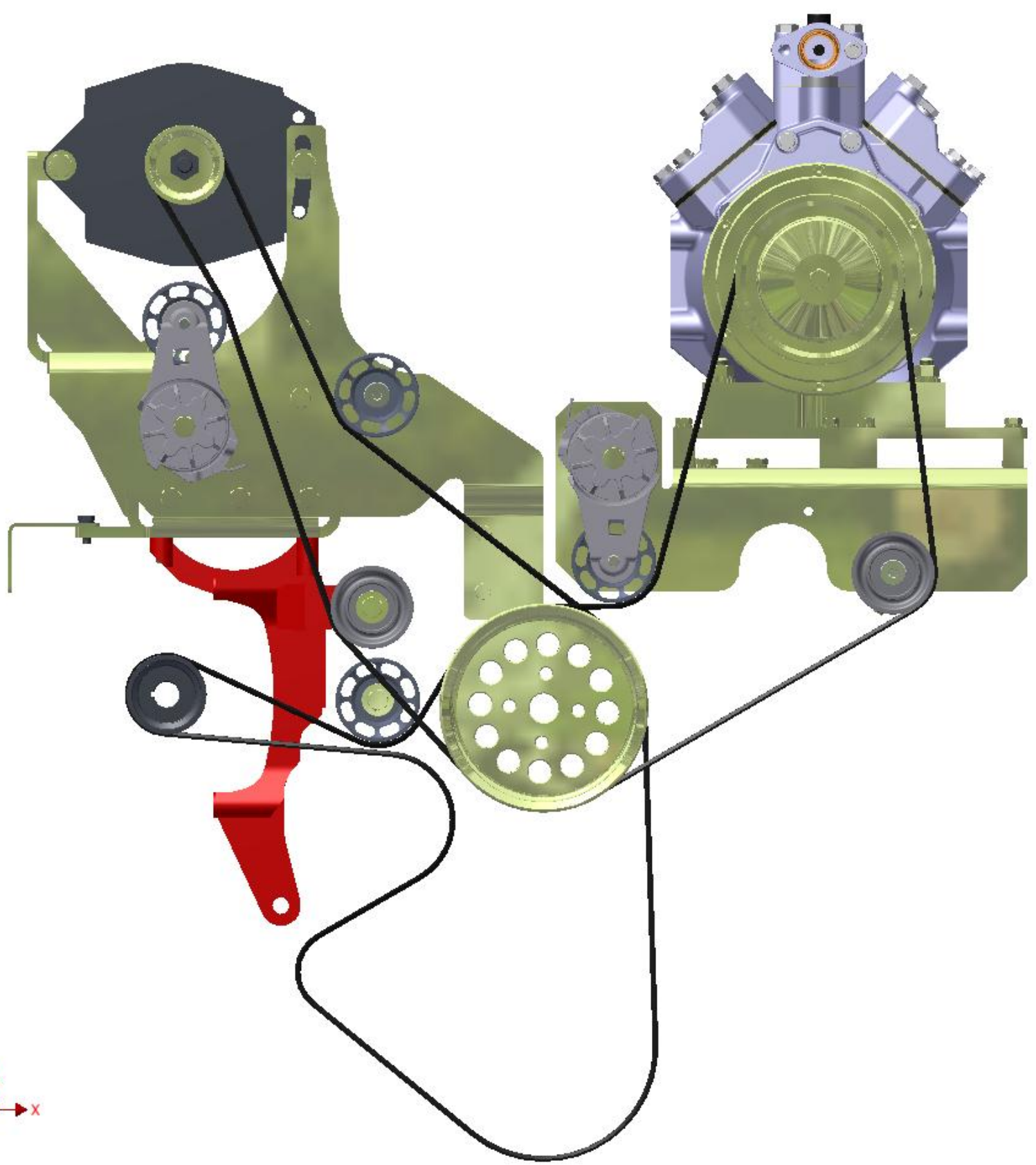

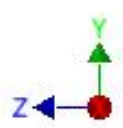
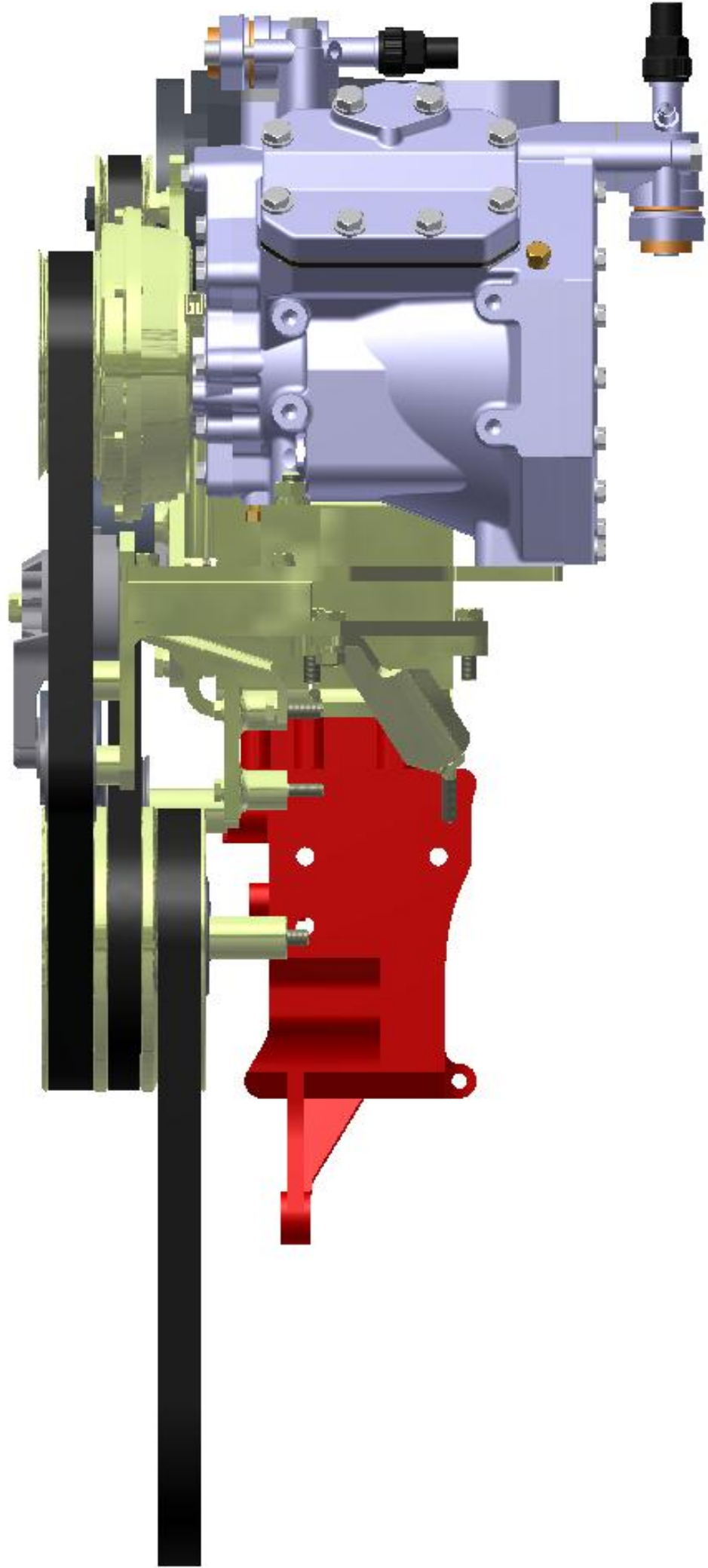

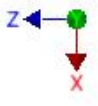
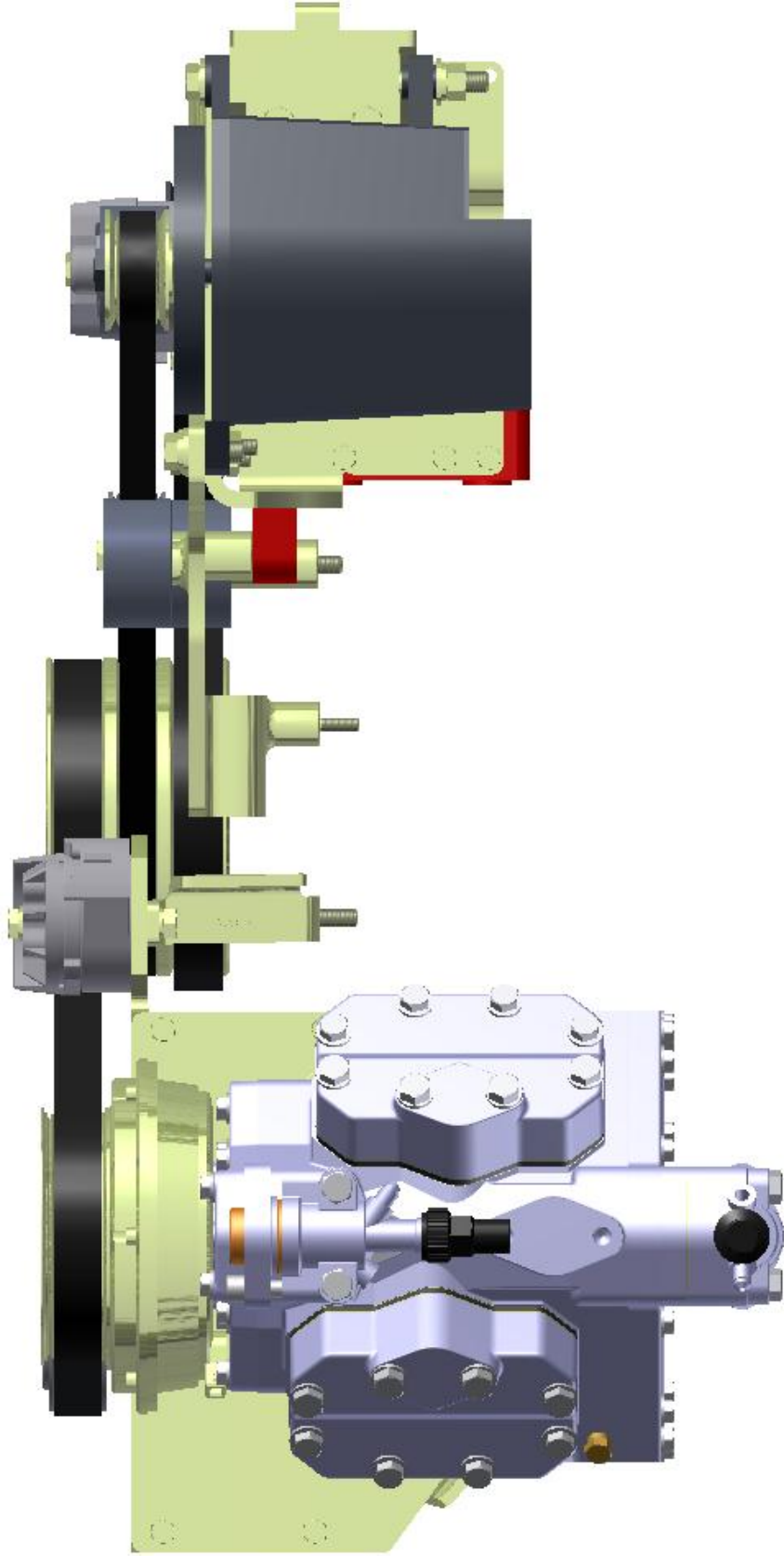

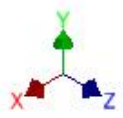
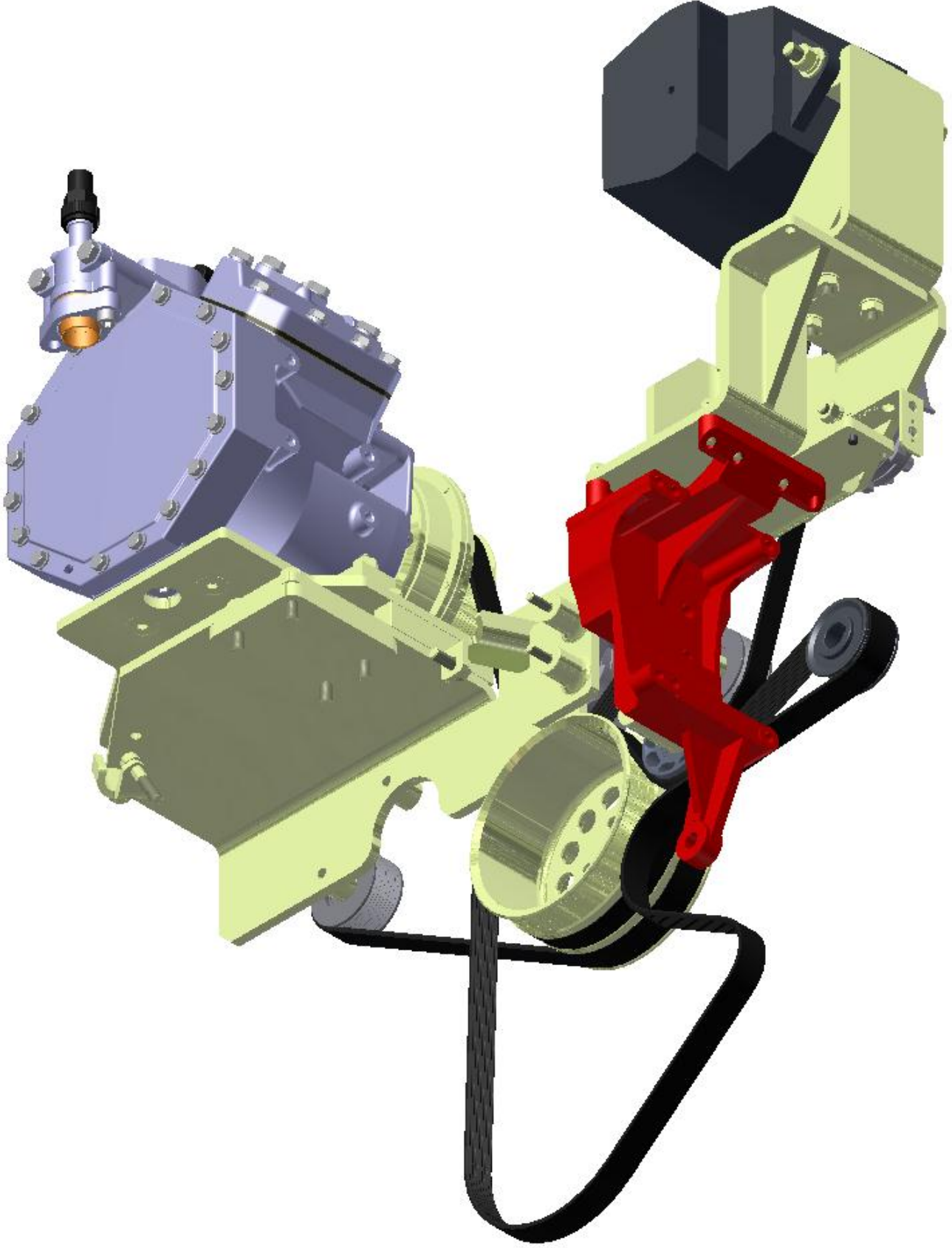

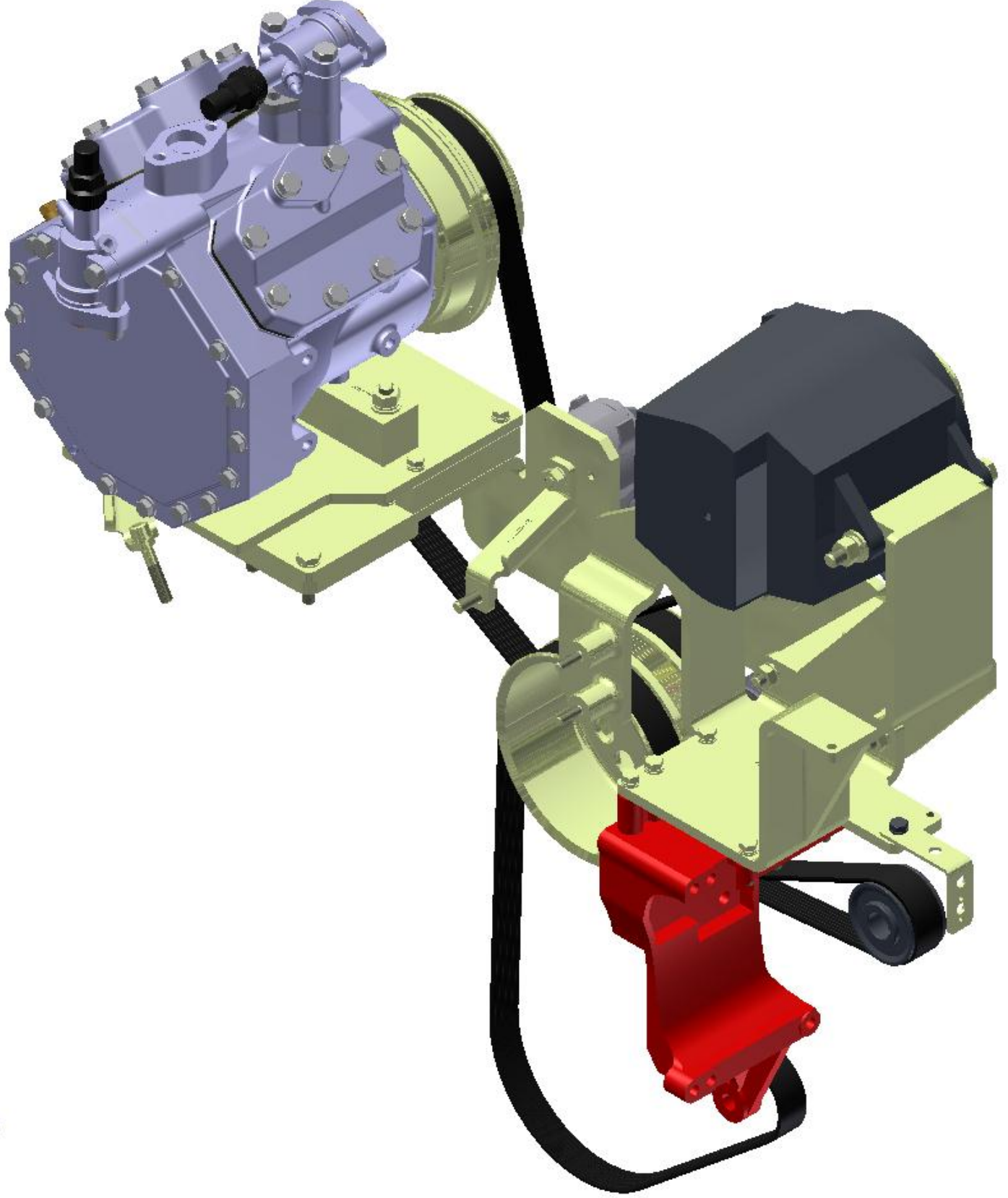

TransArctic A/C Compressor Mount Installation Disclaimer

All compressor mounts should be installed by qualified and trained personnel using proper tools and equipment in safe working conditions following industry standard guidelines for motor vehicle service and repair.

The installer of any compressor mount purchased from TransArctic must undertake all responsibility of issues arising from that compressor bracket being installed on any vehicle. As well as insure that a **proper and sufficient ground** is established between the compressors' clutches and the vehicle's engine. Mount functionality, operation and durability can all be compromised by an incompetent installation.

Due to the many different situations, parameters and application criteria, which are beyond the compressor mount manufacturer's control, TransArctic does not warrant design, durability, or operational functionality of any compressor mount improperly installed by another party.

With no implied guarantees it is the mount installer's strict responsibility to determine safety and functionality, of the compressor mount, at the time of installation.

Please contact TransArctic with any issue arising from installation so we may better improve the product. If you have any reservations about the compressor mount integrity contact TransArctic immediately at 1-877-COLD-AIR.

Mark OEM tensioner location

Install Kit

Check for Interferences

Check to ensure that the proper OEM tensioner orientation is maintained

Run engine with A/C system engaged for at least 10 minutes to run in belt

Check OEM tensioner orientation and adjust as required

Responsabilidad limitada de TransArctic en la instalación del soporte del compresor

Todos los soportes de los compresores deben ser instalados por personas calificadas y entrenadas, usando para ello los equipos y herramientas necesarios para esta labor en buenas condiciones y según las normas y guías para el servicio y/o reparación de motores de vehículos.

El instalador de los soportes comprados en TransArctic asume toda la responsabilidad de cualquier problema que surga en el soporte del compresor al vehículo; de igual manera es responsable que el cable a tierra sea conectado entre el embrague del compresor y el motor del vehículo.

Se advierte que el buen funcionamiento y la durabilidad del soporte pueden ser comprometidos por defectos en su instalación.

Debido a las diversas situaciones que se puedan presentar fuera del control del fabricante, TransArctic no garantiza el diseño, la durabilidad o el correcto funcionamiento de cualquier equipo inapropiadamente instalado por terceros.

Esta sobreentendido que el Instalador del montaje del compresor es estrictamente responsable de la seguridad y funcionamiento del equipo en el momento de la instalación.

Si tuviera algún problema o duda acerca de la instalación del soporte del compresor pongase en contacto inmediatamente con TransArctic al teléfono 1-877-COLD-AIR de modo que podamos mejorar nuestro producto.

Note la ubicación del medidor de tensión OEM

Instale el equipo

Controlar si hay interferencias.

Asegurese que el medidor de tensión mantenga la orientación justa.

Encienda el motor por lo menos 10 minutos con el sistema A/C enganchado para que la correa corra

Controle la orientación justa del medidor de tensión y ajuste a las condiciones requeridas del fabricante