

Bill of Materials Listing

TransArctic Canada Inc.

5/9/2014
Page 1 of 1

Product Number		Description	Bin	Date	Weight	Uof M	Yield
Line	Component Prod#	Description		Unit	Qty		
KMC96690		Mt Kit, XBR-ISL, TM-55/65,ALT,8"Cr,'14		6/3/2013	173.21		0
10	BEL11410	Belt, A gr, 1410mm (55.5") (17555)		each	2		
20	BEL32311	Belt, Banded B gr, 2311mm (91")(RBX88-2)		each	1		
30	BMC83080	Bkt, Main, Frt PI, XBR-ISC		each	1		
40	BMC83081	Bkt, Main, RR PI, XBR-ISC		each	1		
50	BMC83082	Bkt, Main, Alt PI, XBR-ISC		each	1		
60	BMC83083	Bkt, Main, Idler, XBR-ISC		each	1		
70	BMC83087	Bkt, Dampner, Weldm't, XBR-ISC		each	1		
80	BMC83090	Bkt, PI, Coolant, XBR-ISC		each	1		
90	BMC83091	Bkt, Cradle, Alt, XBR-ISC		each	1		
100	BMN80008	Vibration Isolator, Bar,16.50 x 2 x 1.50		each	2		
110	BMN80009	Bkt, Main, Base PI, IC, RE300		each	1		
120	BMN80025	Bkt, Back, PL, Slide, IC, RE300		each	1		
130	TPK00004	Kit, Retrofit, Comp, Platform, TM-65,'12		each	1		
140	PUL80074	Pulley, Idler, B/S, Wide, 76d (89102)		each	2		
150	PUL89023	Pulley, Crank, ISL, XBR, 2B/X, 8", '13		each	1		
160	SCD09510	Spacer, Col, Drl, 9.53mm x 25.4o x10.32i		each	1		
170	SCD57210	Spacer, Col, Drl,57.15mm x28.58o x10.32i		each	1		
180	SLV17010	Sleeve, Pulley, 16.9o x 22.23mm x 10.32i		each	2		
190	KBC96690	Bag Kit, Fasteners, KMC96690		each	1		

Bill of Materials Listing

TransArctic Canada Inc.

5/9/2014
Page 1 of 1

Product Number		Description	Bin	Date	Weight	Uof M	Yield
Line	Component Prod#	Description		Unit	Qty		
KBC96690		Bag Kit, Fasteners, KMC96690		3/11/2011	6.02		0
10	BTC10035	Bolt, Hex, 10 x 1.5 x 35mm, 10.9, Plt,FT		each	9		
20	BTC10040	Bolt, Hex, 10 x 1.5 x 40mm, 10.9, Plt,FT		each	4		
25	BTC10055	Bolt, Hex, 10 x 1.5 x 55mm, 10.9, Plt,FT		each	5		
30	BTC10065	Bolt, Hex, 10 x 1.5 x 65mm, 10.9, Plt,FT		each	1		
40	BTC10120	Bolt, Hex, 10 x 1.5 x 120mm, 10.9, Plt		each	1		
60	BTQ08126	Bolt, Hex, 1/2-20unf, 1.25", 8, Plt		each	9		
70	BTQ08150	Bolt, Hex, 1/2-13unc, 1.5", 8, Plt		each	1		
80	BTQ08151	Bolt, Hex, 1/2-20unf, 1.5", 8, Plt		each	3		
90	BTQ08200	Bolt, Hex, 1/2-13unc, 2.0", 8, Plt		each	6		
100	BTQ08653	Bolt, Hex, 1/2-13unc, 6.5", 8, Plt		each	1		
105	BTP08653	Bolt, Hex, 1/2-13unc, 6.5", 5, Plt, FT		each	1		
110	NTA10000	Nut, Hex, 10 x 1.5, 8.8, Plt		each	11		
120	NTP08000	Nut, Hex, 1/2-13unc, 5, Plt		each	5		
130	WFA10000	Washer, Flat, 10mm, 8.8, Plt		each	13		
135	WFA10002	Washer, Flat, 10mm, Hvy, 8.8, Plt		each	2		
140	WFQ08000	Washer, Flat, 1/2", 8, Plt		each	22		
150	WLA10000	Washer, Lock, 10mm, 8.8, Plt		each	15		
170	WLQ08000	Washer, Lock, 1/2", 8, Plt		each	19		

8 7 6 5 4 3 2 1

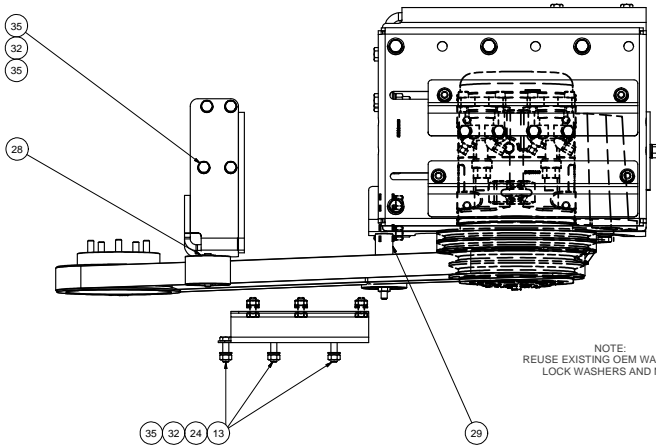

NOTE:
REUSE EXISTING OEM WASHERS,
LOCK WASHERS AND NUT.

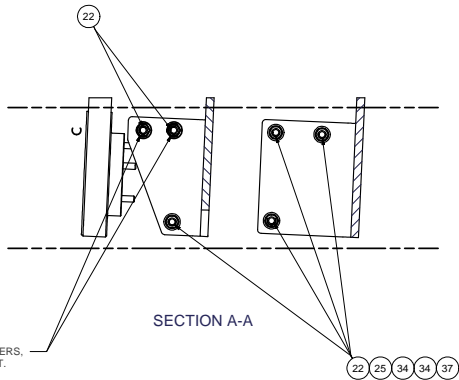

SECTION A-A

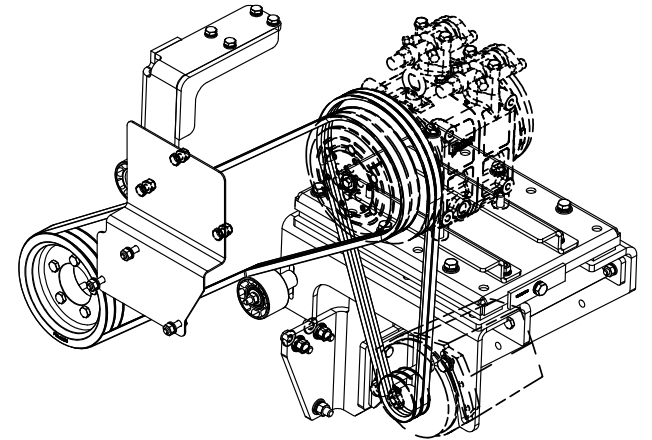

ISOMETRIC VIEW

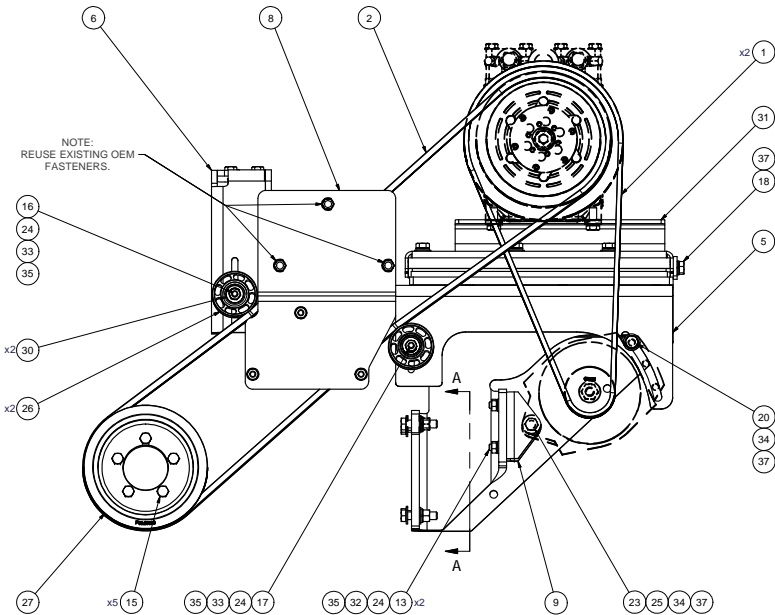

NOTE:
REUSE EXISTING OEM
FASTENERS.

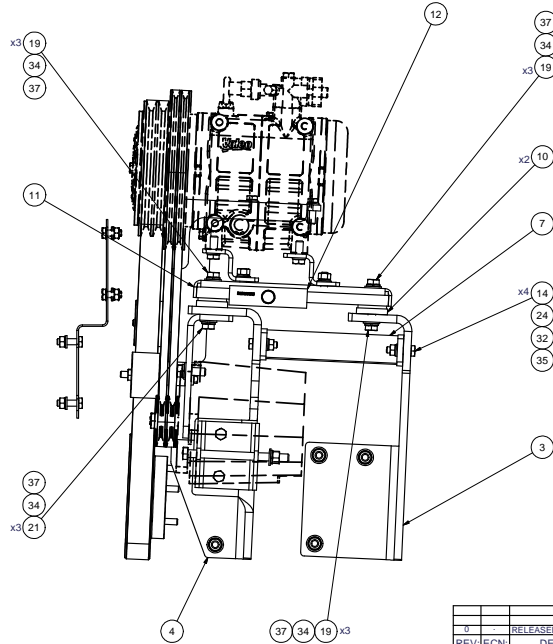

ITEM	QTY	U/M	PART NUMBER	DESCRIPTION
37	19	EACH	WL008000	WASHER, LOCK, 1/2", 8, PLT
35	15	EACH	WLA10000	WASHER, LOCK, 10mm, 8, 8, PLT
34	22	EACH	WFO08000	WASHER, FLAT, 1/2", 8, PLT
33	2	EACH	WFA10002	WASHER, FLAT, 10mm, HVY, 8, 8, PLT
32	13	EACH	WFA10000	WASHER, FLAT, 10mm, 8, 8, PLT
31	1	EACH	TPK00004	KIT, RETROFIT, COMP. PLATFORM, TM-65, '12
30	2	EACH	SLVT7010	SLEEVE, PULLEY, 16.90 x 22.23mm x 10.321
29	1	EACH	SCDS7210	SPACER, COL. DRL, 57.15mm x28.580 x10.321
28	1	EACH	SCD09510	SPACER, COL. DRL, 9.53mm x 25.40 x10.321
27	1	EACH	PUL89023	PULLEY, CRANK, ISL, 8.9L, 2B/X, 8", '13
26	2	EACH	PUL80074	PULLEY, IDLER, BACKSIDE, P8, 74D, 46.27W
25	5	EACH	NTP08000	NUT, HEX, 1/2-13UNC, 5, PLT
24	11	EACH	NTA10000	NUT, HEX, 10 x 1.5, 8, 8, PLT
23	1	EACH	BT008653	BOLT, HEX, 1/2-13UNC x 6.50, 8, PLT
22	6	EACH	BT008200	BOLT, HEX, 1/2-13UNC x 2.00, 8, PLT
21	3	EACH	BT008151	BOLT, HEX, 1/2-20UNF x 1.50, 8, PLT
20	1	EACH	BT008150	BOLT, HEX, 1/2-13UNC x 1.50, 8, PLT
19	9	EACH	BT008126	BOLT, HEX, 1/2-20UNF x 1.25, 8, PLT
18	1	EACH	BT008653	BOLT, HEX, 1/2-13UNC x 6.50, 5, PLT, FT
17	1	EACH	BTCT10120	BOLT, HEX, 10 x 1.5 x 120mm, 10.9, PLT
16	1	EACH	BTCT10065	BOLT, HEX, 10 x 1.5 x 65mm, 10.9, PLT
15	5	EACH	BTCT10055	BOLT, HEX, 10 x 1.5 x 55mm, 10.9, PLT
14	4	EACH	BTCT10040	BOLT, HEX, 10 x 1.5 x 40mm, 10.9, PLT
13	9	EACH	BTCT10035	BOLT, HEX, 10 x 1.5 x 35mm, 10.9, PLT
12	1	EACH	BMNS0025	BKT, BACK, PL, SLIDE, IC, RE300
11	1	EACH	BMNS0009	BKT, MAIN, BASE PL, IC, RE300
10	2	EACH	BMNS0008	VIBRATION ISOLATOR, BAR, 16.50 x 2 x 1.50
9	1	EACH	BMC83091	BKT, CRADLE, ALT., XBR-ISC
8	1	EACH	BMC83090	BKT, PL, COOLANT, XBR-ISC
7	1	EACH	BMC83087	BKT, DAMPNER, WELDM'T, XBR-ISC
6	1	EACH	BMC83083	BKT, MAIN, IDLER, XBR-ISC
5	1	EACH	BMC83082	BKT, MAIN, ALT PL, XBR-ISC
4	1	EACH	BMC83081	BKT, MAIN, RR PL, XBR-ISC
3	1	EACH	BMC83080	BKT, MAIN, FRT PL, XBR-ISC
2	1	EACH	BL32311	BELT, Banded B GR, 2311mm (91")
1	2	EACH	BELT11410	BELT, A GR, 1410mm (55.5") (17555)

BILL OF MATERIALS
TRANSARGTIG INC.

UNSPECIFIED TOLERANCES:	ALL DIMS	±.005
ONE DECIMAL PLACE DIMS	±.010	±.005
TWO DECIMAL PLACE DIMS	±.005	±.002
FRACTIONAL DIMS	±.005	±.002

DRAWN	Jose Rodriguez	5/9/2014
CHECKED	Val Jakovlew	5/9/2014
REVISION	DESCRIPTION	DATE
1	RELEASED TO PRODUCTION	5/9/2014
2	James Stewart	5/9/2014
3	James Stewart	5/9/2014
4	Dale Mason	5/9/2014

TITLE	MT KIT, XBR-ISL, TM-55/ 65, ALT, 8" CR, '14
SIZE	D
DWG NO	KMC96690
REV	0
SCALE	1:4
SHEET	1 OF 1

NOTES:
1) USE SERVICABLE THREADLOCKER ON ALL FASTENERS TO ENGINE COMPONENTS AND TORQUE ALL BOLTS TO S.A.E. SPECIFICATIONS.
2) SEE "TRANSARGTIG A/C COMPRESSOR MOUNT INSTALLATION DISCLAIMER".

8 7 6 5 4 3 2 1

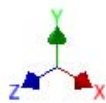
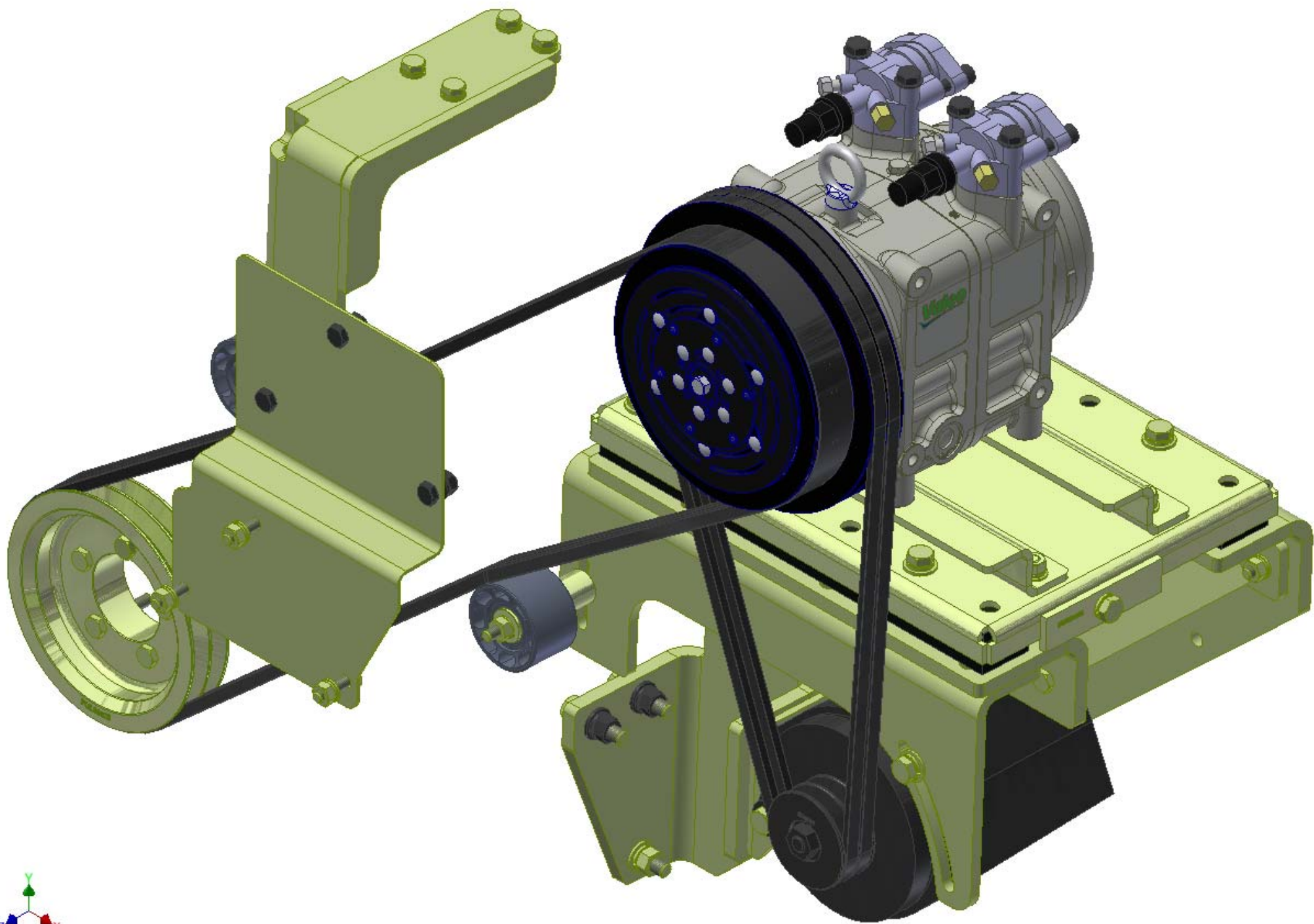

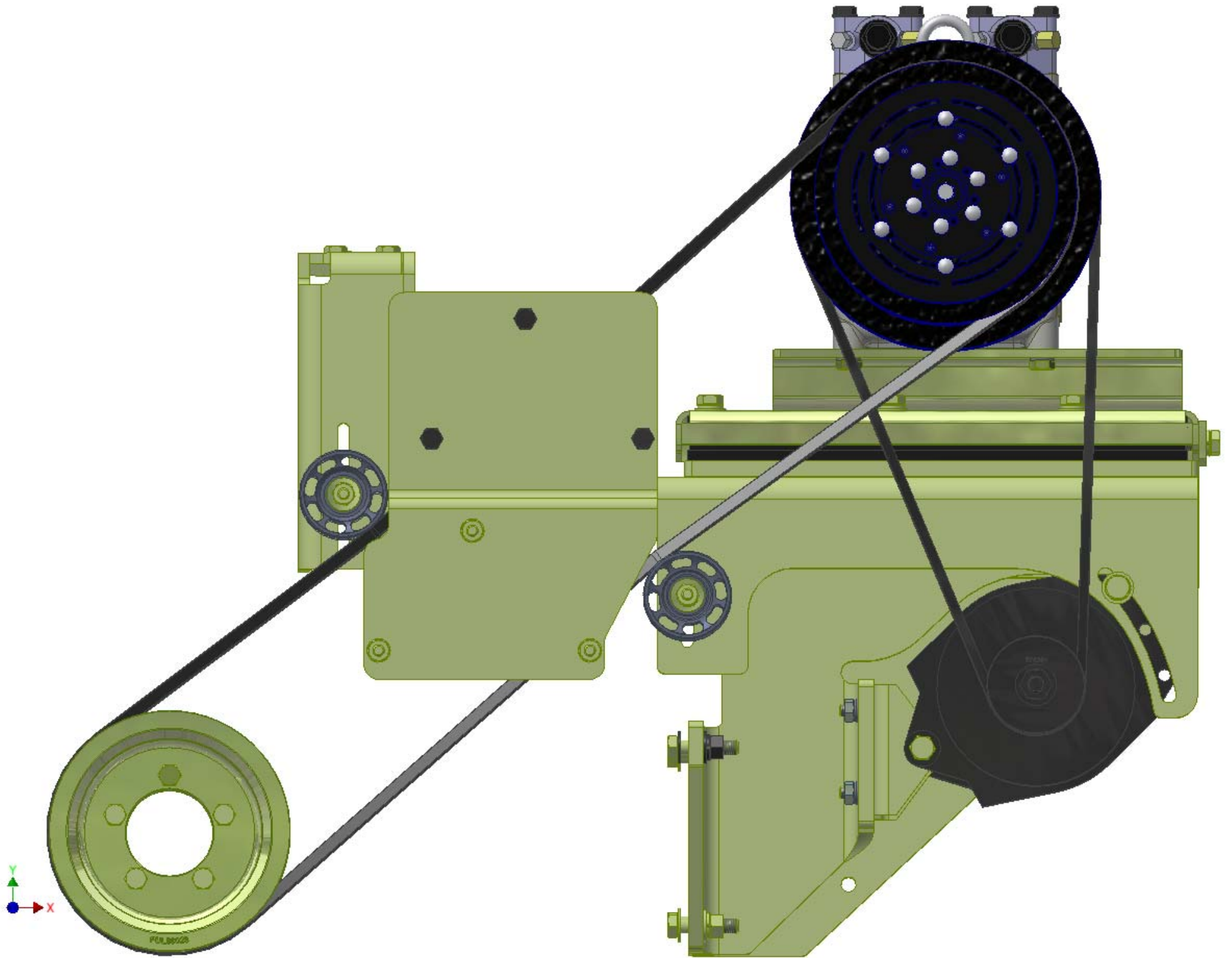

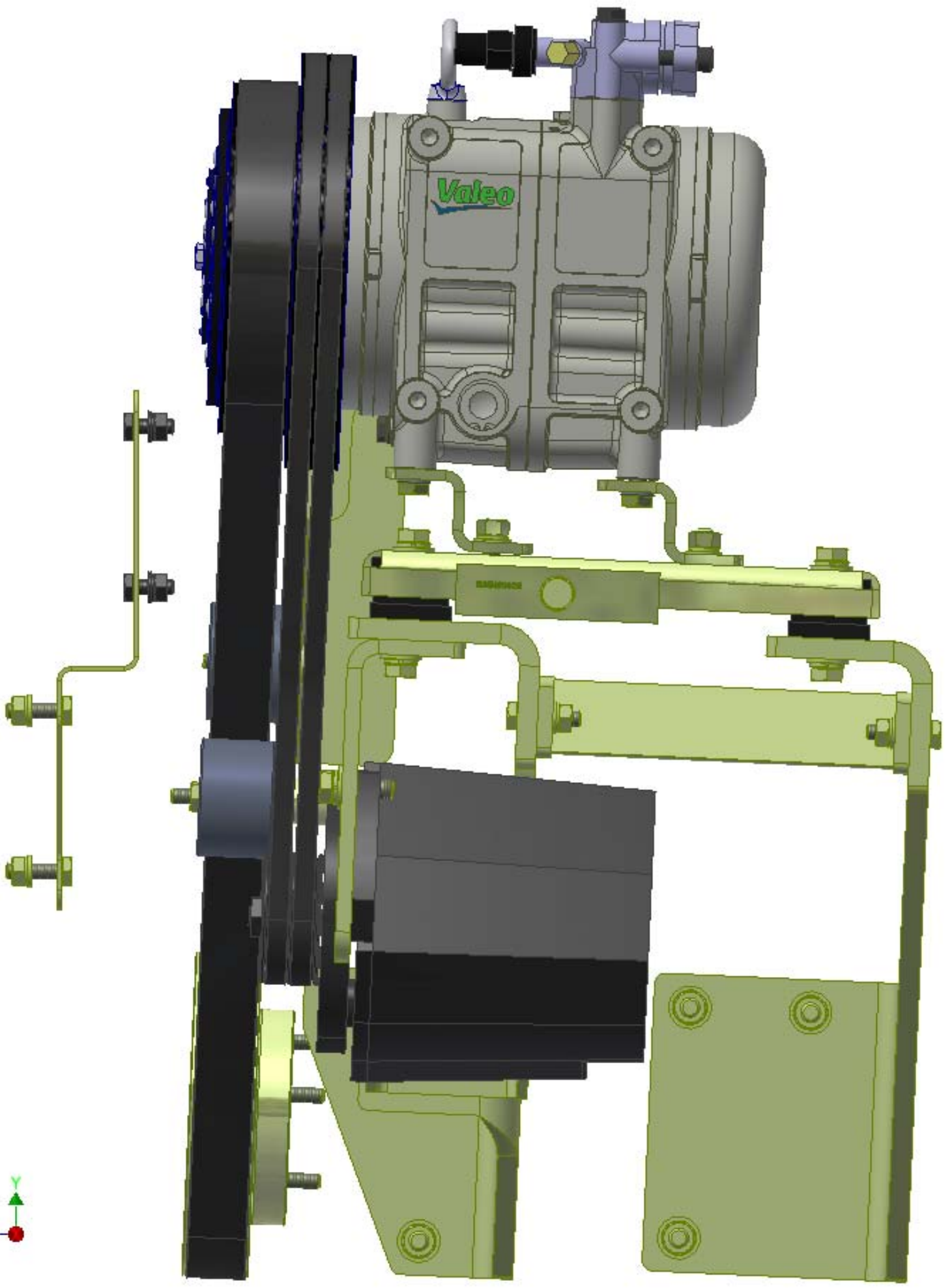
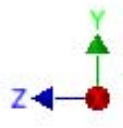

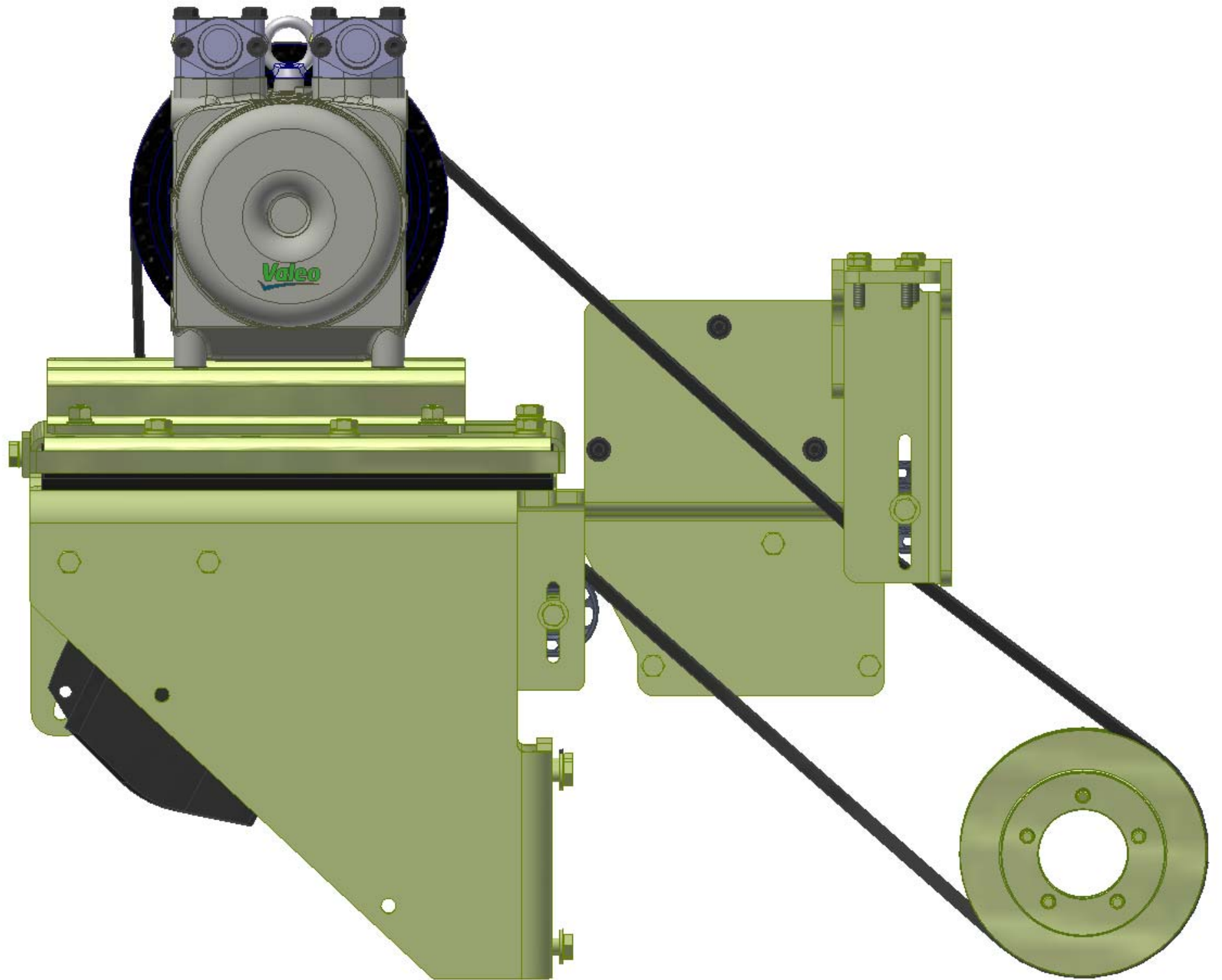

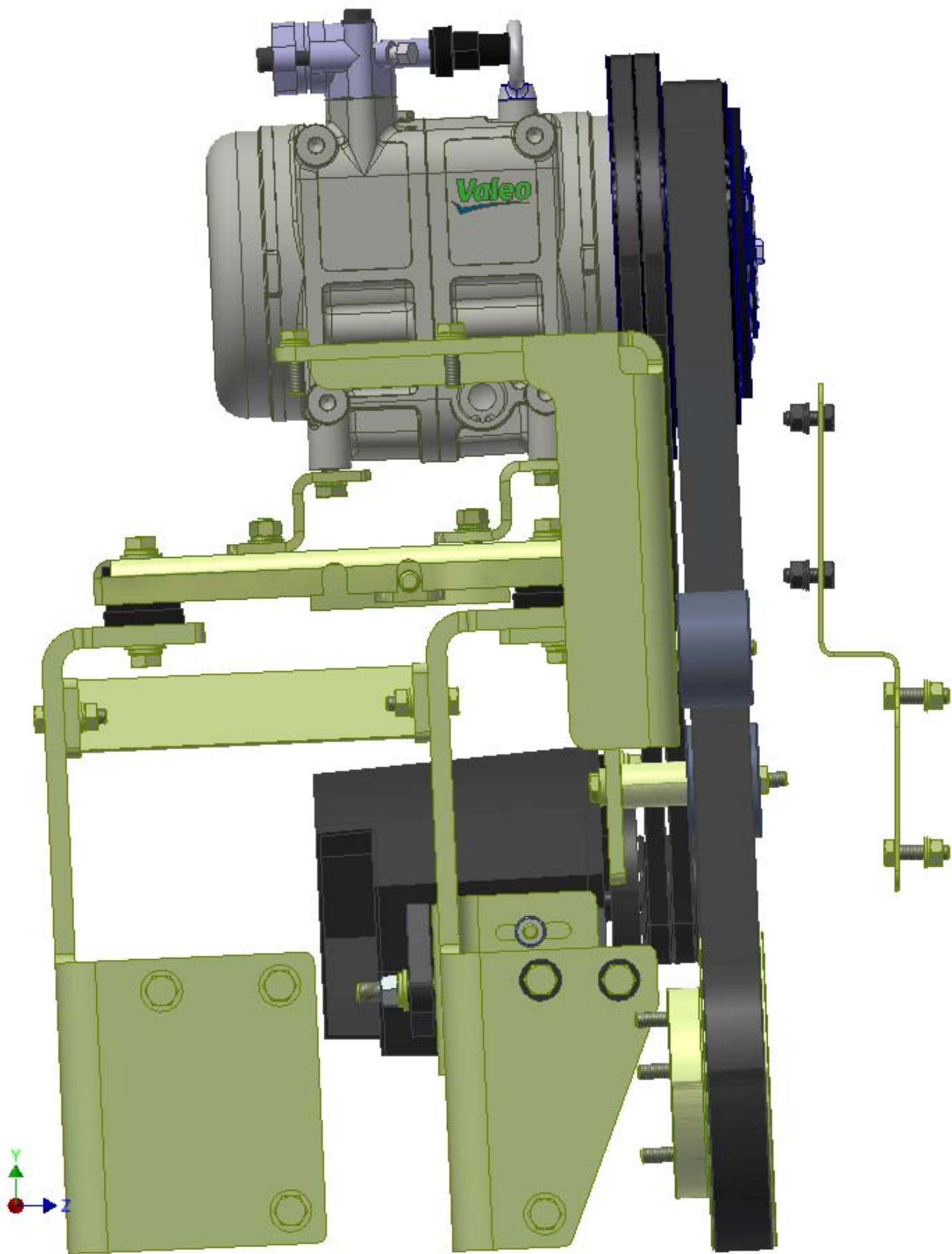

TransArctic A/C Compressor Mount Installation Disclaimer

All compressor mounts should be installed by qualified and trained personnel using proper tools and equipment in safe working conditions following industry standard guidelines for motor vehicle service and repair.

The installer of any compressor mount purchased from TransArctic must undertake all responsibility of issues arising from that compressor bracket being installed on any vehicle. As well as insure that a **proper and sufficient ground** is established between the compressors' clutches and the vehicle's engine. Mount functionality, operation and durability can all be compromised by an incompetent installation.

Due to the many different situations, parameters and application criteria, which are beyond the compressor mount manufacturer's control, TransArctic does not warrant design, durability, or operational functionality of any compressor mount improperly installed by another party.

With no implied guarantees it is the mount installer's strict responsibility to determine safety and functionality, of the compressor mount, at the time of installation.

Please contact TransArctic with any issue arising from installation so we may better improve the product. If you have any reservations about the compressor mount integrity contact TransArctic immediately at 1-877-COLD-AIR.

Mark OEM tensioner location

Install Kit

Check for Interferences

Check to ensure that the proper OEM tensioner orientation is maintained

Run engine with A/C system engaged for at least 10 minutes to run in belt

Check OEM tensioner orientation and adjust as required

Responsabilidad limitada de TransArctic en la instalación del soporte del compresor

Todos los soportes de los compresores deben ser instalados por personas calificadas y entrenadas, usando para ello los equipos y herramientas necesarios para esta labor en buenas condiciones y según las normas y guías para el servicio y/o reparación de motores de vehículos.

El instalador de los soportes comprados en TransArctic asume toda la responsabilidad de cualquier problema que surga en el soporte del compresor al vehículo; de igual manera es responsable que el cable a tierra sea conectado entre el embrague del compresor y el motor del vehículo.

Se advierte que el buen funcionamiento y la durabilidad del soporte pueden ser comprometidos por defectos en su instalación.

Debido a las diversas situaciones que se puedan presentar fuera del control del fabricante, TransArctic no garantiza el diseño, la durabilidad o el correcto funcionamiento de cualquier equipo inapropiadamente instalado por terceros.

Esta sobreentendido que el Instalador del montaje del compresor es estrictamente responsable de la seguridad y funcionamiento del equipo en el momento de la instalación.

Si tuviera algún problema o duda acerca de la instalación del soporte del compresor pongase en contacto inmediatamente con TransArctic al teléfono 1-877-COLD-AIR de modo que podamos mejorar nuestro producto.

Note la ubicación del medidor de tensión OEM

Instale el equipo

Controlar si hay interferencias.

Asegurese que el medidor de tensión mantenga la orientación justa.

Encienda el motor por lo menos 10 minutos con el sistema A/C enganchado para que la correa corra

Controle la orientación justa del medidor de tensión y ajuste a las condiciones requeridas del fabricante