

Bill of Materials Listing

TransArctic Canada Inc.

12/24/2010

Page 1 of 1

Product Number		Description	Bin	Date	Weight	Uof M	Yield
Line	Component	Prod#	Description	Unit	Qty		
KMN82672			Mt. Kit, MF DT, CE300, 2 TM-21, '10		11/10/2010	12.65	0
10	BEL02615		Belt, 10gr, 2615mm (103")	each	1		
20	BMN80034		Bkt, Comp, Upper, CE200	each	1		
30	BMN80035		Bkt, Comp, Lower, CE300	each	1		
40	BMN80038		Bkt, Rad Hose, PMax DT, CE300	each	1		
50	BMN80066		Bkt, Idler, Slot PL, Weldmnt, FE300, '09	each	1		
60	BMS16022		Bkt, TM-16 Spacer Plate	each	2		
70	PUL80074		Pulley, Idler, B/S, Wide, 76d (89102)	each	2		
80	SCD14010		Spacer, Col, Drl, 14mm x25.4o x10.32i	each	1		
90	SCD20010		Spacer, Col, Drl, 20mm x 33.34o x 10.32i	each	1		
100	SLV17010		Sleeve, Pulley, 16.9o x 22.23mm x 10.32i	each	1		
110	CLP20040		Clamp, "P" type, #40, 1/2"w, 2 1/2", PC	each	1		
120	CLP36001		Clamp, Gear, #36, 1 13/16-2 3/4 (46/70mm)	each	2		
130	KBN82672		Bag Kit, Fasteners, KMN82672/2072	each	1		

Bill of Materials Listing

TransArctic Canada Inc.

12/24/2010
Page 1 of 1

Product Number	Description	Date	Weight	Uof M	Yield
Line Component Prod#	Description	Bin Unit	Qty		
KBN82672	Bag Kit, Fasteners, KMN82672/2072	11/10/2010	1.76		0
10 BTC10080	Bolt, Hex, 10 x 1.5 x 80mm, 10.9, Plt,FT	each	1		
20 BTC10040	Bolt, Hex, 10 x 1.5 x 40mm, 10.9, Plt,FT	each	1		
30 BTC08140	Bolt, Hex, 8 x 1.25 x 140mm, 10.9, Plt	each	4		
40 BTC08110	Bolt, Hex, 8 x 1.25 x 110mm, 10.9, Plt	each	4		
50 BTC08100	Bolt, Hex, 8 x 1.25 x 100mm, 10.9, Plt	each	4		
60 BTP04075	Bolt, Hex, 1/4-20unc, .75", 5, Plt	each	1		
70 BTS10001	Bolt, Shoulder, 10mm (89064)	each	1		
80 CSF10046	Capscrew, FH, 10 x 1.5 x 45mm, 10.9,Plt	each	1		
90 NTA10000	Nut, Hex, 10 x 1.5, 8.8, Plt	each	1		
100 NTA08000	Nut, Hex, 8 x 1.25, 8.8, Plt	each	1		
110 NTP04000	Nut, Hex, 1/4-20unc, 5, Plt	each	1		
120 WFA10002	Washer, Flat, 10mm, Hvy, 8.8, Plt	each	1		
130 WFA10000	Washer, Flat, 10mm, 8.8, Plt	each	2		
140 WFA08000	Washer, Flat, 8mm, 8.8, Plt	each	8		
150 WFS04003	Washer, Flat, 1/4", 2, USS, Plt	each	1		
160 WLA10000	Washer, Lock, 10mm, 8.8, Plt	each	2		
170 WLA08000	Washer, Lock, 8mm, 8.8, Plt	each	9		

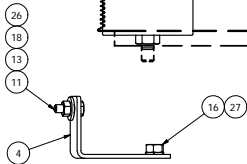
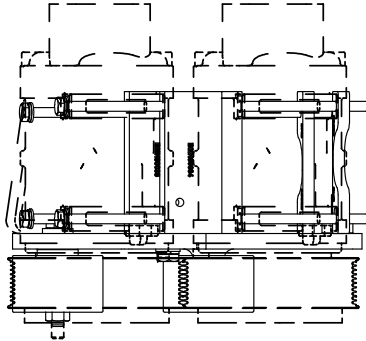

NOTE:
CARRIER COMPRESSOR
PART# 76-62285-xx

NOTE:
CARRIER COMPRESSOR
PART# 76-62285-xx

● SEE NOTE # 3.

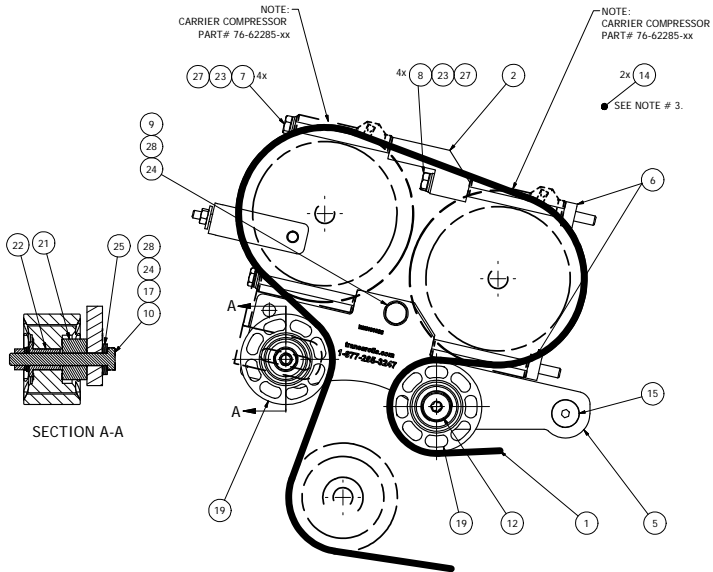

SECTION A-A

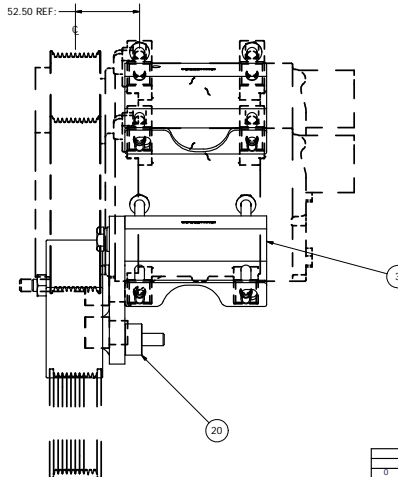

REFER TO PHOTOGRAPH FOR MOUNTING.

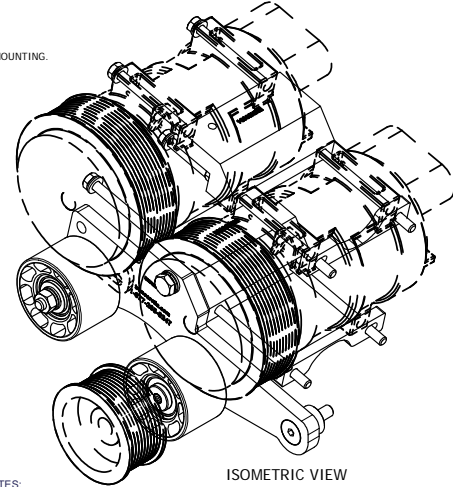

ISOMETRIC VIEW

NOTES:

- 1) USE SERVICABLE THREADLOCKER ON ALL FASTENERS TO ENGINE COMPONENTS AND TORQUE ALL BOLTS TO S.A.E. SPECIFICATIONS.
- 2) SEE "TRANSARGTIC A/C COMPRESSOR MOUNT INSTALLATION DISCLAIMER".
- 3) MODIFY EXISTING RADIATOR HOSE ON PASSENGER SIDE (TO CLEAR BELT & COMPRESSORS.) BY REMOVING HOSE AND FLIPPING END FOR END AND THEN RE-INSTALL ON THE ENGINE WITH THE INTERNAL WIRE COIL REINFORCEMENT IN AT LEAST THE TOP HORIZONTAL PORTION OF THE RAD HOSE. (USING NEW BRKT SUPPLIED, AND (2) GEAR CLAMPS AS NEEDED.)

ITEM	QTY	U/M	PART NUMBER	DESCRIPTION
28	2	EACH	WLA10000	WASHER, LOCK, 10mm, 8.8, PLT
27	9	EACH	WLA08000	WASHER, LOCK, 8mm, 8.8, PLT
26	1	EACH	WFS04003	WASHER, FLAT, 1/4", 2, USS, PLT
25	1	EACH	WFA10002	WASHER, FLAT, 10mm, HVY, 8.8, PLT
24	2	EACH	WFA10000	WASHER, FLAT, 10mm, 8.8, PLT
23	8	EACH	WFA08000	WASHER, FLAT, 8mm, 8.8, PLT
22	1	EACH	SLV17010	SLEEVE, PULLEY, 16.90 x 22.23mm x 10.32i
21	1	EACH	SCD20010	SPACER, COL, 20mm x 33.340 x 10.32i
20	1	EACH	SCD14010	SPACER, COL, DRL, 14mm x 25.40 x 10.32i
19	2	EACH	PUL80074	PULLEY, IDLER, BACKSIDE, PB, 74D, 46.27W
18	1	EACH	NTP04000	NUT, HEX, 1/4-20UNC, 5, PLT
17	1	EACH	NTA10000	NUT, HEX, 10 x 1.5, 8.8, PLT
16	1	EACH	NTA08000	NUT, HEX, 8 x 1.25, 8.8, PLT
15	1	EACH	CSF10046	CAPSCREW, FH, 10 x 1.5 x 45mm, 10.9, PLT
14	2	EACH	CLP36001	CLAMP, GEAR, #36, 1 13/16-2 1/4 (46-70mm)
13	1	EACH	CLP20040	CLAMP, "P" TYPE, #40, 1/2"W, 2 1/2", PC
12	1	EACH	BTS10001	BOLT, SHOULDER, 10mm (IDLER PULLEY)
11	1	EACH	BTP04075	BOLT, HEX, 1/4-20UNC, 75", 5, PLT
10	1	EACH	BTC10080	BOLT, HEX, 10 x 1.5 x 80mm, 10.9, PLT, FT
9	1	EACH	BTC10040	BOLT, HEX, 10 x 1.5 x 40mm, 10.9, PLT
8	4	EACH	BTC08140	BOLT, HEX, 8 x 1.25 x 140mm, 10.9, PLT
7	4	EACH	BTC08100	BOLT, HEX, 8 x 1.25 x 100mm, 10.9, PLT
6	2	EACH	BMS16022	BKT, TM-16, SPACER PLATE
5	1	EACH	BMN80066	BKT, IDLER, WELDMENT, FE300, 07-09
4	1	EACH	BMN80038	BKT, RAD HOSE, PMAX DT, CE300
3	1	EACH	BMN80035	BKT, COMP, LOWER, FE300
2	1	EACH	BMN80034	BKT, COMP, UPPER, FE300
1	1	EACH	BELO2615	BELT, 10gr, 2615mm (103")

BILL OF MATERIALS

DRAWN	vjakovlev	1/3/2011
CHECKED	James Stewart	1/3/2011
REVIEWED	James Stewart	1/3/2011
APPROVED	Ron Ingram	1/3/2011
	Dale Mason	1/3/2011



MT. KIT, MF DT, CE300, 2 TM-21, '10

UNSPECIFIED TOLERANCES:	ALL DIM
ONE DECIMAL PLACE (X.1)	30 (300)
TWO DECIMAL PLACE (X.00)	25 (250)
THREE DECIMAL PLACE (X.000)	15 (150)
FRACTIONAL (1/16")	ANGULAR -- 30'



DRAWING UNIT OF MEASURE:	MM (INCH)
SCALE:	1:2

SIZE	D	DWG NO	KMN82672	REV	0
SHEET	1	OF	1		

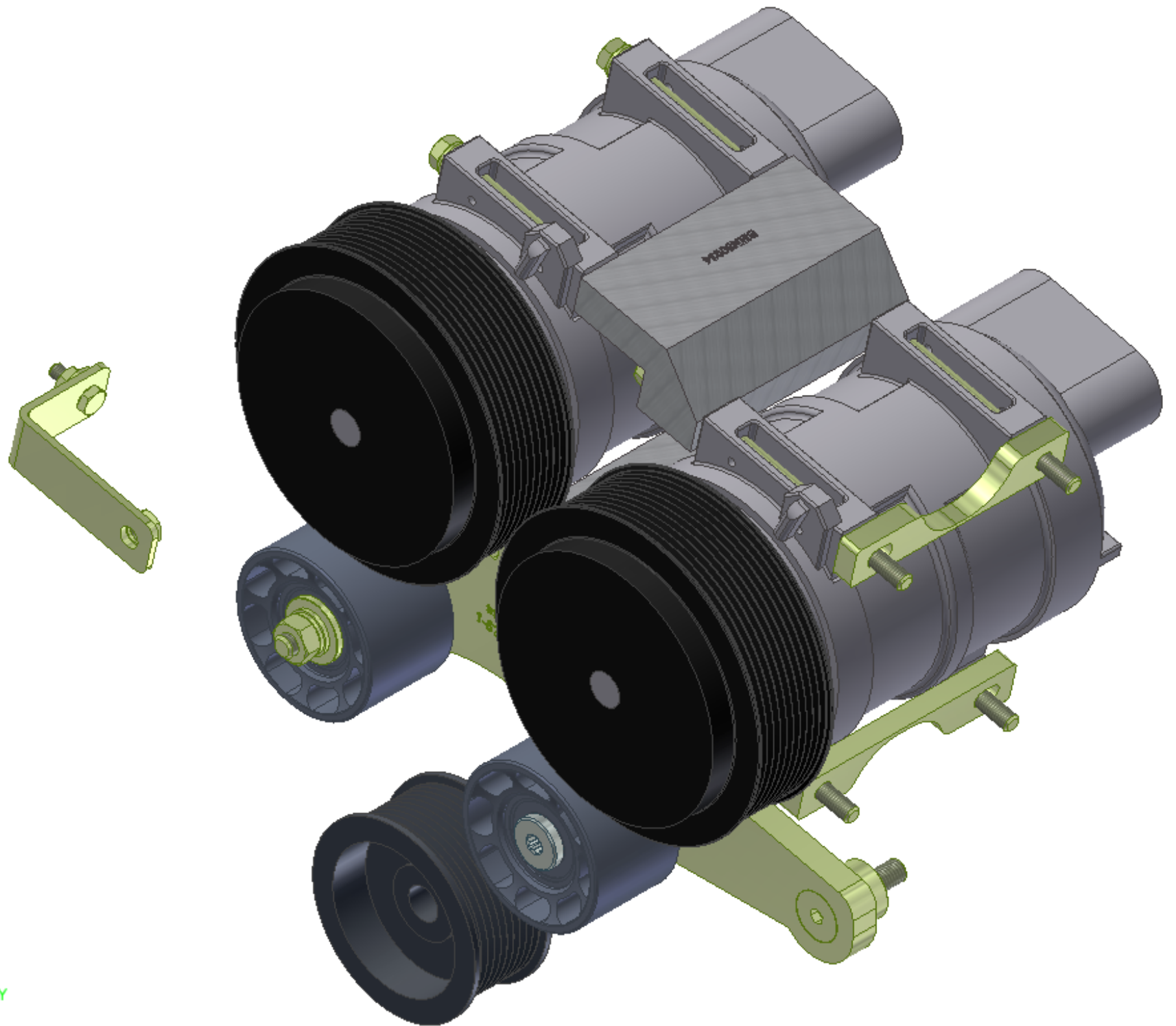

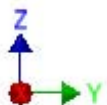
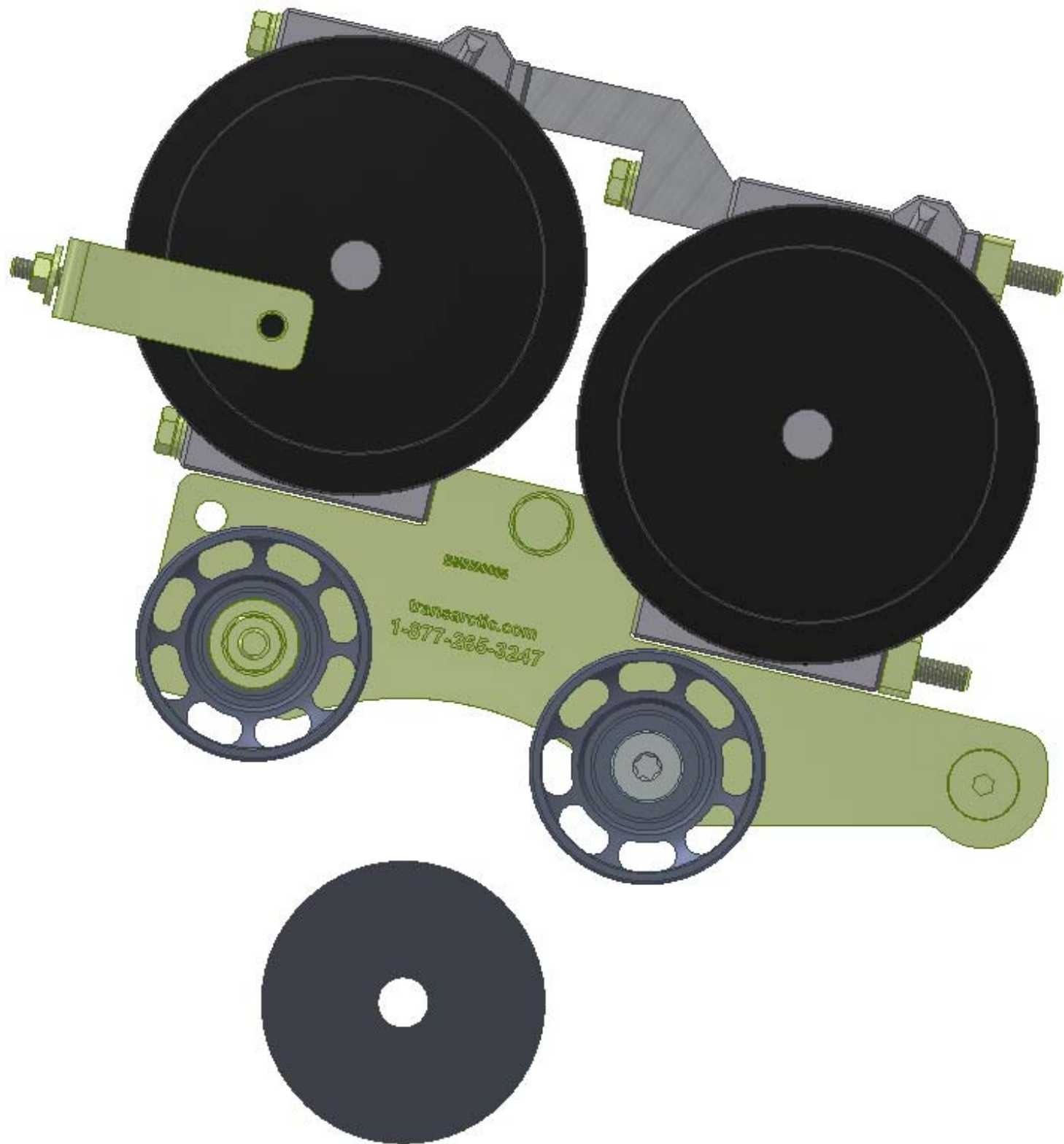

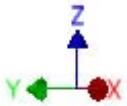
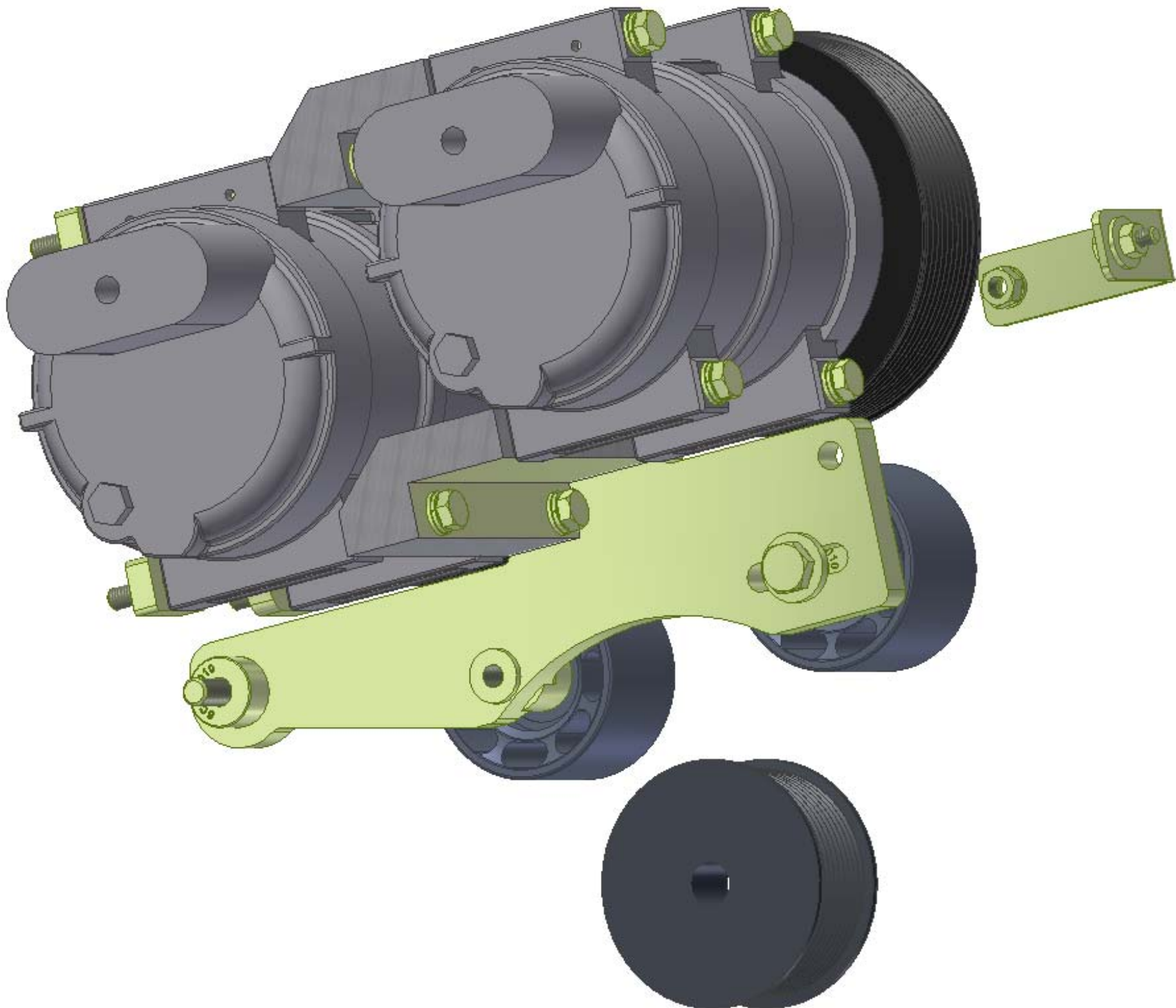

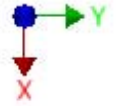
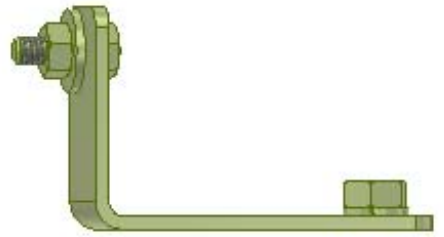
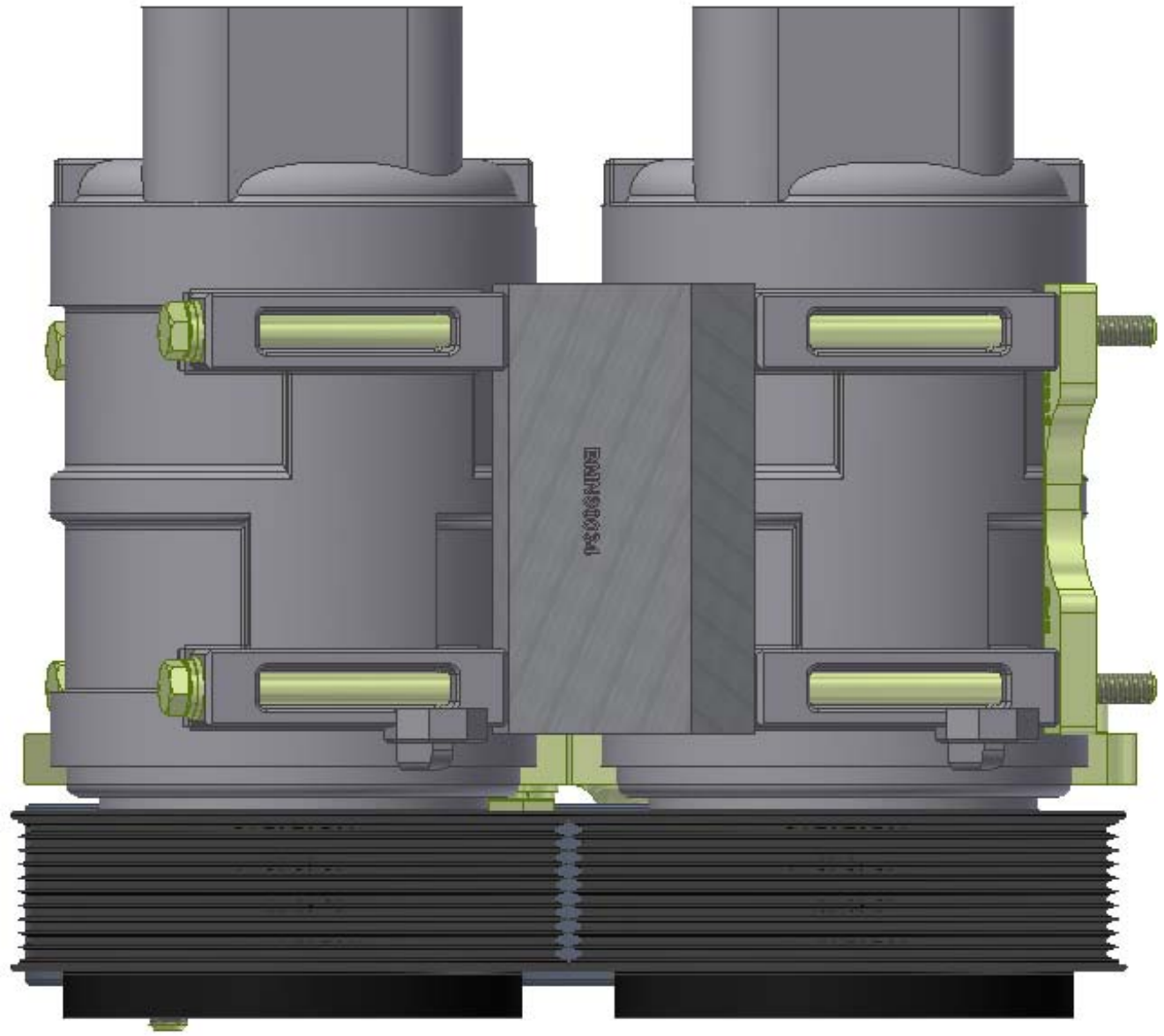

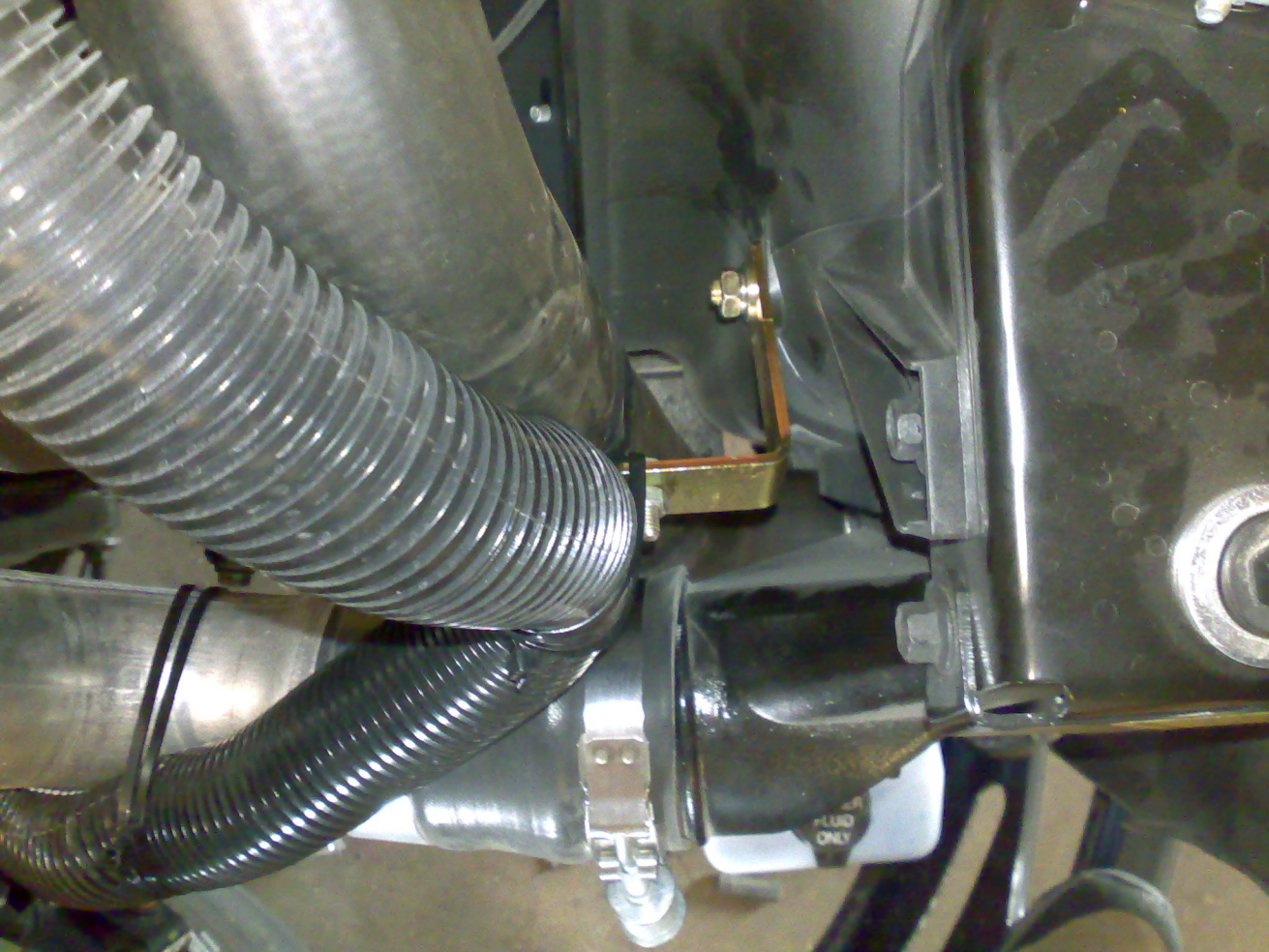

TransArctic A/C Compressor Mount Installation Disclaimer

All compressor mounts should be installed by qualified and trained personnel using proper tools and equipment in safe working conditions following industry standard guidelines for motor vehicle service and repair.

The installer of any compressor mount purchased from TransArctic must undertake all responsibility of issues arising from that compressor bracket being installed on any vehicle. As well as insure that a **proper and sufficient ground** is established between the compressors' clutches and the vehicle's engine. Mount functionality, operation and durability can all be compromised by an incompetent installation.

Due to the many different situations, parameters and application criteria, which are beyond the compressor mount manufacturer's control, TransArctic does not warrant design, durability, or operational functionality of any compressor mount improperly installed by another party.

With no implied guarantees it is the mount installer's strict responsibility to determine safety and functionality, of the compressor mount, at the time of installation.

Please contact TransArctic with any issue arising from installation so we may better improve the product. If you have any reservations about the compressor mount integrity contact TransArctic immediately at 1-877-COLD-AIR.

Mark OEM tensioner location

Install Kit

Check for Interferences

Check to ensure that the proper OEM tensioner orientation is maintained

Run engine with A/C system engaged for at least 10 minutes to run in belt

Check OEM tensioner orientation and adjust as required

Responsabilidad limitada de TransArctic en la instalación del soporte del compresor

Todos los soportes de los compresores deben ser instalados por personas calificadas y entrenadas, usando para ello los equipos y herramientas necesarios para esta labor en buenas condiciones y según las normas y guías para el servicio y/o reparación de motores de vehículos.

El instalador de los soportes comprados en TransArctic asume toda la responsabilidad de cualquier problema que surja en el soporte del compresor al vehículo; de igual manera es responsable que el cable a tierra sea conectado entre el embrague del compresor y el motor del vehículo.

Se advierte que el buen funcionamiento y la durabilidad del soporte pueden ser comprometidos por defectos en su instalación.

Debido a las diversas situaciones que se puedan presentar fuera del control del fabricante, TransArctic no garantiza el diseño, la durabilidad o el correcto funcionamiento de cualquier equipo inapropiadamente instalado por terceros.

Esta sobreentendido que el Instalador del montaje del compresor es estrictamente responsable de la seguridad y funcionamiento del equipo en el momento de la instalación.

Si tuviera algún problema o duda acerca de la instalación del soporte del compresor pongase en contacto inmediatamente con TransArctic al teléfono 1-877-COLD-AIR de modo que podamos mejorar nuestro producto.

Note la ubicación del medidor de tensión OEM

Instale el equipo

Controlar si hay interferencias.

Asegurese que el medidor de tensión mantenga la orientación justa.

Encienda el motor por lo menos 10 minutos con el sistema A/C enganchado para que la correa corra

Controle la orientación justa del medidor de tensión y ajuste a las condiciones requeridas del fabricante