

# Bill of Materials Listing

TransArctic Canada Inc.

11/6/2013

Page 1 of 1

Product Number		Description	Bin	Date	Weight	Uof M	Yield
Line	Component	Prod#	Description	Unit	Qty		
<b>KMC62692</b>			<b>Mt Kit, ISB 2013, HDX , 2 TM-21, '14</b>		<b>06/07/13</b>	<b>21.77</b>	<b>0</b>
10	BEL11753		Belt, A gr, 1753mm (69") (17690)	each	1		
20	BMC67022		Bkt, Upper, Weldmt, D/S, ISB, TM-21	each	1		
30	BMC67023		Bkt, Lower, Weldmt, D/S, ISB, TM-21	each	1		
40	BMC83105		Bkt, Main, Weldm't, 8.3L, ISL, HDX, '13	each	1		
50	PNS04010		Pin, Spring, 1/4" d x 5/8" lg, ST, PLT	each	1		
60	PUL10094		Pulley, Idler, SA,94d x 18w,Blk (IP-103)	each	1		
70	PUL67001		Pulley, Crank, ADD-ON, Cum, ISB, 6.7, SA	each	1		
80	SCD14010		Spacer, Col, Drl, 14mm x25.4o x10.32i	each	1		
90	SLV17040		Sleeve, Pulley, 16.9o x 14.29mm x 10.08i	each	1		
100	TEN00002		Tenr, Spring, C/W, 90d, 3/8 x4.5"/3.5"	each	1		
110	KBC62692		Bag Kit, Fasteners, KMC62692	each	1		

# Bill of Materials Listing

TransArctic Canada Inc.

11/6/2013  
Page 1 of 1

Product Number	Description	Date	Weight	Uof M	Yield
Line    Component    Prod#	Description	Bin                    Unit	Qty		
<b>KBC62692</b>	<b>Bag Kit, Fasteners, KMC62692</b>		<b>06/11/13</b>	<b>2.93</b>	<b>0</b>
10	BTC08100		Bolt, Hex, 8 x 1.25 x 100mm, 10.9, Plt	each	7
30	BTC10040		Bolt, Hex, 10 x 1.5 x 40mm, 10.9, Plt,FT	each	3
40	CSS12090		Capscrew, SH, 12 x 1.25 x 90mm, 12.9,BLK	each	6
50	BTC10130		Bolt, Hex, 10 x 1.5 x 130mm, 10.9, Plt	each	1
60	CSF06250		Capscrew, FH, 3/8-16 x 2.5", Alloy, Plt	each	1
70	CSF10041		Capscrew, FH, 10 x 1.5 x 40mm, 10.9,Plt	each	1
80	CSF10051		Capscrew, FH, 10 x 1.5 x 50mm, 10.9,Plt	each	1
90	NTA10000		Nut, Hex, 10 x 1.5, 8.8, Plt	each	5
100	WFA08000		Washer, Flat, 8mm, 8.8, Plt	each	7
110	WFA10000		Washer, Flat, 10mm, 8.8, Plt	each	14
120	WFS12002		Washer, Flat, Hdn, 12mm, Stl, BLK	each	6
130	WLA08000		Washer, Lock, 8mm, 8.8, Plt	each	7
140	WLA10000		Washer, Lock, 10mm, 8.8, Plt	each	6

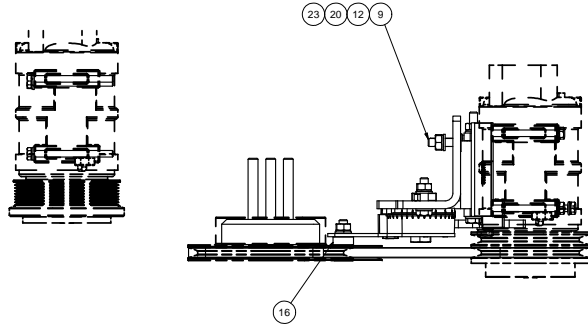

NOTE:  
SHOWING COMPRESSOR  
QUE P/N# QP21-1657  
AS REFERENCE.

NOTE:  
SHOWING COMPRESSOR  
QUE P/N# QP21-1564  
AS REFERENCE.

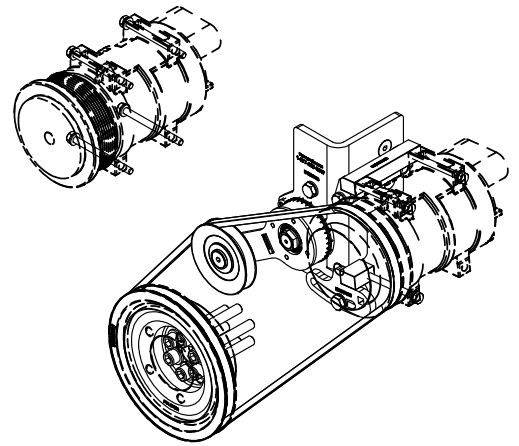

ISOMETRIC VIEW

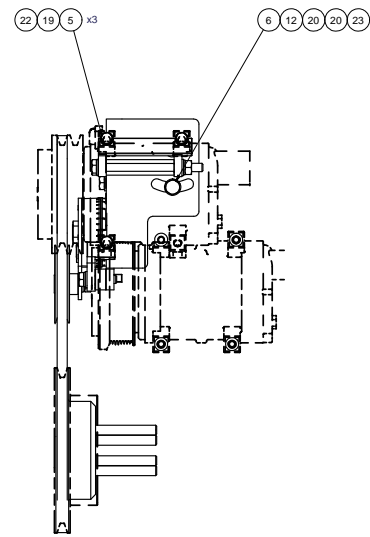
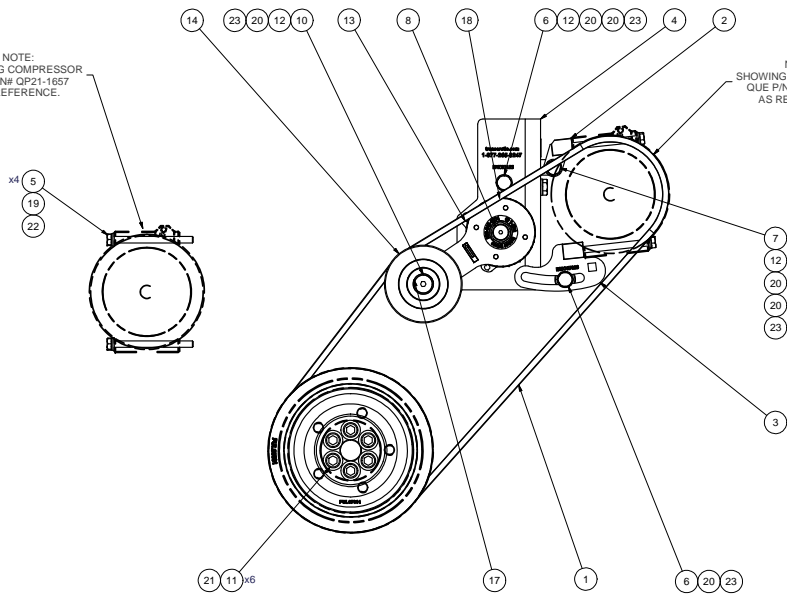

NOTES:  
1) USE SERVICABLE THREADLOCKER ON ALL FASTENERS TO ENGINE COMPONENTS AND TORQUE ALL BOLTS TO S.A.E. SPECIFICATIONS.  
2) SEE "TRANSARGTIC A/C COMPRESSOR MOUNT INSTALLATION DISCLAIMER".

ITEM	QTY	U/M	PART NUMBER	DESCRIPTION
23	6	EACH	WLA10000	WASHER, LOCK, 10mm, 8.8, PLT
22	7	EACH	WLA08000	WASHER, LOCK, 8mm, 8.8, PLT
21	6	EACH	WFS12002	WASHER, FLAT, HDN, 12mm, STL, BLK
20	14	EACH	WFA10000	WASHER, FLAT, 10mm, 8.8, PLT
19	7	EACH	WFA08000	WASHER, FLAT, 8mm, 8.8, PLT
18	1	EACH	TEN00002	TENR, SPRING, UN-DIRECT, 90D, 3/8" X 3.5"
17	1	EACH	SLV17040	SLEEVE, PULLEY, 16.90 x 14.29mm x 10.08i
16	1	EACH	SCD14010	SPACER, COL, DRL, 14mm x 25.40 x 10.32i
15	1	EACH	PUL67001	PULLEY, CRANK, ADD-ON, CUM, ISB, 6.7, SA
14	1	EACH	PUL10094	PULLEY, IDLER, SA, 94D X 18W, BLK (IP-103)
13	1	EACH	PNS04010	PIN, SPRING, 1/4" D x 5/8" L
12	5	EACH	NTA10000	NUT, HEX, 10 x 1.5, 8.8, PLT
11	6	EACH	CSS12090	CAPSCREW, SH, 12 x 1.25 x 90mm, 12.9, PLT
10	1	EACH	CSF10051	CAPSCREW, FH, 10 x 1.5 x 50mm, 10.9, PLT
9	1	EACH	CSF10041	CAPSCREW, FH, 10 x 1.5 x 40mm, 10.9, PLT
8	1	EACH	CSF06250	CAPSCREW, FH, 3/8-16 x 2.5", 9, PLT
7	1	EACH	BTC10130	BOLT, HEX, 10 x 1.5 x 130mm, 10.9, PLT
6	3	EACH	BTC10040	BOLT, HEX, 10 x 1.5 x 40mm, 10.9, PLT
5	7	EACH	BTC08100	BOLT, HEX, 8 x 1.25 x 100mm, 10.9, PLT
4	1	EACH	BMC83105	BKT, MAIN, WELDMT, 8.3L, ISL, HDX, '13
3	1	EACH	BMC67023	BKT, LOWER, WELDMT, D/S, ISB, TM-21
2	1	EACH	BMC67022	BKT, UPPER, WELDMT, D/S, ISB, TM-21
1	1	EACH	BEL11753	BELT A GR, 1753mm (69") (17690)

TRANSARGTIC INC.

DRWN	vjakovlew	08/23/13	VAL	GA
CHECKED	Jose Rodriguez	08/23/13	DATE	08/23/13
REV	ECN	DESCRIPTION	DATE	BY
		RELEASED TO PRODUCTION	11/06/13	GA
				James Stewart
				MFS
				James Stewart
				APPROVED
				Dale Mason
				08/23/13

BILL OF MATERIALS		DRAWING UNIT OF MEASURE		SCALE		SHEET	
ITEM	QTY	U/M	PART NUMBER	MM (INCH)	1:3	1	OF 1
DRAWN: vjakovlew CHECKED: Jose Rodriguez DATE: 08/23/13 BY: James Stewart APPROVED: James Stewart DATE: 08/23/13				DWG NO: KMC62692 SCALE: 1:3		SHEET 1 OF 1	

UNSPECIFIED TOLERANCES: HLT, HML, HPS, HPSH, HPSL, HPSM, HPSN, HPSO, HPSR, HPSV, HPSW, HPSX, HPSY, HPSZ, HPT, HPTL, HPTM, HPTN, HPTO, HPTP, HPTV, HPTW, HPTX, HPTY, HPTZ, HPU, HPUA, HPUB, HPUX, HPUY, HPUZ, HPL, HPLA, HPLB, HPLX, HPLY, HPLZ, HPM, HPM1, HPM2, HPM3, HPM4, HPM5, HPM6, HPM7, HPM8, HPM9, HPM10, HPM11, HPM12, HPM13, HPM14, HPM15, HPM16, HPM17, HPM18, HPM19, HPM20, HPM21, HPM22, HPM23, HPM24, HPM25, HPM26, HPM27, HPM28, HPM29, HPM30, HPM31, HPM32, HPM33, HPM34, HPM35, HPM36, HPM37, HPM38, HPM39, HPM40, HPM41, HPM42, HPM43, HPM44, HPM45, HPM46, HPM47, HPM48, HPM49, HPM50, HPM51, HPM52, HPM53, HPM54, HPM55, HPM56, HPM57, HPM58, HPM59, HPM60, HPM61, HPM62, HPM63, HPM64, HPM65, HPM66, HPM67, HPM68, HPM69, HPM70, HPM71, HPM72, HPM73, HPM74, HPM75, HPM76, HPM77, HPM78, HPM79, HPM80, HPM81, HPM82, HPM83, HPM84, HPM85, HPM86, HPM87, HPM88, HPM89, HPM90, HPM91, HPM92, HPM93, HPM94, HPM95, HPM96, HPM97, HPM98, HPM99, HPM100.



DRAWING UNIT OF MEASURE: MM (INCH)  
SCALE: 1:3

DWG NO: KMC62692  
SHEET 1 OF 1

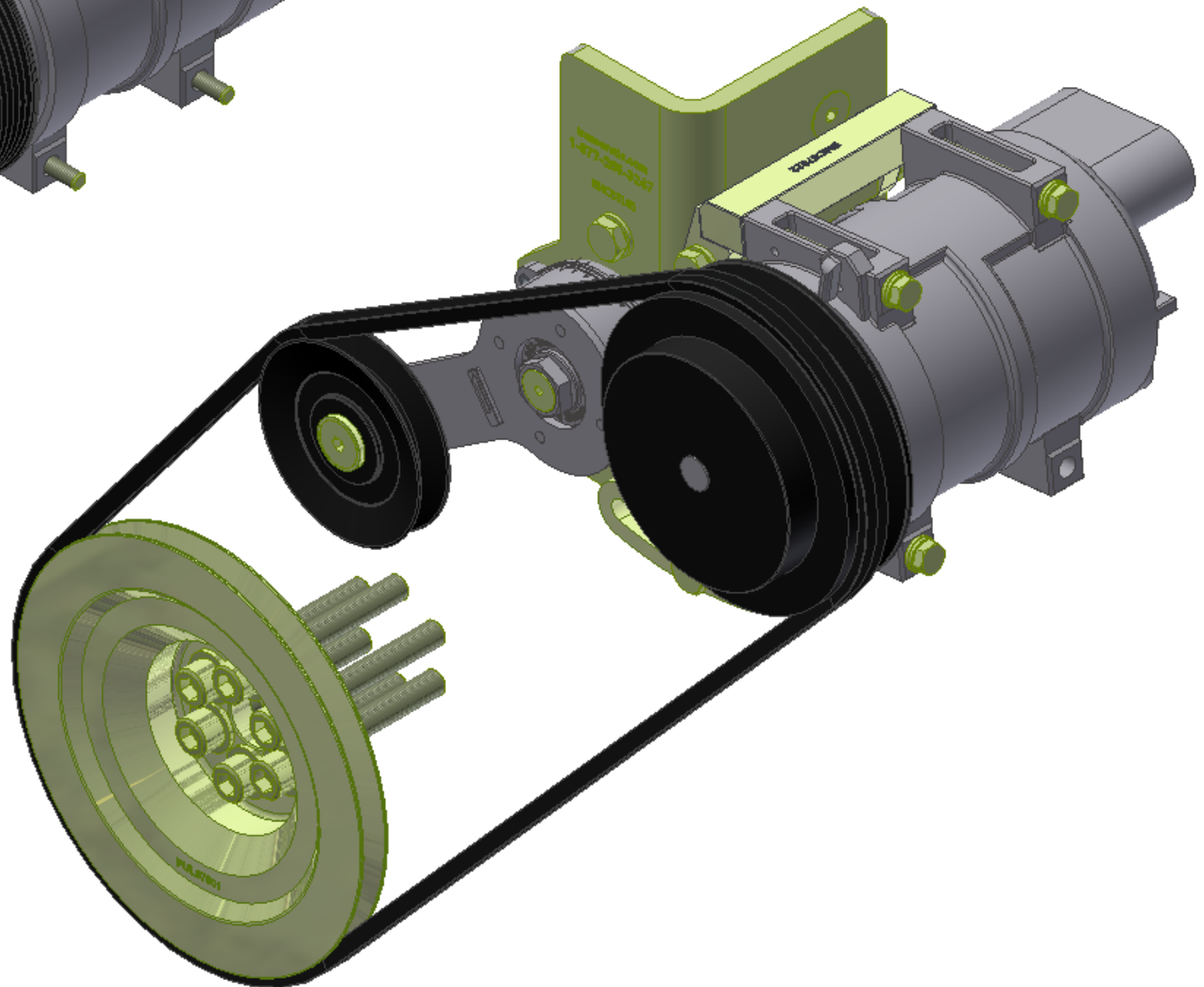
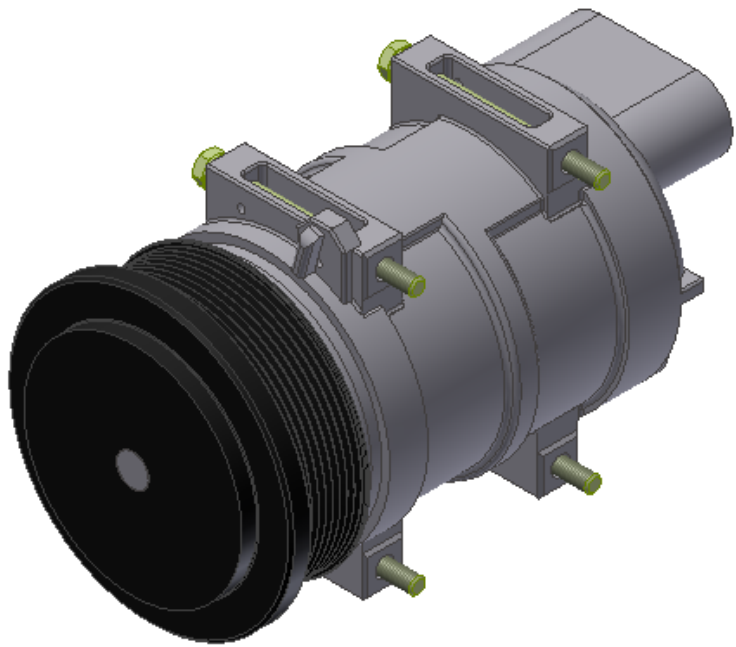

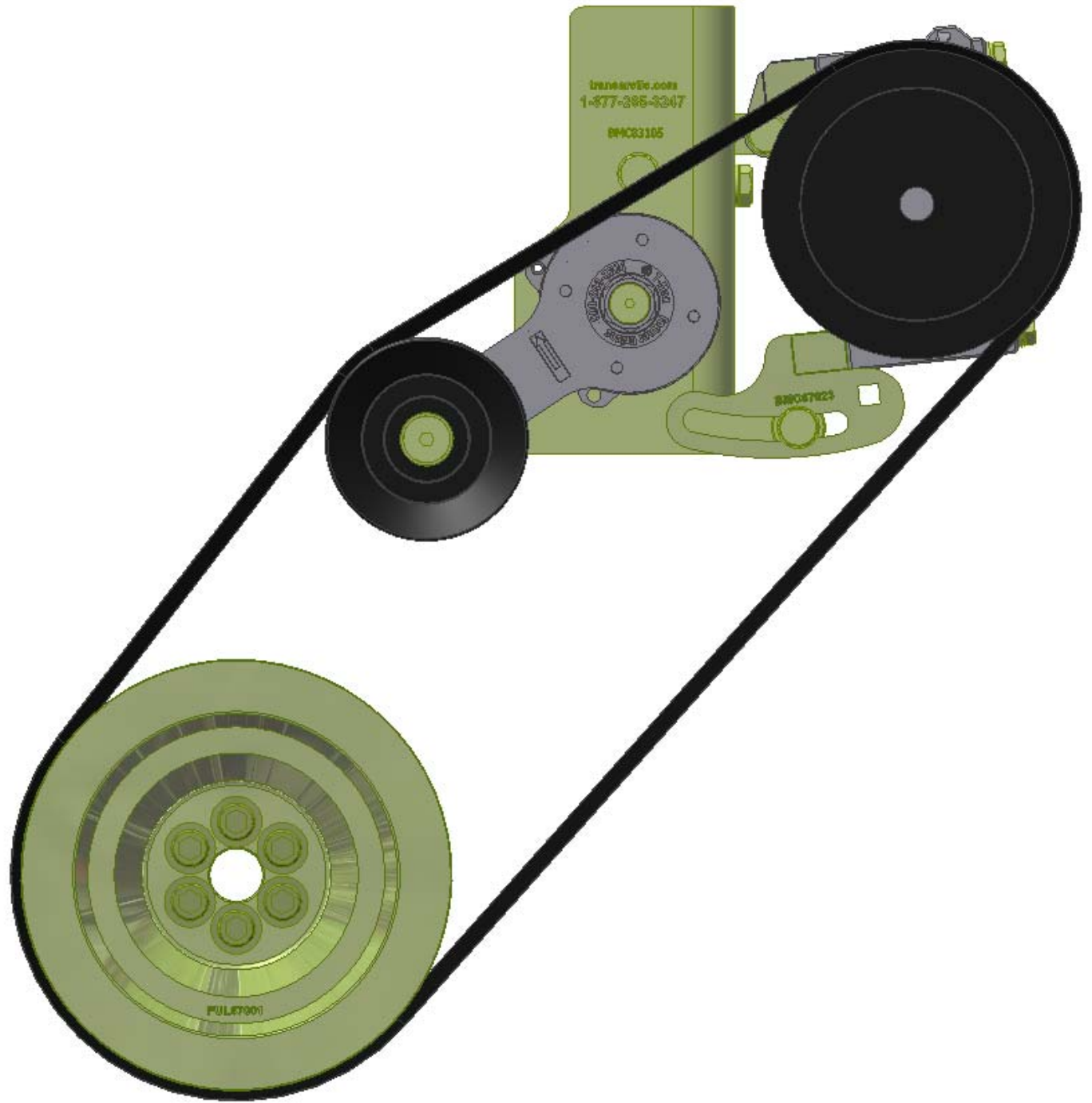
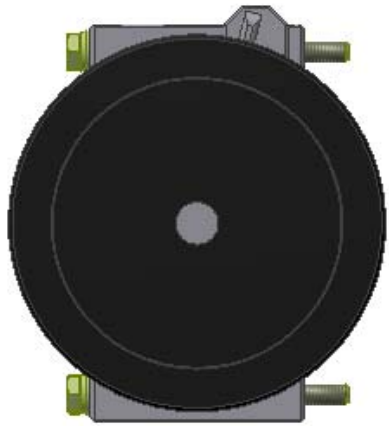

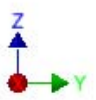
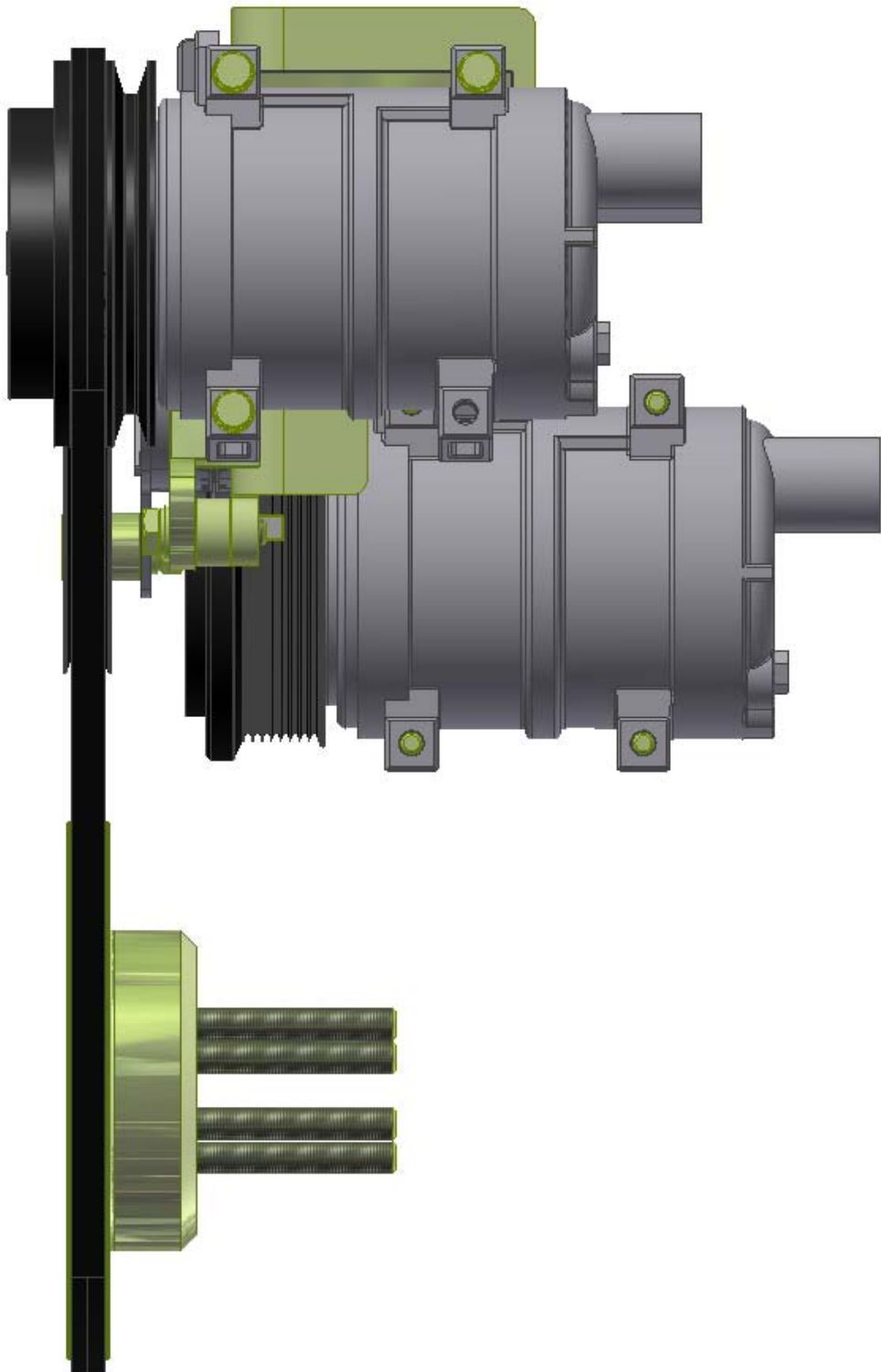

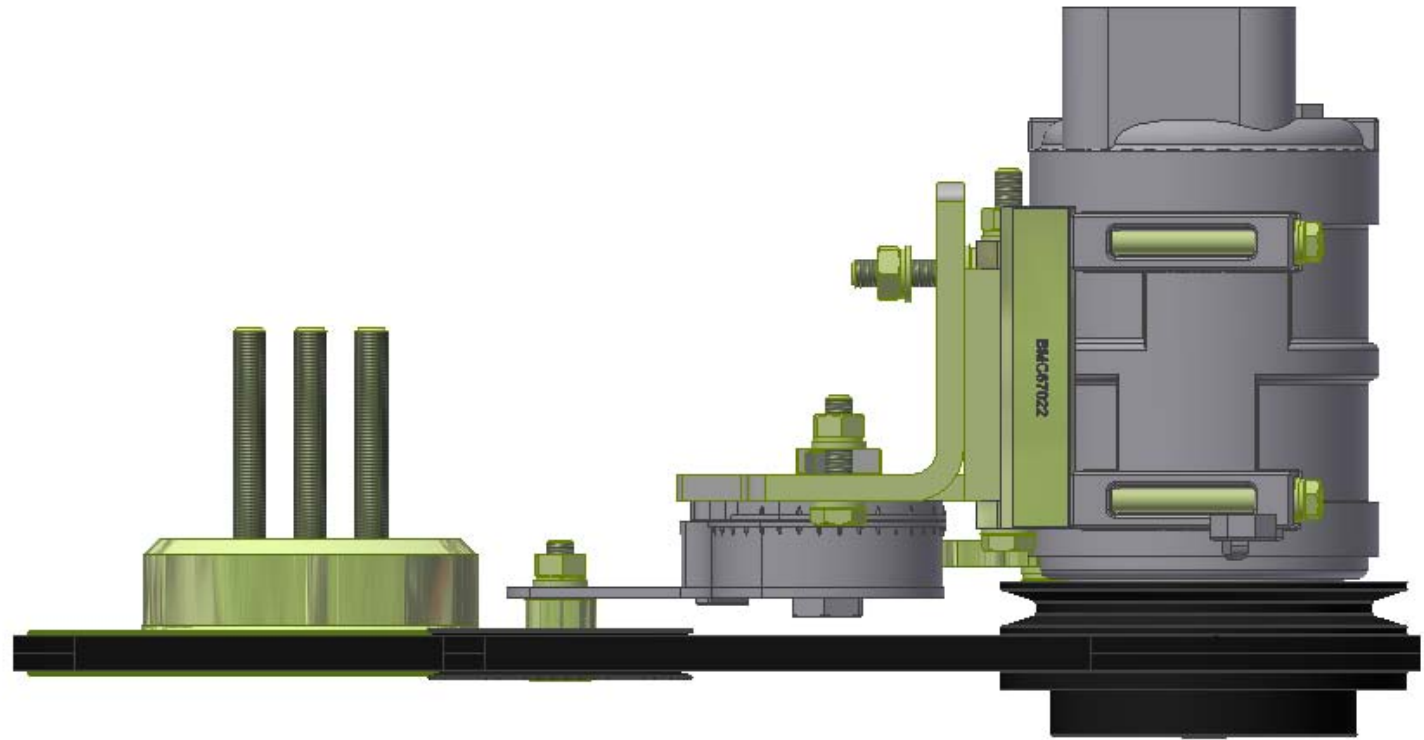
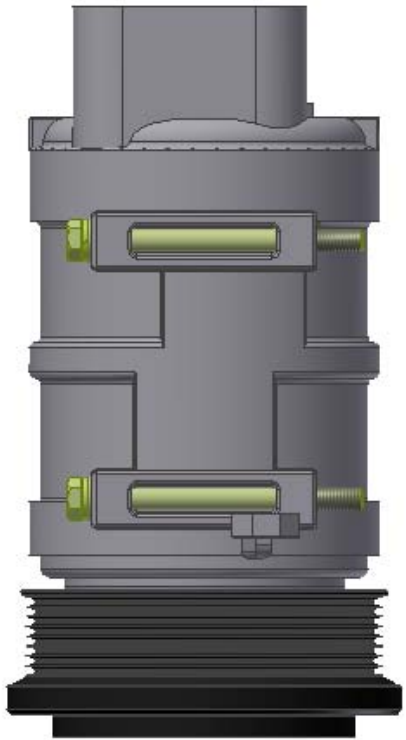

## **TransArctic A/C Compressor Mount Installation Disclaimer**

All compressor mounts should be installed by qualified and trained personnel using proper tools and equipment in safe working conditions following industry standard guidelines for motor vehicle service and repair.

The installer of any compressor mount purchased from TransArctic must undertake all responsibility of issues arising from that compressor bracket being installed on any vehicle. As well as insure that a **proper and sufficient ground** is established between the compressors' clutches and the vehicle's engine. Mount functionality, operation and durability can all be compromised by an incompetent installation.

Due to the many different situations, parameters and application criteria, which are beyond the compressor mount manufacturer's control, TransArctic does not warrant design, durability, or operational functionality of any compressor mount improperly installed by another party.

**With no implied guarantees it is the mount installer's strict responsibility to determine safety and functionality, of the compressor mount, at the time of installation.**

Please contact TransArctic with any issue arising from installation so we may better improve the product. If you have any reservations about the compressor mount integrity contact TransArctic immediately at 1-877-COLD-AIR.

**Mark OEM tensioner location**

**Install Kit**

**Check for Interferences**

**Check to ensure that the proper OEM tensioner orientation is maintained**

**Run engine with A/C system engaged for at least 10 minutes to run in belt**

**Check OEM tensioner orientation and adjust as required**

### **Responsabilidad limitada de TransArctic en la instalación del soporte del compresor**

Todos los soportes de los compresores deben ser instalados por personas calificadas y entrenadas, usando para ello los equipos y herramientas necesarios para esta labor en buenas condiciones y según las normas y guías para el servicio y/o reparación de motores de vehículos.

El instalador de los soportes comprados en TransArctic asume toda la responsabilidad de cualquier problema que surga en el soporte del compresor al vehículo; de igual manera es responsable que el cable a tierra sea conectado entre el embrague del compresor y el motor del vehículo.

Se advierte que el buen funcionamiento y la durabilidad del soporte pueden ser comprometidos por defectos en su instalación.

Debido a las diversas situaciones que se puedan presentar fuera del control del fabricante, TransArctic no garantiza el diseño, la durabilidad o el correcto funcionamiento de cualquier equipo inapropiadamente instalado por terceros.

**Esta sobreentendido que el Instalador del montaje del compresor es estrictamente responsable de la seguridad y funcionamiento del equipo en el momento de la instalación.**

Si tuviera algún problema o duda acerca de la instalación del soporte del compresor pongase en contacto inmediatamente con TransArctic al teléfono 1-877-COLD-AIR de modo que podamos mejorar nuestro producto.

**Note la ubicación del medidor de tensión OEM**

**Instale el equipo**

**Controlar si hay interferencias.**

**Asegurese que el medidor de tensión mantenga la orientación justa.**

**Encienda el motor por lo menos 10 minutos con el sistema A/C enganchado para que la correa corra**

**Controle la orientación justa del medidor de tensión y ajuste a las condiciones requeridas del fabricante**