

Bill of Materials Listing

TransArctic Canada Inc.

6/8/2020
Page 1 of 1

Product Number		Description	Rev#	Date	Weight	Uof M	Yield
Line	Component Prod#	Description	Bin	Unit	Qty		
KMC42698		Mt Kit, ISL-G, HDX ER, 2 TM-21, '19	0	10/2/2019	291.76		0
10	BEL21905	Belt, B gr, 1905mm (75") (BX72)		each	1		
13	BEL82134	Belt, 8gr, 2134mm (84")		each	1		
20	BMC67022	Bkt, Upper, Weldmt, D/S, ISB, TM-21		each	1		
23	BMC90007	Bkt, Cradle, ISL, R/H, TM-21,87mm,90/ccw		each	1		
25	BMC90008	Bkt, Cradle, ISL, L/H, TM-21,92mm,90/ccw		each	1		
30	BMC90030	Bkt, Support, Side Post, HDX, '19		each	1		
40	BMC90031	Bkt, Weldm't, Tensioner, HDX, '19		each	1		
50	BMC90034	Bkt, PI, Jack Screw, HDX, '19		each	1		
60	BMC90037	Bkt, Lower, Cradle, Weldm't, TM-21, '19		each	1		
70	BMT10011	Bkt, Tenr, Block, Offset, 3mm		each	1		
80	BMT10012	Bkt, Block, Jack Screw, Threaded		each	1		
90	KPC90012	Kit, Pulley, ISL-G, 8.9L,1B/X,10.63",'19		each	1		
100	PUA20077	Pulley, Assy, Idler, SB, 3"d , STL		each	2		
110	SCD06410	Spacer, Col, Drl, 6.35mm x 25.4o x10.32i		each	1		
120	SCD37510	Spacer, Col, Drl, 37 mm x 25.4o x 12.3i		each	2		
130	SLV17110	Sleeve, Pulley,S,16.9o x 22.23mm x 10.3i	Alley	each	2		
140	KBC92698	Bag Kit, Fasteners, KMC92698/42698		each	1		

Bill of Materials Listing

TransArctic Canada Inc.

6/8/2020
Page 1 of 1

Product Number		Description	Rev#	Date	Weight	Uof M	Yield
Line	Component Prod#	Description	Bin	Unit	Qty		
KBC92698		Bag Kit, Fasteners, KMC92698/42698	0	10/10/2019	2.97		0
5	BTC08035	Bolt, Hex, 8 x 1.25 x 35mm, 10.9, Plt,FT		each	2		
10	BTC08100	Bolt, Hex, 8 x 1.25 x 100mm, 10.9, Plt		each	6		
20	BTC08120	Bolt, Hex, 8 x 1.25 x 120mm, 10.9, Plt		each	2		
30	BTC10040	Bolt, Hex, 10 x 1.5 x 40mm, 10.9, Plt,FT		each	2		
40	BTC10080	Bolt, Hex, 10 x 1.5 x 80mm, 10.9, Plt,FT		each	2		
50	BTC10130	Bolt, Hex, 10 x 1.5 x 130mm, 10.9, Plt		each	1		
60	BTQ08125	Bolt, Hex, 1/2-13unc, 1.25", 8, Plt		each	1		
65	BTQ08150	Bolt, Hex, 1/2-13unc, 1.5", 8, Plt		each	1		
70	BTQ08200	Bolt, Hex, 1/2-13unc, 2.0", 8, Plt		each	2		
80	BTS08080	Bolt, Hex, Weldm't, 1/2-13 UNC x 8"		each	1		
90	CSF10031	Capscrew, FH, 10 x 1.5 x 30mm, 10.9,Plt		each	1		
100	CSF10036	Capscrew, FH, 10 x 1.5 x 35mm, 10.9,Plt		each	1		
110	NTA10000	Nut, Hex, 10 x 1.5, 8.8, Plt		each	6		
120	NTQ08000	Nut, Hex, 1/2-13unc, 8, Plt		each	4		
130	WFA08000	Washer, Flat, 8mm, 8.8, Plt		each	10		
140	WFA10000	Washer, Flat, 10mm, 8.8, Plt		each	7		
150	WFA10002	Washer, Flat, 10mm, Hvy, 8.8, Plt		each	4		
160	WFAQ08000	Washer, Flat, 1/2", 8, Plt		each	8		
170	WLA08000	Washer, Lock, 8mm, 8.8, Plt		each	10		
180	WLA10000	Washer, Lock, 10mm, 8.8, Plt		each	7		
190	WLQ08000	Washer, Lock, 1/2", 8, Plt		each	5		

Bill of Materials Listing

TransArctic Canada Inc.

6/8/2020
Page 1 of 1

Product Number		Description	Rev#	Date	Weight	Uof M	Yield
Line	Component Prod#	Description	Bin	Unit	Qty		
KPC90012		Kit, Pulley, ISL-G, 8.9L,1B/X,10.63", '19	0	10/15/2013	22.21		0
10	PUL90012	Pulley, Crank, ISL-G,9.0L, 1B/X, 10", '19		each	1		
20	BTC12080	Bolt, Hex, 12 x 1.75 x 80mm, 10.9,Plt,FT		each	4		
30	WFS12002	Washer, Flat, Hdn, 12mm, Stl, BLK		each	4		

8 7 6 5 4 3 2 1

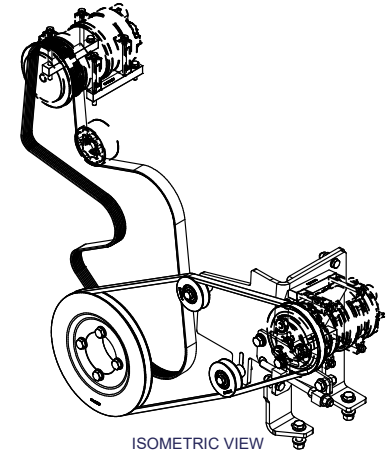
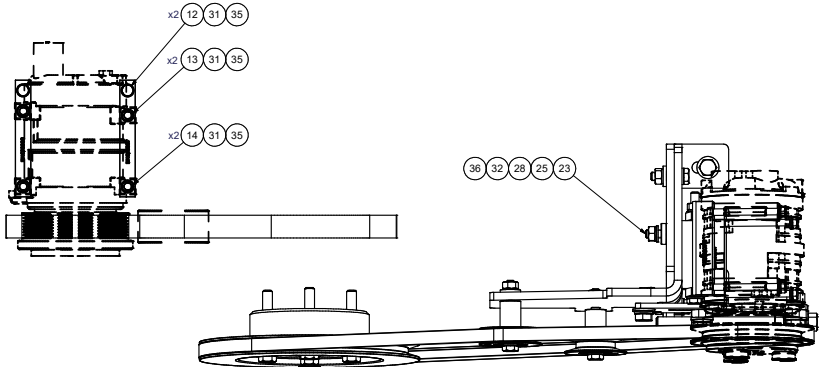

NOTE:
SHOWING TRANSACTIC
COMPRESSOR PART#
CMS13181 (TM-21)
AS REFERENCE.

NOTE:
SHOWING TRANSACTIC
COMPRESSOR PART#
CMV13112 (TM-21)
AS REFERENCE.

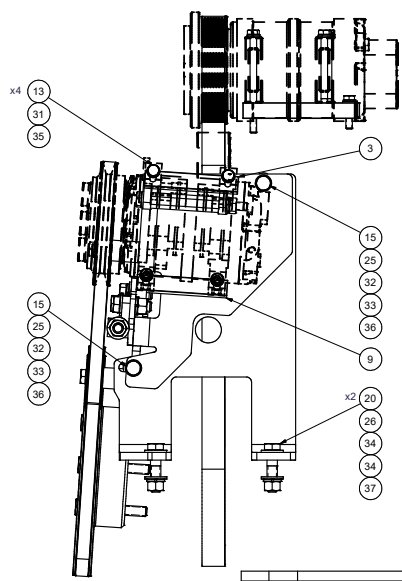
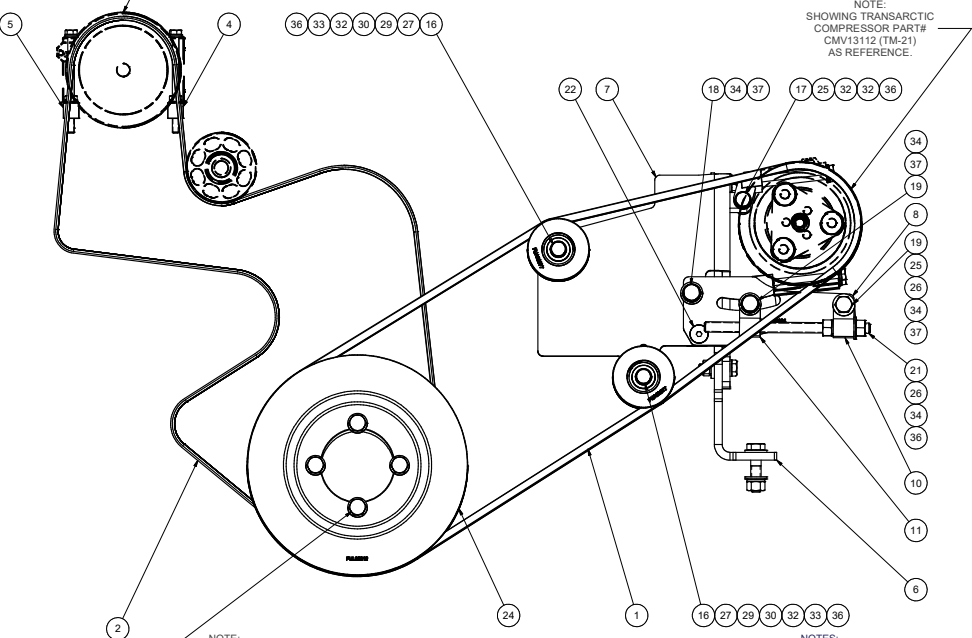

ITEM	QTY	U/M	PART NUMBER	DESCRIPTION
37	5	EACH	WLQ08000	WASHER, LOCK, 1/2", 8, PLT
36	7	EACH	WLA10000	WASHER, LOCK, 10mm, 8.8, PLT
35	10	EACH	WLA08000	WASHER, LOCK, 8mm, 8.8, PLT
34	8	EACH	WFO08000	WASHER, FLAT, 1/2", 8, PLT
33	4	EACH	WFA10002	WASHER, FLAT, 10mm, HVY, 8.8, PLT
32	7	EACH	WFA10000	WASHER, FLAT, 10mm, 8.8, PLT
31	10	EACH	WFA08000	WASHER, FLAT, 8mm, 8.8, PLT
30	2	EACH	SLV17110	SLEEVE, PULLEY, S, 16.90 x 22.23mm x 10.31
29	2	EACH	SCD37510	SPACER, COL, DRL, 37.5mm x 25.40 x 10.31
28	1	EACH	SCD06410	SPACER, COL, DRL, 6.35mm x 25.40 x 10.31
27	2	EACH	PLA30077	PULLEY, ASSY, IDLER, S8, 3"D, STL
26	4	EACH	NTQ08000	NUT, HEX, 1/2-13UNC, 8, PLT
25	6	EACH	NTA10000	NUT, HEX, 10 x 1.5, 8.8, PLT
24	1	EACH	KPC90012	KIT, PULLEY, ISL-G, 8.9L, 18/X, 10.63", '19
23	1	EACH	CSF10036	CAPSCREW, FH, 10 x 1.5 x 35mm, 10.9, PLT
22	1	EACH	CSF10031	CAPSCREW, FH, 10 x 1.5 x 30mm, 10.9, PLT
21	1	EACH	BTS08080	BOLT, HEX, WELDMT, 1/2-13UNC x 8"
20	2	EACH	BTQ08200	BOLT, HEX, 1/2-13UNC x 2.00, 8, PLT
19	2	EACH	BTQ08150	BOLT, HEX, 1/2-13UNC x 1.50, 8, PLT
18	1	EACH	BTQ08125	BOLT, HEX, 1/2-13UNC x 1.25, 8, PLT
17	1	EACH	BTC10130	BOLT, HEX, 10 x 1.5 x 130mm, 10.9, PLT
16	2	EACH	BTC10080	BOLT, HEX, 10 x 1.5 x 80mm, 10.9, PLT
15	2	EACH	BTC10040	BOLT, HEX, 10 x 1.5 x 40mm, 10.9, PLT
14	2	EACH	BTC08120	BOLT, HEX, 8 x 1.25 x 120mm, 10.9, PLT
13	6	EACH	BTC08100	BOLT, HEX, 8 x 1.25 x 100mm, 10.9, PLT
12	2	EACH	BTC08035	BOLT, HEX, 8 x 1.25 x 35mm, 10.9, PLT
11	1	EACH	BMT10012	BKT, BLOCK, JACK SCREW, THREADED
10	1	EACH	BMT10011	BKT, TENR, BLOCK, OFFSET, 3mm
9	1	EACH	BMC90037	BKT, LOWER, CRADLE, WELDMT, TM-21
8	1	EACH	BMC90034	BKT, PL, JACK SCREW, HDX, '19
7	1	EACH	BMC90031	BKT, WELDMT, MAIN, TENSIONER, HDX, '19
6	1	EACH	BMC90030	BKT, SUPPORT, SIDE POST, HDX, '19
5	1	EACH	BMC90008	Bkt, Cradle, ISL, L/H, TM-21, 92mm, 90/ccw
4	1	EACH	BMC90007	Bkt, Cradle, ISL, R/H, TM-21, 87mm, 90/ccw
3	1	EACH	BMC67022	BKT, UPPER, WELDMT, D/S, ISB, TM-21
2	1	EACH	BEL82134	BELT, 8GR, 2134mm (84") (S080840)
1	1	EACH	BEL21905	BELT, B, GR, 1905mm (75") (BX72)

BILL OF MATERIALS			
DRAWN	vjakowlew	DATE	6/8/2020
CHECKED	Jose Rodriguez	DATE	6/8/2020
APPROVED	James Stewart	DATE	6/8/2020
APPROVED	Dale Mason	DATE	6/8/2020
TITLE		MT KIT, ISL-G, HDX ER, 2 TM-21, '19	
SIZE	DWG NO		REV
D	KMC42698		0
SCALE	1:5		SHEET 1 OF 1

REV	ECN	DESCRIPTION	DATE	BY	VAL
0		RELEASED TO PRODUCTION	06/08/2020		
1					

UNSPECIFIED TOLERANCES: ALL DIMS IN INCH

ONE DECIMAL PLACE (X1) 1/16 INCH
TWO DECIMAL PLACE (X2) 1/32 INCH
THREE DECIMAL PLACE (X3) 0.001 INCH
FRACTIONAL IN INCH: 1/8 INCH

THIRD ANGLE PROJECTION

NOTE:
TORQUE TO: 66 - 73 FT-LB PLAIN & LUBRICATED W/ CLEAN ENGINE OIL (15W-40)
(HEXBOLT CAPSCREW M12 x 1.75 x 80mm)
TIGHTEN IN TWO STEPS IN A CRIS-CROSS TIGHTENING SEQUENCE PATTERN.

NOTES:
1) USE SERVICABLE THREADLOCKER ON ALL FASTENERS TO ENGINE COMPONENTS AND TORQUE ALL BOLTS TO S.A.E. SPECIFICATIONS.
2) SEE "TRANSACTIC A/C COMPRESSOR MOUNT INSTALLATION DISCLAIMER".

TRANSACTIC INC.

8 7 6 5 4 3 2 1

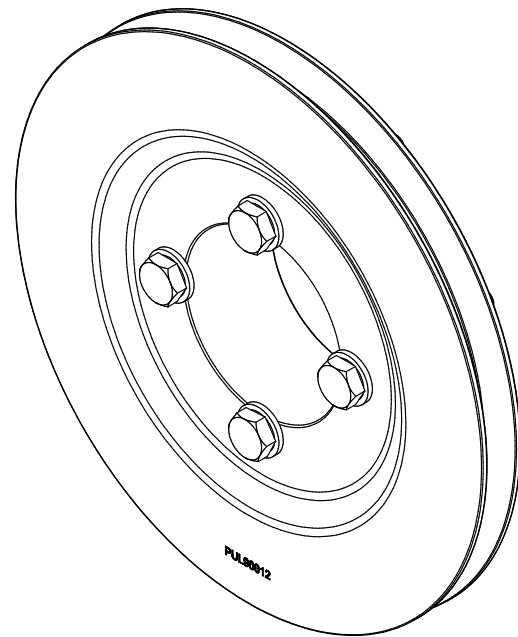
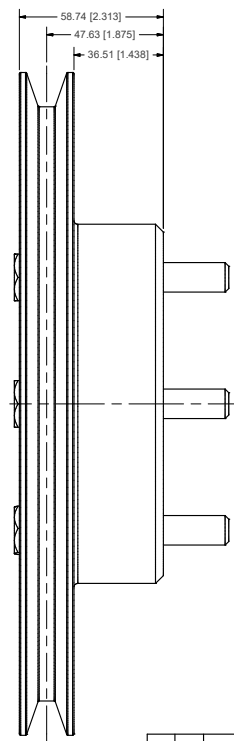
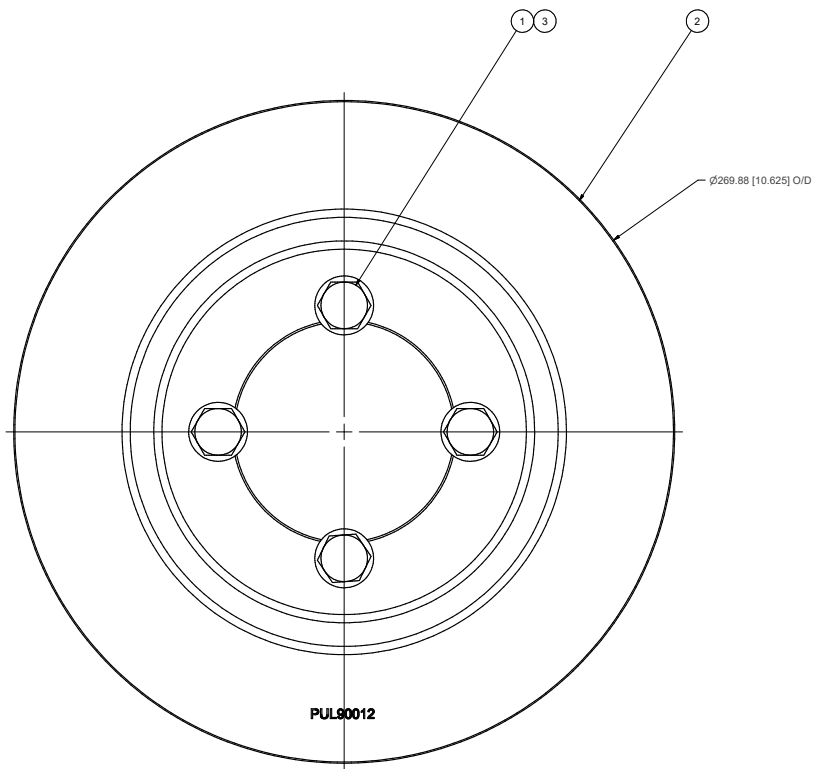

ISOMETRIC VIEW:

- NOTES:**
- 1) USE SERVICABLE THREADLOCKER ON ALL FASTENERS TO ENGINE COMPONENTS AND TORQUE **ALL** BOLTS TO S.A.E. SPECIFICATIONS.
 - 2) SEE "TRANSARC TIC A/C COMPRESSOR MOUNT INSTALLATION DISCLAIMER".
 - 3) WEIGHT: 22.20 LB

ITEM	QTY	U/M	PART NUMBER	DESCRIPTION
3	4	EACH	WFS12002	WASHER, FLAT, HDN, 12mm, STL, BLK
2	1	EACH	PUL90012	PULLEY, CRANK, ISL-G, 8.9L, B/X, 10.63", '19
1	4	EACH	BTC12080	BOLT, HEX, 12 x 1.75 x 80mm, 10.9, FLT, FT

DRAWN		CHECKED		TITLE	
vjakowlew	6/4/2020	Jose Rodriguez	6/4/2020	PULLEY, CRANK, ISL-G, 8.9L, B/X, 10.63", '19	
APPROVED		James Stewart	6/4/2020	MFG	
		Dale Mason	6/4/2020	APPROVED	
UNSPECIFIED TOLERANCES:		ALL DIMS		DWG NO	
ONE DECIMAL PLACE (X1)	MM	FRAC		KPC90012	
TWO DECIMAL PLACE (X2)	MM	FRAC		REV	
THREE DECIMAL PLACE (X3)	MM	FRAC		0	
FRACTIONAL (X1/8)	MM	FRAC		SCALE	

REV	ECN	DESCRIPTION	DATE	BY
0		RELEASED TO PRODUCTION	06/04/2020	VAL



DRAWING UNIT OF MEASURE: MM (INCH) SCALE: 1:1 SHEET 1 OF 1



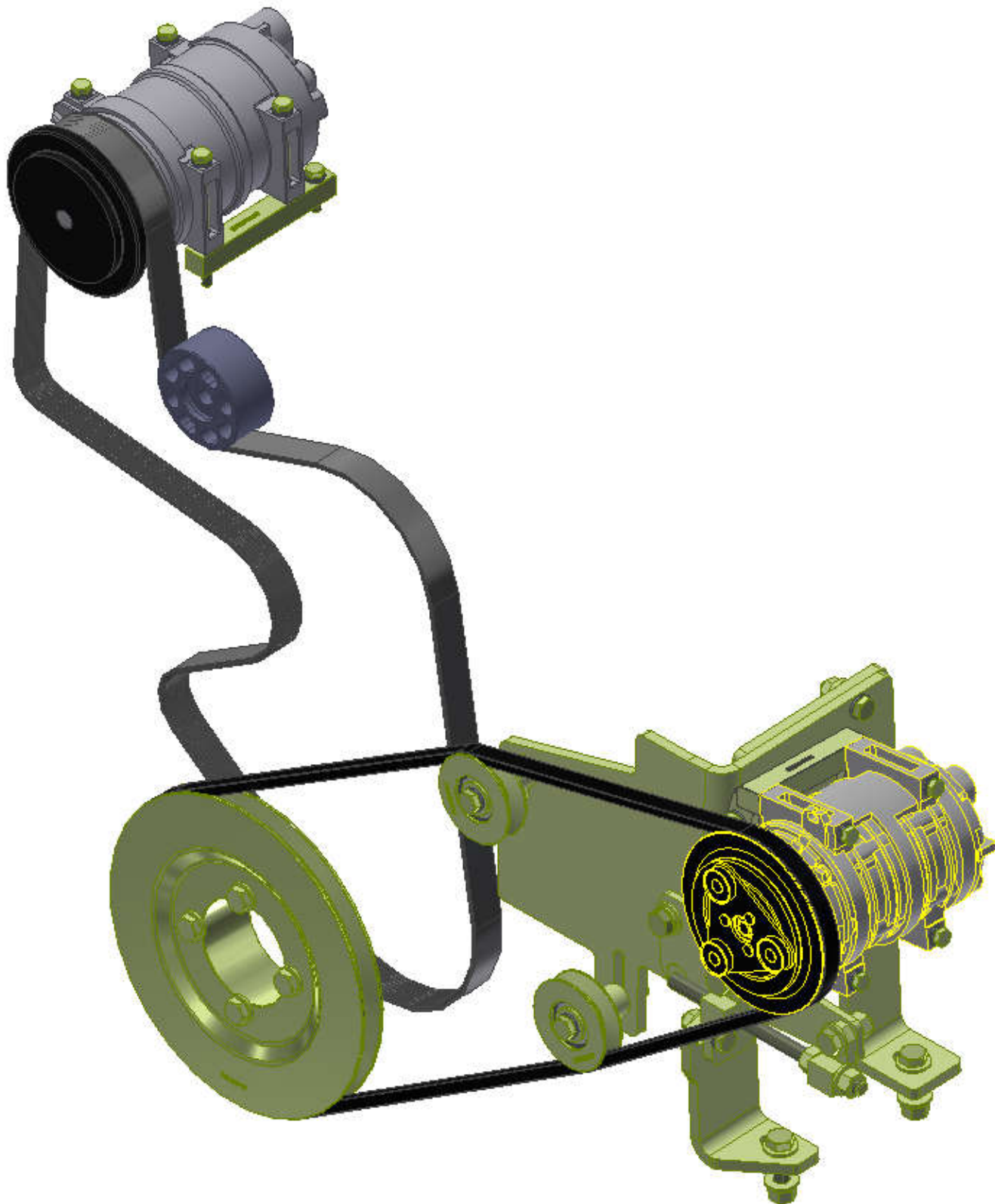

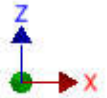
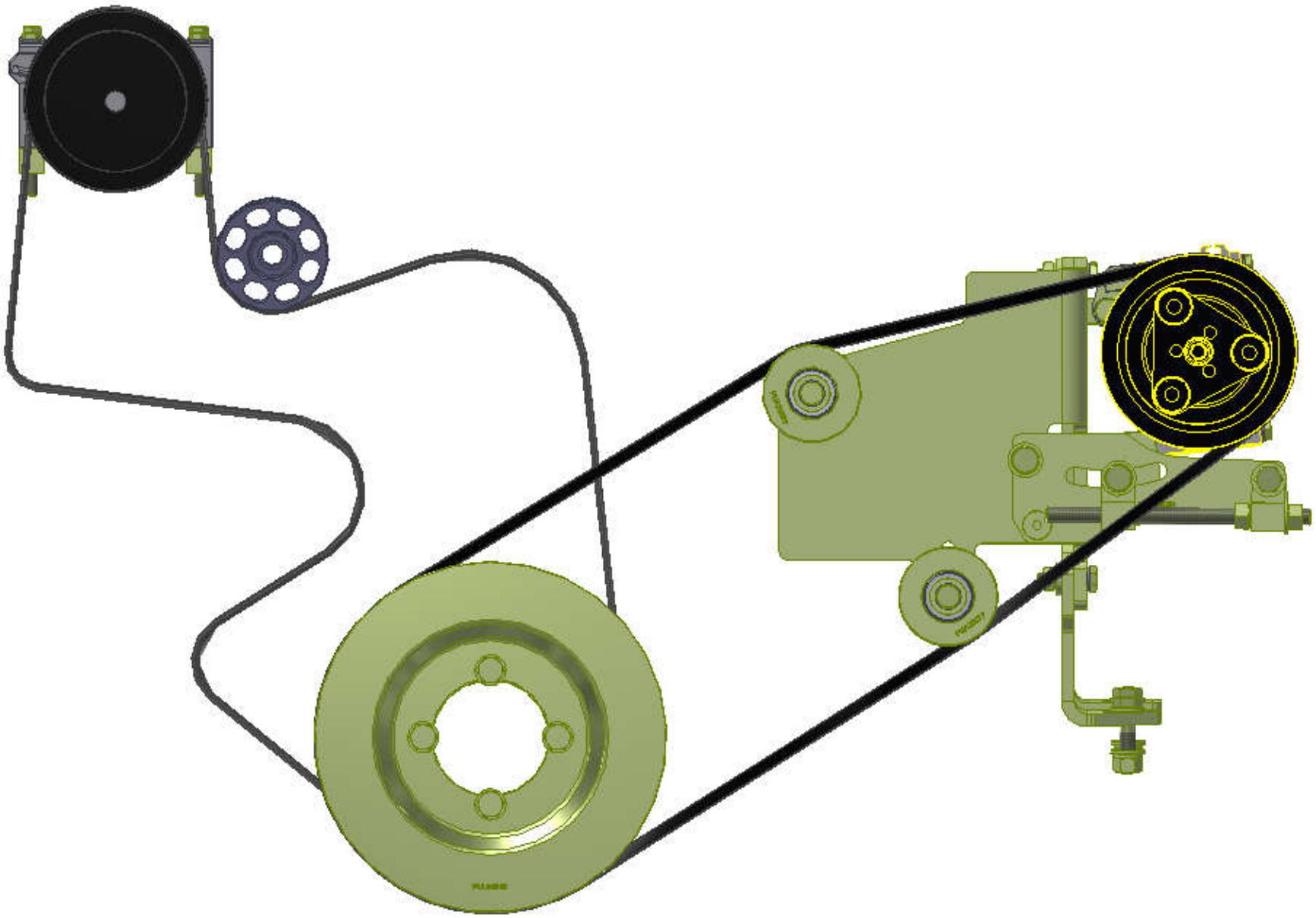

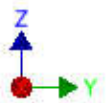
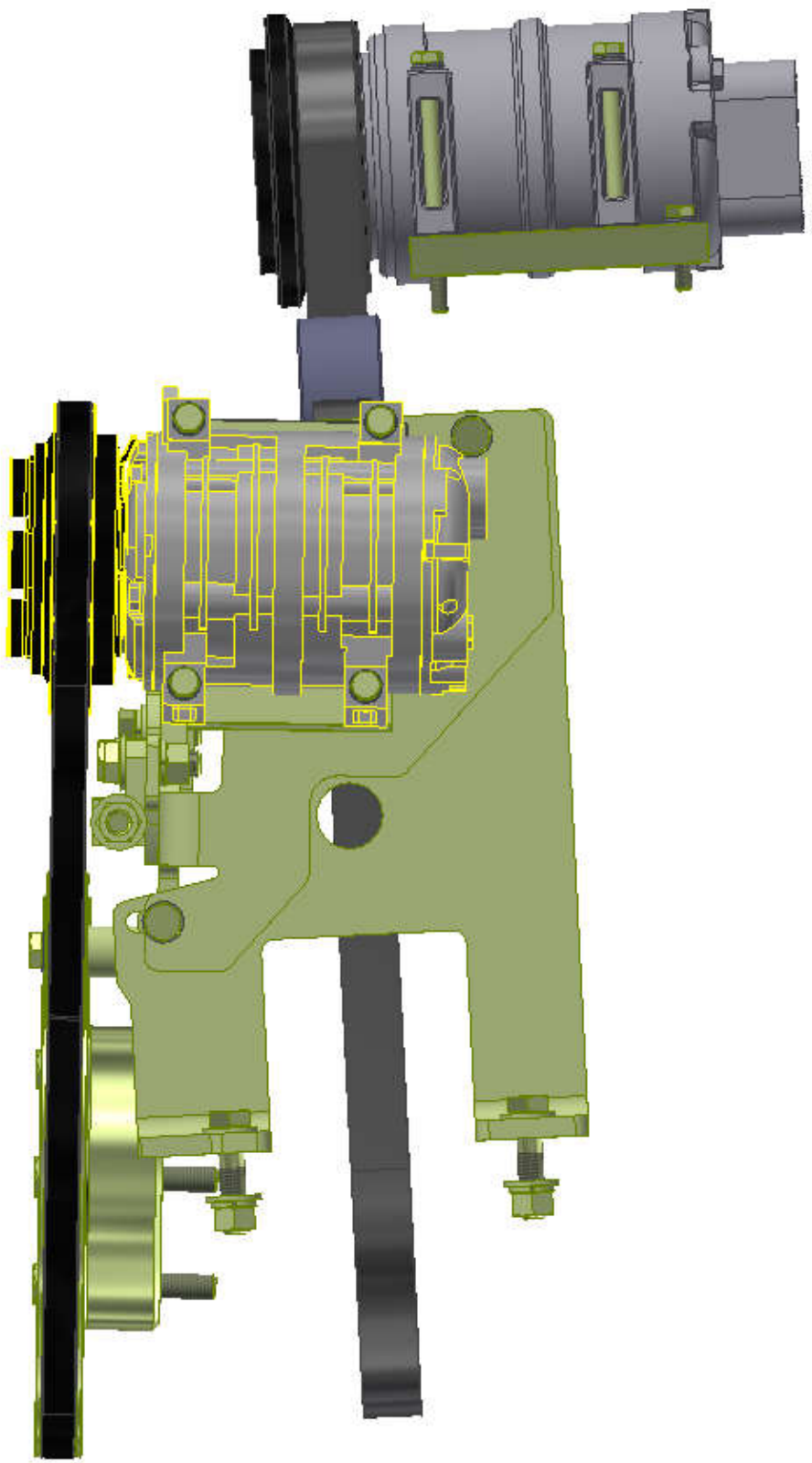

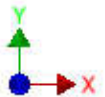
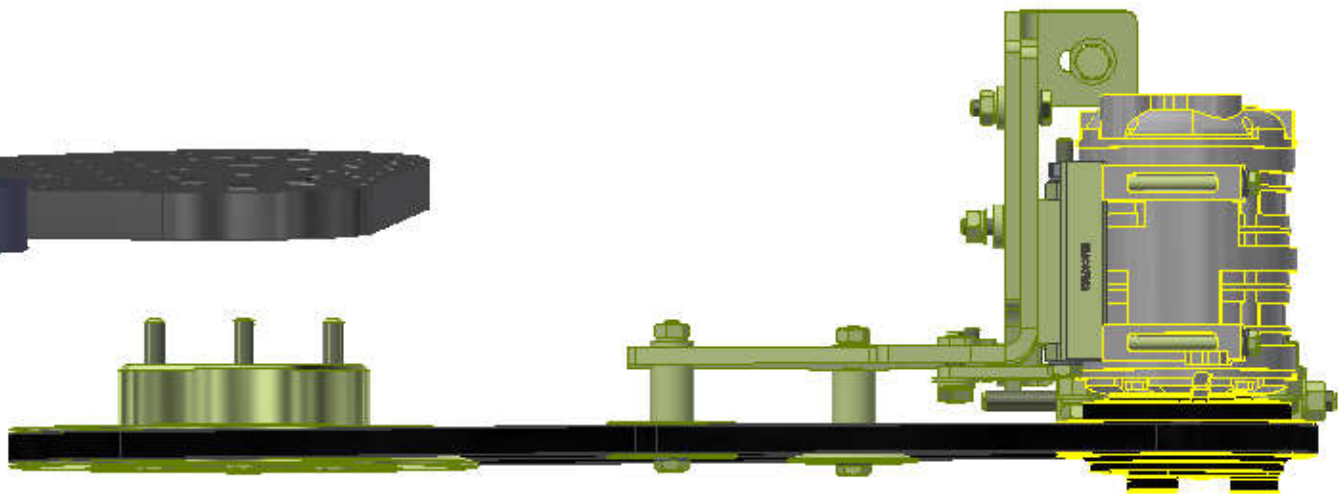

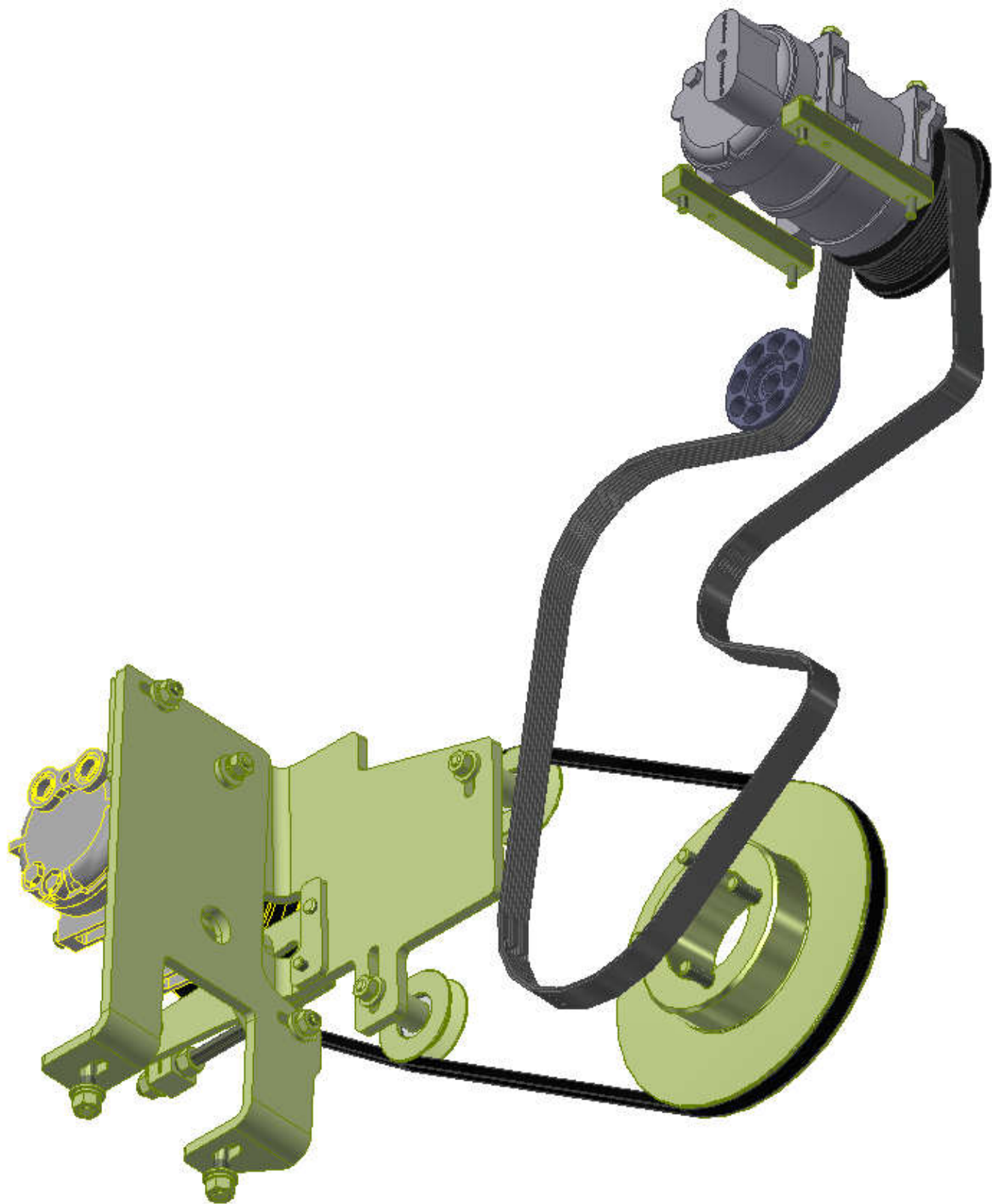

TransArctic A/C Compressor Mount Installation Disclaimer

All compressor mounts should be installed by qualified and trained personnel using proper tools and equipment in safe working conditions following industry standard guidelines for motor vehicle service and repair.

The installer of any compressor mount purchased from TransArctic must undertake all responsibility of issues arising from that compressor bracket being installed on any vehicle. As well as insure that a **proper and sufficient ground** is established between the compressors' clutches and the vehicle's engine. Mount functionality, operation and durability can all be compromised by an incompetent installation.

Due to the many different situations, parameters and application criteria, which are beyond the compressor mount manufacturer's control, TransArctic does not warrant design, durability, or operational functionality of any compressor mount improperly installed by another party.

With no implied guarantees it is the mount installer's strict responsibility to determine safety and functionality, of the compressor mount, at the time of installation.

Please contact TransArctic with any issue arising from installation so we may better improve the product. If you have any reservations about the compressor mount integrity contact TransArctic immediately at 1-877-COLD-AIR.

Mark OEM tensioner location

Install Kit

Check for Interferences

Check to ensure that the proper OEM tensioner orientation is maintained

Run engine with A/C system engaged for at least 10 minutes to run in belt

Check OEM tensioner orientation and adjust as required

Responsabilidad limitada de TransArctic en la instalación del soporte del compresor

Todos los soportes de los compresores deben ser instalados por personas calificadas y entrenadas, usando para ello los equipos y herramientas necesarios para esta labor en buenas condiciones y según las normas y guías para el servicio y/o reparación de motores de vehículos.

El instalador de los soportes comprados en TransArctic asume toda la responsabilidad de cualquier problema que surga en el soporte del compresor al vehículo; de igual manera es responsable que el cable a tierra sea conectado entre el embrague del compresor y el motor del vehículo.

Se advierte que el buen funcionamiento y la durabilidad del soporte pueden ser comprometidos por defectos en su instalación.

Debido a las diversas situaciones que se puedan presentar fuera del control del fabricante, TransArctic no garantiza el diseño, la durabilidad o el correcto funcionamiento de cualquier equipo inapropiadamente instalado por terceros.

Esta sobreentendido que el Instalador del montaje del compresor es estrictamente responsable de la seguridad y funcionamiento del equipo en el momento de la instalación.

Si tuviera algún problema o duda acerca de la instalación del soporte del compresor pongase en contacto inmediatamente con TransArctic al teléfono 1-877-COLD-AIR de modo que podamos mejorar nuestro producto.

Note la ubicación del medidor de tensión OEM

Instale el equipo

Controlar si hay interferencias.

Asegurese que el medidor de tensión mantenga la orientación justa.

Encienda el motor por lo menos 10 minutos con el sistema A/C enganchado para que la correa corra

Controle la orientación justa del medidor de tensión y ajuste a las condiciones requeridas del fabricante