

Bill of Materials Listing

TransArctic Canada Inc.

4/15/2010
Page 1 of 1

Product Number		Description	Bin	Date	Weight	Uof M	Yield
Line	Component Prod#	Description		Unit	Qty		
KMN84132		Mt. Kit, MForce DT, RE300, 05G, 07-08		10/3/2007	226.40		0
10	BEL22769	Belt, B gr, 2769mm (109") (BX106)		each	2		
20	BMN80041	Bkt, Main, Front PI, ICRE, 2007		each	1		
30	BMN80042	Bkt, Main, Rear PI, ICRE, 2007		each	1		
40	BMN80008	Vibration Isolator, Bar,16.50 x 2 x 1.50		each	2		
50	BMN80009	Bkt, Main, Base PI, IC, RE300		each	1		
60	BMN80010	Bkt, Main, Slide, Assy, O5G, IC, RE300		each	1		
70	BMN80024	Bkt, Comp, FRT, Z, IC, RE300		each	1		
80	BMN80025	Bkt, Back, PL, Slide, IC, RE300		each	1		
90	BMN80043	Bkt, Spacer Plate, ICRE, 2007		each	1		
100	BMN80044	Bkt, Main Idler PI, ICRE, 2007		each	1		
115	BMN80061	Bkt, Diag, Brace, IC, RE300, '07		each	1		
116	BMN80068	Bkt, Riser,Weldm't, MF DT, RE300		each	2		
120	PUA06001	Pulley, Assy, Idler, B/S, 6", Stl, Plt		each	1		
130	PUA05012	Pulley, Assy, Idler,B/BX gr,5", STL,Plt		each	1		
140	PUL76022	Pulley, Crank, Nav DT, 7.6L, 2B/X,8" DIA		each	1		
150	SLV17012	Sleeve, Pulley, 16.9o x 22.23mm x 12.32i		each	2		
160	SCD14912	Spacer, Col, Drl,14.9 mm x 31.8o x 12.3i		each	2		
170	SCD29213	Spacer, Col, Drl,29.21mm x 25.4o x 12.7i		each	2		
200	KBN84132	Bag Kit, Fasteners, KMN84132		each	1		

Bill of Materials Listing

TransArctic Canada Inc.

5/6/2010

Page 1 of 1

Product Number		Description	Bin	Date	Weight	Uof M	Yield
Line	Component Prod#	Description		Unit	Qty		
KBN84132		Bag Kit, Fasteners, KMN84132		9/10/2007	8.09		0
20	BTC12070	Bolt, Hex, 12 x 1.75 x 70mm, 10.9, Plt		each	2		
40	BTC10050	Bolt, Hex, 10 x 1.5 x 50mm, 10.9, Plt		each	6		
50	BTC10040	Bolt, Hex, 10 x 1.5 x 40mm, 10.9, Plt,FT		each	4		
55	BTQ08151	Bolt, Hex, 1/2-20unf, 1.5", 8, Plt		each	1		
60	BTQ12250	Bolt, Hex, 3/4- 10unc, 2.50", 8, Plt		each	1		
65	BTQ10250	Bolt, Hex, 5/8-11unc, 2.5", 8, PLT		each	1		
70	BTQ10301	Bolt, Hex, 5/8-18unf, 3", 8, PLT		each	2		
80	BTQ08451	Bolt, Hex, 1/2-20unc, 4.5", 8, Plt		each	1		
85	BTQ08401	Bolt, Hex, 1/2-20unf, 4", 8, Plt		each	6		
90	BTQ08301	Bolt, Hex, 1/2-20unf, 3", 8, Plt		each	1		
100	BTQ08200	Bolt, Hex, 1/2-13unc, 2.0", 8, Plt		each	1		
110	BTQ08201	Bolt, Hex, 1/2-20unc, 2.0", 8, Plt		each	2		
120	BTQ08126	Bolt, Hex, 1/2-20unf, 1.25", 8, Plt		each	11		
130	BTQ06150	Bolt, Hex, 3/8-16unc, 1.50", 8, Plt		each	2		
140	BTP08653	Bolt, Hex, 1/2-13unc, 6.5", 5, Plt, FT		each	1		
150	NTA12000	Nut, Hex, 12 x 1.75, 8.8, Plt		each	2		
160	NTA10000	Nut, Hex, 10 x 1.5, 8.8, Plt		each	4		
165	NTL10000	Nut, Lock, Hex, 5/8-11unc, 9, Plt		each	1		
170	NTP12000	Nut, Hex, 3/4-10unc, 5, Plt		each	1		
180	NTP08000	Nut, Hex, 1/2-13unc, 5, Plt		each	1		
190	NTP07000	Nut, Hex, 7/16-14unc, 5, Plt		each	4		
200	WFA12000	Washer, Flat, 12mm, 8.8, Plt		each	2		
210	WFA10000	Washer, Flat, 10mm, 8.8, Plt		each	14		
220	WFQ12000	Washer, Flat, 3/4", 8, Plt		each	2		
230	WFQ10000	Washer, Flat, 5/8", 8, Plt		each	4		
240	WFQ08000	Washer, Flat, 1/2", 8, Plt		each	24		
250	WFN07000	Washer, Flat, 7/16", 2, Plt		each	4		
260	WFN06000	Washer, Flat, 3/8", 2, Plt		each	2		
270	WLA12000	Washer, Lock, 12mm, 8.8, Plt		each	2		
280	WLA10000	Washer, Lock, 10mm, 8.8, Plt		each	4		
290	WLP12000	Washer, Lock, 3/4", 5, Plt		each	1		
300	WLP08000	Washer, Lock, 1/2", 5, Plt		each	20		
310	WLP07000	Washer, Lock, 7/16", 5, Plt		each	4		
320	WLP06000	Washer, Lock, 3/8", 5, Plt		each	2		
330	WLQ10000	Washer, Lock, 5/8", 8, Plt		each	1		

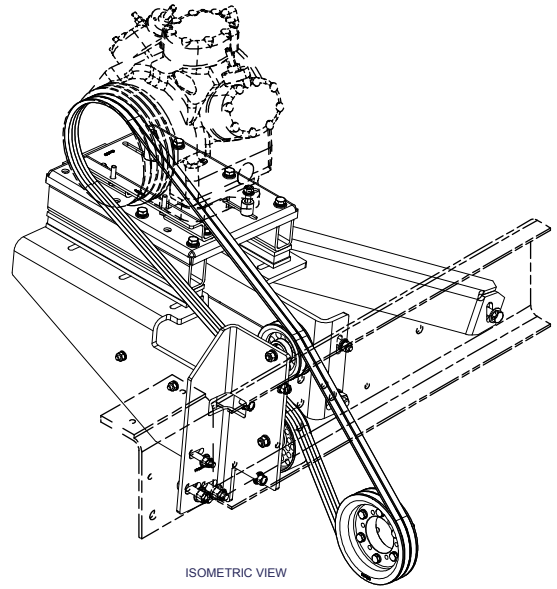
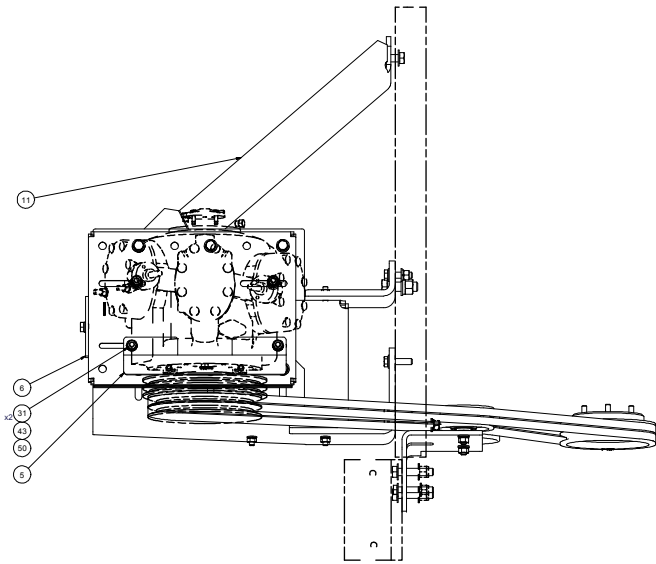

ISOMETRIC VIEW

NOTE:
"HAND TIGHTEN (8) 1/2"x 4 BOLTS (RISER BRACKET FASTENERS) ON INSTALLATION THEN AT FINAL ALIGNMENT & ASSEMBLY, FULLY TIGHTEN"

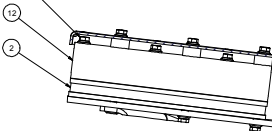

SECTION A-A

NOTE:
"CARISER COMPRESSOR PART#: 68PD541-124-xx"

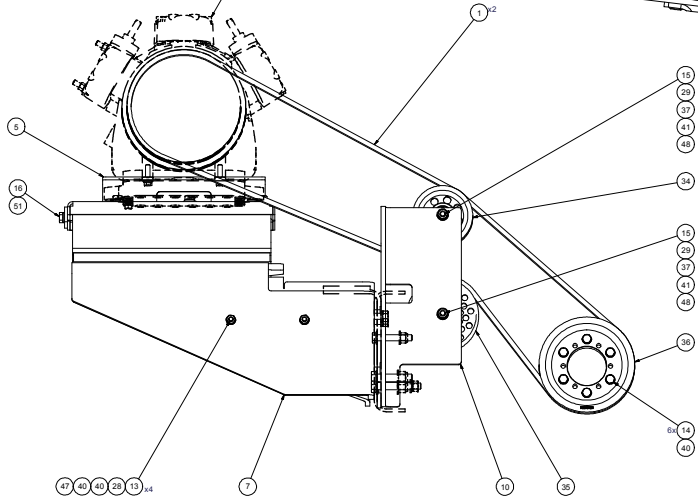

SECTION B-B

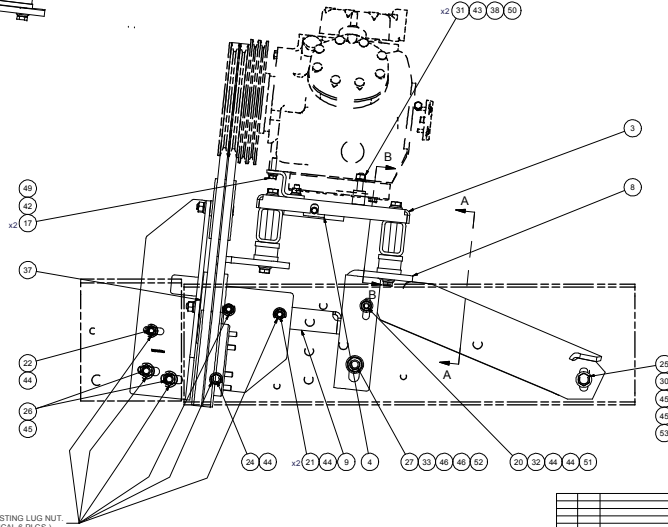
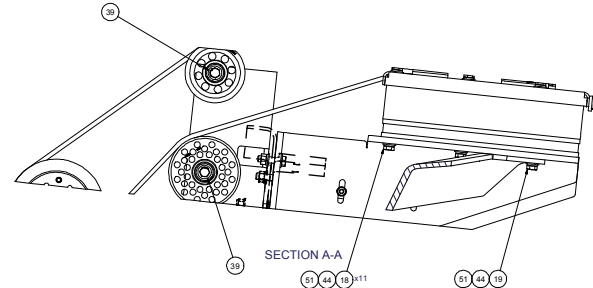

USE EXISTING LUG NUT.
(TYPICAL 6 PLCS.)

ITEM	QTY.	UOM.	DATE NUMBER	DESCRIPTION
53	1	EACH	WUQ10000	WASHER, LOCK, 5/8", 8, PLT
52	1	EACH	WUQ12000	WASHER, LOCK, 3/4", 5, PLT
51	20	EACH	WUQ5000	WASHER, LOCK, 1/2", 5, PLT
50	4	EACH	WUQ7000	WASHER, LOCK, 7/16", 5, PLT
49	2	EACH	WUQ9000	WASHER, LOCK, 3/8", 5, PLT
48	2	EACH	WUQ12000	WASHER, LOCK, 12mm, 8, 8, PLT
47	4	EACH	WUQ10000	WASHER, LOCK, 10mm, 8, 8, PLT
46	2	EACH	WUQ12000	WASHER, FLAT, 3/4", 8, PLT
45	4	EACH	WUQ10000	WASHER, FLAT, 5/8", 8, PLT
44	24	EACH	WUQ08000	WASHER, FLAT, 1/2", 8, PLT
43	4	EACH	WUQ7000	WASHER, FLAT, 7/16", 2, PLT
42	2	EACH	WUQ6000	WASHER, FLAT, 3/8", 2, PLT
41	2	EACH	WUQ12000	WASHER, FLAT, 12mm, 8, 8, PLT
40	14	EACH	WUQ10000	WASHER, FLAT, 10mm, 8, 8, PLT
39	2	EACH	SLV17012	SLEEVE, PULLEY, 16.96 x 22.23 mm x 12.19
38	2	EACH	SCD2013	SPACER, COL, DRL, 29.23mm x 25.4x12.7
37	2	EACH	SCD14912	SPACER, COL, DRL, 14.9 mm x 31.8x 12.0
36	1	EACH	PUL76022	PULLEY, CRANK, NAV DT, 7 GL, 28/36" DIA
35	1	EACH	PLU60001	PULLEY, ASSY, IDLER, 8/8", STL, PLT
34	1	EACH	PLU05012	PULLEY, ASSY, IDLER, 8/8" gr 5" STL, PLT
33	1	EACH	NTP12000	NUT, HEX, 3/4-10UNC, 5, PLT
32	1	EACH	NTP08000	NUT, HEX, 1/2-13UNC, 5, PLT
31	4	EACH	NTP07000	NUT, HEX, 7/16-14UNC, 5, PLT
30	1	EACH	NTL10000	NUT, LOCK, HEX, 5/8-11UNC, 5, PLT
29	2	EACH	NTA12000	NUT, HEX, 12 x 1.75, 8, 8, PLT
28	4	EACH	NTA10000	NUT, HEX, 10 x 1.5, 8, 8, PLT
27	1	EACH	BTQ12250	BOLT, HEX, 3/4-10UNC, 2.507, 8, PLT
26	2	EACH	BTQ10301	BOLT, HEX, 5/8-11UNC x 3.00, 8, PLT
25	1	EACH	BTQ10250	BOLT, HEX, 5/8-11UNC, 2.507, 8, PLT
24	1	EACH	BTQ08451	BOLT, HEX, 1/2-20UNF x 4.50, 8, PLT
23	6	EACH	BTQ08401	BOLT, HEX, 1/2-20UNF, 4", 8, PLT
22	1	EACH	BTQ08301	BOLT, HEX, 1/2-20UNF x 3.00, 8, PLT
21	2	EACH	BTQ08201	BOLT, HEX, 1/2-20UNF x 2.00, 8, PLT
20	1	EACH	BTQ08200	BOLT, HEX, 1/2-13UNC x 2.00, 8, PLT
19	1	EACH	BTQ08151	BOLT, HEX, 1/2-20UNF x 1.50, 8, PLT
18	11	EACH	BTQ08126	BOLT, HEX, 1/2-20UNF x 1.25, 8, PLT
17	2	EACH	BTQ06150	BOLT, HEX, 3/8-16UNC, 1.507, 8, PLT
16	1	EACH	BTQ06533	BOLT, HEX, 1/2-13UNC x 4.50, 5, PLT, FT
15	2	EACH	BTQ12070	BOLT, HEX, 12 x 1.75 x 70mm, 10.9, PLT
14	6	EACH	BTQ10050	BOLT, HEX, 10 x 1.5 x 50mm, 10.9, PLT
13	4	EACH	BTQ10040	BOLT, HEX, 10 x 1.5 x 40mm, 10.9, PLT
12	2	EACH	BMN00068	BKT, RISER, WELDMT, MF DT, RE300
11	1	EACH	BMN00661	BKT, DIAG, BRACE, RE300, 107
10	1	EACH	BMN00444	BKT, MAIN, IDLER PL, ICRE, 2007
9	1	EACH	BMN00443	BKT, SPACER PLATE, ICRE, 2007
8	1	EACH	BMN00442	BKT, MAIN, REAR PL, ICRE, 2007
7	1	EACH	BMN00441	BKT, MAIN, FRONT PL, ICRE, 2007
6	1	EACH	BMN00025	BKT, BACK, PL, SLIDE, IC, RE300
5	1	EACH	BMN00024	BKT, COMP, FRN, 2, IC, RE300
4	1	EACH	BMN00010	BKT, MAIN, SLIDE, ASSY, IC, RE300
3	1	EACH	BMN00009	BKT, MAIN, BASE PL, IC, RE300
2	2	EACH	BMN00008	VIBRATION ISOLATOR, BAR, 16.50 x 2 x 1.50
1	2	EACH	BEL22769	BELT, B gr, 2769mm (109") (BX105)

REV	CCN	DESCRIPTION	DATE	BY	CHKD	APP
01		DESIGNED	5/4/2010	Jose Rodriguez		
		CHECKED	5/4/2010	Chokriev		
		DESIGNED TO PRODUCE	5/4/2010	Chokriev		
		DATE	5/4/2010	Chokriev		
		DATE	5/4/2010	Chokriev		
		DATE	5/4/2010	Chokriev		
		DATE	5/4/2010	Chokriev		

BILL OF MATERIALS
TRANSARC TIC INC.
 MT KIT, MForce DT, RE300, O5G, 07-08
 DWT NO: KMN84132
 SCALE: 1:1
 SHEET: 1 OF 1

NOTES:
1) USE SERVICEABLE THREADLOCKER ON ALL FASTENERS TO ENGINE COMPONENTS AND TORQUE ALL BOLTS TO S.A.E. SPECIFICATIONS.
2) SEE "TRANSARC TIC AC COMPRESSOR MOUNT INSTALLATION DISCLAIMER"

THIS DRAWING CONTAINS PROPRIETARY CONFIDENTIAL INFORMATION
 CONFIDENTIAL TO TRANSARC TIC. NO PART OF THIS DRAWING IS TO BE REPRODUCED OR TRANSMITTED IN ANY FORM OR BY ANY MEANS, WITHOUT THE EXPRESS WRITTEN PERMISSION OF THE COMPANY.

PROPERTY OF TRANSARC TIC
 100% UNCLASSIFIED
 DATE: 1/1/2007
 100% UNCLASSIFIED
 DATE: 1/1/2007

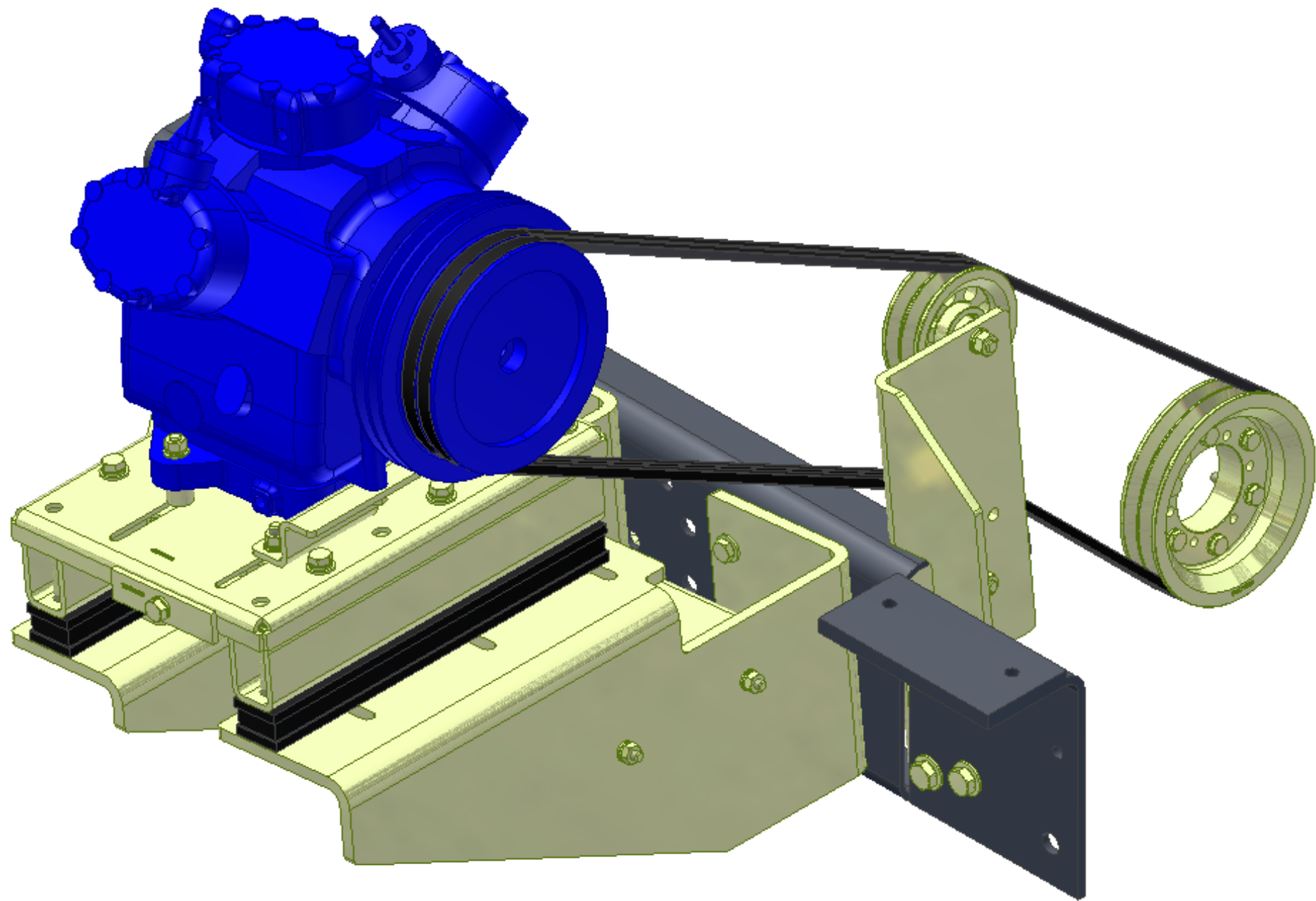

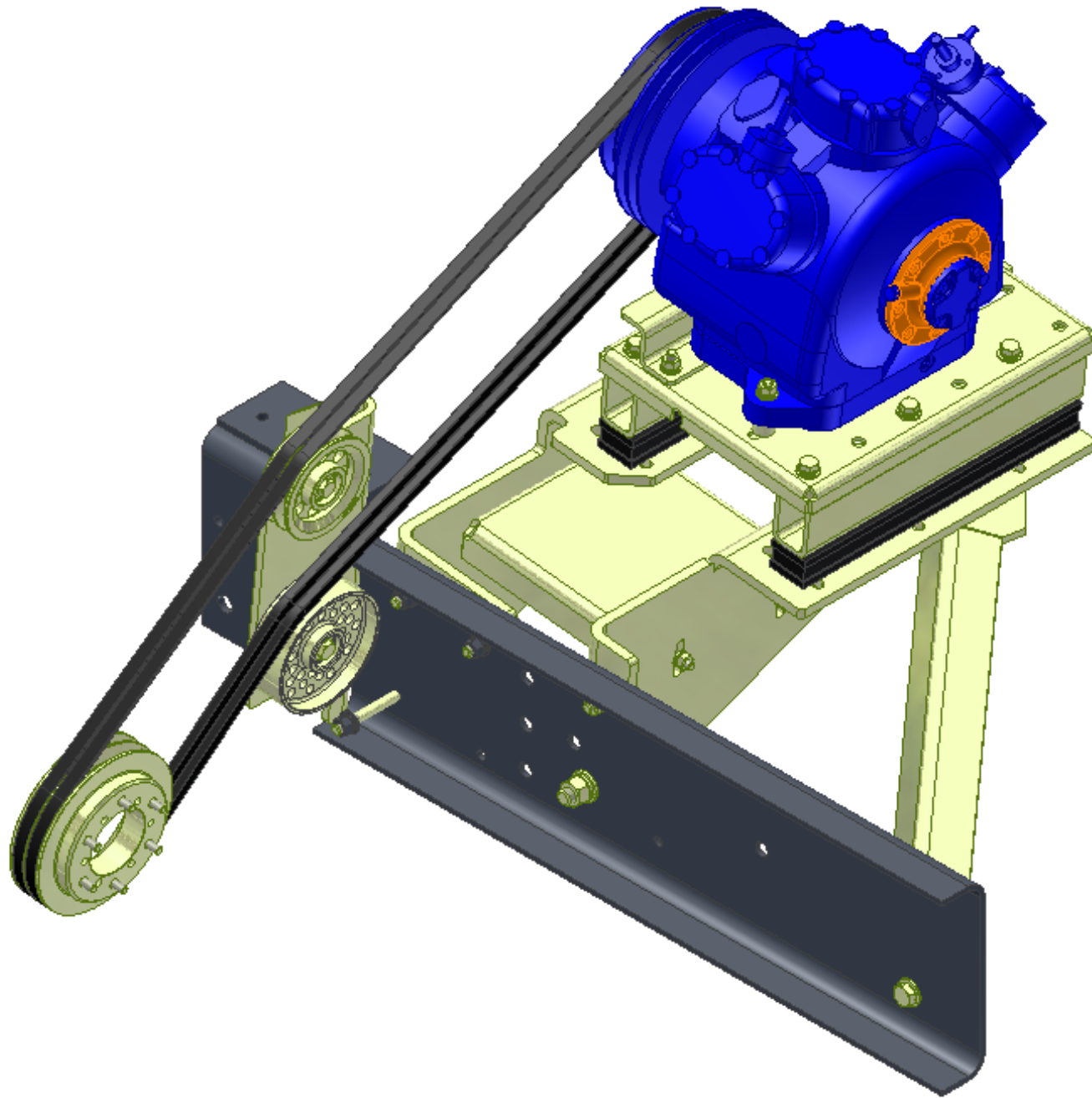

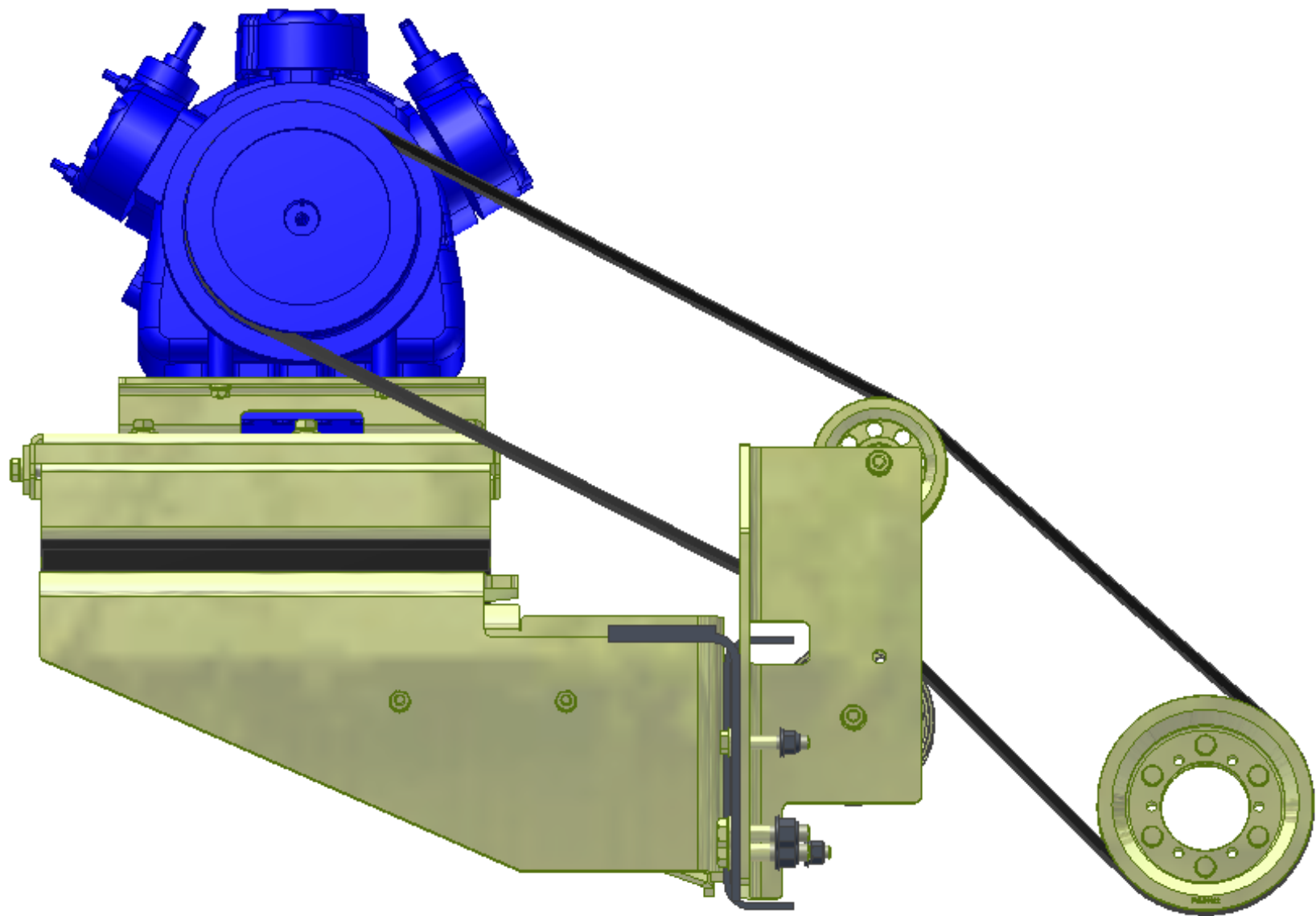

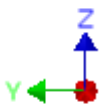
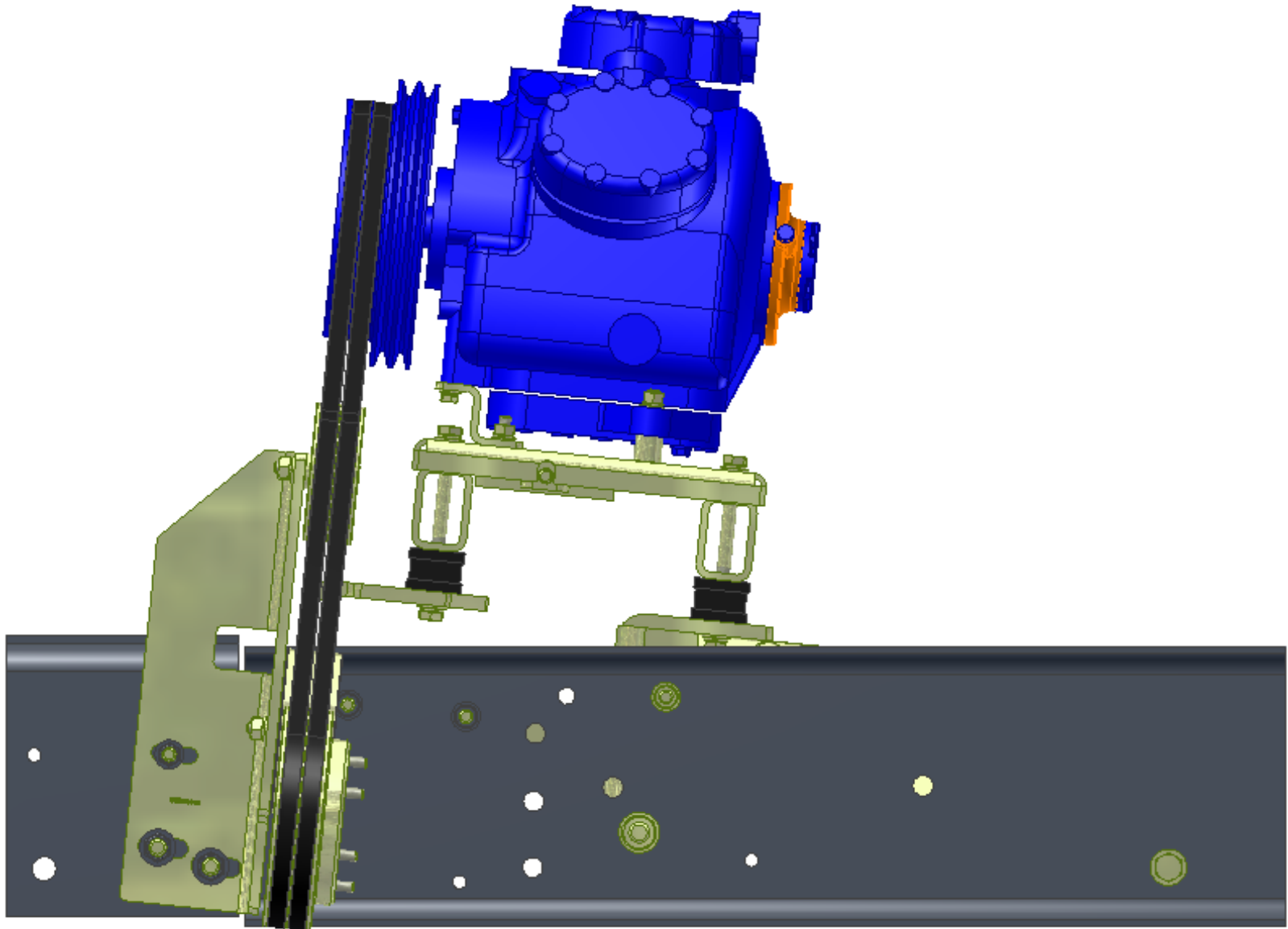

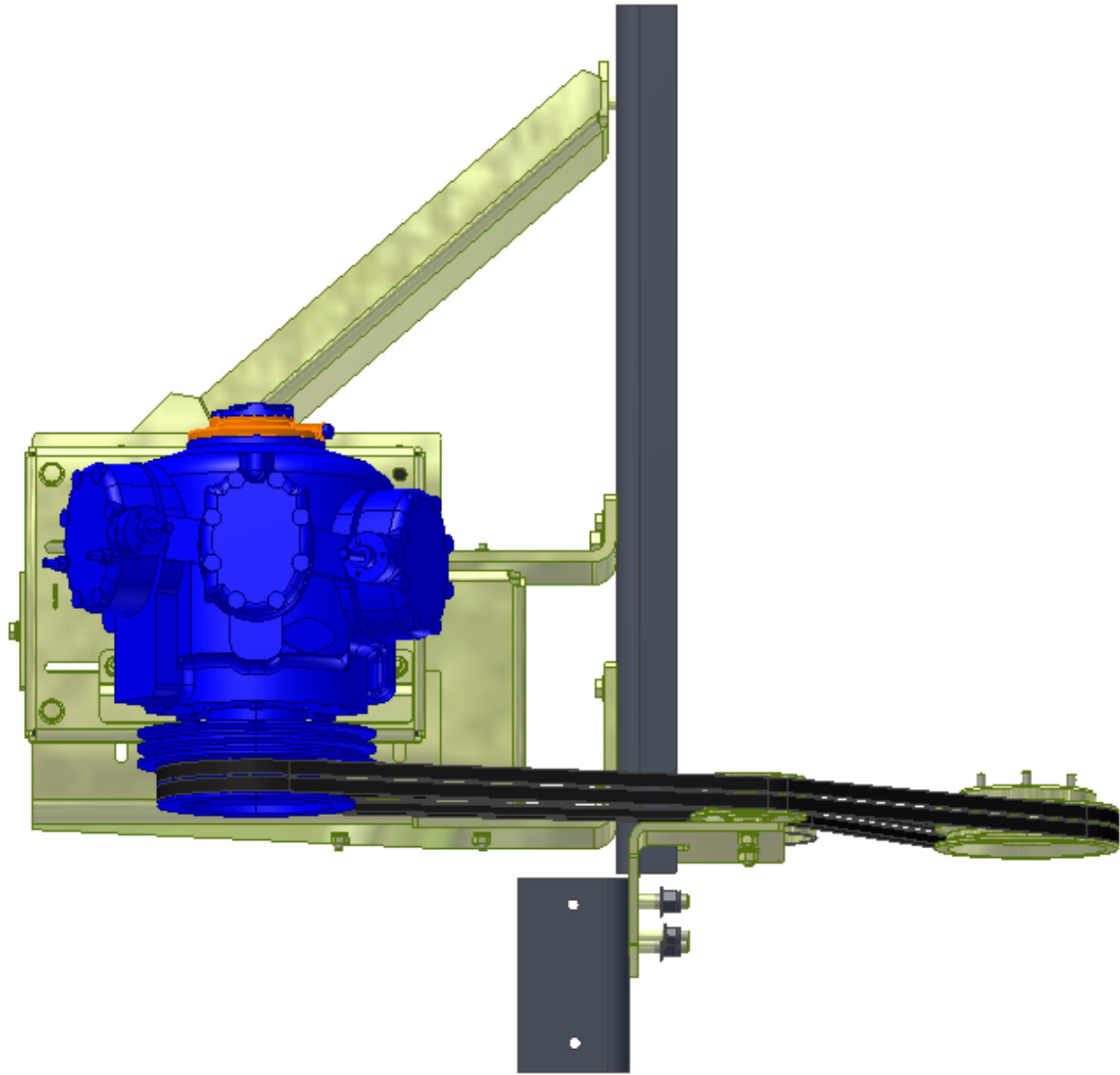

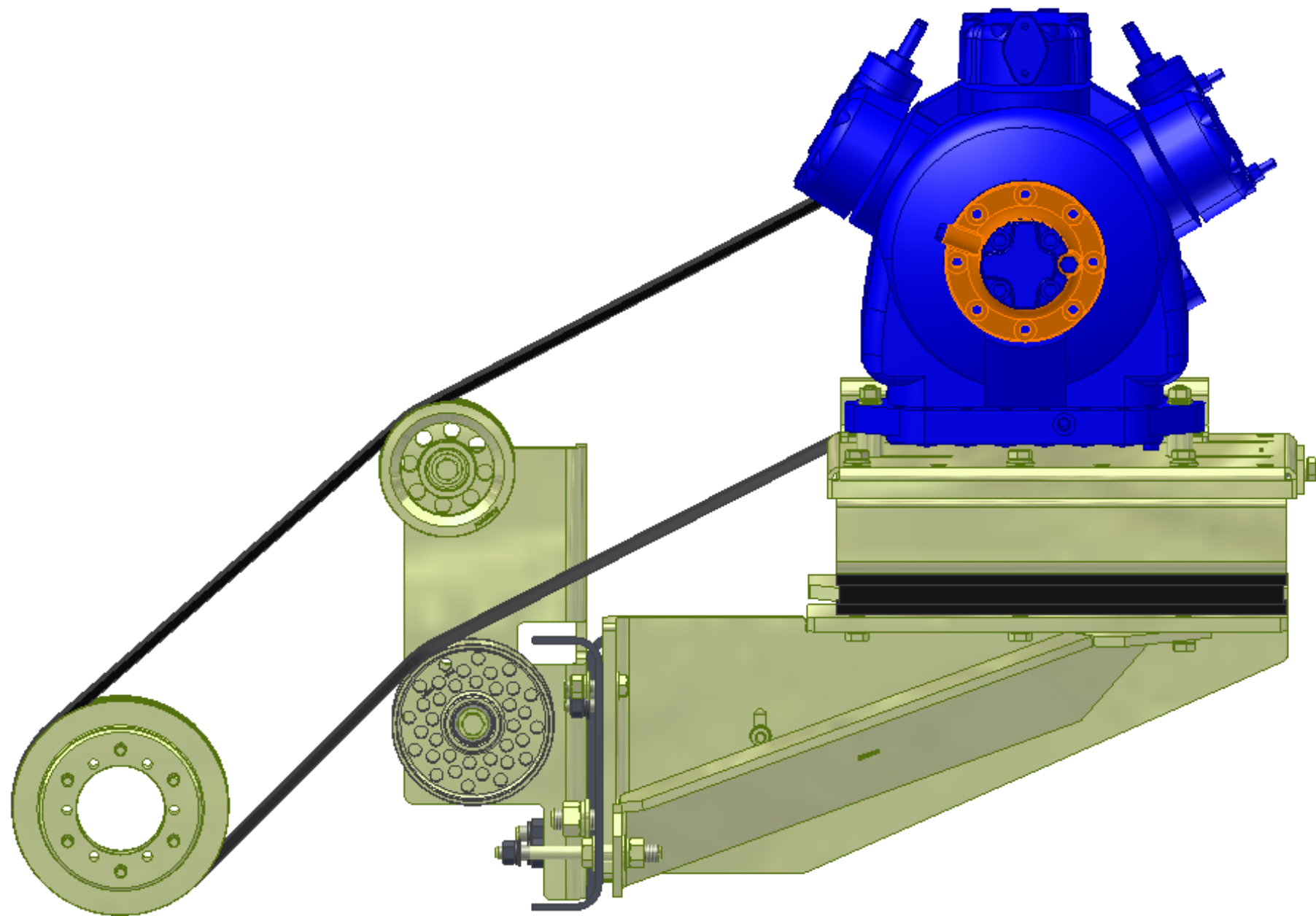

TransArctic A/C Compressor Mount Installation Disclaimer

All compressor mounts should be installed by qualified and trained personnel using proper tools and equipment in safe working conditions following industry standard guidelines for motor vehicle service and repair.

The installer of any compressor mount purchased from TransArctic must undertake all responsibility of issues arising from that compressor bracket being installed on any vehicle. As well as insure that a **proper and sufficient ground** is established between the compressors' clutches and the vehicle's engine. Mount functionality, operation and durability can all be compromised by an incompetent installation.

Due to the many different situations, parameters and application criteria, which are beyond the compressor mount manufacturer's control, TransArctic does not warrant design, durability, or operational functionality of any compressor mount improperly installed by another party.

With no implied guarantees it is the mount installer's strict responsibility to determine safety and functionality, of the compressor mount, at the time of installation.

Please contact TransArctic with any issue arising from installation so we may better improve the product. If you have any reservations about the compressor mount integrity contact TransArctic immediately at 1-877-COLD-AIR.

Mark OEM tensioner location

Install Kit

Check for Interferences

Check to ensure that the proper OEM tensioner orientation is maintained

Run engine with A/C system engaged for at least 10 minutes to run in belt

Check OEM tensioner orientation and adjust as required

Responsabilidad limitada de TransArctic en la instalación del soporte del compresor

Todos los soportes de los compresores deben ser instalados por personas calificadas y entrenadas, usando para ello los equipos y herramientas necesarios para esta labor en buenas condiciones y según las normas y guías para el servicio y/o reparación de motores de vehículos.

El instalador de los soportes comprados en TransArctic asume toda la responsabilidad de cualquier problema que surga en el soporte del compresor al vehículo; de igual manera es responsable que el cable a tierra sea conectado entre el embrague del compresor y el motor del vehículo.

Se advierte que el buen funcionamiento y la durabilidad del soporte pueden ser comprometidos por defectos en su instalación.

Debido a las diversas situaciones que se puedan presentar fuera del control del fabricante, TransArctic no garantiza el diseño, la durabilidad o el correcto funcionamiento de cualquier equipo inapropiadamente instalado por terceros.

Esta sobreentendido que el Instalador del montaje del compresor es estrictamente responsable de la seguridad y funcionamiento del equipo en el momento de la instalación.

Si tuviera algún problema o duda acerca de la instalación del soporte del compresor pongase en contacto inmediatamente con TransArctic al teléfono 1-877-COLD-AIR de modo que podamos mejorar nuestro producto.

Note la ubicación del medidor de tensión OEM

Instale el equipo

Controlar si hay interferencias.

Asegurese que el medidor de tensión mantenga la orientación justa.

Encienda el motor por lo menos 10 minutos con el sistema A/C enganchado para que la correa corra

Controle la orientación justa del medidor de tensión y ajuste a las condiciones requeridas del fabricante