

Bill of Materials Listing

TransArctic Canada Inc.

9/1/2020
Page 1 of 1

Product Number	Date	Description	Uof M	Weight	Yield	
Line	Qty	Component Prod#	Rev#	Bin	Unit	
KMC81062	7/7/2009	0 Mt Kit, ISC/L,A3/D3/T3RE,1 TM-16,'05-'16			86.77	0
5	1	PAC23150			each	
10	1	BEL81842			each	
20	1	BEL81257			each	
30	1	BMC83045	2		each	
40	1	BMC83011	0		each	
50	1	BMC83046	2		each	
55	1	PUL81074			each	
60	1	PUL80076			each	
70	1	PUL83088	2		each	
80	1	SLV17010	1		each	
90	1	SCD57210	0		each	
100	1	TEN80002			each	
110	1	KBC81062			each	

NOTE: * WARNING! ******

Confirm the proper fit up of the "add-on" fan pulley part# PUL83088.
 The installation may vary from engine to engine/model-emmission years.
 i.e: With some 2013 emission engines you will need to discard the (4)
 OEM 30mm fan bolts and the OEM spacer and replace with "blue" loctite"
 on (4) M10 x 25mm long bolts supplied.
 On earlier models you may only need to discard the OEM spacer and
 reuse the (4) OEM 30mm bolts. If you have any questions or concerns
 please contact Val Jakowlew at your earliest convenience. _JUN-02-15

Bill of Materials Listing

TransArctic Canada Inc.

9/1/2020
Page 1 of 1

Product Number	Date	Description			Uof M	Weight	Yield
Line	Qty	Component	Prod#	Rev#	Description	Bin	Unit
KBC81062	9/21/2005	Bag Kit, Fasteners, KMC81062				1.40	0
10	4	BTC08100			Bolt, Hex, 8 x 1.25 x 100mm, 10.9, Plt		each
15	4	BTC10025			Bolt, Hex, 10 x 1.5 x 25mm, 10.9, Plt		each
20	2	BTC10030			Bolt, Hex, 10 x 1.5 x 30mm, 10.9, Plt		each
30	3	BTC10040			Bolt, Hex, 10 x 1.5 x 40mm, 10.9, Plt,FT		each
40	1	BTC10090			Bolt, Hex, 10 x 1.5 x 90mm, 10.9, Plt		each
45	1	BTC10100			Bolt, Hex, 10 x 1.5 x 100mm, 10.9,Plt,FT		each
50	1	BTS10001			Bolt, Shoulder, 10mm (89064)		each
70	1	CSF10041			Capscrew, FH, 10 x 1.5 x 40mm, 10.9,Plt		each
80	1	CSS10055			Capscrew, SH, 10 x 1.5 x 55mm, 12.9,Plt		each
90	2	NTA10000			Nut, Hex, 10 x 1.5, 8.8, Plt		each
100	4	WFA08000			Washer, Flat, 8mm, 8.8, Plt		each
110	2	WFA10000			Washer, Flat, 10mm, 8.8, Plt		each
120	4	WLA08000			Washer, Lock, 8mm, 8.8, Plt		each
130	8	WLA10000			Washer, Lock, 10mm, 8.8, Plt		each

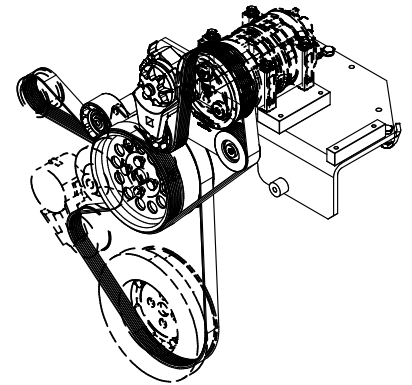
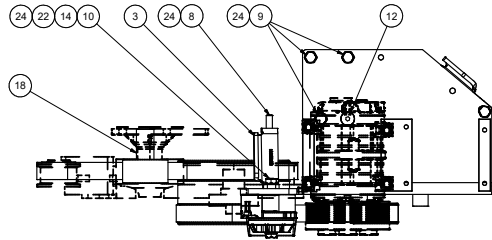

ISOMETRIC VIEW

NOTE: "WARNING"
 - CONFIRM THE PROPER FIT UP OF THE ADD-ON FAN PULLEY # PUL83088.
 - REUSE (4) EXISTING OEM "FAN" PULLEY BOLTS.
 - DISCARD OEM "FAN" PULLEY AND CLAMPING RING.
 - ON SOME 2013 EMISSION ENGINES DISCARD (4) OEM FAN BOLTS AND REPLACE WITH (4) M10 x 25mm LONG (ITEM# 7) (SUPPLIED) AND USE BLUE "LOCTITE".

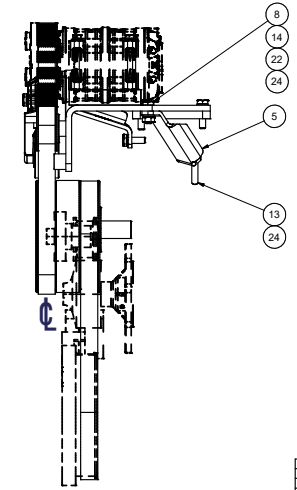
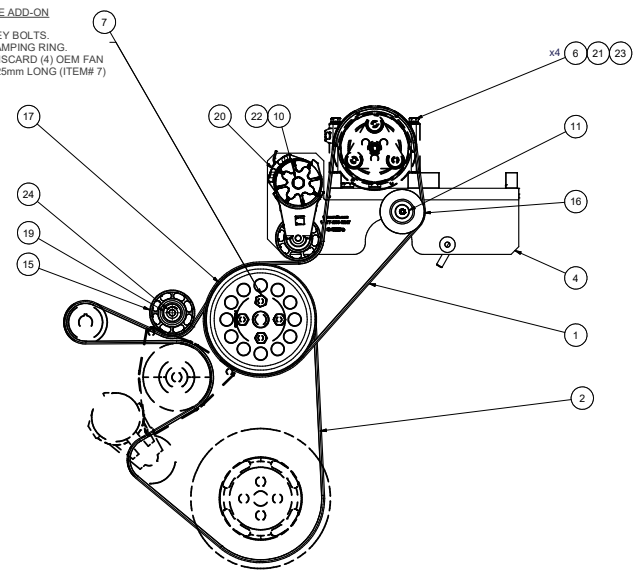

NOTES:
 1) USE SERVICABLE THREADLOCKER ON ALL FASTENERS TO ENGINE COMPONENTS AND TORQUE ALL BOLTS TO S.A.E. SPECIFICATIONS.
 2) SEE "TRANSARC TIC A/C COMPRESSOR MOUNT INSTALLATION DISCLAIMER".

ITEM	QTY	U/M	PART NUMBER	DESCRIPTION
24	8	EACH	WLA10000	WASHER, LOCK, 10mm, 8.8, PLT
23	4	EACH	WLA08000	WASHER, LOCK, 8mm, 8.8, PLT
22	2	EACH	WFA10000	WASHER, FLAT, 10mm, 8.8, PLT
21	4	EACH	WFA08000	WASHER, FLAT, 8mm, 8.8, PLT
20	1	EACH	TEN80002	TENR, HD SPRING, BACKSIDE, CCW
19	1	EACH	SLV17010	SLEEVE, PULLEY, 16.90 x 22.23mm x 10.32i
18	1	EACH	SCDS7210	SPACER, COL, DRL, 57.15mm x28.580 x10.32i
17	1	EACH	PUL83088	Pulley, Fan, Add-on, Combo, ISC, 8.3, 8gr
16	1	EACH	PUL81074	PULLEY, IDLER, FRONTSIDE, P8, 74d x 39w
15	1	EACH	PUL80076	PULLEY, IDLER, BACKSIDE, P8, 76D, 39W
14	2	EACH	NTA10000	NUT, HEX, 10 x 1.5, 8.8, PLT
13	1	EACH	CSS10055	CAPSCREW, SH, 12 x 1.25 x 55mm, 12.9, PLT
12	1	EACH	CSF10041	CAPSCREW, FH, 10 x 1.5 x 40mm, 10.9, PLT
11	1	EACH	BTS10001	BOLT, SHOULDER, 10mm (IDLER PULLEY)
10	1	EACH	BTC10090	BOLT, HEX, 10 x 1.5 x 90mm, 10.9, PLT
9	3	EACH	BTC10040	BOLT, HEX, 10 x 1.5 x 40mm, 10.9, PLT
8	2	EACH	BTC10030	BOLT, HEX, 10 x 1.5 x 30mm, 10.9, PLT
7	4	EACH	BTC10025	BOLT, HEX, 10 x 1.5 x 25mm, 10.9, PLT
6	4	EACH	BTC08100	BOLT, HEX, 8 x 1.25 x 100mm, 10.9, PLT
5	1	EACH	BMC83046	BKT, BRACE, P/S, 8.3L, 09'
4	1	EACH	BMC83045	BKT, MAIN, WELDMT, ISC, 8.3L, 09'
3	1	EACH	BMC83011	BKT, BRACE, RR, TENR, ISC, 8.3L, P8
2	1	EACH	BEL81842	BELT, 8gr, 1842mm (72.5") (5080725)
1	1	EACH	BEL81257	BELT, 8 GR, 1257mm (49.5") (5080495)

REV	ECN	DESCRIPTION	DATE	BY	APPROVED
0		RELEASED TO PRODUCTION	04/24/2019	VAL	
				Jose Rodriguez	
				James Stewart	
				James Stewart	
				Dale Mason	

DRAWN: vjakowlew 4/22/2019
 CHECKED: Jose Rodriguez 4/23/2019
 TITLE: MT KIT, ISC/L, A3/D3/T3RE, 1 TM-16, '05-'16
 DWG NO: KMC81062
 SCALE: 1:4
 SHEET 1 OF 1

THIS DRAWING CONTAINS PROPRIETARY CONFIDENTIAL INFORMATION OWNED BY TRANSARC TIC CANADA INC. THE DOCUMENT AND THE INFORMATION IN IT ARE NOT TO BE USED, DISCLOSED OR REPRODUCED WITHOUT EXPRESS WRITTEN PERMISSION OF THE COMPANY.

UNspecified TOLERANCES:
 ONE DECIMAL PLACE (X0) MM INCH
 TWO DECIMAL PLACE (XX0) MM INCH
 THREE DECIMAL PLACE (XXX) MM INCH
 FRACTIONS (1/16" - 1/8") INCH MM

THIRD ANGLE PROJECTION
 DRAWING UNIT OF MEASURE: MM (INCH)
 SCALE: 1:4
 SHEET 1 OF 1

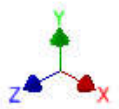
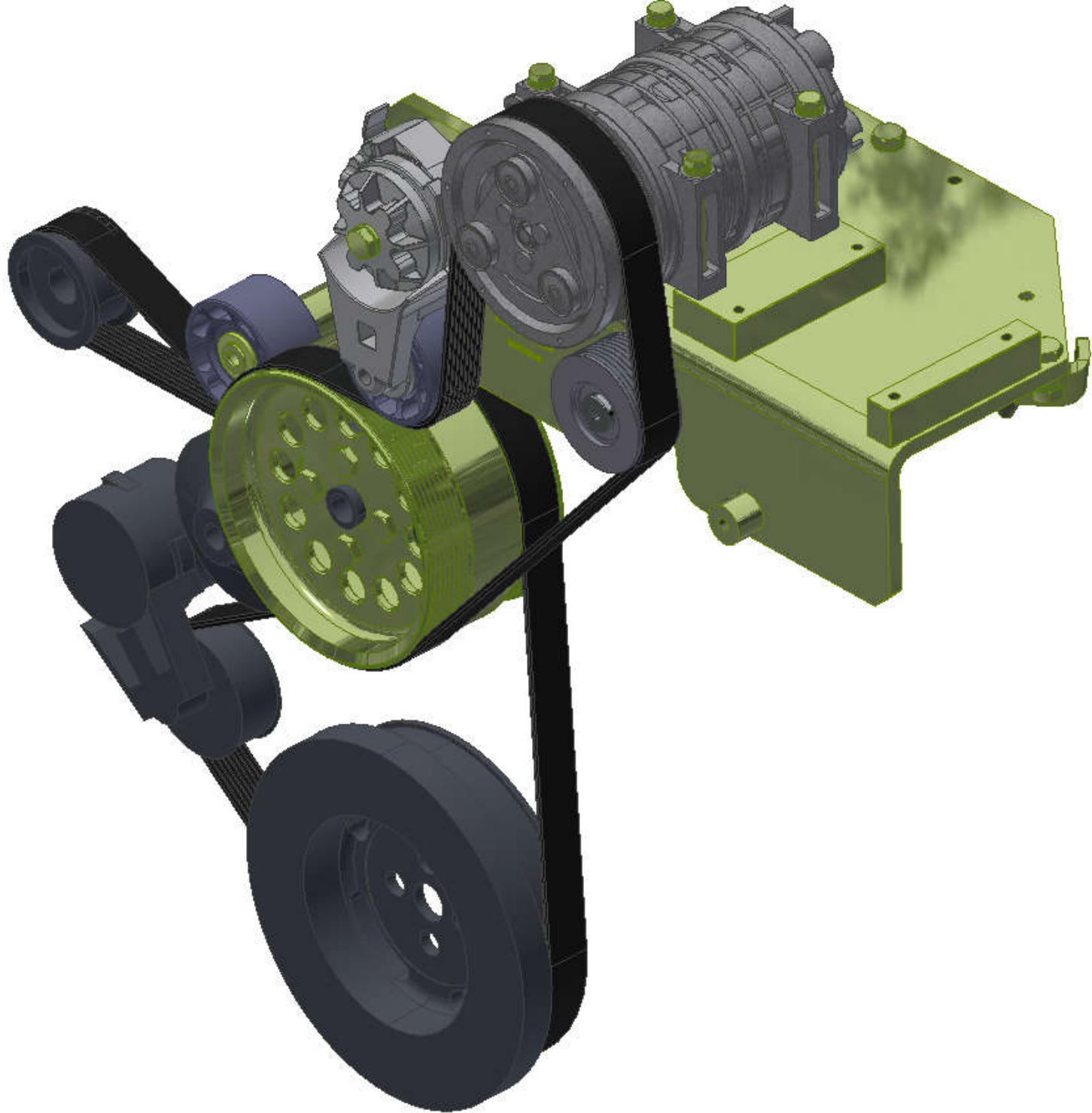

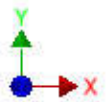
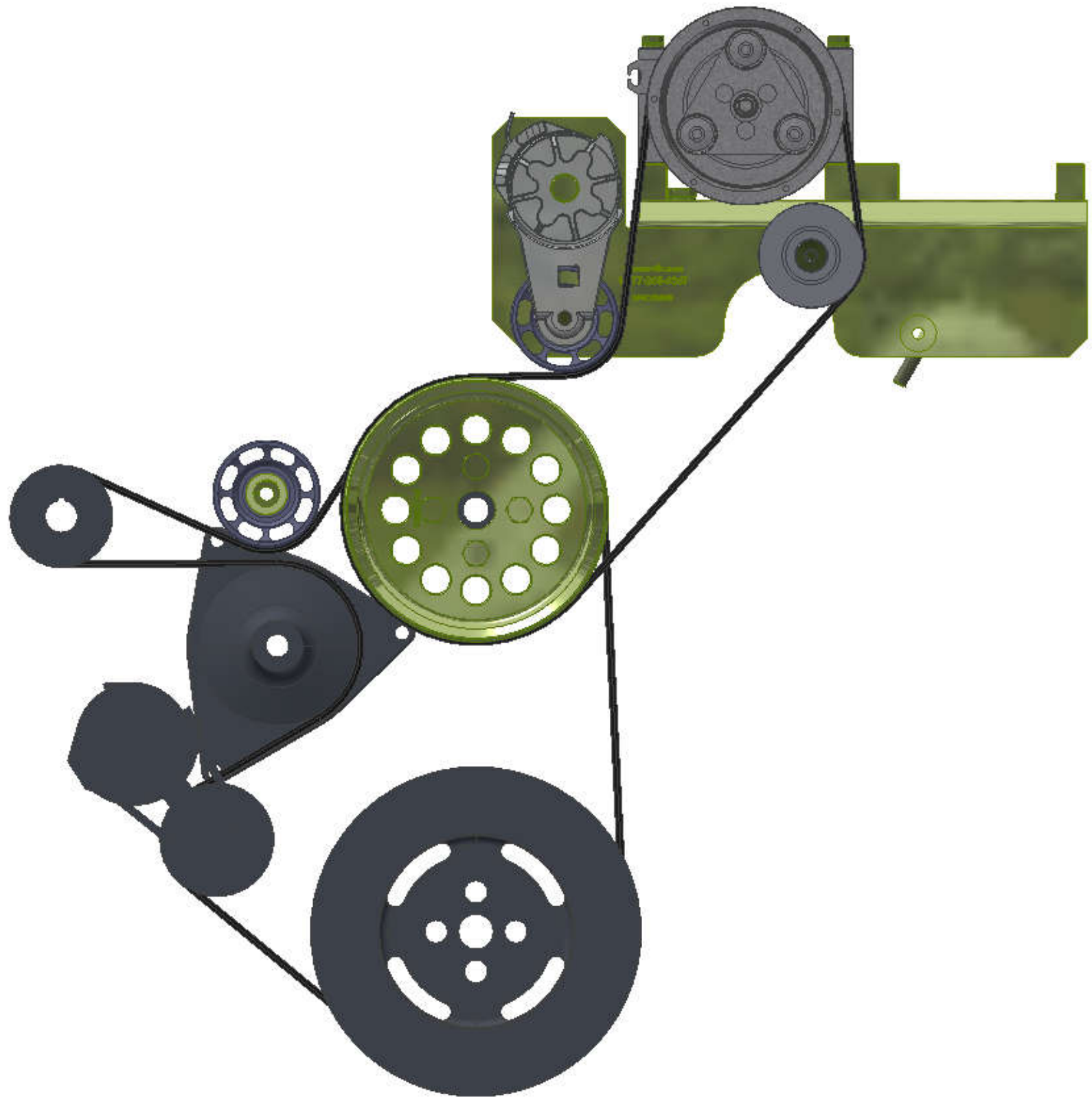

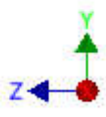

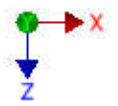
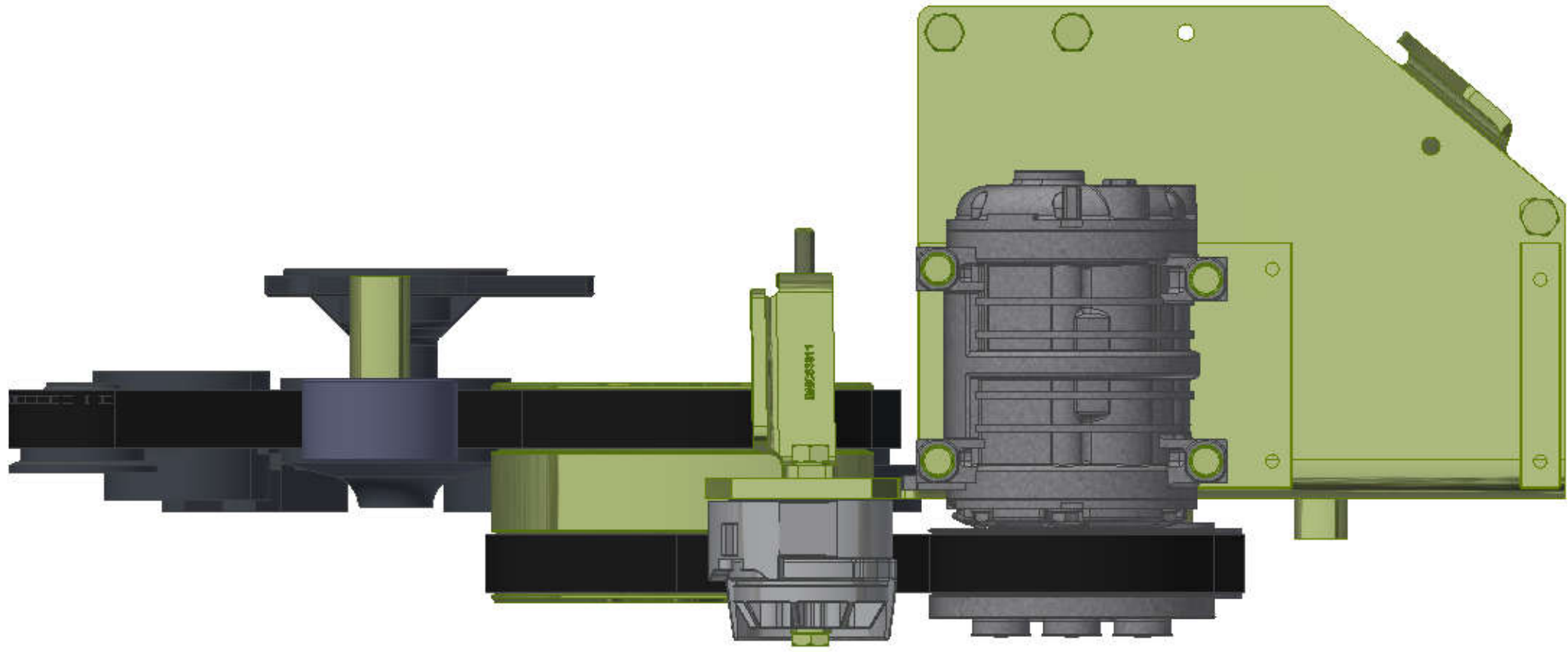



TransArctic A/C Compressor Mount Installation Disclaimer

All compressor mounts should be installed by qualified and trained personnel using proper tools and equipment in safe working conditions following industry standard guidelines for motor vehicle service and repair.

The installer of any compressor mount purchased from TransArctic must undertake all responsibility of issues arising from that compressor bracket being installed on any vehicle. As well as insure that a **proper and sufficient ground** is established between the compressors' clutches and the vehicle's engine. Mount functionality, operation and durability can all be compromised by an incompetent installation.

Due to the many different situations, parameters and application criteria, which are beyond the compressor mount manufacturer's control, TransArctic does not warrant design, durability, or operational functionality of any compressor mount improperly installed by another party.

With no implied guarantees it is the mount installer's strict responsibility to determine safety and functionality, of the compressor mount, at the time of installation.

Please contact TransArctic with any issue arising from installation so we may better improve the product. If you have any reservations about the compressor mount integrity contact TransArctic immediately at 1-877-COLD-AIR.

Mark OEM tensioner location

Install Kit

Check for Interferences

Check to ensure that the proper OEM tensioner orientation is maintained

Run engine with A/C system engaged for at least 10 minutes to run in belt

Check OEM tensioner orientation and adjust as required

Responsabilidad limitada de TransArctic en la instalación del soporte del compresor

Todos los soportes de los compresores deben ser instalados por personas calificadas y entrenadas, usando para ello los equipos y herramientas necesarios para esta labor en buenas condiciones y según las normas y guías para el servicio y/o reparación de motores de vehículos.

El instalador de los soportes comprados en TransArctic asume toda la responsabilidad de cualquier problema que surja en el soporte del compresor al vehículo; de igual manera es responsable que el cable a tierra sea conectado entre el embrague del compresor y el motor del vehículo.

Se advierte que el buen funcionamiento y la durabilidad del soporte pueden ser comprometidos por defectos en su instalación.

Debido a las diversas situaciones que se puedan presentar fuera del control del fabricante, TransArctic no garantiza el diseño, la durabilidad o el correcto funcionamiento de cualquier equipo inapropiadamente instalado por terceros.

Esta sobreentendido que el Instalador del montaje del compresor es estrictamente responsable de la seguridad y funcionamiento del equipo en el momento de la instalación.

Si tuviera algún problema o duda acerca de la instalación del soporte del compresor pongase en contacto inmediatamente con TransArctic al teléfono 1-877-COLD-AIR de modo que podamos mejorar nuestro producto.

Note la ubicación del medidor de tensión OEM

Instale el equipo

Controlar si hay interferencias.

Asegurese que el medidor de tensión mantenga la orientación justa.

Encienda el motor por lo menos 10 minutos con el sistema A/C enganchado para que la correa corra

Controle la orientación justa del medidor de tensión y ajuste a las condiciones requeridas del fabricante