

Bill of Materials Listing

TransArctic Canada Inc.

12/17/2013
Page 1 of 1

Product Number	Description	Date	Weight	Uof M	Yield
Line Component Prod#	Description	Bin Unit	Qty		
KMC63961	Mt Kit, 6.7L ISB13, D3RE, 4xFC, 12V, '13		08/27/12	166.19	0
10	BEL22083		Belt, B gr, 2083mm (82") (258-082)	each	2
20	KBB00001		Mt Kit, Platform, Transit, ADM, '12	each	1
30	KCB03901		Kit, Compressor, 4xFC/ FK40, '12	each	1
40	KFB67001		Kit, Found'n, BB T3/D3RE, ISB, '13	each	1
50	KPC67001		Kit, Pulley, ISB, T3/D3RE, '12	each	1
60	KRC67001		Kit, Retrofit, ISB, Air Filter Reloc,'13	each	1

NOTE:

Check that this kit will require the KRC67001 relocation kit. /Val_DEC-17-13

Bill of Materials Listing

TransArctic Canada Inc.

12/4/2012
Page 1 of 1

Product Number		Description	Bin	Date	Weight	Uof M	Yield
Line	Component Prod#	Description		Unit	Qty		
KBB00001		Mt Kit, Platform, Transit, ADM, '12		6/20/2012	95.30		0
10	BMZ01034	Bkt, Spring, Support Arm, ADM, '12		each	1		
20	BMZ01035	Bkt, Main, Pivot, Ass'y, ADM Transit,'12		each	1		
30	BMZ01037	Bkt, Fork, Knuckle-Joint, Adm, '12		each	1		
40	BMZ01038	Bkt, Main, Base Pl, ADM, '12		each	1		
50	BMZ01040	Bkt, Ass'y, THRD Rod, Isolator, ADM, '12		each	1		
60	BMZ01041	Shaft Key, 8mm W x7mm H x13.7mm Long		each	2		
70	BMZ01042	Vibration Isolator, Bar, 9.63 x 2 x 1.50		each	2		
80	BMZ01044	Bkt, Cradle, Pivot, Adm Transit, '12		each	1		
90	BMZ01047	Bkt, Bar, Slide Nut, ADJ, Trans ADM, '12		each	2		
100	BTS08100	Bolt, Grease,Nipple,1/2-13 x 1.0"		each	1		
105	FTS04007	Ftg, Grease, Nipple, 1/4-28 UNF-2A,Brass		each	1		
110	PIS01010	Shaft, Stl, Grease, ADM Transit, '12		each	1		
120	SPR00002	Spring, Comp, R/H, 110 x 50 x 8.4, Red		each	1		
130	WFS16001	Washer, Flat, Dbl Step, 17mm, 50mm, Plt		each	1		
140	WFS27001	Washer, Flat, Dbl Step, 27mm, 63.5, Plt		each	1		
150	KBB00025	Bag Kit, Fasteners, KBB00001		each	1		

Bill of Materials Listing

TransArctic Canada Inc.

12/4/2012
Page 1 of 1

Product Number	Description	Date	Weight	Uof M	Yield
Line Component Prod# Description	Bin	Unit	Qty		
KBB00025	Bag Kit, Fasteners, KBB00001	8/1/2012	3.90		0
10 BTQ08126	Bolt, Hex, 1/2-20unf, 1.25", 8, Plt	each	12		
15 BTQ08100	Bolt, Hex, 1/2-13unc, 1.00", 8, Plt	each	1		
20 BTQ08150	Bolt, Hex, 1/2-13unc, 1.5", 8, Plt	each	9		
30 BTQ10351	Bolt, Hex, 5/8-18unf, 3.5", 8, PLT	each	1		
50 NTQ08000	Nut, Hex, 1/2-13unc, 8, Plt	each	5		
60 NTQ10000	Nut, Hex, 5/8-11unc, 8, Plt	each	2		
65 NTQ10001	Nut, Hex, 5/8-18unf, 8, Plt	each	1		
70 WFS08001	Washer, Flat, 1/2", 8, USS, Plt	each	2		
100 WFQ08000	Washer, Flat, 1/2", 8, Plt	each	14		
110 WFQ10000	Washer, Flat, 5/8", 8, Plt	each	2		
120 WLQ08000	Washer, Lock, 1/2", 8, Plt	each	23		
130 WLQ10000	Washer, Lock, 5/8", 8, Plt	each	2		

Bill of Materials Listing

TransArctic Canada Inc.

11/5/2012
Page 1 of 1

Product Number		Description	Bin	Date	Weight	Uof M	Yield
Line	Component Prod#	Description		Unit	Qty		
KCB03901		Mt Kit, Comp, 4xFC, '12		10/2/2012	0.99		0
10	BTQ08250	Bolt, Hex, 1/2-13unc, 2.5", 8, Plt		each	4		
20	NTQ08000	Nut, Hex, 1/2-13unc, 8, Plt		each	4		
30	WFQ08000	Washer, Flat, 1/2", 8, Plt		each	4		
40	WLQ08000	Washer, Lock, 1/2", 8, Plt		each	4		

Bill of Materials Listing

TransArctic Canada Inc.

12/5/2012
Page 1 of 1

Product Number	Description	Date	Weight	Uof M	Yield
Line Component Prod#	Description	Bin Unit	Qty		
KFB67001	Kit, Found'n, BB D3RE, ISB, '13		8/20/2012	70.31	0
10 BFB00001	Bkt, Foundation, Main, BB D3RE, '13		each	1	
20 BMZ01050	Bkt, Frt, Angle, Weldmt, BB, D3RE, '13		each	1	
30 PUL80074	Pulley, Idler, B/S, Wide, 76d (89102)		each	2	
40 SCD25412	Spacer, Col, Drl,25.4mm x 25.4o x 12.3i		each	2	
50 SLV17012	Sleeve, Pulley, 16.9o x 22.23mm x 12.32i		each	2	
60 KBB90020	Bag Kit, Fasteners, KFB67001		each	1	

Bill of Materials Listing

TransArctic Canada Inc.

12/5/2012
Page 1 of 1

Product Number	Description	Date	Weight	Uof M	Yield
Line Component Prod#	Description	Bin Unit	Qty		
KBB90020	Bag Kit, Fasteners, KFB67001		8/20/2012	1.45	0
10	BTC12080		Bolt, Hex, 12 x 1.75 x 80mm, 10.9,Plt,FT	each	2
20	BTQ06150		Bolt, Hex, 3/8-16unc, 1.50", 8, Plt	each	2
25	BTQ08150		Bolt, Hex, 1/2-13unc, 1.5", 8, Plt	each	4
30	NTA12000		Nut, Hex, 12 x 1.75, 8.8, Plt	each	2
40	NTP06000		Nut, Hex, 3/8-16unc, 5, Plt	each	2
45	NTQ08000		Nut, Hex, 1/2-13unc, 8, Plt	each	4
50	WFA12000		Washer, Flat, 12mm, 8.8, Plt	each	2
60	WFN06000		Washer, Flat, 3/8", 2, Plt	each	4
65	WFQ08000		Washer, Flat, 1/2", 8, Plt	each	8
70	WLA12000		Washer, Lock, 12mm, 8.8, Plt	each	2
80	WLP06000		Washer, Lock, 3/8", 5, Plt	each	2
90	WLQ08000		Washer, Lock, 1/2", 8, Plt	each	4

Bill of Materials Listing

TransArctic Canada Inc.

12/5/2012
Page 1 of 1

Product Number	Description		Date	Weight	Uof M	Yield
Line Component Prod#	Description	Bin	Unit	Qty		
KPC67001	Kit, Pulley, ISB, D3RE, '12		5/13/2008	17.95		0
10	PUL67322		each	1		
20	BTC12040		each	4		

Bill of Materials Listing

TransArctic Canada Inc.

12/17/2013

Page 1 of 1

Product Number		Description	Bin	Date	Weight	Uof M	Yield
Line	Component Prod#	Description		Unit	Qty		
KRC67001		Kit, Retrofit, ISB, Air Filter Reloc,'13		05/15/13	0.00		0
10	10031369	Brkt, Mtg, Air Clean		each	1		
20	01789262	Elbow, Rubber, 6.00		each	1		
30	01432798	Clamp, Spring, Load		each	2		
40	01856038	Clamp, Spring, Load		each	1		
50	10031278	Tube, Air, Intake		each	1		
60	00014917	Elbow, Rubber, Cobr		each	1		

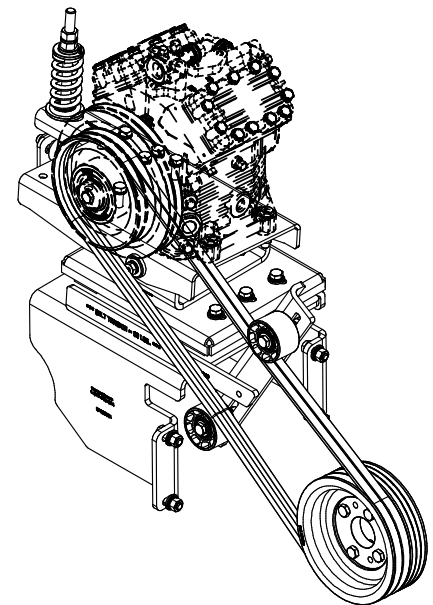

ISOMETRIC VIEW

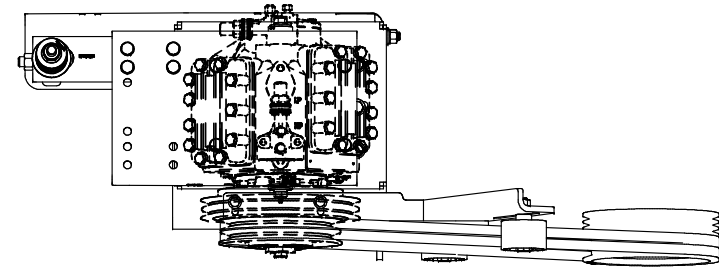

NOTE:
SHOWING COMPRESSOR
4x FCY OR
FK40 xxx
AS REFERENCE.

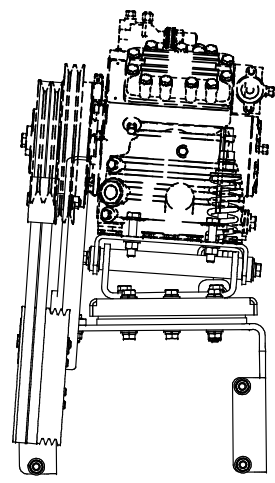
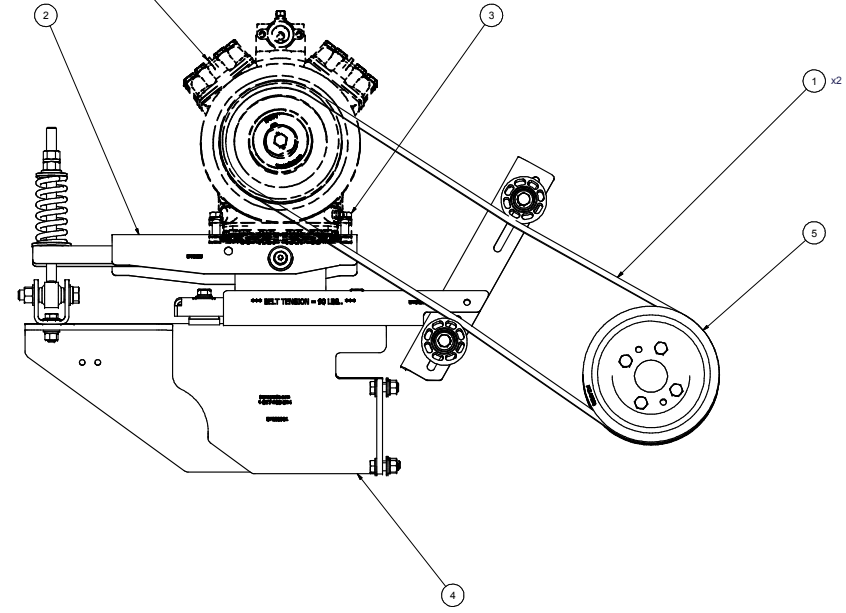

NOTES:
1) USE SERVICABLE THREADLOCKER ON ALL FASTENERS TO ENGINE COMPONENTS AND TORQUE ALL BOLTS TO S.A.E. SPECIFICATIONS.
2) SEE "TRANSARGTIC A/C COMPRESSOR MOUNT INSTALLATION DISCLAIMER".

ITEM	QTY	U/M	PART NUMBER	DESCRIPTION
5	1	EACH	KPC67001	KIT, PULLEY, ISB, D3RE, '12
4	1	EACH	KFB67001	KIT, FOUNDN, BB D3RE, ISB, '13
3	1	EACH	KCB39901	MT KIT, COMP, 4xFC, '12
2	1	EACH	KSB00001	MT KIT, PLATFORM, TRANSIT, ADM, '12
1	2	EACH	BEL22083	BELT, B GR, 2083mm (82") (258-082)

BILL OF MATERIALS

DRAWN	jrodriguez	9/27/2012	
CHECKED	Val Jakowlew	9/6/2012	
REV	ECN	DESCRIPTION	DATE
		MT KIT, 6.7L ISB, D3RE, 4xFC, 12V, 2B, '13	9/6/2012
		MT KIT, PLATFORM, TRANSIT, ADM, '12	9/6/2012
		BELT, B GR, 2083mm (82") (258-082)	9/6/2012

TRANSARGTIC INC.

MT KIT, 6.7L ISB, D3RE, 4xFC, 12V, 2B, '13

DWG NO: KMC63961

SCALE: 1:4

SHEET 1 OF 1

UNSPECIFIED TOLERANCES:	(ALL DIM)	GROUP
ONE DECIMAL PLACE (10)	30	30
TWO DECIMAL PLACE (20)	30	30
FRACTIONAL (1/32)	30	30



DRAWING UNIT OF MEASURE: MM (INCH)

8 | 7 | 6 | 5 | 4 | 3 | 2 | 1

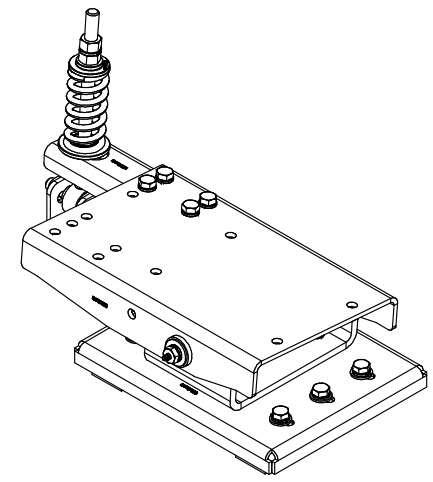
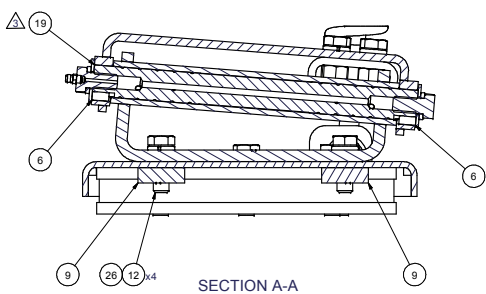
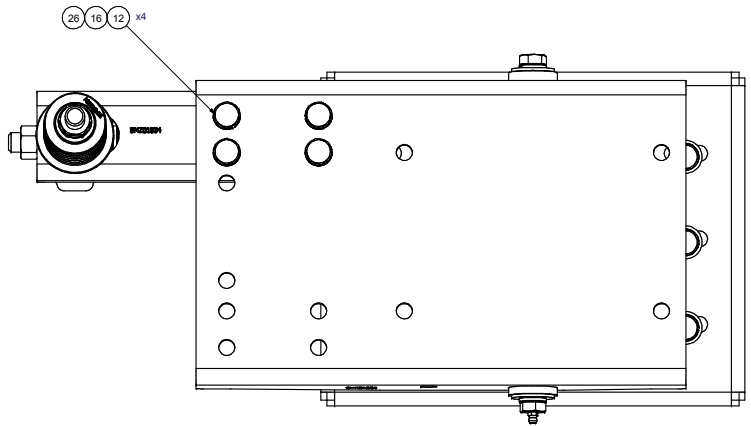

ISOMETRIC VIEW
SCALE 1/3

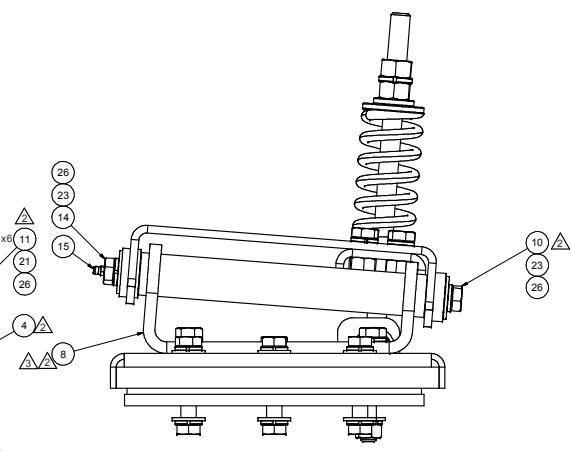
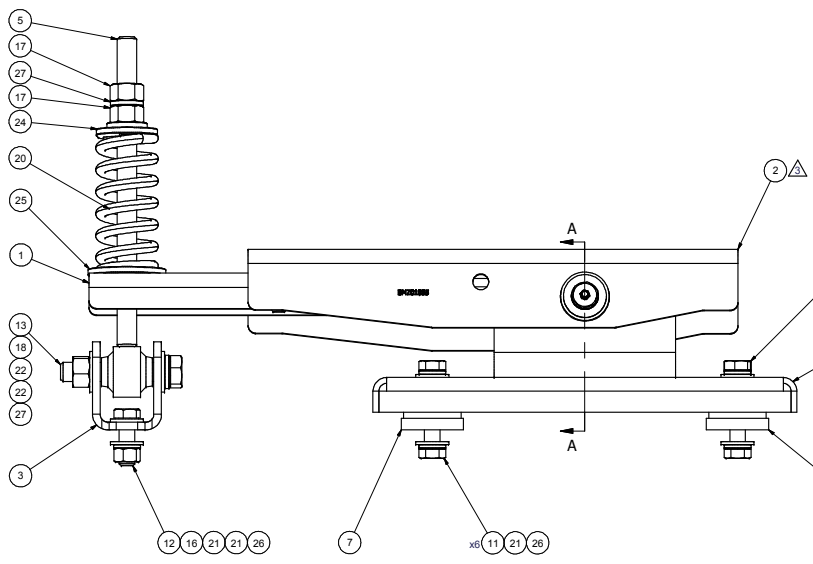

ITEM	QTY	U/M	PART NUMBER	DESCRIPTION
27	2	EACH	WLQ10000	WASHER, LOCK, 5/8", 8, PLT
26	23	EACH	WLQ08000	WASHER, LOCK, 1/2", 8, PLT
25	1	EACH	WFS27001	WASHER, FLAT, DBL STEP, 28mm, 63.5, PLT
24	1	EACH	WFS16001	WASHER, FLAT, DBL STEP, 16mm, 50mm, PLT
23	2	EACH	WFS08001	WASHER, FLAT, 1/2", 8, USS, PLT
22	2	EACH	WFO10000	WASHER, FLAT, 5/8", 8, PLT
21	14	EACH	WFO08000	WASHER, FLAT, 1/2", 8, PLT
20	1	EACH	SPR00002	SPRINGS, COMP, R/H, 110 x 50 x 8.4, RED
19	1	EACH	PIS01010	PIPE, STL, GREASE, ADM TRANSIT, '12
18	1	EACH	NTQ10001	NUT, HEX, 5/8-18UNF, 8, PLT
17	2	EACH	NTQ10000	NUT, HEX, 5/8-11UNC, 8, PLT
16	5	EACH	NTQ08000	NUT, HEX, 1/2-13UNC, 8, PLT
15	1	EACH	FTS04007	FTG, GREASE, NIPPLE, 1/4-28 UNF-2A, BRASS
14	1	EACH	BTS08100	BOLT, GREASE, NIPPLE, 1/2-13 x 1.00"
13	1	EACH	BTQ10351	BOLT, HEX, 5/8-18UNF x 3.50, 8, PLT
12	9	EACH	BTQ08150	BOLT, HEX, 1/2-13UNC x 1.50, 8, PLT
11	12	EACH	BTQ08126	BOLT, HEX, 1/2-20UNF x 1.25, 8, PLT
10	1	EACH	BTQ08100	BOLT, HEX, 1/2-13UNC x 1.00, 8, PLT
9	2	EACH	BMZ01047	BKT, BAR, SLIDE NUT, ADJ, TRANS ADM, '12
8	1	EACH	BMZ01044	BKT, ASSY, CRADLE, PIVOT, ADM TRANSIT, '12
7	2	EACH	BMZ01042	VIBRATION ISOLATOR, BAR, 9.63 x 2 x 1.50
6	2	EACH	BMZ01041	SHAFT KEY, 8mm WIDE x 7mm HIGH x 13.7mm LONG
5	1	EACH	BMZ01040	BKT, ASSY, THRD ROD, ISOLATOR, ADM, '12
4	1	EACH	BMZ01038	BKT, MAIN, BASE PL, ADM, '12
3	1	EACH	BMZ01037	BKT, FORK, KNUCKLE-JOINT, ADM, '12
2	1	EACH	BMZ01035	BKT, MAIN, PIVOT, ASSY, ADM TRANSIT, '12
1	1	EACH	BMZ01034	BKT, SPRING, SUPPORT ARM, ADM, '12

TRANSARGTIC INC.

NOTES:
1) USE SERVICABLE THREADLOCKER ON ALL FASTENERS TO ENGINE COMPONENTS AND TORQUE ALL BOLTS TO S.A.E. SPECIFICATIONS.
2) SEE "TRANSARGTIC A/C COMPRESSOR MOUNT INSTALLATION DISCLAIMER".

3	REVISED DRAWING	448	8	PIES01010	10/18/2012	JRR	POHQUAZ	7/3/2012
2	REVISED DRAWING	448	8	PIES01010	8/19/2012	JRR	Val Jakovlew	7/3/2012
1	GENERAL REVISION				8/30/2012	JRR	DA	7/3/2012
0	RELEASED TO PRODUCTION				7/3/2012	JRR	James Stewart	7/3/2012
REV	ECN	DESCRIPTION	DATE	BY				
					Ron Ingram 7/3/2012			
					Dale Mason 7/3/2012			

THIS DRAWING CONTAINS PROPRIETARY CONFIDENTIAL INFORMATION OWNED BY TRANSARGTIC CANADA INC. THE DOCUMENT AND THE INFORMATION IN IT ARE NOT TO BE USED, DISCLOSED OR REPRODUCED WITHOUT EXPRESS WRITTEN PERMISSION OF THE COMPANY.

UNSPECIFIED TOLERANCES: (ALL DIM)
ONE DECIMAL PLACE (10, 20, 30, 40, 50, 60, 70, 80, 90, 100)
TWO DECIMAL PLACE (1.00, 1.50, 2.00, 2.50, 3.00, 3.50, 4.00, 4.50, 5.00, 5.50, 6.00, 6.50, 7.00, 7.50, 8.00, 8.50, 9.00, 9.50, 10.00)
FRACTIONAL (1/32, 1/16, 1/8, 3/16, 1/4, 3/8, 1/2, 5/8, 3/4, 7/8, 1)



DRAWING UNIT OF MEASURE: MM (INCH)
SCALE: 1:2

DWG NO: KBB00001
REV: 3
SHEET 1 OF 1

8 | 7 | 6 | 5 | 4 | 3 | 2 | 1

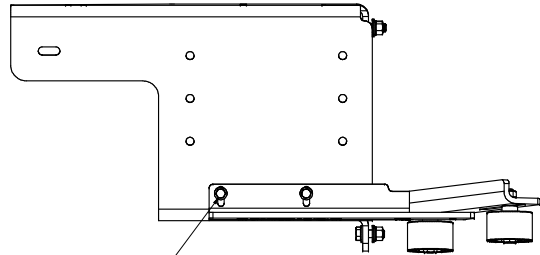

18 13 13 7 4 x2

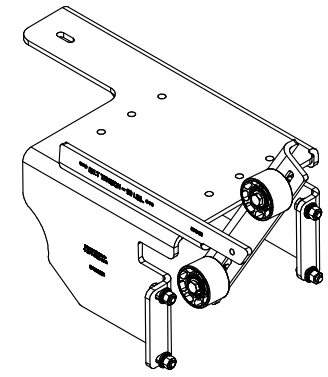
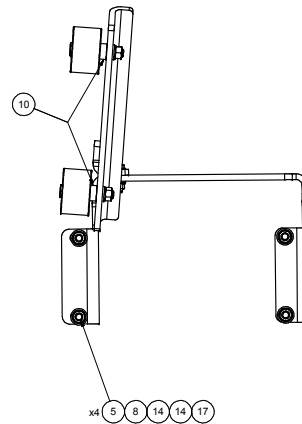
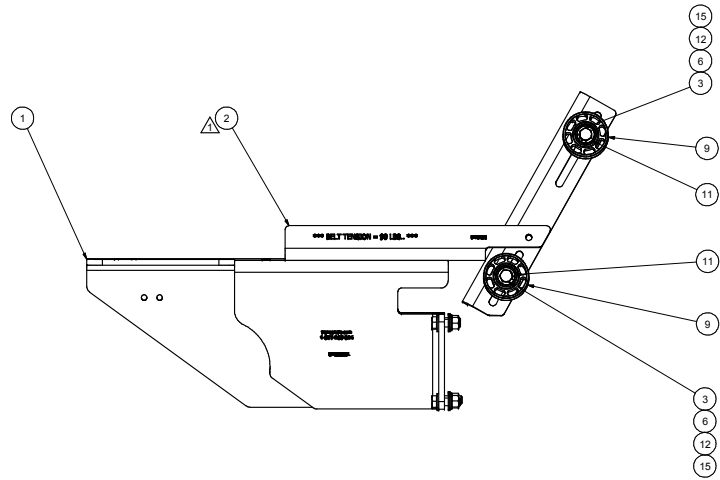

ISOMETRIC VIEW

- NOTES:
 1) USE SERVICABLE THREADLOCKER ON ALL FASTENERS TO ENGINE COMPONENTS AND TORQUE ALL BOLTS TO S.A.E. SPECIFICATIONS.
 2) SEE 'TRANSARGTIC A/C COMPRESSOR MOUNT INSTALLATION DISCLAIMER'.

ITEM	QTY	U/M	PART NUMBER	DESCRIPTION
17	4	EACH	WLQ08000	WASHER, LOCK, 1/2", 8, PLT
16	2	EACH	WLP06000	WASHER, LOCK, 3/8", 5, PLT
15	2	EACH	WLA12000	WASHER, LOCK, 12mm, 8.8, PLT
14	8	EACH	WFO08000	WASHER, FLAT, 1/2", 8, PLT
13	4	EACH	WFN06000	WASHER, FLAT, 3/8", 2, PLT
12	2	EACH	WFA12000	WASHER, FLAT, 12mm, 8.8, PLT
11	2	EACH	SLV17012	SLEEVE, PULLEY, 16.90 x 22.23 mm x12.19l
10	2	EACH	SCD25412	SPACER, COL, DRL, 25.4mm x 25.40 x 12.3l
9	2	EACH	PUL80074	PULLEY, IDLER, BACKSIDE, P8, 74D, 46.27W
8	4	EACH	NTQ08000	NUT, HEX, 1/2-13UNC, 8, PLT
7	2	EACH	NTP06000	NUT, HEX, 3/8-16UNC, 5, PLT
6	2	EACH	NTA12000	NUT, HEX, 12 x 1.75, 8.8, PLT
5	4	EACH	BTQ08150	BOLT, HEX, 1/2-13UNC x 1.50, 8, PLT
4	2	EACH	BTQ06150	BOLT, HEX, 3/8-16UNC, 1.50", 8, PLT
3	2	EACH	BTCT2080	BOLT, HEX, 12 x 1.75 x 80mm, 10.9, PLT
2	1	EACH	BMZ01050	BKT, FRNT, ANGLE, WELDMT, BB, D3RE, '13
1	1	EACH	BFB00001	BKT, FOUNDATION, MAIN, BB D3RE, '13

BILL OF MATERIALS

DRAWN	jodriguez	8/20/2012			
CHECKED	Val Jakowlew	8/20/2012			
REV	ECN	DESCRIPTION	DATE	BY	TITLE
1		REVISED P/N BMZ01050	8/25/2012	JRR	KIT, FOUND'N, BB D3RE, ISB, '13
0		RELEASED TO PRODUCTION	8/20/2012	BRK	
				James Stewart	
				Ron Ingram	
				Dale Mason	
UNDESIGNED TOLERANCES: (ALL DIM) GROUP ONE DECIMAL PLACE (10) 20 USE THIRSDECIMAL PLACE (100) 50 USE FRACTIONAL (1/32) 20 USE					DWG NO KFB67001
DRAWING UNIT OF MEASURE: MM (INCH) SCALE: 1:4					REV 1

UNDESIGNED TOLERANCES: (ALL DIM) GROUP	THIRD ANGLE PROJECTION
--	------------------------

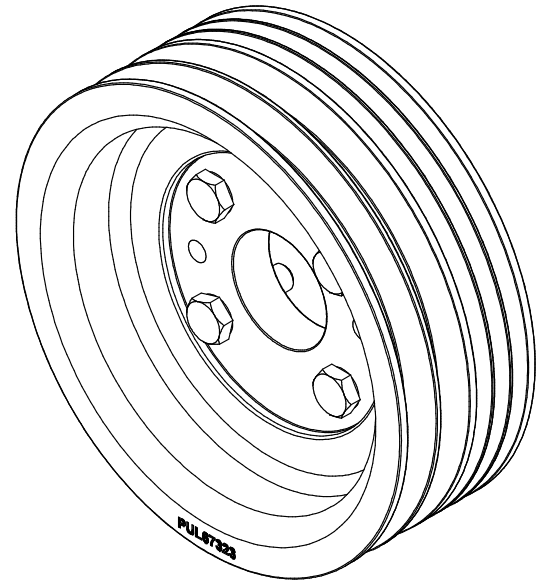
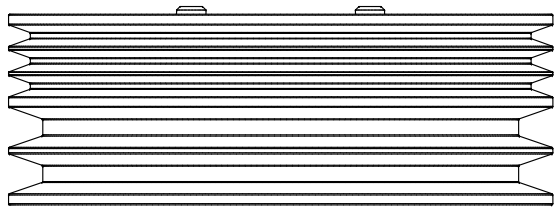

ISOMETRIC VIEW

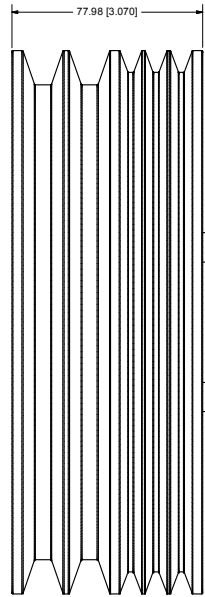
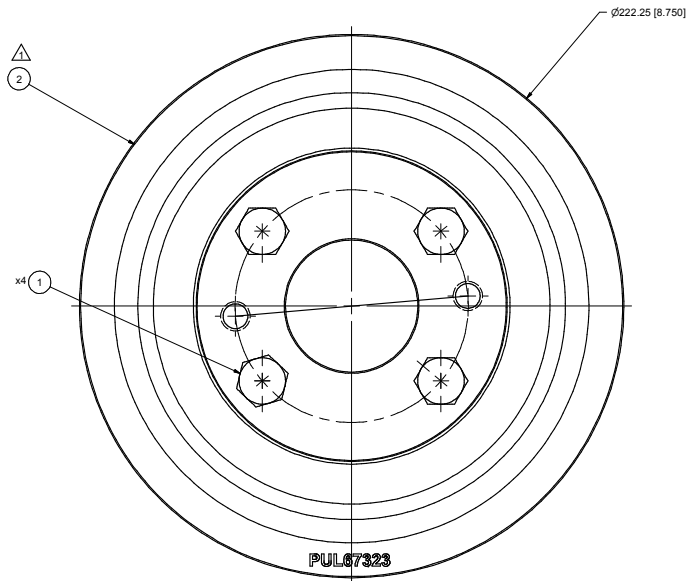

NOTES:

- 1) USE SERVICABLE THREADLOCKER ON ALL FASTENERS TO ENGINE COMPONENTS AND TORQUE ALL BOLTS TO S.A.E. SPECIFICATIONS.
- 2) SEE "TRANSARGTIC A/C COMPRESSOR MOUNT INSTALLATION DISCLAIMER".

ITEM	QTY	U/M	PART NUMBER	DESCRIPTION
2	1	EACH	PUL67323	PULLEY, CRANK, ADD-ON, COMBO, ISB, 28/3V
1	4	EACH	BTCL2040	BOLT, HEX, 12 x 1.75 x 40mm, 10.9, FLT

BILL OF MATERIALS

DRAWN	jrodriguez	09/14/12
CHECKED	Val Jakowlew	09/14/12
REV/ECN	DESCRIPTION:	DATE: BY:
		09/14/12
		09/14/12
		09/14/12

TRANSARGTIC INC.

KIT, PULLEY, ISB, D3RE, '12

UNSPECIFIED TOLERANCES:		DWG NO		REV
ONE DECIMAL PLACE (10)	MM	D	KPC67001	1
TWO DECIMAL PLACE (20)	MM	D		
FRACTIONAL (1/32)	INCHES	SCALE	1:1	
THIRD ANGLE PROJECTION		DRAWING UNIT OF MEASURE	MM (INCH)	SHEET 1 OF 1

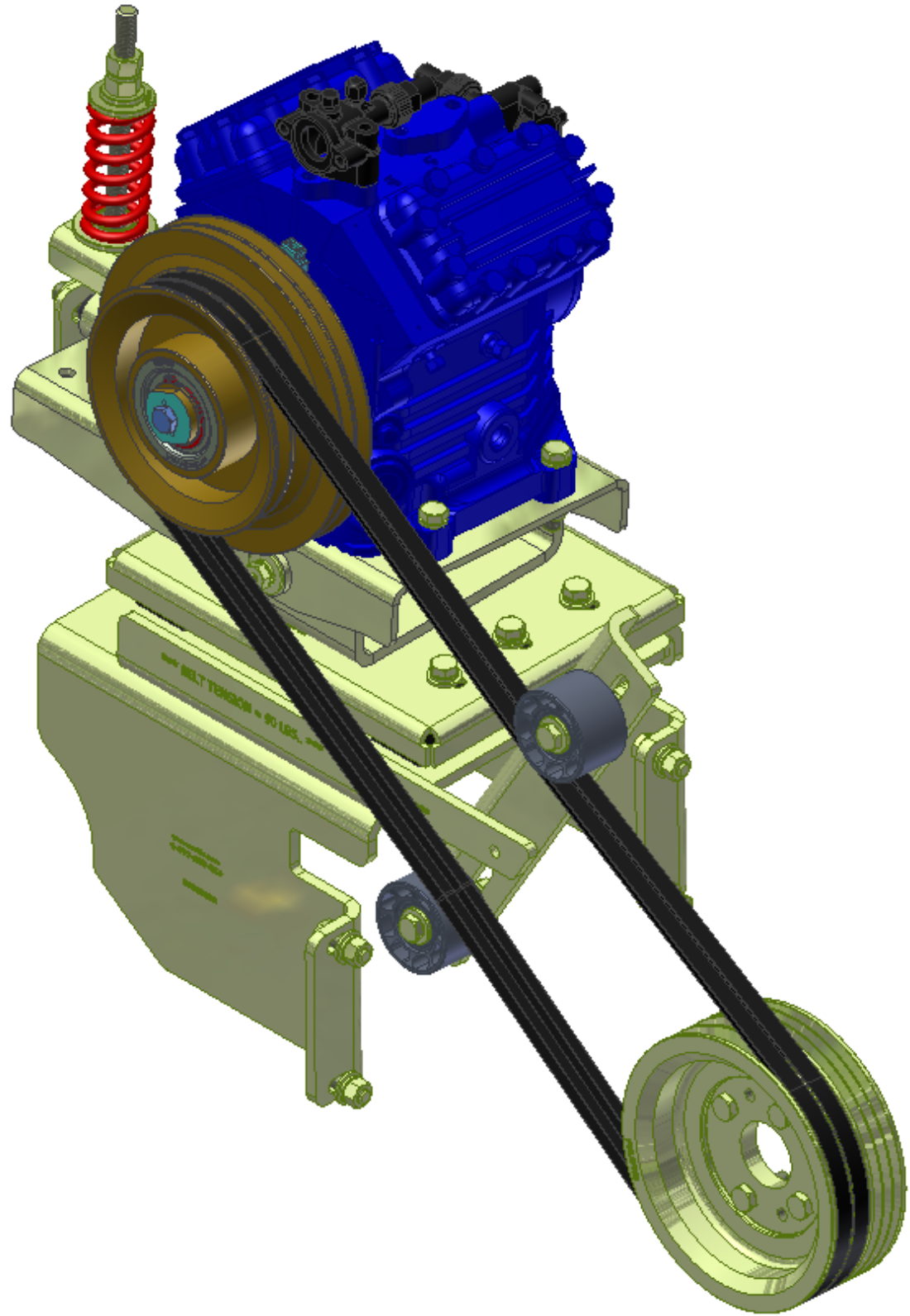

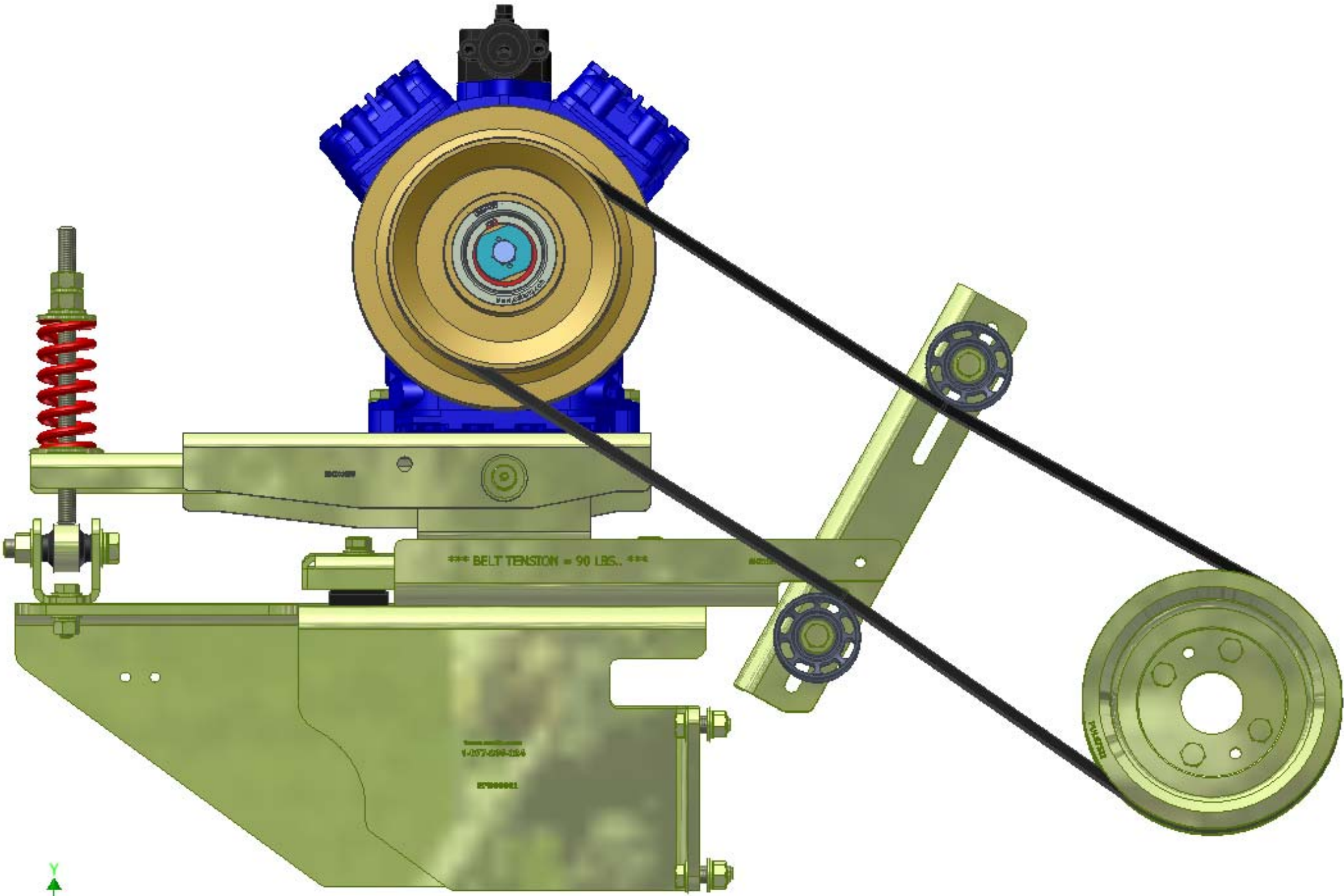

*** BELT TENSION = 90 LBS. ***

1-877-698-284

E700001

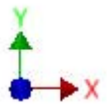

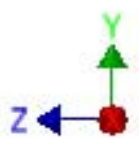
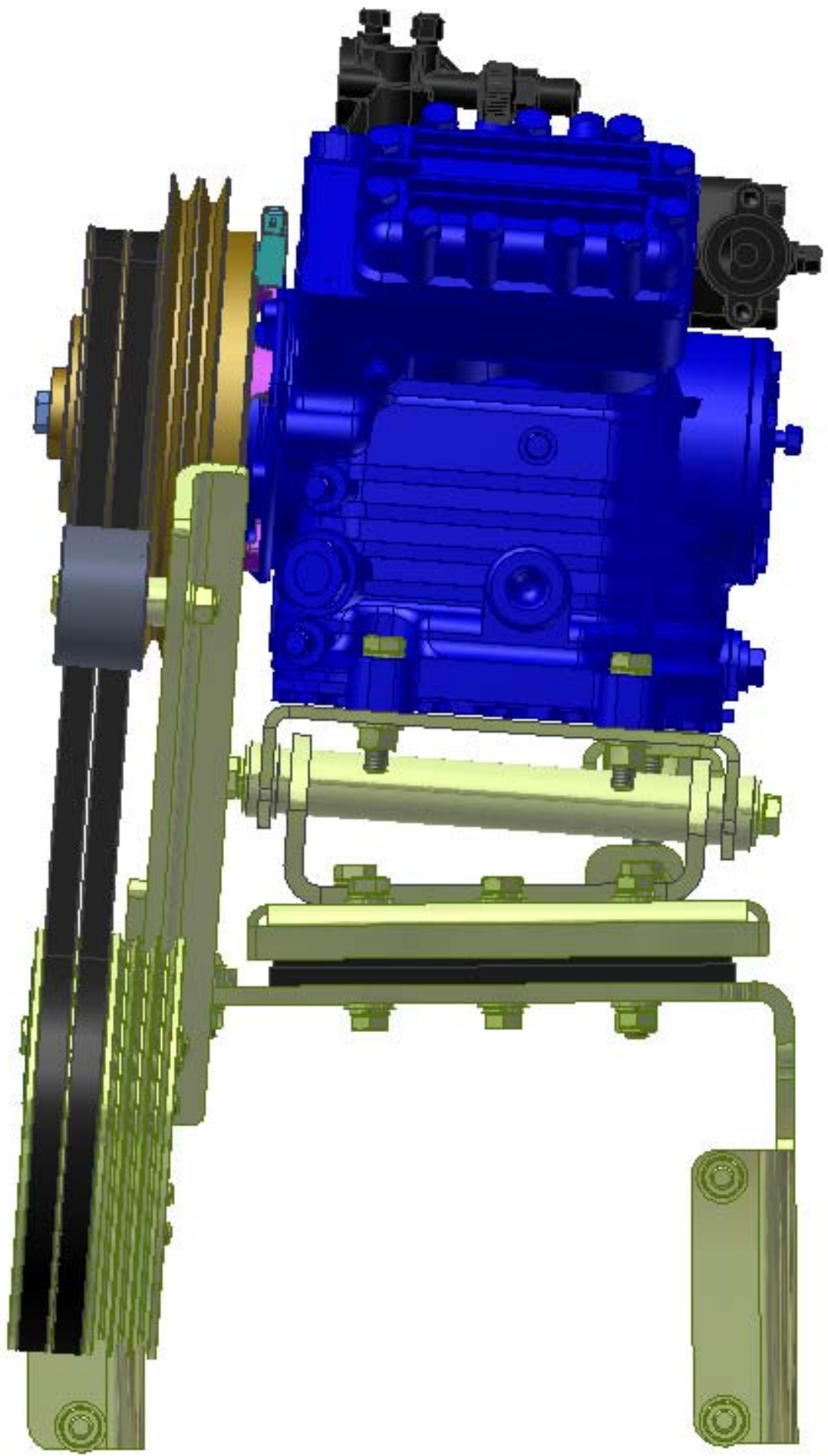

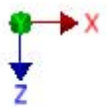
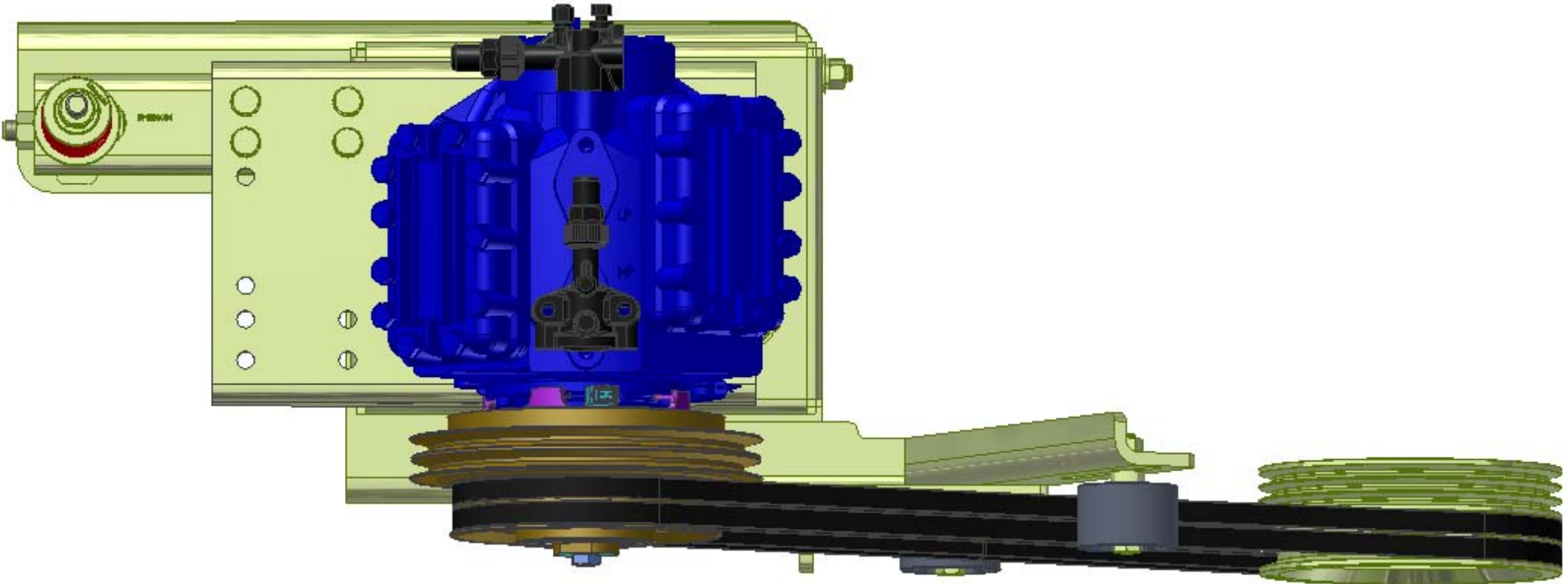

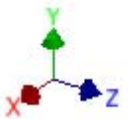
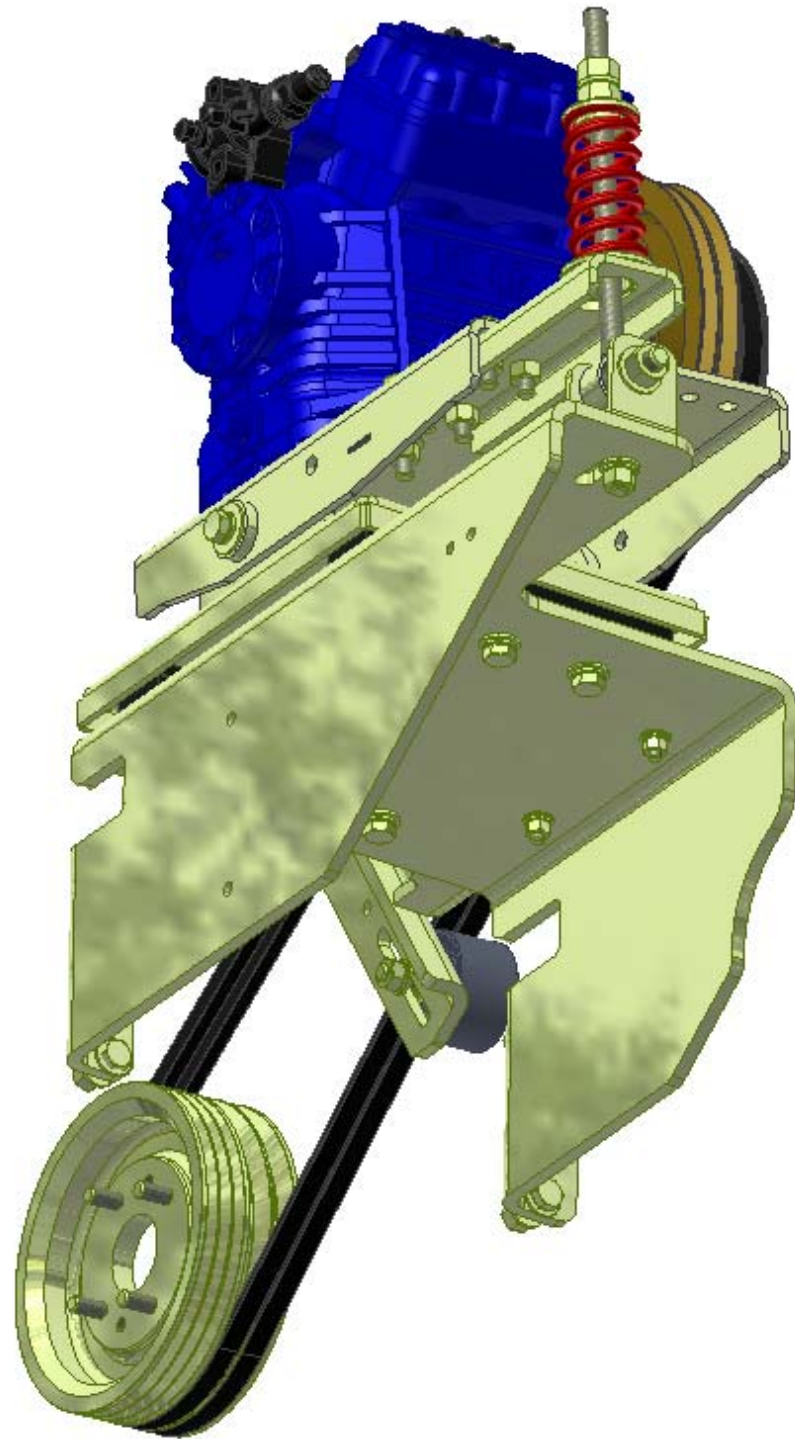

TransArctic A/C Compressor Mount Installation Disclaimer

All compressor mounts should be installed by qualified and trained personnel using proper tools and equipment in safe working conditions following industry standard guidelines for motor vehicle service and repair.

The installer of any compressor mount purchased from TransArctic must undertake all responsibility of issues arising from that compressor bracket being installed on any vehicle. As well as insure that a **proper and sufficient ground** is established between the compressors' clutches and the vehicle's engine. Mount functionality, operation and durability can all be compromised by an incompetent installation.

Due to the many different situations, parameters and application criteria, which are beyond the compressor mount manufacturer's control, TransArctic does not warrant design, durability, or operational functionality of any compressor mount improperly installed by another party.

With no implied guarantees it is the mount installer's strict responsibility to determine safety and functionality, of the compressor mount, at the time of installation.

Please contact TransArctic with any issue arising from installation so we may better improve the product. If you have any reservations about the compressor mount integrity contact TransArctic immediately at 1-877-COLD-AIR.

Mark OEM tensioner location

Install Kit

Check for Interferences

Check to ensure that the proper OEM tensioner orientation is maintained

Run engine with A/C system engaged for at least 10 minutes to run in belt

Check OEM tensioner orientation and adjust as required

Responsabilidad limitada de TransArctic en la instalación del soporte del compresor

Todos los soportes de los compresores deben ser instalados por personas calificadas y entrenadas, usando para ello los equipos y herramientas necesarios para esta labor en buenas condiciones y según las normas y guías para el servicio y/o reparación de motores de vehículos.

El instalador de los soportes comprados en TransArctic asume toda la responsabilidad de cualquier problema que surja en el soporte del compresor al vehículo; de igual manera es responsable que el cable a tierra sea conectado entre el embrague del compresor y el motor del vehículo.

Se advierte que el buen funcionamiento y la durabilidad del soporte pueden ser comprometidos por defectos en su instalación.

Debido a las diversas situaciones que se puedan presentar fuera del control del fabricante, TransArctic no garantiza el diseño, la durabilidad o el correcto funcionamiento de cualquier equipo inapropiadamente instalado por terceros.

Esta sobreentendido que el Instalador del montaje del compresor es estrictamente responsable de la seguridad y funcionamiento del equipo en el momento de la instalación.

Si tuviera algún problema o duda acerca de la instalación del soporte del compresor pongase en contacto inmediatamente con TransArctic al teléfono 1-877-COLD-AIR de modo que podamos mejorar nuestro producto.

Note la ubicación del medidor de tensión OEM

Instale el equipo

Controlar si hay interferencias.

Asegure que el medidor de tensión mantenga la orientación justa.

Encienda el motor por lo menos 10 minutos con el sistema A/C enganchado para que la correa corra

Controle la orientación justa del medidor de tensión y ajuste a las condiciones requeridas del fabricante