

Bill of Materials Listing

TransArctic Canada Inc.

12/23/2015
Page 1 of 1

Product Number	Description	Date	Weight	Uof M	Yield
Line	Component Prod#	Bin	Unit	Qty	
KMC98462	Mt Kit, ISL13, T3RE, TK X430, '13		12/18/2015	190.78	0
10	BEL32210		Belt, Banded B gr,2210mm (87") (RBX84-2)	each	1
20	BMC83053		Bkt, Diag, Brace RR, MFDT, RE300	each	1
30	BMC83054		Bkt, Main, Idler, Weldm't, RE300	each	1
40	BMC83058		Bkt, Cover, Light Pl, MF DT, RE300	each	1
50	BMC83074		Bkt, Relay, ISC, D3RE, 2010	each	1
60	BMC83107		Bkt, Main, FRT Support, T3RE, '13	each	1
70	BMC83108		Bkt, Main, RR Support, T3RE, '13	each	1
80	BMC83109		Bkt, Main, Lateral Brace, T3RE, '13	each	1
90	BMC83113		Bkt, Brace RR/PS, PDU Panel, T3RE, '13	each	1
100	BMC83116		Bkt, Support, PDU Panel, T3RE, '13	each	1
110	BMC83120		Bkt, Weldm't, Sup, A.F Housing,T3RE,'13	each	1
120	BMC83122		Bkt, Exhaust, Adapter, T3RE, '13	each	1
130	BMZ00046		Bkt, Angle, Brace, Hanger, Hose, 2013	each	1
140	CLP04000		Clamp, T bolt, Spring, 4", CAC	each	2
150	TUS04093		Tube, Stl, Exh, 4"o.d., 90 deg elb,8 x 8	each	1
160	HOA04083		Hose, Flex, CAC, 4.0d x 8.0, 3 ring	each	1
170	KCB98462		Kit, Compressor, 24V, TK X430, '13	each	1
180	PUA05012		Pulley, Assy, Idler,B/BX gr,5", STL,Plt	each	1
190	PUL80074		Pulley, Idler, B/S, Wide, 76d (89102)	each	1
200	PUL89323		Pulley, Crank, ADD-ON, ISL, 2B/3V, '13	each	1
210	SCD37012		Spacer, Col, Drl, 37 mm x 25.4o x 12.3i	each	1
220	SCD41012		Spacer, Col, Drl, 41 mm x 25.4o x 12.3i	each	1
230	SLV17012		Sleeve, Pulley, 16.9o x 22.23mm x 12.32i	each	2
240	KBC84064		Bag Kit, Fasteners, KMC840/841/940/94164	each	1

Bill of Materials Listing

TransArctic Canada Inc.

12/23/2015
Page 1 of 1

Product Number	Description	Date	Weight	Uof M	Yield
Line Component Prod#	Description	Bin Unit	Qty		
KBC84064	Bag Kit, Fasteners, KMC840/841/940/94164	7/9/2013	2.97		0
10 BTC08035	Bolt, Hex, 8 x 1.25 x 35mm, 10.9, Plt,FT	each	4		
20 BTC10035	Bolt, Hex, 10 x 1.5 x 35mm, 10.9, Plt,FT	each	2		
40 BTC12040	Bolt, Hex, 12 x 1.75 x 40mm, 10.9,Plt,FT	each	5		
50 BTC12050	Bolt, Hex, 12 x 1.75 x 50mm, 10.9,Plt	each	2		
60 BTC12100	Bolt, Hex, 12 x 1.75 x 100mm, 10.9, Plt	each	2		
70 BTQ08126	Bolt, Hex, 1/2-20unf, 1.25", 8, Plt	each	6		
80 NTA10000	Nut, Hex, 10 x 1.5, 8.8, Plt	each	2		
90 NTA12000	Nut, Hex, 12 x 1.75, 8.8, Plt	each	9		
100 SCP03075	Screw, PH, PD, SDT, #10-16 x .75, ST,Plt	each	3		
160 WFA08000	Washer, Flat, 8mm, 8.8, Plt	each	4		
170 WFA10000	Washer, Flat, 10mm, 8.8, Plt	each	4		
180 WFA12000	Washer, Flat, 12mm, 8.8, Plt	each	16		
190 WFQ08000	Washer, Flat, 1/2", 8, Plt	each	6		
200 WLA08000	Washer, Lock, 8mm, 8.8, Plt	each	4		
210 WLA10000	Washer, Lock, 10mm, 8.8, Plt	each	2		
220 WLA12000	Washer, Lock, 12mm, 8.8, Plt	each	9		
230 WLQ08000	Washer, Lock, 1/2", 8, Plt	each	6		

Bill of Materials Listing

TransArctic Canada Inc.

3/3/2017
Page 1 of 1

Product Number	Description	Date	Weight	Uof M	Yield
Line Component Prod#	Description	Bin Unit	Qty		
KCB98462	Kit, Compressor, 24V, TK X430, '13		9/16/2013	50.88	0
10	BEL11040		Belt, A gr, 1040mm (41")	each	2
20	BMC83114		Bkt, PI, ALT Spacer, T3RE, '13	each	1
30	BMN80008		Vibration Isolator, Bar, 16.50 x 2 x 1.50	each	2
40	BMN80025		Bkt, Back, PL, Slide, IC, RE300	each	1
50	BMT10011		Bkt, Tenr, Block, Offset, 3mm	each	2
60	BMZ00043		Bkt, Main, Base PI, '13	each	1
70	KBT98462		Kit, Platform, X430 W/ Alt, '13	each	1
80	PUL03321		Pulley, ALT, Idler, 3.25"d, 2A	each	1
90	TRD08120		Threaded, Rod, 1/2-13unc x 12", 5, Plt	each	1
100	KBZ84064		Bag Kit, Fasteners, KCB84064	each	1

Bill of Materials Listing

TransArctic Canada Inc.

12/23/2015
Page 1 of 1

Product Number	Description	Date	Weight	Uof M	Yield
Line Component Prod#	Description	Bin Unit	Qty		
KBZ84064	Bag Kit, Fasteners, KCB84064		10/18/2013	2.50	0
10	BTP08653		Bolt, Hex, 1/2-13unc, 6.5", 5, Plt, FT	each	1
20	BTQ08101		Bolt, Hex, 1/2-20unf, 1.00", 8, Plt	each	3
30	BTQ08150		Bolt, Hex, 1/2-13unc, 1.5", 8, Plt	each	4
40	BTQ08126		Bolt, Hex, 1/2-20unf, 1.25", 8, Plt	each	2
50	BTQ08653		Bolt, Hex, 1/2-13unc, 6.5", 8, Plt	each	1
60	CSF08076		Capscrew, FH, 1/2-20unf x .75", Alloy, Plt	each	1
70	NTQ08000		Nut, Hex, 1/2-13unc, 8, Plt	each	7
80	WFQ08000		Washer, Flat, 1/2", 8, Plt	each	11
90	WLQ08000		Washer, Lock, 1/2", 8, Plt	each	13

Bill of Materials Listing

TransArctic Canada Inc.

12/21/2015
Page 1 of 1

Product Number	Description	Date	Weight	Uof M	Yield
Line Component Prod#	Description	Bin Unit	Qty		
KBT98462	Kit, Platform, X430 W/ Alt, '13		2/17/2009	6.83	0
10	BMN80031	Bkt, Main, Slide, Assy, 05K, IC, RE300	each	1	
20	BMC90010	Bkt, Weld't, X430 W/ Alt, T3RE, '13	each	1	
30	BTQ07150	Bolt, Hex, 7/16-14unc, 1.5", 8, Plt	each	4	
40	NTP07000	Nut, Hex, 7/16-14unc, 5, Plt	each	4	
60	WFN07000	Washer, Flat, 7/16", 2, Plt	each	8	
80	WLQ07000	Washer, Lock, 7/16", 8, Plt	each	8	

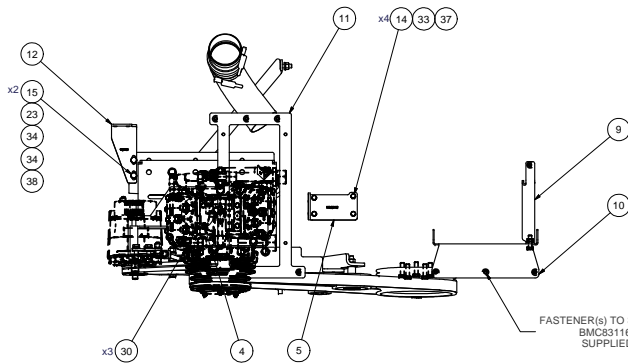

FASTENER(S) TO SECURE BMC83113, BMC83116, BMC83120, SUPPLIED BY OTHER.

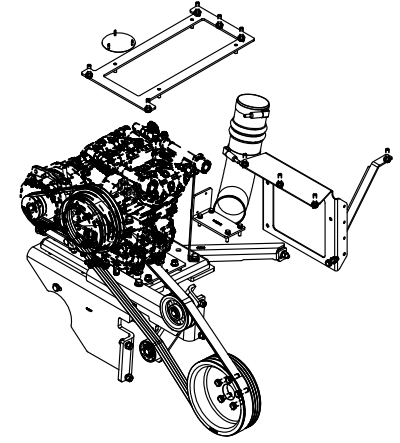

ISOMETRIC VIEW

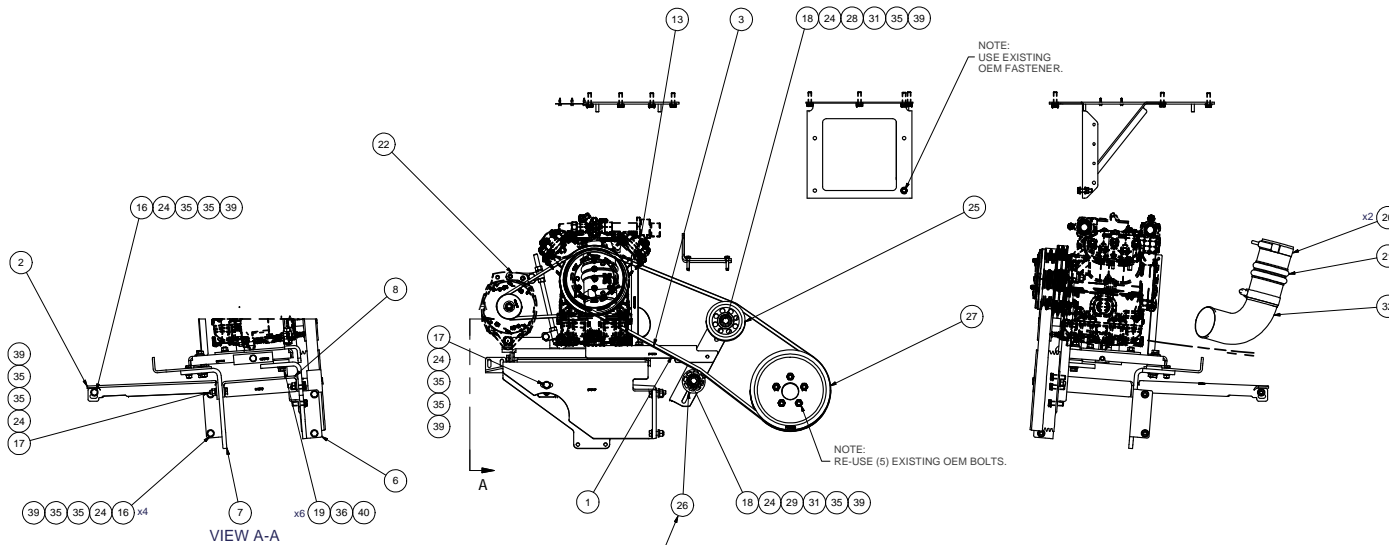

NOTE:
USE EXISTING
OEM FASTENER.

NOTE:
RE-USE (5) EXISTING OEM BOLTS.

VIEW A-A

NOTE:
INSTALL PULLEY WITH
DEEP OFFSET TOWARD SPACER.

NOTES:

- 1) USE SERVICABLE THREADLOCKER ON ALL FASTENERS TO ENGINE COMPONENTS AND TORQUE **ALL** BOLTS TO S.A.E. SPECIFICATIONS.
- 2) SEE "TRANSARTIC A/C COMPRESSOR MOUNT INSTALLATION DISCLAIMER".

ITEM	QTY	U/M	PART NUMBER	DESCRIPTION
40	6	EACH	WLO08000	WASHER, LOCK, 1/2", 8, PLT
39	9	EACH	WLA12000	WASHER, LOCK, 12mm, 8.8, PLT
38	2	EACH	WLA10000	WASHER, LOCK, 10mm, 8.8, PLT
37	4	EACH	WLA08000	WASHER, LOCK, 8mm, 8.8, PLT
36	6	EACH	WFO08000	WASHER, FLAT, 1/2", 8, PLT
35	16	EACH	WFA12000	WASHER, FLAT, 12mm, 8.8, PLT
34	4	EACH	WFA10000	WASHER, FLAT, 10mm, 8.8, PLT
33	4	EACH	WFA08000	WASHER, FLAT, 8mm, 8.8, PLT
32	1	EACH	TUS04093	TUBE, STL, EXH, 4"o.d., 90 deg ELB, 8 x 8
31	2	EACH	SLV17012	SLEEVE, PULLEY, 16.9o x 22.23 mm x12.19l
30	3	EACH	SCP03075	SCREW, PH, SDT, #10-16 x .75, ST, PLT
29	1	EACH	SCD41012	SPACER, COL, DRL, 41mm x 25.4o x 12.3l
28	1	EACH	SCD37012	SPACER, COL, DRL, 37mm x 25.4o x 12.3l
27	1	EACH	PUL89323	PULLEY, CRANK, ADD-ON, ISL, 2B/3V, '13
26	1	EACH	PUL80074	PULLEY, IDLER, BACKSIDE, P8, 74D, 46.27W
25	1	EACH	PUA05012	PULLEY, ASSY, IDLER, B/BX gr, 5" STL, PLT
24	9	EACH	NTA12000	NUT, HEX, 12 x 1.75, 8.8, PLT
23	2	EACH	NTA10000	NUT, HEX, 10 x 1.5, 8.8, PLT
22	1	EACH	KCB98462	KIT, COMPRESSOR, 24V, X430, '13
21	1	EACH	H0A04083	HOSE, FLEX, CAC, 4.0d x 8.0, 3 RING
20	2	EACH	CLP04000	CLAMP, T BOLT, SPRING, 4", CAC
19	6	EACH	BT08126	BOLT, HEX, 1/2-20UNF x 1.25, 8, PLT
18	2	EACH	BT12100	BOLT, HEX, 12 x 1.75 x 100mm, 10.9, PLT
17	2	EACH	BT12050	BOLT, HEX, 12 x 1.75 x 50mm, 10.9, PLT
16	5	EACH	BT12040	BOLT, HEX, 12 x 1.75 x 40mm, 10.9, PLT
15	2	EACH	BT10035	BOLT, HEX, 10 x 1.5 x 35mm, 10.9, PLT
14	4	EACH	BT08035	BOLT, HEX, 8 x 1.25 x 35mm, 10.9, PLT
13	1	EACH	BMZ00046	BKT, ANGLE, BRACE, HANGER, HOSE, 2013
12	1	EACH	BMC83122	BKT, EXHAUST, ADAPTER, T3RE, '13
11	1	EACH	BMC83120	BKT, WELDMT, SUP, A F HOUSING, T3RE, '13
10	1	EACH	BMC83116	BKT, SUPPORT, PDU PANEL, T3RE, '13
9	1	EACH	BMC83113	BKT, BRACE RR/P'S, PDU PANEL, T3RE, '13
8	1	EACH	BMC83109	BKT, MAIN, LATERAL BRACE, T3RE, '13
7	1	EACH	BMC83108	BKT, MAIN, RR SUPPORT, T3RE, '13
6	1	EACH	BMC83107	BKT, MAIN, FRT SUPPORT, T3RE, '13
5	1	EACH	BMC83074	BKT, RELAY, ISC, D3RE, 2010
4	1	EACH	BMC83058	BKT, COVER, LIGHT PL, MFD, RE300
3	1	EACH	BMC83054	BKT, MAIN, IDLER, WELDMT, RE300
2	1	EACH	BMC83053	BKT, DIAG, BRACE RR, MFD, RE300
1	1	EACH	BEL32210	BELT, BANDED, B GR, 2210mm (87") (BX84-2)

BILL OF MATERIALS

DRAWN vjakoview		9/25/2013	TRANSARTIC INC.
CHECKED Jose Rodriguez		12/22/2015	
REV	DESCRIPTION	DATE	BY
0	RELEASED TO PRODUCTION	12/22/15	GA
1			James Stewart
2			MFS
			James Stewart
			APPROVED
			Dale Mason
			12/22/2015

THIS DRAWING CONTAINS PROPRIETARY CONFIDENTIAL INFORMATION OWNED BY TRANSARTIC CANADA INC. THE DOCUMENT AND THE INFORMATION IN IT ARE NOT TO BE USED, DISCLOSED OR REPRODUCED WITHOUT EXPRESS WRITTEN PERMISSION OF THE COMPANY.

UNSPECIFIED TOLERANCES:	MM (INCH)	THIRD ANGLE PROJECTION
ONE DECIMAL PLACE (.X)	FRONT	DRAWING UNIT OF MEASURE: MM (INCH)
TWO DECIMAL PLACES (.XX)	TOP	
FRACTIONAL (1/16")	ANGULAR (1/2°)	

MT KIT, ISL13, T3RE, TK X430, '13

SIZE: D DWG NO: KMC98462 REV: 0

SCALE: 1:1 SHEET: 1 OF 1

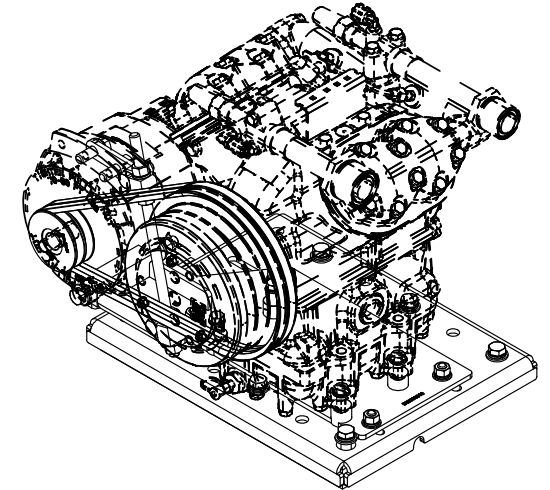
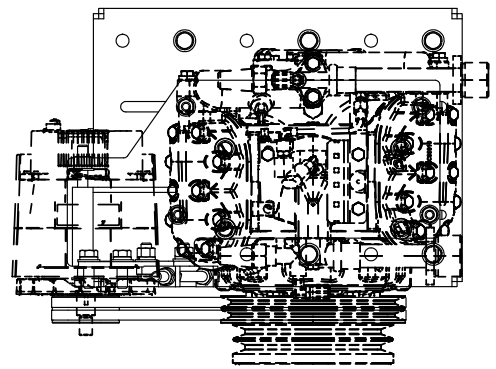
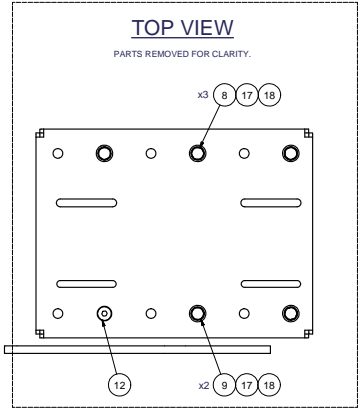

ISOMETRIC VIEW

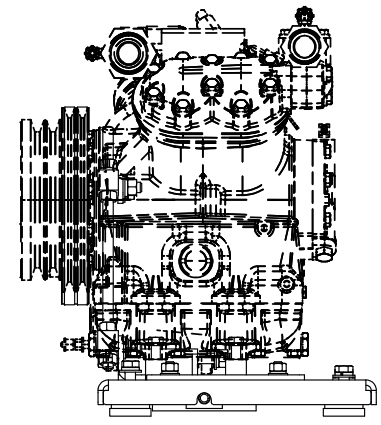
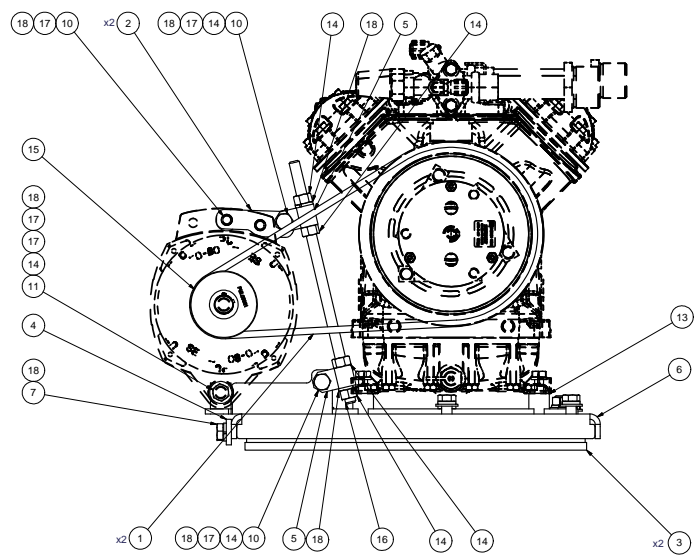

- NOTES:**
- 1) USE SERVICABLE THREADLOCKER ON ALL FASTENERS TO ENGINE COMPONENTS AND TORQUE ALL BOLTS TO S.A.E. SPECIFICATIONS.
 - 2) SEE "TRANSARGTIC A/C COMPRESSOR MOUNT INSTALLATION DISCLAIMER".
 - 3) WEIGHT: 58.86 LBS.

ITEM	QTY	U/M	PART NUMBER	DESCRIPTION
18	13	EACH	WFO08000	WASHER, LOCK, 1/2", 8, PLT
17	11	EACH	WFO08000	WASHER, FLAT, 1/2", 8, PLT
16	1	EACH	TRD08120	THREADED, ROD, 1/2-13UNC x 12", 5 PLT
15	1	EACH	PUL03321	PULLEY, ALT, IDLER, 3.25"o, 2A
14	7	EACH	NT008000	NUT, HEX, 1/2-13UNC, 8, PLT
13	1	EACH	KBT98462	MT KIT, TRANSIT, X430, '13
12	1	EACH	CSF08076	CAPSCREW, FH, 1/2-20UNF x .75", ALLOY, PLT
11	1	EACH	BT008653	BOLT, HEX, 1/2-13UNC x 6.50, 8, PLT
10	4	EACH	BT008150	BOLT, HEX, 1/2-13UNC x 1.50, 8, PLT
9	2	EACH	BT008126	BOLT, HEX, 1/2-20UNF x 1.25, 8, PLT
8	3	EACH	BT008101	BOLT, HEX, 1/2-20UNF x 1.00, 8, PLT
7	1	EACH	BT008653	BOLT, HEX, 1/2-13UNC x 6.50, 5, PLT, FT
6	1	EACH	BMZ00043	BKT, MAIN, BASE PL, '13
5	2	EACH	BMT10011	BKT, TENR, BLOCK, OFFSET, 3mm
4	1	EACH	BMN80025	BKT, BACK, PL, SLIDE, IC, RE300
3	2	EACH	BMN80008	VIBRATION ISOLATOR, BAR, 16.50 x 2 x 1.50
2	1	EACH	BMCS3114	BKT, PL, ALT, SPACER, T3RE, '13
1	2	EACH	BELT1040	BELT, A, gr, 1040mm (41")

BILL OF MATERIALS

DRAWN jrodriguez	12/21/2015	TRANSARGTIC INC.		
CHECKED Jose Rodriguez	12/22/2015			
REV: ECN	DESCRIPTION:	DATE:	BY:	TITLE
1	WAS (2) BELT (0); NOW BELT (0)	3/21/2017	JRR	
0	RELEASED TO PRODUCTION	12/22/15	JAL	
1		12/22/2015	James Stewart	KIT, COMPRESSOR, 24V, X430, '13
		12/22/2015	MFS	
		12/22/2015	James Stewart	
		12/22/2015	APPROVED	
		12/22/2015	Dale Mason	

UNSPECIFIED TOLERANCES:	ALL DIMS	THIRD ANGLE PROJECTION
ONE DECIMAL PLACE (X.0)	30 (3RD)	
TWO DECIMAL PLACES (X.00)	25 (2ND)	
FRACTIONAL (1/16")	12 (1ST)	

DWG NO	REV
KCB98462	1
SCALE: 1:3	SHEET 1 OF 1

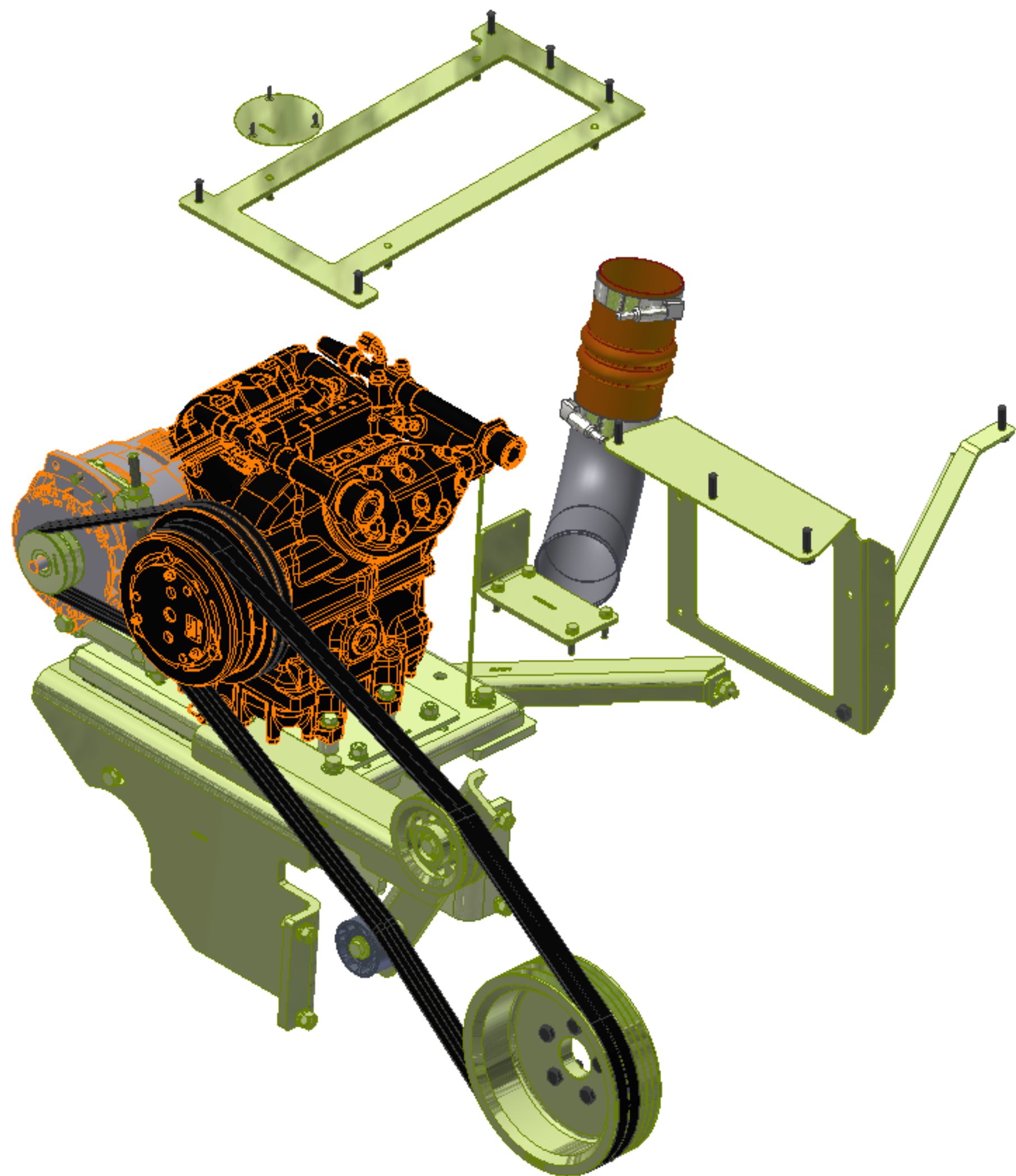

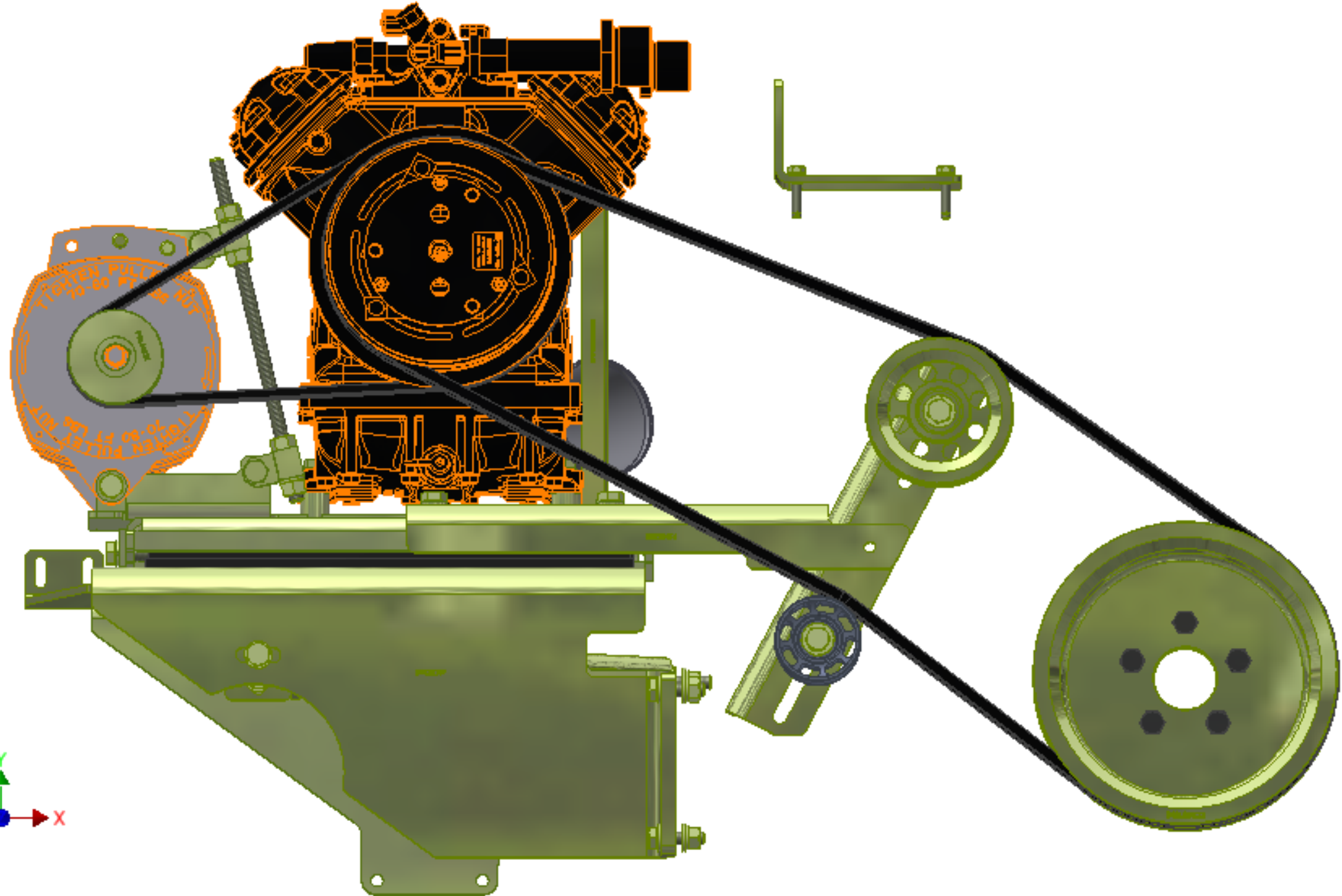
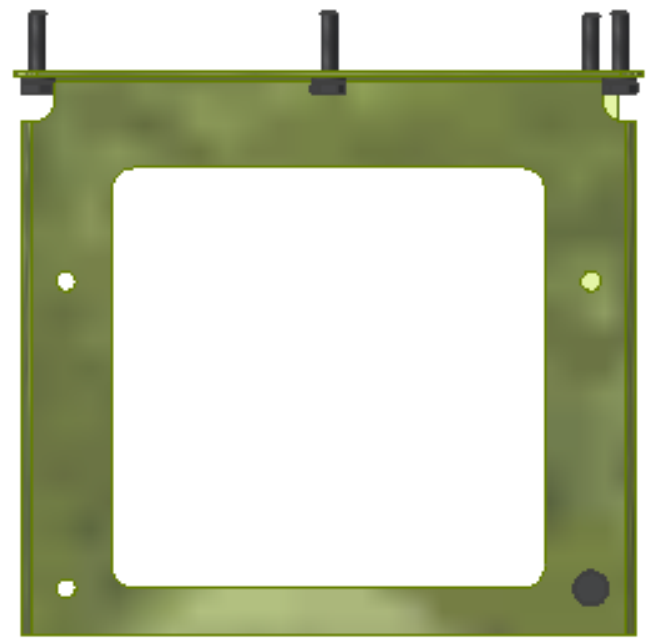

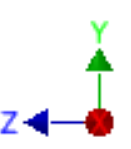
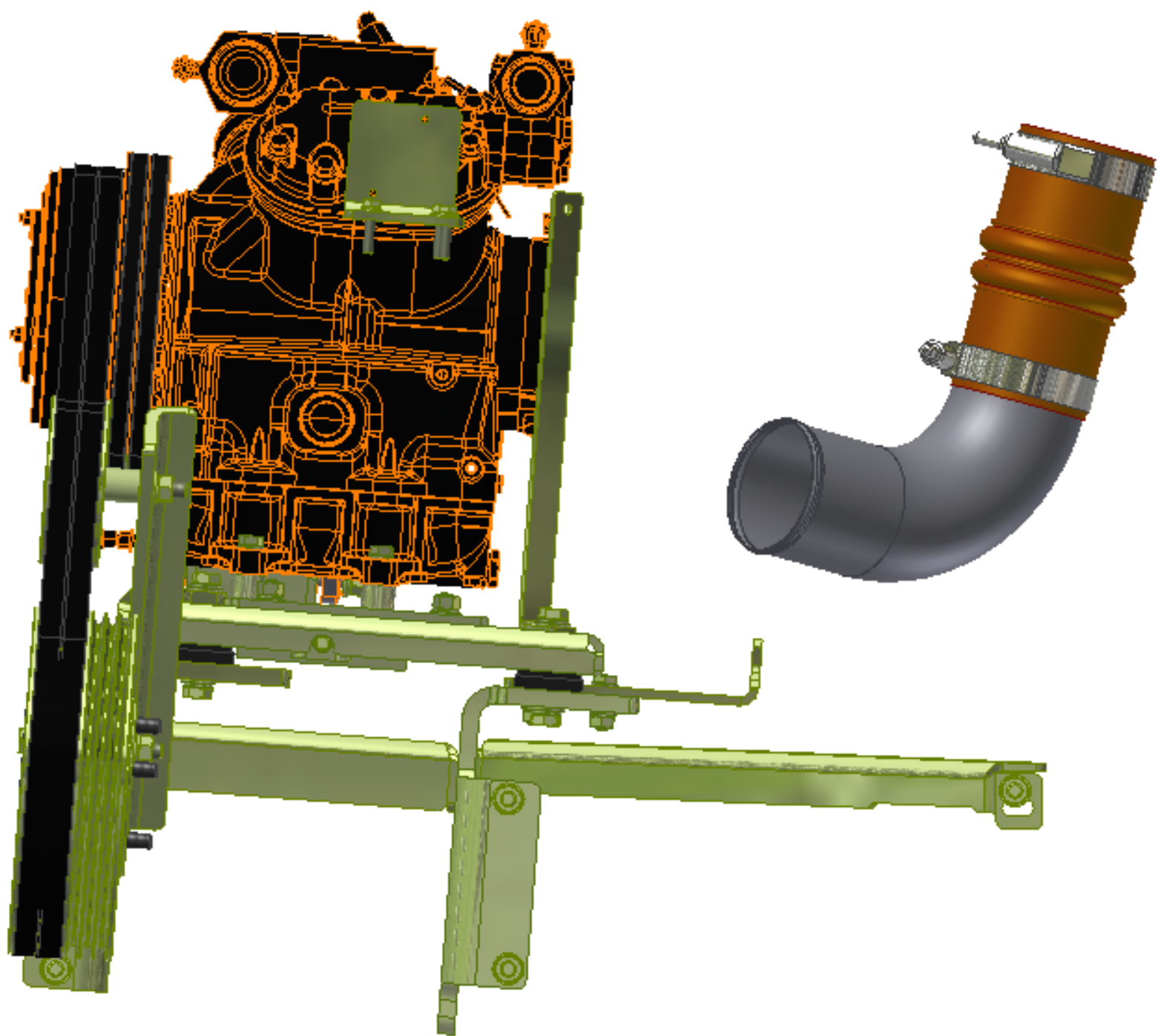
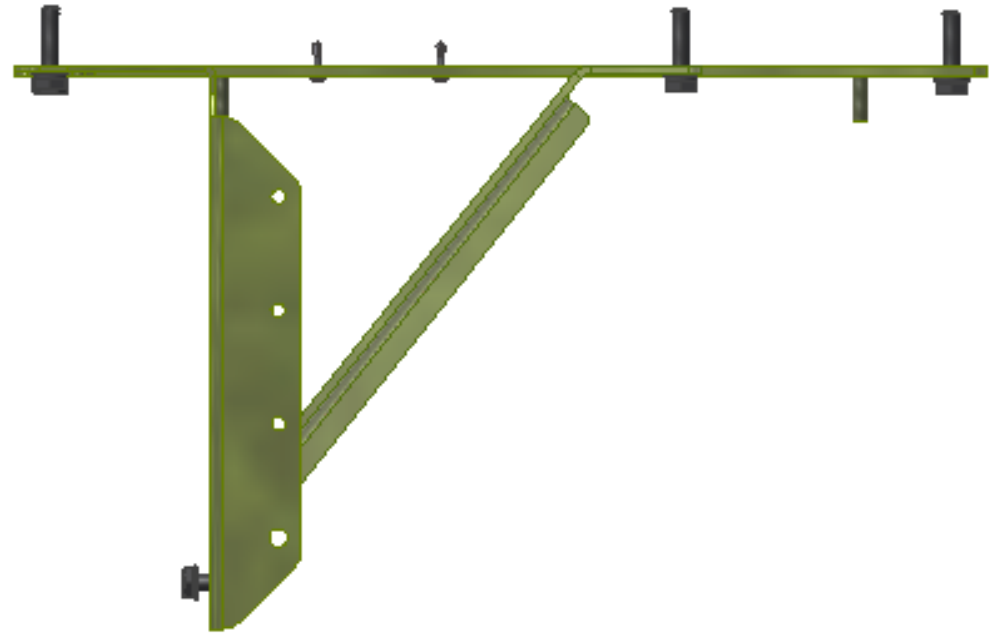

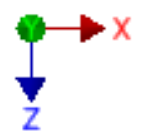
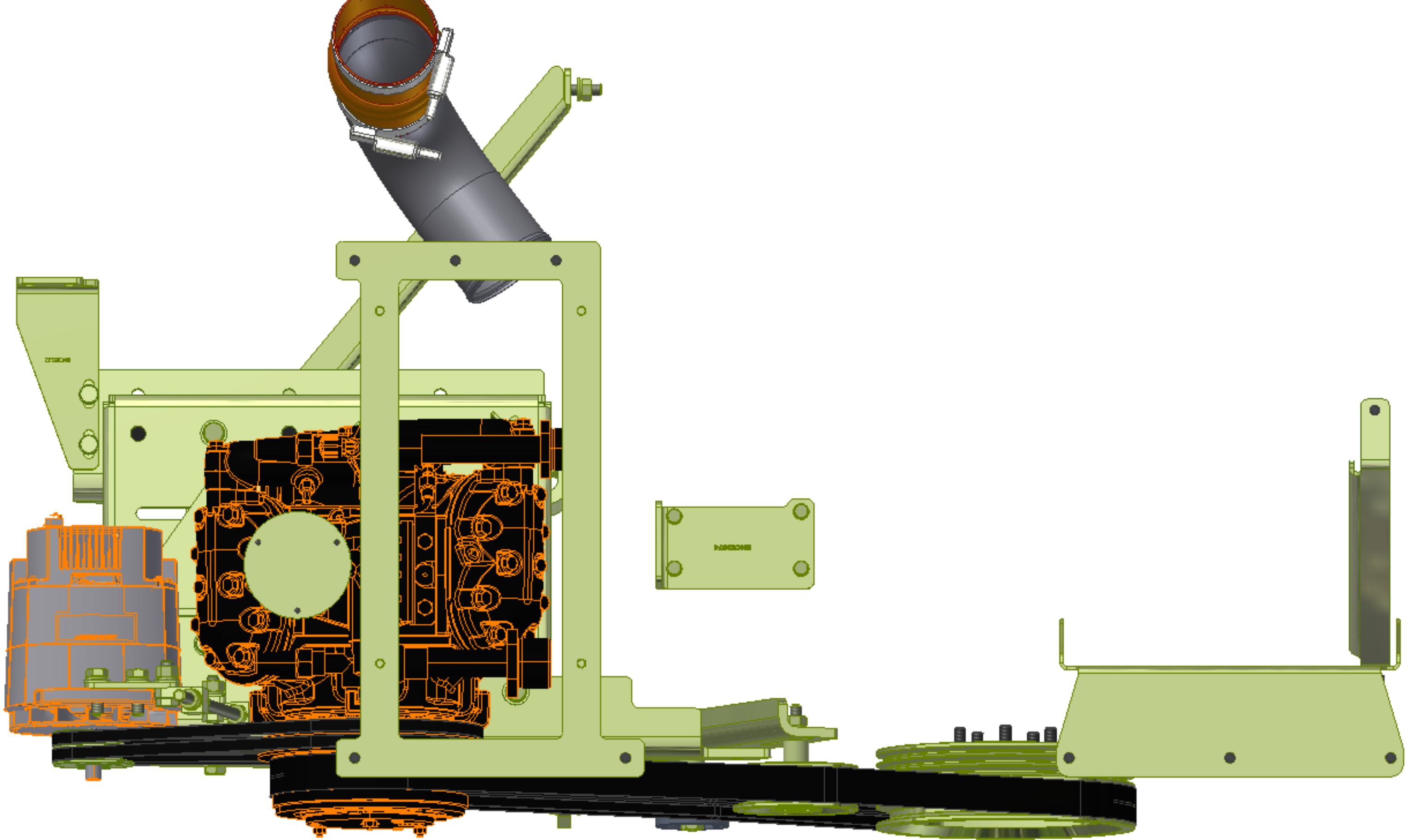

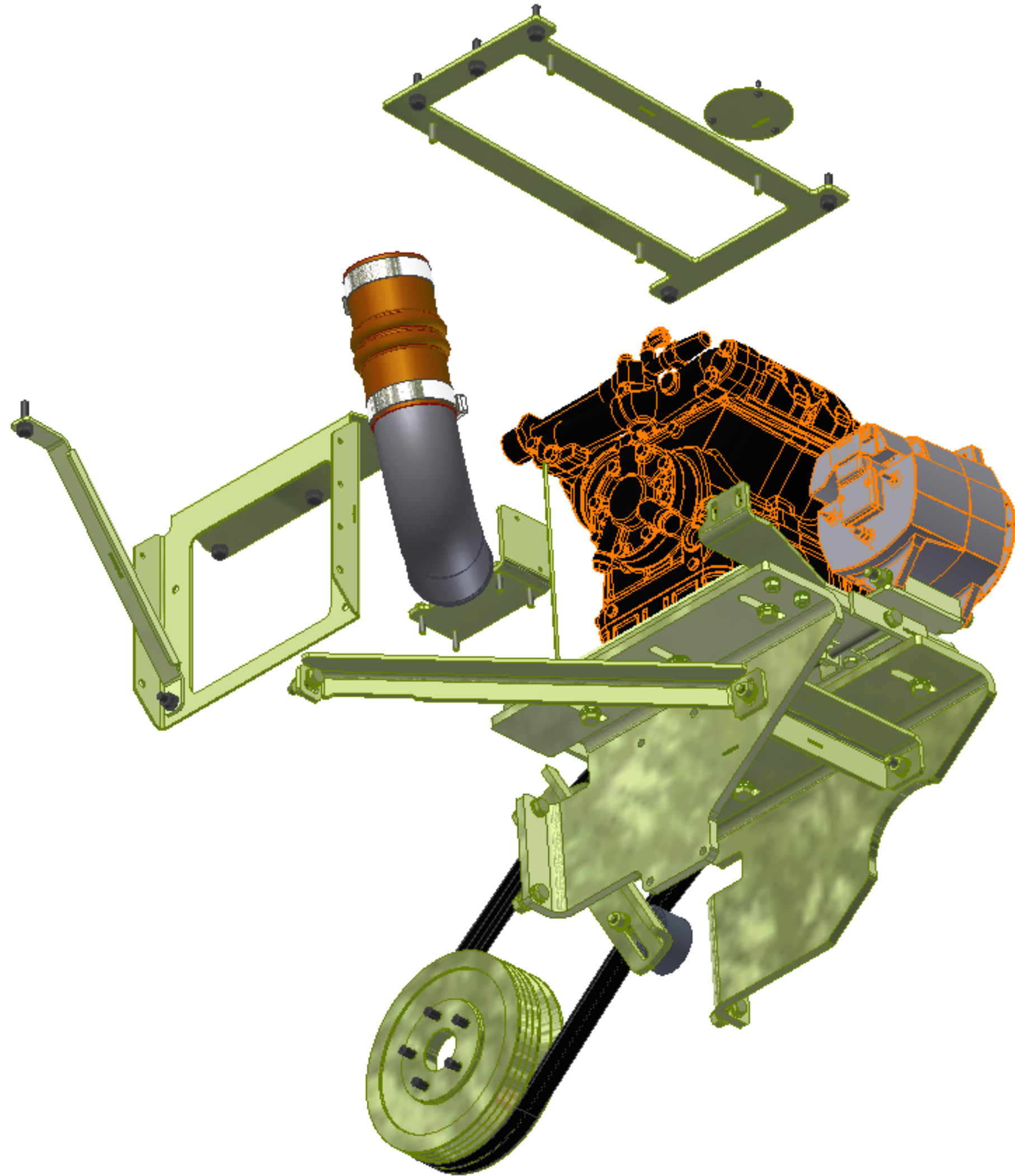

TransArctic A/C Compressor Mount Installation Disclaimer

All compressor mounts should be installed by qualified and trained personnel using proper tools and equipment in safe working conditions following industry standard guidelines for motor vehicle service and repair.

The installer of any compressor mount purchased from TransArctic must undertake all responsibility of issues arising from that compressor bracket being installed on any vehicle. As well as insure that a **proper and sufficient ground** is established between the compressors' clutches and the vehicle's engine. Mount functionality, operation and durability can all be compromised by an incompetent installation.

Due to the many different situations, parameters and application criteria, which are beyond the compressor mount manufacturer's control, TransArctic does not warrant design, durability, or operational functionality of any compressor mount improperly installed by another party.

With no implied guarantees it is the mount installer's strict responsibility to determine safety and functionality, of the compressor mount, at the time of installation.

Please contact TransArctic with any issue arising from installation so we may better improve the product. If you have any reservations about the compressor mount integrity contact TransArctic immediately at 1-877-COLD-AIR.

Mark OEM tensioner location

Install Kit

Check for Interferences

Check to ensure that the proper OEM tensioner orientation is maintained

Run engine with A/C system engaged for at least 10 minutes to run in belt

Check OEM tensioner orientation and adjust as required

Responsabilidad limitada de TransArctic en la instalación del soporte del compresor

Todos los soportes de los compresores deben ser instalados por personas calificadas y entrenadas, usando para ello los equipos y herramientas necesarios para esta labor en buenas condiciones y según las normas y guías para el servicio y/o reparación de motores de vehículos.

El instalador de los soportes comprados en TransArctic asume toda la responsabilidad de cualquier problema que surga en el soporte del compresor al vehículo; de igual manera es responsable que el cable a tierra sea conectado entre el embrague del compresor y el motor del vehículo.

Se advierte que el buen funcionamiento y la durabilidad del soporte pueden ser comprometidos por defectos en su instalación.

Debido a las diversas situaciones que se puedan presentar fuera del control del fabricante, TransArctic no garantiza el diseño, la durabilidad o el correcto funcionamiento de cualquier equipo inapropiadamente instalado por terceros.

Esta sobreentendido que el Instalador del montaje del compresor es estrictamente responsable de la seguridad y funcionamiento del equipo en el momento de la instalación.

Si tuviera algún problema o duda acerca de la instalación del soporte del compresor pongase en contacto inmediatamente con TransArctic al teléfono 1-877-COLD-AIR de modo que podamos mejorar nuestro producto.

Note la ubicación del medidor de tensión OEM

Instale el equipo

Controlar si hay interferencias.

Asegurese que el medidor de tensión mantenga la orientación justa.

Encienda el motor por lo menos 10 minutos con el sistema A/C enganchado para que la correa corra

Controle la orientación justa del medidor de tensión y ajuste a las condiciones requeridas del fabricante